

KENNET
EXPLORATIOI



42A11SE0456 63.4738 TISDALE

010

REPORT ON DIAMOND DRILL PROGRAM - 1985
AND
EXPLORATION PROPOSAL
FOR
DAVIDSON TISDALE MINES LIMITED
DAVIDSON - BROULAN PROJECT
TISDALE TOWNSHIP, ONTARIO

OM 85-168

Timmins, Ontario
December, 1985

Kenneth Guy
Geologist

ph (705) 235-8271

BOX 6045 P.M.S., SOUTH PORCUPINE, ONTARIO PON IKO

TABLE OF



42A116E0456 63.4738 TISDALE

010C

	<u>Page</u>
Summary	1
Conclusions	2
Recommendations	3
Introduction	5
Location And Access	5
Property	7
Previous Work	7
Geology And Economic Geology	8
Diamond Drill Program - 1985	10
A. DT Depth Extension	
B. S-Zone Extension	
C. Armstrong-McGibbon	
Certificate	19

APPENDICES

I	Diamond Drill Logs	under separate cover
II	Diamond Drill Sections	back pocket

LIST OF FIGURES

I	Location Map	5
II	Compilation Map	back pocket

TABLES

I	Diamond Drill Hole Summary	15-18
---	----------------------------	-------

SUMMARY

During the latter part of 1985 a drill program was conducted on the Davidson Tisdale Mines Limited, Davidson-Broulan project in Tisdale township. The property, 27½ claims, 1100 acres, in the heart of the Porcupine gold camp encloses a portion of favourable, gold bearing stratigraphy along strike from the most prolific gold mines in Canada. The property adjoins and surrounds the Getty-Davidson Tisdale joint venture where underground exploration is ongoing in an attempt to determine production feasibility.

The 1985 drill program consisted of testing for the continuity of 3 separate known auriferous structures:

- 1) Testing for the depth extension of the Getty-Davidson Tisdale joint venture project, 4 holes, 2237.1 metres drilled.
- 2) Testing for extensions of the S-zone as outlined on the joint venture project, 2 holes, 514 metres drilled.
- 3) Testing the historic Armstrong-McGibbon shaft and showing 8 holes, 1543 metres drilled.

CONCLUSIONS

- 1) The program for the depth extension of the Getty-Davidson Tisdale project was successful in intersecting the alteration zone hosting the occurrence, anomalous gold values were obtained in each hole, with a high of .0.247 oz./ton/1.5 metres. No significant quartz veining was intersected however the structure hosting the quartz veining is now known to extend to a depth of 450 metres below surface. The values obtained during the program suggest that the zone plunges to the west.

- 2) The S-zone was not found to extend beyond the joint venture property, however due to the extreme step-outs involved in the recent program a small change in attitude of the zone would explain the negative results obtained.

- 3) The program on the Armstrong-McGibbon was successful in delineating 3 separate quartz-sericite-carbonate alteration zones, 2 of which were found to be auriferous. Visible gold with values up to 0.99 oz. Au/ton/1.0 metre were intersected in the middle zone, ore grade mineralization was present in 3 of 7 drill holes. The alteration zones have been traced for a strike length of 200 metres, strike northeast and dip 35-45° to the north.

RECOMMENDATIONS

In view of the mixed results obtained during the 1985 diamond drilling program the following recommendations are suggested for the Davidson Tisdale Mines Ltd., Davidson-Broulan project area.

- 1) Further exploration on extending occurrences from the Getty-Davidson Tisdale joint venture property be suspended pending further delineation work on the joint venture property. The step-outs presently involved are such that a reasonable confidence level cannot be obtained for correlation of data.
- 2) Additional exploration be conducted at the Armstrong-McGibbon area, particularly in delineating the near surface expression of the middle zone where values up to 0.99 oz.Au/ton/1.0 metre were obtained. Geophysical surveys, magnetics, and VLF-EM, are recommended to better delineate stratigraphy and to determine if there is a geophysical expression to the alteration zones.
- 3) A comprehensive compilation be completed of the entire Davidson-Broulan project area to determine additional areas of exploration potential, in particular the Kinch ground where Newmont obtained values of 0.07 oz. Au/28.9 feet including 0.14 oz.Au/ton/4.6 feet. The values were obtained in a faulted carbonaceous basalt, core recoveries were

poor with the sludges assaying 0.17 oz. Au/ton/70 feet including 0.34 oz. Au/ton/10 feet. This is a favourable exploration environment similar to that of Kidd Creek's, Hoyle Pond gold Mine.

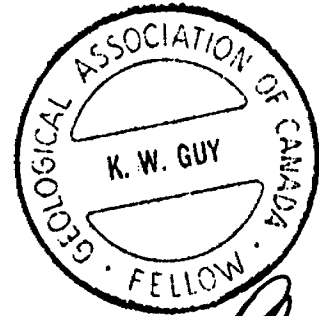

A handwritten signature in black ink, appearing to read "K. W. Guy", written below the circular seal.

INTRODUCTION

The Davidson Tisdale Mines Limited - Davidson Broulan project consists of 27½ claims, approximately 1100 acres, in Tisdale township, in the heart of the Porcupine gold camp.

The properties were acquired by Davidson Tisdale during 1984 and 1985.

The properties adjoin the Getty-Davidson Tisdale joint venture where underground exploration is on-going in an effort to determine production feasibility.

The Davidson-Broulan project overlies rocks of the Tisdale Group which contain most of the gold production of the Porcupine camp.

This report prepared for Davidson Tisdale Mines Limited details the results of a Diamond Drill program conducted during October to December, 1985.

LOCATION AND ACCESS

The Davidson-Broulan project is located in Tisdale township, Porcupine Mining Division, Ontario. The project lies within the boundaries of the City of Timmins.

Access to the property is from South Porcupine via the Getty-Davidson Tisdale joint venture road to the southern portion

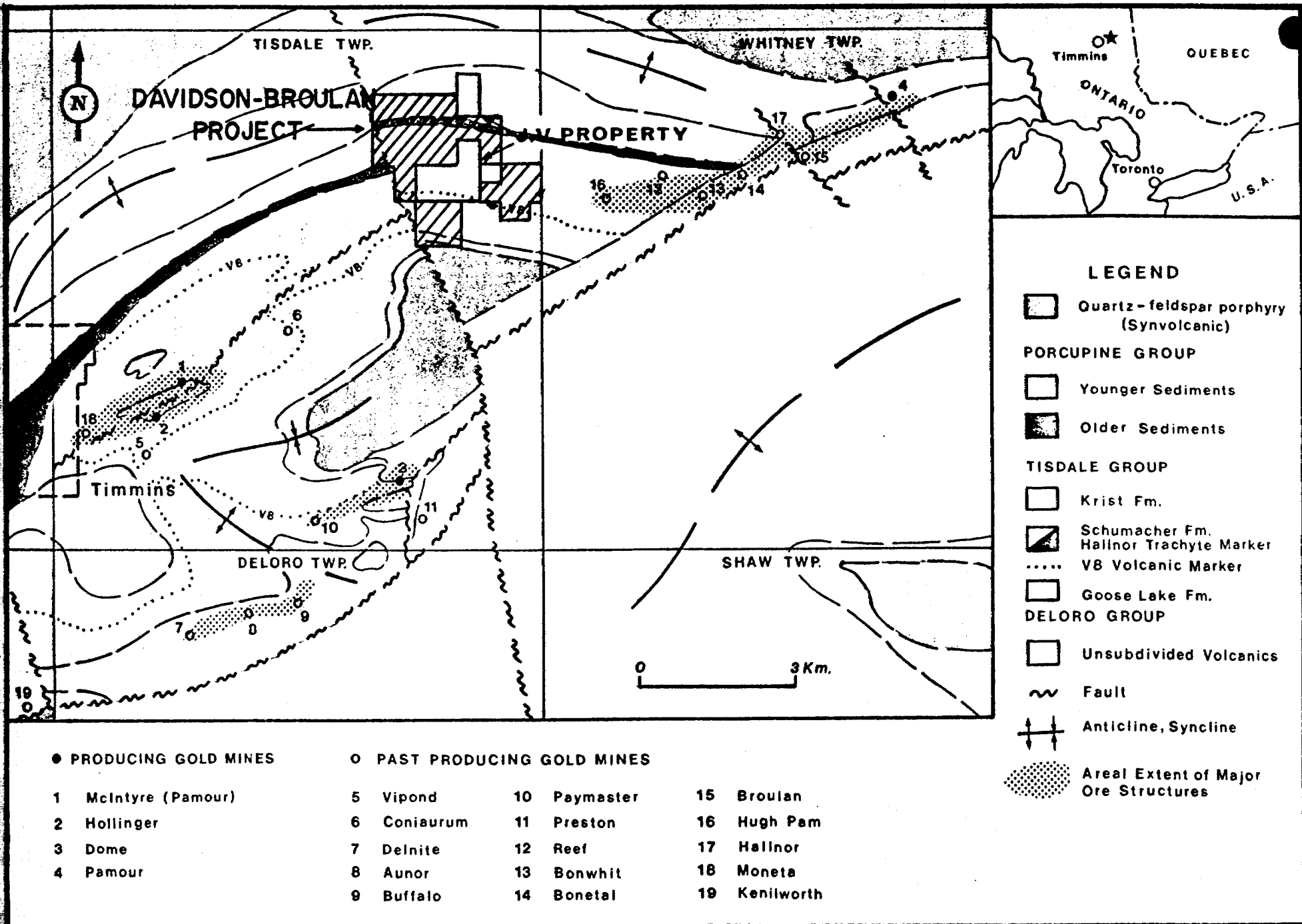

of the property. The northern portion of the property is accessed via the Consumers Gas road from South Porcupine.

PROPERTY

The Davidson-Broulan project consists of 27½ contiguous claims surrounding the Getty-Davidson Tisdale joint venture.

Patent Claims - Broulan Option

P6239, 6254, 6270, 6285, 6287, 6577, 12811, 12812, 12886-890,
12906, 12959, 12969, 12970, 12972 18 Patented claims

Allerston Option

P567377, 567387, 567395-97, 568467

6 Unpatented claims - 200 man days on each claim

Gonzales Option

P530646, 530647, 595535

3 Unpatented Claims - 200 man days on each claim

P836902 - ½ claim recorded under Davidson Tisdale Mines Ltd.

PREVIOUS WORK

Considerable exploration work has been done in the past on the project area. Much of this work was conducted during the earlier part of the century and therefore little documentation is present.

In recent time the most extensive exploration was performed

by Newmont Exploration of Canada Limited who held the properties under option in 1983, 84. The exploration by Newmont consisted of geophysical, geochemical and geological surveys followed by diamond drilling. The Davidson-Broulan option consists of a small portion of the larger holdings maintained by Newmont at that time.

GEOLOGY AND ECONOMIC GEOLOGY

The Davidson-Broulan project area is underlain by mafic volcanic rocks which are part of a volcanic-sedimentary succession that forms the north limb of the Porcupine Syncline. The rocks belong to the Tisdale Group of volcanics, Schumacher formation. The Schumacher formation is the host of the majority of the past and present gold producers in the Porcupine camp.

The Schumacher formation on the project area is primarily magnesium tholeiitic basalts and iron tholeiitic basalts. It is the magnesium tholeiites which are of primary importance as they are the host of the majority of the gold occurrences including that of the joint venture property.

Alteration of the Magnesium tholeiites can be broken down to two alteration facies easily identifiable in the field and in drill core.

- 1) Chlorite-carbonate: fine grained, dark green colour, quartz/albite, chlorite, calcite, trace epidote

- 2) Sericite - carbonate: grey to brown colour-
quartz/albite, sericite, ferroan dolomite

The relationship of the alteration facies is: Mg Tholeiite, fresh grades to - chlorite - carbonate alteration which grades to - sericite-carbonate alteration. Sericite-carbonate rock is the host of the quartz veins detected on the Davidson-Broulan project area and is commonly anomalous in gold. This alteration facies is also the host of the auriferous veins on the joint venture property and of the majority of the auriferous veins in the Porcupine camp.

DIAMOND DRILL PROGRAM - 1985

During the period from October to December, 1985, a total of fifteen diamond drill holes, totalling 4,294.1 metres were completed on the Davidson-Broulan project.

The diamond drill logs and drill sections are contained in Appendix I. The location of the holes can be seen on the compilation, Figure I.

The diamond drilling was carried out by Longyear Canada of North Bay, Ontario. Two drills were utilized, a Longyear 44 drilling NQ core on a program of deep holes, and a Longyear 38 drilling BQ on a program of shorter holes.

The diamond drill program had three separate objectives:

- 1) test for the depth extension of the Davidson Tisdale Mine
- 2) test for extensions of the Getty-Davidson Tisdale joint venture S-zone
- 3) test the Armstrong-McGibbon showing area

A summary of the diamond drill holes and results is given in Table I.

DT Depth Extension

Four holes, 2237.1 metres, were drilled to test for the depth extension of the Getty-Davison Tisdale joint venture

occurrence. The holes, designated BR-85-1, 2, 3, and 4, were drilled from claim P12887.

It is believed that all holes intersected the alteration zone which hosts the joint venture occurrence. Although this can not be determined with certainty, due to the significant step-outs taken of almost 300 metres along section, the nature of the alteration as well as the anomalous gold values obtained tends to support this hypothesis.

Holes 1 and 3 were drilled assuming a plunge down dip of the structure. The alteration zone in both holes displays anomalous gold values relative to unaltered rock and other alteration zones in the holes. In hole 3 a quartz vein was intersected in the alteration zone which assayed 698 ppb Au/0.9 m.

In hole 1 a strong quartz vein was intersected below the alteration zone believed to represent the joint venture occurrence. This vein of 3.9 metres of near massive quartz is of similar nature and probably represents the S-zone from the joint venture property.

Hole 2 was drilled to test for a more northeasterly plunge. At the target depth an alteration zone was intersected which returned anomalous gold values. No significant quartz veining was present.

Hole 4 was drilled to test for a more westerly plunge.

An alteration zone was intersected at the target depth, no significant quartz veining was present however the zone was anomalous in gold with assays up to 0.247 oz. Au/Ton/1.5 metres. This result tends to support a westerly plunge to the joint venture main zone.

S-Zone Extension

Two holes, 514 metres, were drilled to test for the strike extension of the S-zone as outlined on the Getty-Davidson Tisdale joint venture property.

Extraordinary large step-outs were involved making attempts at correlation quite difficult.

Hole DA-85-1 was drilled on the Allerston option to test for the western extension of the S-zone. No alteration zones nor significant quartz veins were intersected.

DG-85-1 was drilled on the Gonzales option to test for the eastern extension of the S-zone. A 5.5 metre alteration zone was intersected however neither quartz veins nor anomalous gold values were intersected.

Armstrong-McGibbon

Eight holes, 1543 metres were drilled on an historic showing referred to as the Armstrong-McGibbon. The attitude

of the quartz veins in the showing area has been the subject of much debate however experience from the joint venture property has shown the intimate relationship of the veins to alteration zone. A re-evaluation of the area utilizing experience gained from work on the joint venture property lead to a better understanding of the alteration zone and prompted a diamond drill test of the area. Three separate quartz-sericite-carbonate alteration zones were each intersected in seven holes. Two of the alteration zones were auriferous with the third yielding no values during the present program.

The alteration zones strike northeast and dip 35-45° to the north. They have been traced, by diamond drilling for a strike length of 200 metres. The alteration zones range in thickness from 10 - 60 metres. The quartz veins occupy the central portion of the alteration zones.

A summary of the zones is as follows:

UPPER ZONE: - Armstrong McGibbon zone, historic showing, 2 shafts - deepest approximately 100 feet, recently stripped on surface over strike length of 150 metres - intersected in seven holes, only one of which contained a significant quartz vein system, 5.5 metres, DB-85-2, one significant assay result from DB-85-8, .173 oz./1.0 m.

MIDDLE ZONE: - previously unknown zone - 30 - 40 metres below Armstrong-McGibbon zone - quartz veining in 5 of 7 holes, up

to 3.7 metres in thickness, visible gold in 3 of 7 holes, values ranging from trace to .99 oz. Au/Ton/1.0 m. Ore grade mineralization in 3 of 7 drill holes.

The interpreted surface expression corresponds with a weak I.P. anomaly.

LOWER ZONE: - lies approximately 40 m below the middle zone - quartz veining in 2 of 7 holes, no visible gold, no economic assays.

DAVIDSON TISDALE MINES LTD.

DIAMOND DRILL HOLE SUMMARY

<u>Hole Number</u>	<u>Property</u>	<u>Location</u>	<u>Dip</u>	<u>Bearing</u>	<u>Length(m)</u>	<u>Target</u>	<u>Alteration Zones</u>	<u>RESULTS</u>	
								<u>Quartz Vein Systems</u>	<u>Assays</u>
BR-85-1	Broulan Patent Claim 12887	DT Mine Grid 10072N 9875E	-83°	az 112°	586.5 m	DT Zone At depth	21.4-49.1 134.5-156.0 232.0-244.0 355.0-399.0 415.5-423.0 450.5-467.0	454.6-458.5 Strong	No Significant Values
BR-85-2	Broulan Patent Claim 12887	DT Mine Grid 10046N 9964E	-85°	az 090°	465.0 m	DT Zone At depth	21.0-56.3 98.0-191.0 286.0-357.6 365.7-377.0 394.0-398.3 422.5-432.5	None	No Significant Values
BR-85-3	Broulan Patent Claim 12887	DT Mine Grid 9,916E 10,118N	-85°	az 090°	650.0	DT Zone At depth	64.0-75.5 91.5-164.0 179.0-275.0 307.0-349.0 425.0-459.0 468.5-489.0 500.0-539.0	103.7-109.7 436.5-437.9	698 ppb/0.9 m
BR-85-4	Broulan Patent Claim 12887	DT Mine Grid 10,040N 9,775E	-87.5°	az 090°	535.6	DT Zone At depth	20.0-53.5 98.8-134.0 301.0-374.0 402.0-415.8 462.0-491.5	478.2-482.3 Weak	688 ppb/1.5 m .247 oz/T/1.5 m 468.5-470.0 .061 oz/T

DAVIDSON TISDALE MINES LTD.

DIAMOND DRILL HOLE SUMMARY

Page 2

<u>Hole Number</u>	<u>Property</u>	<u>Location</u>	<u>Dip</u>	<u>Bearing</u>	<u>Length(m)</u>	<u>Target</u>	<u>Alteration Zones</u>	<u>Quartz Vein Systems</u>	<u>RESULTS</u> <u>Assays</u>
DG-85-1	Gonzales Option	DT Mine Grid 9450N 10450E	-90°		230.0 m	Extension of S-Zone	208.0-213.5	None	No Significant Values
DA-85-1	Allerston Option	DT Mine Grid 9600N 9150E	-90°		284.0	Extension of S-Zone	None	None	No Significant Values

DAVIDSON TISDALE MINES LTD.

DIAMOND DRILL HOLE SUMMARY

Page 3

<u>Hole Number</u>	<u>Property</u>	<u>Location</u>	<u>Dip</u>	<u>Bearing</u>	<u>Length(m)</u>	<u>Target</u>	<u>Alteration Zones</u>	<u>RESULTS</u>	
								<u>Quartz Vein Systems</u>	<u>Assays</u>
DB-85-1	Broulan Armstrong- McGibbon	Newmont Grid 17+10W 125+100N	-90°		254.0	Test Surface Showing	10.0-29.3 73.8-81.0 117.0-128.0 148.0-160.1	121.5-122.9 Strong 150.2-158.3 Moderate	No Significant Values
DB-85-2	Broulan Armstrong- McGibbon	Newmont Grid 17+10W 125+100N	-48.5°	az 180°	56.0 m	Test Surface Showing	10.0-27.0	16.0-21.5	No Significant Values
DB-85-2 ext	Broulan Armstrong- McGibbon	Newmont Grid 17+10W 125+100N	-48.5°	az 180°	179.0	Test Au Zone	69.5-127.0	75.2-78.9 78.55 VG	.203 oz/T/.5 m
DB-85-3	Broulan Armstrong- McGibbon	Newmont Grid L14W 126+50N	-90°		131.0	Test Extension Of Armstrong- McGibbon	None	None	No Significant Values
DB-85-4	Broulan Armstrong- McGibbon	Newmont Grid L22W 126+75N	-90°		203.0	Test Surface Showing	18.8-23.9 35.0-37.5 101.0-108.5 159.3-182.6	104.15-105.2 VG	.084 oz/T/1.0 m 1.65 } .332 } <u>.991 oz/T</u> 1.0 m

DAVIDSON TISDALE MINES LTD.

DIAMOND DRILL HOLE SUMMARY

Page 4

<u>Hole Number</u>	<u>Property</u>	<u>Location</u>	<u>Dip</u>	<u>Bearing</u>	<u>Length(m)</u>	<u>Target</u>	<u>Alteration Zones</u>	<u>RESULTS</u>	
								<u>Quartz Vein Systems</u>	<u>Assays</u>
DB-85-5	Broulan Armstrong- McGibbon	Newmont Grid L22W 126+75N	-50°		217.0	Test Surface Showing	21.0-44.0 79.7-107.0 145.0-170.0		No Significant Values
DB-85-6	Broulan Armstrong- McGibbon	Newmont Grid L22W 126+75N	-65°		178.0 m	Test Surface Showing	20.5-37.0 80.0-103.0 150.5-166.4		No Significant Values
DB-85-7	Broulan Armstrong- McGibbon	Newmont Grid L20W 125+50N	-90°		208.0	Test Surface Showing	9.5-28.0 57.0-81.2 123.0-156.0 163.1-166.3 186.5-194.0	62.7-65.4 124.4-125.6	61.0-62.0 .382 oz/T
DB-85-8	Broulan Armstrong- McGibbon	Newmont Grid L20W 125+50N	-45°	az 180°	173.0	Test Surface Showing	7.0-23.7 56.0-75.9 87.0-107.0	65.5-68.1 (VG)	11.5-12.5 .173 oz/T ----- .629 gms/2.6 m

CERTIFICATE

I, the undersigned, Kenneth Guy, residing at 180 Nadine Street, South Porcupine, Ontario graduated with a Bachelor of Science, degree in Earth Science - Geology from the University of Waterloo, Waterloo, Ontario in 1978.

I have been employed in the field of Geology since graduation in 1978.

I am a fellow of the Geological Association of Canada.

I do not hold, nor do I expect to receive an interest of any kind in these claims held by Davidson Tisdale Mines Ltd. nor in any other mining claims they may have.



Timmins, Ontario

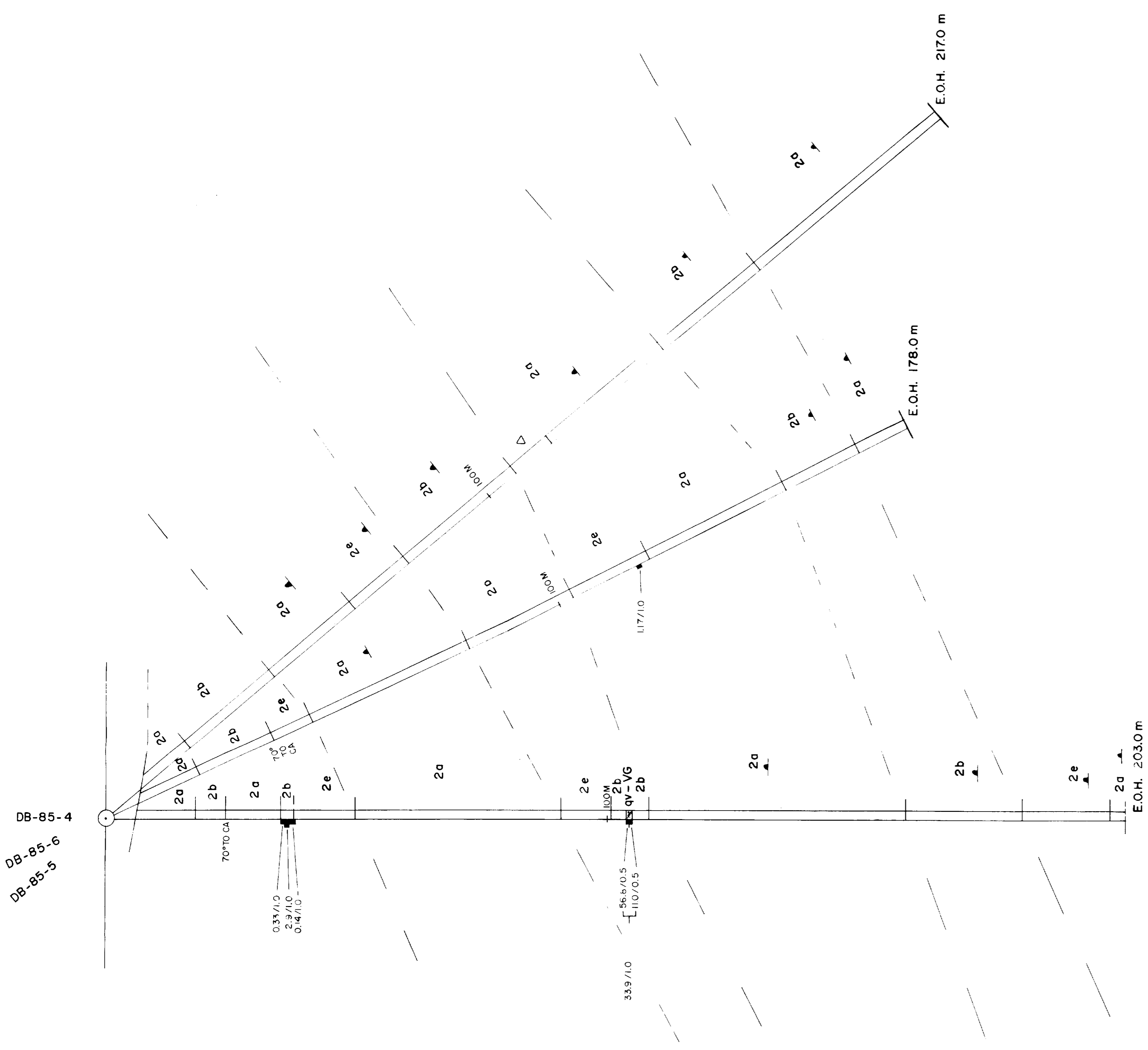

Kenneth Guy, Geologist



LEGEND

- 2 Mg - THOLEIITE BASALT
- 2c schiste - carbonate
- 2e chloite - carbonate
- 2d schiste - carbonate
- 2b chloite - carbonate
- 2a quartz vein system
- 2a quartz vein
- 2a visible sand
- 2a pinched
- 2a fragmental, brecciated
- 2a schistose, sheared
- 2a fault zone

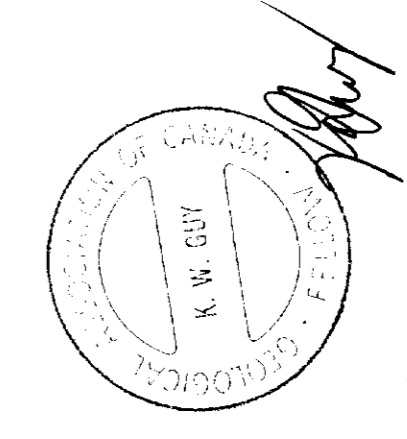
ASSAYS over 0.1 gms Au / tonne
gms Au / metres



OM85-168 **63.4138**
KENNE TH GUY

EXPLORATION SERVICES
DAVIDSON TISDALE MINES LTD.
SECTION : 22 W
(Lookire East)
BROULAN
Claim 12886
NOV/1985
K. GUY
1 : 500

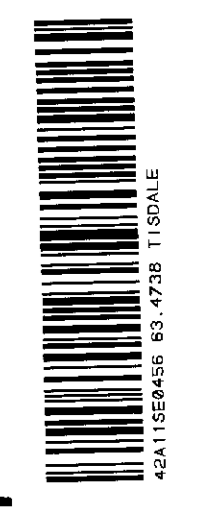

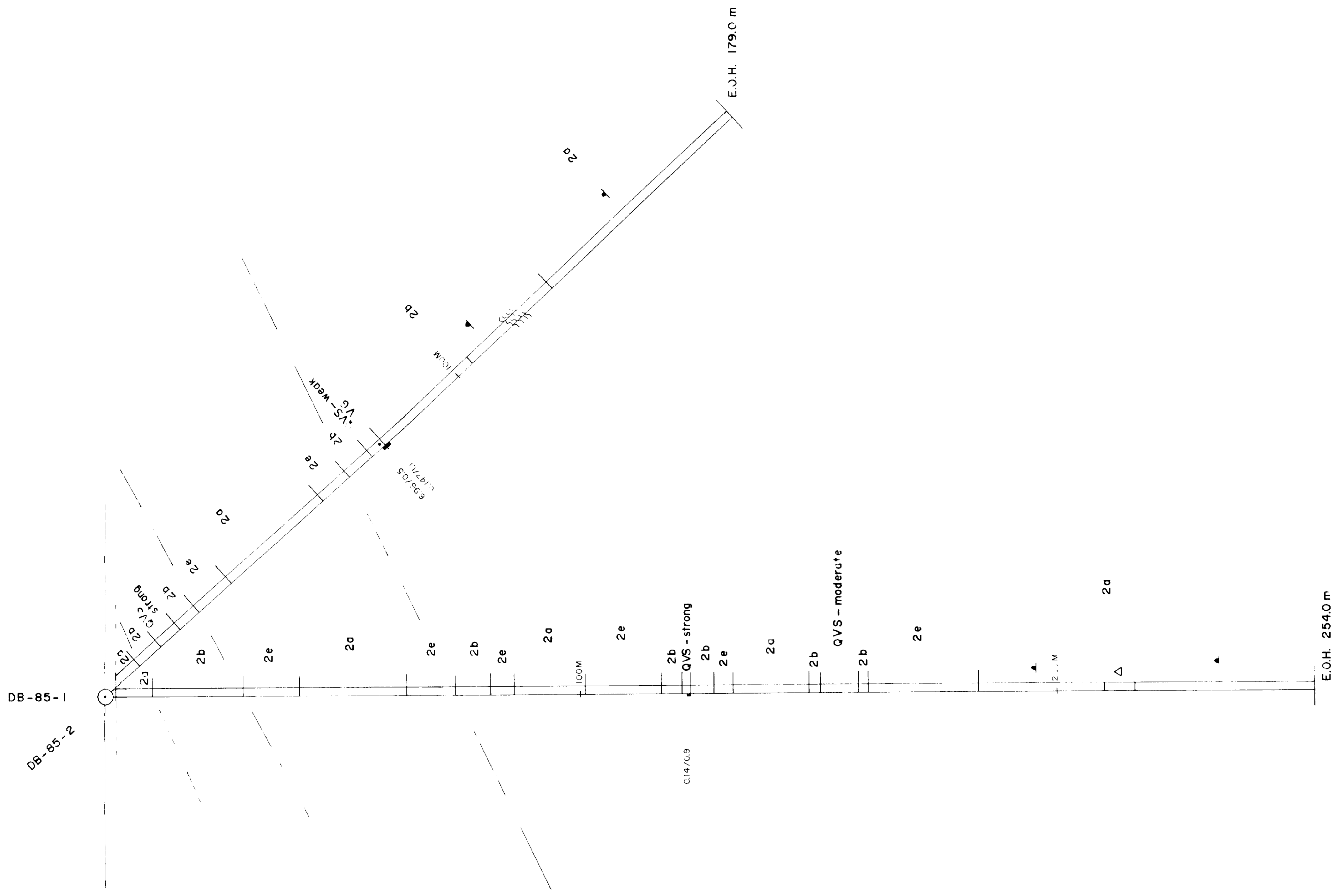

LEGEND

- 2a - Mafic - Basalt
- 2b - Andesite
- 2c - Basalt - Intermediate
- 2e - Diorite - Granite

- QVS - Quartz vein system
- CL4/G3 - Chlorite - Garnet
- CL4/G3 - Chlorite - Garnet
- CL4/G3 - Chlorite - Garnet
- CL4/G3 - Chlorite - Garnet
- CL4/G3 - Chlorite - Garnet
- CL4/G3 - Chlorite - Garnet
- CL4/G3 - Chlorite - Garnet

Scale: 1:500
 Vertical scale: 1 cm = 100 m
 Horizontal scale: 1 cm = 250 m



63.4738

KENNETH GUY
 EXPLORATION SERVICES
 JAMESON TISDALE MINES LTD.

SECTION: 18+50 W

(Looking East)
 BROULAN
 Claim 12986

NOV/1985
 K. GUY

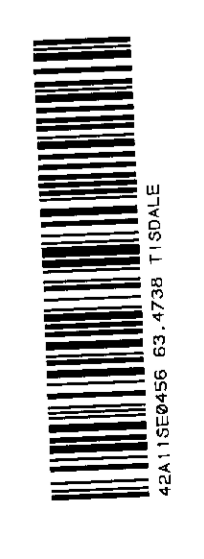

298-84-20
 08-85-4

NEWMONT Diamond Drill Hole
 DAVIDSON TISDALE MINES LTD.
 1985 Diamond Drill Hole

UZ Upper Zone
 MZ Middle Zone
 0.99/1.0 oz. Au/ton / metres

SHAFT

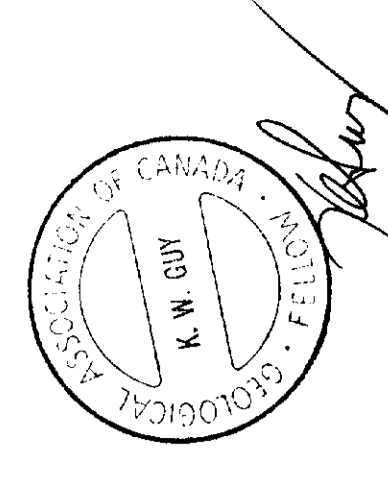
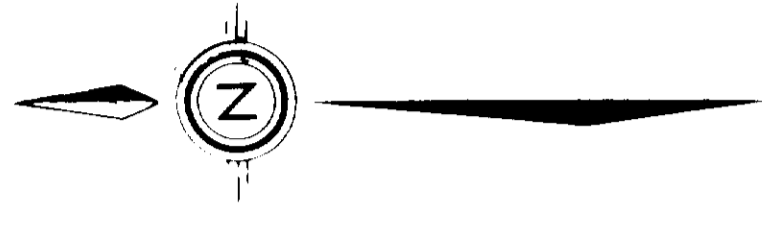

63.4738 0M85-168

KENNETH GUY
 EXPLORATION SERVICES

DAVIDSON TISDALE MINES LTD.

COMPILATION
 DAVIDSON - BROULAN PROJECT

PROPERTY: TISDALE TWP DATE: DEC/85
 LOCATION: TIMMINS, ONT. BY: K. GUY

SCALE: 1 inch = 500 feet

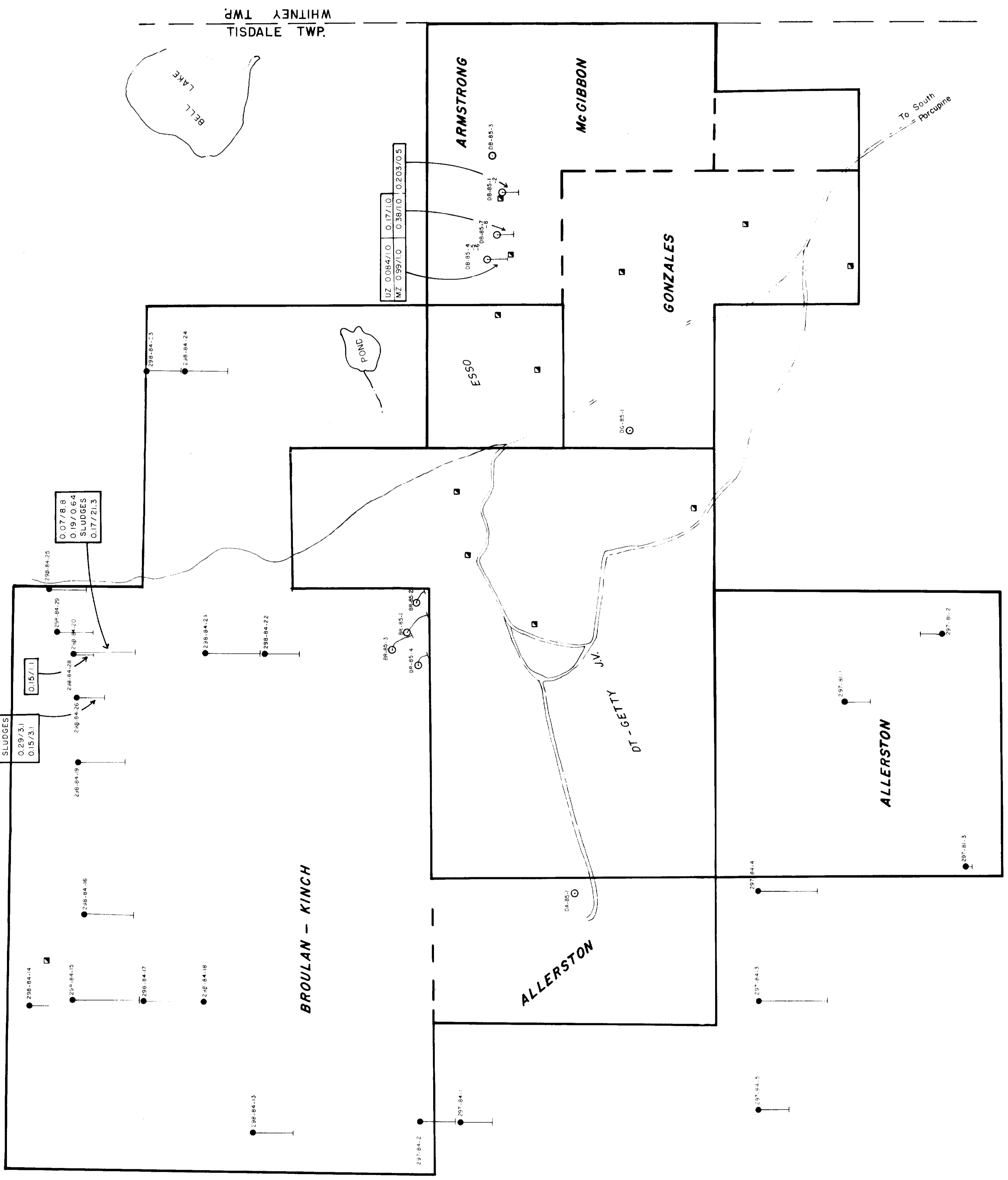

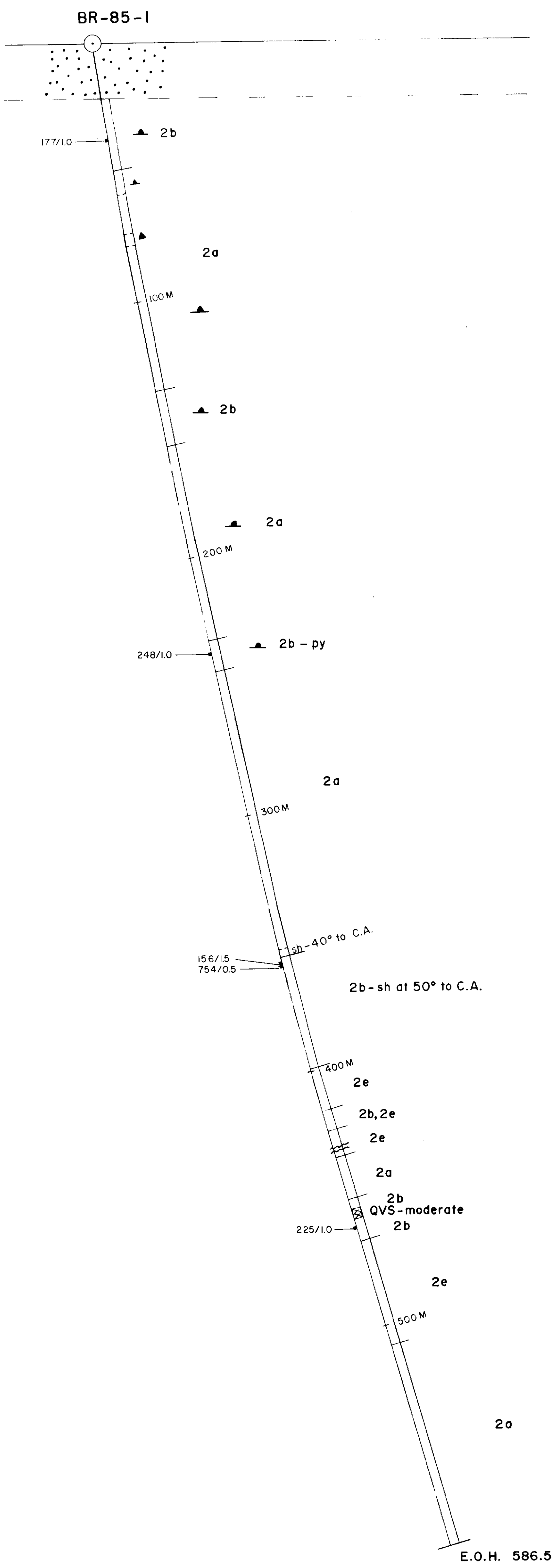
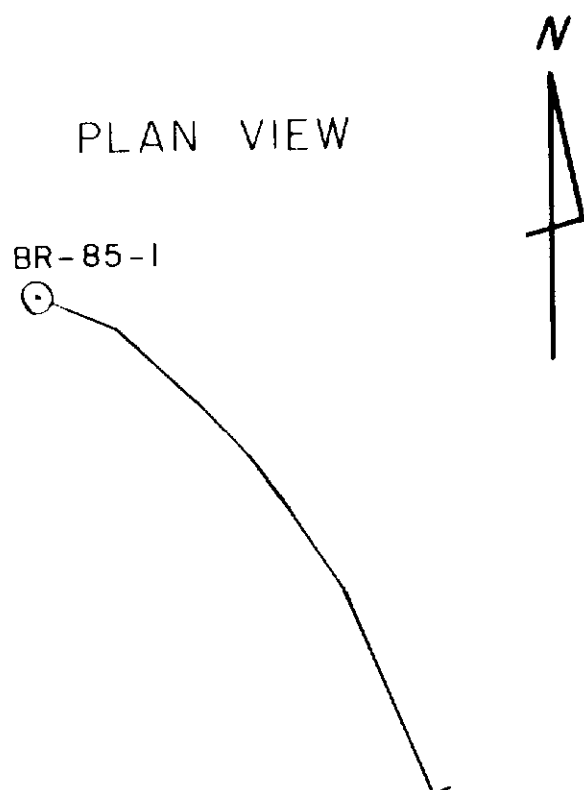

LEGEND

- Mq. E.H. 7.1.7. E.A. 2.1.1
- 2a unaltered
- 2b brecciated - quartzite
- 2c quartzite - quartzite
- QVS Quartz Vein System
- sh. schistose shear zone
- ▲ brecciated
- ASSAYS over 100 ppb
- 0pp Au
- metres

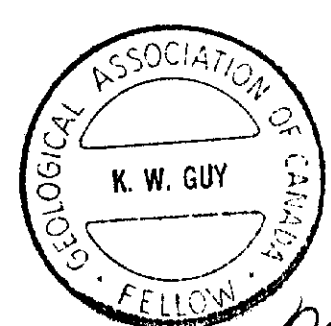

PROJECT	DAVIDSON TISDALE MINES LTD.
DCR No.	BR-85-1
Location	J.V. Mine Grid 10,072N 9,875E
Location	TISDALE TWP. Patent 12887
Date	K. GUY
Date	Oct., Nov. 1985
SCALE	1:1000





PLAN VIEW

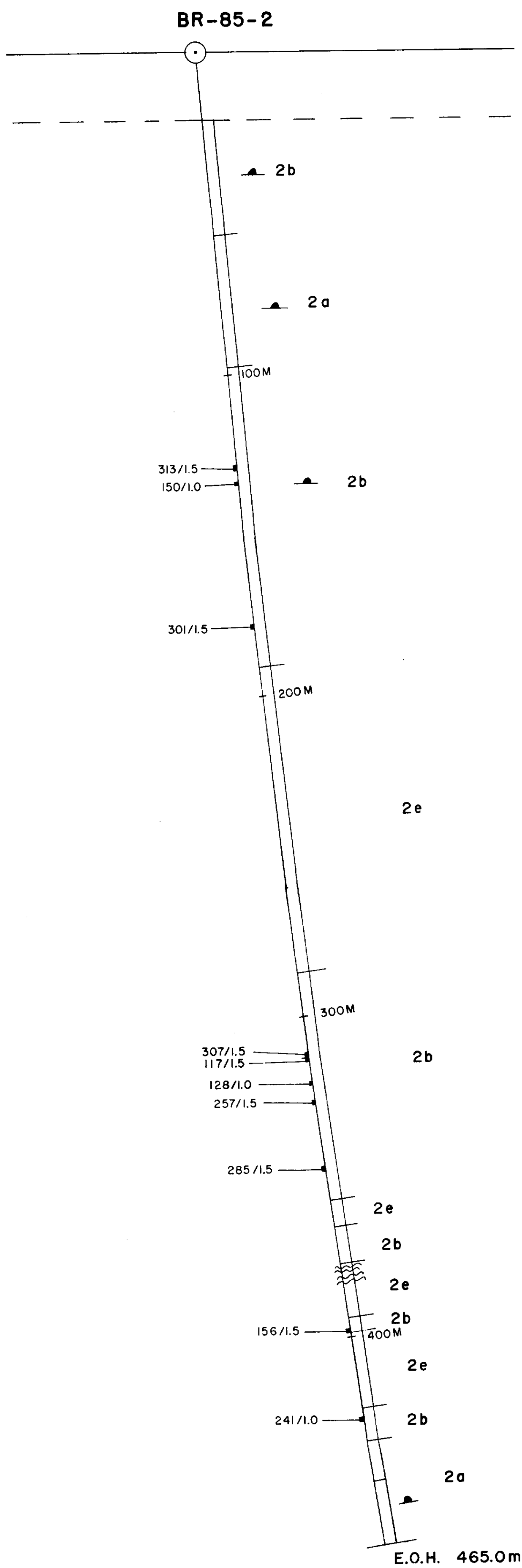
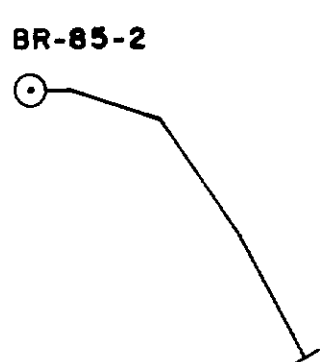

LEGEND

- 2 Mg THOLEIITE BASALT
- 2a unaltered
- 2b sericite - carbonate
- 2e chlorite - carbonate

QVS Quartz Vein System

fault zone

pillows

sh schistose, sheared

ASSAYS over 100 ppb

ppb Au metres

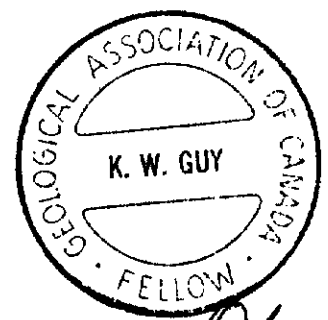

K. W. Guy

OM85-168

63.4738

KENNETH GUY
EXPLORATION SERVICES

PROJECT : DAVIDSON TISDALE
MINES LTD.

D.D.H. No. : BR-85-2

LOCATION : J.V. Mine Grid 10,046N 9,964E

CLAIM NO. : Tisdale Twp. Patent 12887

LOGGED BY : K. GUY

DATE : Nov. 1985

SCALE : 1 : 1000



42A11SE8456 63.4738 TISDALE

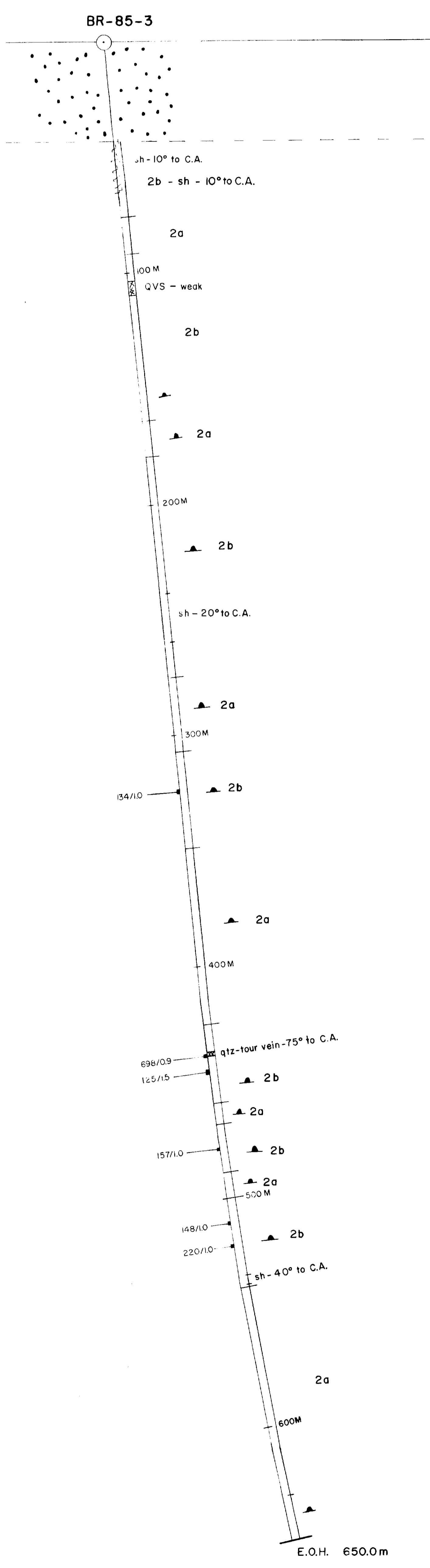
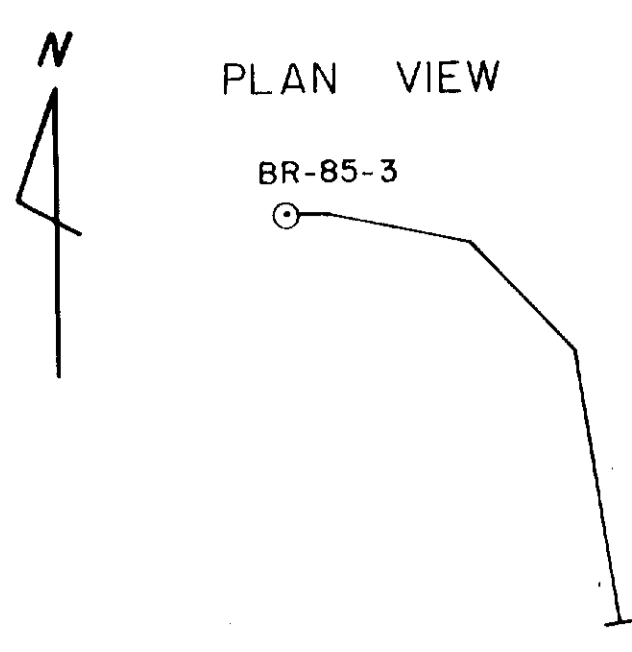

LEGEND

- 2 Mg Talciferous Layer
- 2a unaltered
- 2b sericite-carbonate
- 2c chlorite-carbonate
- QVS Quartz Vein System
- }} fault zone
- ▲ pitrows
- sh schistose, sheared

ASSAYS over 100 ppb
 ppb Au
 metres

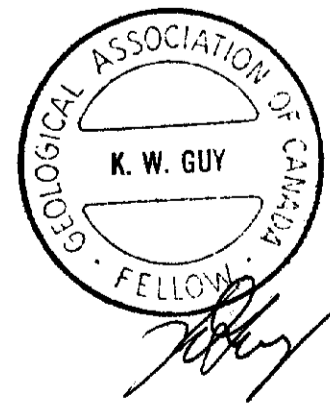

PROJECT	DAVIDSON TISDALE MINES LTD
O.D.H. No.	BR-85-3
LOCATION	J.V. Mine Grid 10,118N 9,816E
REG. No.	Tisdale Twp. Patent 12887
PREPARED BY	K. GUY
DATE	Nov. 1985
SCALE	1:1000

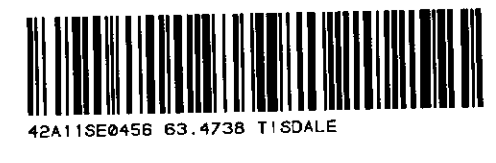



PLAN VIEW

BR-85-4

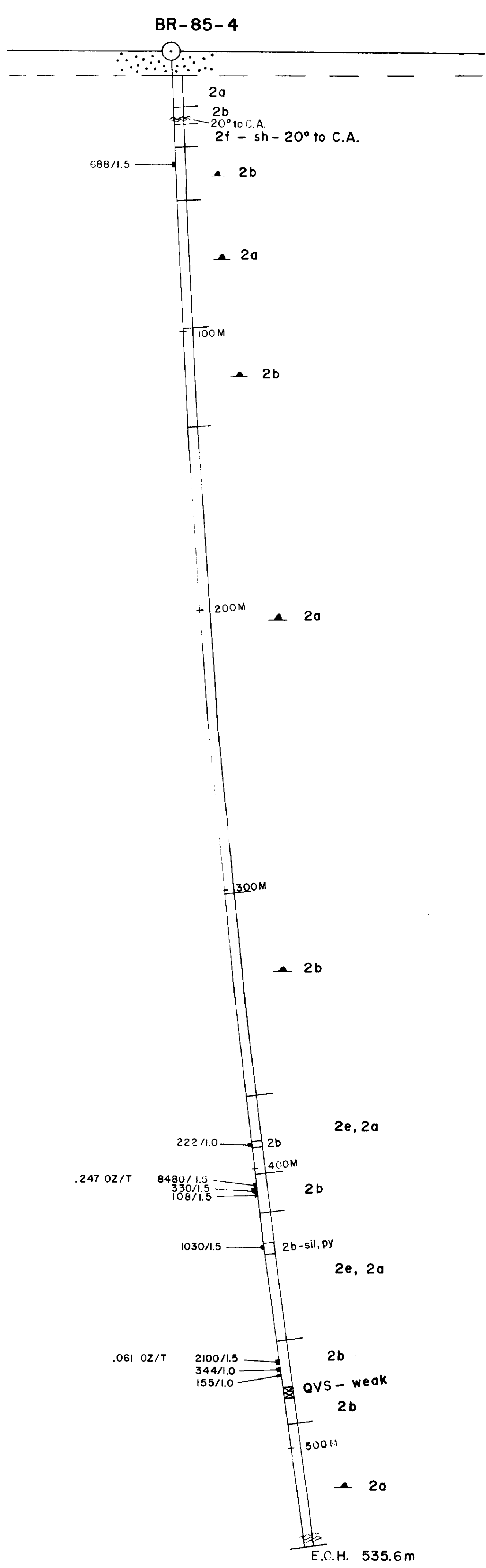
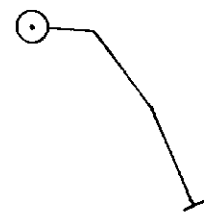

LEGEND

- 2 Mg THOLEIITE BASALT
- 2a unaltered
- 2b sericite - carbonate
- 2e chlorite - carbonate
- 2f carbonaceous
- QVS Quartz Vein System
- ~ fault zone
- ▲ pillows
- sh schistose, sheared

ASSAYS over 100 ppb
 ppb Au
 metres

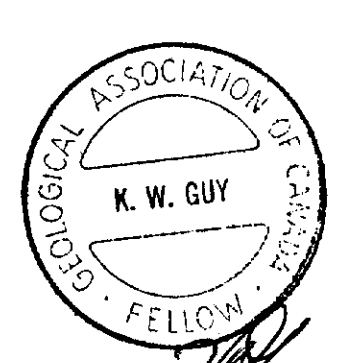

OM85-168

63.4738

KENNETH GUY EXPLORATION SERVICES	
PROJECT :	DAVIDSON TISDALE MINES LTD.
D.D.H. No. :	BR-85-4
LOCATION :	J.V. Mine Grid 10,040N 9,775E
CLAIM NO. :	Tisdale Twp. Patent 12887
LOGGED BY :	K. GUY
DATE :	Nov., Dec. 1985
SCALE :	1 : 1000

