



42A11SE2002 2.18140 CODY

010

Cody Township Property

Geochemical Analyses

Claim P1203884

Timmins Area

2.18140

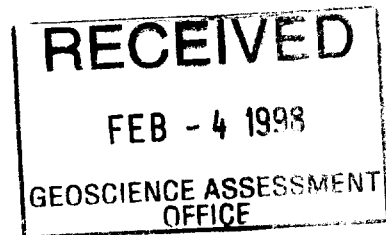

February, 1998

D. Pyke
B. Raine

RECEIVED

Figure 1: Location Cody
TWP CLAIM 1203884

FEB - 4 1993

GEOSCIENCE ASSESSMENT
OFFICE

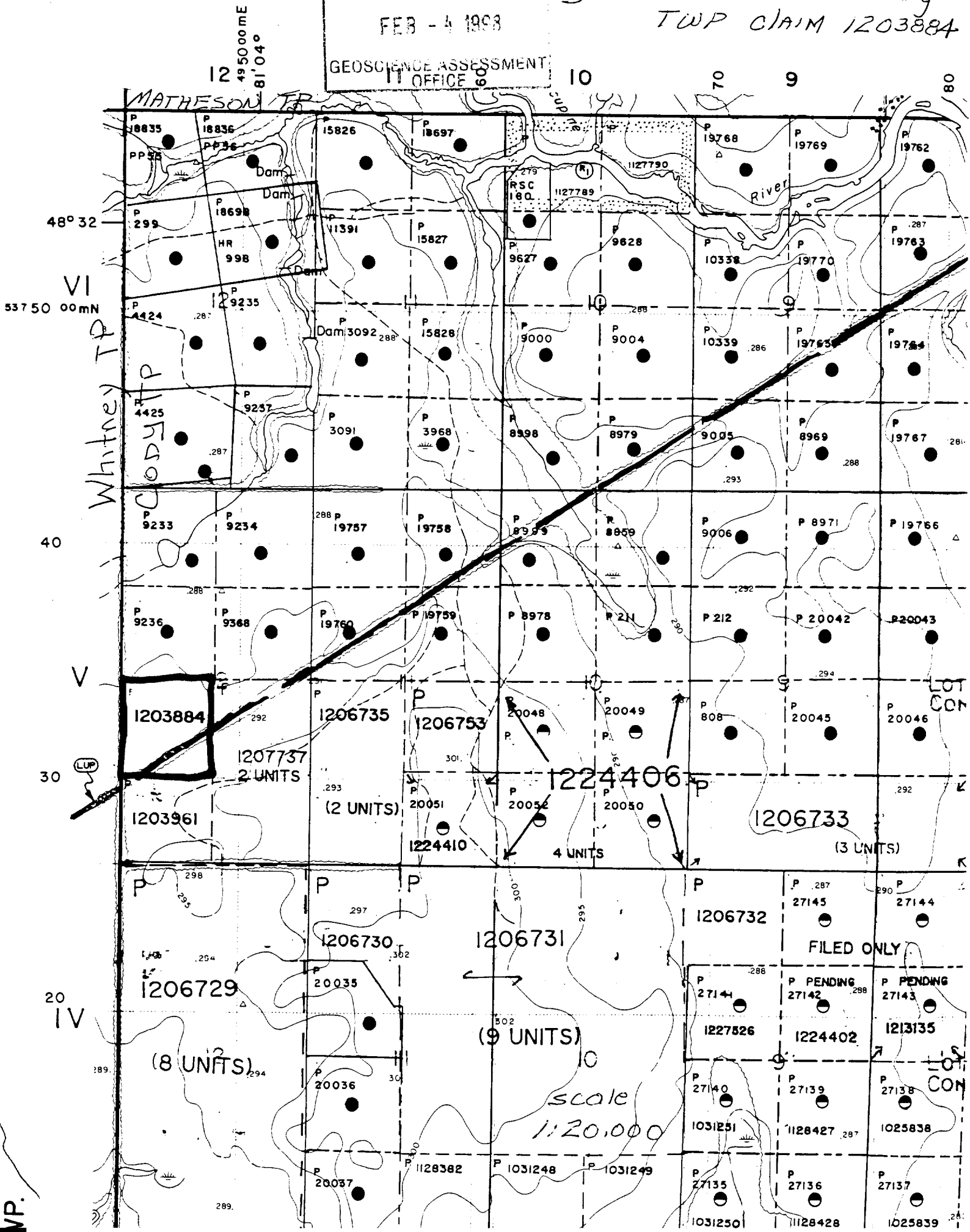

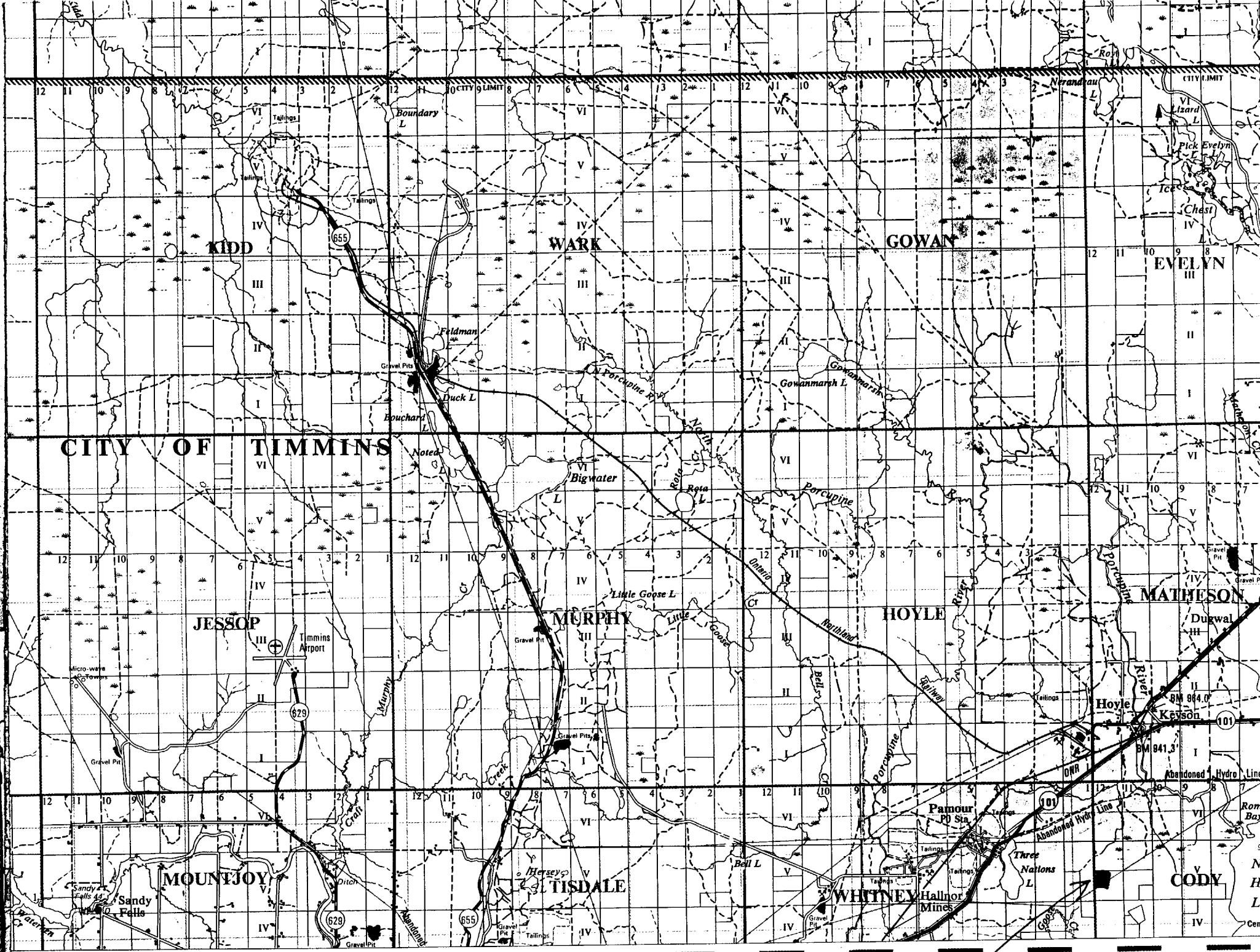

Figure 12 Location Cody Township property 1:100,000

Cody Township Property
Geochemical Analyses
Claim P1203884
Timmins Area

Introduction

The property consists of one 40 acre mining claim, P1203884, comprising the NW1/4, S1/2, Lot 12, Concession 5, Cody Township (Figure 1).

The claim is located approximately 20 km east of Timmins and is accessible via a power line extending eastward from Highway 101 to the south part of the claim, a distance of 3 km (Figures 1 & 2)

Previous Work

The area was previously mapped by Hurst (1939), Berry (1940) and Leahy (1971).

As reported by Leahy (1971), J. W. Young conducted test pitting near the Cody-Whitney township boundary which is thought to have been conducted largely on the present claim where there are a number of shallow trenches, pits and an old timbered shaft (4'x4'). Gold assays on the Young property reportedly ranged from trace to 0.12 ounces per ton (Leahy, 1971).

The current property was formerly part of 8 claims (S1/2 lots 11 & 12 concession 5) which, over the period 1981-1987, Comstate Resources Ltd. and Placer Development Limited completed geochemical (humus), geological and geophysical (magnetic, VLF and Max-Min) surveys.

In 1989, D. Pyke and B. Raine conducted a VLF survey over the current property and in 1990 power stripped an area of outcrop at the 'Young' shaft, which is located in the SE corner of what is now claim P1203884. Sampling at that time did not reveal any anomalous gold values.

General Geological Setting

Regionally, the property is approximately 500 meters south of the Destor Porcupine Fault (DPF), and is located on the north limb of an antinclinal structure which trends northeast across Whitney into Cody Township (Figure 2)

Present Survey and Analytical Results

On October 19, 1997, D. Pyke and B. Raine resampled some of the previously trenched area. Although chip samples had been taken from the area following the stripping (1990), large portions of the trenches were filled with water and could not be sampled at that time, whereas now, these low areas were found to be dry; in particular a large 4 to 5 foot deep pit in the SW corner of the trenched area. It was these previously water filled areas and some of the rock dumps which were specifically sampled at this time. Fourteen grab samples were taken and analysed for gold (ppb) at Swastika Laboratories. The assay results and a brief description of the samples is appended. One sample, CO-5-97, was submitted for whole rock analyses (WRA) to Activation

Laboratories Ltd. Location of the samples is shown on Figure 3, and is taken from a previous assessment report submitted by the current claim owners.

None of the samples returned anomalous gold values; the highest was 10 ppb (Table 2). The WRA indicates a peridotitic komatiite composition (Table 1, Figures 1 & 2), suggesting that many of the rocks previously interpreted to be tholeiitic are possibly of komatiitic affinity and that the entire trenched area is within basaltic-peridotitic komatiites.

Recommendations

The claim is largely within highly tectonized and altered (sericite-carbonate-chlorite/serpentine schists) komatiitic volcanics, located approximately 500 m south of the Destor Porcupine Fault (DPF). Although the current analytical results are disappointing, the regional setting (close to the DPF), the reported gold values from the Young shaft area and the presence of continued high ground (ie- a presumed thin overburden cover) suggest that further power stripping is warranted.



References

Leahy, E. J.

- 1971: Geology of the Night Hawk Lake area, District of Cochrane; Ontario Dept. Mines and Northern Affairs, GR 96, 74p. Map 2222, scale 1 inch to 1/2 mile.

Sample	Co-5-97
SiO2	29.62
TiO2	0.32
Al2O3	5.58
Fe2O3	7.02
MnO	0.20
MgO	15.42
CaO	13.54
Na2O	0.71
K2O	0.90
P2O5	0.07
Cr2O3	0.34
CO2	-
LOI	25.15
Total	98.89
Ba	116
Rb	-
Sr	183
Y	7
Zr	1
Nb	-
Au	-
As	-
Sb	-
W	-
Mo	-
Pb	-
Ni	-
Cu	-
Zn	-
V	120
Cr	-
Sc	23
Co	-
Be	1
Ag	-
Bi	-
Hf	-
Ta	-
La	-
Ce	-
Pr	-
Nd	-
Sm	-
Eu	-
Gd	-
Tb	-
Dy	-
Ho	-
Er	-
Tm	-
Yb	-
Lu	-
Th	-

Table 1. Whole Rock Chemical Analysis from Cody Township Property (P1203884)

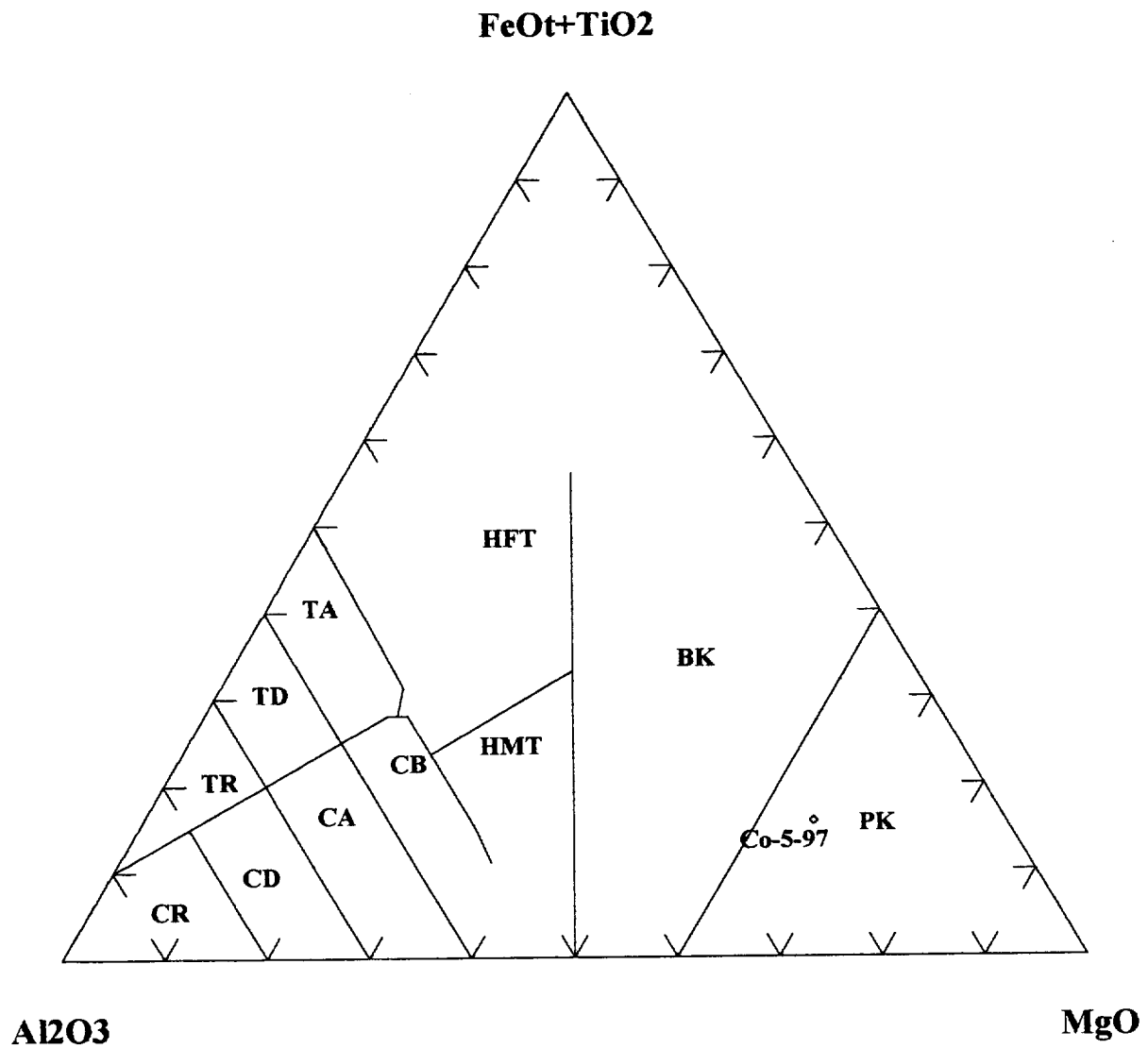

Figure 1. Jensen Cation Plot. Sample CO-5-97, Cody Township

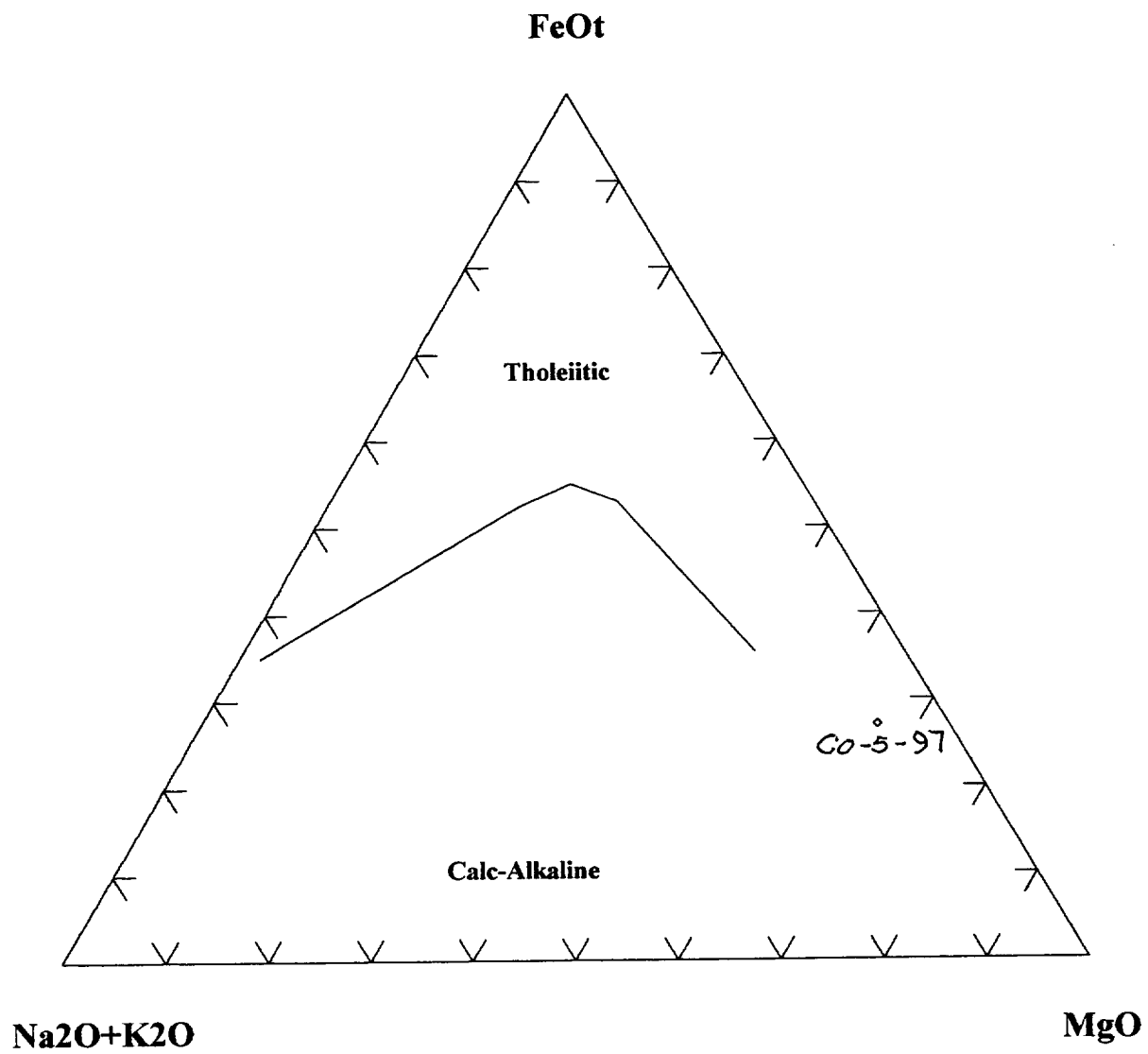

Figure 2. A-F-M Plot. Sample CO-5-97, Cody Township

Sample Description

- CO-1-97 Quartz vein to 3 cm, Trace to 1/2% pyrite. Sample includes 25% wall rock of sheared chlorite-carbonate schist.
- CO-2-97 Quartz vein, white. Minor chloritic slips. No sulphide.
- CO-3-97 Quartz veining (25%) to 2 cm in carbonate chlorite schist. No sulphide.
- CO-4-97 Quartz vein, bull white. Some coarse sericitic patches and slips. No sulphide.
- CO-5-97 Sericite-carbonate-chlorite schist, dark brown, fine grained. Contains 3-4% narrow (1mm) quartz-carbonate veins.
- CO-6-97 Sericite-carbonate schist, 10-15% narrow quartz-carbonate veinlets. Trace pyrite.
- CO-7-97 Sericite-chlorite-carbonate schist, similar to CO-6-97
- CO-8-97 Sericite-chlorite-carbonate schist
- CO-9-97 Same, but less pyrite - 1%
- CO-10-97 Same, trace pyrite
- CO-11-97 Same, but forms wallrock to a 4" wide quartz vein. Trace pyrite.
- CO-12-97 Largely quartz-carbonate vein material from dump alongside large pit. 2% sulphide (py, po, trace cp).
- CO-13-97 Much same as CO-12-97. Quartz-carbonate veining with trace to 2% fine sulphide.
- CO-14-97
- CO-15-97

42136



Swastika Laboratories

A Division of TSI/Assayers Inc.

Established 1928

Assaying - Consulting - Representation

Geochemical Analysis Certificate

7W-4190-RG1

Company: **D. PYKE**

Project:

Date: OCT-28-97

Att: **D. Pyke**

We hereby certify the following Geochemical Analysis of 17 Rock samples submitted OCT-23-97 by .

Sample Number	Au PPB	Au Check PPB
Co-1	2	-
Co-2	Nil	3
Co-3	Nil	-
Co-4	2	-
Co-6	2	-
Co-7	3	-
Co-8	3	-
Co-9	3	-
Co-10	3	-
Co-11	5	-
Co-12	7	-
Co-13	10	-
Co-14	12	12
Co-15	10	-
T-1	2	-
T-2	3	-
T-3	7	7

Table 2. Geochemical analyses Cody Township, Claim P1203884

One assay ton portion used.

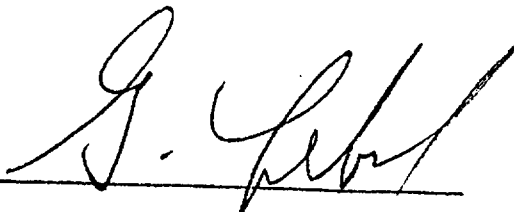
Certified by 

prep - 3.50
Au - 8.00

Activation Laboratories Ltd. Work Order No.14731 Report No. 14611D

SAMPLE	SiO2	Al2O3	Fe2O3	MnO	MgO	CaO	Na2O	K2O	TiO2	P2O5	Cr2O3	LOI	TOTAL	Ba	Sr	Y	Sc	Zr	Be	V
	%	%	%	%	%	%	%	%	%	%	%	%	%	ppm	ppm	ppm	ppm	ppm	ppm	ppm
CO-5-97	29.62	5.58	7.02	0.20	15.42	13.54	0.71	0.90	0.32	0.07	0.34	25.15	98.89	116	183	7	23	-1	-1	120
W3822-1	51.99	13.04	13.10	0.23	4.91	9.10	2.65	0.60	1.68	0.18	0.01	3.17	100.65	265	99	36	44	95	-1	381
W4821-1	51.90	13.54	12.70	0.22	4.97	10.44	2.00	0.20	1.69	0.18	0.01	2.51	100.34	94	371	37	45	122	1	390
W4821-2	48.92	13.23	15.15	0.26	5.14	9.86	1.62	0.19	1.64	0.17	0.01	3.46	99.65	82	134	37	44	120	1	383
W5821-3	51.20	14.25	16.25	0.26	5.41	3.31	2.84	0.05	1.85	0.19	0.01	4.79	100.38	17	46	42	49	134	1	420
WD95-2-1	47.41	12.86	13.09	0.25	5.73	8.08	1.41	0.06	1.11	0.09	0.01	9.88	99.95	38	53	19	44	43	-1	343
WD95-2-4	52.67	13.54	9.11	0.21	4.44	7.59	3.89	-0.01	1.18	0.20	0.01	7.50	100.33	18	59	19	40	42	-1	331
WD95-2-5	49.19	14.91	10.48	0.23	4.69	7.39	3.71	0.33	1.32	0.10	0.01	7.81	100.17	232	53	21	44	50	-1	387
WD95-2-7	51.69	14.68	9.38	0.23	6.39	5.20	4.62	0.02	0.93	0.08	0.01	6.21	99.45	14	50	22	53	52	-1	320
WD95-3-8	65.43	13.41	5.27	0.09	1.04	3.33	3.63	0.98	1.60	0.52	-0.01	3.55	98.86	166	91	62	29	201	1	42



Adrienne I. Rittau, B.Sc., C.Chem
ICP Technical Manager



Declaration of Assessment Work Performed on Mining Land

Mining Act, Subsection 65(2) and 66(3), R.S.O. 1990

Transaction Number (office use) W9860. 00089 Assessment Files Research Imaging



42A11SE2002 2.18140 CODY

900

of subsections 65(2) and 66(3) of the Mining Act. Under section 8 of the review the assessment work and correspond with the mining land holder. Recorder, Ministry of Northern Development and Mines, 6th Floor.

Instructions: - For work performed on Crown Lands before recording a claim, use form 0240. - Please type or print in ink.

2.18140

1. Recorded holder(s) (Attach a list if necessary)

Form with fields for Name, Address, Client Number, Telephone Number, and Fax Number. Handwritten entries include DALE R. PYKE, 31 DELAIR CRES, THORNHILL, ONT L3T 2M3, and client number 184975.

2. Type of work performed: Check (✓) and report on only ONE of the following groups for this declaration.

- Geotechnical: prospecting, surveys, assays and work under section 18 (regs) [checked]
Physical: drilling, stripping, trenching and associated assays [unchecked]
Rehabilitation [unchecked]

Work Type: Sampling for assay and whole rock analysis. Office Use section with fields for Commodity, Total \$ Value of Work Claimed (\$957), NTS Reference, Mining Division (Porcupine), and Resident Geologist District (Timmins).

- Please remember to: - obtain a work permit from the Ministry of Natural Resources as required; - provide proper notice to surface rights holders before starting work; - complete and attach a Statement of Costs, form 0212; - provide a map showing contiguous mining lands that are linked for assigning work; - include two copies of your technical report.

3. Person or companies who prepared the technical report (Attach a list if necessary)

Form with fields for Name, Address, Telephone Number, and Fax Number. Includes a RECEIVED stamp dated FEB - 4 1998 and GEOSCIENCE ASSESSMENT OFFICE stamp.

4. Certification by Recorded Holder or Agent

I, DALE R. PYKE, do hereby certify that I have personal knowledge of the facts set forth in this Declaration of Assessment Work having caused the work to be performed or witnessed the same during or after its completion and, to the best of my knowledge, the annexed report is true.

Signature of Recorded Holder or Agent: DR Pyke, Date: Feb 3/98, Agent's Address: 31 Delair Cres Thornhill Ont, Telephone Number: 905-731-1913, Fax Number: 905-731-1913

5. Work to be recorded and distributed. Work can only be assigned to claims that are contiguous (adjacent) to the mining land where work was performed, at the time work was performed. A map showing the contiguous link must accompany this form.

Mining Claim Number. Or if work was done on other eligible mining land, show in this column the location number indicated on the claim map.	Number of Claim Units. For other mining land, list hectares.	Value of work performed on this claim or other mining land.	Value of work applied to this claim.	Value of work assigned to other mining claims.	Bank. Value of work to be distributed at a future date.
eg TB 7827	16 ha	\$26,825	N/A	\$24,000	\$2,825
eg 1234567	12	0	\$24,000	0	0
eg 1234568	2	\$8,892	\$4,000	0	\$4,892
1 1203883	1	\$957	\$957	0	0
2					See attached f
3					
4					
5					
6					
7					
8					
9					
10					
11					
12					
13					
14					
15					
Column Totals		\$957	\$957		

I, DALE R. PYKE, do hereby certify that the above work credits are eligible under subsection 7 (1) of the Assessment Work Regulation 6/96 for assignment to contiguous claims or for application to the claim where the work was done.

Signature of Recorded Holder or Agent Authorized in Writing Dale R. Pyke Date Feb 3/98

6. Instructions for cutting back credits that are not approved.

Some of the credits claimed in this declaration may be cut back. Please check (✓) in the boxes below to show how you wish to prioritize the deletion of credits:

- 1. Credits are to be cut back from the Bank first, followed by option 2 or 3 or 4 as indicated.
- 2. Credits are to be cut back starting with the claims listed last, working backwards; or
- 3. Credits are to be cut back equally over all claims listed in this declaration; or
- 4. Credits are to be cut back as prioritized on the attached appendix or as follows (describe):

Note: If you have not indicated how your credits are to be deleted, credits will be cut back from the Bank first, followed by option number 2 if necessary.

For Office Use Only Received Stamp <div style="border: 2px solid black; padding: 5px; text-align: center;"> RECEIVED FEB - 4 1998 GEOSCIENCE ASSESSMENT OFFICE </div>	Deemed Approved Date	Date Notification Sent
	Date Approved	Total Value of Credit Approved
	Approved for Recording by Mining Recorder (Signature)	



Ministry of Northern Development and Mines

Ministère du Développement du Nord et des mines

Statement of Costs for Assessment Credit

État des coûts aux fins du crédit d'évaluation

Mining Act/Loi sur les mines

Transaction No./N° de transaction

W9860.00089

Personal information collected on this form is obtained under the authority of the Mining Act. This information will be used to maintain a record and ongoing status of the mining claim(s). Questions about this collection should be directed to the Provincial Manager, Minings Lands, Ministry of Northern Development and Mines, 4th Floor, 159 Cedar Street, Sudbury, Ontario P3E 6A5, telephone (705) 670-7264.

Les renseignements personnels contenus dans la présente formule sont recueillis en vertu de la Loi sur les mines et serviront à tenir à jour un registre des concessions minières. Adresser toute question sur la collecte de renseignements au chef provincial des terrains miniers, ministère du Développement du Nord et des Mines, 159, rue Cedar, 4^e étage, Sudbury (Ontario) P3E 6A5, téléphone (705) 670-7264.

1. Direct Costs/Coûts directs

Type	Description	Amount Montant	Totals Total global
Wages Salaires	Labour 2 mandays sampling - 450 Main-d'oeuvre / manday report 275		
	Field Supervision Supervision sur le terrain		\$725
Contractor's and Consultant's Fees Droits de l'entrepreneur et de l'expert-conseil	Type ASSAYS 14 x 11.50 161.00		
	Whole rock analysis 38.00		\$199
Supplies Used Fournitures utilisées	Type		
Equipment Rental Location de matériel	Type		
Total Direct Costs Total des coûts directs			\$924

2. Indirect Costs/Coûts indirects

** Note: When claiming Rehabilitation work Indirect costs are not allowable as assessment work.
Pour le remboursement des travaux de réhabilitation, les coûts indirects ne sont pas admissibles en tant que travaux d'évaluation.

Type	Description	Amount Montant	Totals Total global
Transportation Transport	Type TRUCK		
	110km x 0.30	\$33.00	
Food and Lodging Nourriture et hébergement			
Mobilization and Demobilization Mobilisation et démoblisation			
Sub Total of Indirect Costs Total partiel des coûts indirects			33.00
Amount Allowable (not greater than 20% of Direct Costs) Montant admissible (n'excédant pas 20 % des coûts directs)			
Total Value of Assessment Credit (Total of Direct and Allowable indirect costs)			\$957

Note: The recorded holder will be required to verify expenditures claimed in this statement of costs within 30 days of a request for verification. If verification is not made, the Minister may reject for assessment work all or part of the assessment work submitted.

Note: Le titulaire enregistré sera tenu de vérifier les dépenses demandées dans le présent état des coûts dans les 30 jours suivant une demande à ce effet. Si la vérification n'est pas effectuée, le ministre peut rejeter tout ou une partie des travaux d'évaluation présentés.

Filing Discounts

- Work filed within two years of completion is claimed at 100% of the above Total Value of Assessment Credit.
- Work filed three, four or five years after completion is claimed at 50% of the above Total Value of Assessment Credit. See calculations below:

Total Value of Assessment Credit	Total Assessment Claimed
	x 0.50 =

Remises pour dépôt

- Les travaux déposés dans les deux ans suivant leur achèvement sont remboursés à 100 % de la valeur totale susmentionnée du crédit d'évaluation.
- Les travaux déposés trois, quatre ou cinq ans après leur achèvement sont remboursés à 50 % de la valeur totale du crédit d'évaluation susmentionné. Voir les calculs ci-dessous.

Valeur totale du crédit d'évaluation	Evaluation totale demandée
	x 0,50 =

Certification Verifying Statement of Costs

I hereby certify: that the amounts shown are as accurate as possible and these costs were incurred while conducting assessment work on the lands shown on the accompanying Report of Work form.

that as Dale R. Pyke I am authorized
(Recorded Holder, Agent, Position in Company)

to make this certification

Attestation de l'état des coûts

J'atteste par la présente: que les montants indiqués sont le plus exact possible et que ces dépenses ont été engagées pour effectuer les travaux d'évaluation sur les terrains indiqués dans la formule de rapport de travail ci-joint.

Et qu'à titre de _____ je suis autorisé
(titulaire enregistré, représentant, poste occupé dans la compagnie)

à faire cette attestation.

Signature <u>D R Pyke</u>	Date <u>Feb 3/9</u>
------------------------------	------------------------

April 27, 1998

DALE RANDOLPH PYKE
31 DELAIR CRESCENT
THORNHILL, ON
L3T-2M3

Geoscience Assessment Office
933 Ramsey Lake Road
6th Floor
Sudbury, Ontario
P3E 6B5

Telephone: (888) 415-9846
Fax: (705) 670-5881

Dear Sir or Madam:

Submission Number: 2.18140

Subject: Transaction Number(s): W9860.00089 **Status:** Deemed Approval

We have reviewed your Assessment Work submission with the above noted Transaction Number(s). The attached summary page(s) indicate the results of the review. **WE RECOMMEND YOU READ THIS SUMMARY FOR THE DETAILS PERTAINING TO YOUR ASSESSMENT WORK.**

If the status for a transaction is a 45 Day Notice, the summary will outline the reasons for the notice, and any steps you can take to remedy deficiencies. The 90-day deemed approval provision, subsection 6(7) of the Assessment Work Regulation, will no longer be in effect for assessment work which has received a 45 Day Notice.

Please note any revisions must be submitted in DUPLICATE to the Geoscience Assessment Office, by the response date on the summary.

If you have any questions regarding this correspondence, please contact Lucille Jerome by e-mail at jeromel2@epo.gov.on.ca or by telephone at (705) 670-5858.

Yours sincerely,



ORIGINAL SIGNED BY
Blair Kite
Supervisor, Geoscience Assessment Office
Mining Lands Section

Work Report Assessment Results

Submission Number: 2.18140

Date Correspondence Sent: April 27, 1998

Assessor: Lucille Jerome

Transaction Number	First Claim Number	Township(s) / Area(s)	Status	Approval Date
W9860.00089	1203884	CODY	Deemed Approval	April 27, 1998

Section:
17 Assays ASSAY

Correspondence to:
Resident Geologist
South Porcupine, ON

Recorded Holder(s) and/or Agent(s):
DALE RANDOLPH PYKE
THORNHILL, ON

Assessment Files Library
Sudbury, ON
