

W.R. # 270/84

Instructions - Supply required data on a separate form for each



Report of Work

Tisdale Twp. Mi



42A11SE5059 W8406-00270 TISDALE

010

Name and Postal Address of Recorded Holder  
508825 Ontario Ltd.

P.O. Box 1184 Timmins, Ontario P4N 7J5

Summary of Work Performance and Distribution of Credits

Total Work Days Cr. claimed 14.33	Mining Claim		Work Days Cr.	Mining Claim		Work Days Cr.	Mining Claim		Work Days Cr.
	Prefix	Number		Prefix	Number		Prefix	Number	
for Performance of the following work. (Check one only)	P	577601	14.33						
<input type="checkbox"/> Manual Work									
<input type="checkbox"/> Shaft Sinking Drifting or other Lateral Work.									
<input checked="" type="checkbox"/> Compressed Air, other Power driven or mechanical equip.									
<input type="checkbox"/> Power Stripping									
<input type="checkbox"/> Diamond or other Core drilling									
<input type="checkbox"/> Land Survey									

All the work was performed on Mining Claim(s): P-577601

RECORDED  
JUN 29 1984  
Receipt No. 30

Required Information eg: type of equipment, Names, Addresses, etc. (See Table Below)

Jean Roy, RR #1 Timmins 4 hrs.  
 Jim Davis " " " 11 hrs.  
 Gerry McNulty " " " 11 hrs.  
 Willie Dubois " " " 7 hrs.  
 A Burt " " " 3 hrs.  
 Denis Dubois " " " 7 hrs.

PORCUPINE MINING DIVISION  
RECEIVED  
JUN 29 1984  
A.M. 7 8 9 10 11 12 1 2 3 4 5 6 P.M.

ONTARIO GEOLOGICAL SURVEY  
ASSESSMENT FILE  
RESEARCH OFFICE  
JUL 30 1984  
RECEIVED

from bard's rental  
1-450 compressor  
2-drills  
4 pcs steel & 400' hose.

rental adamp

Date of Report: June 25/84  
Recorded Holder or Agent (Signature): [Signature] T-1222

Certification Verifying Report of Work

I hereby certify that I have a personal and intimate knowledge of the facts set forth in the Report of Work annexed hereto, having performed the work or witnessed same during and/or after its completion and the annexed report is true.

Name and Postal Address of Person Certifying  
Jean Roy c/o 508825 Ontario Ltd.  
P.O. Box 1184 Timmins P4N-7J5

Date Certified: June 25/84  
Certified by (Signature): [Signature]

Table of Information/Attachments Required by the Mining Recorder

Type of Work	Specific Information per type	Other Information (Common to 2 or more types)	Attachments
Manual Work	Nil	Names and addresses of men who performed manual work/operated equipment, together with dates and hours of employment.	Work Sketch: these are required to show the location and extent of work in relation to the nearest claim post.
Shaft Sinking, Drifting or other Lateral Work	Nil		
Compressed air, other power driven or mechanical equip.	Type of equipment	Names and addresses of owner or operator together with dates when drilling/stripping done.	Work Sketch (as above) in duplicate
Power Stripping	Type of equipment and amount expended. Note: Proof of actual cost must be submitted within 30 days of recording.		
Diamond or other core drilling	Signed core log showing; footage, diameter of core, number and angles of holes.	Nil	Nil
Land Survey	Name and address of Ontario land surveyor.		

900

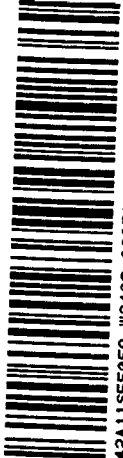

42A1ISE5959 #8406-00270 TISDALE

# TIME REPORTS

# CANUCK CONSTRUCTION INC.

PROJECT 508825 QJLH  
 DATE \_\_\_\_\_  
 FOREMAN \_\_\_\_\_

*Shill & Best*  
*Municipal Lab*

①

No.	Employee's Name					1	½	2
	J. King	May 11 / 84		(4 hrs)	-			
	J. Davis	May 11 / 84		(4 hrs)	-			
	J. McNulty	May 11 / 84		(4 hrs)	-			
	Dennis Dubois			(7 hrs)	-			
	<del>J. W. Dubois</del>			(7 hrs)	-			
	J. Davis			(7 hrs)	-			
	J. McNulty			(7 hrs)	-			
	A. Birt			(3 hrs)	-			
	J. King				3.			
	B. Maric			43 hours	7.			
	Wm Millions				7.			





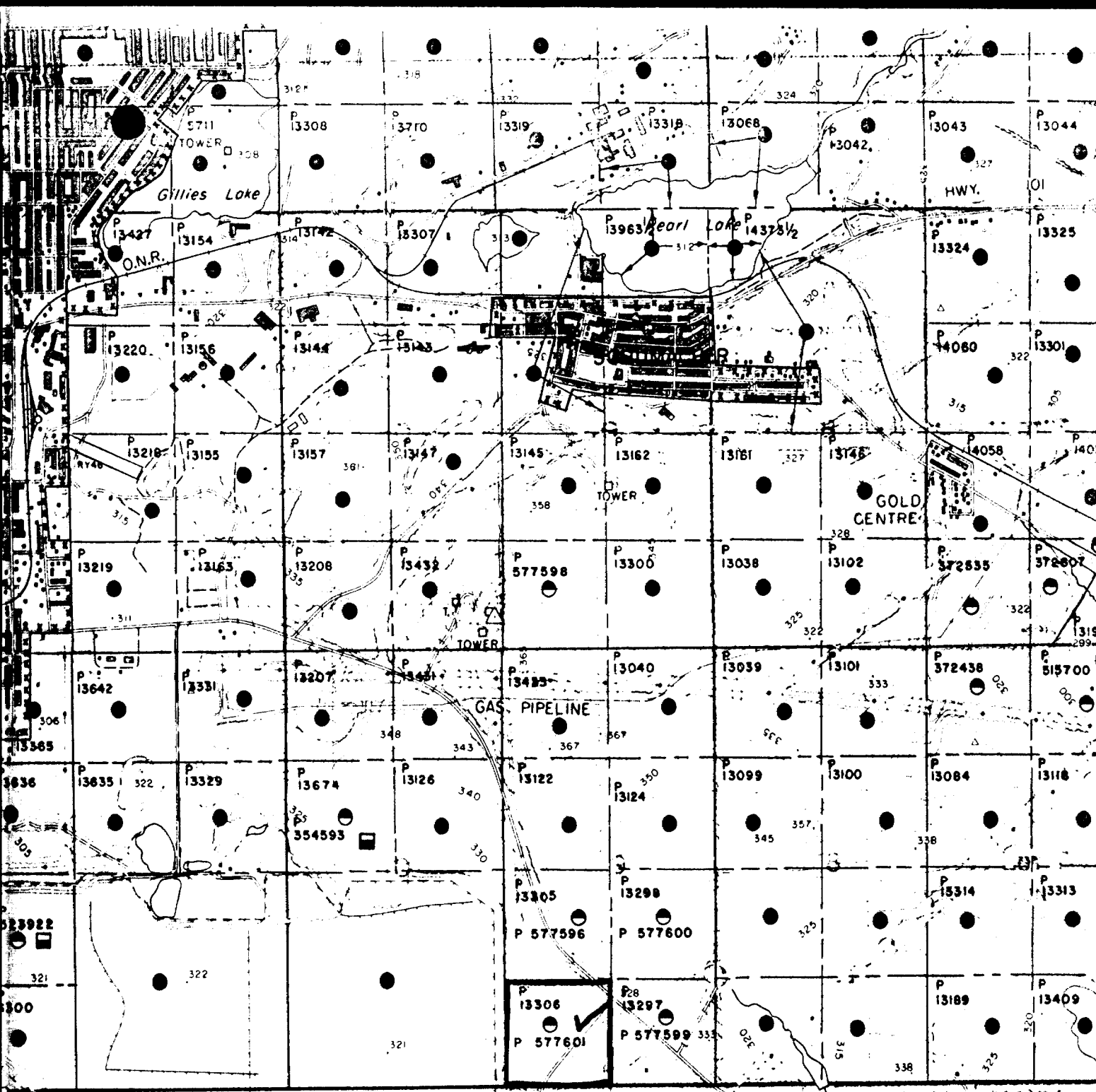

11

10

Tisdale Township  
G-3976

8

7

DELORO