



42A115W0128 2.12509 JAMIESON

010

GEOPHYSICAL REPORT

ON

PANCHO PROJECT CLAIMS

1028594, 1028593, 1028592, 1028595, 1028596,
1028597, 1028602, 1028601, 1028600, 1028603,
1028604, 1028605, 1028609, 1028608

SITUATED IN THE

JAMIESON TOWNSHIP, PORCUPINE MINING DIVISION

HELD BY

GRANGES EXPLORATION LTD
2300 - 885 WEST GEORGIA STREET
VANCOUVER, BC
V6C 3E8

MAY 19, 1989

A.J. O'DONNELL
(E.J. SEAGEL)



42A11SW0128 2.12509 JAMIESON

010C

TABLE OF CONTENTS

	<u>Page</u>
Introduction	1
Location and Access	1
History of Property	1
Geology	1
Geophysical Surveying	2
Recommendations	2
Author's Qualifications	3

ENCLOSURES

Location Map, Scale 1:20,000

Horizontal Loop Electromagnetic Survey, Grids 1 and 2,
Scale 1:5000

INTRODUCTION

The 459 hectare property consists of 27 unpatented contiguous mining claims in the Mattagami-Kamiskotia River area, Jamieson Township, Porcupine Mining District, Ontario.

The claim group is held by Granges Exploration Ltd of Vancouver, BC and are recorded as follows:

P-1028592 to P-1028597 inclusive
P-1028600 to P-1028605 inclusive
P-1028608 and P-1028609
P-1087670 to P-1087674 inclusive
P-1087709 to P-1087711 inclusive
P-1087715 to P-1087719 inclusive

LOCATION AND ACCESS

The property is 6 km northeast of Highway 576, approximately 16 km west of Timmins.

The claim group is 400 meters north of the junction of the Kamiskotia with the Mattagami River, which then traverses the central portion of the claim group.

Accessibility is afforded by boat or motorized toboggan from Highway 576, or by Helicopter from Timmins.

HISTORY OF THE PROPERTY

Considerable exploration has been carried out in the general area, and on the property itself over the past several years. A renewed interest in the area resulted from the airborne input survey by Geoterrex Ltd. on contract from the Ontario Geological Survey. The survey indicated 8 airborne electromagnetic intercepts, which appeared to warrant further exploration.

GEOLOGY

The general geology consists of acid to basic volcanics and sediments of Precambrian age. The property is drift-covered with local geology being described in previously-reported diamond drill holes, consisting of tuffs, pillow lavas and banded sediments.

GEOPHYSICAL SURVEYING

A total of 25.98 km (16.09 miles) of linecutting was completed by Alquest Exploration Services of Timmins, Ontario. Two grids were established to cover previously-outlined airbourne anomalies, as follows:

Grid Pan-1	21.09 km (13.11 miles)	December, 1988
Grid Pan-2	4.8 km (2.98 miles)	January, 1989

The airbourne EM survey indicated 5 anomalies east of the Mattagami River, ranging in strength from 4 to 12 channels. Two 12-channel zones were located on the river and another strong conductor was located 1000 metres west of the river.

Ground EM geophysical surveying was undertaken by Exsics Exploration Ltd. of Timmins, Ontario. Surveying over all the airbourne anomalies located or indicated only one conductive zone which appears to have been previously drilled by International Nickel in March, 1973.

With the exception of the zone west of the river, the conductors appear to be the result of causes such as conductive overburden.

The study of the airbourne charts indicates that the anomalous zone west of the river appears to be a true conductor which warrants further exploration.

RECOMMENDATIONS

A resurvey of the western anomalous zone is recommended to determine if the grid is in the proper location. At the same time, further exploration should employ a larger coil separation in order to have a greater depth penetration.

STATEMENT OF QUALIFICATIONS
GEORGE W. ZBITNOFF
5160 CLIFF PLACE
DELTA, B.C.

Name: Zbitnoff, George William

Birth Date: August 15, 1938

Birthplace: Saskatoon, Saskatchewan

Graduated with Grade 12 matriculation from
Blaine Lake High School in 1955.

Graduated from University of Saskatchewan with a
B.A. (Geology and chemistry majors) in 1963.

Professional

- Associations:
- Member of the Association of Professional Engineers of the Province of Manitoba.
 - Member of the Association of Professional Engineers of the Province of British Columbia since 1973.
 - Member of the Canadian Institute of Mining and Metallurgy.

- Experience:
- Pre-graduation experience in geology with the Department of Mineral Resources of Saskatchewan.
 - May 1962 - Two and one half years, field geologist with Hudson Bay Exploration and Development, Flin Flon area.
 - January 1965 - Six years, field and resident geologist with Noranda Exploration Ltd., Flin Flon area.
 - February 1971 - Twelve and one half years, Assistant Manager, Granges Exploration Aktiebolag in Vancouver, B.C.
 - November 1983 to present - Vice President Exploration, Granges Exploration Ltd. in Vancouver, B.C.
 - Active geological experience in all provinces of Canada and parts of the United States and Mexico.
 - Participated in the discovery of Trout Lake Mine.



Ontario

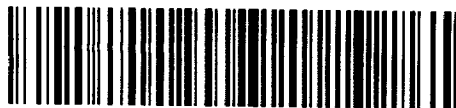

42A11SW0128 2.12509 JAMIESON

900

Ministry of
Northern Development
and Mines

Mining Lands Section
880 Bay Street, 3rd Floor
Toronto, Ontario
M5S 1Z8

Ministère du
Développement du Nord
et des Mines

Telephone: (416) 965-4888

September 15, 1989

Your File: W8906-295
Our File: 2.12509

Mining Recorder
Ministry of Northern Development and Mines
60 Wilson Avenue
Timmins, Ontario
P4N 2S7

Dear Sir:

Re: Notice of Intent dated August 14, 1989 for Geophysical (Electromagnetic) Survey submitted on Mining Claims P 1087715 to 1087718 inclusive in Jamieson Township.

The assessment work credits, as listed with the above-mentioned Notice of Intent, have been approved as of the above date.

Please inform the recorded holder of these mining claims and so indicate on your records.

Yours sincerely,

W.R. Cowan
Provincial Manager, Mining Lands
Mines & Minerals Division

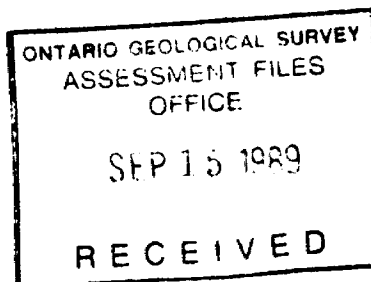

RJS LJS:eb
Enclosure

cc: Mr. G.H. Ferguson
Mining and Lands Commissioner
Toronto, Ontario

Resident Geologist
Timmins, Ontario

Granges Exploration Ltd.
2300-885 West Georgia Street
Vancouver, B.C.
V6C 3E8



Recorded Holder
GRANGES EXPLORATION LTD.

Township or Area
JAMIESON TOWNSHIP.

Type of survey and number of Assessment days credit per claim	Mining Claims Assessed
Geophysical Electromagnetic <u>28</u> days Magnetometer _____ days Radiometric _____ days Induced polarization _____ days Other _____ days Section 77 (19) See "Mining Claims Assessed" column Geological _____ days Geochemical _____ days Aerial days <input type="checkbox"/> Airborne <input type="checkbox"/> Special provision <input checked="" type="checkbox"/> Ground <input checked="" type="checkbox"/> <input checked="" type="checkbox"/> Credits have been reduced because of partial coverage of claims. <input type="checkbox"/> Credits have been reduced because of corrections to work dates and figures of applicant.	P 1087715 to 18 incl.

Special credits under section 77 (16) for the following mining claims

[Empty box for special credits]

No credits have been allowed for the following mining claims

not sufficiently covered by the survey insufficient technical data filed

[Empty box for no credits allowed]

The Mining Recorder may reduce the above credits if necessary in order that the total number of approved assessment days recorded on each claim does not exceed the maximum allowed as follows: Geophysical - 80; Geological - 40; Geochemical - 40; Section 77(19) - 60.



Ministry of Northern Development and Mines
Ontario

Report of Work

(Geophysical, Geological, Geochemical and Expenditures)

DOCUMENT No. **W 8906-295**

- Instructions: - Please type or print.
- If number of mining claims traversed exceeds space on this form, attach a list.
Note: - Only days credits calculated in the "Expenditures" section may be entered in the "Expend. Days Cr." columns.
- Do not use shaded areas below.

July 12

Mining Act

2.12509

Type of Survey(s) **LINECUTTING AND EM SURVEY** Township or Area **JANESBORO**
 Claim Holder(s) **GRANGES EXPLORATION LTD** Prospector's Licence No. **T 1070**
 Address **2300-885 WEST GEORGIA ST., VANCOUVER, BC, V6C 3E8**
 Survey Company **ALQUEST EXPL SERVICES / EXSICS EXPL. LTD** Date of Survey (from & to) **01 84** Total Miles of line Cut **2.98 (4.8 km)**
 Name and Address of Author (of Geo-Technical report) **A.J. O'DONNELL, 2300-885 WEST GEORGIA ST., VANCOUVER, BC, V6C 3E8**

Credits Requested per Each Claim in Columns at right

Mining Claims Traversed (List in numerical sequence)

Special Provisions	Geophysical	Days per Claim
		40
For first survey: Enter 40 days. (This includes line cutting)	Electromagnetic	
	Magnetometer	
	Radiometric	
	Other	
For each additional survey: using the same grid: Enter 20 days (for each)	Geological	
	Geochemical	
	Geophysical	
	Days per Claim	
Man Days Complete reverse side and enter total(s) here	Electromagnetic	
	Magnetometer	
	Radiometric	
	Other	
Airborne Credits Note: Special provisions credits do not apply to Airborne Surveys.	Geological	
	Geochemical	
	Electromagnetic	
	Magnetometer	
	Radiometric	

Mining Claim			Mining Claim		
Prefix	Number	Expend. Days Cr.	Prefix	Number	Expend. Days Cr.
P	1087715				
	1087716				
	1087717				
	1087718				

RECEIVED

JUN - 1 1989

MINING LANDS SECTION

RECORDED
MAY 23 1989

Expenditures (excludes power stripping)
 Type of Work **LINECUTTING**
 Performed on claim(s) **10, 11, 12, 13, 14, 15, 16, 17, 18, 19, 20**
 Calculation of Expenditure Days Credits
 Total Expenditures **\$** ÷ **15** = Total Days Credits
 Instructions: Total Days Credits may be apportioned at the claim holder's choice. Enter number of days credits per claim selected in columns at right.

Total number of mining claims covered by this report of work **4**

Date **MAY 19, 1989** Reported Holder or Agent (Signature) *[Signature]*

For Office Use Only
 Total Days Cr. Recorded **160** Date Recorded **MAY 23/89** Mining Recorder **[Signature]**
 Date Approved as Recorded **See revised statement** Branch Director **[Signature]**

Certification Verifying Report of Work
 I hereby certify that I have a personal and intimate knowledge of the facts set forth in the Report of Work annexed hereto, having performed the work or witnessed same during and/or after its completion and the annexed report is true.
 Name and Postal Address of Person Certifying **G.W. BRITNOFF, 2300-885 WEST GEORGIA ST., VANCOUVER, BC, V6C 3E8**
 Date Certified **MAY 19, 1989** Certified by (Signature) *[Signature]*

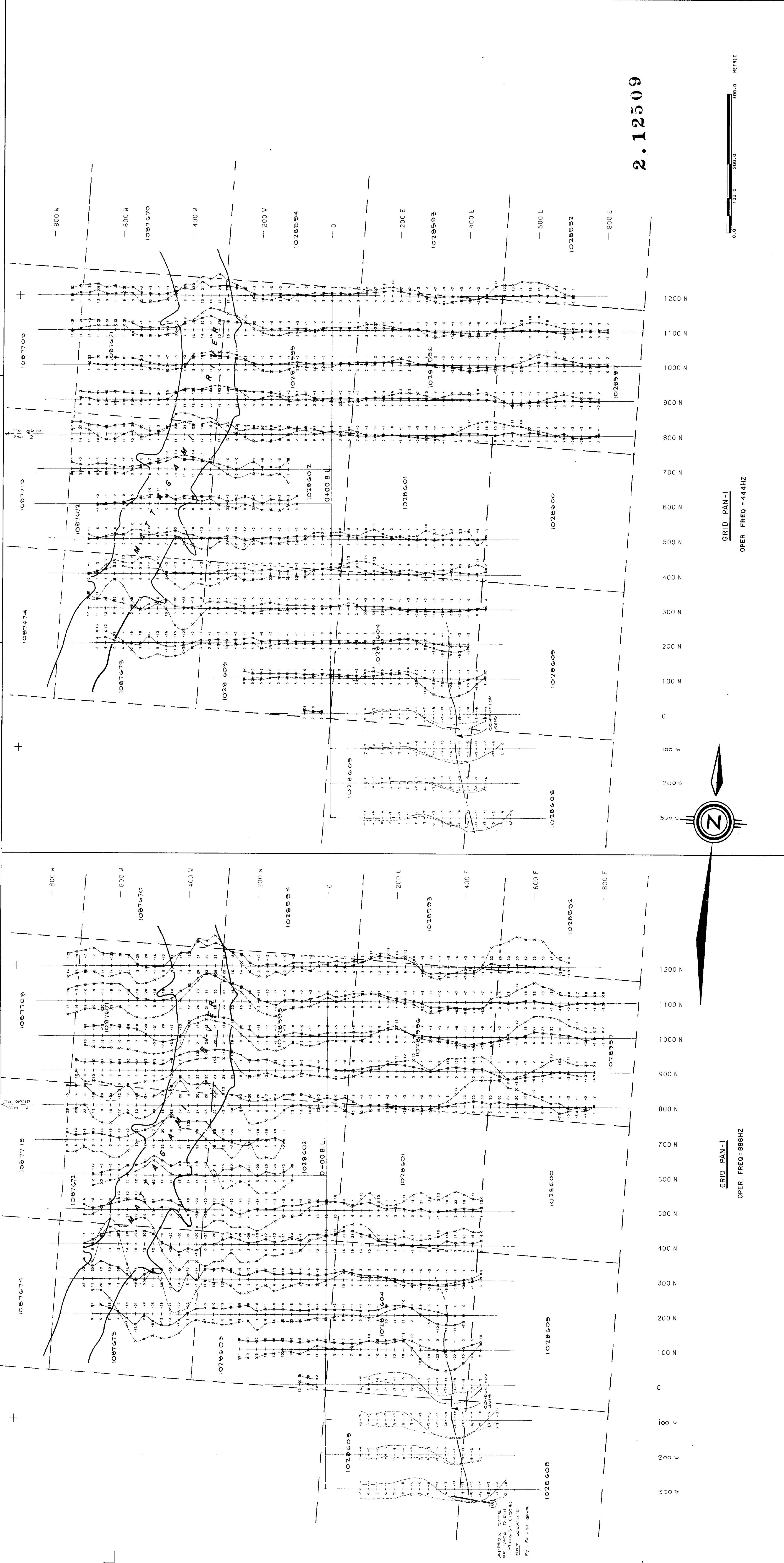
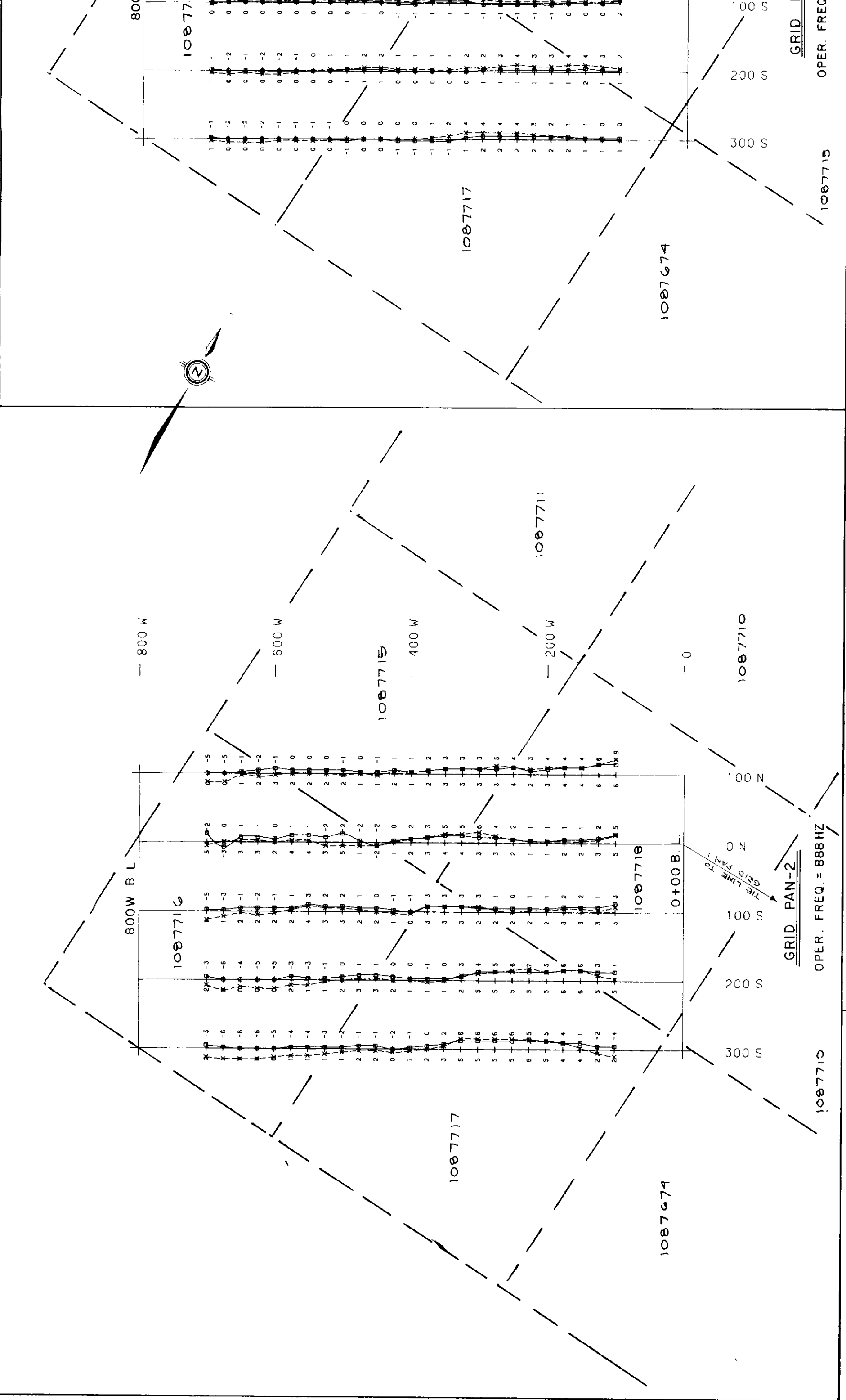
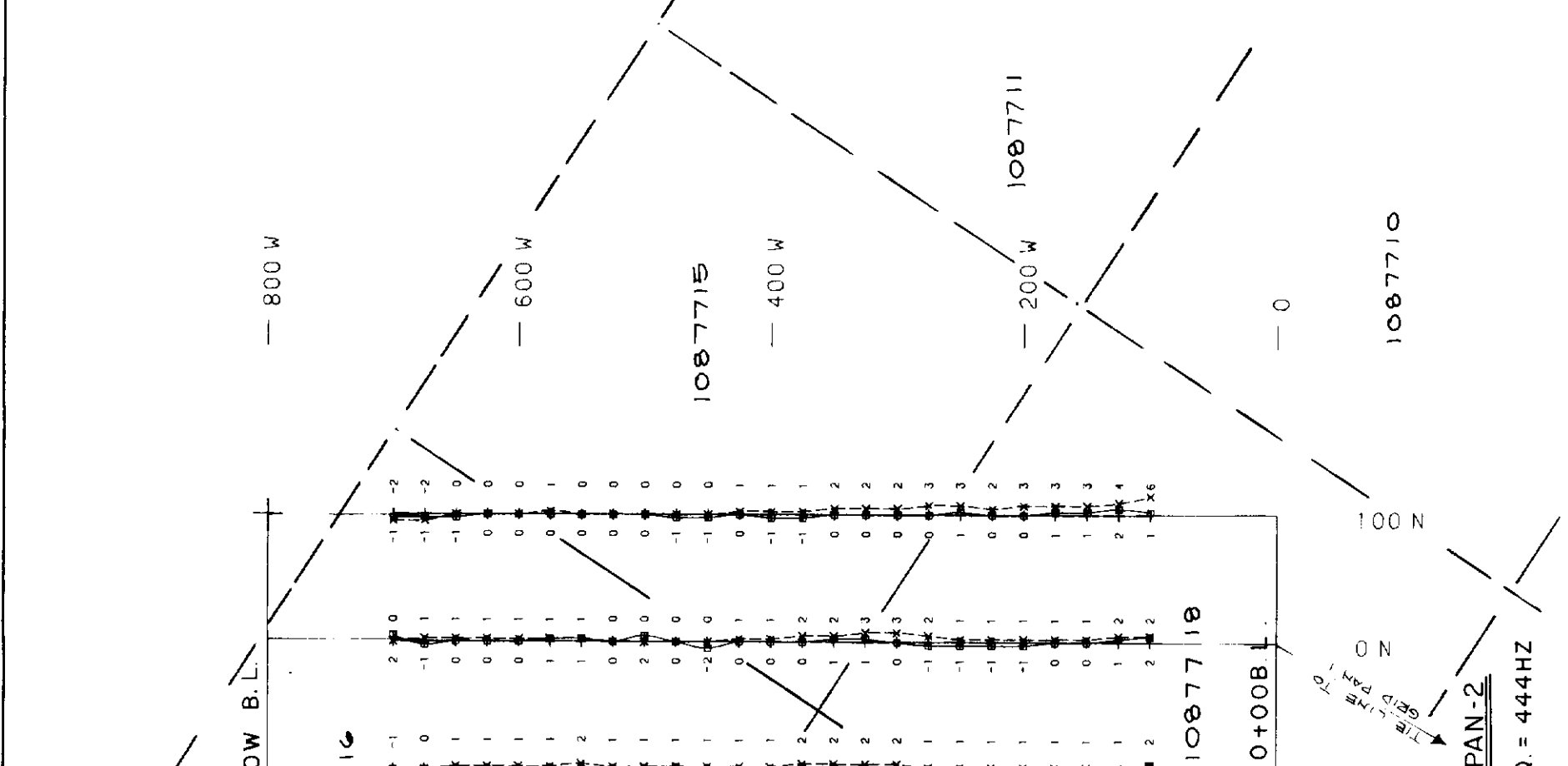
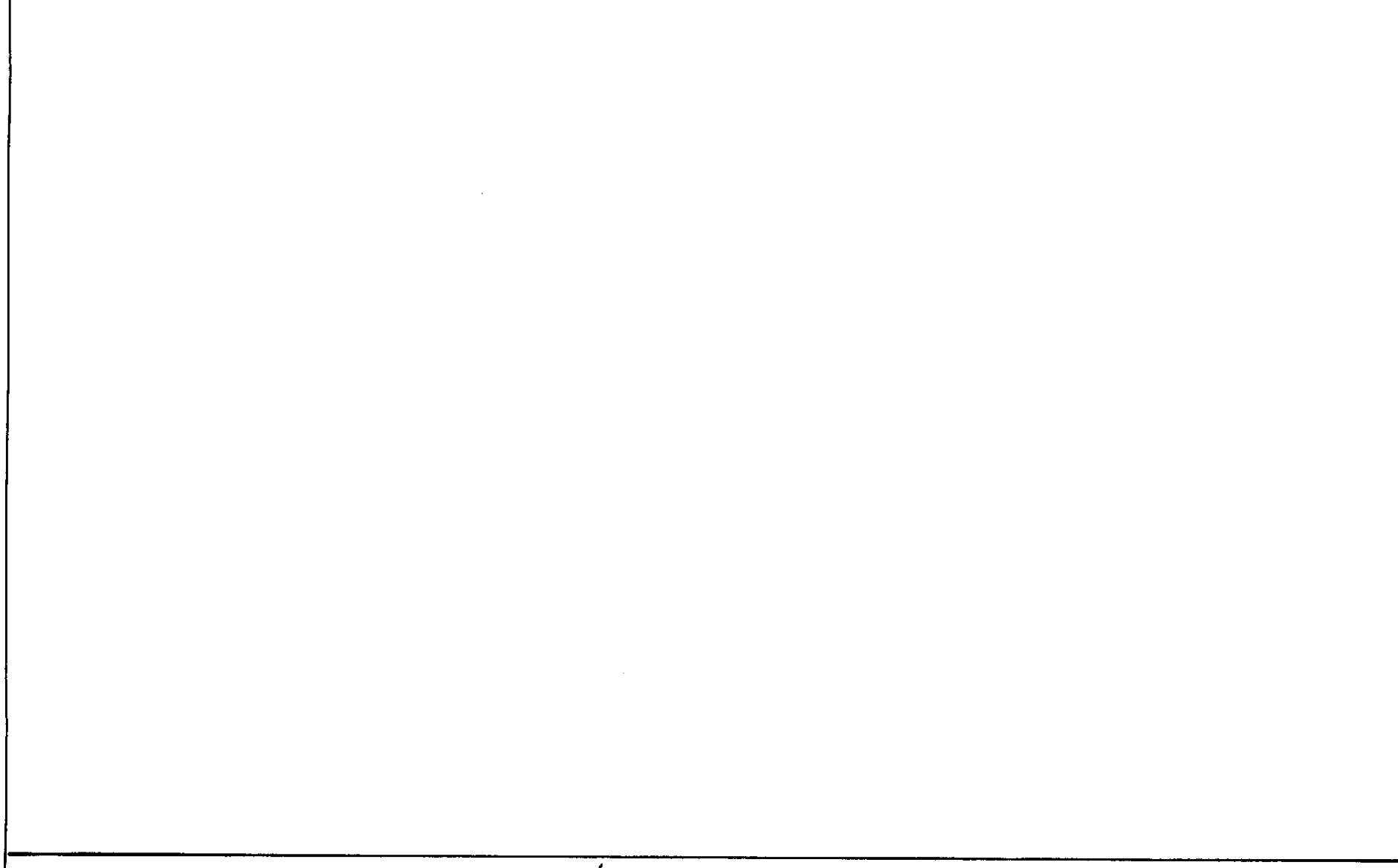
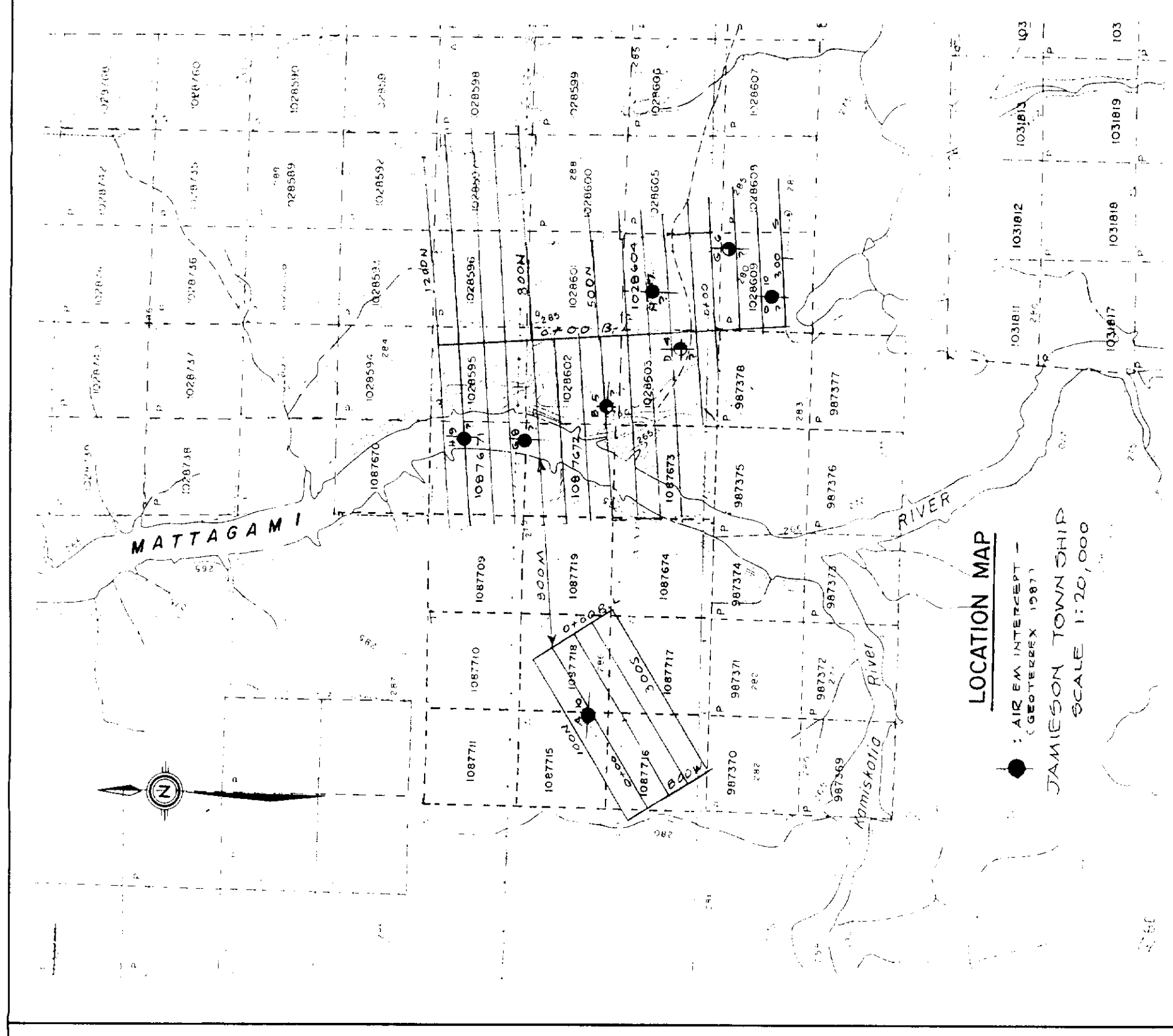

2.12509

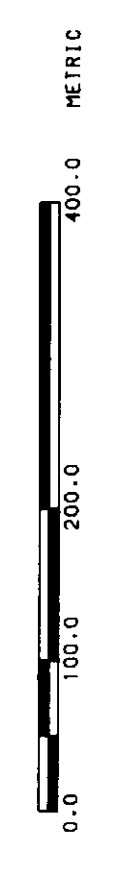
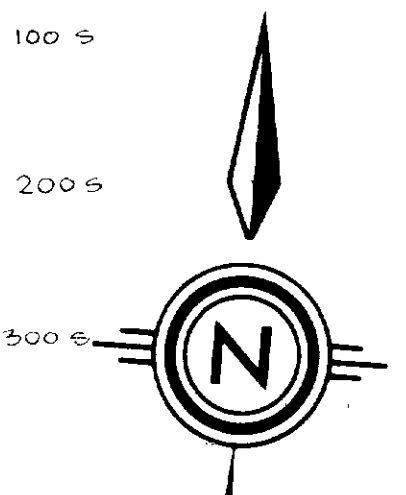

SURVEYED BY: EASICS EXPLORATION LTD., DEC./88		DRAWN BY: GCU AND JRP		HORIZONTAL LOOP ELECTROMAGNETIC SURVEY		SCALE: 1:5000	
IN-PHASE TO LEFT, QUADRATURE TO RIGHT		DATE: JAN. 25/89		PROJECT NO.: S18		PROJECT NO.: S18	
PROFILE SCALE: 1CM=20X		COIL SEPARATION: 200M		INTERPRETED BY: R.P.		N.T.S. NO.: 1	
GRANDES EXPLORATION LTD.				JAMESON TOWNSHIP			
VANCOUVER OFFICE				ONTARIO			

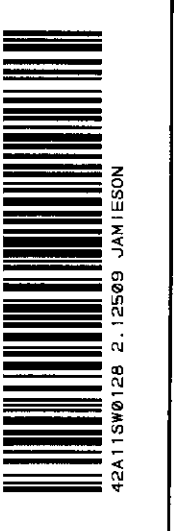

210