

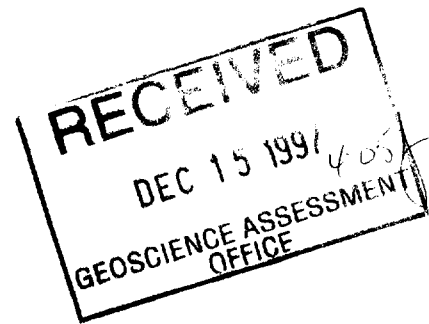

42A11SW2003 2.17969 MOUNTJOY

010



REPORT ON
MAGNETIC SURVEY
MOUNTJOY TOWNSHIP PROPERTY
MOUNTJOY TOWNSHIP

FOR
COMAPLEX MINERALS CORP

2.17969

DECEMBER 1997

D. LONDRY
TIMMINS GEOPHYSICS LTD

SUMMARY AND RECOMMENDATIONS

A magnetic survey was carried out over the Mountjoy property for Comaplex Minerals Corp. in November, 1997.

The magnetic survey maps a number of north-south to north northwest striking diabase dikes on the property. This data should be re-assessed once the induced polarization survey, which has been started, is completed.

2.179 00



42A11SW2003 2.17969 MOUNTJOY

010C

ii

TABLE OF CONTENTS

	page
Summary and Recommendations	i
Introduction	1
General Geology	3
Previous Work	3
Survey Description	4
Magnetic Results	6
References	8

2.17969

LIST OF MAPS

- 1. Magnetic Results (Back Pocket)

LIST OF FIGURES

	page
1.(a) Location Map	2
(b) Claim Map	2
2. Approximate Location of Previous Drill Holes	5
3. Colour Image of Total Magnetic Field	7

LIST OF TABLES

	page
1. Claim Description	1
2. Summary of Previous Work	3

2017000

INTRODUCTION

A magnetic survey was carried out on the Mountjoy Property in Mountjoy Township during October of 1997 for Comaplex Minerals Corp..

The property is located approximately 47 kilometres west from the center of the city of Timmins (Figure 1(a)) in the Porcupine Mining Division. It can be accessed by travelling northwest along the Sandy Falls Road from Timmins or travelling north from Highway 101 along Jaguar Drive which is located along the boundary between Lots 8 and 9, Mountjoy Township.

The property consists of 9 staked claims, which are comprised of a total of 12, forty acre claim units, and 1 patented half lot (Table 1) in the northwest portion of Mountjoy Township (Figure 1(b)). The survey covered the patented half lot and two of the staked claims.

The survey was run by C. McKay

CLAIM #	# of UNITS	DESCRIPTION	TOWNSHIP
568931	1	NE1/4, S1/2, Con IV, Lot 8	Mountjoy
568934	1	NE1/4, S1/2, Con IV, Lot 8	Mountjoy
832525	1	NW1/4, S1/2, Con V, Lot 8	Mountjoy
832524	1	NE1/4, S1/2, Con V, Lot 8	Mountjoy
867472	1	SE1/4, S1/2, Con V, Lot 8	Mountjoy
867473	1	SW1/4, S1/2, Con V, Lot 8	Mountjoy
1204614	2	SE1/4, N1/2 Con V, Lot 9 NE1/4, S1/2, Con V, Lot 9	Mountjoy
1204615	2	SW1/4, N1/2 Con V, Lot 9 NW1/4, S1/2, Con V, Lot 9	Mountjoy
1207585	2	SW1/4, SE1/4, S1/2, Con IV, Lot 8	Mountjoy
Patent		N1/2, Con IV, Lot 8	

Table 1 : Property Description

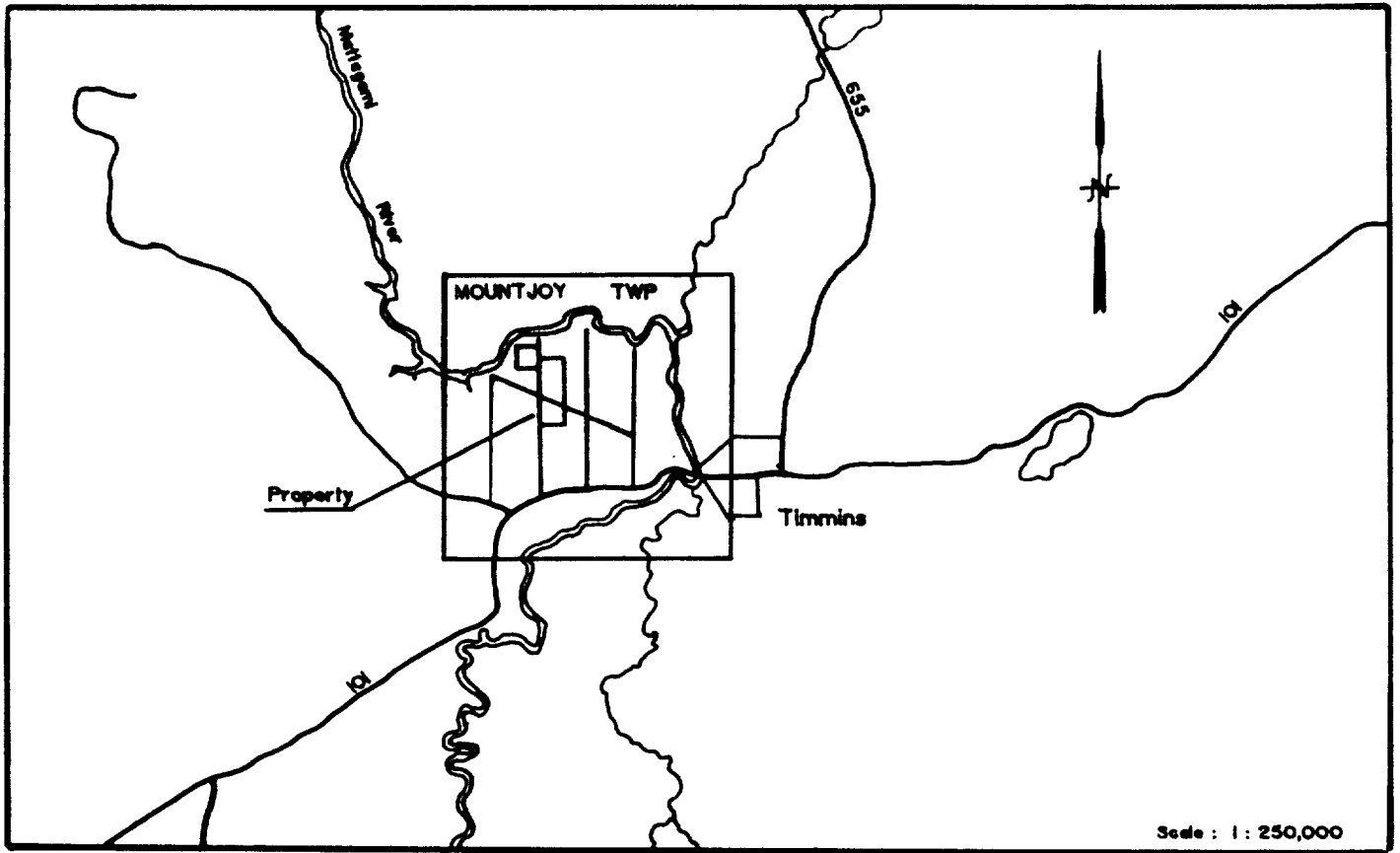

Figure 1 (a) : Location Map

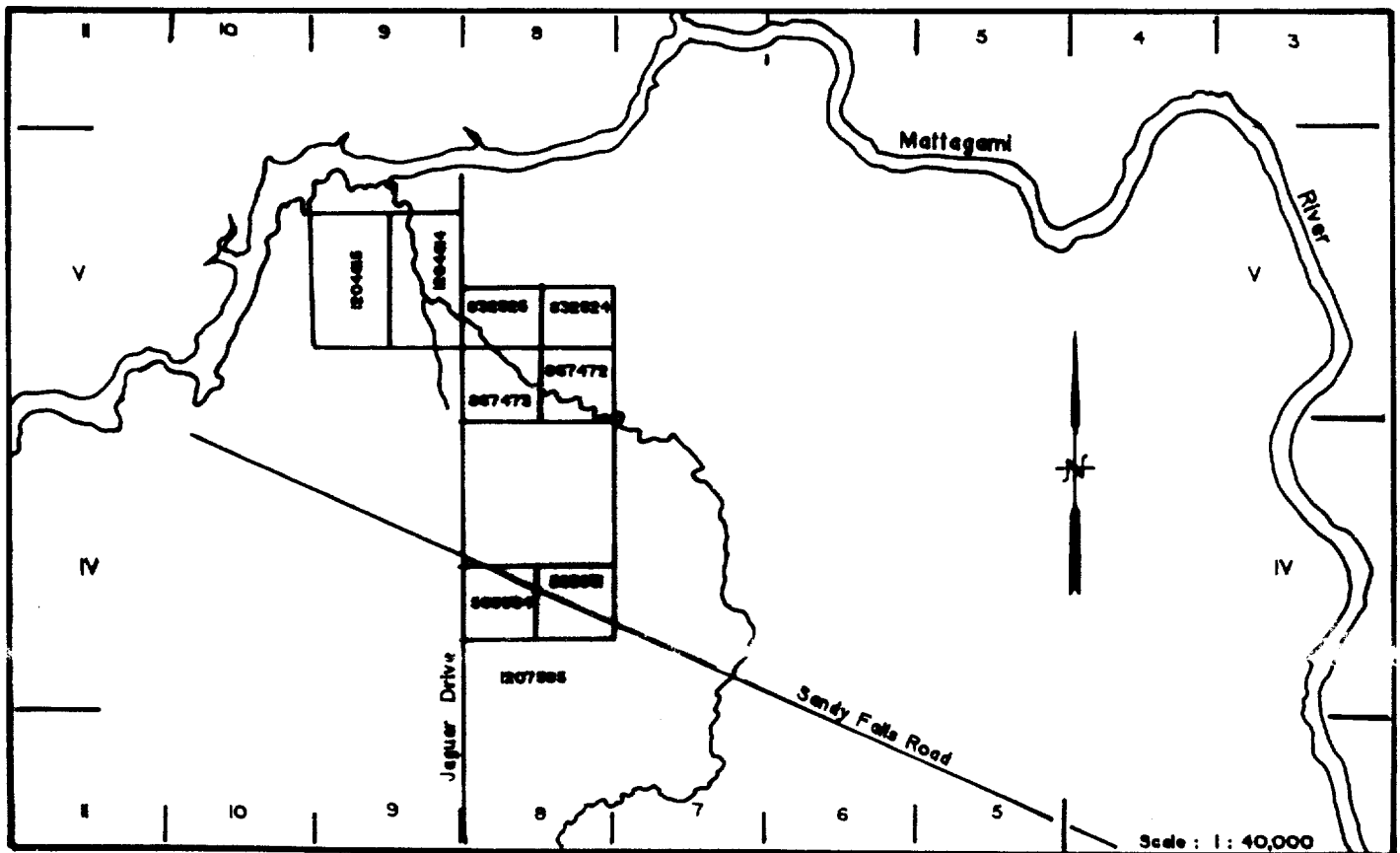

Figure 1 (b) : Claim Map

GENERAL GEOLOGY

The geology of Mountjoy Township is presented on map P-22 (Ferguson, 1958) at a scale of 1 inch to 2000 feet, map 2455 (Pyke, 1982) at a scale of 1:50,000 and map 2205 (Pyke, 1973) at a scale of 1 inch to 4 miles.

Previous drill holes and outcrop along the northern edge of claim 568931 indicate that the property is underlain by sediments and altered mafic and ultramafic volcanics. These rocks have been intruded by quartz-feldspar porphyry and north-south striking diabase dikes.

PREVIOUS WORK

The following is a description of previous exploration work carried out on the property (Table 2).

In the early 1930's, Mineral Estates sank four diamond drill holes in the vicinity of a gold showing along the north edge of claim 568931, in Concession IV, Lot 8 (Figure 2). The best intersection was 30 feet averaging .03 ounces of per ton within which was a two foot section which averaged ,08 ounces per ton.

YEAR	COMPANY	GEOPHYSICS	DRILL HOLES	ASSESSMENT FILE
1930	Mineral Estates		1 to 4	T-47
1964	Hollinger Consolidated Gold Mines		1 and 2	T-833
1974	Kerr Addison Mines Limited	Mag	1 to 14	T-1650
1981	Comstate Resources Limited	Amag, AEM, Geoch		T-2526
1983	Grand Saguenay Mines & Minerals		1 and 2	T-2882
1986	Zahavy Mines Limited		1 to 7	T-2526

Table 2. Summary of previous assessment work.

In 1964, Hollinger Consolidated Gold Mines Limited drilled two holes totalling 833 feet in the S1/2 of Concession Iv, Lot 8.

In 1974, Kerr Addison Mines Limited carried out an exploration program in north central Mountjoy Township which included a magnetic survey, 87 overburden holes and 14 diamond drill holes. The magnetic survey was run along north-south lines spaced every 200 feet; it covered Concession IV, Lots 5 to 9 and Concession III, Lots 5 to 8. The diamond drill holes were sunk to test geochemical anomalies.

In 1981 and 1982, Comstate Resources Ltd. ran a geochemical program in which the humus and basal tills were sampled. In 1983, an airborne magnetic and Input EM survey was flown by Questor Surveys Limited for Comstate over the western three quarters of Mountjoy Township,

In 1983, Grand Saguenay Mines & Minerals Limited optioned 79 claims in Mountjoy Township from Comstate Resources Ltd. An induced polarization (IP) survey was carried out along north-south lines spaced every 400 feet. The survey was run with the Scintrex IPR-8 and IPR-11 receivers and TSQ-3, 3 kWatt transmitter. The 'a' spacing used was 200 feet and readings were taken for 'n'=2 and 3. Two diamond drill holes totalling 804 feet were sunk outside the present survey area to test IP anomalies.

In 1986, Zahavy Mines Limited drilled seven holes to test the area of the original showing and areas of alteration interpreted from the airborne magnetics.

In 1987, the Ontario Geological Survey carried out a combined airborne magnetic and EM survey in the Timmins area which included Mountjoy Township (OGS, 1988). This survey was flown along north-south lines spaced approximately every 200 metres.

SURVEY DESCRIPTIONS

An east-west base line, designated 800 South, was established along the south edge of the patented lot in Lot 8 and north-south grid lines were cut every 100 metres and picketed every 20 metres; Line 0 East is located along the east side of Jaguar Drive. East-west tie lines were also established every 200 metres.

The magnetic readings were taken every 10 metres with a Scintrex IGS-2/MP-4. This instrument is a

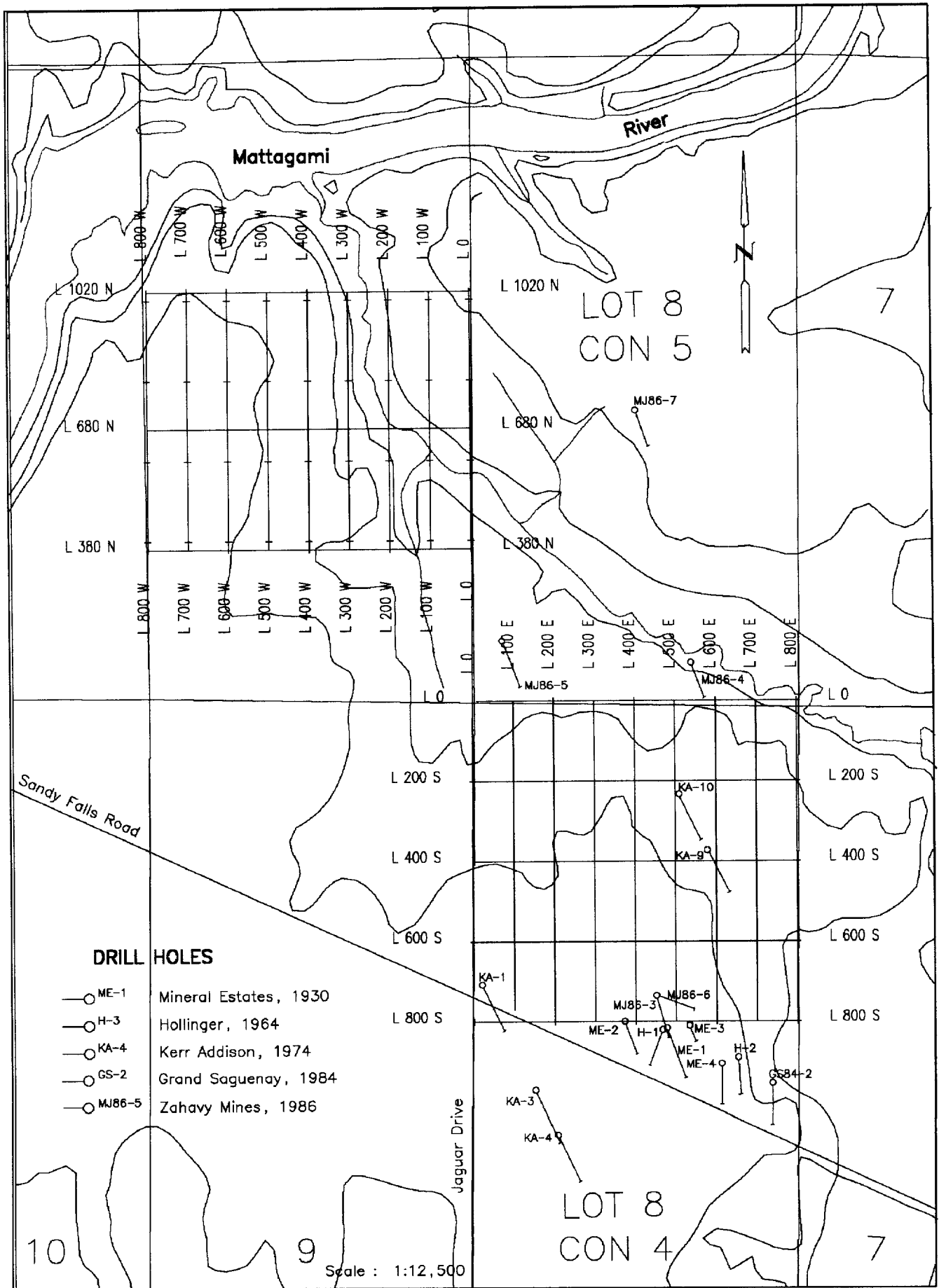

Figure 2: Approximate Location of Previous Drill Holes

proton precession magnetometer which measures the earth's total magnetic field to an accuracy of 0.1 gammas. Diurnal variations were monitored every 12 seconds with a Scintrex MP-3 base station magnetometer located at 60 East on Tie Line 200 South. The base value at this location to which all other readings were leveled to is 57840 nT. A total of 941 readings were taken along 19.3 kilometres of line.

MAGNETIC RESULTS

The magnetic results are posted and contoured every 25 nT on Map 1 at a scale of 1:5000. A colour image of the total magnetic field is also given in Figure 2 at a scale of 1:12,500.

The magnetic field on the property is dominated by the response from a number of north-south to north northwest striking diabase dikes. The low response on the west side of the dikes and the low gradient to the east suggests that the dikes dip to the east. The change in amplitude along the strike of the dike and from one dike to another is likely due to different overburden depths.

Two low amplitude magnetic anomalies are present in Lot 8 which may not be related to the dikes. One strikes east northeast from 300 South on Line 200 East to approximately 50 South on Line 600 East and the other strikes west northwest from 600 South on Line 800 East.

Dec. 12/97
DATE

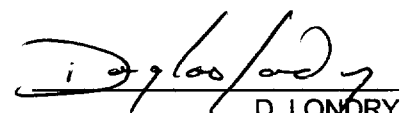
D. LONDROY
TIMMINS GEOPHYSICS LTD

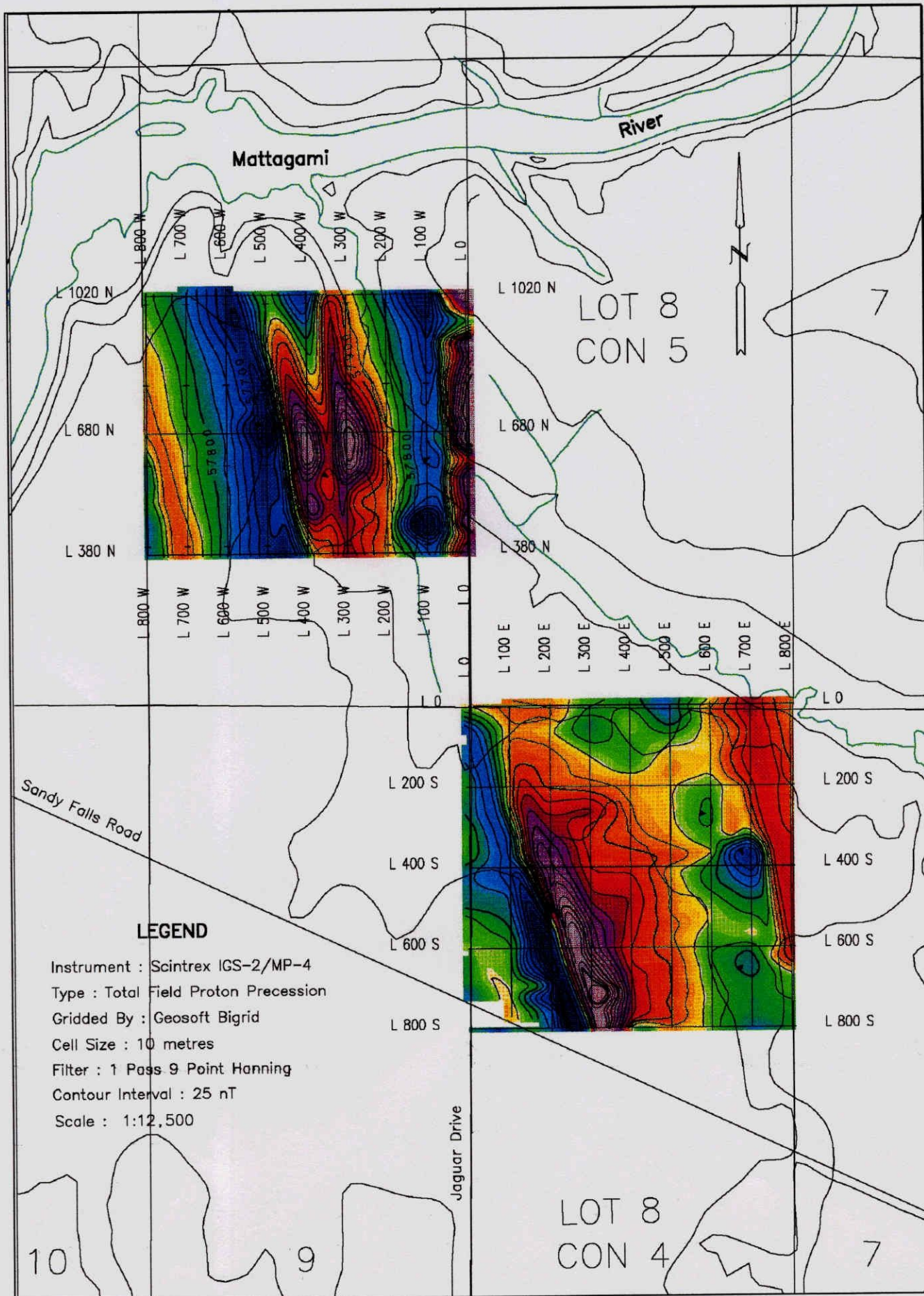

Figure 3 : Colour Image of Total Magnetic Field, Mountjoy Township

REFERENCES

Beaton, W.D.

1983: Evaluation Report on the Mountjoy and Cairo Properties in the Porcupine and Larder Lake Mining Divisions of the Districts of Cochrane and Timiskaming in the Timmins Area, Province of Ontario (Timmins Assessment File 2882).

Ferguson, S.A.

1958: Mountjoy Township; Ontario Department of Mines, Preliminary **Map P-22**, Scale 1 inch to 1320 feet.

Hurst, M.E.

1938: Porcupine Area, District of Cochrane, Ontario; Ontario Department of Mines, **Map No. 47a** at a scale of 1 inch to 2000 feet.

ONTARIO GEOLOGICAL SURVEY

1988: Airborne Electromagnetic and Total Intensity Survey, Timmins Area, Mountjoy Township, Districts of Cochrane and Timiskaming Ontario; by Geoterrex Limited, for Ontario Geological Survey. Geophysical/Geochemical Series **Map 81078**. Scale 1:20,000. Survey and compilation from March 1987 to October 1987.

Pyke, D.R.

1982: Geology of the Timmins Area, District of Cochrane; Ontario Geological Survey Report 219, 141 p. Accompanied by **Map 2455**, Scale 1:50,000, 3 Charts and 1 Sheet Microfiche.

Pyke, D.R., Ayres, L.D. and Innes, D.

1973: Timmins-Kirkland Lake Sheet; Ontario Division of Mines, Geological Compilation Series, **Map 2205**, scale 1" = 4 miles.



Declaration of Assessment Work Performed on Crown Lands

Mining Act, Subsection 66(2), R.S.O. 1990

Transaction Number (office use)
W9760.00759
Assessment Files Research Imaging

Personal information collected on this form is obtained under the authority of the Access to Information Act. This information will be used to review the collection should be directed to a Provincial Mining Recorder, Ministry of Northern Development and Mines, P3E 6B5.

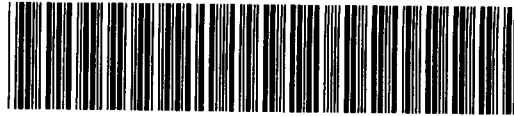

42A11SW2003 2.17969 MOUNTJOY

this
this
jury,

900

Instructions: - For work performed on mining lands, use form 0240.
- Please type or print in ink

1. Recorded holder(s) (Attach a list if necessary)

Name COMAPLEX MINERALS CORP	Client Number 120065
Address SUITE 901, 1015 4th S.W. CALGARY, ALBERTA, T2R 1S4	Telephone Number (403) 265-6973
	Fax Number
Name COMSTATE RESOURCES LTD.	Client Number 302304
Address SUITE 901, 1015 4th S.W. CALGARY, ALBERTA, T2R 1S4	Telephone Number (403) 265-6973
	Fax Number

2. Type of work performed. Only regional surveys and prospecting work are allowed on Crown Lands before recording. For work performed after recording a claim or on other mining lands, use form 0241.

Work Type LINECUTTING MAGNETIC	Office Use
	Commodity
	Total \$ Value of Work Claimed \$8167
Dates Work Performed From 28 JUL 97 To 12 DEC 97	NTS Reference
Global Positioning System Data (if available)	Mining Division Provincial
Township/Area MOUNTJOY TWP.	Resident Geologist District (1. M. M. M.)
M or G-Plan Number G 3974	

Please remember to: - complete and attach a Statement of Costs, form 0212;
- provide a map showing contiguous mining lands that are linked for assigning work;
- include two copies of your technical report;
- provide proper notice to surface rights holders before starting work.

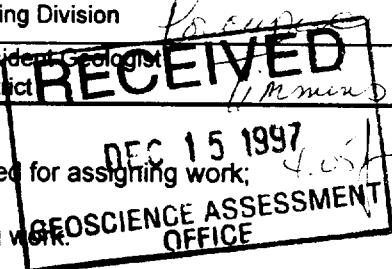

3. Person or companies who prepared the technical report (Attach a list if necessary)

Name DOUGLAS LONDY	Telephone Number (705) 523-5479
Address 547 LOACH'S RD. SUDBURY, ONT. P3E2R3	Fax Number
Name	Telephone Number
Address	Fax Number
Name	Telephone Number
Address	Fax Number

2.17969

4. Certification by Recorded Holder or Agent

I, DOUGLAS LONDY (Print Name), do hereby certify that I have personal knowledge of the facts set forth in this Declaration of Assessment Work having caused the work to be performed or witnessed the same during or after its completion and, to the best of my knowledge, the annexed report is true.

Signature of Recorded Holder or Agent <i>[Signature]</i>	Date DEC. 12/97
Agent's Address 547 LOACH'S RD. SUDBURY, ONT. P3E2R3	Telephone Number (705) 523-5479
	Fax Number

March 15/98

5. Work to be recorded and distributed. Work that is performed on Crown Lands that are subsequently staked as a mining claim, can be claimed at 100% of its value (state this amount in column "a" below). If work is performed on Crown lands and not enclosed within a subsequently recorded claim, it can be claimed at 25% of its value (state this amount in column "b" below). Work can only be assigned to claims that are contiguous to (adjoining) the lands where work was performed at the time work was performed. A map showing the contiguous link must accompany this form.

W9760, OCT 59

Mining Claim Number	No. of Claim Units	Value of work performed before recording a mining claim		Value of work applied to this claim	Value of work assigned to other mining claims	Bank Value of work to be distributed at a later date
		(a) Work now within a claim. Show 100% of cost	(b) Work on adjacent Crown lands. Show 25% of cost.			
eg 1234567	4	\$4980	\$725	\$1800	\$800	\$3305
eg 1234568	2	N/A	N/A	\$ 800	N/A	N/A
1 PATENTED 1/2 LOT N 1/2 CONJUG LOT 8	2 600000	4668.00			4668.00	
2 568931	1			1200.00	✓	
3 568934	1			1200.00	✓	
4 832524	1			800.00	✓	
5 832525	1			800.00	✓	
6 867472	1			800.00	✓	
7 867473	1	100.00		800.00	✓	
8 1204614	2	1699.00		800.00	732.00	167.00
9 1204615	2	1699.00		800.00	899.00	
10 1267585	2			800.00	✓	
11						
12						
13						
14						
15						
Column Totals		8167.00		8000.00	6299.00	167.00

RECEIVED
 DEC 15 1997
 GEOSCIENCE ASSESSMENT OFFICE

I, DOUGLAS LONDREY, do hereby certify that the above work credits are eligible under subsection 7 (1) of the Assessment Work Regulation 6/96 for assignment to contiguous claims or for application to the claim where the work was done.

Signature of Recorded Holder or Agent Authorized in Writing: Douglas Londrey Date: DEC. 12/97

6. Instruction for cutting back credits that are not approved.

Some of the credits claimed in this declaration may be cut back. Please check (✓) in the boxes below to show how you wish to prioritize the deletion of credits:

- 1. Credits are to be cut back from the Bank first, followed by option 2 or 3 or 4 as indicated.
- 2. Credits are to be cut back starting with the claims listed last, working backwards; or *DL FIRST forwards DL*
- 3. Credits are to be cut back equally over all claims listed in this declaration; or
- 4. Credits are to be cut back as prioritized on the attached appendix or as follows (describe):

2. 17989

Note: If you have not indicated how your credits are to be deleted, credits will be cut back from the Bank first, followed by option number 2 if necessary.

For Office Use Only Received Stamp	Deemed Approved Date	Date Notification Sent
	Date Approved	Total Value of Credit Approved
	Approved for Recording by Mining Recorder (Signature)	

Personal information collected on this form is obtained under the authority of subsection 6(1) of the Assessment Work Regulation 6/96. Under section 8 of the Mining Act, the information is a public record. This information will be used to review the assessment work and correspond with the mining land holder. Questions about this collection should be directed to the Chief Mining Recorder, Ministry of Northern Development and Mines, 6th Floor, 933 Ramsey Lake Road, Sudbury, Ontario, P3E 6B5.

Work Type	Units of Work <small>Depending on the type of work, list the number of hours/days worked, metres of drilling, kilometres of grid line, number of samples, etc.</small>	Cost Per Unit of work	Total Cost
LINECUTTING	19.74 Km	\$ 265/Km	\$ 5231.1
MAGNETIC SURVEY	19.36 Km.	\$ 100/Km	\$ 1936.0
REPORT		\$ 1000.	\$ 1000.0
Associated Costs (e.g. supplies, mobilization and demobilization).			
Transportation Costs			
Food and Lodging Costs			
Total Value of Assessment Work			\$ 8167.10

RECEIVED
 DEC 15 1997
 GEOSCIENCE ASSESSMENT OFFICE

Calculations of Filing Discounts: 2.17969

- Work filed within two years of performance is claimed at 100% of the above Total Value of Assessment Work.
- If work is filed after two years and up to five years after performance, it can only be claimed at 50% of the Total Value of Assessment Work. If this situation applies to your claims, use the calculation below:

TOTAL VALUE OF ASSESSMENT WORK $\times 0.50 =$ Total \$ value of worked claimed.

Note:
 - Work older than 5 years is not eligible for credit.
 - A recorded holder may be required to verify expenditures claimed in this statement of costs within 45 days of a request for verification and/or correction/clarification. If verification and/or correction/clarification is not made, the Minister may reject all or part of the assessment work submitted.

Certification verifying costs:
 I, DOUGLAS JAMES LONDREY, do hereby certify, that the amounts shown are as accurate as may reasonably be determined and the costs were incurred while conducting assessment work on the lands indicated on the accompanying Declaration of Work form as AGENT I am authorized to make this certification.
(please print full name)
(recorded holder, agent, or state company position with signing authority)

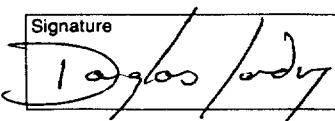
Signature 	Date DEC. 12/97
---	--------------------

March 12, 1998

COMSTATE RESOURCES LTD.
#901, 1015 FOURTH ST. S.W.
CALGARY, ALBERTA
T2R-1J4

Geoscience Assessment Office
933 Ramsey Lake Road
6th Floor
Sudbury, Ontario
P3E 6B5

Telephone: (888) 415-9846
Fax: (705) 670-5881

Dear Sir or Madam:

Submission Number: 2.17969

Status

Subject: Transaction Number(s): W9760.00759 Approval

We have reviewed your Assessment Work submission with the above noted Transaction Number(s). The attached summary page(s) indicate the results of the review. **WE RECOMMEND YOU READ THIS SUMMARY FOR THE DETAILS PERTAINING TO YOUR ASSESSMENT WORK.**

If the status for a transaction is a 45 Day Notice, the summary will outline the reasons for the notice, and any steps you can take to remedy deficiencies. The 90-day deemed approval provision, subsection 6(7) of the Assessment Work Regulation, will no longer be in effect for assessment work which has received a 45 Day Notice.

Please note any revisions must be submitted in DUPLICATE to the Geoscience Assessment Office, by the response date on the summary.

If you have any questions regarding this correspondence, please contact Lucille Jerome by e-mail at jerome12@epo.gov.on.ca or by telephone at (705) 670-5858.

Yours sincerely,



ORIGINAL SIGNED BY
Blair Kite
Supervisor, Geoscience Assessment Office
Mining Lands Section

Work Report Assessment Results

Submission Number: 2.17969

Date Correspondence Sent: March 12, 1998

Assessor: Lucille Jerome

Transaction Number	First Claim Number	Township(s) / Area(s)	Status	Approval Date
W9760.00759	867473	MOUNTJOY	Approval	March 10, 1998

Section:

14 Geophysical MAG

Correspondence to:

Resident Geologist
South Porcupine, ON

Assessment Files Library
Sudbury, ON

Recorded Holder(s) and/or Agent(s):

Douglas Londry
SUDBURY, ONTARIO, CANADA

COMSTATE RESOURCES LTD.
CALGARY, ALBERTA

COMAPLEX MINERALS CORP.
CALGARY, ALBERTA
