



42A12NE0588 24 LOVELAND

010

Diamond Drilling

Township of LOVELAND

Report NO: 24

Work performed by: HOLLINGER MINES

Claim NO	Hole NO	Footage	Date	Note
P 98974	L04-1-72	525'	Feb/72	(1)

Notes: (1) 31/72

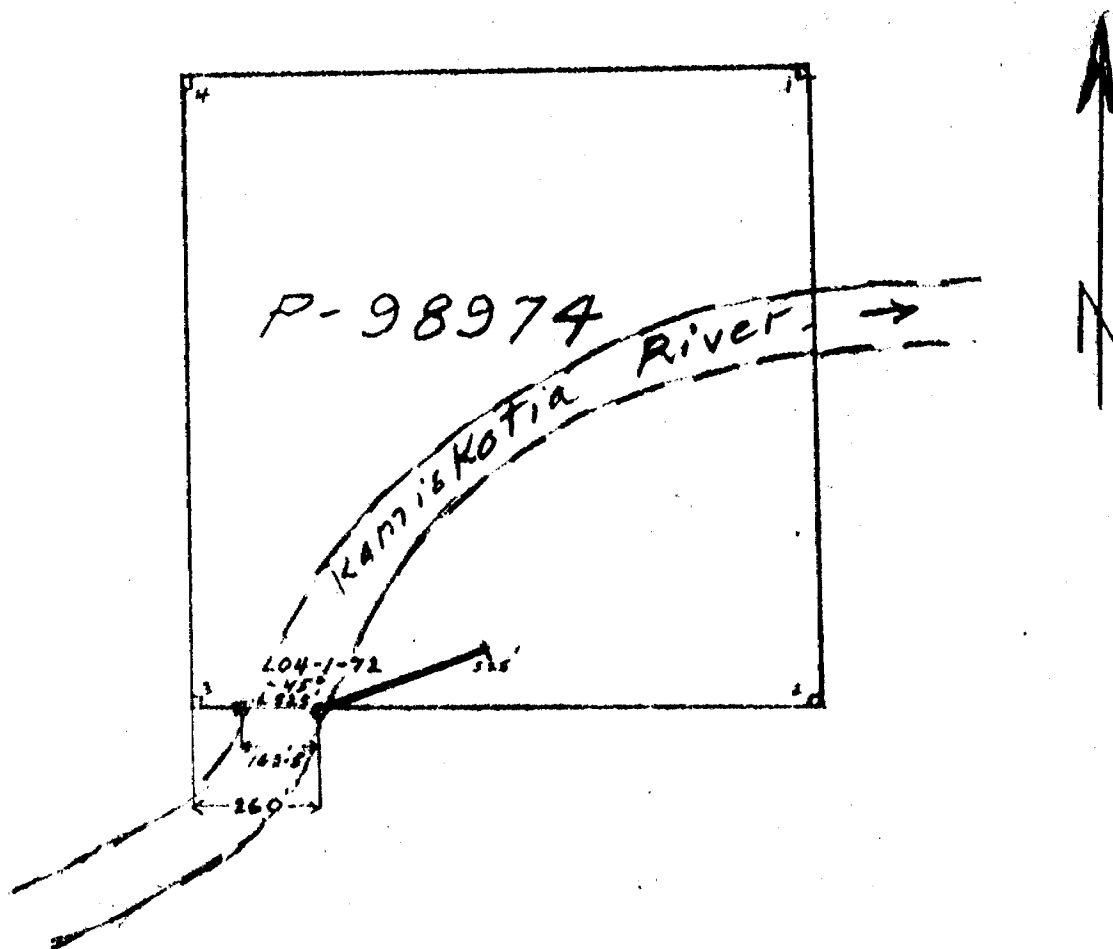

Started - Feb. 1/72  
 Finished - Feb. 8/72  
 Bradley Bros. Ltd.  
 Wire Line (AQ Core)

PLAN OF DDH # LO4-1-72

CLAIM P-98974

Scale 1" = 400'

W. Hansen  
 HOLLANDER MINES LIMITED  
 TIMMINS, ONTARIO

#31/72 Loveland Pgs  
 No. 11/19/72 Min. Ltd

Location of Collar from #3 of P-98974 East 260' and  
FORM 822 00 N on Township Line

NORTH 00 N  
EAST. 162.5' E of 3 mile post.  
ELEV. Surface  
AZIM. 706  
DIP Collar 45° @ 200' - 47°  
@ 525' - 44°

# DIAMOND DRILL REPORT

HOLE NO. L04-1-72  
COMMENCED Feb. 1st, 1972  
FINISHED Feb. 8th, 1972  
PURPOSE OF HOLE Test EM conductor  
(weak)

PROPERTY LOVELAND #4 GROUP

Claim P-98974 Loveland Township

Drilled by: Bradley Bros.

FROM	TO	DESCRIPTION	CORE SAMPLES					DESCRIPTION OF SAMPLE
			FROM	TO	RECOV.	WIDTH	ASSAY	
0	10	Casing.						
10	231.5	Massive grey rhyolite schistosity at 25° to C.A. at 50'. 75-100 ivory type rhy. with dev. of sericite, a few sm. specks of chalco. 100-125 uniform grey rhyolite. Flow banding at 25° to C.A.						
231.5	236	Short andesitic dyke - bleached at contact; contacts broken - grey green chloritic andesite - some py along quartz-CO <sub>2</sub> stringers mostly at first part. Contacts possibly @ 30° to C.A.	231	235		4		Au, Ag + Geochem. Andesite dyke - w. qtz-CO <sub>2</sub> minor py.
236	254.7	Rhyolite - sericitic, locally sections bleached, splash of cp 249, bit of chlorite.						
254.7	262.6	Another andesite dyke - contacts appear somewhat gradational. Only minor qtz-CO <sub>2</sub> .						
262.6	360.1	Rhyolite - darker and more chloritic. Some flow banding @ 20° to C.A. @ 342' some calcite blebs. @ 339 some purple qtz (amethyst?) 330-360.1 weakly brecciated rhyolite a bit darker in colour. Still qtz eyes - brecciation becomes more intense near contact with the dyke.						

NORTH \_\_\_\_\_  
 EAST \_\_\_\_\_  
 ELEV. \_\_\_\_\_  
 AZIM. \_\_\_\_\_  
 DIP \_\_\_\_\_

## DIAMOND DRILL REPORT

PROPERTY LOVELAND #4 GROUPLoveland Twp.HOLE NO. L04-1-72

COMMENCED \_\_\_\_\_  
 FINISHED \_\_\_\_\_  
 PURPOSE OF \_\_\_\_\_  
 HOLE \_\_\_\_\_

FROM	TO	DESCRIPTION	CORE SAMPLES					DESCRIPTION OF SAMPLE
			FROM	TO	RECOV.	WIDTH	ASSAY	
360.1	492.8	Diabase - contact @ 45° to C.A. Chill margin - finer grained to 367. After 367 coarser grained - magnetic with very minor py and local concen- trations of magnetite - slightly serpentinised. The diabase becomes much coarser grained at the center with the typical green feldspars. The lower contact is brecciated and filled with quartz-CO <sub>2</sub> and some cp. 485.4-487.5 - chill margin brecciated qtz-CO <sub>2</sub> + some cp. 491.2-492.8 - chill margin brecciated qtz-CO <sub>2</sub> + cp + ZnS Yellowish sphalerite.						Cu, Au, Ag
			485	488		3		Diabase bx - with cp.
			491	493		2		" " " " ZnS
			505	510		5		Rhyolitic intrusive.
492.8	525	Acid intrusive - rhyolitic - numerous small white feldspars crystals, rock is grey with reddish syenitic appearance. Massive, unmineralized, some epidote alteration locally. 493.2-493.4 - diabase stringer.						
	525	END OF HOLE <i>LA m u t e m p e</i>						

HOLLINGER MINES LIMITED  
 TIMMINS, ONTARIO