



42A12NE0619 2.617 LOVELAND

COMINCO

010

Exploration
N.T.S. 42-A-12

Eastern District

BYERS PROJECT

Byers and Loveland Twp., Ontario

September 22, 1971

E.O. Andersen

This report covers a ground horizontal loop electromagnetic survey performed by Cominco Ltd. on its 39 claim group in Byers and Loveland townships, near Timmins, Ontario during December 1970. The survey was carried out over all the claims on 31.5 line miles of cut and picketed lines spaced 400 feet apart.

The equipment used for the survey was an ABEM Minigun instrument operating at 3520 hertz with a coil spacing of 200 feet and a Scintrix SE-600 instrument operating at 1600 hertz with a coil spacing of 300 feet. The area surveyed with each instrument is indicated on the accompanying map. Readings were taken at 100-foot intervals (50-foot intervals over anomalous areas) and the in-phase and out-of-phase values are plotted midway between the coil locations.

Three definite and three possible anomalies were detected by the survey. Anomalies A and B are of the type usually caused by either massive sulphides or graphite. Both these anomalies have strike lengths of about 800 feet. The other anomalies detected are weaker and show poorer conductivity indicating that they are probably due to irregularities in a sheet-form conductive overburden, or too deeply buried, poor vertical bedrock conductors.

Submitted by:

E.O. Andersen

E.O. Andersen, P. Eng.



Endorsed by:

H.F. Aston

H.F. Aston, P. Eng.

ASSESSMENT WORK DETAILS



Type of Survey ELECTROMAGNETIC
 A separate form is required for each type of
 Township or Area BYERS AND LOVELAND

42A12NE0619 2.617 LOVELAND

300

Chief Line Cutter J. ALIX
 or Contractor RR# 1, AIRPORT RD., TIMMINS, ONT.
 Name
 Address

Party Chief E.O. ANDERSEN
COMINCO LTD. - 335 BAY ST., TORONTO.
 Name
 Address

Consultant _____
 Name
 Address

Geological field mapping by _____
 Name
 Address

COVERING DATES

Line Cutting DECEMBER 1970
 Field DECEMBER 1970
 Instrument work, geological mapping, sampling etc.
 Office JANUARY 1971

INSTRUMENT DATA

Make, Model and Type ABEM MINIGUN / SCINTREX SE 600
 Scale Constant or Sensitivity _____
 Or provide copy of instrument data from Manufacturer's brochure.
 Radiometric Background Count _____
 Number of Stations Within Claim Group 1680
 Number of Readings Within Claim Group 1700
 Number of Miles of Line cut Within Claim Group 31.5
 Number of Samples Collected Within Claim Group _____

MINING CLAIMS TRAVERSED	
List numerically	
P. - 299035	P. - 299055
299036	299056
299037	299057
299038	299058
299039	299059
299040	299060
299041	299061
299042	299062
299043	299063
299044	299064
299045	299065
299046	299066
299047	299067
299048	299068
299049	299069
299050	299070
299051	299071
299052	299072
299053	299073
299054	
TOTAL CLAIMS <u>39</u>	

If space insufficient, attach list

CREDITS REQUESTED

Geological Survey 20 DAYS per claim 40 DAYS per claim Includes (Line cutting)
 Geophysical Survey Show Check ✓
 Geochemical Survey

DATE 22 Sept 71 SIGNED E.O. Andersen

Send in Duplicate to:
 FRED W. MATTHEWS
 SUPERVISOR-PROJECTS SECTION
 DEPARTMENT OF MINES &
 NORTHERN AFFAIRS
 WHITNEY BLOCK
 QUEEN'S PARK
 TORONTO, ONTARIO
 RECEIVED
 SEP 24 1971
 PROJECTS SECTION

SUBMISSION OF GEOLOGICAL, GEOPHYSICAL AND GEOCHEMICAL SURVEYS

AS ASSESSMENT WORK

In order to simplify the filing of geological, geochemical and ground geophysical surveys for assessment work, the Minister has approved the following procedure under Section 84 (8a) of the Ontario Mining Act. This special provision does not apply to airborne geophysical surveys.

If, in the opinion of the Minister, a ground geophysical survey meets the requirements prescribed for such a survey, including:

- (a) substantial and systematic coverage of each claim
- (b) line spacing not exceeding 400 foot intervals
- (c) stations not exceeding 100 foot intervals or
- (d) the average number of readings per claim not less than 40 readings

it will qualify for a credit of 40 assessment work days for each claim so covered. It will not be necessary for the applicant to furnish any data or breakdown concerning the persons employed in the survey except for the names and addresses of those in charge of the various phases (linecutting contractor, etc.). It will be assumed that the required number of man days were spent in producing the survey to qualify for the specified credit.

Each additional ground geophysical survey using the same grid system and otherwise meeting these requirements will qualify for an assessment work credit of 20 days.

A geological survey using the same grid system, and meeting the requirements for submission of geological surveys for maximum credits will qualify for an assessment work credit of 20 days. If line cutting has not previously been reported with any other survey and is reported in conjunction with the geological survey a credit of 40 days per claim will be allowed for the survey.

Similarly, a geochemical survey using the same grid system with the average number of collected samples per claim being not less than 40 samples, and meeting the requirements for the submission of geochemical surveys for maximum credits, will qualify for an assessment work credit of 20 days. If line cutting has not previously been reported with any other survey and is reported in conjunction with the geochemical survey a credit of 40 days per claim will be allowed for the survey.

Credits for partial coverage or for surveys not meeting requirements for full credit will be granted on a pro-rata basis.

If the credits are reduced for any reason, a fifteen day Notice of Intent will be issued. During this period, the applicant may apply to the Mining Commissioner for relief if his claims are jeopardized for lack of work or, if he wishes, may file with the Department, normal assessment work breakdowns listing the names of the employees and the dates of work. The survey would then be re-assessed to determine if higher credits may be allowed under the provisions of subsections 8 and 9 of section 84 of the Mining Act.

If new breakdowns are not submitted, the Performance and Coverage credits are confirmed to the Mining Recorder at the end of the fifteen days.

BYERS PROPERTY

299041	299042	299056	299056	299068	299069
299040	299043	299054	299057	299067	299070
299039	299044	299053	299058	299066	299071
299038	299045	299052	299059	299065	299072
299037	299046	299051	299060	299064	299073
299036	299047	299050	299061	299063	
299035	299048	299049	299062		

GREVAIS

HOLLINGER

NORANDA

BYERS TWP.
LOVELAND TWP.

Lovegood
Creek

Lovegood
Lake

N

INDEX MAP
Scale: 1" = 1/16 MILES

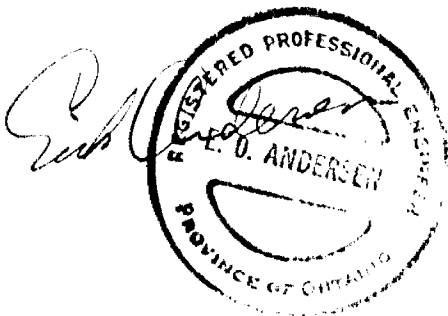
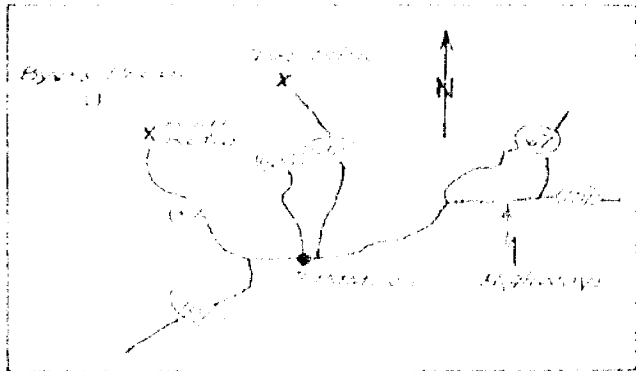

BYERS PROPERTY
ONTARIO
CLAIM MAP

Scale: 1" = 1/2 Mile Date OCT. 7/1970 Plate: 1

205.M

BYERS TWP

205.M

2.617

BYERS TWP

205.M

Moberly Twp. (M.550)

THE TOWNSHIP OF

BYERS
Belaim Map
DISTRICT OF COCHRANE

PORCUPINE MINING DIVISION

SCALE: 1-INCH = 40 CHAINS

LEGEND

- PATENTED LAND Ⓟ
- CROWN LAND SALE C.S.
- LEASES Ⓛ
- LOCATED LAND Loc.
- LICENSE OF OCCUPATION L.O.
- MINING RIGHTS ONLY M.R.O.
- SURFACE RIGHTS ONLY S.R.O.
- ROADS —
- IMPROVED ROADS —
- KING'S HIGHWAYS —
- RAILWAYS —
- POWER LINES —
- MARSH OR MUSKEG —
- MINES *
- CANCELLED C

NOTES

400' Surface Rights Reservation around all lakes and rivers.

DATE OF ISSUE
OCT 1 1971
ONT. DEPT. OF MINES
AND NORTHERN AFFAIRS

PLAN NO. **M-265**

**ONTARIO
DEPARTMENT OF MINES
AND NORTHERN AFFAIRS**

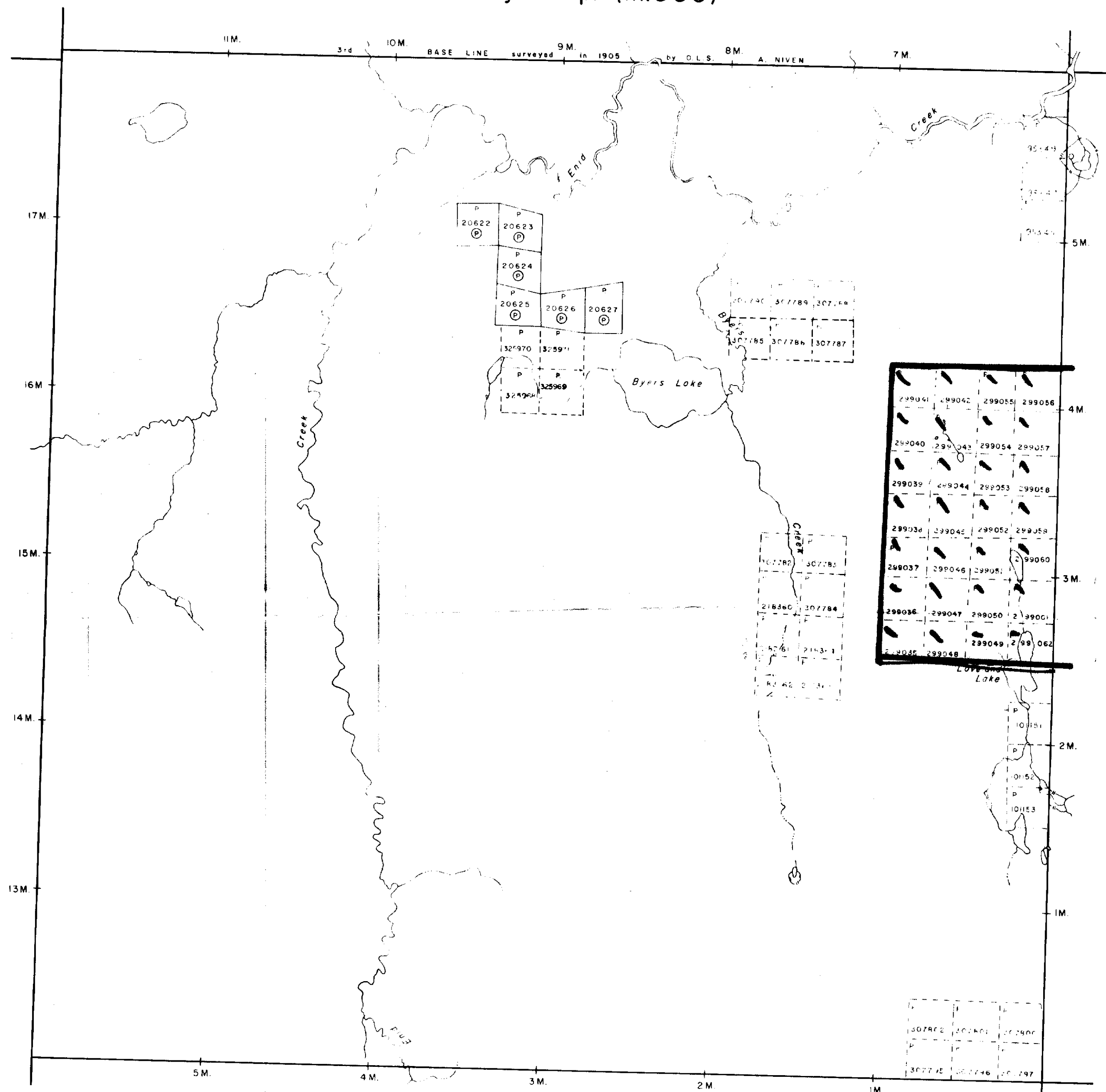

Loveland Twp. (M.293)

Fortune Twp. (M.813)

Côté Twp. (M.271)



200

K. Kolomov

Thorburn Twp. (M.60I)

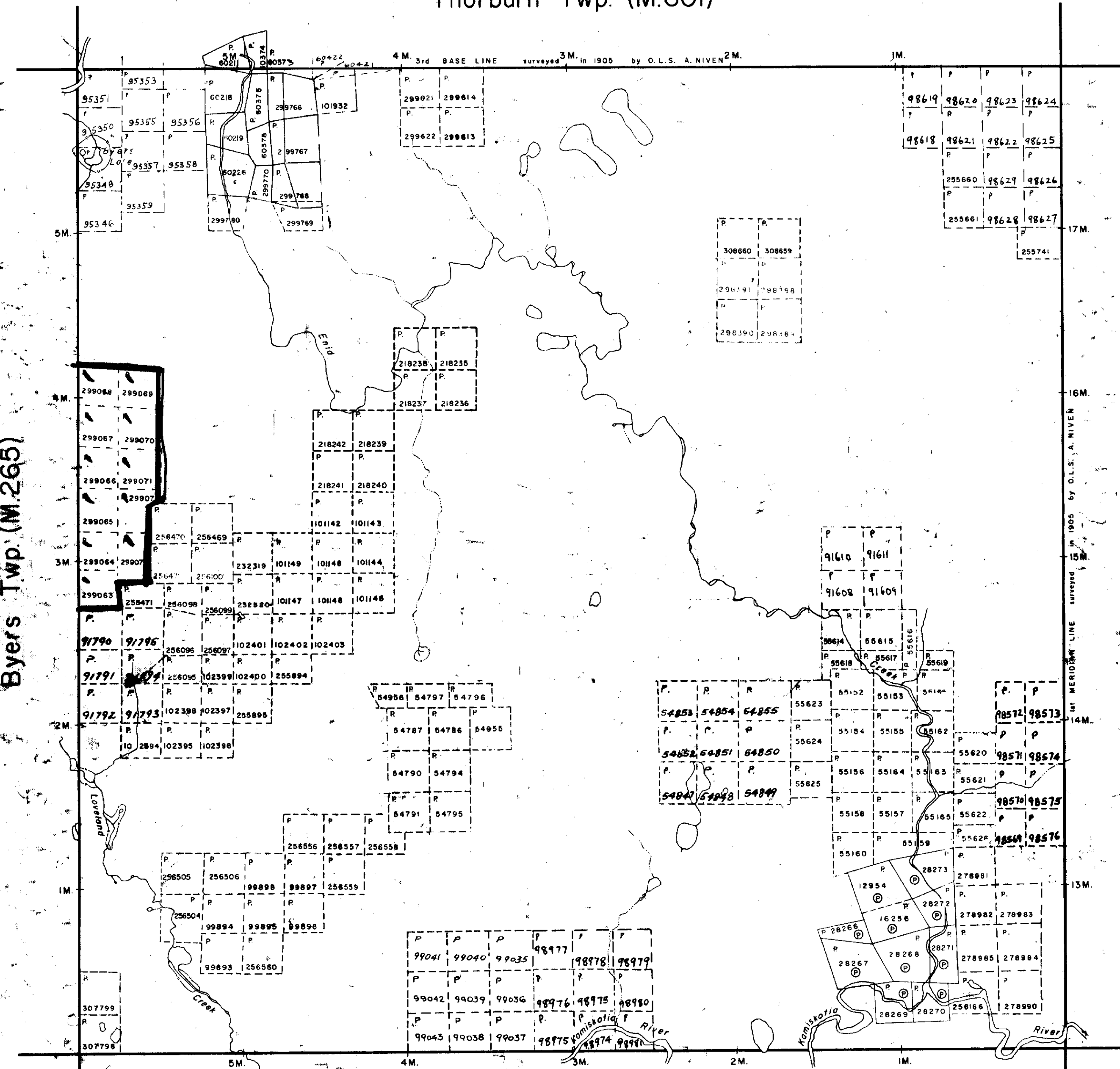

THE TOWNSHIP OF
LOVELAND
Claim map
DISTRICT OF COCHRANE

PORCUPINE
MINING DIVISION

SCALE: 1-INCH = 40 CHAINS

LEGEND

- PATENTED LAND Ⓟ
- CROWN LAND SALE C.S.
- LEASES Ⓞ
- LOCATED LAND Loc
- LICENSE OF OCCUPATION L.O.
- MINING RIGHTS ONLY M.R.O.
- SURFACE RIGHTS ONLY S.R.O.
- ROADS [Symbol]
- IMPROVED ROADS [Symbol]
- KING'S HIGHWAYS [Symbol]
- RAILWAYS [Symbol]
- POWER LINES [Symbol]
- MARSH OR MUSKEG [Symbol]
- MINES [Symbol]
- CANCELLED [Symbol]

NOTES

400' Surface Rights Reservation around all lakes and rivers.

DATE OF ISSUE
OCT 1 1971
ONT. DEPT. OF MINES
AND NORTHERN AFFAIRS

PLAN NO. M-293

ONTARIO
DEPARTMENT OF MINES
AND NORTHERN AFFAIRS



Robb Twp. (M.309)

2.617

FOAELVND TWP

CES.M

BYERS TWP ← | → LOVELAND TWP.

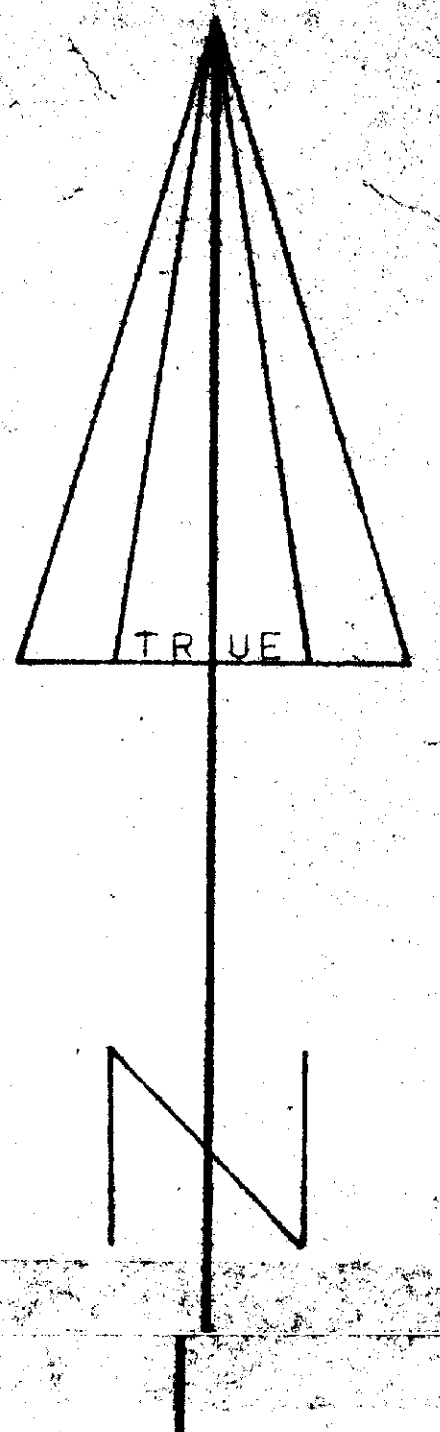
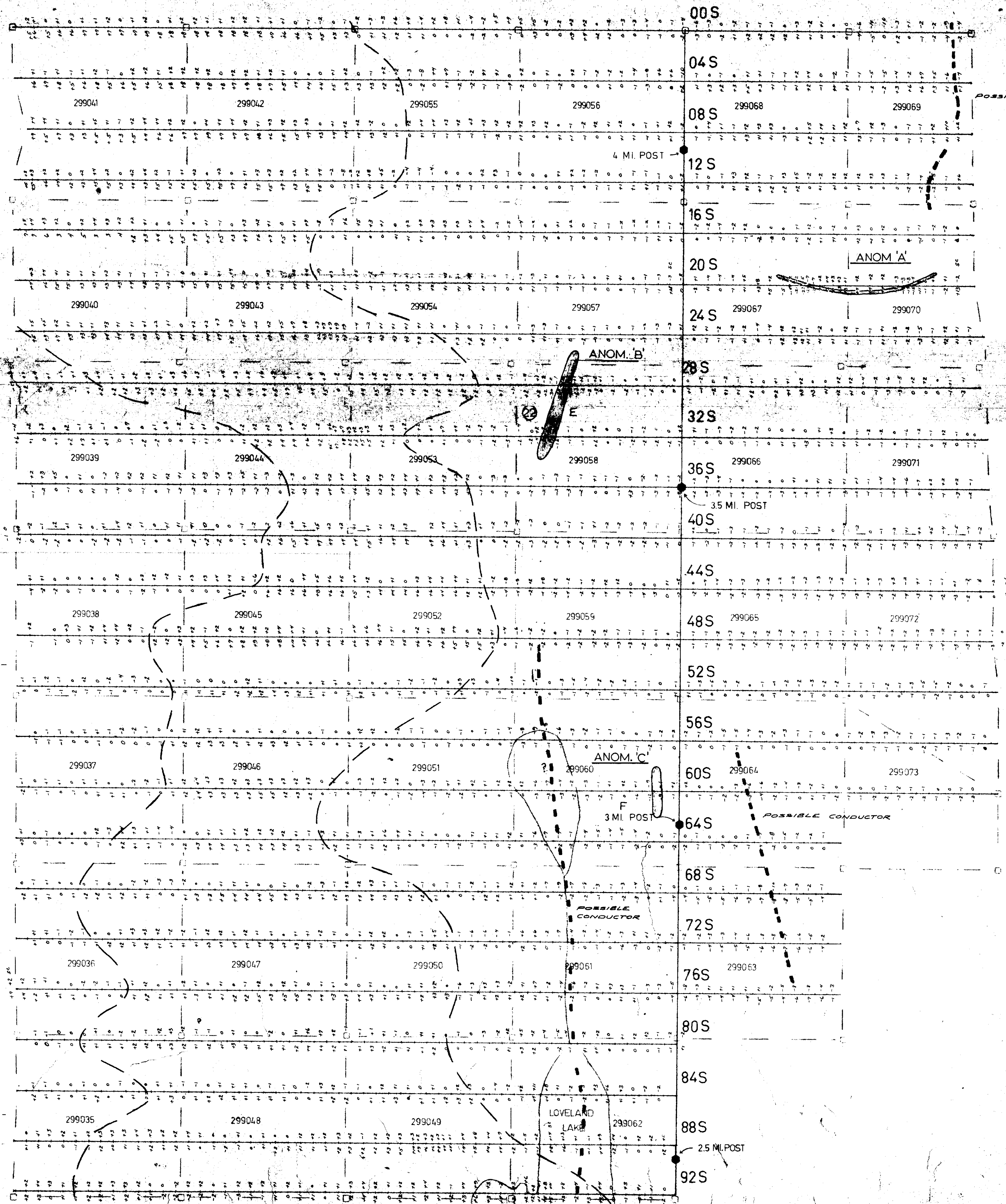

LEGEND

INSTRUMENT: SE-600 HORIZONTAL LOOP
 FREQUENCY: 1800 cps
 COIL SPACING: 300 feet
 IN PHASE READINGS ON THE LEFT
 OUT OF PHASE READINGS ON THE RIGHT

INSTRUMENT: ABEM HORIZONTAL LOOP
 FREQUENCY: 3520 cps
 COIL SPACING: 200 feet
 IN PHASE READINGS ON THE LEFT
 OUT OF PHASE READINGS ON THE RIGHT

CONDUCTORS:
 NO INDICATED WIDTH
 WIDTH INDICATED
 LOCATION UNCERTAIN
 POSSIBLE - CONDUCTOR
 CONDUCTIVITY:
 EXCELLENT
 GOOD
 FAIR
 POOR
 INDICATED CONDUCTOR DEPTH IN FEET
 MARSHY AREA: LARGE, SMALL, ...



Drawn by: R. E. B.	Traced by:	HORIZONTAL LOOP BYERS PROPERTY
Revised by: []	Revised by: []	
Scale: 1" = 400'		Date: Jan 4 / 99

ABEM
 SE 600
 220
 ABEM

