



DATE: 06/06/1994

DRILL HOLE RECORD

HOLE NUMBER: J41-08

FROM TO	ROCK TYPE	TEXTURE AND STRUCTURE	ANGLE TO CA	ALTERATION	MINERALIZATION	REMARKS
0.00 TO 15.50	OVERBURDEN *obj*	-cored from 15.2-15.5m through an intermediate intrusive boulder				
15.50 TO 47.55	FELSIC ASH TUFF, FELSIC AND MAFIC FLOWS *t,l, 2,p,e,z*	-dark green-blue coloured, aphanitic unit -intercalated with mafic volcanics -felsics are very siliceous and hard -bedding is at 45° to CA -occasional pillow selvage within the mafics -massive felsic sections are generally the flow components of this sequence -ashy beds are often slumped such that they look like flow banding eg. 30.0m -mafic volcanic intercalations occur from: 18.3-20.0m, 31.8-32.1, 32.31-32.75m, 38.7-38.8m, 39.35-39.7m, 40.15-41.4m, 44.7-44.85, 45.85-45.95m, 46.1-47.1m. -felsic ash tuff sections occur from 20.0-30.5m, 32.75-33.65m, 47.1-47.55m -felsic flows occur in the remaining intervals		-pervasive silicification is moderate throughout the felsics -pervasive chlorite alteration and bleaching is weak in the mafics *15.5-47.55*Si*	-bedded pyrite in fine laminations is up to 0.2% abundant in the felsic ash units, ie. at 37.0m	
47.55 TO 88.80	MAFIC VOLCANICS *2,m,e*	-dark green coloured, fine to medium grained unit -intercalated felsic blocks occur from 45.95-46.1m, 48.0-48.1m -amygdules are slightly elongated and are carbonate filled -massive to weakly in situ brecciated -the unit looks intrusive for the most part -the unit takes on a pale buff coloured mottled appearance		-pervasive and fracture controlled carbonate alteration is moderate to strong throughout the unit -the buff coloured ophitic textured fabric is likely siderite in the matrix *47.55-88.8*Cb*	-nil to occasional minor, minute, disseminated pyrite cubes	
88.80 TO 148.90	FELSIC VOLCANIC *t,l, 2,p,e,z*	-grey-green coloured, fine grained unit -sharp contacts -intruded by mafic dykes from 92.3-98.25m, 100.45-100.55m, 104.1-104.45m, 111.5-113.0m -a small fault zone occurs from 111.5-112.0m with very strong fracture controlled carbonate alteration -The felsic appears to be strongly amygdaloidal or spherulitic. The amygdules, quartz and carbonate filled, almost coalesce. -the unit gradational changes into a tuff or a sheared, flow banded rhyolite		-pervasive carbonatization and fracture controlled silicification is moderate -fracture controlled and pervasive silicification is moderate	-minor fracture controlled pyrrhotite occurs throughout the unit -occasional chlorite veinlets contains minor pyrite or pyrrhotite	

HOLE NUMBER: J41-08

DRILL HOLE RECORD

LOGGED BY: P. ROOS

HOLE NUMBER: J41-08

DRILL HOLE RECORD

DATE: 06/06/1994

FROM TO	ROCK TYPE	TEXTURE AND STRUCTURE	ANGLE TO CA	ALTERATION	MINERALIZATION	REMARKS
148.90 TO 270.00	MASSIVE MAFIC INTRUSIVE OR VOLCANICS «7m.2m»	<p>-the tuffaceous sections contain angular, lapilli and rounded ash sized fragments while at the same time coexisting with amygdules</p> <p>-grey-green coloured, fine to medium grained unit</p> <p>-fine leucoxenes occur in some sections of the unit</p> <p>-from 150.0-170.0m the unit is medium and definitely ophitic textured</p> <p>-amygdules were not observed in the unit</p> <p>-Occasional assimilated felsic blocks occur within the unit. The felsics could however be thin dykes where altered margins occur on the contacts.</p> <p>-felsics occur from: 171.25-171.7m, 173.7-173.85m, 185.6-187.6m, 188.2-188.4m</p> <p>-foliation is at 60° to CA</p> <p>-the unit looks more flow-like downhole of 178.1m where a thin fault slip occurs</p> <p>-Downhole of 206.4-209.1m, the unit takes on a silicified flow top appearance. This could be a contaminated section where felsic dyke material is mixing with the mafic dyke. A felsic dyke occurs from 208.7-209.1m.</p> <p>-diabase dyke occurs from 234.4-234.75m and 237.6-247.15m and clots from 248.9-249.2m</p>		<p>-fracture controlled epidote-carbonate-quartz alteration is moderate</p>		<p>-epidote alteration is overprinted (metamorphic) due to nearby intrusive heat source</p>
270.00 TO 270.00	E.O.H.			<p>-gash chlorite veining is prominent uphole of 178.1m</p> <p>-epidote alteration is weaker from 208.0-219.0m</p> <p>-epidote alteration is moderate again downhole of 219.0m</p>	<p>-nil to minor disseminated pyrite cubes</p>	<p>-slightly magnetic from 216.7 to the end of hole</p> <p>-strongly magnetic where diabase dykes intrude the massive mafic</p>

HOLE NUMBER: J41-08

DRILL HOLE RECORD

LOGGED BY: P. ROOS

PAGE: 3

HOLE NUMBER : J41-08

ASSAYS SHEET

DATE: 06/06/1994

Sample	From (M)	To (M)	Lehg. (M)	Cu ppm	Zn ppm	Au ppb	Ag ppm	Pb ppm	Co ppm	Cu/Zn ppm	Ni ppm	Pt ppb	Pd ppb
AP04873	35.70	37.00	1.30										
AP04874	37.00	38.45	1.45										
AP04875	38.45	40.00	1.55										
AP04876	40.00	41.45	1.45										
AP04877	41.45	43.00	1.55										
AP04878	43.00	44.50	1.50										
AP04879	44.50	46.00	1.50										
AP04880	46.00	47.55	1.55										
AP04881	47.55	49.00	1.45										

HOLE NUMBER : J41-08

ASSAYS SHEET

PAGE: 4

DATE: 06/06/1994

GEOCHEMICAL ASSAY

HOLE NUMBER : J41-08

Sample	From (M)	To (M)	Leng. (M)	SI02	AL2O3	CAO	MGO	NA2O	K2O	FE2O3	TIO2	P2O5	MNO	CR2O3	LOI	SUM	Y	ZR	BA	RB	SR	NB	CU	ZN	NI	CR	FIELD	CHEM	ALUM
				PPM	PPM	PPM	PPM	PPM	PPM	PPM	PPM	PPM	PPM	PPM	PPM	PPM	PPM	PPM	PPM	PPM	PPM	PPM	PPM	PPM	PPM	PPM	PPM	PPM	PPM
AP04790	20.00	23.00	3.00																										
AP04791	36.00	38.70	2.70																										
AP04792	49.00	52.00	3.00																										
AP04793	81.00	84.00	3.00																										
AP04794	121.00	124.00	3.00																										
AP04795	151.00	154.00	3.00																										
AP04796	178.50	181.50	3.00																										
AP04797	221.30	224.30	3.00																										
AP04798	264.00	267.00	3.00																										

HOLE NUMBER: J41-08

GEOCHEMICAL ASSAY

GEOCHEMICAL ASSAYS

HOLE NUMBER : J41-08

Sample	From (M)	To (M)	Leng. (M)	AC PPM	AU PPM	CO PPM	PB PPM	S PPM	V PPM	AS PPM	SN PPM	CD PPM	SB PPM	BI PPM	SE PPM	HF PPM	TA PPM	W PPM	MO PPM	TH PPM	U PPM	B PPM	CS PPM	LA PPM	CE PPM	ND PPM	SM PPM	EU PPM	GD PPM		
AP04790	20.00	23.00	3.00																												
AP04791	36.00	38.70	2.70																												
AP04792	49.00	52.00	3.00																												
AP04793	81.00	84.00	3.00																												
AP04794	121.00	124.00	3.00																												
AP04795	151.00	154.00	3.00																												
AP04796	178.50	181.50	3.00																												
AP04797	221.30	224.30	3.00																												
AP04798	264.00	267.00	3.00																												

GEOCHEMICAL ASSAYS

HOLE NUMBER : J41-08

# LEGEND

## Geology

### MAJOR ROCK DIVISIONS

12	gneiss	Quartzfeldspathic	<QFP>
11	Schist	Quartz	<QTZ>
10	Dabase	Marble	<MAR>
9	Felsic Intrusive Rocks	Skarn (Calc-Silicate)	<SKA>
8	Intermediate Intrusive Rocks	Phyllite	<PHY>
7	Mafic Intrusive Rocks	Tonalite	<TON>
6	Ultramafic Intrusive Rocks	Syenite	<SYN>
5	Sedimentary Rocks	Granite	<GRA>
4	Felsic Volcanic Rocks	Monzonite	<MON>
3	Intermediate Volcanic Rocks	Granodiorite	<GRD>
2	Mafic Volcanic Rocks	Andesite	<AND>
1	Ultramafic Volcanic Rocks	Basalt	<BAS>

### TEXTURAL/GEOCHEMICAL MODIFIERS

a	Fine Grained	Primitive (<20)	<A>
b	Medium Grained	Evolved (>20<60)	<B>
c	Coarse Grained	Heterolithic	<C>
d	Quartz-Feldspar Phric	Feldspar Phric	<D>
e	Amygdales/Vesicular	Wacke	<E>
f	Graphitic/Argillaceous	Leucoxene Bearing	<F>
g	Toleritic	Basaltic Komatiite	<G>
h	Alkalic	Pyroxenite	<H>
i	Calc-Alkalic	Net Textured	<I>
j	Komatitic	Peridotite	<J>
k	Flows	Ophitic	<K>
l	Massive	Porphyritic	<L>
m	Varolitic/Spherulitic	Polytured	<M>
n	Pillowed	Fractured	<N>
o	Quartz Phric	Gabbroic Textured	<O>
p	Oxide Iron Formation	Gabbroic Textured	<P>
q	Sulphides, Exhalites	Pyroxene Spinifex	<Q>
r	Pyroclastic	Olivine Spinifex	<R>
s	High Mg	Skeletal/Crescumulate	<S>
t	High Fe	Adcumulate	<T>
u	High Al	Mesocumulate	<U>
v	Andesite	Orthocumulate	<V>
w	Andesite		<W>
x	Andesite		<X>
y	Andesite		<Y>
z	Highly Evolved (>60)		<Z>

### ALTERATION MODIFIERS

<AB>	Abtization
<BI>	Bleached
<CB>	Carbonaceous
<CC>	Carbonatization
<CH>	Chloritization
<CI>	Epoxidation
<HE>	Hematization
<KS>	Potassic Alteration
<NS>	Sericitization
<SI>	Sulfidation
<SR>	Serpentinization
<TC>	Talc-Carbonatized

### TEXTURAL/STRUCTURAL MODIFIERS

a	Tuff (67% < 2mm)
b	Lapilli (2-64mm)
c	Lapillstone (75% < 264mm)
d	Block (> 64mm)
e	Autoclastic
f	Thickly Laminated
g	Thinly Laminated
h	Clast Supported
i	Matrix Supported
j	Granule (grit, 2-4mm)
k	Pebble (4-64mm)
l	Cobble (64-256mm)
m	Boulder (> 256mm)
n	Graded Bedding
o	Cross Bedding
p	Fault Gouge
q	Augean
r	Porphyroblastic
s	Hornfels
t	foliated/sheared
u	folded
v	boudinage
w	fragmental (felsic > mafic)
x	fragmental (mafic > felsic)
y	Coastal Tuff (> 50% of frags)
z	Lithic Tuff (> 50% of frags)

### MINERALOGICAL NAMES

Fc	Fuchsite
Gn	Galenite
Gr	Garnet
Vg	Gold
Gs	Graphite
Gt	Gravel & Sand
Gyp	Gypsum
Hem	Hematite
Hb	Hornblende
Hy	Hypersthene
I-F	Iron Formation
Jr	Jarosite
Ky	Kyanite
Lm	Limestone
Ma	Magnetite
Mag	Margarite
Mi	Mica
Mk	Microcline
Mo	Molybdenite
Mu	Muscovite
Ni	Nickel
Ni	Nickel Minerals
Ov	Olivine
Or	Orthoclase
Opx	Orthopyroxene
Pg	Plagioclase
Pn	Pentlandite
Py	Pyrite
Px	Pyroxene
Po	Pyrrhotite
Qtz	Quartz
Rh	Rhodochrosite
Ru	Rutile
Sur	Serpentine
Sc	Sericite
Sh	Scheelite
Sid	Siderite
Sil	Silica
Sim	Silliminite
Sps	Spessartite
Sph	Sphalerite
Tt	Titanite (Titanite)
Ag	Silver
Sp	Spinel
Spd	Spodumene
St	Staurolite
Sb	Sulphur
Sul	Sulphides
S-M	Mass. Sulphides
S-D	Dist. Sulphides
Tk	Talc
Ta-Ci	Tantalite-Columbite
Tt	Tourmaline
Tr	Tremolite
Wo	Wollastonite
Zr	Zircon

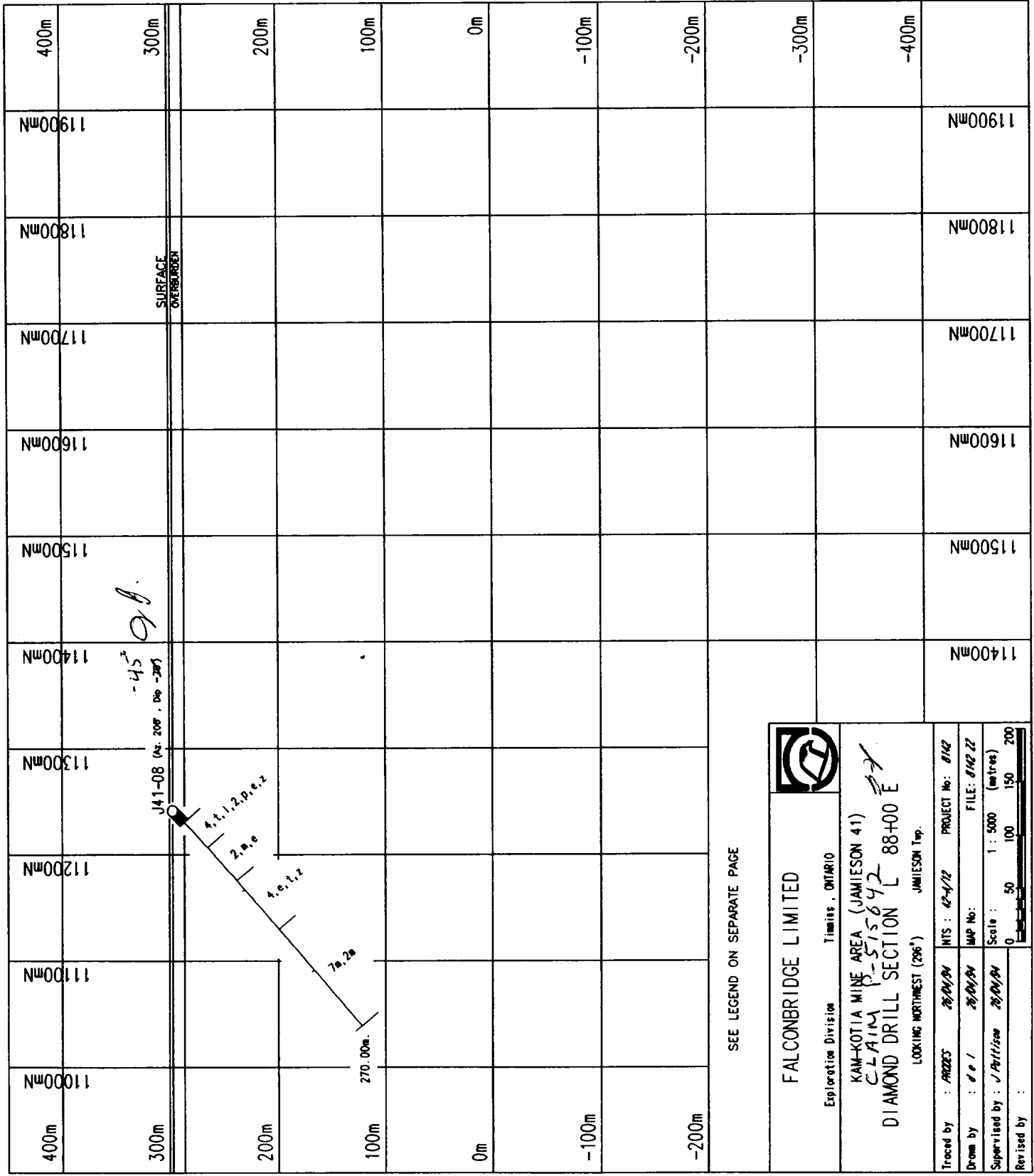

SEE LEGEND ON SEPARATE PAGE

	
<b>FALCONBRIDGE LIMITED</b>	
Exploration Division	Timmins, ONTARIO
KAM-KOTIA MINE AREA (JAMIESON 41) CLAIM P-515642 DIAMOND DRILL SECTION L 88+00 E	
LOOKING NORTHWEST (296°) JAMIESON Twp.	
Traced by : ARZES	NTS : 28/01/94
Drawn by : D e I	PROJECT No : 8142
Supervised by : J.Pettison	MAP No : FILE : 8142 Z1
Revised by :	Scale : 1 : 5000 (metres)
	0 50 100 150 200



# Report of Work Conducted After Recording Claim

Mining Act

Transaction Number *AFR*  
**W9460.00142**

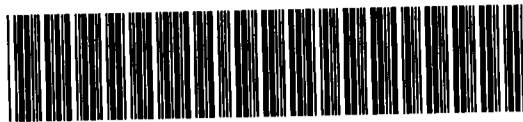

900

Personal Information collected on this form is obtained under the authority of the Act. This collection should be directed to the Provincial Manager, Mining Lands, Mir Sudbury, Ontario, P3E 6A5, telephone (705) 670-7264.

- Instructions:**
- Please type or print and submit in duplicate.
  - Refer to the Mining Act and Regulations for requirements of filing assessment work or consult the Mining Recorder.
  - A separate copy of this form must be completed for each Work Group.
  - Technical reports and maps must accompany this form in duplicate.
  - A sketch, showing the claims the work is assigned to, must accompany this form.

Recorded Holder(s) <b>FALCONBRIDGE LIMITED</b>		Client No. <b>130679</b>
Address <b>P.O. Box 1140, 571 Maneta Ave. Timmins, Ontario P4N 7H9</b>		Telephone No. <b>(705) 267-1188</b>
Mining Division <b>Porcupine</b>	Township/Area <b>Jamieson, Robb and Loveland Twp</b>	M or G Plan No. <b>G-3986, 3968, M-293</b>
Date Work Performed	From: <b>February 11, 1994</b>	To: <b>February 16, 1994</b>

**Work Performed (Check One Work Group Only)**

Work Group	Type
<input type="checkbox"/> Geotechnical Survey	
<input checked="" type="checkbox"/> Physical Work, Including Drilling	<b>Diamond Drilling (1 hole, 270m)</b>
<input type="checkbox"/> Rehabilitation	
<input type="checkbox"/> Other Authorized Work	
<input type="checkbox"/> Assays	
<input type="checkbox"/> Assignment from Reserve	

Total Assessment Work Claimed on the Attached Statement of Costs \$ **11,383.00**

**Note:** The Minister may reject for assessment work credit all or part of the assessment work submitted if the recorded holder cannot verify expenditures claimed in the statement of costs within 30 days of a request for verification.

**Persons and Survey Company Who Performed the Work (Give Name and Address of Author of Report)**

Name	Address
<b>Dominik Drilling</b>	<b>409 King St., Timmins, Ont.</b>

**RECORDED**  
**JUN 08 1994**  
 Receipt \_\_\_\_\_

(attach a schedule if necessary)

**Certification of Beneficial Interest \* See Note No. 1 on reverse side**

I certify that at the time the work was performed, the claims covered in this work report were recorded in the current holder's name or held under a beneficial interest by the current recorded holder.	Date <b>June 7, 1994</b>	Recorded Holder or Agent (Signature) <i>[Signature]</i> (John Pattison)
--	-----------------------------	--

**Certification of Work Report**

I certify that I have a personal knowledge of the facts set forth in this Work report, having performed the work or witnessed same during and/or after its completion and annexed report is true.

Name and Address of Person Certifying <b>John Pattison P.O. Box 1140, 571 Maneta Ave. Timmins Ont. P4N 7H9</b>		
Telephone No. <b>(705) 267-1188</b>	Date <b>June 7, 1994</b>	Certified By (Signature) <i>[Signature]</i> (John Pattison)

**For Office Use Only**

Total Value Cr. Recorded <b>\$11,383.</b>	Date Recorded <b>JUNE 8, 1994</b>	Mining Recorder <i>[Signature]</i>
	Deemed Approval Date <b>SEPT. 6, 1994</b>	Date Approved <b>SEPT. 2, 1994</b>
	Date Notice for Amendments Sent	

**RECEIVED**

**JUN 8 1994**

**PORCUPINE MINING DIVISION**



Statement of Costs for Assessment Credit

État des coûts aux fins du crédit d'évaluation

Mining Act/Loi sur les mines

Transaction No./N° de transaction  
**W9460.00142**

Personal information collected on this form is obtained under the authority of the Mining Act. This information will be used to maintain a record and ongoing status of the mining claim(s). Questions about this collection should be directed to the Provincial Manager, Minings Lands, Ministry of Northern Development and Mines, 4th Floor, 159 Cedar Street, Sudbury, Ontario P3E 6A5, telephone (705) 670-7264.

Les renseignements personnels contenus dans la présente formule sont recueillis en vertu de la Loi sur les mines et serviront à tenir à jour un registre des concessions minières. Adresser toute question sur la collecte de ces renseignements au chef provincial des terrains miniers, ministère du Développement du Nord et des Mines, 159, rue Cedar, 4<sup>e</sup> étage, Sudbury (Ontario) P3E 6A5, téléphone (705) 670-7264.

1. Direct Costs/Coûts directs

Type	Description	Amount Montant	Totals Total global
Wages Salaires	Labour Main-d'oeuvre	<del>1,400</del>	
	Field Supervision Supervision sur le terrain	1,400	
Contractor's and Consultant's Fees Droits de l'entrepreneur et de l'expert-conseil	Type Drilling	39,833	
Supplies Used Fournitures utilisées	Type		
Equipment Rental Location de matériel	Type		
<b>Total Direct Costs Total des coûts directs</b>			<b>41,233</b>

**RECEIVED**  
 JUN 8 1994  
 PORCUPINE MINING DIVISION

*Q.P.*

2. Indirect Costs/Coûts indirects

\*\* Note: When claiming Rehabilitation work Indirect costs are not allowable as assessment work. Pour le remboursement des travaux de réhabilitation, les coûts indirects ne sont pas admissibles en tant que travaux d'évaluation.

Type	Description	Amount Montant	Totals Total global
Transportation Transport	Type Truck Gas	150.0	
Food and Lodging Nourriture et hébergement			
Mobilization and Demobilization Mobilisation et démoblisation			
<b>Sub Total of Indirect Costs Total partiel des coûts indirects</b>			<b>150.0</b>
<b>Amount Allowable (not greater than 20% of Direct Costs) Montant admissible (n'excédant pas 20 % des coûts directs)</b>			<b>29,716.6</b>
<b>Total Value of Assessment Credit (Total of Direct and Allowable indirect costs) Valeur totale du crédit d'évaluation (Total des coûts directs et Indirects admissibles)</b>			<b>41,233</b>

Note: The recorded holder will be required to verify expenditures claimed in this statement of costs within 30 days of a request for verification. If verification is not made, the Minister may reject for assessment work all or part of the assessment work submitted.

Note : Le titulaire enregistré sera tenu de vérifier les dépenses demandées dans le présent état des coûts dans les 30 jours suivant une demande à cet effet. Si la vérification n'est pas effectuée, le ministre peut rejeter tout ou une partie des travaux d'évaluation présentés.

Filing Discounts

- Work filed within two years of completion is claimed at 100% of the above Total Value of Assessment Credit.
- Work filed three, four or five years after completion is claimed at 50% of the above Total Value of Assessment Credit. See calculations below:

Total Value of Assessment Credit	Total Assessment Claimed
× 0.50 =	

Remises pour dépôt

- Les travaux déposés dans les deux ans suivant leur achèvement sont remboursés à 100 % de la valeur totale susmentionnée du crédit d'évaluation.
- Les travaux déposés trois, quatre ou cinq ans après leur achèvement sont remboursés à 50 % de la valeur totale du crédit d'évaluation susmentionné. Voir les calculs ci-dessous.

Valeur totale du crédit d'évaluation	Évaluation totale demandée
× 0,50 =	

Certification Verifying Statement of Costs

I hereby certify: that the amounts shown are as accurate as possible and these costs were incurred while conducting assessment work on the lands shown on the accompanying Report of Work form.

that as Project Geologist I am authorized (Recorded Holder, Agent, Position in Company)

to make this certification

Attestation de l'état des coûts

J'atteste par la présente : que les montants indiqués sont le plus exact possible et que ces dépenses ont été engagées pour effectuer les travaux d'évaluation sur les terrains indiqués dans la formule de rapport de travail ci-joint.

Et qu'à titre de \_\_\_\_\_ je suis autorisé (titulaire enregistré, représentant, poste occupé dans la compagnie)

à faire cette attestation.

Signature <i>[Signature]</i> (John Paterson)	Date June 8, 1994
---	----------------------

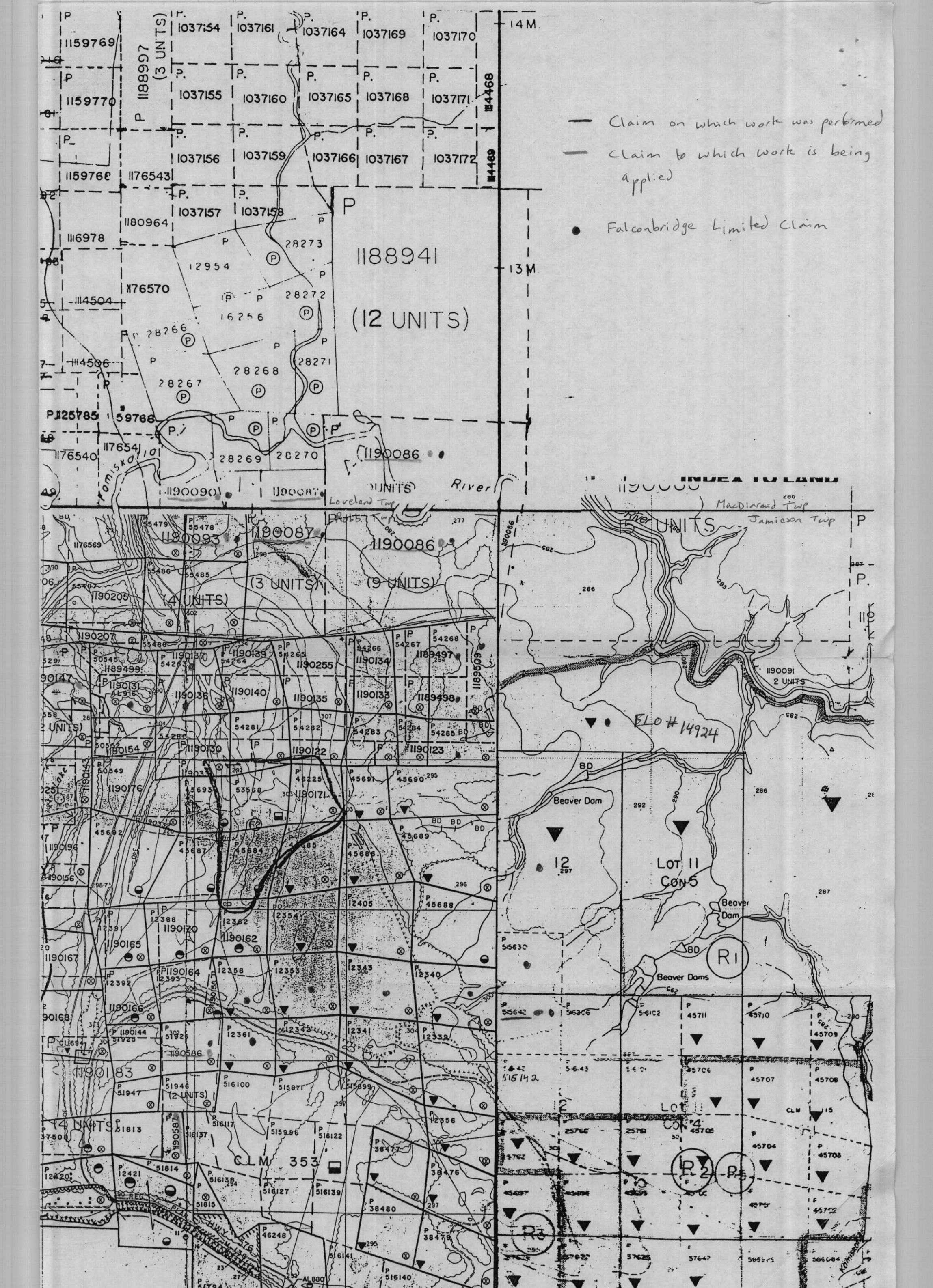

Thorburn Twp. (M.60I)

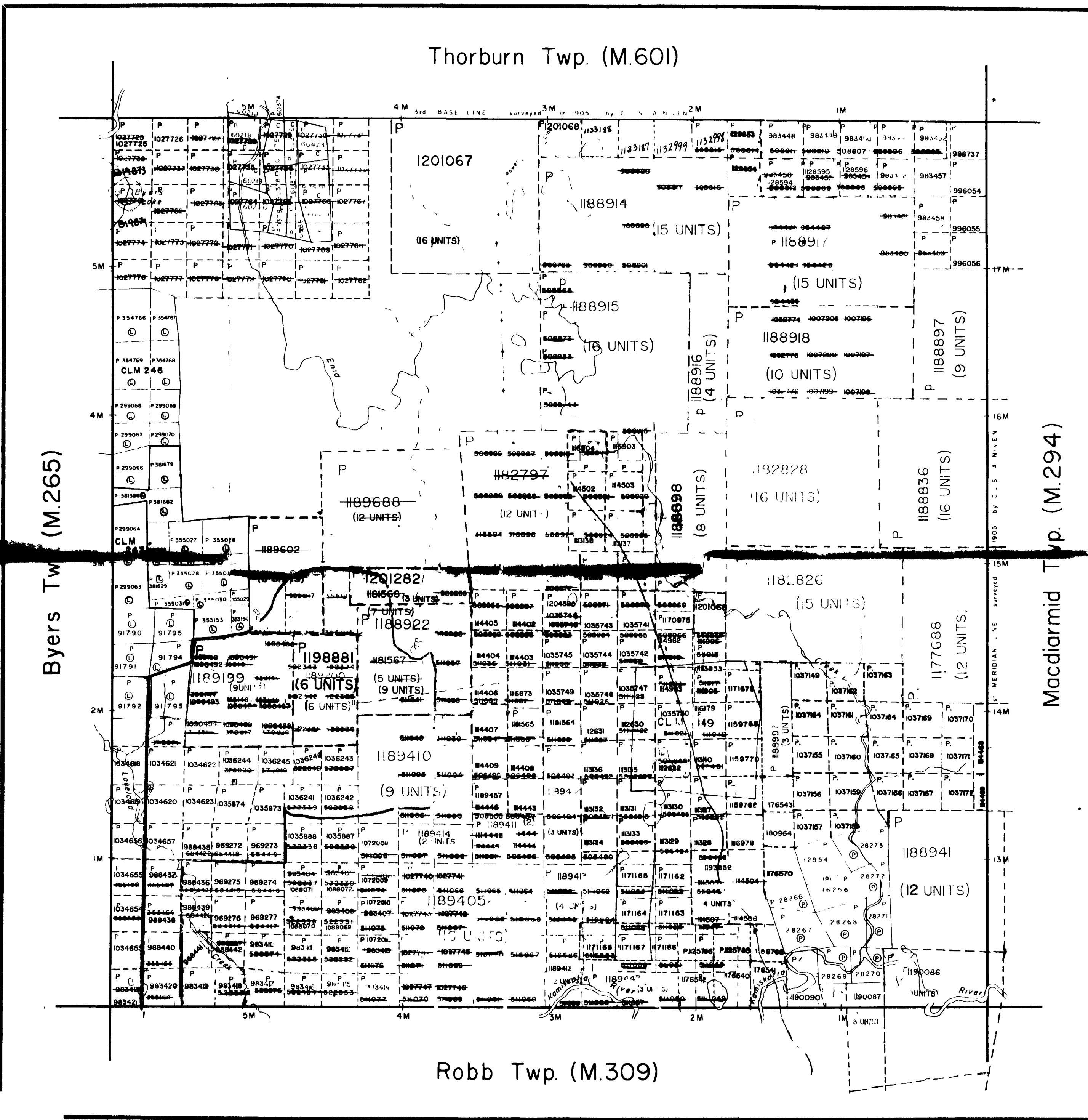

THE TOWNSHIP OF  
LOVELAND

DISTRICT OF COCHRANE  
PORCUPINE MINING DIVISION

SCALE: 1-INCH 40 CHAINS

LEGEND

- PATENTED LAND (P)
- CROWN LAND SALE (C.S.)
- LEASES (L)
- LOCATED LAND (L.C.)
- LICENSE OF OCCUPATION (L.O.)
- MINING RIGHTS ONLY (M.R.O.)
- SURFACE RIGHTS ONLY (S.R.O.)
- ROADS
- IMPROVED ROADS
- KING'S HIGHWAYS
- RAILWAYS
- POWER LINES
- MARSH OR MUSKEG
- MINES

NOTES

400' Surface Rights Reservation along the shores of all lakes and rivers

This township lies within the Municipality of CITY of TIMMINS.

ROAD

THIS TWP IS SUBJECT TO FORESTRY ACTIVITY IN 1994/95. FURTHER INFO AVAILABLE ON FILE

Rec'd Feb 17/83  
PLAN NO M-293

ONTARIO  
MINISTRY OF NATURAL RESOURCES  
SURVEYS AND MAPPING BRANCH

Robb Twp. (M.309)



LOVELAND TWP

LOVELAND TWP

503 N

503 N

**INDEX TO LAND DISPOSITION**

PLAN  
**G-3968**  
 TOWNSHIP  
**ROBB**

M.N.R. ADMINISTRATIVE DISTRICT  
**TIMMINS**  
 MINING DIVISION  
**PORCUPINE**  
 LAND TITLES/REGISTRY DIVISION  
**COCHRANE**

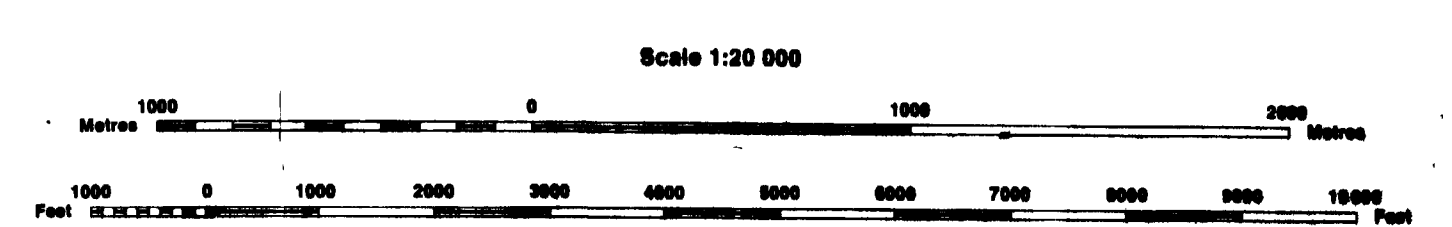

**SYMBOLS**

Description	Order No.	Date	Prepared By	File
Boundary				
Township, Meridian, Baseline				
Road allowance; surveyed				
shoreline				
Lot/Concession; surveyed				
unsurveyed				
Parcel; surveyed				
unsurveyed				
Right-of-way; road				
railway				
utility				
Reservation				
Cliff, Pit, Pile				
Contour				
Interpolated				
Control point (horizontal)				
Flooded land				
Mine head frame				
Pipeline (above ground)				
Railway; single track				
double track				
abandoned				
Road; highway, county, township				
access				
trail, bush				
Shoreline (original)				
Transmission line				
Wooded area				
PLANS OF SUBDIVISION - NOT OPEN FOR STAKING				
PROPOSED SURFACE RIGHTS DISPOSITION UNDER THE P.L.A. - NOTICE RECEIVED MARCH 7, 1991				
THIS TWP IS SUBJECT TO FOREST ACTIVITY IN 1991 FOR FURTHER INFORMATION ON FILE.				
MINING RIGHTS RE-OFFERED BY THE MINING ACT, R.S.O. 1990, CHAPTER 247, SECTION 24(1) AND 24(2) ON 07-27-90 BY T.M.P.				
MINING RIGHTS RE-OFFERED BY THE MINING ACT, R.S.O. 1990, CHAPTER 247, SECTION 24(1) AND 24(2) ON 07-27-90 BY T.M.P.				

**DISPOSITION OF CROWN LANDS**

Patent	
Surface & Mining Rights	●
Surface Rights Only	○
Mining Rights Only	◐
Lease	
Surface & Mining Rights	■
Surface Rights Only	□
Mining Rights Only	◑
Licence of Occupation	○
Order-in-Council	OC
Cancelled	○
Reservation	○
Sand & Gravel	○

6 1994

THE INFORMATION THAT APPEARS ON THIS MAP HAS BEEN COMPILED FROM VARIOUS SOURCES AND ACCURACY IS NOT GUARANTEED. THOSE WISHING TO STAKE MINING CLAIMS SHOULD CONSULT WITH THE MINING RECORDER, MINISTRY OF NORTHERN DEVELOPMENT AND MINES, FOR ADDITIONAL INFORMATION ON THE STATUS OF THE LANDS SHOWN HEREON.

ACTIVATED AUGUST 13, 1992  
 BY D.C.  
 CHECKED BY G.W.

Map base and land disposition drafting by Surveys and Mapping Branch, Ministry of Natural Resources

The disposition of land, location of lot fabric and parcel boundaries on the index was compiled for administrative purposes only.

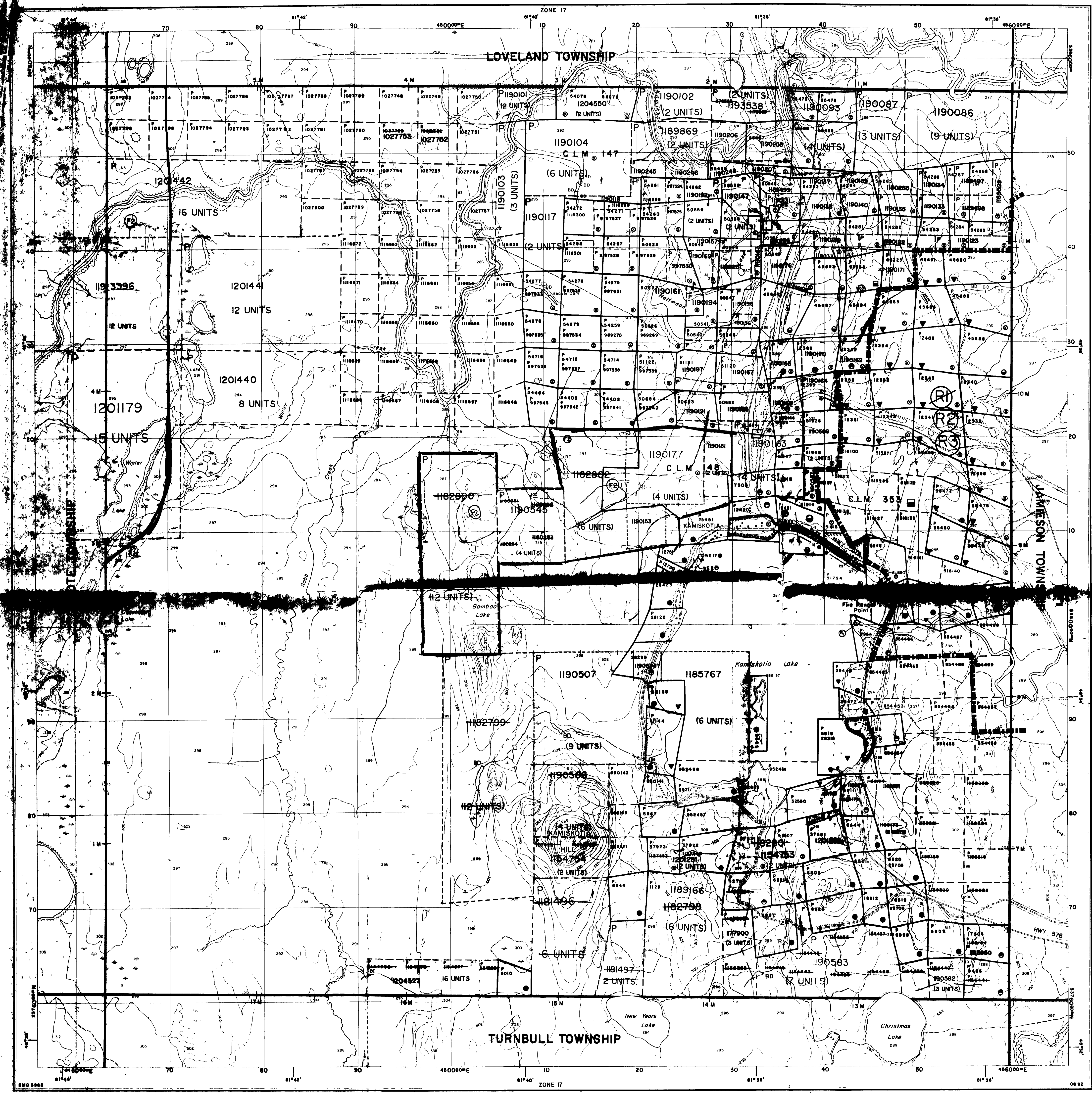

MIDDLETOWN TWP. G.

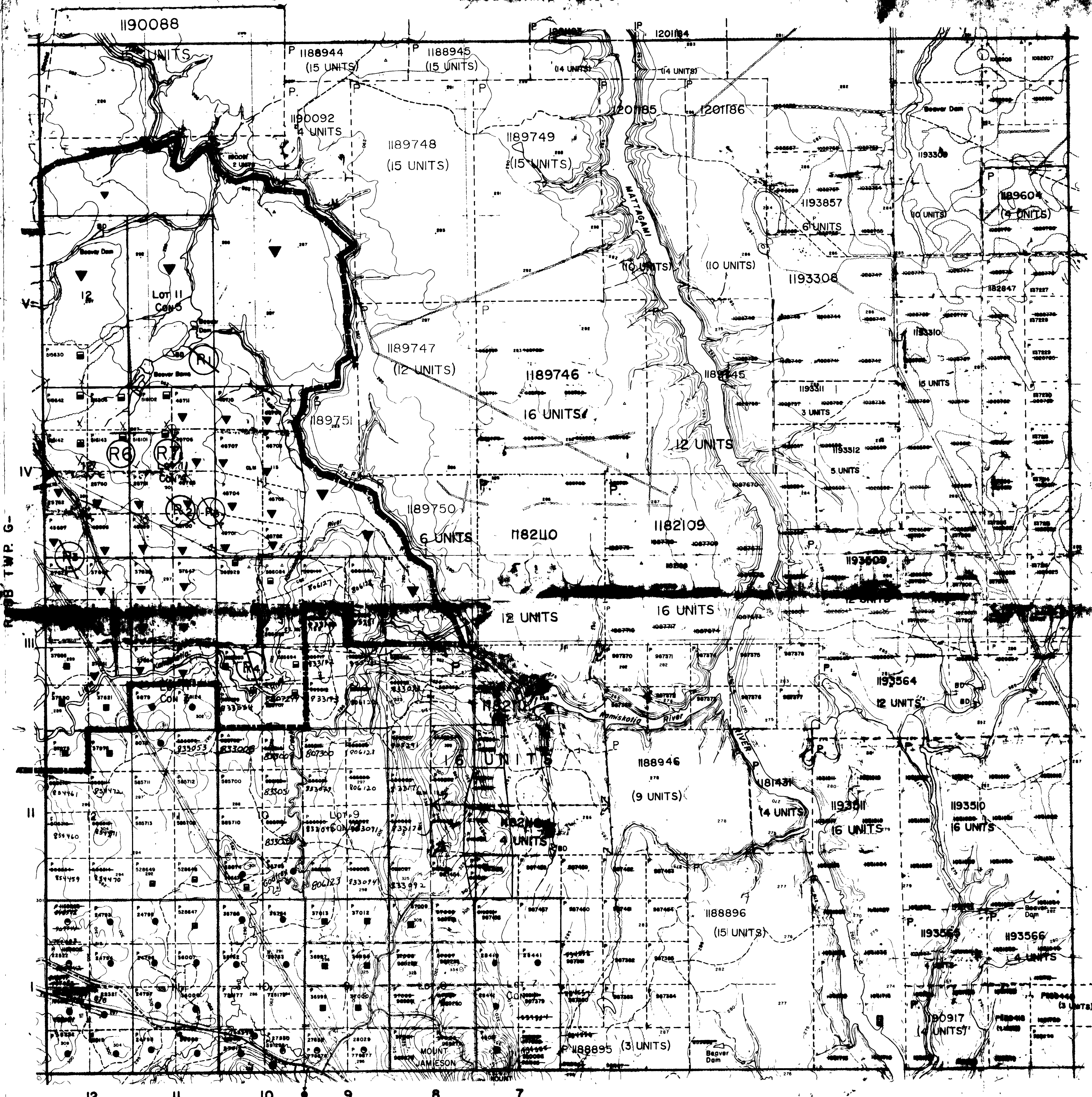

B TWP. G.

J. S. P. TWP. G-3984

THE INFORMATION THAT APPEARS ON THIS MAP HAS BEEN COMPILED FROM VARIOUS SOURCES AND ACCURACY IS NOT GUARANTEED. THOSE WISHING TO STAKE MINING CLAIMS SHOULD CONSULT WITH THE MINING RECORDER, MINISTRY OF NORTHERN DEVELOPMENT AND MINES FOR ADDITIONAL INFORMATION ON THE STATUS OF THE LANDS SHOWN HEREON.

DISPOSITION OF CROWN LANDS  
PATENT, SURFACE & MINING RIGHTS  
SURFACE RIGHTS ONLY  
LEASE, SURFACE & MINING RIGHTS  
MINING RIGHTS ONLY  
LICENSES OF OCCUPATION  
CROWN-OWNED  
RESERVATION  
CANCELLED  
SAND & GRAVEL

DISPOSITION OF CROWN LANDS

TYPE OF DOCUMENT	STATUS
PATENT, SURFACE & MINING RIGHTS	.....
SURFACE RIGHTS ONLY	.....
MINING RIGHTS ONLY	.....
LEASE, SURFACE & MINING RIGHTS	.....
SURFACE RIGHTS ONLY	.....
MINING RIGHTS ONLY	.....
LICENSES OF OCCUPATION	.....
CROWN-OWNED	.....
RESERVATION	.....
CANCELLED	.....
SAND & GRAVEL	.....

NOTE: MINING RIGHTS OR PATENTS APPLICABLE TO OIL & GAS ARE NOTED BY ANOTHER SYMBOL ON THE MAP.  
LAND ACT, R.S.O. 1990, CHAPTER M26, SECTION 11.

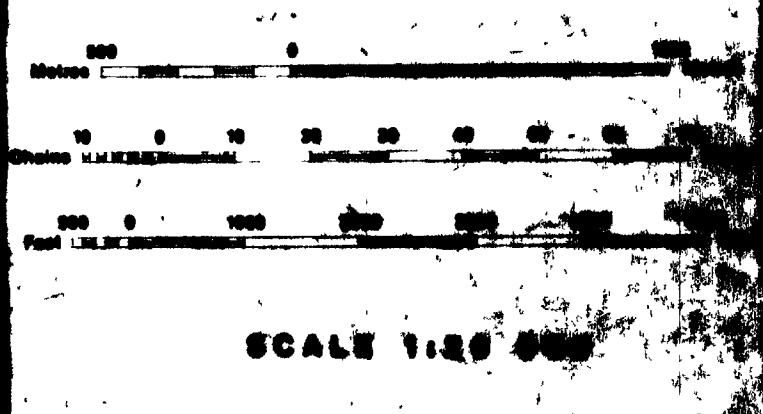

NOTES  
FLOODING RIGHTS TO AREAS ALONG THE MATTAGAM RIVER TO N.E.R.C.

6 1994

TOWNSHIP  
**JAMIESON**  
M.N.R. ADMINISTRATIVE DISTRICT  
**TIMMINS**  
MINING DIVISION  
**PORCUPINE**  
LAND TITLES / REGISTRY DIVISION  
**COCHRANE**

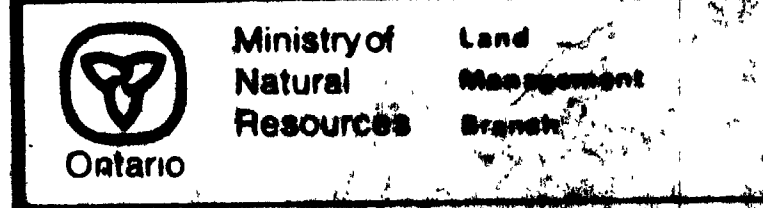

DATE: FEBRUARY, 1994  
G-3986





- PHYSICAL WORK**
- Diamond Drill Hole
  - ⊙ Overburden Drill Hole
  - ⊗ Mine, quarry or glau hole (active abandoned)
  - ⊗ Shaft (vertically inclined, rose, winz)
  - ⊗ Ast. Pump
  - ⊗ Rock Dump, Tailings
- CULTURAL AND PHYSIOGRAPHIC FEATURES**
- - - - - E.L.O. 14924 Boundary
  - - - - - Claim Line
  - - - - - Lot/Concession Line
  - - - - - 15' wheel track (steep, gravel)
  - - - - - 4' wheel drive road
  - - - - - Road
  - - - - - Building
  - - - - - Conspire
  - - - - - Power Line (major line, regular line)
  - - - - - Irrigation Line (existing, unsubs)
  - - - - - Railway Track
  - - - - - Tower
  - - - - - Bridge
  - - - - - River (canal, rapids)
  - - - - - Intermittent Stream
  - - - - - Lake
  - - - - - Swamp
  - - - - - Easement
  - - - - - Claim Post (O.S. - Open, unimpacted survey; S.O.S. - unimpacted, witness, or water)
  - - - - - B.D. Beaver Dam

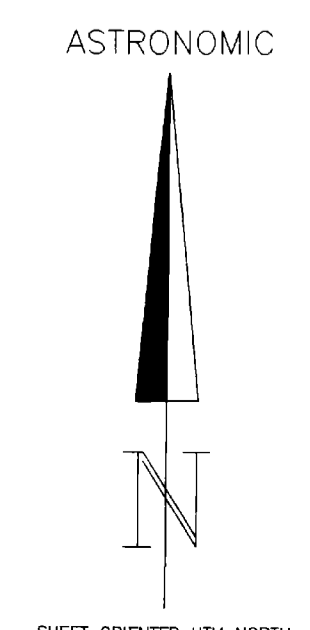
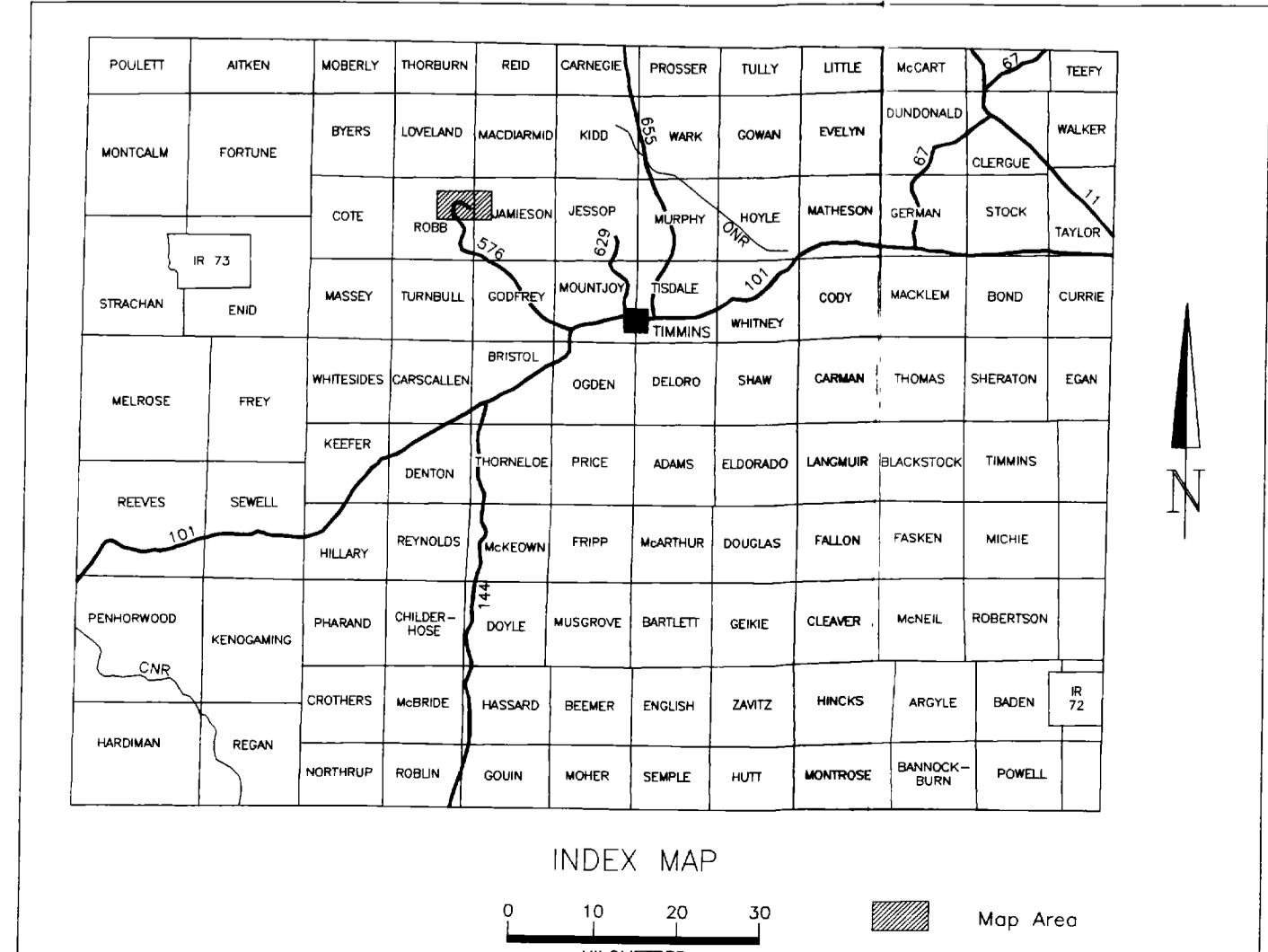

<b>FALCONBRIDGE LIMITED</b>			
Exploration Division		Timmins, ONTARIO	
<b>ROBB AND JAMIESON TOWNSHIPS</b>			
<b>DIAMOND DRILL HOLE LOCATION MAP</b>			
PROJECT	DATE	NTS	PROJECT SHEET
DRAWN	DATE	MAP No.	FILE
SUPERVISED	DATE	SCALE 1:5000 (NAD83)	
REVISED	DATE		