



42A12SE0259 63.1805 ROBB

010

REPORT
ON
ELECTROMAGNETIC SURVEY
DONE FOR
CINCINNATI - PORCUPINE MINES LIMITED, TORONTO
ON THEIR CLAIM GROUP
IN ROBB TOWNSHIP
PORCUPINE MINING DIVISION, ONTARIO

WORK BY
MESPI MINES LIMITED
TIMMINS, ONTARIO

WORK CONDUCTED BETWEEN MAY 11 TO MAY 25, 1964

AUGUST 19, 1965

W.E. NYMAN

INTRODUCTION

During the period from May 11, 1964 to May 25, 1964, a dual frequency Crone method electromagnetic survey was conducted by Mespi Mines Limited of 1705 Victory Building, 80 Richmond Street, West, Toronto, Ontario for Cincinnati-Porcupine Mines Limited of the same address on a small portion (6 claims) of their large group of claims (144) in Robb township.

LOCATION OF CLAIMS

Six claims located in the central portion of Robb township, Porcupine Mining Division, Ontario are numbered as follows: P. 54402, P. 54403, P. 54404, P. 54714, P. 54715, P. 54716.

This group is located approximately eighteen miles north west of Timmins, Ontario and two and one half miles west of the KamKotia Mine.

ACCESS

The work on the group was performed from the permanent base camp of Mespi Mines just north of Kamiscotia Lake. The large grid on the Cincinnati ground of which this group represents a small portion extends to highway 576 from which this ground is easily reached on foot.

PREVIOUS WORK

The complete area has been covered by two combined airborne magnetic-electromagnetic surveys.

Aeromagnetic Surveys flew it in a N-S direction with $\frac{1}{4}$ mile flight line spacing in 1957 for Mr. B.W. Lang of Toronto.

In May 1964, Hunting Survey Corporation covered the area with E-W flight lines and 1/8 mile spacing.

Both airborne electromagnetic surveys showed only weak electromagnetic responses with poor ratios.

The ground was covered as part of a blanket E.M. coverage of the Cincinnati ground in Robb township.

METHOD OF SURVEY

A Crone dual frequency (1800 cps - 480 cps) transceiver unit was used for the survey. The work was done using an in-line method, a coil separation of 300 feet and readings were taken at 100 foot intervals. The dip angles shown on the plan are the resultant angles and are plotted at the mid point between the two coils.

A total of 11 miles of line were cut and 552 stations were read with the instrument.

SURVEY RESULTS AND RECOMMENDATIONS

No conductors were located. The electromagnetic results were undisturbed and indicated a neutral overburden.

No further exploration can be recommended on the basis of these results.

Respectfully submitted

MESPI MINES LIMITED



W.E. Nyman
Exploration Manager

WEN/jf

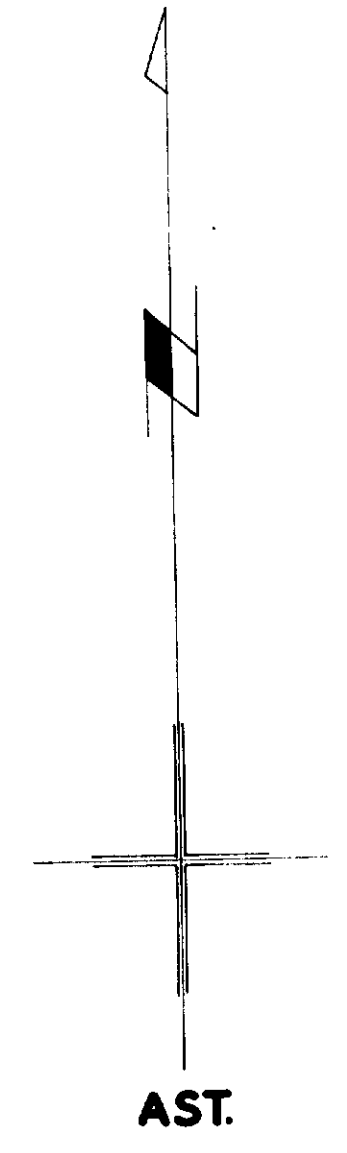
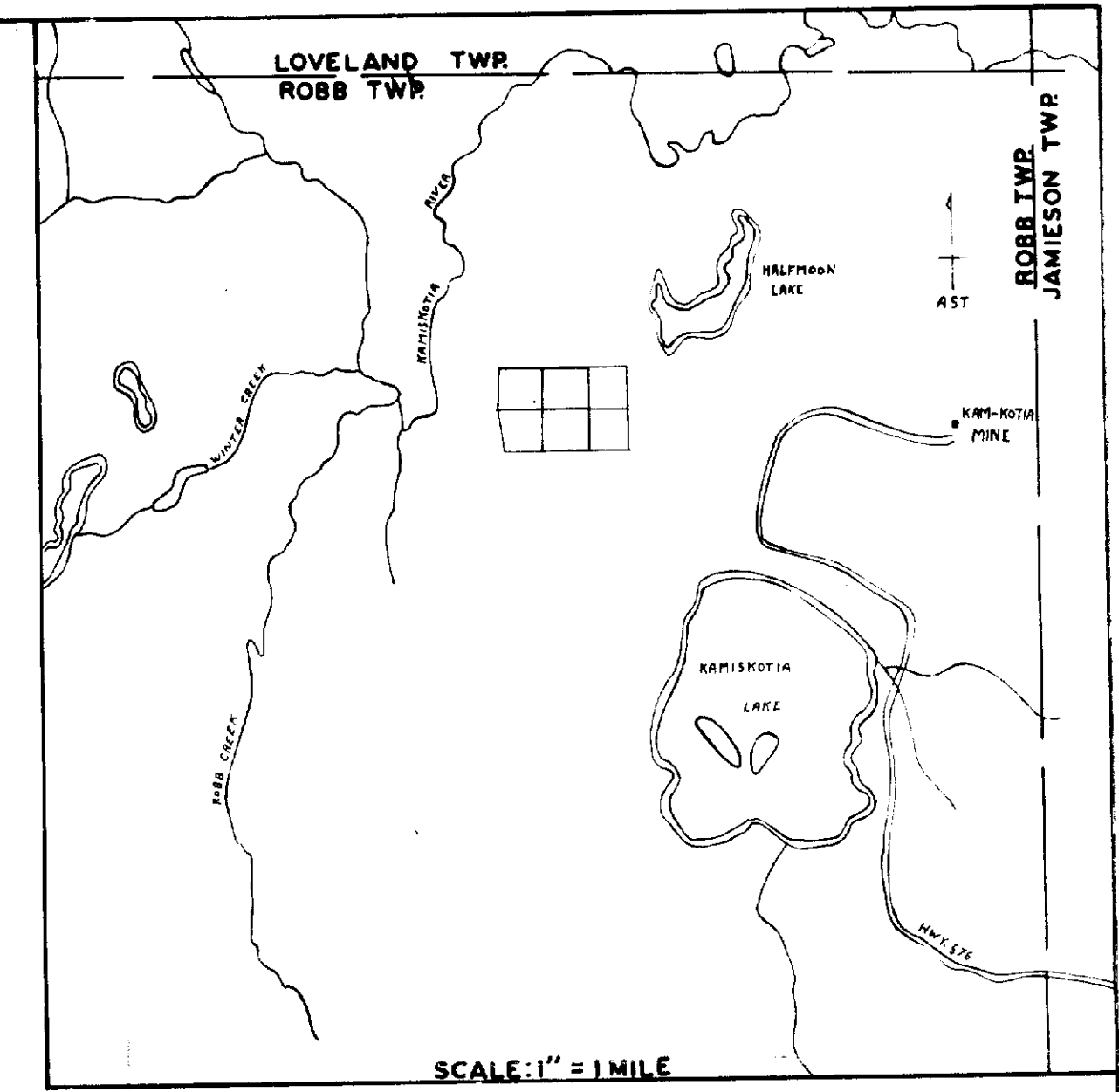
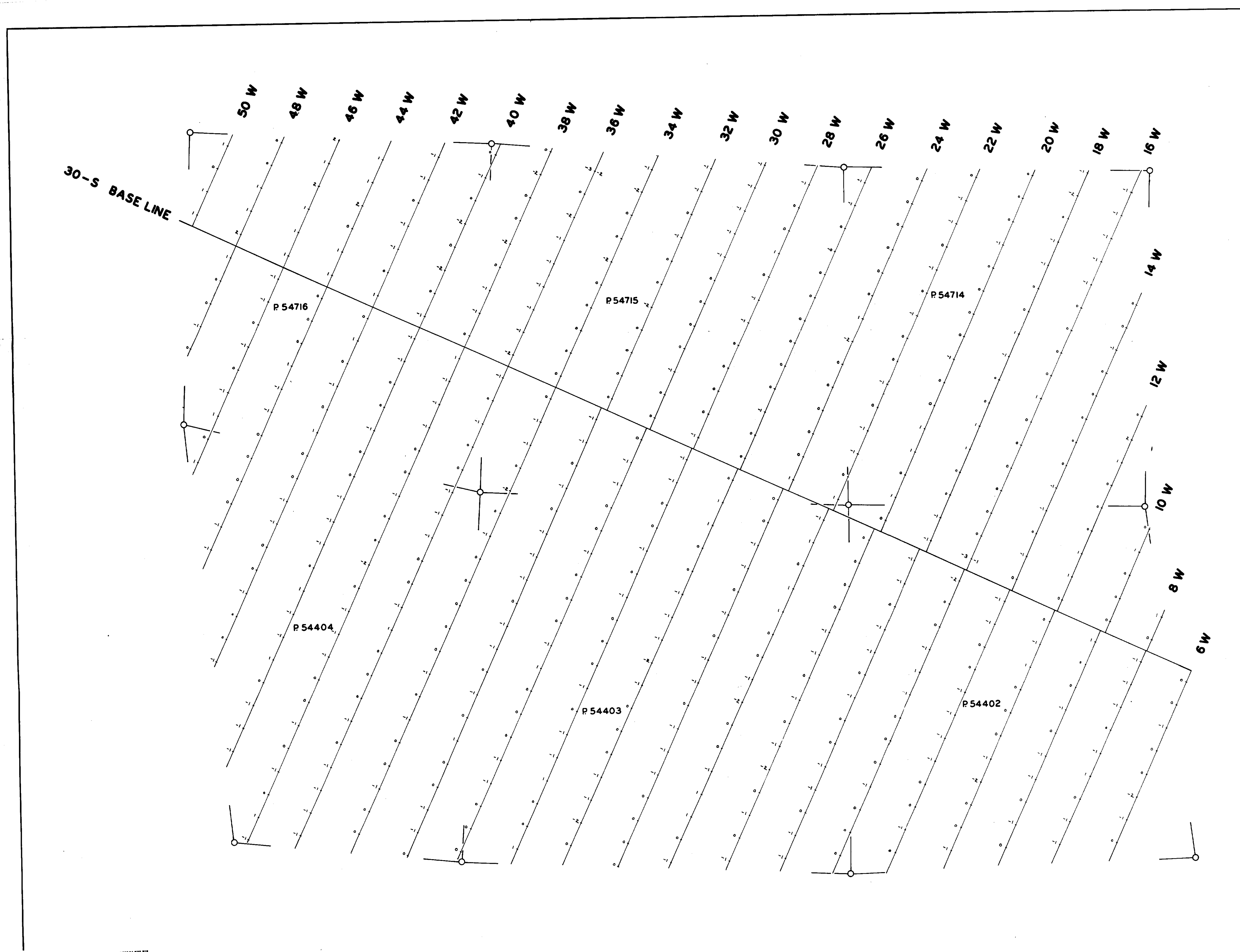

CINCINNATI-PORCUPINE MINES LTD.
ELECTRO-MAGNETIC SURVEY
ROBB TWP.
INSTRUMENT: CRONE J.E.M.
DUAL FREQUENCY: IN-LINE METHOD
COILS 300' APART
MAP SCALE: 1" = 200'
LEGEND

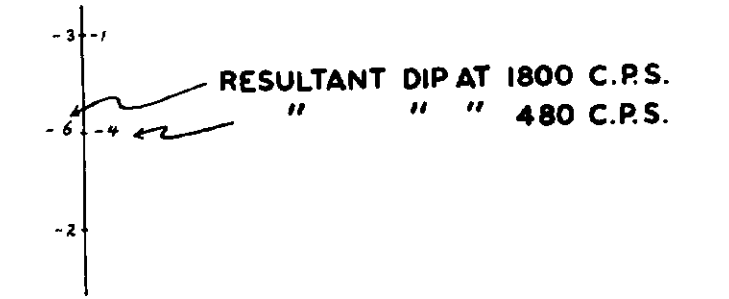

SURVEY DATE: MAY 25-31, 1964
 DRAWN BY: R.C. DENOMEE
 APPROVED: *W.E. Ryan*

(1/2 x 3) 4 1/2 method - in line

