



42A12SE0279 63.1229 ROBB

010

63.1229

INTRODUCTION

Duvan Copper Company carried out a magnetic survey over a group of 15 claims held in Robb Township during August & September 1962.

The property consists of the following claims:

P-50526 - 29	P-50558 - 59
P-50540 - 45	P-50683 - 84
P-50552	P-51121 - 22

A grid of north-south picket lines were cut over the property at 300 foot intervals and chainage pickets set up at 100 foot intervals along the picket lines.

A Sharpe A-2 magnetometer was used in the survey using a scale constant of 20 gammas per scale division. All readings were corrected to a common base station which gives the same result as if all the readings were taken at the same time.

The results of the survey have been plotted on the accompanying map which is on the scale of 1" - 400'.

GENERAL GEOLOGY

The property is underlain by early Precambrian lavas and fragmentals of the Keewatin type which have been tightly folded and intruded by basic igneous rocks, granite and related acid dykes.

RESULTS OF THE MAGNETOMETER SURVEY

A north westerly trending elongated magnetic zone trends from the south western corner of the property to Moon Lake.

This anomaly is believed to be caused by a diabase dyke.

A magnetic zone occurs on the western part of the property on line 27 W. The magnetic zone occurs on one line only and hits a peak of about 300 gammas above normal at chainage 1300 North.

CONCLUSION & RECOMMENDATIONS

Sulphide mineralization containing chalcopyrite has been found in diamond drilling to the northwest close to the Duvan boundary.

It is recommended that the magnetic anomaly on line 27 W be tested by diamond drilling.

Respectfully submitted,

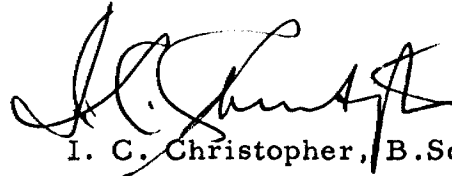

I. C. Christopher, B.Sc. P.Eng.

Toronto, Ontario

May 13, 1963.

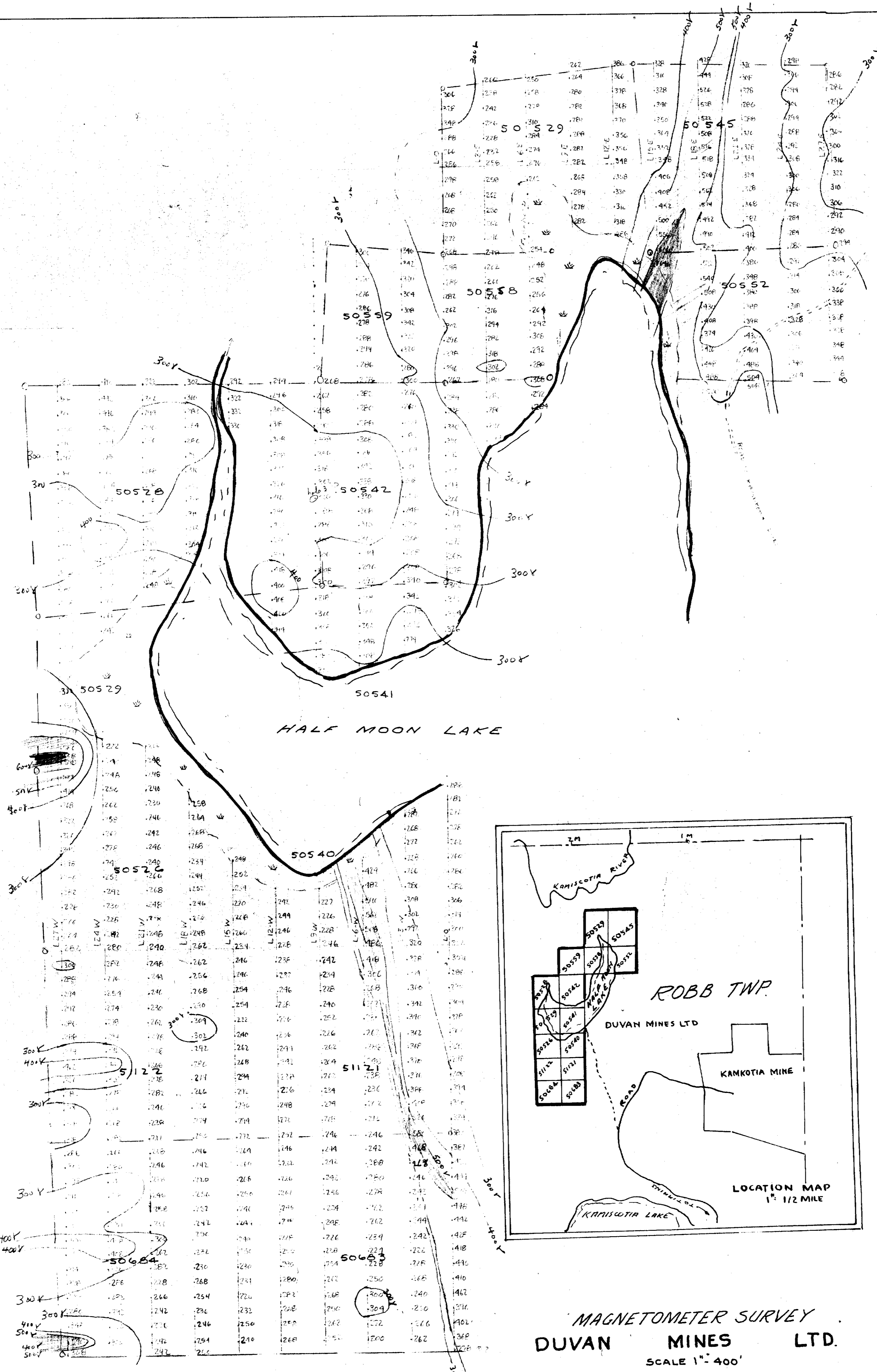

SEPT 1962

MAGNETOMETER SURVEY
 DUVAN MINES LTD.
 SCALE 1" = 400'

J. F. HODGE
[Signature]

