



42A12SE0350 63.4212 ROBB

010

Report on Diamond Drilling, Tesluk Property

by

William O. Karvinen, Ph.D.

August 11, 1982

OM 82-5-C-155

### Introduction

At the request of Sam Levinson and Mike Tesluk of Glory Mining and Refining Ltd. the writer spotted two diamond drill holes to be drilled on an earlier-discovered gold prospect on the Tesluk Property in Kobb Township, about 25 miles northwest of Timmins, Ontario.

Purpose of the drilling was mainly to test the width of the pyritic alteration zone which had been partly stripped and trenched during an early phase of work.

### Program

Hole 82-1 was drilled directly under the trench from which some erratic but significant gold values (up to 0.18 oz. Au/ton) were obtained while hole 82-2, collared in the same spot, was directed about 60 degrees west of the first hole to test for mineralization in rocks covered by up to 40 feet of clay. Statistics on the holes are as follows:

Collar location: 25 m west of 75 m (N) on 600 m E

Hole 82-1:           direction: N54°E  
                      dip: 45°  
                      depth: 166 feet

Hole 82-2:           direction: N6°W  
                      dip at collar: 45°  
                      dip at 336 feet: 51°  
                      depth: 336 feet

### Results

Although hole 82-1 was drilled under altered rocks found on surface, only chloritic basalt-gabbro with some barren quartz veining was intersected in the first 107 feet. From 107 ft. to 166 ft. medium-grained, massive, unaltered gabbro was intersected.

Hole 82-2 cut two zones of altered rocks containing pyrite and numerous quartz-ankerite veinlets with traces of chalcopyrite and in a few some galena and sphalerite. The first zone was intersected from 18 feet to 113 feet (95 feet total) and the second from 153 ft. 6 in. to 183 ft. 6 in. (30 feet total). The remaining rocks are chloritic to partly altered gabbro with little to no veining.

The zones of alteration consist of 10% to 30% quartz-carbonate veinlets ( $\frac{1}{8}$  to  $1\frac{1}{2}$  in.) at random angles to the core axis and carry from  $\frac{1}{2}$  to 2% pyrite and traces of chalcopyrite mainly along the walls of the veins. Alteration consists of ankeritization and silicification. The resulting rock has a mottled texture with outlines of original plagioclase and pyroxene crystals destroyed by alteration. The fresh rock is pale to medium green in color while the weathered outcrop is rusty from the breakdown of ankerite.

The chloritic basalt-gabbro which appears to envelop the zones of alteration is more magnetic than the surrounding rocks. This may be the cause of the magnetic anomaly delineated by an earlier magnetometer survey.

Two samples (no. 38039 and 38040) of pyrite-bearing vein material from hole 82-1 assayed 71 and 15 ppb (part per billion) gold and low arsenic. Similarly, 52 samples (no. 38008 to 38034) from the wider alteration zone in Hole 82-2 intersected low but anomalous gold (30 to 129 ppb) and arsenic (5 to 50 parts). The second alteration zone in Hole 82-2 (from 153'6" to 183'6") assayed only low gold (8 to 16 ppb) and arsenic.

#### Discussion

Although no ore-grade values in gold were intersected, the consistently normal low gold and arsenic content over a core length of 85 feet in the main alteration zone cut by hole 82-2 is encouraging. This data is indicative of

Some potential ore-bearing zones being present in the altered rocks. If the magnetic anomaly is a product of alteration, as appears to be the case from an examination of the magnetic properties of the core from these holes, then the potential area of altered rocks may be up to 500 feet long. In this regard the weak electromagnetic anomaly detected off the northwest end of the magnetic anomaly may be an important target. Because hole 82-2 was drilled at an acute angle both in the vertical and horizontal planes to the zones of alteration, their true widths are much less than the core intersections. Assuming a vertical dip and a strike of  $N40^{\circ}W$  for the zones, the true width of the first zone is about 40 feet, while the second, less anomalous zone of alteration is about 11 feet wide.

#### Conclusions

The drilling indicates:

1. Two zones of carbonate-silica alteration with pyritic quartz-ankerite veinlets carrying anomalous values of gold (8 to 129 ppb) and arsenic (up to 50 ppm). The zones are about 40 and 11 feet wide and appear to trend approximately  $N40^{\circ}W$ .
2. The magnetic anomaly, situated immediately northeast of the alteration zones appears to be a product of alteration.
3. The surmised size of the main alteration zone (up to 500 feet long?) based on the magnetics and the consistently anomalous gold and arsenic values indicate a potential of finding ore-grade gold mineralization somewhere in the altered rocks. Perhaps the weak electromagnetic anomaly on strike to the northwest represents a pyrite-rich (>5%) rocks which carry better values of gold. (The anomalous gold and arsenic values in till support this possibility.)

Recommendations

1. The weak electromagnetic anomaly should be tested with two 400 ft. diamond drill holes. Similarly, another shorter hole (300 ft.) should be drilled across the northwest extension of the alteration zone, about 900 feet from the collar of holes 82-1 and 82-2. Absolute values of gold in ppb and particularly arsenic (values >150 ppm) should be used as guides in interpreting proximities to ore zones.
2. Be rock westward from the existing trench and across the alteration zone should be stripped, trenched and bulk sampled. This could give a strip of representative analytical information for over 50 feet across the favourable rock.

*W. O. Karvinen*

August 11, 1982

Dr. William O. Karvinen

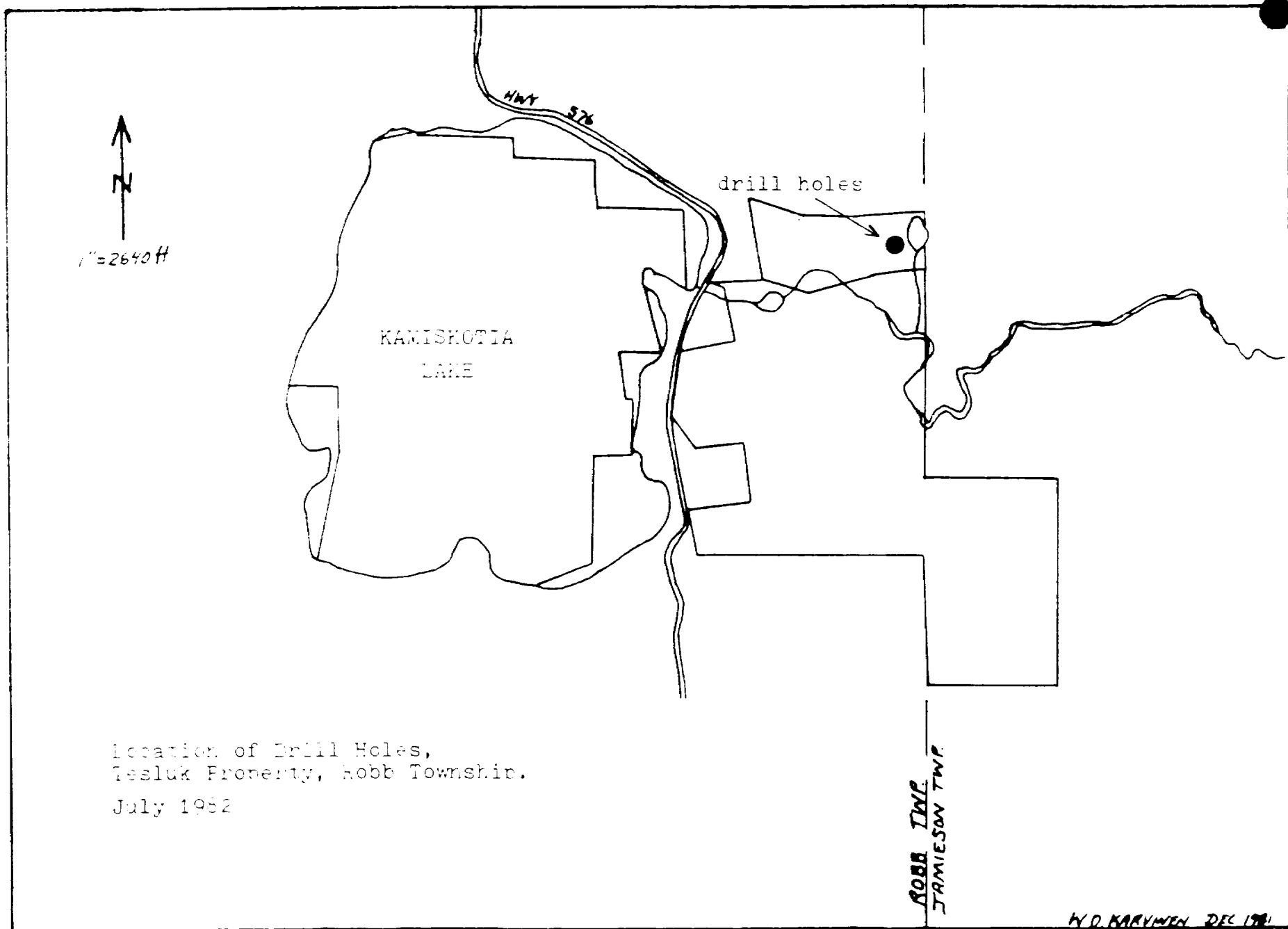

Location of Drill Holes,  
Tesluk Property, Robb Township.

July 1982

ROBB TWP.  
JAMIESON TWP.

W.D. KARVONEN DEC 1984

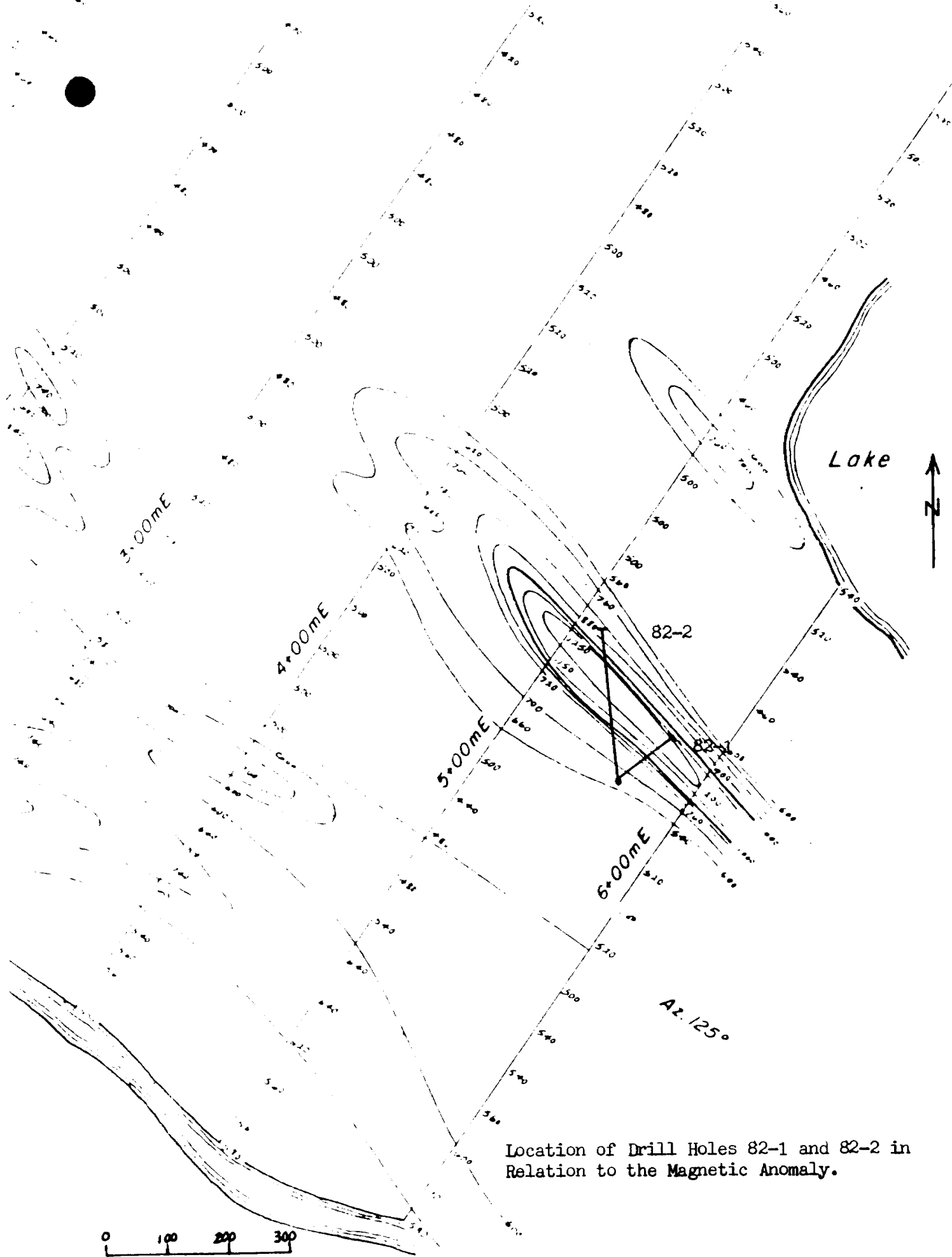

Location of Drill Holes 82-1 and 82-2 in Relation to the Magnetic Anomaly.

0 100 200 300  
1 inch = 200 feet

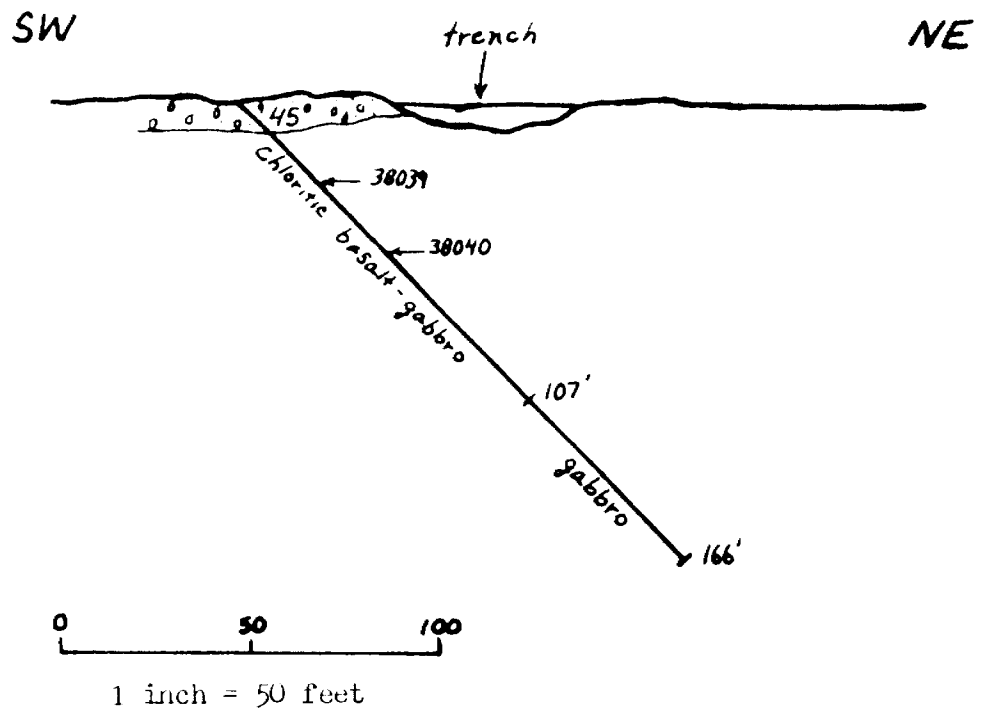

Section of Diamond Drill Hole 82-1



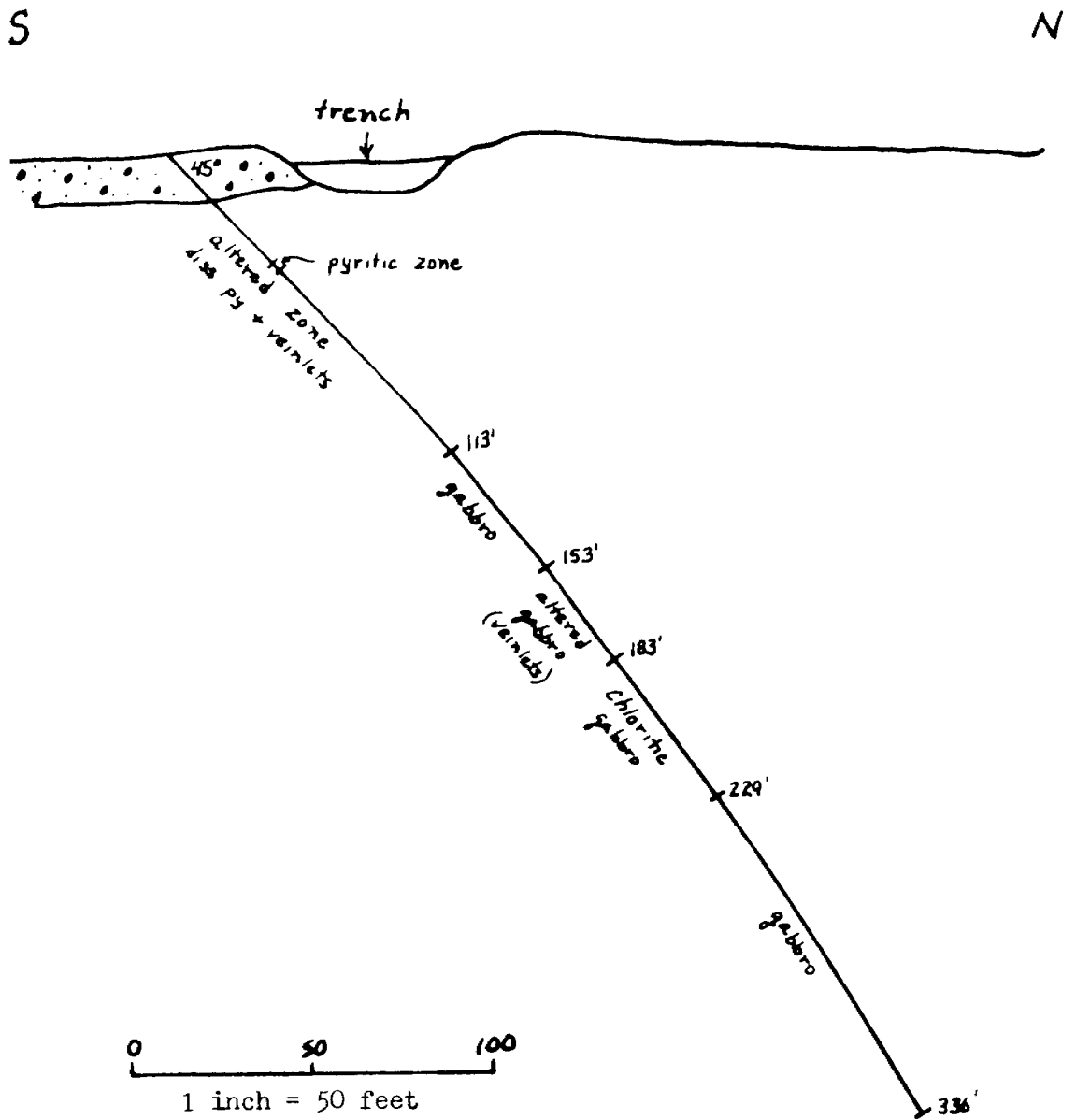

Section of Diamond Drill Hole 82-2

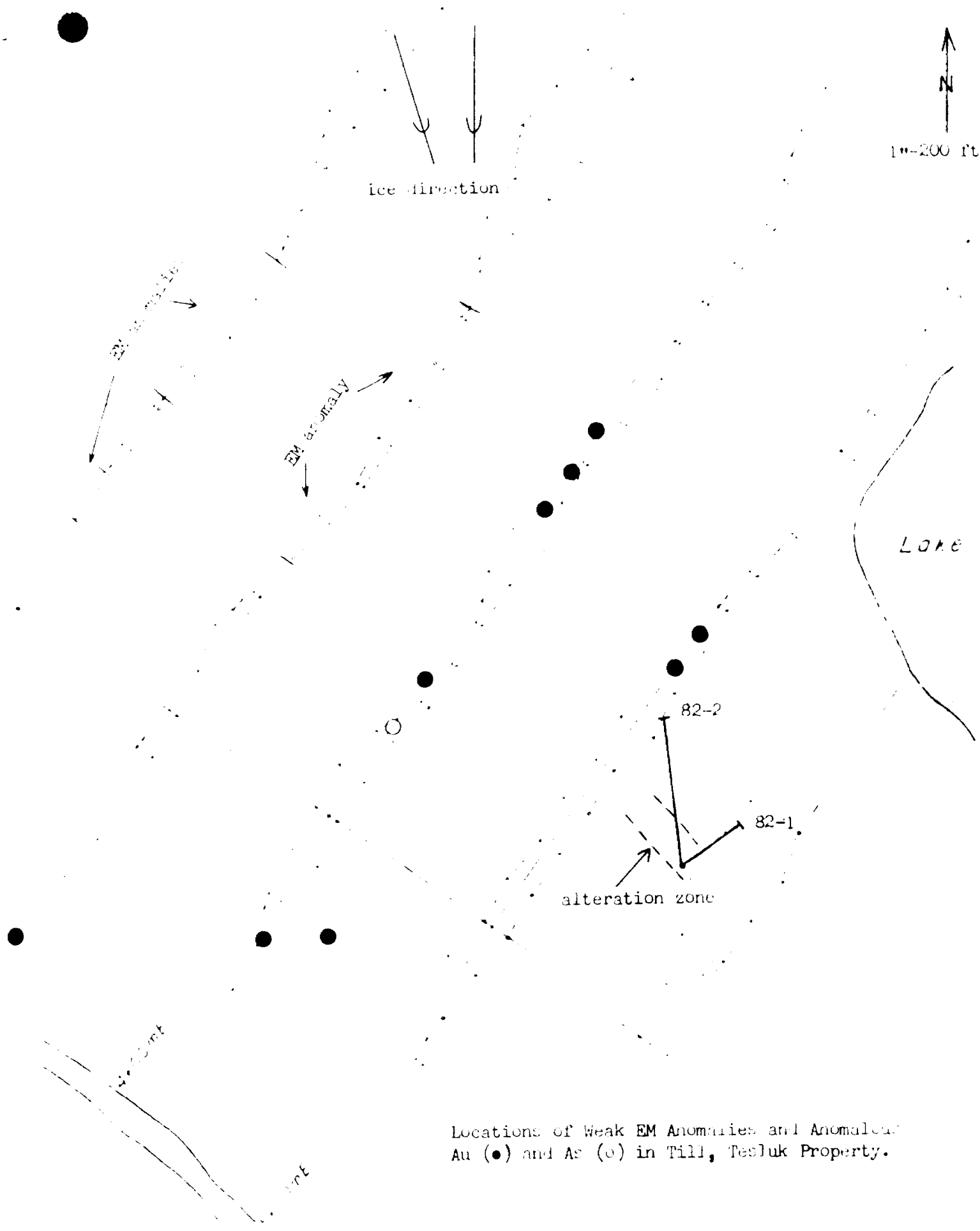

Locations of Weak EM Anomalies and Anomalous Au (●) and As (○) in Till, Tesluk Property.



**Diamond  
Drilling  
Log**

Fill in on every page **Hole No. 32-2** Page No. 1

Drilling Company <b>Dominik Drilling</b>		Collar Elevation	Bearing of hole from true North <b>N54°E</b>	Total Footage <b>336 ft.</b>	Dip of Hole at Collar <b>45°</b>	Location of hole in relation to a fixed point on the claim.  <b>25 m west of 75N (m) on 600E (m)</b>	Map Reference No.	Claim No. <b>P12557</b>	
Date Hole Started <b>July 25, 1982</b>	Date Completed <b>July 27, 1982</b>	Date Logged <b>28-30.7.82</b>	Logged by <b>W. O. Karvinen</b>		<b>336</b> Ft. <b>51°</b>		Location (Twp., Lot, Con or Lat. and Long.)	<b>Robb Township</b>	
Exploration Co., Owner or Optionee  <b>Glory Mining &amp; Refining Limited</b>		Date Submitted	Submitted by (Signature)  <i>W. O. Karvinen</i>					Property Name <b>Tesluk</b>	

Footage		Rock Type	Description <small>Colour grain size texture minerals alteration etc</small>	Planar Feature Angle	Core Specimen Footage †	Your Sample No.	Sample Footage		Sample Length	Assays †	
From	To						From	To		Au	AS
0'	18'	overburden								ppb	ppm
18'	113'	altered gabbro	18'- 21'6" -altered gabbro with disseminated pyrite (½%)			38003		3'6"		58	40
			21'6"-22'6" -bleached rock with qtz. veinlets & py (1%)			38004		1'		52	50
			22'6"-22'8" -altered but no veins; tr. py			38005		2"		60	50
			22'8"-23' -qtz.-carb. veinlets with diss. py (1%)			38006		4"		61	40
			23'-24'2" -altered gabbro with trace py; no veins			38007		1'2"		59	25
			24'2"-25'8" -qtz.-carb. veinlets; pyrite 1%			38008		1'6"		37	25
			25'8"-28' -few veinlets; tr. py			38009		2'4"		51	20
			28'-33' -few veinlets; tr. py			38010		5'		36	15
			33'-37' -few veinlets; tr. py			38011		4'		38	10
			37'-39' -few veinlets; tr. py			38012		2'		41	5
			39-40' -2-½" veinlets with diss. py. also in wallrock			38013		1'		67	15
			40'-41'6" -few veinlets; tr. py			38014		1'6"		26	20
		pyritic zone 4'9"	41'6"-44' -2% diss. pyrite with some veinlets			38015		2'6"		41	10
			44'-46'3" -2% diss. pyrite with some veinlets			38016		2'3"		36	10
			46'3"-49' -tr. py in altered gabbro; no veinlets			38017		2'9"		52	N.D.
			49'-52' -qtz.-carb. veinlets; tr. py.			38018		3'		43	5



**Diamond  
Drilling  
Log**

Fill in on every page Hole No. 82-2 Page No. 3

Drilling Company	Collar Elevation	Bearing of hole from True North	Total Footage	Dip of Hole at Collar	Location of hole in relation to a fixed point on the claim	Map Reference No.	Claim No.
Date Hole Started	Date Completed	Date Logged	Logged by W. O. Karvinen			Location (Twp., Lot, Con. or Lat. and Long.)	
Exploration Co., Owner or Optionee  Glory Mining & Refining Limited		Date Submitted	Submitted by (Signature) <i>W. O. Karvinen</i>			Property Name Tesluk	

Footage		Rock Type	Description <small>Colour, grain size, texture, mineral alteration, etc.</small>	Planar Feature Angle	Core Specimen Footage	Your Sample No.	Sample Footage		Sample Length	Assays †		
From	To						From	To		Au ppb	As ppm	Ag
			102-102'8" -qtz.-carb. vein with large py cubes; vein parallel CA			38034		8"		129	5	-
			102'-113' -altered leucogabbro; diss. py in hairline bleached fractures									
113'	153'6"	gabbro	113'-131' -med. to crs.-gr. leucogabbro; few thin barren veinlets at 45° to CA									
			131'-133' -ophitic textured gabbro with 2% py cubes									
			133'-145' -ophitic, crs. gabbro; few barren veinlets									
			145'-153'6" -med.-gr. moderately altered gabbro; tr. py.									
153'6"	183'6"	altered gabbro	153'6"-156' -light-colored, altered gabbro with 20% veinlets; py & cpy 1%			38035		2'6"		8		
			156'-171' -altered gabbro with barren veinlets, some pyrite in walls									
			161'6"-162'2" -veinlets & fractures in chloritic gabbro; diss. py, cpy 1%			38036		8"		7		
			164'-164'8" -2" atz. vein with py @ 45° to CA			38037		8"		8		
			167'-167'6" -rusty, hard rock, all limonite, fault?									
			171'-183'6" -altered gabbro; 10% veinlets; tr. py									
			183'-183'6" -1" veinlet of glassy qtz. with diss. py, cpy ga			38038		6"		16		

**Diamond  
Drilling  
Log**

Fill in on  
every page

Hole No. 82-2 Page No. 4

Drilling Company		Collar Elevation	Bearing of hole from true North	Total Footage	Dip of Hole at Collar	Location of hole in relation to a fixed point on the claim.	Map Reference No.	Claim No.	
Date Hole Started	Date Completed	Date Logged	Logged by W. O. Karvinen		Ft.		Location (Twp., Lot, Con. or Lat. and Long.)	Property Name Tesluk	
Exploration Co., Owner or Optionee Glory Mining & Refining Limited		Date Submitted	Submitted by (Signature) <i>W. O. Karvinen</i>		Ft.				
					Ft.				

Footage		Rock Type	Description Colour, grain size, texture, minerals, alteration, etc.	Planar Feature Angle	Core Specimen Footage	Your Sample No.	Sample Footage		Sample Length	Assays †
From	To						From	To		
183'6"	229'	chloritic to altered gabbro	183'6"-202'	-med.gr. dark chloritic gabbro, no veinlets tr. py.						
			202'-206'	-altered gabbro with 10% veinlets; tr. py						
			206'-209'	-zones & veinlets of qtz.carb; parallel to CA; diss. py 1% in walls; 2" of feldspar (porphyry?)						
			209'-229'	-some altered gabbro with 10% veinlets nearly parallel to CA						
			218'218'6"	-very altered, yellow-green zone with chlorite 1% py; tr. cpy						
229'	336'	gabbro	229'-280'	-relatively unaltered, dark med.-gr. gabbro no veinlets; tr. py; massive						
			280'-281'	-2 veinlet zones with bleaching; barren						
			281'-295'	-massive, med.-gr. gabbro						
			295'297'	-barren qtz. veinlets parallel to CA						
			297'-336'	-massive, med.-gr. gabbro						
	336'	End of hole								



42A125E0350 83.4212 ROBB

020

Report on Diamond Drilling and Trenching,

Tesluk Property, Robb Township

by

William O. Karvinen, Ph. D.

October 23, 1982

OM82-5-C-155



## Introduction

During a meeting of directors and investors of Glory Mining and Refining Co. Ltd. held on Sept. 2, 1982, plans were made to better delineate the distribution of mineralization exposed on stripped outcrops and trenches on the Tesluk gold prospect in Robb Township. The writer recommended additional stripping of overburden, some trenching and the establishment of a 10 ft. x 10 ft. grid over the mineralized area. In addition, directors of Glory wanted a vertical hole drilled to 100 ft. to test the depth of alteration and mineralization.

## Work Done

Early in September, additional stripping and road building were done under the direction of Dan Davison. The newly stripped areas were trenched and sampled by W. O. KARVINEN & Associates Ltd. during the last week of September. A total of 12 composite samples from three new trenches were submitted for analysis. In addition, a detailed grid was established and all trenches were mapped and tied to the property grid.

On Sept. 13 to 15, 1982, Dominik Drilling Co. of South Porcupine drilled vertical hole 82-3 and the core was logged and sampled by the writer on Sept. 26, 1982. Seven sections of core were submitted for analysis.

## Results

Previous and recently excavated trenches as well as values of gold (ppb) over sections of 3 to 6 feet are plotted with respect to the detailed grid on the enclosed map. Gold values in the new trenches ranged from 4 to 1120 ppb (0.03 oz. Au/ton) while arsenic content was no higher than 15 ppm.

Diamond drill hole 82-3 passed through two zones of alteration (0 to 11 ft. and 19 to 27 ft.) near surface and penetrated hybrid to relatively unaltered gabbro/basalt for the remainder of the hole to a depth of 100 feet (see logs enclosed). The altered zones consist of pale green, carbonatized and silicified rock cut by narrow quartz-carbonate veinlets. Cubic pyrite up to 2% is confined to veinlet walls and is also disseminated in zones in the altered rock.

The best value (1301 ppb) obtained was a 5 ft. section in altered rock from 0 to 5 ft.; gold content diminished downward as indicated by values in the assay column in the logs.

#### Conclusions

Best concentrations of gold, although not of economic value, are located in a thin (<10 ft.) sheet of rock measuring 5 to 10 ft. wide and up to 20 ft. long in the vicinity of drill hole 82-3. As suggested earlier and confirmed by this phase of work, the anomalous zones of gold which coincide with the altered rock, are thin at this outcrop exposure and appear to thicken northwestward. Chances for thicker zones of alteration and better gold values are expected to improve in that direction.

#### Recommendations

No further work on this stripped outcrop area is recommended and certainly no bulk sampling is justified by the results of sampling done to date.

Testing of the northwest projection of the zone by three diamond drill holes as suggested earlier is recommended.



October 23, 1982

Dr. William O. Karvinen

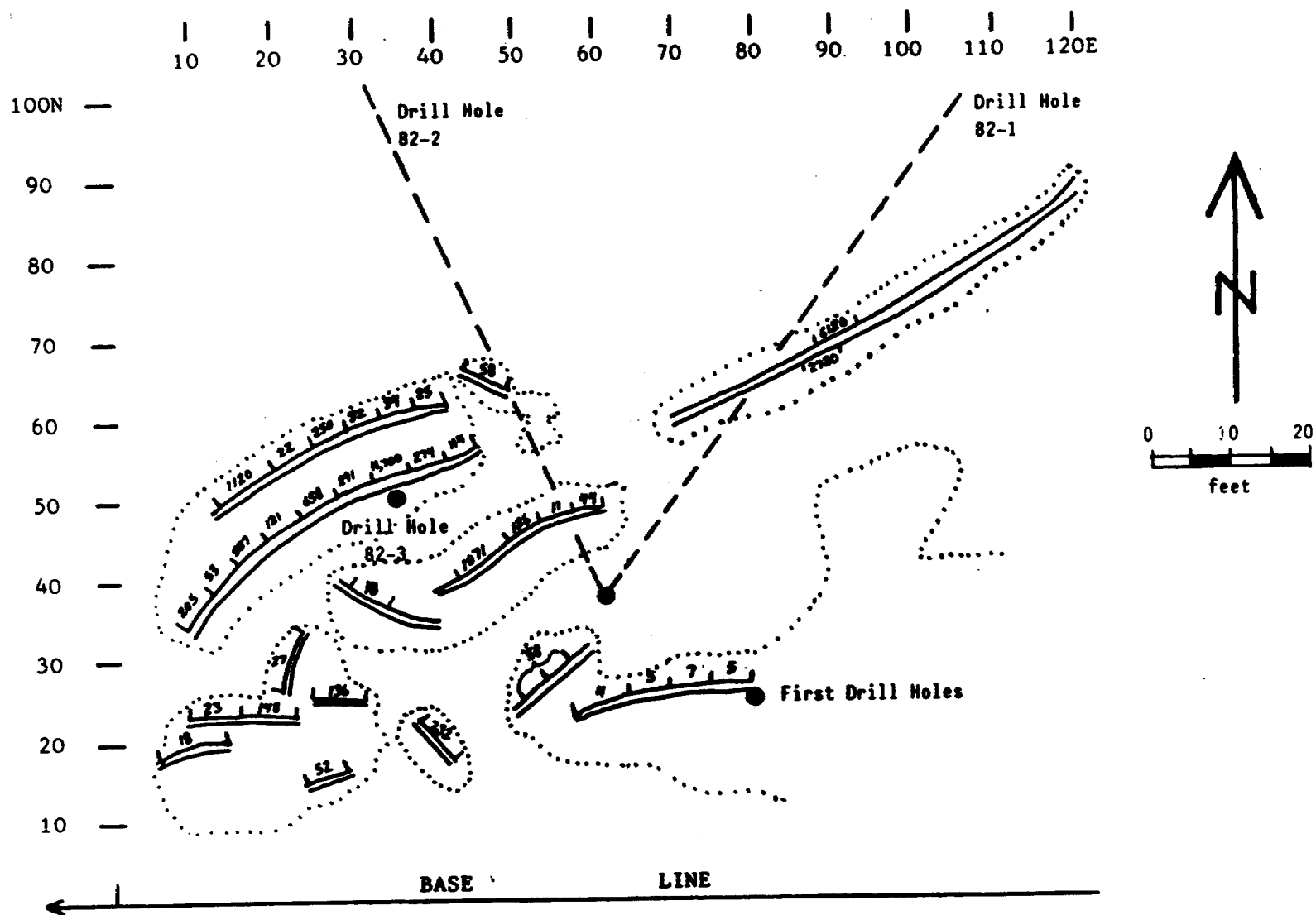

Gold Values (parts per billion) of Composite Samples  
from Trenches on the Tesluk Property

**Diamond  
Drilling  
Log**

Fill in on every page Hole No. 82-3 Page No. 1

Drilling Company <b>Dominik Drilling</b>		Collar Elevation	Bearing of hole from true North	Total Footage 101	Dip of Hole at Collar 90	Location of hole in relation to a fixed point on the claim.	Map Reference No.	Claim No. P12557
Date Hole Started Sept. 13, 1982	Date Completed Sept. 15, 1982	Date Logged Sept. 26, 82	Logged by W. O. Karvinen		Fl.		Location (Twp., Lot, Con. or Lat. and Long.)  Robb Twp.	
Exploration Co., Owner or Optionee  Glory Mining & Refining Ltd.		Date Submitted	Submitted by (Signature) <i>W. O. Karvinen</i>		Fl.			
					Fl.			
							Property Name <b>Tesluk Property</b>	

Footage		Rock Type	Description Colour, grain size, texture, minerals, alteration, etc.	Planar Feature Angle *	Core Specimen Footage †	Your Sample No.	Sample Footage		Sample Length	Gold ppb	Assays †
From	To						From	To			
0 ft.	11 ft.	altered zone	- bleached, pale green, massive, recrystallized rock cut by qtz.-carb. veinlets; mottled texture; cubic pyrite up to 2% along veinlet (1/2 to 1") walls								
			0-5 ft. -2 main veinlets @ 1 ft. and @ 4 ft., gray wall rock alteration with traces of cpy in places			38041	0'	5'	5'	1301	
			5-9 ft. -same as previous section			38042	5'	9'	4'	555	
11 ft.	19 ft.	hybrid gabbro/basalt	- dark gray to black; tr. py diss. mottled, partly recrystallized texture; few 1/8" veinlets								
19 ft.	27 ft.	altered zone	19 ft.-20 ft. -pyritic zone ( 2%) with veinlets at 25 ft. -6" zone of rusty rock - rest of zone has only traces of pyrite and few barren veinlets			38043	19'	20'	1'	48	
27 ft.	60 ft.	hybrid gabbro/basalt	- dark colored, mottled, partly recrystallized; carbided; magnetic; - zones of white quartz up to one foot wide; tr. py & cpy; 10 to 15% qtz veinlets								
			28'4" to 29' -barren qtz. zone with tr. py on walls at 45° to C.A.			38044	28'4"	29'	8"	43	
			31' to 32'6" -90% qtz. barren; tr. py. in inclusions			38045	31'	32'6"	1'6"	29	
			39' to 39'10" -green, altered zone with veinlets; 2% py			38046	39'	39'10"	10"	58	





# BELL - WHITE ANALYTICAL LABORATORIES LTD.

P.O. BOX 187.

HAILEYBURY, ONTARIO

TEL: 672-3107

## Certificate of Analysis

NO. B298-82

DATE: October 4, 1982

SAMPLE(S) OF: Rock (12)

RECEIVED: Sept.-Oct., 1982

SAMPLE(S) FROM: Dr. W.O. Karvenin, for Glory Mining & Refining.

<u>Sample No.</u>	<u>Gold ppb</u>	<u>Arsenic ppm</u>
F38124	58	15
25	25	5
26	34	ND
27	32	5
28	250	3
29	22	3
F38130	1120	5
31	18	ND
32	5	ND
33	7	ND
34	5	ND
35	4	3

Note; ND denotes Not Detected

IN ACCORDANCE WITH LONG-ESTABLISHED NORTH AMERICAN CUSTOM, UNLESS IT IS SPECIFICALLY STATED OTHERWISE GOLD AND SILVER VALUES REPORTED ON THESE SHEETS HAVE NOT BEEN ADJUSTED TO COMPENSATE FOR LOSSES AND GAINS INHERENT IN THE FIRE ASSAY PROCESS.

BELL-WHITE ANALYTICAL LABORATORIES LTD.

PER



42A12SE0350 63.4212 ROBB

030

**Report on Diamond Drilling**  
**(holes 82-4 to 82-7),**  
**Tesluk Property, Robb Township**

by

**W. O. Karvinen, Ph.D.**

**November 11, 1982**

OM 82-5-C-155

## Introduction

At a meeting of Directors and investors of Glory Mining and Refining Ltd, held on Sept. 2, 1982, the writer was requested to lay out a diamond drilling program on the Tesluk property in Robb Township. Purpose of the drilling was to test the northwestward extent of carbonatized and silicified rocks carrying erratic gold mineralization that had been exposed in bedrock by stripping and intersected in two earlier diamond drill holes. It was also suggested by the writer that a weak, but broad, electromagnetic anomaly to the northwest of the showing be tested by drilling.

## Work Done

A total of 1540 feet of drilling representing 3 holes was completed during the period Oct. 26 to Nov. 9, 1982 (see map). The drilling was monitored and supervised on the site by Roger Poulin, a Geological Technician, while the core was logged and sampled by the writer.

## Results

Hole 82-4: was collared 296 ft. in a  $N75^{\circ}W$  direction from 000E and 120N on the stripped area grid. Because of a misjudgement on the part of the Technician regarding the identity of the rock being intersected (diabase basalt/gabbro), the hole was abandoned at 84 feet and the drill moved 50 feet in a  $N40^{\circ}$  direction.

Hole 82-5: was collared at 45 degrees in a  $N50^{\circ}E$  direction about 320 feet northwest of the exposed showing on surface (see maps). From 72 feet to 360 feet the hole encountered massive diabasic to mottled basalt. From 360 ft. to 373 ft. a zone of silicified and carbonatized rocks cut by quartz veinlets with sparse pyrite were intersected. This altered zone was



split, sampled and sent for gold analysis. The remainder of the hole to 450 feet cut massive to foliated basalt.

Hole 82-6: was intended to test rocks underlying a weak electromagnetic anomaly delineated on line 300 m E by an earlier survey (see maps). After 126 feet of overburden, the hole cut chloritic diabasic to mottled basalt to 473 ft. until encountering an alteration zone from 473 ft. to 490 feet. This zone consists of light to medium green, silicified and carbonatized rocks cut by quartz veinlets but containing only traces of sulfides. These altered rocks were sampled and sent for gold analysis. The carbonatized rocks continue from 490 ft. to the end of the hole at 556 feet, but in this section very little veining and no sulfides are present. A fault zone is present at 526 feet to 530 feet.

Hole 82-7: was directed at 45 degrees in a due south direction to test an area about 100 feet to the west and northwest of the exposed showing. The radical change in direction was intended to gain a better understanding of geometry of the zones encountered in hole 82-2. For the first 395 feet the hole encountered diabasic to mottled basalt while the remainder of the hole to 450 feet intersected pillow basalt and pillow breccias. No altered zones which could have potential for gold mineralization were intersected.

#### Interpretation

The altered zone in hole 82-5 is not similar in appearance to the altered rocks exposed on surface and intersected in hole 82-2. They may however relate to those altered rocks encountered in hole 82-6.

The weak electromagnetic anomaly tested by hole 82-6 appears to be caused by conductive material in the deep overburden (100 feet) and not by any mineralized zones in the bedrock.

Although hole 82-7 intersected planar features and barren veinlets in the rock at a better angle (90 degrees) than the other hole (30 degrees), it was a complete surprise that no altered rocks were intersected. This revelation indicates the alteration exposure to be very irregular in shape and to have a shallow depth.

Conclusions

This phase of diamond drilling has demonstrated the absence of a northward extension of any significant alteration and mineralization. The two narrow zones of alteration encountered are devoid of any significant mineralization and appear to have little potential. The area of alteration exposed on surface appears to be small with little extension to depth. Combining these results with the low and erratic distribution of gold in these rocks as delineated from earlier trenching and composite sampling, the prospect appears to have very little potential of being economic.

Recommendations

Based on these negative results, no further work or expenditures are justified for this property.



November 11, 1982

Dr. William O. Karvinen

PROPERTY BOUNDARY

82-6

320°  
476 Ft.

82-5

75°  
250 Ft.

82-4

285°  
296 Ft.

82-7

82-2

82-1

120N

grid on  
stripped area

OE



1"=100'

Positions and Horizontal Projections of Diamond Drill Holes, Tesluk Property.

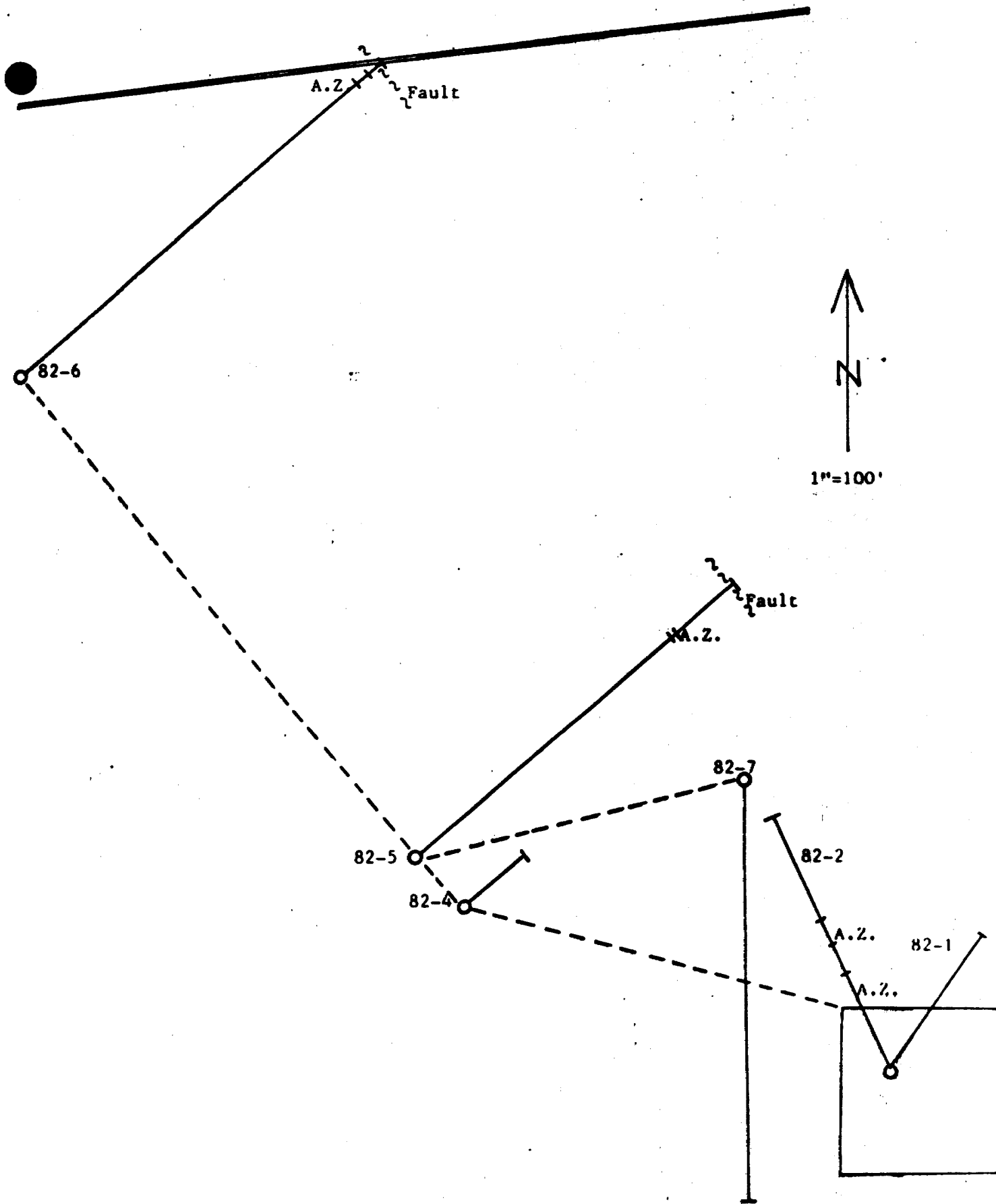

Horizontal Projection of Altered Zone (A.Z.) Intersected in Diamond Drill Holes, Tesluk Property.

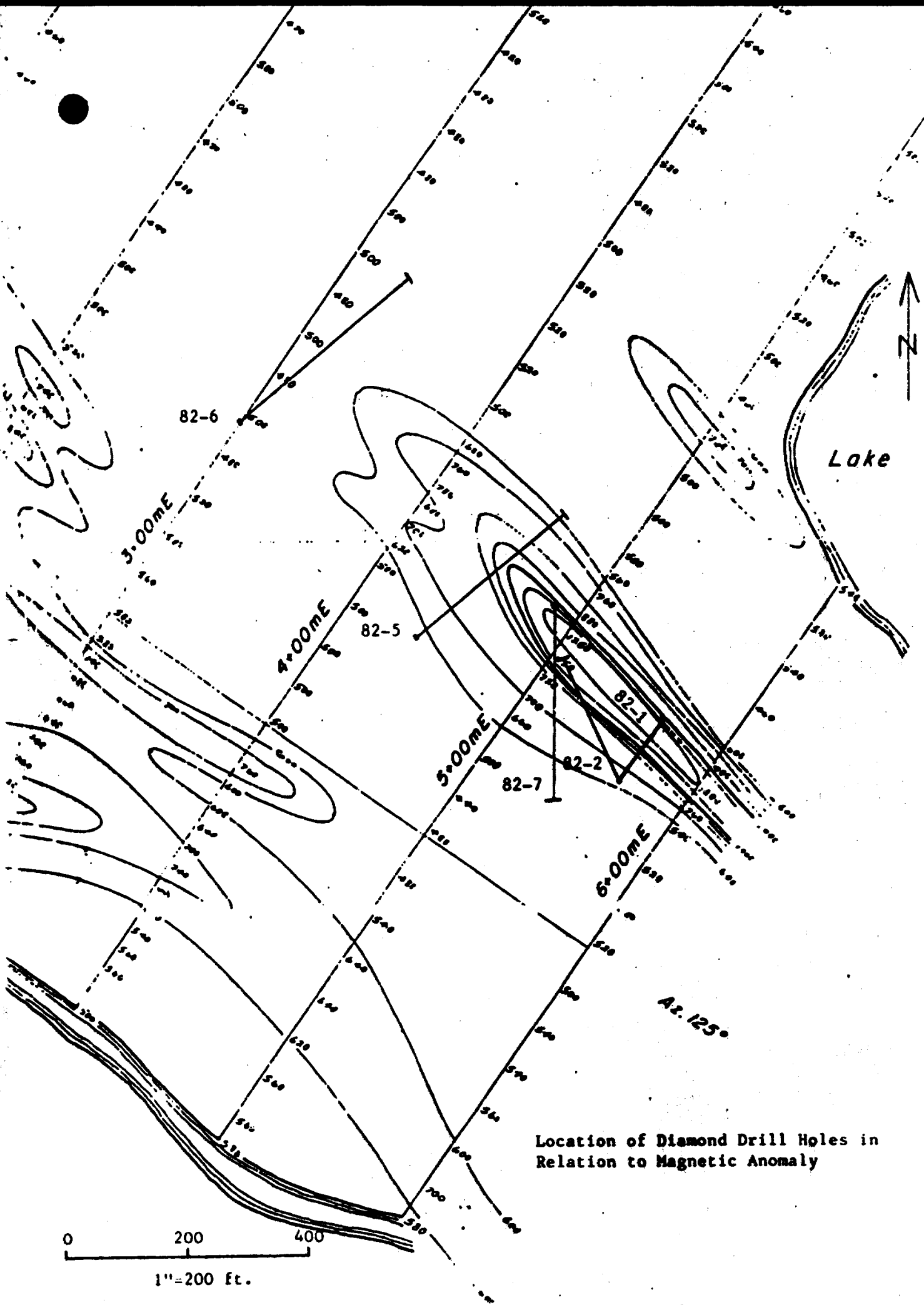

Location of Diamond Drill Holes in Relation to Magnetic Anomaly



S

N

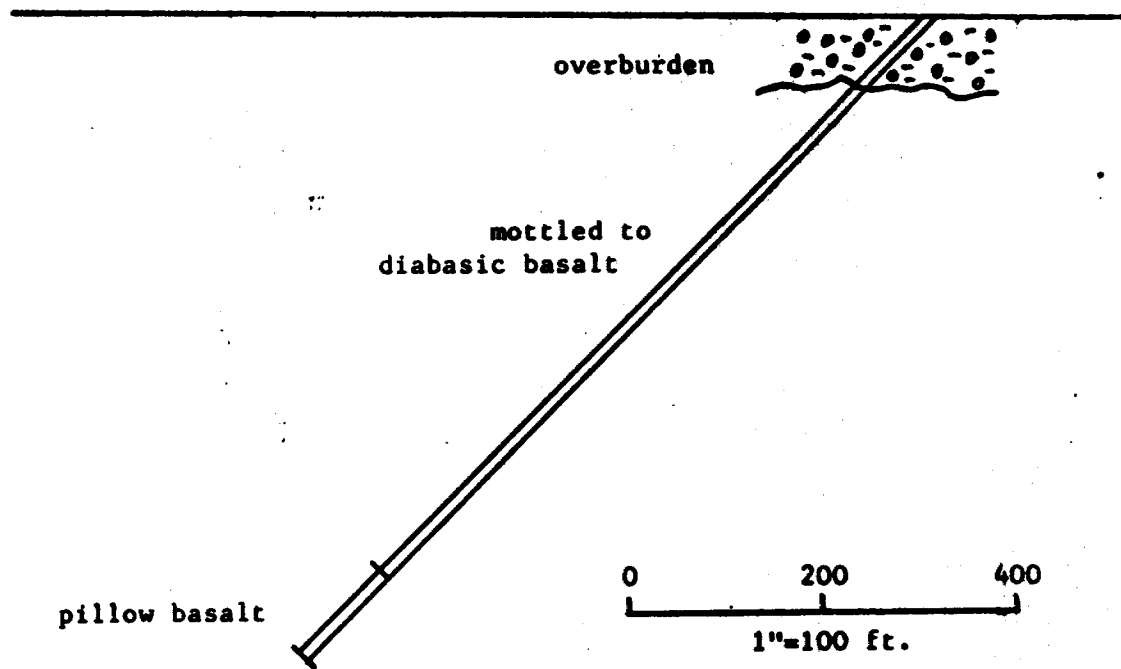

South - North Profile of Diamond Drill Hole No. 82-7

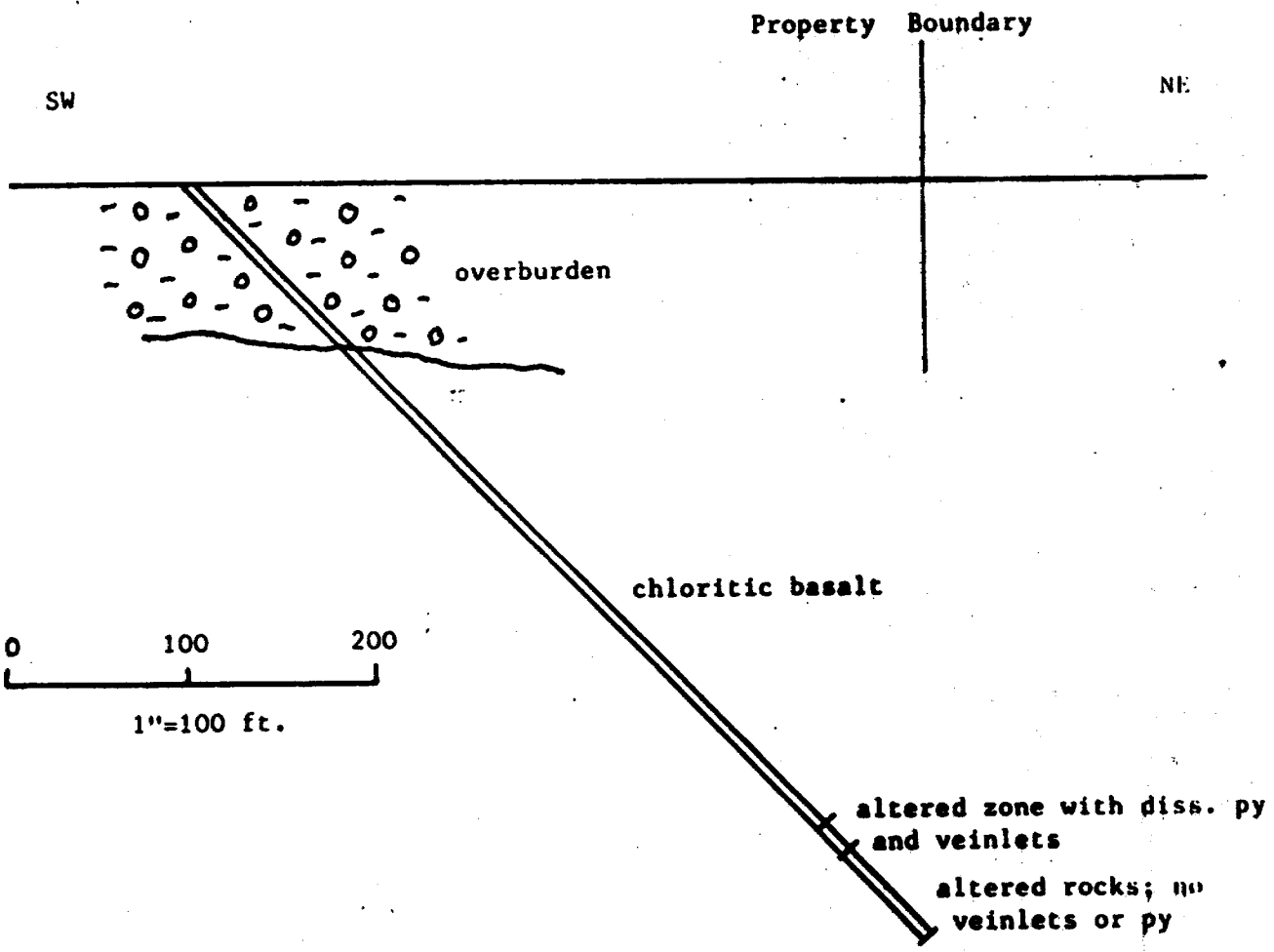

Southwest - Northeast Profile of Diamond  
Drill Hole No. 82-6



SW

NW

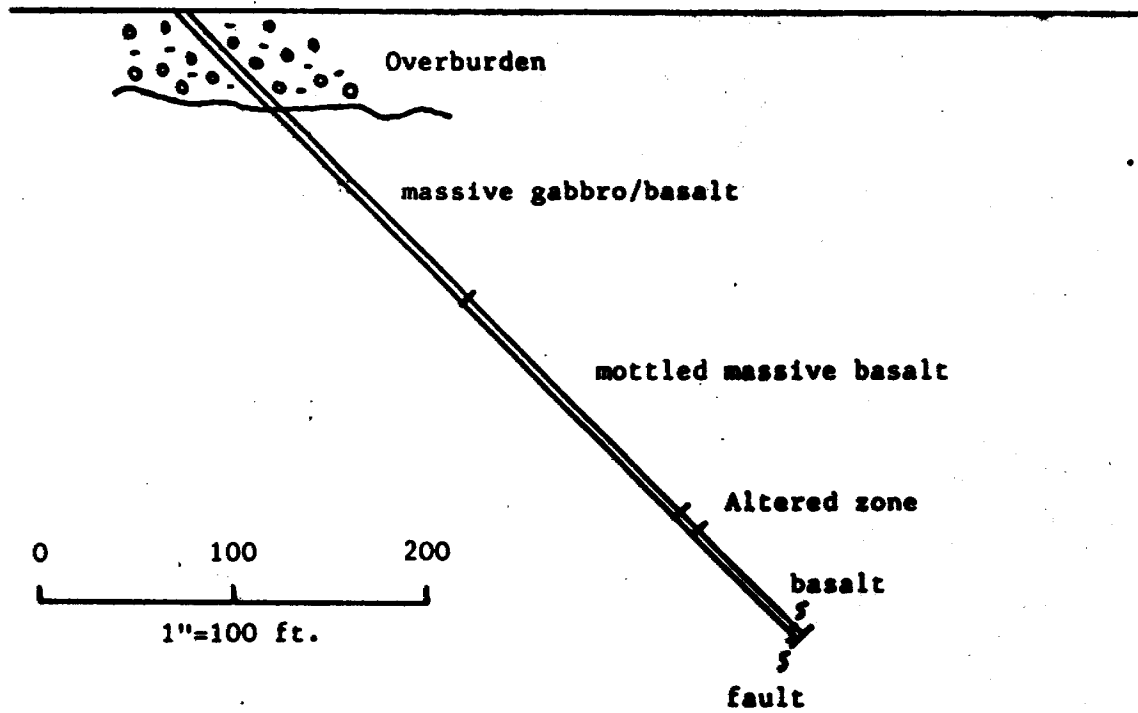

Southwest - Northeast Profile of Diamond Drill Hole No. 82-5





pond  
ng

Drilling Company <b>Dominik Drilling Ltd.</b>		Collar Elevation	Bearing of hole from true North <b>N50E</b>	Total Footage <b>450 ft.</b>	Dip of Hole at Collar <b>45</b>	Location of hole in relation to a fixed point on the claim.	Map Reference No.	Claim No. <b>P12557</b>
Date Hole Started <b>Oct. 27, 1982</b>	Date Completed <b>Oct. 30, 1982</b>	Date Logged <b>Nov. 8/82</b>	Logged by <b>W. O. Karvinen</b>		Fr.		Location (Twp., Lot, Con. or Lat. and Long.)  <b>Robb Township</b>	Property Name  <b>Tesluk</b>
Exploration Co., Owner or Optionee <b>Glory Mining &amp; Refining Ltd.</b>		Date Submitted	Submitted by (Signature) <i>W. O. Karvinen</i>		Fr.			
					Fl.			
					Fl.			

Footage		Rock Type	Description Colour, grain size, texture, minerals, alteration, etc.	Planar Feature Angle *	Core Specimen Footage †	Your Sample No.	Sample Footage		Sample Length	Assays †	
From	To						From	To			
0	72'	overburden									
72'	208'	massive gabbro/ basalt	- diabasic texture; some chlorite alteration along narrow fractures; little py in fractures; narrow qtz veinlets (2%)								
			105' - qtz with aplite 2" wide at 45° to C.A.								
			139' - 3" of barren qtz veinlets								
			147' - 1" wide qtz veinlet								
208'	360'	mottled, massive basalt	- massive, dark-green, med.-gr.; with mottled texture, altered plagioclases; narrow, barren qtz veinlets (5%)								
			251'-258' - epidote veinlets with qtz; volc. is chloritized, massive texture;								
			258' - diabasic to mottled								
			270'-281' - epidotized, diabasic basalt								
			281'-309' - mottled basalt with epidote zones, few qtz veinlets; tr. pyrite								
			309'-329' - very diabasic massive basalt								
			329'-347' - dark green, chloritized, massive basalt								
			347'-359' - massive basalt with zones rich in feldspar - "granitized"								

\* For features such as foliation, bedding, schistosity, measured from the long axis of the core

† Additional credit available. See Assessment Work Regulations

ing

Drilling Company		Collar Elevation	Bearing of hole from true North	Total Footage	Dip of Hole at Collar	Location of hole in relation to a fixed point on the claim.	Map Reference No.	Claim No.	
Date Hole Started	Date Completed	Date Logged	Logged by		Ft.		Location (Twp., Lot, Con. or Lat. and Long.)	Property Name Tesluk	
Exploration Co., Owner or Optionee		Date Submitted	Submitted by (Signature)		Ft.				
Glory Mining & Refining Ltd.			<i>W. D. Karvinen</i>		Ft.				

Footage		Rock Type	Description Colour, grain size, texture, minerals, alteration, etc.	Planar Feature Angle *	Core Specimen Footage †	Your Sample No.	Sample Footage		Sample Length	Assays ‡	
From	To						From	To			
360'	373'	silicified zone	360'-373' - silicified, altered zone with qtz. veinlets, diss. cubic pyrite; light green to dark green								
			360'6"-362'6" - silicified, altered; minor py (3%); 1-2 mm qtz veins at 40° to C.A.			38136			2'		
			362'6"-363'6" - gray carb basalt; 2% py cubes; qtz veinlets			38137			1'		
			363'6"-369'4" - epidote-silic. crs. gr. carb basalt; veinlets			38138			2'10"		
			369'4"-371'6" - epidote-carb basalt; tr. py; qtz veinlets			38139			2'2"		
			371'6"-373' - epidote-crs. gr. basalt, py cubes; veinlets			38140			2'4"		
373'	450'	basalt	- massive to foliated; mottled or diabasic; few barren veinlets								
			373'-380' - very dark, massive, med-gr. basalt - magnetic?								
			380'-405' - massive, med.-gr., mottled basalt; no veinlets - epidote veins here & there								
			405'-426' - fine to med-gr. massive, dark basalt								
			426'-436' - light gray mottled basalt; few veinlets; slightly bleached; tr. py								
			436'-441' - dark, massive, basalt								
			441'-450' - sheared, light-green basalt qtz & calcite veinlets - fault gouge (2") at 449' - 45' to CA								
450'		end of hole									

\* For features such as foliation, bedding, schistosity measured from the long axis of the core. † Additional credit available. See Assessment Work Reg. at 018.

# Drilling Log

Fill in on every page Hole No. 82-6  
Page No. 1

Drilling Company <b>Dominik Drilling Ltd.</b>		Collar Elevation	Bearing of hole from True North <b>N50E</b>	Total Footage <b>556</b>	Dip of Hole at Collar <b>45</b>	Location of hole in relation to a fixed point on the claim.	Map Reference No.	Claim No. <b>82-6</b>
Date Hole Started <b>Oct. 31, 1982</b>	Date Completed <b>Nov. 6, 1982</b>	Date Logged <b>Nov. 9&amp;11/82</b>	Logged by <b>W.O. Karvinen</b>		Fl.		Location (Twp., Lot, Con. or Lat. and Long.)  <b>Robb Township</b>	
Exploration Co., Owner or Optionee  <b>Glory Mining &amp; Refining Ltd.</b>		Date Submitted	Submitted by (Signature)  <i>W.O. Karvinen</i>		Fl.			
					Fl.			

Footage		Rock Type	Description <small>Colour, grain size, texture, minerals, alteration, etc.</small>	Planar Feature Angle *	Core Specimen Footage †	Your Sample No.	Sample Footage		Sample Length	Assays †	
From	To						From	To			
0	126'	overburden									
126'	426'	chloritic basalt	126'-136' - vuggy, weathered, amygdaloidal pillow basalt								
			136'-185' - diabasic to mottled basalt, very chloritic; few vugs; some epidote; subby, weathered								
			185'-426' - diabasic, massive basalt, fresh; few flow tops or interflow sections; narrow zones of epidotization; narrow barren qtz. veinlets here & there								
			426'-433' - dark, massive, black, med-gr.; looks almost like an ultramafic; magnetic?								
			433'-453' - green-gray, mottled, med. gr. basalt; few barren qtz. veinlets								
			453'- - 6" of rusty fault gouge; silicified								
			453'-465' - med-gr. gray-green basalt; feathery texture								
			465'-473' - fine-gr. gray-green basalt; few barren qtz veinlets; very dark in places								
473'	490'	altered zone	473'-475' - massive, light gray-green; barren qtz vein (1") at 474'			38144			2'		
			475'-478' - light gray-green carbed&silicified; cut by numerous qtz veinlets			38145			3'		

\* For features such as foliation, bedding, schistosity, measured from the long axis of the core

**Diamond  
Drilling  
Log**

Fill in on  
every page

Hole No.  
82-6

Page No.  
2

Date Hole Started		Date Completed	Collar Elevation	Direction of hole from true North	Total Footage	Dip of Hole at Collar 45	Location of hole in relation to a fixed point on the claim.	Map Reference No.	Claim No.	
Exploration Co., Owner or Optionee		Date Logged	Date Submitted	Logged by	Submitted by (Signature)	Fl.		Location (Twp., Lot, Con. or Lat. and Long.)	Property Name	
Glory Mining & Refining Ltd.				W. O. Karvinen	<i>W O Karvinen</i>	Fl.			Tesluk	
						Fl.				

Footage		Rock Type	Description Colour, grain size, texture, minerals, alteration, etc.	Planar Feature Angle *	Core Specimen Footage †	Your Sample No.	Sample Footage		Sample Length	Assays †	
From	To						From	To			
			478'-481' - light gray-green carbed & silc.; cuty by numerous qtz veinlets			38146			3'		
			481'-484' - same as above			38147			3'		
			484'-486' - same as above; trace pyrite; black chlorite in veins			38148			2'		
			486'-498' - gray-green, massive, altered rock; few qtz veinlets			38149			4'		
490'	556'	altered pillow breccia/basalt	- gray-green, fine-gr. carbed pillow bx and massive basalt; no sulfide, no veinlets of qtz; chlorite in fractures								
			496'-498' - reddish calcite or anhydrite in pillow breccia								
			503'-513' - gray-green, mass carb. pillow basalt								
			513'-526' - light gray-green carbed pillow breccia; no sulfides - few ankerite veinlets								
			526'-530' - fault gouge with barren qtz; sericite & chlorite								
			530'-550' - well-sheared, gray green, carbed pillow bx; no sulfides few barren qtz veinlets shearing at 45° to C.A.								
			550'-556' - more massive, foliated, carbed gray-green basalt								
556'		end of hole									

\* For features such as foliation, bedding, schistosity, measured from the long axis of the core

† Additional credit available. See Assessment Work Reg. 3





