



42A12SE0442 13 GODFREY

010

Diamond Drilling

Township of Godfrey

Report NO: 13

Work performed by: Consolidated Brewis Minerals Ltd.

| Claim NO | Hole NO | Footage | Date | Note |
|----------|---------|---------|---------|------|
| P 52273 | 1 | 270' | July/64 | |
| | 2 | 264' | July/64 | |
| P 52271 | 15 | 250' | Oct/64 | |

Notes:

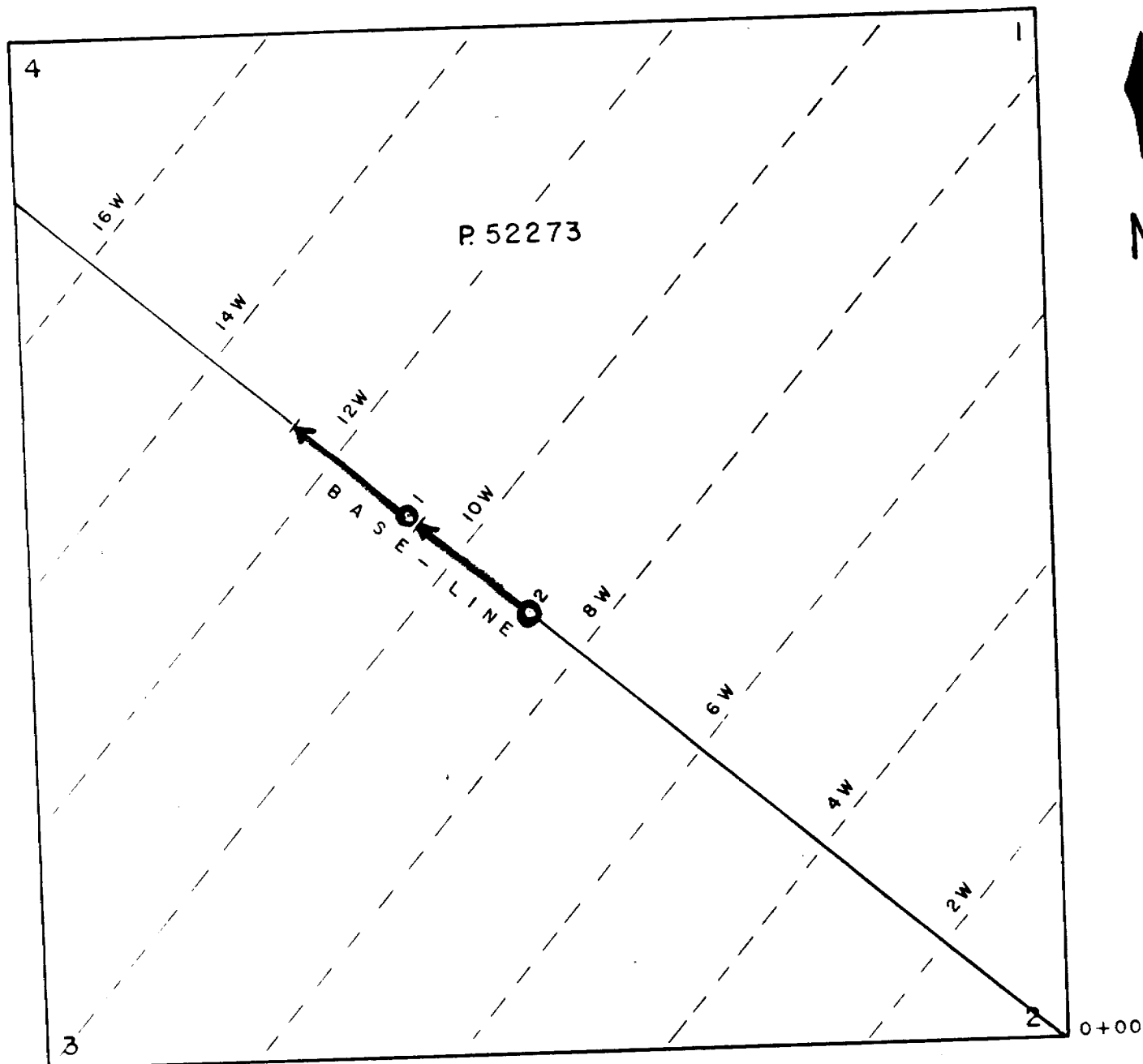

DIAMOND DRILL HOLES - ASSESSMENT WORK
 CONSOLIDATED BREWIS MINERALS LTD.

GODFREY TWP.

SCALE - 1 INCH = 200 FEET

M.A. 7/64

2-115

DIAMOND DRILL RECORD

PROPERTY CONSOLIDATED BREWIS MINERALS LTD. HOLE NO. 1
 (GODFREY GROUP. P52273)

SHEET NUMBER _____ SECTION FROM _____ TO _____
 LATITUDE _____ DATUM _____
 DEPARTURE _____ BEARING NORTHWEST
 ELEVATION _____ DIP 45°

STARTED JULY 6, 1964
 COMPLETED JULY 11, 1964
 ULTIMATE DEPTH 270.0
 PROPOSED DEPTH _____

| DEPTH FEET | FORMATION | SAMPLE No. | WIDTH OF SAMPLE | GOLD \$ | SLUDGE GOLD \$ |
|-------------|---|------------|-----------------|---------|----------------|
| 0-10.0 | CASING | | | | |
| 10.0-102.2 | BASIC LAVAS, PORPHYRITIC SECTIONS NUMEROUS QTZ + CALC. STRS. 60.5-61.0 FRACTURED 75.0-77.0 - IRREGULAR SPLASHES OF QTZ, CHLORITE, SERICITE. | | | | |
| 102.2-270.0 | BASIC LAVAS, CHAORTIC, NUMEROUS QTZ STRS. AT 102.2 - 1" QTZ AT 125.3 - 2" QTZ 135.4-136.1 - FRACT'D 140.6-141.0 - QTZ, CHLORITE AT 208.5 - FRACTURE ACUTE TO CORE CPY + PYR ON SLIP | | | | |
| AT 270.0 | END OF HOLE | | | | |

DRILLED BY Bendley Bros.

SIGNED Ronald J. Turner B.Sc. P. P.

DIAMOND DRILL RECORD

PROPERTY CONSOLIDATED BREWIS MINERALS LTD. HOLE NO. 2
 (GODFREY)

SHEET NUMBER _____ SECTION FROM _____ TO _____ STARTED July 12, 1964
 LATITUDE _____ DATUM _____ COMPLETED July 15, 1964
 DEPARTURE _____ BEARING NORTHWEST ULTIMATE DEPTH 264.0
 ELEVATION _____ DIP 45° PROPOSED DEPTH _____

| DEPTH FEET | FORMATION | SAMPLE NO. | WIDTH OF SAMPLE | GOLD \$ | SLUDGE GOLD \$ |
|------------|--|------------|-----------------|---------|----------------|
| 0-7.0 | CASING | | | | |
| 7.0-40.3 | PORPHYRY, NUMEROUS QTZ STRS., 1 DOLYK (PURE) | | | | |
| 40.3-191.5 | ANDESITE, LESS THAN 10% PYR. | | | | |
| | 185.0-187.0 - FRACT'D & BROKEN | | | | |
| | AT 94.5 - 4" QTZ VUGGY, RUSTY | | | | |
| | 191.5-202.0 - LIGHT BUFF PORPHYRY | | | | |
| | 191.5 202.0-215.4 - GREY PORPHYRY | | | | |
| | 215.4 - 264.0 - ANDESITE | | | | |
| | 229.8-232.5 - BRECCIA VERY SILICEOUS | | | | |
| | 241.2-247.0 - PORPHYRY | | | | |
| 264.0 | END OF HOLE | | | | |

DRILLED BY BRADLEY BEES

SIGNED Ralph Turner

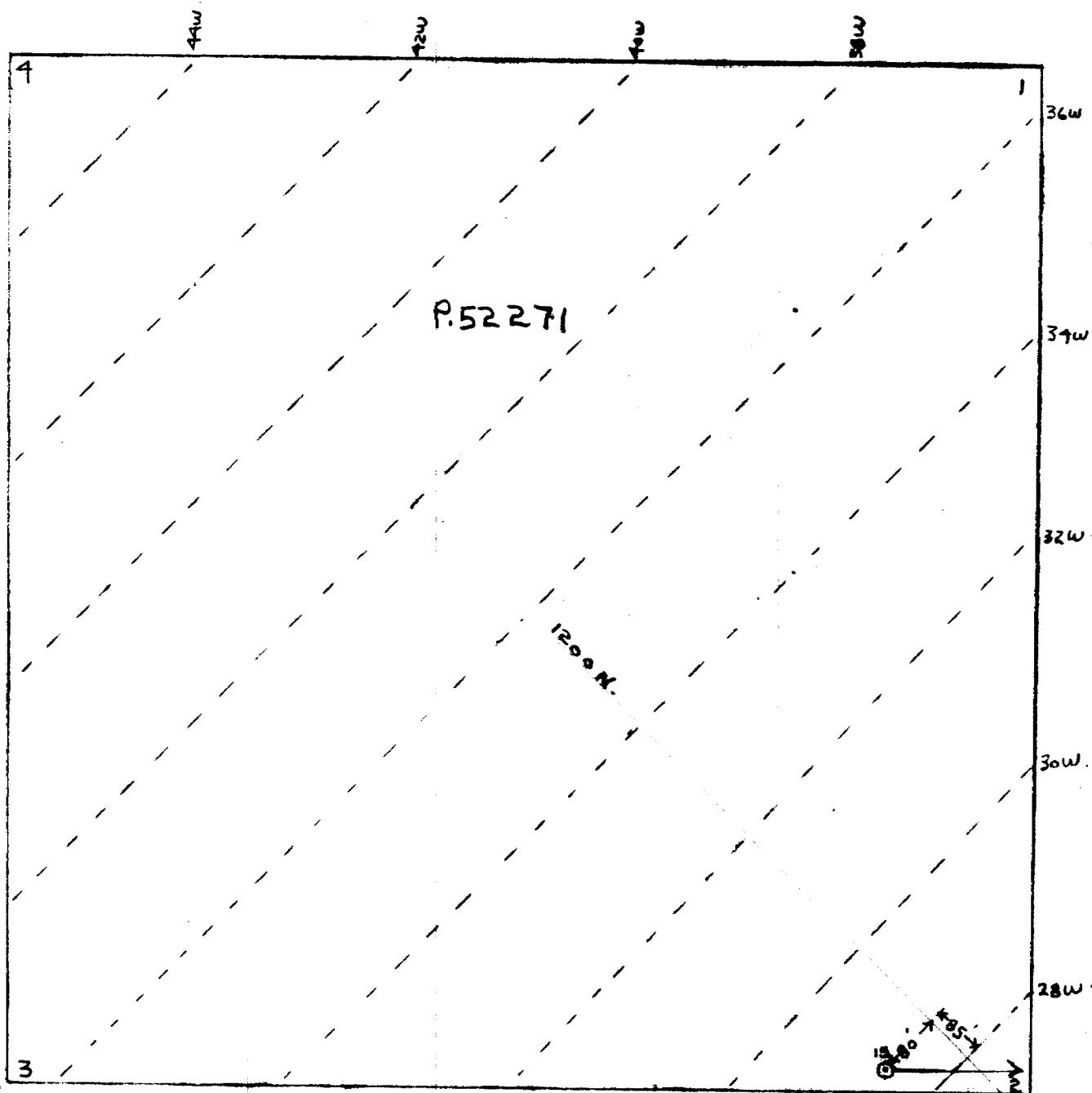

DIAMOND DRILL HOLE — ASSESSMENT WORK
CONSOLIDATED BREWIS MINERALS LTD.

GODFREY TWP

SCALE - 1 INCH = 200 FEET

M.A. 12/64

DIAMOND DRILL RECORD

1-114

PROPERTY CONSOLIDATED BROWN MINERALS LTD. HOLE NO. 15

SHEET NUMBER _____

SECTION FROM GODFREY TWP. P.52271 TO _____

STARTED OCT. 4 - 1964

LATITUDE 80° 5' OF 12N

DATUM _____

COMPLETED OCT. 6 - 1964

DEPARTURE 2885' W.

BEARING EAST.

ULTIMATE DEPTH 250'

ELEVATION _____

DIP -45°

PROPOSED DEPTH _____

| DEPTH FEET | FORMATION | SAMPLE NO. | WIDTH OF SAMPLE | GOLD g | SLUDGE GOLD g |
|--------------|--|------------|-----------------|--------|---------------|
| 0 - 19.0 | CASING. | | | | |
| 19.0 - 250.0 | LAUA. | | | | |
| | 35.0 - 37.5 SCATTERED CPY., PYR. | | | | |
| | 47.0 - 50.5 - 1" QTZ. II TO CORE | | | | |
| | 75.0 - 96.0 - WEAK BRECCIA | | | | |
| | BLEB ZNS. PYR. AT 112.5 | | | | |
| | AT 123.3, 3" QTZ. & CALCITE | | | | |
| | AT 128.2, 1" CPY., PYR., ZNS. | | | | |
| | 132.0 - 140.0 BROKEN UP; FRAS'D. | | | | |
| | 133.8 - 134.3 MISSING CORE. | | | | |
| | 135.5 - 136.2 " " | | | | |
| | 137.5 - 138.7 " " | | | | |
| | 139.1 - 139.8 " " | | | | |
| | 147.8 - 148.7 " " | | | | |
| | 150.0 - 175.0 - SCATTERED FINE PYR. & ZNS. | | | | |
| | 172.5 - 174.7 - LEACHED; PITTED. | | | | |
| 250.0 | END OF HOLE. | | | | |

DRILLED BY A. McKNIGHT DRILLING _____

SIGNED _____

Robert I. Flemer