



42A12SE0446 2.14608 GODFREY

010

PROGRESS REPORT  
 ON THE  
 HARRINGTON GOLD  
 OCCURRENCE  
 TRENCHING & SAMPLING  
 PROGRAM  
 IN  
 GODFREY TOWNSHIP  
 NORTHERN ONTARIO

2.14608

RECEIVED

JUN 10 1992

MINING LANDS BRANCH

MAR 10/92

By: J.K. Fild  
 HBS Geology



42A12SE0446 2.14608 GODFREY

010C

### TABLE OF CONTENTS

INTRODUCTION .....	1
PROPERTY LOCATION & ACCESS .....	1
PROPERTY HISTORY .....	2
ECONOMIC GEOLOGY & WORK REPORT DISCUSSION .....	2
CONCLUSIONS .....	5

### FIGURES

- FIG #1 - GENERAL LOCATION MAP
- FIG #2 - CLAIM LOCATION MAP
- FIG #3 - WORK LOCATION MAP ON CLAIM

### Appendix

- Appendix I - ORIGINAL ASSAY SHEETS
- Appendix II - WORK DIARY

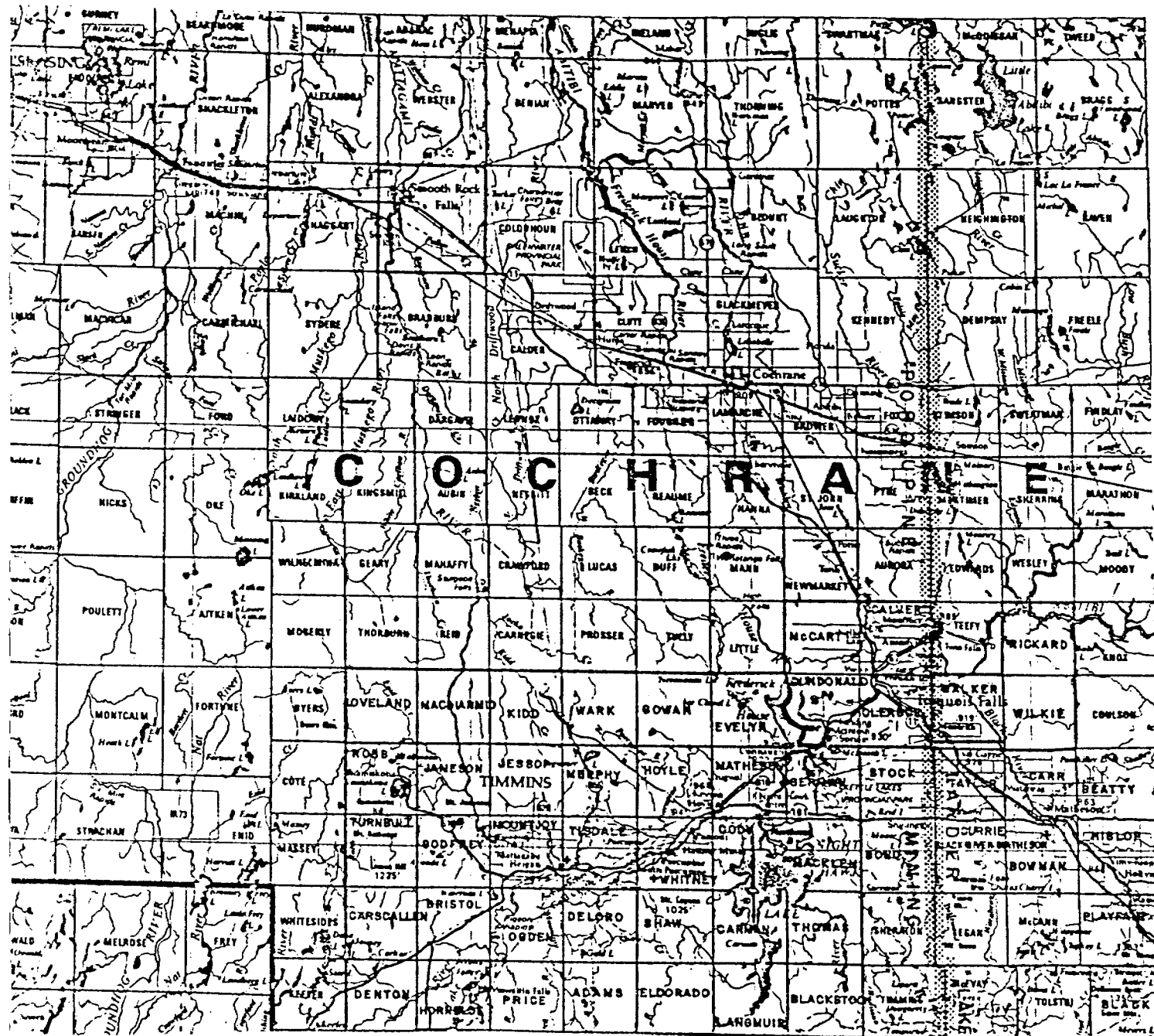

FIG 1: GENERAL LOCATION MAP  
 (●) PROPERTY

## INTRODUCTION

The purpose of this brief report is to document the progress on trenching and sampling carried out on the Harrington gold occurrence to fulfill assessment requirements. This author has only recently become involved with this project and has not visited the property. Details on work carried out have been provided by the prospector C. Harrington. Geological descriptions have been taken from field notes given to Mr Harrington by corporate geologists who have visited the subject property. Such companies included Falconbridge Exploration and Rio Algom Exploration.

## PROPERTY LOCATION & ACCESS

The property presently consists of three contiguous claims numbered 1155087, 1132988, and 1132989 located in the N 1/2 of Lot 8, Con III Godfrey Twp. (See Fig 142).

Access to the property is obtained by driving west of Timmins along Highway 101 to Highway 576. At Highway 576 one turns north and continues to the Kam-Kotia club road; one then proceeds along this road to the ski club.

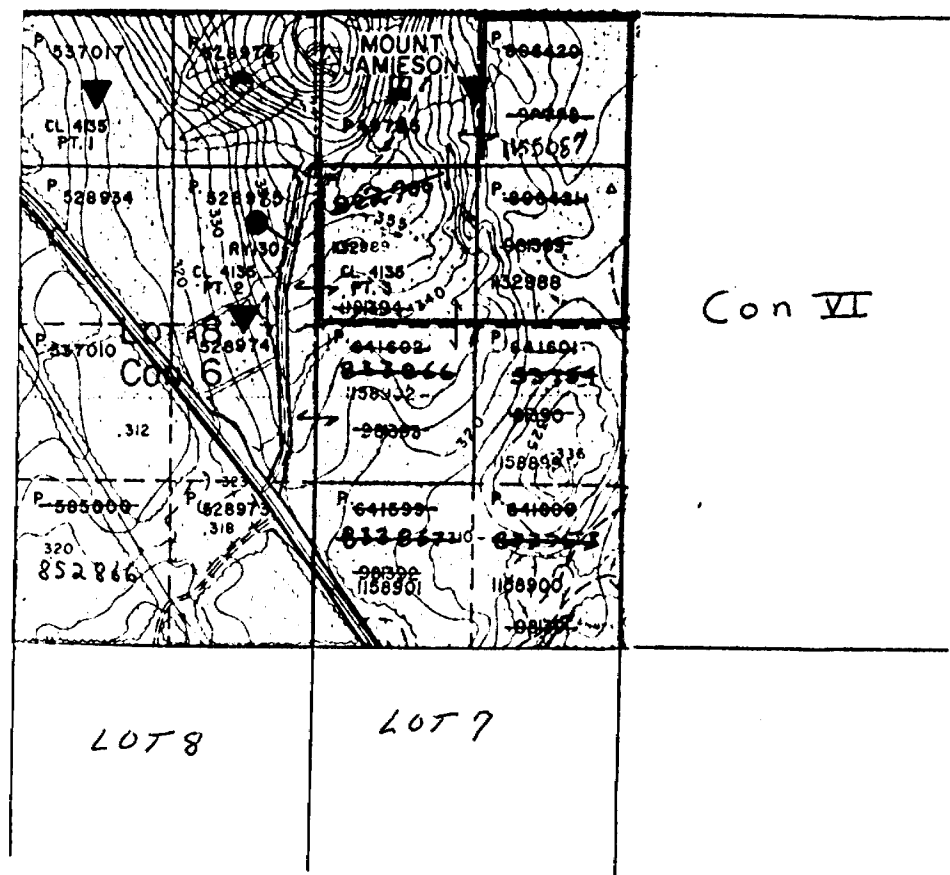

Fig #2 : CLAIM LOCATION MAP  
(-) PROPERTY

From there the claim group is accessible via a short trail.

### PROPERTY HISTORY

Over the years a few companies have owned this prospect but all documented exploration work appears to have been related to base metal exploration. No drilling of any sort has been done for gold and no drilling has been carried out on the new Harrington occurrence except for a hole by C. Harrington. This hole was drilled in an attempt to reach the vein. However, it had to be abandoned due to blocky ground & stuck rods, prior to intersecting the vein. This core will be logged at a later date and the results of this work presented in a future report.

### ECONOMIC GEOLOGY & WORK REPORT DISCUSSION

As stated previously the author has not visited this prospect to date. Data on the prospect has been supplied by Mr. Harrington's notes & from rough field notes from company geologists which Mr. Harrington also possessed.

The occurrence is located on claim 1132989 approximately 100m south of the number one

PATENT

CLAIM #  
1155087

CLAIM #  
1132989

CLAIM #  
1132988

3  
POST  
4  
POST

1  
POST

100M

NEW TRENCH (B)  
3.04M LONG  
0.76M WIDE  
0.30M DEEP

ORIGINAL TRENCH (A)  
3.96 M LONG  
0.76 M WIDE  
0.91 M DEEP (ORIGINALLY)  
REBLASTED & DEEPEMED BY 0.3M  
TOTAL DEPTH NOW 1.21M  
ALL GRAB SAMPLES TAKEN  
FROM THIS TRENCH!

(C)  
LENGTHENED ORIGINAL TRENCH  
BY 1.5M WIDTH 0.76M DEPTH 1.21M

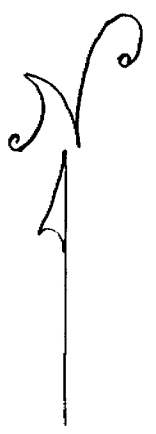

0 5 10 m.

FIG #3  
TRENCH LOCATION  
MAP

post (Fig#3). All work to date has been concentrated on the main occurrence and no other work has been done on other portions of the block.

Sketches show that the vein strikes at roughly  $335^{\circ}$  Az and the dip is estimated to be  $15^{\circ}$  SW. Rough notes from Falconbridge exploration state that the occurrence consists of a well mineralized quartz vein ranging in thickness from 10cm to 50cm. Mineralization in the vein consisted of sphalerite, chalcopyrite, galena & pyrite. From personal communication with Falconbridge geologists it appears that the vein is within a break within a package of felsic volcanics. Rio Algom geologists field notes mention that there is some brecciation associated with the vein contact and fine pyrite is present. An assay from Rio Algom on this contact assayed 0.42oz/ton Au. Also a sample of vein material once again from Rio Algom assayed 0.31oz/ton Au. This vein is reported to exist intermittently over a strike length of roughly 100'.

Work to date has consisted of trenching and sampling of the main gold occurrence. Initially a 3.96m trench was blasted along the vein. (previously reported) Since that time the initial trench has been deepened & extended 15m



along strike and a second trench 3m long has been blasted a short distance north of the original trench.

A number of samples by Mr Harrington (grab samples) were taken from the main trench and also by Falconbridge & Rio Algom & a government geologist. Results for Au, Ag, Cu, Pb, Zn were variable. The ranges for these elements are as follows. Original assay sheets for all samples are given in Appendix I

Au RANGE	150 pph	to	0.42 oz / ton Au
Ag RANGE	nil	to	2.38 oz / ton Ag
Cu RANGE	0.0042	to	0.142 Cu
Pb RANGE	0.0032	to	0.382 Pb
Zn RANGE	0.0022	to	0.142 Zn

As stated previously upon completion of trenching an attempt was made to diamond drill the vein unsuccessfully due to ground conditions. A separate report will later document the rock found on the hanging wall of the vein.

## Conclusions & Recommendations

In light of reasonably encouraging gold values on this prospect a limited follow up program should be considered for this claim group. Such a program should consist of:

- 1) A control grid establishment over the three claims
- 2) Carry out a prospecting program over the area to locate any other zones of interest
- 3) Carry out limited geophysics i.e. MAG, and VLF
- 4) Continue trenching the main zone to follow the system as far as possible
- 5) Carry out a thorough chip sampling program on the vein

Respectfully Submitted  
J. J. [Signature] HBS& Geology

Appendix F  
ASSAY Appendix

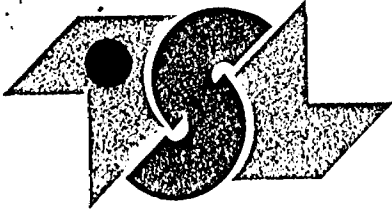

# T S L LABORATORIES

DIVISION OF BURGNER TECHNICAL ENTERPRISES LIMITED

2031 RIVERSIDE DRIVE, UNIT #2

TIMMINS, ONTARIO

P4N 7C3

☎ (705) 268-4441 FAX: (705) 268-4420

## CERTIFICATE OF ANALYSIS

SAMPLE(S) FROM C. Harrington  
82 Theriault Blvd.  
Timmins, Ontario  
P4N 5B5

REPORT No.  
W3916

INVOICE #: 3829  
P.O.:

SAMPLE(S) OF rock

	Au ppb	<sup>Au</sup> oz/t	Ag ppm	<sup>As</sup> oz/t
LNL-90-11	450	0.013	4.0	0.117
LNL-90-12	150	0.004	1.0	0.029

COPIES TO: C. Harrington  
INVOICE TO: C. Harrington

Apr 23/90

SIGNED \_\_\_\_\_



For enquiries on this report, please contact Customer Service Department.  
Samples, Pulps and Rejects discarded two months from the date of this report.

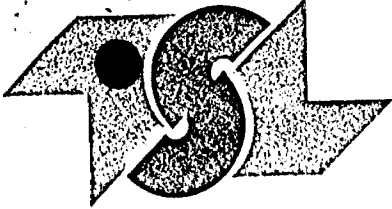

# T S L LABORATORIES

DIVISION OF BURGNER TECHNICAL ENTERPRISES LIMITED

2031 RIVERSIDE DRIVE, UNIT #2

TIMMINS, ONTARIO

P4N 7C3

☎ (705) 268-4441 FAX: (705) 268-4420

## CERTIFICATE OF ANALYSIS

SAMPLE(S) FROM Charles Harrington  
Therriault Blvd.  
Timmins, Ontario

268-5640

REPORT No.  
W4550

INVOICE #: 4471

P. O. :

SAMPLE(S) OF rock

	Au ppb	Ag ppm
Godfrey	225	0.4

COPIES TO: Timmins  
INVOICE TO: Timmins

Aug 23/90

SIGNED \_\_\_\_\_

Page 1 of 1



For enquiries on this report, please contact Customer Service Department.  
Samples, Pulps and Rejects discarded two months from the date of this report.

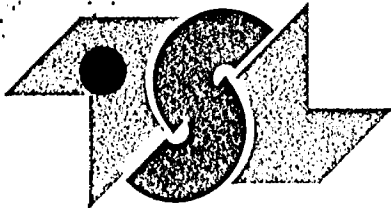

# T S L LABORATORIES

DIVISION OF BURGNER TECHNICAL ENTERPRISES LIMITED

2031 RIVERSIDE DRIVE, UNIT #2

TIMMINS, ONTARIO

P4N 7C3

☎ (705) 268-4441 FAX: (705) 268-4420

## CERTIFICATE OF ANALYSIS

SAMPLE(S) FROM Charles Harrington  
Therault Blvd.  
Timmins, Ontario

REPORT No.

W4120

SAMPLE(S) OF Rock

INVOICE #: 4047

P. O. :

	Au ppb	Au ozpt	Ag ppm	Ag ozpt	Ni ppm
- A -	>1000	0.047	>20	3.32	10

COPIES TO: Timmins  
INVOICE TO: Timmins

Jun 22/90

SIGNED \_\_\_\_\_



For enquiries on this report, please contact Customer Service Department.  
Samples, Pulps and Rejects discarded two months from the date of this report.

Page 1 of 1

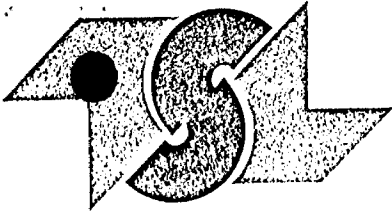

3

# T S L LABORATORIES

DIVISION OF BURGNER TECHNICAL ENTERPRISES LIMITED

2031 RIVERSIDE DRIVE, UNIT #2  
TIMMINS, ONTARIO  
P4N 7C3

☎ (705) 268-4441 FAX: (705) 268-4420

## CERTIFICATE OF ANALYSIS

SAMPLE(S) FROM Charles Harrington  
82 Theriault Blvd.  
Timmins, Ontario

268-5640

REPORT No.

W3948

SAMPLE(S) OF rock

INVOICE #: 3864  
P. O.:

REMARKS: Results in ozpt.

	Au ozpt	Ag ozpt
- A -	0.105	0.402

*I had read this wrong  
to you yesterday. bears a reading  
of my assays, and some rock.  
Keep this assay report I like to  
keep it a THANKS!*

COPIES TO: Charles Harrington  
INVOICE TO: Charles Harrington

May 09/90

SIGNED \_\_\_\_\_



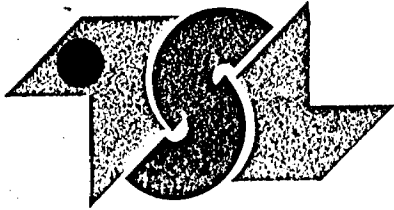

# T S L LABORATORIES

DIVISION OF BURGNER TECHNICAL ENTERPRISES LIMITED

2031 RIVERSIDE DRIVE, UNIT #2

TIMMINS, ONTARIO

P4N 7C3

☎ (705) 268-4441 FAX: (705) 268-4420

## CERTIFICATE OF ANALYSIS

SAMPLE(S) FROM Charles Harrington  
82 Theriault Blvd.  
Timmins, Ontario

REPORT No.  
W4757

SAMPLE(S) OF rocks

INVOICE #: 4725  
P. O. :

	Au ozpt
A -	0.024
B -	0.022

COPIES TO: Charles Harrington  
INVOICE TO: Charles Harrington

Oct 03/90

SIGNED \_\_\_\_\_



For enquiries on this report, please contact Customer Service Department.  
Samples, Pulps and Rejects discarded two months from the date of this report.



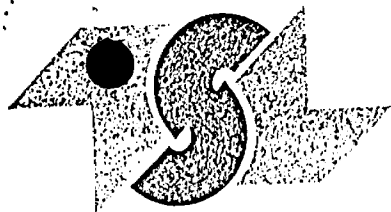

2

# T S L LABORATORIES

DIVISION OF BURGNER TECHNICAL ENTERPRISES LIMITED

2031 RIVERSIDE DRIVE, UNIT #2

TIMMINS, ONTARIO

P4N 7C3

☎ (705) 268-4441 FAX: (705) 268-4420

## CERTIFICATE OF ANALYSIS

SAMPLE(S) FROM Charles Harrington  
82 Theriault Blvd.  
Timmins, Ontario

REPORT No.

W3937

268-5640

INVOICE #: 3852

P. O. :

SAMPLE(S) OF rock

REMARKS: Would like results in ozpt.

	Au ozpt	Ag ppm	Ag ozpt	Cu ppm	Zn ppm
- A -	0.029	8.4	0.245	915	1140

COPIES TO: C. Harrington  
INVOICE TO: C. Harrington

May 03/90

SIGNED

For enquiries on this report, please contact Customer Service Department.  
Samples, Pulps and Rejects discarded two months from the date of this report.

Page 1 of 1



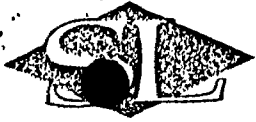

Established 1928

# Swastika Laboratories

A Division of Assayers Corporation Ltd.

Assaying - Consulting - Representation

0W-0623-RA1

## Assay Certificate

Company: MR. RALPH E. ALLERSTON  
Project:  
Attn: MR. RALPH E. ALLERSTON

Date: MAY-11-90  
Copy 1. 543 PINE ST. NORTH, TIMMINS, ONT. P4N 6L9

We hereby certify the following Assay of 1 ROCK samples submitted MAY-10-90 by MR. RALPH E. ALLERSTON.

Sample Number	Au oz/ton	Au check oz/ton	Ag oz/tonne
#230	0.042	0.040	2.38

*Charles Harrington*

Certified by *G. Lebel*  
G. Lebel / Manager



# Swastika Laboratories

A Division of Assayers Corporation Ltd.

Assaying - Consulting - Representation

## Geochemical Analysis Certificate

1W-2989-RG1

Company: RALPH E. ALLERSTON

Date: MAY-29-91

Project:

Copy 1. 543 PINE NORTH TIMMINS, ONT. P4N-6L9

Attn:

We hereby certify the following Geochemical Analysis of 1 ROCK samples submitted MAY-28-91 by .

Sample Number	Au ppb	Au check ppb
236	1195	1155

NOTE: GOLD  
APP. .0402 TROY

*Ralph E. Allerston*

Au was determined using 1 AT fusions

Certified by Donna Gardner



Ministry of  
Northern Development  
and Mines

Temiskaming  
Testing  
Laboratories

P.O. Box 799  
Presley St.  
Cobalt, Ontario  
P0J 1C0  
(705) 679-8313

Report Number  
CB 11446

Laboratory Report

Date Aug. 16, 1990

Issued To: P.J. Sangster, Staff Geologist, MNDM, 60 Wilson Ave., Timmins, Ont. P4N 2S7

Sample Number	Gold Oz. Per Ton	Silver Oz. Per Ton	Cu%	Pb%	Zn%
<i>LNL-90-14</i>					
LNL-90-17	0.023	Nil	0.004	0.005	0.012
LNL-90-18	0.034	Trace	0.006	0.013	0.007
LNL-90-19	0.044	Nil	0.007	0.003	0.012

*C. Harrington*  
*Good Frey Tap.*

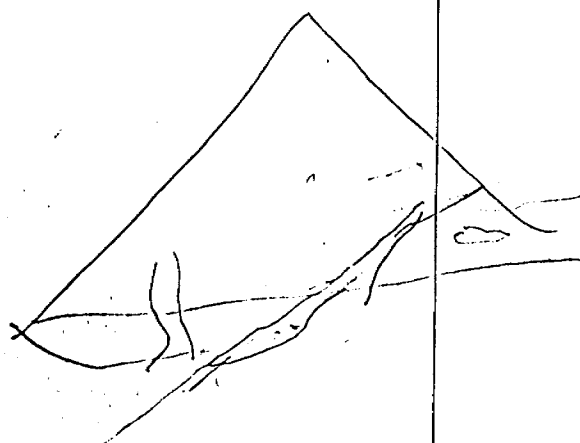

Fees Received Ministry

*10*  
*W*  
*X X X*  
*S*  
*A*  
*D*

*John for*

L. Owsicki  
Manager (Acting)

Except by special permission, reproduction of these results must include any qualifying remarks made by this ministry with reference to

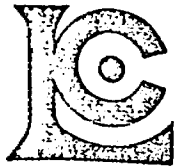

# Chemex Labs Ltd.

Analytical Chemists \* Geochemists \* Registered Assayers  
5175 Timberlea Blvd., Mississauga,  
Ontario, Canada L4W 2S3  
PHONE: 416-624-2806

To: RIO ALGOM EXPLORATION INC.

P.O. BOX 470  
TIMMINS, ON  
P4N 7E3

Project: 9102  
Comments: ATTN: R. ARCHER

Page Number : 1  
Total Pages : 1  
Certificate Date: 22-JUL-91  
Invoice No. 9117723  
P.O. Number

## CERTIFICATE OF ANALYSIS A9117723

SAMPLE DESCRIPTION	PREP CODE	Au ppb FA+AA	Ag ppm	Co ppm	Cu ppm	Fe %	Mn ppm	Mo ppm	Ni ppm	Pb ppm	Zn ppm	Au FA g/tonne			
298148	205 294	450	0.5	9	40	4.38	660	6	6	102	346	-----			
298149	205 294	>10000	19.0	8	1180	4.12	65	5	8	1935	646	10.63	= 0.31 oz/ton		
298150	205 294	>10000	21.5	7	755	4.36	70	5	7	882	246	14.57	= 0.42 oz/ton		

*Harrington Property  
- Godfrey Twp.*

*298148 - Footwall Bx w/ 1% cubic py  
149 - Q.V. w/ 2-3% py, cpq, gal + tr sph.  
150 - edge of Q.V. 3% f. to crs. g. pyrite.*

CERTIFICATION: B. Coughlin

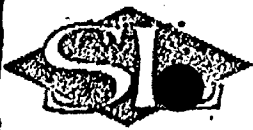

# Swastika Laboratories

A Division of Assayers Corporation Ltd.

Assaying - Consulting - Representation

Established 1928

CHARLES HARRINGTON PROPERTY  
GODFREY TWP.

## Geochemical Analysis Certificate

1W-3955-RG1

Company: FALCONBRIDGE LIMITED (TIMMINS)  
Project: 8147  
Attn: JOHN PATTISON

Date: SEP-18-91  
Copy 1. P.O. BOX 1140, TIMMINS, ONT. P4N 7H9  
2. FAX TO 264-6080

We hereby certify the following Geochemical Analysis of 2 ROCK samples submitted SEP-13-91 by JOHN PATTISON.

Sample Number	Au ppb	Cu ppm	Zn ppm	Pb ppm	Ag ppm	Ni ppm
AMD8651	1917	1480	1990	3840	28.2	49
AMD8652	3185	579	514	336	10.2	29

AMD8651 - a north vein (10-50m wide, dipping ~~to~~ 15°) on southeast side of Mt. Jameson near east boundary of claim P-1132989 (100m south of #1 post) SW 1/4, N 1/2 Lot 7 Con VI Godfrey. Vein is well mineralized with galena, sphalerite, and chalcopyrite and pyrite.

AMD8652 -> Same vein as above except mineralization consists of v. fine fracture controlled pyrite.

Certified by Donna Gardner

Appendix II  
Work Appendix log

- JUNE 2/91 - Drilled off first trench north of main original trench
- JUNE 3/91 - Completed drilling off main trench and extension of old original trench
- JUNE 6/92 - Blasted & began mucking out trenches, misholes noted, had to stop & reblast; completed cleaning trenches
- JUNE 7/92 - Began to drill off extension of main trench and put a few holes in main trench in order to deepen them. Problems with stuck steels
- JUNE 8/92 - Completed drilling, got steels out, loaded holes and blasted.
- JUNE 9/92 - Cleared out trenches with shovel and by hand, examined rock and took a few new samples.





Ontario



42A12SE0446 2.14608 GODFREY

900

Ministry of  
Northern Development  
and Mines

Ministère du  
Développement du Nord  
et des Mines

Geoscience Approvals Section  
Mining Lands Branch  
159 Cedar Street, 4th Floor  
Sudbury, Ontario  
P3E 6A5

Telephone: (705) 670-7264  
Fax: (705) 670-7262

Our File: 2.14608  
Transaction #: W9260.00039

June 12, 1992

Mining Recorder  
Ministry of Northern Development  
and Mines  
60 Wilson Avenue  
Timmins, Ontario  
P4N 2S7

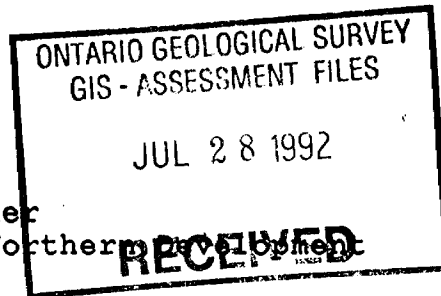

Dear Sir:

RE: Approval of Assessment Work on mining claims P 1132989 in Godfrey Township.

The Assessment Credits for Assaying, section 17 of the Mining Act Regulations, as listed on the original Report of Work, have been approved as of JUNE 11, 1992.

Please indicate this approval on the claim record sheets.

If you have any questions please call Clive Stephenson at (705) 670-7251.

Yours sincerely,

Ron C. Gashinski  
Senior Manager, Mining Lands Branch  
Mines and Minerals Division

CDI  
CDS/jl

Enclosures:

cc: ✓ Assessment Files Office  
Toronto, Ontario

Resident Geologist  
Timmins, Ontario



Report of Work Conducted After Recording Claim

Mining Act

Transaction Number  
W9260.00039

Personal information collected on this form is obtained under the authority of the Mining Act. This information will be used for correspondence. Questions about this collection should be directed to the Provincial Manager, Mining Lands, Ministry of Northern Development and Mines, Fourth Floor, 159 Cedar Street, Sudbury, Ontario, P3E 6A5, telephone (705) 670-7264.

2.14608

- Instructions:
- Please type or print and submit in duplicate.
  - Refer to the Mining Act and Regulations for requirements of filing assessment work or consult the Mining Recorder.
  - A separate copy of this form must be completed for each Work Group.
  - Technical reports and maps must accompany this form in duplicate.
  - A sketch, showing the claims the work is assigned to, must accompany this form.

Recorded Holder(s) J.K. FIBO & C. HARRINGTON		Client No. #131784/141990
Address 535 BATTLEMAN, TIMMINS ONT. PAN 4X2		Telephone No. 268-9045
Mining Division PORCUPING	Township/Area GODFREY	M or G Plan No.
Dates Work Performed From: <del>APR 1990</del> APR 1990		To: <del>APR 1990</del> OCT 1990

Work Performed (Check One Work Group Only)

Work Group	RECEIVED Type
Geotechnical Survey	JUN 10 1992
Physical Work, Including Drilling	MINING LANDS BRANCH
Rehabilitation	
Other Authorized Work	
Assays	ASSAYING ONLY SAMPLES RILLED TO C. HARRINGTON (LA-MED) (BRT. #N3937, W4757, W3948, W4120 W, 4550 + W 3916
Assignment from Reserve	

RECORDED  
MAR 16 1992  
Receipt

Total Assessment Work Claimed on the Attached Statement of Costs \$ 108.00

Note: The Minister may reject for assessment work credit all or part of the assessment work submitted if the recorded holder cannot verify expenditures claimed in the statement of costs within 30 days of a request for verification.

Persons and Survey Company Who Performed the Work (Give Name and Address of Author of Report)

Name	Address
C. Harrington	82 THE GRINDLE RD. TIMMINS, PAN 5B5
J.K. Fibo (Report)	535 BATTLEMAN TIMMINS ONT.

(attach a schedule if necessary)

Certification of Beneficial Interest \* See Note No. 1 on reverse side

I certify that at the time the work was performed, the claims covered in this work report were recorded in the current holder's name or held under a beneficial interest by the current recorded holder.	Date MAR 15/92	Recorded Holder or Agent (Signature) J.K. Fibo
--	-------------------	---

Certification of Work Report

I certify that I have a personal knowledge of the facts set forth in this Work report, having performed the work or witnessed same during and/or after completion and annexed report is true.		
Name and Address of Person Certifying J.K. Fibo 535 Battleman, Timmins Ont		
Telephone No. 268-9045	Date MAR 15/92	Certified By (Signature) J.K. Fibo

For Office Use Only

Total Value Cr. Recorded 108.00	Date Recorded MARCH 16 1992	Mining Recorder Blwhite	Received BY MINING DIVISION RECEIVED MAR 16 1992 2:30am
	Date Notice for Amendments Sent	Date Approved	



Statement of Costs  
for Assessment Credit

État des coûts aux fins  
du crédit d'évaluation

Mining Act/Loi sur les mines

Transaction No./N° de transaction  
**W9260.00039**

Personal information collected on this form is obtained under the authority of the Mining Act. This information will be used to maintain a record and ongoing status of the mining claim(s). Questions about this collection should be directed to the Provincial Manager, Minings Lands, Ministry of Northern Development and Mines, 4th Floor, 159 Cedar Street, Sudbury, Ontario P3E 6A5, telephone (705) 670-7264.

Les renseignements personnels contenus dans la présente formule sont recueillis en vertu de la Loi sur les mines et serviront à tenir à jour un registre des concessions minières. Adresser toute question sur la collecte de ces renseignements au chef provincial des terrains miniers, ministère du Développement du Nord et des Mines, 159, rue Cedar, 4<sup>e</sup> étage, Sudbury (Ontario) P3E 6A5, téléphone (705) 670-7264.

1. Direct Costs/Coûts directs

Type	Description	Amount Montant	Totals Total global
Wages Salaires	Labour Main-d'oeuvre		
	Field Supervision Supervision sur le terrain		
Contractor's and Consultant's Fees Droits de l'entrepreneur et de l'expert- conseil	Type		
Supplies Used Fournitures utilisées	Type ASSAYING	108	
	NOTE ONLY SAMPLES		
	BILLED TO: HARRINGTON		
	CLAIMED! RECEIVED		108
Equipment Rental Location de matériel	Type		
	JUN 10 1992		
	MINING LANDS BRANCH		
Total Direct Costs Total des coûts directs		108	

2. Indirect Costs/Coûts indirects

\*\* Note: When claiming Rehabilitation work Indirect costs are not allowable as assessment work.  
Pour le remboursement des travaux de réhabilitation, les coûts indirects ne sont pas admissibles en tant que travaux d'évaluation.

Type	Description	Amount Montant	Totals Total global
Transportation Transport	Type		
Food and Lodging Nourriture et hébergement			
Mobilization and Demobilization Mobilisation et démobilisation			
Sub Total of Indirect Costs Total partiel des coûts indirects			
Amount Allowable (not greater than 20% of Direct Costs) Montant admissible (n'excédant pas 20 % des coûts directs)			
Total Value of Assessment Credit (Total of Direct and Allowable indirect costs)			
Valeur totale du crédit d'évaluation (Total des coûts directs et indirects admissibles)			

RECORDED  
MAR 16 1992  
Receipt \_\_\_\_\_

Note: The recorded holder will be required to verify expenditures claimed in this statement of costs within 30 days of a request for verification. If verification is not made, the Minister may reject for assessment work all or part of the assessment work submitted.

Note: Le titulaire enregistré sera tenu de vérifier les dépenses demandées dans le présent état des coûts dans les 30 jours suivant une demande à cet effet. Si la vérification n'est pas effectuée, le ministre peut rejeter tout ou une partie des travaux d'évaluation présentés.

Filing Discounts

- Work filed within two years of completion is claimed at 100% of the above Total Value of Assessment Credit.
- Work filed three, four or five years after completion is claimed at 50% of the above Total Value of Assessment Credit. See calculations below:

Total Value of Assessment Credit	Total Assessment Claimed
	x 0.50 =

Remises pour dépôt

- Les travaux déposés dans les deux ans suivant leur achèvement sont remboursés à 100 % de la valeur totale susmentionnée du crédit d'évaluation.
- Les travaux déposés trois, quatre ou cinq ans après leur achèvement sont remboursés à 50 % de la valeur totale du crédit d'évaluation susmentionné. Voir les calculs ci-dessous.

Valeur totale du crédit d'évaluation	Evaluation totale demandée
	x 0,50 =

Certification Verifying Statement of Costs

I hereby certify:  
that the amounts shown are as accurate as possible and these costs were incurred while conducting assessment work on the lands shown on the accompanying Report of Work form.

that as Ronald Holder & Bent I am authorized  
(Recorded Holder, Agent, Position in Company)

to make this certification

Attestation de l'état des coûts

J'atteste par la présente :  
que les montants indiqués sont le plus exact possible et que ces dépenses ont été engagées pour effectuer les travaux d'évaluation sur les terrains indiqués dans la formule de rapport de travail ci-joint.

Et qu'à titre de \_\_\_\_\_ je suis autorisé  
(titulaire enregistré, représentant, poste occupé dans la compagnie)

à faire cette attestation.

Signature [Signature] Date 14/07/92



**MAP SYMBOLOGY**

<b>Aerial Corridor</b>	<b>Pipeline</b>
<b>Boundary</b>	<b>Railroad</b>
<b>Interpretation</b>	<b>Single Track</b>
<b>District, Township</b>	<b>Double Track</b>
<b>Indian Reserve</b>	<b>Abandoned</b>
<b>Approach</b>	<b>Turbine</b>
<b>Lot, Concession</b>	<b>Road</b>
<b>Approach</b>	<b>Highway, County</b>
<b>Park Boundary</b>	<b>Approach</b>
<b>Bridge</b>	<b>Access (Loss of beneficial interest) at</b>
<b>Road, Railroad</b>	<b>Point (Beneficial interest)</b>
<b>Building</b>	<b>Trail, Back Road</b>
<b>Chimney</b>	<b>(Setback lines)</b>
<b>Cliff, Pit, Pile</b>	<b>Rapids</b>
<b>Contours</b>	<b>Double line river with multiple rapids</b>
<b>Interpretation</b>	<b>Double line river with multiple rapids</b>
<b>Approach</b>	<b>Reservoir</b>
<b>Control Points</b>	<b>River, Stream, Canal</b>
<b>Horizontal</b>	<b>Approach</b>
<b>Vertical</b>	<b>Approach</b>
<b>Culvert</b>	<b>Lock</b>
<b>Falls</b>	<b>Flooded Land</b>
<b>Double line river</b>	<b>Lock</b>
<b>Fence, Hedge, Wall</b>	<b>Marsh or Swamp</b>
<b>Feature Outline</b>	<b>Mast</b>
<b>(Construction features, etc.)</b>	<b>Mine Head Frame</b>
<b>Outcrop</b>	<b>Outcrop</b>

**AREAS WITHDRAWN FROM DISPOSITION**

M.R.O. - MINING RIGHTS ONLY  
 S.R.O. - SURFACE RIGHTS ONLY  
 M+S. - MINING AND SURFACE RIGHTS

Description	Order No.	Date	Disposition	File
(N) - S.R.O. UNDER APPLICATION FOR AGRICULTURAL PURPOSES				
(C) - CERTIFIED AGRICULTURAL LAND 26/8 RP SUBJECT TO SEC 41(1) OF THE MINING ACT				
(B) - BONA FIDE APPLICATION				
(A) - Mining S.R. Application under Part 1 of the Mining Act				
(F) - Pending proceedings under Part 1 of the Mining Act				

THE INFORMATION THAT APPEARS ON THIS MAP HAS BEEN COMPILED FROM VARIOUS SOURCES AND ACCURACY IS NOT GUARANTEED. THOSE WISHING TO STAKE MINING CLAIMS SHOULD CONSULT WITH THE MINING RECORDER, MINISTRY OF NORTHERN DEVELOPMENT AND MINES, FOR ALL ADDITIONAL INFORMATION ON THE STATUS OF THE LANDS SHOWN HEREON.

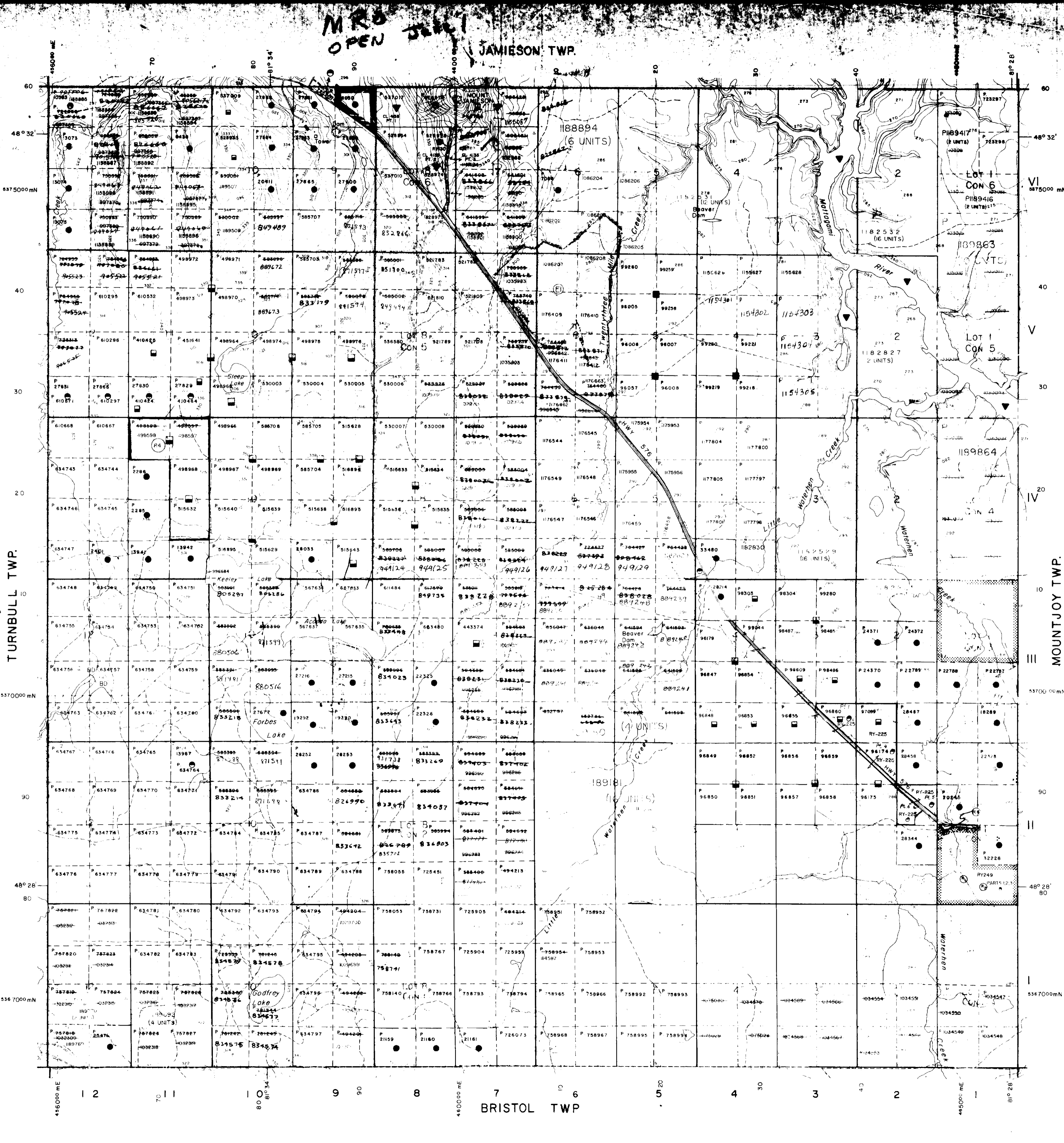

**DISPOSITION OF CROWN LANDS**

TYPE OF DOCUMENT	SYMBOL
PATENT, SURFACE & MINING RIGHTS	●
SURFACE RIGHTS ONLY	○
MINING RIGHTS ONLY	○
LEASE, SURFACE & MINING RIGHTS	○
SURFACE RIGHTS ONLY	○
MINING RIGHTS ONLY	○
LICENCE OF OCCUPATION	○
ORDER IN COUNCIL	OC
RESERVATION	○
CANCELLED	○
SAND & GRAVEL	○

**DISPOSITION OF CROWN LANDS**

TYPE OF DOCUMENT	SYMBOL
PATENT, SURFACE & MINING RIGHTS	●
SURFACE RIGHTS ONLY	○
MINING RIGHTS ONLY	○
LEASE, SURFACE & MINING RIGHTS	○
SURFACE RIGHTS ONLY	○
MINING RIGHTS ONLY	○
LICENCE OF OCCUPATION	○
ORDER IN COUNCIL	OC
RESERVATION	○
CANCELLED	○
SAND & GRAVEL	○

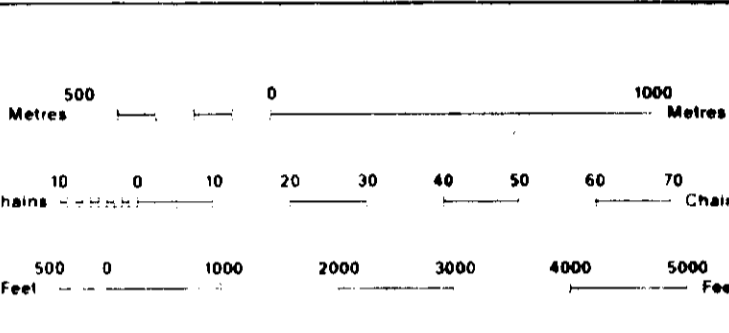

**NOTES**

FLOODING RIGHTS ON EITHER SIDE OF THE MATTAGAMI RIVER TO H.E.P.C.

THIS TWP. IS SUBJECT TO FOREST ACTIVITIES IN 92/93 F. FURTHER INFORMATION AVAILABLE ON FILE.

TOWNSHIP  
**GODFREY**  
 M.N.R. ADMINISTRATIVE DISTRICT  
**TIMMINS** RECEIVED  
 MINING DIVISION JUN 10 1992  
 PORCUPINE  
 LAND TITLES / REGISTRATION BRANCH  
**COCHRANE**

Ministry of Natural Resources  
 Land Management Branch

Ontario

DATE: JULY 1984  
 NUMBER: **G-3991**