



42A13SE0379 17 MAHAFFY

010

### Diamond Drilling

Township of Mahaffy

Report NO: 17

Work performed by: Black River Mining Limited

Claim NO	Hole NO	Footage	Date	Note
P. 63603	64-1	204'	May/64	
	64-2	373'	May/64	
	64-3	647'	May/64	
	64-5	432'	June/64	
	64-6	300'	June/64	
	P. 72765	64-4	281'	June/64
<u>6</u>		<u>2237'</u>		

Notes:

# DIAMOND DRILL RECORD

**PROPERTY** Black River - Transterre - Coastal **HOLE NO.** 64-1  
**Location - L** 1 + 18' E. **Mahaffy Township**  
**SHEET NUMBER** \_\_\_\_\_ **SECTION FROM** \_\_\_\_\_ **TO** \_\_\_\_\_ **STARTED** \_\_\_\_\_  
**Station - 104' N.**  
**LATITUDE** \_\_\_\_\_ **DATUM** \_\_\_\_\_ **COMPLETED** May 12th. 1964.  
 (Geophysical grid)  
**DEPARTURE** \_\_\_\_\_ **BEARING** Az. 140° **ULTIMATE DEPTH** 204'  
**ELEVATION** \_\_\_\_\_ **DIP** 50° **PROPOSED DEPTH** \_\_\_\_\_

DEPTH FEET	FORMATION	SAMPLE NO.	WIDTH OF SAMPLE	GOLD %	SLUDGE GOLD %
0 - 100	Casing.				
100 - 128.5	Graphitic slate:				
	100 - 110 disseminated pyrite (less than 5%)				
	110 - 111 massive pyrite, sli pyrrhotite, bedding at approx. 45-50°				
	111 - 114 core lost.				
	114 - 115 65% pyrite				
	115 - 117 core lost.				
	117 - 119.5 core broken but moderate pyrite.				
	119.5 - 122 core lost.				
	122 - 123 65% pyrite.				
	123 - 125 core lost.				
	125 - 126 80% pyrite mostly as concretions				
	126 - 127 core lost.				
	127 - 127.7 50% pyrite.				
	127.7 - 128.5 core lost.				
128.5 - 152	Slate: carbonatized and schistose, slight pyrite dissemination.				
	at 144' 2" mass. pyrite.				
	136.6 - 137.6 core lost.				

DRILLED BY L.J. Baker Diamond Drilling.

SIGNED [Signature]



# DIAMOND DRILL RECORD

PROPERTY Black River - Fransterre - Coastal HOLE NO. 64-2  
Mahaffy Township.

TOWNSHIP \_\_\_\_\_ PAGE NO. \_\_\_\_\_

LOCATION L 1 17 E  
 Stat. 154' N.  
(Geophysical grid)

CORE LOCATION \_\_\_\_\_

STARTED \_\_\_\_\_

DATUM \_\_\_\_\_

COMPLETED May 18th, 1964.

BEARING Az. 135°

DEPTH 373

ELEVATION \_\_\_\_\_

DIP 60°

DEPTH FEET	FORMATION	SAMPLE No.	WIDTH OF SAMPLE	GOLD OZ.			
0 - 98	Casing						
98 - 107.5	Slate - greywacke; somewhat graphitic, 102 - 104 core lost						
	104 - 106 as above with 20% py.						
	106 - 107.5 massive pyrite or marcasite	2 - 1	1.5	Au. Cu.	Zn. Ag.		
	ellipsoidal pyrite			Tr. .02	Mill .01		
107.5	Graphitic Slate; with diss. py.						
	110 - 113 core lost						
	at 114 6" massive py.						
	115 - 117 core lost						
	117 - 119 10% py.						
	119 - 119.6 core lost						
	119.6 - 120 - 50% py.						
	120 - 125 core lost						
	125 - 132 core lost						
132 - 133	Slate;						
133 - 178	Andesite; ? with occ. amygdules, cubes of pyrite, dark grey, could be massive greywacke.						
178 - 200	As above; but darker, somewhat graphitic						
200 - 275	Graphite; essentially, plus ellipsoidal pyrite.						

Drilled By L. J. Baker Diamond Drilling

Signed [Signature]





# DIAMOND DRILL RECORD

PROPERTY Transferre, Coastal, Black River

HOLE NO. 64-3

Location: L 3 E  
 SHEET NUMBER \_\_\_\_\_  
 Station 0 + 90 N.  
 LATITUDE (Geophysical grid) \_\_\_\_\_

Mahaffy Township.

SECTION FROM \_\_\_\_\_ TO \_\_\_\_\_

STARTED \_\_\_\_\_

DATUM \_\_\_\_\_

COMPLETED May 31st, 1964.

DEPARTURE \_\_\_\_\_

BEARING Az. 135°

ULTIMATE DEPTH 647'

ELEVATION \_\_\_\_\_

DIP 60°

PROPOSED DEPTH \_\_\_\_\_

DEPTH FEET	FORMATION	SAMPLE NO.	WIDTH OF SAMPLE	GOLD S	SLUDGE GOLD †
0 - 67	Casing				
67 - 184	Graphitic slate & diss/py, some carbonate.				
	11 - 73.5 core lost.				
	73.5 - 75 marcasite concretions				
	75 - 79 core lost.				
	79 - 81.5 sli. py.				
	81.5 - 82 core lost.				
	82 - 83 massive pyrite	3 - 1	1	Au Ag tr. 0.11	Zn nil
	83 - 85.5 core lost				
	85.5 - 86 marcasite concretions.				
	86 - 90 core lost				
	90 - 91 heavy py.				
	91 - 92.5 core lost				
	92.5 - 98 10% py.				
	98 - 104.5 30% py.				
	102 - 104	3 - 2	Z	Au Ag nil..02	Cu Zn .02 nil.
	104.5 - 108 sli. py.				
	108 - 109 core lost				
	109 - 111 silicified; sli. py.				
	111 - 112 core lost				
	114.5 - 116.0 core lost.				

N.M.P. TORONTO - STOCK FORM NO. 501 REV. 12/51

DRILLED BY L.J. Baker Diamond Drilling Ltd.

SIGNED \_\_\_\_\_

# DIAMOND DRILL RECORD

- Page 2 -

PROPERTY Transerre, Coastal, Black River HOLE NO. 64-3

SHEET NUMBER \_\_\_\_\_ SECTION FROM \_\_\_\_\_ TO \_\_\_\_\_ STARTED \_\_\_\_\_  
 LATITUDE \_\_\_\_\_ DATUM \_\_\_\_\_ COMPLETED \_\_\_\_\_  
 DEPARTURE \_\_\_\_\_ BEARING \_\_\_\_\_ ULTIMATE DEPTH \_\_\_\_\_  
 ELEVATION \_\_\_\_\_ DIP \_\_\_\_\_ PROPOSED DEPTH \_\_\_\_\_

DEPTH FEET	FORMATION	SAMPLE NO.	WIDTH OF SAMPLE	GOLD g	SLUDGE GOLD †
116 - 118	sli. py.				
118 - 119	core lost				
119 - 128	slightly silicified, carbonatized, sli. py.				
131 - 136	core lost				
140 - 141	core lost				
144 - 146	core lost				
146 - 148	sli. py.				
148 - 152	core lost				
152 - 153	sli. py.				
153 - 159	core lost				
159 - 168	sli. py.				
168 - 170	core lost				
184 - 202	Rhyolite: gradational contact. 3" qtz. str. at 183.5 and 192				
202 - 647	Rhyolite breccia or agglomerate: a few tuff, sections, sli. py. 313 - 317 sli. cpy. dissemination. at 377 6" qtz. str.				
411 - 414	sheared and altered.				
414 - 417	core lost				

N.M.P. TORONTO-STOCK FORM NO. 501 REV. 12/51

DRILLED BY L.J. Baker Diamond Drilling Ltd.

SIGNED [Signature]







# DIAMOND DRILL RECORD

PROPERTY Transerra, Coastal, Black River

HOLE NO. 615

Location: L 0 + 67 E.

Mahaffy Township.

SHEET NUMBER \_\_\_\_\_

SECTION FROM \_\_\_\_\_ TO \_\_\_\_\_

STARTED \_\_\_\_\_

Station: 1 + 54 N.  
LATITUDE (Geophysical grid.) \_\_\_\_\_

DATUM \_\_\_\_\_

COMPLETED June 19, 1964.

DEPARTURE \_\_\_\_\_

BEARING Az. 135°

ULTIMATE DEPTH 432'

ELEVATION \_\_\_\_\_

DIP 60°

PROPOSED DEPTH 500'

DEPTH FEET	FORMATION	SAMPLE NO.	WIDTH OF SAMPLE	GOLD \$	SLUDGE GOLD \$
0 - 110	Casing				
110 - 135	Graphitic tuff. with large cubes pyrite, diss. pyrite. concretions of marcasite.				
118 - 122	core lost.				
123 - 127	core lost.				
129 - 130	core lost.				
133 - 135	core lost.				
138 - 142	core lost.				
135 - 156	Andesite some amygdulae, grey, some pyrite.				
156 -	Graphitic tuff. slight pyrite.				
162 - 164	core lost.				
166.5 - 168	core lost.				
173 - 176	core lost.				
178.5 - 179	core lost.				
180 - 180.8	core lost.				
181 - 184	core lost.				
185 - 186	core lost.				
187 - 189	core lost.				
190 - 192	core lost.				
201 - 203	core lost.				
207.5 - 208.5	core lost.				

N.M.P., TORONTO-STOCK FORM NO. 801 REV. 12/51

DRILLED BY L.J. Baker Diamond Drilling Limited.

SIGNED

*[Signature]*

# DIAMOND DRILL RECORD

PROPERTY Transterra, Coastal, Black River, HOLE NO. 64-5  
Mahaffy Township.

SHEET NUMBER \_\_\_\_\_ SECTION FROM \_\_\_\_\_ TO \_\_\_\_\_ STARTED \_\_\_\_\_  
 LATITUDE \_\_\_\_\_ DATUM \_\_\_\_\_ COMPLETED \_\_\_\_\_  
 DEPARTURE \_\_\_\_\_ BEARING \_\_\_\_\_ ULTIMATE DEPTH \_\_\_\_\_  
 ELEVATION \_\_\_\_\_ DIP \_\_\_\_\_ PROPOSED DEPTH \_\_\_\_\_

DEPTH FEET	FORMATION	SAMPLE NO.	WIDTH OF SAMPLE	GOLD %	SLUDGE GOLD %
	211 - 221.5 35% pyrite marcasite.				
	223 - 227 core lost.				
	230 - 232 core lost.				
	236 - 237 core lost.				
	247 - 249 core lost.				
	bedding at 45°				
260	Rhyolite tuff. gradational changes.				
	at 278' 6" qtz. str.				
	279.5 - 281 quartz sericite vein, sli. py.	5 - 1	1.5	Au.	tr
	at 288' 4" qtz. stringers.				
	296 - 298.5 qtz. sericite vein and sli. pyrite.	5 - 2	2.5	Au.	nil
	301 - 315 sericitized.				
	302.5 - 305 qtz. stringers.				
	308.5 - 310 70% qtz. plus sericite, sli. py.				
	at 358' 1" graphite and heavy pyrite.				
	375 - 400 sli. disseminated pyrite, sli. pyrrhotite.				
	at 384.5 splash of chalcopryite.				
	384 - 385	5 - 3	1	Cu.	0.18
	at 428 fine galena with pyrite and brown carbonate.				
432 -	END, DIP TESTS.				

N.M.P., TORONTO-STOCK FORM NO. 501 REV. 12/51

# DIAMOND DRILL RECORD

PROPERTY Transterre, Coastal, Black River HOLE NO. 64 - 6

TOWNSHIP Mahaffy Township PAGE NO. \_\_\_\_\_

LOCATION L 15 E CORE LOCATION \_\_\_\_\_ STARTED \_\_\_\_\_  
 (Stat. 6 50 S. \_\_\_\_\_  
 (Geophysical grid) \_\_\_\_\_) DATUM \_\_\_\_\_ COMPLETED June 29, 1964  
 BEARING Southeast DEPTH 300'  
 ELEVATION \_\_\_\_\_ DIP - 60°

DEPTH FEET	FORMATION	SAMPLE NO.	WIDTH OF SAMPLE	GOLD OZ.			
0 - 20	Casing						
20 - 142	Rhyolite agglomerate, some tuff; moderate pyrite dissemination to 100', well sericitized.						
	32 - 33 core lost						
	40 - 42 core lost						
	43 - 54 core lost						
	61 - 66 core lost						
	70 - 74 core lost						
	at 80' becoming more tuffaceous from 100' - very slightly disseminated pyrite						
142 - 155	Graphite; with quartz stringers and moderate pyrite dissemination.						
	145 - 152 core lost						
155 - 300	Rhyolite tuff, some agglomerate; mod. pyrite dissemination as cubes, grains, etc. to 290', at 198 - 6" carbonate						
300'	END.						

Drilled By L. J. Baker Diamond Drilling Limited.

Signed [Signature]

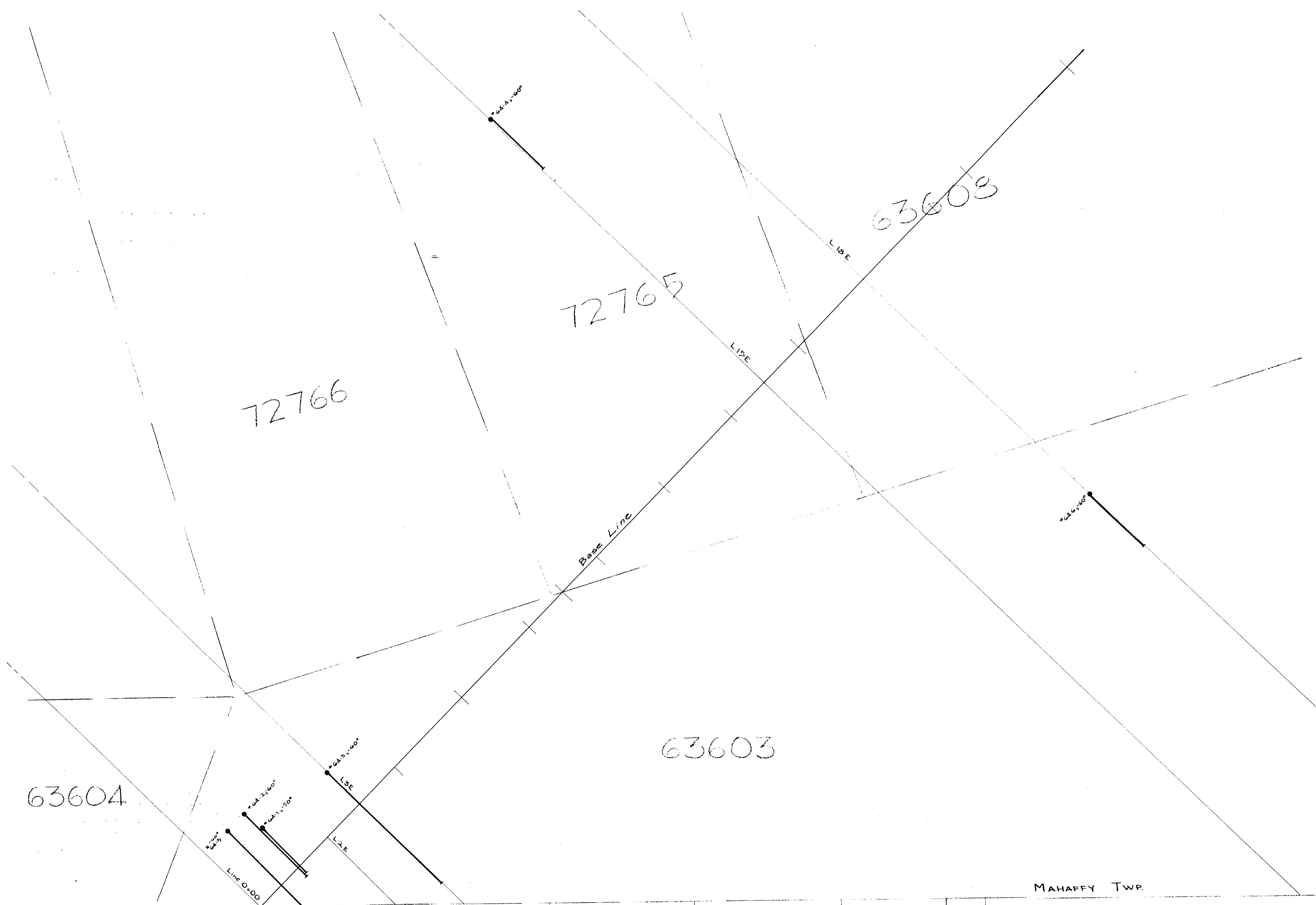

MAHAFFY TWP.  
REID TOWNSHIP

DRILL-HOLE LOCATION SKETCH  
BLACK RIVER MINING LTD  
Mahaflly Twp., ONT.

1" = 100'

MAR. 1965

MAHAFFY TWP. #17

