

FROM TO	ROCK TYPE	TEXTURE AND STRUCTURE	ANGLE TO CA	ALTERATION	MINERALIZATION	REMARKS
0.00 TO 77.00	< ob >					- BW casing left in hole.
77.00 TO 118.98	Altered Mafic Volcanic <2,a,m>	<ul style="list-style-type: none"> - fine grained to locally weakly granular. - medium to dark grey. - massive. - not magnetic. - possible intermediate volcanic rock. - locally contains up to 2%, submillimetre, subrounded, pale white leucoxenes near the top of the interval. - 77-88m - darker coloured, less altered interval gradational into a grey, more altered rock. - cut by 3-5%, late, irregular. 0.5-10cm, white, pale pink and orange quartz-feldspar veins and hairline veinlets. - 5% of interval contains orange, medium grained, weakly marble-textured monzogranite to syenite with locally brecciated margins. - downhole contact is approximate at a 3m fault gouge. 		<ul style="list-style-type: none"> - pale grey colour change may indicate a weak pervasive alteration associated with increased pyrite content (up to 5%). - quartz-feldspar veins are commonly orange coloured which may be indicative of hematite staining or potassium feldspar. - rare, dark brown to black filled fractures represent minor carbon in the system. - locally, intervals have patchy, orange to pale orange granitic alteration associated with up to 5%, disseminated cubic pyrite and chlorite/biotite. 	<ul style="list-style-type: none"> - 1-2%, disseminated, 0.5-1mm, cubic pyrite with rare specks of chalcopyrite. - pyrite locally increases to 3-5% after 88m with apparent increasing alteration. - 1% pyrite associated with quartz-feldspar veining. 	
118.98 TO 120.00	Mafic Fragmental with Argillite <2,t/5,g>	<ul style="list-style-type: none"> - fine grained. - medium green-grey with dark brown. - moderately strained, 0.5-5cm, mafic fragments are tightly packed in an argillaceous matrix. - bedding and a variably developed foliation are subparallel at 35-50°/ca. - downhole contact is marked by an irregular band of pyrite and fuchsite at 45°/ca. 		<ul style="list-style-type: none"> - 1% quartz-feldspar veins and veinlets, similar to previous interval. - rare quartz + carbonate + pyrite veinlets are late. 	<ul style="list-style-type: none"> - 2% pyrite is commonly found in elongate clusters within the matrix but is also seen as fine disseminations both within the fragments and the matrix. - mineralization is both subparallel to and cross-cutting bedding. - rare quartz-filled 1cm tension gashes contain pyrite. 	
120.00 TO 135.60	Felsic Crystal Tuff <4,t,y,s>	<ul style="list-style-type: none"> - dark grey with medium green. - dark grey patches containing up to 30% quartz grains with 2-10% feldspar grains in a fine grained, dark grey siliceous matrix. - 50-60% of interval is altered by pale green-grey, bleached patches of pyrite + fuchsite ± chlorite. Quartz eyes are typically preserved. - may be porphyritic flow? - weak banding in mineralized and altered zones is typically at 75°/ca. - 126.71-127.82m - orange granitic dyke contains up to 2% disseminated pyrite. 		<ul style="list-style-type: none"> - bleaching (silicification?) of 50-60% of the interval in irregular patches with up to 15% pyrite, 5%, bright green fuchsite, and minor carbonate (calcite). Typical in top 5 metres of the interval. - fuchsite appears to be pervasive within the alteration patches but is locally fracture-bounded. - cut by <1%, pale pink quartz-feldspar veinlets with trace epidote and carbonate. - minor iron oxide staining on 	<ul style="list-style-type: none"> - 1cm, irregular patches of pyrite up to 2%. - 0.5% finely disseminated pyrite throughout interval. - last metre of interval is poorly mineralized. 	

FROM TO	ROCK TYPE	TEXTURE AND STRUCTURE	ANGLE TO CA	ALTERATION	MINERALIZATION	REMARKS
135.60 TO 137.00	Argillite «S, g»	<p>Dykes also occur at:</p> <ul style="list-style-type: none"> - 128.26-128.90m and - 129.00-130.25m. <p>- downhole contact is fault bounded at 70°/ca.</p> <ul style="list-style-type: none"> - fine grained. - dark brown with rare white and green. - predominantly broken core and fault gouge. - where the core is intact, the argillite is strongly fractured and cross-cut by irregular granitic veinlets (10%). - ground grains of pale orange granite and pale green talc comprise 1% of fault gouge. 		<p>fracture surfaces.</p> <ul style="list-style-type: none"> - 135-135.7m - up to 25%, pale orange, weakly granitic patches. 	- no visible mineralization.	- unable to continue drilling through this interval as hole was collapsing in on the rods. Hole was shut down and casing left in the hole. The last metre of core was ground.
137.00 TO 137.00	«EOH» End-of-hole					

Sample	From (M)	To (M)	Leg. (M)	Cu ppm	Zn ppm	Au ppb	Ag ppm	Pb ppm	Co ppm	Cu/Zn ppm	Ni ppm	Nil %	Po %	Py %	Cp %	Sp %	Gn %	ROCK TYPE	Comments
AR09573	0.00	0.00	0.00	11	120	<2	0.3	14			9								
AR09524	77.00	78.50	1.50	59	82	<2	0.2	1			179							KRAP	control
AR09525	78.50	80.00	1.50	52	67	<2	0.1	1			161							2	tr cpy
AR09526	80.00	81.42	1.42	68	58	<2	0.1	1			145							2	aa
AR09527	81.42	83.00	1.58	54	80	<2	0.1	13			175							2	aa
AR09528	83.00	84.42	1.42	83	67	<2	0.1	1			182							2	aa
AR09529	84.42	86.00	1.58	81	74	<2	0.1	2			208							2	aa
AR09530	86.00	87.56	1.56	80	104	<2	0.1	6			191							2 alt	tr cpy
AR09531	87.56	89.00	1.44	49	66	<2	0.1	2			198							2 alt	aa
AR09532	89.00	90.43	1.43	54	49	<2	0.1	3			136							2 alt	
AR09533	90.43	92.00	1.57	47	74	<2	0.1	6			122							2 alt	
AR09534	92.00	93.10	1.10	57	76	<2	0.1	7			118							2 alt	
AR09535	93.10	94.46	1.36	68	74	<2	0.1	6			137							2 alt	
AR09536	94.46	95.22	0.76	58	74	<2	0.1	4			105							2 alt	
AR09537	95.22	96.60	1.38	45	52	<2	0.1	11			47							2 alt	
AR09538	96.60	98.00	1.40	52	99	<2	0.1	3			124							2 alt	
AR09539	98.00	99.65	1.65	59	84	<2	0.1	2			122							2 alt	
AR09540	99.65	101.00	1.35	51	47	<2	0.1	2			141							2 alt	
AR09541	101.00	102.50	1.50	50	75	<2	0.1	2			115							2 alt	
AR09542	102.50	104.00	1.50	50	80	3	0.1	3			140							2 alt	
AR09543	104.00	105.56	1.56	68	94	<2	0.1	12			109							2 alt	
AR09544	105.56	107.00	1.44	53	167	<2	0.1	4			143							2 alt	
AR09545	107.00	108.52	1.52	64	151	<2	0.1	1			129							2 alt	
AR09546	108.52	110.00	1.48	66	48	<2	0.1	1			128							2 alt	
AR09547	110.00	111.50	1.50	46	42	<2	0.1	4			123							2 alt	
AR09548	111.50	113.00	1.50	86	107	<2	0.1	1			141							2 alt	
AR09549	113.00	114.55	1.55	69	72	<2	0.1	1			126							2 alt	
AR09550	114.55	115.95	1.40	59	79	<2	0.1	1			223							2 alt	
AR09551	115.95	117.00	1.05	33	150	<2	0.1	6			114							2 alt	
AR09552	117.00	117.98	0.98	113	427	<2	0.1	3			245							2 alt	
AR09553	117.98	119.00	1.02	146	137	<2	0.1	1			205							2 alt	
AR09554	119.00	120.00	1.00	170	698	<2	0.1	1			208							2t	
AR09555	120.00	120.93	0.93	75	60	<2	0.1	1			184							2t,5g	
AR09556	120.93	122.00	1.07	45	54	<2	0.1	1			179							4,t,D	fuchsite
AR09557	122.00	123.06	1.06	84	53	<2	0.1	1			255							4,t,d	aa
AR09558	123.06	123.99	0.93	93	124	<2	0.1	1			177							4,t,D	
AR09559	123.99	124.84	0.85	139	35	<2	0.1	3			202							4,t,D	
AR09560	124.84	125.95	1.11	85	59	<2	0.1	2			261							4,t,D	
AR09561	125.95	126.80	0.85	118	127	<2	0.1	4			257							4,t,D	
AR09562	126.80	127.82	1.02	36	118	<2	0.1	11			17							4,t,D	
AR09563	127.82	128.28	0.46	68	161	<2	0.1	10			285							9	
AR09564	128.28	129.16	0.88	66	473	<2	0.8	366			44							4,2t	
AR09565	129.16	130.25	1.09	55	172	<2	0.1	62			19							9	
AR09566	130.25	131.00	0.75	93	124	3	0.2	23			246							9	
AR09567	131.00	131.87	0.87	39	84	3	0.1	15			147							4,t,D	
AR09568	131.87	132.88	1.01	21	73	<2	0.1	2			188							4,t,D	
AR09569	132.88	133.78	0.90	46	132	<2	0.1	9			138							4,t,D	

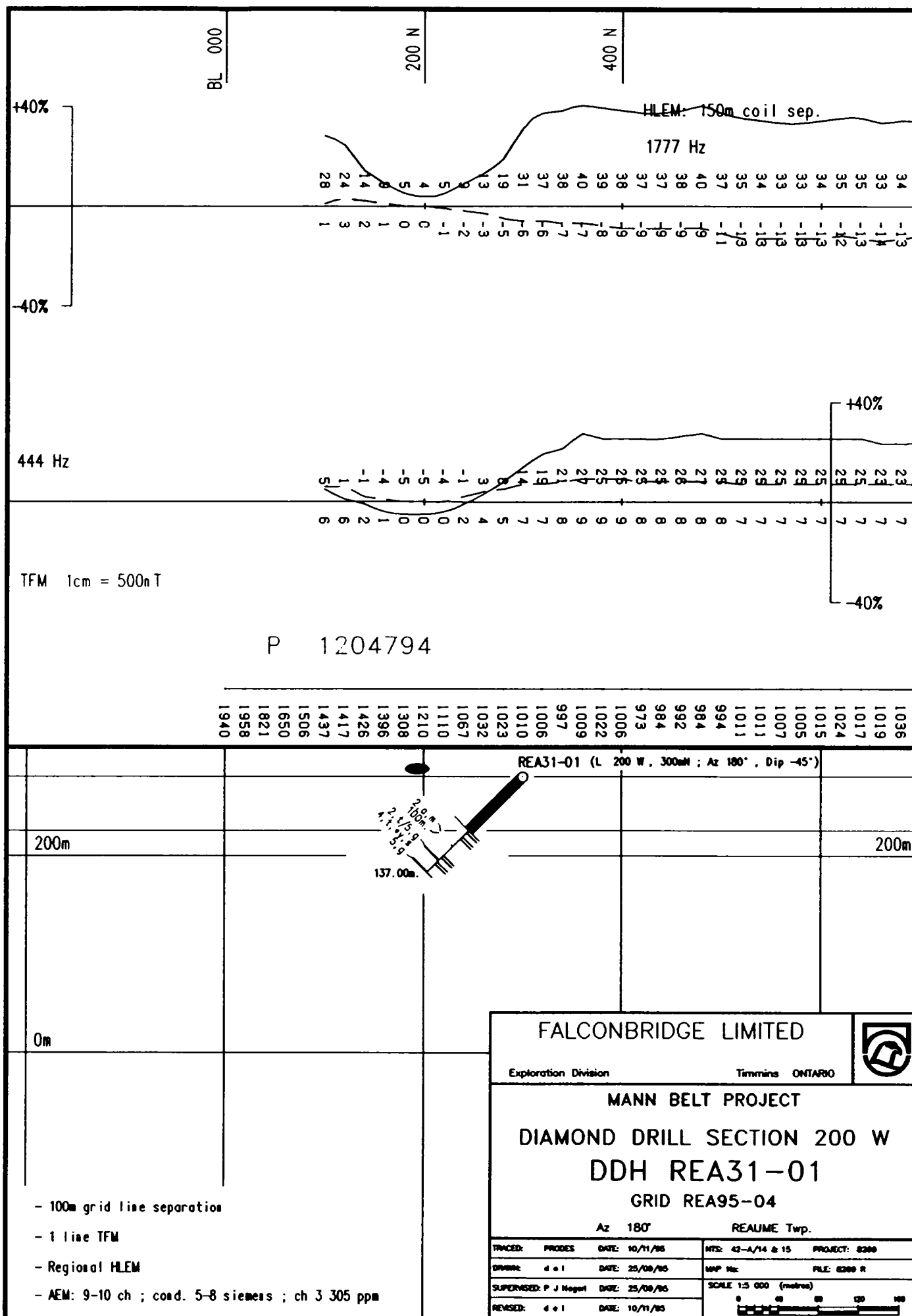

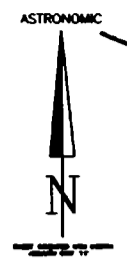
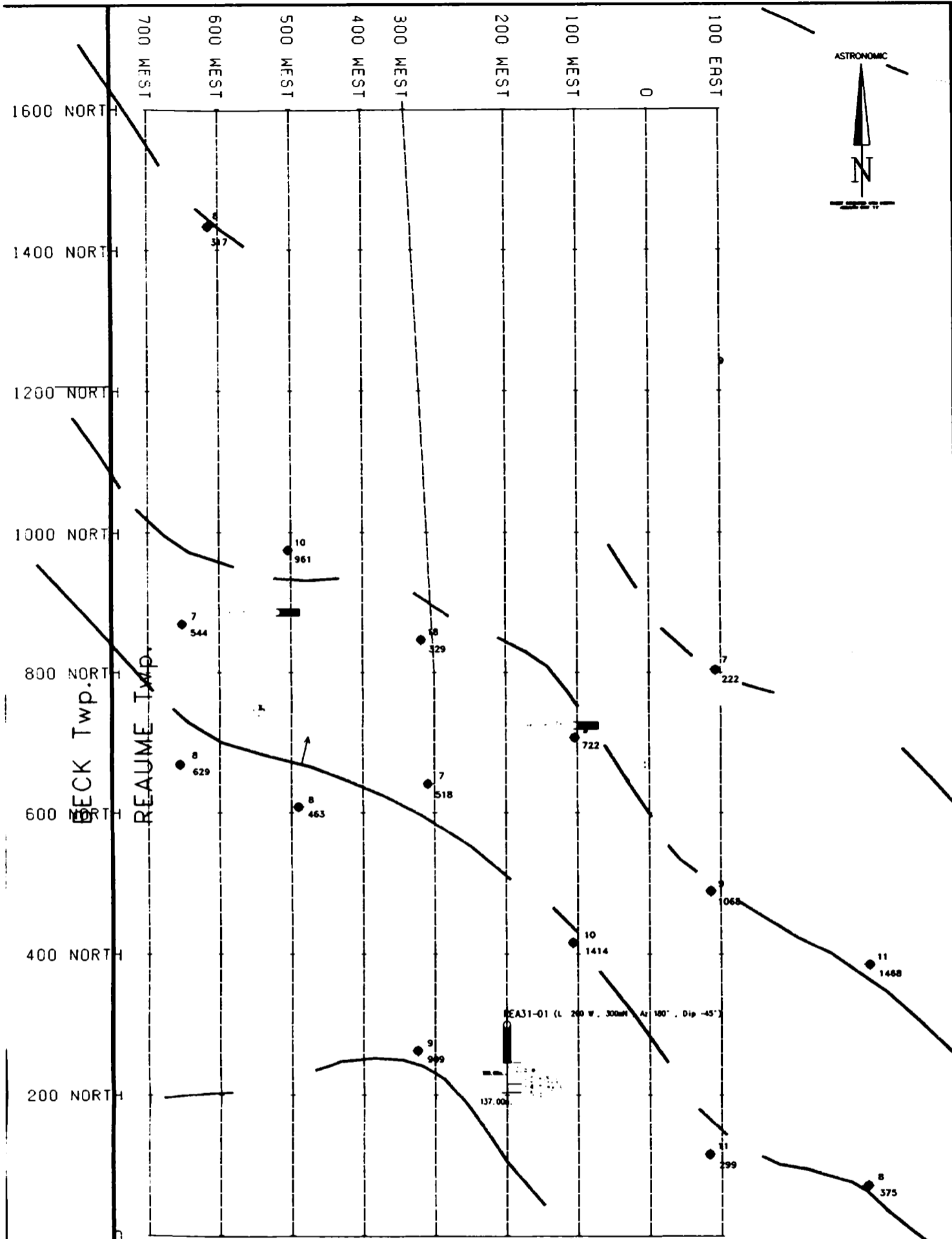

FALCONBRIDGE LIMITED		
<small>Exploration Division</small>	<small>Township ONTARIO</small>	
MANN BELT PROJECT GRID REA95-04 REAUME TOWNSHIP		
DIAMOND DRILL PLAN		
<small>TRACED: Lutes</small>	<small>DATE: 07/86</small>	<small>APP: 43-A/74</small>
<small>DRAWN: H W B</small>	<small>DATE: 07/86</small>	<small>FILE: REA95-04</small>



Report of Work Conducted
After Recording Claim

Mining Act

Transaction Number
W9560.00522

Personal information collected on this form is obtained under the authority of the
this collection should be directed to the Provincial Manager, Mining Lands,
Sudbury, Ontario, P3E 6A5, telephone (705) 870-7284.



42A14NE0085 W9560-00522 REAUME

900

- Instructions:
- Please type or print and submit in duplicate.
 - Refer to the Mining Act and Regulations for requirements of filing assessment work or consult the Mining Recorder.
 - A separate copy of this form must be completed for each Work Group.
 - Technical reports and maps must accompany this form in duplicate.
 - A sketch, showing the claims the work is assigned to, must accompany this form.

Recorded Holder(s) FALCONBRIDGE LIMITED		Client No. 130679
Address P.O. Box 1140, 571 MONETA AVE. TIMMINS, ONTARIO P4N 7H9		Telephone No. (705) 267-1188
Mining Division PORCUPINE	Township/Area REAUME	M or G Plan No.
Dates Work Performed	From: October 26, 1995	To: October 29, 1995

Work Performed (Check One Work Group Only)

Work Group	Type
Geotechnical Survey	
Physical Work, Including Drilling	DOMINIK DRILLING - (ddh REA31-01, 138m)
Rehabilitation	
Other Authorized Work	
Assays	
Assignment from Reserve	

RECORDED
DEC 04 1995

Total Assessment Work Claimed on the Attached Statement of Costs \$ 15184

Note: The Minister may reject for assessment work credit all or part of the assessment work submitted if the recorded holder cannot verify expenditures claimed in the statement of costs within 30 days of a request for verification.

Persons and Survey Company Who Performed the Work (Give Name and Address of Author of Report)

Name	Address
DOMINIK DRILLING	409 KING ST P.O. Box 479, PORCUPINE, ONT.

(attach a schedule if necessary)

Certification of Beneficial Interest * See Note No. 1 on reverse side

I certify that at the time the work was performed, the claims covered in this work report were recorded in the current holder's name or held under a beneficial interest by the current recorded holder.	Date Nov. 28, 1995	Recorded Holder or Agent (Signature) Christine Petch
----------------------------------------------------------------------------------------------------------------------------------------------------------------------------------------------------------	-----------------------	---------------------------------------------------------

Certification of Work Report

I certify that I have a personal knowledge of the facts set forth in this Work report, having performed the work or witnessed same during and/or after its completion and annexed report is true.		
Name and Address of Person Certifying CHRISTINE PETCH P.O. Box 1140, 571 MONETA AVE. TIMMINS, ONTARIO P4N 7H9		
Telephone No. (705) 267-1188	Date NOVEMBER 28, 1995	Certified By (Signature) Christine Petch

For Office Use Only

Total Value Cr. Recorded \$15,184.	Date Recorded	Mining Recorder	
	Deemed Approval Date MARCH 3/96	Date Approved MARCH 3, 1996	
	Date Notice for Amendments Sent		



Ministry of
Northern Development
and Mines

Ministère du
Développement du Nord
et des mines

Statement of Costs
for Assessment Credit

État des coûts aux fins
du crédit d'évaluation

Transaction No./N° de transaction
W9560.00522

Mining Act/Loi sur les mines

Personal information collected on this form is obtained under the authority of the Mining Act. This information will be used to maintain a record and ongoing status of the mining claim(s). Questions about this collection should be directed to the Provincial Manager, Minings Lands, Ministry of Northern Development and Mines, 4th Floor, 159 Cedar Street, Sudbury, Ontario P3E 6A5, telephone (705) 670-7264.

Les renseignements personnels contenus dans la présente formule sont recueillis en vertu de la Loi sur les mines et serviront à tenir à jour un registre des concessions minières. Adresser toute question sur la collecte de ces renseignements au chef provincial des terrains miniers, ministère du Développement du Nord et des Mines, 159, rue Cedar, 4^e étage, Sudbury (Ontario) P3E 6A5, téléphone (705) 670-7264.

1. Direct Costs/Coûts directs

Type	Description	Amount Montant	Totals Total global
Wages Salaires	Labour Main-d'oeuvre		
	Field Supervision Supervision sur le terrain	1400	1400
Contractor's and Consultant's Fees Droits de l'entrepreneur et de l'expert- conseil	Type DOMINIK	4098.92 920.20	
		62.55 330.61 7632.20	
			12995
Supplies Used Fournitures utilisées	Type Core Rack	39	
			39
Equipment Rental Location de matériel	Type TRUCK TILDEN	350.00	
	ATV	250.00	
	RADIO CELLPHONE	50.00	650
Total Direct Costs Total des coûts directs			15084

2. Indirect Costs/Coûts indirects

Note: When claiming Rehabilitation work indirect costs are not allowable as assessment work.
Pour le remboursement des travaux de réhabilitation, les coûts indirects ne sont pas admissibles en tant que travaux d'évaluation.

Type	Description	Amount Montant	Totals Total global
Transportation Transport	Type GASOLINE	100.00	
			100
Food and Lodging Nourriture et hébergement			
Mobilization and Demobilization Mobilisation et démobilisation			
Sub Total of Indirect Costs Total partiel des coûts indirects			100
Amount Allowable (not greater than 20% of Direct Costs) Montant admissible (n'excédant pas 20 % des coûts directs)			100
Total Value of Assessment Credit (Total of Direct and Allowable Indirect costs)			15184

Note: The recorded holder will be required to verify expenditures claimed in this statement of costs within 30 days of a request for verification. If verification is not made, the Minister may reject for assessment work all or part of the assessment work submitted.

Note: Le titulaire enregistré sera tenu de vérifier les dépenses demandées dans le présent état des coûts dans les 30 jours suivant une demande à cet effet. Si la vérification n'est pas effectuée, le ministre peut rejeter tout ou une partie des travaux d'évaluation présentés.

Filing Discounts

1. Work filed within two years of completion is claimed at 100% of the above Total Value of Assessment Credit.
2. Work filed three, four or five years after completion is claimed at 50% of the above Total Value of Assessment Credit. See calculations below:

Total Value of Assessment Credit	Total Assessment Claimed
	x 0.50 =

Remises pour dépôt

1. Les travaux déposés dans les deux ans suivant leur achèvement sont remboursés à 100 % de la valeur totale susmentionnée du crédit d'évaluation.
2. Les travaux déposés trois, quatre ou cinq ans après leur achèvement sont remboursés à 50 % de la valeur totale du crédit d'évaluation susmentionné. Voir les calculs ci-dessous.

Valeur totale du crédit d'évaluation	Evaluation totale demandée
	x 0,50 =

Certification Verifying Statement of Costs

I hereby certify:
that the amounts shown are as accurate as possible and these costs were incurred while conducting assessment work on the lands shown on the accompanying Report of Work form.

that as CHRISTINE PETCH
(Recorded Holder, Agent, Position in Company) I am authorized

to make this certification

Attestation de l'état des coûts

J'atteste par la présente :
que les montants indiqués sont le plus exact possible et que ces dépenses ont été engagées pour effectuer les travaux d'évaluation sur les terrains indiqués dans la formule de rapport de travail ci-joint.

Et qu'à titre de _____ je suis autorisé
(titulaire enregistré, représentant, poste occupé dans la compagnie)

à faire cette attestation.

Signature C. Petch Date Nov. 28/95

Ministry of
Northern Development
and MinesMinistère du
Développement du Nord
et des Mines(705) 360-8330
Fax: 360-2001**File: W9560.00522**

April 15, 1996

Falconbridge Limited
P.O. Box 1140
571 Moneta Avenue
Timmins, ON
P4N 7H9**Subject: APPROVAL OF ASSESSMENT WORK SUBMITTED ON MINING
CLAIMS P-1204794 et al in REAUME TOWNSHIP**

A Notice of Deficiency was not issued on this Report of Work prior to the 90 day deemed approval date and as outlined in subsection 6(5) of the Mining Act Regulations this Report of Work is deemed approved as of **MARCH 3, 1996.**

If you require further information please contact Terry Binkley at (705) 360-8338.

Yours sincerely,

**Dale Messenger
Acting Mining Recorder
Porcupine Mining Division**

TB/

1080 rue Echo, P.O. Box 247
Val D'Or, Québec
J9P 4P3
Tel.: (819) 824-6839
Fax.: (819) 824-4217

forage

**MAJOR
DOMINIK**
drilling

Page 003
No 6206

CON'T:

MATERIAL LEFT IN HOLE :

REA-3101 : 4 Pails mud x 114,40 = 457,60
: 75m BW casing x 31,92 = 2 394,00
: 1 BW casing 2' x 39,50 = 39,50
: 1 BW to NQ crown x 440,00 = 440,00

15% Service charge
7% GST

\$ 3 331,10
499,67
268,15 ✓
\$ 4 098,92

DIVERS:

59 core boxe trays credit x 5,75 = (339,25)
Demobilization as per contract agreement = 860,00 x 7% = 920.25

Water line hole REA-43-01

21 man hrs x 23,50 = 493,50
5 muskeg hrs x 45,00 = 225,00
60 litres fuels x 0,40 = 24,00
3 100 lbs propane x 35,00 = 105,00
Total 847,50 ~1127 = 0,75 x 677 = 507,75

7% GST

\$ 1 028,50
72,00
\$ 1 100,50

Contract no. T1-732
Footage drilled 2283'
Meters drilled 696m

SUMMARY

Invoiced \$40 068,80
15% Service charge 499,67
7% GST 2 839,79
8% PST -----
TOTAL..... \$43 408,26

Core boxes. 61 m - 6 m / x 5.75 / bx = \$58.46 + 4.10 x = \$62.55

1080 rue Echo, P.O. Box 247
Val D'Or, Québec
J9P 4P3

Tel.: (819) 824-6839
Fax.: (819) 824-4217

forage

MAJOR
DOMINIK
drilling

Page 002
No 6206

CON'T:

ANALYSES:

REA-5501: sperry sun test at 60m, 120m, 180m.
REA-4301: sperry sun test at 60m.
REA-5201: sperry sun test at 45m, 60m, 120m.
REA-3101: sperry sun test at 77m.

8 sperry sun test n/c

OTHER COSTS:

Oct. 16 : 14 man hrs (move on hole REA-5501)
Oct. 17 : 24 man hrs (" ")
Oct. 17 : 8 float hrs (" ")
Oct. 17 : 1 tractor hr (" ")
Oct. 18 : 12 man hrs (finishing move REA-5501)
Oct. 18 : 2 tractpr hr (" ")
Oct. 20 : 16 man hrs (move on hole REA-4301)
Oct. 20 : 2 tractor hr (" ")
Oct. 22 : 6 man hrs (move on hole REA-5201)
Oct. 23 : 16 man hrs (build bridge)
Oct. 23 : 3 muskeg hrs (build bridge all wood)
Oct. 23 : 12 man hrs (move, build bridge)
Oct. 23 : 3 tractor hr (" ")
Oct. 24 : 10 man hrs (" ")
Oct. 24 : 5 tractor hr (" ")
Oct. 26 : 18 man hrs (move on hole REA-3101)
Oct. 26 : 5 tractor hr (" ")

423
700
823 + 57.61 * = 880.61

128 man hrs	x	23,50	=	3 008,00
8 float	x	70,00	=	560,00
18 tractor hrs	x	80,00	=	1 440,00
3 muskeg hrs	x	45,00	=	135,00

7% GST

\$ 5 143,00
360,01 ✓
\$ 5 503,01

1080 rue Echo, P.O. Box 247
Val D'Or, Québec
J9P 4P3
Tel.: (819) 824-6839
Fax.: (819) 824-4217

forage

MAJOR
DOMINIK
drilling

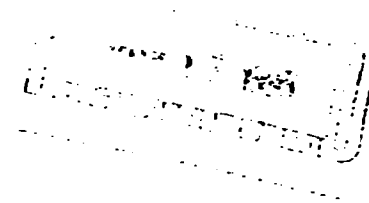

INVOICE 6206

Falconbridge limited
P.O. Box 1140
571 Moneta Avenue
Timmins (Ontario)
P4N 7H9

Octobre 31, 1995

TPS 89895 4896
TVQ 10175 04424

SURFACE DIAMOND DRILLING BO DUFF TWP OCTOBER 16-31/1995
DRILL NO. 6

Hole no. REA-55-01

From	0,00	to	15,00	=	15,00 m casing	x	41,80	=	627,00
	15,00	to	30,00	=	15,00 m casing	x	46,80	=	702,00
	30,00	to	37,00	=	7,00 m casing	x	56,80	=	397,60
	37,00	to	150,00	=	113,00 m coring	x	41,80	=	4 723,40
	150,00	to	197,00	=	47,00 m coring	x	43,55	=	2 046,85

Hole no. REA-43-01

From	0,00	to	15,00	=	15,00 m casing	x	41,80	=	627,00
	15,00	to	24,00	=	9,00 m casing	x	46,80	=	421,20
	24,00	to	150,00	=	126,00 m coring	x	41,80	=	5 266,80
	150,00	to	200,00	=	50,00 m coring	x	43,55	=	2 177,50

Hole no. REA-52-01

From	0,00	to	15,00	=	15,00 m casing	x	41,80	=	627,00
	15,00	to	30,00	=	15,00 m casing	x	46,80	=	702,00
	30,00	to	42,00	=	12,00 m casing	x	56,80	=	681,60
	42,00	to	150,00	=	108,00 m coring	x	41,80	=	4 514,40
	150,00	to	161,00	=	11,00 m coring	x	43,55	=	479,05

Hole no. REA-31-01

From	0,00	to	15,00	=	15,00 m casing	x	41,80	=	627,00
	15,00	to	30,00	=	15,00 m casing	x	46,80	=	702,00
	30,00	to	45,00	=	15,00 m casing	x	56,80	=	852,00
	45,00	to	60,00	=	15,00 m casing	x	76,80	=	1 152,00
	60,00	to	77,00	=	17,00 m casing	x	cost	=	-----
	77,00	to	138,00	=	61,00 m coring	x	41,80	=	2 549,80
					Cost : 20 man hrs	x	23,50	=	470,00
					10 drill hrs	x	22,00	=	220,00

7% GST

\$ 30 566,20
2 139,63 ✓
\$ 32 705,83

6572.80
460.10
7032.90

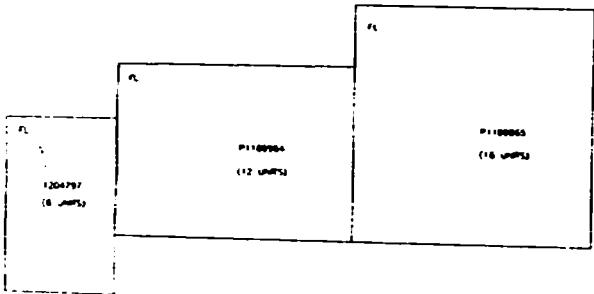

Handwritten note:
 1204797
 1204798
 1204799

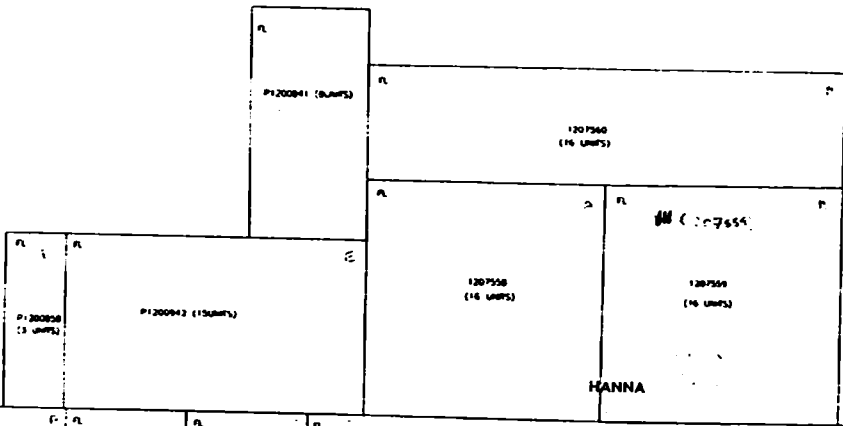

TOWNSHIP OF HANNA

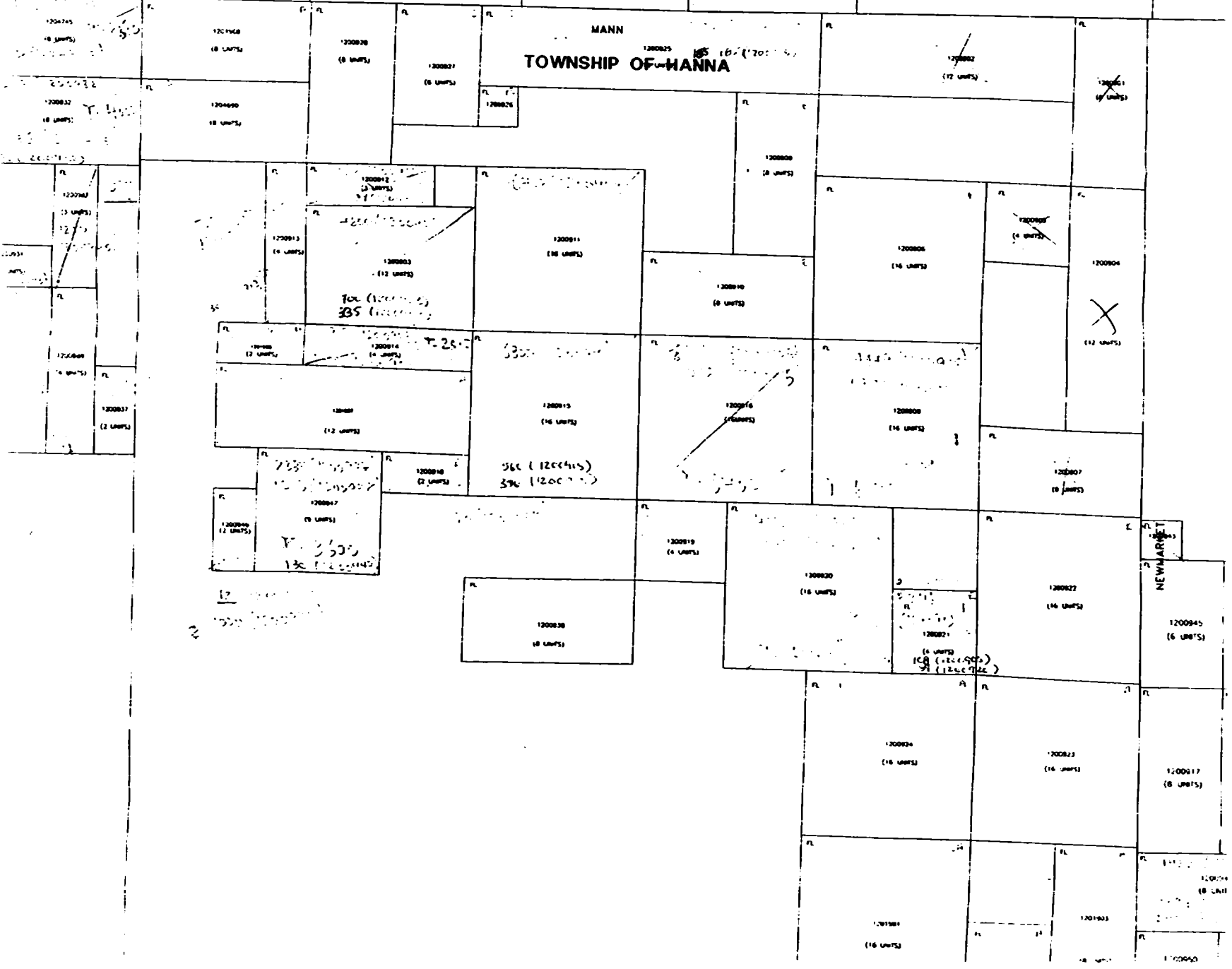

NOTES

400' surface rights reservation along the shores of all lakes and rivers.

Subdivision of this township into lots and concessions was annulled July 9, 1962.

SAND AND GRAVEL

- ⊕ GRAVEL RESERVE FILE 144570 EXPIRED, NOTICE RECEIVED 93-JAN-06
- ⊕ GRAVEL RESERVE FILE 144566
- ⊕ GRAVEL RESERVE FILE 170970
- ⊕ QUARRY PERMIT

* PROPOSED SILVICULTURE PLANTING CAMPS RECEIVED JANUARY 12, 1989

⊗ THIS TWP. IS SUBJECT TO FOREST ACTIVITY IN 1992/93. FURTHER INFORMATION AVAILABLE ON FILE.

⊕ SNOWMOBILE TRAIL NOTICE RECEIVED 92-DEC-09

⊗ THIS TWP. IS SUBJECT TO FOREST ACTIVITY IN 1993/94. FURTHER INFORMATION ON FILE.

⊗ THIS TWP. IS SUBJECT TO FOREST ACTIVITY IN 1993/94. (CHEM. SPRAY, JULY 22, 1993)

FOURNIER TP.

CONCESSION 1

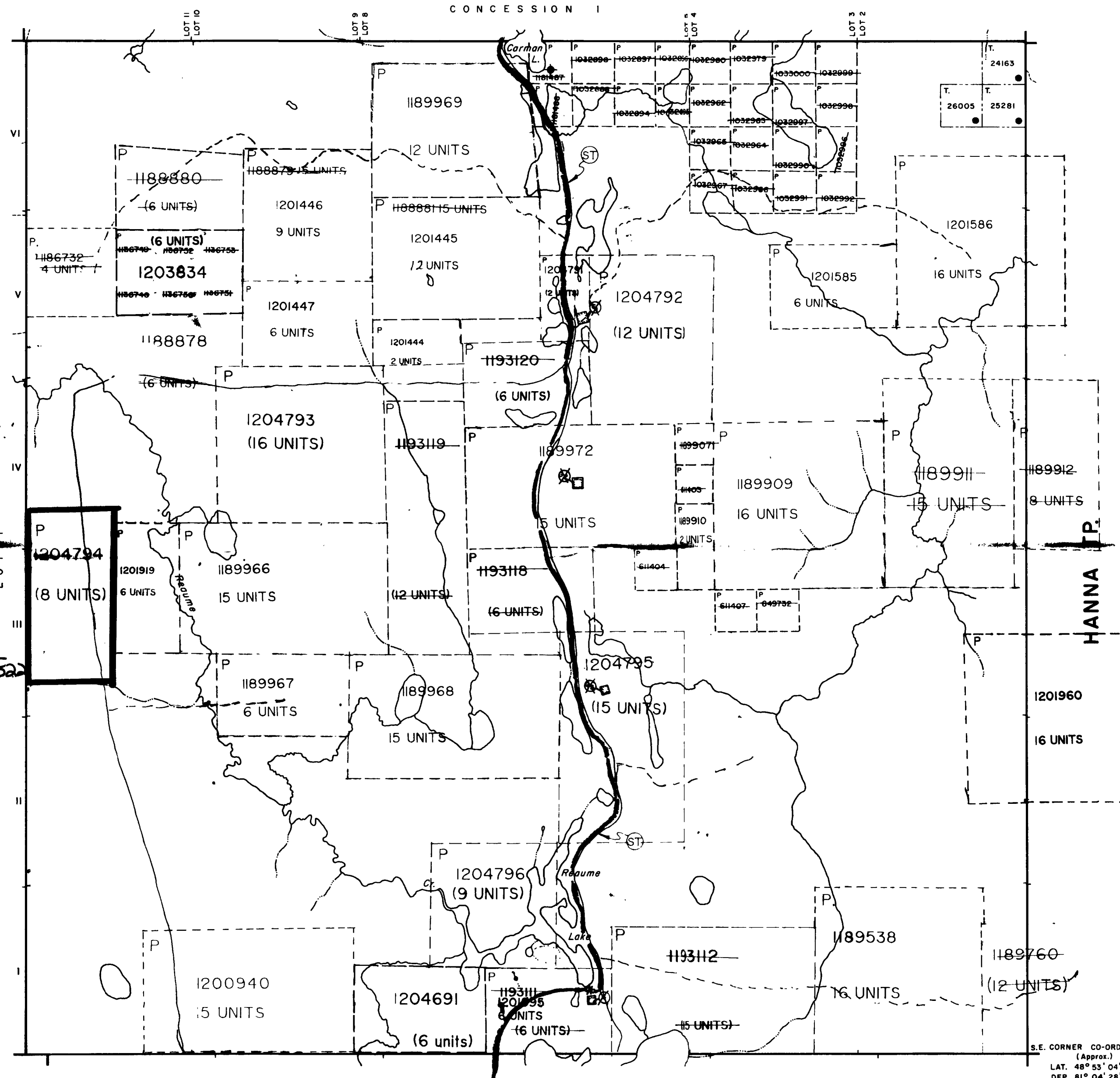

S.E. CORNER CO-ORDINATES (Approx.)
LAT. 48° 53' 04"
DER. 81° 04' 28"

LEGEND

- HIGHWAY AND ROUTE No.
- OTHER ROADS
- TRAILS
- SURVEYED LINES:
 - TOWNSHIPS, BASE LINES, ETC.
 - LOTS, MINING CLAIMS, PARCELS, ETC.
- UNSURVEYED LINES:
 - LOT LINES
 - PARCEL BOUNDARY
 - MINING CLAIMS ETC
- RAILWAY AND RIGHT OF WAY
- UTILITY LINES
- NON-PERENNIAL STREAM
- FLOODING OR FLOODING RIGHTS
- SUBDIVISION OR COMPOSITE PLAN RESERVATIONS
- ORIGINAL SHORELINE
- MARSH OR MUSKEG
- MINES
- TRAVERSE MONUMENT

DISPOSITION OF CROWN LANDS

TYPE OF DOCUMENT	SYMBOL
PATENT, SURFACE & MINING RIGHTS	●
" SURFACE RIGHTS ONLY	○
" MINING RIGHTS ONLY	◐
LEASE, SURFACE & MINING RIGHTS	■
" SURFACE RIGHTS ONLY	□
" MINING RIGHTS ONLY	◑
LICENCE OF OCCUPATION	▼
ORDER-IN-COUNCIL	OC
RESERVATION	⊙
CANCELLED	⊕
SAND & GRAVEL	⊕
RTS	◆

SCALE: 1 INCH = 40 CHAINS

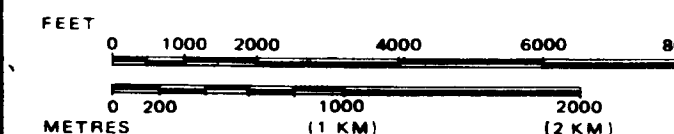

TOWNSHIP

REAUME

M.N.R. ADMINISTRATIVE DISTRICT

COCHRANE

MINING DIVISION

PORCUPINE

LAND TITLES / REGISTRY DIVISION

COCHRANE



Ministry of Natural Resources

Ministry of Northern Development and Mines

Date OCT. 1975

Number

G-3560

ACTIVATED JULY 20, 1992 BY D.C.

CHECKED BY G.W.



42A14NE0085 W9560-00522 REALUME