

FROM TC	ROCK TYPE	TEXTURE AND STRUCTURE	ANGLE TC CA	ALTERATION	MINERALIZATION	REMARKS
1.00 TO 42.00	*10B*					
42.00 TO 79.95	Mafic Volcanic Flows and Breccias *2,a,l,b*	<ul style="list-style-type: none"> - fine grained, aphyric. - medium green with dark grey. - series of 1-3 metre wide flows with 1 metre wide flow breccias. - breccia intervals are comprised of tightly packed, poorly sorted, angular fragments that range in size from 0.5-10cm. - matrix is fine grained and dark grey to locally black suggesting a minor amount of carbon in the system. - weak alignment of fragments at 40°/ca. - 55.15-56.47m - coarse to medium grained interval with feathery feldspars(?), up to 50%, in a fine grained, medium grey matrix. - downhole contact is lost in ground core. 		<ul style="list-style-type: none"> - cut by irregular quartz-carbonate veinlets and veins. Local quartz and carbonate euhedra in vugs within these veins. - 46-52m - 10% of the larger fragments within brecciated intervals have dark green, 1-3mm, up to 30%, rounded spots that are interpreted as an alteration feature (retrograded cordierites?). They do not have physical boundaries and appear to be chemical in nature. - 67-79.95m - rock has a paler green, bleached look and with up to 10% fine grained, bright green fuchsite. The alteration is most pronounced where mineralization is strongest. - 77.5-79.95m - 1-2mm wide, pale green veinlets(?) produce a net textured alteration pattern in both fragments and matrix. - minor medium grey, thin silica veinlets. 	<ul style="list-style-type: none"> - matrix to the fragment commonly contains trace to 2% fracture-controlled pyrite with lesser pyrrhotite and sphalerite. - 74.9-79.95m - up to 4% fracture-controlled and finely disseminated pyrite and pyrrhotite, predominantly in the matrix but locally within altered fragments. 	
79.95 TO 85.47	Mafic Intrusive *7,P*	<ul style="list-style-type: none"> - dark grey, porphyritic. - 10-15%, 1 mm, subangular, subequant feldspars and 5%, 1mm, subrounded, irregular, medium green mafic (pyroxene?) phenocrysts in a fine grained, dark grey matrix. - weak fabric/foliation near downhole contact at 40°/ca. - downhole contact is sharp and irregular (intrusive) at 40°/ca. 			<ul style="list-style-type: none"> - trace disseminated pyrite. - up to 0.5% fracture-controlled pyrite. 	<ul style="list-style-type: none"> - This unit may be a semi-conformable flow as the uphole mafic contact is altered and mineralized and whereas the downhole mafic contact is not. As a 30 metre-thick package of mafic volcanic rock and its associated alteration and mineralization patterns appear to be repeated on either side of the diorite, this location may also represent an intruded fault.
85.47 TO 113.40	Mafic Volcanic *2,a,e,s*	<ul style="list-style-type: none"> - fine grained, aphyric. - medium green. - similar to 42.00-79.95m. - series of flows and flow breccias with local in situ brecciation. 		<ul style="list-style-type: none"> - rare fragments are rimmed by rust-brown iron oxide(?) mineral. This mineral is also seen along rare fractures that cross-cut mineralization. 	<ul style="list-style-type: none"> - trace pyrite with lesser pyrrhotite is predominantly fracture-controlled with minor carbonate. 	

FROM TO	ROCK TYPE	TEXTURE AND STRUCTURE	ANGLE TO CA	ALTERATION	MINERALIZATION	REMARKS
		<ul style="list-style-type: none"> - matrix is typically dark grey, carbon-rich - 89.98-90.22 - dark grey, feldspar - pyroxene porphyritic mafic dyke. Also at 105.1-105.75m. - 91.65-96.00 [46?] - fine to medium grained, brownish-grey, granular textured. Contacts are gradational and irregular. Not magnetic, moderately soft (pyroxenite?). - 106.73-108.04m - core breaks along irregular surfaces represented by 2cm long, pale green amphibole-like blades (?) that are randomly oriented. Surface of core is fine grained and no coarse grained mineral is identifiable. - degree of alteration and mineralization, and argillite content in the matrix of the fragmental intervals increase approaching the downhole contact. - downhole contact is lost in ground core. 		<ul style="list-style-type: none"> - 100m - alteration and fracture density increases downhole with the reappearance of fuchsite. 	<ul style="list-style-type: none"> - 110m - mineralization increases to up to 4% pyrite with minor dark brown pyrrhotite. 	
113.40 TO 115.00	Graphitic Argillite +5,g	<ul style="list-style-type: none"> - fine grained, dark grey and dark brown. - weakly laminated, with submillimetre to 3mm bands at 70°/ca. - initial 2 metres are ground with up to 50% argillaceous fault gouge. 		<ul style="list-style-type: none"> - cut by irregular carbonate + quartz filled fractures with trace pink hematite(?) 	<ul style="list-style-type: none"> - 1% finely disseminated pyrite cubes (<1mm) only locally appear to be concentrated in distinct beds. 	<ul style="list-style-type: none"> - 114.7-115.0m - core lost due to grinding.
115.00 TO 121.52	Fault Zone +{FAI}	<ul style="list-style-type: none"> - fine grained, pale green to medium grey. - 80% of the interval is highly strained, crumbly rock. Fabric is randomly oriented but the preferred orientation is at 40°/ca. - 20% of interval is competent rock which is pale brown grey and soft, similar to the subinterval at 91.65-96.00. This may imply an ultramafic component to the zone. - downhole contact is sharp, faulted and at 50°/ca. 			<ul style="list-style-type: none"> - nil. 	
121.52 TO 132.85	Mafic Volcanic +2,a,n	<ul style="list-style-type: none"> - fine grained with local granular texture. - pale to medium green. - massive, inhomogeneous interval. - moderately soft, not magnetic. - 5% of core has 1mm, pale green spots that locally coalesce (may be varicles or an alteration texture) giving core a granular texture. - Thin, irregular interflow areas (1%) are dark grey to black and hard (siliceous), and dark brown and soft (argillaceous). 		<ul style="list-style-type: none"> - minor silica flooding. - 1% quartz + carbonate veins. - rare fine fractures with rust-red iron oxide staining. 	<ul style="list-style-type: none"> - trace disseminated pyrite is fracture-controlled and associated with the argillite. - rare 1-2mm pyrite cubes are fracture-controlled. 	

FROM TO	ROCK TYPE	TEXTURE AND STRUCTURE	ANGLE TO CA	ALTERATION	MINERALIZATION	REMARKS
		<ul style="list-style-type: none"> - texture suggests a more ultramafic composition. - 126.42-125.94m - dark brown-grey feldspar porphyritic dyke. - downhole contact is in broken core. 				
132.85 TO 134.40	Graphitic Argillite «5.g»	<ul style="list-style-type: none"> - fine grained. - dark brown to black. - rare, poorly developed, bands suggest weak bedding. - variably foliated. - downhole contact is faulted at 65°/ca. 				<ul style="list-style-type: none"> - rare pyrite in fractures with carbonate.
134.40 TO 136.50	Mafic Volcanic «2.a,S»	<ul style="list-style-type: none"> - pale green-grey, fine grained, weakly granular. - similar to 121.52-132.85m except that the interval is strongly fractured and moderately sheared. - moderately magnetic, moderately soft. - downhole contact is sharp at 75°/ca. 		<ul style="list-style-type: none"> - 1%, reddish, iron oxide stained veinlets. 		<ul style="list-style-type: none"> - trace pyrite. - trace thin bands of pyrrhotite within the highly strained intervals. - rare fine grained brown mineral (sphalerite?).
136.50 TO 161.00	Ultramafic «6.«Sr»»	<ul style="list-style-type: none"> - dark blue-grey with emerald green. - fine to medium grained, weak feathery textured. - strongly magnetic, soft. 		<ul style="list-style-type: none"> - moderate to strong pervasive serpentine alteration gives rock an emerald green hue. - serpentine also found in fractures with carbonate. - common reddish brown stain on fracture surfaces (hematite?). 		<ul style="list-style-type: none"> - trace disseminated pyrite.
161.00 TO 161.00	«ECH» End-of-hole					

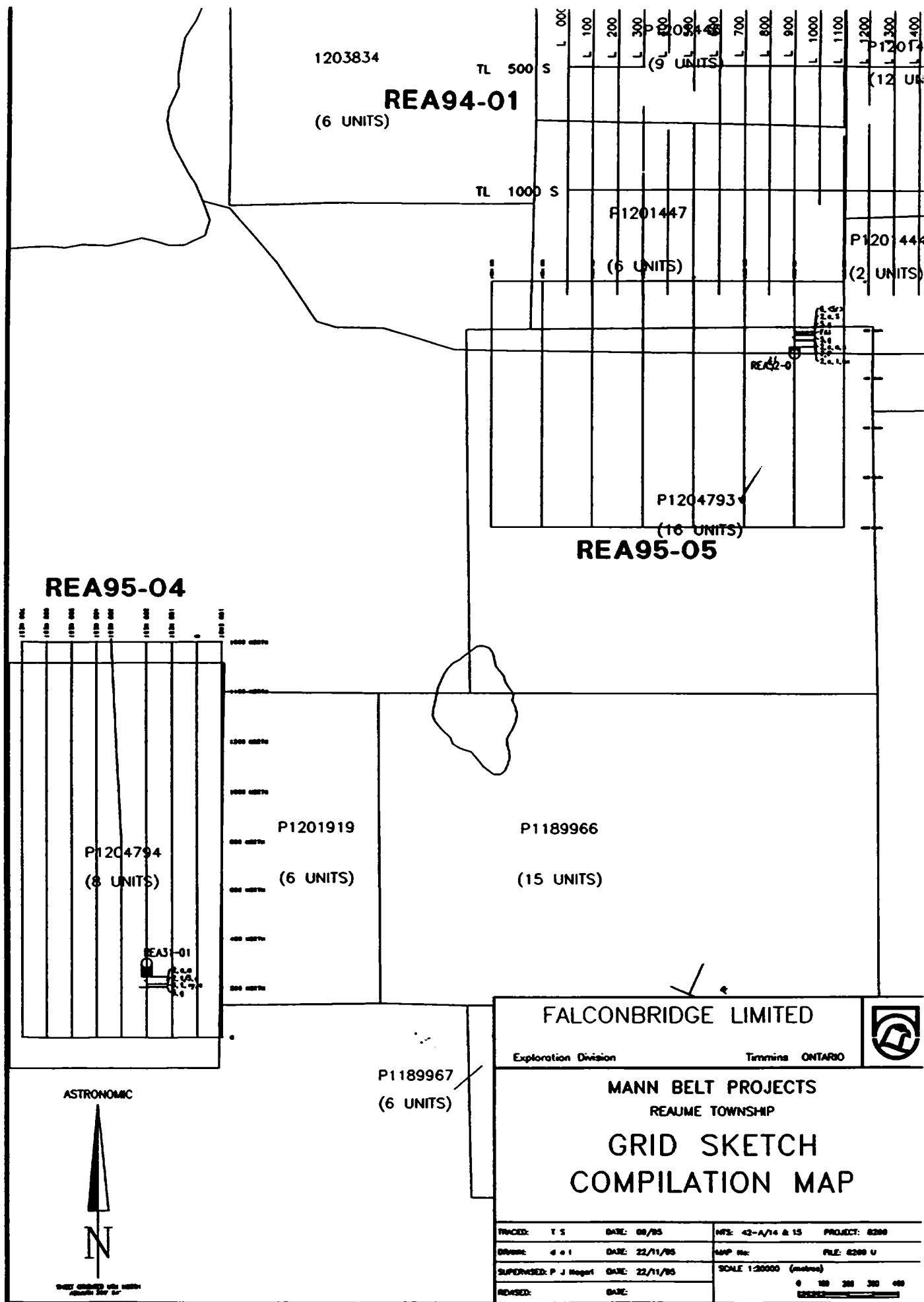

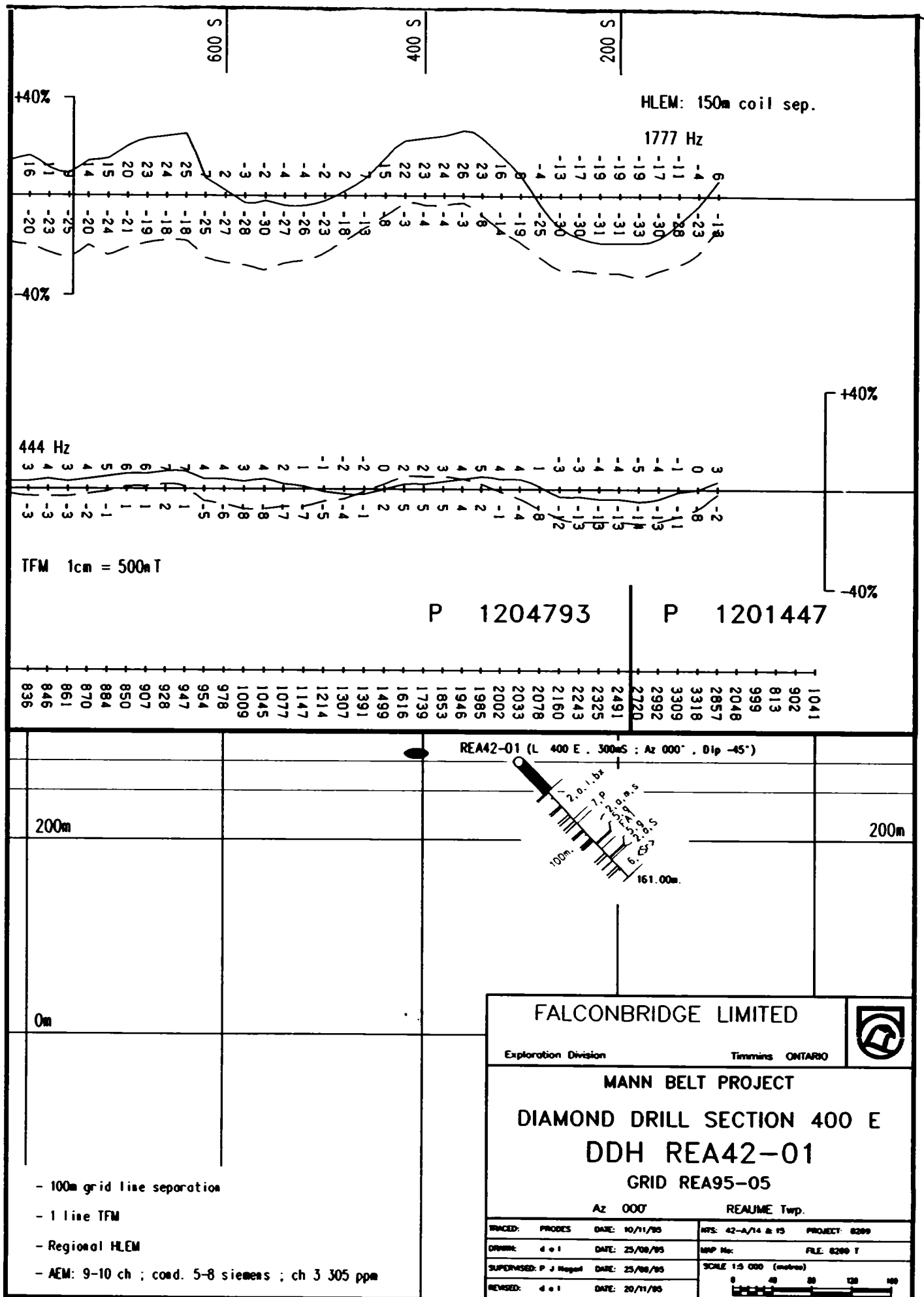

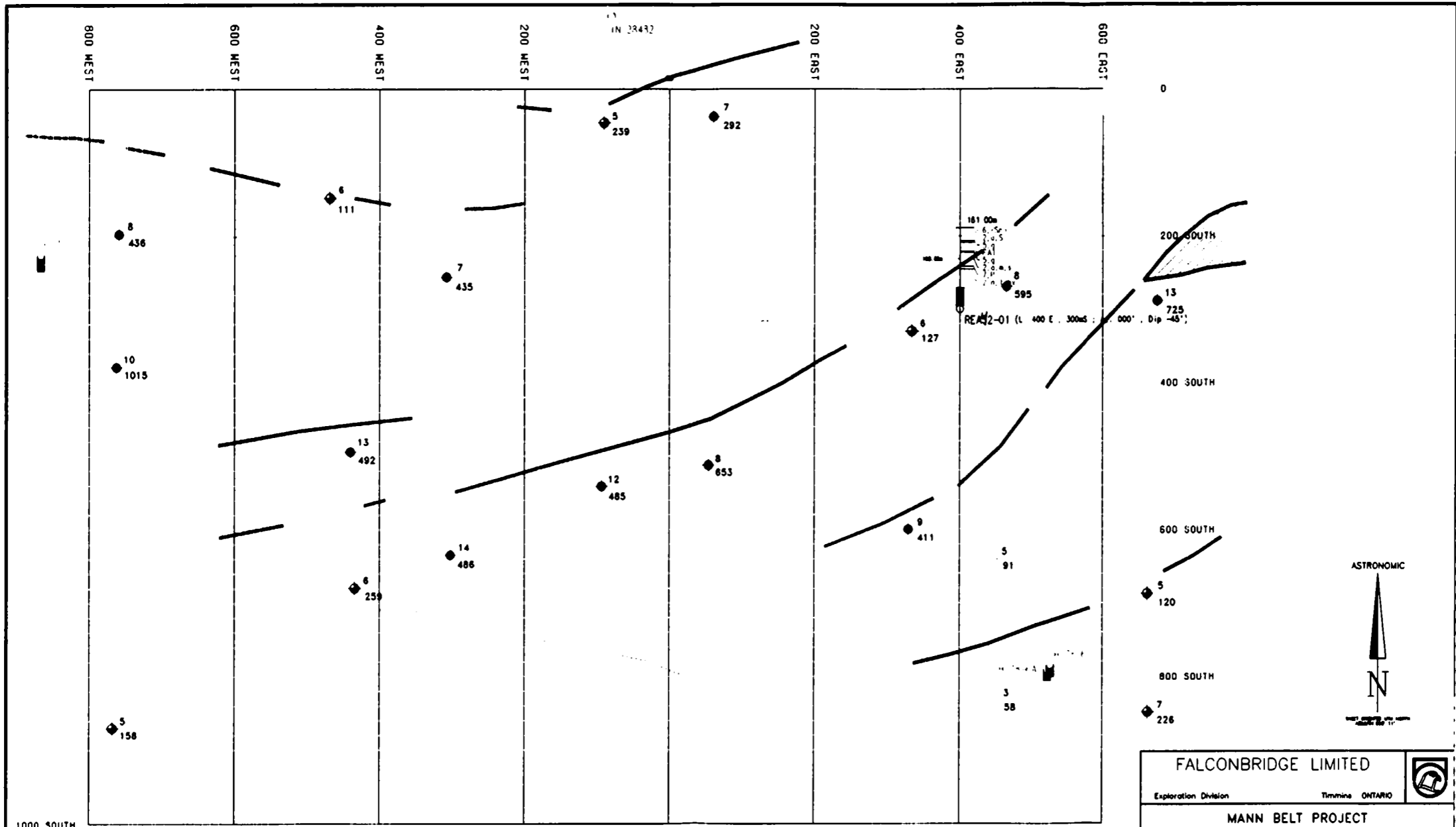

FALCONBRIDGE LIMITED		
Exploration Division	Timmins ONTARIO	
MANN BELT PROJECT GRID REA95-05 REAUME TOWNSHIP		
DIAMOND DRILL PLAN		
TRACED: Lesko	DATE: 10/94	HTS: 42-A/11
PROJECT: 8280		
DRAWN: P. Johnson	DATE: 10/94	MAP No.
SUPERVISED: P. J. Hoggart	DATE: 13/10/95	FILE: REA9505-
REVISED: 4 of 1	DATE: 26/11/95	SCALE: 1:5 000 (metres)
		0 40 80 120 160



Report of Work Conducted
After Recording Claim

Mining Act

Transaction Number
W9560.00523

Personal information collected on this form is obtained under the authority of the this collection should be directed to the Provincial Manager, Mining Lands, & Sudbury, Ontario, P3E 6A5, telephone (705) 670-7264.

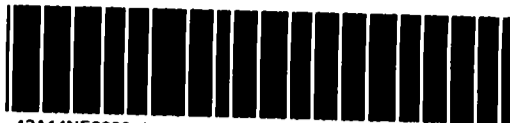

42A14NE0090 W9560-00523 REAUME

900

- Instructions:
- Please type or print and submit in duplicate.
 - Refer to the Mining Act and Regulations for requirements of filing assessment work or consult the mining Recorder.
 - A separate copy of this form must be completed for each Work Group.
 - Technical reports and maps must accompany this form in duplicate.
 - A sketch, showing the claims the work is assigned to, must accompany this form.

Recorded Holder(s) FALCONBRIDGE LIMITED		Client No. 130679
Address P.O. Box 1140, 571 MONETA AVE. TIMMINS, ONTARIO P4N 7H9		Telephone No. (705) 267-1188
Mining Division PORCUPINE	Township/Area REAUME	M or G Plan No.
Dates Work Performed From: October 20, 1995 To: October 26, 1995		

Work Performed (Check One Work Group Only)

Work Group	Type
Geotechnical Survey	
Physical Work, Including Drilling	DOMINIK DRILLING (ddh REA42-01; 161m)
Rehabilitation	
Other Authorized Work	
Assays	
Assignment from Reserve	

RECORDED
DEC 04 1995
Receipt _____

Total Assessment Work Claimed on the Attached Statement of Costs \$ 11611

Note: The Minister may reject for assessment work credit all or part of the assessment work submitted if the recorded holder cannot verify expenditures claimed in the statement of costs within 30 days of a request for verification.

Persons and Survey Company Who Performed the Work (Give Name and Address of Author of Report)

Name	Address
DOMINIK DRILLING	409 KING ST., P.O. Box 479, PORCUPINE, ONT.

(attach a schedule if necessary)

Certification of Beneficial Interest * See Note No. 1 on reverse side

I certify that at the time the work was performed, the claims covered in this work report were recorded in the current holder's name or held under a beneficial interest by the current recorded holder.	Date Nov. 28, 1995	Recorded Holder or Agent (Signature) Christine Petch
--	-----------------------	---

Certification of Work Report

I certify that I have a personal knowledge of the facts set forth in this Work report, having performed the work or witnessed same during and/or after its completion and annexed report is true.		
Name and Address of Person Certifying CHRISTINE PETCH P.O. Box 1140, 571 MONETA AVE. TIMMINS, ONTARIO P4N 7H9		
Telephone No. (705) 267-1188	Date NOVEMBER 28, 1995	Certified By (Signature) Christine Petch

For Office Use Only

Total Value Cr. Recorded \$ 11,611	Date Recorded	Mining Recorder	<div style="border: 2px solid black; padding: 5px; font-weight: bold; font-size: 1.2em;">RECEIVED</div> <p>DEC 4 1995 09:20 (c) [initials] PORCUPINE MINING DIVISION</p>
	Deemed Approval Date MARCH 3/96	Date Approved MARCH 3, 1996	
	Date Notice for Amendments Sent		



Ministry of
Northern Development
and Mines

Ministère du
Développement du Nord
et des mines

Statement of Costs
for Assessment Credit

État des coûts aux fins
du crédit d'évaluation

Transaction No./N° de transaction
W9560.00523

Mining Act/Loi sur les mines

Personal information collected on this form is obtained under the authority of the Mining Act. This information will be used to maintain a record and ongoing status of the mining claim(s). Questions about this collection should be directed to the Provincial Manager, Minings Lands, Ministry of Northern Development and Mines, 4th Floor, 159 Cedar Street, Sudbury, Ontario P3E 6A5, telephone (705) 670-7264.

Les renseignements personnels contenus dans la présente formule sont recueillis en vertu de la Loi sur les mines et serviront à tenir à jour un registre des concessions minières. Adresser toute question sur la collecte de ces renseignements au chef provincial des terrains miniers, ministère du Développement du Nord et des Mines, 159, rue Cedar, 4^e étage, Sudbury (Ontario) P3E 6A5, téléphone (705) 670-7264.

1. Direct Costs/Coûts directs

Type	Description	Amount Montant	Totals Total global
Wages Salaires	Labour Main-d'oeuvre		
	Field Supervision Supervision sur le terrain	1200.	1200.
Contractor's and Consultant's Fees Droits de l'entrepreneur et de l'expert- conseil	Type DOMINIK	1935.63	
		122.02	
		1494.33	
		951.98	9551
Supplies Used Fournitures utilisées	Type CORE RACKS	110	
			110
Equipment Rental Location de matériel	Type TRUCK-TILDEN	350. ⁰⁰	
	ATV	250. ⁰⁰	
	RADIO CELLPHONE	50. ⁰⁰	650
Total Direct Costs Total des coûts directs			11511

2. Indirect Costs/Coûts indirects

Note: When claiming Rehabilitation work indirect costs are not allowable as assessment work.
Pour le remboursement des travaux de réhabilitation, les coûts indirects ne sont pas admissibles en tant que travaux d'évaluation.

Type	Description	Amount Montant	Totals Total global
Transportation Transport	Type GASOLINE	100	
			100
Food and Lodging Nourriture et hébergement			
Mobilization and Demobilization Mobilisation et démobilisation			
Sub Total of Indirect Costs Total partiel des coûts indirects			100
Amount Allowable (not greater than 20% of Direct Costs) Montant admissible (n'excédant pas 20 % des coûts directs)			100
Total Value of Assessment Credit (Total of Direct and Allowable Indirect costs)			11611

Note: The recorded holder will be required to verify expenditures claimed in this statement of costs within 30 days of a request for verification. If verification is not made, the Minister may reject for assessment work all or part of the assessment work submitted.

Note: Le titulaire enregistré sera tenu de vérifier les dépenses demandées dans le présent état des coûts dans les 30 jours suivant une demande à cet effet. Si la vérification n'est pas effectuée, le ministre peut rejeter tout ou une partie des travaux d'évaluation présentés.

Filing Discounts

1. Work filed within two years of completion is claimed at 100% of the above Total Value of Assessment Credit.
2. Work filed three, four or five years after completion is claimed at 50% of the above Total Value of Assessment Credit. See calculations below:

Total Value of Assessment Credit	Total Assessment Claimed
	x 0.50 =

Remises pour dépôt

1. Les travaux déposés dans les deux ans suivant leur achèvement sont remboursés à 100 % de la valeur totale susmentionnée du crédit d'évaluation.
2. Les travaux déposés trois, quatre ou cinq ans après leur achèvement sont remboursés à 50 % de la valeur totale du crédit d'évaluation susmentionné. Voir les calculs ci-dessous.

Valeur totale du crédit d'évaluation	Evaluation totale demandée
	x 0,50 =

Certification Verifying Statement of Costs

I hereby certify:
that the amounts shown are as accurate as possible and these costs were incurred while conducting assessment work on the lands shown on the accompanying Report of Work form.

that as CHRISTINE PETEL I am authorized
(Recorded Holder, Agent, Position in Company)

to make this certification

Attestation de l'état des coûts

J'atteste par la présente :
que les montants indiqués sont le plus exact possible et que ces dépenses ont été engagées pour effectuer les travaux d'évaluation sur les terrains indiqués dans la formule de rapport de travail ci-joint.

Et qu'à titre de _____ je suis autorisé
(titulaire enregistré, représentant, poste occupé dans la compagnie)

à faire cette attestation.

Signature C. Petel Date Nov 28/95

Ministry of
Northern Development
and Mines

Ministère du
Développement du Nord
et des Mines

(705) 360-8330
Fax: 360-2001

File: W9560.00523

April 15, 1996

Falconbridge Limited
P.O. Box 1140
571 Moneta Avenue
Timmins, ON
P4N 7H9

**Subject: APPROVAL OF ASSESSMENT WORK SUBMITTED ON MINING
CLAIMS P-1204793 et al in REAUME TOWNSHIP**

A Notice of Deficiency was not issued on this Report of Work prior to the 90 day deemed approval date and as outlined in subsection 6(5) of the Mining Act Regulations this Report of Work is deemed approved as of MARCH 3, 1996.

If you require further information please contact Terry Binkley at (705) 360-8338.

Yours sincerely,



Dale Messenger
Acting Mining Recorder
Porcupine Mining Division

TB/

1080 rue Echo, P.O. Box 247
Val D'Or, Québec
J9P 4P3
Tel.: (819) 824-6839
Fax.: (819) 824-4217

forage

MAJOR
DOMINIK
drilling

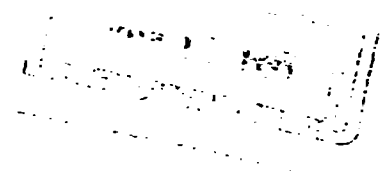

INVOICE 6206

Falconbridge limited
P.O. Box 1140
571 Moneta Avenue
Timmins (Ontario)
P4N 7H9

Octobre 31, 1995

TPS 89895 4896
TVQ 10175 04424

SURFACE DIAMOND DRILLING BO DUFF TWP OCTOBER 16-31/1995
DRILL NO. 6

Hole no. REA-55-01

From	0,00 to 15,00 =	15,00 m casing x 41,80 =	627,00
	15,00 to 30,00 =	15,00 m casing x 46,80 =	702,00
	30,00 to 37,00 =	7,00 m casing x 56,80 =	397,60
	37,00 to 150,00 =	113,00 m coring x 41,80 =	4 723,40
	150,00 to 197,00 =	47,00 m coring x 43,55 =	2 046,85

Hole no. REA-43-01

From	0,00 to 15,00 =	15,00 m casing x 41,80 =	627,00
	15,00 to 24,00 =	9,00 m casing x 46,80 =	421,20
	24,00 to 150,00 =	126,00 m coring x 41,80 =	5 266,80
	150,00 to 200,00 =	50,00 m coring x 43,55 =	2 177,50

Hole no. REA-⁴32-01

From	0,00 to 15,00 =	15,00 m casing x 41,80 =	627,00
	15,00 to 30,00 =	15,00 m casing x 46,80 =	702,00
	30,00 to 42,00 =	12,00 m casing x 56,80 =	681,60
	42,00 to 150,00 =	108,00 m coring x 41,80 =	4 514,40
	150,00 to 161,00 =	11,00 m coring x 43,55 =	479,05

7004.05 x 490.25 = 7494.33

Hole no. REA-31-01

From	0,00 to 15,00 =	15,00 m casing x 41,80 =	627,00
	15,00 to 30,00 =	15,00 m casing x 46,80 =	702,00
	30,00 to 45,00 =	15,00 m casing x 56,80 =	852,00
	45,00 to 60,00 =	15,00 m casing x 76,80 =	1 152,00
	60,00 to 77,00 =	17,00 m casing x cost =	-----
	77,00 to 138,00 =	61,00 m coring x 41,80 =	2 549,80
	Cost :	20 man hrs x 23,50 =	470,00
		10 drill hrs x 22,00 =	220,00

7% GST

\$ 30 566,20
2 139,63 ✓
\$ 32 705,83

1080 rue Echo, P.O. Box 247
Val D'Or, Québec
J9P 4P3

Tel.: (819) 824-6839
Fax.: (819) 824-4217

forage

MAJOR
DOMINIK
drilling

Page 002
No 6206

CON'T:

ANALYSES:

REA-5501: sperry sun test at 60m,120m,180m.
REA-4301: sperry sun test at 60m.
REA-5201: sperry sun test at 45m,60m,120m.
REA-3101: sperry sun test at 77m.

8 sperry sun test n/c

OTHER COSTS:

Oct. 16 : 14 man hrs (move on hole REA-5501)
Oct. 17 : 24 man hrs (" ")
Oct. 17 : 8 float hrs (" ")
Oct. 17 : 1 tractor hr (" ")
Oct. 18 : 12 man hrs (finishing move REA-5501)
Oct. 18 : 2 tractpr hr (" ")
Oct. 20 : 16 man hrs (move on hole REA-4301)
Oct. 20 : 2 tractor hr (" ")
Oct. 22 : 6 man hrs (move on hole REA-~~4301~~)
Oct. 23 : 16 man hrs (build bridge)
Oct. 23 : 3 muskeg hrs (build bridge all wood)
Oct. 23 : 12 man hrs (move, build bridge)
Oct. 23 : 3 tractor hr (" ")
Oct. 24 : 10 man hrs (" ")
Oct. 24 : 5 tractor hr (" ")
Oct. 26 : 18 man hrs (move on hole REA-3101)
Oct. 26 : 5 tractor hr (" ")

44 x 23.⁵⁰ = 1034
3 x 45 = 135
8 x 80 = 640
1809 -
+ 126.63
1935.63

128 man hrs x 23,50 = 3 008,00
8 float x 70,00 = 560,00
18 tractor hrs x 80,00 = 1 440,00
3 muskeg hrs x 45,00 = 135,00

7% GST

\$ 5 143,00
360,01 ✓
\$ 5 503,01

REA42-C-1

conc box: 119 m³ / 6 m³/bx x \$ 5.75/bx = 114.01 * 7.98 = \$1122.02

BECK

LUCAS

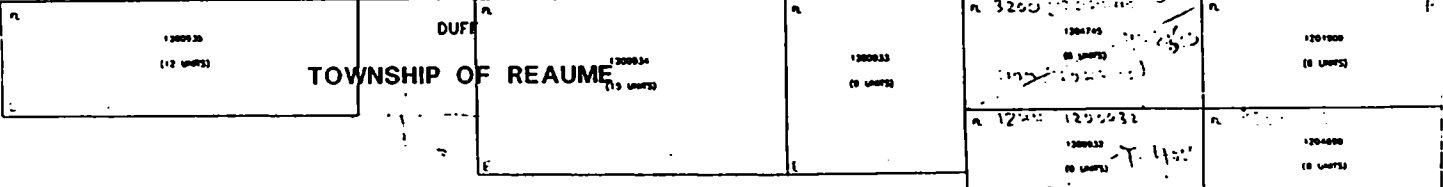
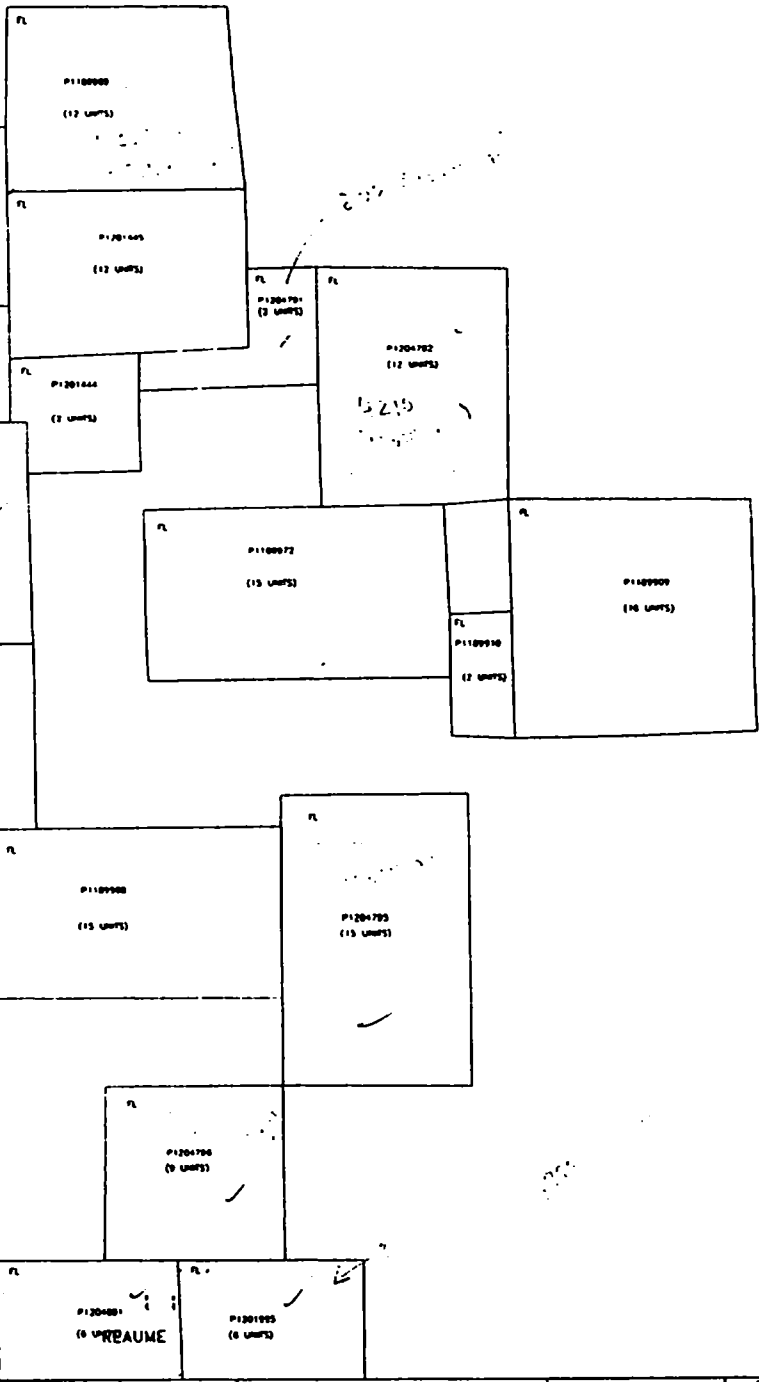

120051 (8 UNITS)
 120052 (8 UNITS)
 120053 (8 UNITS)
 120054 (15 UNITS)
 120055 (8 UNITS)
 120056 (8 UNITS)

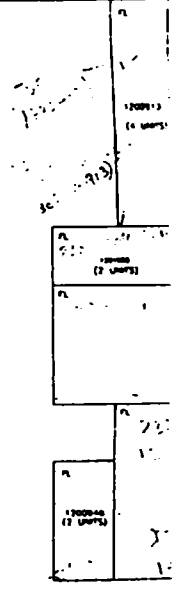
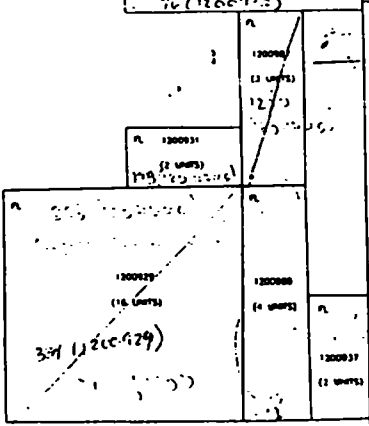

Pg 2/2
 120067
 120068
 120069

120070 (8 UNITS)
 120071 (8 UNITS)
 120072 (8 UNITS)

ST. JOHN

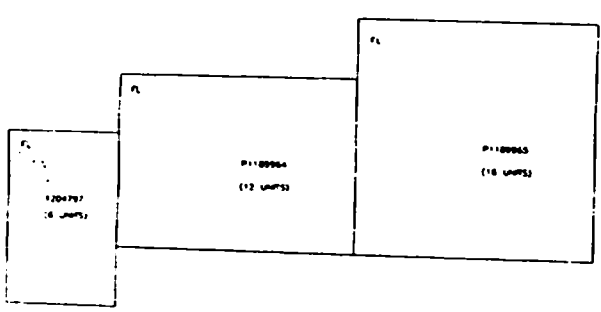

1755 (10)
145 (10)
100 (10)

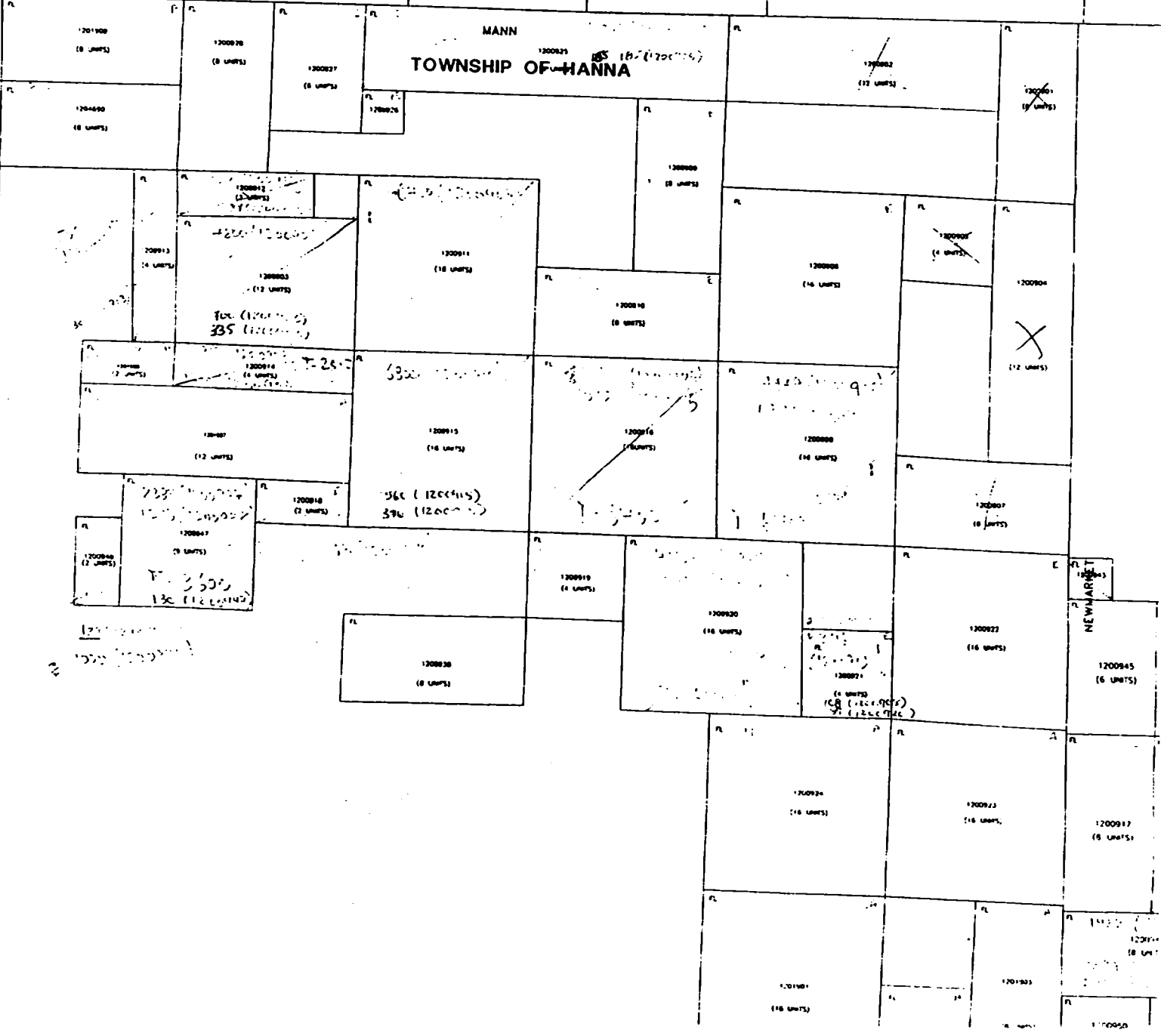
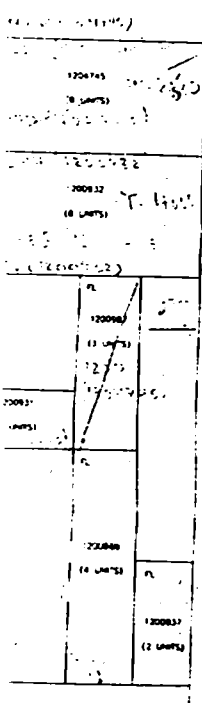
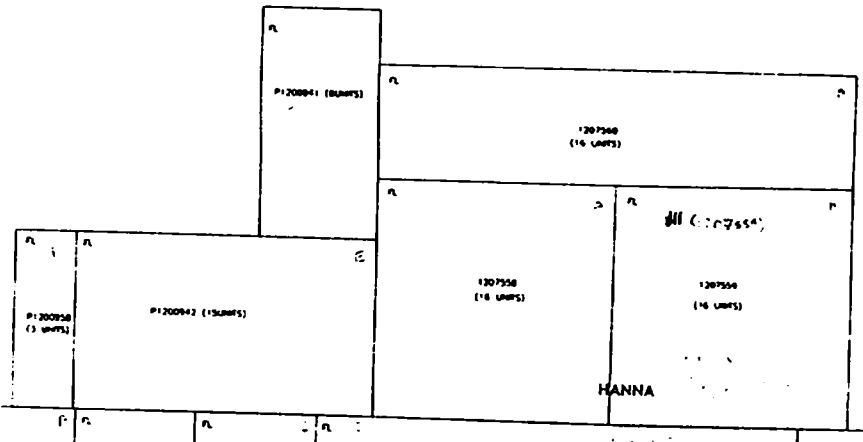

NOTES

400' surface rights reservation along the shores of all lakes and rivers.

Subdivision of this township into lots and concessions was annulled July 9, 1962.

SAND AND GRAVEL

- GRAVEL RESERVE FILE 114570 EXPIRED, NOTICE RECEIVED 93-JAN-06
- GRAVEL RESERVE FILE 114686
- GRAVEL RESERVE FILE 170970
- QUARRY PERMIT

* PROPOSED SILVICULTURE PLANTING CAMPS RECEIVED JANUARY 12, 1989

⊗ THIS TWP. IS SUBJECT TO FOREST ACTIVITY IN 1992/93. FURTHER INFORMATION AVAILABLE ON FILE.

⊗ SNOWMOBILE TRAIL NOTICE RECEIVED 92-DEC-09

⊗ THIS TWP. IS SUBJECT TO FOREST ACTIVITY IN 1993/94. FURTHER INFORMATION ON FILE.

⊗ THIS TWP. IS SUBJECT TO FOREST ACTIVITY IN 1993/94. (CHEM. SPRAY, JULY 22, 1995)

FOURNIER TP.

CONCESSION 1

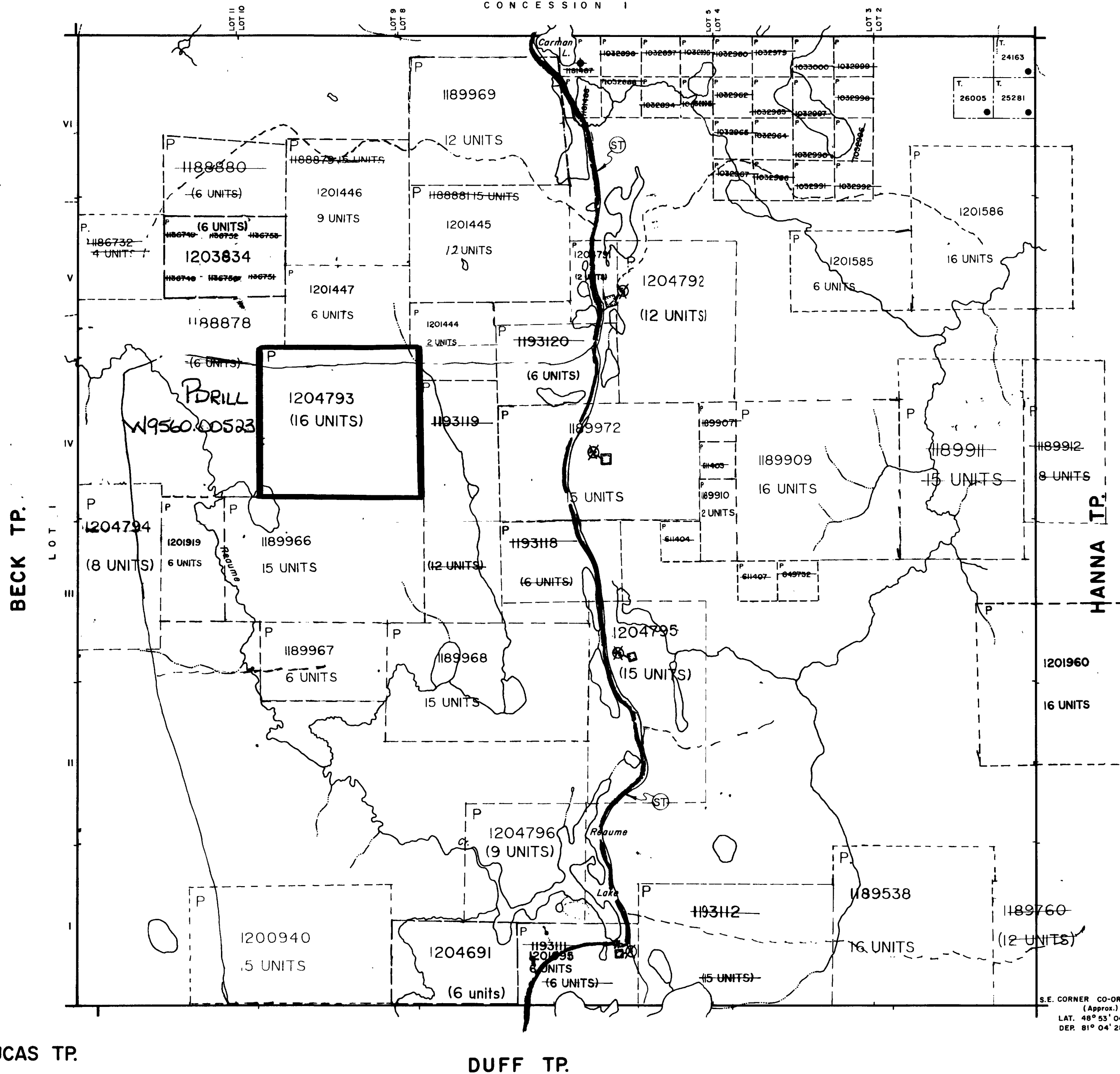

S.E. CORNER CO-ORDINATES (Approx.)
LAT. 48° 53' 04"
DEP. 81° 04' 28"

LEGEND

- HIGHWAY AND ROUTE No.
- OTHER ROADS
- TRAILS
- SURVEYED LINES:
 - TOWNSHIPS, BASE LINES, ETC.
 - LOTS, MINING CLAIMS, PARCELS, ETC.
- UNSURVEYED LINES:
 - LOT LINES
 - PARCEL BOUNDARY
 - MINING CLAIMS ETC.
- RAILWAY AND RIGHT OF WAY
- UTILITY LINES
- NON-PERENNIAL STREAM
- FLOODING OR FLOODING RIGHTS RESERVATIONS
- SUBDIVISION OR COMPOSITE PLAN
- ORIGINAL SHORELINE
- MARSH OR MUSKEG
- MINES
- TRAVERSE MONUMENT

DISPOSITION OF CROWN LANDS

TYPE OF DOCUMENT	SYMBOL
PATENT, SURFACE & MINING RIGHTS	●
" SURFACE RIGHTS ONLY	○
" MINING RIGHTS ONLY	◐
LEASE, SURFACE & MINING RIGHTS	■
" SURFACE RIGHTS ONLY	□
" MINING RIGHTS ONLY	◑
LICENCE OF OCCUPATION	◒
ORDER-IN-COUNCIL	OC
RESERVATION	⊙
CANCELLED	⊘
SAND & GRAVEL	⊗
RTS	⊛

SCALE: 1 INCH = 40 CHAINS

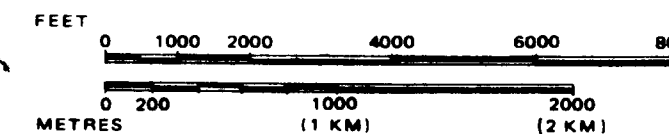

TOWNSHIP

REAUME

M.N.R. ADMINISTRATIVE DISTRICT

COCHRANE

MINING DIVISION

PORCUPINE

LAND TITLES / REGISTRY DIVISION

COCHRANE



Ministry of Natural Resources Ontario

Ministry of Northern Development and Mines

Date OCT. 1975

Number

G-3560

ACTIVATED JULY 20, 1992 BY D.C.

CHECKED BY G.W.



42A14NE0090 W9580-00523 REAUME