



42A14SE0008 2.6744 LUCAS

010

ASSESSMENT REPORT

ON THE

LUCAS EAST GROUP
(28 CLAIMS)

BY

S. L. FUMERTON
CHEVRON CANADA RESOURCES LIMITED
167B WILSON AVENUE
TIMMINS, ONTARIO
P4N 2T2

FOR

ABITIBI-PRICE INC.
TORONTO-DOMINION BANK TOWER
TORONTO, ONTARIO

RECEIVED

MAY 11 1984

MINING LANDS SECTION

April 5, 1984

The 566 days of work credits from this Input Survey are to be distributed evenly over the total claim group. That is 20 days/claim, with the remaining 6 days forfeited because the maximum of 80 days/claim of geophysical work has been achieved.

ASSESSMENT REPORT

LUCAS EAST GROUP (28 CLAIMS)

LUCAS TOWNSHIP	CON III LOT 1
	CON III LOT 2
N 1/2	CON III LOT 3
S 1/2	CON IV LOT 1
S 1/2	CON IV LOT 2

CLAIMS: 595011, 595012, 595013, 595014, 595015,
595016, 595017, 595018, 595019, 595020

597024, 597025, 597026, 597027, 597028,
597029, 597030, 597031, 597032, 597033

597064, 597065, 597066, 597067, 597068,
597069, 597070, 597071

Fig. 1 - Location Map, South East part of Lucas Township
 Scale 1:31,680

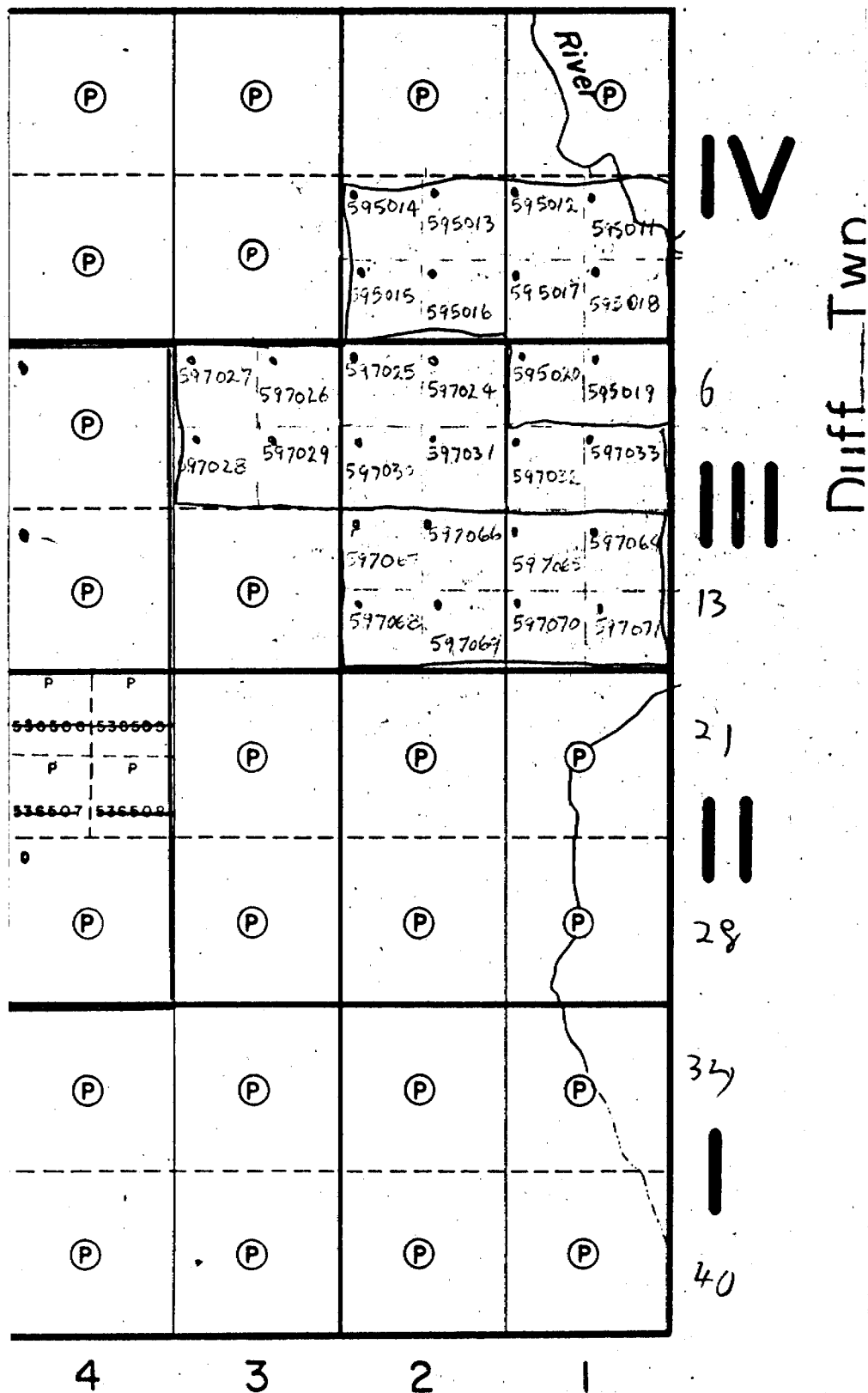

INTERPRETATION

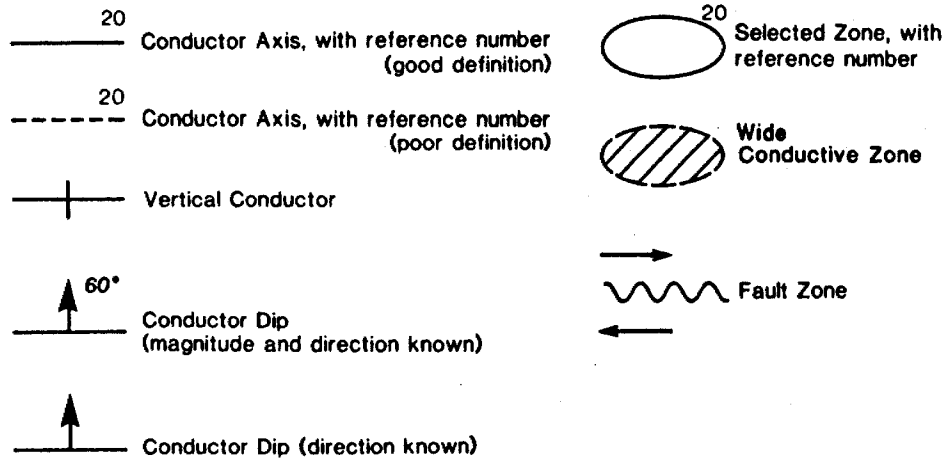

Representative INPUT[®] Magnetometer and Altimeter Recording

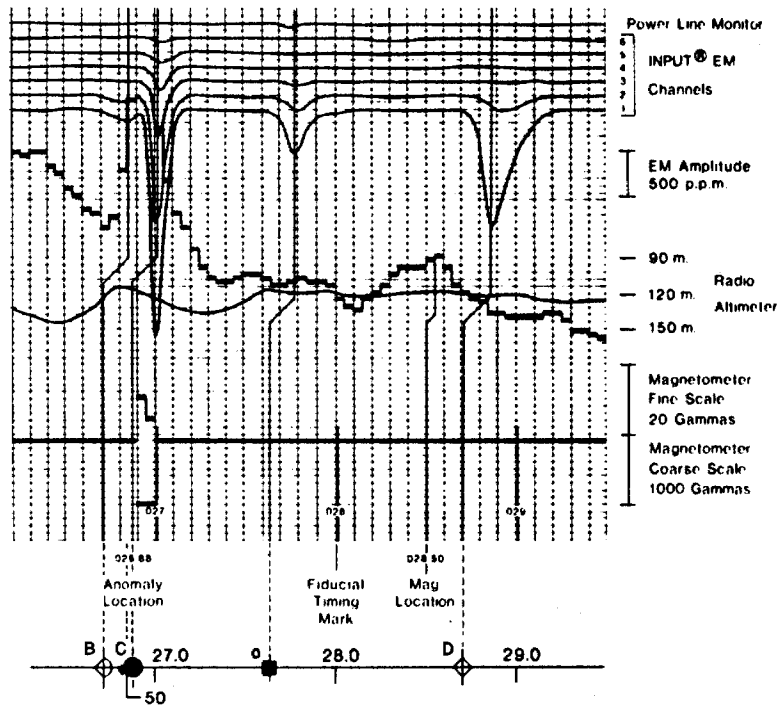

INPUT[®] PEAK RESPONSE SYMBOLS 1ms PULSE

SURFICIAL RESPONSE	UP-DIP PEAK RESPONSE	BEDROCK RESPONSE	DECAY INTERVAL CLASSIFICATION
			1 Channel (322 microseconds)
			2 Channel (486 microseconds)
			3 Channel (732 microseconds)
			4 Channel (1060 microseconds)
			5 Channel (1470 microseconds)
			6 Channel (1962 microseconds)

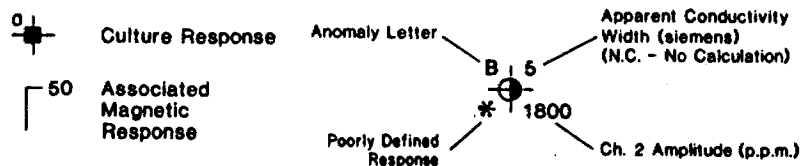

DESCRIPTIVE NOTES

The aircraft is equipped with the Barringer/Questor Mark VI INPUT[®] airborne E.M. System and the Sonotek PMH 5010 Proton Precession Magnetometer and Sonotek SDS-1200 Series Data Acquisition System. The INPUT[®] system will respond to conductive overburden and near-surface horizontal conducting layers in addition to bedrock conductors. Discrimination of conductors is based on the rate of transient decay, magnetic correlation and the anomaly shape, together with the conductor pattern and topography.

[®] Registered Trade Mark of Barringer Research Limited

INTERPRETATION REFERENCES

- Becker, A., Gauvreau, C., and Collett, L.S.
1972: Scale Model Study of Time Domain Electromagnetic Response of Tabular Conductors; Canadian Mining and Metallurgical Bulletin, Volume 65, No. 725, p. 90-96.
- Dyck, A.V., Becker, A., and Collett, L.S.
1974: Surficial Conductivity Mapping with the Airborne INPUT[®] System; Canadian Mining and Metallurgical Bulletin, Volume 67, No. 744, p. 104-109.
- Lazenby, P.G.
1973: New Developments in the INPUT[®] Airborne E.M. System; Canadian Mining and Metallurgical Bulletin, Volume 66, No. 732, p. 96-104.
- Nelson, Philip, H.
1973: Model Results and Field Checks for a Time-Domain Airborne E.M. System; Geophysics, Volume 38, No. 5, p. 845-853.
- Palacky, G.J., and West G.F.
1974: Computer Processing of Airborne Electromagnetic Data; Geophysical Prospecting, Volume 22, No. 3, p. 490-509.

This survey forms part of a larger survey which consisted of 1,250 km.

Type of instrument was Questor/Barringer's Mk VI Input System mounted on a Britten-Norman Trislander.

Flight line control was achieved using a 35mm strip camera with fiducial points plotted on a 1:20,000 uncontrolled photo mosaic.

Results of the survey shows that the claim group is underlain by numerous weak conductors, some of which are probably formational conductors which trend south-east.



S. L. Fumerton,
Geologist

for

J. P. Steele,
Chief Geophysicist

RECEIVED
AUG 07 1964
MILITARY DIVISION

2.6744

Questor Mark VI Input Survey, October 1983
Lucas East Group, Lucas Township

A total of 22.8 km of continuous recording was made over
this claim group, equivalent to 566 days of work credits.

Fig. 2 - Input Survey

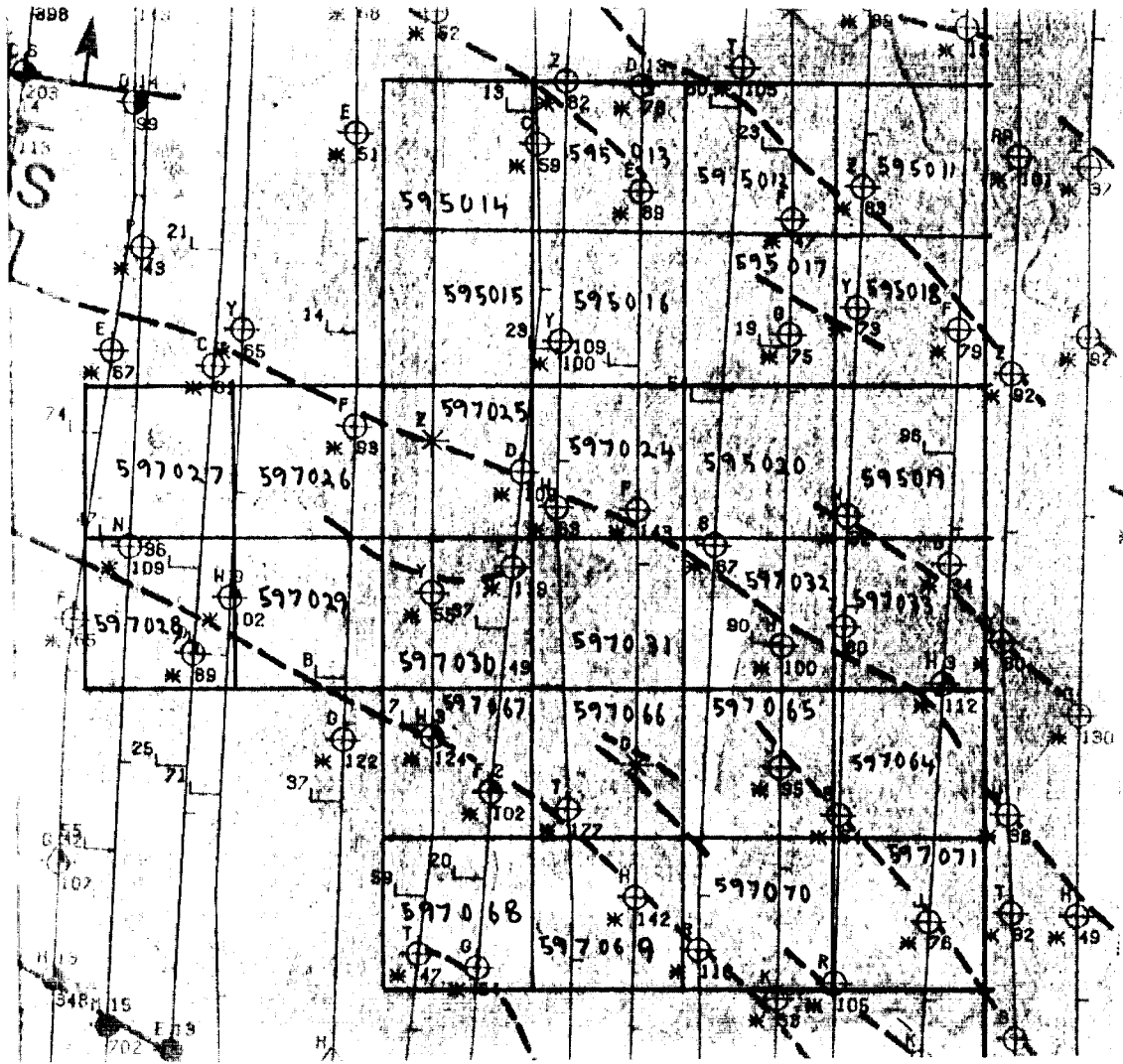

Scale 1:20,000
See legend on the following pages.

Levin F. Farnsworth

CERTIFICATE

I, Stewart Fumerton, hereby certify that:

- 1) I am a 1973 BSc Geology, 1974 BSc Honours Geology, and a 1975 MSc Geology Graduate of the University of the Witwatersrand. Furthermore, I am a 1979 PhD Geology Graduate of the University of Saskatchewan.
- 2) Subsequent to graduating, I have worked two (2) years as a Research Assistant at the Bernard Price Institute of Geophysics R.S.A., five (5) years as a Geologist carrying out government mapping in Saskatchewan and Ontario, and I have worked as an Exploration Geologist for five (5) years for Comaplex, Atla; Shell Canada, Ontario; Iron Ore Co., Quebec; and Chevron Canada, Ontario.
- 3) The work described herein was assembled and written by myself, though the survey was supervised by John Steele who was not present at the time the report was written.



Stewart Fumerton
Chevron Canada Resources Ltd.

RECEIVED
AUG 07 1984
MINING ENGINEERING SECTION



Report of Work
(Geophysical, Geological,
Geochemical and Expenditures)

W.R.
161



42A145E0008 2.6744 LUCAS

900

W 8906/61 2.6744

Mir

Type of Survey(s) **Input EM Survey**

Claim Holder(s) **Abitibi-Price Inc.**

Address **Toronto-Dominion Tower, Toronto**

Survey Company **Questor Ltd.**

Date of Survey (from & to) **19 10 83** to **21 10 83**

Total Miles of line Cut

Name and Address of Author (of Geo-Technical report) **Stewart Fumerton, Chevron Canada Resources Limited, Timmins, Ont. P4N 2T2**

Lucas Township (Prospector's License No. **7-840**)

167B Wilson Avenue

Credits Requested per Each Claim in Columns at right

Mining Claims Traversed (List in numerical sequence)

Special Provisions	Geophysical	Days per Claim
For first survey: Enter 40 days. (This includes line cutting)	Electromagnetic	
	Magnetometer	
For each additional survey: using the same grid: Enter 20 days (for each)	Radiometric	
	Other	
	Geological	
	Geochemical	
Airborne Credits		Days per Claim
Notes: Special provisions credits do not apply to Airborne Surveys.	Electromagnetic	20
	Magnetometer	
	Radiometric	

Mining Claim		Expend. Days Cr.	Mining Claim		Expend. Days Cr.
Prefix	Number		Prefix	Number	
P	595011		P	597067	
	595012			597068	
	595013			597069	
	595014			597070	
	595015			597071	
	595016				
	595017				
	595018				
	595019				
	595020				
	597024				
	597025				
	597026				
	597027				
	597028				
	597029				
	597030				
	597031				
	597032				
	597033				
	597064				
	597065				
	597066				

RECEIVED
PORCUPINE MINING DIVISION
APR 13 1984
7:8 9 10 11 12 1 2 3 4 5 6 7

RECEIVED
MAY 11 1984
LANDS SECTION

RECORDED
APR 15 1984
Receipt No. 30

Expenditures (excludes power stripping)

Type of Work Performed

Performed on Claim(s)

Calculation of Expenditure Days Credits

Total Expenditures \$ + 15 =

Total Days Credits

Instructions
Total Days Credits may be apportioned at the claim holder's choice. Enter number of days credits per claim selected in columns at right.

Total number of mining claims covered by this report of work. **28**

For Office Use Only

Total Days Cr. Recorded **560**

Date Recorded **April 13, 1984**

Date Approved as Recorded **84.9.13**

Mining Recorder **[Signature]**

Area Director **[Signature]**

Date **April 13/84**

Recorded Holder or Agent (Signature) **[Signature]**

Certification Verifying Report of Work

I hereby certify that I have a personal and intimate knowledge of the facts set forth in the Report of Work annexed hereto, having performed the work or witnessed same during and/or after its completion and the annexed report is true.

Name and Postal Address of Person Certifying
John P. Steele, Mountjoy Road 3, R. R. #2, Timmins, Ontario P4N 2T2

Date Certified **April 13, 1984**

Certified by (Signature) **[Signature]**

268-9926

Mining Lands Section

File No 26744

Control Sheet

TYPE OF SURVEY



GEOPHYSICAL

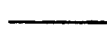

GEOLOGICAL



GEOCHEMICAL



EXPENDITURE

MINING LANDS COMMENTS:

- qualifications
- not signed

RECEIVED
APR 24 1985
MINING LANDS SECTION

L.D.

Arthur Barr
Signature of Assessor

August 28th 1984
Date

August 20, 1984

File: 2.6744

Abitibi-Price Inc
P.O. Box 21
Toronto Dominion Centre
Toronto, Ontario
M5K 1B3

Dear Sirs:

RE: Airborne Geophysical (Electromagnetic)
Survey submitted on Mining Claims
P 595011 et al in the Township of Lucas

Returned herein are the plans, (in duplicate), for the above-mentioned survey. Please have the author of the Report sign each copy and return the material to this office quoting file 2.6744.

For further information, please contact Mr. Ray Pichette at (416)965-4888.

Yours sincerely,

S.E. Yundt
Director
Land Management Branch

Whitney Block, Room 6643
Queen's Park
Toronto, Ontario
M7A 1W3
Phone:(416)965-4888

S. Hurst:mc

cc: Mining Recorder
Toronto, Ontario

cc: Questor Ltd
6380 Viscount Road
Mississauga, Ontario
L4V 1H3

Encl.

July 16, 1984

Our File: 2.6744

Abitibi Price Inc
P.O. Box 21
Toronto Dominion Centre
Toronto, Ontario
M5K 1B3

Dear Sir:

RE: Airborne Geophysical (Electromagnetic) Survey submitted
on Mining Claims P 595011 et al in Lucas Township

Returned herein is the last page of the report and map (in duplicate) for the above-mentioned survey. Please have the author of the report sign each copy. Also, please provide a resume of the qualifications of the author of the report (Stewart Fumerton), as outlined on the attached.

When return this material, please quote file 2.6744.

For further information, please contact Mr. Ray Pichette at (416)965-4888.

Yours sincerely,

S.E. Yundt
Director
Land Management Branch

Whitney Block, Room 6643
Queen's Park
Toronto, Ontario
M7A 1W3
Phone: (416)965-4888

S. Hurst:mc

cc: Mining Recorder
Timmins, Ontario

Attach:

1984 05 23

Your File: 161
Our File: 2.6744

Mr. Bruce W. Hanley
Mining Recorder
Ministry of Natural Resources
60 Wilson Avenue
Timmins, Ontario
P4N 2S7

Dear Sir:

We have received reports and maps for an Airborne Geophysical (Electromagnetic) Survey submitted on Mining Claims P 595011 et al in the Township of Lucas.

This material will be examined and assessed and a statement of assessment work credits will be issued.

Yours sincerely,

S.E. Yundt
Director
Land Management Branch

Whitney Block, Room 6643
Queen's Park
Toronto, Ontario
M7A 1W3
Phone: (416) 965-6918

A. Barr:mc

cc: Abitibi-Price Inc
Toronto Dominion Centre
P.O. Box 21
Toronto, Ontario
M5K 1B3

File
2-6744

1985 05 07

Mr. John P. Steele
Mineral Resources Development Project
Department of Mineral Resources
Bangkok 10400, Thailand

Dear Sir:

Your letter of April 5, 1985 has been received. The work submitted in support of Report of Work #161/84, was in fact signed by Stewart Fumerton. Since Mr. Fumerton has exceeded the minimum qualification necessary to submit geotechnical work to this Ministry, the credibility and accuracy of the work performed lies with Mr. Fumerton, and not yourself.

Regarding the certification on the report of work #161/84, the matter is being brought to the attention of the Mining Recorder in Timmins by the receipt of this letter.

Yours sincerely,

S.E. Yundt
Director
Land Management Branch

Whitney Block, Room 6643
Queen's Park
Toronto, Ontario
M7A 1W3
Phone:(416)965-4888

R. Pichette:mc

cc: Mining Recorder
Timmins, Ontario (Please respond accordingly to
the attached copy of letter
from Mr. J.P. Steele).

Encl.

Mineral Resources Development Project
Department of Mineral Resources,
Bangkok 10400, Thailand

April 5, 1985

Land Management Branch
Ministry of Natural Resources
Whitney Block
Room 6643
99 Wellesley Street West,
Toronto, Ontario
M7A 1W3 Canada

Dear Sirs,

It has come to my attention that a Report of Work (#161/84 of April 13, 1984) has been certified in my name and signed for me by L.A. Tihor without my permission. In fact, I do not certify this work as I have no knowledge of the content of the report prepared apparently by Stewart Fumerton submitted by with this Report of Work. The claims in question are in Lucas Township, Ontario and are 595011 to 595020 inclusive, 597025 to 597033 inclusive and 597064 to 597071 inclusive.

This is the only incidence of its kind that I presently know of but as I have worked on many claims in the Timmins area there may be other such instances. Could I request, please, that you examine all Reports of Work in your files which have been submitted by Chevron Canada Resources of 167B Wilson Avenue, Timmins, Ontario to see if any others have been similarly falsely certified.

Yours sincerely,

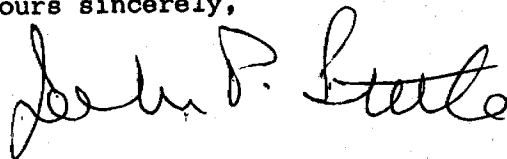

John P. Steele

RECEIVED
APR 23 1985
MINING LANDS SECTION

RECEIVED	
Land Management Branch	
CIRCULATE	
APR 23 1985	
S. E. YUNDT	
J. H. JACKSON	
J. E. PLY	
W. L. GOOD	
W. L. HAN	
W. L. BROOK	
<i>Lucy</i>	
R. 6643	



ABITIBI-PRICE MINERAL RESOURCES, Toronto-Dominion Centre, Toronto, Canada M5K 1B3 (416) 369-6700

August 22, 1984

Mr. L. Tihor
Chevron Canada Resources Limited
167B Wilson Street
Toronto, Ontario P4N 2T2

Dear Mr. Tihor:

I believe the enclosed should have been forwarded to your office.

Yours sincerely,

ABITIBI-PRICE MINERAL RESOURCES

Carolyn - Hamilton

Carolyn Hamilton
Executive Secretary

Enclosure
/cah

RECEIVED	
Land Management Branch	
CHIEF CLERK	<input type="checkbox"/>
GENERAL CLERK	<input type="checkbox"/>
SEP 10 1984	
W. L. COON	<input checked="" type="checkbox"/>
MISS [unclear]	<input type="checkbox"/>
MR. [unclear]	<input type="checkbox"/>
RECEIVED BY: [unclear]	

RECEIVED
SEP 10 1984
MINING LANDS SECTION

Date
Material Rec'd: *Aug 27/84*
Date Sent To:
Charge:
Approved:



Chevron Canada Resources Limited

Minerals Staff

167B Wilson Ave., Timmins, Ontario P4N 2T2 Phone (705) 264-2291

1st August 1984

Land Management Branch,
Ministry of Natural Resources,
Room 6643
Whitney Block,
Queen's Park,
Toronto, M7A 1W3.

Attention Ray Pichette.

File # 2.6744

Dear Ray,

Enclosed are the final pages of the report in question,
and brief copies of my resume duly signed. Hopefully all is now
in order.

Yours truly,

A handwritten signature in cursive script that reads "Stewart Fumerton".

Stewart Fumerton.
Geologist.

RECEIVED
AUG 07 1984
MINING LANDS SECTION

P.595011

✓

597024

✓

597064

✓

12

✓

25

✓

65

✓

13

✓

26

✓

66

✓

14

✓

27

✓

67

✓

15

✓

28

✓

68

✓

16

✓

29

✓

69

✓

17

✓

30

✓

70

✓

18

✓

31

✓

71

✓

19

✓

32

✓

20

✓

33

✓

Arthur

Beck Twp.

THE TOWNSHIP OF
OF

LUCAS

DISTRICT OF
COCHRANE

PORCUPINE
MINING DIVISION

SCALE: 1-INCH=40 CHAINS

W231

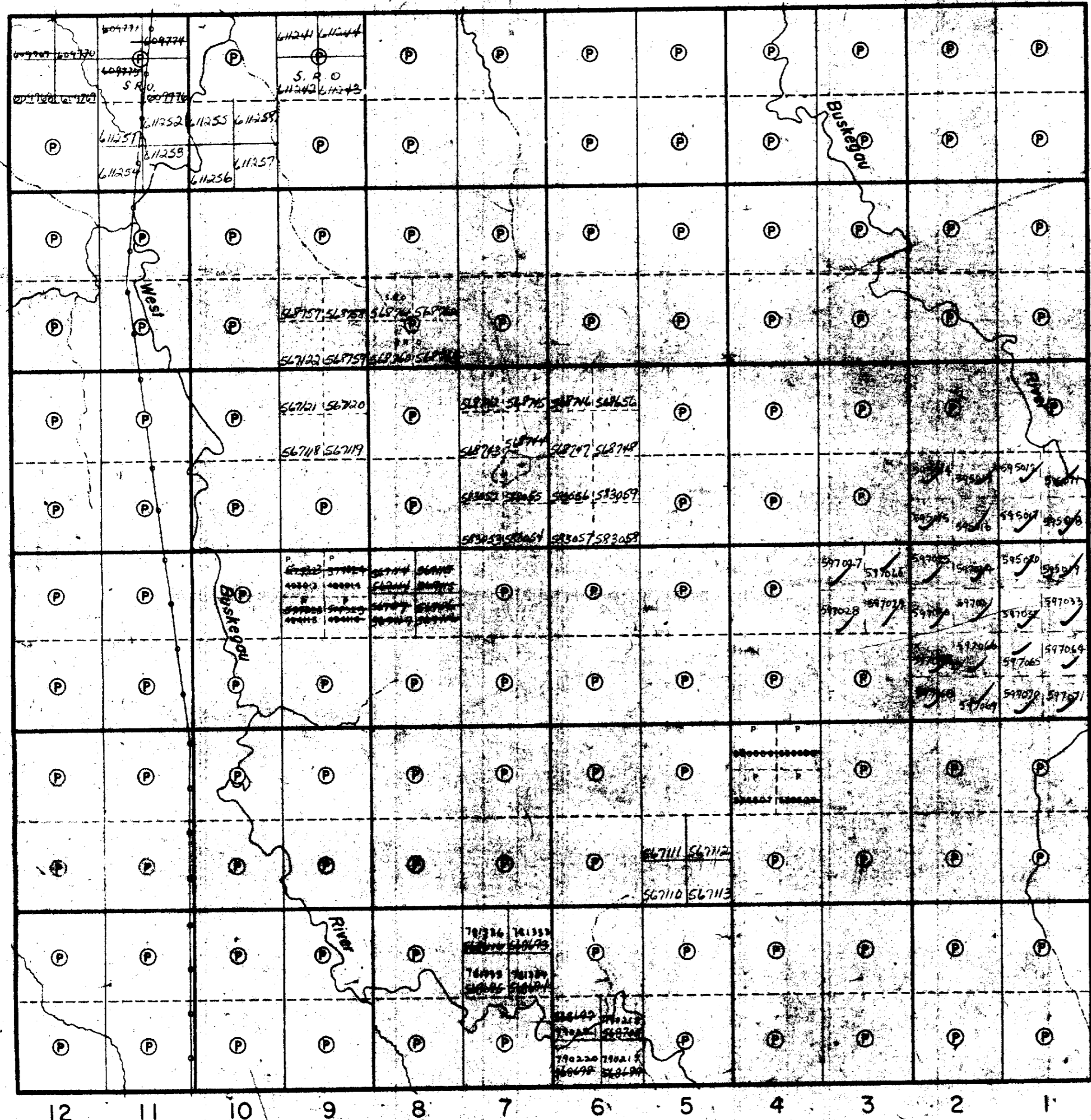

VI

V

IV

III

II

I

Duff Twp.

Crawford Twp.

Prosser Twp.

LEGEND

- PATENTED LAND
- CROWN LAND SALE
- LEASES
- LOCATED LAND
- LICENSE OF OCCUPATION
- ROADS
- IMPROVED ROADS
- RAILWAYS
- POWER LINES
- MARSH OR MUSKEG

NOTES

400' Surface Rights Reservation around all Lakes and Rivers.

Areas withdrawn from staking under Section 13 of the Mining Act

File	Date	Disposition

DATE OF ISSUE
AUG 3 1984
Ministry of Natural Resources
TORONTO

RECEIVED
APR 25 1984
A.M.
10:11:12:1:3:4:5:6

PLAN NO. - M-537

ONTARIO
MINISTRY OF NATURAL RESOURCES
SURVEYS AND MAPPING BRANCH

W231

