



42A14SE0189 20 DUFF

010

Diamond Drilling

Township of DUFF

Report NO: 20

Work performed by: Cromarty Exploration Co. Ltd.
(Wallingford Option)

Claim NO	Hole NO	Footage	Date	Note
P ⁵⁹⁸⁵⁴ 58718	C7-2	528.0'	Mar/65	
P 59854	C7-2A	165.0'	Feb/65	
		<u>693</u>		

Notes:

EXPLORATION DEPARTMENT

Property Wallingford Option
 Location Duff Township, Ontario
 Claim No. P-58718
 Location of Core Campsite, N end Crawfish Lake

MCINTYRE
 PORCUPINE MINES LIMITED

DIAMOND DRILL LOG

Hole No. C7-2 Sheet No. 1
 Length of Hole 528'
 Date Started March 7, 1965 Completed March 27, 1965
 Core Logged by W. H. Thorpe
 Date March 27, 1965
 Elevation Surface Datum _____
 Co-ordinates of Collar
 North L 20 N
 East 150 E

At	Surveys	
	Dip	Bearing
0'	-55°	S 65° W
400'	-52°	

From	To	Description of Core	Sample No.	FOOTAGE		Width	CORE ASSAYS		
				From	To		Au	Ag	Cu%
0	230.0	Casing:							
		0 - 157 BXT Gravel sand.							
		157 - 180 AXT Mud, sand gravel boulders.							
		180 - 230 EXT Sand gravel boulders.							
230	254	Andesite: Highly carbonatized with numerous elongated chloritic inclusions.							
		Hardness of 4 overall.							
		231 - 235 60% milky qtz. 80° to core axis. 2% pyrite. 20% lost core.	3304	231.0	235.0	4'	Nil	Tr.	0.02
		235 - 237 40% milky qtz. Severely broken. 5% pyrite in rounded blebs.							
		30% lost core.	3305	235.0	237.0	2'	Nil	Nil	0.06
		237 - 239 Graphitic banding with 3 to 5% pyrite.	3306	237.0	239.0	2'	Nil	Tr.	0.16
		239 - 254 Moderate carbonatization. Minor graphite.							
254	336	Argillite: Graphitic bands at 80° to 50° to core axis. Moderate to highly carbonatized.							
		254 - 256 Mainly graphitic. Barren.							

EXPLORATION DEPARTMENT

Property.....

Location.....

Claim No.....

Location of Core.....

	Surveys	
At	Dip	Bearing
_____	_____	_____
_____	_____	_____
_____	_____	_____

MCINTYRE
PORCUPINE MINES LIMITED

DIAMOND DRILL LOG

Hole No. Sheet No. **2**

Length of Hole.....

Date Started..... Completed.....

Core Logged by.....

Date.....

Elevation..... Datum.....

Co-ordinates of Collar

North.....

East.....

From	To	Description of Core	Sample No.	FOOTAGE		Width	CORE ASSAYS		
				From	To		Au	Ag	Cu%
		256 - 270 Mainly graphitic with schistosity at 45° to 65° to core axis, 3% pyrite. No dimethyl reaction. Nine ft. lost core.	3307	256.0	270.0	4'	Tr.	Tr.	0.25
		270 - 275 Mainly graphitic and barren.							
		275 - 278 Graphite with 3% pyrite. No dimethyl reaction. 2' lost core.	3308	275.0	278.0	3'	0.005	Tr.	0.02
		278 - 334 Argillite with numerous graphitic bands or partings at 75° to 90° to core axis. Occasional cube of pyrite.							
336	528	Dacite: Light grey massive. Soft due to carbonatization.							
		336 - 360 Moderate to highly carbonatization. Flowage or banding at 80° to core axis. Occasional fine graphitic parting. Core recovery 90%. Brecciated in places.							
		360 - 380 Dacite flow bx. Minor pyrite throughout. Occasional graphitic inclusion. Well formed plagioclase phenos. in places. Flow lines 75° to core axis.							
		380 - 528 Massive lava. Moderate carbonate throughout. Occasional well formed plagioclase phenocrysts.							
END OF HOLE									

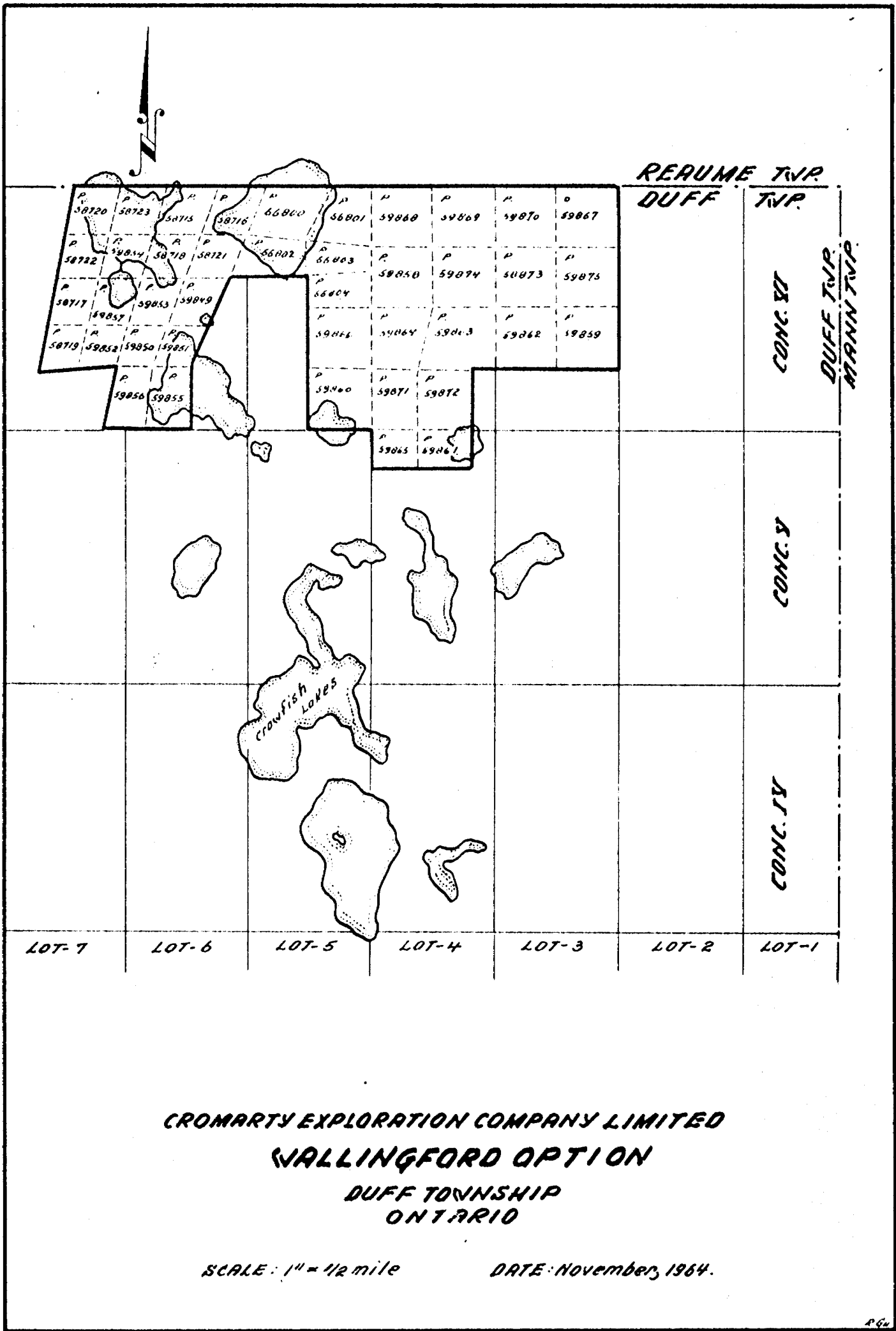

REARME TWP.
DUFF TWP.

CONC. VI
DUFF TWP.
MANN TWP.

CONC. V

CONC. IV

LOT-7 LOT-6 LOT-5 LOT-4 LOT-3 LOT-2 LOT-1

Crawfish Loves

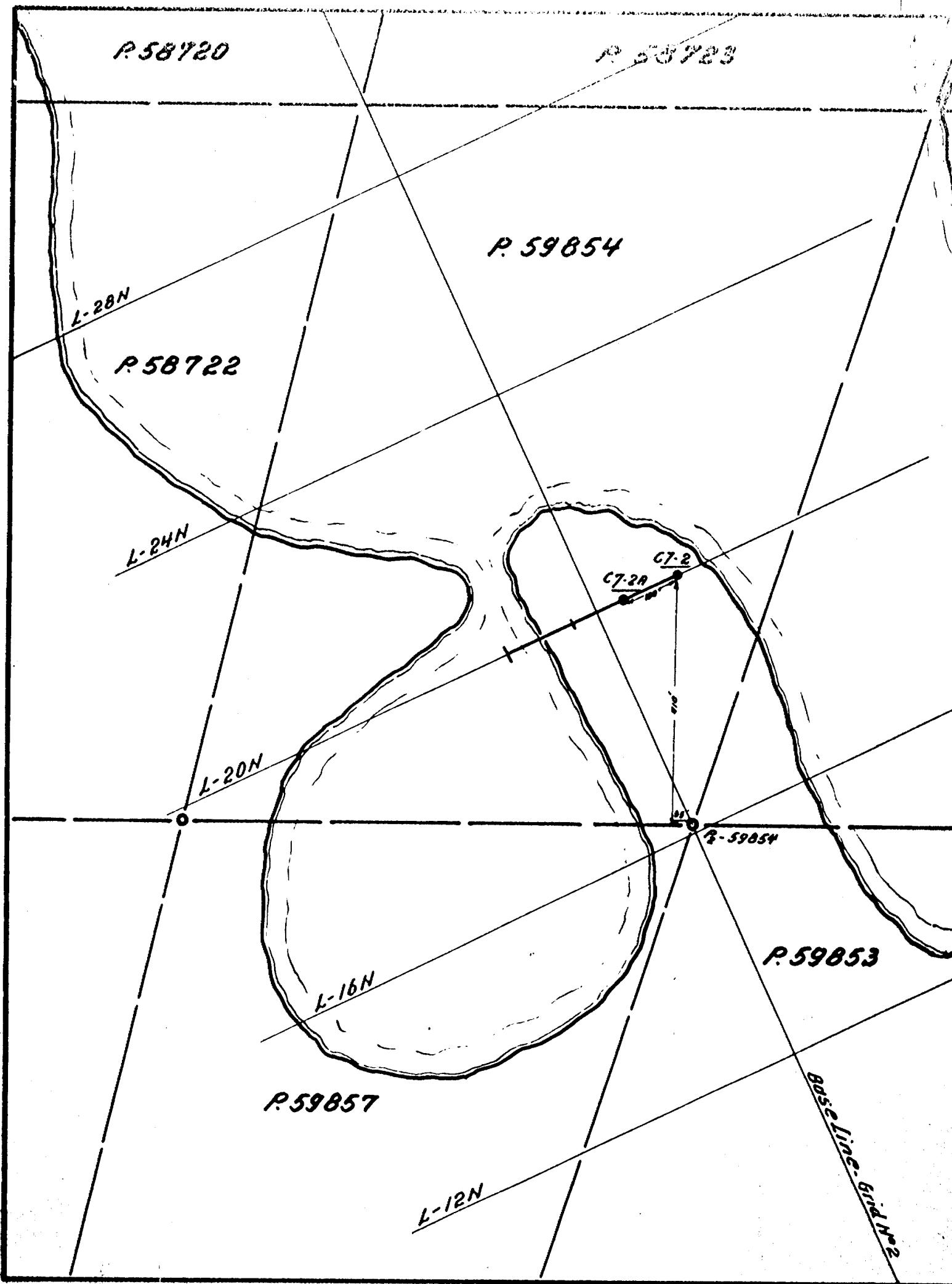

N-30°W

C7-1 C7-1A

Surface

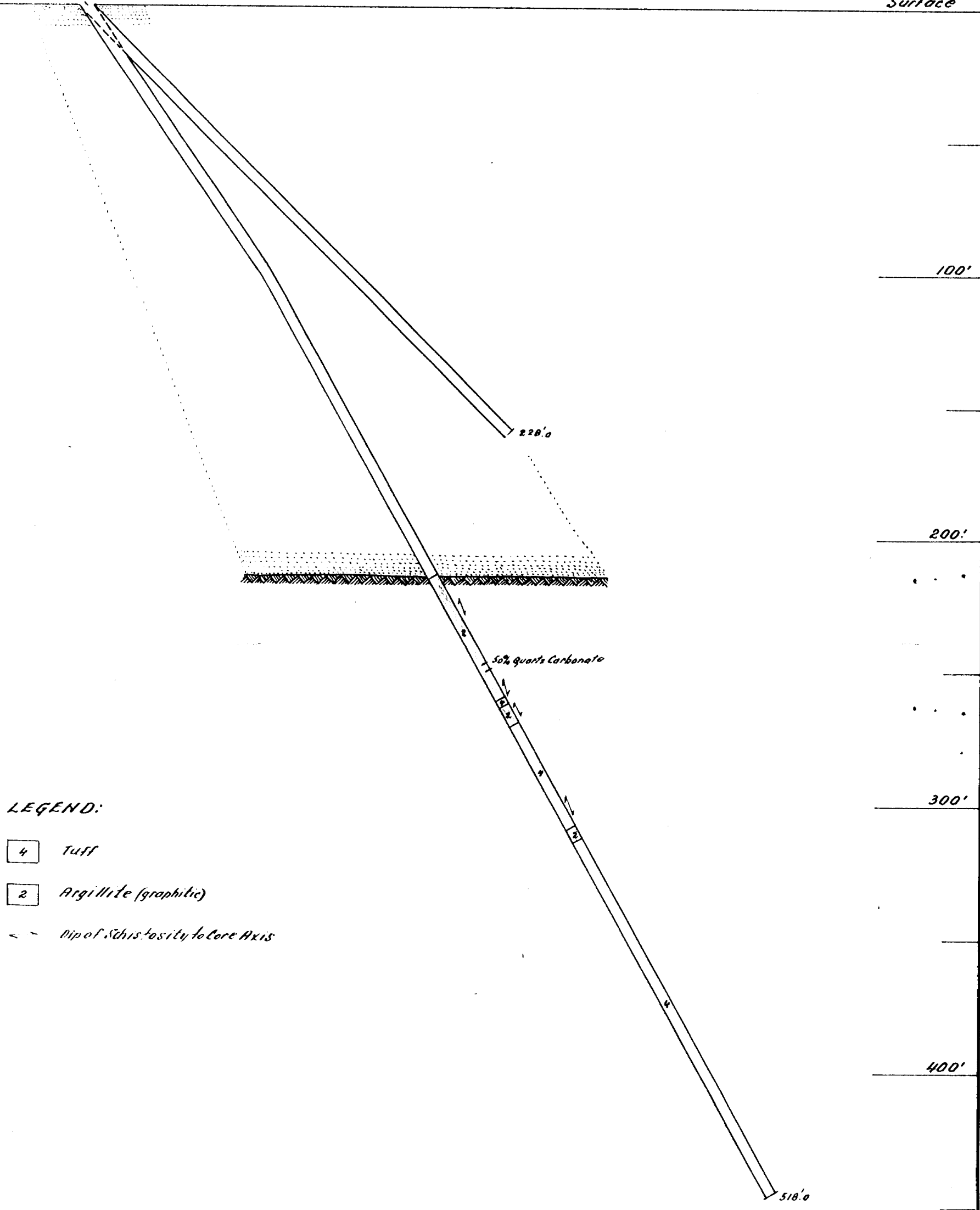

LEGEND:

- 4 Tuff
- 2 Argillite (graphitic)
- - Dip of Schistosity to Core Axis

CROMARTY EXPLORATION COMPANY LIMITED
WALLINGFORD OPTION

DUFF TOWNSHIP
PORCUPINE MINING DIVISION
ONTARIO

SECTION DRILL HOLES C7-1 & C7-1A

SCALE: 1"=40'

DATE: Apr, 1965.

S-65°-W

C7-2

C7-2A

Surface

100'

200'

300'

400'

500'

LEGEND:

- 3 dacite
- 2 Argillite (graphitic)
- 1 Andesite

50%
milky
qtz.

schistosity

dip of flow

165.0

528.0

CROMARTY EXPLORATION COMPANY LIMITED
WALLINGFORD OPTION

DUFF TOWNSHIP
PORCUPINE MINING DIVISION
ONTARIO

SECTION DRILL HOLES C7-2 & C7-2A

SCALE: 1"=40'

DATE: Apr., 1965.

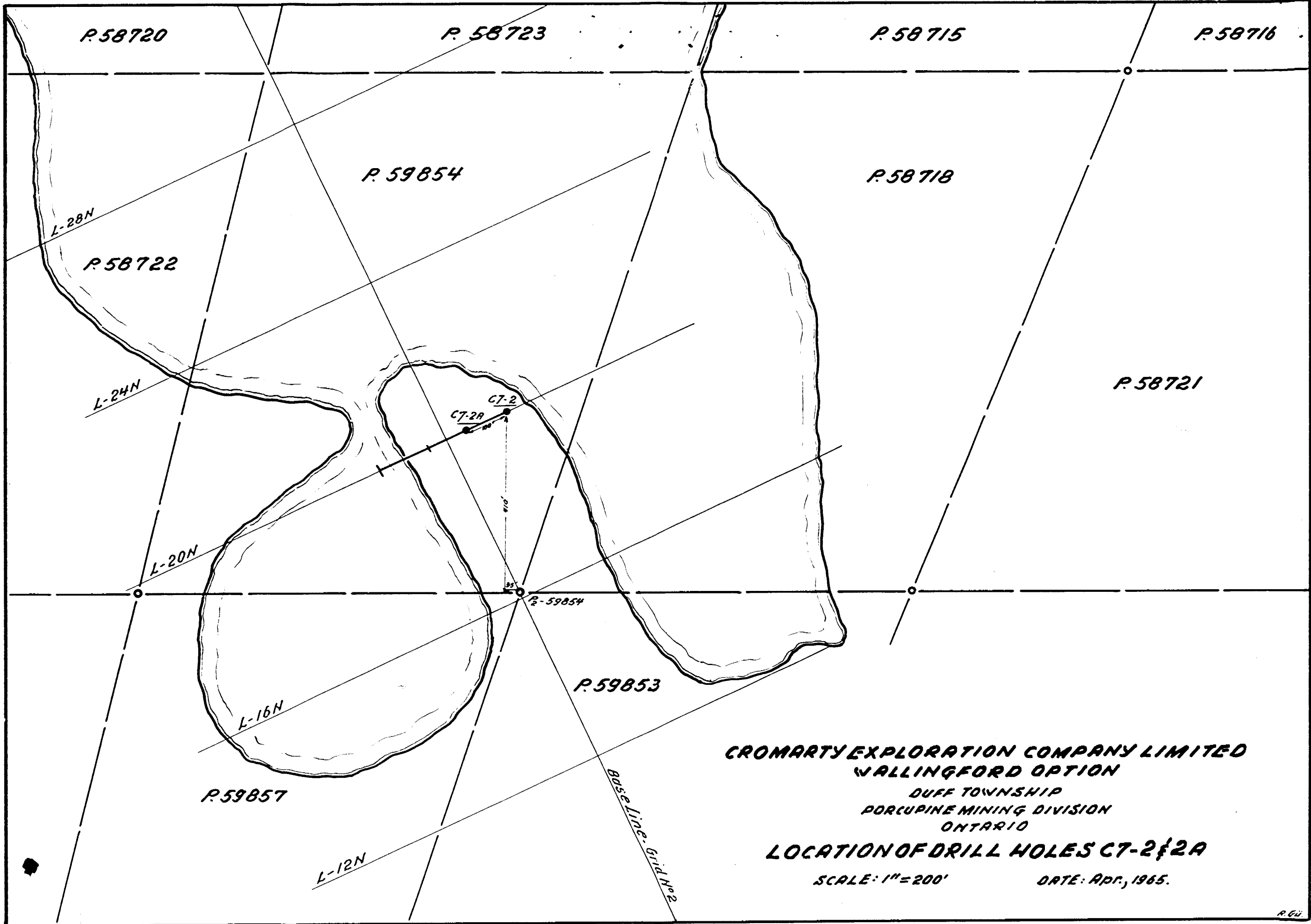

CROMARTY EXPLORATION COMPANY LIMITED
WALLINGFORD OPTION
 DUFF TOWNSHIP
 PORCUPINE MINING DIVISION
 ONTARIO

LOCATION OF DRILL HOLES CT-2 & 2A

SCALE: 1" = 200'

DATE: Apr., 1965.