



42A14SE0301 63.5790 MANN

010

Len E. Hill
122 Helen Ave.,
P.O. Box 1022
S. Porcupine, Ont.
P0N 1H0
Feb.5/91

O.P.A.P. Office
Sudbury, Ont.

Dear Mr. McCauly:

Enclosed find township maps for Mann, Duff, Reaume and Hanna Twps.

1) Mann Twp and Duff Twp:

Access to Mann and Duff townships is two miles past the post office at Tunis, Ont., on Hwy 11, to Newmarket Twp. Concession 5 & 6. Turn left here and you go three miles due west on the old trans-Canada Hwy 11, then you keep on going west for seven miles to the steel bridge over Frederick House River. It is a new timber access road. Where the bridge is the river is called the three rapids area.

I had to restake my original nine claims in Mann Twp and four more in Duff Twp plus six more new ones in Mann Twp.

There are no outcrops in the four Duff claims.

In Mann Twp the rocks are pretty well all coarse peridotites, with pyroxenite and werlite sills, with gabbro outcropping on the east side of the river north and south of the bridge, and south of the bridge roughly 300 ft. on the west side of the river on up to the middle rapids.

I had to rearrange my summer work programme, as the companies I had contacted seemed very interested in the showings, FALCONBRIDGE - T.E.G.- PLACER DOME. This went on all summer till late fall, then they dropped their interest. In the mean time I kept prospecting all summer.

I could not do the work I had planned for Mann Twp, so I did panning and traverses north and south of the bridge.

The PGE showing is about 30 ft. north of the bridge on the west side of the river.

I have come to the conclusion that there is a kimberlite dyke or a part of a diatreme running from the Falls Wanatango down to 200 ft. north of the bridge running under the river, which gives it a length of at least 3/4 of a mile. Where else would the indicator minerals found come from?

If I cannot promote these claims I am going to drill these showings if I can afford it.

It must be the recession on now and the mining companies are tightening up on funds for exploration.

Access to Reaume Twp is, you go west two miles into Duff Twp then north 1/2 mile and west again about three miles then north about 1 1/2 miles to Reaume Twp and north to the bridge over Reaume Creek. This is a new timer access road into Reaume Twp.

OP90-164

Last summer if I made a deal I was interested in going up to the Reaume Creek bridge and set up a camp there, and take a good look into that area. When I traversed there last summer, the rocks were interesting, pretty well all peridotites, there is a documented chromite and a micro-diamond find in the early days. Access on the old road was bad, lots of water.

Access to Hanna Twp, the same road that leaves Hwy 11 to go to Mann Twp also connects to a side road 8 miles, and then you go north for about 1 mile, then you drive into Hanna Twp due north for about 3 miles only in the dry summer time. It is a new timber access road, this is how I got to traverse in that part of Hanna Twp.

Then you can get into Hanna Twp from the steel bridge in Mann Twp by boat where I did traverses, soil testing and panning. Panning revealed negative results, and the soil samples proved not to be interesting. No new outcrops were found in my traverses.

My recommendation for this year is to do more work in Mann Twp, diamond drill and core sampling, at the same time trying to make a deal.

Sincerely Yours,

Len Hill

L. G. Hill

Timmins
29 January, 1991

Dear Sir/Madam:

Enclosed find the results of my summer's prospecting.

First in Mann Township I got three major mining companies interested:

1) Total Energold were interested, they reviewed my results, but said they were looking for properties in a more advanced stage!

2) Falconbridge was interested and did fifteen channel samples of their own, and told me it definitely was anomalous, as time was going by they finally said they refused the ground - it took them about ten months to say no, maybe next year they said.

3) So I got Placer Dome interested, and they reviewed my results, and showed great interest. But after many more visits by me to see them and phone calls, they finally said they were not interested at the time. They took some samples, sent me two results, and have some more results to send. I have included these along with the Falconbridge results in this submission.

But to me this reflects to a downturn in exploration, of tough economic times.

So the reason I did not drill on the property at the time was because of the pending interest by the two majors and the work they were doing. If I cannot get no company interested, I am going to drill it myself.

So I went into Reaume Township as planned, the place of interest, and found many outcrops. But the roads are bad - flooded in many places which made the south side of the roads and bush part flooded by beavers.

Then I decided I would check out Hanna Township also. Did panning and soil tests there, these tests were on open ground.

Well that about winds it up.

Sincerely Yours,

Len Hill

L. E. Hill

OLD
TIMBER
HAY
ROAD

BECK TWP.

FOURNIER TP. M.477
CONCESSION

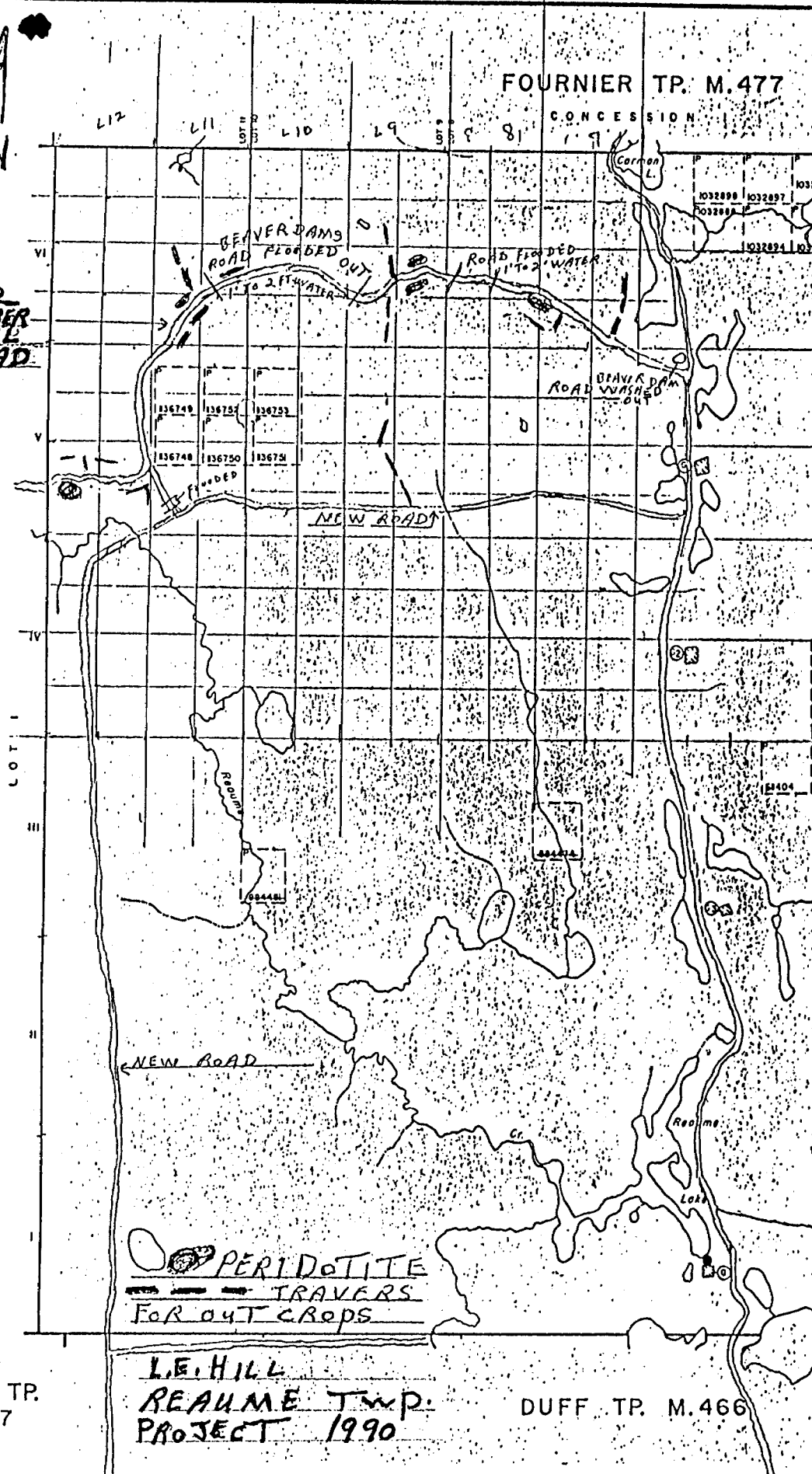

PERIDOTITE
TRAVERS
FOR OYSTER CROPS

L.E. HILL
REAUME TWP.
PROJECT 1990

DUFF TP. M.466

LEGEND

- HIGHWAY AND ROUTE No.
- OTHER ROADS
- TRAILS
- SURVEYED LINES:
 - TOWNSHIPS, BASE LINES, ETC.
 - LOTS, MINING CLAIMS, PARCELS, ETC.
- UNSURVEYED LINES:
 - LOT LINES
 - PARCEL BOUNDARY
 - MINING CLAIMS ETC.
- RAILWAY AND RIGHT OF WAY
- UTILITY LINES
- NON-PERENNIAL STREAM
- FLOODING OR FLOODING RIGHTS
- SUBDIVISION
- ORIGINAL SHORELINE
- MARSH OR MUSKOG
- MINES

DISPOSITION OF CROWN LANDS

- TYPE OF DOCUMENT
- PATENT, SURFACE & MINING RIGHTS
- " SURFACE RIGHTS ONLY
- " MINING RIGHTS ONLY
- LEASE, SURFACE & MINING RIGHTS
- " SURFACE RIGHTS ONLY
- " MINING RIGHTS ONLY
- LICENCE OF OCCUPATION
- CROWN LAND SALE
- ORDER-IN-COUNCIL
- RESERVATION
- CANCELLED
- SAND & GRAVEL

PLACED ON ACTIVE F.I.E. CHECKED 20/03/90

SCALE: 1:12800

ACRES	HECTARES
40	16

TOWNSHIP

REAUME

DISTRICT



MINING DIVISION

PORCUPINE



Ministry of Na
Resources

Ontario Surveys and Mapping Branch

Date OCT. 1975
Whitney Block
Ouse's Park, Toronto

Plan No.
M.576

TP.
7

MANN TWP.

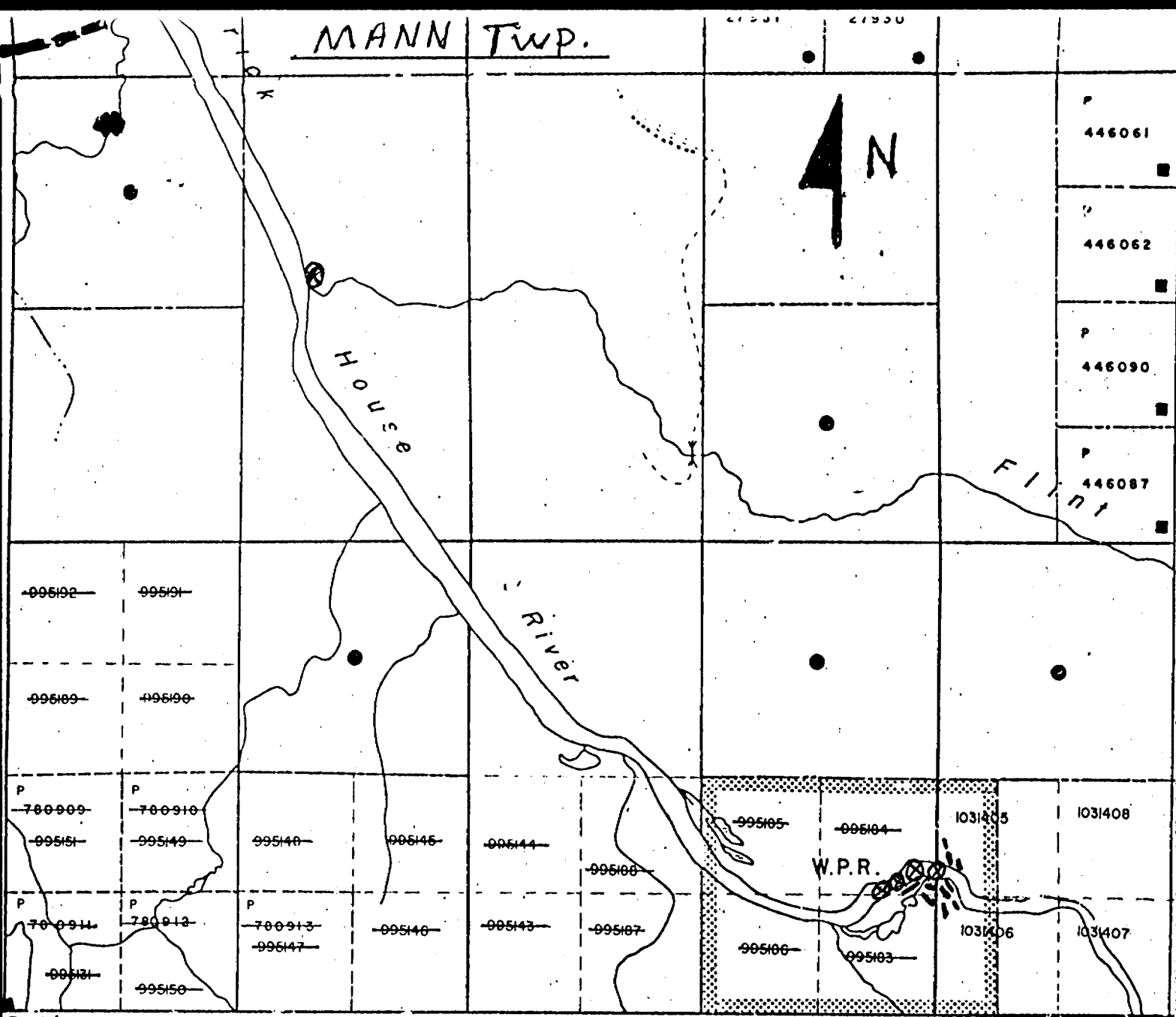

S.W. CORNER 12 11 10 9 8

5 PANNING SPOTS ON GRAVEL BARS - LOW WATER L.E. HILL - PROJECT

NEGATIVE RESULTS - ALL SAMPLES SHOWED - MANN TWP

FINE MAGNETITE - FINE ROSE COLOURED GARNETS - JAN. 1990

QUARTZ - ALL HIGHLY ABRASSED & SMALL - 1 TO 1 1/2 -

MM. SIZE - AND NOT MANY GARNETS

--- TRAVERS FOR OUTCROPS

SCALE - 1:20,000

RE
N

HANNA TWP

REARME
TWP

THAT
MAP
PILED
RCES,
S NOT
HOSE
= MIN.
D CON-
MINING
RY OF
ELOP-
OR AD-
ATION
IF THE
EON.
C1

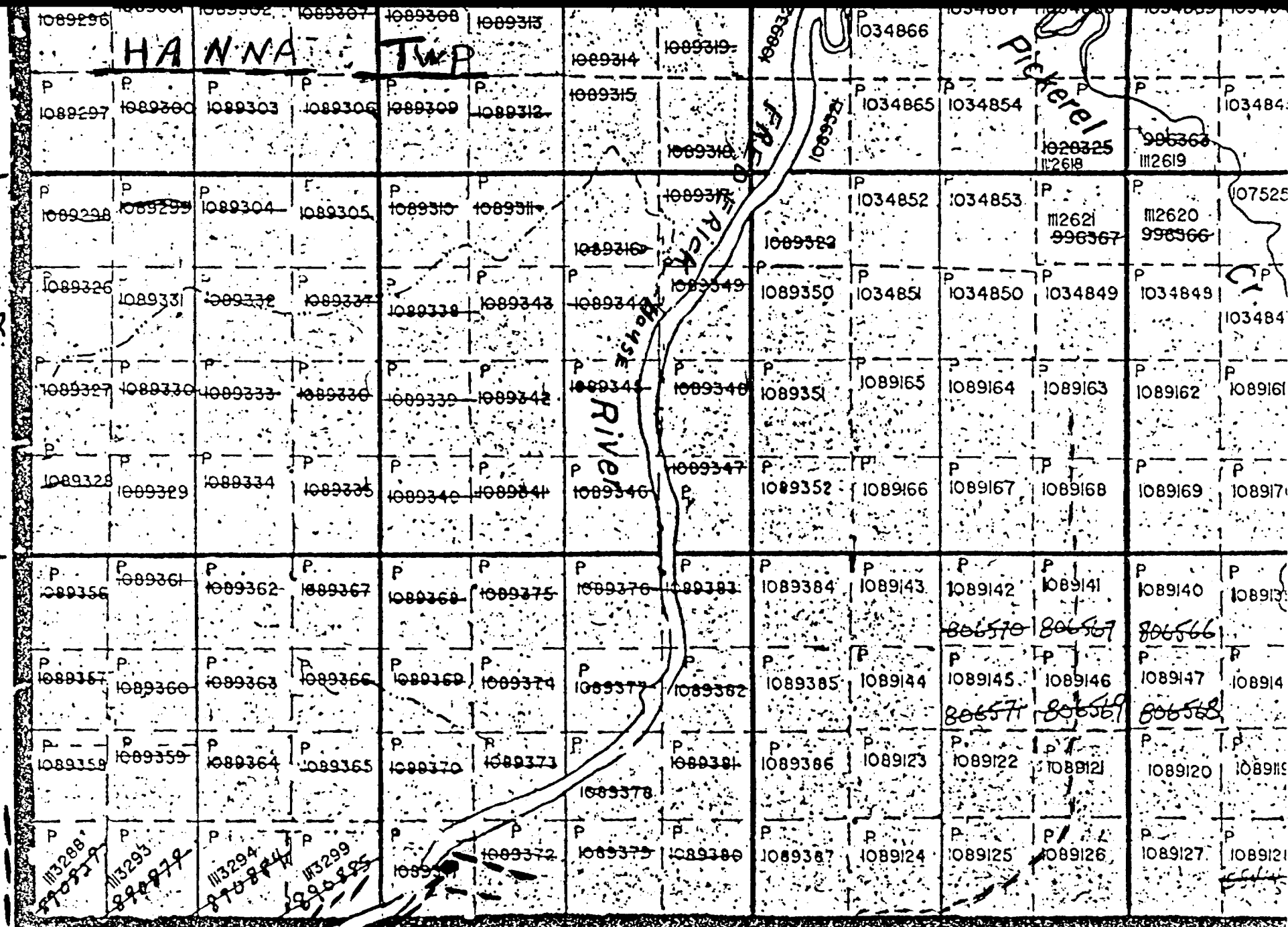

DUFF TWP | 12 | 11 | 10 | 9 | 8 | 7 | 6

SCALE - 1" = 20,000'

TRAVERS LINES - FOR OUTER OPS ALONG LOTS 6-7-8-9-10-11-12

E & W $\frac{1}{4}$ MI. FROM SW CORNER OF HANNA TWP - ALSO IN -

SE $\frac{1}{4}$ & SW $\frac{1}{4}$ OF S $\frac{1}{2}$ L 10 C-1 HANNA TWP - ALSO SE $\frac{1}{4}$ OF S $\frac{1}{2}$ L 11 C-1

HANNA TWP PROJECT 1990

Mann Twp
PORCUPINE MINE DIV.

RE
↑

RESUME TWP
C2

THAT
MAP
FILED
RCES,
NOT
HOSE
MIN.

CONTAINING
RY OF
ELOP-
OR AD-
ATION
= THE
EON.

C1

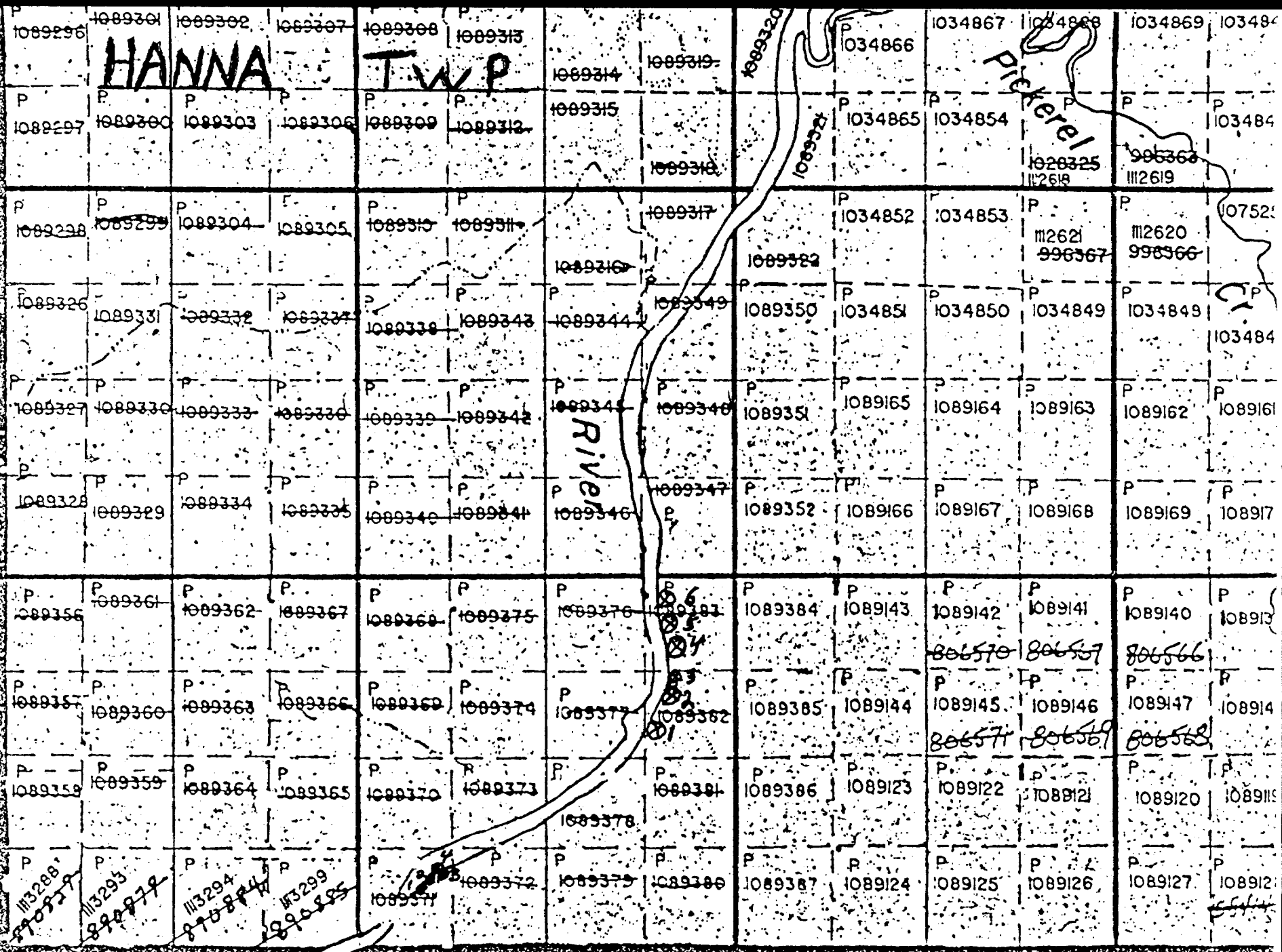

DUFF

SCALE - 1:20,000

12 11 10 9 8 7 L.E. HILL 6

4 SOIL SAMPLES - ● - S.W. 1/4 of S. 1/2 Lot 10 C1 - HANNA TWP. E. SIDE OF RIVER HANNA TWP. PROTECT 1990

6 - PANNING SPOTS - NE 1/4 & SE 1/4 of N. 1/2 L9 - C1 - E. SIDE OF RIVER

TWP. 1, 2, 3, 4, 5, 6 - N-R SOIL SAMPLES - 1, 2, 3, 4.

Mann Twp
PARQUINE ALIVE DIV.



Established 1928

Swastika Laboratories

A Division of Assayers Corporation Ltd.

Assaying - Consulting - Representation

Geochemical Analysis Certificate

1W-2036-SG1

Company: L.E. HILL

Date: JAN-10-91

Project:

Copy 1. P.O.BOX 1022,SOUTH PORCUPINE,ONT.P0N1H0

Attn:

We hereby certify the following Geochemical Analysis of 4 CLAY SOIL samples submitted JAN-09-91 by L.E. HILL.

Sample Number	Au ppb	Geo Scan
4601	Nil	
4602	Nil	
4603	Nil/Nil	
4604	Nil	

* Note: Samples shown on map are numbered 1,2,3,4.

GEO SCAN RESULTS TO FOLLOW

Certified by Donna Gardner

SWASTIKA LABORATORIES

P.O. BOX 10, SWASTIKA, ONTARIO

TELEPHONE #: (705) - 642 - 3244

FAX #: (705) - 642 - 3300

I.C.A.P. PLASMA SCAN

Aqua-Regia Digestion

SWASTIKA LABS L.E. Hill

T.S.L. REPORT No. : M - 8677 - 1

T.S.L. File No. : JA16MD

T.S.L. Invoice No. :

YOUR REFERENCE - 1W-2036-SG1

ALL RESULTS PPM

ELEMENT	4601	4602	4603	4604
Aluminum [Al]	12000	13000	10000	18000
Iron [Fe]	16000	17000	14000	22000
Calcium [Ca]	64000	66000	42000	26000
Magnesium [Mg]	7300	7000	6800	6300
Sodium [Na]	220	280	190	270
Potassium [K]	2300	2700	1800	2900
Titanium [Ti]	650	690	580	910
Manganese [Mn]	330	310	350	490
Phosphorus [P]	270	250	310	340
Barium [Ba]	68	74	58	86
Chromium [Cr]	36	130	33	81
Zirconium [Zr]	17	20	10	13
Copper [Cu]	20	21	19	21
Nickel [Ni]	20	26	18	29
Lead [Pb]	41	30	15	28
Zinc [Zn]	35	15	27	42
Vanadium [V]	27	31	24	40
Strontium [Sr]	53	56	37	34
Cobalt [Co]	7	10	6	11
Molybdenum [Mo]	< 2	< 2	< 2	< 2
Silver [Ag]	< 1	< 1	< 1	< 1
Cadmium [Cd]	< 1	< 1	< 1	< 1
Beryllium [Be]	< 1	< 1	< 1	< 1
Boron [B]	< 10	< 10	< 10	< 10
Antimony [Sb]	10	10	10	15
Yttrium [Y]	8	8	7	9
Scandium [Sc]	3	4	3	5
Tungsten [W]	< 10	< 10	< 10	< 10
Niobium [Nb]	< 10	< 10	< 10	< 10
Thorium [Th]	40	10	40	20
Arsenic [As]	10	10	10	< 5
Bismuth [Bi]	5	< 5	< 5	< 5
Tin [Sn]	< 10	< 10	< 10	< 10
Lithium [Li]	35	40	35	45

DATE : JAN-17-1991

SIGNED : _____

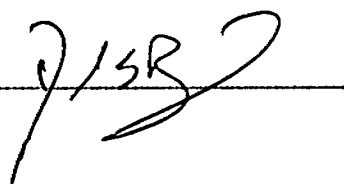

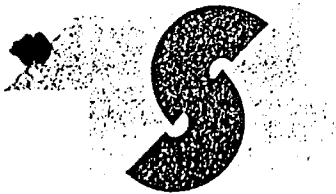

T S L LABORATORIES

DIVISION OF BURGENER TECHNICAL ENTERPRISES LIMITED

2031 RIVERSIDE DRIVE, UNIT #2

TIMMINS, ONTARIO

P4N 7C3

☎ (705) 268-4441 FAX: (705) 268-4420

CERTIFICATE OF ANALYSIS

SAMPLE(S) FROM Falconbridge Exploration Ltd.
571 Moneta Ave.
P.O.Box 1140
Timmins, Ontario
P4N 7H9

REPORT No.
W3972

INVOICE #: 3921
P.O.:

SAMPLE(S) OF CORE

Ian Liu
project 8002

	Au ppb	Pt ppb	Pd ppb
AJ08306	89	100 200	150 300
AJ08307	9	50	92
AJ08308	2	40	54
AJ08309	4	60	82
AJ08310	5	210	210
AJ08311	58	250	120
AJ08312	150	150	42
AJ08313	22	40 80	42 84
AJ08314	10	240 480	300 600
AJ08315	5	210 420	260 520
AJ08316	1	170 340	210 420
AJ08317	<1	40 80	64 128
AJ08318	7	60 120	100 200
AJ08319	30	50 100	78 156
AJ08320	320	<10	6 ← standard
		2550	3008
		83	97

COPIES TO: Stan Clemmer
INVOICE TO: Stan Clemmer

May 31/90

SIGNED _____

Page 1 of 1



For enquiries on this report, please contact Customer Service Department.
Samples, Pulps and Rejects discarded two months from the date of this report.

Len Hill Samples
Mann Twp.

10/12/1990

SAMPLE #

DESCRIPTION

Am. E2218

Apple green ultramafic "dyke".
Traces of chlorite and calcite

Si, Cu. E2219

Serpentinized ultramafic with 15%
crystalline magnetite. chloritized,
heavily sheared

Len
Here are some preliminary
results only for Mann
Twp.
JOHN

03/01/91



PLACER DOME INC.
DOME MINE

BOX 70
SOUTH PORCUPINE, ONTARIO
PON 1H0

(705) 235-3221
TELEX 067-81811
TELECOPIER (705) 235-2343

ANALYTICAL SERVICES

PLACER DOME INC.

DOME MINES ANALYTICAL SERVICE

ASSAY REPORT

Customer: Placer Dome Inc.Expl.Dept.
PO Box 650,S.Porcupine Ont.
PON 1H0

DATE: December 28, 1990

Date sample Received: 12/11/90

Proj.205

Assay for..Ni

Sample No.	Value in Percentage	PPM	Rerun	Reject
E2219	.035			

NOTE: N/D = NONE DETECTED

Assayed by: *[Signature]*



PLACER DOME INC.
DOME MINE

BOX 70
SOUTH PORCUPINE, ONTARIO
PON 1H0

(705) 235-3221
TELEX 067-81611
TELECOPIER (705) 235-2343

ANALYTICAL SERVICES

PLACER DOME INC.
DOME MINES ANALYTICAL SERVICE
ASSAY REPORT

Customer: Placer Dome Inc.Expl.Dept.
PO Box 650,S.Porcupine Ont.
PON 1H0

DATE: December 28, 1990

Date sample Received: 12/11/90

Proj.205

Assay for..Cu

Sample No.	Value in Percentage	PPM	Rerun	Reject
E2219	.003			

NOTE: N/D = NONE DETECTED

Assayed by: 

8W

10E

Scale 1:100
(1cm = 1meter)

Claim # 1154611
MANN TWP

N

15W

10W

15W

10W

E2218
PLACER DOME
SAMPLES
E2219

DYKE

AJ08312
7m - 8m

AJ08311
6m - 7m

AJ08310
5m - 6m

AJ08309
4m - 5m

AJ08308
3 - 4m

AJ08307
2 - 3m

AJ08306
0 - 2m

BRIDGE

AJ08320	AJ08319	AJ08318	AJ08317	AJ08316	AJ08315	AJ08314	AJ08313
2m - 23m	19 - 21m	17 - 19m	15m - 17m	13m - 15m	11m - 13m	9m - 11m	7 - 9m

FALCON BRIDGE SAMPLES
AJ08306 TO AJ08320-INCL

0 + 00

10E

BEAUME
TWP.

HANNA TWP.



DUFF
TWP.

MANN TWP.

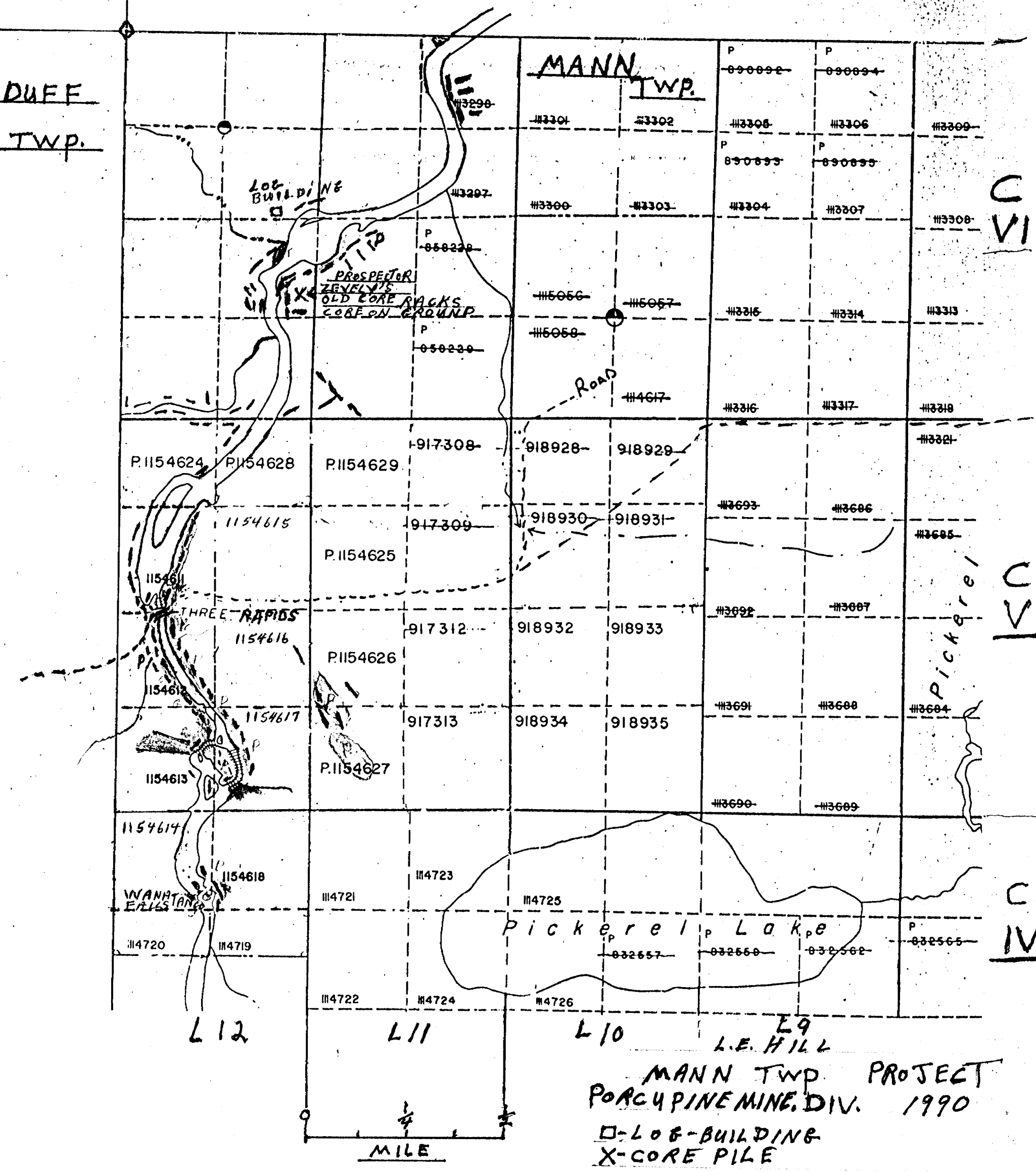

C VI

C V

C IV

MANN TWP. PROJECT
 PORCUPINE MINE. DIV. 1990
 □-LOB-BUILDING
 X-CORE PILE
 --- TRAVERSING FOR OUTCROPS
 [BLUE] PERIDOTITE
 [GREENISH WHITE] GABBRO
 [TUFF] TUFF
 SCALE-1" = 1320'

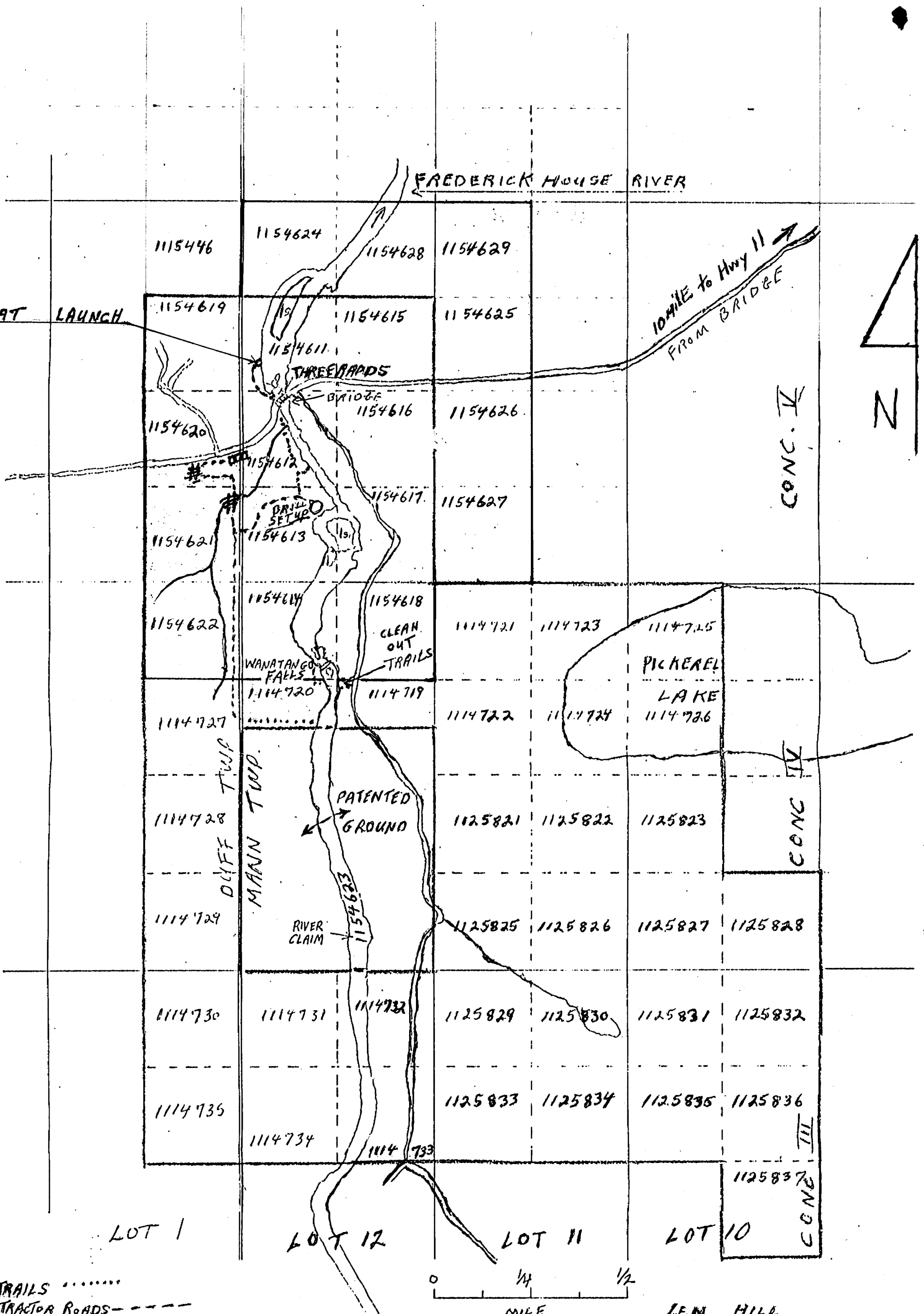

BOAT LAUNCH

FREDERICK HOUSE RIVER

10 MILE to Hwy 11
FROM BRIDGE



THREEMADS BRIDGE

WANATANGO FALLS

CLEAN OUT TRAILS

PATENTED GROUND

RIVER CLAIM

PICKEREL LAKE

LOT 1

LOT 12

LOT 11

LOT 10

1/4 1/2 MILE

CUT TRAILS
 CUT TRACTOR ROADS - - - - -
 BRIDGES-BUILT ###
 13 CLAIMS STAKED - 1154611 TO 1154623 INCL.
 6 CLAIMS STAKED - 1154624 TO 1154629 INCL.

LEN HILL
 DUFF & MANN TWP. PROPERTY
 MANN TWP. & DUFF TWP.
 PORCUPINE MINING DIVISION
 JANUARY 1990
 SCALE - 1" = 1320'

AREAS WITHDRAWN FROM DISPOSITION

- M.R.O. - MINING RIGHTS ONLY
- S.R.O. - SURFACE RIGHTS ONLY
- M.F.S. - MINING AND SURFACE RIGHTS

Description Order No. Date Disposition File

 WATER POWER RESERVE

W.O. 87 / 87

 MINING AND SURFACE RIGHTS WITHDRAWN UNDER SECTION 36 OF THE MINING ACT (OCTOBER 15, 1987) AND THE 88-4255 SURFACE AND MINING RIGHTS RE-OPENED TO PROSPECTING, STAKING OUT, SALE OR LEASE UNDER SECTION 36 OF THE MINING ACT R.S.O. 1980 EFFECTIVE 30-SEP-86 AT 7AM E.S.T. ORDER NO. O-P 4/90 NR DATED 30-NOV-22.

← THIS IS THE NEW TIMBER ACCESS ROAD INTO HANNA TWP.

HANNA TOWNSHIP

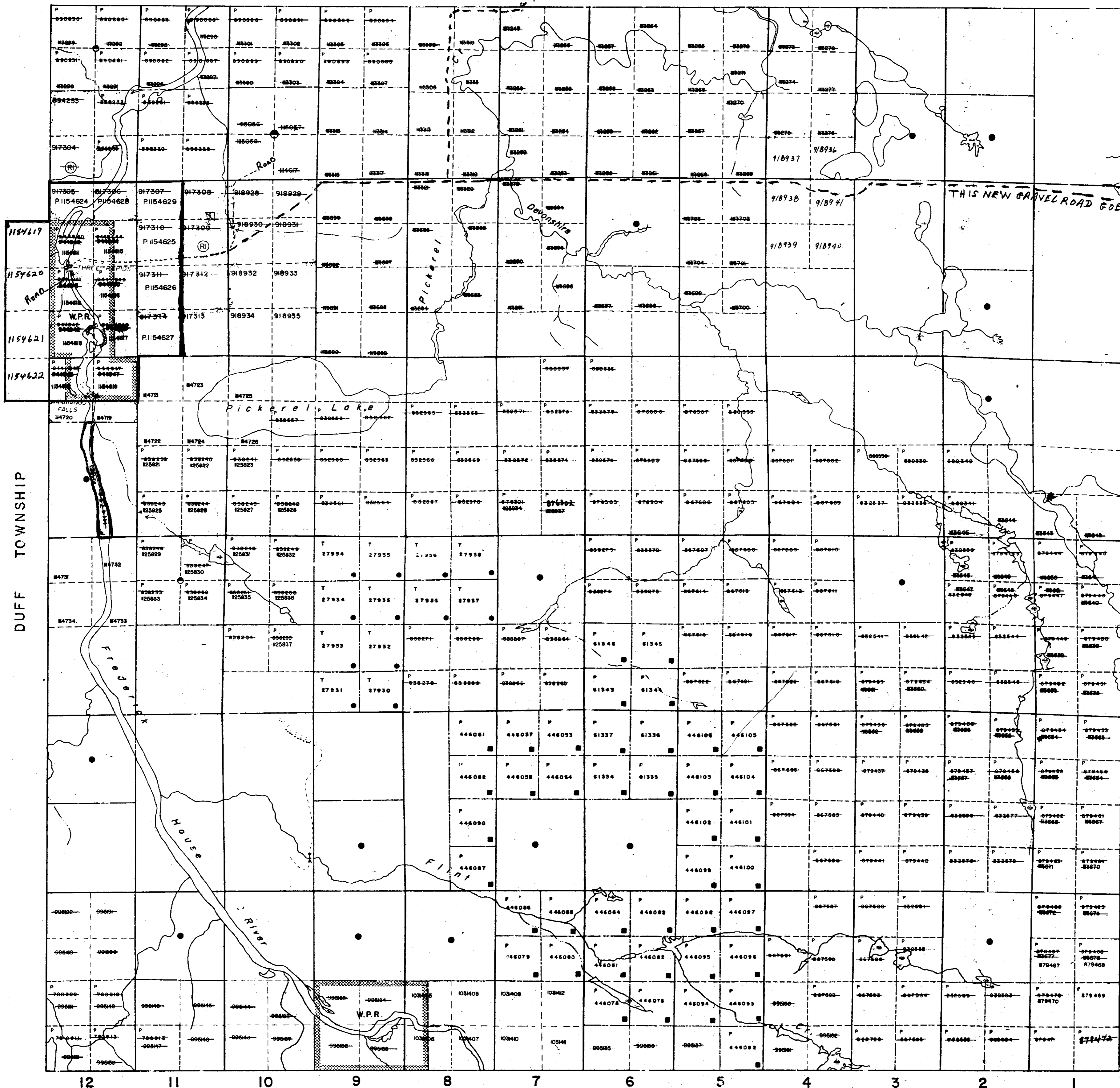

DUFF TOWNSHIP

VI

V

IV

III

II













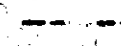

I

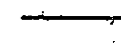
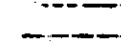
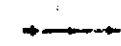
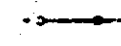
NEWMARKET TOWNSHIP











LITTLE TOWNSHIP

12 11 10 9 8 7 6 5 4 3 2 1

LEGEND

- HIGHWAY AND ROUTE No. 
- OTHER ROADS 
- TRAILS 
- SURVEYED LINES: TOWNSHIPS, BASE LINES, ETC. 
- LOTS, MINING CLAIMS, PARCELS, ETC. 
- UNSURVEYED LINES: LOT LINES 
- PARCEL BOUNDARY 
- MINING CLAIMS ETC. 
- RAILWAY AND RIGHT OF WAY 
- UTILITY LINES 
- NON PERENNIAL STREAM 
- FLOODING OR FLOODING RIGHTS 
- SUBDIVISION OR COMPOSITE PLAN RESERVATIONS 
- ORIGINAL SHORELINE 
- MARSH OR MUSKEG 
- MINES 
- TRAVERSE MONUMENT 

DISPOSITION OF CROWN LANDS

TYPE OF DOCUMENT	SYMBOL
PATENT, SURFACE & MINING RIGHTS	
" SURFACE RIGHTS ONLY	
" MINING RIGHTS ONLY	
LEASE, SURFACE & MINING RIGHTS	
" SURFACE RIGHTS ONLY	
" MINING RIGHTS ONLY	
LICENCE OF OCCUPATION	
ORDER-IN-COUNCIL	
RESERVATION	
CANCELLED	
SAND & GRAVEL LAND USE PERMIT	

NOTE: MINING RIGHTS IN PARCELS PATENTED PRIOR TO M.A.S. 1913, VESTED IN ORIGINAL PATENTEE BY THE PUBLIC LANDS ACT, R.S.O. 1970, CHAP. 380, SEC. 63, SUBSEC. 1.

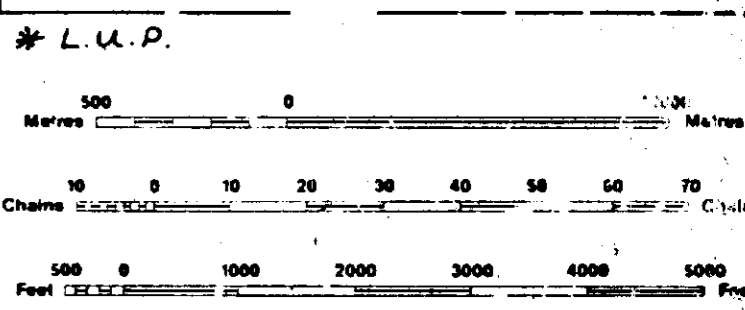

SCALE 1:20 000

Received Sept 22/86

TOWNSHIP
MANN
M.N.R. ADMINISTRATIVE DISTRICT
COCHRANE
MINING DIVISION
PORCUPINE
LAND TITLES / REGISTRY DIVISION
COCHRANE

Ministry of Natural Resources Ontario
Ministry of Northern Development and Mines

Date: SEPTEMBER, 1986
Number: G-3537



4241458381 63.5796 MANN

THE INFORMATION THAT APPEARS ON THIS MAP HAS BEEN COMPILED FROM VARIOUS SOURCES, AND ACCURACY IS NOT GUARANTEED. THOSE WISHING TO STAKE MINING CLAIMS SHOULD CONSULT WITH THE MINING RECORDER, MINISTRY OF NORTHERN DEVELOPMENT AND MINES, FOR ADDITIONAL INFORMATION ON THE STATUS OF THE LANDS SHOWN HEREON.

200

NOTES

400' surface rights reservation along the shores of all lakes and rivers.

Subdivision of this township into lots and concessions was annulled July 9, 1962.

SAND AND GRAVEL

- G₁ GRAVEL RESERVE FILE: 144579
- G₂ GRAVEL RESERVE FILE: 144585
- G₃ GRAVEL RESERVE FILE: 173973
- G QUARRY PERMIT

● PROPOSED SILVICULTURE PLANTING CAMPS RECEIVED JANUARY 12, 1989

PERIDOTITE

⊙ - OUTCROPS
- - - TRAVERSES



210

THE INFORMATION THAT APPEARS ON THIS MAP HAS BEEN COMPILED FROM VARIOUS SOURCES, AND ACCURACY IS NOT GUARANTEED. THOSE WISHING TO STAKE MINING CLAIMS SHOULD CONSULT WITH THE MINING RECORDER, MINISTRY OF NORTHERN DEVELOPMENT AND MINES, FOR ADDITIONAL INFORMATION ON THE STATUS OF THE LANDS SHOWN HEREON.

LUCAS TP. M.537

FOURNIER TP. M.477

CONCESSION I

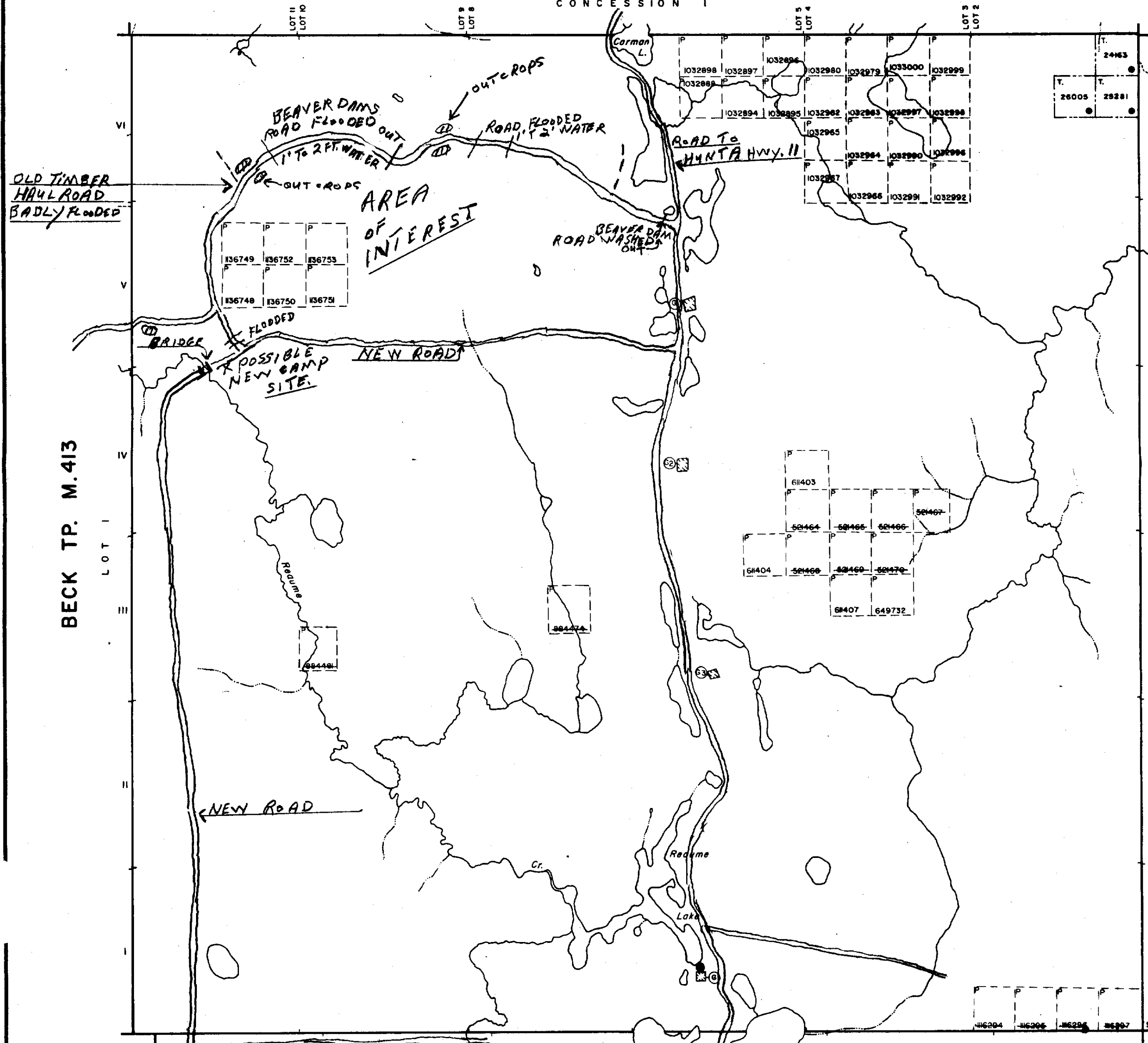

DUFF TP. M.466

LEGEND

- HIGHWAY AND ROUTE No.
- OTHER ROADS
- TRAILS
- SURVEYED LINES: TOWNSHIPS, BASE LINES, ETC.
- LOTS, MINING CLAIMS, PARCELS, ETC.
- UNSURVEYED LINES: LOT LINES
- PARCEL BOUNDARY MINING CLAIMS ETC.
- RAILWAY AND RIGHT OF WAY
- UTILITY LINES
- NON-PERENNIAL STREAM
- FLOODING OR FLOODING RIGHTS
- SUBDIVISION
- ORIGINAL SHORELINE
- MARSH OR MUSKEG
- MINES

DISPOSITION OF CROWN LANDS

TYPE OF DOCUMENT	SYMBOL
PATENT, SURFACE & MINING RIGHTS	●
" SURFACE RIGHTS ONLY	○
" MINING RIGHTS ONLY	◐
LEASE, SURFACE & MINING RIGHTS	■
" SURFACE RIGHTS ONLY	◼
" MINING RIGHTS ONLY	◻
LICENCE OF OCCUPATION	▼
CROWN LAND SALE	CS
ORDER-IN-COUNCIL	OC
RESERVATION	○
CANCELLED	⊙
SAND & GRAVEL	⊙

PLACED ON ACTIVE FILE CHECKED 20/03/90

SCALE: 1 INCH = 40 CHAINS



ACRES HECTARES

40 16

TOWNSHIP

REAUME

DISTRICT

COCHRANE

MINING DIVISION

PORCUPINE

Ministry of Natural Resources

Ontario Surveys and Mapping Branch

Date OCT. 1975

Plan No.

Whitney Block Queen's Park, Toronto

M.576

S.E. CORNER CO-ORDINATES (Approx.)
LAT. 48° 53' 04"
DEP. 81° 04' 28"

REFERENCES

AREAS WITHDRAWN FROM DISPOSITION

- M.R.O. - MINING RIGHTS ONLY
- S.R.O. - SURFACE RIGHTS ONLY
- M.+S. - MINING AND SURFACE RIGHTS

Description	Order No.	Date	Disposition	File
SEC 36/80	W.1/80	8/8/80	M.+S.	

① SEC 36/80 W.1/80 8/8/80 M.+S.

② ~~TOWNSHIP SURFACE RIGHTS WITHDRAWN UNDER SECT. 36 OF THE MINING ACT, R.S.O. 1990, ORDER W.26/87 NR. DATED MARCH 6, 1987~~

REOPENED FEBRUARY 3, 1989
ORDER NO. O-P 2/89 NR

Subdivision of this township into lots and concessions was annulled May 10, 1963.

SAND and GRAVEL

① QUARRY PERMIT

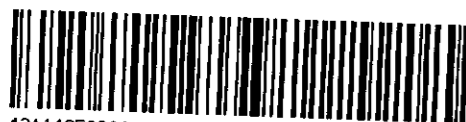

THE INFORMATION THAT APPEARS ON THIS MAP HAS BEEN COMPILED FROM VARIOUS SOURCES, AND ACCURACY IS NOT GUARANTEED. THOSE WISHING TO STAKE MINING CLAIMS SHOULD CONSULT WITH THE MINING RECORDER, MINISTRY OF NORTHERN DEVELOPMENT AND MINES, FOR ADDITIONAL INFORMATION ON THE STATUS OF THE LANDS SHOWN HEREON.

220

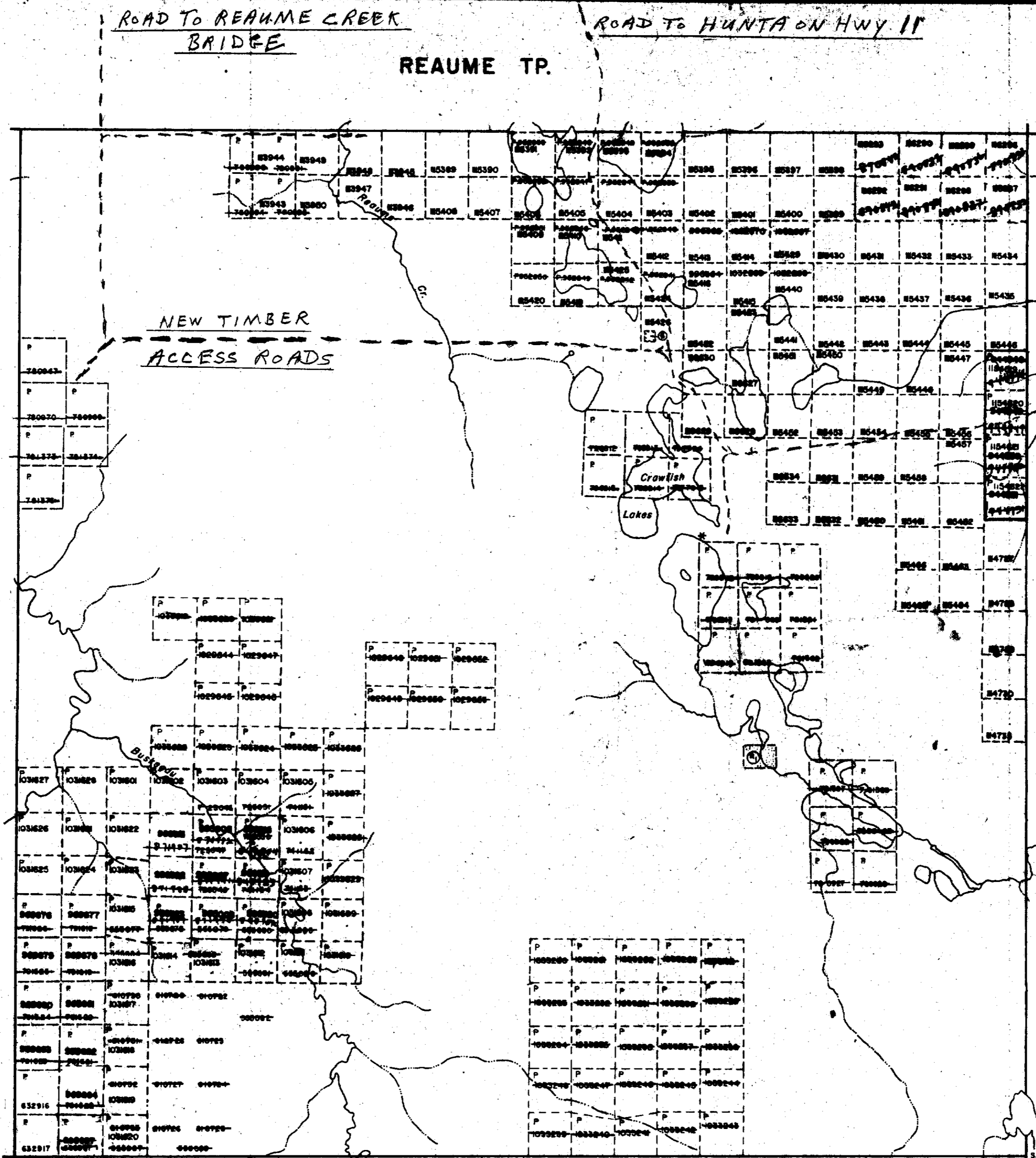

S.E. CORNER CO-ORDINATES (Approx.)
LAT. 48° 47' 50"
DEP. 81° 04' 28"

LEGEND

- HIGHWAY AND ROUTE No.
- OTHER ROADS
- TRAILS
- SURVEYED LINES:
 - TOWNSHIPS, BASE LINES, ETC.
 - LOTS, MINING CLAIMS, PARCELS, ETC.
- UNSURVEYED LINES:
 - LOT LINES
 - PARCEL BOUNDARY
 - MINING CLAIMS ETC.
- RAILWAY AND RIGHT OF WAY
- UTILITY LINES
- NON-PERENNIAL STREAM
- FLOODING OR FLOODING RIGHTS
- SUBDIVISION OR COMPOSITE PLAN
- RESERVATIONS
- ORIGINAL SHORELINE
- MARSH OR MUSKEG
- MINES
- TRAVERSE MONUMENT

DISPOSITION OF CROWN LANDS

TYPE OF DOCUMENT	SYMBOL
PATENT, SURFACE & MINING RIGHTS	●
" SURFACE RIGHTS ONLY	○
" MINING RIGHTS ONLY	◐
LEASE, SURFACE & MINING RIGHTS	■
" SURFACE RIGHTS ONLY	□
" MINING RIGHTS ONLY	◑
LICENCE OF OCCUPATION	▼
ORDER-IN-COUNCIL	OC
RESERVATION	⊙
CANCELLED	⊖
SAND & GRAVEL LAND USE PERMIT	⊙

NOTE: MINING RIGHTS IN PARCELS PATENTED PRIOR TO MAY 8, 1913, VESTED IN ORIGINAL PATENTEE BY THE PUBLIC LANDS ACT, R.S.O. 1970, CHAP. 380, SEC. 63, SUBSEC. 1.

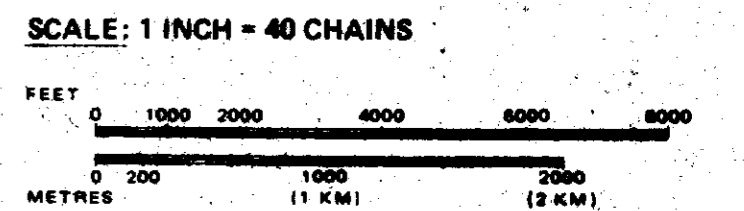

TOWNSHIP
DUFF
M.N.R. ADMINISTRATIVE DISTRICT
COCHRANE
MINING DIVISION
PORCUPINE
LAND TITLES / REGISTRY DIVISION
COCHRANE

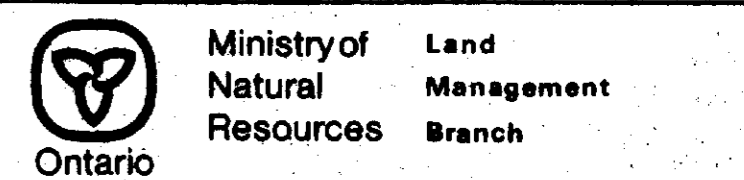

Date MARCH, 1985
Number
G-3234

Lamarche Twp.

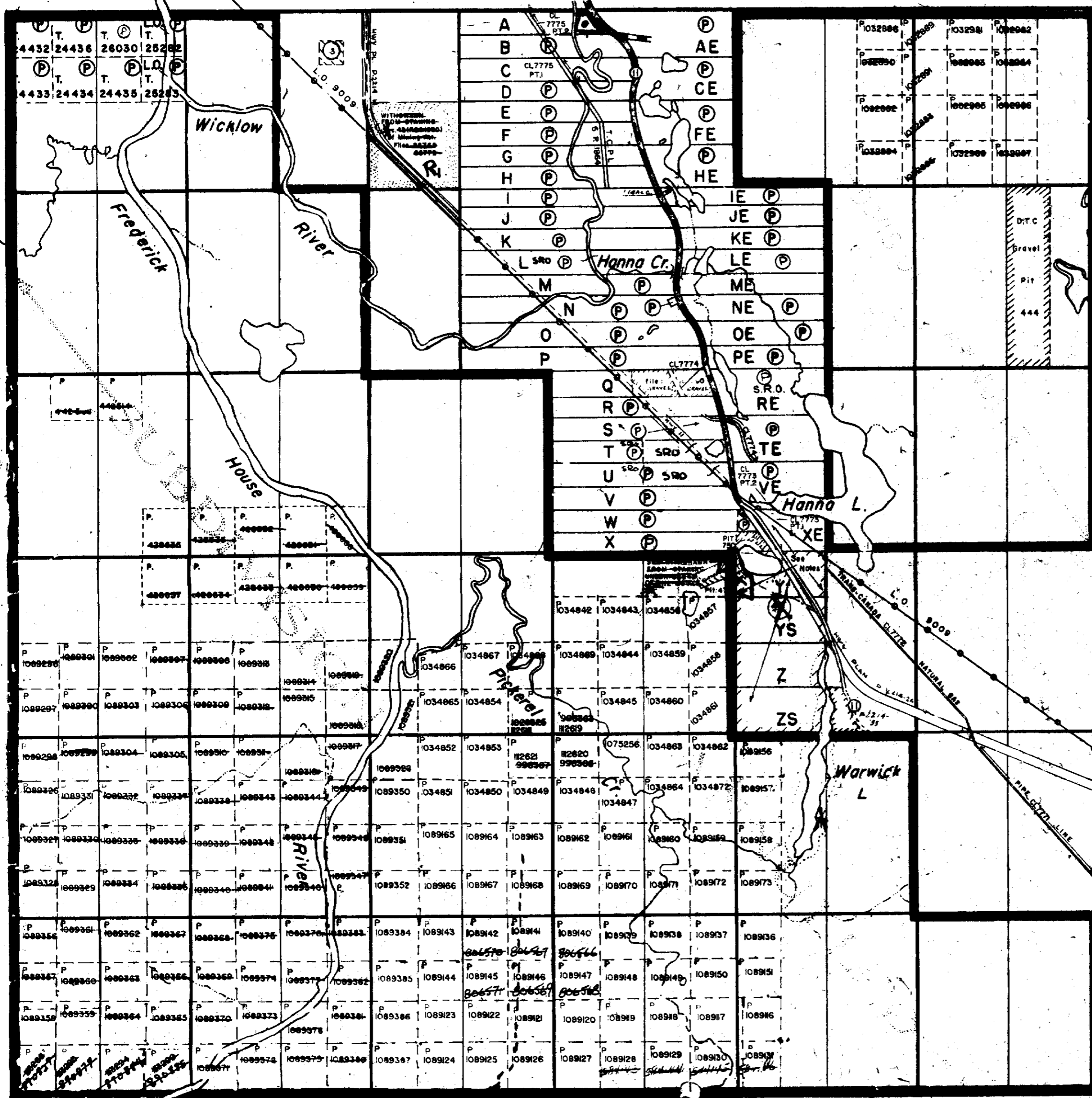

Reaume Twp.

ST. John Twp.

Mann Twp.

NEW TIMBER ACCESS ROAD

THE TOWNSHIP OF **HANNA**

DISTRICT OF COCHRANE

PORCUPINE MINING DIVISION

SCALE: 1-INCH = 40 CHAINS

LEGEND

- PATENTED LAND
- CROWN LAND SALE
- LEASES
- LOCATED LAND
- LICENSE OF OCCUPATION
- ROADS
- IMPROVED ROADS
- RAILWAYS
- POWER LINES
- MARSH OR MUSKEG
- KING'S HIGHWAY

NOTES

400' Surface rights reservation around all lakes & rivers.

REG. PLAN NO. - M 57 COVERS LOTS "A" TO "Z" IN CON. 3 TO CON. 6

Surface Rights Only reserved to Dept of Lands & Forests shown thus: File 88767

See L & F File 96605 - 122598 Re Gravel On Loc. XE & Loc. Y

Opening under Section 19(3) (R.S.O. 1970)

File No.	Date	Disposition
W 54/73 (45) 88778	27/11/73	S.R.O.
W 32/74 (4) 88605	12/6/74	S.R. & M.R.
W 20/75 (2) 88605	03/1/85	S.R.O.

Ri - S.R. & M.R. REOPENED FOR STAKING
L.O.P. *
X.L.P. Reopened N.R.O. 7/1/84
Reopened May 5/80

PLAN NO. - M 490

ONTARIO
MINISTRY OF NATURAL RESOURCES
SURVEYS AND MAPPING BRANCH

NOTICE THAT THIS MAP WAS COMPILED FROM SOURCES AND IS NOT GUARANTEED. THOSE WHO TAKE MINING SHOULD CONSULT THE MINING DEPARTMENT FOR DEVELOPMENT INFORMATION AND FOR THE LATEST INFORMATION HEREON.

