



42A14SE2002 2.18652 MANN

010

W9760.00383

DIAMOND DRILL RECORD

Hole No. M96-1

Hole No. M96-1	Sheet 1	Length 804'	Commenced September 2, 1996	Dip: Collar -65	Location Sketch
Property Len Hill		Bearing 172°	Completed November 19, 1996	Etch Test	
Township Mann		Dip -65°	Drilling Co. Hillex	Depth	
Location Collared on 1154612, drilled onto 1154613		Objective Testing mafic and ultramafic intrusives for mineralization.	Core Size A Q 1 1/16"	Rdg.	
Logged By Wayne Constarphine			Casing Left/Lost in Hole 6.0 left	True	
Core Location 122 Helen St., S Porcupine			Logged to 804' on May 30, 1997 by Wayne Constarphine	15' -68°	
				200' -68°	
				400' -69°	
				600' -69°	
				800' -69°	

Remarks Set up used for M96-1 is the same as used for earlier hole 91-1. Stopped drilling November 19, 1996 @ 804.0' Restart drilling June, 1997 804.0'

Footage - Metres		DESCRIPTION	Sample No.	From	To	Length						
From	To											
0.0	5.0	Casing										
5.0	132.0	Gabbro. Massive, medium-grained, medium to dark green colour. Non magnetic Groundmass consists of dark green hornblende and white to greenish white plagioclase feldspar. Proportions approximately 60:40 respectively Overall there is some variability in the appearance as grain size changes and relative proportions of the main minerals fluctuate. Some sections over a few inches are finer textured, but in general small patches of coarser texture are more frequent. Occasional white quartz-carbonate veinlet ~ 1" in thickness, as at 21.0'. Rare, narrow chloritic seam as at 48.3 feet. First coarsening in texture appears at 41.8 feet. After this point there is a more intimate mix of coarse spots and finer ground mass. 115.0 - 132.0: gabbro exhibits annealed, fracturing and breccia texture Estimate 5-8% pale grey, fine-grained calcite in fractures, also some white-beige quartz. No mineralization readily observed. Seams defining fragments .5 - 1.0 inches maximum. Some evidence of ultramafic composition - softness, darker green colours. Minor occurrences of epidote as isolated, narrow pistachio-green vein-like bands - quite sparse. Lower contact somewhat arbitrary - start of more abundant darker green peridotite material, but no pristine - still in contact zone where the two units are not completely segregated.										

Wayne Constarphine

DIAMOND DRILL RECORD

Hole No. M96-1
Sheet No. 2

Footage - Metres		DESCRIPTION	Sample No.	From	To	Length feet	Au ppb	Pt ppb	Pd ppb	Ni ppm		
From	To											
132.0	804.0	<p>Ultramafic - Peridotite to Dunite.</p> <p>Section displays some variability. Where not affected by localized fracturing and brecciation textures (ie deformation features) the unit is dark, blackish green and massively textured. The groundmass exhibits a well defined nodular structure wherein lighter, coalescing rounded crystals are matrixed by an aphanitic very dark green to black groundmass. It is assumed the rounded 1-2 and even 3mm grains are olivine pseudomorphs.</p> <p>132.0 - 165.0 : contact zone</p> <p>Unit is texturally similar to the gabbro rather than the ultramafic but is quite talcose. Clearly in deformation zone although not a strongly developed one. Much foliate to banded structure of variable orientation. Breccia fragments common. 3-5% carbonate seams. No significant sulphide development. No quartz veins of note. Non magnetic.</p>										
		<p>165.0 - 292.0 : typical peridotite-dunite, local deformation structures</p>	20	184	187	3.0	2	<5	4	438		
		<p>"Nodular" texture well developed. ~ 75-80% with remainder a dark groundmass. Frequent intervals exhibiting foliated and quasi-banded fabric with some calcite and possibly quartz as veinlike to matrix-like material. Estimate 5% vein-like quartz-carbonate material, locally to 8-10% over 1-2 foot intervals as at 187.0.</p>	21	207	210	3.0	2	6	7	1175		
		<p>No mineralization readily observed. Nonmagnetic to weakly so over very short sections. Grain size is fine to medium.</p>	22	224	227	3.0	<1	<5	<1	683		
		<p>292.0 - 352.3 peridotite-dunite with strong magnetic signature. Similar to undeformed section in 165.0 - 292.0 but magnetic content high ~ 2-3%+. Groundmass texture more even and finer. White calcite fracture and veinlets common - every 2-3 inches, very narrow (1-2mm) to 1cm in width - random orientations, no sulphides. Typical massive fragmentation of ultramafic. Groundmass grain size is medium sometimes becoming fine and very even in appearance as in the vicinity of 294.0 feet. Where it is very dense and compact. This is the predominant character of this interval.</p>										
		<p>352.3 - 378.0 Alteration Zone. Pale discoloration of unit, core very blocky over first 3 feet and tends to have low angle fracture fragments from 364.7 to 366.8 feet. Contrasting pale, apple-green (but not fuchsite) shade to coarse, 25 to 1.0 inch clasts or breccia fragments of varying concentrations, set in dark, serpentine matrix.</p>										

Handwritten signature

DIAMOND DRILL RECORD

Hole No. M96-1
Sheet No. 3

Footage - Metres		DESCRIPTION	Sample No.	From	To	Length feet	Au ppb	Pt ppb	Pd ppb	Ni ppm		
From	To											
		Minor white quartz and carbonate - similar to typical concentrations elsewhere - 2-3%. No readily observed mineralization in this section. Loss of magnetite extends throughout interval and on up hole side for at least 5 feet in normal-looking material. Gradational reduction in relative amount of pale, discoloured patches towards lower contact.										
	328.0 - 748.6	typical peridotite - dunite rock	023	409	412	3.0	3	<5	2	816		
		Strongly magnetic, 5% magnetite.	01	737	742	5.0	1	7	4	1744		
		Dark colour - faint pistachio green to serpentine green to fresh surfaces.	02	742	745	3.0	3	12	4	1210		
		Textures on coned surface can be highly variable.	03	745	747	2.0	10	<5	6	926		
		Appears to be an almost varietic texture in places - grey nodules tightly packed with darker, bounding patches - as at 410-414 feet.	04	747	749	2.0	2	<5	<1	561		
		Olivine pseudo-morphs become more clearly defined & coarser with increasing depth after about 425 feet and appearance of the unit is more homogeneous.	01A	691	693	2.0	1	<5	<4			
		Occasional ham-turcent, medium green serpentine seams.	02A	693	695	2.0	1	<5	<4			
		Unit is very uniform from 425 to 748.6 feet - very magnetic, dark blackish green, medium texture, homogeneous. Occasional fibrous serpentine veinlets in some areas, particularly after 600 feet.	03A	697	699	2.0	2	<5	<4			
			04A	705	707	2.0	1	<5	<4			
			05A	707	709	2.0	1	<5	<4			
	748.6 - 779.3	Alteration Zone in the peridotite/dunite	05	749	752	3.0	91	46	2	290		
		Contact is quite sharp - near orthoandite c.a., and abrupt. change in colour from dark green to very pale, whitish green. In some ways there is a similarity with the alteration zone at 352.3 in the pale green discolouring. Overall textural appearance differs. A pale green - towards apple-green characterizes the section. A blotchy crudely foliated to massive colour scheme consists of apple-green, fine mineralogy matrixed by white aphanitic groundmass, in medium textured format. In the first 6 feet. Occasional greyish patches of a soft nature (protolith remnants) float through the pale alteration groundmass. The alteration changes gradationally into a massive pale green section of uniform character. Occasional dark green, coarse aggregate masses 3-5mm scattered through pale green groundmass.										
		Note sparse concentration of soft, metallic, grey in colour in various locations in this section. Concentrations <<1%.										
		No strong sulphide development observed. To what extent ??										

Wagner

DIAMOND DRILL RECORD

Hole No. M96-1 EXT

Hole No. <u>M96-1 EXT Sheet 1</u>	Length <u>114 feet</u>	Commenced <u>June 23, 1997</u>	Dip: Collar <u>-65 degrees</u>	Location Sketch
Property <u>Len Hill</u>	Bearing <u>172 degrees</u>	Completed <u>July 21, 1997</u>	Ech Test	
Township <u>Mann</u>	Dip <u>-65 at collar</u>	Drilling Co. <u>Hilllex</u>	Depth	
Location <u>Collar on 1154612, 804-918 on 1154613</u>	Objective <u>extending original drill hole from 804' to 918', see</u>	Core Size <u>AQ 1 1/16"</u>	Rdg.	
Logged By <u>Wayne Constorphine</u>		Casing Left/Lost in Hole <u>6.0'</u>	True	
Core Location <u>122 Helen St, S. Porcupine</u>		Logged <u>June 20, 1998</u> <u>by Wayne Constorphine</u>	15' <u>-68°</u>	
			200' <u>-68°</u>	
			400' <u>-69°</u>	
			600' <u>-69°</u>	
			800' <u>-69°</u>	

Remarks This section of 114 feet is extension of M96-1 from 804' to 918'

Footage - Metres		DESCRIPTION	Sample No.	From	To	Length feet	Au ppb	Pt ppb	Pd ppb
From	To								
0.0	804.0	see log for M96-1							
804.0	815.8	Weak Alteration Zone - Peridotite/Dunite Continuation of zone beginning at 779.3 (see log M96-1) Distinctly lighter in colour than unaltered dunite-peridotite Colour is medium green to greyish green Colour suggests pervasive Serpentinization Nonmagnetic or very weakly so - due to the alteration. No obvious mineralization Lower contact not preserved - cone breakage.							
815.8	918.0	Ultramafic - Peridotite to Dunite Relatively homogeneous section Dark colour - blackish green with beige, speckled cast. Medium to coarse-grained, massive but with occasional fine-grained to aphanitic shear of foliated to schistose serpentine - light soapy green colour. More massive patches show radiating fibrous crystal texture. Very magnetic throughout, occasional heavy concentration of coarse magnetite as at 884.5. Olivine crystals comprise 80% of groundmass - paler colour, average about .6 to 1 mm in size - tightly packed 914.0-916.0: possible alteration zone. The ultramafic appears to be slightly siliceous in this interval, although there is no clear evidence for secondary alteration. (extra pressure on the bit at this point caused Bit to start to break up and eventually at 918 complete failure occurred)	06A	882	884	2.0	<1	2	4
			07A	911	913	2.0	1	6	8
			4601	887.8	888.5	0.7	<1	13	10
918.0		End of Hole.							

Wayne Constorphine

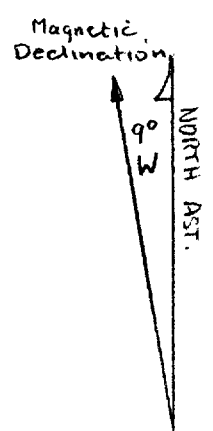

1154612

1154616

DDH: M96-1
-65°
804'

COLLAR
30' N of CL

DDH M96-1EXT
114'

804'
918'

Setup for 96-1 same as for 91-1.

- No Grid on Property -

1154613

1154617

RECEIVED
JUL 13 1998
GEOSCIENCE ASSESSMENT
OFFICE

Wayne Don Tapscott
02/07/98

FREDERICK HOUSE RIVER

LOT 12

L.E. Hill Property
MANN TOWNSHIP

Scale

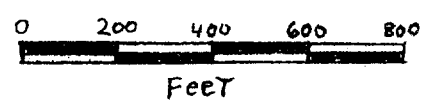

DUFF TOWNSHIP
MANN TOWNSHIP

V
IV

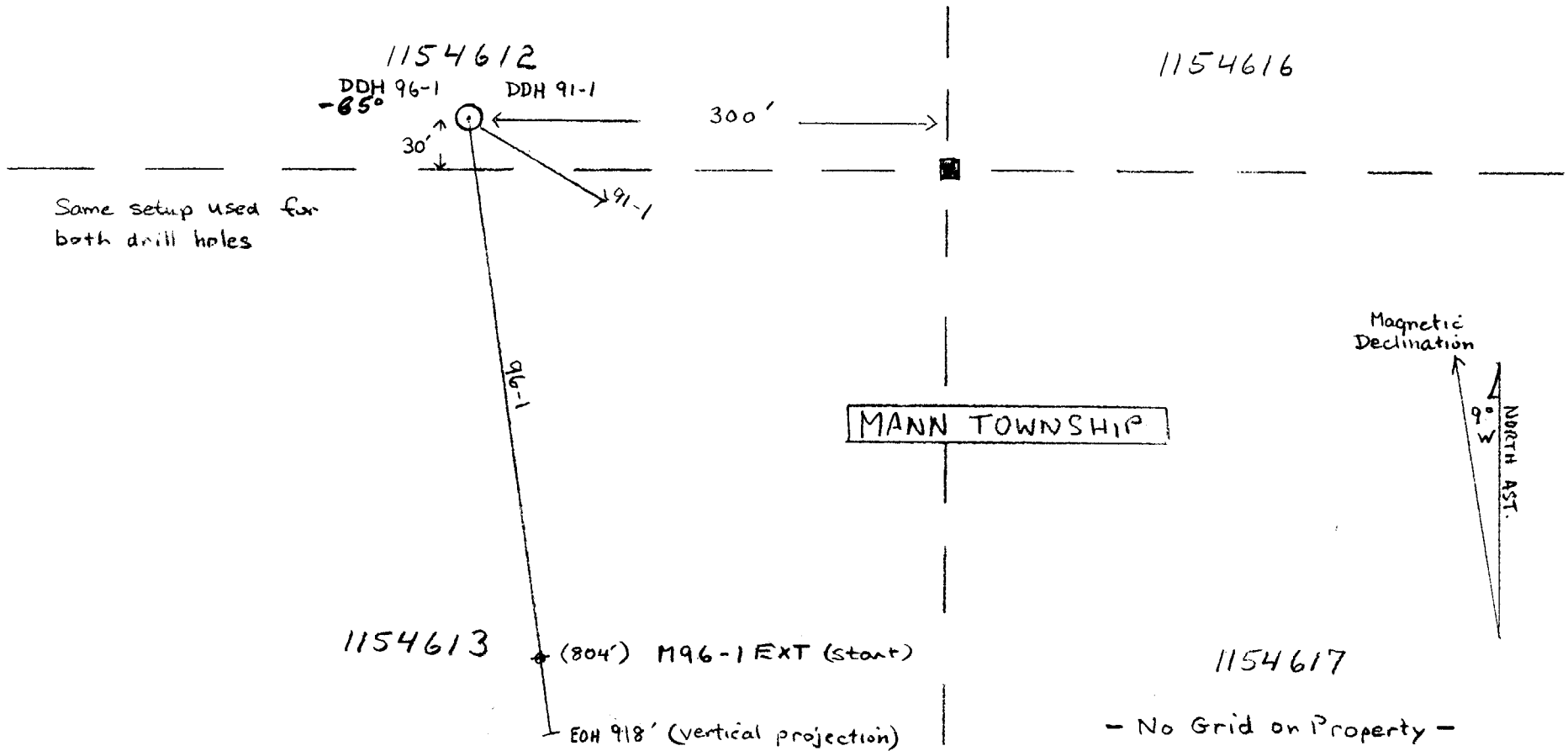

ASSESSMENT: DDH 96-1

Distribution per claim

on 1154612	10%	\$ 1,566.
" 1154613	90%	\$ 14,095

} previously submitted

ASSESSMENT: DDH 96-1 EXT

Distribution per claim

on 1154613: 100%

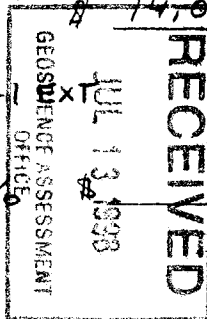

Wayne Gustafson
02/07/98

L. E. Hill Property
MANN TOWNSHIP
Scale

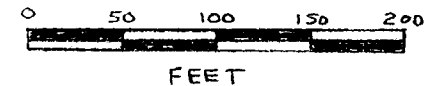

1:1200 scale

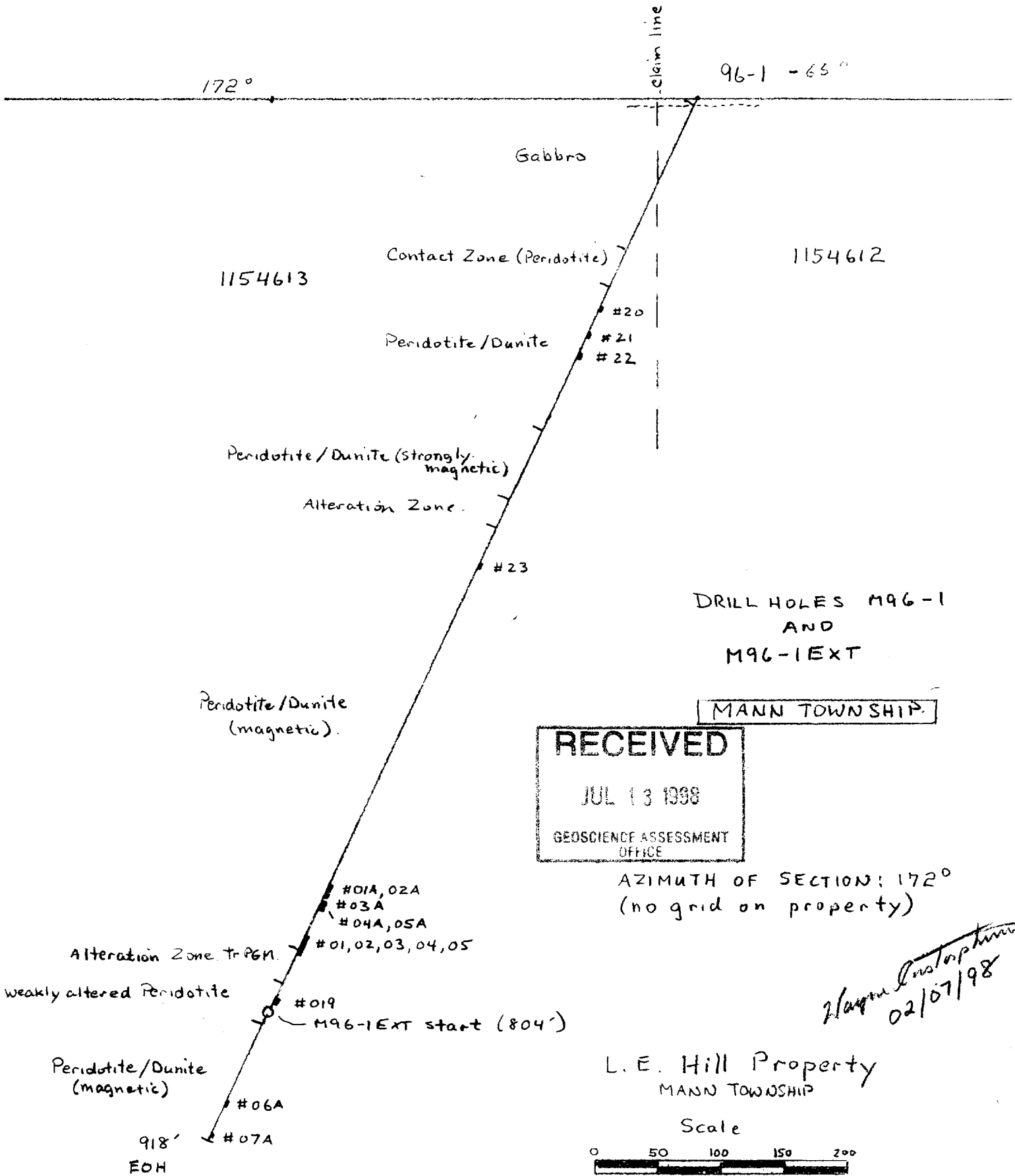



Intertek Testing Services Chimitec Bondar Clegg

Certificat D'Analyse Assay Lab Report

CLIENT: BATTLE MOUNTAIN CANADA LTD.
REPORT: T97-57424.0 (COMPLETE)

PROJECT: 501
DATE PRINTED: 25-AUG-97 PAGE 1

SAMPLE NUMBER	ELEMENT UNITS	AU PPB	Pt PPB	Pd PPB
4601		<1	13	10

2.18652



42A14SE2002 2.18652 MANN 020

ITS - Chimitec - Bondar Clegg
1322-B rue Harricana, Val d'Or, Québec, J9P 3X6
Tél: (819) 825-0178, Fax: (819) 825-0256



Intertek Testing Services Chimitec Bondar Clegg

Certificat D'Analyse Assay Lab Report

CLIENT: BATTLE MOUNTAIN CANADA LTD.

PROJECT: 501

REPORT: T97-57426.1 (COMPLETE)

DATE PRINTED: 5-AUG-97

PAGE 1A

SAMPLE NUMBER	ELEMENT UNITS	As PPM	Ag PPM	Cu PPM	Zn PPM	Pb PPM	Ni PPM	Mo PPM	V PPM	Ba PPM	Nb PPM	Sr PPM	Y PPM
4601		<5	<0.2	18	54	<2	911	<1	<20	8	<1	5	<1

*Len Hill's Property in Yarm Twp
Mojic - Ultramafic Complex*

*Diamond Drill Hole M96-1
Multi Element Analysis at 888 feet. (887.8-888.5)*



Intertek Testing Services Chimitec Bondar Clegg

Certificat D'Analyse Assay Lab Report

CLIENT: BATTLE MOUNTAIN CANADA LTD.
REPORT: T97-57426.1 (COMPLETE)

PROJECT: 501
DATE PRINTED: 5-AUG-97 PAGE 18

SAMPLE NUMBER	ELEMENT UNITS	Zr PPM	Cr PPM	Sb PPM	V PPM	Co PPM	Sc PPM	La PPM	Bi PPM	Cd PPM	Sn PPM	Cu PPM	Li PPM
4601		<1	173	<5	10	83	<5	<1	<5	<0.2	70	4	3



Intertek Testing Services Chimitec Bondar Clegg

Certificat D'Analyse Assay Lab Report

CLIENT: BATTLE MOUNTAIN CANADA LTD.

PROJECT: 501

REPORT: Y97-57426.1 (COMPLETE)

DATE PRINTED: 5-AUG-97

PAGE 1C

SAMPLE NUMBER	ELEMENT UNITS	Ti PCT	Te PPM	Ta PPM	Fe PCT	Al PCT	Ca PCT	Mg PCT	Na PCT	K PCT	Mn PPM
4601		<0.01	<10	<10	7.16	1.02	0.15	>10.00	<0.01	0.03	856



Intertek Testing Services Chimitec Bondar Clegg

Certificat D'Analyse Assay Lab Report

CLIENT: BATTLE MOUNTAIN CANADA LTD.
REPORT: T97-57755.0 (COMPLETE)

PROJECT: 501
DATE PRINTED: 17-OCT-97 PAGE 1

SAMPLE NUMBER	ELEMENT UNITS	AU PPB	Pt PPB	Pd PPB	Ni PPM
1		1	7	4	1744
2		3	12	4	1210
3		10	<5	6	926
4		2	<5	<1	561
5		91	46	2	290

1865 2

Sample description	AU PPB	PT PPB	PD PPB
01 A	1.	<5.	<4.
02 A	1.	<5.	<4.
03 A	2.	<5.	<4.
04 A	1.	<5.	<4.
05 A	1.	<5.	<4.

Sample description	AU PPB	AG PPM	AS PPM	BA PPM	BR PPM	CA %	CO PPM	CR PPM	CS PPM	FE %	HP PPM	HG PPM	IR PPB	MO PPM	NA %	NI PPM	RB PPM	SB PPM	SC PPM	SE PPM	SN %	SR %	TA PPM	TH PPM
01 A	<5	<5	<2	<100	17	2	99	1400	<2	5.16	<1	<1	<5	<5	<0.05	2100	<30	<0.2	13	<5	<0.02	<0.05	<1	<0.5
05 A	10	<5	<2	<100	18	<1	94	670	<2	6.43	<1	<1	<5	<5	<0.05	2600	<30	<0.2	13	<5	<0.02	<0.05	<1	<0.5

Sample description	U PPM	W PPM	EN PPM	LA PPM	CE PPM	ND PPM	SM PPM	EU PPM	TB PPM	YB PPM	LU PPM	Mass g
01 A	<0.5	<4	<50	<1	<3	<5	0.2	<0.2	<0.5	0.3	<0.05	36.78
05 A	<0.5	<4	72	<1	<3	<5	0.2	0.3	<0.5	0.3	0.05	31.35

Sample ID	Au ppb	Pt ppb	Pd ppb
06A ONE	<1	2	4
07A TWO	1	6	8

RECEIVED
JUL 13 1998
GEOSCIENCE ASSESSMENT
OFFICE

Sample description	AU PPB	AG PPM	AS PPM	BA PPM	BR PPM	CA %	CO PPM	CR PPM	CS PPM	FE %	HF PPM	HG PPM	IR PPB	MO PPM	MA %	NI PPM	RB PPM	SB PPM	SC PPM	SE PPM	SN %	SR %	TA PPM	TH PPM
06A ONE	<5	<5	<2	<100	2	2	110	3000	<2	7.61	<1	<1	<5	<5	<0.05	1200	<30	<0.2	15	<5	<0.01	<0.05	<1	<0.5
07A TWO	<5	<5	<2	<100	3	1	120	2200	<2	9.85	<1	<1	<5	<5	<0.05	1400	<30	<0.2	14	<5	<0.01	<0.05	<1	<0.5

Sample description	U PPM	W PPM	ZN PPM	LA PPM	CE PPM	ND PPM	SM PPM	EU PPM	TE PPM	YB PPM	LU PPM	Mass g
064 ONE	<0.5	<4	121	1	4	<5	0.4	<0.2	<0.5	0.6	0.09	52.41
074 TWO	<0.5	<4	105	<1	<3	<5	0.3	<0.2	<0.5	0.5	0.07	34.62

Activation Laboratories Ltd. Work Order: 15711 Report: 15517B

Sample ID	Au ppb	Pt ppb	Pd ppb
06A ONE	<1	2	4
07A TWO	1	6	8

Sample description	AU PPB	AG PPM	AS PPM	BA PPM	BR PPM	CA %	CO PPM	CR PPM	CS PPM	FE %	HF PPM	HG PPM	IR PPB	MO PPM	NA %	NI PPM	RB PPM	SB PPM	SC PPM	SE PPM	SN %	SR %	TA PPM	TE PPM
06A ONE	<5	<5	<2	<100	2	2	110	3000	<2	7.61	<1	<1	<5	<5	<0.05	1200	<30	<0.2	15	<5	<0.01	<0.05	<1	<0.5
07A TWO	<5	<5	<2	<100	3	1	120	2200	<2	9.85	<1	<1	<5	<5	<0.05	1400	<30	<0.2	14	<5	<0.01	<0.05	<1	<0.5

Sample description	U PPM	W PPM	ZN PPM	LA PPM	CE PPM	ND PPM	SM PPM	SU PPM	TB PPM	YB PPM	LU PPM	Mass g
064 ONE	<0.5	<4	121	1	4	<5	0.4	<0.2	<0.5	0.6	0.09	52.41
074 TWO	<0.5	<4	105	<1	<3	<5	0.3	<0.2	<0.5	0.5	0.07	34.62



Declaration of Assessment Work Performed on Mining Land

Mining Act, Subsection 65(2) and 66(3), R.S.O. 1990

Transaction Number (office use) W986000702 Assessment Files Research Imaging



42A14SE2002 2.18652 MANN

900

ity of subsections 65(2) and 66(3) of the Mining Act. Under section 8 of the d to review the assessment work and correspond with the mining land holder. ing Recorder, Ministry of Northern Development and Mines, 6th Floor,

2.18652

Instructions: - For work performed on Crown Lands before recording a claim, use form 0240. - Please type or print in ink.

1. Recorded holder(s) (Attach a list if necessary)

Name Leonard Edward Hill Client Number 144430 Address 122 Helen Ave. Telephone Number (705) 235-9736 South Porcupine, Ont. P0N 1H0 Fax Number

2. Type of work performed: Check (✓) and report on only ONE of the following groups for this declaration.

Geotechnical: prospecting, surveys, assays and work under section 18 (regs) Physical: drilling, stripping, trenching and associated assays Rehabilitation

Work Type Diamond Drilling M96-1 EXT (Extension of DDH M96-1) Office Use Commodity Total \$ Value of Work Claimed 4153 Dates Work Performed From 23 06 97 To 21 07 97 NTS Reference Mining Division Tim Resident Geologist District G-3537

Please remember to: - obtain a work permit from the Ministry of Natural Resources as required; - provide proper notice to surface rights holders before starting work; - complete and attach a Statement of Costs, form 0212; - provide a map showing contiguous mining lands that are linked for assessing work; - include two copies of your technical report.

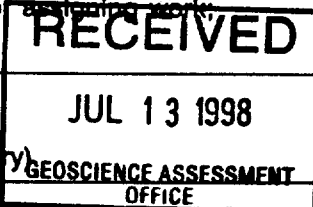

3. Person or companies who prepared the technical report (Attach a list if necessary)

Name Wayne Corstorphine Telephone Number (705) 264-3090 Address 441 Hart St, Timmins Ont P4N 6X3

4. Certification by Recorded Holder or Agent

I, Leonard Edward Hill, do hereby certify that I have personal knowledge of the facts set forth in this Declaration of Assessment Work having caused the work to be performed or witnessed the same during or after its completion and, to the best of my knowledge, the annexed report is true.

Signature of Recorded Holder or Agent L.E. Hill Date July 3/98 Agent's Address Telephone Number 705-235-9736 Fax Number

declared: Oct. 9/98

5. Work to be recorded and distributed. Work can only be assigned to claims that are contiguous (adjoining) to the mining land where work was performed, at the time work was performed. A map showing the contiguous link must accompany this form.

Mining Claim Number. Or if work was done on other eligible mining land, show in this column the location number indicated on the claim map.	Number of Claim Units. For other mining land, list hectares.	Value of work performed on this claim or other mining land.	Value of work applied to this claim.	Value of work assigned to other mining claims.	Bank. Value of work to be distributed at a future date.
eg TB 7827	16 ha	\$26,825	N/A	\$24,000	\$2,825
eg 1234567	12	0	\$24,000	0	0
eg 1234568	2	\$ 8,892	\$ 4,000	0	\$4,892
1 1154613	1	4,153	0	4,000	153
2 1154619	1	0	400		
3 1154620	1	0	400		
4 1154621	1	0	400		
5 1154622	1	0	400		
6 1154624	1	0	400		
7 1154625	1	0	400		
8 1190501	1	0	400		
9 1154626	1	0	400		
10 1154627	1	0	400		
11 1154628	1	0	400		
12					
13					
14					
15					
Column Totals			4,000.	4,000	153

I, Leonard Edward Hill (Print Full Name), do hereby certify that the above work credits are eligible under subsection 7 (1) of the Assessment Work Regulation 6/96 for assignment to contiguous claims or for application to the claim where the work was done.

Signature of Recorded Holder or Agent Authorized in Writing L.E. Hill Date July 3/98

6. Instructions for cutting back credits that are not approved.

Some of the credits claimed in this declaration may be cut back. Please check (✓) in the boxes below to show how you wish to prioritize the deletion of credits:

- 1. Credits are to be cut back from the Bank first, followed by option 2 or 3 or 4 as indicated.
- 2. Credits are to be cut back starting with the claims listed last, working backwards; or
- 3. Credits are to be cut back equally over all claims listed in this declaration; or
- 4. Credits are to be cut back as prioritized on the attached appendix or as follows (describe):

Note: If you have not indicated how your credits are to be deleted, credits will be cut back from the Bank first, followed by option number 2 if necessary.

For Office Use Only

Received By [Signature]

RECEIVED

JUL 10 1998

[Signature] 13.20

0241 (02/94) PORCUPINE MINING DIVISION

Deemed Approved Date	Date Notification Sent
Date Approved	Total Value of Credit Approved
Approved for Recording by Mining Recorder (Signature)	



Personal information collected on this form is obtained under the authority of subsection 6(1) of the Assessment Work Regulation 6/96. Under section 8 of the Mining Act, the information is a public record. This information will be used to review the assessment work and correspond with the mining land holder. Questions about this collection should be directed to the Chief Mining Recorder, Ministry of Northern Development and Mines, 8th Floor, 933 Ramsey Lake Road, Sudbury, Ontario, P3E 6B5.

2,100.00

Work Type	Units of Work <small>Depending on the type of work, list the number of hours/days worked, metres of drilling, kilometres of grid line, number of samples, etc.</small>	Cost Per Unit of work	Total Cost
Diamond Drilling	114 ft	\$ 16.00 / ft	\$ 1,824.00
Acid Dip Tests	2	\$ 75.00 ea	\$ 150.00
Assays	18	\$ 21.00 ea	\$ 378.00
Multielement Analysis	5	\$ 18.00 ea	\$ 90.00
Associated Costs (e.g. supplies, mobilization and demobilization).			
Demobilization - Mann Twp to S. Porcupine		\$ 800.00	\$ 800.00
Propane. 2 x 20lb.		\$ 10.00	\$ 20.00
Sample shipping costs May 20/98, June 5/98			\$ 20.00
Transportation Costs			
Travel 176 mi per week x 7 weeks = 1232mi		\$.48 / mi	\$ 591
Food and Lodging Costs			
Food 40.00 per week x 7 weeks		\$ 40.00 / wk.	\$ 280
Total Value of Assessment Work			\$ 4,153

RECEIVED
JUL 13 1998
GEOSCIENCE ASSESSMENT
OFFICE

Calculations of Filing Discounts:

1. Work filed within two years of performance is claimed at 100% of the above Total Value of Assessment Work.
2. If work is filed after two years and up to five years after performance, it can only be claimed at 50% of the Total Value of Assessment Work. If this situation applies to your claims, use the calculation below:

TOTAL VALUE OF ASSESSMENT WORK x 0.50 = Total \$ value of worked claimed.

Note:

- Work older than 5 years is not eligible for credit.
- A recorded holder may be required to verify expenditures claimed in this statement of costs within 45 days of a request for verification and/or correction/clarification. If verification and/or correction/clarification is not made, the Minister may reject all or part of the assessment work submitted.

Certification verifying costs:

I, Leonard Edward Hill (please print full name), do hereby certify, that the amounts shown are as accurate as may reasonably be determined and the costs were incurred while conducting assessment work on the lands indicated on the accompanying Declaration of Work form as Recorded Holder I am authorized (recorded holder, agent, or state company position with signing authority) to make this certification.

RECEIVED
JUL 10 1998
13.20
PORCUPINE MINING DIVISION

Signature: L.E. Hill Date: July 3/98

Geoscience Assessment Office
933 Ramsey Lake Road
6th Floor
Sudbury, Ontario
P3E 6B5

Telephone: (888) 415-9846
Fax: (877) 670-1555

September 29, 1998

LEONARD EDWARD HILL
122 HELEN AVENUE
P.O. BOX 1022
SOUTH PORCUPINE, Ontario
P0N-1H0

Visit our website at:
www.gov.on.ca/MNDM/MINES/LANDS/mlsmnpge.htm

Dear Sir or Madam:

Submission Number: 2.18652

Status

Subject: Transaction Number(s): W9860.00708 Deemed Approval

We have reviewed your Assessment Work submission with the above noted Transaction Number(s). The attached summary page(s) indicate the results of the review. **WE RECOMMEND YOU READ THIS SUMMARY FOR THE DETAILS PERTAINING TO YOUR ASSESSMENT WORK.**

If the status for a transaction is a 45 Day Notice, the summary will outline the reasons for the notice, and any steps you can take to remedy deficiencies. The 90-day deemed approval provision, subsection 6(7) of the Assessment Work Regulation, will no longer be in effect for assessment work which has received a 45 Day Notice. Allowable changes to your credit distribution can be made by contacting the Geoscience Assessment Office within this 45 Day period, otherwise assessment credit will be cut back and distributed as outlined in Section #6 of the Declaration of Assessment work form.

Please note any revisions must be submitted in **DUPLICATE** to the Geoscience Assessment Office, by the response date on the summary.

If you have any questions regarding this correspondence, please contact Bruce Gates by e-mail at gatesb2@epo.gov.on.ca or by telephone at (705) 670-5856.

Yours sincerely,



ORIGINAL SIGNED BY
Blair Kite
Supervisor, Geoscience Assessment Office
Mining Lands Section

Work Report Assessment Results

Submission Number: 2.18652

Date Correspondence Sent: September 29, 1998

Assessor: Bruce Gates

Transaction Number	First Claim Number	Township(s) / Area(s)	Status	Approval Date
W9860.00708	1154613	MANN	Deemed Approval	September 28, 1998

Section:
16 Drilling PDRILL

Correspondence to:
Resident Geologist
South Porcupine, ON

Recorded Holder(s) and/or Agent(s):
LEONARD EDWARD HILL
SOUTH PORCUPINE, Ontario

Assessment Files Library
Sudbury, ON

C-2231

AREAS WITHDRAWN FROM DISPOSITION

- M.R.O. - MINING RIGHTS ONLY
- S.R.O. - SURFACE RIGHTS ONLY
- M.S. - MINING AND SURFACE RIGHTS

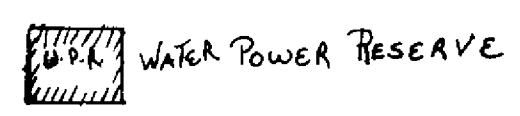

W.D. 87 / 87

SURFACE AND MINING RIGHTS RE-OPENED TO PROSPECTING, STAKING OUT, SALE OR LEASE UNDER SECTION 36 OF THE MINING ACT (R.S.O. 1990) EFFECTIVE 30-SEP-05 AT 7AM EST. ORDER NO. O-P-4/90 NR DATED 30-AUG-22.

NOTE: P1125837 PLOTTED IN ERROR. S/B P114737.

PROVINCIAL RECORDS OFFICE - SUDBURY SEP 30 1996 DATE OF ISSUE

2-18652
DRILL

DUFF TOWNSHIP

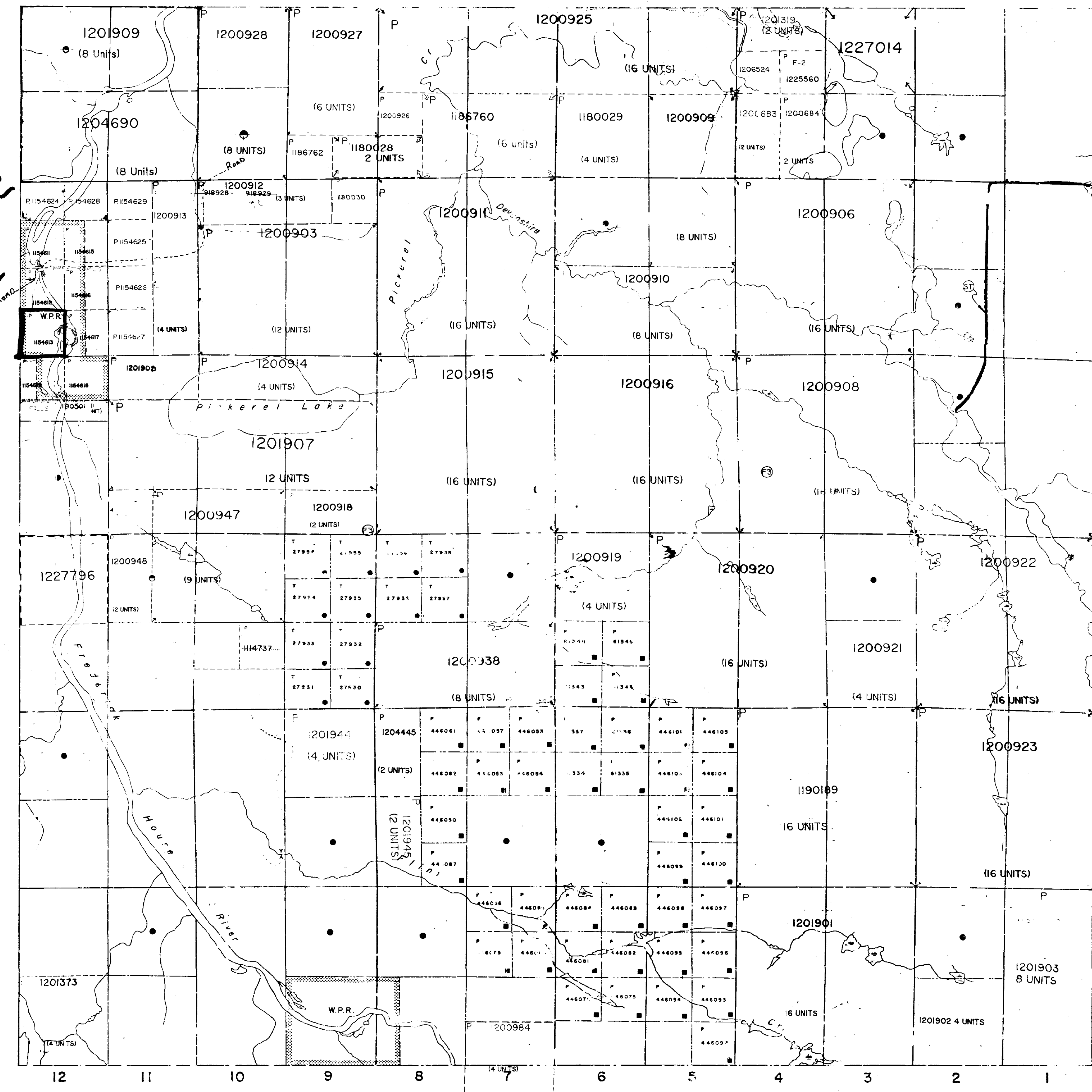

LITTLE TOWNSHIP

VI

V

IV

III

II

I

NEWMARKET TOWNSHIP

LEGEND

- HIGHWAY ROUTE No.
- TRAIL
- URV. LINES
- TOWNSHIP, BASE LINES, ETC.
- LOTTING, MINING CLAIMS, ETC.
- LOT LINES
- PARCEL BOUNDARIES
- MINING CLAIMS, ETC.
- RAILWAY RIGHT OF WAY
- UTILITY LINES
- NON-PERENNIAL STREAM
- FLOODING OR FLOODING RIGHTS
- SUBDIVISION OR COMP. SITE PLAN
- RESERVATIONS
- ORIGINAL SHORELINE
- MARSH OR MUSKEG
- MINES
- REVERSE MONUMENT

DISPOSITION OF CROWN LANDS

- TYPE OF DOCUMENT
- PATENT, SURFACE & MINING RIGHTS
 - ... SURFACE RIGHTS ONLY
 - ... MINING RIGHTS ONLY
 - LEASE, SURFACE & MINING RIGHTS
 - ... SURFACE RIGHTS ONLY
 - ... MINING RIGHTS ONLY
 - LICENCE OF OCCUPATION
 - ORDER IN COUNCIL
 - RESERVATION
 - CANCELLED
 - SALT & GRAVEL
 - LAND USE PERMIT
- NOTE: MINING RIGHTS IN PARCELS PATENTED PRIOR TO 1913, VESTED IN ORIGINAL PATENTEE BY LANDS ACT, R.S.O. 1970, CHAP. 330, SEC. 6. (U.S.)

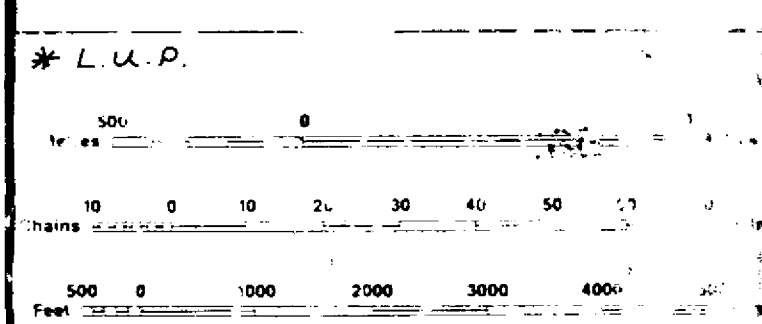

SCALE 1:20 000

SHOWMOBILE TRAIL (LAND USE PERMIT) NOTICE RECEIVED 92-DEC-09

Received Sept 22/86

TOWNSHIP

MANN

M.N.R. ADMINISTRATIVE DISTRICT

COCHRANE

MINING DIVISION

PORCUPINE

LAND TITLES / REGISTRY DIVISION

COCHRANE

Ministry of Natural Resources
Ontario

Ministry of Northern Development and Mines

SEPTEMBER 1986

G-3537

C-2231

C-2231

