



42A15NW0013 2.16034 MANN

010

Assesment Work Report,  
J. Ward & D. Ward  
Magnetic, Vertical Coil EM  
and IP, Prospecting for  
NORLISK'SK Type  
Mineralization Along the  
Footwall Contact of a 5 Mile  
Long Peridotite Intrusive.

Mann Twp., Ont.

2. 16034

John T. Ward, PE.

March 25, 1995





# Table of Contents

Location & access	P, 1
Geology & History of Property	P, 1
1993 - 4 Assessment Work	P, 3
Interpretation	P, 5
Conclusions & Recommendations	P, 6
Certification	P, 7

Fig. #1 TOTAL FIELD MAGNETIC DETAIL (LOT 9)  
CLAIM P1180028 SCALE 1/2500

Fig #2 TOTAL FIELD MAGNETIC SURVEY LOT 6, 7, 8  
CLAIMS P1186760 AND P1180029 SCALE 1/2500  
ALSO SHOWS LOCATION GRAVITY TRAVERSES 1993

Fig #3 VERTICAL COIL EM COVERAGE CLAIMS P1180025  
P1180029 AND P1186760 SCALE 1/2500  
ALSO SHOWS INDUCED POLARIZATION TRAVERSE + ANOMALY LOCATION

Fig #4 MANN TWP CLAIM GROUP LOCATION MAP

Fig # 5A, 5B, 5C, 5D, 5E INDUCED POLARIZATION PSEUDO SECTIONS

Fig # 6A, 6B GRAVITY (1993) SURVEY BOUGUER GRAVITY PROFILES  
CLAIM P 1180028.

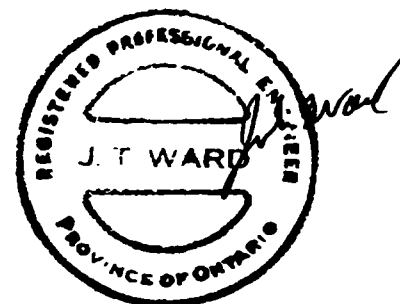

Assesment Work Report, J. Ward & D. Ward Magnetic, Vertical Coil EM and IP, Prospecting for NORLISK'SK Type Mineralization Along the Footwall Contact of a 5 Mile Long Peridotite Intrusive.

**Location and Access** Project area consists of 14 claim units staked in 1993 to cover the footwall contact of an eastwest trending peridotite intrusive, in the southern half of concession 6, lots 6 through 9, Mann Twp.. These claims were jointly recorded in the name of John Ward and David Ward and consist of: claim nos P1180028 - 30, P1186760, P1186762. The claim group can be reached by driving southward from the community of Cochrane, Ont., 25 kilometres on highway 11, thence westward 12 kilometres on gravel road along concession 5/6 line in Newmarket and Mann Twp. The NTS sheet # 42A/14, latitude 48 degrees 52 minutes north and longitude 81 degrees 2 minutes west.

**Geology and History of Property.** The property straddles the central 4 kilometres of an 8 kilometre long peridotite footwall contact. The peridotite is terminated on the west by the Frederickhouse River Timiskaming (rift related) Fault and on the east by a 400 square kilometre area of megacrystic potash granodiorite / syenitic-monzonite. The peridotite, age 2710 MY (Neoproterozoic) as indicated in MNDM map# 2577, intrudes mafic volcanics predominantly, and in some places volcanic sediments.

*The Zevely showing* (one mile to the west) which lies in lot 11 south half concession 6, Mann Twp., is a nickeliferous pyrrhotite-chalcopyrite mineralized zone, exposed for a width of 20 metres and a length of approximately 100 metres along the south contact of the same east-west trending serpentinized peridotite.

The mineralization lies entirely in pillowed andesites and within 30 metres of the peridotite contact exhibiting considerable similarity to the Alexo mine in Dundonald Twp. 30 kilometres to the southeast. The Zevely zone in 1949, following an electrical resistivity survey, was tested by 20,000 feet of diamond drilling (Timmins file T-173). Grab samples of the showing assayed between 1% and 6% copper and 2% and 5% nickel (reference Northern Miner Nov. 18, 1948).

The nickeliferous pyrrhotite, pentlandite and massive stringers along with irregular patches of chalcopyrite were encountered in andesite pillow lavas within 30 metres of the southern peridotite contact.

*Sulphurization may be responsible for mineralization.* In CIM bulletin (1966) vol.59 pp 489-497 A.J.Naldrett suggests sulphurization as being responsible for the formation of the Alexo mine. Sulphurization may therefore also be responsible for the mineralization of the Zevely showing and other nickel-copper mineralization to be found along the south contact of the

peridotite. The Alexo mine and Zevely deposit both lie close to the Frederickhouse river Timiskiming rift fault and are therefore probably classifiable as Norlisk 'sk type Cu-Ni deposits.

*Ground electromagnetic surveys not successful in detecting potential sulphide drill targets underlying the peridotites* From 1948 to 1978 ground electromagnetic and magnetic surveys were carried out in Range VI by several companies covering the east-west trending peridotite from lot 12 thru lot 7 (Noranda file T-152, INCO file T-266, Rosario Resources file T-1827, and in lot 4 by Hollinger Gold Mines Ltd.. T-1656). The ground electromagnetic surveys (VCEM, and MAX-MIN HLEM) failed to indicate anomolous electrical conductivity underlying the peridotite, however they did indicate a broad 100 metre wide zone of very weakly anomalous conductivity in the mafic volcanics immediately south of the peridotite.

*Airborne electromagnetic surveys detect potential sulphide drill targets underlying the peridotite.* Airborne INPUT electromagnetic surveying (OGS Map 81049) flown in 1987 did not show response to the Zevely showing or other sulfide mineralization lying along the south contact of the peridotite, except for 3 INPUT anomalies in lot 6 and the OPAP 1995 recommended drill site in lot 9.

An airborne VLF and magnetometer survey was carried out by Shield Platinum in 1987 covering lots 10, 11, and 12 (file T-3147). No VLF response was attributable to the sulfide mineralization lying along the south contact of the Peridotite, however, eddy current crowding could be identified within the serpentinized peridotite approximately 100 metres north of the contact.

*Diamond Drill report did not identify sulphides.* In 1965 INCO tested the south contact of the peridotite by diamond drilling in lot 9 approx. 400 metres west of the OPAP95 proposed drill hole. In the same year INCO tested the south contact of the peridotite by diamond drilling in lot 7. Logs of both holes by INCO simply indicated serpentine at the beginning of the holes and mafic volcanics at the end of the holes. As was the custom with INCO, drill logs did not indicate the presence of sulphide mineralization even when pervasive massive sulphides were present. These two holes by INCO were setup to test Bouguer gravity highs for which the only plausible explanation in the opinion of J. Ward would be the presence of heavy sulphide mineralization.

In 1965 INCO drilled 2 holes in the peridotite 100 to 300 metres north of the contact in lot 7 and encountered serpentinized peridotite and talc magnesite.

*Humus samples anomalous in nickel, copper, gold & chromium.* In 1993 as part of J.Ward's and D.Ward's OPAP supported prospecting programme humus samples were collected at 130 sites and multi-element assayed. 20 of these samples were gathered for background control purposes at accessible points throughout Newmarket, Mann, Duff, Reaume and Hanna Twp.. It was expected that the area was overlain by the Abitibi clay belt, however clear evidence in the assay results indicate the area is overlain by a fine sandy till with glacial movement south 20 degrees east.

Nickel, copper, gold and chromium assays were in general 4 times greater than background assays for humus in the Abitibi greenstone belt region, and reached assays of 10 times background in the humus geochemistry detail areas in lots 4, 7, 8 and 9 in the south half of concession 6.

*Relocated gravity highs similar to sulphide indications.* A gravity survey (assessment file T-152) was completed by INCO in 1948 covering lot 7, 8 & 9, south half of concession 6. Anomaly locations of this gravity survey were redetermined by matching magnetic features of INCO's concomitant 1948 magnetic survey (which used the same grid as the 1948 Gravity survey), and matching magnetic anomalies with the present magnetic surveying. The magnetically relocated INCO Bouguer gravity highs are shown in figure 1. as lying along the south contact of the peridotite approximately 50 metres south of the contact.

The location of these Bouguer gravity highs is similar to that of the sulphides encountered at the Zevely showing lying in mafic volcanics 30 metres south of the peridotite contact.

## **1993 - 1994 Assessment Work.**

### **Claim P1180029.**

In 1993 a grid was cut and chained on lot 6, and magnetic and vertical coil EM surveys were completed. The peridotite extending easterly was indicated by magnetic field strengths as great as 69000 gammas. Four vertical coil EM traverses indicated a moderately weak conductor lying parallel to and immediately south of the magnetically interpreted peridotite contact. The vertical coil EM conductor coincided with three weak airborne INPUT survey anomalies indicated on OGS map #81049. In the opinion of J. Ward and D. Ward that due to its indicated geological location this conductor on lot 6 is probably associated with copper-nickel mineralization.

Oct. 6th and 7th 1993, 5.0 kilometres of magnetic traverses were read for a total of 284 stations using a Geometrics model 486 total field proton precession magnetometer readable to 1 gamma. Drift corrected values are shown in figure 2 at a scale of 1/2500 and contoured as 1000 gamma intervals.

November 4th 1993 and Oct 1st 1994 2.1 kilometres of vertical coil EM traverses were read for a total of 86 dip angle readings using a 1000 Hz INCO VCEM large transmitter loop system with line spacings of 200 metres. Results are shown in figure number 3 at a scale of 1/2500 and profiled at a scale of 1 cm. = 5 degrees.

July 28th to 30th, Sept 30 and Oct 2nd to 4th, 1993, 2.0 kilometres of line cutting were cut and chained with pickets at 25 metre intervals. 4.0 kilometres of survey line were compassed, chained and ribboned at 25 metre intervals.

**Claim P1180028.**

Oct. 5th and 11th 1993, 2.4 kilometres of magnetic traverses were read for a total of 136 stations using a Geometrics model 486 total field proton precession magnetometer readable to 1 gamma. Drift corrected values are shown in figure 1 at a scale of 1/2500 and contoured as 1000 gamma intervals.

November 6th 1993 and Oct 1st 1994 0.7 kilometres of vertical coil EM traverses were read for a total of 42 dip angle readings using a 1000 Hz INCO VCEM large transmitter loop system with line spacings of 100 metres. Results are shown in figure number 3 at a scale of 1/2500 and profiled at a scale of 1 cm. = 5 degrees.

Six days of induced polarization were read Aug 11th, 14, 15, 19, 21 and 22, 1993 detailing the south contact of the peridotite on claim P1180028. The IP survey was carried out using a Hunttec 2.5 kilowatt system using a 428 millisecond delay to start of M1 integration. This along with dipole-dipole configuration, and overburden resistivities greater than 100 ohm metres, guaranteed electromagnetic coupling would be absolutely minimal. The first traverse was completed using an "a" spacing of 25 metres. Subsequently an "a" spacing of 50 metres was used upon noting that anomalous chargeabilities were 50 metres subsurface and deeper. SEE FIG 3 @ 1/2500 AND PSEUDO SECTIONS FIGS. 5A, B, C, D, E. JTW.

JTW

<sup>1.6</sup>  
1.2 kilometres of gravity were read using a Sodin model 100 T thermostated gravity metre with readings at 25 metre intervals for a total of 50 stations. Bouguer gravity was calculated using optically leveled elevations and a density of 3.0 grams per centimetre cubed (mafic volcanics). Gravity was read Dec. 12, 14th and 18th, 1993. Optical levels were read Dec 15th 1993.

JTW

(<sup>Aug 10, 12, 13-21</sup>  
Aug 17th to 18th, and 20th, 1993, 2.4 kilometres of line cutting were cut and chained with pickets at 25 metre intervals. 1.0 kilometre of survey line was compassed, chained and ribboned at 25 metre intervals.

**Claim P1180030.**

JTW

<sup>0.75</sup> ~~1.0~~ kilometres of gravity were read using a Sodin model 100 T thermostated gravity metre with readings at 50 metre intervals for a total of 20 stations. Bouguer gravity was calculated using optically leveled elevations and a density

of 3.0 grams per centimetre cubed (mafic volcanics). Gravity was read Dec. 12 and 14th, 1993. Optical levels were read Dec 15th 1993.

Aug 17th to 18th, and 20th, 1993, 1.0 kilometres of line cutting were cut and chained with pickets at 25 metre intervals.

**Claim P1186760** *MAY 28th to JUNE 8th 1994 7.7 km of LINE CUTTING + PICKETING* *JW*  
June 3rd to 8th 1994, 7.7 kilometres of magnetic traverses were read for a total of 456 stations using a Geometrics model 486 total field proton precession magnetometer readable to 1 gamma. Drift corrected values are shown in figure 2 at a scale of 1/2500 and contoured as 1000 gamma intervals.

September 28th to Oct 1st 1994 8.0 kilometres of vertical coil EM traverses were read for a total of 173 dip angle readings using a 1000 Hz INCO VCEM large transmitter loop system with line spacings of predominantly 200 metres with some spacings of 300 and 400 metres. Results are shown in figure number 3 at a scale of 1/2500 and profiled at a scale of 1 cm. = 5 degrees.

## **Interpretation.**

It is interpreted by the writer, John Ward, that the south contact of the peridotite centrally traverses the length of the property lying along the 59000 to 60000 gamma contour. The highly magnetic zone associated with the peridotite varies between 300 metres north/south to 800 metres north/south in width. Airborne INPUT anomalies indicated to lie along the south contact of the peridotite are interpreted by J. Ward to dip shallowly northward at 30 degrees from the horizontal. At 75 metres north of the number 4 post of claim P1180028 a vertical drill hole by INCO in 1951 reached 135 metres depth in peridotite without reaching the base contact. Probable thickness of the peridotite is 200 to 400 metres.

The 1993 OPAP programme using induced polarization by J. Ward and D. Ward demonstrated that the gravity high central to lot 9 and 50 metres south of the peridotite contact had a chargeability indicating the presence of minor sulphides using an "a" spacing of 25 metres. However, when an "a" spacing of 50 metres was used anomalous chargeability probably indicating the presence of heavy sulphides 100 metres further north and underlying 70 metres of peridotite was indicated. This more northerly location is coincident with the airborne INPUT anomaly indicated on OGS map 81049 (The OPAP 1995 proposed drill hole test site).

It is further noted that weak conductivity is indicated at gravity highs 50 metres south of the contact straddling the lot 7/8 lot line and also central to lot 9. A slightly stronger conductivity conductor axis also follows the south contact of the peridotite across the property and lies 100 metres south of the contact as indicated by Rosario Resources horizontal loop EM MAX-MIN survey in 1978. The present VCEM survey verifies the presence of this weakly conductive

horizon 100 metres south of the peridotite contact. The weak Rosario HLEM and weak VCEM interpreted conductive axes identified in fig.3 are for the most part exactly coincident.

The VCEM survey results on lot 6 (claim P1180029) verify the presence of weak conductivity coincident with three INPUT anomalies all 50 to 100 metres south of the peridotite contact. No gravity coverage exists for claim P1180029.

It is to be noted that the OPAP 93 Bouguer gravity values maximize 100 metres north of the INCO gravity anomalies read in 1948. This suggests to the writer that the INCO gravity anomalies are residual after the removal of local background.

## Conclusions and Recommendations

The several Inco gravity anomalies in lots 7, 8 and 9 are noted to be in similar geological setting to the Zevely deposit, namely in mafic volcanics within 50 metres of the peridotite south contact and are concluded to be due to similar mineralization, ie, sulphide mineralization containing chalcopyrite, millerite, palladium and minor platinum. In addition it is concluded that weak electrical conductivity associated with these gravity highs enhances the probability that they are sulphide mineralization related.

It is also concluded by the writer that INPUT, gravity, and Induced Polarization were the only methods which satisfactorily detected suspected sulphide mineralization underlying 70 metres of peridotite, whereas VCEM and HEM electromagnetic surveys were effective in identifying subcropping mineralization in the mafic volcanics immediately south of the peridotite.

It is recommended that the airborne INPUT anomaly location in lot 9 concession 6 Mann Twp. be tested for nickel-copper PGE sulphides by a 150 metre vertical diamond drill hole. It is also recommended to further detail the footwall contact of the peridotite with two weeks of Induced Polarization surveying in lots 6, 7, 8 and 9, in order to detect possible economic sulphides underlying the peridotite.

Cost of 150 metre diamond drill hole to test the airborne INPUT anomaly located in lot 9 is estimated to be \$10,000. Cost of 2 weeks Induced Polarization detail of the footwall contact of the peridotites estimated to be \$15,000.

Respectfully submitted,

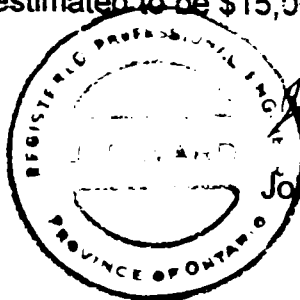

John T. Ward, PE.



## CERTIFICATION

I hereby certify that I am a registered holder of a 50% interest interest in the property covered by this Report of Work and that I personally performed this work with the assistance of David Ward, holder of the other 50% interest. I further certify that I have been engaged in Geophysical mineral exploration in Canada for most of the last 35 years as a geophysicist, geophysical survey contractor and consulting engineer.

Former employment includes the positions of senior geophysicist at Barringer Research Ltd.; geophysicist, Derry Michener and Booth, consulting geologists; geophysicist, Patino Mining Ltd.; staff-geophysicist Urangesellschaft Canada Ltd.; and from 1974 to present as a self employed consulting engineer.

I further certify that my assistant in performing this work and 50% owner of the claims, David Ward , has 19 years experience as a geophysicist employed in Canada by St. Josephs Exploration Co.; Sulpetro Canada Ltd; and Bridgewater Resources Ltd.; and then as a self employed prospector 1990 to 1995

March 25, 1995

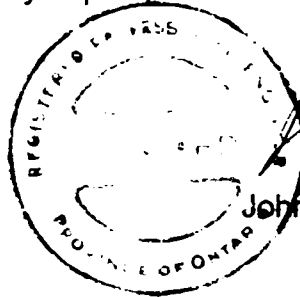

John T. Ward, PE.



Personal information collected on this form is obtained under the authority of the Mining Act. This information will be used for correspondence. Questions about this collection should be directed to the Provincial Manager, Mining Lands, Ministry of Northern Development and Mines, Fourth Floor, 159 Cedar Street, Sudbury, Ontario, P3E 6A5, telephone (705) 670-7264.

- Instructions:
- Please type or print and submit in duplicate.
  - Refer to the Mining Act and Regulations for re-Recorder.
  - A separate copy of this form must be complete
  - Technical reports and maps must accompany
  - A sketch, showing the claims the work is assigned

2019034



42A15NW0013 2.16034 MANN

900

Recorded Holder(s) DAVID A WARD 50% JOHN T. WARD 50%	Client No. 206725 / 200630
Address 9 WILLAMERE DRIVE SCARBOROUGH ONT. M1M-1W5	Telephone No. 416-261-8477
Mining Division PORCUPINE	Township/Area MANN TWP
	M or G Plan No. G 3537
Dates Work Performed From: AUGUST 10 1993 To: OCTOBER 11, 1993	

Work Performed (Check One Work Group Only)

Work Group	(6 DAYS) (2.4km) Type 2.4km HOK 0.7km
<input checked="" type="checkbox"/> Geotechnical Survey	INDUCED POLARIZATION, MAGNETOMETER, LINE CUTTING VCEM
<input type="checkbox"/> Physical Work, Including Drilling	
<input type="checkbox"/> Rehabilitation	
<input type="checkbox"/> Other Authorized Work	
<input type="checkbox"/> Assays	
<input type="checkbox"/> Assignment from Reserve	

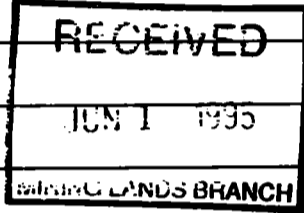

Total Assessment Work Claimed on the Attached Statement of Costs \$ 10,524

Note: The Minister may reject for assessment work credit all or part of the assessment work submitted if the recorded holder cannot verify expenditures claimed in the statement of costs within 30 days of a request for verification.

Persons and Survey Company Who Performed the Work (Give Name and Address of Author of Report)

Name	Address
JOHN T. WARD	9 WILLAMERE DRIVE SCARBOROUGH ONT M1M-1W5
DAVID A. WARD	9 WILLAMERE DRIVE SCARBOROUGH ONT M1M-1W5

(attach a schedule if necessary)

Certification of Beneficial Interest \* See Note No. 1 on reverse side

I certify that at the time the work was performed, the claims covered in this work report were recorded in the current holder's name or held under a beneficial interest by the current recorded holder.	Date MARCH 30/95	Recorded Holder or Agent (Signature) John T. Ward
--	---------------------	--

Certification of Work Report

I certify that I have a personal knowledge of the facts set forth in this Work report, having performed the work or witnessed same during and/or after its completion and annexed report is true.		
Name and Address of Person Certifying JOHN T. WARD 9 WILLAMERE DRIVE SCARBOROUGH ONT. M1M-1W5		
Telephone No. 416-261-8477	Date March 30/95	Certified By (Signature) John T. Ward

For Office Use Only

Total Value Cr. Recorded \$ 10,524	Date Recorded	Mining Recorder Gary White	RECEIVED MAR 31 1995 TRB 2:15 PORCUPINE MINING DIVISION
Deemed Approval Date JUNE 29/95	Date Approved	NOT DATED	
Date Notice for Amendments Sent			

Work Report Number for Applying Reserve	Claim Number (see Note 2)	Number of Claim Units
	1180028	2
	1186760	6
	1180029	4
<b>Total Number of Claims</b>		<b>3</b>

Value of Assessment Work Done on this Claim	Value Applied to this Claim
10,524	<del>10,524</del> 4800
	3324
<b>Total Value Work Done</b>	
10,524	10,524
<b>Total Value Work Applied</b>	

Value Assigned from this Claim	Reserve: Work to be Claimed at a Future Date
8124	
<b>Total Assigned From</b>	
8124	NIL
<b>Total Reserve</b>	

Credits you are claiming in this report may be cut back. In order to minimize the adverse effects of such deletions, please indicate from which claims you wish to prioritize the deletion of credits. Please mark (✓) one of the following:

- Credits are to be cut back starting with the claim listed last, working backwards.
- Credits are to be cut back equally over all claims contained in this report of work.
- Credits are to be cut back as prioritized on the attached appendix.

In the event that you have not specified your choice of priority, option one will be implemented.

**Note 1:** Examples of beneficial interest are unrecorded transfers, option agreements, memorandum of agreements, etc., with respect to the mining claims.

**Note 2:** If work has been performed on patented or leased land, please complete the following:

I certify that the recorded holder had a beneficial interest in the patented or leased land at the time the work was performed.	Signature	Date
---	-----------	------



Statement of Costs  
for Assessment Credit

État des coûts aux fins  
du crédit d'évaluation

Transaction No./N° de transaction

Mining Act/Loi sur les mines

Personal information collected on this form is obtained under the authority of the Mining Act. This information will be used to maintain a record and ongoing status of the mining claim(s). Questions about this collection should be directed to the Provincial Manager, Minings Lands, Ministry of Northern Development and Mines, 4th Floor, 159 Cedar Street, Sudbury, Ontario P3E 6A5, telephone (705) 670-7264.

Les renseignements personnels contenus dans la présente formule sont recueillis en vertu de la Loi sur les mines et serviront à tenir à jour un registre des concessions minières. Adresser toute question sur la collecte de ces renseignements au chef provincial des terrains miniers, ministère du Développement du Nord et des Mines, 159, rue Cedar, 4<sup>e</sup> étage, Sudbury (Ontario) P3E 6A5, téléphone (705) 670-7264.

1. Direct Costs/Coûts directs

Type	Description	Amount Montant	Totals Total global
Wages Salaires	Labour Main-d'oeuvre		
	Field Supervision Supervision sur le terrain		
Contractor's and Consultant's Fees Droits de l'entrepreneur et de l'expert- conseil	Type 6 DAYS INDUCED POLLUTION	7200	
	VERTICAL EM MAGNETIC SURVEY 2.4 KM x 1.0 KM	210 360	
	LIME CUTTING	1000	8770 JTW
			<del>8560</del>
Supplies Used Fournitures utilisées	Type		
Equipment Rental Location de matériel	Type		
Total Direct Costs Total des coûts directs			8560 8770 JTW.

2. Indirect Costs/Coûts indirects

\*\* Note: When claiming Rehabilitation work Indirect costs are not allowable as assessment work. Pour le remboursement des travaux de réhabilitation, les coûts indirects ne sont pas admissibles en tant que travaux d'évaluation.

Type	Description	Amount Montant	Totals Total global
Transportation Transport	Type 4000km AUTOMOBILE	1200	
	TRUCK 2000km	600	
Sub Total of Indirect Costs Total partiel des coûts indirects			1800
Food and Lodging Nourriture et hébergement	30 DAYS MAN	900	900
Mobilization and Demobilization Mobilisation et démobilisation			

Sub Total of Indirect Costs Total partiel des coûts indirects		2700
Amount Allowable (not greater than 20% of Direct Costs) Montant admissible (n'excédant pas 20 % des coûts directs)		1754
Total Value of Assessment Credit (Total of Direct and Allowable indirect costs)	Valeur totale du crédit d'évaluation (Total des coûts directs et indirects admissibles)	10,524

Note: The recorded holder will be required to verify expenditures claimed in this statement of costs within 30 days of a request for verification. If verification is not made, the Minister may reject for assessment work all or part of the assessment work submitted.

Note : Le titulaire enregistré sera tenu de vérifier les dépenses demandées dans le présent état des coûts dans les 30 jours suivant une demande à cet effet. Si la vérification n'est pas effectuée, le ministre peut rejeter tout ou une partie des travaux d'évaluation présentés.

Filing Discounts

1. Work filed within two years of completion is claimed at 100% of the above Total Value of Assessment Credit.
2. Work filed three, four or five years after completion is claimed at 50% of the above Total Value of Assessment Credit. See calculations below:

Total Value of Assessment Credit	Total Assessment Claimed
	x 0.50 =

Remises pour dépôt

1. Les travaux déposés dans les deux ans suivant leur achèvement sont remboursés à 100 % de la valeur totale susmentionnée du crédit d'évaluation.
2. Les travaux déposés trois, quatre ou cinq ans après leur achèvement sont remboursés à 50 % de la valeur totale du crédit d'évaluation susmentionné. Voir les calculs ci-dessous.

Valeur totale du crédit d'évaluation	Evaluation totale demandée
	x

Certification Verifying Statement of Costs

I hereby certify:  
that the amounts shown are as accurate as possible and these costs were incurred while conducting assessment work on the lands shown on the accompanying Report of Work form.

that as RECORDED HOLDER 50% I am authorized  
(Recorded Holder, Agent, Position in Company)

to make this certification

Attestation de l'état des coûts

J'atteste par la présente :  
que les montants indiqués sont le plus exact possible et que ces dépenses ont été engagées pour effectuer les travaux d'évaluation sur les terrains indiqués dans la formule de rapport de travail ci-joint.

Et qu'à titre de \_\_\_\_\_ je suis autorisé  
(titulaire enregistré, représentant, poste occupé dans la compagnie)

à faire cette attestation.

Signature Jh Twad Date MARCH 30/95

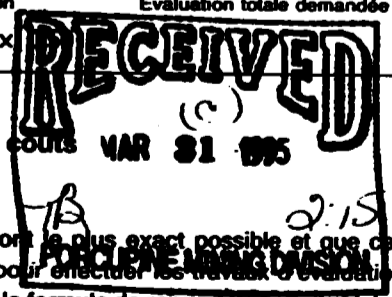



# Report of Work Conducted After Recording Claim

## Mining Act

Transaction Number  
W9560.00169

Personal information collected on this form is obtained under the authority of the Mining Act. This information will be used for correspondence. Questions about this collection should be directed to the Provincial Manager, Mining Lands, Ministry of Northern Development and Mines, Fourth Floor, 159 Cedar Street, Sudbury, Ontario, P3E 6A5, telephone (705) 670-7284.

- Instructions:**
- Please type or print and submit in duplicate.
  - Refer to the Mining Act and Regulations for requirements of filing assessment work or consult the Mining Recorder.
  - A separate copy of this form must be completed for each Work Group.
  - Technical reports and maps must accompany this form in duplicate.
  - A sketch, showing the claims the work is assigned to, must accompany this form.

Recorded Holder(s) DAVID A. WARD 50% JOHN T. WARD 50%	Client No. 206725 / 206650
Address 9 WILLAMERE DRIVE SCARBORO ONT M1M-1W5	Telephone No. 416 261-8477
Mining Division PORCUPINE	Township/Area MANN TWP
	M or G Plan No. G 3537
Date Work Performed From: MAY 28 1994, To: OCT 1st 1994	

**Work Performed (Check One Work Group Only)**

Work Group	Type
Geotechnical Survey	Z.T.R. S.O.M. T.P.M. MAGNETOMETER, VERTICAL COIL EM, LINECUTTING.
Physical Work, Including Drilling	
Rehabilitation	
Other Authorized Work	
Assays	
Assignment from Reserve	

**RECEIVED**  
 JUN 1 1995  
 MINING LANDS BRANCH

Total Assessment Work Claimed on the Attached Statement of Costs \$ 7440

**Note:** The Minister may reject for assessment work credit all or part of the assessment work submitted if the recorded holder cannot verify expenditures claimed in the statement of costs within 30 days of a request for verification.

**Persons and Survey Company Who Performed the Work (Give Name and Address of Author of Report)**

Name	Address
JOHN T. WARD	9 WILLAMERE DRIVE SCARBOROUGH ONT M1M-1W5
DAVID A. WARD	9 WILLAMERE DRIVE SCARBOROUGH ONT M1M-1W5

(attach a schedule if necessary)

**Certification of Beneficial Interest \* See Note No. 1 on reverse side**

I certify that at the time the work was performed, the claims covered in this work report were recorded in the current holder's name or held under a beneficial interest by the current recorded holder.	Date MARCH 30/95	Recorded Holder or Agent (Signature) John T. Ward
--	---------------------	--

**Certification of Work Report**

I certify that I have a personal knowledge of the facts set forth in this Work report, having performed the work or witnessed same during and/or after its completion and annexed report is true.		
Name and Address of Person Certifying JOHN T. WARD 9 WILLAMERE DRIVE SCARBOROUGH ONT M1M-1W5		
Telephone No. 416 261 8477	Date MARCH 30/95	Certified By (Signature) John T. Ward

**For Office Use Only**

Total Value Cr. Recorded 2,440.	Date Recorded	Mining Recorder Jay White	<p style="border: 2px solid black; padding: 5px; text-align: center;"> <b>RECEIVED</b>            (c)            MAR 31 1995            TB            PORCUPINE MINING DIVISION         </p>
	Deemed Approval Date JUNE 29/95	Date Approved	
	Date Notice for Amendments Sent		

Work Report Number for Applying Reserve	Claim Number (see Note 2)	Number of Claim Units
	1186760	6
	1180028	2
	1180030	1
	1186762	1
	1180029	4
Total Number of Claims	5	

Value of Assessment Work Done on the Claim	Value Applied to this Claim
7440	4800
	800
	400
	400
	400
Total Value Work Done	7440
Total Value Work Applied	6800

Value Assigned from this Claim	Reserve: Work to be Claimed at a Future Date
2000	640
Total Assigned From	2000
Total Reserve	640

Credits you are claiming in this report may be cut back. In order to minimize the adverse effects of such deletions, please indicate from which claims you wish to prioritize the deletion of credits. Please mark (✓) one of the following:

1.  Credits are to be cut back starting with the claim listed last, working backwards.
2.  Credits are to be cut back equally over all claims contained in this report of work.
3.  Credits are to be cut back as prioritized on the attached appendix.

In the event that you have not specified your choice of priority, option one will be implemented.

**Note 1:** Examples of beneficial interest are unrecorded transfers, option agreements, memorandum of agreements, etc., with respect to the mining claims.

**Note 2:** If work has been performed on patented or leased land, please complete the following:

I certify that the recorded holder had a beneficial interest in the patented or leased land at the time the work was performed.	Signature	Date
---	-----------	------



Statement of Costs  
for Assessment Credit

État des coûts aux fins  
du crédit d'évaluation

Mining Act/Loi sur les mines

Transaction No./N° de transaction  
W9560.00169

Personal information collected on this form is obtained under the authority of the Mining Act. This information will be used to maintain a record and ongoing status of the mining claim(s). Questions about this collection should be directed to the Provincial Manager, Minings Lands, Ministry of Northern Development and Mines, 4th Floor, 159 Cedar Street, Sudbury, Ontario P3E 6A5, telephone (705) 670-7264.

Les renseignements personnels contenus dans la présente formule sont recueillis en vertu de la Loi sur les mines et serviront à tenir à jour un registre des concessions minières. Adresser toute question sur la collecte de ces renseignements au chef provincial des terrains miniers, ministère du Développement du Nord et des Mines, 159, rue Cedar, 4<sup>e</sup> étage, Sudbury (Ontario) P3E 6A5, téléphone (705) 670-7264.

1. Direct Costs/Coûts directs

Type	Description	Amount Montant	Totals Total global
Wages Salaires	Labour Main-d'oeuvre		
	Field Supervision Supervision sur le terrain		
Contractor's and Consultant's Fees Droits de l'entrepreneur et de l'expert- conseil	Type 7.7km MAGNETIC SURVEY	1000	
	8.0km VLEM SURVEY	2400	
	7.7km LINE CUTTING	2800	6200
Supplies Used Fournitures utilisées	Type		
Equipment Rental Location de matériel	Type		
<b>Total Direct Costs Total des coûts directs</b>			<b>6200</b>

2. Indirect Costs/Coûts indirects

\*\* Note: When claiming Rehabilitation work Indirect costs are not allowable as assessment work.  
Pour le remboursement des travaux de réhabilitation, les coûts indirects ne sont pas admissibles en tant que travaux d'évaluation.

Type	Description	Amount Montant	Totals Total global
Transportation Transport	Type 2000km AUTOMOBILE	600	
			600
Food and Lodging Nourriture et hébergement	40 MAN DAYS	1200	1200
Mobilization and Demobilization Mobilisation et démobilisation			
<b>Sub Total of Indirect Costs Total partiel des coûts indirects</b>			<b>1800</b>
<b>Amount Allowable (not greater than 20% of Direct Costs) Montant admissible (n'excédant pas 20 % des coûts directs)</b>			<b>1240</b>
<b>Total Value of Assessment Credit (Total of Direct and Allowable Indirect costs)</b>			<b>7440</b>
<b>Valueur totale du crédit d'évaluation (Total des coûts directs et indirects admissibles)</b>			

Note: The recorded holder will be required to verify expenditures claimed in this statement of costs within 30 days of a request for verification. If verification is not made, the Minister may reject for assessment work all or part of the assessment work submitted.

Note : Le titulaire enregistré sera tenu de vérifier les dépenses demandées dans le présent état des coûts dans les 30 jours suivant une demande à cet effet. Si la vérification n'est pas effectuée, le ministre peut rejeter tout ou une partie des travaux d'évaluation présentés.

Filing Discounts

1. Work filed within two years of completion is claimed at 100% of the above Total Value of Assessment Credit.
2. Work filed three, four or five years after completion is claimed at 50% of the above Total Value of Assessment Credit. See calculations below:

Total Value of Assessment Credit	Total Assessment Claimed
	x 0.50 =

Remises pour dépôt

1. Les travaux déposés dans les deux ans suivant leur achèvement sont remboursés à 100 % de la valeur totale susmentionnée du crédit d'évaluation.
2. Les travaux déposés trois, quatre ou cinq ans après leur achèvement sont remboursés à 50 % de la valeur totale du crédit d'évaluation susmentionné. Voir les calculs ci-dessous.

Valeur totale du crédit d'évaluation	x
--------------------------------------	---

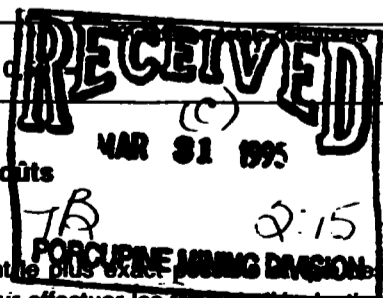

Certification Verifying Statement of Costs

I hereby certify:  
that the amounts shown are as accurate as possible and these costs were incurred while conducting assessment work on the lands shown on the accompanying Report of Work form.

that as RECORDED HOLDER 50% I am authorized  
(Recorded Holder, Agent, Position in Company)

to make this certification

Attestation de l'état des coûts

J'atteste par la présente :  
que les montants indiqués sont le plus exact possible et que les dépenses ont été engagées pour effectuer les travaux d'évaluation sur les terrains indiqués dans la formule de rapport de travail ci-joint.

Et qu'à titre de \_\_\_\_\_ je suis autorisé  
(titulaire enregistré, représentant, poste occupé dans la compagnie)

à faire cette attestation.

Signature John T. Ward Date MARCH 30/95



Ministry of  
Northern Development  
and Mines  
Ontario

# Report of Work Conducted After Recording Claim

Mining Act

Transaction Number  
**W9560.00170**

Personal information collected on this form is obtained under the authority of the Mining Act. This information will be used for correspondence. Questions about this collection should be directed to the Provincial Manager, Mining Lands, Ministry of Northern Development and Mines, Fourth Floor, 159 Cedar Street, Sudbury, Ontario, P3E 6A5, telephone (705) 670-7264.

- Instructions:**
- Please type or print and submit in duplicate.
  - Refer to the Mining Act and Regulations for requirements of filing assessment work or consult the Mining Recorder.
  - A separate copy of this form must be completed for each Work Group.
  - Technical reports and maps must accompany this form in duplicate.
  - A sketch, showing the claims the work is assigned to, must accompany this form.

Recorded Holder(s) <b>DAVID A. WARD 50% 50% JOHN T. WARD 9 WILLAMERE DRIVE SCARBOROUGH ONT</b>	<b>MIM-1WS</b>	Client No. <b>206 725 / 2-0650</b>
Address <b>9 WILLAMERE DRIVE SCARBOROUGH ONT</b>		Telephone No. <b>416-261-8477</b>
Mining Division <b>PORCUPINE</b>	Township/Area <b>MANN TWP.</b>	M or G Plan No. <b>G 3537</b>
Date Work Performed From: <b>DEC 12 / 93</b>		To: <b>DEC 18 / 93</b>

**Work Performed (Check One Work Group Only)**

Work Group	Type
<input checked="" type="checkbox"/> Geotechnical Survey	<del>2.35km</del> <b>GRAVITY SURVEY WITH OPTICAL LEVELLING</b>
<input type="checkbox"/> Physical Work, Including Drilling	
<input type="checkbox"/> Rehabilitation	
<input type="checkbox"/> Other Authorized Work	
<input type="checkbox"/> Assays	
<input type="checkbox"/> Assignment from Reserve	

**RECEIVED**  
 JUN 1 1995  
 MINING LANDS BRANCH

Total Assessment Work Claimed on the Attached Statement of Costs \$ 2820 3350 2820.

**Note:** The Minister may reject for assessment work credit all or part of the assessment work submitted if the recorded holder cannot verify expenditures claimed in the statement of costs within 30 days of a request for verification.

**Persons and Survey Company Who Performed the Work (Give Name and Address of Author of Report)**

Name	Address
<b>JOHN T. WARD</b>	<b>9 WILLAMERE DRIVE SCARBOROUGH ONT. MIM-1WS</b>
<b>DAVID A. WARD</b>	<b>9 WILLAMERE DRIVE SCARBOROUGH ONT MIM-1WS</b>

(attach a schedule if necessary)

**Certification of Beneficial Interest \* See Note No. 1 on reverse side**

I certify that at the time the work was performed, the claims covered in this work report were recorded in the current holder's name or held under a beneficial interest by the current recorded holder.	Date <b>MARCH 30/95</b>	Recorded Holder or Agent (Signature) <i>John T. Ward</i>
--	----------------------------	---

**Certification of Work Report**

I certify that I have a personal knowledge of the facts set forth in this Work report, having performed the work or witnessed same during and/or after its completion and annexed report is true.		
Name and Address of Person Certifying <b>JOHN T. WARD 9 WILLAMERE DRIVE SCARBOROUGH ONT. MIM-1WS</b>		
Telephone No. <b>416-261-8477</b>	Date <b>MARCH 30/95</b>	Certified By (Signature) <i>John T. Ward</i>

**For Office Use Only**

<b>2820.</b>	Total Value Cr. Recorded	Date Recorded	Mining Recorder <i>Gary White</i>	<b>RECEIVED</b> (e) <b>MAR 31 1995</b> TA PORCUPINE MINING DIVISION
	Deemed Approval Date	Date Approved		
	Date Notice for Amendments Sent			



AMENDED

Work Report Number for Applying Reserve	Claim Number (see Note 2)	Number of Claim Units
	1180036	1
	1186762	1
	1190028	2
<b>Total Number of Claims</b>		<b>3</b>

Value of Assessment Work Done on the Claim	Value Applied to this Claim
900 \$/w	900 \$/w
800 \$/w	800 \$/w
1920 \$/w	800 \$/w
<b>Total Value Work Done</b>	
2820 \$/w	2500 \$/w

Value Assigned from this Claim	Reserve: Work to be Claimed at a Future Date
800 \$/w	320 \$/w
<b>Total Assigned from</b>	
800 \$/w	320 \$/w
<b>Total Reserve</b>	

Credits you are claiming in this report may be cut back. In order to minimize the adverse effects of such deletions, please indicate from which claims you wish to prioritize the deletion of credits. Please mark (✓) one of the following:

- Credits are to be cut back starting with the claim listed last, working backwards.
- Credits are to be cut back equally over all claims contained in this report of work.
- Credits are to be cut back as prioritized on the attached appendix.

In the event that you have not specified your choice of priority, option one will be implemented.

**Note 1:** Examples of beneficial interest are unrecorded transfers, option agreements, memorandum of agreements, etc., with respect to the mining claims.

**Note 2:** If work has been performed on patented or leased land, please complete the following:

I certify that the recorded holder had a beneficial interest in the patented or leased land at the time the work was performed.	Signature	Date
---	-----------	------



Personal information collected on this form is obtained under the authority of the Mining Act. This information will be used to maintain a record and ongoing status of the mining claim(s). Questions about this collection should be directed to the Provincial Manager, Minings Lands, Ministry of Northern Development and Mines, 4th Floor, 159 Cedar Street, Sudbury, Ontario P3E 6A5, telephone (705) 670-7264.

Les renseignements personnels contenus dans la présente formule sont recueillis en vertu de la Loi sur les mines et serviront à tenir à jour un registre des concessions minières. Adresser toute question sur la collecte de ces renseignements au chef provincial des terrains miniers, ministère du Développement du Nord et des Mines, 159, rue Cedar, 4<sup>e</sup> étage, Sudbury (Ontario) P3E 6A5, téléphone (705) 670-7264.

1. Direct Costs/Coûts directs

Type	Description	Amount Montant	Totals Total global
Wages Salaires	Labour Main-d'oeuvre		
	Field Supervision Supervision sur le terrain		
Contractor's and Consultant's Fees Droits de l'entrepreneur et de l'expert- conseil	Type 2.35M GRAND SURVEY	2350	
			2350
Supplies Used Fournitures utilisées	Type		
Equipment Rental Location de matériel	Type		
<b>Total Direct Costs Total des coûts directs</b>			<b>2350</b>

2. Indirect Costs/Coûts indirects

\*\* Note: When claiming Rehabilitation work Indirect costs are not allowable as assessment work.  
Pour le remboursement des travaux de réhabilitation, les coûts indirects ne sont pas admissibles en tant que travaux d'évaluation.

Type	Description	Amount Montant	Totals Total global
Transportation Transport	Type <del>TRUCK</del> TRUCK 1000km	300	
			300
Food and Lodging Nourriture et hébergement	10 MAN DAYS	300	300
Mobilization and Demobilization Mobilisation et démobilisation			
<b>Sub Total of Indirect Costs Total partiel des coûts indirects</b>			<b>600</b>
<b>Amount Allowable (not greater than 20% of Direct Costs) Montant admissible (n'excédant pas 20 % des coûts directs)</b>			<b>470</b>
<b>Total Value of Assessment Credit (Total of Direct and Allowable indirect costs)</b>			<b>2820</b>

Note: The recorded holder will be required to verify expenditures claimed in this statement of costs within 30 days of a request for verification. If verification is not made, the Minister may reject for assessment work all or part of the assessment work submitted.

Note: Le titulaire enregistré sera tenu de vérifier les dépenses demandées dans le présent état des coûts dans les 30 jours suivant une demande à cet effet. Si la vérification n'est pas effectuée, le ministre peut rejeter tout ou une partie des travaux d'évaluation présentés.

Filing Discounts

1. Work filed within two years of completion is claimed at 100% of the above Total Value of Assessment Credit.
2. Work filed three, four or five years after completion is claimed at 50% of the above Total Value of Assessment Credit. See calculations below:

Total Value of Assessment Credit	Total Assessment Claimed
	x 0.50 =

Remises pour dépôt

1. Les travaux déposés dans les deux ans suivant leur achèvement sont remboursés à 100 % de la valeur totale susmentionnée du crédit d'évaluation.
2. Les travaux déposés trois, quatre ou cinq ans après leur achèvement sont remboursés à 50 % de la valeur totale du crédit d'évaluation susmentionné. Voir les calculs ci-dessous.

Valeur totale du crédit d'évaluation	Évaluation totale demandée
	x

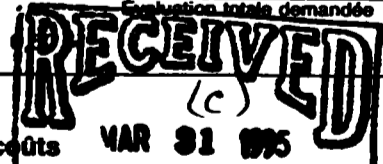

Certification Verifying Statement of Costs

I hereby certify: that the amounts shown are as accurate as possible and these costs were incurred while conducting assessment work on the lands shown on the accompanying Report of Work form.

that as RECORDED HOLDER 50% I am authorized (Recorded Holder, Agent, Position in Company)

to make this certification

Attestation de l'état des coûts  
J'atteste par la présente : que les montants indiqués sont le plus exact possible et que ces dépenses ont été engagées pour effectuer les travaux d'évaluation sur les terrains indiqués dans la formule de rapport de travail ci-joint.

Et qu'à titre de \_\_\_\_\_ je suis autorisé (titulaire enregistré, représentant, poste occupé dans la compagnie)

à faire cette attestation.

Signature: John T. Ward Date: MARCH 30/95



# Report of Work Conducted After Recording Claim

## Mining Act

Transaction Number  
W9560.00171

Personal information collected on this form is obtained under the authority of the Mining Act. This information will be used for correspondence. Questions about this collection should be directed to the Provincial Manager, Mining Lands, Ministry of Northern Development and Mines, Fourth Floor, 159 Cedar Street, Sudbury, Ontario, P3E 6A5, telephone (705) 670-7284.

- Instructions:
- Please type or print and submit in duplicate.
  - Refer to the Mining Act and Regulations for requirements of filing assessment work or consult the Mining Recorder.
  - A separate copy of this form must be completed for each Work Group.
  - Technical reports and maps must accompany this form in duplicate.
  - A sketch, showing the claims the work is assigned to, must accompany this form.

Recorded Holder(s) DAVID A WARD 50% JOHN T. WARD 50%	Client No. 206725 / 206680
Address 9 WILLAMERE DRIVE SCARBOROUGH ONT M1M-1W5	Telephone No. 416-261-8477
Mining Division PORCUPINE	Township/Area MANN TWP.
M or G Plan No. G 3537	
Dates Work Performed From: JULY 28 1993 To: <del>SEP</del> OCT 1 1994	

Work Performed (Check One Work Group Only)

Work Group	Type
Geotechnical Survey	(5.0 km) (2.1 km) 2.0 km + 4.0 km MAGNETOMETER SURVEY, VCEM SURVEY, LINE CUTTING
Physical Work, Including Drilling	
Rehabilitation	
Other Authorized Work	
Assays	
Assignment from Reserve	

RECEIVED  
JUN 1 1995  
MINING LANDS BRANCH

Total Assessment Work Claimed on the Attached Statement of Costs \$ 3036

Note: The Minister may reject for assessment work credit all or part of the assessment work submitted if the recorded holder cannot verify expenditures claimed in the statement of costs within 30 days of a request for verification.

Persons and Survey Company Who Performed the Work (Give Name and Address of Author of Report)

Name	Address
JOHN T. WARD	9 WILLAMERE DRIVE SCARBOROUGH ONT. M1M-1W5
DAVID A. WARD	9 WILLAMERE DRIVE SCARBOROUGH ONT M1M-1W5

(attach a schedule if necessary)

Certification of Beneficial Interest \* See Note No. 1 on reverse side

I certify that at the time the work was performed, the claims covered in this work report were recorded in the current holder's name or held under a beneficial interest by the current recorded holder.	Date MARCH 30/95	Recorded Holder or Agent (Signature) John T. Ward
--	---------------------	--

Certification of Work Report

I certify that I have a personal knowledge of the facts set forth in this Work report, having performed the work or witnessed same during and/or after its completion and annexed report is true.		
Name and Address of Person Certifying JOHN T. WARD		
Telephone No. 416-261-8477	Date MARCH 30/95	Certified By (Signature) John T. Ward

For Office Use Only

Total Value Cr. Recorded 3,036	Date Recorded	Mining Recorder S. White NOT DATED	Received RECEIVED (c) MAR 31 1995 TB 2:15 PORCUPINE MINING DIVISION
	Deemed Approval Date JUNE 29/95	Date Approved	
	Date Notice for Amendments Sent		

Work Report Number for Applying Reserve	Claim Number (see Note 2)	Number of Claim Units
	1180029	4
Total Number of Claims		1

Value of Assessment Work Done on this Claim	Value Applied to this Claim
3036	3036
Total Value Work Done	
3036	3036
Total Value Work Applied	

Value Assigned from this Claim	Reserve: Work to be Claimed at a Future Date
Total Assigned From	
	NIL
Total Reserve	

Credits you are claiming in this report may be cut back. In order to minimize the adverse effects of such deletions, please indicate from which claims you wish to prioritize the deletion of credits. Please mark (✓) one of the following:

- Credits are to be cut back starting with the claim listed last, working backwards.
- Credits are to be cut back equally over all claims contained in this report of work.
- Credits are to be cut back as prioritized on the attached appendix.

In the event that you have not specified your choice of priority, option one will be implemented.

Note 1: Examples of beneficial interest are unrecorded transfers, option agreements, memorandum of agreements, etc., with respect to the mining claims.

Note 2: If work has been performed on patented or leased land, please complete the following:

I certify that the recorded holder had a beneficial interest in the patented or leased land at the time the work was performed.	Signature	Date
---	-----------	------

Statement of Costs for Assessment Credit

État des coûts aux fins du crédit d'évaluation

Mining Act/Loi sur les mines

Transaction No./N° de transaction

W9560.00171

Personal information collected on this form is obtained under the authority of the Mining Act. This information will be used to maintain a record and ongoing status of the mining claim(s). Questions about this collection should be directed to the Provincial Manager, Minings Lands, Ministry of Northern Development and Mines, 4th Floor, 150 Cedar Street, Sudbury, Ontario P3E 6A5, telephone (705) 670-7264.

Les renseignements personnels contenus dans la présente formule sont recueillis en vertu de la Loi sur les mines et serviront à tenir à jour un registre des concessions minières. Adresser toute question sur la collecte de ces renseignements au chef provincial des terrains miniers, ministère du Développement du Nord et des Mines, 150, rue Cedar, 4<sup>e</sup> étage, Sudbury (Ontario) P3E 6A5, téléphone (705) 670-7264.

1. Direct Costs/Coûts directs

Type	Description	Amount Montant	Totals Total global
Wages Salaires	Labour Main-d'œuvre		
	Field Supervision Supervision sur le terrain		
Contractor's and Consultant's Fees Droits de l'entrepreneur et de l'expert-conseil	Type (5.0 Km) MAGNETIC SURVEY	750	
	2.1 Km SURVEY	630	
	VARIABLE COIL EM		
	2.0 Km, 4.0 Km LINE CUTTING	1150	2530
Supplies Used Fournitures utilisées	Type		
Equipment Rental Location de matériel	Type		
Total Direct Costs Total des coûts directs			2530

2. Indirect Costs/Coûts indirects

\*\* Note: When claiming Rehabilitation work Indirect costs are not allowable as assessment work. Pour le remboursement des travaux de réhabilitation, les coûts indirects ne sont pas admissibles en tant que travaux d'évaluation.

Type	Description	Amount Montant	Totals Total global
Transportation Transport	Type 500 Km AUTOMOBILE	150	
			150
Food and Lodging Nourriture et hébergement	20 MAN DAYS	600	600
Mobilization and Demobilization Mobilisation et démoblisation			
Sub Total of Indirect Costs Total partiel des coûts indirects			750
Amount Allowable (not greater than 20% of Direct Costs) Montant admissible (n'excédant pas 20 % des coûts directs)			506
Total Value of Assessment Credit (Total of Direct and Allowable Indirect costs) Valeur totale du crédit d'évaluation (Total des coûts directs et indirects admissibles)			3036

Note: The recorded holder will be required to verify expenditures claimed in this statement of costs within 30 days of a request for verification. If verification is not made, the Minister may reject for assessment work all or part of the assessment work submitted.

Note: Le titulaire enregistré sera tenu de vérifier les dépenses demandées dans le présent état des coûts dans les 30 jours suivant une demande à cet effet. Si la vérification n'est pas effectuée, le ministre peut rejeter tout ou une partie des travaux d'évaluation présentés.

Filing Discounts

- Work filed within two years of completion is claimed at 100% of the above Total Value of Assessment Credit.
- Work filed three, four or five years after completion is claimed at 50% of the above Total Value of Assessment Credit. See calculations below:

Total Value of Assessment Credit	Total Assessment Claimed
	x 0.50 =

Remises pour dépôt

- Les travaux déposés dans les deux ans suivant leur achèvement sont remboursés à 100 % de la valeur totale susmentionnée du crédit d'évaluation.
- Les travaux déposés trois, quatre ou cinq ans après leur achèvement sont remboursés à 50 % de la valeur totale du crédit d'évaluation susmentionné. Voir les calculs ci-dessous.

Valeur totale du crédit d'évaluation

x 0.50

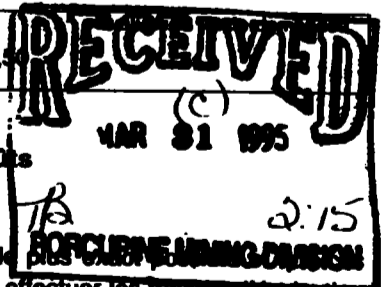

Certification Verifying Statement of Costs

I hereby certify: that the amounts shown are as accurate as possible and these costs were incurred while conducting assessment work on the lands shown on the accompanying Report of Work form.

that as RECORDED HOLDER 50% I am authorized (Recorded Holder, Agent, Position in Company)

to make this certification

Attestation de l'état des coûts

J'atteste par la présente: que les montants indiqués sont le plus exact possible et que les dépenses ont été engagées pour effectuer les travaux d'évaluation sur les terrains indiqués dans la formule de rapport de travail ci-joint.

Et qu'à titre de \_\_\_\_\_ je suis autorisé (titulaire enregistré, représentant, poste occupé dans la compagnie)

à faire cette attestation.

Signature: John T. Ward Date: MARCH 30/95

Nota: Dans cette formule, lorsqu'il désigne des personnes, le masculin est utilisé au sens neutre.

Ministry of  
Northern Development  
and Mines

Ministère du  
Développement du Nord  
et des Mines

Geoscience Approvals Office  
933 Ramsey Lake Road  
6th Floor  
Sudbury, Ontario  
P3E 6B5

Telephone: (705) 670-5853  
Fax: (705) 670-5863

Our File: 2.16034  
Transaction #W9560.000168  
#W9560.000169  
#W9560.000170  
#W9560.000171

June 26, 1995

Mining Recorder  
Ministry of Northern  
Development and Mines  
60 Wilson Avenue, 1st Floor  
Timmins, Ontario  
P4N 2S7

Dear Mr. White:

**SUBJECT: APPROVAL OF ASSESSMENT WORK CREDITS ON MINING CLAIMS  
1180028 ET AL. IN MANN TOWNSHIP**

Assessment work credits have been approved as outlined on the original report of work forms for this submission. The credits have been approved under Section 14, Geophysics(MAG,EM,IP,GRAV), Mining Act Regulations.

The approval date is June 12, 1995. Please indicate this approval on the claim record sheets.

If you have any questions regarding this correspondence, please contact Bruce Gates at (705) 670-5856.

ORIGINAL SIGNED BY:

Yours sincerely,

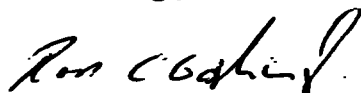

Ron C. Gashinski  
Senior Manager, Mining Lands Section  
Mining and Land Management Branch  
Mines and Minerals Division

BIG/jn

cc: Resident Geologist  
Timmins, Ontario

Assessment Files Library  
Sudbury, Ontario

G-3537

**AREAS WITHDRAWN FROM DISPOSITION**

M.R.O. - MINING RIGHTS ONLY  
 S.R.O. - SURFACE RIGHTS ONLY  
 M.R.S. - MINING AND SURFACE RIGHTS

Description Order No. Date Disposition File

WATER POWER RESERVE

NOTE: P1125837 PLOTTED IN ERROR S/B P1114737

FANNA TOWNSHIP **2.16034**  
 (MAG. REM. GRAY, IP)

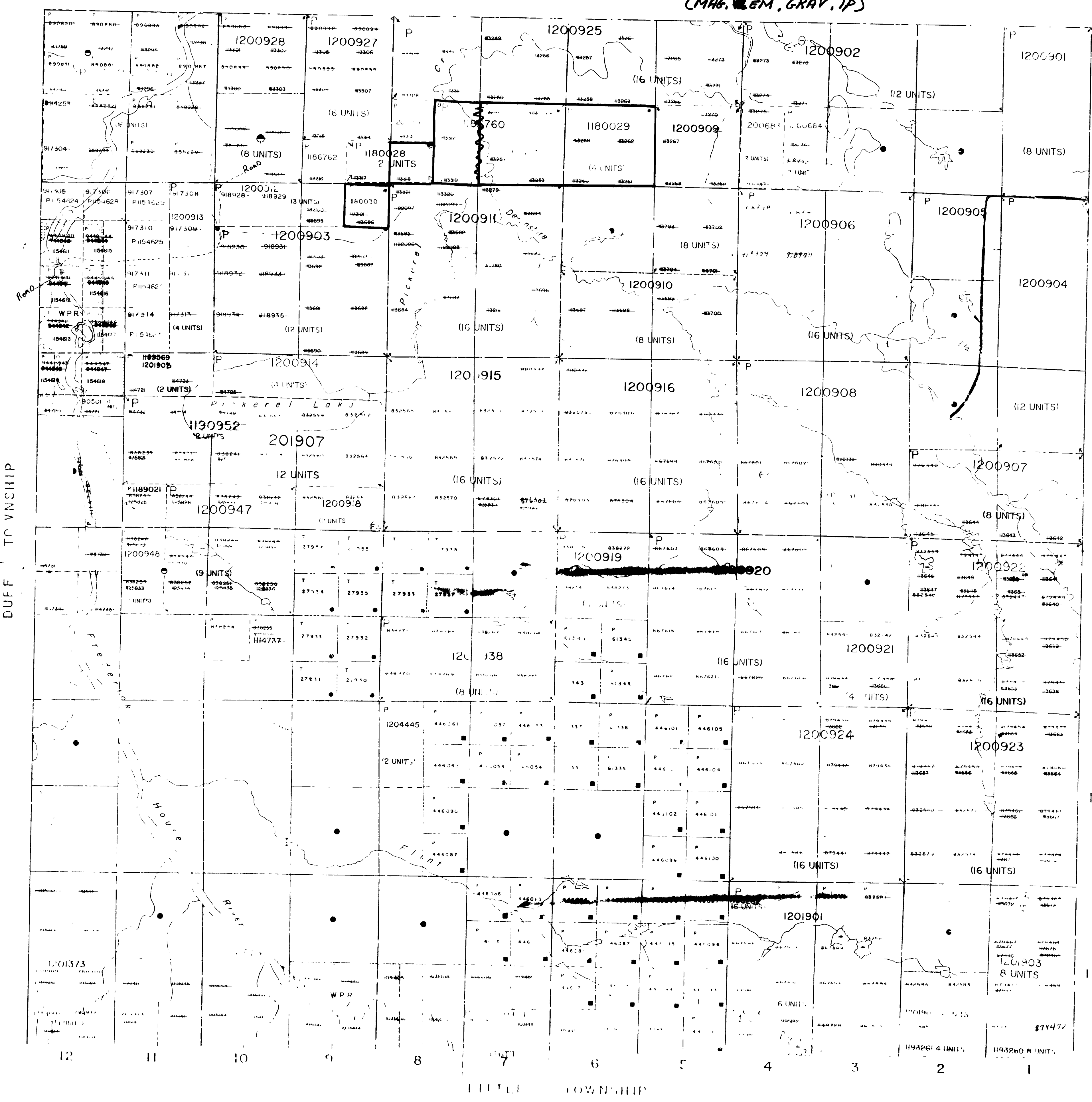

**LEGEND**

HIGHWAY NOT TO SCALE  
 TRAILS  
 SURVEY LINES  
 TOWNSHIP, RANGE, SECTION, ETC.  
 LOTS, MINING CLAIMS, ETC.  
 UNRESERVED LAND  
 P  
 PARCELS BOUND BY MINING CLAIMS  
 RAILWAY RIGHT OF WAY  
 UTILITY LINES  
 NON-FUEL OIL STREAM  
 FLOODING ZONE CLAIMS  
 WADSWORTH CLAIMS  
 ORIGINAL SHORELINE  
 FURNACE MARKERS  
 LINES  
 RAVERLEY POINT

**DISPOSITION OF CRIMINAL LAND**

TYPE OF DOCUMENT

PATENT SURFACE & MINING RIGHTS  
 SURFACE RIGHTS ONLY  
 MINING RIGHTS ONLY  
 SURFACE RIGHTS ONLY  
 MINING RIGHTS ONLY  
 LITIGATION  
 PRESERVATION  
 CANCELLATION  
 S.A.P. & G.P. RE...

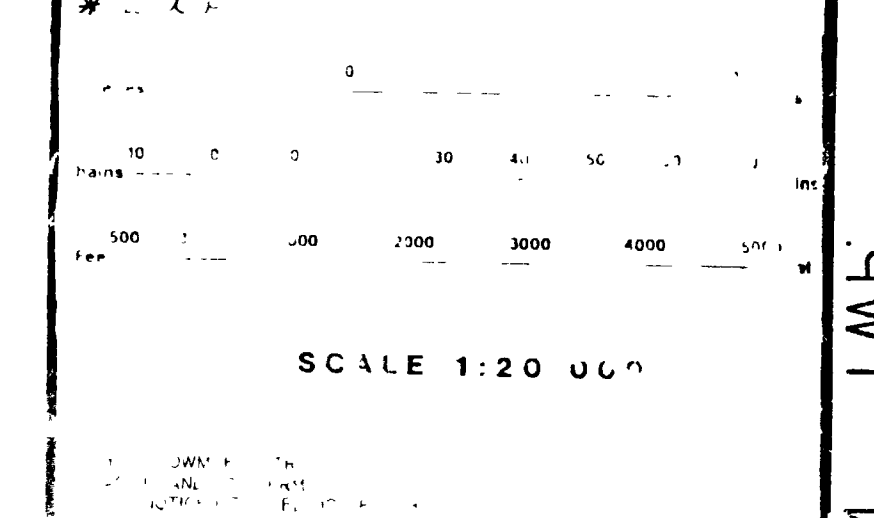

**2.16034**

**MAIN**

MINING DISTRICT  
 COCHISE  
 PINE  
 COCHISE

Ministry of Northern Development

G-3537



2.16034  
**OPAP 1993 TOTAL FIELD MAGNETIC SURVEY  
 WITH DETAIL HUMUS GEOCHEMISTRY  
 LOT 9 AND 8 MANN TWP.**

**FIG. #1**

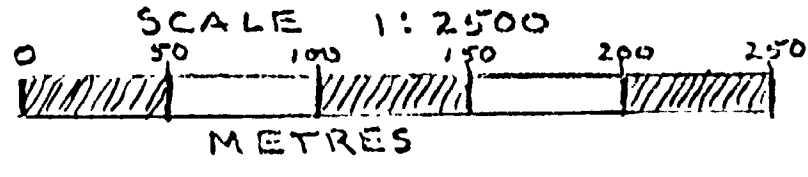

TOTAL FIELD MAGNETIC VALUES SHOWN IN GAMMAS  
 CONTOUR INTERVAL 1000 GAMMAS

HUMUS SAMPLE LOCATION/IDENTIFICATION  
 HUMUS ASSAYS Ni, Cu, Zn + Pb in ppm  
 Au in ppb

MORANNA CIRCA 1991 VCEM AXIS  
 (PROBABLY GRANITIC SIBYRIAN)

(INCO 1950) MAG. GRAVITY SURVEY LINE 1000' E

ASTRONOMICAL  
 N

INCO DDM #6 (VERTICAL)  
 8 METERS OR  
 135 METRES SEPARATE TO E.O.H.  
 DRILLED 1965

(INCO 1950) MAG. GRAVITY SURVEY BASELINE  
 INCO 1950 CLAIM LINE

**P1186762**

**P1180028**

**P1180030**

INPUT  
 ANOMALY  
 OGS MAP  
 #81049

(INCO 1950) LINE 1000' EAST

OPAP 1993 LINE 685' E

ROSARIO RESOURCES CANADA LTD 1978 BASE LINE

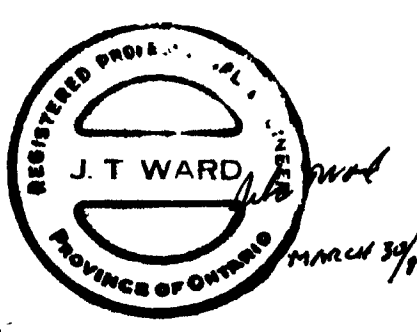
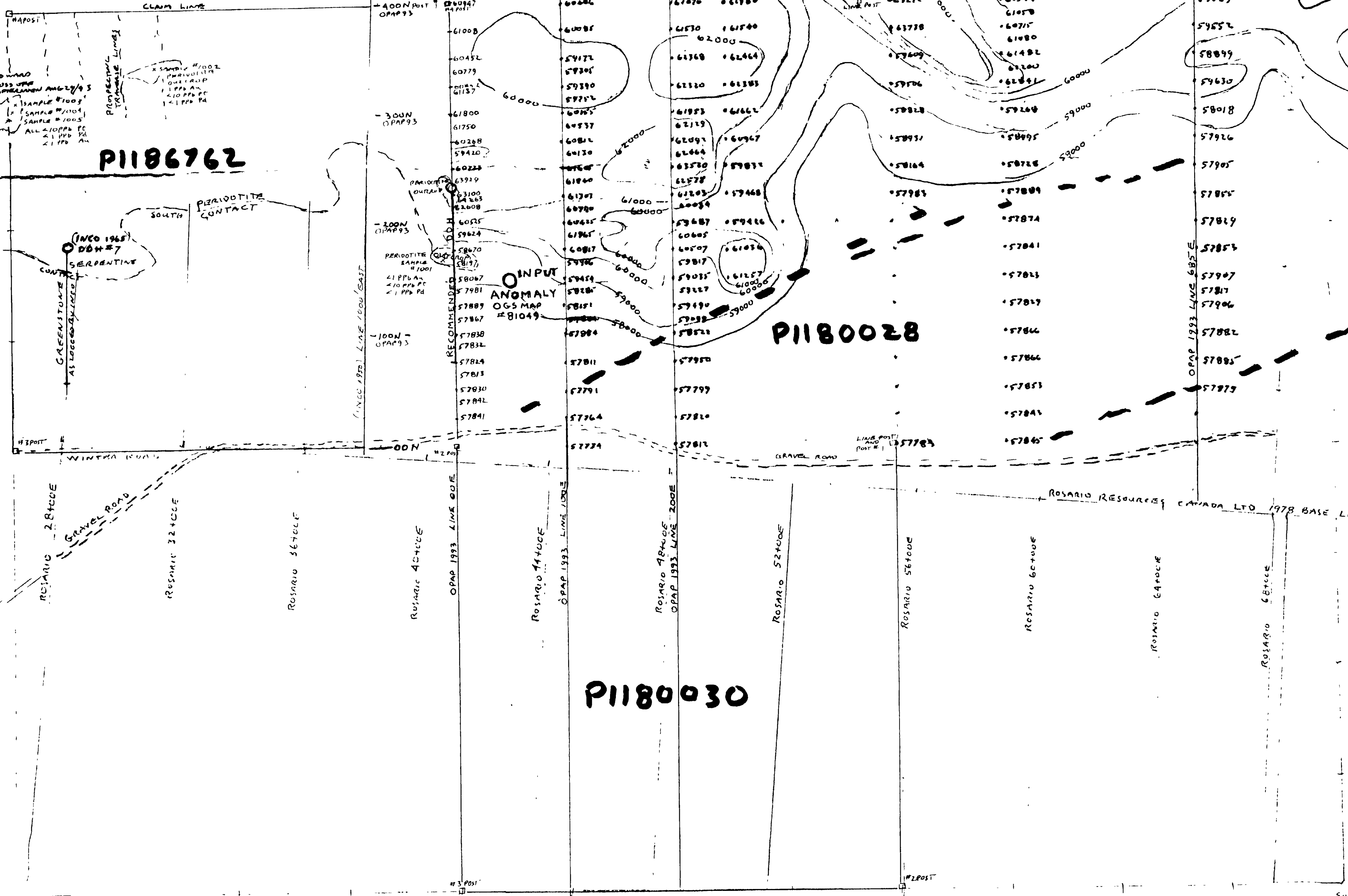



OPAP 1994 PROJECT #2  
MANN Twp., Ontario  
John T. Ward

TOTAL FIELD  
MAGNETIC SURVEY

2.1603 4  
2.1603 4

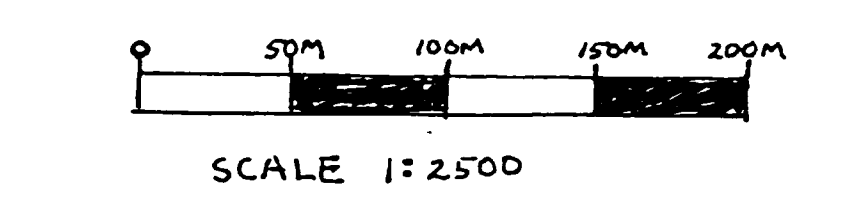
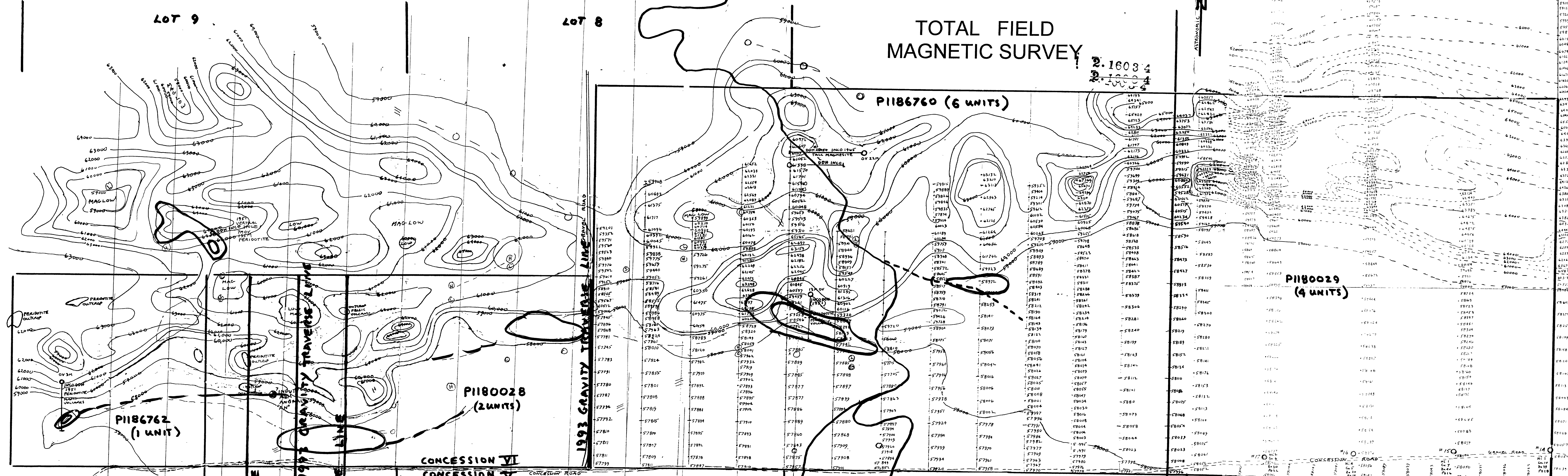

MAGNETIC READINGS IN GAMMAS ABSOLUTE.  
CONTOUR INTERVAL 1000 GAMMAS  
DATA 1994 OPAP PROGRAM  
PLUS CONTOURING FROM 1993 OPAP, 1978 ROSARIO, 1950 INCO.  
LEGEND  
RESIDUAL (INCO (1950) GRAVITY ANOMALY)  
ROSARIO RESOURCES CANADA LTD (1978) MAX-MIN NLEM CONDUCTOR AXIS.

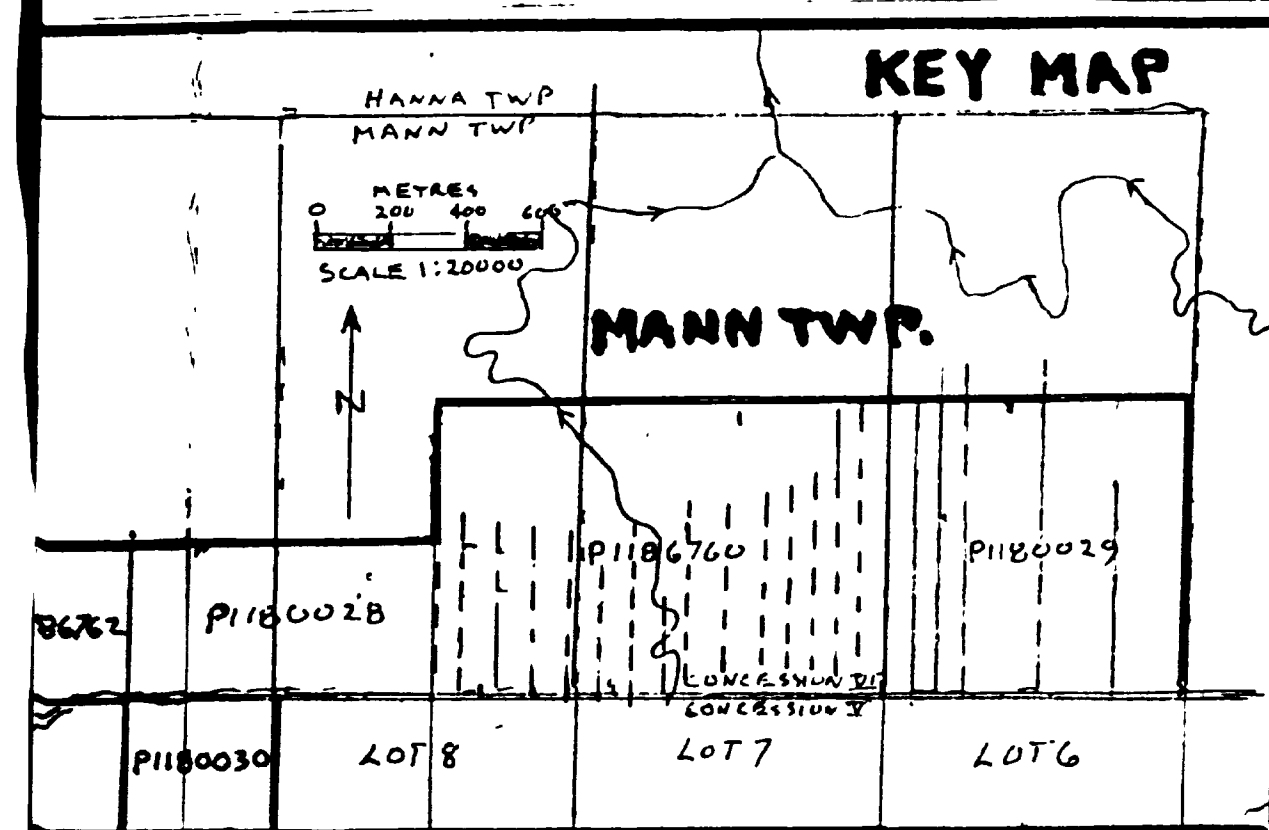
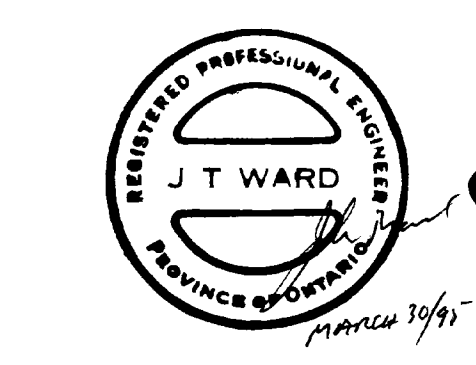

OPAP 1994 PROJECT #2  
MANN Twp., Ontario  
John T. Ward

Vertical Coil EM and  
Humus Geochemistry



WITHDRAWN FROM DISPOSITION

M.I.D. MINING RIGHTS ONLY  
S.R.O. SURFACE RIGHTS ONLY  
M.S. MINING AND SURFACE RIGHTS

Description Order No. Date Disposition File

WATER POWER RESERVE

87187

MINING AND SURFACE RIGHTS WITHDRAWN UNDER SECTION 36 OF THE MINING ACT, 1963, OCTOBER 12, 1987, BY THE 894253.  
SURFACE AND MINING RIGHTS RE-OPENED TO PROSPECTING, STAKING OUT, SALE OR LEASE UNDER SECTION 36 OF THE MINING ACT, R.S.O. 1980, EFFECTIVE 30-SEP-85 AT 7 AM EST. ORDER NO. O-P 4790 DATED 30-AUG-22.

# LOCATION

## FANNA TOWNSHIP J. WARD GROUP D. WARD

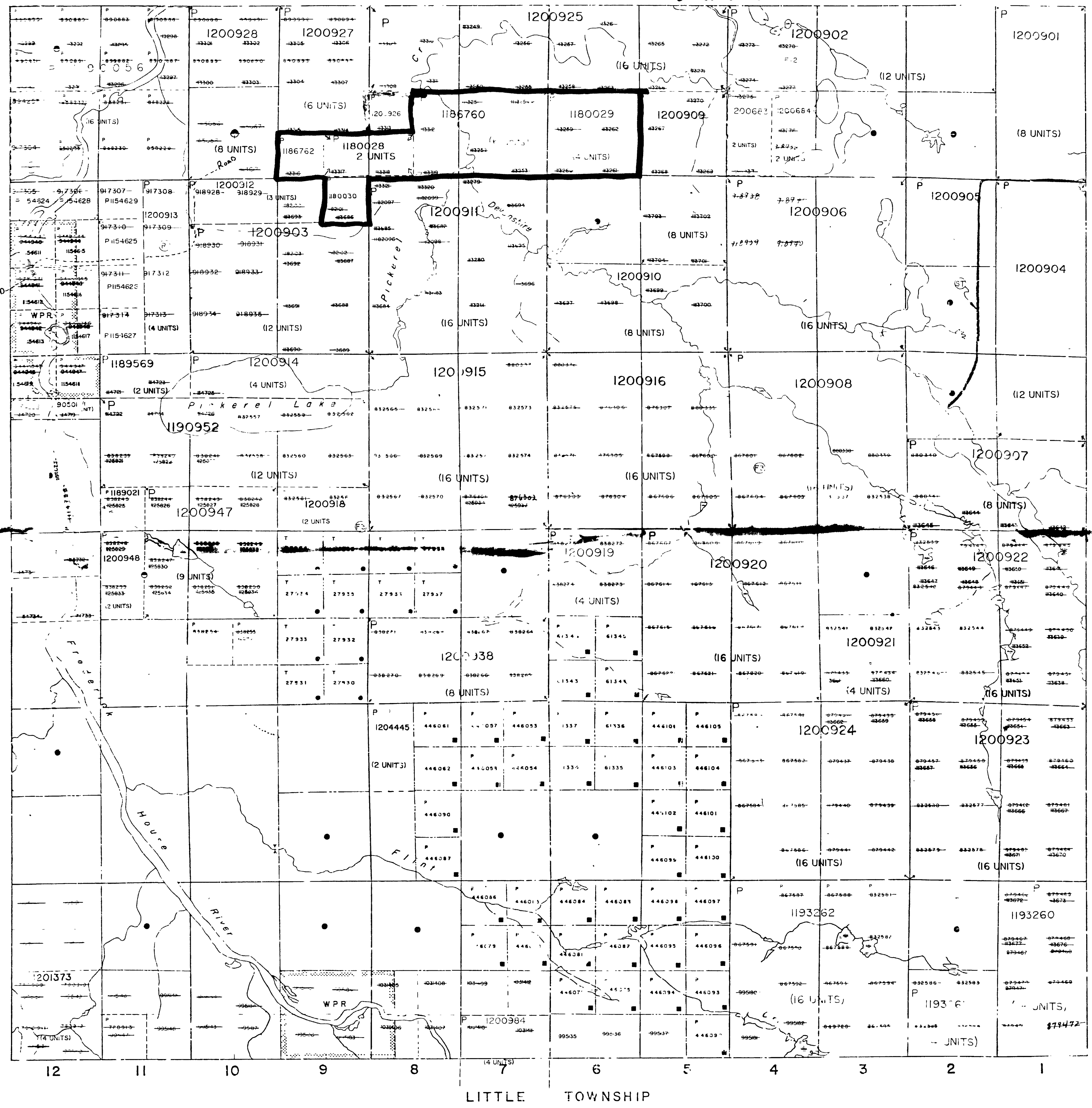

### LEGEND

- HIGHWAY AND ROUTE NO.
- OTHER ROADS
- TRAILS
- TRAILS
- SURVEYED LINES
- TOWNSHIP, BASE LINES, ETC.
- LOTS, MINING CLAIMS, PARCELS, ETC.
- UNSHIPPED LINES
- PARCEL BOUNDARY
- MINING CLAIM, ETC.
- RAILWAY RIGHT OF WAY
- UTILITY LINES
- NON-PERMANENT BEAM
- FLOODING OR FLOOD RIGHTS
- SUBDIVISION OR COMPACT SITE PLAN
- RESERVATIONS
- ORIGINAL SHORELINE
- MARSH OR MUSKEG
- MINES
- REVERSE MONUMENT

### DISPOSITION OF CROWN LANDS

TYPE OF DOCUMENT	SYMBOL
PATENT SURFACE & MINING RIGHTS	□
" SURFACE RIGHTS ONLY	□
" MINING RIGHTS ONLY	□
LEASE, SURFACE & MINING RIGHTS	□
" SURFACE RIGHTS ONLY	□
" MINING RIGHTS ONLY	□
LICENCE OF OCCUPATION	□
ORDER IN COUNCIL	□
RESERVATION	□
CANCELLED	□
SAND & GRAVEL	□
LAND USE PERMIT	□

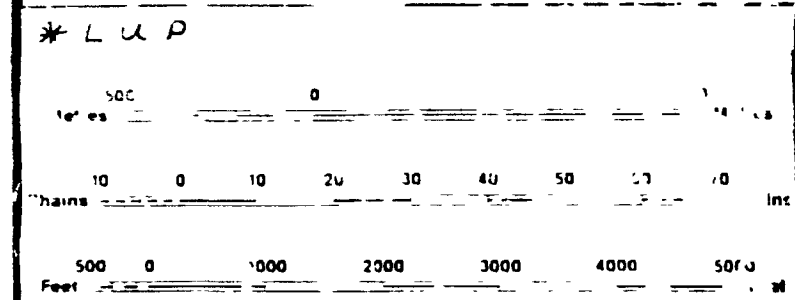

SCALE 1:20 000

UNZIMBLE TRAIL (LAND USE PERMIT) NOTICE RECEIVED 92-DEC-09

*John T. Ward*  
MARCH 30/95

ISSUED  
MARCH 30 1995  
FORCUPINE MINING DIVISION

RECEIVED Sept 22/86

TOWNSHIP  
**MANN**  
MNR ADMINISTRATIVE DISTRICT  
**COCHRANE**  
MINING DIVISION  
**PORCUPINE**  
LAND TITLES / REGISTRY DIVISION  
**COCHRANE**

Ministry of Natural Resources Ontario  
Ministry of Northern Development and Mines

Date: SEPTEMBER 1986  
Number: **G-3537**

MANN

MANN

G-3537

G-3537



# MANN TWP.

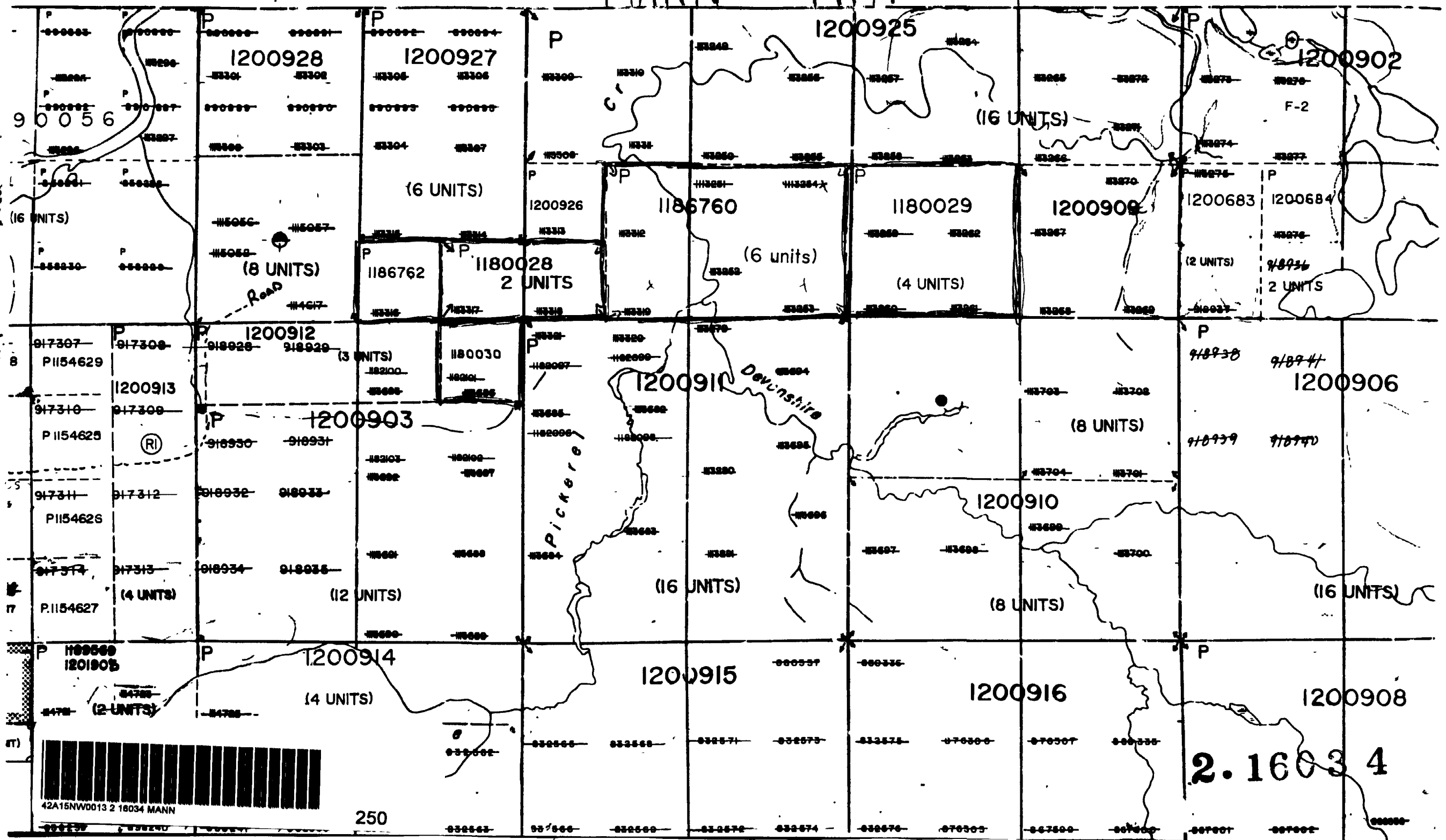

250

2.16034

# FIG. 5A

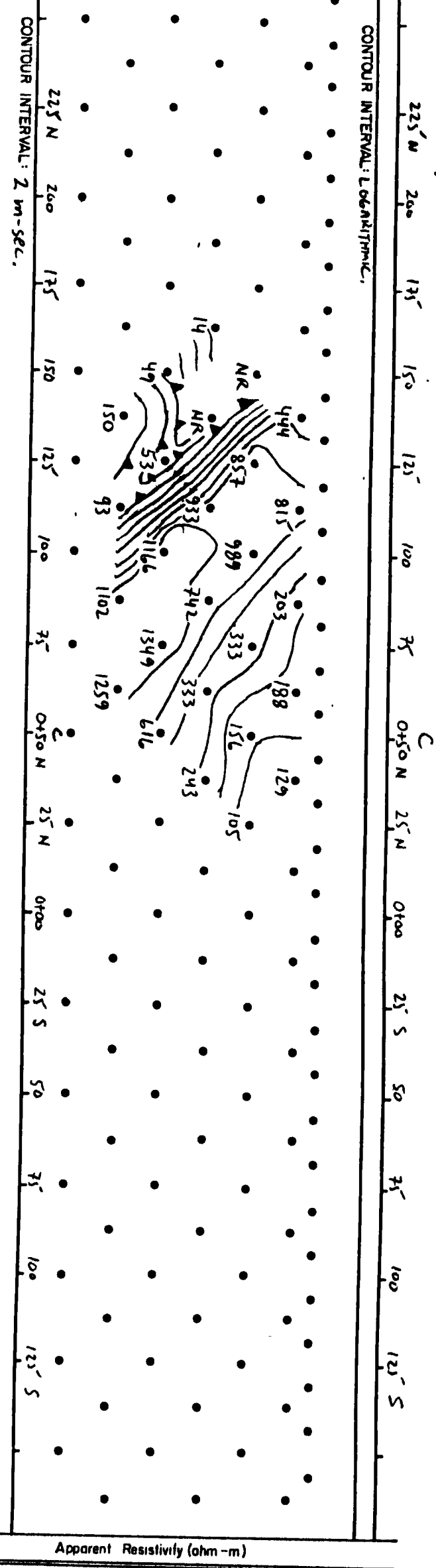

CONCESSION VI  
CONCESSION V



2.18034

260

OPAP-93

DIPOLE-DIPOLE

SUBJECT MANN TWP. LOT 9  
PROJECT P1180028

*John P. Mann  
MANN 30/95*

DATE \_\_\_\_\_  
LINE 00E (WEST BOUNDARY)  
SPREAD 25m READING N+S

FIG. 50

CONTOUR INTERVAL: LOGARITHMIC.

400 M 350 300 250 200 150 100 0+50 M 0+00 50 S 100 150 200 250 300 S

CONTOUR INTERVAL: 5 m-sec

400 M 350 300 250 200 150 100 0+50 M 0+00 50 S 100 150 200 250 300 S

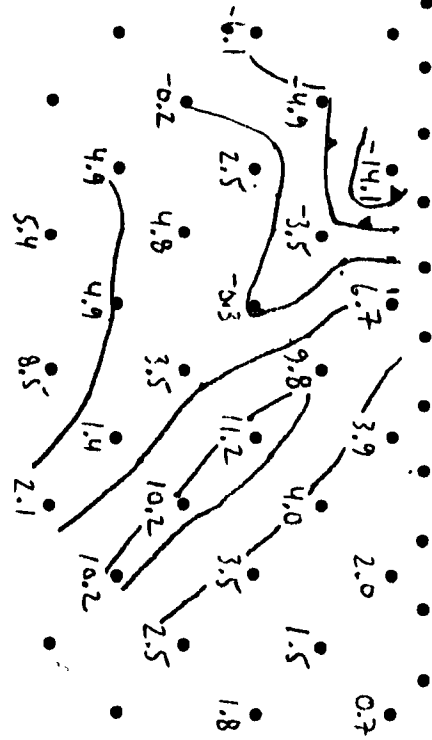
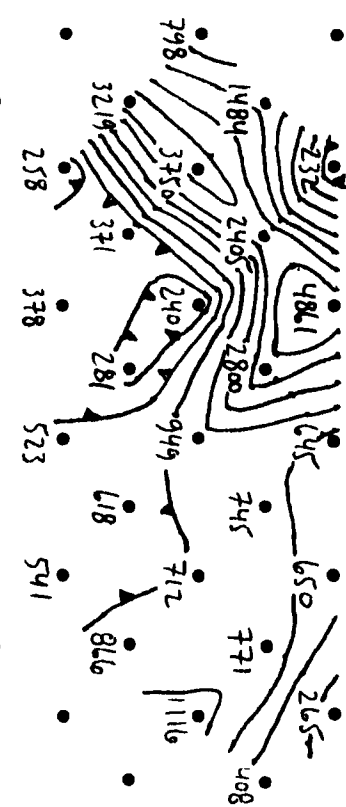

CONCESSION VI  
CONCESSION V



2.16034

270

Chargeability (m-sec)

Apparent Resistivity (ohm-m)

OPAR-93

DIPOLE-DIPOLE

JECT MANN TWP. LOT 9  
P1180028

*John Mann  
March 31/88*

DATE \_\_\_\_\_  
LINE 0+00  
SPREAD 50m BEARING N-S

CONTOUR INTERVAL: LOG RESISTIVITY

CONTOUR INTERVAL: 5 m-sec

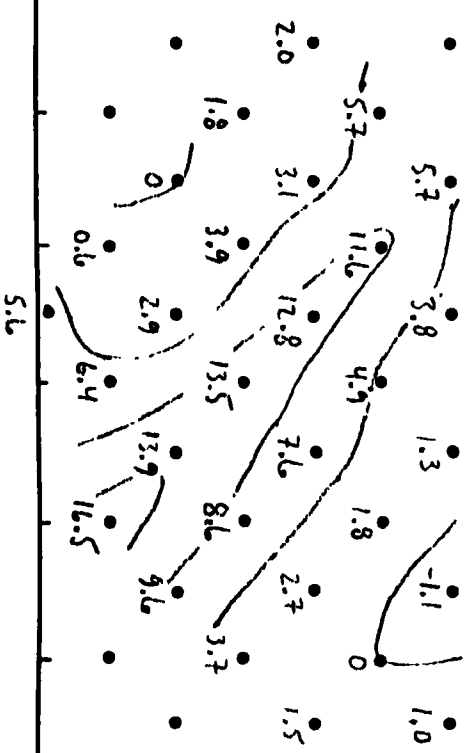
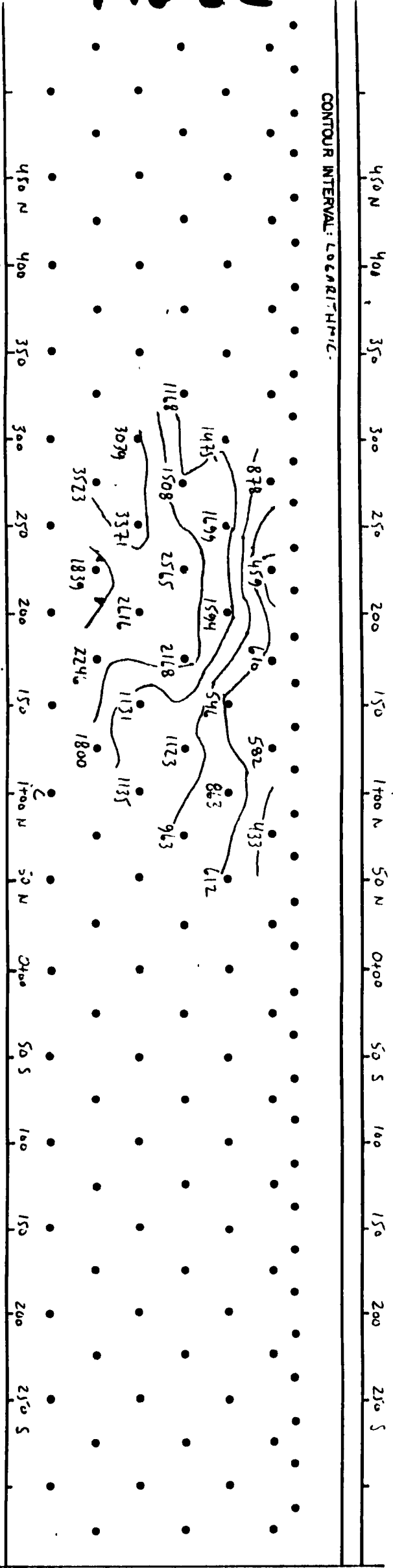

2.16034



280

Chargeability (m-sec)

Apparent Resistivity (ohm-m)

OPAP-93

WIPOLIE - DIPOLE

PROJECT MANN TWA LOT 9

*Jb Ward*  
*MARCH 30/95*

DATE \_\_\_\_\_  
LINE 1+00 E

PI180028

SPREAD 50M BEARING N-S

350 N 300 250 200 150 100 50 0 50 S 100 150 200 250 300 350 S

CONTOUR INTERVAL: LOGARITHMIC.

CONTOUR INTERVAL: 2 m-sec.

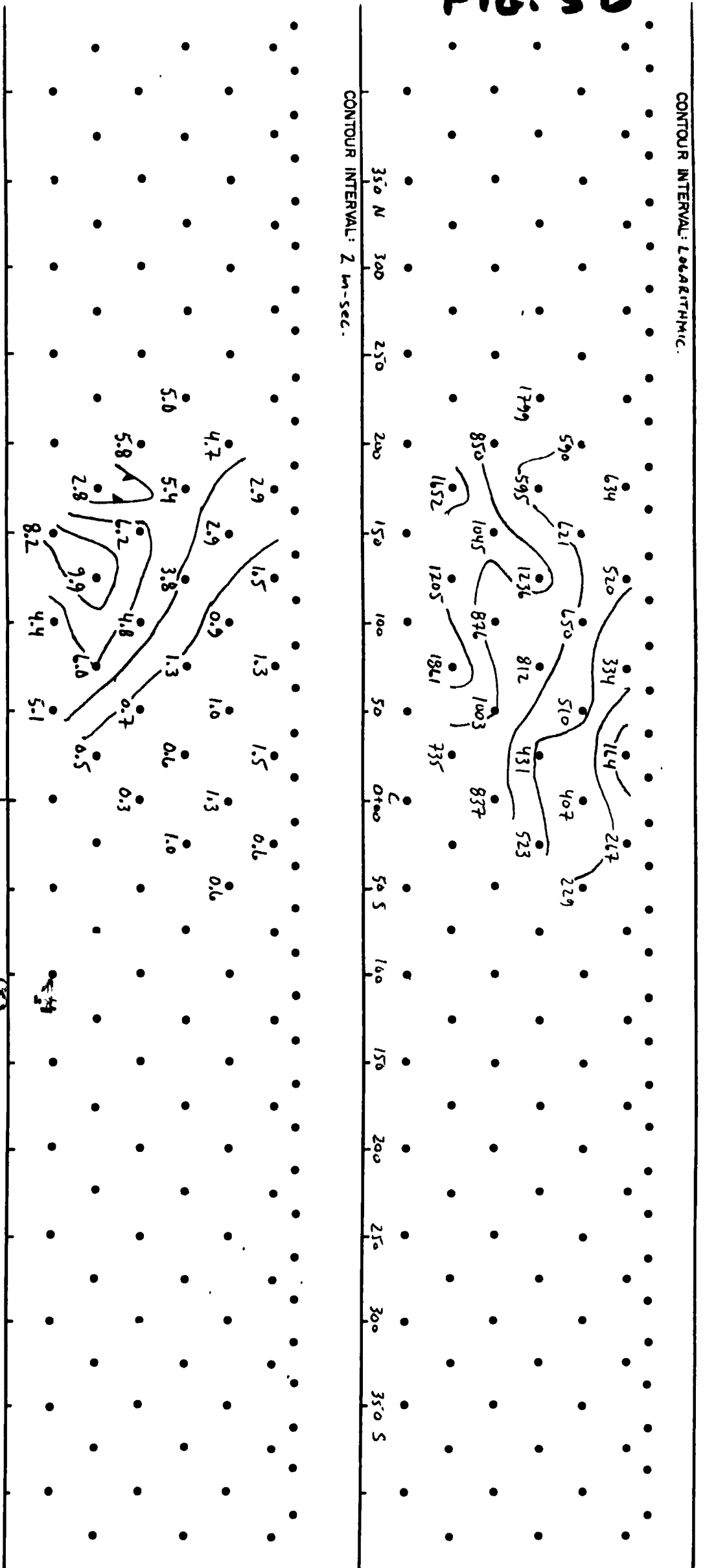

Chargeability (m-sec)

Apparent Resistivity (ohm-m)

2.1603

290



42A15N00013 2 18034 MANN

OPAP-93

DIPOLLE - DIPOLLE

OBJECT MANN TWP. LOT 9

*John Tidwell*  
MARCH 29/95

DATE \_\_\_\_\_

LINE 2+00 E

REF: PH8002B

SURVEY AD 50M

REMARKS N-S



# FIG 5E

CONTOUR INTERVAL: LOGARITHMIC.

CONTOUR INTERVAL: 1 m-sec.

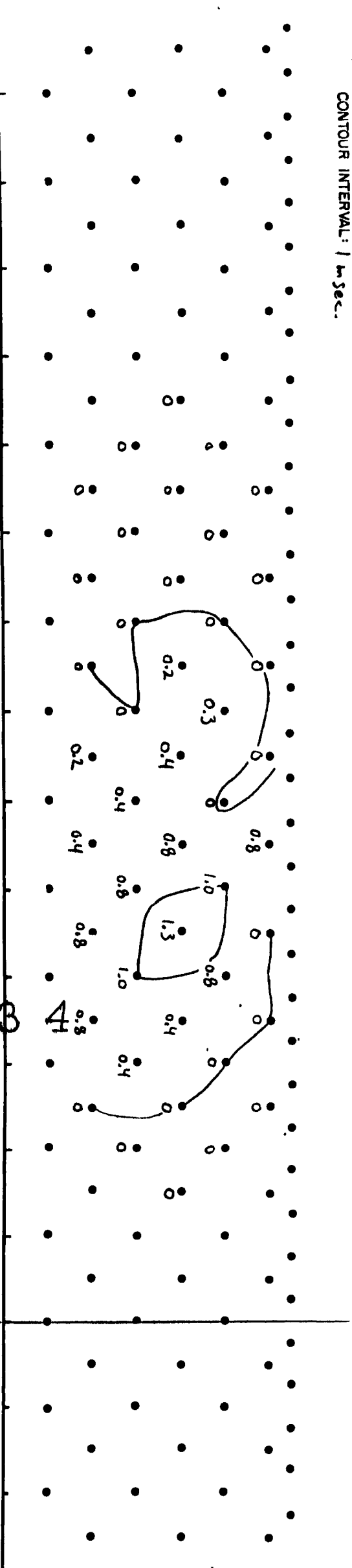
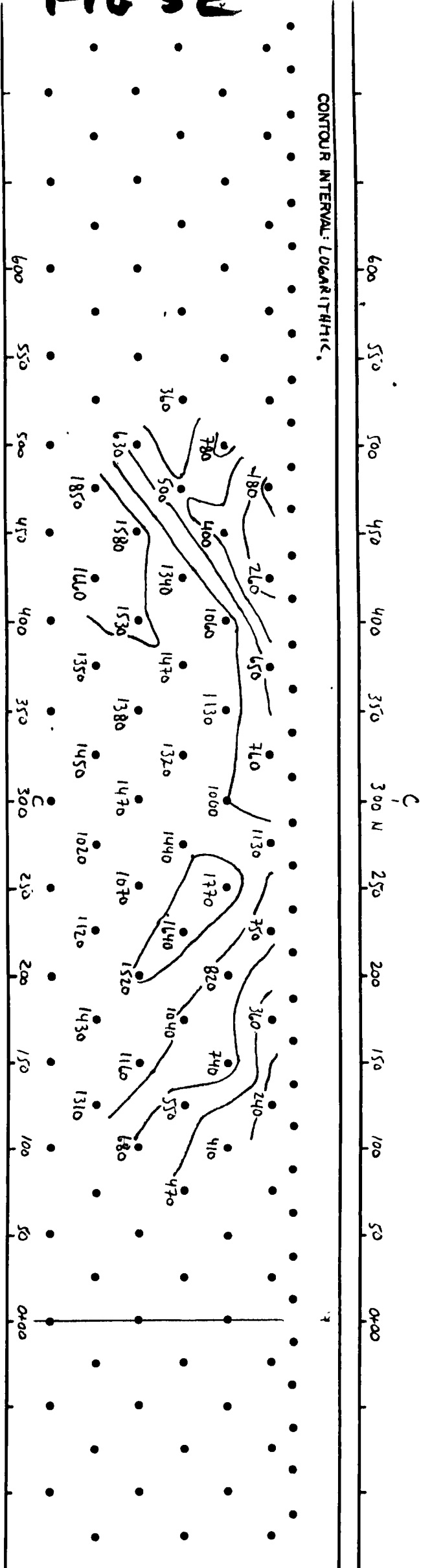

300



42A15NW0013 2 16034 MANN



2.16034

CONCESSION VI  
CONCESSION V

Chargeability (m-sec)

Apparent Resistivity (ohm-m)

DIPOLÉ - DIPOLÉ

*John Mann*  
MARCH 30/95

DATE \_\_\_\_\_  
LINE 6485E MANN TWP LOT 8  
SERIAL 504A REEL NO N-5

SUBJECT MANN TWP. LOT 8  
FILE NO P1180020

GRAVITY SURVEY

OPAF - 93

FIG. 6A

MANN TWP.

LOT 9 (P1180028 AND P1180030)

SCALE:  
BOUGUER GRAVITY  
VERTICAL -  
1 cm = 0.5 mgal

HORIZONTAL -  
1 cm = 25 m.

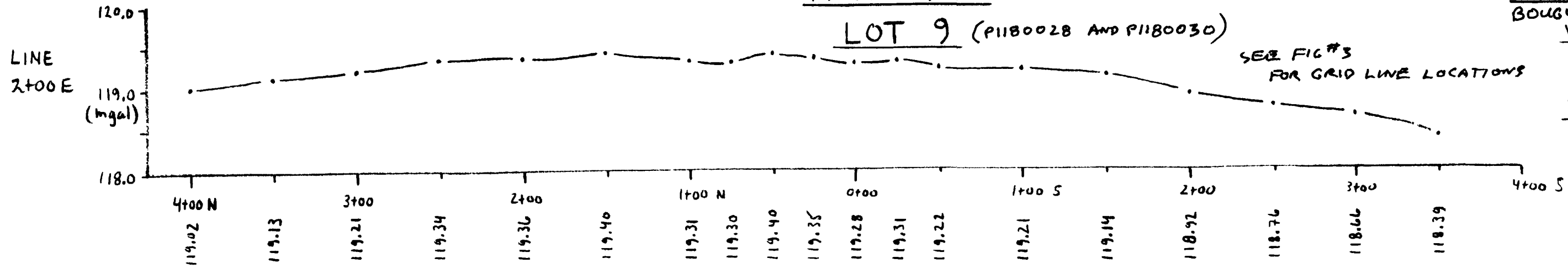

SEE FIG #3  
FOR GRID LINE LOCATIONS

SEE FIG. #2  
FOR LOCATION MAP

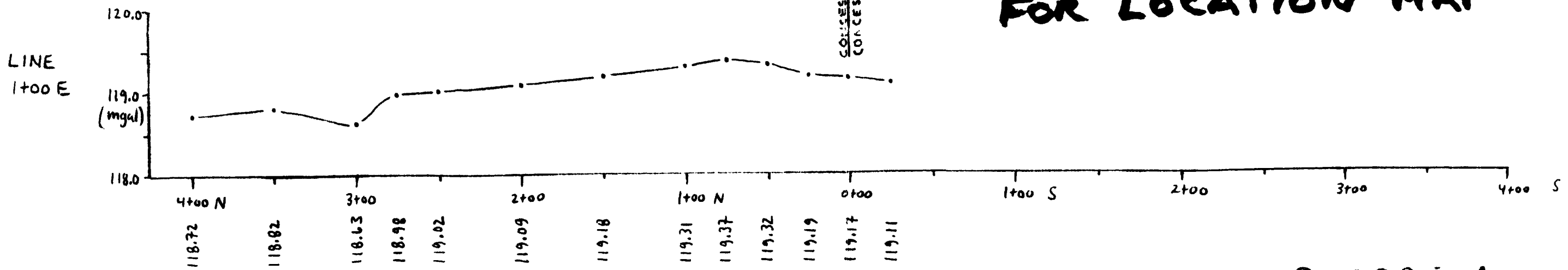

CONCESSION VI  
CONCESSION V

P1180028  
CONCESSION VI  
CONCESSION V  
P1180030

2.16034



310

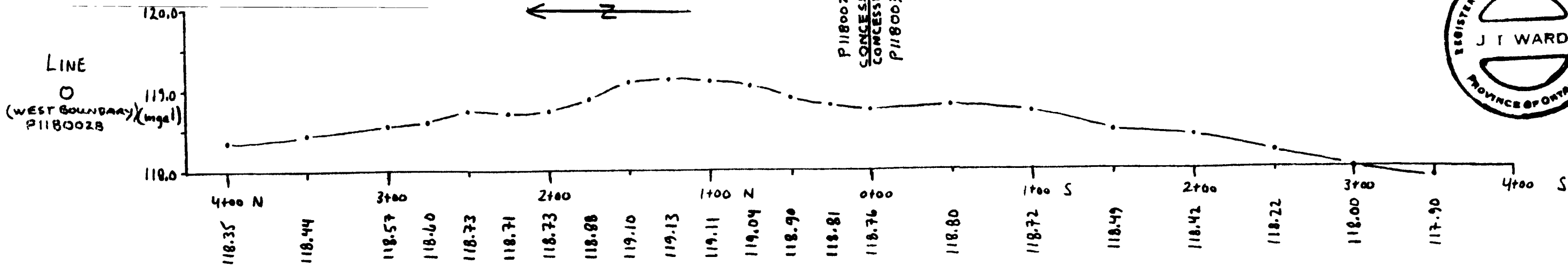

MARCH 30/93

GRAVITY SURVEY

OPAP. - 93

MANN TWP.

LOT 8 (P1180028)

SCALE:

VERTICAL - BOUGUER GRAVITY

1 cm = 0.5 mgal.

HORIZONTAL -

1 cm = 25 m.

**SEE FIG #2  
FOR LOCATION MAP**

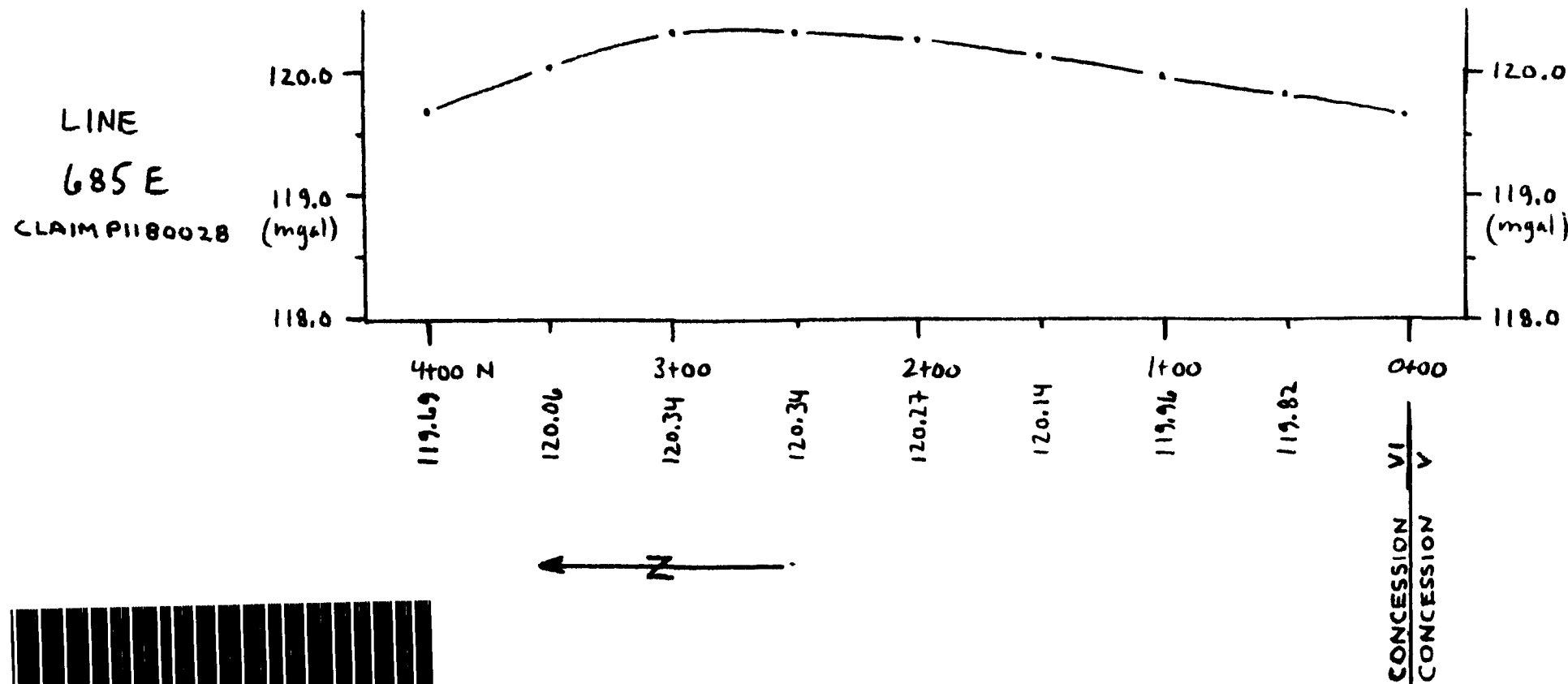

*J. T. Ward*  
MARCH 30/95

