

HOLE NUMBER: AUR11-01

PROJECT NAME: MANN BELT
PROJECT NUMBER: 6269
CLAIM NUMBER: P1200983
LOCATION: AURORA TWP.

DATE STARTED: 10/04/1995
DATE COMPLETED: 10/11/1995
DATE LOGGED: 10/11/1995

COMMENTS : Casing pulled.
REGS AT:

DIRECTIONAL DATA:

Depth (M)	Astronomic Azimuth	Dip degrees	Type of Test	FLAG	Comments	Depth (M)	Astronomic Azimuth	Dip degrees	Type of Test	FLAG	Comments
60.00	0	-45° 0' 0"	A	OK							
110.00	0	-45° 0' 0"	A	OK							
170.00	0	-45° 0' 0"	A	OK							
234.00	0	-45° 0' 0"	A	OK							

HOLE NUMBER: AUR11-01

DRILL HOLE RECORD

PAGE: 1

LOGGED BY: C.A. PETCH
Paul Noyel

FALCONBRIDGE LIMITED
DRILL HOLE RECORD

010

ALTERNATE COORDS GRID: UTM
NORTH: 0+ 0
EAST: 0+ 0
ELEV: 0.00 250

PLOTTING COORDS GRID: AUR95-02
NORTH: 380.00M
EAST: 400.00E
ELEV: 0.00 250

COLLAR DIP: -45° 0' 0"
LENGTH OF THE HOLE: 251.00M
START DEPTH: 0.00M
FINAL DEPTH: 251.00M

GRID ASTRONOMIC AZIMUTH: 335° 0' 0"

COLLAR ASTRONOMIC AZIMUTH: 155° 0' 0"

PULSE BH SURVEY: NO
PLUGGED: NO
HOLE SIZE: BQ

COLLAR SURVEY: NO
ROD LOG: NO
HOLE MARKS WATER: NO

CONTRACTOR: DOMINI DRILLING
CASING: NH
CORE STORAGE: MINESITE
UTM COORD.:



42A16SW0007 W9560.00463 AURORA

FROM TO	ROCK TYPE	TEXTURE AND STRUCTURE	ANGLE TO CA	ALTERATION	MINERALIZATION	REMARKS
0.00 TO 54.60	felsic to mafic Lapilli tuff c4,t,*b/2,p	<ul style="list-style-type: none"> - pale pink and green with dark green, brown and grey - lapilli to tuff-sized fragments and feldspar crystals in a fine grained, ashy matrix. - bedding and strong flattening (locally weakly mylonitic) are at 65-80°/ca. - fragments are composed of: <ol style="list-style-type: none"> 1) 30%, pale green to white, and dark green, elongate (1mm x 0.1-1cm), wispy fragments. 2) 10%, 1 mm, subrounded, pale pink to white to grey feldspar + quartz grains. 3) 5%, siliceous, pale pink to pale grey, flattened clasts (0.5 x 2 cm). 4) rare, light grey, siliceous, 1 cm, sub-rounded felsic clasts - matrix (5%) is ashy and varies from more mafic in composition (dark green and brown, moderately hard) to felsic (pale pink-brown and medium grey, hard). - although individual beds are hard to define, packages of fragment types change on the order of a half metre. - not magnetic - proportion of mafic tuff(?) increases downhole. - 59.90-62.51m - fine to medium grained, dark green mafic dyke cuts tuff at 35°/ca (uphole) and 55°/ca (downhole). - 64.29-64.74m - fine grained, dark green mafic dyke. - 83.1m - 1 cm, brown band contains 2%, 2mm, retrograded garnets, similar to those in pillow selvages. This may indicate a higher proportion of the unit is mafic volcanic rock that has been strongly altered and deformed. - 95m-102.78m - pale green, discontinuously banded mafic volcanic. The bands may be deformed (highly strained) fracture-controlled alteration patches. Locally see 2-5 mm boudins of same. - downhole contact is sharp at 50 °/ca. 		<ul style="list-style-type: none"> - 10%, pale pink and green, feldspar and epidote alteration (bleaching) associated with thin fractures that are oriented subparallel to bedding (locally patchy). - 1%, thin veinlets of quartz + carbonate + chlorite cross-cut banding at random orientations. - rare fragments appear to be hematite stained or rimmed. 	- nil	

HOLE NUMBER: AUR11-01

DRILL HOLE RECORD

DATE: 10/17/1995

FROM TO	ROCK TYPE	TEXTURE AND STRUCTURE	ANGLE TO CA	ALTERATION	MINERALIZATION	REMARKS
102.78 TO 253.00	Mafic Intrusive (7,b)	<ul style="list-style-type: none"> - fine to medium grained, locally coarse grained. - grey-green to brownish green-grey. - weakly to moderately magnetic. - equigranular to weakly porphyritic. - local leucocratic phases are light green. - 104.45-104.7m - xenolith of mafic lapilli-tuff. - 104.7-105.6m - fault - dark green chloritic fault gouge with 1 cm pieces of quartz-rich rock. Updip contact is sharp at 35°/ca and discordant with banding. Downhole contact is lost in broken core. - more consistently coarser grained after 167m. - 191-201m - coarse grained interval has 4t, 0.5 cm, white, irregular patches of feldspar, 2t, 2-4 mm, black, acicular amphibole, and rare, 5 mm, dark green, tabular, locally twinned amphibole. The interval contains 2t, 1 cm, irregular dark green to black, softer, fine grained, chloritic patches. 		<ul style="list-style-type: none"> - weak red-pink stain of feldspars (hematite). - locally weakly chloritic. - 205.3m - two 3 mm, straight quartz + feldspar + chlorite + carbonate veins (these are rare). 	<ul style="list-style-type: none"> - trace to 0.05% disseminated pyrite is subhedral. 	<ul style="list-style-type: none"> - fault zone is the probable conductor. - core at 250 m is indistinguishable from core at 149 m (ie. no large scale heterogeneities).

HOLE NUMBER: AUR11-01

DRILL HOLE RECORD

LOGGED BY: C.A. PETCH

PAGE: 2

HOLE NUMBER : AUR11-01

GEOCHEMICAL ASSAY

DATE: 17/10/19:

Sample	From (M)	To (M)	Leq. (M)	SI02	AL2O3	CAO	MGO	NA2O	K2O	FE2O3	TI02	P2O5	MNO	CR2O3	LOI	SUN	Y PPM	ZR PPM	BA PPM	CU PPM	ZN PPM	NI PPM	CR PPM	FIELD NAME	CHEM ID	ALOR
AR06985	56.65	57.32	0.67																					4,t		
AR06986	61.12	61.77	0.65																					4,t		
AR06987	79.34	80.00	0.66																					7,a		
AR06988	109.30	110.00	0.70																					7,a		
AR06989	137.22	137.75	0.53																					7,b		
AR06990	203.00	203.57	0.57																					7,b		
AR06991	248.00	248.49	0.49																					7,a		

HOLE NUMBER: AUR11-01

GEOCHEMICAL ASSAY

PAGE:

Report of Work Conducted After Recording Claim

Transaction Number
W9560.00463

Mining Act

SEE PAGE 2

Personal information collected on this form is obtained under the authority of the Mining Act. This collection should be directed to the Provincial Manager, Mining Lands, Ministry of Northern Development and Mines, Sudbury, Ontario, P3E 6A5, telephone (705) 670-7264.



900

- Instructions:**
- Please type or print and submit in duplicate.
 - Refer to the Mining Act and Regulations for recording requirements.
 - A separate copy of this form must be completed for each Work Group.
 - Technical reports and maps must accompany this form in duplicate.
 - A sketch, showing the claims the work is assigned to, must accompany this form.

Recorded Holder(s) <u>Falconbridge Limited</u>		Client No. <u>130679</u>
Address <u>P.O. Box 1140 571 Moneta Ave. Timmins, Ont. P4N7H9</u>		Telephone No. <u>(705) 267-1188</u>
Mining Division <u>Porcupine</u>	Township/Area <u>AURORA/McCART</u>	M or G Plan No.
Dates Work Performed From: <u>October 3, 1995</u>		To: <u>October 11, 1995</u>

Work Performed (Check One Work Group Only)

Work Group	Type
<input type="checkbox"/> Geotechnical Survey	
<input checked="" type="checkbox"/> Physical Work, including Drilling	<u>Dominik Drilling (ddh AUR11-01, 251m)</u>
<input type="checkbox"/> Rehabilitation	
<input type="checkbox"/> Other Authorized Work	
<input type="checkbox"/> Assays	
<input type="checkbox"/> Assignment from Reserve	

RECORDED
 OCT 25 1995

Total Assessment Work Claimed on the Attached Statement of Costs \$ 17,846.16

Note: The Minister may reject for assessment work credit all or part of the assessment work submitted if the recorded holder cannot verify expenditures claimed in the statement of costs within 30 days of a request for verification.

Persons and Survey Company Who Performed the Work (Give Name and Address of Author of Report)

Name	Address
<u>Dominik Drilling</u>	<u>409 King St. P.O. Box 479 Porcupine, Ont.</u>

(attach a schedule if necessary)

Certification of Beneficial Interest * See Note No. 1 on reverse side

I certify that at the time the work was performed, the claims covered in this work report were recorded in the current holder's name or held under a beneficial interest by the current recorded holder.	Date <u>Oct 25 '95</u>	Recorded Holder or Agent (Signature) <u>Paul Nagel</u>
--	---------------------------	---

Certification of Work Report

I certify that I have a personal knowledge of the facts set forth in this Work report, having performed the work or witnessed same during and/or after its completion and annexed report is true.		
Name and Address of Person Certifying <u>Paul Nagel 571 Moneta Ave. Timmins Ont.</u>		
Telephone No. <u>(705) 267-1188</u>	Date <u>Oct 25 '95</u>	Certified By (Signature) <u>Paul Nagel</u>

For Office Use Only

Total Value Cr. Recorded <u>16876</u> <u>\$17,846</u>	Date Recorded	Mining Recorder
Deemed Approval Date <u>Jan. 23/96</u>	Date Approved <u>JAN 22/96</u>	<div style="border: 2px solid black; padding: 5px; font-weight: bold; font-size: 1.5em;">RECEIVED</div> <p>(c.) OCT 25 1995 11:25 A PORCUPINE MINING DIVISION</p>
Date Notice for Amendments Sent		

Report of Work Conducted After Recording Claim

Mining Act

PAGE 2
 Transaction Number
W9560.00463

Personal information collected on this form is obtained under the authority of the Mining Act. This information will be used for correspondence. Questions about this collection should be directed to the Provincial Manager, Mining Lands, Ministry of Northern Development and Mines, Fourth Floor, 159 Cedar Street, Sudbury, Ontario, P3E 6A5, telephone (705) 670-7264.

- Instructions:**
- Please type or print and submit in duplicate.
 - Refer to the Mining Act and Regulations for requirements of filing assessment work or consult the Mining Recorder.
 - A separate copy of this form must be completed for each Work Group.
 - Technical reports and maps must accompany this form in duplicate.
 - A sketch, showing the claims the work is assigned to, must accompany this form.

Recorded Holder(s) FALCONBRIDGE LIMITED		Client No. 130679
Address P.O. Box 1140, 571 Moneta Ave. Timmins Ont. P4N7H9		Telephone No. (705) 267-1188
Mining Division Porcupine	Township/Area AURORA	M or G Plan No.
Dates Work Performed From: Oct. 3, 1995		To: Oct. 11, 1995

Work Performed (Check One Work Group Only)

Work Group	Type
Geotechnical Survey	
Physical Work, Including Drilling	Dominik Drilling DDH AUR11-01
Rehabilitation	
Other Authorized Work	
Assays	
Assignment from Reserve	

Total Assessment Work Claimed on the Attached Statement of Costs \$ 970 (PART OF \$17,846 TOTAL)

Note: The Minister may reject for assessment work credit all or part of the assessment work submitted if the recorded holder cannot verify expenditures claimed in the statement of costs within 30 days of a request for verification.

Persons and Survey Company Who Performed the Work (Give Name and Address of Author of Report)

Name	Address
Dominik Drilling	409 King St. P.O. Box 479 Porcupine Ont.

Attach a schedule if necessary)

Certification of Beneficial Interest - See Note No. 1 on reverse side

I certify that at the time the work was performed, the claims covered in this work report were recorded in the current holder's name or held under a beneficial interest by the current recorded holder.	Date Nov. 28/95	Recorded Holder or Agent (Signature) <i>Christine Petch</i>
--	---------------------------	--

Certification of Work Report

I certify that I have a personal knowledge of the facts set forth in this Work report, having performed the work or witnessed same during and/or after its completion and annexed report is true.		
Name and Address of Person Certifying CHRISTINE PETCH P.O. Box 1140 Timmins, Ont. P4N 7H9		
Telephone No. 267-1188	Date November 28, 1995	Certified By (Signature) <i>Christine Petch</i>

For Office Use Only

Total Value Cr. Recorded	Date Recorded	Mining Recorder	<div style="border: 2px solid black; padding: 5px; font-weight: bold; font-size: 1.2em;">RECEIVED</div> <p>NOV 30 1995</p> <p>@ 11:15 (c) de</p> <p>PORCUPINE MINING DIVISION</p>
	Deemed Approval Date	Date Approved	
	Date Notice for Amendments Sent		



Ministry of
Northern Development
and Mines

Ministère du
Développement du Nord
et des mines

Statement of Costs
for Assessment Credit

État des coûts aux fins
du crédit d'évaluation

Mining Act/Loi sur les mines

Transaction No./N° de transaction

SEE PAGE 2.

Personal information collected on this form is obtained under the authority of the Mining Act. This information will be used to maintain a record and ongoing status of the mining claim(s). Questions about this collection should be directed to the Provincial Manager, Minings Lands, Ministry of Northern Development and Mines, 4th Floor, 159 Cedar Street, Sudbury, Ontario P3E 6A5, telephone (705) 670-7264.

Les renseignements personnels contenus dans la présente formule sont recueillis en vertu de la Loi sur les mines et serviront à tenir à jour un registre des concessions minières. Adresser toute question sur la collecte de ces renseignements au chef provincial des terrains miniers, ministère du Développement du Nord et des Mines, 159, rue Cedar, 4^e étage, Sudbury (Ontario) P3E 6A5, téléphone (705) 670-7264.

1. Direct Costs/Coûts directs

Type	Description	Amount Montant	Totals Total global
Wages Salaires	Labour Main-d'oeuvre		
	Field Supervision Supervision sur le terrain	1800	1800
Contractor's and Consultant's Fees Droits de l'entrepreneur et de l'expert- conseil	Type Dominik	11203.55	
		2302	
		201.25	
			13866.8
Supplies Used Fournitures utilisées	Type Core Rocks	160	
			160
Equipment Rental Location de matériel	Type Truck - Tilden	350.00	
	ATV	250.00	
	Radio - Cellphone	500.00	650.00
Total Direct Costs Total des coûts directs			16476

2. Indirect Costs/Coûts indirects

** Note: When claiming Rehabilitation work Indirect costs are not allowable as assessment work.
Pour le remboursement des travaux de réhabilitation, les coûts indirects ne sont pas admissibles en tant que travaux d'évaluation.

Type	Description	Amount Montant	Totals Total global
Transportation Transport	Type Gasoline	100.00	
			100.00
Food and Lodging Nourriture et hébergement	Bartlett	200.00	
	Food	100.00	300.00
Mobilization and Demobilization Mobilisation et démobilisation			
Sub Total of Indirect Costs Total partiel des coûts indirects			400.00
Amount Allowable (not greater than 20% of Direct Costs) Montant admissible (n'excedant pas 20 % des coûts directs)			16476
Total Value of Assessment Credit (Total of Direct and Allowable Indirect costs)		Valeur totale du crédit d'évaluation (Total des coûts directs et indirects admissibles)	16876

Note: The recorded holder will be required to verify expenditures claimed in this statement of costs within 30 days of a request for verification. If verification is not made, the Minister may reject for assessment work all or part of the assessment work submitted.

Note : Le titulaire enregistré sera tenu de vérifier les dépenses demandées dans le présent état des coûts dans les 30 jours suivant une demande à cet effet. Si la vérification n'est pas effectuée, le ministre peut rejeter tout ou une partie des travaux d'évaluation présentés.

Filing Discounts

- Work filed within two years of completion is claimed at 100% of the above Total Value of Assessment Credit.
- Work filed three, four or five years after completion is claimed at 50% of the above Total Value of Assessment Credit. See calculations below:

Total Value of Assessment Credit	Total Assessment Claimed
	x 0.50 =

Remises pour dépôt

- Les travaux déposés dans les deux ans suivant leur achèvement sont remboursés à 100 % de la valeur totale susmentionnée du crédit d'évaluation.
- Les travaux déposés trois, quatre ou cinq ans après leur achèvement sont remboursés à 50 % de la valeur totale du crédit d'évaluation susmentionné. Voir les calculs ci-dessous.

Valeur totale du crédit d'évaluation	Evaluation totale demandée
	x 0.50

Certification Verifying Statement of Costs

I hereby certify:
that the amounts shown are as accurate as possible and these costs were incurred while conducting assessment work on the lands shown on the accompanying Report of Work form.

I, Paul Nozuel I am authorized
(Recorded Holder, Agent, Position in Company)

To make this certification

Attestation de l'état des coûts

J'atteste par la présente :
que les montants indiqués sont le plus exact possible et que ces dépenses ont été engagées pour effectuer les travaux d'évaluation sur les terrains indiqués dans la formule de rapport de travail ci-joint.

Et qu'à titre de Paul Nozuel je suis autorisé
(titulaire enregistré, représentant, poste occupé dans la compagnie)

à faire cette attestation.

Signature <u>Paul Nozuel</u>	Date Oct 25 '95
---------------------------------	--------------------



Ministry of
Northern Development
and Mines

Ministère du
Développement du Nord
et des mines

Statement of Costs
for Assessment Credit

État des coûts aux fins
du crédit d'évaluation

Mining Act/Loi sur les mines

PAGE 2.

Transaction No./N° de transaction
W9560.00463

DDH AUR11-01

Personal information collected on this form is obtained under the authority of the Mining Act. This information will be used to maintain a record and ongoing status of the mining claim(s). Questions about this collection should be directed to the Provincial Manager, Minings Lands, Ministry of Northern Development and Mines, 4th Floor, 159 Cedar Street, Sudbury, Ontario P3E 6A5, telephone (705) 670-7264.

Les renseignements personnels contenus dans la présente formule sont recueillis en vertu de la Loi sur les mines et serviront à tenir à jour un registre des concessions minières. Adresser toute question sur la collecte de ces renseignements au chef provincial des terrains miniers, ministère du Développement du Nord et des Mines, 159, rue Cedar, 4^e étage, Sudbury (Ontario) P3E 6A5, téléphone (705) 670-7264.

1. Direct Costs/Coûts directs

Type	Description	Amount Montant	Totals Total global
Wages Salaires	Labour Main-d'oeuvre		
	Field Supervision Supervision sur le terrain		
Contractor's and Consultant's Fees Droits de l'entrepreneur et de l'expert- conseil	Type DOMINIK	970. ⁰⁰	
	(13866.8 Tax)		970
Supplies Used Fournitures utilisées	Type		
Equipment Rental Location de matériel	Type		
Total Direct Costs Total des coûts directs			970

2. Indirect Costs/Coûts indirects

Note: When claiming Rehabilitation work indirect costs are not allowable as assessment work.
Pour le remboursement des travaux de réhabilitation, les coûts indirects ne sont pas admissibles en tant que travaux d'évaluation.

Type	Description	Amount Montant	Totals Total global
Transportation Transport	Type		
Food and Lodging Nourriture et hébergement			
Mobilization and Demobilization Mobilisation et démobilisation			
Sub Total of Indirect Costs Total partiel des coûts indirects			
Amount Allowable (not greater than 20% of Direct Costs) Montant admissible (n'excédant pas 20 % des coûts directs)			
Total Value of Assessment Credit (Total of Direct and Allowable Indirect costs)			970
Valeur totale du crédit d'évaluation (Total des coûts directs et indirects admissibles)			

Note: The recorded holder will be required to verify expenditures claimed in this statement of costs within 30 days of a request for verification. If verification is not made, the Minister may reject for assessment work all or part of the assessment work submitted.

Note: Le titulaire enregistré sera tenu de vérifier les dépenses demandées dans le présent état des coûts dans les 30 jours suivant une demande à cet effet. Si la vérification n'est pas effectuée, le ministre peut rejeter tout ou une partie des travaux d'évaluation présentés.

Filing Discounts

1. Work filed within two years of completion is claimed at 100% of the above Total Value of Assessment Credit.
2. Work filed three, four or five years after completion is claimed at 50% of the above Total Value of Assessment Credit. See calculations below:

Total Value of Assessment Credit	Total Assessment Claimed
x 0.50 =	

Remises pour dépôt

1. Les travaux déposés dans les deux ans suivant leur achèvement sont remboursés à 100 % de la valeur totale susmentionnée du crédit d'évaluation.
2. Les travaux déposés trois, quatre ou cinq ans après leur achèvement sont remboursés à 50 % de la valeur totale du crédit d'évaluation susmentionné. Voir les calculs ci-dessous.

Valeur totale du crédit d'évaluation	Evaluation totale demandée
x 0,50 =	

Certification Verifying Statement of Costs

I hereby certify:
that the amounts shown are as accurate as possible and these costs were incurred while conducting assessment work on the lands shown on the accompanying Report of Work form.

that as CHRISTINE PETCH I am authorized
(Recorded Holder, Agent, Position in Company)

to make this certification

Attestation de l'état des coûts

J'atteste par la présente :
que les montants indiqués sont le plus exact possible et que ces dépenses ont été engagées pour effectuer les travaux d'évaluation sur les terrains indiqués dans la formule de rapport de travail ci-joint.

Et qu'à titre de _____ je suis autorisé
(titulaire enregistré, représentant, poste occupé dans la compagnie)

à faire cette attestation.

Signature C. Petch Date Nov. 28/95

AR21-01 240-300
 APR 15-01 60-110-174-234-
 MAY 43-01 65-125-185-

9 Acid tests x _____ = N/C
 _____ Tropy tests x _____ = _____
 BT _____
 7% GST _____
 Total.. N/C

replacing spray gun on fuel
 every 60 METRES

OTHER COSTS:

10/95 28 MANHRS CUT ROAD EVERYTHING PRIVATE PROPERTY
 10/95 26 " " MOVE OVER 30 MANHRS 1269.00 } 166
 5 TRACTORS " APR 22-01 400 }
 2 FLOATS " 140 } 180
 10/95 34 MANHRS 14000 CUT ROAD LOOK FOR WATER 799
 4 TRACTORS " APR 11-01 320 } 1319
 4 FLOATS " 260 }
 10/95 18 MANHRS " " " 423 } 983
 7 TRACTORS " 560 }

2382

166 man hrs x 23.50 = 3891.00
16 TRACTOR x 80.00 = 1280.00
6 drill hrs x 70.00 = 420.00
 ST 4191.00
 7% GST 293.37
 Total 4484.37

20.25
 2382
 11283.55
 13665.55 x 7% = \$970.67

CORROGE LIMITED

OX 1140

MONETA AVENUE

MISSISSAUGA ONTARIO P44 7H9

DATE: 15 OCT 1985

BQ LAQUOIZ FALLS

ILL N° 6

Le No. AUR - 22-01

206	to 300 = 94 M. CORIUS X 43.55	4093.70
300	to 305 = 5 M " X 45.80	229.00
	to	
	to	
	to	4322.70

Le No. AUR - 11-01

0	to 15 = 15 M. CASING X 41.80	627.00
15	to 30 = 15 " " X 46.80	702.00
30	to 45 = 15 " " X 56.80	852.00
45	to 54 = 9 " " X 76.80	691.20
54	to 150 = 96 CORIUS X 41.80	4012.80

150	TO 251 = 101 " X 43.55	4398.55
	to	
	to	
	to	
	to	
	to	

11284.55

e No. MAN 43-01

0	to 9 = 9 M. CASING X 41.80	376.20
9	to 150 = 141 M. CORIUS X 41.80	5893.80
150	to 185 = 35 M. " X 43.55	1654.90
	to	
	to	7924.90

	to	
	to	
	to	
	to	
	to	

	to	
	to	
	to	
	to	
	to	

BT 23531.15
 7% GST 1647.18
 Total 25178.33

To: Falconbridge (Timmins)

From: Bonnie Bartlett
Big Nettle Lake

Rental invoice to Falconbridge for the amount of \$200.00 per
week for the period of Oct 1/95 to Oct 28/95.

TOTAL \$800.00

Bonnie Bartlett
Signature

Oct 19/95
Date

Paul Negele
Oct 22 '95
8269

THE TOWNSHIP OF
OF
AURORA

DISTRICT OF
COCHRANE
PORCUPINE
MINING DIVISION

SCALE 1-INCH = 40 CHAINS

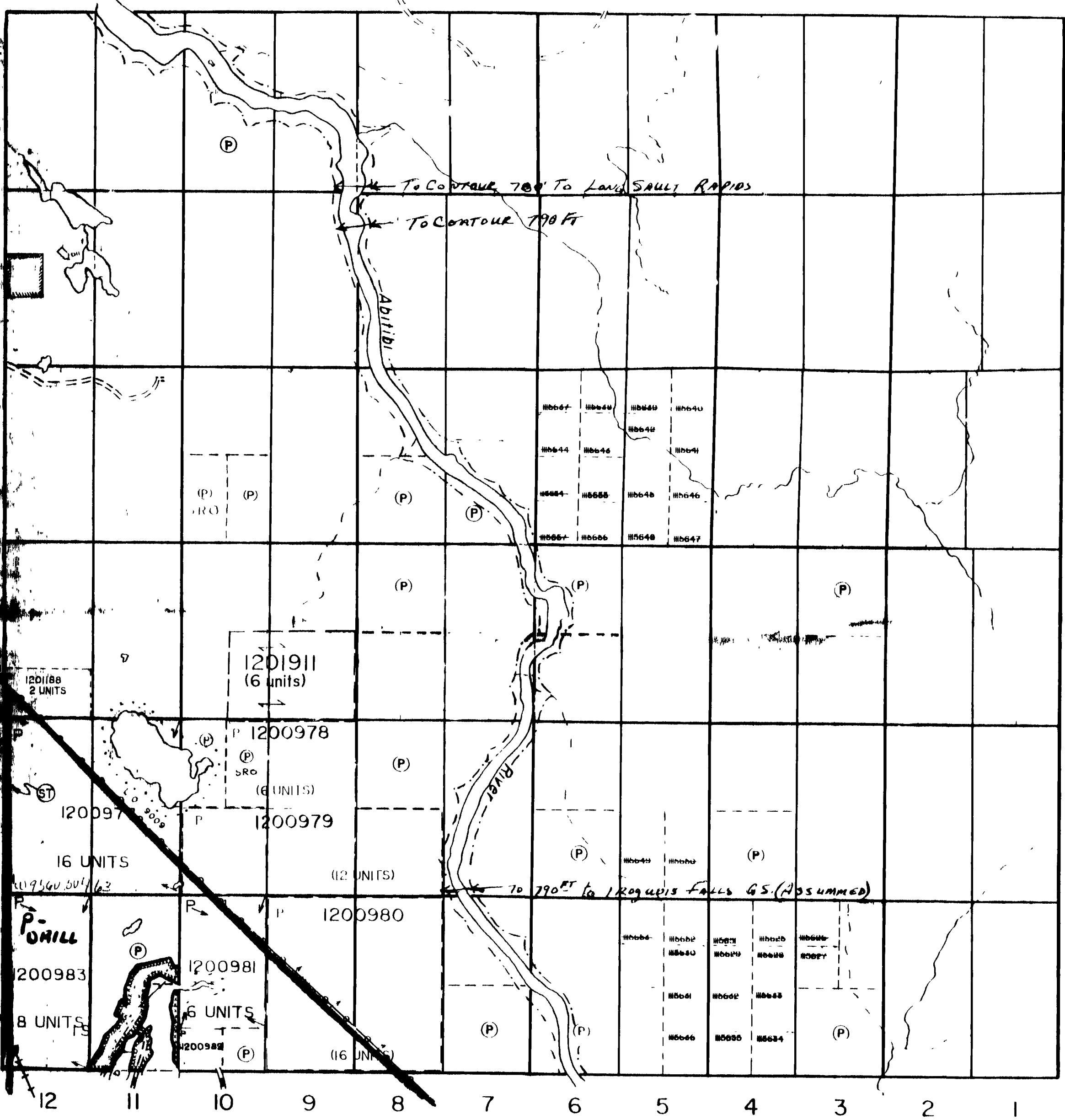

VI
V
IV
III
II
I

Edwards Twp

LEGEND

REGISTERED PLAN OF SUBDIVISION	=====
PATENTED LAND	(P)
CROWN LAND SALE	CS
LEASES	L
LOCATED LAND	Loc
LICENSE OF OCCUPATION	L.O.
ROADS	---
IMPROVED ROADS	==
RAILWAYS	+
POWER LINES	o-o
MARSH OR MUSKEG	~
TRAIL	---
WATER POWER LEASE	W.P.L.

NOTES

400' surface rights reservation ~~around~~ ^{along} lakes and rivers.

Flooding area shown thus
Flooding rights To Contour 790 And 780 Ft
reserved to HEPC

WASTE DISPOSAL SITE (WASTE ATTENUATION ZONE)
NOTICE RECEIVED APRIL 6, 1990

THIS TWP SUBJECT TO FOREST ACTIVITY IN 1991/92.
FURTHER INFORMATION AVAILABLE ON FILE

(S) SNOWMOBILE TRAIL
NOTICE RECEIVED 92-DEC 09

(X) THIS TWP. IS SUBJECT TO FOREST ACTIVITY
IN 1993/94. (CHEM. SPRAY JULY 22 1993)

Received Oct 15/79

PLAN NO - M 408

MINISTRY OF NATURAL RESOURCES
SPECIAL AND MAPS BRANCH

THAT THIS MAP IS COMPILED FROM SOURCES WHICH ARE NOT GUARANTEED TO BE ACCURATE. CLAIMS SHOULD CONSULT WITH THE MINING RECORDER, MINISTRY OF NATURAL RESOURCES FOR ADDITIONAL INFORMATION ON THE STATUS OF THE LANDS SHOWN HEREON.



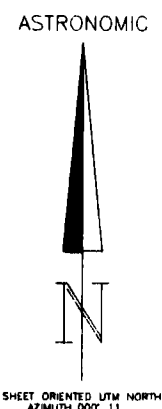
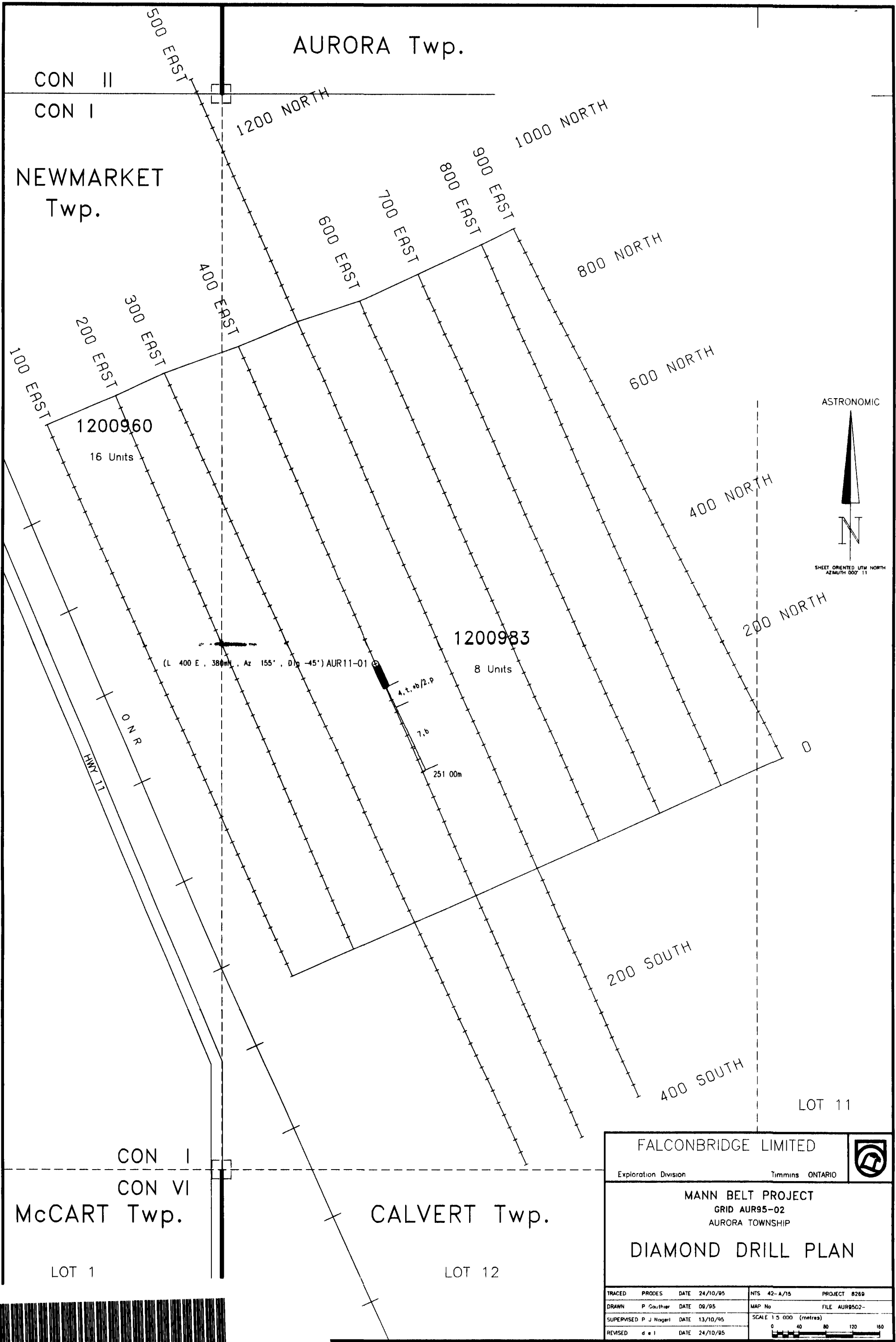

FALCONBRIDGE LIMITED				
Exploration Division	Timmins ONTARIO			
MANN BELT PROJECT GRID AUR95-02 AURORA TOWNSHIP				
DIAMOND DRILL PLAN				
TRACED	PRODES	DATE 24/10/95	NTS 42-A/15	PROJECT 8269
DRAWN	P. Gauthier	DATE 09/95	MAP No	FILE AUR9502-
SUPERVISED	P. J. Nagel	DATE 13/10/95	SCALE 1:5,000 (metres)	
REVISED	d e l	DATE 24/10/95		



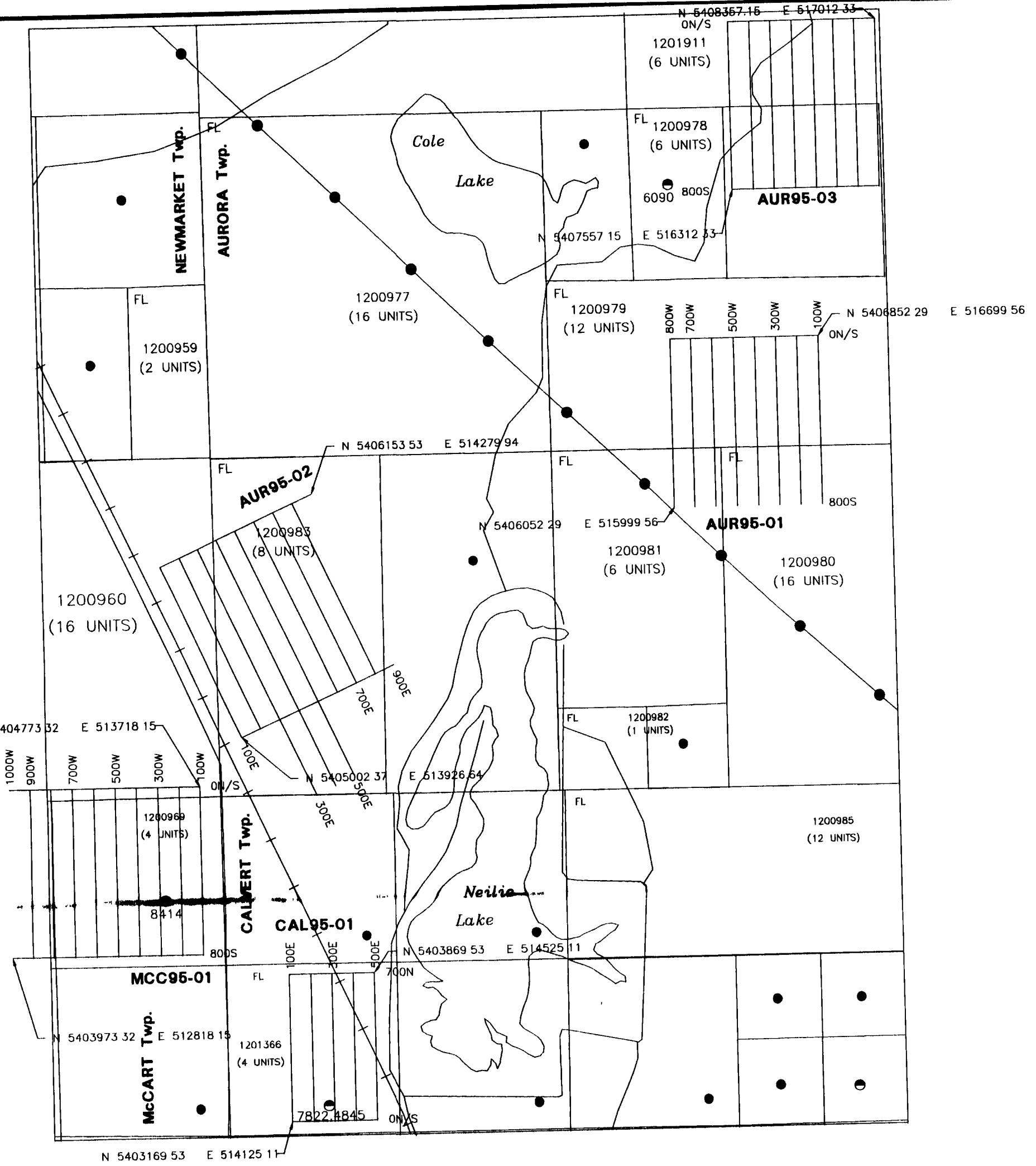

FALCONBRIDGE LIMITED

Exploration Division Timmins ONTARIO

MANN BELT PROJECTS
 McCART NEWMARKET CALVERT & AURORA TOWNSHIPS

**GRID SKETCH
 COMPILATION MAP**

ACED	T S	DATE	06/95	NTS	42-A/15	PROJECT	8269
JAWN	T S	DATE	01/08/95	MAP No		FILE	8269 D
IPRVSIED	P J Nopari	DATE	25/07/95	SCALE	1:20000 (metres)		
VISED	d e l	DATE	07/09/95				

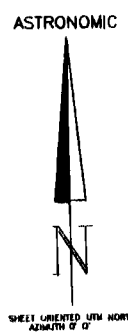

SHEET ORIENTED WITH NORTH
 ADJUSTED TO 0°



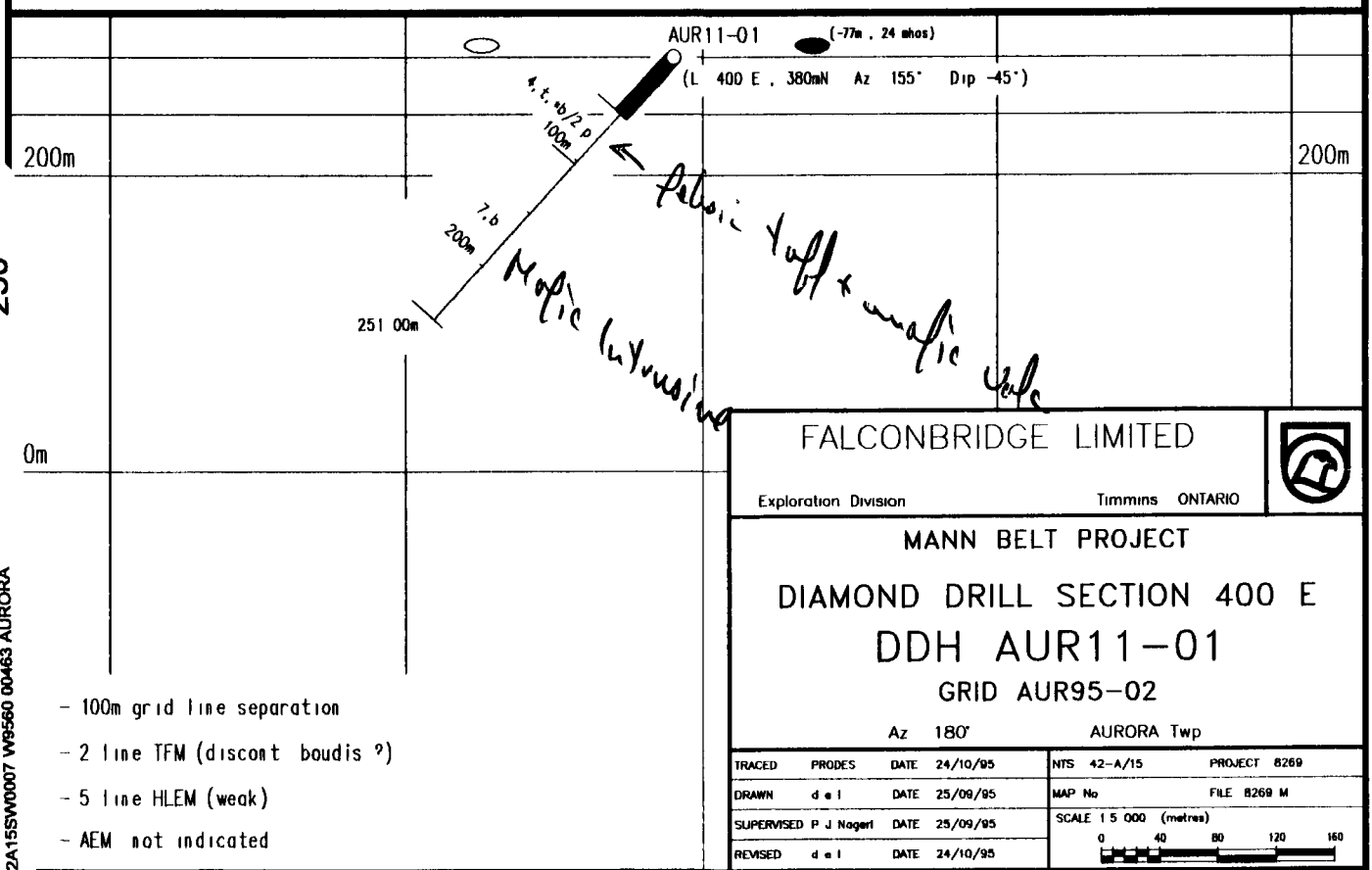
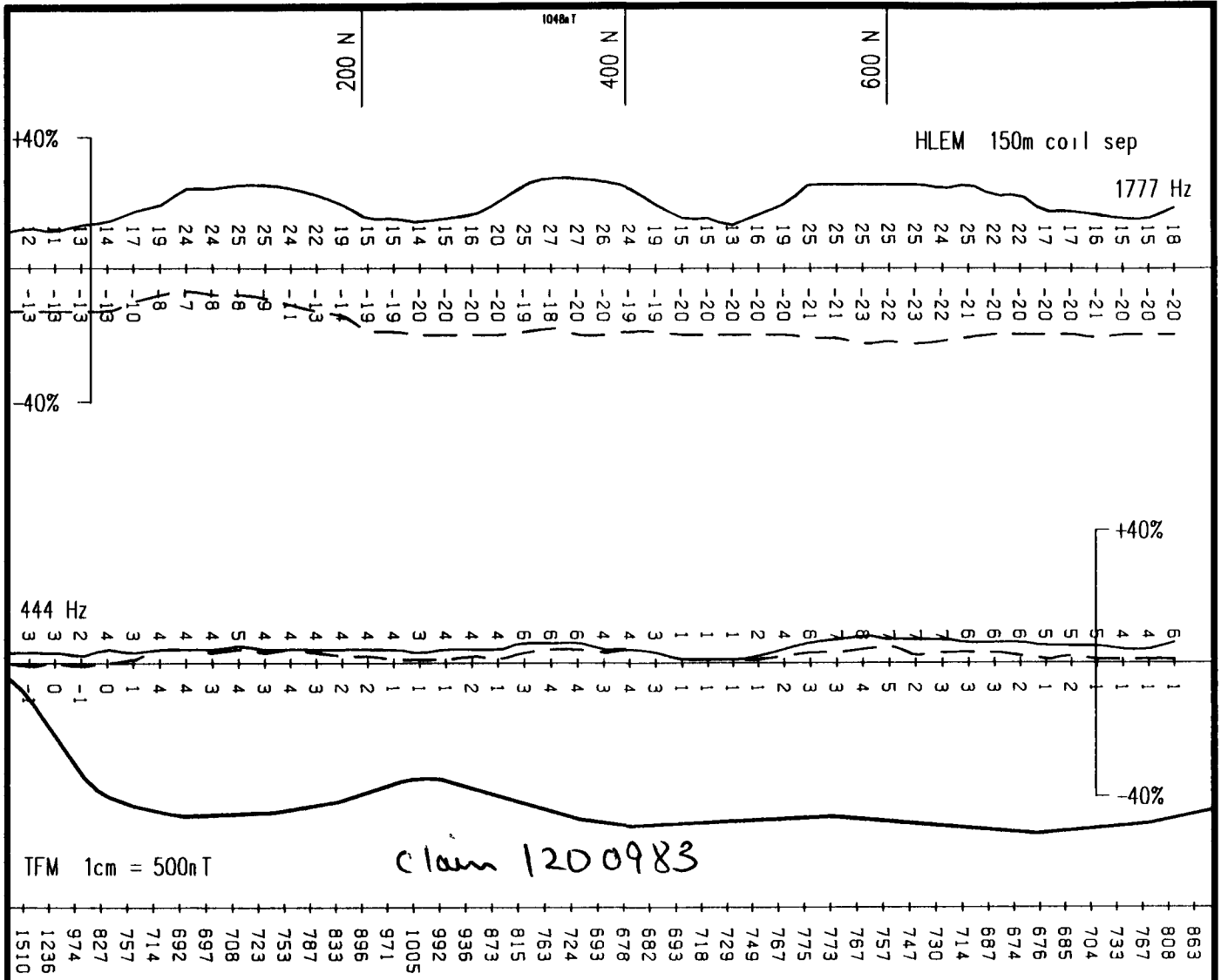

- 100m grid line separation
- 2 line TFM (discont boudis ?)
- 5 line HLEM (weak)
- AEM not indicated

FALCONBRIDGE LIMITED		
Exploration Division	Timmins ONTARIO	
MANN BELT PROJECT		
DIAMOND DRILL SECTION 400 E		
DDH AUR11-01		
GRID AUR95-02		
Az 180°		AURORA Twp
TRACED	PRODES	DATE 24/10/95
NTS 42-A/15		PROJECT 8269
DRAWN	d e l	DATE 25/09/95
MAP No		FILE B269 M
SUPERVISED	P J Nagerl	DATE 25/09/95
SCALE 1:5 000 (metres)		
REVISED	d e l	DATE 24/10/95

