

42A15SW0041 24 MANN

010

Diamond Drilling

Township OF MANN

Report No: 24

Work performed by: International Mogul Mines Limited

Claim No	Hole No	Footage	Date	Note
P. 358270	73-1	524'	Oct/73	(1)
P. 358269	73-2	547'	Oct/73	(1)
P. 358268	73-3	499'	Oct/73	(1)
P. 68504	73-4	474'	Nov/73	(1)
P. 68538	73-5	359'	Nov/73	(1)
P. 68530	73-6	369'	Nov/73	(1)
P. 347883	73-8	467'	Nov/73	(2)
P. 347870	73-9	552'	Dec/73	(2)
P. 358242	73-10	410'	Dec/73	(3)
P. 358240	73-11	401'	Dec/73	(3)
		<u>10</u>		
		1000		

Notes:

- (1) 130/74
- (2) 131/74
- (3) 129/74

DIAMOND DRILL LOG

#130
MANN Twp.

D. D. HOLE NO. 73-1

PAGE 1

PROPERTY International Nickel Mines Ltd.

LOCATION Mann Twp., Ont. Claim 358270

COLLAR: LAT. L 820 W

DEP. 1700' W of D.L. 7

ELEV. Surface

BEARING N 87° W

DIP -55.5°

Test at 200' -51°

DEPTH OF HOLE 524'

STARTED Oct. 11, 1973.

COMPLETED Oct. 18, 1973.

DRILLED BY Brady Bros.

Core Size ANL

FROM	TO	DESCRIPTION	SAMPLE NO.	CORE FT.	% Ni
0	126'	CASING - OVERBURDEN			
126'	524'	PERIDOTITE			
		Soft, black with white noddles, slightly magnetic, fine seams of white carbonate at irregular angles to the core axis and 1% of total rock, fine grained lath like and fan shaped growths of calcite, rock has a semi corroded appearance due to alteration, serpentine on some fracture planes, rock is not seriously fractured, bluish tinge in places due to magnetite probably, scattered asbestos fibre. Dimethyl test used at one intervals and produced a mild pink with slow reaction time.			
		SAMPLES : From 185.5' - 190.5' to check for nickel as a result of the mild reaction to the nickel test.	2301	5.0	0.24
		From 285' - 290' as above	2302	5.0	0.22
		Clay seams occur periodically down to 270' depth. A conductor could be caused by one of these or be the contact between the overburden and the rock surface.			
		Dimethyl reacts pink all through the core until the end. Where a joint or fracture is present, it appears to be more noticeable.			
	524'	END OF HOLE.			

SIGNED

J. G. Willars
JACK G. WILLARS B.A.S.C., P. ENG

DIAMOND DRILL LOG

D. D. HOLE NO. 73 - 1

PROPERTY International Nickel Mines Ltd. (Canada)

PAGE 2

FROM	TO	DESCRIPTION	SAMPLE NO.	CORE FT.	Total Ni
		Mud seams 3" at 129.5', 1/8" at 130', 3" breccia with mud at 151'. At 276' evidence of clay.			
		Additional sampling - core homogeneous, taken for further checks.			
		From 135' - 140'	2303	5	0.25
		From 210' - 215'	2304	5	0.23
		From 310' - 315'	2305	5	0.24
		From 395' - 400'	2306	5	0.23
		From 450' - 455'	2307	5	0.22
		From 505.5' - 510.5'	2308	5	0.25

SIGNED _____

Jack G. Willars

JACK G. WILLARS B.A.S.C., P. ENG.

DIAMOND DRILL LOG

D. D. HOLE NO. 73 - 2

PROPERTY International Regal Lines Ltd.

PAGE 1

LOCATION Man Tap. (Claim 358269)

DEPTH OF HOLE 517'

COLLAR: LAT. D.I. No. 1

STARTED Oct. 20, 1973.

DEP. 300' N

Test at 300' -52.5°

COMPLETED Oct. 21, 1973.

ELEV. Surface

DRILLED BY Bradley Bros.

BEARING N 89° W

Core Size AJNL

DIP -51.5°

FROM	TO	DESCRIPTION	SAMPLE NO.	CORE FT.
0	131'	CASING - OVERBUNDEN		
131'	517'	<p>PERIDOTITE</p> <p>As in 73 - 1, slightly more magentic. From 131' - 118' is more fractured with serpentine filling. At 154' is a 4" rad seam. From 212' - 218' is more fractured and serpentine filled. Texture grades from fine grained to medium grained intermittently with approximately 20' fine grained sections. Upon application of nickel test, the reaction is very slow and mild, less than in 73 - 1. From 430' - 490.5' is a rad breccia at 20° to the core axis. From 472' - 473' is a predominant serpentized rad seam. Seams and fractures in this area are at small angles to the core axis. Ground core from 460' - 487'. Near the end the core is good unfractured rock.</p> <p>END OF HOLE.</p>		

SIGNED

Jack G. Willars

JACK G. WILLARS B.A.S.C., P. ENG.

DIAMOND DRILL LOG

D. D. HOLE NO. ~~73-2~~

PROPERTY International Nickel Mines Ltd. (Mann Typ.)

PAGE 2

OM	TO	DESCRIPTION	SAMPLE NO.	CORE FT.	% Total Ni
		Check sampling -			
		From 115° - 150° Fine grained section	2309		0.12
		From 200° - 205° Medium grained area	2310		0.11
		From 255° - 260° Fractured fine to medium grained	2311		0.10
		From 310° - 315° Fine to medium grained	2312		0.11
		From 365° - 370° Fractured medium grained	2313		0.11
		From 420° - 425°	2314		0.11
		From 475° - 480°	2315		0.11
		From 530° - 535° $\frac{1}{2}$ " very fine grained black band at 35° to the core axis.	2316		0.12

SIGNED

Jack G. Willars

JACK G. WILLARS B.A.SC., P. ENG.

DIAMOND DRILL LOG

D. D. HOLE NO. 73 - 3

PAGE 1

PROPERTY INTERNATIONAL NIOGUL MINES LTD.

LOCATION Mann Trp., Ont. Claim 350268

COLLAR: LAT. L 1000 S

DEP. 650' W. of D.L. No. 3

ELEV. Surface

BEARING N 07° W
DIP -50° 10'

Test at 200' -10°

DEPTH OF HOLE 199'

STARTED Oct. 26, 1973

COMPLETED Oct. 31, 1973

DRILLED BY Bradley Bros.

Core Size AGUL

FROM	TO	DESCRIPTION	SAMPLE NO.	CORE FT.	Total Bl
0	120'	CASING			
120'	199'	PERIDOTITE			
		As in 73 - 1 and 73 - 2, homogeneous but fine grained, relatively minor fracturing in general, minor serpentine. Nickel test reacts readily as in 73 - 1. At 230' and 236' there is 1" of incipiently brecciated material. From 230' - 334' the core is very finely cemented with tension fractures. Sparse fine grained black bands occur at 15° and 35° to the core axis. Sparse asbestos was observed. From 366' - 417' the core is badly broken up. At 411.5' there is a 2" shearing with serpentine.			
		Check samples :			
		135' - 140' two 1/4" fine black seams	2317	5	0.25
		185' - 190'	2318	5	0.28
		210' - 215'	2319	5	0.18
		290' - 295' very small Ni. reaction	2320	5	0.16
		310' - 315' "	2321	5	0.20
		395' - 400' "	2322	5	0.25
		417' - 452'	2323	5	0.29
		494' - 499'	2324	5	0.29
199'		END OF HOLE.			

SIGNED

Jack G. Willars

JACK G. WILLARS B.A.S.C., P. ENG

DIAMOND DRILL LOG

D. D. HOLE NO. 73-4

PROPERTY INTERNATIONAL NIOGUL MINES LTD.

PAGE 1

LOCATION Hann Twp., Ont. Claim 68504

COLLAR: LAT. 1300' N

DEP. L 12 E., B.L. No. 6

ELEV. Surface

Test at 200' 120

BEARING S 30° W

DIP 50° 35'

DEPTH OF HOLE 474'

STARTED Nov. 3, 1973

COMPLETED Nov. 6, 1973

DRILLED BY Bradley Bros.

Core Size ANIL

FROM	TO	DESCRIPTION	SAMPLE NO.	CORE FT.	% Total Ni.
0	84'	CASING			
84'	127'	VOICANICS Very hard, fine grained, olive green colour, ghosty banding at 60° to the core, glassy textured. Intermediate volcanics. The top 3' is very badly fractured and muddy.			
127'	142'	VOICANICS Softer than the above, fine grained, black, non-magnetic. May be an altered sill rock or most likely is basic volcanics.			
142'	151'	VOICANICS Light green, hard, fine grained with quartz banding at 70° to the core axis. Bottom contact sheared for 1/2" and at 30° to the core axis.			
151'	181'	VOICANICS Ugly looking rock, black mottles in a dark green background, non-magnetic. Black mottles may be chlorite alteration. ? altered gabbro or diorite. Basic volcanics.			
181'	213'	PERIDOTITE Medium soft with fine grained quartz eyes in olive green matrix, slightly magnetic. Very broken up core. From 187' - 190' is muddy as is 210' - 211'. Faint reaction to the nickel test.			
213'	474'	PERIDOTITE Black, fine to medium grained, as in holes 73 - 1,2,3, regular core, slightly magnetic. Pink reaction to the nickel test is mild. From 311' - 314' is an inclusion of rock as in 161' - 161'. More serpentine as go deeper but still not as much as in earlier holes. From 332' - 405' the core is very broken up and muddy.			
		Check samples :			
		227' - 232'	2325	S	0.28
		232' - 237'	2326		0.23
		310' - 315'	2327		0.23
		395' - 400'	2328		0.23
		451' - 456'	2329		0.29
	474'	END OF HOLE.			

SIGNED Jack G. Willars
 JACK G. WILLARS B.A.Sc., P. ENG

DIAMOND DRILL LOG

D. D. HOLE NO. 73 - 5

PROPERTY INTERNATIONAL MINERAL WATERS LTD.

PAGE 1

LOCATION From Top, Ont. Chain 65538

DEPTH OF HOLE 359'

COLLAR: LAT. 43° 11'

STARTED Nov. 11, 1973

DEP. 2100 W. B.L. 6

Test at 200' = 42.5°

COMPLETED Nov. 17, 1973

ELEV. Surface

DRILLED BY Donley Inc.

BEARING S 29° W

Core Size AGL

DIP 75°

FROM	TO	DESCRIPTION	SAMPLE NO.	CORE FT.
0	60'	CASING		
60'	118'	PERidotite Contact zone, altered, slightly magnetic, dark green to black colour. Seams of white carbonate at 60' to the core axis. Patchy but severe alteration. Soft rock. From 81' - 93' is very fractured core with much alteration and fine carbonate and mud seams. At 97' 1" banded white carbonate at 70° to the core axis. No reaction to the nickel test when applied.		
118'	266.6'	VECONITE Somewhat massive, soft, waxy looking rock with brown to black nodules in a dark green base material. Appears to be altered but homogeneously. Much less magnetic than the above rock - just a very minute amount. Bluish hue colour to the rock. From 127' - 129' is fractured and soaked with carbonate. At 132' 1" waxy brecciated quartz - basalt. No reaction to nickel test - except at 150' where it was very mild pink and slow to react. This rock resembles the one in 73 - 10 at 151' - 161'.		
266.6'	273'	FINNESS DITE Very fine grained and very hard dark coloured rock with diagonal contacts at 15° to the core axis. Minor spots of brown mineral at lower contact which may be epidote. This is likely the cause of the conductor.		
273'	339'	VECONITE As above at 118' - 266.6'.		
	359'	END OF HOLE.		

SIGNED

Jack G. Willars

JACK G. WILLARS B.A.Sc., P. ENG

DIAMOND DRILL LOG

D. D. HOLE NO. 73 - 6

PROPERTY INTERNATIONAL MOGUL MINES LTD.

PAGE 1

LOCATION Mam Tep. Claim 69530

DEPTH OF HOLE 369'

COLLAR: LAT. 2315 N

STARTED Nov. 18, 1973.

DEP. 2200' W on D.L. No. 6

COMPLETED Nov. 20, 1973.

ELEV. Surface

Test at 200' -44°

DRILLED BY Brailley Bros.

BEARING S 30° W

Core Size AQWL

DIP -50°

FROM	TO	DESCRIPTION	SAMPLE NO.	CORE FT.	% total Ni
0	42'	CASING			
42'	159'	PERIDOTITE Not homogeneous, slightly magnetic, fine grained, black rock, medium soft, very broken up core, moderately scamed with fine carbonate and serpentine. Core is weathered down to 87'. From 42' - 57' thin white mottles are spattered on the rock - ? some type of alteration. From 57' - 67' olivene green colour, finely banded and tends to be schistose. Contact appears to be at 30° to the core axis. Nickel test reacts nil except in the last 20'. Sample : 152' - 157' Possibly this section of core represents the contact area with volcanics and also is the cause of the conductor.	2330	5	0.30
159'	369'	PERIDOTITE Homogeneous, medium grained dark green to black with light green mottling, massive looking, slightly magnetic, medium soft in hardness. Nickel test reacts more rapidly than the above section at 12' - 159'. Samples : 202' - 207' 250' - 255' 310' - 315' 325' - 330'	2331 2332 2333 2334	5 5 5 5	0.27 0.23 0.23 0.22
	369'	END OF HOLE.			

SIGNED

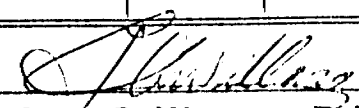

JACK G. WILLARS B.A.S.C., P. ENG

DIAMOND DRILL LOG

#131

MANN TWP.

D. D. HOLE NO. 73-8

PROPERTY INTERNATIONAL MOGUL MINES LTD.

PAGE 1

LOCATION Mann Twp., Ont. Claim 347083

COLLAR: LAT. L 2100 S

DEP. 1150' W of P.L. No. 2

ELEV. Surface

BEARING N 87° W

DIP 50°

Test at 200' -48°

DEPTH OF HOLE 167'

STARTED Nov. 20, 1973.

COMPLETED Dec. 3, 1973.

DRILLED BY Bradley Inc.

Core Size AQIL

FROM	TO	DESCRIPTION	SAMPLE NO.	CORE FT.
0	96'	CASING		
96'	173'	GABBRO Medium grained, hard, white-green mottled rock weathered down to 111'. White feldspar in 35% amount of rock, dark and light green mafics 65% of rock, minor accessory pyrite. From 112' - 173' is very vuggy rock and blocky core near the contact zone. Ground core from 152' - 165' (4' of core) and 165' - 173' (1.5' of core). The core is well fractured with the fractures close together. No reaction with the nickel test.		
173'	195'	RYHOLITE PORPHYRY Stretched angular pinkish phenocrysts in a pink to purple fine grained ground mass with ghostly banding at 80° to the core axis. Contact is at 80°. Very hard rock. Very little or no fracturing.		
195'	268'	DACITE Intermediate to basic medium grained mottled volcanic rock - 10% intruded by quartz veinlets at 80° to the core axis in general although locally irregularly. Moderate fracturing. At 213' - 7" containing brownish spots. Appears that silicification has bleached the original rock. Not as hard as the rhyolite, but hard. Volcanic fragments occur in the quartz in places.		
268'	274.5'	RYHOLITE PORPHYRY As above at 173' - 195'.		
274.5'	292'	DACITE As above but with more pronounced banding at 80°- 90° to the core axis.		
292'	305'	RYHOLITE PORPHYRY As above at 173' - 195' with two small horses of dacite included.		
305'	308.5'	BRECCIA Quartz chunks and dacite chunks loosely cemented together. Devoid of metallic minerals.		
308.5'	339'	DACITE As above at 195' - 268'. The banding at the lower contact is closer to 45° to the core axis.		

SIGNED

Jack G. Willars

JACK G. WILLARS B.A.Sc., P. ENG

DIAMOND DRILL LOG

D. D. HOLE NO. 73-8

PROPERTY OF INTERNATIONAL NICOL MINES LTD. (Mann-Twp.)

PAGE 2

FROM	TO	DESCRIPTION	SAMPLE NO.	CORE FT.
339'	385'	DIORITE Massive, medium grained granular volcanic rock, black with crystalline white feldspar in patches. Only 5% quartz inclusions which is very irregular and veinlike. Not much bleaching.		
385'	413'	DACTITE Volcanics as above at 195' - 268'. Banding at 50° to the core axis. Contact area is very broken up core from 385' - 396'.		
413'	467'	DIORITE As above at 339' - 385'. Very good coring.		
	467'	END OF HOLE.		

SIGNED



JACK G. WILLARS B.A.SC., P. ENG.

DIAMOND DRILL LOG

D. D. HOLE NO. 73 - 9

PROPERTY INTERNATIONAL MOGUL MINES LTD.

PAGE 1

LOCATION Mann Twp. Ont., Claim 347870

COLLAR: LAT. L 5075' S

DEP. 3250' W of B.L. No. 2

ELEV. Surface

BEARING S 67° W

DIP 50°

Test at 250' -41.50

DEPTH OF HOLE 552'

STARTED Dec. 5, 1973.

COMPLETED Dec. 9, 1973.

DRILLED BY Bradley Bros.

Core Size ANL

FROM	TO	DESCRIPTION	SAMPLE NO.	CORE FT.
0	204'	CASING		
204'	552'	ANDESITE Medium green coloured volcanic rock with various grain sizes, hard to medium hard cut by a few irregular quartz veinlets and by many fine seams of quartz which are sometimes drag folded in minute size. Sections of chlorite alteration in spots occur. From 277.5' - 278.3' mildly vuggy and sheared section with soft corroded carbonate. At 419' 1" white quartz vein at 45° to the core axis. From 411' - 414' Contorted scjistic section - shearing From 498.3' & 498.8' & 499.1' - 499.7' Contorted sheared sections at 45° to the core axis with siliceous filling. From 527.2' - 528.4' rusty broken up section of core.		
	552'	END OF HOLE		

SIGNED *J. G. Willars*
 JACK G. WILLARS B.A.S.C., P. ENG

DIAMOND DRILL LOG

#129
MANN TWP.

D. D. HOLE NO. 73-10

PROPERTY INTERNATIONAL HOGUL MINES LTD.

PAGE 1

LOCATION Mann Twp., Ont. Claim 358242

COLLAR: LAT. 2000 N

DEP. 3200 W. of B.L. No. 5

ELEV. Surface

BEARING S 50° W

DIP 53° 30'

Test at 200' -52°

DEPTH OF HOLE 110'

STARTED Dec. 11, 1973.

COMPLETED Dec. 13, 1973.

DRILLED BY Bradley Bros.

Core Size AQWL

FROM	TO	DESCRIPTION	SAMPLE NO.	CORE FT.	
0	122.5'	CASING			
122.5'	166'	VOLCANICS Diorite. Schistic banding at 70° to the core axis. Light green coloured mafics with white feldspars stretched. Medium hardness and cut by irregular fine white quartz-carbonate seams. Pyrrhotite in 1/4" quartz-carbonate at 126'.			
166'	172'	MINERALIZED TUFF Hard, light gray coloured rock with banding at 70° to the core axis and mineralized with pyrrhotite and minor chalcopyrite. SAMPLE : At 166' - 172' As above. Core not split - whole core taken.	1801	6	0.01% Ni 0.04% Cu nil oz. Au nil oz. Ag
172'	259.5'	VOLCANICS As above at 122.5' - 166'. From 201' - 206' is a well brecciated section. From 210' - 212' is a bleached section with a vuggy 1" ? fault at bottom end.			
259.5'	286.5'	MINERALIZED TUFF As above at 166' - 172' containing a horse of bleached volcanics from 262' - 264'. SAMPLE : 264' - 271' Mineralized with pyrrhotite chiefly. No mineralization to speak of in the section above otherwise. Whole core taken - not split.	1802	7	- % Ni 0.04% Cu 0.005 oz. Au nil oz. Ag
286.5'	316'	VOLCANICS As above at 122.5' - 166' but much altered. This is an altered contact zone. Contains quartz-carbonate stringers.			
316'	386'	PERIDOTITE Slightly magnetic black rock same as in previous holes.			
386'	400'	VOLCANICS Light grey to white coloured rock with ghostly banding at 50° to the core axis. Chunks of chlorite included. Grades to olive green andesite with quartz-carbonate stringers. Smears of H_2S_2 and FeS_2 on chloritized slip at 399'.			
400'	110'	PERIDOTITE As above at 316' - 386'. Gradational contact.			
	110'	END OF CORE.			

SIGNED

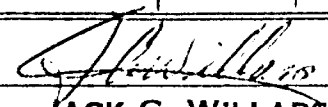

JACK G. WILLARS B.A.S.C., P. ENG.

DIAMOND DRILL LOG

D. D. HOLE NO. 73-11

PROPERTY INTERNATIONAL MOGUL MINES LTD.

PAGE 1

LOCATION Yann Twp., Ont. Claim 358210

DEPTH OF HOLE 101'

COLLAR: LAT. 100 N.

STARTED Dec. 16, 1973

DEP. 650 W of B.L. No. 5

COMPLETED Jan. 10, 1974

ELEV. Surface

Test at 300' -1.8°

DRILLED BY Bradley Bros.

BEARING S 50° W

Core Size AQNL

DIP 55° 10'

FROM	TO	DESCRIPTION	SAMPLE NO.	CORE FT.
0	253'	CASING		
253'	101'	<p>GRANITE GNEISS</p> <p>50% pink feldspar, 30% quartz, 20% hornblende. Quartz eyes with stretched phenocrysts of pink feldspar (3/8" largest and scarce - mainly 1/8" to 1/4") hornblende laths 1/4" to 3/8" long which is 50% altered to chlorite. Gneissosity is at 60° to the core axis. Porphyritic. From 321' - 324' open vuggy fracture running along the core with chlorite smeared on face. No. metallics. From 357' to 368' 1' fracture along the core which is chlorite smeared. At 385' 2" irregular barren white quartz vein with sparse hematite smears. Gneissosity gradually changes to angle of 80° to the core axis near 387'. Also pink feldspar increases in amount and quartz decreases as hole deepens. Phenocrysts get larger as bottom nears. From 387' to 391' Gneissosity at 1.5° the changes to 60° to the core axis - mild contortion.</p>		
	101'	END OF HOLE.		

SIGNED  JACK G. WILLARS B.A.S.C., P. ENG

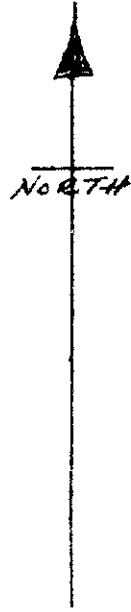

LOT 4

LOT 3

LOT 2

LOT 12

CONC III

CONC II

CONC III

CONC II

CONC I

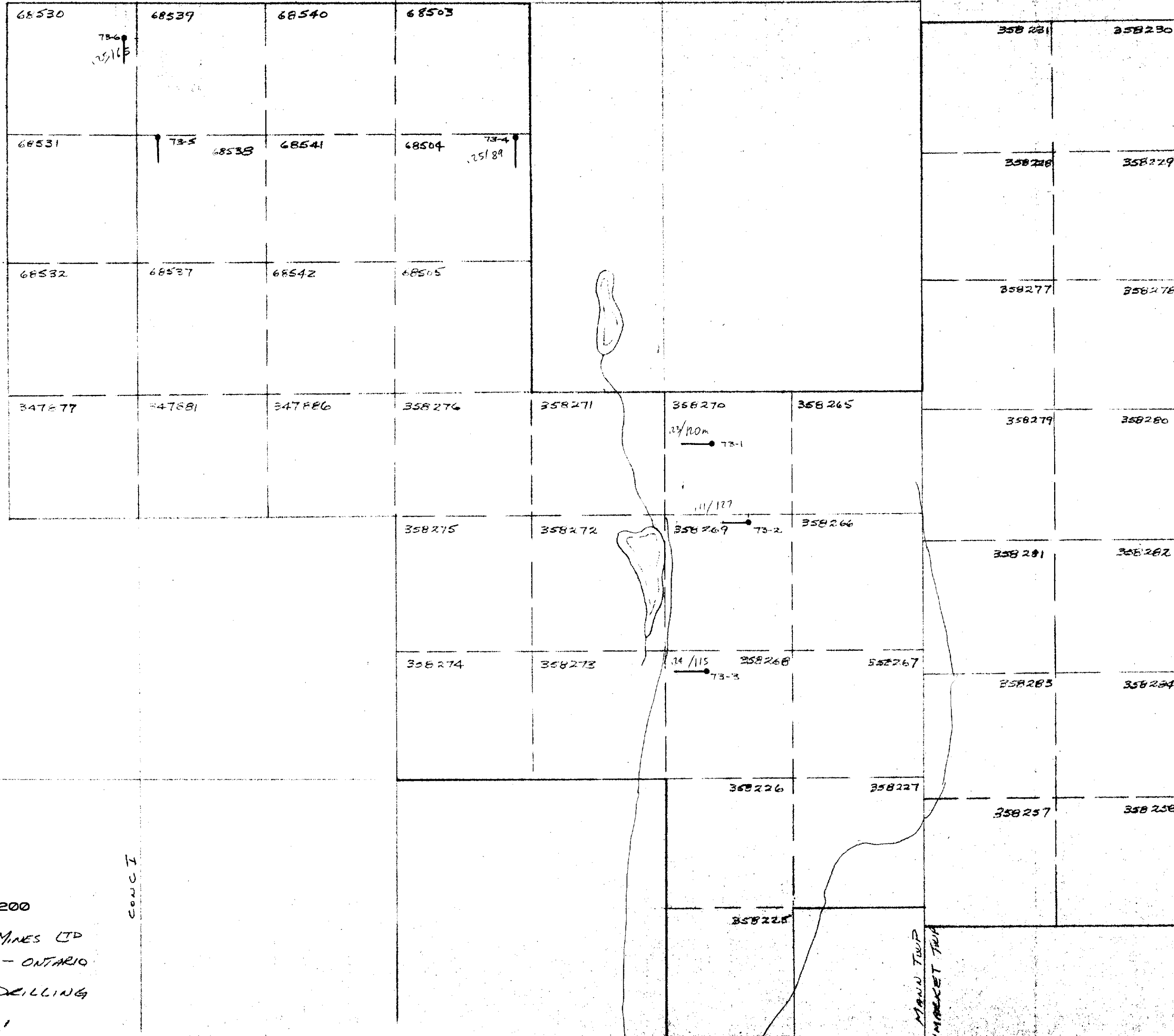

200

INTERNATIONAL MOGUL MINES LTD
MANN & NEWMARKET TWP - ONTARIO
PLAN OF DIAMOND DRILLING

SCALE 1" = 800'

Mann Twp D.D # 24

LOT 4

LOT 3

LOT 2

LOT 1

CONC II

CONC I

MAIN TWP
NEWMARKET TWP

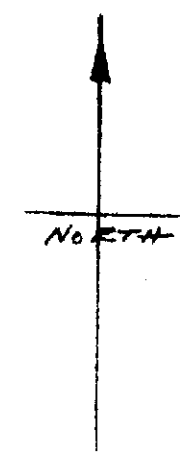

80-533

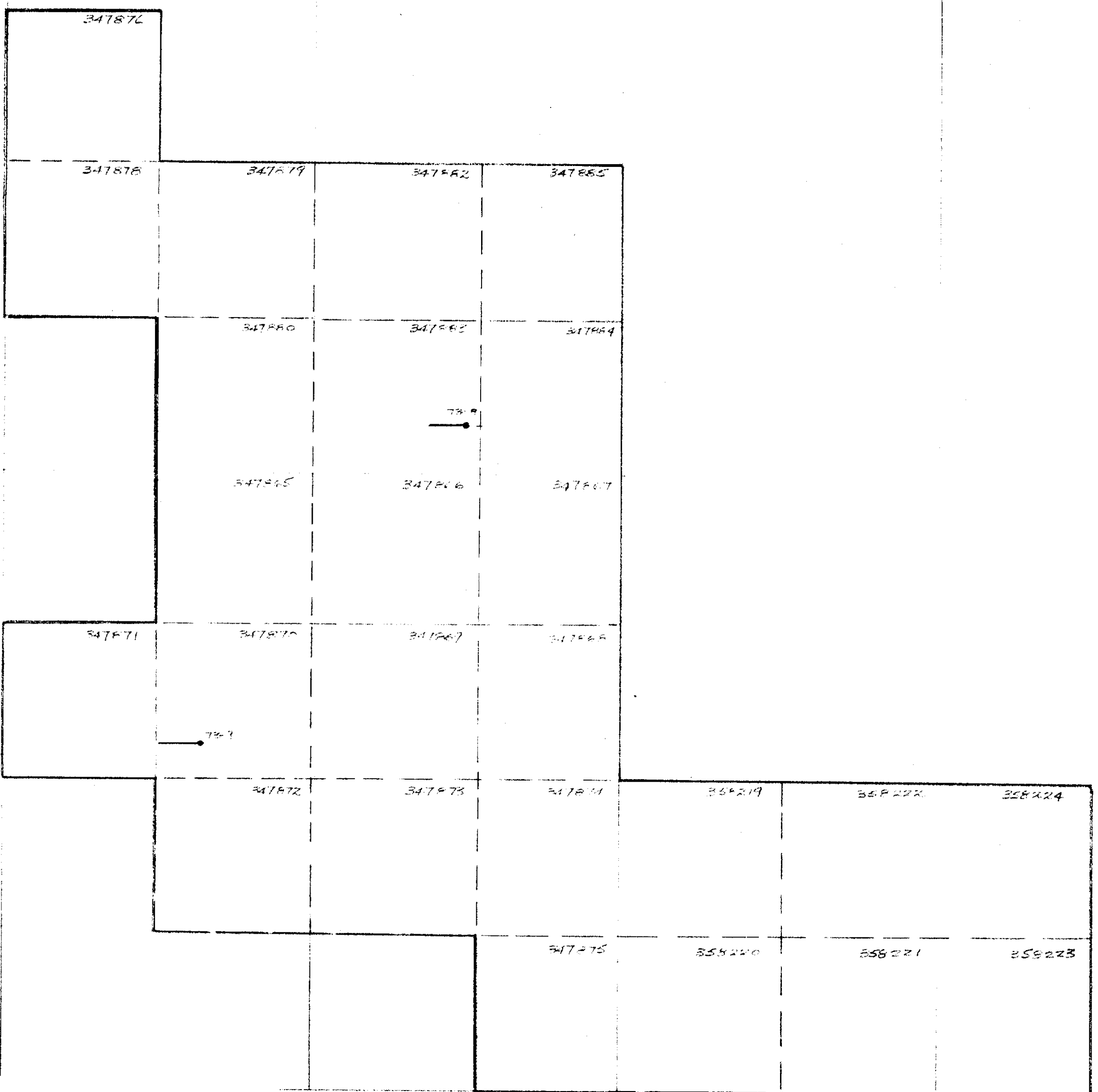

INTERNATIONAL MUGUL MINES LTD
MINING NEWMARKET TWPS - ONTARIO

PLAN OF DIAMOND DRILLING
SCALE 1" = 800'

MAIN TWP
LITTLE TWP



PLAN TO DRAIN DRAINAGE
MANN & NEIGHBORHOOD TOWNSHIP
INTERNATIONAL MACHINERY LTD

