



42A15SW2011 2.20401 McCART

010

PROVINCIAL RECORDING
 OFFICE - SUDBURY
RECEIVED
 JUL 07 2000
 A.M. 10:45 *mm* P.M.
 7 | 8 | 9 | 10 | 11 | 12 | 1 | 2 | 3 | 4 | 5 | 6

Geochemical Analyses
 McCart Township Property
 McCart Township
 Porcupine Mining Division

June, 2000

RECEIVED
 JUL 07 2000 *mm*
 GEOSCIENCE ASSESSMENT
 OFFICE

D. R. Pyke

2.20401

Geochemical Analyses
McCart Township Property
McCart Township
Porcupine Mining Division

General Statement

On June 5, 2000, D. Pyke collected five samples from an outcrop area of dunite/peridotite on mining claims P1090035 and P1226413, in lot 6, Conc 5, McCart Township, located approximately 55 km northeast of Timmins (Figure 1). This outcrop area forms part of a larger area of contiguous claims (26 claim units) currently held by D. Pyke and K. Cunnison (Figure 2). A number of reports have previously been submitted relating to the geology of the property which is considered to be favorable for Cu-Ni-PGE mineralization.

It was in 1916 that Baker (1917) reported on the O'Connor nickel occurrence (3 % Ni) at an ultramafic sill- mafic volcanic contact (Figure 3). Previous sampling of the showing, by the current claim owners, has returned only anomalous values of Ni-Cu. The sulphides are seen to consist predominantly of pyrrhotite with minor chalcopyrite and pentlandite and occur as fine disseminations forming 2-5 percent of the rock or more commonly as an interlocking net textured sulphide forming 15-20 percent of the rock over widths of up to 0.5 m. All the samples within this zone contained at best only weakly anomalous Pt-Pd values (16-69 ppb PGE) - see Cunnison and Pyke, 1994.

The massive dunite/peridotite at the south margin of the property had not previously been assayed for Pt/Pd and that was the purpose of this present sampling. The location of the samples are shown in Figure 3. All the samples consist of massive, light grey weathering, fine grained, dark green black serpentinized olivine-rich peridotite to dunite. A trace of pyrite in sample MC-01 was the only sulphide observed. Most samples also contained minor serpentine as a light green, brittle variety, along narrow fracture surfaces. MC-05 was a composite sample containing much of the brittle serpentine.

The analytical results are appended and only sample MC-01 contained minor detectable PGE's (Pt - 12 ppb, Pd - 14 ppb), and was the only sample noted to contain a trace of sulphide.

A Max-Min survey is planned for portions of the claim group later in the summer.

July 6/2000
Date

D. R. Pyke
D. R. Pyke

References

Baker, M. VB.

1917: Ontario Bureau of Mines, Vol. 26, p. 270-271

Cunnison, K. M. and Pyke, D. R.

1994: Geological report, McCart Township Property, Porcupine Mining Division; Assessment Rept., 62p.

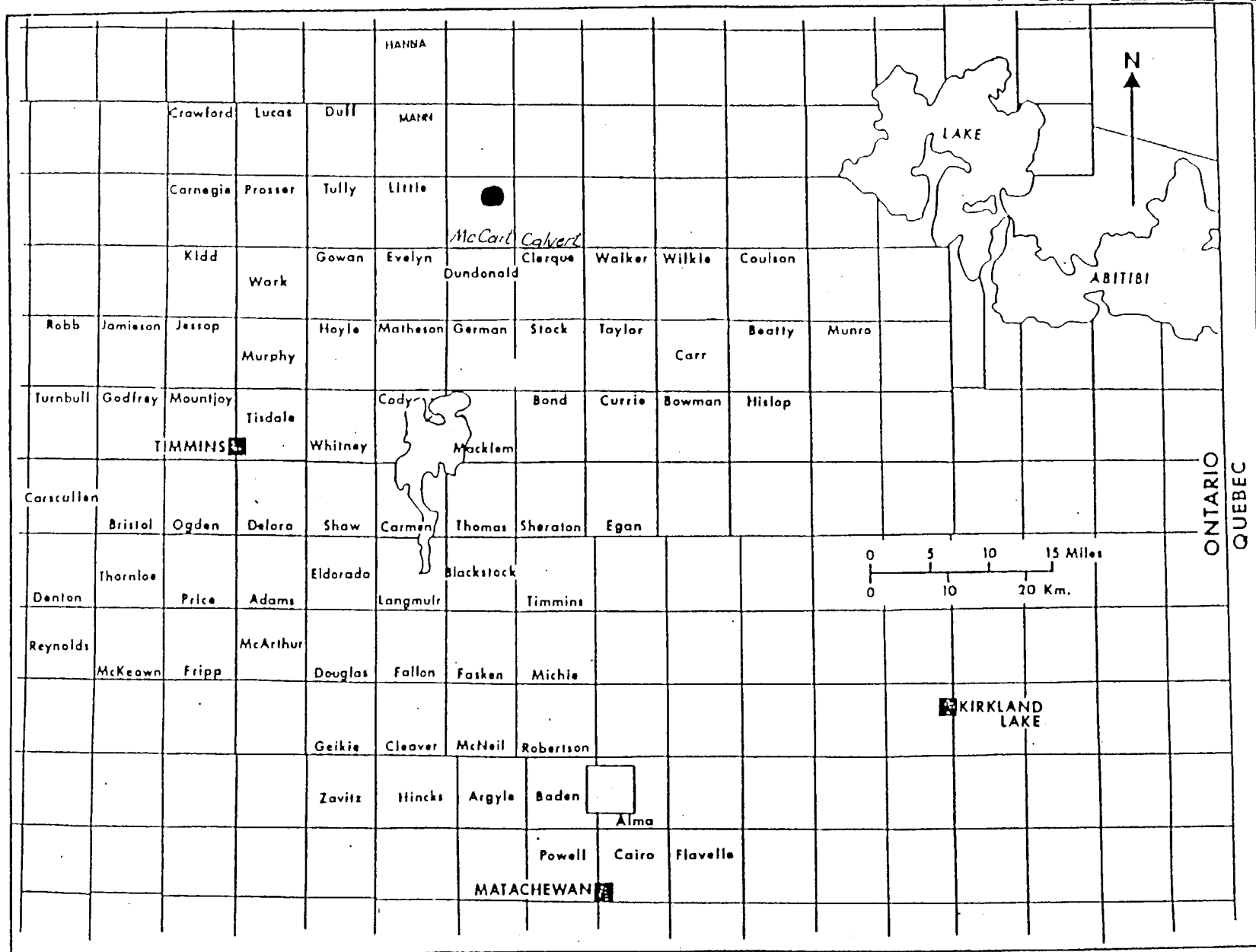

Figure 1: Location of McCart Township Property

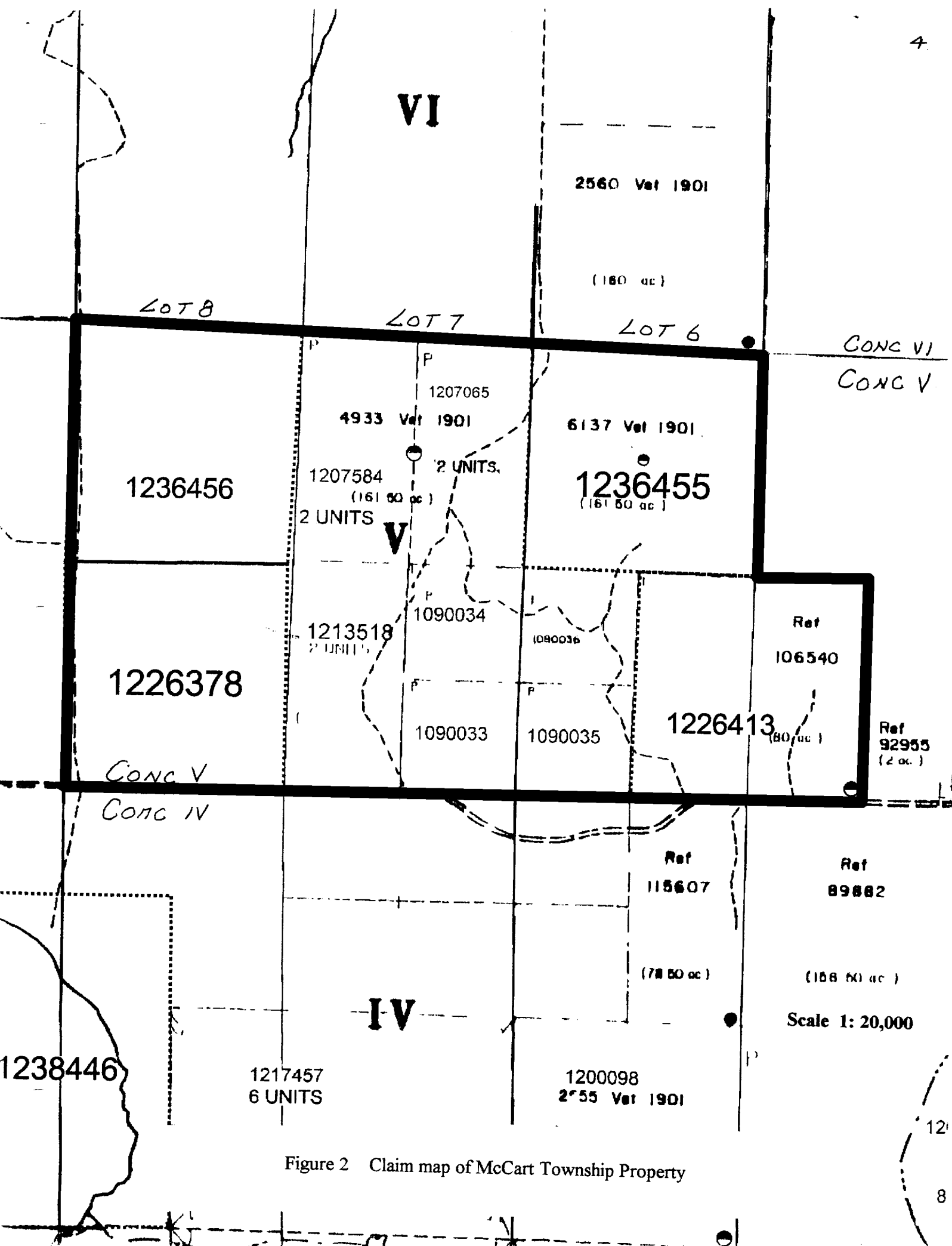

Figure 2 Claim map of McCart Township Property

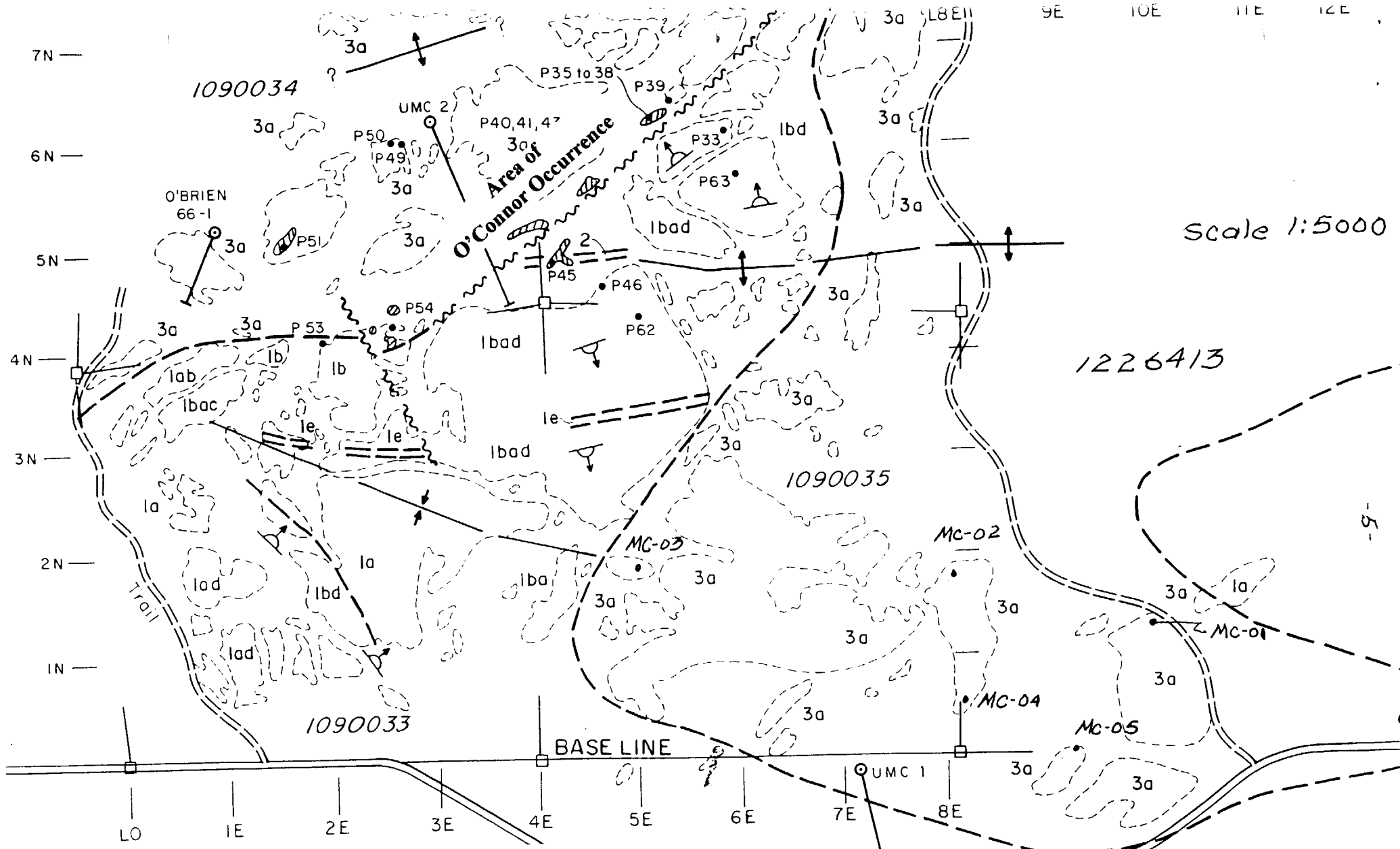

Figure 3 Geological map of portion of McCart Property, showing sample locations. For details of geology see Cunnison and Pyke, 1994.

- | | | | | |
|-------|--|-------|---|--|
| LOT 7 | | LOT 6 | 1 | Basaltic komatiite |
| LOT 7 | | LOT 6 | 3 | Ultramafic intrusion (dunite/peridotite) |



Established 1928

Swastika Laboratories Ltd

Assaying - Consulting - Representation

Geochemical Analysis Certificate

0W-1970-RG1

Company: **D.R. PYKE**

Date: JUN-19-00

Project:

Attn: D.R. Pyke

We hereby certify the following Geochemical Analysis of 5 Rock samples submitted JUN-13-00 by .

| Sample Number | Pt PPB | Pd PPB |
|---------------|-----------|-----------|
| MC-01 | 12 | 14 |
| MC-02 | <5 | <5 |
| MC-03 | <5 | <5 |
| MC-04 | <5 | <5 |
| MC-05 | <5 | <5 |

One assay ton portion used.

Certified by

Declaration of Assessment Work Performed on Mining Land

Minina Act. Subsection 65(2) and 66(3), R.S.O. 1990

| |
|--|
| Transaction Number (office use) W0000.00305 |
| Assessment Files Research Imaging |

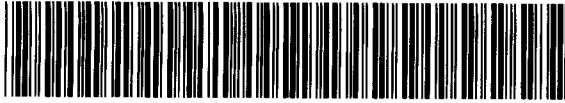

42A15SW2011 2.20401 McCART 900

Sections 65(2) and 66(3) of the Mining Act. Under section 8 of the Mining Act, this work and correspond with the mining land holder. Questions about this collection sent and Mines, 3rd Floor, 933 Ramsey Lake Road, Sudbury, Ontario, P3E 6B5.

Instructions: - For work performed on Crown Lands before recording a claim, use form 0240.
- Please type or print in ink.

1. Recorded holder(s) (Attach a list if necessary)

| | |
|---|---|
| Name <i>DALE R. PYKE</i> | Client Number <i>184975</i> |
| Address <i>31 DELAIR CRES THORNHILL, ONT L3T 2M3</i> | Telephone Number <i>905-731-1913</i> |
| | Fax Number <i>905-731-1913</i> |
| Name <i>K.M. CUNNINGSON</i> | Client Number <i>123055</i> |
| Address <i>APT 707 540 PROUDFOOT LANE LONDON ONT N6H 1W4</i> | Telephone Number <i>519-657-1386</i> |
| | Fax Number |

2. Type of work performed: Check (✓) and report on only ONE of the following groups for this declaration.

Geotechnical: prospecting, surveys, assays and work under section 18 (regs)
 Physical: drilling stripping, trenching and associated assays
 Rehabilitation

| | |
|---|---|
| Work Type <i>ASSAYS</i> | Office Use |
| | Commodity |
| | Total \$ Value of Work Claimed <i>\$ 363</i> |
| Dates Work Performed From Day <i>5</i> Month <i>06</i> Year <i>2000</i> To Day <i>6</i> Month <i>07</i> Year <i>2000</i> | NTS Reference |
| Global Positioning System Data (if available) | Mining Division <i>Porcupine</i> |
| Township/Area <i>MC CART</i> | Resident Geologist District <i>Jimmins</i> |
| M or G-Plan Number <i>G-3541</i> | |

Please remember to: - obtain a work permit from the Ministry of Natural Resources as required;
- provide proper notice to surface rights holders before starting work;
- complete and attach a Statement of Costs, form 0212;
- provide a map showing contiguous mining lands that are linked for assigning work;
- include two copies of your technical report.

3. Person or companies who prepared the technical report (Attach a list if necessary)

| | |
|--|---|
| Name <i>D. R. Pyke</i> | Telephone Number <i>905-731-1913</i> |
| Address <i>31 DELAIR CRES THORNHILL ONT L3T 2M3</i> | Fax Number <i>905-731-1913</i> |
| Name | Telephone Number |
| Address | Fax Number |
| Name | Telephone Number |
| Address | Fax Number |

4. Certification by Recorded Holder or Agent

I, *D. R. Pyke* (Print Name), do hereby certify that I have personal knowledge of the facts set forth in this Declaration of Assessment Work having caused the work to be performed or witnessed the same during or after its completion and, to the best of my knowledge, the annexed report is true.

| | |
|--|---|
| Signature of Recorded Holder or Agent <i>D. R. Pyke</i> | Date <i>July 6, 2000</i> |
| Agent's Address <i>31 DELAIR CRES THORNHILL ONT</i> | Telephone Number <i>905-731-1913</i> |
| | Fax Number <i>905-731-1913</i> |

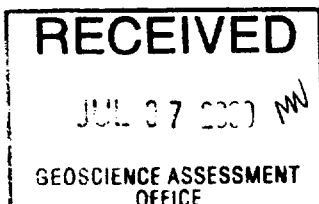

5. Work to be recorded and distributed. Work can only be assigned to claims that are contiguous (adjoining) to the mining land where work was performed, at the time work was performed. A map showing the contiguous link must accompany this form.

00060.00305

| Mining Claim Number. Or if work was done on other eligible mining land, show in this column the location number indicated on the claim map. | Number of Claim Units. For other mining land, list hectares. | Value of work performed on this claim or other mining land. | Value of work applied to this claim. | Value of work assigned to other mining claims. | Bank. Value of work to be distributed at a future date |
|---|--|---|--------------------------------------|--|--|
| eg TB 7827 | 16 ha | \$26,825 | N/A | \$24,000 | \$2,825 |
| eg 1234567 | 12 | 0 | \$24,000 | 0 | 0 |
| eg 1234568 | 2 | \$ 8,892 | \$ 4,000 | 0 | \$4,892 |
| 1 1090035 | 1 | 150 | 0 | 150 | 0 |
| 2 1226413 | 4 | 213 | 0 | 213 | 0 |
| 3 1213518 | 2 | 0 | 363 | 0 | 0 |
| 4 | | | | | |
| 5 | | | | | |
| 6 | | | | | |
| 7 | | | | | |
| 8 | | | | | |
| 9 | | | | | |
| 10 | | | | | |
| 11 | | | | | |
| 12 | | | | | |
| 13 | | | | | |
| 14 | | | | | |
| 15 | | | | | |
| Column Totals | 7 | 363 | 363 | 363 | 0 |

I, DALE Fyke (Print Full Name), do hereby certify that the above work credits are eligible under subsection 7 (1) of the Assessment Work Regulation 6/96 for assignment to contiguous claims or for application to the claim where the work was done.

Signature of Recorded Holder or Agent Authorized in Writing

DK Fyke

Date

July 6/2000

6. Instructions for cutting back credits that are not approved.

Some of the credits claimed in this declaration may be cut back. Please check (✓) in the boxes below to show how you wish to prioritize the deletion of credits:

- 1. Credits are to be cut back from the Bank first, followed by option 2 or 3 or 4 as indicated.
- 2. Credits are to be cut back starting with the claims listed last, working backwards; or
- 3. Credits are to be cut back equally over all claims listed in this declaration; or
- 4. Credits are to be cut back as prioritized on the attached appendix or as follows (describe):

2.20401

Note: If you have not indicated how your credits are to be deleted, credits will be cut back from the Bank first, followed by option number 2 if necessary.

For Office Use Only

Received Stamp

| | |
|---|--------------------------------|
| Deemed Approved Date | Date Notification Sent |
| Date Approved | Total Value of Credit Approved |
| Approved for Recording by Mining Recorder (Signature) | |

0241 (03/97)

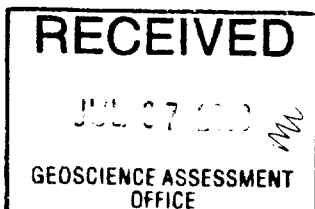



Statement of Costs for Assessment Credit

Transaction Number (office use) 00060.00305

Personal information collected on this form is obtained under the authority of subsection 6 (1) of the Assessment Work Regulation 6/96. Under section 8 of the Mining Act, this information is a public record. This information will be used to review the assessment work and correspond with the mining land holder. Questions about this collection should be directed to a Provincial Mining Recorder, Ministry of Northern Development and Mines, 3rd Floor, 933 Ramsey Lake Road, Sudbury, Ontario, P3E 6B5.

Table with 4 columns: Work Type, Units of work, Cost Per Unit of work, Total Cost. Includes entries for Collecting Samples, Report preparation, ASSAYS (5), and Transportation Costs.

Calculations of Filing Discounts: 1. Work filed within two years of performance is claimed at 100% of the above Total Value of Assessment Work. 2. If work is filed after two years and up to five years after performance, it can only be claimed at 50% of the Total Value of Assessment Work. TOTAL VALUE OF ASSESSMENT WORK x 0.50 = Total \$ value of worked claimed.

Note: - Work older than 5 years is not eligible for credit. - A recorded holder may be required to verify expenditures claimed in this statement of costs within 45 days of a request for verification and/or correction/clarification. If verification and/or correction/clarification is not made, the Minister may reject all or part of the assessment work submitted.

Certification verifying costs: I, DALE Pyke, do hereby certify, that the amounts shown are as accurate as may reasonably be determined and the costs were incurred while conducting assessment work on the lands indicated on the accompanying Declaration of Work form as Recorded holder/Agent I am authorized to make this certification.

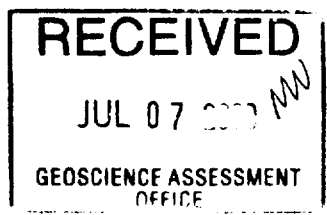

Signature: DR Pyke Date: July 6/2000

Geoscience Assessment Office
933 Ramsey Lake Road
6th Floor
Sudbury, Ontario
P3E 6B5

Telephone: (888) 415-9845
Fax: (877) 670-1555

August 24, 2000

DALE RANDOLPH PYKE
31 DELAIR CRESCENT
THORNHILL, ON
L3T-2M3

Dear Sir or Madam:

Submission Number: 2.20401

Status

Subject: Transaction Number(s): W0060.00305 Approval

We have reviewed your Assessment Work submission with the above noted Transaction Number(s). The attached summary page(s) indicate the results of the review. **WE RECOMMEND YOU READ THIS SUMMARY FOR THE DETAILS PERTAINING TO YOUR ASSESSMENT WORK.**

If the status for a transaction is a 45 Day Notice, the summary will outline the reasons for the notice, and any steps you can take to remedy deficiencies. The 90-day deemed approval provision, subsection 6(7) of the Assessment Work Regulation, will no longer be in effect for assessment work which has received a 45 Day Notice. Allowable changes to your credit distribution can be made by contacting the Geoscience Assessment Office within this 45 Day period, otherwise assessment credit will be cut back and distributed as outlined in Section #6 of the Declaration of Assessment work form.

Please note any revisions must be submitted in DUPLICATE to the Geoscience Assessment Office, by the response date on the summary.

If you have any questions regarding this correspondence, please contact BRUCE GATES by e-mail at bruce.gates@ndm.gov.on.ca or by telephone at (705) 670-5856.

Yours sincerely,



ORIGINAL SIGNED BY
Steve B. Beneteau
Acting Supervisor, Geoscience Assessment Office
Mining Lands Section

Work Report Assessment Results

Submission Number: 2.20401

Date Correspondence Sent: August 24, 2000

Assessor: BRUCE GATES

| Transaction Number | First Claim Number | Township(s) / Area(s) | Status | Approval Date |
|---------------------------|---------------------------|------------------------------|---------------|----------------------|
| W0060.00305 | 1090035 | MCCART | Approval | August 23, 2000 |

Section:

17 Assays ASSAY

Correspondence to:

Resident Geologist
South Porcupine, ON

Assessment Files Library
Sudbury, ON

Recorded Holder(s) and/or Agent(s):

DALE RANDOLPH PYKE
THORNHILL, ON

KIMBERLY MCCABE CUNNISON
LONDON, ONTARIO

REFERENCES

NOTE
 LOT AND CONCESSION LINES SHOWN HEREON ARE PROJECTED FROM THE BEST INFORMATION AVAILABLE, BUT THEIR TRUE POSITION IS NOT GUARANTEED

FOR LEGAL AND SURVEY PURPOSES CONSULT THE ORIGINAL SURVEY PLANS AND FIELD NOTES OF RECORD IN THE DEPARTMENT OF LANDS AND FORESTS, TORONTO

ACREAGES SHOWN IN RESPECT OF PATENTED LOTS ARE IN ACCORDANCE WITH AREA GRANTED

AREAS WITHDRAWN FROM DISPOSITION

| Order No. | Date | Disposition | File |
|-----------|------|---------------------------|------|
| M R D | | MINING RIGHTS ONLY | |
| S R D | | SURFACE RIGHTS ONLY | |
| M + S | | MINING AND SURFACE RIGHTS | |

Description: M R D, S R D, M + S
 Order No.: 100000
 Date: 10/27/70
 Disposition: M R D
 File: 100000

AGGREGATE PERMIT

The information that appears on this map has been compiled from various sources and accuracy is not guaranteed those wishing to stake mining claims or gold loan

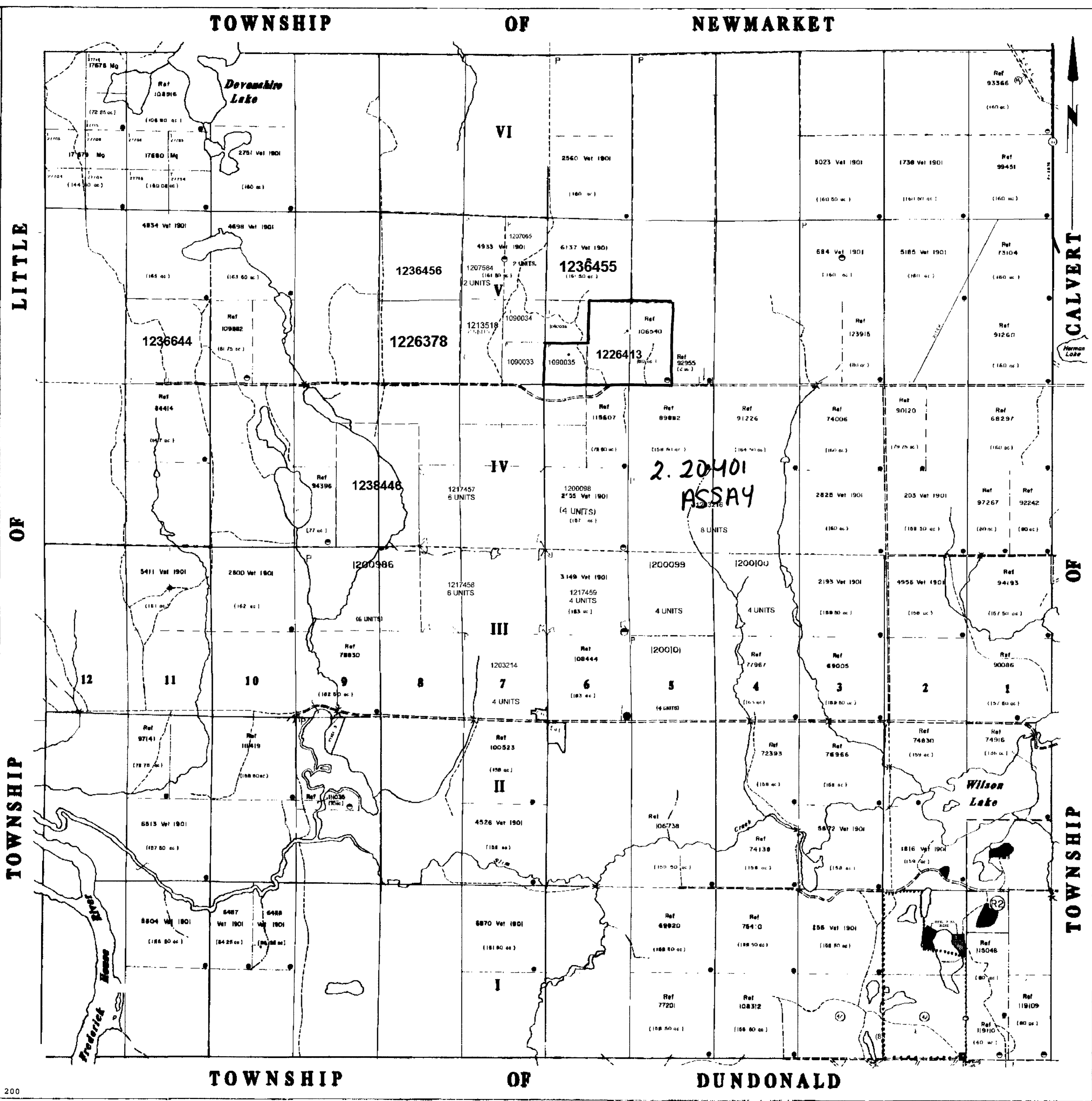

REFERENCES

TOPOGRAPHY
 LAKES, RIVERS, ETC. FROM FOREST RESOURCES INVENTORY SHEETS NO 486804 AND 487804

SURVEYS
 TOWNSHIP OF McCART SUBDIVIDED BY A D GRIFFIN, O.L.S., 1904 FIELD NOTE BOOK 1533
 WEST LIMIT OF McCART TOWNSHIP (SEE LITTLE TWP) SURVEY BY J.W. FITZGERALD, O.L.S., 1904 FIELD NOTE BOOK 1402
 EAST LIMIT OF McCART TOWNSHIP (SEE CALVERT TWP) SURVEY BY ALEXANDER BAIRD, O.L.S., 1904 FIELD NOTE BOOK 1009
 THIRD MERIDIAN (EAST LIMIT OF McCART TWP) BY WILLIAM GALBRAITH, O.L.S., 1904 FIELD NOTE BOOK 2363
 BASE LINE (SOUTH LIMIT OF McCART TWP) BY T.J. PATTEN, O.L.S., 1903 FIELD NOTE BOOK 2480

LEGEND

- HIGHWAY AND ROUTE No.
- OTHER ROADS
- TRAILS
- SURVEYED LINES
- TOWNSHIPS, BASE LINES, ETC.
- LOTS, MINING CLAIMS, PARCELS, ETC.
- UNSURVEYED LINES
- LOT LINES
- PARCEL BOUNDARY
- MINING CLAIMS ETC.
- RAILWAY AND RIGHT OF WAY
- UTILITY LINES
- NON-PERENNIAL STREAM
- FLOODING OR FLOODING RIGHTS
- SUBDIVISION OR COMPOSITE PLAN
- RESERVATIONS
- ORIGINAL SHORELINE
- MARSH OR MUSKEG
- MINES
- TRAVERSE MONUMENT

DISPOSITION OF CROWN LANDS

| TYPE OF DOCUMENT | SYMBOL |
|--------------------------------|--------|
| PATENT SURFACE & MINING RIGHTS | ● |
| SURFACE RIGHTS ONLY | ○ |
| MINING RIGHTS ONLY | ○ |
| LEASE SURFACE & MINING RIGHTS | ○ |
| SURFACE RIGHTS ONLY | ○ |
| MINING RIGHTS ONLY | ○ |
| LICENCE OF OCCUPATION | ○ |
| ORDER IN COUNCIL | ○ |
| RESERVATION | ○ |
| CANCELLED | ○ |
| SAND & GRAVEL | ○ |
| L. U. A. | ○ |

NOTE: MINING RIGHTS IN PARCELS PATENTED PRIOR TO 1904 ARE HELD VESTED IN ORIGINAL PATENTEES BY THE PUBLIC LANDS ACT R.S.O. 1970 CHAP. 306 SEC. 30 SUBSEC. 1 SEE SRT 9/11/71 WITHIN BOUNDARY

SCALE 1 INCH = 20 CHAINS

TOWNSHIP McCART

M.R.D. ADMINISTRATIVE DISTRICT
 COCHRANE
 MINING DIVISION
 PORCUPINE
 LAND TITLES / REGISTRY DIVISION
 COCHRANE

Ministry of Natural Resources and Mines
 Ontario

Date: July 1988
 Number: G-3541