

Fenton Scott Management Inc.

17 Malabar Place, Don Mills, Ontario M3B 1A4
416-444-1717

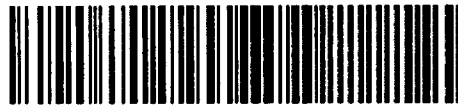

42A15SW8860 2.9590 CLERGUE

010

REPORT ON

AIRBORNE GEOPHYSICAL SURVEYS

MANN, NEWMARKET, LITTLE, MCCART, CALVERT
EVELYN, DUNDONALD, CLERGUE, GERMAN

TOWNSHIPS

ONTARIO

FOR

ANGELA DEVELOPMENTS LTD

BY

H. FERDERBER GEOPHYSICS

RECEIVED

DEC - 1 1986

DON MILLS, ONTARIO
November 29, 1986

MINING LANDS SECTION FENTON SCOTT, P. ENG.

INTRODUCTION

An airborne geophysical survey was carried out over a number of claim groups in nine townships in the Cochrane District of Ontario, by H. Ferderber Geophysics.

Data was collected on VLF and magnetometer responses. The survey was flown from a base at Timmins, Ontario.

PURPOSE OF SURVEY

The survey was designed to provide data which would:

1. Permit an interpretation of geological structures through recording variations in the magnetic mineral content of the formations underlying the areas.
2. Identify potentially economic mineral concentrations which may have marked variations in accessory magnetic minerals.
3. Identify linear structures, such as major shear zones, which may result in current concentrations of VLF signals. Such structures may contain economic minerals, notably precious metals.
4. Identify shallow, potentially valuable metallic sulfide deposits whose lower electrical resistances give resultant secondary VLF - EM fields.

SURVEY AREA

The survey covered a number of claim blocks in nine separate townships, Cochrane District, Ontario. The unpatented mining claims included in the survey are shown in an attached pocket.

EQUIPMENT

The aircraft used in the survey was a Cessna 172 owned and operated by H. Ferderber Geophysics. The sensors for geophysical data were mounted in modified wing tip installations.

Magnetometer The instrument used was a GEM GSM - 18 proton precession type. The sensitivity of the device was set at 2 gammas at a 1 second sampling rate. Analogue profiles were recorded on-board, on paper tapes.

VLF - EM System The instrument used was a Herz Totem 2 A. The total field and vertical resultant field was recorded on analogue tape. The line transmitter station for this survey was Cutler, Maine, (NAA) at a frequency of 24.0 kilohertz, with orthogonal signals measured from Seattle, Washington (NSA) at a frequency of 24.8 kilohertz.

SURVEY METHOD

The aircraft was flown at a terrain clearance of 300 feet and 500 feet. Navigation consisted of reference to an air mosaic, with manual fiducials recorded on the mosaic simultaneously with the geophysical tapes.

Line directions were North-South, and line spacing was one-twelfth mile (440 feet).

DATA PRESENTATION

Flight lines, fiducial points, and geophysical responses are shown on three sets of maps produced from air photo mosaics at a scale of 1/15, 840 (quarter mile). These maps also show the outlines of the claim group.

Vertical Gradient Magnetic Airborne profiles from surveys at elevations of 300 and 500 feet were compared. The differences between the total field at the two elevations are expressed on the contoured gradient plans with intervals of 0.5, 2.5 and 12.5 nanoteslas per meter.

Magnetic Contour Maps Correction of the areomagnetic data for diurnal variation was by reference to a cross-line. The corrected profiles were then reduced to appropriate field strength intervals, and presented as contours at 20 gamma intervals.

VLF - EM Maps The axes of conductivity were selected on each analogue tape, and transferred to the mosaics with reference to fiducial points. These axes are further discriminated between those conductors showing a variation on total field strength, and those whose position only relates to "crossover" points on the resultant vertical field geometry.

At each conductor axis is shown the "peak to peak" amplitude of the resultant field geometry, together with a measure of the so-called "quadrature" or variable field strength at 90° to the primary field direction.

The descriptive numbers at each conductor intercept are basically a function of the effective length of the responding body, or alternately its distance from the detecting coils. In no case should these measurements be considered to be related to any conductivity-thickness measurements or estimates.

INTERPRETATION OF RESULTS

Magnetometer Survey (Maps 1M, 2M)

The aerial survey shows three broad, complex, magnetic highs trending northwest through the survey area. These are interpreted as concentrations of magnetite in ultramafic sills.

Vertical Gradient Magnetometer Survey (Maps 1VG, 2VG)

When considered in association with the total field magnetometer results, the vertical gradient maps enable the ultramafic sills to be distinguished into separate units, and also to be mapped through areas with strong variation in overburden depths. The data from this survey is preferable to the total field data in enabling structural definition.

VLF - EM SURVEY (Maps 1M, 2M)

Forty-four conductor axes are interpreted for discussion purposes, with some one-line features not discriminated.

Map 2M

Remarks on these 44 features are:

1. Bedrock - north flank of peridotite
2. Bedrock coincident with magnetic low
3. Bedrock - south flank of peridotite
4. Bedrock - intermittent stratigraphic
5. Overburden
6. Interpreted cross structure
7. Bedrock - north flank of peridotite

8. Bedrock - south flank of peridotite
9. Bedrock, (serpentine?) coincident with magnetic high
- 10,11,12. Bedrock, located in previous survey
13. Isolated
14. Isolated
15. Interpreted cross structure
16. Bedrock
17. Culture
18. South flank of magnetic high
19. Bedrock
20. Cross structure
21. On magnetic high
22. Cross structure
23. Coincides with shallow peridotite
24. Cross structure

Map 1M

- 25,26,27. Indefinite, on wide north flank of magnetic high
28. Isolated
29. Magnetic high
30. Bedrock
- 31,32. Cross structure
33. Indefinite

34. Magnetic high
35. Probable bedrock, indefinite
36. Isolated
37. Possible bedrock
38. Magnetic high
39. Isolated
40. Bedrock
41. Bedrock, near peridotite
42. Bedrock
43. Magnetic high
44. May be lake "edge effect"

James S. Carr

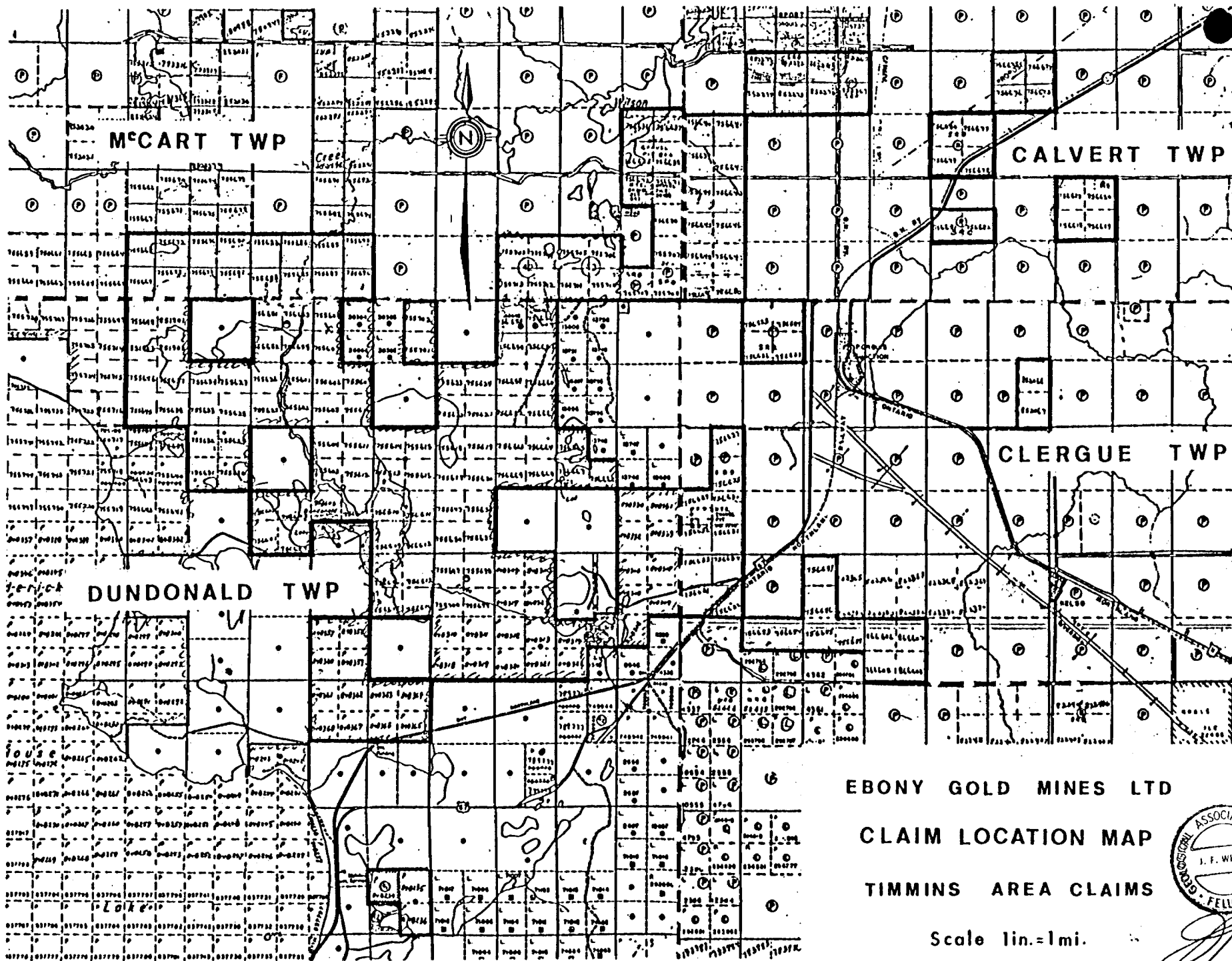

Newmarket

TULLY TWP.

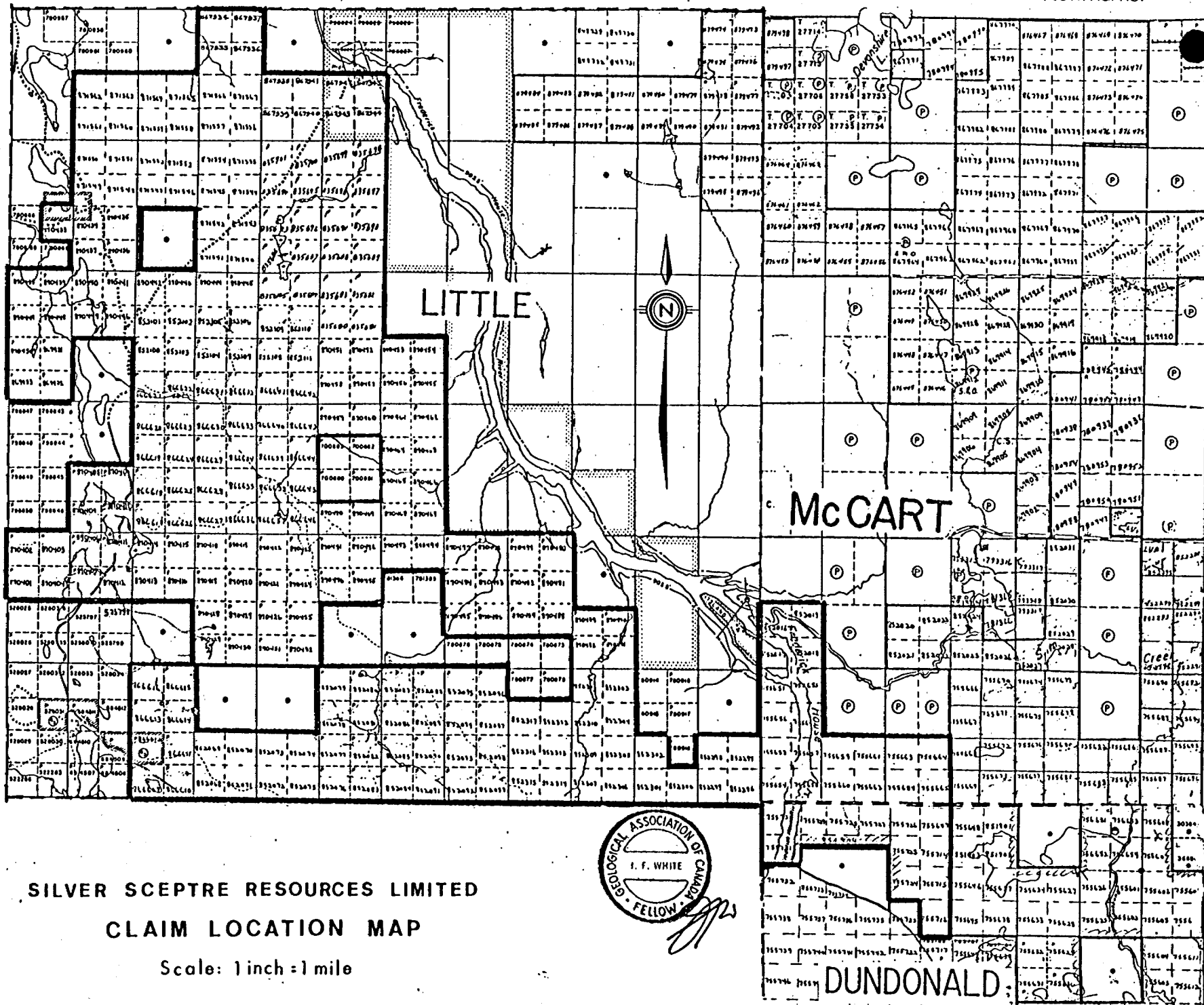

SILVER SCEPTRE RESOURCES LIMITED
 CLAIM LOCATION MAP

Scale: 1 inch = 1 mile

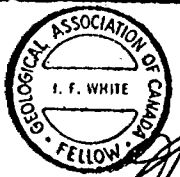

DUNDONALD

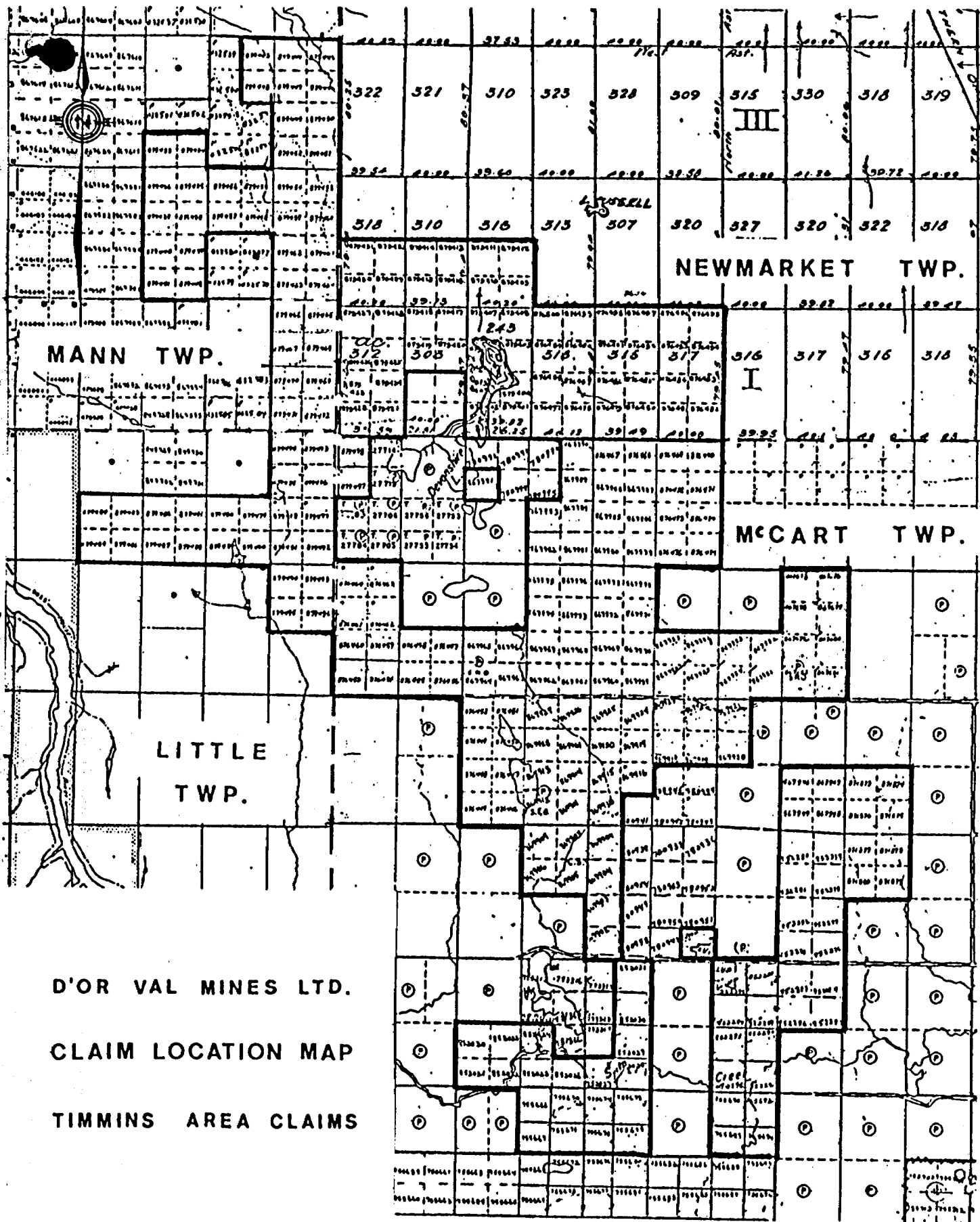

D'OR VAL MINES LTD.
 CLAIM LOCATION MAP
 TIMMINS AREA CLAIMS

Scale 1in.=1mi.

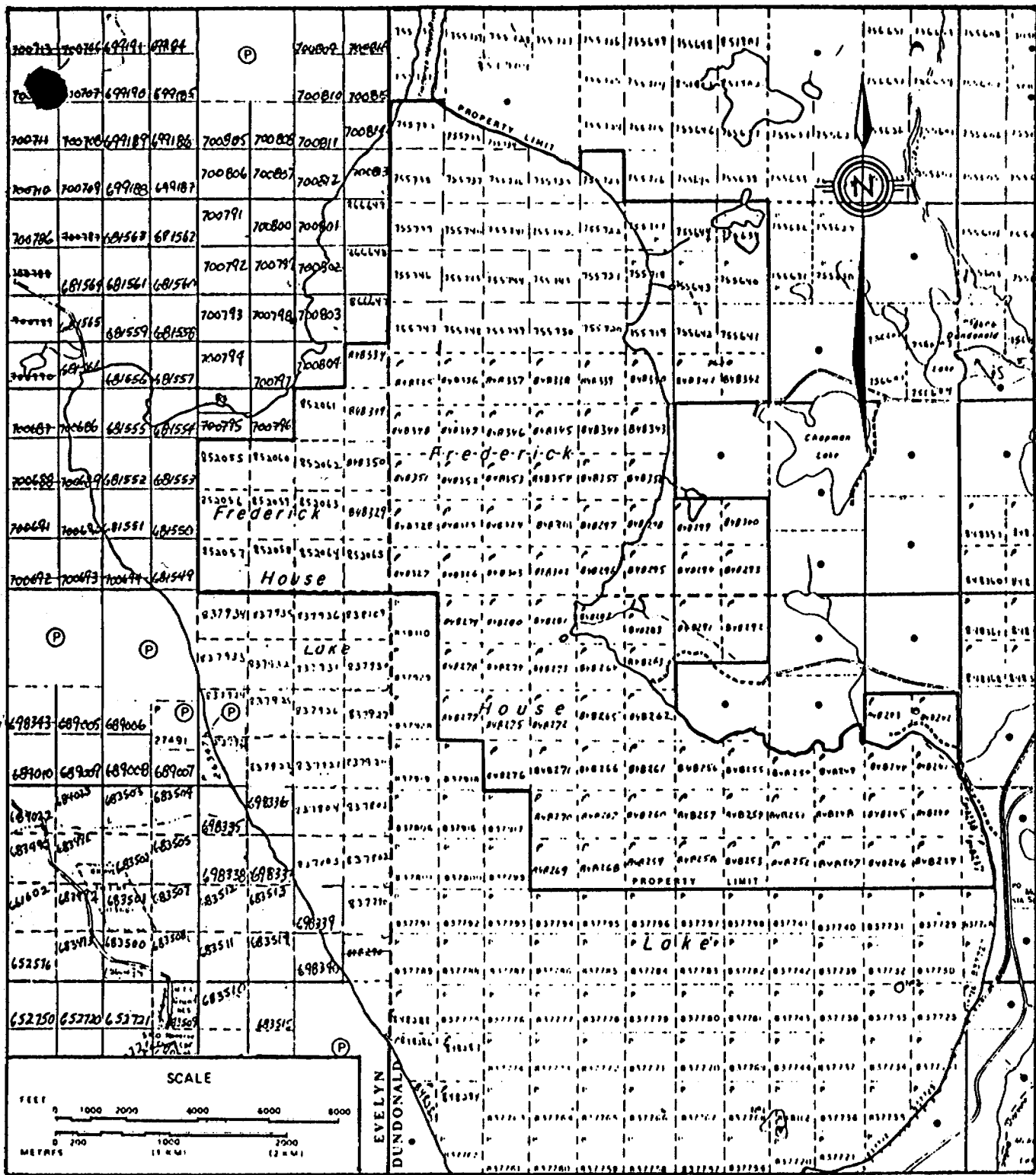

LOCKWOOD PETROLEUM INC.
 CLAIM LOCATION MAP
 TIMMINS AREA CLAIMS

Data From O. D. M. Claim Maps
 M-277 and G-3240



Ministry of
Northern Development
Mines

Report of Work
(Geophysical, Geological,
Geochemical and Expenditures)



42A155W8860 2.9590 CLERGUE

900

W-007-252

M

Type of Survey(s) AIRBORNE MAGNETOMETER VLF-EM	Township or Area NEWMARKET Twp.
Claim Holder(s) (L. SALO - M20010) (J. ROBERT - M21551)	Prospector's Licence No.
Address Box 1130, TIMMINS, ONT. P4N 7S6	
Survey Company H. FERDERBER GEOPHYSICS	Date of Survey (from & to) 19 07 86 19 07 86
Name and Address of Author (of Geo-Technical report) FENTON SCOTT, 17 MALABAR PLACE, DON MILLS, ONT	Total Miles of line Cut 67

Credits Requested per Each Claim in Columns at right

Mining Claims Traversed (List in numerical sequence)

Special Provisions	Geophysical	Days per Claim
For first survey: Enter 40 days. (This includes line cutting)	- Electromagnetic	
	- Magnetometer	
For each additional survey: using the same grid: Enter 20 days (for each)	- Radiometric	
	- Other	
	Geological	
	Geochemical	
Man Days	Geophysical	Days per Claim
Complete reverse side and enter total(s) here	- Electromagnetic	
	- Magnetometer	
	- Radiometric	
	- Other	
	Geological	
	Geochemical	
Airborne Credits	Geophysical	Days per Claim
Note: Special provisions credits do not apply to Airborne Surveys.	Electromagnetic VLF	30
	Magnetometer	30
	Radiometric	

Mining Claim			Mining Claim		
Prefix	Number	Expend. Days Cr.	Prefix	Number	Expend. Days Cr.
LIST ATTACHED					

Expenditures (excludes power stripping)

Type of Work Performed

Performed on Claim(s)

Calculation of Expenditure Days Credits

Total Expenditures **\$** ÷ **15** = Total Days Credits

Instructions: Total Days Credits may be apportioned at the claim holder's choice. Enter number of days credits per claim selected in columns at right.

Date **AUG. 6/86** Recorded Holder or Agent (Signature)

Certification Verifying Report of Work

I hereby certify that I have a personal and intimate knowledge of the facts set forth in the Report of Work annexed hereto, having performed the work or witnessed same during and/or after its completion and the annexed report is true.

Name and Postal Address of Person Certifying
DON MCKINNON, Box 1130, TIMMINS, ONT. P4N 7S6

Date Certified **AUG 6/86** Certifying by (Signature)

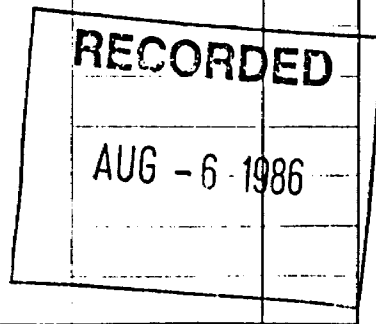
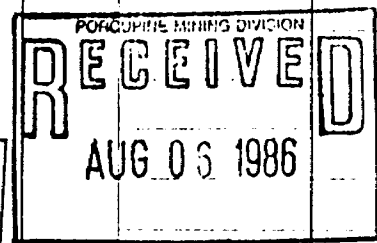

Total number of mining claims covered by this report of work. **56**

For Office Use Only

Total Days Cr. Recorded **336** Date Recorded **Aug 6/86**
Date Approved as Recorded **Aug 1/86**

Mining Agent (Signature)
Branch Director

NEWMARKET TWP.

D	876477	D	876408
D	876478	D	876409
F	876479	D	876410
D	876480	D	876411
F	876481	D	876412
D	876482	D	876413
D	876483	D	876414
D	876484	D	876415
D	876485	D	876416
D	876486	D	876417
F	876487	D	876418
D	876488	D	876419
D	876489	D	876420
D	876490	D	876421
D	876491	D	876422
D	876492	D	876423
D	876493	D	876424
D	876494	D	876425
D	876495	D	876426
D	876496	D	876427
D	876497	D	876428
D	876498	D	876429
D	876499	D	876430
D	876500	D	876431
D	876501	D	876432
D	876502	D	876433
D	876503	D	876434
D	876504	D	876435

Sept 25

253/86 Mining Act 2.9590

W8606-253

Type of Survey(s) AIRBORNE MAGNETOMETER ULF-EM Township or Area MANU TWP
 Claim Holder(s) J. ROBERT - M 21551 Prospector's Licence No. _____
 Address Box 1130, TIMMINS, ONT. P4N 7S6
 Survey Company H. FERDERBER GEOPHYSICS Date of Survey (from & to) 14 07 86 Total Miles of line Cut 48
 Name and Address of Author (of Geo-Technical report) FENTON SCOTT, 17 MALABAR PLACE, DON MILLS, ONT

Credits Requested per Each Claim in Columns at right			Mining Claims Traversed (List in numerical sequence)					
Special Provisions	Geophysical	Days per Claim	Mining Claim		Expend. Days Cr.	Mining Claim		Expend. Days Cr.
			Prefix	Number		Prefix	Number	
For first survey: Enter 40 days. (This includes line cutting)	Electromagnetic		LIST ATTACHED					
For each additional survey: using the same grid: Enter 20 days (for each)	Magnetometer							
	Radiometric							
	Other							
	Geological							
	Geochemical							
Man Days	Electromagnetic							
Complete reverse side and enter total(s) here	Magnetometer							
	Radiometric							
	Other							
Airborne Credits	Electromagnetic	30	<div style="border: 2px solid black; padding: 5px; display: inline-block;">RECORDED</div> <div style="border: 2px solid black; padding: 5px; display: inline-block; margin-left: 20px;">RECEIVED</div>					
Note: Special provisions credits do not apply to Airborne Surveys.	Magnetometer	30						
	Radiometric							

Expenditures (excludes power stripping)

Type of Work Performed _____

Performed on Claim(s) _____

Calculation of Expenditure Days Credits

Total Expenditures \$ _____ ÷ 15 = Total Days Credits _____

Instructions: Total Days Credits may be apportioned at the claim holder's choice. Enter number of days credits per claim selected in columns at right.

Date Aug. 6/86 Recorder/Holder or Agent (Signature) [Signature]

For Office Use Only

Total Days Cr. Recorded _____ Date Recorded 8/16/86 Mining Director [Signature]

Date Approved as Recorded 8/19 Branch Director [Signature]

Certification Verifying Report of Work

I hereby certify that I have a personal and intimate knowledge of the facts set forth in the Report of Work annexed hereto, having performed the work or witnessed same during and/or after its completion and the annexed report is true.

Name and Postal Address of Person Certifying Don McKinnon, Box 1130, TIMMINS, ONT. P4N 7S6

Date Certified Aug. 6/86 Certified by (Signature) [Signature]

Total number of mining claims covered by this report of work. 40

MEMO TWF

0 878433	= 878453
1 878434	= 878454
2 878435	= 878455
3 878436	= 878456
4 878437	= 878457
5 878438	= 878458
6 878439	= 878459
7 878440	= 878460
8 878441	= 878461
9 878442	= 878462
0 878443	= 878463
1 878444	= 878464
2 878445	= 878465
3 878446	= 878466
4 878447	= 878467
5 878448	= 878468
6 878449	= 878469
7 878450	= 878470
8 878451	= 878471
9 878452	= 878472

Mining Act

#254/86
29590

Sept 25

Type of Survey(s) **AIRBORNE MAGNETOMETER ULF-EM** Township or Area **GERMAN TWP.**
 Claim Holder(s) **(D. BEDARD - M21887) (R. SALO - M21107)** Prospector's Licence No.
 Address **Box 1130, TIMMINS, ONT. P4N 7S6**
 Survey Company **H. FERDERBER GEOPHYSICS** Date of Survey (from & to) **20 17 86** Total Miles of line Cut **7**
 Name and Address of Author (of Geo-Technical report) **FENTON SCOTT, 17 MALABAR PLACE, DON MILLS, ONT.**

Credits Requested per Each Claim in Columns at right

Special Provisions	Geophysical	Days per Claim
For first survey: Enter 40 days. (This includes line cutting)	- Electromagnetic	
	- Magnetometer	
	- Radiometric	
	- Other	
For each additional survey: using the same grid: Enter 20 days (for each)	Geological	
	Geochemical	
Man Days Complete reverse side and enter total(s) here	Geophysical	Days per Claim
	- Electromagnetic	
	- Magnetometer	
	- Radiometric	
	- Other	
Airborne Credits Note: Special provisions credits do not apply to Airborne Surveys.	Electromagnetic VLF	30
	Magnetometer	30
	Radiometric	

Mining Claims Traversed (List in numerical sequence)

Prefix	Mining Claim Number	Expend. Days Cr.
P	871513	
	871514	
	871515	
	871516	
	871538	
	871539	

RECORDED
AUG - 6 1986

RECEIVED
AUG 06 1986

Expenditures (excludes power stripping)

Type of Work Performed

Performed on Claim(s)

Calculation of Expenditure Days Credits

Total Expenditures \$ ÷ 15 = Total Days Credits

Instructions
Total Days Credits may be apportioned at the claim holder's choice. Enter number of days credits per claim selected in columns at right.

Total number of mining claims covered by this report of work. **6**

For Office Use Only

Total Days Cr. Recorded **360** Date Recorded **Aug. 6/86** Mining Record by **[Signature]**
 Date Approved as Recorded **87.1.9** By **[Signature]**

Date **Aug. 6/86** Recorded Holder or Agent (Signature) **[Signature]**

Certification Verifying Report of Work

I hereby certify that I have a personal and intimate knowledge of the facts set forth in the Report of Work annexed hereto, having performed the work or witnessed same during and/or after its completion and the annexed report is true.

Name and Postal Address of Person Certifying **DON MCKINNON, Box 1130, TIMMINS, ONT. P4N 7S6**
 Date Certified **Aug. 6/86** Certified by (Signature) **[Signature]**

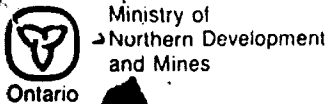

Report of Work

(Geophysical, Geological,
Geochemical and Expenditures)

- Instructions: -- Please type or print.
- If number of mining claims traversed exceeds space on this form, attach a list.
 - Note: -- Only days credits calculated in the "Expenditures" section may be entered in the "Expend. Days Cr." columns.
 - Do not use shaded areas below.

Sept 25

255/86
29590
Mining Act

W8606705

Type of Survey(s) AIRBORNE MAGNETOMETER VLF-EM Township or Area MCCART TWP.

Claim Holder(s) (J. ROBERT - M2155) Prospector's Licence No. _____

(R. SALO - M21107)(Y. GRONDIN - M.21611)(L. SALO - M20010)

Address Box 1130, TIMMINS, ONT. P4N 7S6

Survey Company H FERDERBER GEOPHYSICS Date of Survey (from & to) 11 07 86 to 13 07 86 Total Miles of line Cut 148

Name and Address of Author (of Geo-Technical report) FENTON SCOTT, 17 MALABAR PLACE, DON MILLS, ONT.

Credits Requested per Each Claim in Columns at right

Special Provisions	Geophysical	Days per Claim
For first survey: Enter 40 days. (This includes line cutting)	- Electromagnetic	
	- Magnetometer	
	- Radiometric	
	- Other	
For each additional survey: using the same grid: Enter 20 days (for each)	Geological	
	Geochemical	
Man Days	Geophysical	Days per Claim
Complete reverse side and enter total(s) here	- Electromagnetic	
	- Magnetometer	
	- Radiometric	
	- Other	
	Geological	
	Geochemical	
Airborne Credits		Days per Claim
Note: Special provisions credits do not apply to Airborne Surveys.	Electromagnetic VLF	30
	Magnetometer	30
	Radiometric	

Mining Claims Traversed (List in numerical sequence)

Mining Claim			Expend. Days Cr.	Mining Claim			Expend. Days Cr.
Prefix	Number			Prefix	Number		

RECORDED
AUG - 6 1986

RECEIVED
AUG 06 1986

Expenditures (excludes power stripping)

Type of Work Performed _____

Performed on Claim(s) _____

Calculation of Expenditure Days Credits

Total Expenditures \$ _____ ÷ 15 = Total Days Credits _____

Total number of mining claims covered by this report of work. 123

Instructions
Total Days Credits may be apportioned at the claim holder's choice. Enter number of days credits per claim selected in columns at right.

For Office Use Only	
Total Days Cr. Recorded <u>7,380</u>	Date Recorded <u>Aug 6/86</u>
Date Approved as Recorded <u>87.1.9</u>	Mining Claim Holder Signature <u>[Signature]</u>
	Branch Director Signature <u>[Signature]</u>

Date Aug. 6/86 Recorded Holder or Agent (Signature) [Signature]

Certification Verifying Report of Work
I hereby certify that I have a personal and intimate knowledge of the facts set forth in the Report of Work annexed hereto, having performed the work or witnessed same during and/or after its completion and the annexed report is true.

Name and Postal Address of Person Certifying DON MCKINNON, Box 1130, TIMMINS, ONT. P4N 7S6

Date Certified AUG. 6/86 Certified by (Signature) [Signature]

MCART, W.F.

867675	867740	867781
867676	867741	871878
867677	867742	871879
867678	867743	871880
867679	867744	871881
867680	867745	871882
867681	867746	871883
867682	867747	871884
867683	867748	871885
867684	867749	871886
867685	867750	871887
867686	867751	871888
867687	867752	871889
867688	867753	871890
867689	867754	871891
867690	867755	871892
867691	867756	871893
867692	867757	871894
867693	867758	871895
867694	867759	871896
867695	867760	871897
867696	867761	871898
867697	867762	871899
867698	867763	871900
867699	867764	871901
867700	867765	871902
867701	867766	871903
867702	867767	871904
867703	867768	871905
867704	867769	871906
867705	867770	871907
867706	867771	871908
867707	867772	871909
867708	867773	871910
867709	867774	871911
867710	867775	871912
867711	867776	871913
867712	867777	871914
867713	867778	871915
867714	867779	871916
867715	867780	871917
867716	867781	871918
867717	867782	871919
867718	867783	871920
867719	867784	871921
867720	867785	871922
867721	867786	871923
867722	867787	871924
867723	867788	871925
867724	867789	871926
867725	867790	871927
867726	867791	871928
867727	867792	871929
867728	867793	871930
867729	867794	871931
867730	867795	871932
867731	867796	871933
867732	867797	871934
867733	867798	871935
867734	867799	871936
867735	867800	871937
867736	867801	871938
867737	867802	871939
867738	867803	871940
867739	867804	871941
867740	867805	871942
867741	867806	871943
867742	867807	871944
867743	867808	871945
867744	867809	871946
867745	867810	871947
867746	867811	871948
867747	867812	871949
867748	867813	871950
867749	867814	871951
867750	867815	871952
867751	867816	871953
867752	867817	871954
867753	867818	871955
867754	867819	871956
867755	867820	871957
867756	867821	871958
867757	867822	871959
867758	867823	871960
867759	867824	871961
867760	867825	871962
867761	867826	871963
867762	867827	871964
867763	867828	871965
867764	867829	871966
867765	867830	871967
867766	867831	871968
867767	867832	871969
867768	867833	871970
867769	867834	871971
867770	867835	871972
867771	867836	871973
867772	867837	871974
867773	867838	871975
867774	867839	871976
867775	867840	871977
867776	867841	871978
867777	867842	871979
867778	867843	871980
867779	867844	871981
867780	867845	871982
867781	867846	871983
867782	867847	871984
867783	867848	871985
867784	867849	871986
867785	867850	871987
867786	867851	871988
867787	867852	871989
867788	867853	871990
867789	867854	871991
867790	867855	871992
867791	867856	871993
867792	867857	871994
867793	867858	871995
867794	867859	871996
867795	867860	871997
867796	867861	871998
867797	867862	871999
867798	867863	
867799	867864	
867800	867865	



Ministry of Northern Development and Mines

Report of Work
(Geophysical, Geological, Geochemical and Expenditures)

Instructions: - Please type or print.
- If number of mining claims traversed exceeds space on this form, attach a list.
Note: - Only days credits calculated in the "Expenditures" section may be entered in the "Expend. Days Cr." column.
- Do not use shaded areas below.

#256/86
Mining Act 2.9590

Sept 25

Type of Survey(s) **AIRBORNE MAGNETOMETER ULF-EM** Township or Area **LITTLE TWP**
 Claim Holder(s) _____ Prospector's Licence No. _____
 Address **(R. SALO - M21107)(M. PEPLINSKI - M21221)(J. ROBERT - M21591)**
Box 1130, TIMMINS, ONT. P4N 7S6
 Survey Company **H. FERDERBER GEOPHYSICS** Date of Survey (from & to) _____ Total Miles of line Cut **232**
 Name and Address of Author (of Geo-Technical report) **FENTON SCOTT, 17 MALABAR PLACE, DON MILLS, ONT.**

Credits Requested per Each Claim in Columns at right

Mining Claims Traversed (List in numerical sequence)

Special Provisions	Geophysical	Days per Claim
For first survey: Enter 40 days. (This includes line cutting)	- Electromagnetic	
	- Magnetometer	
	- Radiometric	
	- Other	
For each additional survey: using the same grid: Enter 20 days (for each)	Geological	
	Geochemical	
	Geophysical	
	Days per Claim	
Man Days Complete reverse side and enter total(s) here	- Electromagnetic	
	- Magnetometer	
	- Radiometric	
	- Other	
Airborne Credits Note: Special provisions credits do not apply to Airborne Surveys.	Geological	
	Geochemical	
	Electromagnetic VLF	30
	Magnetometer	30
	Radiometric	

Prefix	Mining Claim Number	Expend. Days Cr.	Prefix	Mining Claim Number	Expend. Days Cr.
LIST ATTACHED					
RECEIVED AUG 05 1986					

Expenditures (excludes power stripping)

Type of Work Performed _____
 Performed on Claim(s) _____
 Calculation of Expenditure Days Credits
 Total Expenditures \$ _____ ÷ 15 = Total Days Credits _____
 Instructions
 Total Days Credits may be apportioned at the claim holder's choice. Enter number of days credits per claim selected in columns at right.

Total number of mining claims covered by this report of work. **193**

Date **AUG. 6/86** Recorded Holder or Agent (Signature) *[Signature]*

For Office Use Only
 Total Days Cr. Recorded **11,580** Date Recorded **Aug 6/86** Mining Director *[Signature]*
 Date Approved as Recorded **87.1.9**

Certification Verifying Report of Work
 I hereby certify that I have a personal and intimate knowledge of the facts set forth in the Report of Work annexed hereto, having performed the work or witnessed same during and/or after its completion and the annexed report is true.

Name and Postal Address of Person Certifying **DON MCKINNON, Box 1130, TIMMINS, ONT. P4N 7S6**
 Date Certified **AUG. 6/86** Certified by (Signature) *[Signature]*

LITTLE TWP.

P 835620	P 870401	P 870450	F 871344
P 835621	P 870402	P 870451	P 871347
P 835622	P 870403	P 870452	P 871348
P 835623	P 870404	P 870453	P 871349
P 835624	P 870405	P 870454	P 871350
P 835625	P 870406	P 870455	P 871351
P 835626	P 870407	P 870456	P 871352
P 835627	P 870408	P 870457	P 871353
P 835628	P 870409	P 870458	P 871354
P 835629	P 870410	P 870459	P 871355
P 835630	P 870411	P 870460	P 871356
P 835631	P 870412	P 870461	P 871357
P 835632	P 870413	P 870462	P 871358
P 835633	P 870414	P 870463	P 871359
P 835634	P 870415	P 870464	P 871360
P 835635	P 870416	P 870465	P 871361
P 835636	P 870417	P 870466	P 871362
P 835637	P 870418	P 870467	P 871363
P 835638	P 870419	P 870468	P 871364
P 835639	P 870420	P 870469	P 871365
P 835700	P 870421	P 870470	P 871366
P 835701	P 870422	P 870471	P 871367
P 835702	P 870423	P 870472	P 871368
P 835703	P 870424	P 870473	P 871369
P 835704	P 870425	P 870474	P 871370
P 835705	P 870426	P 870475	P 871371
P 835706	P 870427	P 870476	P 871372
P 835707	P 870428	P 870477	P 871373
P 835708	P 870429	P 870478	P 871374
P 835709	P 870430	P 870479	P 871375
P 835710	P 870431	P 870480	P 871376
P 835711	P 870432	P 870481	P 871377
P 835712	P 870433	P 870482	P 871378
P 835713	P 870434	P 870483	P 871379
P 835714	P 870435	P 870484	P 871380
P 835715	P 870436	P 870485	P 871381
P 835716	P 870437	P 870486	P 871382
P 835717	P 870438	P 870487	P 871383
P 835718	P 870439	P 870488	P 871384
P 835719	P 870440	P 870489	P 871385
P 835720	P 870441	P 870490	P 871386
P 835721	P 870442	P 870491	P 871387
P 835722	P 870443	P 870492	P 871388
P 835723	P 870444	P 871340	P 871389
P 835724	P 870445	P 871341	P 871390
P 835725	P 870446	P 871342	P 871391
P 835726	P 870447	P 871343	P 871392
P 835727	P 870448	P 871344	P 871393
P 835728	P 870449	P 871345	P 871394



Ministry of Natural Resources

Report of Work (Geophysical, Geological, Geochemical and Expenditures)

286/86 29590

Instructions: - Please type or print.
- If number of mining claims traversed exceeds space on this form, attach a list.
Note: - Only days credits calculated in the "Expenditures" section may be entered in the "Expend. Days Cr." columns.
- Do not use shaded areas below.

0222

Type of Survey(s) **AIRBORNE MAGNETOMETER VLF-EM** Township or Area **CLERGUE**

Claim Holder(s) **(DON MCKINNON - M15389** Prospector's Licence No.

(DON L. MCKINNON - M21873) (YVONNE GRONDIN - M21611)

Address **Box 1130, TIMMINS, ONT. P4N 7S6**

Survey Company **H. FERDERBER GEOPHYSICS** Date of Survey (from & to) **27 06 86 27 06 86** Total Miles of line Cut **24**

Name and Address of Author (of Geo-Technical report) **FENTON SCOTT, 17 MALABAR PLACE, DON MILLS ONTARIO**

Credits Requested per Each Claim in Columns at right

Special Provisions	Geophysical	Days per Claim
For first survey: Enter 40 days. (This includes line cutting)	- Electromagnetic	
	- Magnetometer	
	- Radiometric	
	- Other	
For each additional survey: using the same grid: Enter 20 days (for each)	Geological	
	Geochemical	
Man Days Complete reverse side and enter total(s) here	Geophysical	Days per Claim
	- Electromagnetic	
	- Magnetometer	
	- Radiometric	
	- Other	
	Geological	
Airborne Credits	Geophysical	Days per Claim
	Electromagnetic VLF	30
	Magnetometer	30
	Radiometric	

Mining Claims Traversed (List in numerical sequence)

Mining Claim		Expend. Days Cr.	Mining Claim		Expend. Days Cr.
Prefix	Number		Prefix	Number	
P	756621				
	756622				
	756623				
	756624				
	756625				
	756626				
	756627				
	756628				
	756629				
	756630				
	756631				
	756632				
	756633				
	756634				
	756683				
	756684				
	756685				
	756686				
	756687				
	756688				

RECORDED
SEP - 2 1986

RECEIVED
SEP 22 1986
MINING LANDS SECTION

Expenditures (excludes power stripping)

Type of Work Performed

Performed on Claims:

Calculation of Expenditure Days Credits

Total Expenditure = **15** = Total Days Credits

RECEIVED
SEP 02 1986

Instructions: Total Days Credits may be apportioned at the claim holder's choice. Enter number of days credits per claim selected in columns at right.

Date **AUG. 29/86** Recorded Holder or Agent (Signature)

For Office Use Only

Total Days Cr. Recorded **15** Date Recorded **27/06/86** Mining Approver **[Signature]**

Date Approved as Recorded **89.1.9** Branch Director **[Signature]**

Certification Verifying Report of Work

I hereby certify that I have a personal and intimate knowledge of the facts set forth in the Report of Work annexed hereto, having performed the work or witnessed same during and/or after its completion and the annexed report is true.

Name and Postal Address of Person Certifying **DON MCKINNON, BOX 1130, TIMMINS, ONT. P4N 7S6**

Date Certified **1/9/86** Certified by (Signature) **[Signature]**

Total number of mining claims covered by this report of work. **20**



Ministry of Natural Resources
Ontario

Report of Work
(Geophysical, Geological, Geochemical and Expenditures)

4257/86
29590
The Mining Act

Instructions: - Please type or print.

- If number of mining claims traversed exceeds space on this form, attach a list.
- Only days credits calculated in the "Expenditures" section may be entered in the "Expend. Days Cr." columns.
- Do not use shaded areas below.

Type of Survey(s) AIRBORNE MAGNETOMETER ULF-EM			Township or Area MCCART		
Claim Holder(s) (D. LACROIX - M20603) DON. MCKINNON-M15389				Prospector's Licence No.	
Address Box 1130, TIMMINS, ONTARIO, P4N 7S6					
Survey Company H. FERDERBER GEOPHYSICS			Date of Survey (from & to) Day Mo. Yr. 26 06 86		Total Miles of line Cut 1.2
Name and Address of Author (of Geo-Technical report) FENTON SCOTT, 17 MALABAR PLACE, DON MILLS, ONT.					

Credits Requested per Each Claim in Columns at right Mining Claims Traversed (List in numerical sequence)

Special Provisions	Geophysical		Days per Claim
	- Electromagnetic		
For first survey: Enter 40 days. (This includes line cutting)	- Magnetometer		
For each additional survey: using the same grid: Enter 20 days (for each)	- Radiometric		
	- Other		
	Geological		
	Geochemical		

Man Days	Geophysical		Days per Claim
	- Electromagnetic		
Complete reverse side and enter total(s) here	- Magnetometer		
	- Radiometric		
	- Other		
	Geological		
	Geochemical		

Airborne Credits	Days per Claim	
	Electromagnetic VLF	30
	Magnetometer	30

Mining Claim		Expend. Days Cr.
Prefix	Number	
P	852292	

Mining Claim		Expend. Days Cr.
Prefix	Number	

RECEIVED

SEP 22 1986

MINING LANDS SECTION

RECORDED

SEP - 2 1986

Expenditures (excluding power) in dollars

Type of Work Performed: Geophysical Geological Geochemical

Performed on Claim(s): **SEP 02 1986**

Calculation of Expenditure Days Credits

Total Expenditures Total Days Credits

\$ ÷ 15 =

Instructions
Total Days Credits may be apportioned at the claim holder's choice. Enter number of days credits per claim selected in columns at right.

Date: **AUG. 29/86** Recorded Holder or Agent (Signature): *[Signature]*

For Office Use Only

Total Days Cr. Recorded 66	Date Recorded Sept 2/86	Mining Recorder <i>[Signature]</i>
	Date Approved as Recorded 1-8-86	

Total number of mining claims covered by this report of work. **1**

Certification Verifying Report of Work

I hereby certify that I have a personal and intimate knowledge of the facts set forth in the Report of Work annexed hereto, having performed the work or witnessed same during and/or after its completion and the annexed report is true.

Name and Postal Address of Person Certifying:
DON MCKINNON, Box 1130, TIMMINS, ONT. P4N 7S6

Date Certified: **AUG 29/86** Certified by (Signature): *[Signature]*

LITTLE TWF.

P.852068	P.852091	P.852311	P.866625
P.852069	P.852092	P.852312	P.866626
P.852070	P.852093	P.852313	P.866627
P.852071	P.852094	P.852314	P.866628
P.852072	P.852095	P.852315	P.866629
P.852073	P.852096	P.852316	P.866630
P.852074	P.852097	P.852317	P.866631
P.852075	P.852098	P.866609	P.866632
P.852076	P.852099	P.866610	P.866633
P.852077	P.852296	P.866611	P.866634
P.852078	P.852297	P.866612	P.866635
P.852079	P.852298	P.866613	P.866636
P.852080	P.852299	P.866614	P.866637
P.852081	P.852300	P.866615	P.866638
P.852082	P.852301	P.866616	P.866639
P.852083	P.852302	P.866617	P.866640
P.852084	P.852303	P.866618	P.866641
P.852085	P.852304	P.866619	P.866642
P.852086	P.852305	P.866620	P.866643
P.852087	P.852306	P.866621	P.866644
P.852088	P.852307	P.866622	P.866645
P.852089	P.852309	P.866623	P.866646
P.852090	P.852310	P.866624	

Mining Act **2,9570**

Type of Survey(s) AIRBORNE MAGNETOMETER VLF-EM		Township or Area MCCART TWP.	
Claim Holder(s) (D. DEBARD - M21887) (R. SAO - M21873) (Y. GRONDIN - M21611) (D. LACROIX - M20603) (D. MCKINNON - M21873) (E. KORBA - M20807)		Prospector's Licence No.	
Address Box 1130, TIMMINS, ONT. P4N 7S6			
Survey Company H. FERDERBER GEOPHYSICS		Date of Survey (from & to) 1 JUNE 86 5 JUNE 86 Day Mo. Yr. Day Mo. Yr.	
Total Miles of line Cut 116.4			
Name and Address of Author (of Geo-Technical report) FENTON SCOTT, 17 MALABAR PLACE, DON MILLS ONTARIO			

Credits Requested per Each Claim in Columns at right

Special Provisions	Geophysical	Days per Claim
For first survey: Enter 40 days. (This includes line cutting)	- Electromagnetic	
	- Magnetometer	
	- Radiometric	
	- Other	
For each additional survey: using the same grid: Enter 20 days (for each)	Geological	
	Geochemical	
Man Days Complete reverse side and enter total(s) here	Geophysical	Days per Claim
	- Electromagnetic	
	- Magnetometer	
	- Radiometric	
	- Other	
	Geological	
Airborne Credits Note: Special provisions credits do not apply to Airborne Surveys.	Electromagnetic VLF	30
	Magnetometer	30
	Radiometric	

Mining Claims Traversed (List in numerical sequence)

Mining Claim		Expend. Days Cr.	Mining Claim		Expend. Days Cr.
Prefix	Number		Prefix	Number	
LIST ATTACHED					

RECORDED
DEC 19 1986

Expenditures (excludes power stripping)

Type of Work Performed
Performed on Claim(s)
Calculation of Expenditure Days Credits
Total Expenditures \$ <input type="text"/> ÷ 15 = Total Days Credits <input type="text"/>
Instructions Total Days Credits may be apportioned at the claim holder's choice. Enter number of days credits per claim selected in columns at right.

Total number of mining claims covered by this report of work. **42**

For Office Use Only			
Total Days Cr. Recorded	Date Recorded	Mining Recorder	
2520	Dec. 19/86	<i>[Signature]</i>	
	Date Approved as Recorded	Branch Director	
	8.7.86	<i>[Signature]</i>	

Date	Recorded Holder or Agent (Signature)
DEC. 17, 1986	<i>[Signature]</i>

Certification Verifying Report of Work

I hereby certify that I have a personal and intimate knowledge of the facts set forth in the Report of Work annexed hereto, having performed the work or witnessed same during and/or after its completion and the annexed report is true.

Name and Postal Address of Person Certifying DON MCKINNON, Box 1130, TIMMINS, ONT. P4N 7S6	
Date Certified DEC. 17, 1986	Certified by (Signature) <i>[Signature]</i>

MCCART TWP.

~~P.755651~~
~~P.755652~~
~~P.755653~~
~~P.755654~~
~~P.755655~~
~~P.755656~~
~~P.755657~~
~~P.755658~~
~~P.755659~~
~~P.755660~~
~~P.755661~~
~~P.755662~~
~~P.755663~~
~~P.755664~~
~~P.755665~~
~~P.755666~~
~~P.755667~~
~~P.755668~~
~~P.755669~~
~~P.755670~~
~~P.755671~~
~~P.755672~~
~~P.755673~~
~~P.755674~~
~~P.755675~~

~~P.755676~~
~~P.755677~~
~~P.755678~~
~~P.755679~~
~~P.755680~~
~~P.755681~~
~~P.755682~~
~~P.755683~~
~~P.755684~~
~~P.755685~~
~~P.755686~~
~~P.755687~~
~~P.755688~~
~~P.755689~~
~~P.755690~~
~~P.755693~~
~~P.755694~~
~~P.755695~~
~~P.755696~~
~~P.755703~~
~~P.755704~~
~~P.755705~~
~~P.755706~~
~~P.755707~~
~~P.755708~~

being cancelled

~~P.755709~~
~~P.755710~~
~~P.755711~~
~~P.755712~~
~~P.755713~~
P.756635
P.756636
P.756637
P.756638
P.756670
P.756671
P.756672
P.852016
P.852017
P.852018
P.852019
P.852020
P.852021
P.852022
P.852023
P.852024
P.852025
P.852026
P.852027
P.852028

being cancelled

P.852029
P.852030
P.852031
P.852276
P.852277
P.852278
P.852279
P.852280
P.852281
P.852282
P.852283
P.852284
P.852285
P.852286
P.852287
P.852288
P.852289
P.852290
P.852291
P.852293
P.852294
P.852295

412/86

Instructions: - Please type or print.
- If number of mining claims traversed exceeds space on this form, attach a list.
Note: - Only days credits calculated in the "Expenditures" section may be entered in the "Expend. Days Cr." columns.
- Do not use shaded areas below.

Mining Act

2.9570

Sub 7

Type of Survey(s) AIRBORNE MAGNETOMETER VLF-EM		Township or Area DUNDONALD TWP.
Claim Holder(s) (D. MCKINNON - M 21873) (D. BEDARD - M 21887) (R. SALO - M 21873)		Prospector's Licence No. (L. GRONDA - M 21611)
Address Box 1130, TIMMINS, ONT		
Survey Company H. FEEDERBER GEOPHYSICS	Date of Survey (from & to) 1 JUNE 86 5 JUNE 86 Day Mo. Yr. Day Mo. Yr.	Total Miles of line Cut 170.4
Name and Address of Author (of Geo-Technical report) FENTON SCOTT, 17 MALABAR PLACE, DON MILLS, ONT		

Credits Requested per Each Claim in Columns at right		
Special Provisions	Geophysical	Days per Claim
For first survey: Enter 40 days. (This includes line cutting)	- Electromagnetic	
	- Magnetometer	
	- Radiometric	
	- Other	
For each additional survey: using the same grid: Enter 20 days (for each)	Geological	
	Geochemical	
	Geophysical	Days per Claim
	- Electromagnetic	
Man Days Complete reverse side and enter total(s) here	- Magnetometer	
	- Radiometric	
	- Other	
	Geological	
Airborne Credits Note: Special provisions credits do not apply to Airborne Surveys.	Electromagnetic VLF	30
	Magnetometer	30
	Radiometric	

Mining Claims Traversed (List in numerical sequence)					
Mining Claim		Expend. Days Cr.	Mining Claim		Expend. Days Cr.
Prefix	Number		Prefix	Number	
LIST ATTACHED					

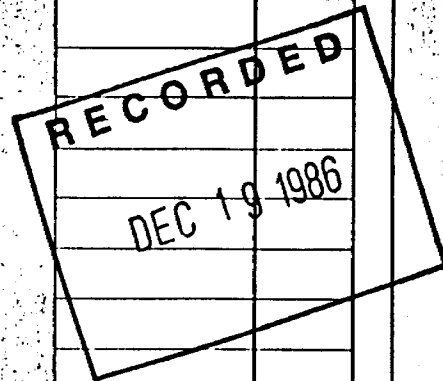

Expenditures (excludes power stripping)	
Type of Work Performed	
Performed on Claim(s)	
DEC 19 1986	
Calculation of Expenditure - Days Credits	
Total Expenditures	Total Days Credits
\$	÷ 15 =
Instructions Total Days Credits may be apportioned at the claim holder's choice. Enter number of days credits per claim selected in columns at right.	

For Office Use Only			
Total Days Cr. Recorded	Date Recorded	Mining Registrar	
2480	Dec. 19/86	[Signature]	
	Date Approved as Recorded	Branch Director	
	87.7.70	[Signature]	

Date	Recorded Holder or Agent (Signature)
DEC. 17, 1986	[Signature]
Certification Verifying Report of Work	
I hereby certify that I have a personal and intimate knowledge of the facts set forth in the Report of Work annexed hereto, having performed the work or witnessed same during and/or after its completion and the annexed report is true.	
Name and Postal Address of Person Certifying	
DON MCKINNON, Box 1130, TIMMINS, ONT. P4N 7S6	
Date Certified	Certified by (Signature)
DEC. 17, 1986	[Signature]

DUNDONALD TWF.

~~P.755601~~
~~P.755602~~
~~P.755603~~
~~P.755604~~
~~P.755605~~
~~P.755606~~
~~P.755607~~
~~P.755608~~
~~P.755609~~
~~P.755610~~
~~P.755611~~
~~P.755612~~
~~P.755613~~
~~P.755614~~
~~P.755615~~
~~P.755616~~
~~P.755617~~
~~P.755618~~
~~P.755619~~
~~P.755620~~
~~P.755621~~
~~P.755622~~
~~P.755623~~
~~P.755624~~
~~P.755625~~
~~P.755626~~
~~P.755627~~
~~P.755628~~
~~P.755629~~
~~P.755630~~
~~P.755631~~
~~P.755632~~
~~P.755633~~
~~P.755634~~
~~P.755635~~
~~P.755636~~

*claims
 canceled*

P.755637
P.755638
~~P.755645~~
~~P.755646~~
~~P.755647~~
~~P.755648~~
~~P.755649~~
~~P.755650~~
~~P.755697~~
~~P.755698~~
~~P.755699~~
~~P.755700~~
~~P.755701~~
~~P.755714~~
~~P.755715~~
~~P.755716~~
~~P.755724~~
~~P.755725~~
~~P.755726~~
~~P.755727~~
~~P.755728~~
~~P.755729~~
~~P.755730~~
~~P.755731~~
P.756601
P.756602
P.756603
P.756604
P.756606
P.756607
P.756609
P.756610
P.756611
P.756612
P.756613

P.756614
P.756615
P.756616
~~P.756651~~
~~P.756652~~
~~P.756653~~
~~P.756654~~
~~P.756655~~
~~P.756656~~
~~P.756657~~
~~P.756658~~
~~P.756659~~
~~P.756660~~
~~P.756661~~
~~P.756662~~
~~P.756663~~
~~P.756664~~
~~P.756665~~
~~P.756666~~
~~P.756667~~
~~P.756668~~
~~P.756669~~
P.848234
P.848235
P.848236
P.848284
P.848285
P.848286
P.848287
P.848288
P.848304
P.848305
P.848306
P.848307
P.848308
P.848309

*claims
 canceled*

P.848310
P.848311
P.848312
P.848313
P.848314
P.848315
P.848316
P.848317
P.848318
P.848319
P.848320
P.848321
P.848322
P.848323
P.848330
P.848331
P.848332
P.848333
P.848357
P.848358
P.848359
P.848360
P.848361
P.848362
P.848363
P.848364
P.848365
P.848366
P.848367
P.848368
~~P.851901~~
~~P.851902~~
~~P.851903~~
~~P.851904~~

*claims
 canceled*



413/86

Instructions: - Please type or print.
- If number of mining claims traversed exceeds space on this form, attach a list.
Note: - Only days credits calculated in the "Expenditures" section may be entered in the "Expend. Days Cr." columns.
- Do not use shaded areas below.

2,9590

Mining Act

Type of Survey(s) AIRBORNE MAGNETOMETER VLF-EM		Township or Area CALVERT & CLERGUE TWS.	
Claim Holder(s) (D. MCKINNON - M21833)(Y. GRONDIN - M21611)(P. LACROIX - M20603)			Prospector's Licence No.
Address Box 1130, TIMMINS, ONT. P4N 7S6			
Survey Company H. FERDERBER GEOPHYSICS		Date of Survey (from & to) 23 Day 06 Mo. 86 Yr. 24 Day 06 Mo. 86 Yr.	
Name and Address of Author (of Geo-Technical report) FENTON SCOTT 17 MALABAR PLACE, DON MILLS, ONTARIO		Total Miles of line Cut 48	

Credits Requested per Each Claim in Columns at right

Mining Claims Traversed (List in numerical sequence)

Special Provisions	Geophysical		Days per Claim
	- Electromagnetic		
For first survey: Enter 40 days. (This includes line cutting)	- Magnetometer		
For each additional survey: using the same grid: Enter 20 days (for each)	- Radiometric		
	- Other		
	Geological		
	Geochemical		
Man Days	Geophysical		Days per Claim
	- Electromagnetic		
Complete reverse side and enter total(s) here	- Magnetometer		
	- Radiometric		
	- Other		
	Geological		
	Geochemical		
Airborne Credits	Electromagnetic VLF		Days per Claim
Note: Special provisions credits do not apply to Airborne Surveys.			30
	Magnetometer		30
	Radiometric		

Mining Claim			Mining Claim		
Prefix	Number	Expend. Days Cr.	Prefix	Number	Expend. Days Cr.
LIST ATTACHED					

RECORDED
DEC 19 1986

Expenditures (excludes power stripping)

Type of Work Performed	
Performed on Claim(s)	DEC 10 1986

Calculation of Expenditure Days Credits

Total Expenditures	+	15	=	Total Days Credits
\$				

Total number of mining claims covered by this report of work. 40

Instructions
Total Days Credits may be apportioned at the claim holder's choice. Enter number of days credits per claim selected in columns at right.

For Office Use Only			
Total Days Cr. Recorded	Date Recorded	Mining Recorder	
2400	Dec. 19/86	<i>[Signature]</i>	
	Date Approved as Recorded		
	87.2.20	Branch Director	

Date	Recorded Holder or Agent (Signature)
DEC. 17, 1986	<i>[Signature]</i>

Certification Verifying Report of Work

I hereby certify that I have a personal and intimate knowledge of the facts set forth in the Report of Work annexed hereto, having performed the work or witnessed same during and/or after its completion and the annexed report is true.

Name and Postal Address of Person Certifying	Date Certified	Certified by (Signature)
DON MCKINNON, Box 1130, TIMMINS, ONTARIO. P4N 7S6	DEC. 17, 1986	<i>[Signature]</i>

CALVERT AND CLERGUE TWF.

P.756617	P.756645	P.756677	P.852270
P.756618	P.756646	F.756678	P.852271
P.756619	P.756647	F.756679	P.852272
P.756620	P.756648	P.756680	P.852273
P.756639	P.756649	F.756681	P.852274
P.756640	P.756650	P.756682	P.852275
P.756641	P.756673	F.852066	P.866605
P.756642	P.756674	F.852067	P.866606
P.756643	P.756675	P.852268	P.866607
P.756644	P.756676	P.852269	P.866608

06/87

Instructions: - Please type or print.
- If number of mining claims traversed exceeds space on this form, attach a list.
Note: - Only days credits calculated in the "Expenditures" section may be entered in the "Expend. Days Cr." columns.
- Do not use shaded areas below.

W8706-00

Mining Act

2,9570

Type of Survey(s) AIRBORNE MAGNETOMETER VLF-EM		Township or Area HCCART TWP. DUNDONALD TWP.	
Claim Holder(s) (D. BEDARD - M21887) (D. L. MCKINNON - M21873) (R. SALO - M21873)		Prospector's Licence No. (Y. GRANDIN - M21611)	
Address Box 1130, TIMMINS, ONTARIO P4N 7S6			
Survey Company H. FERDERBER GEOPHYSICS	Date of Survey (from & to) 1 JUNE 86 5 JUNE 86		Total Miles of line Cut 158
Name and Address of Author (of Geo-Technical report) FENTON SCOTT, 17 MALABAR PLACE, DON MILLS, ONTARIO			

Credits Requested per Each Claim in Columns at right

Mining Claims Traversed (List in numerical sequence)

Special Provisions	Geophysical	Days per Claim
For first survey: Enter 40 days. (This includes line cutting)	- Electromagnetic	
	- Magnetometer	
	- Radiometric	
	- Other	
For each additional survey: using the same grid: Enter 20 days (for each)	Geological	
	Geochemical	
	Geophysical	Days per Claim
	- Electromagnetic	
Man Days Complete reverse side and enter total(s) here	- Magnetometer	
	- Radiometric	
	- Other	
	Geological	
Airborne Credits Note: Special provisions credits do not apply to Airborne Surveys.	Electromagnetic VLF	30
	Magnetometer	30
	Radiometric	

Mining Claim			Mining Claim		
Prefix	Number	Expend. Days Cr.	Prefix	Number	Expend. Days Cr.
LIST ATTACHED					
RECEIVED					
FEB - 4 1987					
MINING LANDS SECTION					
RECORDED					
JAN 14 1987					

Expenditures (excludes power stripping)

Type of Work Performed

Performed on Claim(s)

Calculation of Expenditure Days Credits

Total Expenditures \$ + 15 = Total Days Credits

Instructions
Total Days Credits may be apportioned at the claim holder's choice. Enter number of days credits per claim selected in columns at right.

Total number of mining claims covered by this report of work. **139**

For Office Use Only		Mining Recorder	
Total Days Cr. Recorded	Date Recorded	<i>[Signature]</i>	
8340	Jan. 14/87		
Date Approved as Recorded		Branch Director	
977.70		<i>[Signature]</i>	

Certification Verifying Report of Work

I hereby certify that I have a personal and intimate knowledge of the facts set forth in the Report of Work annexed hereto, having performed the work or witnessed same during and/or after its completion and the annexed report is true.

Name and Postal Address of Person Certifying
DON MCKINNON, Box 1130, TIMMINS, ONT. P4N 7S6

Date Certified **DEC. 22/86** Certified by (Signature) *[Signature]*

755651
 755652
 755653
 755654
 755655
 755656
 755657
 755658
 755659
 755660
 755661
 755662
 755663
 755664
 755665
 755666
 755667
 755668
 755669
 755670
 755671
 755672
 755673
 755674
 755675
 755676
 755677
 755678
 755679
 755680
 755681
 755682
 755683
 755684
 755685
 755686
 755687
 755688
 755689
 755690
 755693
 755694
 755695
 755696
 755703
 755704
 755705
 755706
 755707
 755708
 755709
 755710
 755711
 755712
 755713

P. 755601
 755602
 755603
 755604
 755605
 755606
 755607
 755608
 755609
 755610
 755611
 755612
 755613
 755614
 755615
 755616
 755617
 755618
 755619
 755620
 755621
 755622
 755623
 755624
 755625
 755626
 755627
 755628
 755629
 755630
 755631
 755632
 755633
 755634
 755635
 755636
 755637
 755638
 755645
 755646
 755647
 755648
 755649
 755650
 755697
 755698
 755699
 755700
 755701
 755702
 755714
 755715
 755716
 755724
 755725

P. 755726
 755727
 755728
 755729
 755730
 755731
 756651
 756652
 756653
 756654
 756655
 756656
 756657
 756658
 756659
 756660
 756661
 756662
 756663
 756664
 756665
 756666
 756667
 756668
 756669
 851901
 851902
 851903
 851904



2950

File 410 412 411 413

TO BE ATTACHED AS AN APPENDIX TO TECHNICAL REPORT
FACTS SHOWN HERE NEED NOT BE REPEATED IN REPORT
TECHNICAL REPORT MUST CONTAIN INTERPRETATION, CONCLUSIONS ETC.

Type of Survey(s) AIRBORNE VLF-MAG-GRADIENT MAG
Township or Area LITTLE ET AL.
Claim Holder(s) L. SAND ET AL
Survey Company H. FERDEKSEL GEOPHYSICS
Author of Report FENTON SCOTT
Address of Author 17 MARLBOROUGH PLACE, DON MILLS,
Covering Dates of Survey JUNE 1 - JUNE 24/86
Total Miles of Line Cut

MINING CLAIMS TRAVERSED
List numerically

Table with columns for (prefix) and (number) for listing mining claims.

If space insufficient, attach list

SPECIAL PROVISIONS CREDITS REQUESTED table with columns for Geophysical and DAYS per claim.

AIRBORNE CREDITS (Special provision credits do not apply to airborne surveys)
Magnetometer 30 Electromagnetic 30 Radiometric 20

DATE: Dec 29/86 SIGNATURE: [Signature]
Author of Report or Agent

Res. Geol. Qualifications

Previous Surveys

Table with columns for File No., Type, Date, and Claim Holder for previous surveys.

TOTAL CLAIMS

OFFICE USE ONLY

GEOPHYSICAL TECHNICAL DATA

GROUND SURVEYS - If more than one survey, specify data for each type of survey

Number of Stations _____ Number of Readings _____
Station interval _____ Line spacing _____
Profile scale _____
Contour interval _____

MAGNETIC

Instrument _____
Accuracy - Scale constant _____
Diurnal correction method _____
Base Station check-in interval (hours) _____
Base Station location and value _____

ELECTROMAGNETIC

Instrument _____
Coil configuration _____
Coil separation _____
Accuracy _____
Method: Fixed transmitter Shoot back In line Parallel line
Frequency _____
(specify V.L.F. station)
Parameters measured _____

GRAVITY

Instrument _____
Scale constant _____
Corrections made _____

Base station value and location _____

Elevation accuracy _____

INDUCED POLARIZATION RESISTIVITY

Instrument _____

Method Time Domain Frequency Domain

Parameters - On time _____ Frequency _____
- Off time _____ Range _____
- Delay time _____
- Integration time _____

Power _____
Electrode array _____
Electrode spacing _____
Type of electrode _____

REPORT ON
AIRBORNE GEOPHYSICAL SURVEYS
MANN, NEWMARKET, LITTLE, MCCART, CALVERT
EVELYN, DUNDONALD, CLERGUE, GERMAN
TOWNSHIPS
ONTARIO
FOR
ANGELA DEVELOPMENTS LTD
BY
H. FERDERBER GEOPHYSICS

DON MILLS, ONTARIO
November 29, 1986

FENTON SCOTT, P. ENG.

SELF POTENTIAL

Instrument _____ Range _____

Survey Method _____

Corrections made _____

RADIOMETRIC

Instrument _____

Values measured _____

Energy windows (levels) _____

Height of instrument _____ Background Count _____

Size of detector _____

Overburden _____

(type, depth - include outcrop map)

OTHERS (SEISMIC, DRILL WELL LOGGING ETC.)

Type of survey _____

Instrument _____

Accuracy _____

Parameters measured _____

Additional information (for understanding results) _____

AIRBORNE SURVEYS

Type of survey(s) VLF-EM MAGNETOMETRIC GRAVIMET. MAG.

Instrument(s) TOTEM 2A GEM-GSM-2A GEM-GSM-2A
(specify for each type of survey)

Accuracy 1% 2% 2%
(specify for each type of survey)

Aircraft used CESSNA 172

Sensor altitude 300' 300' 300' AND 500'

Navigation and flight path recovery method VISUAL NAVIGATION, MANUAL FIDUCIALS
ON AIR PHOTO MOSAICS

Aircraft altitude 300' Line Spacing 440'

Miles flown over total area _____ Over claims only _____

GEOCHEMICAL SURVEY - PROCEDURE RECORD

Numbers of claims from which samples taken _____

Total Number of Samples _____

Type of Sample _____
(Nature of Material)

Average Sample Weight _____

Method of Collection _____

Soil Horizon Sampled _____

Horizon Development _____

Sample Depth _____

Terrain _____

Drainage Development _____

Estimated Range of Overburden Thickness _____

SAMPLE PREPARATION
(Includes drying, screening, crushing, ashing)

Mesh size of fraction used for analysis _____

General _____

ANALYTICAL METHODS

Values expressed in: per cent
p. p. m.
p. p. b.

Cu, Pb, Zn, Ni, Co, Ag, Mo, As, -(circle)

Others _____

Field Analysis (_____ tests)

Extraction Method _____

Analytical Method _____

Reagents Used _____

Field Laboratory Analysis

No. (_____ tests)

Extraction Method _____

Analytical Method _____

Reagents Used _____

Commercial Laboratory (_____ tests)

Name of Laboratory _____

Extraction Method _____

Analytical Method _____

Reagents Used _____

General _____



TO BE ATTACHED AS AN APPENDIX TO TECHNICAL REPORT
FACTS SHOWN HERE NEED NOT BE REPEATED IN REPORT
TECHNICAL REPORT MUST CONTAIN INTERPRETATION, CONCLUSIONS ETC.

Type of Survey(s) VLF-EM, MAGNETOMETER, GRADIENT MAG.
Township or Area MANN ET AL
Claim Holder(s) D'ORVAZ MINES, SILVER SCEPTRE,
EBINY GOLD MINES
Survey Company H. FERRELLER GEOPHYSICS
Author of Report FENTON SCOTT
Address of Author 17 MAZABAN PLACE, DIN MILLS
Covering Dates of Survey 1
FROWN (linecutting to office)
Total Miles of Line Cut _____

MINING CLAIMS TRAVERSED
List numerically

755601 ET AL
(prefix) (number)

SPECIAL PROVISIONS
CREDITS REQUESTED

DAYS
per claim

ENTER 40 days (includes
line cutting) for first
survey.

ENTER 20 days for each
additional survey using
same grid.

- Geophysical
 - Electromagnetic _____
 - Magnetometer _____
 - Radiometric _____
 - Other _____
- Geological _____
- Geochemical _____

AIRBORNE CREDITS (Special provision credits do not apply to airborne surveys)

Magnetometer 30 Electromagnetic 30 GRADIENT Radiometric 20
(enter days per claim)

DATE: Nov 24/84 SIGNATURE: [Signature]
Author of Report or Agent

Res. Geol. _____ Qualifications (B 1263)

Previous Surveys

File No.	Type	Date	Claim Holder

TOTAL CLAIMS 735

If space insufficient, attach list

OFFICE USE ONLY

GEOPHYSICAL TECHNICAL DATA

GROUND SURVEYS – If more than one survey, specify data for each type of survey

Number of Stations _____ Number of Readings _____

Station interval _____ Line spacing _____

Profile scale _____

Contour interval _____

MAGNETIC

Instrument _____

Accuracy – Scale constant _____

Diurnal correction method _____

Base Station check-in interval (hours) _____

Base Station location and value _____

ELECTROMAGNETIC

Instrument _____

Coil configuration _____

Coil separation _____

Accuracy _____

Method: Fixed transmitter Shoot back In line Parallel line

Frequency _____
(specify V.L.F. station)

Parameters measured _____

GRAVITY

Instrument _____

Scale constant _____

Corrections made _____

Base station value and location _____

Elevation accuracy _____

INDUCED POLARIZATION

RESISTIVITY

Instrument _____

Method Time Domain Frequency Domain

Parameters – On time _____ Frequency _____

– Off time _____ Range _____

– Delay time _____

– Integration time _____

Power _____

Electrode array _____

Electrode spacing _____

Type of electrode _____

ANGELA

EBONY

(CLAIMS)

200 ch

755601	755627	755683	756616	756646
755602	755628	755685	756617	756647
755603	755629	755686	756618	756648
755604	755630	755687	756619	756649
755605	755631	755688	756620	756650
755606	755632	755695	756621	756651
755607	755633	755696	756622	756652
755608	755634	755697	756623	756653
755609	755635	755698	756624	756654
755610	755636	755699	756625	756655
755611	755637	755700	756626	756656
755612	755638	755701	756627	756657
755613	755645	755702	756628	756658
755614	755646	756601	756629	756659
755615	755647	756602	756630	756660
755616	755648	756603	756631	756661
755617	755650	756604	756632	756662
755618	755668	756606	756633	756663
755619	755669	756607	756634	756664
755620	755672	756609	756639	756665
755621	755673	756610	756640	756666
755622	755676	756611	756641	756667
755623	755677	756612	756642	756668
755624	755680	756613	756643	756669
755625	755681	756614	756644	756673
755626	755682	756615	756645	756674

130
/20
202

756675	848234	848315	848358	852066
756676	848235	848316	848359	852067
756677	848236	848317	848360	852268
756678	848304	848318	848361	852269
756679	848305	848319	848362	852270
756680	848306	848320	848363	852271
756681	848307	848321	848364	852272
756682	848308	848322	848365	852273
756683	848309	848323	848366	852274
756684	848310	848330	848367	852275
756685	848311	848331	848368	866605
756686	848312	848332	851901	866606
756687	848313	848333	851902	866607
756688	848314	848357	852903	866608

APPENDIX I

LIST OF MINING CLAIMS

(SUMMARY)

287

Little Township - 24 claims

879473 to 879496 inclusive

McCart Township - 167 claims

755666, 755667, 755670
 755671, 755674, 755675
 755678, 755679, 755689
 755690, 755693, 755694
 852020 to 852031 inclusive
 852276 to 852295 inclusive
 867675 to 867682 inclusive
 867901 to 867930 inclusive
 867946 to 867949 inclusive
 867951 to 867991 inclusive
 871873 to 871880 inclusive
 876445 to 876464 inclusive
 876467 to 876476 inclusive
 879497 to 879498 inclusive

Mann Township - 40 claims

879433 to 879472 inclusive

Newmarket Township - 56 claims

876477 to 876500 inclusive
 879401 to 879432 inclusive

(CLAIMS)

755666	755678	852020	852026	852276
755667	755679	852021	852027	852277
755670	755689	852022	852028	852278
755671	755690	852023	852029	852279
755674	755693	852024	852030	852280
755675	755694	852025	852031	852281

852282	867906	867948	867976	876448
852283	867907	867949	867977	876449
853384	867908	867951	867978	876450
852285	867909	867952	867979	876451
852286	867910	867953	867980	876452
852287	867911	867954	867981	876453
852288	867912	867955	867982	876454
852289	867913	867956	867983	876455
852290	867914	867957	867984	876456
852291	867915	867958	867985	876457
852292	867916	867959	867986	876458
852293	867917	867960	867987	876459
852294	867918	867961	867988	876460
852295	867919	867962	867989	876461
867675	867920	867963	867990	876462
867676	867921	867964	867991	876463
867677	867922	867965	871873	876464
867678	867923	867966	871874	876467
867679	867924	867967	871875	876468
867680	867925	867968	871876	876469
867681	867926	867969	871877	876470
867682	867927	867970	871878	876471
867901	867928	867971	871879	876472
867902	867929	867972	871880	876473
867903	867930	867973	876445	876474
867904	867946	867974	876446	876475
867905	867947	867975	876447	876476

876477	879402	879427	879452	879477
876478	879403	879428	879453	879478
876479	879404	879429	879454	879479
876480	879405	879430	879455	879480
876481	879406	879431	879456	879481
876482	879407	879432	879457	879482
876483	879408	879433	879458	879483
876484	879409	879434	879459	879484
876485	879410	879435	879460	879485
876486	879411	879436	879461	879486
876487	879412	879437	879462	879487
876488	879413	879438	879463	879488
876489	879414	879439	879464	879489
876490	879415	879440	879465	879490
876491	879416	879441	879466	879491
876492	879417	879442	879467	879492
876493	879418	879443	879468	879493
876494	879419	879444	879469	879494
876495	879420	879445	879470	879495
876496	879421	879446	879471	879496
876497	879422	879447	879472	879497
876498	879423	879448	879473	879498
876499	879424	879449	879474	
876500	879425	879450	879475	
879401	879426	879451	879476	

278 ANGELA - SIEBEL - SCOTT - A2

835697	852085	852296	866615	866642
835698	852086	852297	866616	866643
835699	852087	852298	866617	866644
835700	852088	852299	866618	866645
835701	852089	852300	866619	866646
851904	852090	852301	866620	867931
852016	852091	852302	866621	867932
852017	852092	852303	866622	867933
852018	852093	852304	866623	867934
852019	852094	852305	866624	867935
852068	852095	852306	866625	867936
852069	852096	852307	866626	867937
852070	852097	852309	866627	867938
852071	852098	852310	866628	867939
852072	852099	852311	866629	867940
852073	852100	852312	866630	867941
852074	852101	852313	866631	867942
852075	852102	852314	866632	867943
852076	852103	852315	866633	867944
852077	852104	852316	866634	867945
852078	852105	852317	866635	870401
852079	852106	866609	866636	870402
852080	852107	866610	866637	870403
852081	852108	866611	866638	870404
852082	852109	866612	866639	870405
852083	852110	866613	866640	870406
852084	852111	866614	866641	870407

134

870408	870431	870454	870477	871547
870409	870432	870455	870478	871548
870410	870433	870456	870479	871549
870411	870434	870457	870480	871550
870412	870435	870458	870481	871551
870413	870436	870459	870482	871552
870414	870437	870460	870483	871553
870415	870438	870461	870484	871554
870416	870439	870462	870485	871555
870417	870440	870463	870486	871556
870418	870441	870464	870487	871557
870419	870442	870465	870488	871558
870420	870443	870466	870489	871559
870421	870444	870467	870490	871560
870422	870445	870468	870491	871561
870423	870446	870469	870492	871562
870424	870447	870470	871540	871563
870425	870448	870471	871541	871564
870426	870449	870472	871542	871565
870427	870450	870473	871543	871566
870428	870451	870474	871544	871567
870429	870452	870475	871545	
870430	870453	870476	871546	

SELF POTENTIAL

Instrument _____ Range _____

Survey Method _____

Corrections made _____

RADIOMETRIC

Instrument _____

Values measured _____

Energy windows (levels) _____

Height of instrument _____ Background Count _____

Size of detector _____

Overburden _____

(type, depth - include outcrop map)

OTHERS (SEISMIC, DRILL WELL LOGGING ETC.)

Type of survey _____

Instrument _____

Accuracy _____

Parameters measured _____

Additional information (for understanding results) _____

AIRBORNE SURVEYS

Type of survey(s) VLF-EM MAGNETIC GRADIENT MAG

Instrument(s) WEM 2A GEM GSH12A
(specify for each type of survey)

Accuracy 1% 2%
(specify for each type of survey)

Aircraft used CESNA 172

Sensor altitude 300' 300' ← AND → 500'

Navigation and flight path recovery method VISUAL NAVIGATION WITH
MANUAL NAVIGATION FIDUCIAL PLOTS.

Aircraft altitude 300' + 500' Line Spacing 440'

Miles flown over total area 1500' (?) Over claims only 500

GEOCHEMICAL SURVEY – PROCEDURE RECORD

Numbers of claims from which samples taken _____

Total Number of Samples _____

Type of Sample _____
(Nature of Material)

Average Sample Weight _____

Method of Collection _____

Soil Horizon Sampled _____

Horizon Development _____

Sample Depth _____

Terrain _____

Drainage Development _____

Estimated Range of Overburden Thickness _____

SAMPLE PREPARATION

(Includes drying, screening, crushing, ashing)

Mesh size of fraction used for analysis _____

General _____

ANALYTICAL METHODS

Values expressed in: per cent
p. p. m.
p. p. b.

Cu, Pb, Zn, Ni, Co, Ag, Mo, As, (circle)

Others _____

Field Analysis (_____ tests)

Extraction Method _____

Analytical Method _____

Reagents Used _____

Field Laboratory Analysis

No. (_____ tests)

Extraction Method _____

Analytical Method _____

Reagents Used _____

Commercial Laboratory (_____ tests)

Name of Laboratory _____

Extraction Method _____

Analytical Method _____

Reagents Used _____

General _____

MINING LANDS: PLEASE COMPLETE THIS FORM & RETURN IT WITH REPORT TO THE GEOSCIENCE DATA CENTRE

DATE REMOVED: FEB 13/87
(from GDC)

DATE RETURNED: _____
(to GDC)

REPORT # : 2.9590

FICHE NO. : _____ (where applicable)

REASON FOR REQUESTING REPORT (complete #1-4 below):

1. INFORMATION ADDED TO EXISTING PAGES OF REPORT:

IF YES, SPECIFY PAGES: _____
: _____
: _____

2. a) PAGES/MAPS ADDED TO THIS REPORT: _____ TOTAL PAGES ADDED
: _____ TOTAL MAPS ADDED

b) TYPE OF PGS ADDED: ✓ CORRESPONDENCE
: _____ WORK REPORTS (AMENDED)
: ✓ WORK RPTS (NEW)
: _____ MISSING PAGES OF TEXT
: ✓ OTHER (PLEASE SPECIFY) *Technical Data Statement*

3. a) REMOVAL OF PGS FROM REPORT: _____ TOTAL PGS REMOVED

b) TYPE OF PAGES REMOVED : _____ CORRESPONDENCE
: _____ WORK REPORTS
: _____ PGS OF TEXT
: _____ OTHER (PLEASE SPECIFY)

4. REPORT NEEDED FOR REFERENCE ONLY:

NO INFORMATION ALTERED :
NO INFORMATION ADDED :
NO INFORMATION DELETED :

*NOTE: ENTER "X" IN APPLICABLE BOXES

NOTE

LOT AND CONCESSION LINES SHOWN HEREON ARE PROJECTED FROM THE BEST INFORMATION AVAILABLE, BUT THEIR TRUE POSITION IS NOT GUARANTEED.

FOR LEGAL AND SURVEY PURPOSES CONSULT THE ORIGINAL SURVEY PLANS AND FIELD NOTES OF RECORD IN THE DEPARTMENT OF LANDS AND FORESTS, TORONTO.

ACREAGES SHOWN IN RESPECT OF PATENTED LOTS ARE IN ACCORDANCE WITH AREA GRANTED.

AREAS WITHDRAWN FROM DISPOSITION

M.R.O. - MINING RIGHTS ONLY	S.R.O. - SURFACE RIGHTS ONLY	M.F.S. - MINING AND SURFACE RIGHTS
Description	Order No.	Date
1	2	3
4	5	6
7	8	9
10	11	12
13	14	15
16	17	18
19	20	21
22	23	24
25	26	27
28	29	30
31	32	33
34	35	36
37	38	39
40	41	42
43	44	45
46	47	48
49	50	51
52	53	54
55	56	57
58	59	60
61	62	63
64	65	66
67	68	69
70	71	72
73	74	75
76	77	78
79	80	81
82	83	84
85	86	87
88	89	90
91	92	93
94	95	96
97	98	99
100	101	102
103	104	105
106	107	108
109	110	111
112	113	114
115	116	117
118	119	120
121	122	123
124	125	126
127	128	129
130	131	132
133	134	135
136	137	138
139	140	141
142	143	144
145	146	147
148	149	150
151	152	153
154	155	156
157	158	159
160	161	162
163	164	165
166	167	168
169	170	171
172	173	174
175	176	177
178	179	180
181	182	183
184	185	186
187	188	189
190	191	192
193	194	195
196	197	198
199	200	201
202	203	204
205	206	207
208	209	210
211	212	213
214	215	216
217	218	219
220	221	222
223	224	225
226	227	228
229	230	231
232	233	234
235	236	237
238	239	240
241	242	243
244	245	246
247	248	249
250	251	252
253	254	255
256	257	258
259	260	261
262	263	264
265	266	267
268	269	270
271	272	273
274	275	276
277	278	279
280	281	282
283	284	285
286	287	288
289	290	291
292	293	294
295	296	297
298	299	300
301	302	303
304	305	306
307	308	309
310	311	312
313	314	315
316	317	318
319	320	321
322	323	324
325	326	327
328	329	330
331	332	333
334	335	336
337	338	339
340	341	342
343	344	345
346	347	348
349	350	351
352	353	354
355	356	357
358	359	360
361	362	363
364	365	366
367	368	369
370	371	372
373	374	375
376	377	378
379	380	381
382	383	384
385	386	387
388	389	390
391	392	393
394	395	396
397	398	399
400	401	402
403	404	405
406	407	408
409	410	411
412	413	414
415	416	417
418	419	420
421	422	423
424	425	426
427	428	429
430	431	432
433	434	435
436	437	438
439	440	441
442	443	444
445	446	447
448	449	450
451	452	453
454	455	456
457	458	459
460	461	462
463	464	465
466	467	468
469	470	471
472	473	474
475	476	477
478	479	480
481	482	483
484	485	486
487	488	489
490	491	492
493	494	495
496	497	498
499	500	501
502	503	504
505	506	507
508	509	510
511	512	513
514	515	516
517	518	519
520	521	522
523	524	525
526	527	528
529	530	531
532	533	534
535	536	537
538	539	540
541	542	543
544	545	546
547	548	549
550	551	552
553	554	555
556	557	558
559	560	561
562	563	564
565	566	567
568	569	570
571	572	573
574	575	576
577	578	579
580	581	582
583	584	585
586	587	588
589	590	591
592	593	594
595	596	597
598	599	600

TOWNSHIP OF NEWMARKET

LITTLE OF TOWNSHIP

CALVERT OF TOWNSHIP

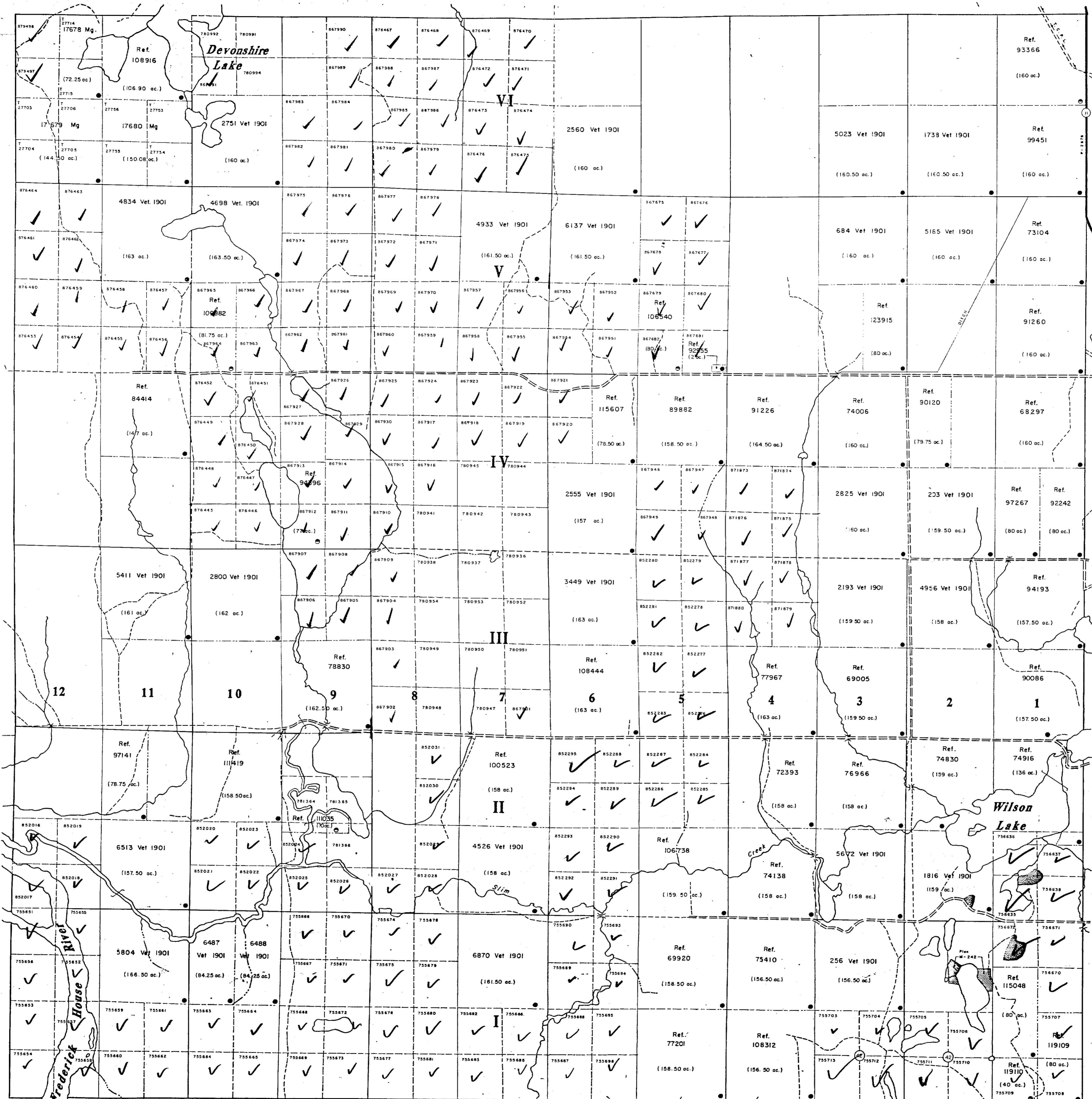

TOPOGRAPHY

LAKES, RIVERS, ETC., FROM FOREST RESOURCES INVENTORY SHEETS N# 486804 AND 487804

SURVEYS

TOWNSHIP OF McCART SUBDIVIDED BY A.D. GRIFFIN, O.L.S., 1904. FIELD NOTE BOOK 1533. WEST LIMIT OF McCART TOWNSHIP (SEE LITTLE TWP) SURVEY BY J.W. FITZGERALD, O.L.S., 1904. FIELD NOTE BOOK 1402. EAST LIMIT OF McCART TOWNSHIP (SEE CALVERT TWP) SURVEY BY ALEXANDER BAIRD, O.L.S., 1904. FIELD NOTE BOOK 1009. THIRD MERIDIAN (EAST LIMIT OF McCART TWP) BY WILLIAM GALBRAITH, O.L.S., 1904. FIELD NOTE BOOK 2363. BASE LINE (SOUTH LIMIT OF McCART TWP) BY T.J. PATTEN, O.L.S., 1903. FIELD NOTE BOOK 2460.

LEGEND

- Highway and route No. OTHER ROADS TRAILS SURVEYED LINES: TOWNSHIPS, BASE LINES, ETC. LOTS, MINING CLAIMS, PARCELS, ETC. UNSURVEYED LINES: LOT LINES PARCEL BOUNDARY MINING CLAIMS ETC. RAILWAY AND RIGHT OF WAY UTILITY LINES NON-PERENNIAL STREAM FLOODING OR FLOODING RIGHTS SUBDIVISION OR COMPOSITE PLAN RESERVATIONS ORIGINAL SHORELINE MARSH OR MUSKEG MINES TRAVERSE MONUMENT

DISPOSITION OF CROWN LANDS

Table with columns: TYPE OF DOCUMENT, SYMBOL. Includes entries for Patent, Surface & Mining Rights, Lease, Surface & Mining Rights, Licence of Occupation, Order-in-Council, Reservation, Cancelled, Sand & Gravel.

NOTE: MINING RIGHTS IN PARCELS PATENTED PRIOR TO MAY 8, 1912, VESTED IN ORIGINAL PATENTEES BY THE PUBLIC LANDS ACT, R.S.O. 1970, CHAP. 380, SEC. 63, SUBSEC. 1.

SCALE: 1 INCH = 20 CHAINS

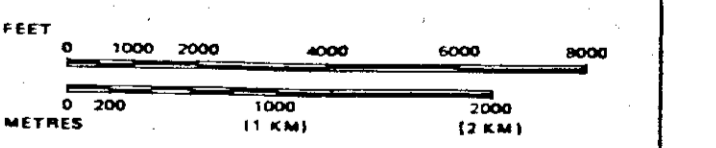

TOWNSHIP McCART M.N.R. ADMINISTRATIVE DISTRICT COCHRANE MINING DIVISION PORCUPINE LAND TITLES / REGISTRY DIVISION COCHRANE

Ministry of Natural Resources Ontario Ministry of Northern Development and Mines



MAP SYMBOLOGY

Aerial Cableway	Pipeline (above ground)
Boundary	Railroad
International	Single Track
Interprovincial	Double Track
District, Township Indian Reserve	Abandonment
Approach	Turbine
Lot, Concession	Road
Approach	Highway, County Township
Post Boundary	Access Road (of doubtful importance)
Bridge	Trail, Bush Road (average size)
Road, Railroad	Rapids
Building	Double line river with multiple rapids
Chimney	Double line river with multiple rapids
Cliff, Pit, Pile	Reservoir
Contours	River, Stream, Canal
Interprovincial	Approximate location of stream
Approach	Direction of flow
Control Points	Spot Elevation (Close elevation)
Horizontal	Tower
Vertical	Transmission Line
Culvert	Power Poles
Falls	Tunnel
Double line river	Utility Poles
Fence, Hedge, Wall	Wharf, Dock, Pier
Feature Outline (Construction features, etc.)	Wooded Area
Flooded Land	
Lock	
Marsh or Swamp	
Mast	
Mine Head Frame	
Outcrop	

AREAS WITHDRAWN FROM DISPOSITION

M.R.O. - MINING RIGHTS ONLY				
S.R.O. - SURFACE RIGHTS ONLY				
M.F.S. - MINING AND SURFACE RIGHTS				
Description	Order No.	Date	Disposition	File
(1) CERTIFIED AGRICULTURAL LAND				
(2) RESERVED FOR RECREATIONAL PURPOSES	188543			
- cancelled - see landroll				
(3) WTS/TT	22/5/77	S.R.O.	54333	
(4) SEWAGE DISPOSAL SITE - BONA FIDE APPLICATION UNDER P.L.A.				
(5) M.F.S. N.R.W.	1/84	Callie Sec		NRD 17/85

DUNDONALD TWP

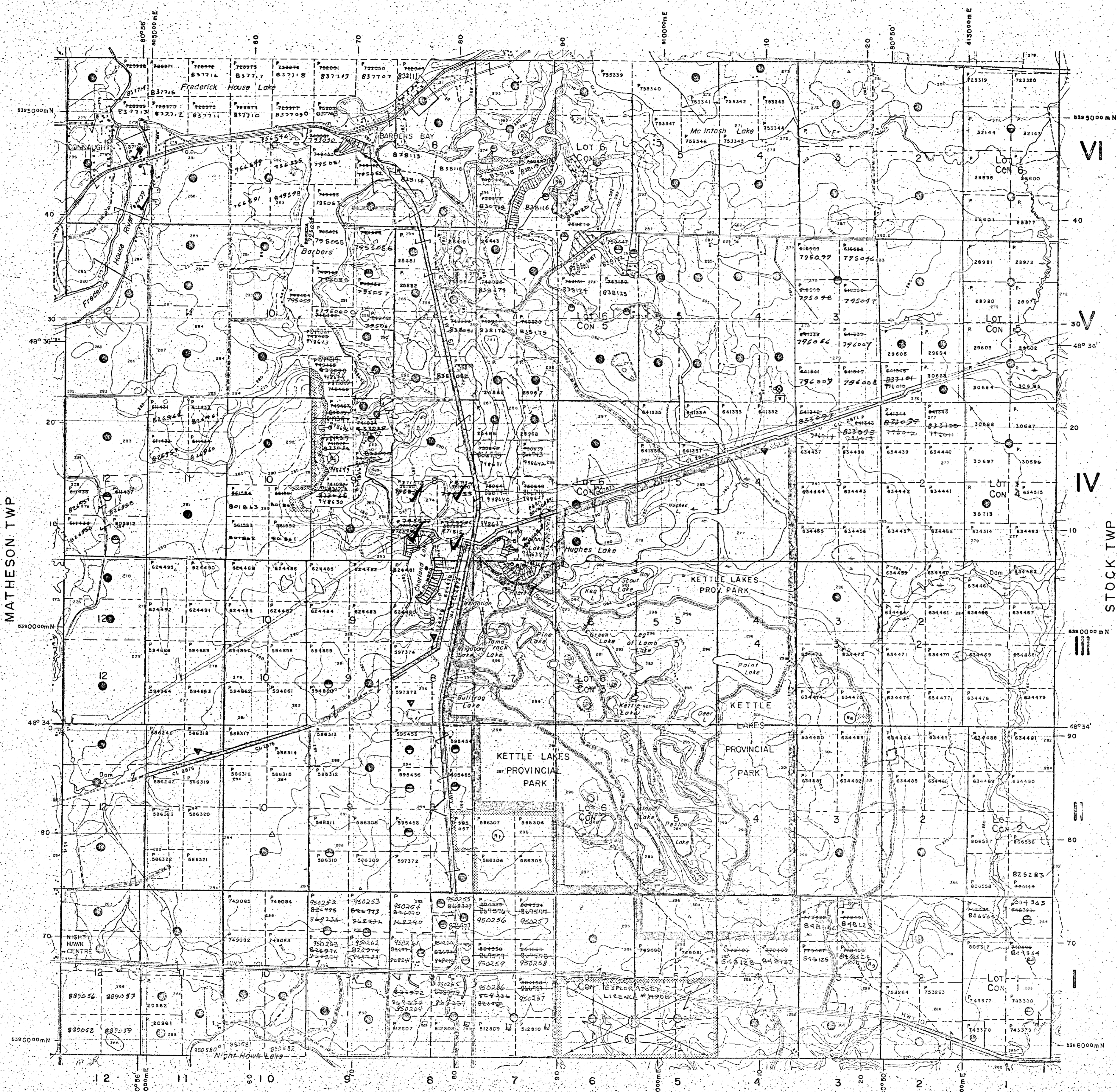

LEGEND

HIGHWAY AND ROUTE No	
OTHER ROADS	
TRAILS	
SURVEYED LINES:	
TOWNSHIPS, BASE LINES, ETC.	
LOTS, MINING CLAIMS, PARCELS, ETC.	
UNSURVEYED LINES:	
LOT LINES	
PARCEL BOUNDARY	
MINING CLAIMS ETC.	
RAILWAY AND RIGHT OF WAY	
UTILITY LINES	
NON PERENNIAL STREAM	
FLOODING OR FLOODING RIGHTS	
SUBDIVISION OR COMPOSITE PLAN	
RESERVATIONS	
ORIGINAL SHORELINE	
MARSH OR MUSKIE	
MINES	
TRAVERSE MONUMENT	

DISPOSITION OF CROWN LANDS

TYPE OF DOCUMENT	SYMBOL
PATENT, SURFACE & MINING RIGHTS	
SURFACE RIGHTS ONLY	
MINING RIGHTS ONLY	
LEASE, SURFACE & MINING RIGHTS	
SURFACE RIGHTS ONLY	
MINING RIGHTS ONLY	
LICENCE OF OCCUPATION	
ORDER IN COUNCIL	
RESERVATION	
CANCELLED	
SAND & GRAVEL	

NOTE: MINING RIGHTS IN PARCELS PATENTED PRIOR TO MAY 6 1913, VESTED IN ORIGINAL PATENTEES BY THE PUBLIC LANDS ACT, P.S.O. 1970, CHAP. 380, SEC. 63, SUBSEC. 1.

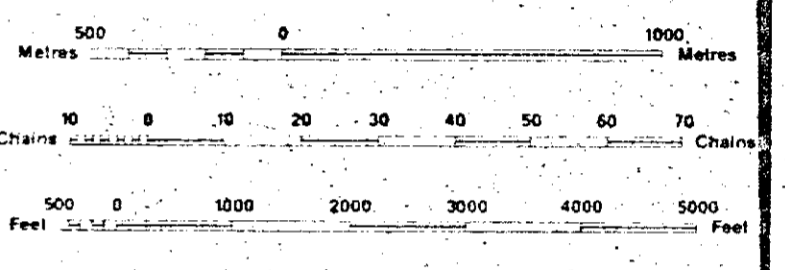

SCALE 1:20 000

GRID ZONE 17

NOTES

FLOODING RIGHTS ON NIGHTHAWK LAKE AND FREDRICK HOUSE RIVER TO ELEV. 903.5' RESERVED TO ONTARIO HYDRO.

FLOODING RIGHTS ON FREDRICK HOUSE LAKE TO ELEV. 903.0' TO ONTARIO HYDRO.

REGISTERED PLAN OF SUBDIVISION

NR 0 8/85 MAR 11/85 RE 107/84

NR 0 17/85 MAR 24/85 RE 149/84

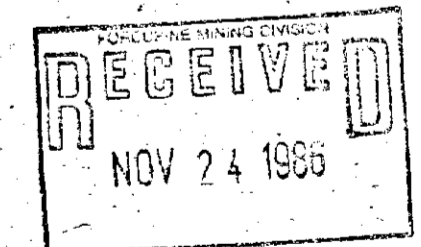

TOWNSHIP
GERMAN

M.M.R. ADMINISTRATIVE DISTRICT
TIMMINS

MINING DIVISION
POSCUPINE

LAND TITLES / REGISTRY DIVISION
COCHRANE

Ministry of Natural Resources
Land Management Branch
Ontario

ORIGINAL COMPILATION - JULY 1984
REVISED

Number
G-3902



ANGELA DEVELOPMENTS LTD.
AIRBORNE MAGNETIC SURVEY

DATE: 1986
SHEET: 4 OF 4
PLATE: 1M

LEGEND
CONTOUR INTERVAL: 500 GAMMAS
200 GAMMAS
100 GAMMAS
MAGNETIC LOW
BASE VALUE: 10000
MAGNETIC HIGH: 10000

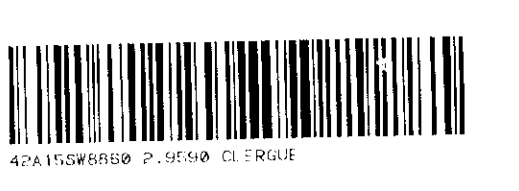
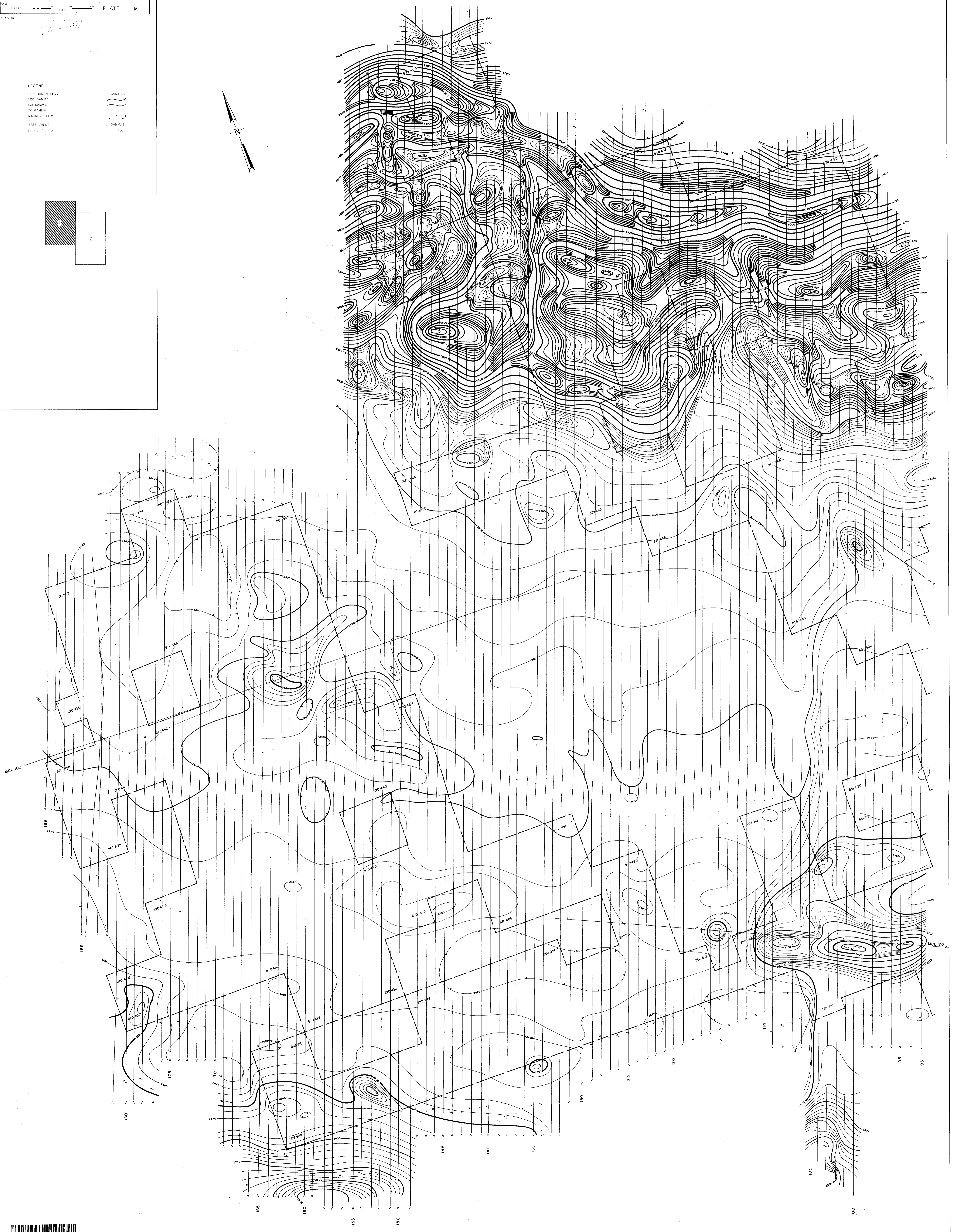
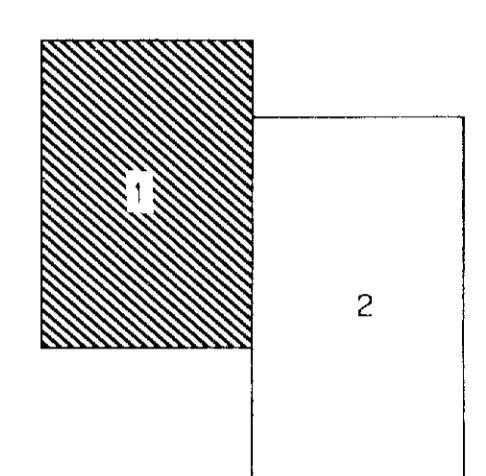
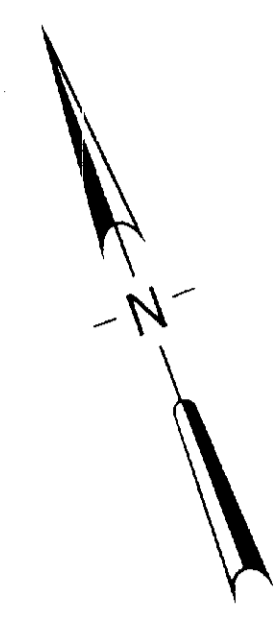

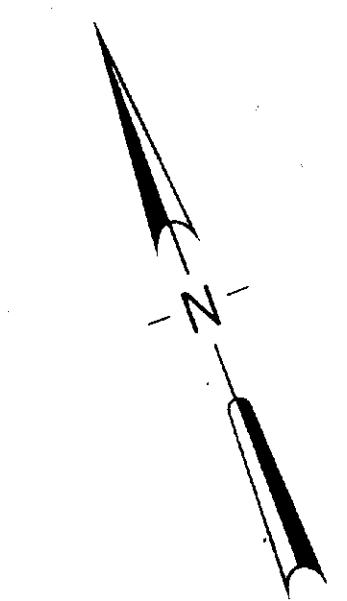


LEGEND

--- INCREASE INTERVAL
 --- 500 GAMMA
 --- 400 GAMMA
 --- 300 GAMMA
 --- 200 GAMMA
 --- 150 GAMMA
 --- 100 GAMMA
 --- 50 GAMMA

[Symbol: Dotted line] MAGNETIC DECLINATION
 [Symbol: Wavy line] MAGNETIC VARIATION
 [Symbol: Small circles] LOCATION OF STATION

H. Ferderber
H. FERDERBER GEOPHYSICS LTD.
1100 UNIVERSITY AVENUE, TORONTO, ONTARIO
ANGELA DEVELOPMENTS LTD.
 AIRBORNE MAGNETIC SURVEY

SHEET NO. 11
 DATE: 11-15-53
 SCALE: 1:25000
 PLATE 2 M



LEGEND
100.0 NANOTESLA/METRE
2.5 NANOTESLA/METRE
0.5 NANOTESLA/METRE
DEPRESSION
FLIGHT ALTITUDES
11m and 150m

MEASURED VERTICAL MAGNETIC GRADIENT
SENSOR SEPARATION = 60m

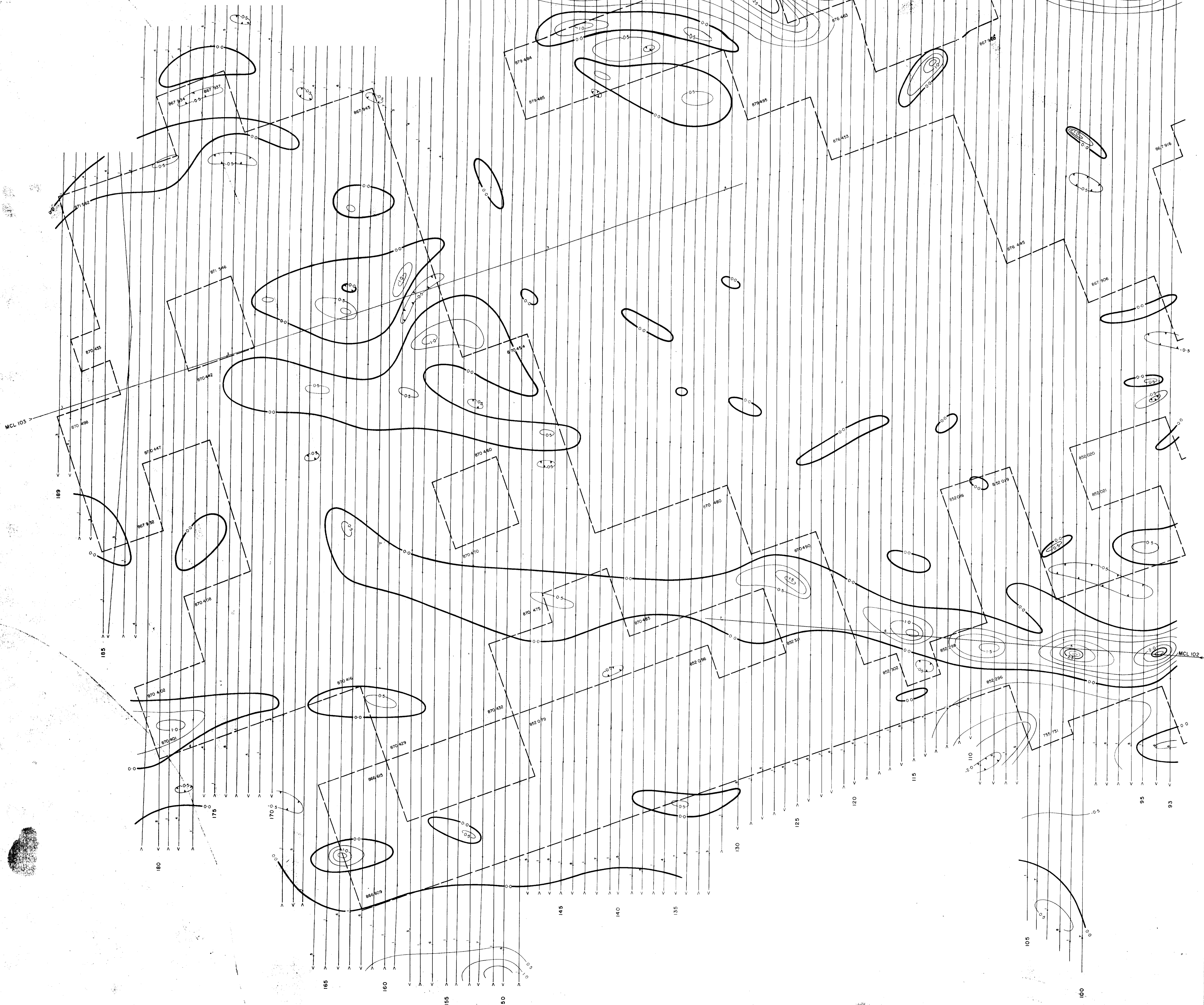
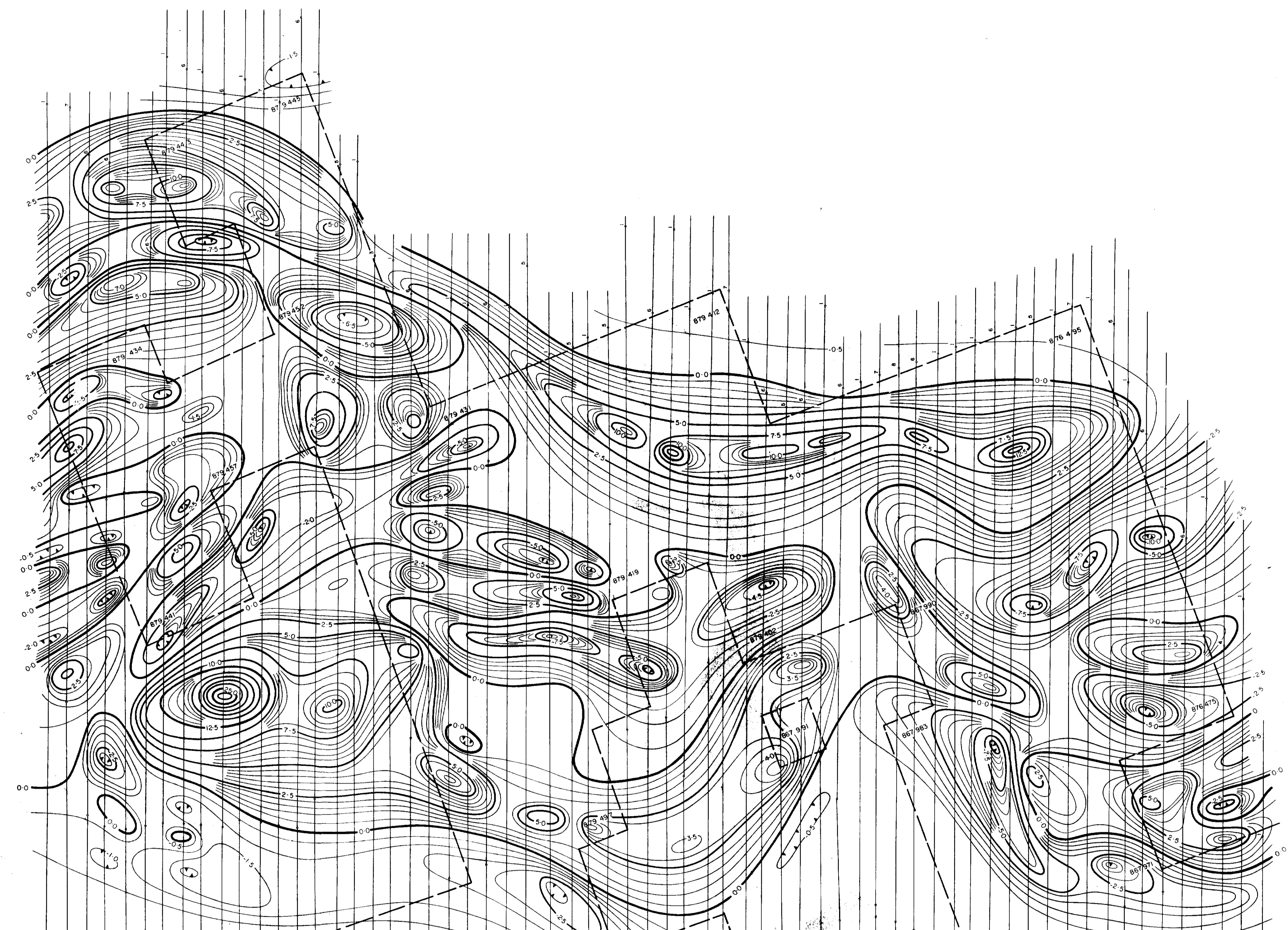
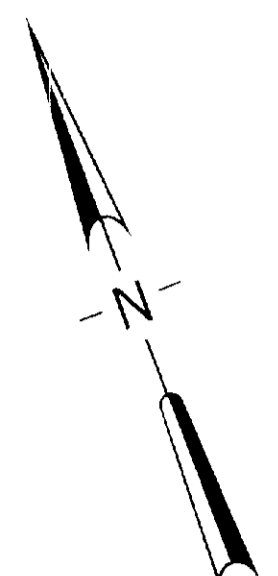
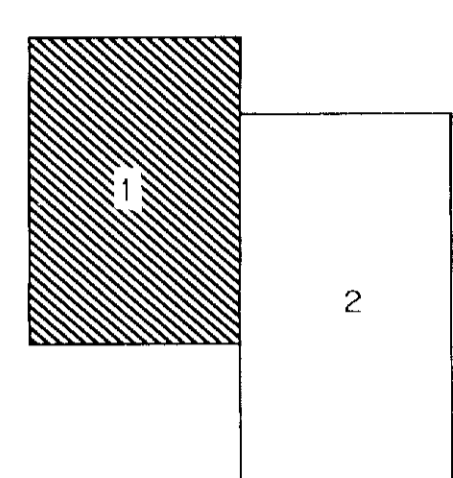

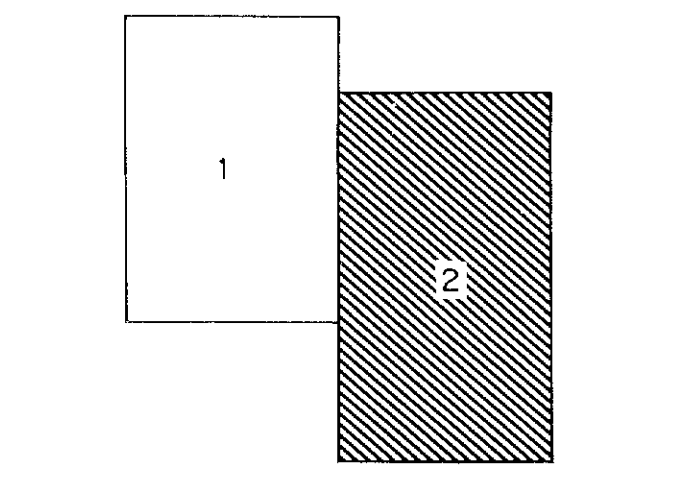
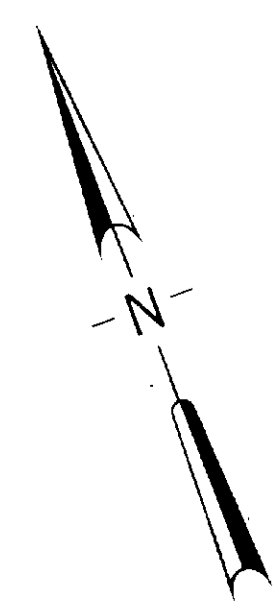

LEGEND
 0.25 NANOTESLA/METRE
 0.25 NANOTESLA/METRE
 0.25 NANOTESLA/METRE
 0.25 NANOTESLA/METRE
 0.25 NANOTESLA/METRE
 0.25 NANOTESLA/METRE

0.25 NANOTESLA/METRE
 0.25 NANOTESLA/METRE
 0.25 NANOTESLA/METRE
 0.25 NANOTESLA/METRE
 0.25 NANOTESLA/METRE
 0.25 NANOTESLA/METRE

H. FERDNER GEOPHYSICS LTD.
 404 FREDERICK HOUSE LANE, BRANTFORD, ONTARIO, CANADA

ANGELA DEVELOPMENTS LTD.
 AIRBORNE MAGNETIC SURVEY
 VERTICAL GRADIENT

DATE: 4/20/1986
 SHEET: 2 OF 2
 PLATE: 2 VG



LEGEND

- CONDUCTOR AXIS
- CONDUCTOR AXIS WITH QUADRATURE FIELD
- TRUCKS/PROX. (distance) + or - (angle) (height)
- FIELD INSTRUMENT AT 90° TO TRACKS/PROX. (distance)
- WIND: THESE TRACKS INDICATE WIND DIRECTION ONLY

INTERPRETATION

- OVERBURDEN IN SPONGE
- BEDROCK RESPONSE
- CULTURE

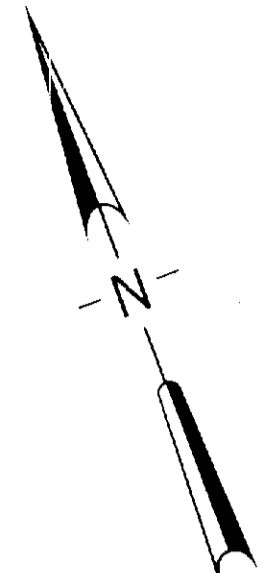
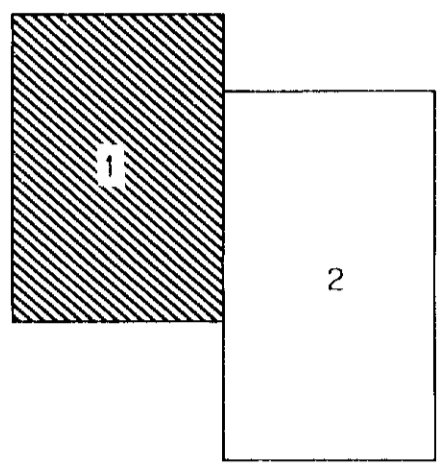



LEGEND

CONDUCTOR AXIS \rightarrow

CONDUCTOR AXIS WITH QUANTIFIED FIELD \bullet

TRAPS TO V.A. (SOUTH) AND TO SLOPE (SOUTH) \rightarrow

TRAP DISTANCE OF 100' TO SLOPE (SOUTH) \rightarrow

SEE: FROM FACTOR INDEX, FIELD DISTANCE (M)

INTERPRETATION

EMERGENCY RESPONSE \rightarrow

REMARK RESPONSE \rightarrow

STRUCTURE \triangle

H. FERDERBER GEOPHYSICS LTD.
 424/424.4/5 SEPTEMBER - 1986
 ANGELA DEVELOPMENTS LTD.
 AIRBORNE V.L.F.-EM SURVEY

SCALE 1:1200 PLATE 2V

