

Bowyer Twp.

THE TOWNSHIP OF
OF
GALNA
DISTRICT OF
COCHRANE
LARDER LAKE
MINING DIVISION
SCALE: 1 INCH = 40 CHAINS

VI
V
IV
III
II
I

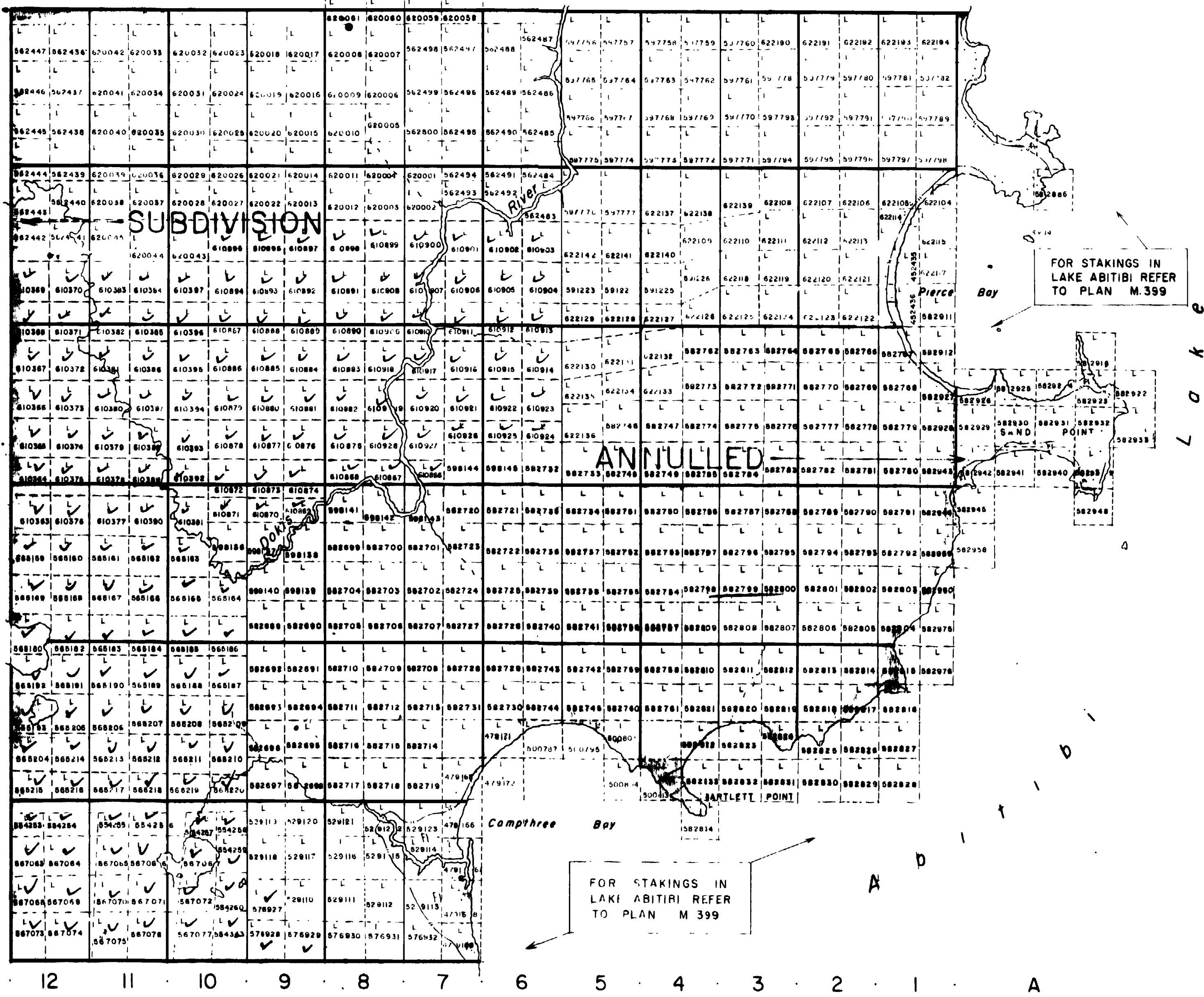

LEGEND

- PATENTED LAND (P)
- CROWN LAND SALE (C.S.)
- LEASES (L)
- LOCATED LAND (Loc.)
- LICENSE OF OCCUPATION (L.O.)
- ROADS
- IMPROVED ROADS
- KING'S HIGHWAY
- RAILWAYS
- POWER LINES
- MARSH OR MUSKEG
- MINES

NOTES

400' Surface rights reservation around all lakes and rivers.

DATE OF ISSUE
DEC - 7 1982
Ministry of Natural Resources
TORONTO

12 11 10 9 8 7 6 5 4 3 2 1 A

Kerrs Twp.



PLAN NO - M.480

MINISTRY OF NATURAL RESOURCES
SUPPLY OF NATURAL RESOURCES

MARATHON TP. M.542

Marathon Lake

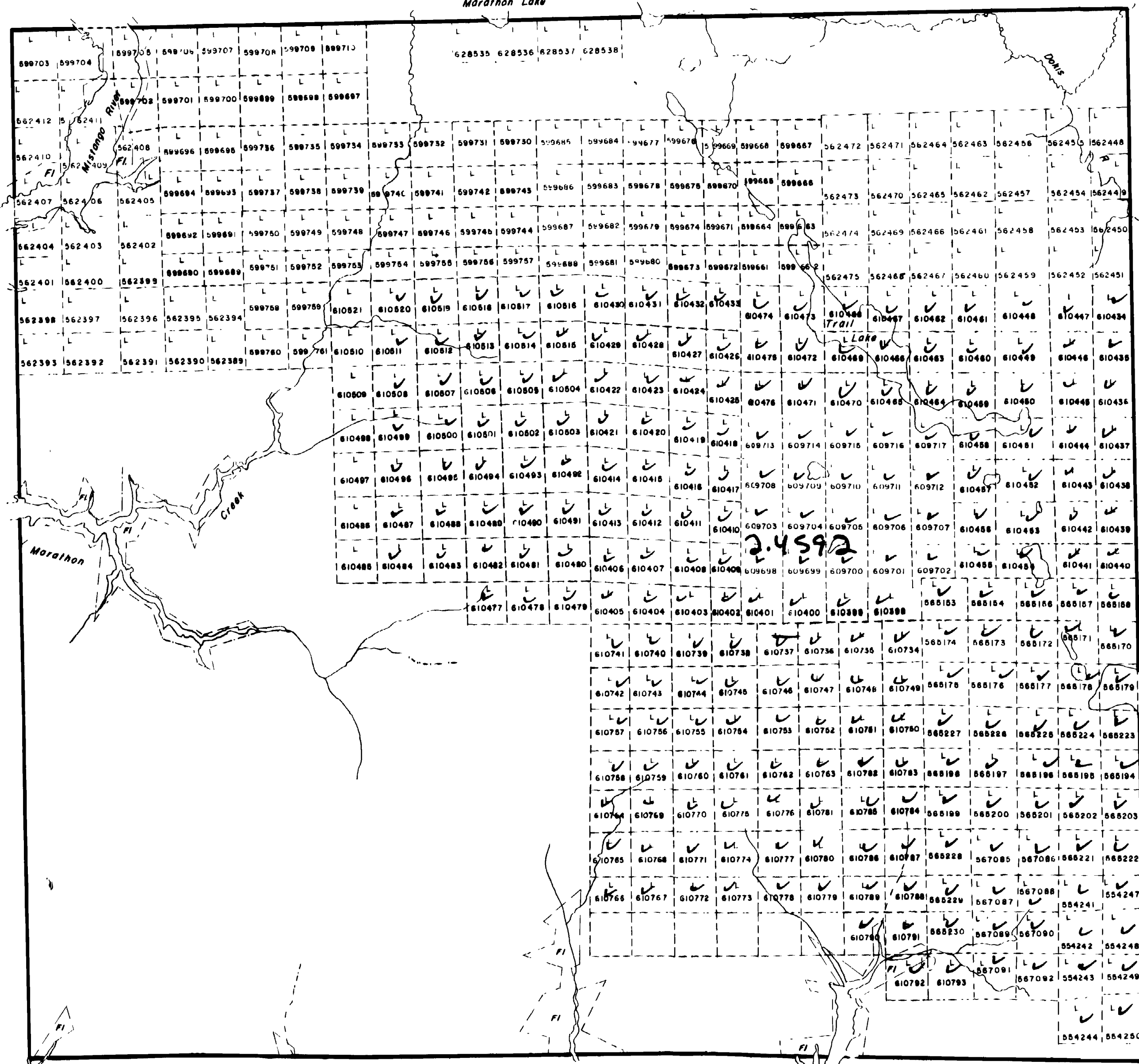

KNOX TP. M.525

THE TOWNSHIP OF

MOODY

DISTRICT OF COCHRANE

LARDER LAKE MINING DIVISION

SCALE: 1-INCH=40 CHAINS

LEGEND

- PATENTED LAND Ⓟ
- CROWN LAND SALE Ⓢ
- LEASES Ⓛ
- LOCATED LAND Loc.
- LICENSE OF OCCUPATION L.O.
- MINING RIGHTS ONLY M.R.O.
- SURFACE RIGHTS ONLY S.R.O.
- ROADS ⏏
- IMPROVED ROADS ⏏
- KING'S HIGHWAYS ⏏
- RAILWAYS ⏏
- POWER LINES ⏏
- MARSH OR MUSKEG ⏏
- MINES ⏏
- CANCELLED ⏏

NOTES

400' surface rights reservation along the shores of all lakes and rivers.

L.O. 8674 shown thus: covers land below contour 826' and 881'

Subdivision of this township in lots and concessions was annulled May 29, 1963.

DATE OF ISSUE
DEC 1 1982
Ministry of Natural Resources
TORONTO

PLAN NO.- M. 1832

ONTARIO
MINISTRY OF NATURAL RESOURCES
SURVEYS AND MAPPING BRANCH



Moody Twp.

THE TOWNSHIP OF
OF

KNOX

DISTRICT OF
COCHRANE

LARDER LAKE
MINING DIVISION

SCALE: 1-INCH=40 CHAINS

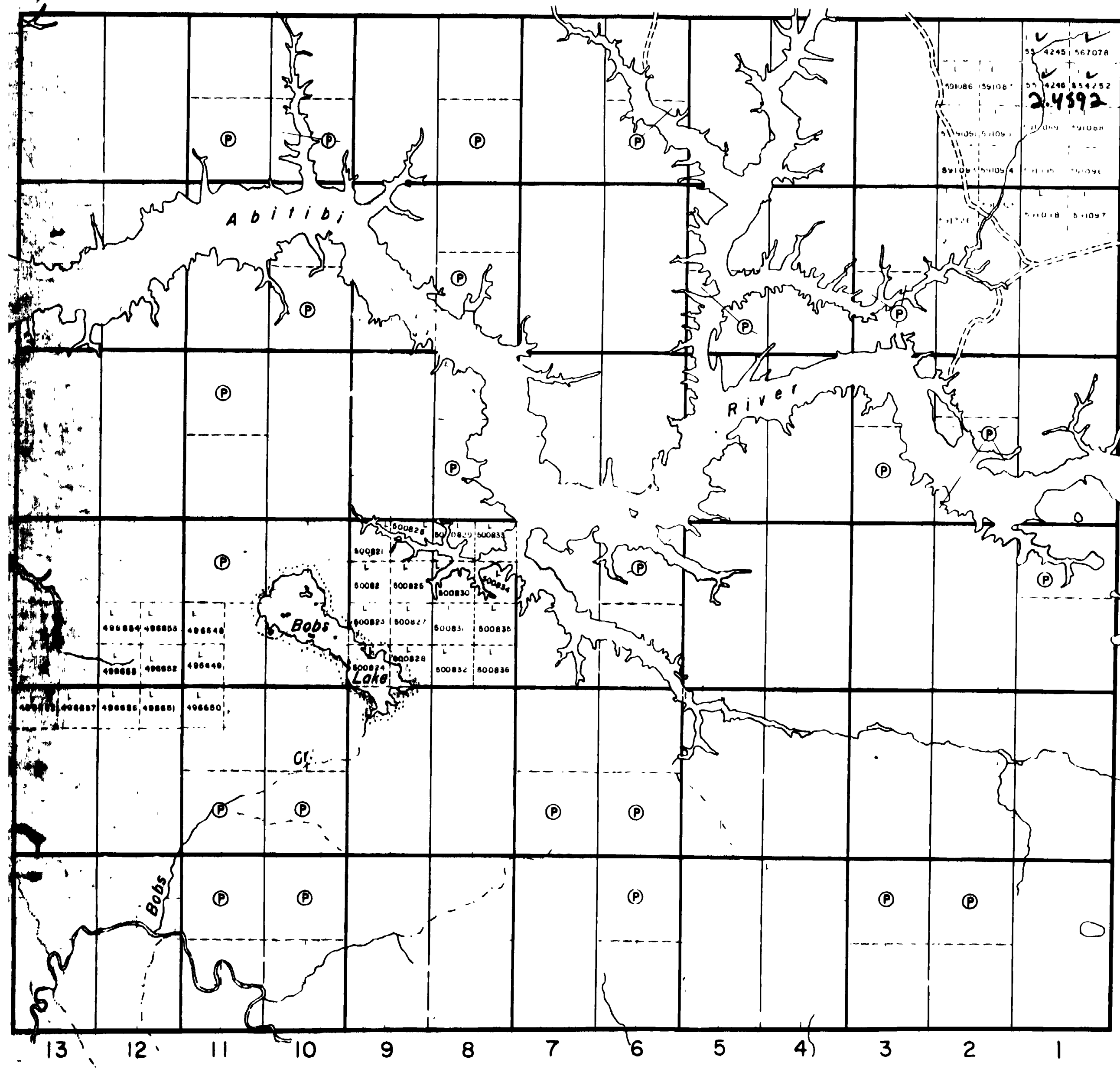

VI

V

IV

Kerrs Twp.

III

II

I

Coulson Twp.

LEGEND

- PATENTED LAND Ⓟ
- CROWN LAND SALE C.S.
- LEASES Ⓞ
- LOCATED LAND Loc.
- LICENSE OF OCCUPATION L.O.
- ROADS —
- IMPROVED ROADS —
- RAILWAYS —
- POWER LINES —
- MARSH OR MUSKEG —
- TRAILS - - -

NOTES

400' Surface Rights Reservation around all Lakes and Rivers.

Flooding rights along shores of Abitibi River.

License of Occupation 8674 covers land below 826' & 851' level along the shores of the Abitibi River.

DATE OF ISSUE
DEC 1 1982
Ministry of Natural Resources
TORONTO

PLAN NO. - M. 525

ONTARIO
MINISTRY OF NATURAL RESOURCES
SURVEYS AND MAPPING BRANCH



NOTES

ANNULMENT CERTIFICATE

The Subdivision of this Township into Lots and Concessions is partially annulled by order of The Deputy Minister of Lands and Forests. July 22, 1963.

400' surface rights reservation along the shores of all lakes and rivers.

L.O. 8674 to the Abitibi Power & Paper Co. Ltd. shown thus:

Abitibi River flooded below 826' & 881' level contour covered by L.O. 8674.

DATE OF ISSUE

DEC - 1982

Ministry of Natural Resources
TORONTO

GALNA TWP. - M. 480

CHESNEY BAY - M. 399

KNOX TWP.

WARDEN TWP.

M. 399

M. 375

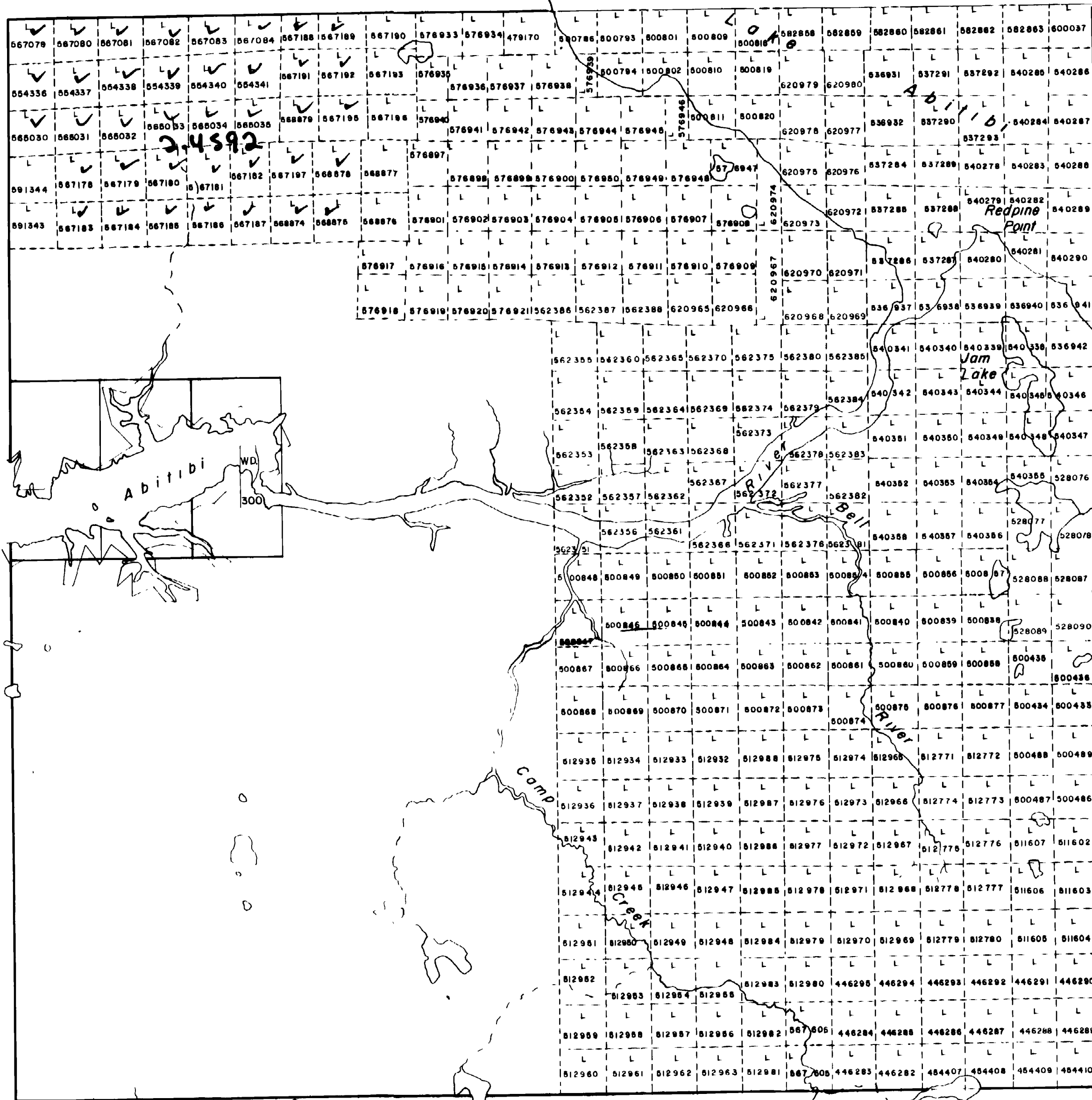

LEGEND

- HIGHWAY AND ROUTE No.
- OTHER ROADS
- TRAILS
- SURVEYED LINES
- TOWNSHIPS, BASE LINES, ETC
- LOTS MINING CLAIMS PARCELS, ETC
- UNSURVEYED LINES
- LOT LINES
- PARCEL BOUNDARY
- MINING CLAIMS ETC
- RAILWAY AND RIGHT OF WAY
- UTILITY LINES
- NON PERENNIAL STREAM
- FLOODING OR FLOODING RIGHTS
- SUBDIVISION OR COMPOSITE PLAN
- RESERVATIONS
- ORIGINAL SHORELINE
- MARSH OR MUSKEG
- MINES
- TRAVEL MONUMENT

DISPOSITION OF CROWN LANDS

| TYPE OF DOCUMENT | SYMBOL |
|---------------------------------|--------|
| PATENT, SURFACE & MINING RIGHTS | ● |
| SURFACE RIGHTS ONLY | ○ |
| MINING RIGHTS ONLY | ◐ |
| LEASE SURFACE & MINING RIGHTS | ◑ |
| SURFACE RIGHTS ONLY | ◒ |
| MINING RIGHTS ONLY | ◓ |
| LICENCE OF OCCUPATION | ◔ |
| ORDER IN COUNCIL | OC |
| RESERVATION | ⊙ |
| CANCELLED | ⊘ |
| SAND & GRAVEL | ⊚ |

NOTE MINING RIGHTS IN PARCELS PATENTED PRIOR TO MAY 6 1913 VESTED IN ORIGINAL PATENTEE BY THE PUBLIC LANDS ACT R.S.O. 1970 CHAP 380 SEC 63 SUBSEC 1

SCALE: 1 INCH = 40 CHAINS

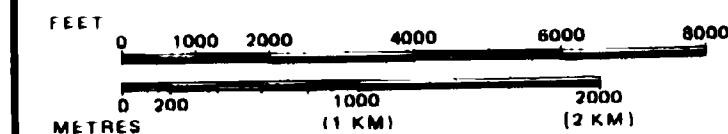

**TOWNSHIP OF
KERRS**
DISTRICT
COCHRANE
MINING DIVISION
LARDER LAKE

Ministry of Natural Resources
Ontario
Surveys and Mapping Branch

Date JAN / 80

Plan No

National Topographic Series

M-518



42A1858119 2.4592 GALNA

Jim's Lake Assessment Work Location Map


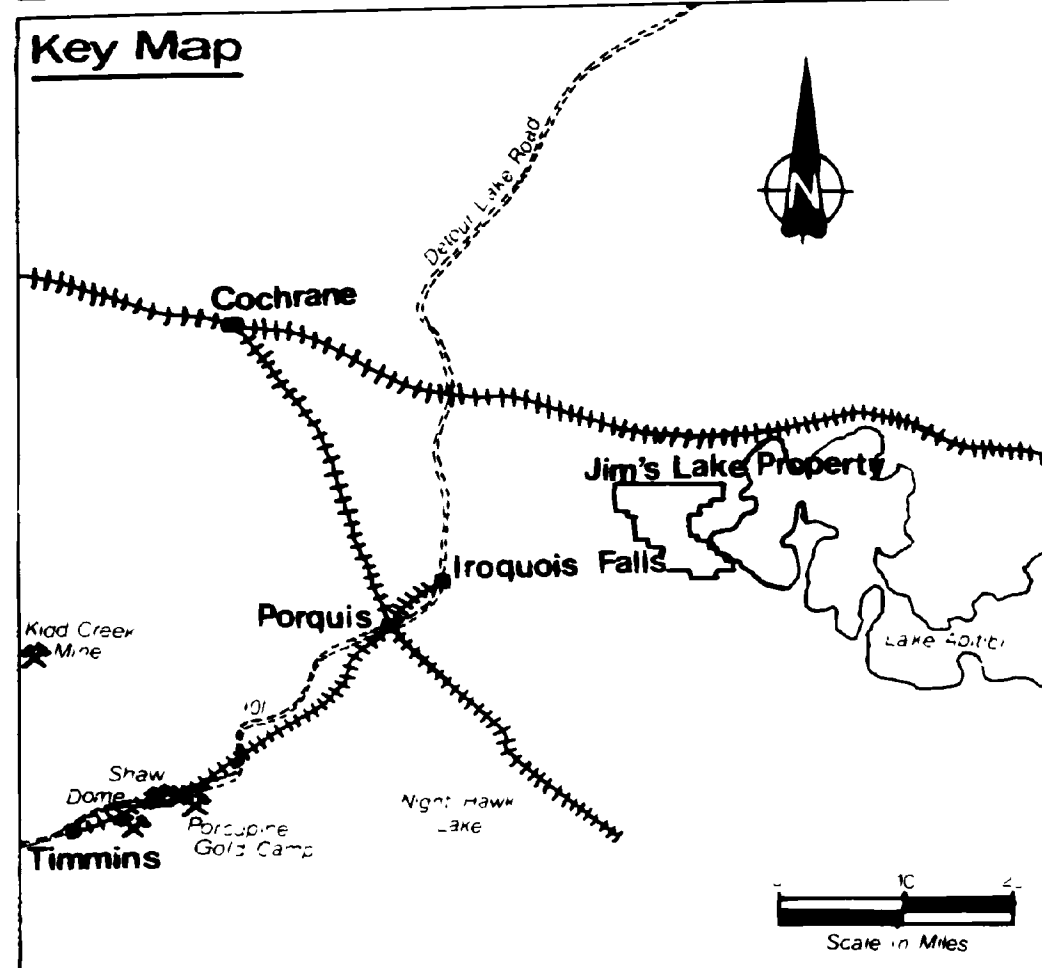

LEGEND

JIM'S LAKE PROPERTY

ONTARIO

Scale: 1" = 1320'

ISOMAGNETIC INTERVAL

(TOTAL FIELD)

- 10 GAMMA CONTOUR LINE
- 50 GAMMA CONTOUR LINE
- 500 GAMMA CONTOUR LINE
- MAGNETIC DEPRESSION
- FLIGHT ALTITUDE 400' ABOVE TERRAIN

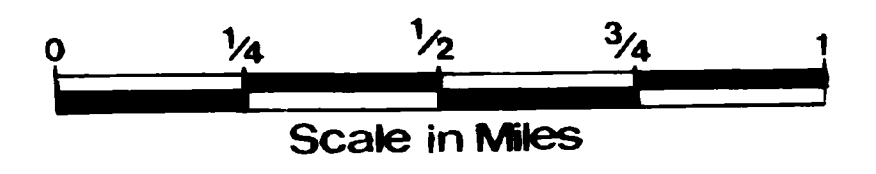

Jim's Lake Assessment Work Location Map

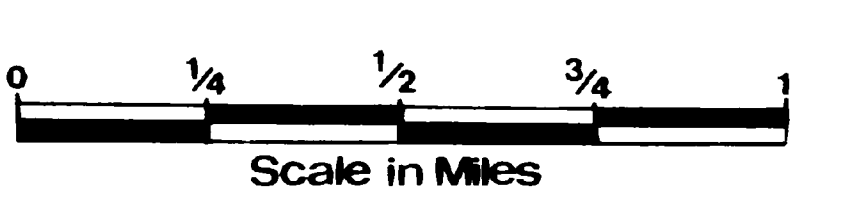
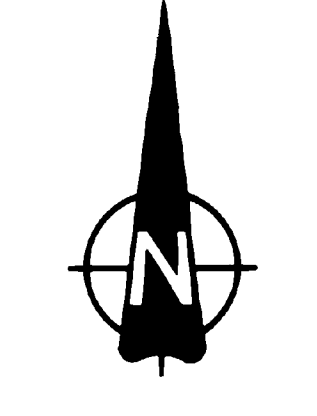

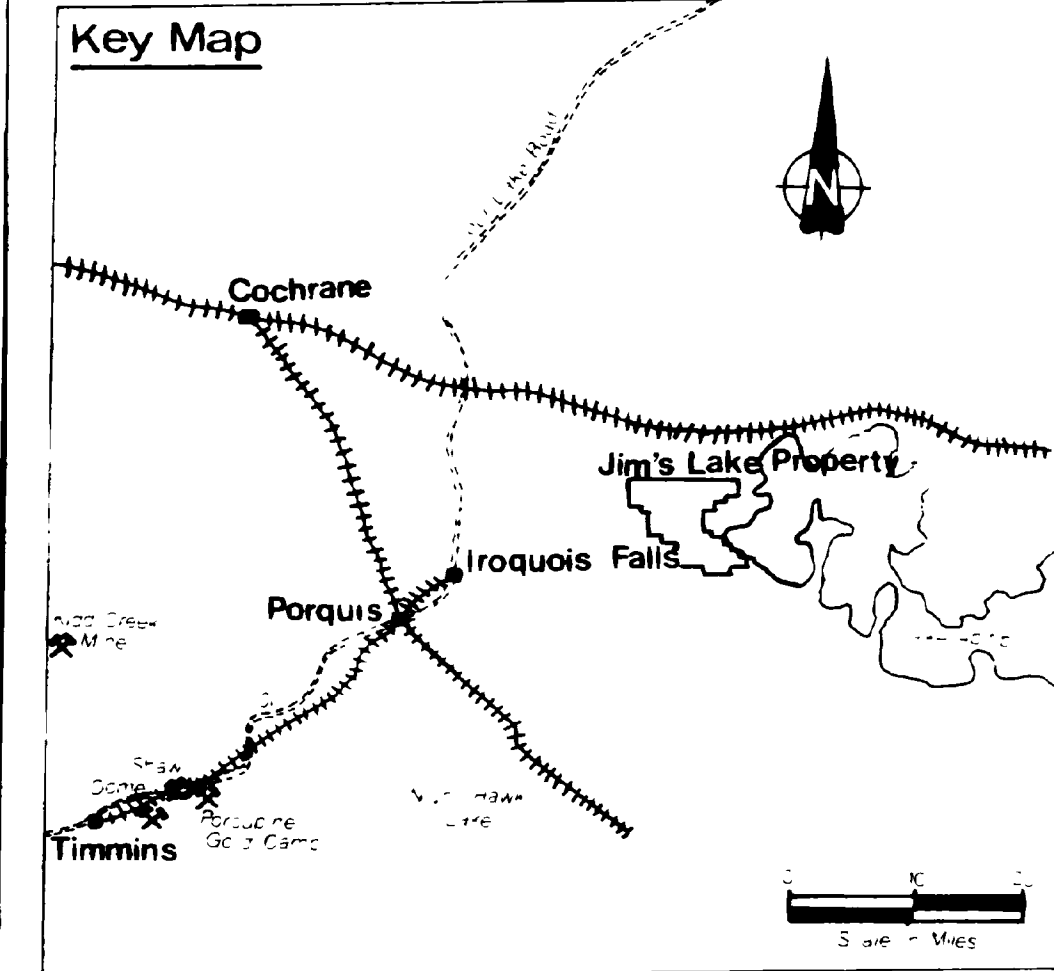

LEGEND

- Overburden Drill Holes Submitted in 1982 Assessment Report
- Overburden Drill Holes Submitted in 1981 Assessment Report
- Magnetic Survey
- Road
- ⊖ Swamp
- ▲ Andesite
- Basalt
- Dacite
- ⬜ Ultramafic

