

NOTES

ANNULMENT CERTIFICATE

The Subdivision of this Township into Lots and Concessions is partially annulled by order of The Deputy Minister of Lands and Forests. July 22, 1963.

400' surface rights reservation along the shores of all lakes and rivers

L.O. 8674 to the Abitibi Power & Paper Co Ltd shown thus

Abitibi River flooded below 826' & 881' level contour covered by L.O. 8674.

GALNA TWP.

KNOX TWP.

WARDEN TWP.

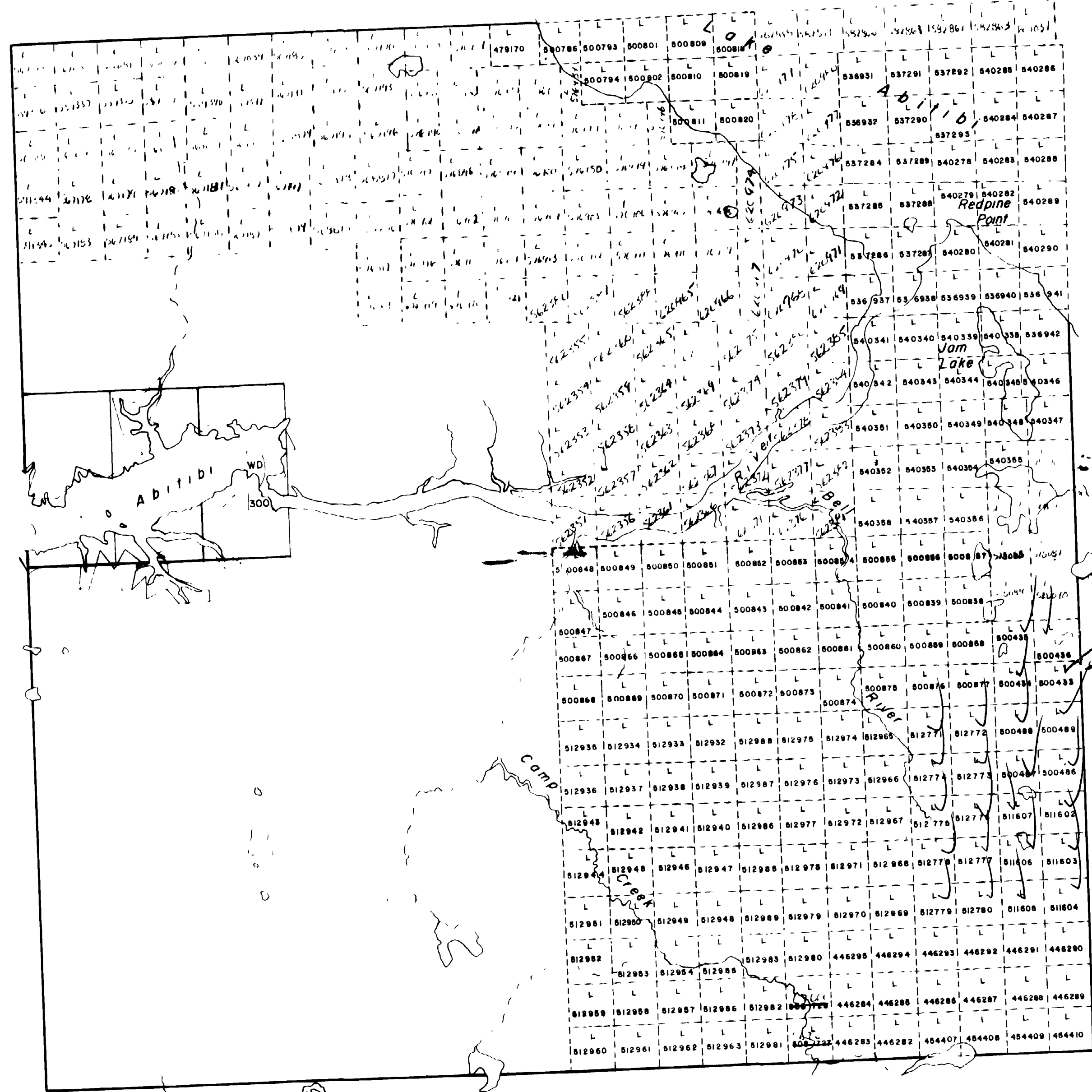

LEGEND

- HIGHWAY AND ROUTE No.
- OTHER ROADS
- TRAILS
- SURVEYED LINES
- TOWNSHIPS, BASE LINES ETC.
- LOTS, MINING CLAIMS, PARCELS ETC.
- UNSURVEYED LINES
- LOT LINES
- PARCEL BOUNDARY
- MINING CLAIMS ETC.
- RAILWAY AND RIGHT OF WAY
- UTILITY LINES
- NON PERENNIAL STREAM
- FLOODING OR FLOODING RIGHTS
- SUBDIVISION OR COMPOSITE PLAN
- RESERVATIONS
- ORIGINAL SHORELINE
- MARSH OR MUSKEG
- MINES
- TRAVERSE MONUMENT

DISPOSITION OF CROWN LANDS

TYPE OF DOCUMENT	SYMBOL
PATENT SURFACE & MINING RIGHTS	●
SURFACE RIGHTS ONLY	○
MINING RIGHTS ONLY	◐
LEASE SURFACE & MINING RIGHTS	■
SURFACE RIGHTS ONLY	□
MINING RIGHTS ONLY	◑
LICENCE OF OCCUPATION	○
ORDER IN COUNCIL	OC
RESERVATION	⊙
CANCELLED	⊖
SAND & GRAVEL	⊕

NOTE MINING RIGHTS IN PARCELS PATENTED PRIOR TO MAY 6 1913 VESTED IN ORIGINAL PATENTEE BY THE PUBLIC LANDS ACT R.S.O. 1970 CHAP 380 SEC 63 SUBSEC 1

SCALE: 1 INCH = 40 CHAINS

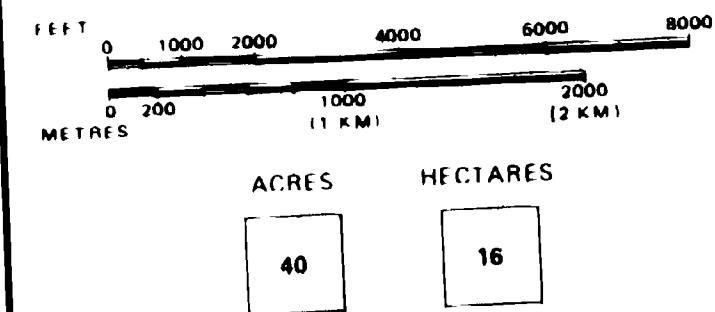

TOWNSHIP OF KERRS

DISTRICT PORCUPINE

MINING DIVISION LARDER LAKE

1 of 2

Ministry of Natural Resources
 Ontario
 Surveys and Mapping Branch

#6

Date JAN / 80

Plan No

National Topographic Series

M-518



42A168E0136 2.4601 GALNA

M-518

NOTES:

CERTIFICATE
of this Township into
one is partially an
of The Deputy Minister
ests.
22, 1963.

Reservation along the
and rivers

Libl Power & Paper Co.

below 826' & 881' level
...O. 8674.

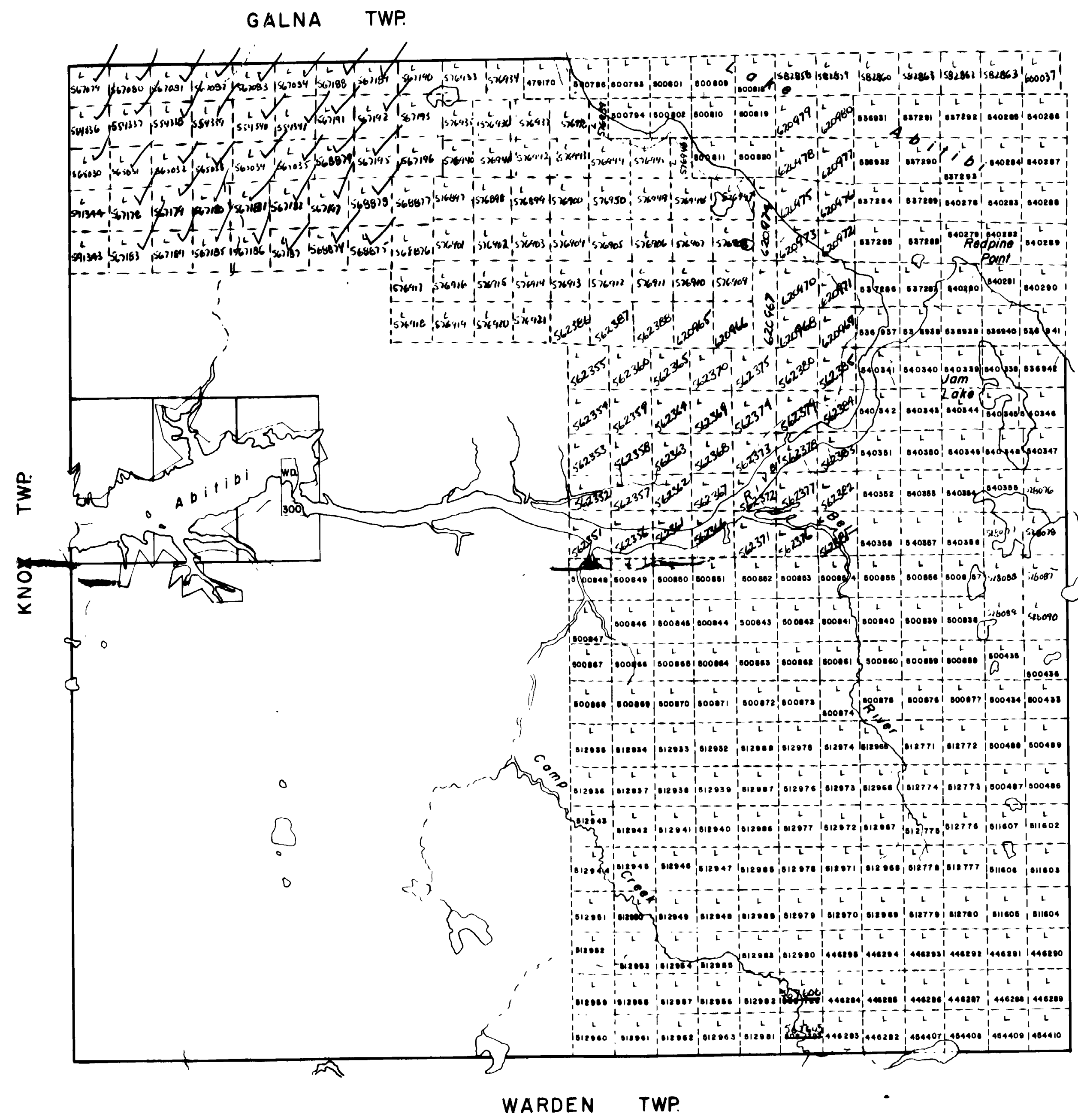

LEGEND

- HIGHWAY AND ROUTE No
- OTHER ROADS
- TRAILS
- SURVEYED LINES
 - TOWNSHIPS, BASE LINES ETC
 - LOTS, MINING CLAIMS, PARCELS, ETC
- UNSURVEYED LINES
 - LOT LINES
 - PARCEL BOUNDARY
 - MINING CLAIMS ETC
- RAILWAY AND RIGHT OF WAY
- UTILITY LINES
- NON PERENNIAL STREAM
- FLOODING OR FLOODING RIGHTS
- SUBDIVISION OR COMPOSITE PLAN
- RESERVATIONS
- ORIGINAL SHORELINE
- MARSH OR MUSKEG
- MINES
- TRAVERSE MONUMENT

DISPOSITION OF CROWN LANDS

TYPE OF DOCUMENT	SYMBOL
PATENT, SURFACE & MINING RIGHTS	●
SURFACE RIGHTS ONLY	○
MINING RIGHTS ONLY	◐
LEASE SURFACE & MINING RIGHTS	■
SURFACE RIGHTS ONLY	◼
MINING RIGHTS ONLY	◻
LICENCE OF OCCUPATION	▲
ORDER IN COUNCIL	OC
RESERVATION	⊙
CANCELLED	⊖
SAND & GRAVEL	⊕

NOTE: MINING RIGHTS IN PARCELS PATENTED PRIOR TO MAY 6 1913 VESTED IN ORIGINAL PATENTEES BY THE PUBLIC LANDS ACT, R.S.O. 1970 CHAP 300, SEC 63, SUBSEC 1

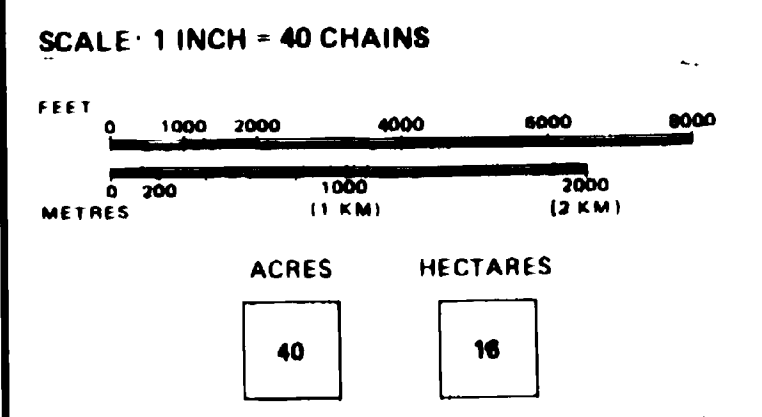

TOWNSHIP OF
KERRS
DISTRICT
PORCUPINE *2 of 2*
MINING DIVISION
LARDER LAKE

Ministry of Natural Resources
Ontario
Surveys and Mapping Branch #6

Date: JAN / 80
National Topographic Series
Plan No: M-518



KNOX TWP M 525

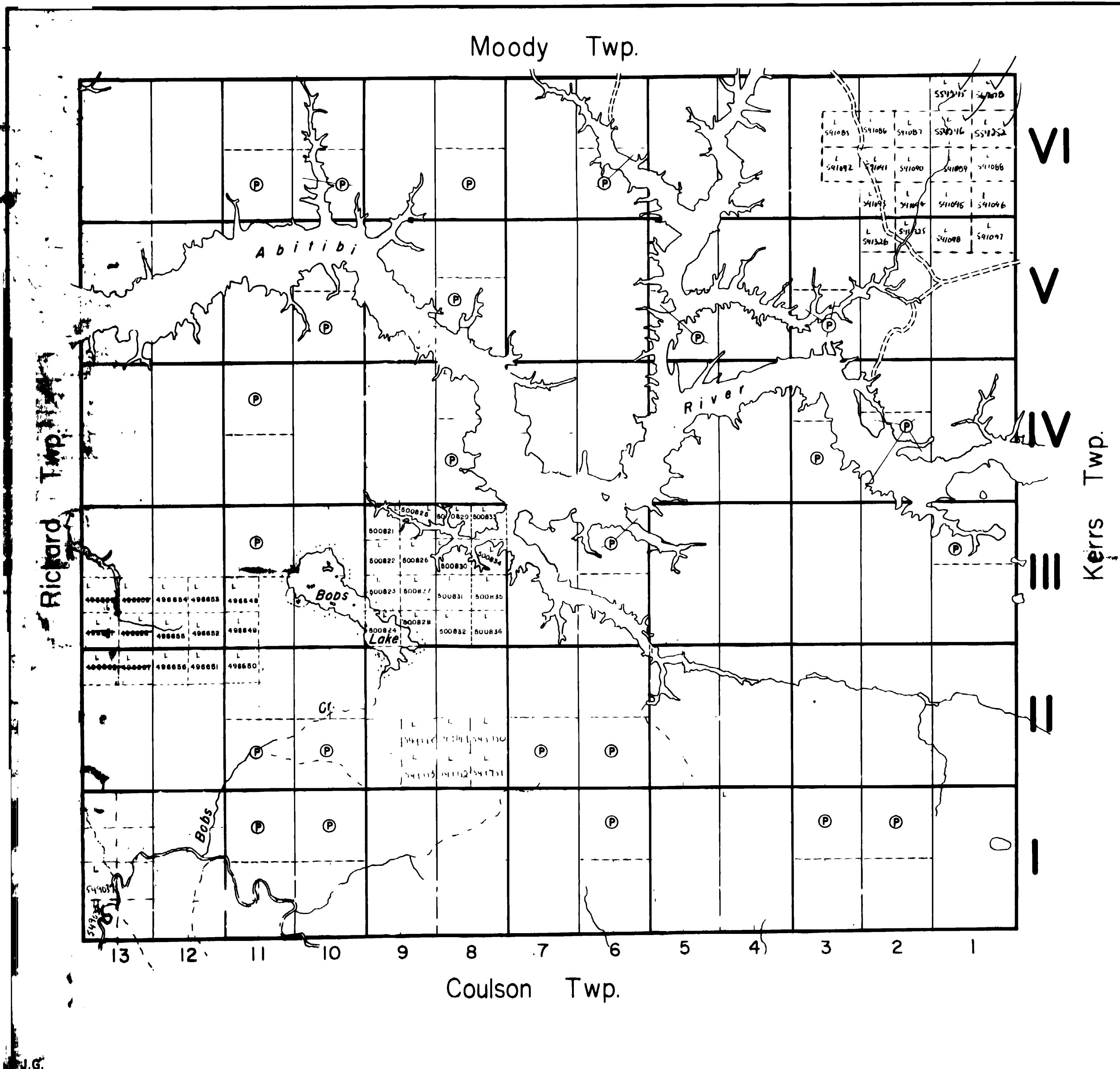

THE TOWNSHIP
OF
KNOX
DISTRICT OF
COCHRANE
LARDER LAKE
MINING DIVISION
SCALE: 1-INCH= 40 CHAINS

LEGEND.

PATENTED LAND	Ⓟ
CROWN LAND SALE	C.S.
LEASES	Ⓞ
LOCATED LAND	Loc.
LICENSE OF OCCUPATION	L.O.
ROADS	—
IMPROVED ROADS	—
RAILWAYS	—
POWER LINES	—
MARSH OR MUSKEG	—
TRAILS	—

NOTES

400' Surface Rights Reservation around all Lakes and Rivers.

Flooding rights along shores of Abitibi River

License of Occupation 8674 covers land below 826' & 881' level along the shores of the Abitibi River

PLAN NO. - M. 525

ONTARIO
MINISTRY OF NATURAL RESOURCES
SURVEYS AND MAPPING BRANCH



9

W. 1835

W. 1835

MARATHON TP. M.542

Marathon Lake

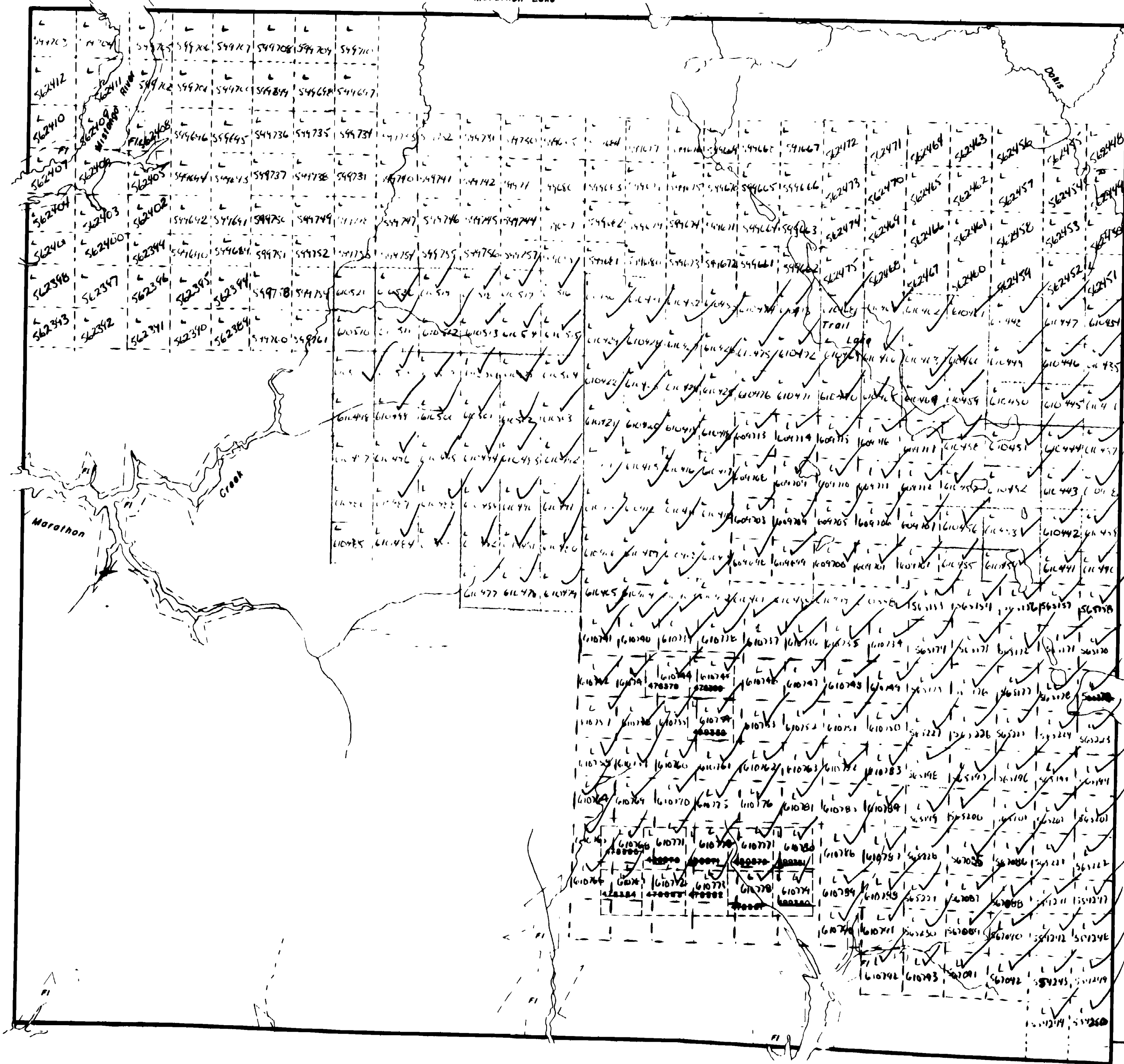

KNOX TP. M.525













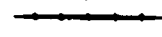

THE TOWNSHIP OF MOODY

DISTRICT OF COCHRANE

LARDER LAKE MINING DIVISION

SCALE: 1-INCH=40 CHAINS

LEGEND

- PATENTED LAND 
- CROWN LAND SALE 
- LEASES 
- LOCATED LAND 
- LICENSE OF OCCUPATION 
- MINING RIGHTS ONLY 
- SURFACE RIGHTS ONLY 
- ROADS 
- IMPROVED ROADS 
- KING'S HIGHWAYS 
- RAILWAYS 
- POWER LINES 
- MARSH OR MUSKOG 
- MINES 
- CANCELLED 

NOTES

400' surface rights reservation along the shores of all lakes and rivers.

L.O. 8674 shown thus  covers land below contour 826' and 881'.

Subdivision of this township in lots and concessions was annulled May 29, 1963.

PLAN NO.- M. 1832

ONTARIO
MINISTRY OF NATURAL RESOURCES
SURVEYS AND MAPPING BRANCH

WOODY TWP

WESLEY TP. M.613

GALNA TP. M.480

WOODY TWP



W. 1835

THE TOWNSHIP OF
OF

GALNA

DISTRICT OF
COCHRANE

LARDER LAKE
MINING DIVISION

SCALE: 1 INCH = 40 CHAINS

LEGEND

- PATENTED LAND
- CROWN LAND SALE
- LEASES
- LOCATED LAND
- LICENSE OF OCCUPATION
- ROADS
- IMPROVED ROADS
- KING'S HIGHWAY
- RAILWAYS
- POWER LINES
- MARSH OR MUSKOG
- MINES

NOTES

400' Surface rights reservation around
rivers.

For Stakings in Lake Abitibi refer to
Plan M-399

PLAN NO. - M. 490

ONTARIO
MINISTRY OF NATURAL RESOURCES
SURVEYS AND MAPPING BRANCH

1

Bowyer Twp.

VI
V
IV
III
II
I

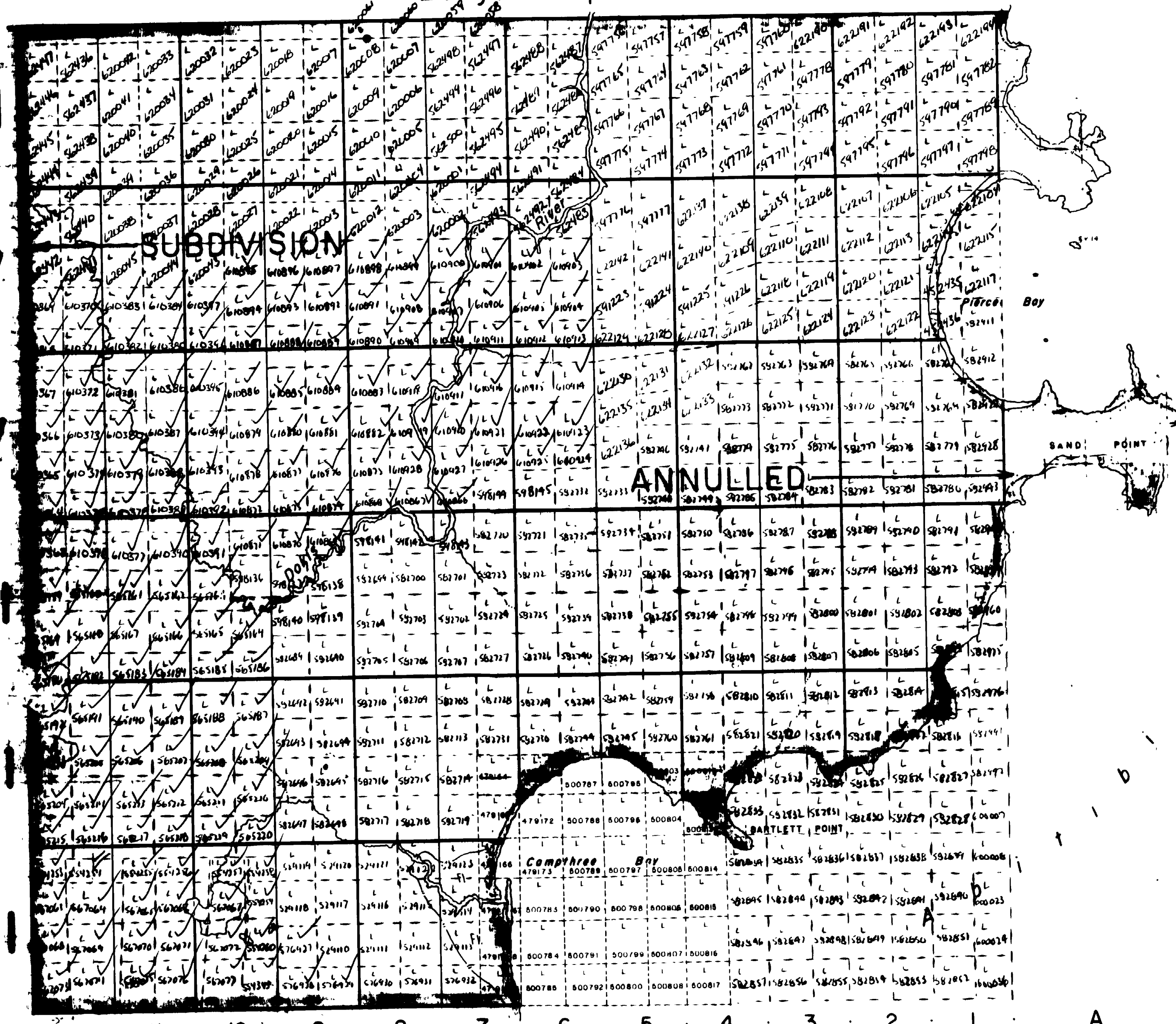

Kerrs Twp.



42A1688136 2-4881 GALNA 240

NOTES

400' surface rights reservation along the shores of lakes and rivers

Areas withdrawn from staking under Section 43 of the Mining Act. (R.S.O. 1970)

Order No.	File	Date	Disposition
W27/79	188511	Nov 21 '79	surface & mining rights

CHESEY BAY M 399

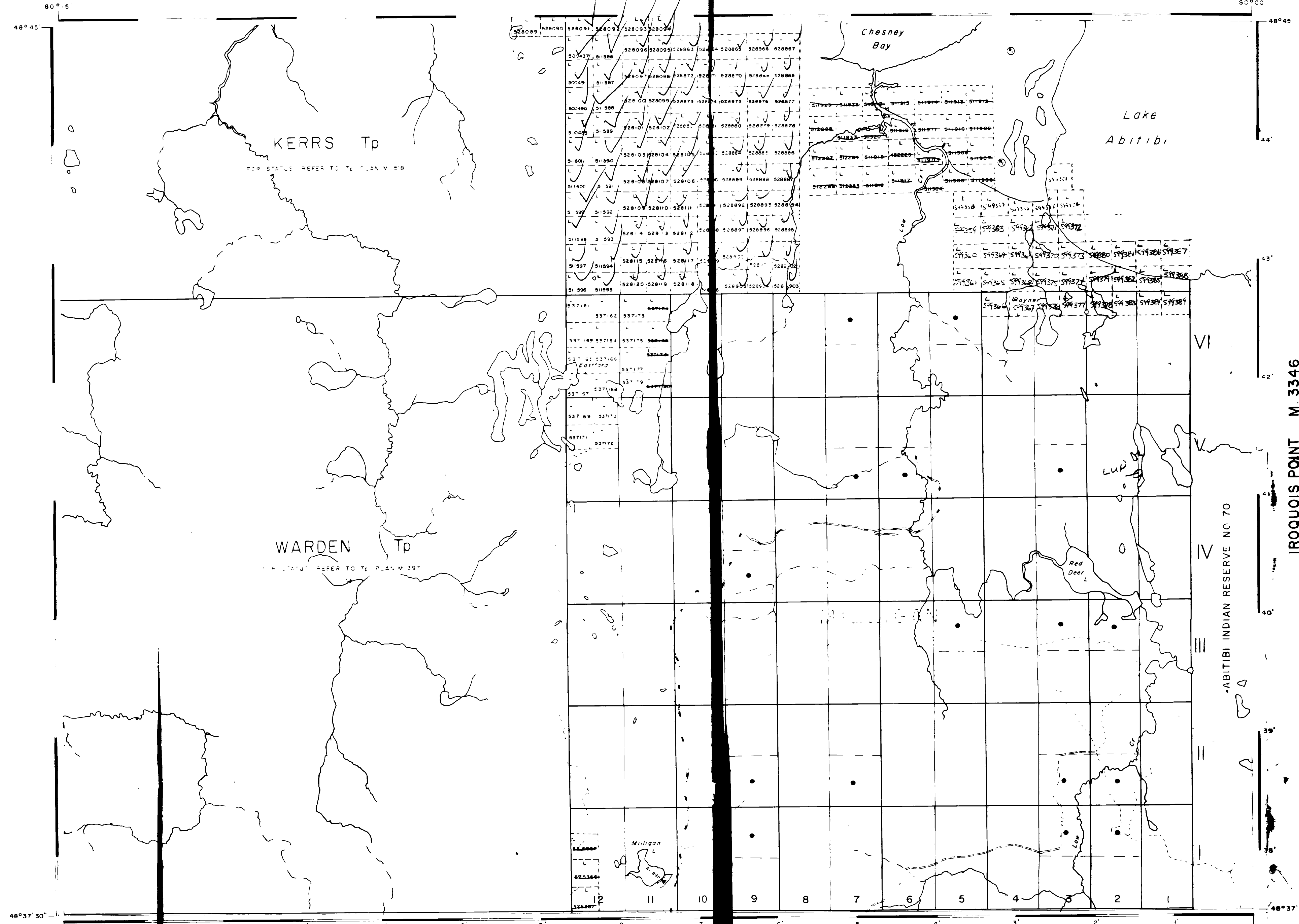

LEGEND

- HIGHWAY AND ROUTE NO.
- OTHER ROADS
- TRAILS
- SURVEYED LINES
- TOWNSHIP'S BASE LINES ETC.
- LOTS MINING CLAIMS PARCELS ETC.
- UNSURVEYED LINES
- LOT LINES
- PARCEL BOUNDARY
- MINING CLAIMS ETC.
- RAILWAY AND RIGHT OF WAY
- UTILITY LINES
- NON-PERENNIAL STREAM
- FLOODING OR FLOODING RIGHTS
- SUBDIVISION
- ORIGINAL SHORELINE
- MARSH OR MUSKEG
- MINES

DISPOSITION OF CROWN LANDS

TYPE OF DOCUMENT	SYMBOL
PATENT SURFACE & MINING RIGHTS	●
SURFACE RIGHTS ONLY	○
MINING RIGHTS ONLY	◐
LEASE SURFACE & MINING RIGHTS	◑
SURFACE RIGHTS ONLY	◒
MINING RIGHTS ONLY	◓
LICENCE OF OCCUPATION	◔
CROWN LAND SALE	◕
ORDER-IN-COUNCIL	◖
RESERVATION	◗
CANCELLED	◘
SAND & GRAVEL	◙

SCALE 1 INCH = 40 CHAINS

ACRES	HECTARES
40	16

AREA
RAYNER LAKE

DISTRICT
COCHRANE

MINING DIVISION
LARDER LAKE.

Ministry of Natural Resources #7

Ontario Surveys and Mapping Branch

Date May '73 Plan No.

National Topographical Series 42 A 9 **M. 375**

AKAJ PENYAR

RAYNER LAKE

STC.M

STC.M

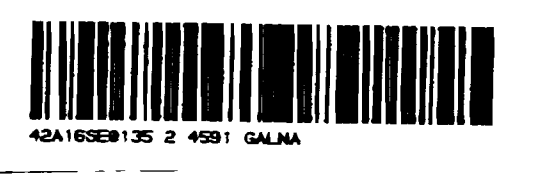

M. 572 M. 593

NOTES

Surface rights reservation along the shores of lakes and rivers

The shoreline of Lake Abitibi forms the Boundary of the Townships

Areas withdrawn from staking under Section 43 of the Mining Act (R.S.O. 1970)

Order No.	File	Date	Disposition
277/79	188511	21/11/79	Surface & mining rights

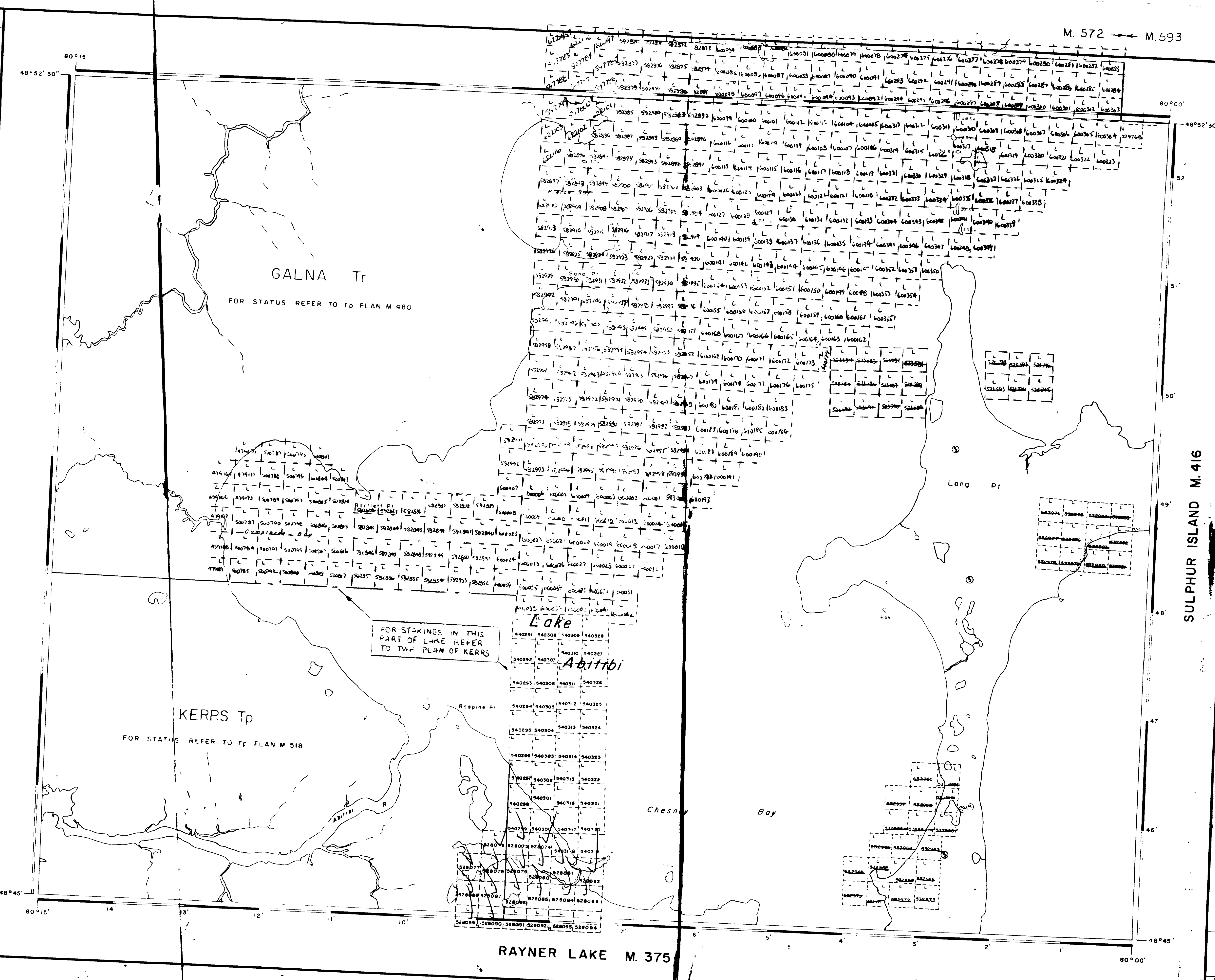

LEGEND

- HIGHWAY AND ROUTE NO
- OTHER ROADS
- TRAILS
- SURVEYED LINES
- TOWNSHIPS BASE LINES ETC
- LOTS MINING CLAIMS PARCELS ETC
- UNSURVEYED LINES
- LOT LINES
- PARCEL BOUNDARY
- MINING CLAIMS ETC
- RAILWAY AND RIGHT OF WAY
- UTILITY LINES
- NON-PERMANENT STREAM
- FLOODING OR FLOODING RIGHTS
- SUBDIVISION
- ORIGINAL SHORELINE
- MARSH OR MUSKOG
- MINES

DISPOSITION OF CROWN LANDS

- TYPE OF DOCUMENT
- PATENT SURFACE & MINING RIGHTS
- SURFACE RIGHTS ONLY
- MINING RIGHTS ONLY
- LEASE SURFACE & MINING RIGHTS
- SURFACE RIGHTS ONLY
- MINING RIGHTS ONLY
- LICENCE OF OCCUPATION
- CROWN LAND SALE
- ORDER IN COUNCIL
- RESERVATION
- CANCELLED
- SAND & GRAVEL

SCALE 1 INCH = 40 CHAINS

ACRES	HECTARES
40	16

AREA
CHESENEY BAY
 (LAKE ABITIBI)
 DISTRICT
 COCHRANE
 MINING DIVISION
 LARDER LAKE

Ministry of Natural Resources
 Ontario Surveys and Mapping Branch
 Date April '73 Plan No
 National Topographical Series
M. 399



260

RAYNER LAKE M. 375

Jim's Lake Assessment Work Location Map

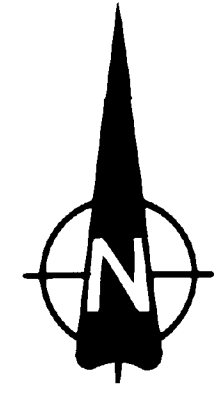

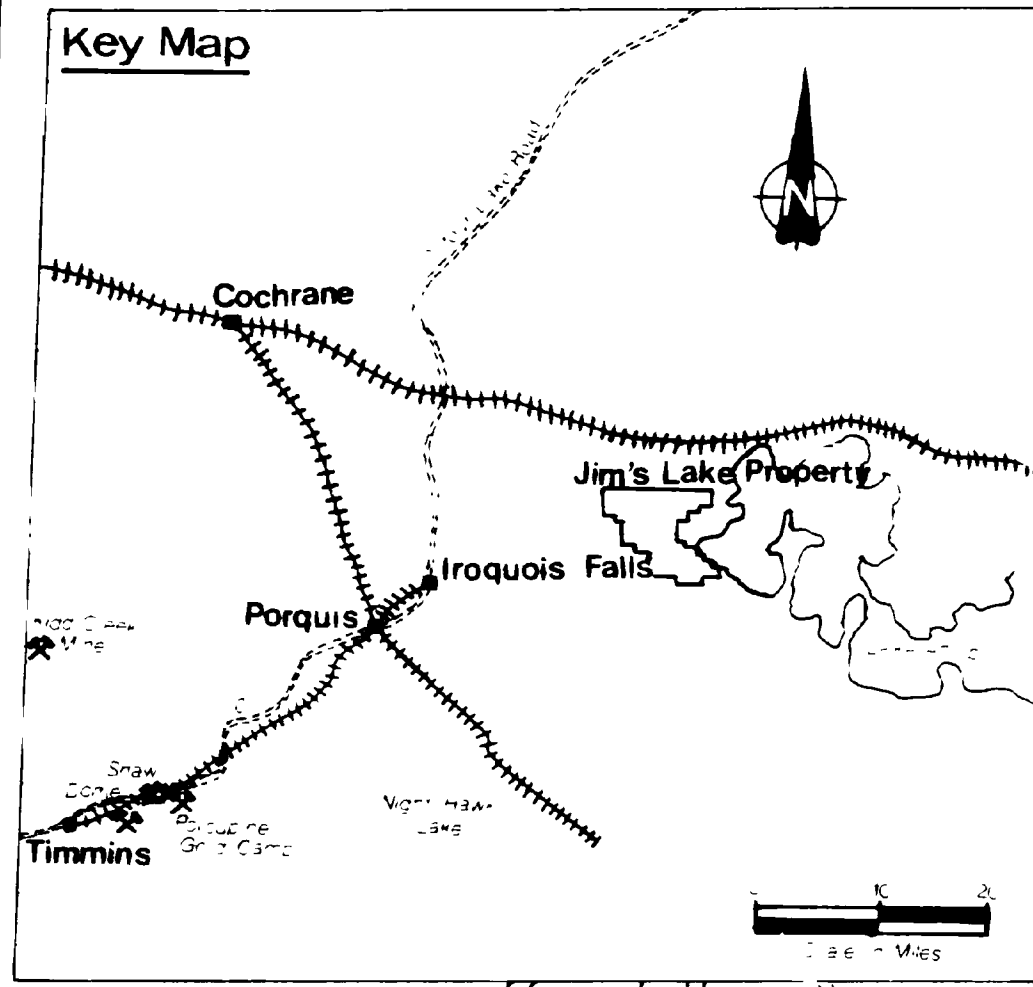

LEGEND

- Overburden Drill Holes Submitted in 1982 Assessment Report
- Overburden Drill Holes Submitted in 1981 Assessment Report
- ▭ Magnetic Survey
- Road
- ⊖ Swamp
- ▲ Andesite
- Basalt
- ◆ Dacite
- ⬢ Ultramafic

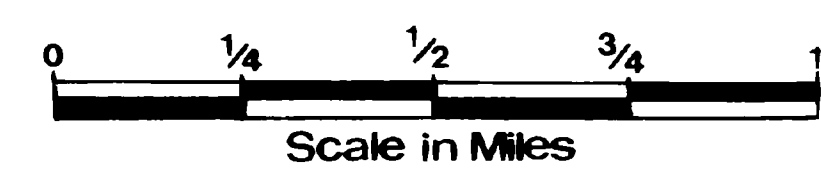

Jim's Lake Assessment Work Location Map

Key Map

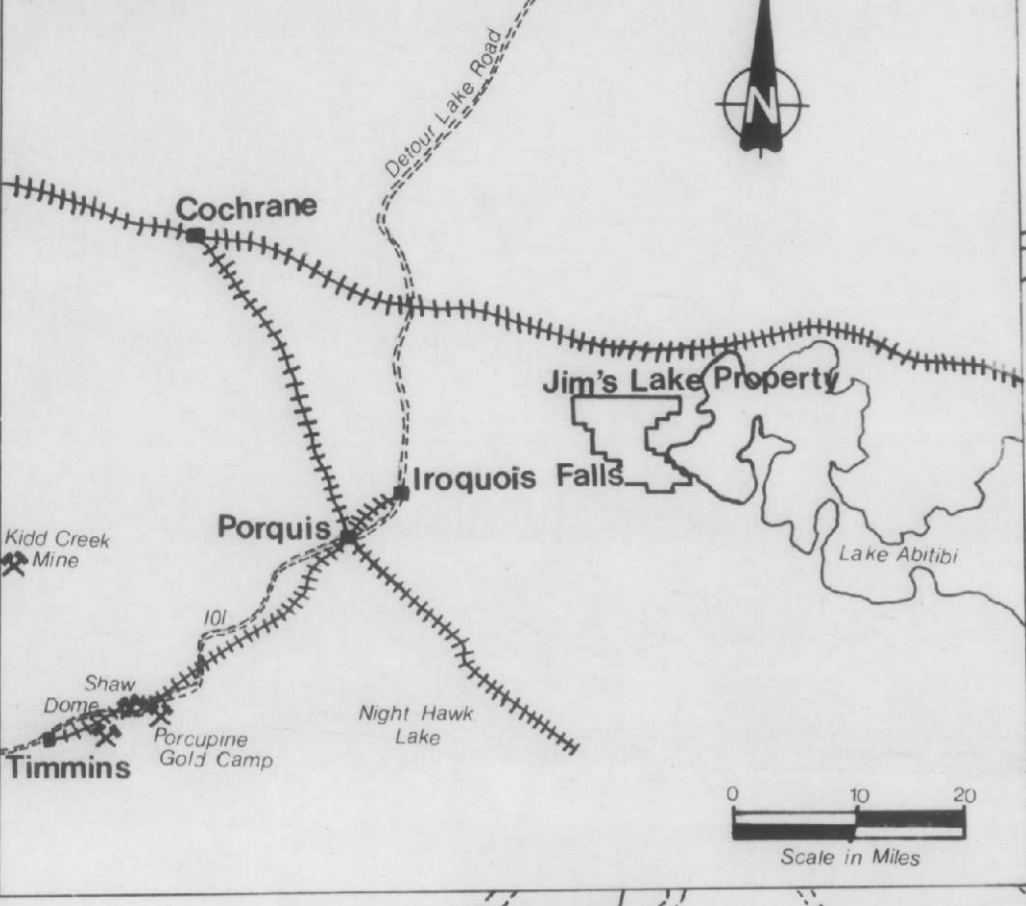

Moody Township

Abitibi River

Abitibi River

Knox Township
Kerrs Township



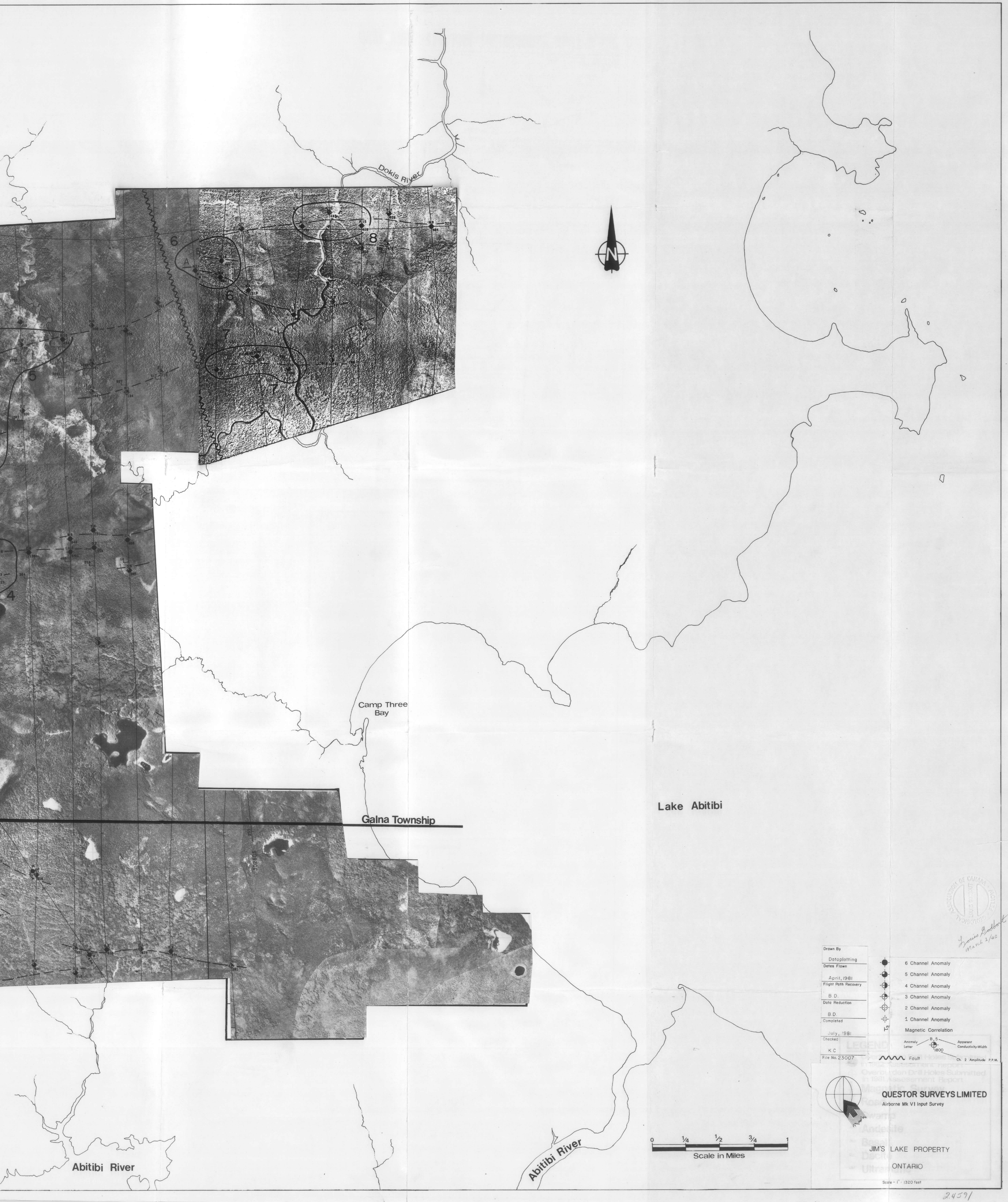

Dokis River



Camp Three Bay

Galna Township

Lake Abitibi

Abitibi River

Abitibi River

Drawn By	
Date Plotted	
Dates Flown	April, 1981
Flight Path Recovery	B.D.
Date Reduction	B.D.
Completed	July, 1981
Checked	K.C.
File No.	23007

6 Channel Anomaly	
5 Channel Anomaly	
4 Channel Anomaly	
3 Channel Anomaly	
2 Channel Anomaly	
1 Channel Anomaly	
Magnetic Correlation	

Anomaly Letter	8, 5	Apparent Conductivity-Width	1800
Fault		Ch. 2 Amplitude P.P.M.	

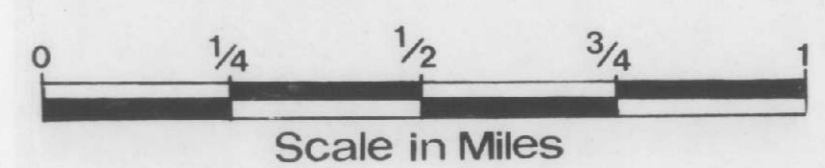

QUESTOR SURVEYS LIMITED
Airborne Mk VI Input Survey

JIM'S LAKE PROPERTY
ONTARIO

Scale - 1" = 1320 Feet