



42B01NE0068 22 REEVES

010

Diamond Drilling

Township of REEVES

Report N<sup>o</sup>: 22

Work performed by: Canadian Johns-Manville Co. Ltd.

Claim N <sup>o</sup>	Hole N <sup>o</sup>	Footage	Date	Note
P.380230	RT-75-1	121'	Apr/75	(1)
	RT-75-2	122'	Apr/75	(1)
	RT-75-3	122'	Apr/75	(1)
	RT-75-4	120'	Apr/75	(1)
	RT-75-5	125'	Apr/75	(1)
	RT-75-6	121'	May/75	(1)
	<u>6</u>	<u>731</u>		

Notes: (1) 150/75

DIAMOND DRILL HOLE RT-75-1  
WEST REEVES GROUP OF CLAIMS  
REEVES TOWNSHIP.

Location: Line 15+00W; 100' North  
of Base Line

Bearing: West

Date Started: April 16<sup>th</sup>, 1975

Date Compl'd: April 17<sup>th</sup>, 1975

Dip: -60°

Total Depth: 121'

<u>Footage</u>	<u>Description</u>
0 - 23'	Overburden
23' - 32'	Medium green brecciated talc-carbonate altered volcanics. Small rusty weathered pyrite cubes are present in the fragments which are recemented with almost pure talc. Rusty oxidation is minimal. At 63' a 1" band is present 30° to the core axis. Very minor magnetite is noticeable. Minor pyrite is noted at 49' which is very white and fresh. (no response to Ni powder). Texture of fragments is andesitic almost at this point.
	32' - 37' and 41' - 43' basic agglomerate.
	44' - 58' brecciated andesite fragments.
58' - 71'	Brownish-grey (sedimentary-greywacke ?) with white carbonate veining.
71' - 77'	Medium green schistose volcanics with talc - carbonate alteration - possibly chloritic.
	77' - 78' fault 30° to core axis.
78' - 121'	Grey brecciated soapstone with talc cementing fragments. Carbonate is rusty and about 5%. Talc content 90%.
	97' - 98' and 98.5' - 99.5' core lost.
	103' - 121' carbonate content approximately 50%.
121'	END OF HOLE.

Logged by: P. A. R. Brown  
Geologist

Drilled by: D. Desjardins and  
R. Haley

April 18<sup>th</sup>, 1975

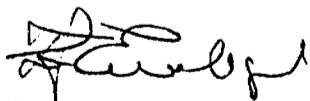

DIAMOND DRILL HOLE RT-75-2  
WEST REEVES GROUP OF CLAIMS  
REEVES TOWNSHIP.

Location: Line 15+00W; 400' North  
of Base Line

Bearing: West

Date Started: April 18th, 1975

Date Compl'd: April 21st, 1975

Dip: -60°

Total Depth: 122'

<u>Footage</u>	<u>Description</u>
0 - 33'	Overburden
33' - 35'	Dark green carbonated ultrabasic. At 35' rock becomes grey and talcose. Much of the Carbonate is rusty from 33' - 53'.  At 53' rock is mainly talc-carbonate, dark grey in colour.  41' - 46' soapstone.  Lost core 65.5' - 66' and 72' - 72.8'.
46' - 76'	Dark to lightgrey talc/carbonate rock.
76' - 97'	Light grey soapstone with many pure green talc veins at all angles.
97' - 102'	15% magnetite.
102' - 122'	Almost soapstone but patches of magnetite crystals.
122'	END OF HOLE.

Logged by: P. A. R. Brown  
Geologist

Drilled by: D. Desjardins and  
R. Haley

April 22nd, 1975

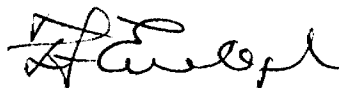

DIAMOND DRILL HOLE RT-75-3  
WEST REEVES GROUP OF CLAIMS  
REEVES TOWNSHIP.

Location: Line 18+00W; 1100' North  
of Base Line

Bearing: West

Date Started: April 22nd, 1975

Dip: -60°

Date Compl'd: April 23rd, 1975

Total Depth: 122'

<u>Footage</u>	<u>Description</u>
0 - 8'	Overburden
8' - 122'	Medium to light grey, talc/carbonate rock. Talc more than 20%. From 8' - 17' brown staining due to weathered carbonate. 30' - 35' brown stained very coarsely crystalline - original rock. 39.5' - 40.5' brown stained. 54' - 54.5' core lost. 55' - 63' badley broken and oxidized - possible fault zone. 67' - 68' broken and oxidized. 68' medium grey to dark grey talc/carbonate rock. At 81' slip 15° to core axis with 1/8" pure talc on slip. Paint hematite staining on core 77' - 93'. Minor talc veining at varying angles. 101' - 102' rusty carbonate crystals in core. 104' - 105' rusty broken core. 107' - 109' - 1/2" talc vein running down core. 118' - 122' talc content appears higher. 122' END OF HOLE.

Logged by: P. A. R. Brown  
Geologist

Drilled by: D. Desjardins and  
R. Haley

April 25th, 1975

*[Handwritten signature]*

DIAMOND DRILL HOLE RT-75-4  
WEST REEVES GROUP OF CLAIMS  
REEVES TOWNSHIP

Location: 15+50W; 500' North  
of Base Line  
Date Started: April 24, 1975  
Date Compl'd: April 25, 1975  
Total Depth: 120'

Bearing: West

Dip: -60°

<u>Footage</u>	<u>Description</u>
0 - 14'	Overburden
14' - 40'	Dark grey, slaty sedimentary rock with a schistosity of 0 - 20° to core axis. 18' - 25' several oxidized slips at 50° to core axis.
40' - 47'	Shear zone - 3' of lost core.
47' - 110'	Banded light grey and cream talc-carbonate rock with a schistosity of 35° - 50° to core axis. The core can be readily scratched by a knife. 73' oxidized slip at 50° to core axis. 77' oxidized slip at 50° to core axis.  98' - 110' the talc-carbonate rock becomes massive, light grey in colour, with less talc-carbonate content near 110'.
110' - 120'	dark grey banded sedimentary rock with a schistosity of 50° - 60° to core axis. Narrow calcitic zones give a banded effect.
120'	END OF HOLE.

Logged by: J. Goodger  
Geologist

Drilled by: D. Desjardins and  
R. Haley

May 22nd, 1975

*[Handwritten signature]*

DIAMOND DRILL HOLE RT-75-5  
WEST REEVES GROUP OF CLAIMS  
REEVES TOWNSHIP

Location: 14+50W; 500' North of  
Base Line  
Date Started: April 28, 1975  
Date Compl'd: April 30, 1975  
Total Depth: 125'

Bearing: West  
Dip: -60°

<u>Footage</u>	<u>Description</u>
0 - 22'	Overburden
22' - 87'	Light grey banded talc-carbonate rock with a schistosity of 50° - 60° to core axis. Good talc content. 29' - 54' slight trace of oxidation - hair veins parallel to schistosity. 54' oxidized slip at 20° to core axis. 54' - 87' some of rock becomes massive, light grey and talc content is higher in the light grey zones. 82' oxidized slip at 50° to core axis.
87' - 125'	Light grey talc-carbonate rock, slightly foliated with a schistosity of 0 - 20° to core axis. Talc content good.
125'	END OF HOLE

Logged by: J. Goodger  
Geologist

Drilled by: D. Desjardins and  
R. Haley

May 22nd, 1975

*J. Goodger*

DIAMOND DRILL HOLE RT-75-6  
WEST REEVES GROUP OF CLAIMS  
REEVES TOWNSHIP

Location: 14+50W; 300' North  
of Base Line  
Date Started: May 1, 1975  
Date Compl'd: May 5, 1975  
Total Depth: 121'

Bearing: West

Dip: -60°

<u>Footage</u>	<u>Description</u>
0 - 33'	Overburden
33' - 92'	Light grey-green massive talc-carbonate rock with several white talc-carbonate veins at 60° - 80° to core axis. Talc content good.  67' - 73' slight oxidation to core with some blebs of translucent green talc.
92' - 121'	Light green-grey talc-carbonate rock with a slight crystalline appearance and a high concentration of talc-carbonate and carbonate veins at 70° - 80° to core axis.  107' - 113' good concentration of pale green talc-carbonate veins.  113' - 121' slightly oxidized and mottled talc-carbonate rock.
121'	END OF HOLE

Logged by: J. Goodger  
Geologist

Drilled by: D. Desjardins and  
R. Haley

May 22nd, 1975

*J. Goodger*

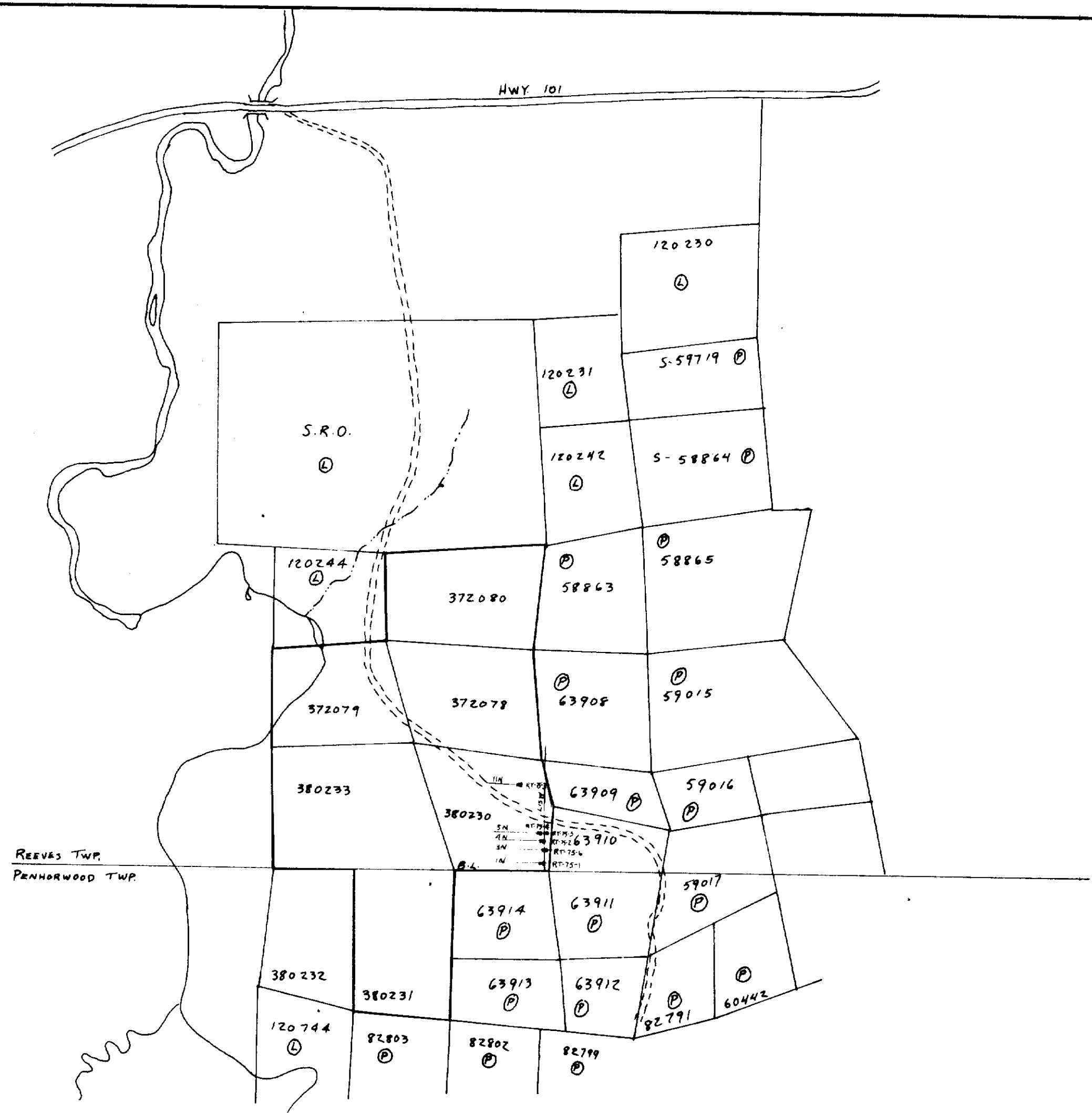

PLAN 1:1320

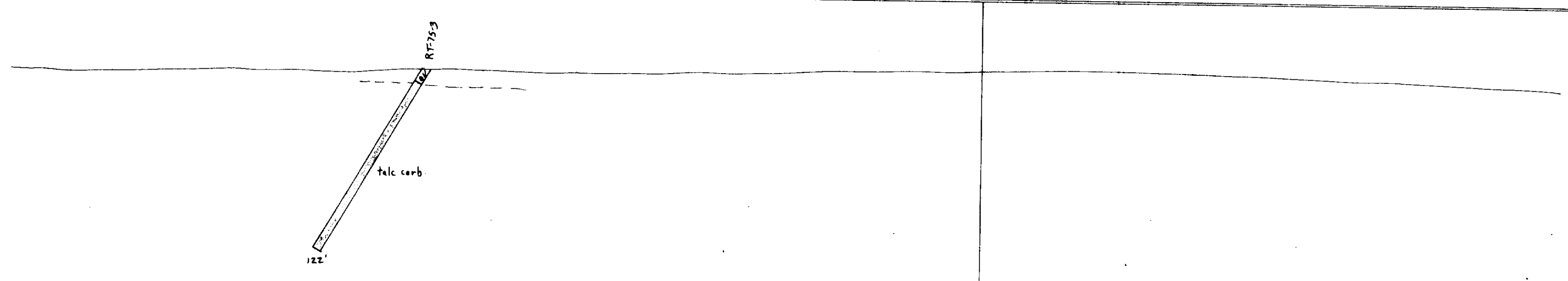

SECTION 11+00N 1:50'

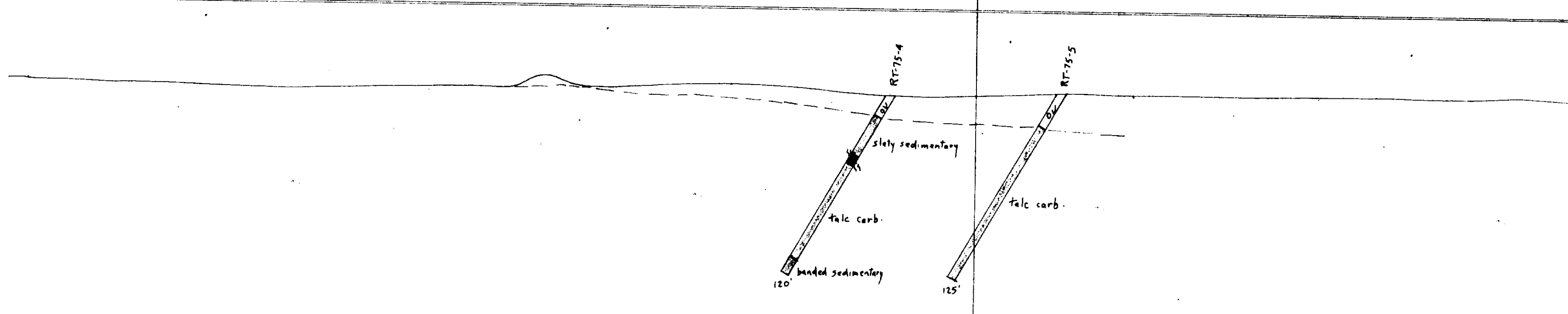

SECTION 5+00N 1:50'

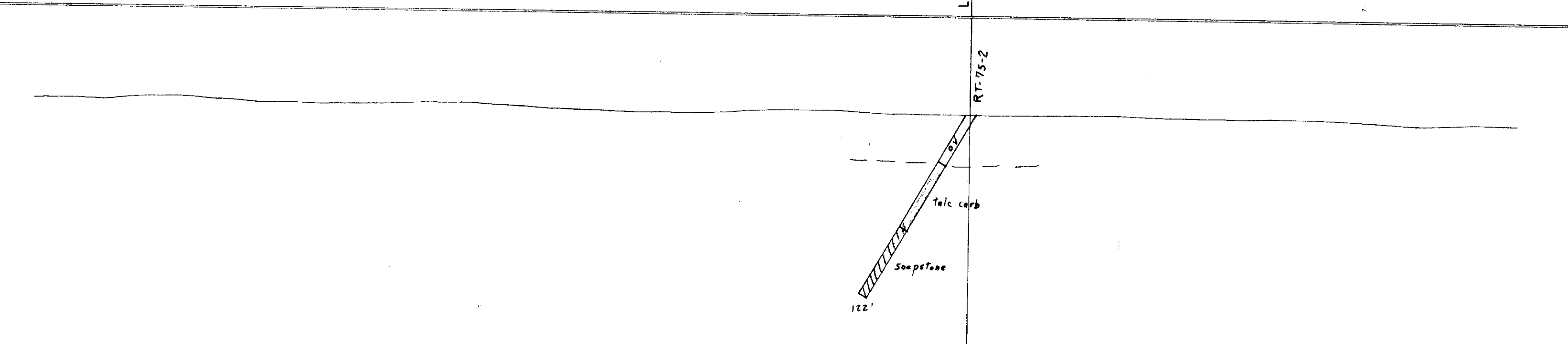

SECTION 4+00N 1:50'

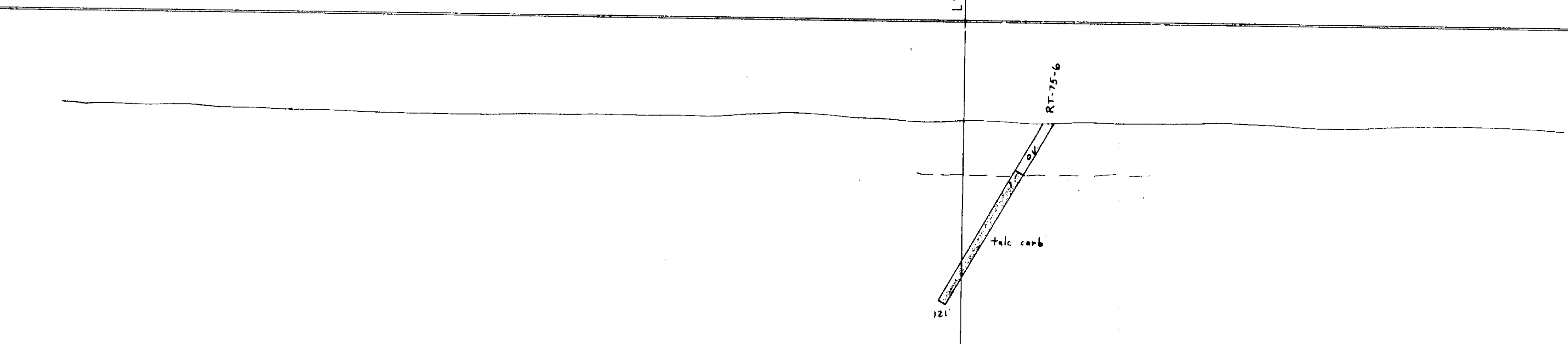

SECTION 3+00N 1:50'

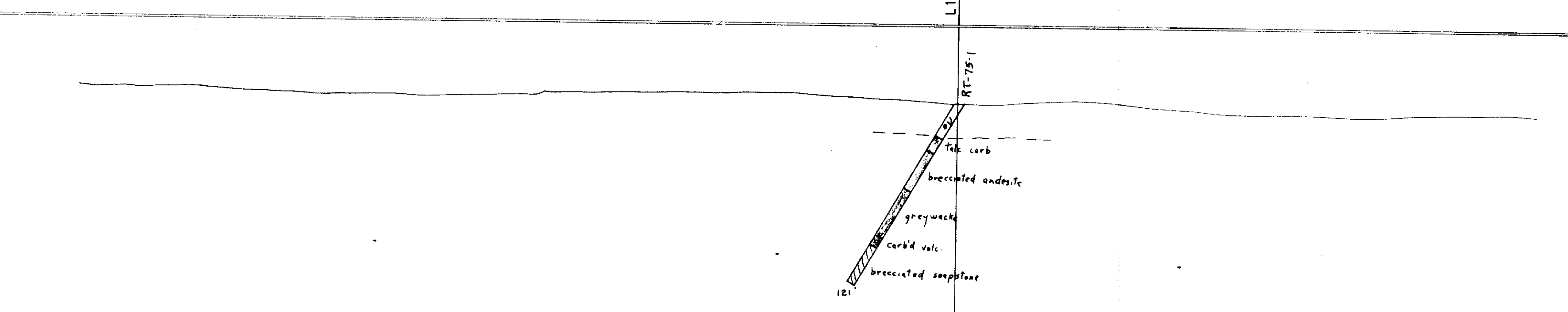

SECTION 1+00N 1:50'

ADJOINS SHEET No.

CANADIAN JOHNS MANVILLE CO. LTD. - MATHESON, ONT.

ADJOINS SHEET No.

