

Diamond Drilling



42B01NE0150 39 KEITH

010

Township of KEITH

Report N<sup>o</sup> 39

Work performed by: Purdy Mica Mines

Claim N <sup>o</sup>	Hole N <sup>o</sup>	Footage	Date	Note
	1	811'		(1)
	2	698'		(1)
	3	496'		(1)
	4	764'		(1)
	9	255'		(1)
	12	850'		(1)
	13	943'		(1)
	J.G.1	171'		(1)
	J.G.4	250'		(1)
	J.G.6	126'		(1)
	15	254'		(1)
		<hr/>		
		5618		

Notes:

- (1) These holes were located in claims S 25033, S 10381, and were drilled in September-October 1955.

MUSKEGO TWP.

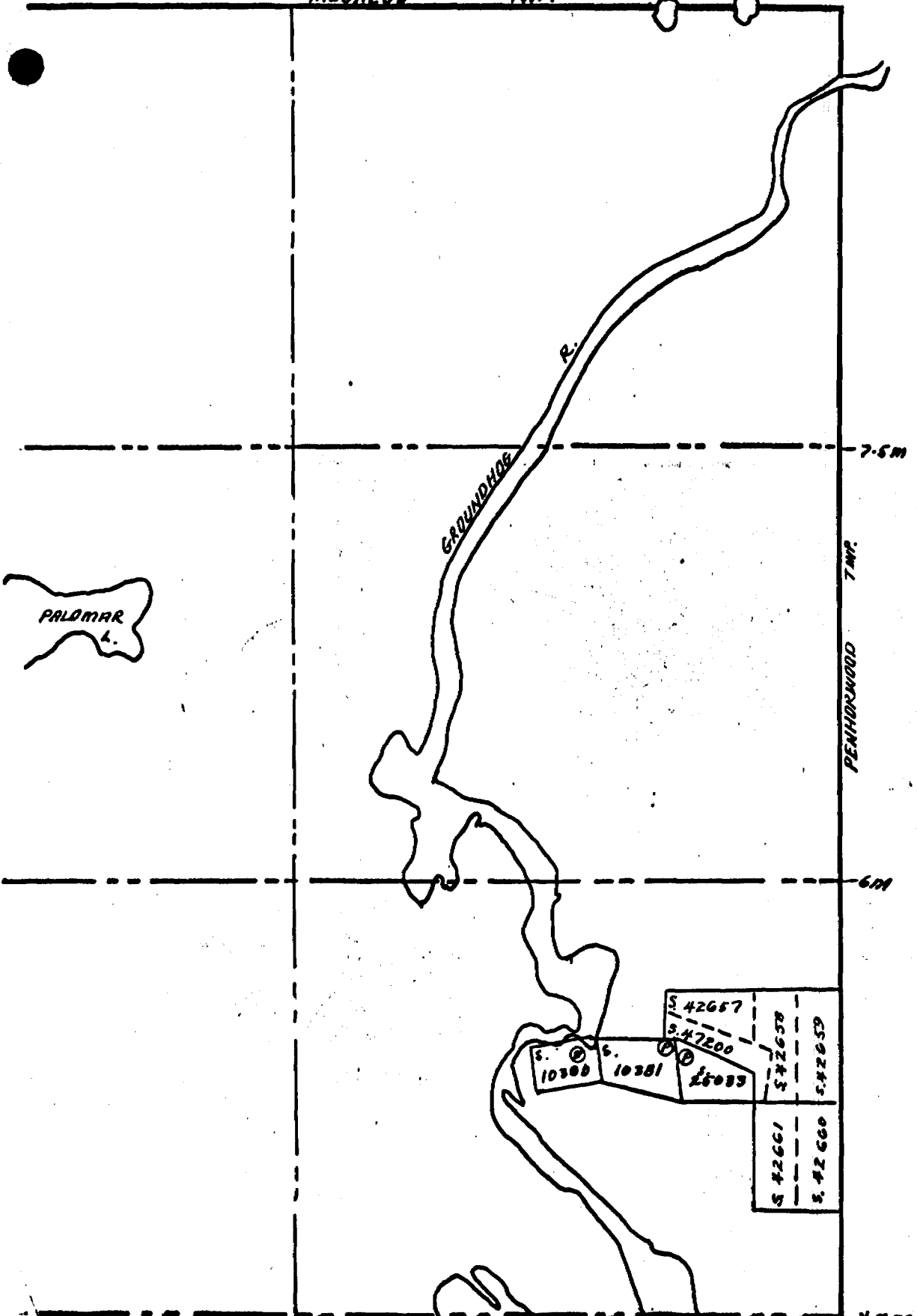

PALOMAR L.

GROUNDHOGE R.

7-5M

PENHORNWOOD TWP.

6M

S. 10380	S. 10381	S. 42657	S. 42658	S. 42659
S. 42660	S. 42661	S. 42662	S. 42663	S. 42664

GROUNDHOGE L.

4-5M

FURDY MICA MINES LTD.

Keith Township

Scale: 1 inch = 40 chains

PURDY MICA MINES LTD.  
JOBURKE GOLD MINES LIMITED

T-83

Keith Township  
Claims S.10381, S.20533

On October 19 I visited this property in company with E. Jutila. The property is located adjacent to the Groundhog River station on the Canadian National Railway, which is 7,000 feet along the railway from Kukatush.

Drilling by Longyear had been in progress for the last two months but the drilling equipment is now being taken away. The Toronto office of Joburke Gold Mines Limited did not reply to my letter making enquiries about the drilling. For this reason I do not know the number of claims held or under what agreement they are held. Our information is that the claims were held by Keith-gold Mines Limited.

PURDY  
mica

Fifteen drill holes were put down on claims S. 10381 and S. 20533. The better ore sections of the core have been shipped from the property so that only the poorer grade sections are left. The surface showings are along an east-west ridge, with a length of 1500 feet. The rountry rocks are andesitic lavas which have been strongly chloritized and carbonatized adjacent to the mineralized zone. The mineralization consists of pyrrhotite, pyrite and chalcopyrite. The sulphides are in lenses and stringers which produce a mineralized zone about ten feet in width. Surface prospecting consists of stripping, trenching and sinking one shallow shaft. This work has been done many years ago. Individual lenses of massive sulphides are about 10 feet in length and from two to three feet in maximum width. Such lenses consist mainly of pyrrhotite. The

T-83

chalcopyrite tends to occur in narrow veinlets and appears to be later than the pyrrhotite and pyrite.



Stewart A. Ferguson,  
Resident Geologist.

Timmins, Ontario,  
October 20, 1955.

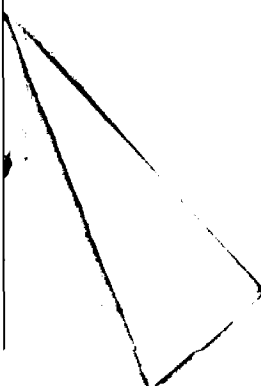

PROPERTY PURDY MICA - HER ON OSLUND GROUP

Keith Twp.

# DIAMOND DRILL RECORD

HOLE NUMBER 1  
 SHEET NUMBER 1  
 SECTION FROM 0' TO 510'

LOCATION: LAT. 4 1/2 Mile Post - Penhorwood Boundary is

DEP. N 4147

ELEVATION OF COLLAR E 30,330'

DATUM

DIRECTION AT START: BEARING S. Ast.

DIP 0 - 44, 150-42 1/2, 400-34 1/2, 600-31

STARTED

COMPLETED

ULTIMATE DEPTH 811'

PROPOSED DEPTH

DEPTH FEET	FORMATION	SAMPLE NO.	WIDTH OF SAMPLE	GOLD \$	SLUDGE GOLD \$
0 - 10	Casing				
10-720	Basic Lavas - Dark green, hard, fine textured, with some evidence of foliation at about 60° caused by light green silicification. Probably somewhat affected by intrusion.				
	136-146 - C oarser, sheared, chloritic zone.				
	151.3-155 - Basic Dyke - Pyroxenite ?				
	155-160 - Becomes somewhat porphyritic with small white poorly developed phenocrysts of secondary origin.				
	213.2-213.6 - Acid, granular dyke, with small garnets.	196'	1		
	213.6 - Dark green, hard, as before with short sections of coarse-chloritic material which looks like recrystallized lava.				
	450-510 - Some local silicification and some epidote - Pyrite mineralization, affect of granite becomes more pronounced from this point and core is intersected by short sections of				
	granite.				

DRILLED BY

SIGNED N.H.

PROPERTY PURDY MICA - H. miston Oslund Group

Keith Twp.

# DIAMOND DRILL RECORD

HOLE NUMBER 1

SHEET NUMBER 2

SECTION FROM 539' TO 811'

LOCATION: LAT. 4 $\frac{1}{2}$  Mile Post - Penhorwood Boundary is

DEP. N 4147

ELEVATION OF COLLAR E 30,330'

DATUM .....

DIRECTION AT START: BEARING S. Ast.

DIP 0-44, 150-42 $\frac{1}{2}$ , 400-34 $\frac{1}{2}$ , 600-31

STARTED .....

COMPLETED .....

ULTIMATE DEPTH 811'

PROPOSED DEPTH .....

DEPTH FEET	FORMATION	SAMPLE No.	WIDTH OF SAMPLE	GOLD \$	SLUDGE GOLD \$
	539-540 - Grey-coarse granitic dyke.				
	546-547 - Grey-coarse granitic dyke.				
	562 $\frac{1}{2}$ -563 $\frac{1}{2}$ - Grey-coarse granitic dyke.				
	599-600 $\frac{1}{2}$ - Grey-coarse granitic dyke.				
	600-720 - About 10% of core is grey coarse granite in short sections up to 2 feet. These carry pyrite mineralization.				
720-811	Granite - Grey to pink, coarse textured biotite granite. Biotite is partly gone to chlorite.	756' 2			
811	END OF HOLE				

DRILLED BY .....

SIGNED N.H.

PROPERTY PURDY MICA - Hemiston Oslund Group

Keith Twp.

# DIAMOND DRILL RECORD

HOLE NUMBER ..... 2 *83*

SHEET NUMBER ..... 1

SECTION FROM ..... 0' TO 554'

LOCATION: LAT. 8202.5 N

DEP. 29525.2 E

ELEVATION OF COLLAR 1111.6

DATUM .....

DIRECTION AT START: BEARING N 1° W

DIP 0-30°, 240-14°, 500-11°, 625-11°

STARTED .....

COMPLETED .....

ULTIMATE DEPTH 698'

PROPOSED DEPTH .....

DEPTH FEET	FORMATION	SAMPLE NO.	WIDTH OF SAMPLE	GOLD \$	SLUDGE GOLD \$
0 - 11	Casing				
11-275	Basic Lavas - Hard, blue-black, relatively unaltered crystalline type, similar to collar of d.d.h. 1.				
	134-136 - Biotite lamprophyre				
	185-255 - Colour of lavas becomes slightly lighter.				
	255-275 - Grades to blue black, basaltic type, becoming softer and more serpentized.				
275-584	Serpentinized Greenstone (Basic Lava) 351'	3			
	Gradational from basic lavas. Blue-black, soft, soapy rock, becoming coarser textured down hole. It is almost wholly altered to talc and serpentine.				
	451-455 - Grey, acid dyke.				
	464-471 - Grey-green, fine textured acid dyke.				
	518-527 - Acid fine textured siliceous dyke with white quartz.				
	527-531 - Biotite lamprophyre.				
	531-552 - Silicified with quartz stringers.				
	552-554 - Black Graphitic tuff - well mineralized with chalcopyrite.				

DRILLED BY .....

SIGNED N.H.

PROPERTY PURDY MICA # Helmiston Oslund Group

Keith Twp.

# DIAMOND DRILL RECORD

HOLE NUMBER 2

SHEET NUMBER 2

SECTION FROM 554' TO 698'

LOCATION: LAT. 8202.5 N

DEP. 29525.2 E

ELEVATION OF COLLAR 1111.6

DATUM

DIRECTION AT START: BEARING N 1° W

DIP 0-30°, 240-14°, 500-11°, 625-11°

STARTED

COMPLETED

ULTIMATE DEPTH 698'

PROPOSED DEPTH

DEPTH FEET	FORMATION	SAMPLE NO.	WIDTH OF SAMPLE	GOLD \$	SLUDGE GOLD \$		
	<u>554-560 - Silicified and mineralized.</u>						
<u>584-596</u>	<u>Graphitic Tuff - Graphitic tuff - mineralized with chalco and pyrite and pyrrhotite.</u>						
<u>596-698</u>	<u>Serpentinized Greenstone - Serpentine rock as before, but texture is somewhat finer toward end.</u>						
<u>698</u>	<u>END OF HOLE</u>						

DRILLED BY

SIGNED N.H.



PROPERTY PURDY MICA  
Keith Twp.

# DIAMOND DRILL RECORD

HOLE NUMBER 3 *T-83*  
 SHEET NUMBER 1  
 SECTION FROM 0' TO 361½'

LOCATION: LAT. 9321.9 N  
 DEP. 29514.5 E  
 ELEVATION OF COLLAR 1129.5  
 DATUM .....  
 DIRECTION AT START: BEARING S 1° E  
 DIP 0-30°, 200-28°, 400-23°

STARTED .....  
 COMPLETED .....  
 ULTIMATE DEPTH 496'  
 PROPOSED DEPTH .....

DEPTH FEET	FORMATION	SAMPLE NO.	WIDTH OF SAMPLE	GOLD \$	SLUDGE GOLD \$		
0 - 6	Casing						
6 - 83	Grey to Green Carbonates - (Original lava?) Largely <del>greyish</del> greyish carbonate, with some emerald green mica, and some quartz stringers. Pyrite mineralization along edges of quartz stringers.						
83 - 120	Serpentinized Greenstone (Basic Lava - Blue-black, soft, soapy, almost wholly altered to serpentine. Some light green and grey fragments may indicate original fragmental nature.						
120-255	Grey-Green Carbonates - (as before) Grades from 120-125. Some foliation at about 45°.						
255-325	Serpentinized Greenstone - Grades from light grey carbonate rock to soft black serpentinized greenstone from 255-260. 285-300 - Light green - Somewhat oxidized.						
325-361½	Grey, Acid Dyke - Medium textured, siliceous type, with some considerable biotite in a siliceous matrix.						

DRILLED BY .....

SIGNED N.H.

PROPERTY PURDY MICA  
Keith Twp.

# DIAMOND DRILL RECORD

HOLE NUMBER ..... 3  
SHEET NUMBER ..... 2  
SECTION FROM 361 1/2' TO 496'

LOCATION: LAT. 9321.9 N  
DEP. 29514.5 E  
ELEVATION OF COLLAR ..... 1129.5  
DATUM .....  
DIRECTION AT START: BEARING S 1° E  
DIP 0-30°, 200-28°, 400-23°

STARTED .....  
COMPLETED .....  
ULTIMATE DEPTH ..... 496'  
PROPOSED DEPTH .....

DEPTH FEET	FORMATION	SAMPLE NO.	WIDTH OF SAMPLE	GOLD \$	SLUDGE GOLD \$		
<u>361 1/2-496 1/2</u>	<u>Serpentinized Greenstone - Blue black, soft,</u> <u>soapy type as before.</u> <u>364.8-369.5 - Grey dyke.</u>						
<u>496 1/2</u>	<u>END OF HOLE</u>						

NORTHERN MINER PRESS LIMITED, TORONTO-STOCK FORM NO. 801 REV. 9/44

DRILLED BY .....

SIGNED N.H.

PROPERTY FURDY MICA - Armiston Oslund Group

Keith Twp.

# DIAMOND DRILL RECORD

HOLE NUMBER 4 783

SHEET NUMBER 1

SECTION FROM 0' TO 534'

LOCATION: LAT. 93143 N

DEP. 29512.0 E

ELEVATION OF COLLAR 1129.9

DATUM .....

DIRECTION AT START: BEARING N 1° W

DIP 0-30°, 200-27½°, 400-30°, 600-30°

STARTED .....

COMPLETED .....

ULTIMATE DEPTH 764'

PROPOSED DEPTH .....

DEPTH FEET	FORMATION <u>760-28¼</u>	SAMPLE NO.	WIDTH OF SAMPLE	GOLD \$	SLUDGE GOLD \$
0 - 9	Casing				
9 - 80	Grey-green Carbonates - Same as collar of d.d.h. 3. Some fine pyrite mineralization. Includes short sections of felsite.				
80-402	Serpentinized Greenstone (Basalt?) Grades from 80-84. Soft, blue-black, soapy type as in d.d.h. 3. Quite uniform and massive, with only a few carbonate stringers.				
402-442	Grey Acid Dyke - Granular siliceous dyke with biotite.				
442-448	Fracture Breccia - Contact feature of acid dyke.				
448-610	Andesitic Lava - Dark green, rather hard type fine-textured and carrying disseminated pyrite near contact for 30 feet.	488'	4		
	473-491 - Grey, siliceous dyke.				
	491-515 - Andesitic type as before, with some foliation at about 20°. Several narrow acid dykes.				
	515-531 - Brownish carbonatized, with pronounced foliation.				
	531-534 - Grey, siliceous dyke.				

DRILLED BY .....

SIGNED N.H.

PROPERTY PURDY MICA - Heliston Oslund Group  
Keith Twp.

HOLE NUMBER 4  
 SHEET NUMBER 2  
 SECTION FROM 534' TO 764'

# DIAMOND DRILL RECORD

LOCATION: LAT. 93143 N  
 DEP. 29512.0 E  
 ELEVATION OF COLLAR 1129.9  
 DATUM  
 DIRECTION AT START: BEARING N 1° W  
 DIP 0-30°, 200-27½°, 400-30°, 600-30°

STARTED  
 COMPLETED  
 ULTIMATE DEPTH 764'  
 PROPOSED DEPTH

DEPTH FEET	FORMATION	SAMPLE NO.	WIDTH OF SAMPLE	GOLD \$	SLUDGE GOLD \$
	760-28¼°				
534-587	Grey-green, dacitic lava - some foliation, but quite massive, characterized by brown leucoxene flecks.				
587-590	Siliceous dyke.				
590-596	Andesitic sheared light greenish				
596-599	Grey acid felsite				
599-610	Yellow-green to light green andesite.				
610-645	Grey Acid Dyke - Grey acid felsite.				
614-615½	Well mineralized. 638°	5			
642-645	Fractured, well mineralized margin of dyke - Pyrite mineralization.				
645-681	Tuffs - 645-653 - Black, graphitic type mineralized. 653-667 - <del>Ex</del> Yellow and grey cherty tuff. 667-681 - Black graphitic tuff - Contact @ about 20°.				
681-764	Sediments? Acid Pyroclastics - Brownish yellow to grey, with a few quartz eyes and some contorted banding. Probably belongs to rhyolite series.				
764	END OF HOLE.				

PROPERTY PURDY MICA - He. Iston Oslund Group

Keith Twp.

# DIAMOND DRILL RECORD

HOLE NUMBER..... 9  
 SHEET NUMBER..... 1  
 SECTION FROM 0' TO 255'

LOCATION: LAT..... 9835.5  
 DEP..... 286046 E  
 ELEVATION OF COLLAR..... 1130.1  
 DATUM.....  
 DIRECTION AT START: BEARING..... N. Ast.  
 DIP..... 0-40°, 200-42 1/2°

STARTED.....  
 COMPLETED.....  
 ULTIMATE DEPTH..... 255'  
 PROPOSED DEPTH.....

DEPTH FEET	FORMATION	SAMPLE NO.	WIDTH OF SAMPLE	GOLD \$	SLUDGE GOLD \$
0 - 6	Casing				
6 - 160	Andesitic (and Dacitic) Lavas				
	Light green to dark green colour medium grained, relatively unaltered carbonatized but cut by stringers of quartz and carbonate. Some shows quartz eyes and leucoxene alteration. Some foliation at angles from 70-30°.				
	148-149 - Grey felsite dyke.				
	150-160 - Grey felsite dyke.				
160-255	Tuffs - 160-171 - Yellow-green, silicified andesite or tuff.				
	171-175 - Grey siliceous, granular dyke.				
	175-188 - Black, graphitic tuffs - well bedded.				
	188-190 1/2 - Grey felsitic dyke siliceous.				
	190 1/2 - 194 1/2 - Black well-bedded graphitic tuff bands @ 60° to core.				
	194 1/2 - 196 - Grey, siliceous felsite				
	196 1/2 - 198 - Grey, siliceous felsite.				
	204-204 1/2 - 6" grey, siliceous felsite.				
	208-210 - Grey siliceous dyke.				
	210-255 - Black, graphitic tuff.	254'	6		

NORTHERN MINER PRESS LIMITED, TORONTO-STOCK FORM NO. 501 REV. 9/44

255

END OF HOLE

DRILLED BY.....

SIGNED..... N.H.

PROPERTY PURDY MICA - H. Oslund Group  
 Keith Twp.

HOLE NUMBER 12  
 SHEET NUMBER 1  
 SECTION FROM 0' TO 245'

# DIAMOND DRILL RECORD

LOCATION: LAT. 10040 N  
 DEP. 27200 E  
 ELEVATION OF COLLAR  
 DATUM

STARTED  
 COMPLETED  
 ULTIMATE DEPTH 850'  
 PROPOSED DEPTH

DIRECTION AT START: BEARING S. Ast.  
 DIP 45° 250'-39° 550'-40° 750'-42°

DEPTH FEET	FORMATION	SAMPLE NO.	WIDTH OF SAMPLE	GOLD \$	SLUDGE GOLD \$
0 - 21	Casing 31'	7			
21-173	<del>Quartzose Greywacke</del> - Grey, massive, siliceous fine textured, with occasional small quartz grains and some small white carbonate fillings. Granular nature is evident at 31' but in places the quartz look like small eyes.				
62½-64	Grey felsitic dyke - Very similar to sediment, but has biotite flakes and crystalline texture can be seen with lens.				
173-176	Black Tuffs				
176-197	<del>Quartzose Greywacke?</del> Grey Felsite? - Grey as before.				
197-203	Black Tuffs.				
203-210	Grey, siliceous rock - Contacts look intrusive - Possibly a dyke.				
210-213	Black Tuffs				
213-220	Grey, siliceous rock - Quartzose Greywacke or Felsite?				
220-234	Black Tuffs				
234-245	Greywacke and grey rock in which granular				

*- This section - an igneous rock - probably rhyolite.*

*Saw some of them in the field nearby. They appear to be getting narrower to the west.*

*These are good rocks between before greywacke and and felsite. There are north and hole 13 must therefore lens out to the west of any way related to the rhyolite seen in it in previous section in this area. go*

*Rhyolite & BLACK TUFF*

DRILLED BY

SIGNED N.H.

PROPERTY HERMISTON OSLUR GROUP - Purdy Mica

Keith Twp.

# DIAMOND DRILL RECORD

HOLE NUMBER 12

SHEET NUMBER 2

SECTION FROM 245' TO 376½'

LOCATION: LAT. 10040 N  
 DEP. 27200 E

ELEVATION OF COLLAR

DATUM

DIRECTION AT START: BEARING S. Ast.  
 DIP 250' - 39°, 550' - 40°, 750' - 42°

STARTED

COMPLETED

ULTIMATE DEPTH 850'

PROPOSED DEPTH

DEPTH FEET	FORMATION	SAMPLE NO.	WIDTH OF SAMPLE	GOLD \$	SLUDGE GOLD \$
	<del>Black tuff</del> -clastic nature is apparent at 234.				
	but has beds of black-graphitic tuff to 245.				
245-618	<u>Dacitic Lavas</u>				
	245-246 - Siliceous dyke.				
	246-263 - Yellowish to <del>tan</del> brown, silicified, and mineralized zone, with numerous stringers of quartz and carbonate.				
	263-264 - Grey dyke.				
	264 - Grey green to brownish, sheared lavas with stringers of quartz and carbonate. Some quartz eyes noted in less altered sections - Well sheared and extremely altered.				
	285-288 } Dioritic dykes.				
	292-294 - }				
	322-323 - Grey felsitic dyke.				
	352-360 - Gray felsitic dyke.				
	362-369 - Dark green, relatively fresh dacite with leucoxene. 343'	8			
	369-371 - Acid dyke with chloritic streaks.				
	371-376½ - Light green sheared type as before				

with squeezed amygdules.

DRILLED BY

SIGNED N.H.

PROPERTY ..... HERMISTON OSLU GROUP - Purdy Mica

Keith Twp.

# DIAMOND DRILL RECORD

HOLE NUMBER ..... 12

SHEET NUMBER ..... 3

SECTION FROM 376½' TO 850'

LOCATION: LAT. 10040 N  
 DEP. 27200 E

ELEVATION OF COLLAR .....  
 DATUM .....

DIRECTION AT START: BEARING S Ast.  
 DIP 250'-39°, 550'-40°, 750'-42°

STARTED .....

COMPLETED .....

ULTIMATE DEPTH 850'

PROPOSED DEPTH .....

DEPTH FEET	FORMATION	SAMPLE NO.	WIDTH OF SAMPLE	GOLD \$	SLUDGE GOLD \$
	376½-378½ - Grey dyke with chloritic streaks.				
	394-402 - Somewhat darker with small quartz eyes.				
	402 - Light green and sheared.				
	426-428 - Dark brown, biotite lamprophyre.				
	428-507 - Light green andesitic type, some foliation and quite a number of irregular quartz carbonate stringers.				
	507-510 - Medium textured dykes - dioritic.				
	510-583 - Green, andesitic as before with no shearing but numerous small stringers.				
	583-618 - Grey siliceous dykes, becoming somewhat coarser at centre.				
618-850	<u>Serpentinized Greenstone (Basic Lava)</u> Black, soft, massive, soapy, probably original basic lava, but almost entirely converted to serpentine.				
	752-764 - Slightly lighter green - possibly flow contact.				
	764 - Blue black, soft and soapy as before.				
850	END OF HOLE				

DRILLED BY .....

SIGNED N.H. ....



PROPERTY HERMISTON OSLU GROUP - Purdy Mica

HOLE NUMBER 13  
 SHEET NUMBER 1  
 SECTION FROM 0' TO 595'

# DIAMOND DRILL RECORD

LOCATION: LAT. 9538 N  
 DEP. 30,278 E  
 ELEVATION OF COLLAR  
 DATUM

STARTED  
 COMPLETED  
 ULTIMATE DEPTH 943'  
 PROPOSED DEPTH

DIRECTION AT START: BEARING N Ast.  
 DIP 30° 250-35°, 500-36½°, 750-39°

DEPTH FEET	FORMATION	SAMPLE NO.	WIDTH OF SAMPLE	GOLD \$	SLUDGE GOLD \$
0 - 12	Casing				
12-50	Carbonate Schist - Foliation at about 40° is well marked.				
50-185	Serpentinized Greenstone - Relatively coarse, almost completely altered to serpentine. Some white to light green stringers.				
185-200	Grey-Felsitic Dyke				
200-303½	Serpentinized Greenstone - Patchy looking, somewhat schistose soft soapy rock, with about 50% light green carbonate in streaks.				
303½-336	Grey Siliceous Felsite Grey siliceous felsite rock with numerous small quartz eyes - Graphitic near 336.	324'	9		
336-595	Grey to Green Carbonate Rock - Highly altered, somewhat sheared at about 30° with streaks of light green chlorite and yellowish sericite. Also somewhat silicified. Origin is a problem. Becomes progressively more highly altered 400' with green carbonates and quartz. Some	10			

NORTHERN MINER PRESS LIMITED, TORONTO-STOCK FORM NO. 801 REV. 8/44

DRILLED BY ..... SIGNED N.H.

PROPERTY HERMISTON OSLUN GROUP - Purdy Mica

Keith Twp.

# DIAMOND DRILL RECORD

HOLE NUMBER 13

SHEET NUMBER 2

SECTION FROM 579' TO 943'

LOCATION: LAT. 9538 N  
 DEP. 30,278 E

ELEVATION OF COLLAR  
 DATUM

DIRECTION AT START: BEARING N. Ast.  
 DIP 30° 250-35°, 500-36½°, 750-39°

STARTED

COMPLETED

ULTIMATE DEPTH 943'

PROPOSED DEPTH

DEPTH FEET	FORMATION	SAMPLE NO.	WIDTH OF SAMPLE	GOLD \$	SLUDGE GOLD \$
	sections of bluish siliceous porphyry.				
	579-595 - More schistose and sericitic with foliation from 40°-60°.				
595-943	Quartzose Greywacke				
	595-659 - Massive dense, grey, siliceous rock slightly sheared. No bedding, but granular quartz is visible under lens and also has a few cherty fragments.				
	659 - Some argillaceous beds, but most rock is massive quartzose type.				
	726-758 - Bedding is almost parallel to core and contorted.				
	725-726 - Rounded to angular cherty pebbles that look similar to some of the fine beds.				
	758-790 Grits - Very coarse greywacke in which angular clastic fragments are numerous.				
	790-875 - Greywacke with some argillaceous beds.	772'	11		
	875-885 - Grits				
	885-943 - Greywacke as before and argillaceous				

*Possibly rhyolite or felsite.*

*Might not this be supporting evidence that the sediments are intercalated with the acidic volcanics?*

*Good Sediments*

*See log hole 12*

NORTHERN MINER PRESS LIMITED, TORONTO-STOCK FORM NO. 801 REV. 9/44 bed at angles of about 20° or less.

943

END OF HOLE  
 DRILLED BY

SIGNED N.H.

PROPERTY HERMISTON OSLUN GROUP - Purdy Mica

Keith Twp.

# DIAMOND DRILL RECORD

HOLE NUMBER 14

SHEET NUMBER 1

SECTION FROM 0' TO 528'

LOCATION: LAT. 9586 N  
 DEP. 30,253 E

ELEVATION OF COLLAR .....

DATUM .....

DIRECTION AT START: BEARING S. Ast.  
 DIP 35° 200' - 26° 500' - 26½°

STARTED .....

COMPLETED .....

ULTIMATE DEPTH 523'

PROPOSED DEPTH .....

DEPTH FEET	FORMATION	SAMPLE NO.	WIDTH OF SAMPLE	GOLD \$	SLUDGE GOLD \$
0 - 25½	Casing				
25½ - 131	Grey-Green Carbonates as at collar of d.d.h. 13 Foliation at about 50°.				
131 - 154	Siliceous Felsite Dyke? Yellow and sericitized to 133. 133 - Greyish, massive, somewhat sheared. Possibly greywacke.				
154 - 239	Carbonate-Sericite-Chlorite Schist - Closely related to carbonate rock above, but shows more foliation in sections.				
239 - 509	Serpentinized Greenstone - Black, soft, soapy with a few stringers of greyish carbonates and light green talc. 351-357 - Grey, siliceous dyke. 376-384 - Grey, siliceous dyke. 440-465 - Becomes slightly lighter colour and somewhat schistose with foliation showing some drag folding, but in general at about 40°. 465-509 - Reverts to blue-black, massive type.				
509 - 527	Pink Granitic Dyke - Rather fine sugary texture.				

NORTHERN MINER PRESS LIMITED, TORONTO-STOCK FORM NO. 501 REV. 9/44

527-528

Serpentinized Greenstone as before.

DRILLED BY .....

SIGNED N.H.

528

END OF HOLE

6501 plus N 70°  
Cabo Lindero  
90° of head pier  
Cabo Largo  
Sal 4900000000

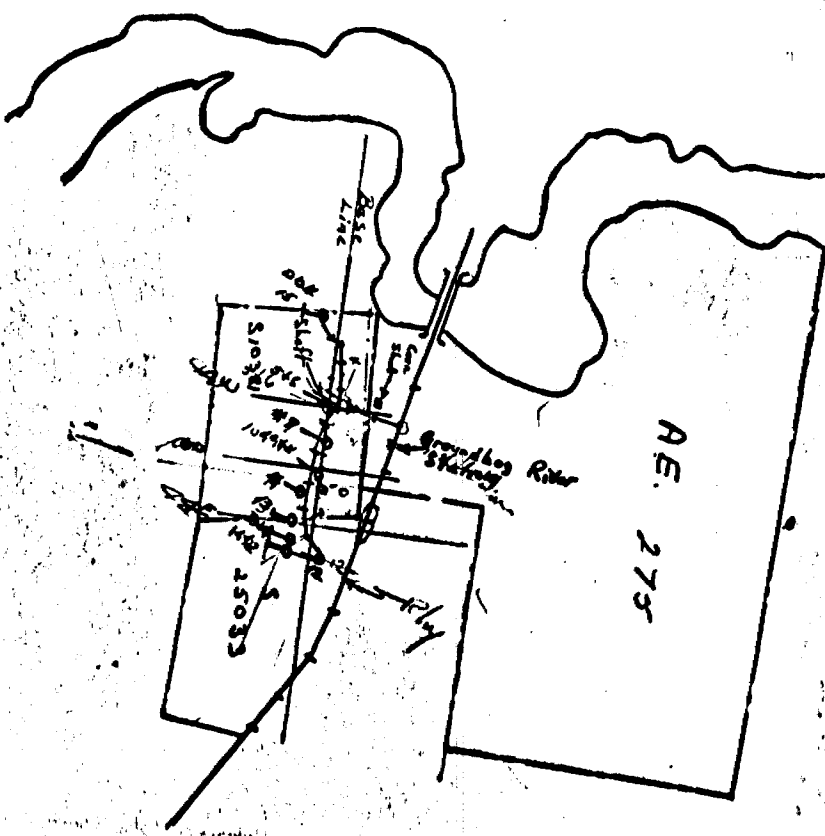

Johannes Dilling 1955

T-83

# DIAMOND DRILL RECORD

Hole No. J.G. 1 Sheet No. 1

Property JOBURKE GOLD MINES, Keith Twp.  
 Location Claims S.10381, S.25033

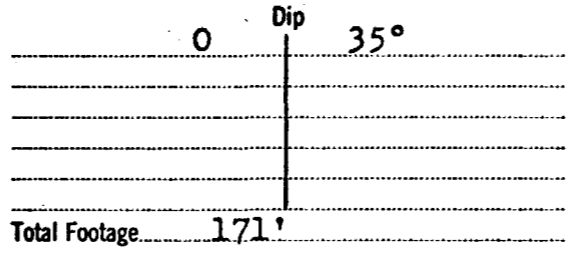

Latitude 140' S. (Approx.)  
 Departure 600' E. (Approx.)  
 Bearing Azimuth 198°

Elev. Collar \_\_\_\_\_  
 Datum \_\_\_\_\_  
 Date Started \_\_\_\_\_  
 Date Completed \_\_\_\_\_  
 Drilled by Longyear  
 Logged by S. A. Ferguson

Footage		Formation	Sample Number	Sample Footage	Sample Width	Gold Sample	Gold Sludge	Remarks
From	To							
0	20	No core.						
20	171	Andesite -- Chloritized and carbonatized with carbonate veinlets.	19	35				Andesite - chloritized and carbonatized.
		37 - 60 -- Core is split.						
		44 - 60 -- Veinlets of pyrrhotite, pyrite and chalcopyrite. Estimated grade -- less than 1 per cent copper.						
		70 - 73, 75 - 82 -- Core is split with veinlets of pyrrhotite, pyrite and chalcopyrite. Estimated grade is less than 1/2 per cent copper.						
		111 - 114 -- Core is split, a few veinlets of pyrrhotite and pyrite.						
		127 - 128 -- Core is split with minor sulphides						
		130 - 135 -- Core is split. First three feet are fairly massive sulphides, pyrrhotite, and pyrite and a little chalcopyrite.						
		141 - 144 -- Core is split. Three inches of massive sulphides, mainly pyrrhotite with a little chalcopyrite.						
171		END OF HOLE						

Date of Examination October 19, 1955

*S. A. Ferguson*

T-83

# DIAMOND DRILL RECORD

Hole No. J.G. 4 Sheet No. 1

Property JOBURKE GOLD MINES LTD., Keith Twp.  
 Location Claims S.10381, S.25033

Latitude 100' S. (Approx.)  
 Departure 500' E. (Approx.)  
 Bearing 185°

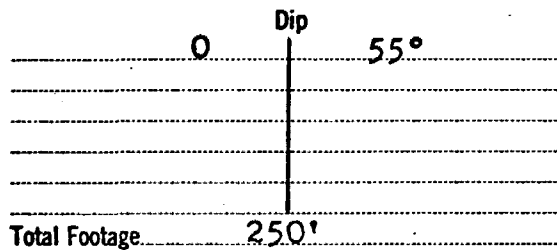

Elev. Collar \_\_\_\_\_  
 Datum \_\_\_\_\_  
 Date Started \_\_\_\_\_  
 Date Completed \_\_\_\_\_  
 Drilled by Longyear  
 Logged by S. A. Ferguson

Footage		Formation	Sample Number	Sample Footage	Sample Width	Gold Sample	Gold Sludge	Remarks
From	To							
0	9	Casing						
9	80	Carbonatized and Chloritized Andesite. -- Carbonate veinlets less than 10 per cent of rock. At 25' carbonate veinlets at 45 degrees to the core axis. 71 - 73 -- Core is split, about 6 inches of fairly massive sulphides, mainly pyrrhotite with some chalcopyrite. 78 - 103 -- Core is split. Scattered veinlets of sulphides throughout. 94 - 96 -- Section of fairly massive sulphides. Pyrrhotite, pyrite and some chalcopyrite are present.	20	21				Andesite, chloritized and carbonatized.
80	102	Silicified Tuffs -- Fairly hard. Bedding at 50 degrees to the core axis at 88'.	21	96				Silicified Tuff
102	250	Andesite -- Carbonatized. 105 - 105; 109.5 - 113.5; 117 - 118 -- Core is split, narrow veinlets of pyrrhotite, pyrite and a little chalcopyrite. 135 - 139; 141 - 152; 155 - 160; 161 - 163.5; 169 - 174 -- Sulphide veinlets with pyrrhotite, pyrite and a little chalcopyrite. 179 - 181; 216 - 218.5 -- Pyrite and pyrrhotite veinlets with a little chalcopyrite.						
250		END OF HOLE						

Date of Examination

October 19, 1955

*Shelton A. Ferguson*

# DIAMOND DRILL RECORD

Hole No. J.G. 6 Sheet No. 1

T-83

Property JOBURKE GOLD MINES LTD., Keith Twp.  
 Location Claims S. 10381, S. 25033

Latitude 50' N. (Approx.)  
 Departure 400' W. (Approx.)  
 Bearing 200°

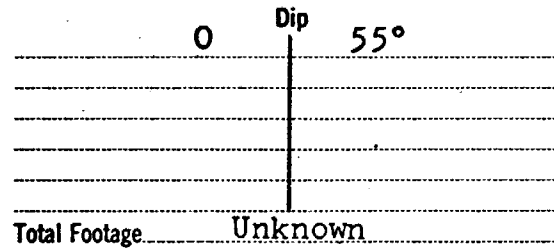

Elev. Collar \_\_\_\_\_  
 Datum \_\_\_\_\_  
 Date Started \_\_\_\_\_  
 Date Completed \_\_\_\_\_  
 Drilled by Longyear  
 Logged by S. A. Ferguson

Total Footage Unknown

Footage		Formation	Sample Number	Sample Footage	Sample Width	Gold Sample	Gold Sludge	Remarks
From	To							
0	13	Casing						
13	77	Andesite -- Strongly carbonatized and chloritized with a soapy feeling. Numerous carbonate veinlets are present making up from 10 to 20 per cent of the rock. At 28' carbonate veinlets 45 degrees to the core axis.	22	22				Andesite with carbonate veinlets.
77	92	Andesite Dyke -- Light coloured, uniform texture shows sharp contact with adjacent rock.						
92	126	Andesite, Chloritized with carbonate veinlets like preceding section. 107 - 112 -- Core is split. 107 - 109 -- Veinlets of chalcopryrite, pyrrhotite and pyrite. 109 - 112 -- Massive sulphides mainly pyrrhotite, with pyrite, a little chalcopryrite. At 123' carbonate veinlets at 40 degrees to the core axis.						
126		Core not located, probably sent for assay. 8' of core in the box is not located. Carbonatized andesite with carbonate veinlets. This is probably the toe of the hole.						

Date of Examination October 19, 1955

*S. A. Ferguson*

T-83

# DIAMOND DRILL RECORD

Hole No. 15 Sheet No. 1

Property JOBURKE GOLD MINES LTD., Keith Twp.  
Location Claims S. 10381, S. 25033

Latitude \_\_\_\_\_  
Departure \_\_\_\_\_  
Bearing South

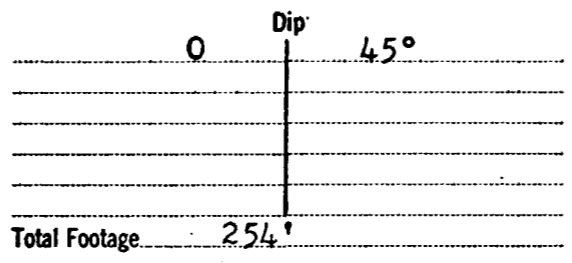

Elev. Collar \_\_\_\_\_  
Datum \_\_\_\_\_  
Date Started \_\_\_\_\_  
Date Completed \_\_\_\_\_  
Drilled by Longyear  
Logged by S. A. Ferguson

Footage		Formation	Sample Number	Sample Footage	Sample Width	Gold Sample	Gold Sludge	Remarks
From	To							
0	12	Casing						
12	136	Andesite -- Carbonatized and chloritized with carbonate veinlets. The veinlets are at 50 degrees to the core axis.	23	40				Andesite, chloritized and carbonatized.
		103 - 108 -- Core is split, veinlets of pyrrhotite, pyrite and a little chalcopyrite.						
136	243	Core is not located, probably sent for assay.						
243	254	Andesite -- Strongly chloritized with a few carbonate stringers.						

Date of Examination October 19, 1955

*S. A. Ferguson*