

TABLE OF CONTENTS.

- #1 - SKETCH OF CLAIM-INCLUDING GRID
BASE LINE & PICKET LINES
- #2 - LOCATION AND ACCESS { 2 "A" PROVINCIAL MAP
2 "B" TOWNSHIPS MAP }
- #3 - SUMMARY
- #4 - PROPERTY AND REGIONAL GEOLOGY
- #5 - INTRODUCTION
- #6 - PREVIOUS WORK.
- #7 - DIAGRAM "A" OLD SHAFT BETWEEN LINE 1E & 2
- #8 - DIAGRAM "B" OLD SHAFT BETWEEN LINE 4E & 5E
- #9 - DESCRIPTION OF SAMPLES & LOCATIONS
- #10 - DESCRIPTION OF SAMPLES
- #11 - ASSAY RESULTS
- #12 - ASSAY RESULTS.
- #13 - WORK SCHEDULE & PERSONS WORKING
- #14 - COST SCHEDULE.
- #15 - PROPOSED FOLLOW UP.



42B01NE2012 2.20403 KEITH

010

5.6

10

Dennis Morin



42B01NE2012 2.20403 KEITH

010C

#1

Keith Twp

CNR

Groundhog RIVER

#1

QUARTZ VEIN

TRENCHES

Base Line 00

TRENCH

OLD SHAFT
DIA. 'A'

OLD SHAFT
DIA. 'B'

CLAIM

122 3235

24 UNITS

LEGEND

Scale: 1:2500

□ claim post

■ old shaft

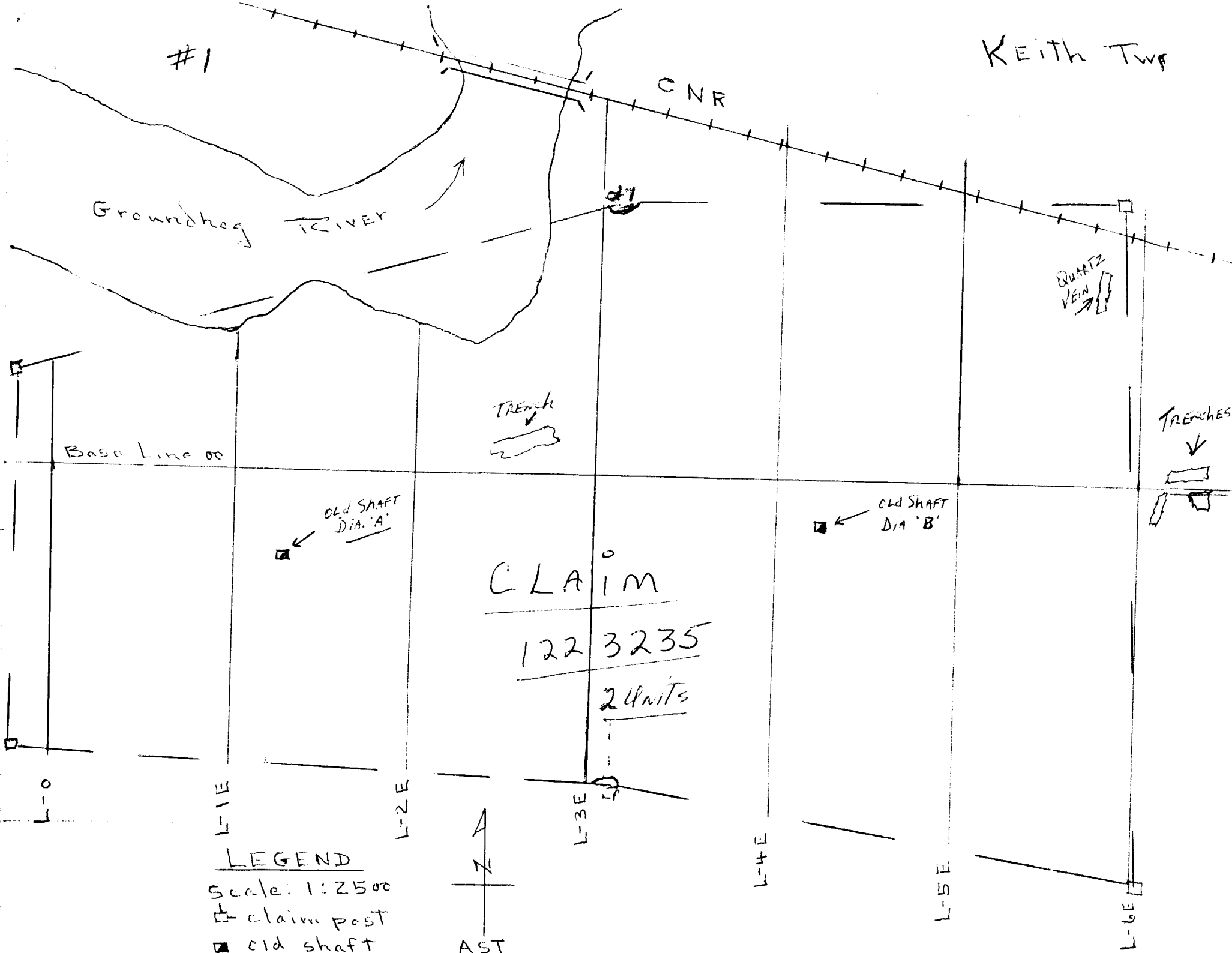

#2

LOCATION + ACCESS

THE PROPERTY - CLAIM # 1223235 - IS
SITUATED IN KEITH-TWP AND IS LOCATED
APPX 85 KM SOUTHWEST OF TIMMINS. ONT.
EDGING THE GROUNDHOG RIVER AT BRIDGE
AND STRADDLING THE RAILWAY TRACKS EAST
OF RIVER .

ACCESSED BY BOAT FROM GROUND HOG LAKE.
TO THE RIVER = SHORELINE @ BRIDGE

Dennis Morin

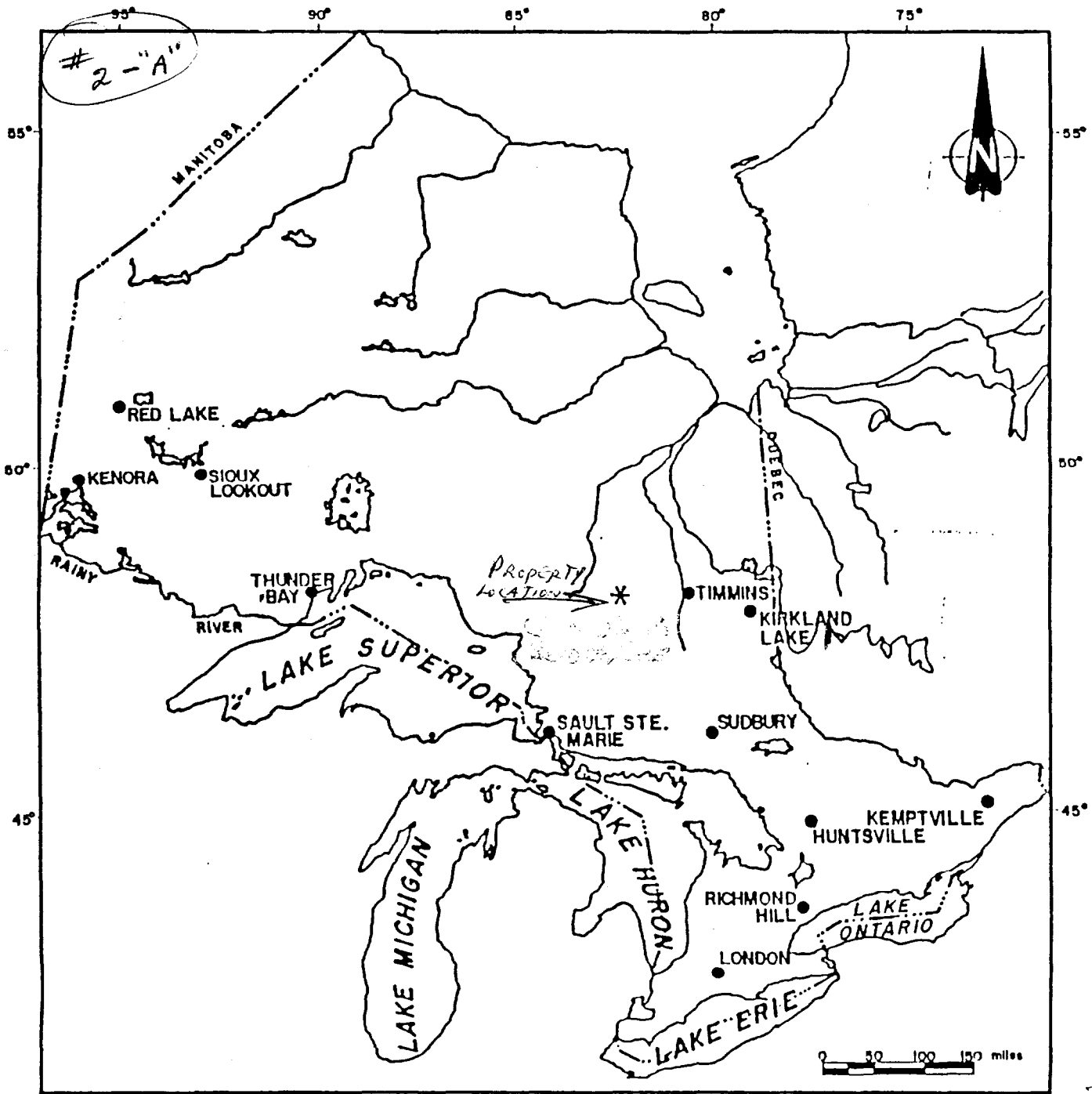

PROVINCE OF ONTARIO

0 50 100 150 miles

John Mann

#2 - "B"

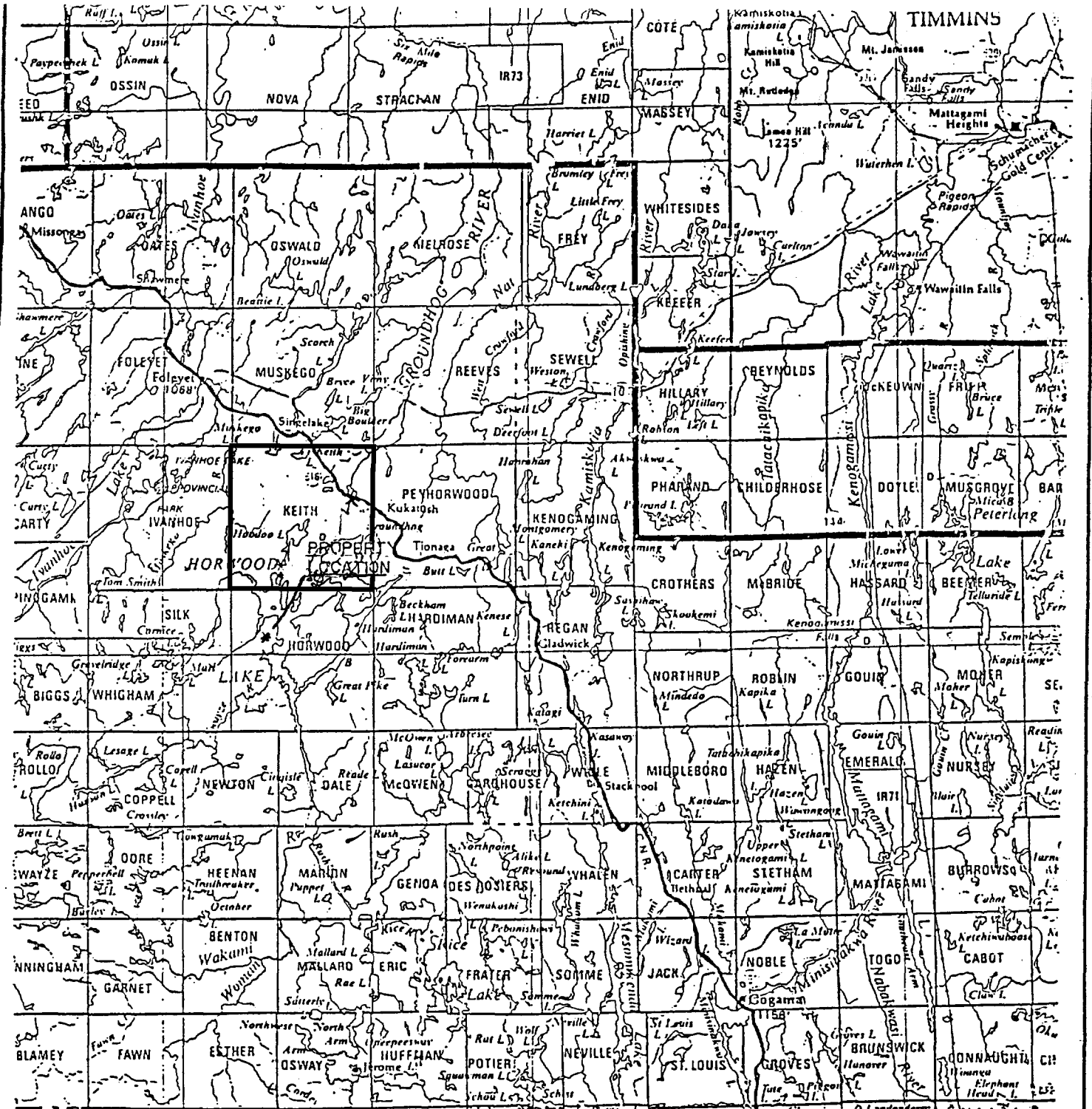

Davis Man PROPERTY LOCATION
CLAIM # 1223235

SUMMARY

#3

THE PROPERTY CONSIST OF ONE CLAIM
(2) UNITS WHICH LIE ALONG STRIKE TO THE
EAST OF JO BURKE MINES PROPERTY, WHICH IS
SITUATED IN KEITH TWP - SEE #.

THE CLAIM BORDERS THE GROUNDHOG RIVER
EAST ALONG THE RAILWAY TRACKS.

WORK WAS DONE ON THE PROPERTY AS FOLLOWS:

RE CUTTING THE BASE LINE

RE CUTTING THE PICKET LINES - 0 - 6E

PROSPECTING TO LOCATE 2 OLD SHAFTS
AND OLD TRENCHES.

PLUGGER DRILLING AND EXPLOSIVES (BLASTING)
SAMPLING

Dennis Morin

#4

PROPERTY GEOLOGY

In general, the geology of the property is comprised of an east-west trending sequence of Keewatin mafic and intermediate to felsic metavolcanic rocks, iron formation and intrusions of granite, diorite and serpentine, quartz-feldspar porphyry and diabase.

REGIONAL GEOLOGY

The Keith Township area was mapped by V.K. Frest and reported by the Ontario Department of Mines in 1950 (ODM Vol. LIX, Pt. VII). The area is situated on an east-west trending metavolcanic-metasedimentary belt known as the Archaean Swayze greenstone belt. The belt is predominantly comprised of Keewatin mafic and intermediate to felsic metavolcanic sequences, and thin associated epiclastic sedimentary rocks, intrusive rocks and iron formation (Frest, 1950) (Figure 3). The local stratigraphy trends east-west with a steep north dip. Oxide and sulphide facies iron formations strike across the region paralleling the trend of the mafic and felsic volcanic sequences (Figure 3). Intruding the mixed complex of volcanic and sedimentary rocks are sill like bodies of dioritic composition. The sill and dyke character of these diorites is readily apparent when associated with magnetically quiet metasediments. Ultramafic intrusive rocks, believed to be younger than the diorites appearing as serpentine, may represent altered diorites and/or peridotites (Frest, 1950). These rocks contain abundant carbonate alteration due to the carbonate being released during metamorphism of the serpentine (Frest, 1950). Granite plutons occur to the north and south of the greenstone belt. Proterozoic diabase intrudes all of the rocks of the region and generally trend north-northwest.

Darius Mowin

~~T. 3204~~

5

INTRODUCTION

Keith and Muskego townships are bounded by latitudes 48° 03'N and 48° 19'N and by longitudes 82° 12'W and 82° 24'W (Figure 1). An area of approximately 414 km² was mapped at 1:15 840 scale in 1992. The mapping part of an ongoing project, commenced immediately west of the current map area in 1991 (Ayer and Puumala 1991) to provide incentives for mineral exploration and to update the geological database of the northern Swayze greenstone belt. The project is funded by the Northern Ontario Development Agreement, a subsidiary agreement to the Canada-Ontario Economic and Regional Development Agreement signed by the governments of Canada and Ontario.

The map area is about 90 km southwest of Timmins and can be reached by Highway 101. The eastern and western parts of Keith Township are traversed by all weather gravel surfaced roads. Dry weather roads and trails provide access to northern Muskego Township. Water access is available for the southern and eastern parts of Keith Township from Horwood Lake, Groundhog Lake and the Groundhog River. North-central Keith Township and central and northeastern Muskego Township can be reached by water on a chain of interconnected lakes including Keith Lake, Slate Rock Lake and Scorch Lake. A Canadian National Railway line extends across northeastern Keith Township and southwestern Muskego Township.

Dennis Martin

#6

PREVIOUS WORK

GLEN AUDEN RESOURCES - JUNE - OCTOBER 1989
GEOPHYSICS AND IP SURVEY. FILE T-3204

Consolidated Mining & Smelting - 1946
GEOLOGICAL Mapping.

Purdy Mica Mines Ltd. - 1947 to 1955
SEVERAL DIAMOND DRILLING
THESE HOLES INTERSECTED CARBONATIZED ANDESITE
WITH PYRITE, PYRRHOTITE AND CALCOPYRITE.

ROBERT S. MIDDLETON EXPLORATION WAS CONTRACTED
IN 1988 TO CONDUCT A RECONNAISSANCE MAPPING
PROGRAM.

TAKEN FROM FILE 3204

Alvin Morris

DIAGRAM "A"

OLD SHAFT - BETWEEN LINE 1E & 2E.

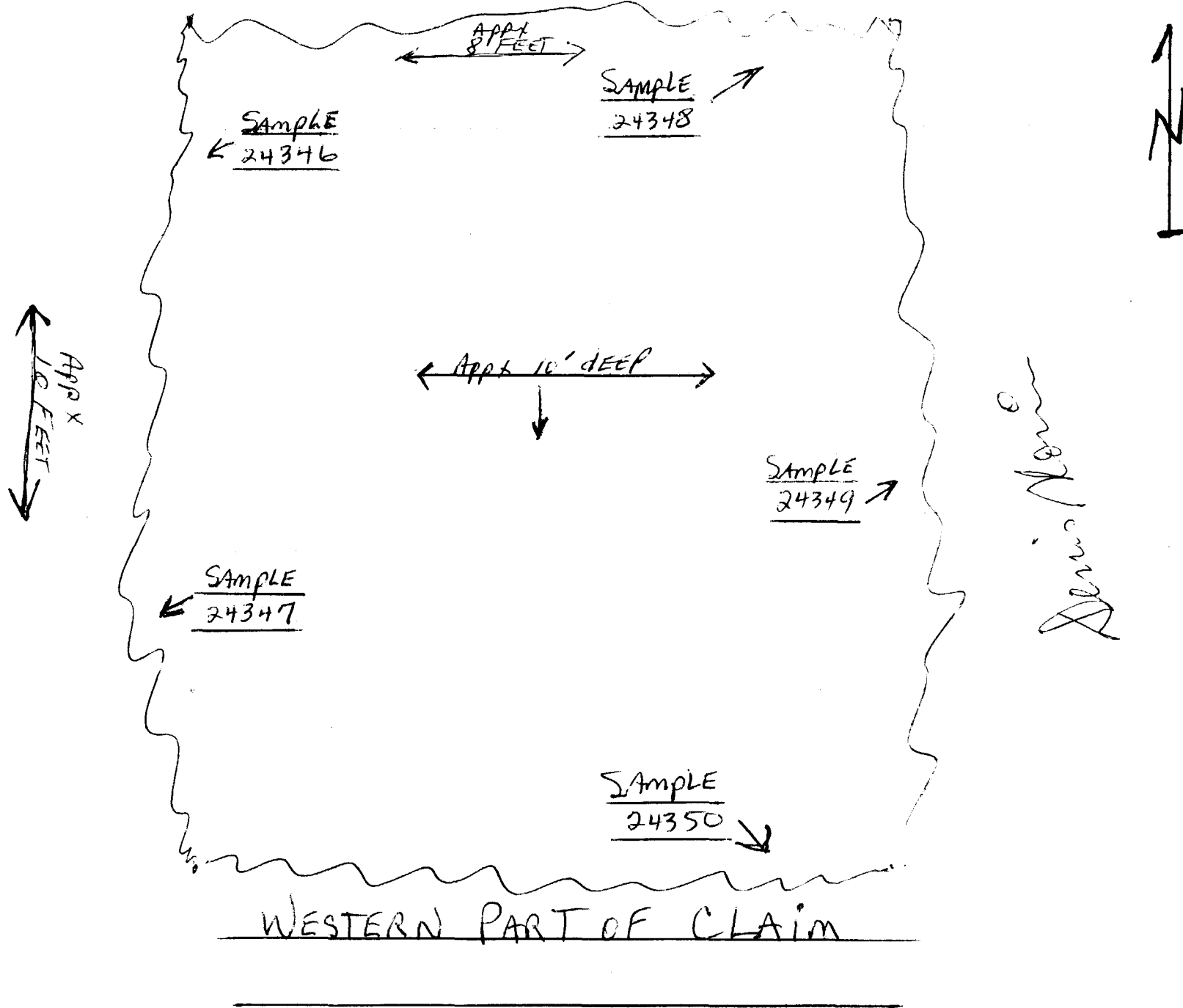

17

DIAGRAM "B"

SHAFT BETWEEN LINE 4E & 5E

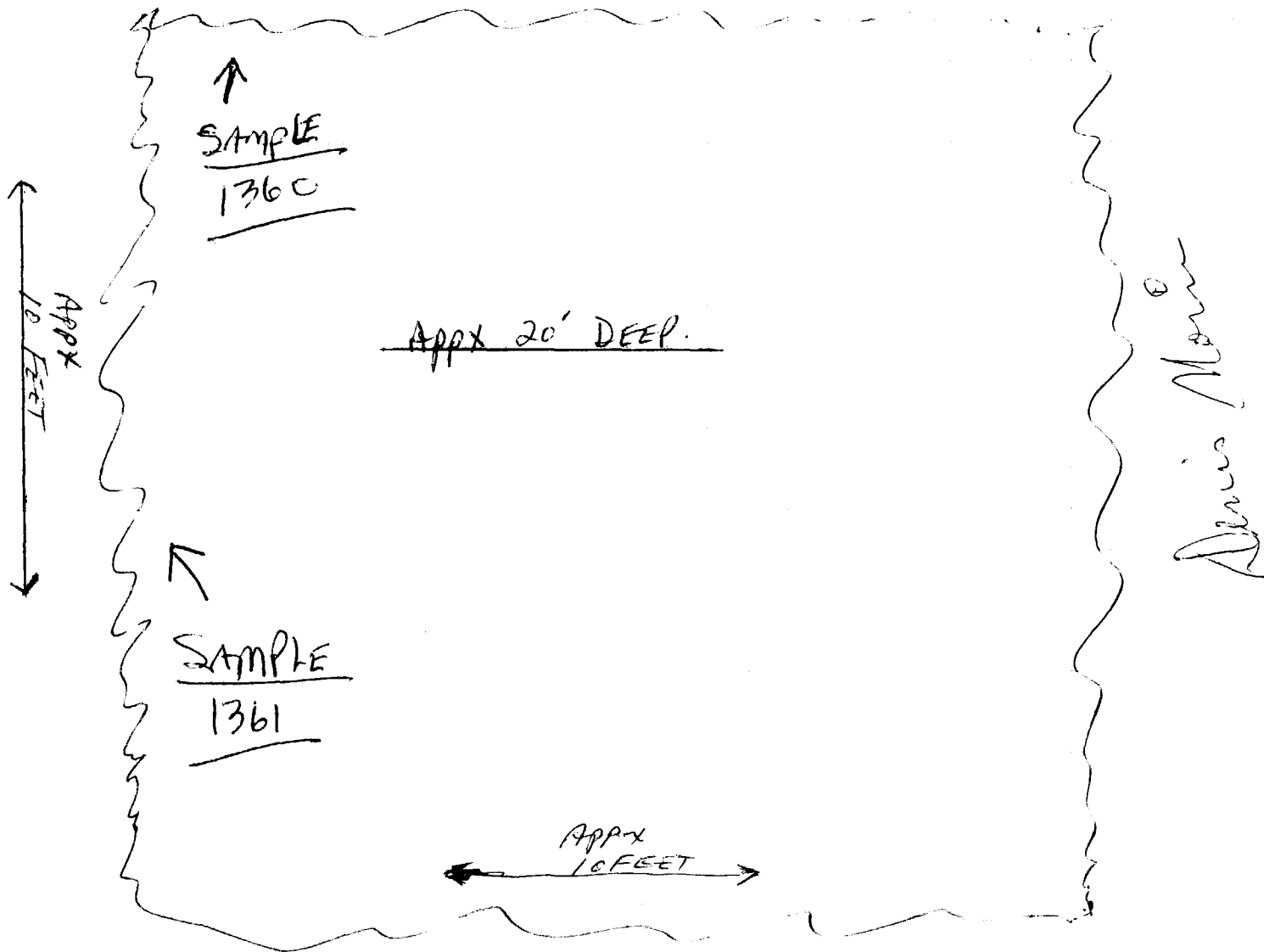

8#

9

DESCRIPTION OF SAMPLES LOCATION

Sample

- # 1357 TAKE APPX 60 FT NORTH OF BASE LINE
BETWEEN LINE 2-E & 3-E
HEAVY CUBE Py. MASSIVE.
- # 1358 AS ABOVE = GREEN CARBONATES WITH Py.
- # 1359 TAKEN FROM LONG TRENCH LINE 3-E
MASSIVE Sulphides.
- # 1360 TAKEN FROM SHAFT DIAGRAM B.
MASSIVE Sulphides - MINOR CALCO-Py.
- # 1361 TAKEN FROM SHAFT - DIA - B
BLACK GREY QTZ MINOR Py. & CALCO Py.
- # 1364 TAKEN FROM STRIPPED & BLASTED AREA
PIT. MASSIVE Sulphides. LINE 7-EAST
- # 1365 TAKEN FROM STRIPPED & BLASTED AREA PIT
MASSIVE Sulphides - LINE 7-EAST

Dennis Martin

#10

DESCRIPTION OF SAMPLES

- # 24346 = RUSTED QTZ FROM WALL ROCK
MINOR PY.
- # 24347 = QTZ = GREEN CARBONATES +
DISSIMINATED SULPHIDES.
- # 24348 = WALL ROCK - MINOR PY + QTZ
- # 24349 = WALL ROCK - GREEN QTZ STRINGERS
LARGE CUBE PY.
- # 24350 = QTZ CARBONATES - MINOR PY.

Jimis Morin



Established 1928

#11

Swastika Laboratories

A Division of Assayers Corporation Ltd.

Assaying - Consulting - Representation

Geochemical Analysis Certificate

9W-1778-RG1

Company: **D. MORIN**

Date: JUL-12-99

Project:

Attn: D. Morin

We hereby certify the following Geochemical Analysis of 2 Rock samples submitted JUL-05-99 by .

Sample Number	Au PPB	Au Check PPB	Ag PPM	Cu PPM	Ni PPM
1364	55	99	0.7	3760	472
1365	31	-	1.0	5590	453

Denis Morin

Certified by

#12



Established 1928

Swastika Laboratories Ltd

Assaying - Consulting - Representation

Assay Certificate

0W-1830-RA1

Company: **D. MORIN**
Project:
Attn: **D. Morin**

Date: JUN-05-00

We hereby certify the following Assay of 3 Rock samples submitted JUN-01-00 by .

Sample Number	Au oz/ton	Pt oz/ton	Pd oz/ton	WRA
1357	-	-	-	Results
1360	-	<0.001	<0.001	to
1362	<0.001	-	-	follow

Dennis Morin

One assay ton portion used.

Certified by *G. Leblond*

#13

WORK SCHEDULE.

JUNE 22 / 98 = TRUCKING THEN BOATING TO CLAIM AREA LOCATION.
2 MEN LOCATE OLD BASE LINE AND PICKET LINES.
CUT & CLEAN BASE LINE BETWEEN LINE 0 & 6E

LOCATE OLD SHAFT DIAGRAM "A"
SAMPLE # 24346 - 24347 - 24348 - 24349 - 24350

JUNE 24 / 98 = TRUCKING THEN BOATING TO CLAIM AREA.
2 MEN CUT & CLEAN PICKET LINES 6E & 5E & 4E

JUNE 25 / 98 = TRUCKING THEN BOATING TO CLAIM LOCATION.
2 MEN CUT & CLEAN PICKET LINES 3E & 2E 1E

JULY 3 / 99 = TRUCKING THEN BOATING TO CLAIM LOCATION
2 MEN PLUGGER WORK - DRILLING & BLASTING
AND SAMPLING # 1364 and # 1365

JULY 20 / 99 = TRUCKING THEN BOATING TO CLAIM LOCATION
1 MAN PROSPECT PICKET LINES
SAMPLING # 1357 - 1358 - 1359
SAMPLING OLD SHAFT DIAGRAM "B"
1360 AND 1361

ASSAYING COSTS TO FOLLOW

Denis Morin

PERSON WORKING ON PROPERTY.

ROGER DENOMME, P.O. Box 1625, Timmins, Ont.
Groundhog LAKE.

Denis Morin, Ivanhoe Lake, Foleyet, Ont. Pomito

#14

COST SCHEDULE

JUNE 22/98 =	2 MEN @ 160.00 PER-DAY	=	3 20 00
	TRUCK TRANSPORTATION - 76 KL-RTN @ 30¢	=	2 2 80
	Food 2 MEN	=	3 0 00
JUNE 24/98 =	2 MEN @ 160.00 PER-DAY	=	3 20 00
	TRUCK TRANSPORTATION - 76 KL-RTN @ 30¢	=	2 2 80
	Food. 2 MEN	=	3 0 00
JUNE 25/98 =	2 MEN @ 160.00 PER-DAY	=	3 20 00
	TRUCK TRANSPORTATION - 76 KL-RTN @ 30¢	=	2 2 80
	Food. 2 MEN	=	3 0 00
JULY 3/99 =	2 MEN @ 160.00 PER-DAY	=	3 20 00
	TRUCK TRANSPORTATION - 76 KL-RTN @ 30¢	=	2 2 80
	Food 2 MEN	=	3 0 00
	PLUGGER RENTAL 1 DAY	=	7 5 00
	EXPLOSIVES	=	3 0 00
JULY 20/99 =	1 MAN @	PER-DAY =	1 6 0 00
	TRUCK TRANSPORTATION - 76 KL-RTN @ 30¢	=	2 2 80
	Food. 1 MAN	=	1 5 00

TOTAL COSTS = 1,794.00

Dennis Morin

#15

Proposed Follow Up.

WE ARE PLANNING A STRIPPING PROGRAM ALONG AND JUST WEST OF LINE 5 E, WHERE MASSIVE SULPHIDES WAS ENCOUNTERED.

Denis Morin



Declaration of Assessment Work Performed on Mining Land

Mining Act, Subsection 65(2) and 66(3), R.S.O. 1990

Transaction Number (office use)
00060.00282
Assessment Files Research Imaging



42B01NE2012 2.20403 KEITH 900

Sections 65(2) and 66(3) of the Mining Act. Under section 8 of the Mining Act, this work and correspond with the mining land holder. Questions about this collection sent and Mines, 3rd Floor, 933 Ramsey Lake Road, Sudbury, Ontario, P3E 6B5.

Instructions: - For work performed on Crown Lands before recording a claim, use form 0240. - Please type or print in ink.

1. Recorded holder(s) (Attach a list if necessary)

Name: ROGER DENOMME, Client Number: 125387, Address: P.O. Box 1625, Timmins, Ont. (Groundhog Lake), Telephone Number: 705-899-2077, Fax Number: SAME.

2. Type of work performed: Check (✓) and report on only ONE of the following groups for this declaration.

Geotechnical: [checked] Physical: [checked] Rehabilitation: [] Work Type: LINE CUTTING, PROSPECTING, PLUGGER DRILLING, SAMPLING. Dates Work Performed: Day 22, Month 06, Year 1998 to Day 20, Month 07, Year 1999. Township/Area: KEITH, Mining Division: Porcupine, Resident Geologist District: Timmins.

- Please remember to: - obtain a work permit from the Ministry of Natural Resources as required; - provide proper notice to surface rights holders before starting work; - complete and attach a Statement of Costs, form 0212; - provide a map showing contiguous mining lands that are linked for assigning work; - include two copies of your technical report.

3. Person or companies who prepared the technical report (Attach a list if necessary)

Name: DENIS MORIN, Client # 172503, Telephone Number: 705-899-2077, Address: IVANHOE LAKE, FOLEYET, ONT. PERMITS.

4. Certification by Recorded Holder or Agent

I, DENIS MORIN, do hereby certify that I have personal knowledge of the facts set forth in this Declaration of Assessment Work having caused the work to be performed or witnessed the same during or after its completion and, to the best of my knowledge, the annexed report is true.

Signature of Recorded Holder or Agent: [Signature], Date: JUNE 14/2000, Agent's Address: IVANHOE LK. FOLEYET ONT. PERMITS, Telephone Number: 705-899-2077, Fax Number: SAME.

0241 (03/97) Denis Morin

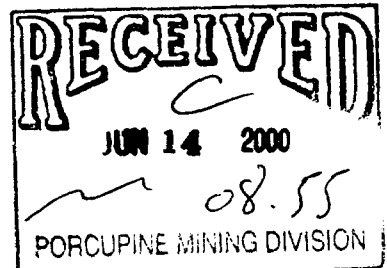
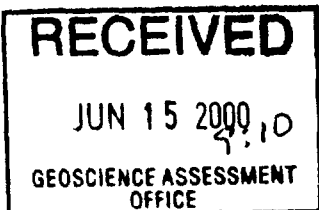

5. Work to be recorded and distributed. Work can only be assigned to claims that are contiguous (adjoining) to the mining land where work was performed, at the time work was performed. A map showing the contiguous link must accompany this form.

WDOUO. 00282

Mining Claim Number. Or if work was done on other eligible mining land, show in this column the location number indicated on the claim map.	Number of Claim Units. For other mining land, list hectares.	Value of work performed on this claim or other mining land.	Value of work applied to this claim.	Value of work assigned to other mining claims.	Bank. Value of work to be distributed at a future date
eg TB 7827	16 ha	\$26,825	N/A	\$24,000	\$2,825
eg 1234567	12	0	\$24,000	0	0
eg 1234568	2	\$ 8,892	\$ 4,000	0	\$4,892
1 1223235	2	1,794.	1,600	0	194
2					
3					
4					
5					
6					
7					
8					
9					
10					
11					
12					
13					
14					
15					
Column Totals	2	1,794.	1600	0	194

I, DENIS MORIN (Print Full Name), do hereby certify that the above work credits are eligible under subsection 7 (1) of the Assessment Work Regulation 6/96 for assignment to contiguous claims or for application to the claim where the work was done.

Signature of Recorded Holder or Agent Authorized in Writing Denis Morin Date June 14 / 2000

6. Instructions for cutting back credits that are not approved.

Some of the credits claimed in this declaration may be cut back. Please check (✓) in the boxes below to show how you wish to prioritize the deletion of credits:

- 1. Credits are to be cut back from the Bank first, followed by option 2 or 3 or 4 as indicated.
- 2. Credits are to be cut back starting with the claims listed last, working backwards; or
- 3. Credits are to be cut back equally over all claims listed in this declaration; or
- 4. Credits are to be cut back as prioritized on the attached appendix or as follows (describe):

Note: If you have not indicated how your credits are to be deleted, credits will be cut back from the Bank first, followed by option number 2 if necessary.

For Office Use Only

Received Stamp <u>12 20408</u>	Deemed Approved Date	Date Notification Sent
	Date Approved	Total Value of Credit Approved
	Approved for Recording by Mining Recorder (Signature)	

0241 (03/97)

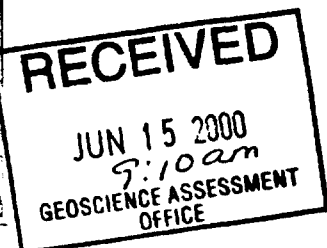
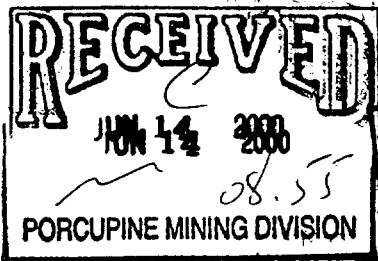



Schedule for Declaration of Assessment Work on Mining Land

Transaction Number (office use)
W D O U O. 00282

Table with 6 columns: Mining Claim Number, Number of Claim Units, Value of work performed on this claim, Value of work applied to this claim, Value of work assigned to other mining claims, Bank Value of work to be distributed at a future date. Row 1 contains handwritten data: 1223235, 2, 1,794, 1,600, 0, 194.

RECEIVED JUN 15 2000 GEOSCIENCE ASSESSMENT OFFICE

Column Totals

RECEIVED JUN 14 2000 9:10 88 55 PORCUPINE MINING DIVISION

Personal information collected on this form is obtained under the authority of subsection 6 (1) of the Assessment Work Regulation 6/96. Under section 8 of the Mining Act, this information is a public record. This information will be used to review the assessment work and correspond with the mining land holder. Questions about this collection should be directed to a Provincial Mining Recorder, Ministry of Northern Development and Mines, 3rd Floor, 933 Ramsey Lake Road, Sudbury, Ontario, P3E 6B5.

Work Type	Units of work Depending on the type of work, list the number of hours/days worked, metres of drilling, kilometres of grid line, number of samples, etc.	Cost Per Unit of work	Total Cost
LINE CUTTING	2 MEN @ 3 days \$160.00 ea per day		960.00
PLUGGER DRILLING	2 MEN @ 1 day \$160.00 ea per day		320.00
SAMPLING & PROSPECTING			160.00
Associated Costs (e.g. supplies, mobilization and demobilization).			
	PLUGGER RENTAL 1 day =		75.00
	EXPLOSIVES		30.00
Transportation Costs			
	5 TRIPS - IVANHOE LAKE TO Ground Hog Lk. @ 76 KL RETURN = 380 KL @ 30¢ PER.		114.00
Food and Lodging Costs			
	2 MEN X 4 days @ \$30.00 per DAY		240.00
	1 MAN X 1 day @ \$15.00 per DAY		15.00
Total Value of Assessment Work			1,794.00

Calculations of Filing Discounts:

1. Work filed within two years of performance is claimed at 100% of the above Total Value of Assessment Work.
2. If work is filed after two years and up to five years after performance, it can only be claimed at 50% of the Total Value of Assessment Work. If this situation applies to your claims, use the calculation below:

TOTAL VALUE OF ASSESSMENT WORK x 0.50 = Total \$ value of worked claimed.

Note:

- Work older than 5 years is not eligible for credit.
- A recorded holder may be required to verify expenditures claimed in this statement of costs within 45 days of a request for verification and/or correction/clarification. If verification and/or correction/clarification is not made, the Minister may reject all or part of the assessment work submitted.

Certification verifying costs:

I, DENIS MORIN, do hereby certify, that the amounts shown are as accurate as may reasonably be determined and the costs were incurred while conducting assessment work on the lands indicated on the accompanying

Declaration of Work form as PARTNER & AGENT I am authorized to make this certification.
(recorded holder, agent, or state Company position with signing authority)

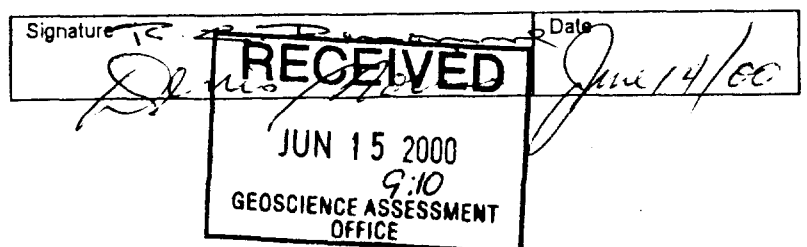
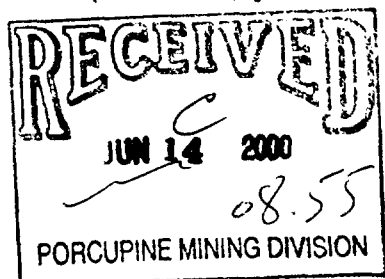

Geoscience Assessment Office
933 Ramsey Lake Road
6th Floor
Sudbury, Ontario
P3E 6B5

Telephone: (888) 415-9845
Fax: (877) 670-1555

August 11, 2000

ROGER C. DENOMME
P.O. BOX 1625
TIMMINS, ONTARIO
P4M-7W8

Visit our website at:
www.gov.on.ca/MNDM/MINES/LANDS/mlsmnpge.htm

Dear Sir or Madam:

Submission Number: 2.20403

Status

Subject: Transaction Number(s): W0060.00282 Approval

We have reviewed your Assessment Work submission with the above noted Transaction Number(s). The attached summary page(s) indicate the results of the review. WE RECOMMEND YOU READ THIS SUMMARY FOR THE DETAILS PERTAINING TO YOUR ASSESSMENT WORK.

If the status for a transaction is a 45 Day Notice, the summary will outline the reasons for the notice, and any steps you can take to remedy deficiencies. The 90-day deemed approval provision, subsection 6(7) of the Assessment Work Regulation, will no longer be in effect for assessment work which has received a 45 Day Notice. Allowable changes to your credit distribution can be made by contacting the Geoscience Assessment Office within this 45 Day period, otherwise assessment credit will be cut back and distributed as outlined in Section #6 of the Declaration of Assessment work form.

Please note any revisions must be submitted in DUPLICATE to the Geoscience Assessment Office, by the response date on the summary.

If you have any questions regarding this correspondence, please contact JIM MCAULEY by e-mail at james.mcauley@ndm.gov.on.ca or by telephone at (705) 670-5880.

Yours sincerely,

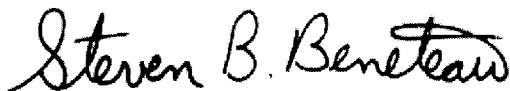

ORIGINAL SIGNED BY
Steve B. Beneteau
Acting Supervisor, Geoscience Assessment Office
Mining Lands Section

Work Report Assessment Results

Submission Number: 2.20403

Date Correspondence Sent: August 11, 2000

Assessor: JIM MCAULEY

Transaction Number	First Claim Number	Township(s) / Area(s)	Status	Approval Date
W0060.00282	1223235	KEITH	Approval	August 11, 2000

Section:

10 Physical PTRNCH

10 Physical PMAN

At the discretion of the Ministry, the assessment work performed on the mining lands noted in this work report may be subject to inspection and/or investigation at any time.

Correspondence to:

Resident Geologist
South Porcupine, ON

Recorded Holder(s) and/or Agent(s):

Denis Morin
IVANHOE LAKE FOLEYET, ONTARIO, CANADA

Assessment Files Library
Sudbury, ON

ROGER C. DENOMME
TIMMINS, ONTARIO

REFERENCE

AREAS WITHDRAWN FROM DISPOSTION

M.R.O. - MINING RIGHTS ONLY
 S.R.O. - SURFACE RIGHTS ONLY
 M+S. - MINING AND SURFACE RIGHTS

Description	Order No.	Date	Disposition	File
(R)			S.R.O.	13563
(R)	M.N.R. RES.		S.R.O.	2247.
(R)	SEC. 36/80	7/2/80	S.R.O.	18843
(R)	MNR OPERATIONS BASE	3/01/95	S.R.O.	LND. HOLE

SEC 35 W.L.L.C1565/99 ONT MAY 15/99 M&S 200 METRES FROM SHORELINE SAND AND GRAVEL

- (A) M.T.C. PIT
- (B) M.T.C. PIT 3A-18
- (C) M.T.C. PIT 3A-16
- (D) M.T.C. PIT 10A5
- (E) GRAVEL PILE 177587
- (F) M.N.R. PIT 3A-1 (MOJ. WASTE DISP. SITE)

SEC.35 W.L.L.C1565/99 ONT MAY 17/99 M&S

SURVEY LINES SHOWN THIS ARE FOR CONTROL ONLY. CLAIMS CLASSIFIED AS BEING IN UNSUBDIVIDED TERRITORY. — March 7, 1947.
 Surveyor General

FLOODING

Flooded areas on Hoodoo & Horwood Lakes and Groundhog R. to contour elev 1117' L.O. 7746 File 75156



THE INFORMATION THAT APPEARS ON THIS MAP HAS BEEN COMPILED FROM VARIOUS SOURCES, AND ACCURACY IS NOT GUARANTEED. THOSE WISHING TO STAKE MINING CLAIMS SHOULD CONSULT WITH THE MINING RECORDER MINISTRY OF NORTHERN DEVELOPMENT AND MINES, FOR ADDITIONAL INFORMATION ON THE STATUS OF THE LANDS SHOWN HEREON.

MUSKEGO TWP.

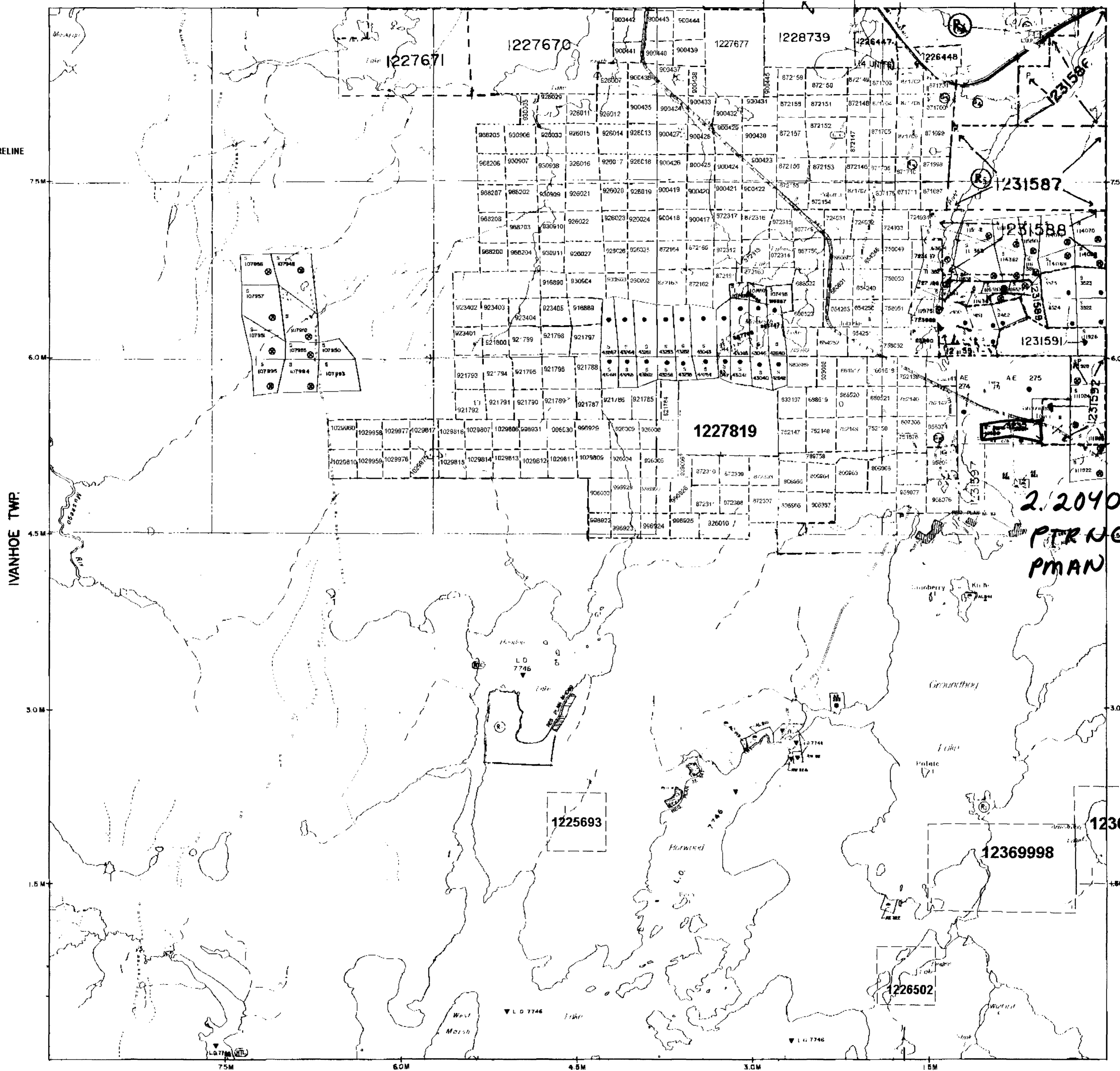

LEGEND

- HIGHWAY AND ROUTE No.
- OTHER ROADS
- TRAILS
- SURVEYED LINES
- TOWNSHIPS, BASE LINES, ETC.
- LOTS, MINING CLAIMS, PARCELS, ETC.
- UNSURVEYED LINES
- LOT LINES
- PARCEL BOUNDARY
- MINING CLAIMS ETC.
- RAILWAY AND RIGHT OF WAY
- UTILITY LINES
- NON-PERENNIAL STREAM
- FLOODING OR FLOODING RIGHTS
- SUBDIVISION OR COMPOSITE PLAN
- RESERVATIONS
- ORIGINAL SHORELINE
- MARSH OR MUSKEG
- MINES
- TRAVERSE MONUMENT

DISPOSITION OF CROWN LANDS

TYPE OF DOCUMENT	SYMBOL
PATENT SURFACE & MINING RIGHTS	●
" SURFACE RIGHTS ONLY	○
" MINING RIGHTS ONLY	◐
LEASE, SURFACE & MINING RIGHTS	■
" SURFACE RIGHTS ONLY	◼
" MINING RIGHTS ONLY	◻
LICENCE OF OCCUPATION	▼
ORDER-IN-COUNCIL RESERVATION	OC
CANCELLED	⊙
SAND & GRAVEL	⊗
LAND USE PERMITS FOR COMMERCIAL TOURISM, OUTPOST CAMPS	⊕

NOTE: MINING RIGHTS IN PARCELS PATENTED PRIOR TO MAY 6, 1913, VESTED IN ORIGINAL PATENTEE BY THE PUBLIC LANDS ACT, R.S.O. 1970, CHAP. 386, SEC. 63, SUBSEC. 1.

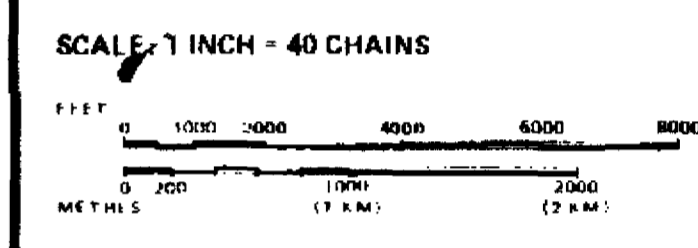

REMOTE TOURIST CAMPS

TOWNSHIP
KEITH
 M.N.R. ADMINISTRATIVE DISTRICT
 CHAPLEAU
 MINING DIVISION
 PORCUPINE
 LAND TITLES / REGISTRY DIVISION
 SUDBURY

Ministry of Natural Resources
 Land Management Branch
 Ontario

Date: APRIL 1985
 Number: **G-3238**