



42B01NW0072 16 KEITH

010

# Diamond Drilling

Area of Keith

Report NO 16

Work performed by: Kukatush Mining Corp. Ltd.

Claim NO	Hole NO	Footage	Date	Note
S 107495	K-1	430'	June/62	

Notes:

S 107495

107495

## DIAMOND DRILL RECORD S-1-208

107495

PROPERTY Kukatash Mining Corp. (1960) Ltd. KEITH TOWNSHIP HOLE No. K-1

SHEET NUMBER 1 SECTION FROM ..... TO ..... STARTED June 12 1962

LATITUDE 3310' North DATUM ..... COMPLETED June 14 1962

DEPARTURE Section 8,000 East BEARING South ULTIMATE DEPTH 430'

ELEVATION ..... DIP ..... PROPOSED DEPTH 550'

DEPTH FEET	FORMATION	SAMPLE NO.	FROM	TO	WIDTH	ASSAY VALUES		
0 - 6'	Overburden							
6'-162'	Basic volcanics: Green, medium grained. Diorite, Carbonaceous Parting varies between 45 & 60 Degrees. Has "mottled" appearance. Mottling (amygdules?) is elongated in the direction of the parting planes. Calcite evident on parting planes.							
	17- very minor disseminated pyrite 27½- pyrrhotite							
	51 - pyrite 77 - 15 degree fracture showing evidence of movement 83 - Sheared, darker coloured due to increased Chlorite, some pyrite							
	91½ - Network of fine Calcite veins 100½ - contorted and sheared at 15 degrees. Carbonaceous.							
	121 - Sheared 0 degrees 122 - Sheared, soft, green, greasy feel; Talc-Chlorite schist 122½ - Calcite fracture with long, bladed greenish coloured mineral- soft: 2-3 Serpentine							
	140½ - drag fold. Pyrite mineralization 144-149 - Wavy appearance to banding. Parting 45 degrees							
	150 - Pyrite 151 - Fracture filled with pyrite and minute Calcite XI growth 152- 1" Pyrite- Pyrrhotite							

NORTHERN MINER FORM 905 REV./84

DRILLED BY \_\_\_\_\_

SIGNED \_\_\_\_\_

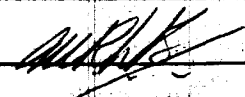

# DIAMOND DRILL RECORD

 PROPERTY Kukatash Mining Corp. (1960) Ltd.

KEITH TOWNSHIP

 HOLE No. K-1

 SHEET NUMBER 2 SECTION FROM \_\_\_\_\_ TO \_\_\_\_\_ STARTED \_\_\_\_\_

LATITUDE \_\_\_\_\_ DATUM \_\_\_\_\_ COMPLETED \_\_\_\_\_

DEPARTURE \_\_\_\_\_ BEARING \_\_\_\_\_ ULTIMATE DEPTH \_\_\_\_\_

ELEVATION \_\_\_\_\_ DIP \_\_\_\_\_ PROPOSED DEPTH \_\_\_\_\_

DEPTH FEET	FORMATION	SAMPLE NO.	FROM	TO	WIDTH	ASSAY VALUES	
2 162-177	Volcanics interbanded with Carbonate, banding at 50 degrees Carbonate represents 20% of core 168- 5" banded magnetite and sulphides in chert- volcanic complex banding at 45 degrees						
168½-170	Chlorite schist (no angle determinable) with pyrite-pyrrhotite and quartz.						
170-171	Banded chert, chlorite and magnetite. Banding at 60 degrees 2 magnetite bands one eighth inch wide. Some radiating needle-like Xls of brownish coloured Tremolite and possibly some hornblende with the Chlorite. Some scattered prite and fine well-developed magnetite Xls in the Chlorite. Carbonate not readily identifiable but definite effervescence with dilute HCl						
177-178½	Same as 170-171 but with considerably more pyrite						
178½-189	Iron Formation	19	179½	189½	10	27.40	22.1
	Banded chert and magnetite. Magnetite bands vary from almost nothing to ½" wide 178½- 6" quartz with tremolite and pyrite 186½- 3" quartz with pyrite 187½- two small tremolite bands 188½- Tremolite- Rosettes of fine needle-like Xls, some greenish, some brown.						

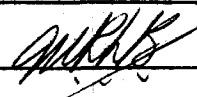

# DIAMOND DRILL RECORD

PROPERTY Kukatash Mining Corp. (1960) Ltd. KEITH TOWNSHIP HOLE No. K-1

SHEET NUMBER 3 SECTION FROM \_\_\_\_\_ TO \_\_\_\_\_ STARTED \_\_\_\_\_

LATITUDE \_\_\_\_\_ DATUM \_\_\_\_\_ COMPLETED \_\_\_\_\_

DEPARTURE \_\_\_\_\_ BEARING \_\_\_\_\_ ULTIMATE DEPTH \_\_\_\_\_

ELEVATION \_\_\_\_\_ DIP \_\_\_\_\_ PROPOSED DEPTH \_\_\_\_\_

DEPTH FEET	FORMATION	SAMPLE NO.	FROM	TO	WIDTH	ASSAY VALUES			
189-194	Same as 170-7 171 with magnetite bands 189½ - 6" magnetite bands 190- Pyrite and Tremolite 192- 1½' banded pyrite and chlorite; some black bands, probably graphitic schist containing pyrite as rectangular xls and as drop-shaped blebs. Elongation is parallel to banding (60 degrees) 193½- Cherty material								
194-195	1' lost core								
195-197	Has almost brecciated appearance- cherty-some bands of magnetite dragged to 15 degrees. Tremolite present, also a similar appearing mineral but blue coloured- Riebeckite								
197-200	3' Lost core								
200-201	1' " "								
201-202	Massive Riebeckite, Tough medium hard (4½-5) blue. Surface perpendicular to X1 growth shows great permeability. Some pyrite and pyrrhotite mineralization. Cut by fine calcite stringers. Random orientation								
202	202- 6" Breccia zone cut by multiple calcite stringers some pyrite-pyrrhotite and a little disseminated magnetite								

NORTHERN MINER FORM 905 REV./54

DRILLED BY \_\_\_\_\_

SIGNED \_\_\_\_\_

*AMR/B*

# DIAMOND DRILL RECORD

PROPERTY Kukatash Mining Corp. (1960) Ltd. KEITH TOWNSHIP HOLE No. K-1

SHEET NUMBER 4 SECTION FROM \_\_\_\_\_ TO \_\_\_\_\_ STARTED \_\_\_\_\_

LATITUDE \_\_\_\_\_ DATUM \_\_\_\_\_ COMPLETED \_\_\_\_\_

DEPARTURE \_\_\_\_\_ BEARING \_\_\_\_\_ ULTIMATE DEPTH \_\_\_\_\_

ELEVATION \_\_\_\_\_ DIP \_\_\_\_\_ PROPOSED DEPTH \_\_\_\_\_

DEPTH FEET	FORMATION	SAMPLE NO.	FROM	TO	WIDTH	ASSAY VALUES	
						% Fe Sol.	% mag. Fe
202½-207	Iron Formation. Chert & Magnetite	20	202½	207½	4½	31.61	23.9
	Banding at 45 degrees, mostly fine grained and containing some carbonate						
	203½ - Tremolite xls						
	206½ - Sheared at 60 degrees						
	207 - Coarse grained magnetite						
207-208½	1½' Lost core						
208½-215	Light coloured, medium grained siliceous rok. No quartz, although massive appears to have a sugary texture on a broken surface rather than conchoidal fracture, but grains not distinct. Probably Quartzite. Banding 30 degrees						
	209- 1" Magnetite band						
	209½- Much Tremolite with pyrite and some magnetite grains						
	212- Interbanded magnetite, pyrite and chloritic diorite 1' wide						
	Banding 30 degrees						
	215- Magnetite xls in siliceous matr. Some Tremolite						
215- 224	Interbanded volcanics and carbonate. Banding 30 degrees. Medium grained. quartz-diorite.						

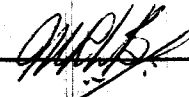

# DIAMOND DRILL RECORD

PROPERTY Kukatash Mining Corp. (1960) Ltd. KEITH TOWNSHIP HOLE No. K-1  
 SHEET NUMBER 5 SECTION FROM \_\_\_\_\_ TO \_\_\_\_\_ STARTED \_\_\_\_\_  
 LATITUDE \_\_\_\_\_ DATUM \_\_\_\_\_ COMPLETED \_\_\_\_\_  
 DEPARTURE \_\_\_\_\_ BEARING \_\_\_\_\_ ULTIMATE DEPTH \_\_\_\_\_  
 ELEVATION \_\_\_\_\_ DIP \_\_\_\_\_ PROPOSED DEPTH \_\_\_\_\_

DEPTH FEET	FORMATION	SAMPLE NO.	FROM	TO	WIDTH	ASSAY VALUES	
						Fe Sol.	Mag Fe
224-292	Same as above with considerably less carbonate still dioritic looking. Parting at 30 degrees to 230' where it becomes approx. 90 degrees.						
244-	Hematite on 10 degree slip						
256½	- 10 degree fault 1" wide. Calcite on margins. Considerable number of low angle (10-30 degree) slips throughout.						
283½	- 2½' containing quartz eyes						
286-	2' lost core						
288-292	: Quartz eyes more abundant						
292-316	Iron Formation	21	291	301	10	31.68	30.0
		22	301	311	10	29.70	20.9
	Chert and magnetite bands at 60 degrees containing some pyrite and some amphibole Crystals. Bands up to three eighths of an inch wide. Mostly fine grained.						
294.8-	Coarse grained magnetite						
295.7-	" " "						
302	- 6" Lost core						
307.3-	Coarse grained magnetite						
310.4	10 degree slip						
311-312	Frequent bands of coarse grained magnetite						

NORTHERN MINER FORM 205 REV./84

DRILLED BY \_\_\_\_\_

SIGNED \_\_\_\_\_

*Handwritten signature*

# DIAMOND DRILL RECORD

PROPERTY Kukatash Mining Corp, (1960) Ltd. KEITH TOWNSHIP HOLE No. K-1  
 SHEET NUMBER 6 SECTION FROM \_\_\_\_\_ TO \_\_\_\_\_ STARTED \_\_\_\_\_  
 LATITUDE \_\_\_\_\_ DATUM \_\_\_\_\_ COMPLETED \_\_\_\_\_  
 DEPARTURE \_\_\_\_\_ BEARING \_\_\_\_\_ ULTIMATE DEPTH \_\_\_\_\_  
 ELEVATION \_\_\_\_\_ DIP \_\_\_\_\_ PROPOSED DEPTH \_\_\_\_\_

DEPTH FEET	FORMATION	SAMPLE NO.	FROM	TO	WIDTH	ASSAY VALUES		
292-316	Iron Formation							
	312-316: Magnetite bands become sparsely separated and sulphides becoming prominent							
	315½- one eighth inch band pyrite-pyrrhotite							
316-322	2½' Lost core . Siliceous breccia zone. Pyrite- Pyrrhotite mineralization 318- Black graphitic material, a little magnetite							
322-430	Light green coloured siliceous rock, fine grained DACITE Sparse carbonate banding and some included carbonate with sulphides: Pyrite-pyrrhotite Parting between 322-379 is 60 degrees 396- Chlorite schist 30 degrees 415- Dacite sheared at 45 degrees 425- 1' slate and carbonate 426- Graphitic schist							
430	End of hole							

NORTHERN MINER FORM 905 REV./84

DRILLED BY \_\_\_\_\_

SIGNED \_\_\_\_\_

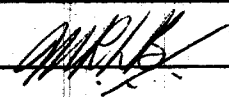

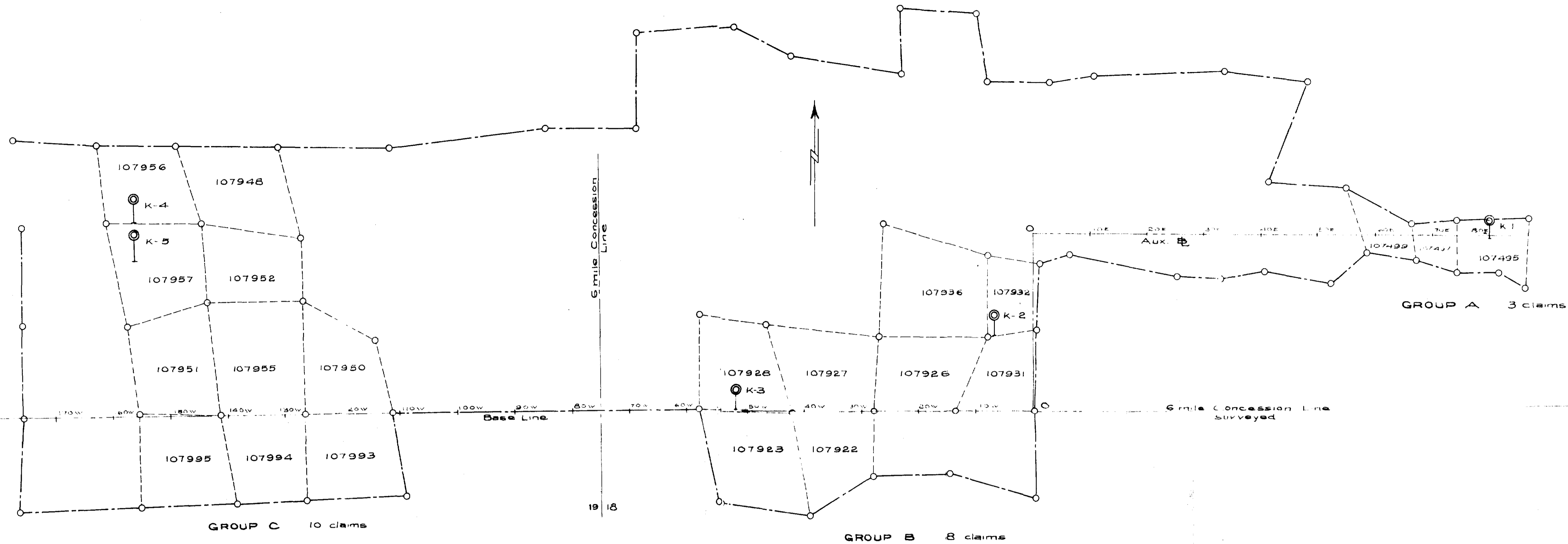

KEITH TWP

LEGEND

- Outline of original 67 claim group
- Base Line
- Claim Line
- ⊙ Diamond Drill Hole
- Claim Corner

HOLE N°	SECTION	NORTH OF BASE LINE	BEARING	DIP	LENGTH
K-1	80+00E	3310'	SOUTH	-45°	430'
K-2	7+00W	1642'	SOUTH	-45°	495'
K-3	52+00W	284'	SOUTH	-45°	499'
K-4	156+00W	3744'	SOUTH	-45°	601'
K-5	156+00W	3127'	SOUTH	-45°	663'

KUKATUSH MINING CORPORATION  
(1960) LIMITED

KUKATUSH ONTARIO

PARTIAL PLAN OF KEITH GROUP  
SHOWING  
PROPOSED CLAIM GROUPING AND  
DIAMOND DRILLING COMPLETED IN  
1962

SCALE: 1"=1000' DRAWING NUMBER  
DATE: OCT. 11, 1962

Report 5-1-208 Keith Twp.



42881N0072 16 KEITH