



42B01SE0006 2.13005 PENHORWOOD

010

2.13005

**- ADDENDUM TO REPORT ON -
ROSEVAL SILICA INC. - TIONAGA QUARTZ
RESERVES**

RECEIVED

JAN 08 1990

MINING LANDS SECTION

Prepared by:

**BEDROCK CONSULTING
July 10 1989**

for:

ROSEVAL SILICA INC.

**ADDENDUM TO REPORT ON
ROSEVAL SILICA INC. - TIONAGA QUARTZ
RESERVES**

July 10, 1989

The following report gives a brief description of the recent stripping at site #3 and 2(a) as shown on the attached maps #1 and #2.

SITE #3

At site #3, six days of slashing and stripping was undertaken by the contractor Claude Caron of Timmins. Two equipment operators using a small bulldozer and a trackhoe along with a slasher were assigned to this operation.

Stripping was initiated near hole A3 and progressed northward until the quartz bedrock started dipping below about 7' of overburden, stripping was halted here despite the lack of a contact. Continuing stripping to the south and southeast revealed a contact with a greenish grey talc-ankerite phyllite containing parallel 1' - 3' wide veins of quartz. (This phyllitic rock type bore a resemblance with that encountered in the stripped area of site #1 - see assessment file information for claim #P984379, Penhorwood township.) This was the widest area stripped representing a width of quartz at least 90' wide.

Stripping continued to the east and west with more quartz being encountered in both these directions. Excessive pile up of overburden and limited time prevented more extensive stripping.

Test pits #2, 3 and 4 were dug to determine the possible extent of the quartz. Quartz with a brown surface stain was encountered in pit #2 and quartz with some waste rock was found in pit #3. In pit #4 an undetermined waste rock was encountered. Pit #1 was dug on the basis of some quartz outcrops which later proved to be loose float. No quartz appeared to be present in this pit although solid bedrock was not reached.

It should be mentioned that prior to stripping a crude survey of the area was undertaken with a prototype digital GDD Beep Mat purchased by Bedrock Consulting. This instrument was able to discriminate quartz bedrock underlain by up to 3' of overburden and was useful to indicate the area of intended stripping and helped define the nature and location of the quartz contact. Blue ribbons marking the extent of the quartz as indicated by the instrument readings matched the actual contacts and the abruptness in the change of the readings indicated the sharpness of the contact.

The apparent quality of quartz encountered was very good (suitable for the production of silicon metal). Occasional discrete inclusions of dark green to rusty coloured talc-ankerite were observed ranging in size from 6" x 6" to a rare maximum 1' x 10'. These inclusions seemed to be arranged along a trend parallel to the strike of the quartz body. Minor surface films of orange brown staining were frequently encountered on the surface exposures of the quartz.

Based on the maximum width stripped (90' width of quartz), the length of quartz exposed - assuming continuity to hole A6 (270' length of quartz) and the results of a drill program (60' depth of quartz), we can assume a volume of 54,000 m³ or 143,000 tonnes of quartz. This is about the maximum predicted size of the body as stated in the March 12 report. As this body is still open to the north and at depth, and the termination of the east and west boundaries have not yet been located, the possibility of additional reserves are very good.

A deeper drill program with holes at 24' centres would be adequate to give drill proven tonnes of quartz over the area of quartz exposure.

SITE 2(a)

A very limited one day stripping program was carried out on site 2(a). A report from Gaetan Lavallee indicated that quartz of unknown quality was encountered over an area 100' x 200' - 300' as determined by two trenches 5 to 6' deep at right angles to each other. It is quite possible that site 2(a) could be an extension of site 2.

If an assumption is made of a quartz depth of 45' (as indicated by the nearest set of drill holes - see March 12 Reserves report) over an area of 20,000 ft² the volume of quartz would be 32,620 m³ or 86,575 tonnes. These possible reserves could be proven again by further stripping and drilling at 24' centres. These reserves would be in addition to those drill indicated reserves reported in the March 12 Reserves report. Further reserves at site 2(a) are also possible.

CERTIFICATE

I, Robert G. Komarechka, of the City of Sudbury, in the Province of Ontario hereby certify as follows:

1. That I am a consulting geologist currently residing in Sudbury.
2. That I am a graduate, BSc. Geology major, of Laurentian University of Sudbury, Ontario, a registered professional geologist in the Province of Alberta affiliated with the Canadian Council of Professional Engineers, and that I have been practising my profession for seven years.
3. That I have no interest direct or indirect, and do not expect to receive any interest in the properties, or in the security of anyone or company involved with this property.
4. That this report is based on a personal examination of the property during stripping operations from June 26 to July 6, 1989.

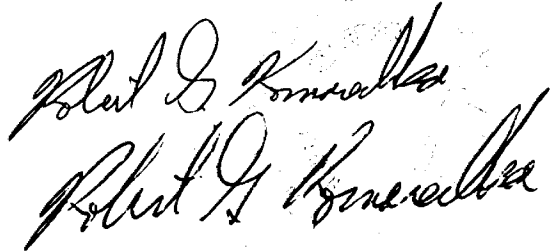
The image shows two handwritten signatures of Robert G. Komarechka. The top signature is written in a cursive style, and the bottom signature is a more stylized, possibly photocopied or scanned version of the same name.

Robert G. Komarechka

Dated at Sudbury, Ontario, this 10th day of July, 1989.



Ministry of
Northern Development
and Mines

DOCUMENT No.

9006-019



42B015E0006 2.13005 PENHORWOOD

900

Mining Act

Report of Work
(Expenditures, Subsection)

AMENDED
NEW

Type of Work Performed CONSULTANTS REPORT	Mining Division PORCUPINE	Township or Area PENHORWOOD SECTION 7 WP
Recorded Holder ROSEVAL SILICA INC	2.13005	Prospector's Licence No. 74950
Address 150 de Brullon, Boucherville Quebec	J4B 2J2	Telephone No. (514) 655-0157
Work Performed By BED ROCK CONSULTING, SUITE #1, 396 EVA AVE, SUDBURY ONTARIO P3C 4N3		
Name and Address of Author (of Submission) ROBERT GERALD KUMARECHKA APT #1, 396 EVA AVE SUDBURY ONT. P3C4N3		Date When Work was Performed From: 26 06 89 To: 26 07 89 Day Mo. Yr. Day Mo. Yr.

All the work was performed on Mining Claim(s): Indicate no. of days performed on each claim. *See Note No. 1 on reverse side									
Mining Claim	No. of Days	Mining Claim	No. of Days	Mining Claim	No. of Days	Mining Claim	No. of Days	Mining Claim	No. of Days

Instructions Total days credits may be distributed at claim holder's choice. Enter number of days credits per claim in the expenditure days credit column (below).	Calculation of Expenditure Days Credits Total Expenditures	Total Days Credits	Total Number of Mining Claims Covered by this Report of Work
	\$ 2,174.08	÷ 15 = 144.9	11

Mining Claims (List in numerical sequence). If space is insufficient, attach schedules with required information

Prefix	Mining Claim Number	Expend. Days Cr.	Prefix	Mining Claim Number	Expend. Days Cr.	Prefix	Mining Claim Number	Expend. Days Cr.	Prefix	Mining Claim Number	Expend. Days Cr.
P	995807	7	P	986587	20						
P	995808	7	P	986589	7						
P	995809	7									
P	995810	7	P	994627	10.9						
P	986583	20									
P	986584	20									
P	986585	20									
P	986586	19									

RECORDED
JAN - 8 1990

Total Number of Days Performed 144.9	Total Number of Days Claimed 144.9	Total Number of Days to be Claimed at a Future Date 0
--	--	---

Certification of Beneficial Interest *See Note No. 2 on reverse side

I hereby certify that, at the time the work was performed, the claims covered in this report of work were recorded in the current recorded holder's name or held under a beneficial interest by the current recorded holder.

Date: **JAN. 9, 1990**

Recorded Holder or Agent (Signature): *Robert G. Kumarechka*

Certification Verifying Report of Work

I hereby certify that I have a personal and intimate knowledge of the facts set forth in the Report of Work annexed hereto, having performed the work or witnessed same during and/or after its completion and the annexed report is true.

Name and Address of Person Certifying: **ASSESSMENT FILES**
Robert Gerald Kumarechka
APR 10 1990
396 EVA AVE SUDBURY ONTARIO P3C 4N3

Telephone No.: **(514) 678-0832**

Date of Survey: **APR 10 1990**

Certified By (Signature): *Robert G. Kumarechka*

For Office Use Only

RECEIVED

APR 1 1990

RECEIVED

JAN 8 1990

Total Days Cr. Recorded 144.9	Date Recorded JAN. 8/90	Mining Recorder <i>[Signature]</i>
Date Approved as Recorded 5 April 90	Provincial Manager Mining Lands <i>[Signature]</i>	

BEDROCK CONSULTING

SUITE #1, 398 EVA AVE.
SUDBURY, ONT. P3C 4N3

OUR NO.	R	000471
DATE	JULY 7 1989	
CUSTOMER'S ORDER		
SALESMAN	B. Komarechka	
TERMS	Payable on receipt of billing	
F.O.B.		

SOLD TO ROSEVAL SILICA INC
SUPERVISION & MAPPING STRIPPING
SHIP TO OF SITE #3
ADDRESS _____ VIA _____

INVOICE

June 3	3 1/2 DAYS GEOLOGICAL CONSULTING @				
to June 6	\$200.00 / DAY	700	00		
JULY	MILEAGE 1,156 km @ .25¢/km	289	00	-	
to July 13	3 EVENINGS @ RAMADA - ACCOMODATION	187	43	-	
to July 13	MEALS \$11.12 + 2.59 + 7.29 + 5.23 (NO RECEIPT)	26	23	-	
	TOTAL				1202 66

46.7 days

*Payment by 133
to bank on 7/13/89*

BLUELINE D 31

*Payment Received
Robert G Komarechka*

SECTION:
46.7 DAYS - 77-14.

35.84
18.00
14.00
14.00
8.74
7.75
14.00
61.20
6.00
174.00

700.
200.
400.
200.
2,000. CONSULTING.

DISBURSEMENTS

BEDROCK CONSULTING

SUITE #1, 396 EVA AVE.
SUDBURY, ONT. P3C 4N3

OUR NUMBER	000470
DATE	JULY 2 1989
CUSTOMER'S ORDER	
SALESMAN	B. KOMARECHKA
TERMS	PAYABLE ON RECEIPT
F. O. B.	OF BILLING

SOLD TO ROSEVAL SILICA INC
~~SUPERVISE~~
SHIP TO STRIPPING OF SITE #3
ADDRESS _____ VIA _____

INVOICE

JUNE	4 1/2 DAYS @ \$200.00 / DAY FOR	900 00	60	DAYS	-77-19
JUNE 26-30	GEOLOGIC SUPERVISION CONSULTING				
JUNE 26-27	RAMADA ACCOMODATION MEALS	137 46			
JUNE 28-30	OPISHING TAVERN ROOM BOARD	10 3 68			
JUNE 30	MEAL ON ROAD	4 65			
JUNE 26	FORMS FOR DATA IN TRIPLICATE	8 79			
	MILEAGE 1177km @ 25¢/km	294 25			
	PROMOTIONAL GIFT FOR CARSTAKER	22 85			
	JULES OF EXTENDER MINERALS				
	TOTAL		1471	68	

*Payment received 133
B. Komarechka*

BLUELINE D 31

PAYMENT RECEIVED - *Robert J Komarechka*

BEDROCK CONSULTING

SUITE #1, 398 EVA AVE.
SUDBURY, ONT. P3C 4N3

OUR NUMBER	000472
DATE	JULY 7 1989
CUSTOMER'S ORDER	
SALESMAN	B. KOMARECHKA
TERMS	Payable on receipt of billing
F. O. B.	of billing

SOLD TO ROSEVAL SILICA INC
PREPARATION OF 6 REPORTS ON PENHURWOOD RESERVES
SHIP TO 1/2 INFORMATION REQUESTED BY GAETAN LAVALLEE
ADDRESS _____ VIA _____

INVOICE

JULY 7	10 hours @ \$20.00 / hr	200. 00	13.3	DAYS	77-19
	PARKING METER	2. 25			
	MILEAGE 40km @ .25 / km	10. 00			
	BLUPRINTS	14. 00			
	PHOTOCOPYING - 306 pgs @ .20 / pg	61 20			
	6 REPORT FORMS 1.00 each	6 00			
	TOTAL		293	45	

*Payment Received
Robert J Komarechka*

*Payment received 133
B. Komarechka*

BLUELINE D 31

BEDROCK CONSULTING
 SUITE #1, 596 EVA AVE.
 SUDBURY, ONT. P3C 4N3

OUR NO.	R	000473
DATE	JULY 10 1989	
CUSTOMER'S ORDER		
SALESMAN	B. KONARECHKA	
TERMS	PAYABLE ON	
F.O.B.	RECEIPT OF BILLING	

SOLD TO ROSEVAL SILICA INC
PREPARATION OF ADDENDUM TO PENHOLMWOOD RESERVE
 SHIP TO AND PREPARATION & SHIPPING OF 14 COPIES.
 ADDRESS _____ VIA _____

INVOICE

JULY 9	5 HRS @ \$20.00/HR GEOL. CONSULTING	100	00	6.7	PAYS	- 77-19
JULY 10	" " " "	100	00	6.7	DAYS	77-19
28	BLUE PRINTS @ 1.20 ea	35	84			
2	PHOTO ^{CO} PRINTS ON VECUM @ 18.00 ea	18	00			
	14 REPORT FORMS @ \$1.00 ea	14	00			
	PHOTOCOPYING 70 COPIES @ 20¢ ea.	14	00			
	MILEAGE 23 km @ 25¢/km.	5	75			
	TOTAL				287	59

paid by cheque

BLUELINE D 31

Payment Received
Robert J. Konarechka

BEDROCK CONSULTING

SUITE #1, 398 EVA AVE.
SUDBURY, ONT. P3C 4N3

OUR NO	R	000471
DATE	JULY 7 1989	
CUSTOMER'S ORDER		
SALESMAN	B. Komarechka	
TERMS	Payable on receipt	
F.O.B.	of billing	

SOLD TO ROSEVAL SILICA INC
SUPERVISION & MAPPING STRIPPING
SHIP TO OF SITE #3
ADDRESS _____ VIA _____

ROY ADDRESS *July*

INVOICE

June 3	3 1/2 DAYS GEOLOGICAL CONSULTING @				
to June 6	\$200.00 / DAY	700	00		OK
JULY	MILEAGE 1,156 km @ .25¢/km	289	00	-	X
<i>ROY</i>	3 EVENINGS @ RAMADA - ACCOMODATION	187	43	-	X
	MEALS \$11.12 + 2.59 + 7.29 + 5.23 (NO RECEIPT)	26	23	-	X
	TOTAL				1202 66

46.7 days

Payment 137 + amount 7 days

BLUELINE D 31

Payment Received
Robert Komarechka

SECTION 46.7 DAYS - 77-14

25.84
18.00
14.00
14.00
8.71
7.75
14.00
61.20
6.00
174.08

700.
700.
400.
200.
1000. CONSULTING

700. +
900. +
8.79 +
200. +
14. +
61.2 +
6. +
200. +
35.84 +
18. +
14. +
14. +

BEDROCK CONSULTING

SUITE #1, 396 EVA AVE.
SUDBURY, ONT. P3C 4N3

OUR NO. ER	000470
DATE	JULY 2 1989
CUSTOMER'S ORDER	
SALESMAN	B. KOMARCECHKA
TERMS	PAYABLE ON RECEIPT
F.O.B.	OF BILLING

SOLD TO ROSEVAL SILICA INC
~~SUPERVISE ROSEVAL SILICA INC~~
 SHIP TO STRIPPING OF SITE #3
 ADDRESS _____ VIA _____

INVOICE

JUNE	4 1/2 DAYS @ \$200.00 / DAY FOR	900	00	60	OK	77-11
26-30	GEOLOGIC SUPERVISION; CONSULTING					
JUNE 26-27	RAMADA ACCOMODATION; MEALS	137	46		X	
JUNE 28-30	OPISHING TAVERN ROOM; BOARD	10.3	68		X	
JUNE 30	MEAL ON ROAD	4	65		X	
JUNE 26	FORMS FOR DATA IN TRIPLICATE	8	79		✓	
	MILEAGE 1177km @ 25¢/km	294	25		X	
	PROMOTIONAL GIFT FOR CARSTAKER	22	85		X	
	JULES OF EXTENDER MINERALS					
	TOTAL			1471	68	

Payment received 133

BLUELINE D 31

PAYMENT RECEIVED - *Robert S. Komarcechka*

BEDROCK CONSULTING

SUITE #1, 396 EVA AVE.
SUDBURY, ONT. P3C 4N3

OUR NUMBER	000472
DATE	JULY 7 1989
CUSTOMER'S ORDER	
SALESMAN	B. KOMARCECHKA
TERMS	Payable on receipt
F.O.B.	of billing

SOLD TO ROSEVAL SILICA INC
PREPARATION OF 6 REPORTS ON PENHORWOOD RESERVES
 SHIP TO 1/2 INFORMATION REQUESTED BY GAETAN LAVALLEE
 ADDRESS _____ VIA _____

INVOICE

JULY 7	10 hours @ \$20.00 / hr	200.	00	13.3	DA ✓	77-11
	PARKING METER	2.	25		X	
	MILEAGE 40km @ .25 / km	10.	00		X	
	BLUEPRINTS	14.	00		✓	
	PHOTO COPYING - 306 pgs @ .20 / pg	61	20		✓	
	6 REPORT FORMS 1.00 each	6	00		✓	
	TOTAL			293	45	

Payment Received Robert S. Komarcechka

Payment received 133

BLUELINE D 31

BEDROCK CONSULTING

SUITE #1, 396 EVA AVE.
SUDBURY, ONT. P3C 4N3

OUR NL	R	000473
DATE	JULY 10 1989	
CUSTOMER'S ORDER		
SALESMAN	B. KONARECHKA	
TERMS	PAYABLE ON	
F.O.B.	RECEIPT OF BILLING	

SOLD TO ROSEVAL SILICA INC
PREPARATION OF ADDENDUM TO PENHOLDWOOD RESERVE
SHIP TO AND PREPARATION & SHIPPING OF 14 COPIES.
ADDRESS _____ VIA _____

INVOICE

JULY 9	5 HRS @ \$20.00/HR	GEOL. CONSULTING	100	00	6.7	✓	77-19
JULY 10	"	"	100	00	6.7	✓	77-19
28	BLUE PRINTS @ 1.20 ea		35	84		✓	
2	PHOTO ^{CO} PRINTS ON VELUM @ 18.00 ea		18	00		✓	
	14 REPORT FORMS @ \$1.00 ea		14	00		✓	
	PHOTOCOPYING 70 COPIES @ 20¢ ea.		14	00		✓	
	MILEAGE 23 km @ .25¢/km.		5	75			
	TOTAL						287 59

*Payment received
Amount due 7/21/89*

BLANKLINE D 31

*Payment Received
Robert J. Konarechka*



Ontario,

Ministry of
Northern Development
and Mines

Ministère du
Développement du Nord
et des Mines

Roseval Silica Inc.
150 de Brullon
Boucherville, Quebec
J4B 2J2

REFERENCE

AREAS WITHDRAWN FROM DISPOSITION

M.R.O. - MINING RIGHTS ONLY	S.R.O. - SURFACE RIGHTS ONLY	M.+S. - MINING AND SURFACE RIGHTS		
Description	Order No.	Date	Disposition	File
400' RESERVE			S.R.O.	03537
SEC. 43/70	W. 31/72	27/12/72	S.R.O.	63006 V2
SEC. 36/80		1/7/78	S.R.O.	03537
ORDER OF THE MINISTER #33/87 DATED MARCH 30/87 WITHDRAWS MINING AND SURFACE RIGHTS UNDER SECTION 36 OF THE MINING ACT RSD 1980				

SAND AND GRAVEL

GRAVEL	FILE 38729
GRAVEL PIT	FILE 03555 V.6
GRAVEL	FILE 106274
QUARRY PERMIT #22805 ISSUED FOR THE REMOVAL OF THE QUARTZ JULY 1, 1987.	
QUARRY PERMIT # 22808 ISSUED FOR THE REMOVAL OF QUARTZ SEPT. 10, 1987	
CANCELLED PATENT AND LEASED CLAIMS	

REEVES TWP.

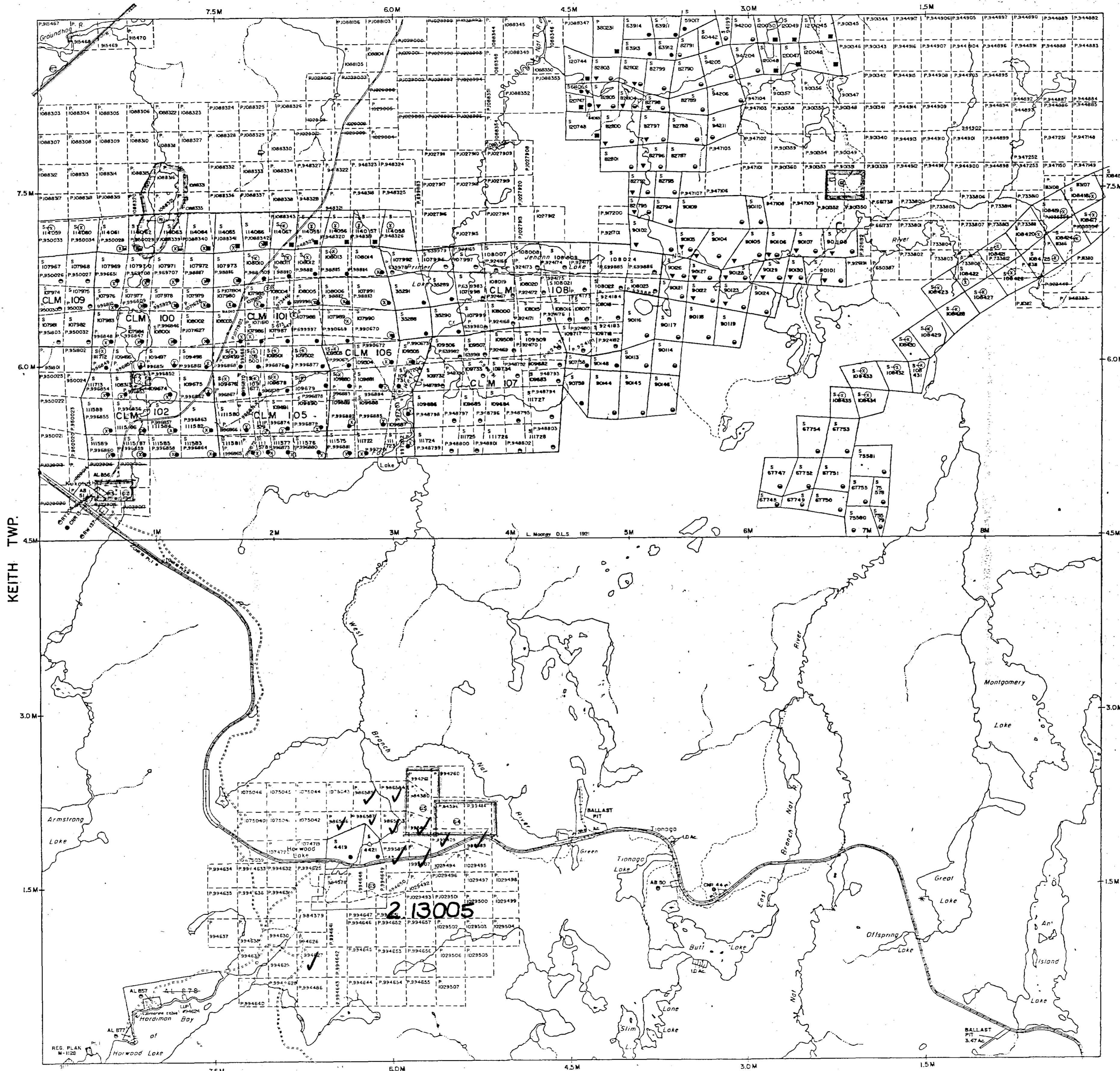

LEGEND

- HIGHWAY AND ROUTE No.
- OTHER ROADS
- TRAILS
- SURVEYED LINES:
 - TOWNSHIPS, BASE LINES, ETC.
 - LOTS, MINING CLAIMS, PARCELS, ETC.
- UNSURVEYED LINES:
 - LOT LINES
 - PARCEL BOUNDARY
 - MINING CLAIMS ETC.
- RAILWAY AND RIGHT OF WAY
- UTILITY LINES
- NON-PERENNIAL STREAM
- FLOODING OR FLOODING RIGHTS
- SUBDIVISION OR COMPOSITE PLAN RESERVATIONS
- ORIGINAL SHORELINE
- MARSH OR MUSKEG
- MINES
- TRAVERSE MONUMENT

DISPOSITION OF CROWN LANDS

TYPE OF DOCUMENT	SYMBOL
PATENT, SURFACE & MINING RIGHTS	●
" SURFACE RIGHTS ONLY	○
" MINING RIGHTS ONLY	◐
LEASE, SURFACE & MINING RIGHTS	◑
" SURFACE RIGHTS ONLY	◒
" MINING RIGHTS ONLY	◓
LICENCE OF OCCUPATION	◔
ORDER-IN-COUNCIL	OC
RESERVATION	⊙
CANCELLED	⊘
SAND & GRAVEL	⊛
LAND USE PERMIT	⊜

NOTE: MINING RIGHTS IN PARCELS PATENTED PRIOR TO MAY 6, 1913, VESTED IN ORIGINAL PATENTEE BY THE PUBLIC LANDS ACT, R.S.O. 1970, CHAP. 390, SEC. 63, SUBSEC. 1.

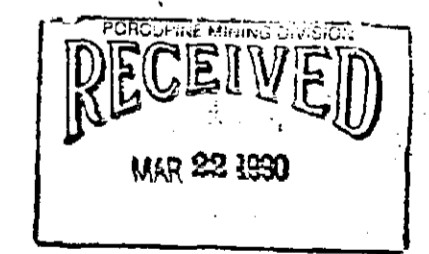
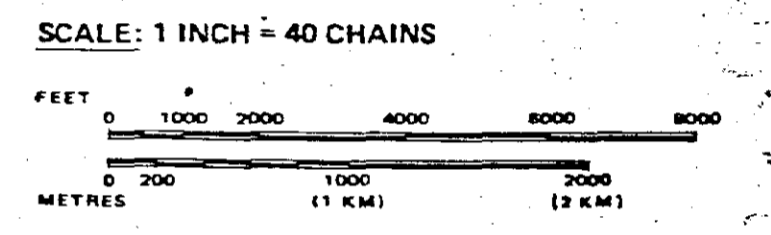

ACTIVATED JANUARY 30, 1990.

TOWNSHIP
PENHORWOOD

M.N.R. ADMINISTRATIVE DISTRICT
CHAPLEAU
MINING DIVISION
PORCUPINE
LAND TITLES / REGISTRY DIVISION
SUDBURY

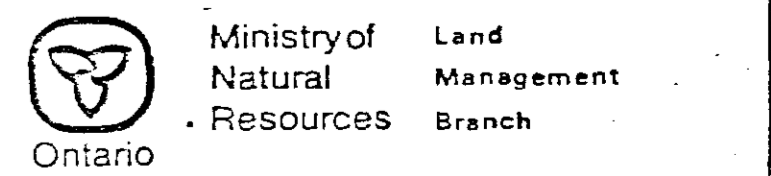

Date: MARCH 1995

Number: **G-3244**

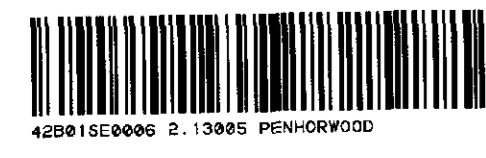

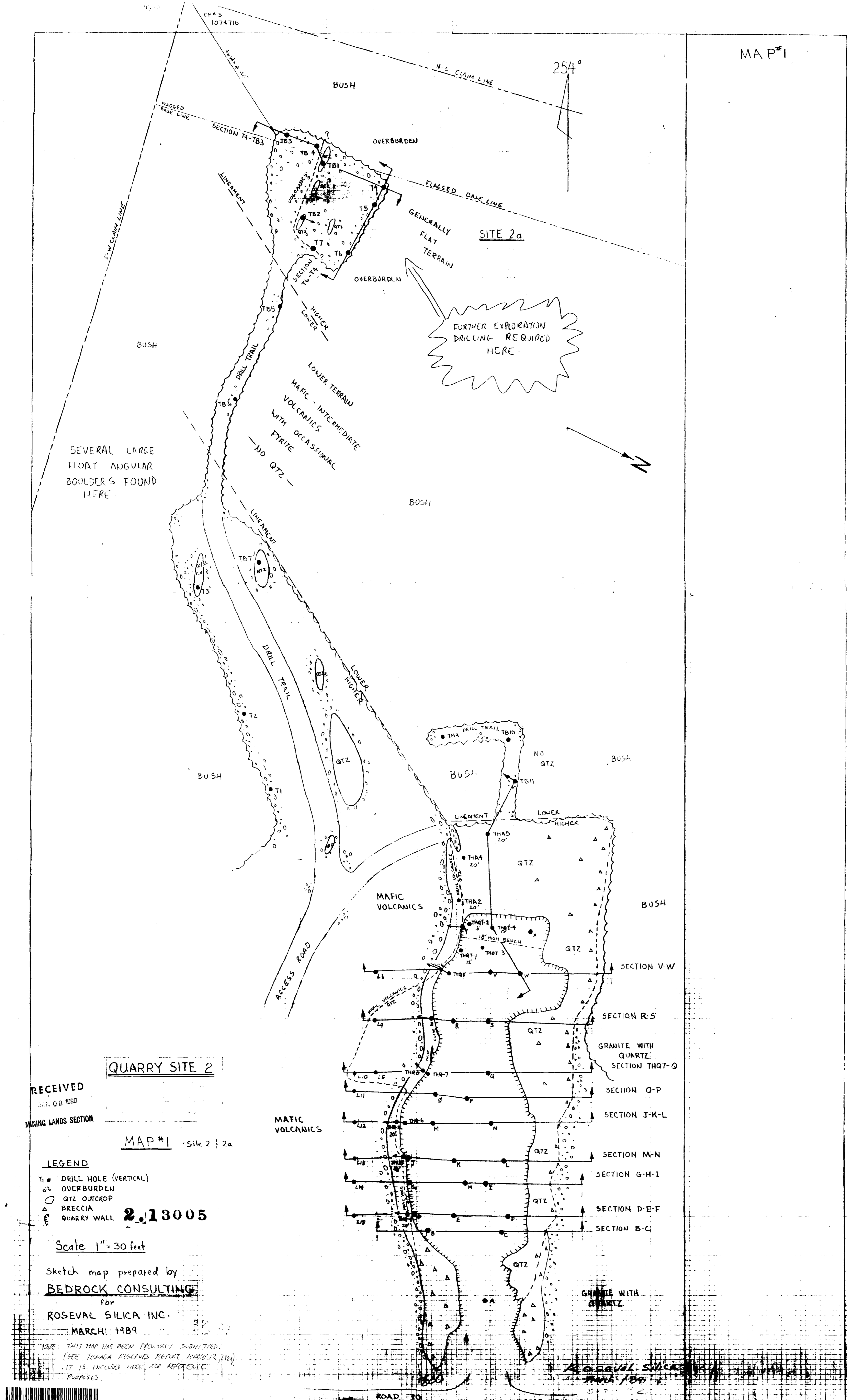

QUARRY SITE 2

RECEIVED
MAR 08 1989
MINING LANDS SECTION

MAP #1 - Site 2 ; 2a

LEGEND

- Ti • DRILL HOLE (VERTICAL)
- o OVERBURDEN
- QTZ OUTCROP
- △ BRECCIA
- QUARRY WALL

2,13005

Scale 1" = 30 feet

Sketch map prepared by
BEDROCK CONSULTING

for
ROSEVAL SILICA INC.

MARCH 1989

NOTE: THIS MAP HAS BEEN PREVIOUSLY SUBMITTED.
(SEE TUNAGA RESERVS REPORT, MARCH 12, 1984)
IT IS INCLUDED HERE FOR REFERENCE
PURPOSES.

Roseval Silica Inc.
MARCH 1989



SITE #3



AREA OF STRIPPED QUARTZ
OUTCROP OF QUARTZ

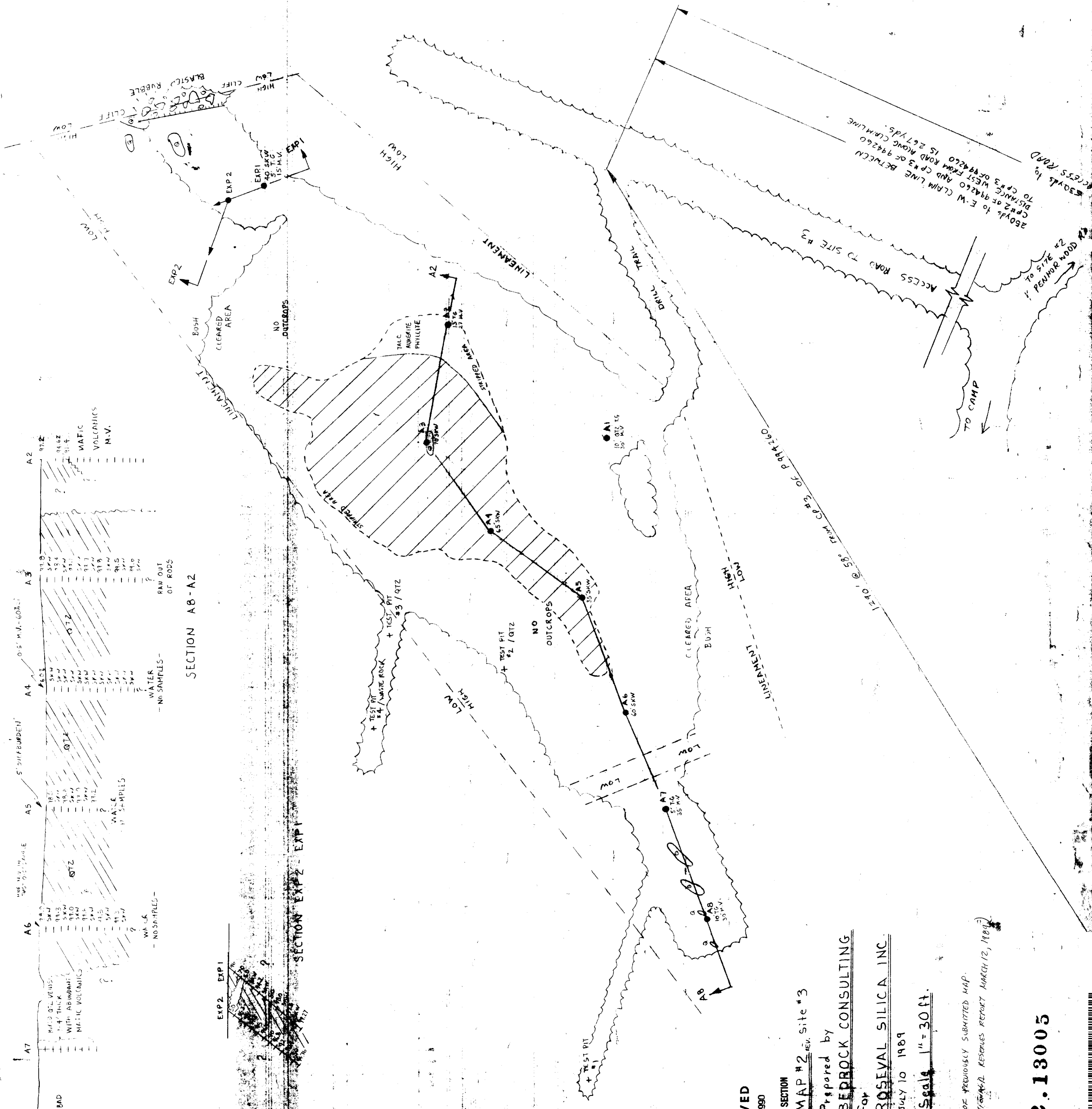

SECTION A8-A2

STATION	DESCRIPTION	DEPTH	REMARKS
A7	WATER	10.0	NO SAMPLES
A6	WATER	10.0	NO SAMPLES
A5	WATER	10.0	NO SAMPLES
A4	WATER	10.0	NO SAMPLES
A3	WATER	10.0	NO SAMPLES
A2	WATER	10.0	NO SAMPLES

RECEIVED
JAN 08 1990

MINING LANDS SECTION

MAP #2 REV. SITE #3

Prepared by
BERBROCK CONSULTING

for
ROSEVAL SILICA INC.

JULY 10 1989

Scale 1" = 30 ft.

NOTE: REGION OF PREVIOUSLY SUBMITTED MAP
(SEE THOMPSON RESOURCES REPORT MARCH 12, 1989)

ROSEVAL SILICA
MAP #2
MARCH 1989
1" = 30'

2.13005

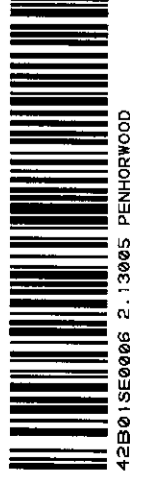

250