



42B01SW8531 12 HORWOOD

010

# Diamond Drilling

Township of Horwood

Report NO: 12

Work performed by: J. E. <sup>L</sup>efever

Claim NO	Hole NO	Footage	Date	Note	
S 48436	1	90'	Mar/48		
	2	70'	Mar/48		
	3	80'	Apr/48		
S 42142	1	80'	Mar/48		
	2	70'	Mar/48		
S 48438	1	80'	Apr/48		
	2	78'	Feb/49		
	3	85'	Mar/49		
	4	80'	Mar/49		
S 43233	1	80'	May/48		
S 39086	1	80'	May/48		
	2	80'	May/48		
	3	80'	May/48		
S 48437	1	80'	Feb/49		
	2	80'	Feb/49		
	3	80'	Feb/49		
	1	85'	Mar/50		
	2	75'	Mar/50		
	3	80'	Mar/50		
	S 42143	1	70'	Apr/49	
		2	80'	Apr/49	
		3	75'	Apr/49	
4		85'	Apr/49		
5		90'	Apr/49		

Notes:

### Diamond Drilling

Township of Horwood

Report NO: 12

Work performed by: J. E. Fefever

Claim NO	Hole NO	Footage	Date	Note
S 42143 (cont'd)	5	70'	Dec/49	
	6	85'	Dec/49	
	7	25'	Jan/50	
	8	75'	Feb/50	
	9	10'	Feb/50	
	10	10'	Feb/50	
S 42145	1	75'	Aug/47	
	2	75'	Aug/47	
	3	110'	Aug/47	
	4	100'	Aug/47	
	1	78'	Dec/49	
	2	71'	Dec/49	
	3	71'	Dec/49	
	4	60'	Dec/49	
S 42144	1	80'	May/49	
	11	80'	Dec/49	
S 48213	1	80'	Mar/50	
	2	81'	Mar/50	
	3	40'	Mar/50	
S 100108 (rest. 42143)	1	82'	Apr/57	
	2	81'	Apr/57	
	1	101'	Sept/59	
	2	102'	Sept/59	
S 100107 (rest. 42145)	B2	103'	Dec/58	

Notes:

PROPERTY

Lefors Property, Howard Camp

HOLE NUMBER

T

SHEET NUMBER

SECTION FROM

0

TO 1

## DIAMOND DRILL RECORD

LOCATION: LAT.

St. Lawrence

ELEVATION OF COLLAR

DEP. 45436

DATUM

DIRECTION AT START:

BEARING South 10° East

DIP 45°

STARTED

March 10, 1948

COMPLETED

" 18, 1948

ULTIMATE DEPTH

90'

PROPOSED DEPTH

75'

DEPTH FEET	FORMATION	SAMPLE No.	WIDTH OF SAMPLE	GOLD \$	SLUDGE GOLD \$
0 - 10	bedges				
10 - 40	lt. green limestone, some quartz, blebs, some mineral				
40' - 75'	Quartzite blends into Dishouse course				
75' - 90'	Dishouse Mass				
	3/4" core				

NORTHERN MINER PRESS LIMITED, TORONTO—STOCK FORM NO. 501 REV. 9/44

DRILLED BY

E. J. Lefors

SIGNED

John E. Lefors



PROPERTY .....

HOLE NUMBER 3

# DIAMOND DRILL RECORD

SHEET NUMBER .....

SECTION FROM 0 TO 80

LOCATION: LAT. S. E. Canada

STARTED April 8, 1948

DEP. 118136

COMPLETED " 10, 1948

ELEVATION OF COLLAR .....

DATUM .....

ULTIMATE DEPTH .....

DIRECTION AT START: BEARING South 15° East  
DIP 30°

PROPOSED DEPTH .....

DEPTH FEET	FORMATION	SAMPLE No.	WIDTH OF SAMPLE	GOLD \$	SLUDGE GOLD \$
0 - 25	Mass. Sioite				
25 - 50	Sioite some quartz shattering mineralized Chloro Sioite				
50 - 80	Sioite - Quartz - Blasts				
	3/4" core				

DRILLED BY J. E. Rogers

SIGNED John C. Lyver

PROPERTY

Life and Property Development

HOLE NUMBER

1

SHEET NUMBER

## DIAMOND DRILL RECORD

SECTION FROM

0 TO 80

LOCATION:

LAT.

N. E. Corner

DEP.

Claim # 5-1-2-142

ELEVATION OF COLLAR

DATUM

DIRECTION AT START:

BEARING

South

DIP

1/2°

STARTED

March 12, 1948

COMPLETED

" 14, 1948

ULTIMATE DEPTH

80'

PROPOSED DEPTH

80'

DEPTH FEET	FORMATION	SAMPLE No.	WIDTH OF SAMPLE	GOLD \$	SLUDGE GOLD \$
0-75'	Greenstone				
75'-50	Greenstone - andesite sheared - some min. some quartz				
50'-80	3' pow. greenstone well sheared not much quartz min				
	3/4" Core -				

NORTHERN MINER PRESS LIMITED, TORONTO—STOCK FORM No. 501 REV. 9/44

DRILLED BY

J. E. Lefevre

SIGNED

John E. Lefevre

PROPERTY .....

HOLE NUMBER 2

# DIAMOND DRILL RECORD

SHEET NUMBER .....

SECTION FROM 0 TO 8

LOCATION: LAT. S.E. Corner  
 DEP. Cl. 24 x 42  
 ELEVATION OF COLLAR .....

DATUM .....

DIRECTION AT START: BEARING South 15° East  
 DIP 15°

STARTED March 14, 1948  
 COMPLETED " 16, 1948  
 ULTIMATE DEPTH 70'  
 PROPOSED DEPTH 70'

DEPTH FEET	FORMATION	SAMPLE NO.	WIDTH OF SAMPLE	GOLD \$	SLUDGE GOLD \$
<u>0 - 25'</u>	<u>Greenstone H. Colored porph.</u>				
<u>25 - 50'</u>	<u>Greenstone andesite Badly sheared no thin.</u>				
<u>50' - 70'</u>	<u>Andesite - Greenstone Altered - no gsf</u>				
	<u>3/4" Core</u>				

DRILLED BY [Signature]

SIGNED John E. Lefran







HORWOOD  
LAKE

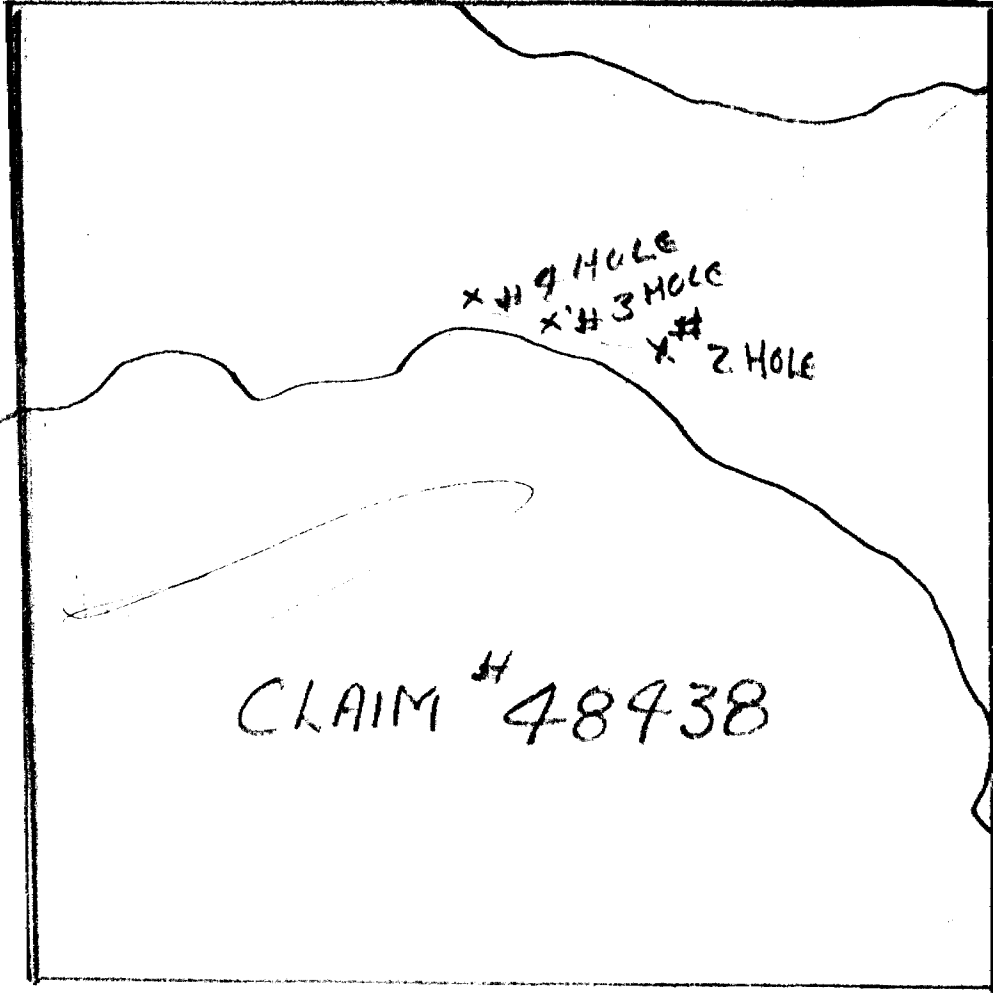

LOCATION OF DIAMOND DRILL  
HOLES - DATES OF DRILLING  
FEB. 26<sup>TH</sup> 1949 TO  
- MARCH. 17<sup>TH</sup> 1949

PROPERTY .....

HOLE NUMBER 2

# DIAMOND DRILL RECORD

SHEET NUMBER .....

SECTION FROM 0 TO 78

LOCATION: LAT. N. W. Corner  
 DEP. Claim #S-48438  
 ELEVATION OF COLLAR .....

DATUM .....

DIRECTION AT START: BEARING South  
 DIP 45 deg.

STARTED Feb. 26, 1949  
 COMPLETED Mar. 1, 1949  
 ULTIMATE DEPTH 78 ft.  
 PROPOSED DEPTH 80 "

DEPTH FEET	FORMATION	SAMPLE No.	WIDTH OF SAMPLE	GOLD \$	SLUDGE GOLD \$
0 - 11	Ledge				
11 - 31	Andesite lt. color				
31 - 60	Andesite				
60 - 78	Andesite, some shearing - no qtz.				
	13/16 core				

DRILLED BY J. E. Lefever

SIGNED .....

PROPERTY .....

HOLE NUMBER 3

# DIAMOND DRILL RECORD

SHEET NUMBER .....

SECTION FROM 0 TO 58

LOCATION: LAT. N. W. Corenr  
 DEP. Claim #S-48438

STARTED Mar. 2, 1949

ELEVATION OF COLLAR .....

COMPLETED " 13, "

DATUM .....

ULTIMATE DEPTH 85 ft.

DIRECTION AT START: BEARING South  
 DIP 45 degrees

PROPOSED DEPTH 90 "

DEPTH FEET	FORMATION	SAMPLE NO.	WIDTH OF SAMPLE	GOLD \$	SLUDGE GOLD \$
0 - 18	Ledge				
18 - 40	Andesite Lt. color				
40 - 60	Andesite				
60 - 65	Andesite diorite slightly sheared				
65 - 85	Diorite with qtz stringers, slightly min.				
	#3 hole 50 ft. west of hole #2				
	13/16 core				

DRILLED BY J. E. Lefever

SIGNED .....

PROPERTY .....

HOLE NUMBER 4.....

## DIAMOND DRILL RECORD

SHEET NUMBER .....

SECTION FROM 0 TO 80.....LOCATION: LAT. N. W. Cochr  
DEP. Claim #S-48438.....STARTED Mar. 14, 1949.....

ELEVATION OF COLLAR .....

COMPLETED " 17 ".....

DATUM .....

ULTIMATE DEPTH 80 ft......DIRECTION AT START: BEARING South  
DIP 43 degrees.....PROPOSED DEPTH 80 ".....

DEPTH FEET	FORMATION	SAMPLE No.	WIDTH OF SAMPLE	GOLD \$	SLUDGE GOLD \$			
0 - 12	Ledge							
12 - 40	Andesite lt. color							
40 - 65	Andesite changing to medium dark diorite							
65 - 80	Diorite slightly sheared with qtz min.							
	#4 hole 50 ft. west of #3 hole							
	13/16 core							

NORTHERN MINER PRESS LIMITED, TORONTO-STOCK FORM NO. 801 REV. 9/44

DRILLED BY J. E. Lefever.....

SIGNED .....

PROPERTY

Lefever Property - Greenwood

HOLE NUMBER No. 1

SHEET NUMBER 1

SECTION FROM 0 TO 80

## DIAMOND DRILL RECORD

LOCATION: LAT. N. E. Corner  
DEP. Claim No. S.43233.

ELEVATION OF COLLAR Lakeshore

DATUM

DIRECTION AT START: BEARING South 10° East  
DIP 45'

STARTED May 3, 1948

COMPLETED May 4, 1948

ULTIMATE DEPTH 80'

PROPOSED DEPTH 80'

DEPTH FEET	FORMATION	SAMPLE No.	WIDTH OF SAMPLE	GOLD \$	SLUDGE GOLD \$
0 - 25	Greenstone				
25 - 60	Lt. greenstone, some shearing, some Mineral, no quartz.				
60 - 80	Andesite				
	3/4 core.				

NORTHERN MINER PRESS LIMITED, TORONTO—STOCK FORM No. 501 REV. 9/44

DRILLED BY J. E. Lefever

SIGNED J. E. Lefever.

PROPERTY *Lefever Property, Greenwood*

HOLE NUMBER 1

SHEET NUMBER 1

SECTION FROM 0 TO 80'

# DIAMOND DRILL RECORD

LOCATION: LAT. N. W. Corner  
DEP. Claim No. 39086  
ELEVATION OF COLLAR Lake shore  
DATUM \_\_\_\_\_  
DIRECTION AT START: BEARING South 10° East  
DIP 45°

STARTED May 5, 1948  
COMPLETED May 7, 1948  
ULTIMATE DEPTH 80'  
PROPOSED DEPTH 80'

DEPTH FEET	FORMATION	SAMPLE No.	WIDTH OF SAMPLE	GOLD \$	SLUDGE GOLD \$			
0 - 25	Greenstone							
25 - 50	Dark Colour Diorite							
50 - 80	Diorite							
	<u>3/4 core.</u>							

DRILLED BY J. E. Lefever

SIGNED J. E. Lefever.

PROPERTY

*James Property - Diamond Trap*

HOLE NUMBER ..... 2

SHEET NUMBER ..... 2

SECTION FROM ..... 0 ..... TO ..... 80

# DIAMOND DRILL RECORD

LOCATION: LAT. .... N.W. Corner .....  
 DEP. .... Claim No. S.39086 .....  
 ELEVATION OF COLLAR ..... Lake Shore .....  
 DATUM .....  
 DIRECTION AT START: BEARING ..... South 10° East .....  
 DIP ..... 45° .....

STARTED ..... May 8, 1948. ....  
 COMPLETED ..... May 9, 1948. ....  
 ULTIMATE DEPTH ..... 80' .....  
 PROPOSED DEPTH ..... 80' .....

DEPTH FEET	FORMATION	SAMPLE No.	WIDTH OF SAMPLE	GOLD \$	SLUDGE GOLD \$		
0 - 30	Diorite						
30 - 55	Greenstone well sheardd some Quartz - mineral						
55 - 80	Greenstone						
	3/4 core.						

DRILLED BY ..... J. E. Lefever .....

SIGNED ..... J. E. Lefever .....

PROPERTY 5-6180

HOLE NUMBER 3

SHEET NUMBER 3

SECTION FROM 0 TO 80

### DIAMOND DRILL RECORD

*HORWOOD Twp.*

LOCATION: LAT. N. W. Corner  
 DEP. Claim S. 39086  
 ELEVATION OF COLLAR Lakeshore  
 DATUM \_\_\_\_\_  
 DIRECTION AT START: BEARING South 10° East  
 DIP 45°

STARTED May 10, 1948  
 COMPLETED May 11, 1948  
 ULTIMATE DEPTH 80'  
 PROPOSED DEPTH 80'

DEPTH FEET	FORMATION	SAMPLE No.	WIDTH OF SAMPLE	GOLD \$	SLUDGE GOLD \$
0 - 20	Greenstone				
20 - 35	Por. Lt. Colour Some minerals.				
35 - 50	Dark Grey Andesite				
50 - 80	Greenstone				

NORTHERN MINER PRESS LIMITED, TORONTO-STOCK FORM No. 501 REV. 9/44

DRILLED BY J. E. Lefever

SIGNED J. E. Lefever.



HORWOOD LAKE



CLAIM # 48437

LOCATION OF DIAMOND  
DRILL HOLES  
DATES OF DRILLING  
FEB. 19<sup>TH</sup> 1999 TO  
FEB. 29<sup>TH</sup> 1999

X# 3 HOLE

X# 2 HOLE

# 1 HOLE

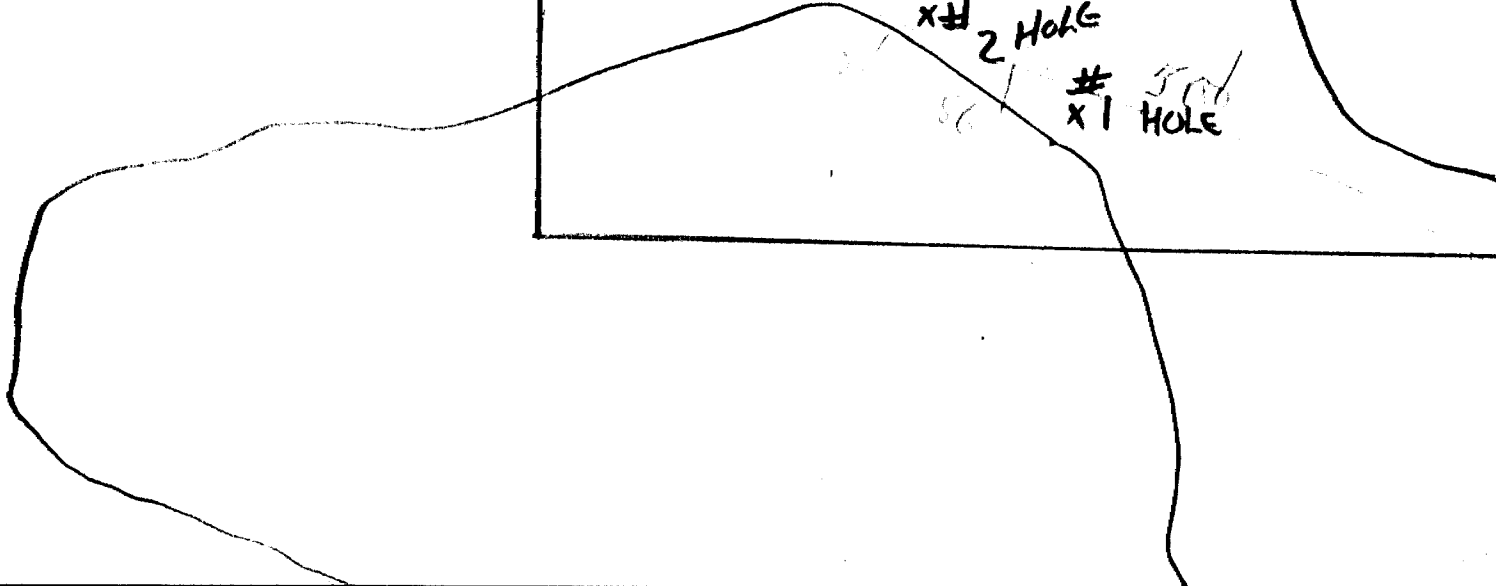

PROPERTY .....

HOLE NUMBER #1 .....

# DIAMOND DRILL RECORD

SHEET NUMBER .....

SECTION FROM 0 TO 80 .....

LOCATION: LAT. S. W. Corner  
DEP. Claim #S-48137  
ELEVATION OF COLLAR  
DATUM  
DIRECTION AT START: BEARING South 10 deg. west  
DIP 45 degrees

STARTED Feb. 14, 1949  
COMPLETED Feb. 16, "  
ULTIMATE DEPTH 80 ft.  
PROPOSED DEPTH 80 "

DEPTH FEET	FORMATION	SAMPLE NO.	WIDTH OF SAMPLE	GOLD \$	SLUDGE GOLD \$			
0 - 10	Ledge							
10 - 35	Lt. color diorite							
35 - 60	Diorite some shearing - qtz stringers some min.							
60 - 68	Cut diabase dike							
68 - 80	Diorite - andesite							
	13/16 core							

NORTHERN MINER PRESS LIMITED, TORONTO-STOCK FORM No. 801 REV. 9/44

DRILLED BY J. E. Lefever .....

SIGNED .....

HORWOOD LAKE

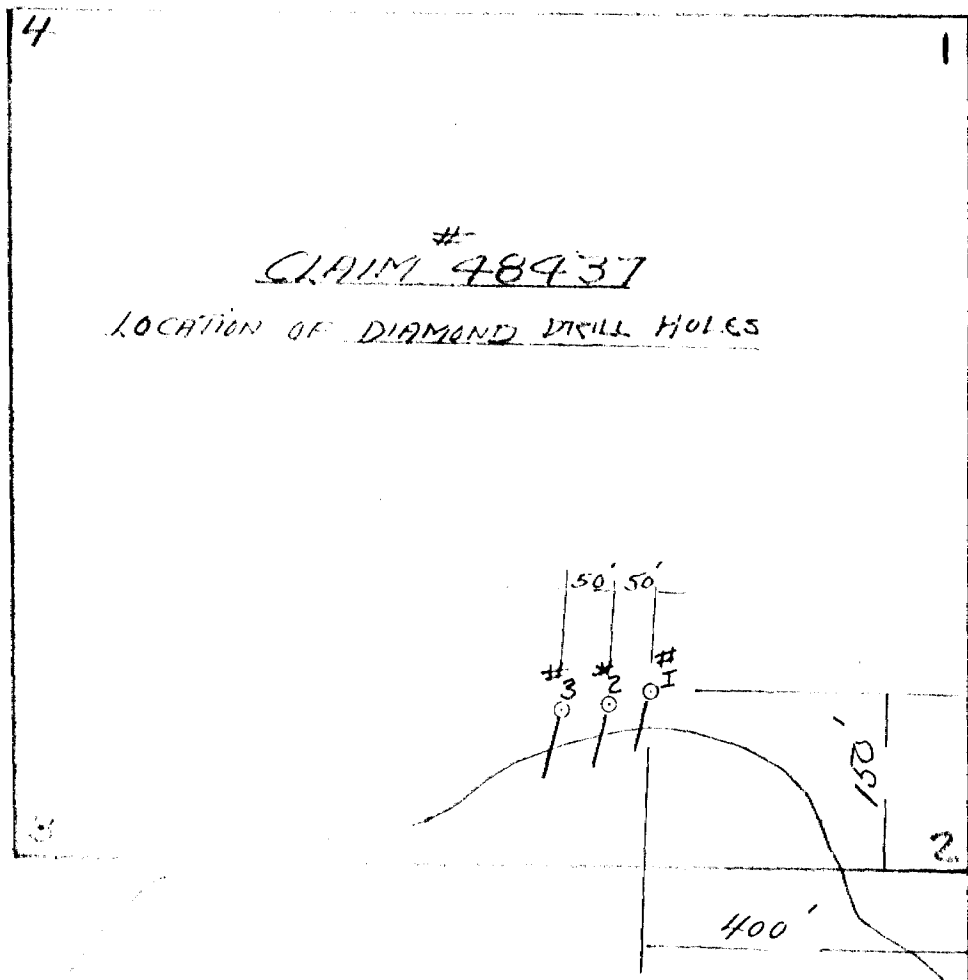

#  
CLAIM 48937

LOCATION OF DIAMOND DRILL HOLES

50' 50'  
#3 #2 #1

100'

400'

2

PROPERTY .....

HOLE NUMBER #2 .....

# DIAMOND DRILL RECORD

SHEET NUMBER .....

SECTION FROM 0 TO 80 .....

LOCATION: LAT. S. W. Corner  
 DEP. Claim #S-48437  
 ELEVATION OF COLLAR .....  
 DATUM .....  
 DIRECTION AT START: BEARING South 10 deg. west  
 DIP 45 deg. ....

STARTED Feb. 17, 1949  
 COMPLETED " 19, 1949  
 ULTIMATE DEPTH 80 ft.  
 PROPOSED DEPTH 80 ft.

DEPTH FEET	FORMATION	SAMPLE No.	WIDTH OF SAMPLE	GOLD \$	SLUDGE GOLD \$
0 - 9	Ledge				
9 - 30	Lt. green color diorite				
30 - 60	Diorite slightly sheared				
60 - 80	Sheared diorite some qtz. stringers no min.				
	#2 hole 50 ft. west of hole #1				
	13/16 core				

DRILLED BY J. E. Lefever .....

SIGNED .....

PROPERTY .....

HOLE NUMBER 3.....

# DIAMOND DRILL RECORD

SHEET NUMBER .....

SECTION FROM 0 TO 80.....

LOCATION: LAT. S. W. Corner  
 DEP. Claim #S-48437

STARTED Feb. 21, 1949.....

ELEVATION OF COLLAR .....

COMPLETED Feb. 24, 1949.....

DATUM .....

ULTIMATE DEPTH 80 ft......

DIRECTION AT START: BEARING South 10 deg. west  
 DIP 45 degrees.

PROPOSED DEPTH 80 ".....

DEPTH FEET	FORMATION	SAMPLE No.	WIDTH OF SAMPLE	GOLD \$	SLUDGE GOLD \$		
0 - 12	Ledge						
12 - 36	lt. green diorite , change to dark color						
36 - 65	Dark color diorite, some shearing , not much qtz.						
70 - 74	Mass. qtz . - some chalco pyrite						
74 - 80	Sheared diorite qtz stringers						
	#3 hole 50 ft. west of #2 hole						
	13/16 core						

NORTHERN MINER PRESS LIMITED, TORONTO-STOCK FORM NO. 501 REV. 9/44

DRILLED BY J. E. Lefeyer.....

SIGNED .....

PROPERTY .....

HOLE NUMBER I

SHEET NUMBER .....

# DIAMOND DRILL RECORD

SECTION FROM 0 TO 85

LOCATION: LAT. S. E. CORNER  
 DEP. CHAIN # 5-48+37

STARTED MARCH 1, 1950

ELEVATION OF COLLAR .....

COMPLETED " 4, 1950

DATUM .....

ULTIMATE DEPTH 85'

DIRECTION AT START: BEARING SOUTH 10° WEST  
 DIP 50°

PROPOSED DEPTH 75'

DEPTH FEET	FORMATION	SAMPLE NO.	WIDTH OF SAMPLE	GOLD \$	SLUDGE GOLD \$
0 - 8	LEDGE				
8 - 33	LIT. COLORED DIORITE				
33 - 40	DIORITE - FINE				
40 - 46	SHEAR - SOME QTZ. - S.M.				
46 - 50	DIORITE - ANDESITE				
50 - 62	DIORITE				
62 - 70	DIABASE DYKE				
70 - 85	DIORITE				
13/16 CORE					

DRILLED BY J. E. LEFEVER

SIGNED .....

PROPERTY .....

HOLE NUMBER I

SHEET NUMBER .....

## DIAMOND DRILL RECORD

SECTION FROM 0 TO 75LOCATION: LAT. S.E. CORNER  
DEP. CLAIM # 5-48437STARTED MARCH 6, 1950

ELEVATION OF COLLAR .....

COMPLETED " 10, 1950

DATUM .....

ULTIMATE DEPTH 75'DIRECTION AT START: BEARING SOUTH 10° WEST  
DIP 60°PROPOSED DEPTH 80'

DEPTH FEET	FORMATION	SAMPLE NO.	WIDTH OF SAMPLE	GOLD \$	SLUDGE GOLD \$		
0 - 7	LEDGE						
7 - 32	LT. COLOR DIORITE						
32 - 36	SHEARING QTZ STRINGERS N.M.						
36 - 50	DIORITE SLIGHTLY SHEAR QTZ. THOBS N.M.						
50 - 60	DIORITE - SHEAR QTZ. STRINGERS CARB. S.M.						
60 - 75	DIORITE - ANDESITE						
	13/16 CORE						

NORTHERN MINER PRESS LIMITED, TORONTO—STOCK FORM NO. 501 REV. 9/44

DRILLED BY J. E. LEFEVER

SIGNED .....

Map No. 4000

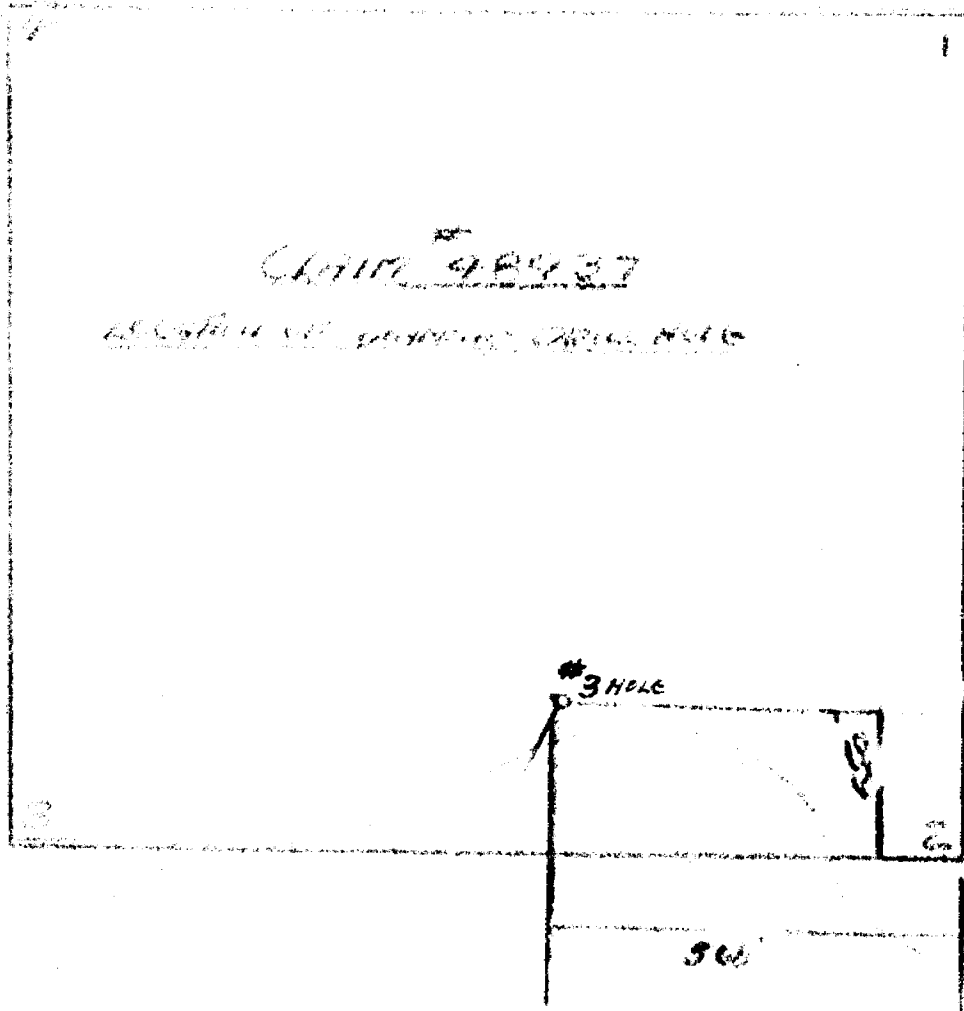



PROPERTY .....

HOLE NUMBER III

SHEET NUMBER .....

# DIAMOND DRILL RECORD

SECTION FROM 0 TO 80'

LOCATION: LAT. S.E. CORNER  
 DEP. CHAIN H 5-48437  
 ELEVATION OF COLLAR .....

STARTED MARCH 23, 1950  
 COMPLETED " 29, 1950  
 ULTIMATE DEPTH 80'  
 PROPOSED DEPTH 80'

DATUM .....

DIRECTION AT START: BEARING SOUTH 10° WEST  
 DIP 35°

DEPTH FEET	FORMATION	SAMPLE No.	WIDTH OF SAMPLE	GOLD \$	SLUDGE GOLD \$
0-9	LEDGE				
9-30	DIORITE MED. LT. COLOR				
30-40	MED DIORITE FINE GR ANDESITE				
40-55	DIORITE - QTZ STRINGERS IN SHEARING N.M.				
55-70	DIORITE - ANDESITE				
70-80	DIAPYASE DYKE				
1 3/16 CORE					

DRILLED BY J. E. LEFFNER

SIGNED .....

HORWOOD LAKE

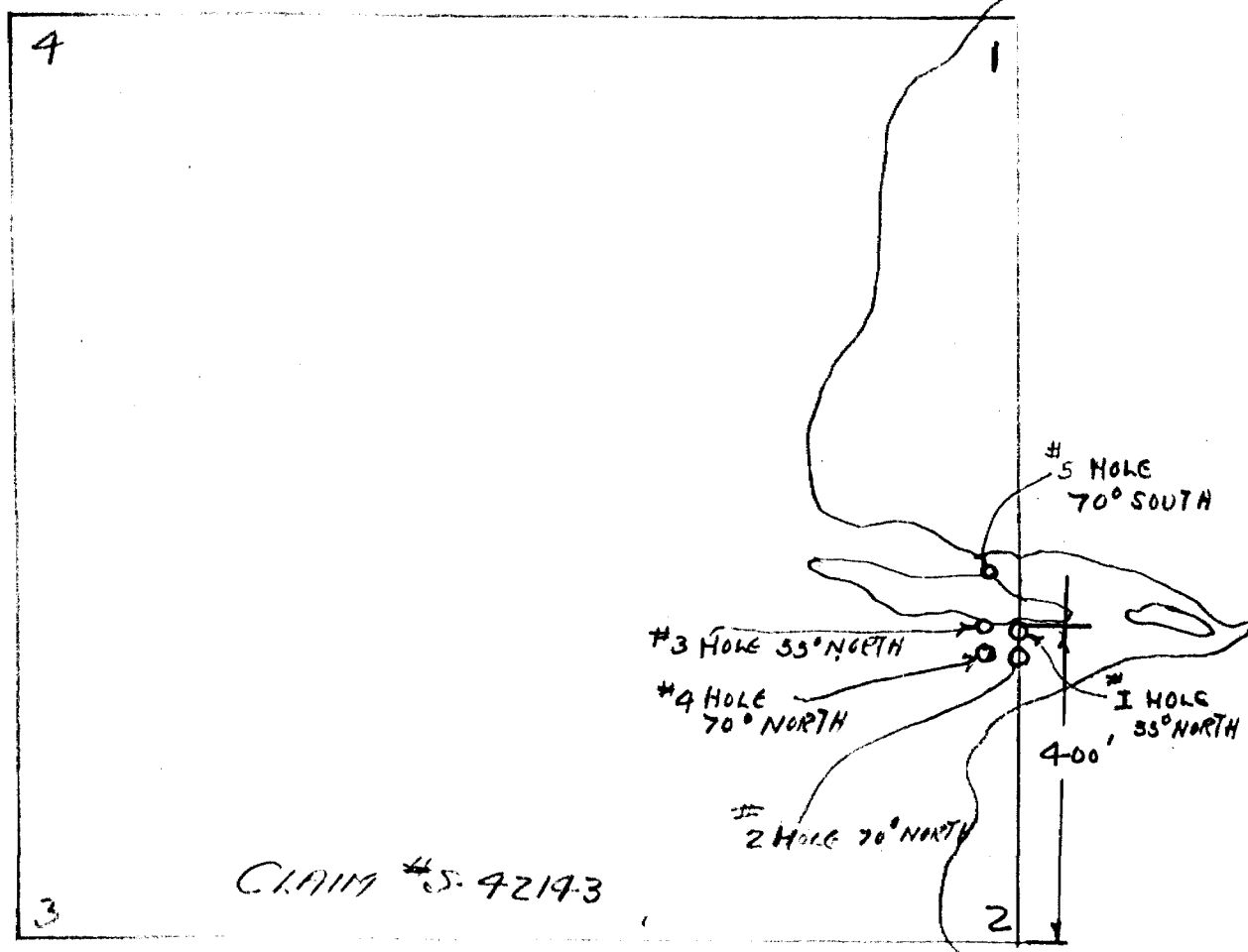

CLAIM #5-9219-3

LOCATION OF DIAMOND DRILL  
HOLES

PROPERTY .....

HOLE NUMBER 1

SHEET NUMBER .....

# DIAMOND DRILL RECORD

SECTION FROM 0 TO 70

LOCATION: LAT. N.E. Corner  
 DEP. Claim #S-42143

STARTED April 7, 1949

ELEVATION OF COLLAR .....

COMPLETED "8"

DATUM .....

ULTIMATE DEPTH 70 deg.

DIRECTION AT START: BEARING North  
 DIP 55 deg.

PROPOSED DEPTH 75 "

DEPTH FEET	FORMATION	SAMPLE No.	WIDTH OF SAMPLE	GOLD \$	SLUDGE GOLD \$
0 - 25	Greenstone				
25 - 50	Qtz. Porph.				
50 - 70	Sheared greenstone, some qtz stringers				
	13/16 core				
	Hole spotted 400 ft. north of				
	#2 post				

DRILLED BY J.C. Lerner

SIGNED .....

PROPERTY .....

# DIAMOND DRILL RECORD

HOLE NUMBER 2

SHEET NUMBER .....

SECTION FROM 0 TO 80

LOCATION: LAT. N. E. Corener  
DEP. Claim #S-42143

STARTED April 9, 1949

ELEVATION OF COLLAR .....

COMPLETED " 10 "

DATUM .....

ULTIMATE DEPTH 80 feet

DIRECTION AT START: BEARING North

PROPOSED DEPTH 100 "

DIP 70 deg.

DEPTH FEET	FORMATION	SAMPLE No.	WIDTH OF SAMPLE	GOLD \$	SLUDGE GOLD \$				
0 - 35	Greenstone								
35 - 60	Qtz. Porph. with qtz. stringers some mineral								
60 - 80	Sheared greenstone, qtz stringers								
	13/16 core								
	Hole spotted as for #1								

DRILLED BY J.E. Corener

SIGNED .....

PROPERTY .....

HOLE NUMBER 3 .....

SHEET NUMBER .....

SECTION FROM 0 to 75 .....

# DIAMOND DRILL RECORD

LOCATION: LAT. N. E. Corner  
 DEP. Claim #S-42143  
 ELEVATION OF COLLAR .....

DATUM .....

DIRECTION AT START: BEARING North  
 DIP 55 deg.

STARTED April 11, 1949  
 COMPLETED " 12, " "  
 ULTIMATE DEPTH 75 ft.  
 PROPOSED DEPTH 80 "

DEPTH FEET	FORMATION	SAMPLE No.	WIDTH OF SAMPLE	GOLD \$	SLUDGE GOLD \$		
0 - 10	Ledge						
10 - 35	Greenstone						
35 - 60	Qtz. Porph.						
60 - 75	Qtz Porph. 65 ft. 70 ft. sheared with qtz stringers						
	13/16 core						
	Hole spotted 50 ft. N. W. of #1-2holes						

DRILLED BY *W. R. Jensen*

SIGNED .....

PROPERTY .....

HOLE NUMBER 4

SHEET NUMBER .....

# DIAMOND DRILL RECORD

SECTION FROM 0 TO 85ft.

LOCATION: LAT. N. E. Corener  
 DEP. Claim #S-42143

STARTED .....

ELEVATION OF COLLAR .....

COMPLETED .....

DATUM .....

ULTIMATE DEPTH .....

DIRECTION AT START: BEARING North  
 DIP 70 deg.

PROPOSED DEPTH .....

DEPTH FEET	FORMATION	SAMPLE NO.	WIDTH OF SAMPLE	GOLD \$	SLUDGE GOLD \$		
0 - 15	Ledge						
15 - 45	Greenstone						
45 - 65	Qtz Porph.						
65 - 85	Qtz. porph. with sheared section from 70 to 80 ft. qtz stringers with min.						
	13/16 core Hole spotted same location as #3 hole						

NORTHERN MINER PRESS LIMITED, TORONTO-STOCK FORM NO. 501 REV. 9/44  
 DRILLED BY H. E. Corener

SIGNED .....

PROPERTY .....

HOLE NUMBER ..... 5 .....

SHEET NUMBER .....

# DIAMOND DRILL RECORD

SECTION FROM ..... 0 ..... TO 90 ft.

LOCATION: LAT. .... N. E. Corner .....  
 DEP. .... Claim #S-42143 .....

STARTED ..... April 16, 1949 .....

ELEVATION OF COLLAR .....

COMPLETED ..... " 18, " .....

DATUM .....

ULTIMATE DEPTH ..... 90 ft. ....

DIRECTION AT START: BEARING ..... South .....  
 DIP ..... 70 deg. ....

PROPOSED DEPTH ..... 100 ft. ....

DEPTH FEET	FORMATION	SAMPLE NO.	WIDTH OF SAMPLE	GOLD \$	SLUDGE GOLD \$			
0-35	Sheared greenstone with qtz porph.							
35 - 60	Qtz. porph. some shearing qtz. stringers							
60 - 75	Qtz. porph. qtz. blubs.							
75- 9-	Greenstone diorite							
	13/16 core							
	Hole spotted 50 ft. north of Hole #3							

NORTHERN MINER PRESS LIMITED, TORONTO-STOCK FORM NO. 801 REV. 9/44

DRILLED BY *He. S. S. S.*

SIGNED .....

HORWOOD LAKE

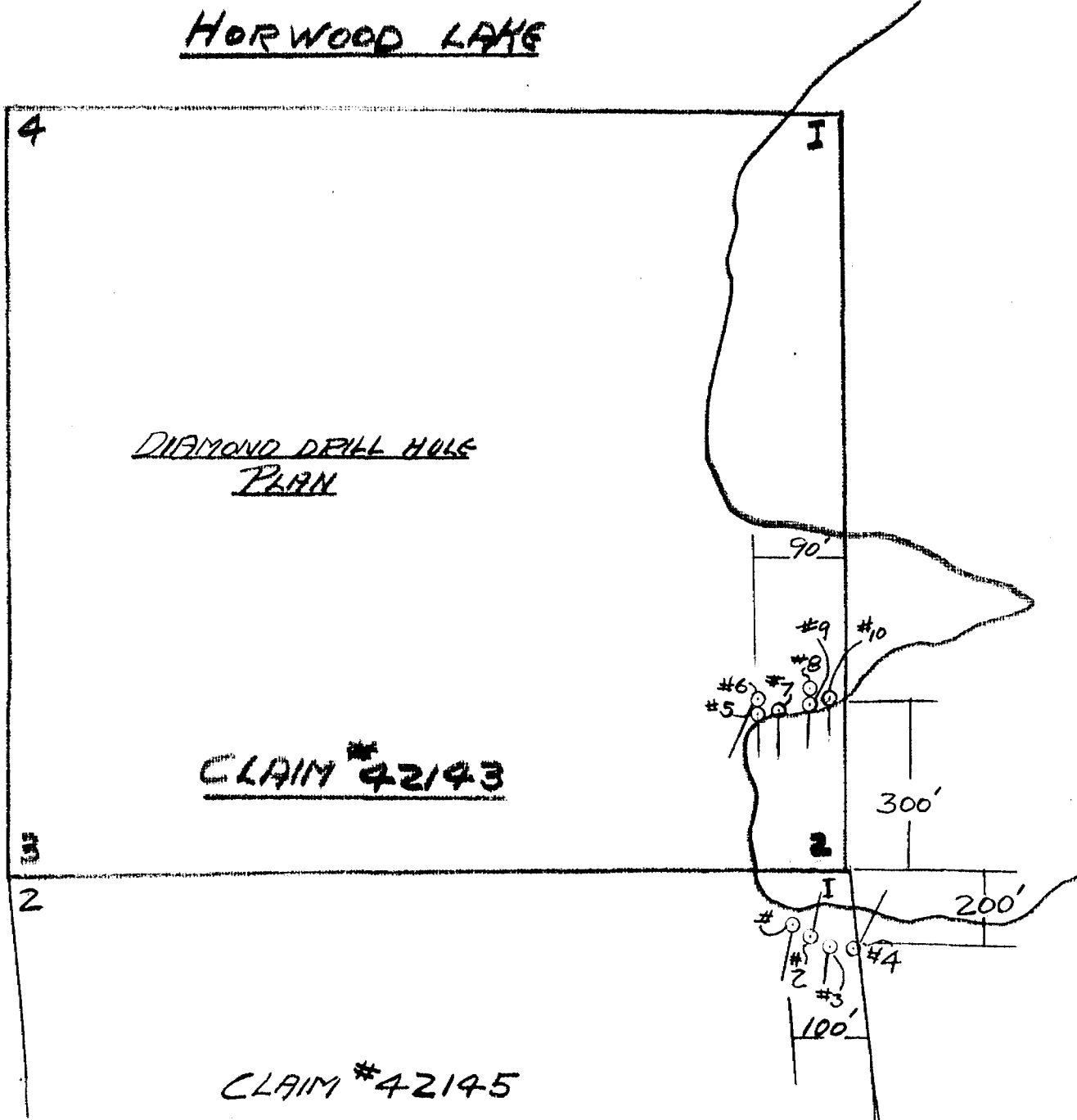



PROPERTY .....

HOLE NUMBER 1

SHEET NUMBER .....

# DIAMOND DRILL RECORD

SECTION FROM 0 TO 78

LOCATION: LAT. S. E. CORNER  
 DEP. CLAIM # S-42145  
 ELEVATION OF COLLAR .....

STARTED DEC. 10, 1949  
 COMPLETED " 13, 1949  
 ULTIMATE DEPTH 78  
 PROPOSED DEPTH 80

DATUM .....

DIRECTION AT START: BEARING SOUTH 20° WEST  
 DIP 45°

DEPTH FEET	FORMATION	SAMPLE NO.	WIDTH OF SAMPLE	GOLD \$	SLUDGE GOLD \$
0 - 20	LEDGE				
20 - 30	DIORITE MED. GREEN SHOWING BLOCKY FRACTURE MIN.				
30 - 40	DIORITE MED. TO LIGHT-GREEN NARROW BANDS OF SHEARING SHOWING, SOME PYRRHOTITE IN SHEARS				
40 - 50	DIORITE FINE MED. GREEN				
50 - 78	DIORITE BLOCKY - MIN IN FRACTURES				
	13/16 CORE				

DRILLED BY J. E. LEFFLER

SIGNED .....

PROPERTY .....

HOLE NUMBER 2

SHEET NUMBER .....

## DIAMOND DRILL RECORD

SECTION FROM 0 TO 71

LOCATION: LAT. S. E. CORNER  
 DEPT. CLAIMS - 42145  
 ELEVATION OF COLLAR .....

STARTED DEC - 14, 1949  
 COMPLETED " 17, 1949  
 ULTIMATE DEPTH 71  
 PROPOSED DEPTH 80

DATUM .....

DIRECTION AT START: BEARING NORTH 70° EAST  
 DIP 55°

DEPTH FEET	FORMATION	SAMPLE No.	WIDTH OF SAMPLE	GOLD \$	SLUDGE GOLD \$		
0 - 19	LEDGE						
19 - 29	DIORITE MED. GREEN BLOCKY FRACTURES						
29 - 30	MED. GREEN - SHEARING CHALCO PYRRHOTITE MIN IN SHEAR - SOME QTZ.						
30 - 39	DIORITE FINE GR. MED. GREEN						
39 - 49	MED. GREEN MED GR. SL SQUEEZED QTZ. STRINGERS BLUISH						
49 - 59	QTZ. IN SLIKENSIDES						
59 - 64	DIORITE MED.						
64 - 71	MED. GR. LT. QTZ. PORPH. QTZ. STRINGERS						
	13/16 CORE						

DRILLED BY J. E. LEFEVIER

SIGNED .....

PROPERTY .....

HOLE NUMBER 3

## DIAMOND DRILL RECORD

SHEET NUMBER .....

SECTION FROM 0 TO 76

LOCATION: LAT. S. E. CORNER  
 DEP. CHAIN # S-42145  
 ELEVATION OF COLLAR .....

STARTED DEC. 19, 1949  
 COMPLETED " 21, 1949  
 ULTIMATE DEPTH 76  
 PROPOSED DEPTH 75

DIRECTION AT START: BEARING SOUTH 10° WEST  
 DIP 30°

DEPTH FEET	FORMATION	SAMPLE No.	WIDTH OF SAMPLE	GOLD \$	SLUDGE GOLD \$			
0 - 30	LEDGE							
30 - 38	MED. GREEN DIORITE BLOCK FRACTURES MIN. SOME QTZ.							
38 - 40	QTZ. STRINGERS IN SHEARING SOME MIN.							
40 - 50	SHEARING, SOME QTZ. BLOCKS							
50 - 55	SHEARED GREYISH DIORITE ALTERED QTZ. STRINGERS + SQUEEZED							
55 - 56	ANDESITE LT. COL. FINE GR.							
65 - 71	ANDESITE - DIORITE FINE GR.							
	13/16 CORE							

NORTHERN MINER PRESS LIMITED, TORONTO-STOCK FORM No. 501 REV. 9/44

DRILLED BY J. E. LEFEVRE

SIGNED .....

PROPERTY .....

HOLE NUMBER 4

SHEET NUMBER .....

SECTION FROM 0 TO 60

## DIAMOND DRILL RECORD

LOCATION: LAT. S.E. CORNER  
 DEP. CHAIN # 5-42145  
 ELEVATION OF COLLAR .....

STARTED DEC. 22, 1949COMPLETED " 24, 1949ULTIMATE DEPTH 60PROPOSED DEPTH 70

DATUM .....

DIRECTION AT START: BEARING NORTH 30° EAST  
 DIP 45°

DEPTH FEET	FORMATION	SAMPLE No.	WIDTH OF SAMPLE	GOLD \$	SLUDGE GOLD \$			
0 - 20	LEDGE							
20 - 30	DIORITE, MED GR. LT.							
30 - 34	SOME SLIKENSIDES, SHEARS IN BANDS MIN.							
34 - 40	ANDESITE, FINE - DARKISH							
40 - 50	DIORITE MED.							
50 - 55	MED GR. LT. QTZ. PORPH.							
55 - 60	DIORITE - ANDESITE FINE TO MED. COLOR.							
	13/16 CORE							

NORTHERN MINER PRESS LIMITED, TORONTO—STOCK FORM No. 801 REV. 9/44

DRILLED BY J. E. LEFNER

SIGNED .....

PROPERTY .....

HOLE NUMBER 5

## DIAMOND DRILL RECORD

SHEET NUMBER .....

SECTION FROM 0 TO .....LOCATION: LAT. S. E. CORNERDEP. CHAIN # 2-42143

ELEVATION OF COLLAR .....

DATUM .....

DIRECTION AT START: BEARING SOUTH  
DIP 45°STARTED DEC. 27, 1949COMPLETED " 29, 1949ULTIMATE DEPTH 70PROPOSED DEPTH 60

DEPTH FEET	FORMATION	SAMPLE NO.	WIDTH OF SAMPLE	GOLD \$	SLUDGE GOLD \$		
0 - 15	LEDGE						
15 - 20	DIORITE - MED. GR. MED GREEN						
20 - 28	SHEARED QTZ VEIN MATTER MIN. PYRRHOTITE - CHALCO						
28 - 30	DIORITE - SOME MIN.						
30 - 40	DIORITE - SOME CRABS.						
40 - 41½	QTZ - MIN. PYRRHOTITE - CHALCO						
41½ - 50	DIORITE - SOME MIN.						
50 - 52	QTZ. MIN. PYRRHOTITE - CHALCO.						
52 - 60	DIORITE						
60 - 70	SOME QTZ. MIN. BLOCKY						
							13/16 CORE

NORTHERN MINER PRESS LIMITED, TORONTO - STOCK FORM No. 501 REV. 9/44

DRILLED BY

J. E. LEFFNER

SIGNED .....

PROPERTY .....

HOLE NUMBER 6

# DIAMOND DRILL RECORD

SHEET NUMBER .....

SECTION FROM 0 TO 85

LOCATION: LAT. N.E. CORNER  
 DEP. CLAIM # 5-42143

STARTED DEC. 31, 1949

ELEVATION OF COLLAR .....

COMPLETED JAN. 4, 1950

DATUM .....

ULTIMATE DEPTH 85

DIRECTION AT START: BEARING SOUTH 30° WEST  
 DIP 55°

PROPOSED DEPTH 80

DEPTH FEET	FORMATION	SAMPLE NO.	WIDTH OF SAMPLE	GOLD \$	SLUDGE GOLD \$
0 - 15	LEDGE				
15 - 20	DIORITE MED. GR. MED GREEN				
20 - 30	SHEAR QTZ. VEIN MATTER MIN. PYRRHOTITE - CHALCO				
30 - 40	DIORITE - SOME MIN.				
40 - 48	DIORITE - MIN. FINE				
48 - 50	DIORITE - QTZ. STRINGERS - MIN.				
50 - 60	DIORITE - MED GREEN - SOME MIN.				
60 - 70	" " " "	"			
70 - 73	SHEARING SOME MIN.				
73 - 80	DIORITE				
80 - 85	LOST CORE				
	13/16 CORE				

DRILLED BY J. E. LEFEVER

SIGNED .....

PROPERTY .....

HOLE NUMBER 7

# DIAMOND DRILL RECORD

SHEET NUMBER .....

SECTION FROM 0 TO 25

LOCATION: LAT. S. E. CORNER  
 DEP. CLAIM # 42143  
 ELEVATION OF COLLAR .....

DATUM .....

DIRECTION AT START: BEARING SOUTH  
 DIP 45°

STARTED JAN. 5, 1950  
 COMPLETED " 6, 1950  
 ULTIMATE DEPTH 75  
 PROPOSED DEPTH 70

DEPTH FEET	FORMATION	SAMPLE No.	WIDTH OF SAMPLE	GOLD \$	SLUDGE GOLD \$	
0 - 15	LEDGE					
15 - 20	DIORITE - SHEARED - MED. GREEN					
20 - 24	VEIN MATTER - QTZ. PYRRHOTITE - CHALCO					
24 - 25	DIORITE SOME MIN.					

1 3/16 CORE

DRILLED BY J. E. LEEVER

SIGNED .....

PROPERTY .....

HOLE NUMBER 8

## DIAMOND DRILL RECORD

SHEET NUMBER .....

SECTION FROM 0 TO 75

LOCATION: LAT. S.E. CORNER  
 DEP. CLAIM # S-42143  
 ELEVATION OF COLLAR .....

STARTED FEB. 17, 1950  
 COMPLETED " 21, 1950  
 ULTIMATE DEPTH 75  
 PROPOSED DEPTH 60

DIRECTION AT START: BEARING SOUTH  
 DIP 45°

DEPTH FEET	FORMATION	SAMPLE No.	WIDTH OF SAMPLE	GOLD \$	SLUDGE GOLD \$		
0 - 14	LEDGE						
14 - 22	DIORITE MED GREEN						
22 - 24	SHEARING QTZ. MIN.						
24 - 27	" " "						
27 - 34	MED. GREEN - DIORITE SOME SHEAR						
34 - 44	DIORITE						
45 - 65	" LT. GREEN QTZ. STRINGERS						
65 - 70	VEIN MATTER - CORE GROUND UP.						
70 - 75	DIORITE MED. GREEN						
	13/16 CORE						

NORTHERN MINER PRESS LIMITED, TORONTO-STOCK FORM No. 501 REV. 9/44

DRILLED BY J. E. LEFFLER

SIGNED .....







PROPERTY .....

HOLE NUMBER 1 .....

SHEET NUMBER .....

# DIAMOND DRILL RECORD

SECTION FROM ..... TO .....

LOCATION: LAT. N. E. corner  
 DEP. Claim S-42145

ELEVATION OF COLLAR .....

DATUM .....

DIRECTION AT START: BEARING North 10 deg. West  
 DIP 59 degrees

STARTED Aug. 5 1947

COMPLETED " 8 1947

ULTIMATE DEPTH 75 feet

PROPOSED DEPTH .....

DEPTH FEET	FORMATION	SAMPLE No.	WIDTH OF SAMPLE	GOLD \$	SLUDGE GOLD \$
0-25	Lt. Green fairly course Diorite stringers of Qtz no min.				
25-50	Med. grade Qtz Diorite shows fracturing with Qtz stringers no min.				
50-75	Med grade Qtz Diorite containing lt. color Qtz Porph				
	3/4" core				

DRILLED BY J. E. Lefever

SIGNED .....

PROPERTY .....

HOLE NUMBER 2 .....

# DIAMOND DRILL RECORD

SHEET NUMBER .....

SECTION FROM ..... TO .....

LOCATION: LAT. N. E. corner .....

STARTED Aug. 9, 1947 .....

DEP. Claim #S-42145 .....

COMPLETED " 13, 1947 .....

ELEVATION OF COLLAR .....

DATUM .....

ULTIMATE DEPTH 75 feet .....

DIRECTION AT START: BEARING South 10 deg. East .....

PROPOSED DEPTH .....

DIP 60 degrees .....

DEPTH FEET	FORMATION	SAMPLE NO.	WIDTH OF SAMPLE	GOLD \$	SLUDGE GOLD \$		
0-25	Lt. green fairly course Diorite						
25-28	Shearing 3' with 12" Qtz vein Heavy min. Pyrrh, Chalco Pyrite				AV		
28-50	Med. grade lt. green Diorite						
50-60	Fine Gr. Diorite						
60-82	Sheared Diorite containing Qtz. vein Pyrrh Chalco Pyrite				AV		
62-75	Greenstone lt color						
	3/4" core						

DRILLED BY J. E. Lefever .....

SIGNED .....

PROPERTY .....

HOLE NUMBER 3.....

# DIAMOND DRILL RECORD

SHEET NUMBER .....

SECTION FROM ..... TO .....

LOCATION: LAT. N. E. Corner  
 DEP. S-42145  
 ELEVATION OF COLLAR .....  
 DATUM .....  
 DIRECTION AT START: BEARING North 8 degrees West  
 DIP 39 deg. 13'

STARTED Aug. 14, 1947  
 COMPLETED " 29, 1947  
 ULTIMATE DEPTH 110 feet  
 PROPOSED DEPTH .....

DEPTH FEET	FORMATION	SAMPLE No.	WIDTH OF SAMPLE	GOLD \$	SLUDGE GOLD \$		
0-25	Lt. Green Qtz. Diorite						
25-27	Shearing 2' containing heavy min. Qtz vein with Pyrrh, Chalco Pyrites				Av.		
27-40	Med. lt. green Qtz Diorite #' shear zone containing 10* Qtz vein heavy min. containing Pyrrh, Chalco Pyrites				Av.		
40-60	Alter Diorite Med. Dk Green						
60-70	Shearing 10' wide shot through with Qtz. Qtz. min. with Pyrrh, Chalco Pyrites				Av.		
70-105	Med. lt. green Diorite some Carb. Qtz.						
105-110	Med. gr. Diorite shows shearing ( 3/4* core )						

DRILLED BY J. E. Lefever

SIGNED .....

PROPERTY .....

HOLE NUMBER 4 .....

# DIAMOND DRILL RECORD

SHEET NUMBER .....

SECTION FROM ..... TO .....

LOCATION: LAT. S. E. Corner .....

STARTED August 21, 1947 .....

DEP. Claim #S-42145 .....

COMPLETED 25, 1947 .....

ELEVATION OF COLLAR .....

DATUM .....

ULTIMATE DEPTH 100 feet .....

DIRECTION AT START: BEARING North 5 degrees West .....

PROPOSED DEPTH .....

DIP 45 degrees .....

DEPTH FEET	FORMATION	SAMPLE No.	WIDTH OF SAMPLE	GOLD \$	SLUDGE GOLD \$	
0-25	Greenstone Lt. Gb.					
25-50	Greenstone Lt. Gr. grades into med. gr. diorite .					
50-75	Diorite Med. dark.					
75-78	Diorite med. gr. shows shearing with some qtz. min.				Av.	
78-100	Altered diorite med. gr. fine gr. diorite					

DRILLED BY J. E. Lefever .....

SIGNED .....

HORWOOD LAKE

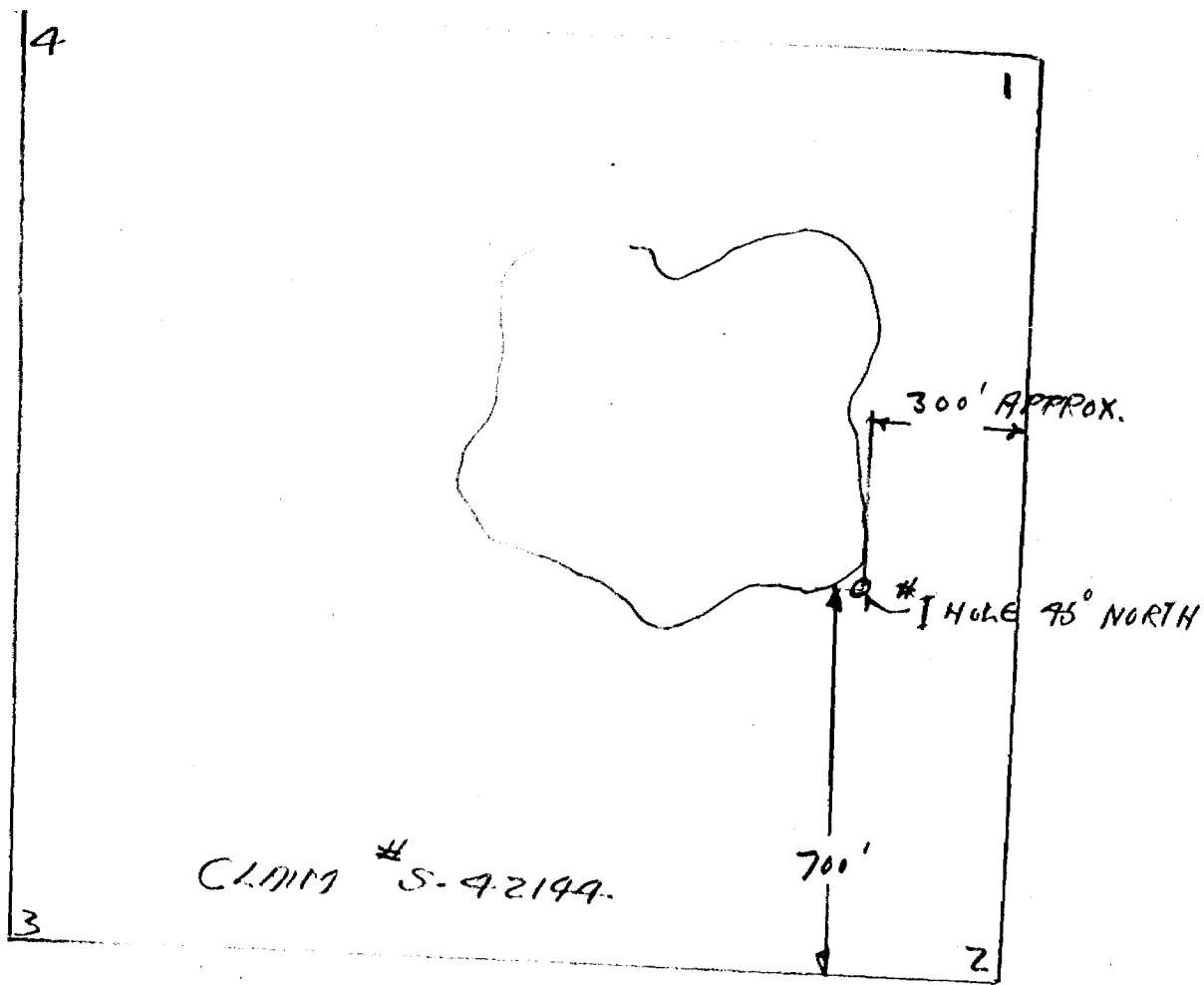

CLAIM # S-42199.

LOCATION OF DRILL HOLE

PROPERTY .....

HOLE NUMBER 1

# DIAMOND DRILL RECORD

SHEET NUMBER .....

SECTION FROM 0 To 80 ft.

LOCATION: LAT. M. W. Corener  
DEP. Claim #s-42144

STARTED May 2, 1949

ELEVATION OF COLLAR .....

COMPLETED " 4 "

DATUM .....

ULTIMATE DEPTH 80 ft.

DIRECTION AT START: BEARING North

PROPOSED DEPTH 80 ft.

DIP 45 deg.

DEPTH FEET	FORMATION	SAMPLE NO.	WIDTH OF SAMPLE	GOLD \$	SLUDGE GOLD \$		
0 - 25	Greenstone / Diorite						
25 - 50	Altered Porph.						
50 - 80	Greenstone, sheared qtz. some min .						
	13/16 core						
	Hole spotted on S.E. side of Island						
	<del>XXXXXX</del>						

NORTHERN MINER PRESS LIMITED, TORONTO-STOCK FORM No. 501 REV. 9/44

DRILLED BY J. E. Lefever

SIGNED .....



HORWOOD LAKE

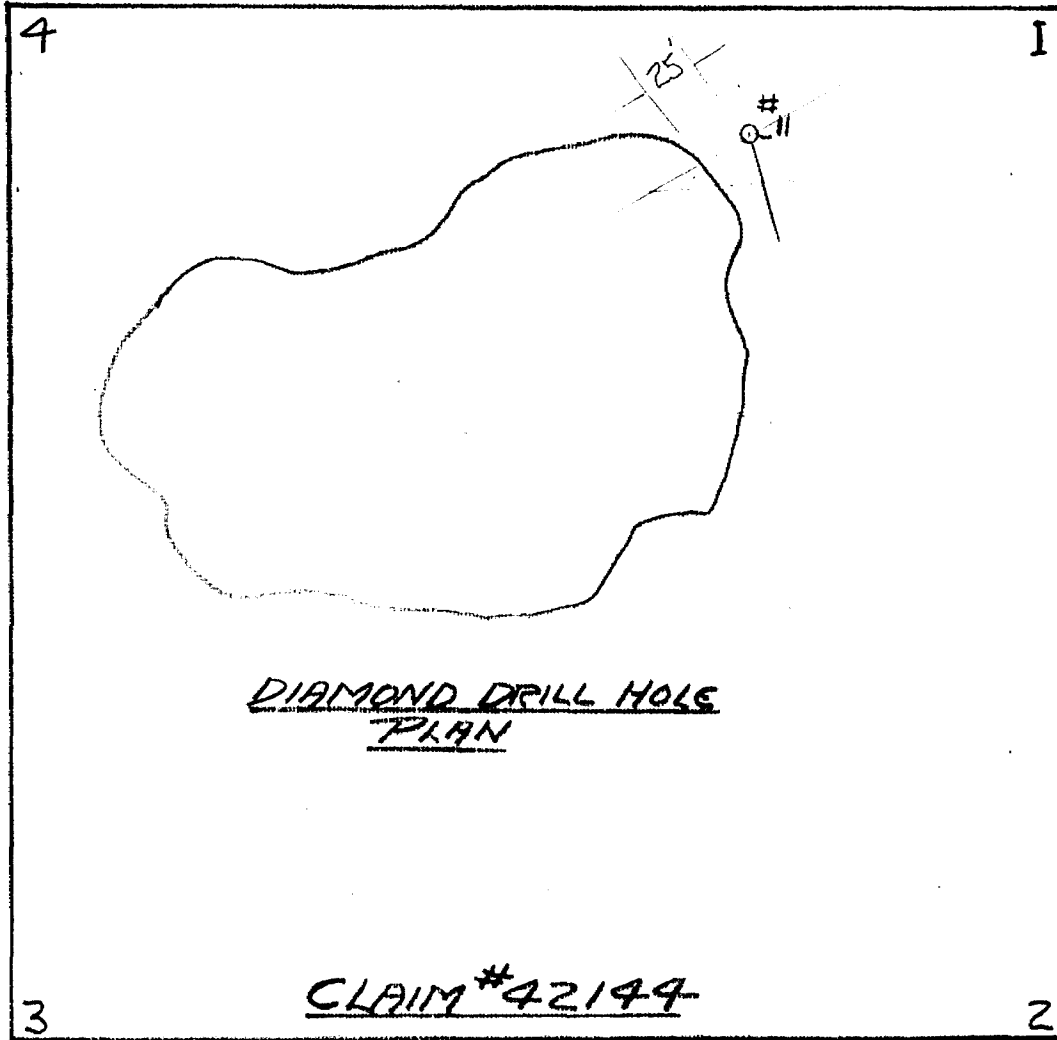

DIAMOND DRILL HOLE  
PLAN

CLAIM #42144

PROPERTY .....

HOLE NUMBER 11

# DIAMOND DRILL RECORD

SHEET NUMBER .....

SECTION FROM 0 TO 80

LOCATION: LAT. N.E. CORNER  
 DEP. CLAIM # 3-42144

STARTED DEC. 6, 1949

ELEVATION OF COLLAR .....

COMPLETED " 9, 1949

DATUM .....

ULTIMATE DEPTH 80

DIRECTION AT START: BEARING SOUTH 10° WEST  
 DIP 45°

PROPOSED DEPTH 75

DEPTH FEET	FORMATION	SAMPLE No.	WIDTH OF SAMPLE	GOLD \$	SLUDGE GOLD \$
0 - 20	LEDGE				
20 - 26	ANDESITE - MED LT. MED. GR. SHEAR.				
26 - 30	SHEARING BANDS. QTZ. BLOBS - STRINGERS				
30 - 40	SOME CARB. SOME MIN.				
40 - 44	QTZ. BULK ANDESITE DARK.				
44 - 50	REDDISH PORPH. LT. COLOR QTZ. STRINGERS No. MIN.				
50 - 60	DIORITE - DK. MED.				
60 - 70	GREENSTONE - BLOCKY FRACTURES SHEARS IN BANDS SOME MIN.				
70 - 80	GREENSTONE - ANDESITE				
	13/16 CORE				

DRILLED BY J. E. LEFEYER

SIGNED .....



HORWOOD LAKE

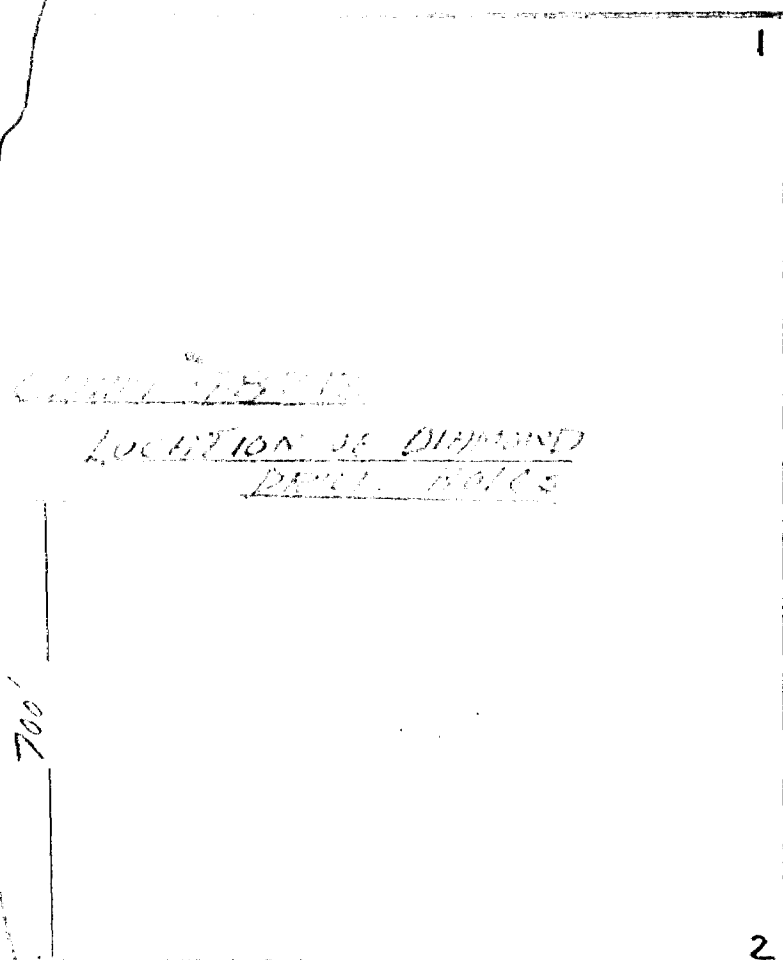
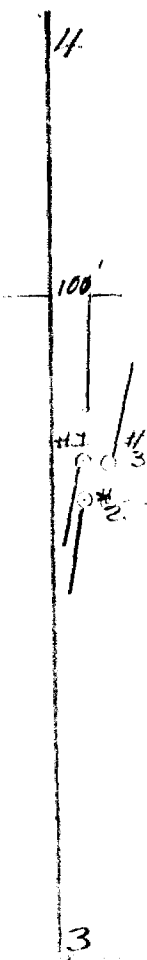

PROPERTY .....

HOLE NUMBER 1

## DIAMOND DRILL RECORD

SHEET NUMBER .....

SECTION FROM 0 TO 80LOCATION: LAT. S. W. CORNER  
DEP. CLAIM # 48Y13STARTED MARCH 11, 1950

ELEVATION OF COLLAR .....

COMPLETED " 15, 1950

DATUM .....

ULTIMATE DEPTH 80'DIRECTION AT START: BEARING SOUTH 10° WEST  
DIP 35°PROPOSED DEPTH 80'

DEPTH FEET	FORMATION	SAMPLE NO.	WIDTH OF SAMPLE	GOLD \$	SLUDGE GOLD \$
0-10	LEDGE				
10-25	DIORITE. MED. TO DK COLOR				
25-27	QTZ. N.M. SOME CARB.				
27-36	SHEAR - SOME QTZ N.M.				
36-70	DK COLOR DIORITE SLIGHTLY SHEARED S. QTZ. CARB.				
70-76	QTZ. BLOSS. SO. CARB. PYRITE				
76-80	DIORITE - QTZ STRINGERS				
	13/16 CORE				

NORTHERN MINER PRESS LIMITED, TORONTO-STOCK FORM NO. 501 REV. 9/44

DRILLED BY J. E. LEFEVER

SIGNED .....



17

HORWOOD L&S

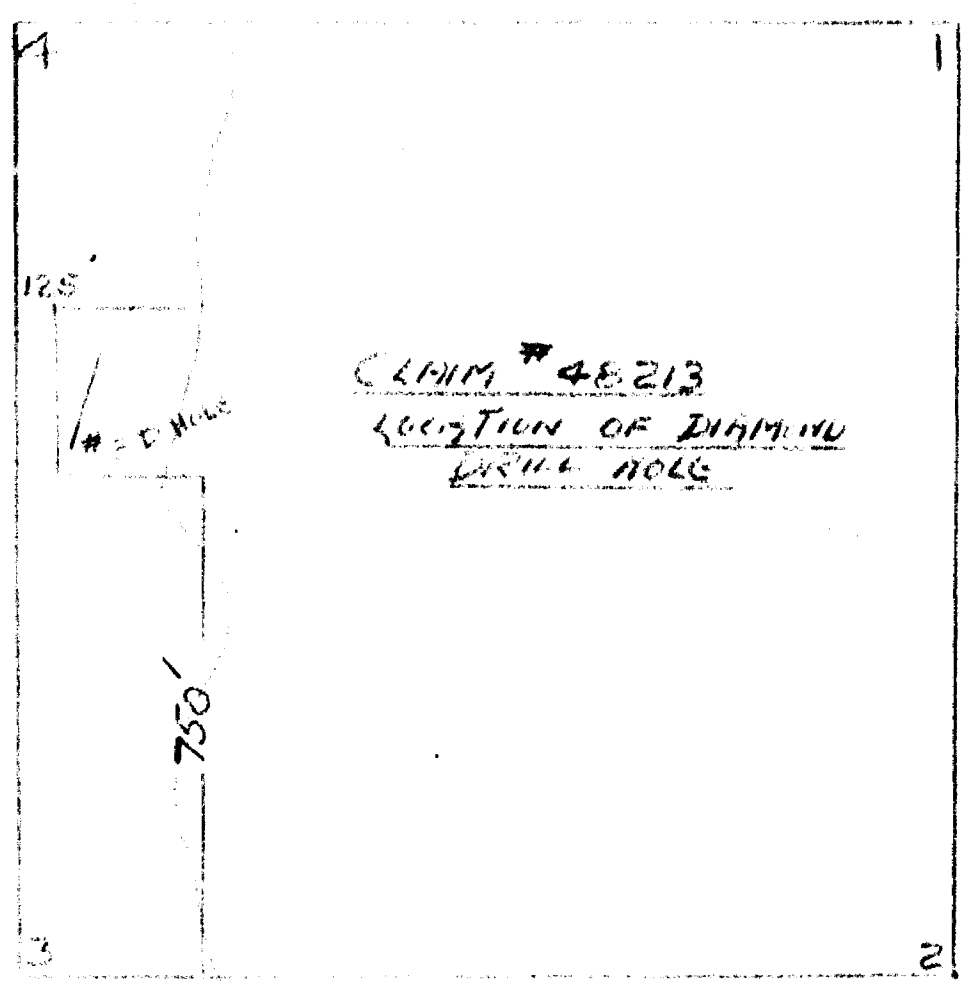



CLAIM 5-100108

HORWOOD TWP.

SHORE LINE

HORWOOD LAKE

LOW WATER LINE

9'

4' DEEP

3'

200' APP.

300' APP.

\* 2 POST

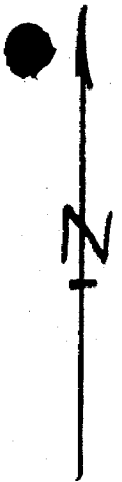

X LOCATION OF MANUAL WORK.

ON CLAIM 5-100108

HORWOOD TWP.

TRENCHING



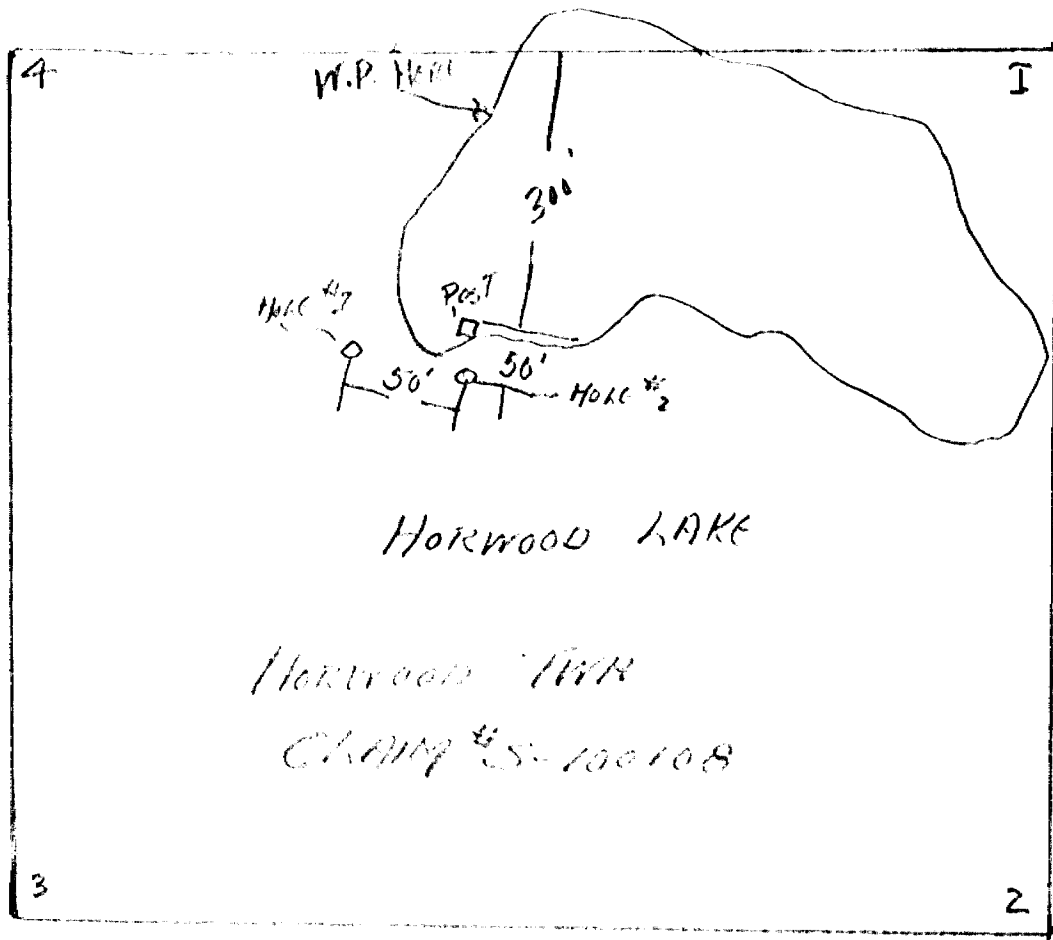

Location map of HORWOOD LAKE  
By [unclear] 1977

PROPERTY CLAIM # 5-100108

HOLE NUMBER ONE

SHEET NUMBER 41

SECTION FROM 0' TO 82'

# DIAMOND DRILL RECORD

LOCATION: LAT. DEP. N.W. CORNER 5-100108

ELEVATION OF COLLAR

DATUM

DIRECTION AT START: BEARING 45° S.W. 10°  
DIP

STARTED APRIL 19 - 1957

COMPLETED APRIL 28 - 1957

ULTIMATE DEPTH 82'

PROPOSED DEPTH 80'

DEPTH FEET	FORMATION	SAMPLE NO.	WIDTH OF SAMPLE	GOLD \$	SLUDGE GOLD \$
0 - 25'	DIORITE				
25 - 40'	SHEARRED SOME MIN.				
40 - 82'	DIORITE SOME Qtz MIN.				
	1/8 CORE				
	40 DAYS TO BE APPLIED ON EACH OF CLAIMS 5-100108-9.				

NORTHERN MINER PRESS LIMITED, TORONTO-STOCK FORM No. 501 REV. 9/44

DRILLED BY S.H.F.

SIGNED John E. Lefran



CLAIM 5-100108

HORWOOD LAKE

VEIN #1

40' APP.

10' APP.

#1  
D.D.H.

45' APP.

W.P.  
FOR #3

POST  
IN LAKE

SHORE  
LINE



D.D. HOLE #1

HORWOOD TWP

# DIAMOND DRILL RECORD

PROPERTY CRAIN 5-100108

HOLE NO. #1

SHEET NUMBER ONE

SECTION FROM 9' TO 101'

STARTED SEPT. 17 - 16 - 1959

LATITUDE \_\_\_\_\_

DATUM \_\_\_\_\_

COMPLETED SEPT - 16 1959.

DEPARTURE \_\_\_\_\_

BEARING NORTH 20° WEST

ULTIMATE DEPTH 101

ELEVATION \_\_\_\_\_

DIP 35°

PROPOSED DEPTH \_\_\_\_\_

DEPTH FEET	FORMATION	SAMPLE NO.	WIDTH OF SAMPLE	GOLD \$	SLUDGE GOLD \$	
0-9'	LEDGE					
9'-55'	DIORITE (SHEARING)					
55'-66'	PT2. MINERALIZED AU.		10'	18% AU.	7.80	02.
66'-101'	DIORITE					
RECOVERY 95%						

DRILLED BY SELF

SIGNED John E. Lefum

HORWOOD LAKE



120' APP

CLAIM 5-100108

30' APP

D.D.H #2

A-D.H

W.P. F.O.O.  
#3 POST IN LAKE

SHORE LINE

EAST WEST CLAIM LINE

D.D.HOLE #2

HORWOOD TWP

# DIAMOND DRILL RECORD

PROPERTY CLAIM 5-100108

HOLE NO. #2

SHEET NUMBER 2 HORWOOD TWP. SECTION FROM 12 TO 102'

STARTED SEPT. 17-1959.

LATITUDE \_\_\_\_\_ DATUM \_\_\_\_\_

COMPLETED " 20. "

DEPARTURE \_\_\_\_\_ BEARING NORTH 20° WEST

ULTIMATE DEPTH 102'

ELEVATION \_\_\_\_\_ DIP 35°

PROPOSED DEPTH 101'

DEPTH FEET	FORMATION	SAMPLE NO.	WIDTH OF SAMPLE	GOLD \$	SLUDGE GOLD \$
0-12'	LEDGE				
12-63'	DIORITE				
63-67'	SHEAR. SOME QTZ. MIN. AU. CORE BADLY GROUND UP.				1.24 OZ.
67-102'	DIORITE				
RECOVERY 95%					

DRILLED BY *Seki*

SIGNED *John E. Lopera*

# DIAMOND DRILL RECORD

PROPERTY CLAIM # S-100107

HOLE NO. #B.2

HORWOOD TWP. 15' TO 103'

SHEET NUMBER \_\_\_\_\_

STARTED DEC. 10 - 1958

LATITUDE \_\_\_\_\_

DATUM \_\_\_\_\_

COMPLETED DEC. 17 - "

DEPARTURE \_\_\_\_\_

BEARING \_\_\_\_\_

ULTIMATE DEPTH 103

ELEVATION \_\_\_\_\_

DIP 40°

PROPOSED DEPTH 100

DEPTH FEET	FORMATION	SAMPLE NO.	WIDTH OF SAMPLE	GOLD \$	SLUDGE GOLD \$
<u>0-15'</u>	<u>LEDGE</u>				
<u>15'-65'</u>	<u>DIORITE (DARK)</u>				
<u>65-103</u>	<u>" MED GR.</u>				

N.M.P., TORONTO-STOCK FORM NO. 501 REV. 12/51

DRILLED BY SELF

SIGNED John E. Lefvre





CLAIM 5-100107

HORWOOD TWP.

SHORE LINE

900' APP.

WIP  
FOR  
#2 PLOT  
IN LAKE

200' APP.

#  
D.D.H B2

HORWOOD  
LAKE

