



42B015W8543 55 KEITH

010

TOWNSHIP: Keith

REPORT NO: 55

WORK PERFORMED FOR: FALCONBRIDGE

RECORDED HOLDER: SAME AS ABOVE

OTHER

<u>CLAIM NO.</u>	<u>HOLE NO.</u>	<u>FOOTAGE</u>	<u>DATE</u>	<u>NOTE</u>
1160695	KTH13-01	197.0 m	MARCH/92	(1)

NOTES: (1) W9360.00035, FILED MAY/93.

Falconbridge Limited
Keith Township Claims
(PN 8200)
1992 Progress Report
Keith Township
N.T.S. 41-B-1

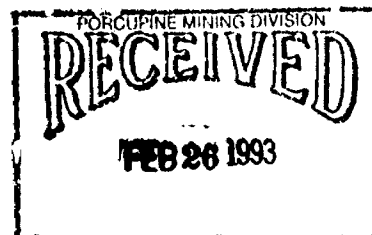

February, 1993

J.T. Aultman
Field Geologist

EXECUTIVE SUMMARY

The 1992 exploration program on the Keith Township Claims consisted of the drilling of one diamond drill hole. The diamond drilling program was completed by Norex Drilling Limited of Porcupine, Ontario during March, 1992.

Diamond drilling on the property totalled 197 metres in hole **KTH13-01**. This hole tested a 1.1km long HLEM conductor and intersected mafic volcanics with interflow sediment/tuffaceous units that were intercalated with graphitic argillite beds. The graphitic argillite beds were identified as the cause of the HLEM anomaly. Based upon the disappointing results obtained during the 1991 mapping program and the 1992 drilling program, the potential for the property to contain an economic base metal deposit is limited. Mineralization intersected to date has been low grade and no hydrothermal activity was noted on the property.

No further work is planned for the Keith Township Claims.





42B01SW8543 55 KEITH

010C

TABLE OF CONT.

INTRODUCTION 1

LOCATION AND ACCESS 1

1992 EXPLORATION ACTIVITIES 1

1992 EXPLORATION RESULTS 1

ENVIRONMENTAL CONCERNS 5

RECOMMENDATIONS 6

APPENDICES

 APPENDIX A Drill Plan and Vertical Section

 APPENDIX B 1992 Diamond Drill Data

LIST OF FIGURES

Figure 1: Location of Keith Township. 2

Figure 2 Location of the Keith Township Claims (PN 8200). 3

Figure 3 Keith Township Claims (PN 8200) property map. 4

LIST OF TABLES

Table 1: 1992 Diamond Drilling Summary for the Keith Township Claims (PN 8200). 5

Table 2: Significant assay results from hole KTH13-01. 5



INTRODUCTION

A compilation of government and assessment files was undertaken in anticipation of the release of results of an airborne survey of the North Swayze-Montcalm area on October 4, 1990, by the Ministry of Northern Development and Mines. In response to the release of the survey unstaked AEM anomalies occurring in potentially favourable areas were staked. The occurrence of a cluster of strong AEM anomalies prompted the staking of 7 claims, to which 3 additional claims were later added.

Exploration on the Keith Township Claims by Falconbridge has included ground geophysics, geological mapping, lithogeochemical sampling and diamond drilling. This report only covers the 1992 drilling program, the reader is referred to the 1991 property report by M.Y. Houle and D. Truscott for details of the 1991 program.

LOCATION AND ACCESS

The project area is located approximately 90 kilometres west-southwest of Timmins, Ontario in the south central part of Keith Township (See Figures 1 and 2). This property consists of a contiguous block of 10 staked claims totalling approximately 160 hectares (Figure 3). The claims are located 3.5 kilometres east of the Foleyet Timber logging road and is 16-18 kilometres south of Highway 101. The claims can be accessed using 4x4 pickup and ATV or by boat from the Horwood Lake Lodge.

1992 EXPLORATION ACTIVITIES

The 1992 exploration program on the Keith Township Claims consisted of the diamond drilling of one hole. The drilling was conducted between March 19 and March 21, 1992. The diamond drilling was completed by Norex Drilling Limited of Porcupine, Ontario.

The purpose of the 1992 exploration program was to test for the source of a 1.1km long HLEM conductor (HLEM "A") which crosses the claims.

1992 EXPLORATION RESULTS

Between March 19 and March 21, 1992, one diamond drill hole totalling 197 metres in length was completed on the Keith Township Claims by Norex Drilling Limited of Porcupine, Ontario. Diamond drilling statistics and direct invoice costs for the 1992 drilling program are illustrated in Table 1. Surface plan showing the drill hole location and a drill section are included in Appendix A. Drill log, assay results and lithogeochemical data for hole KTH13-01 are presented in Appendix B. The diamond drill core from the 1992 drilling program is stored at the Kidd Creek Mine in Timmins, Ontario.



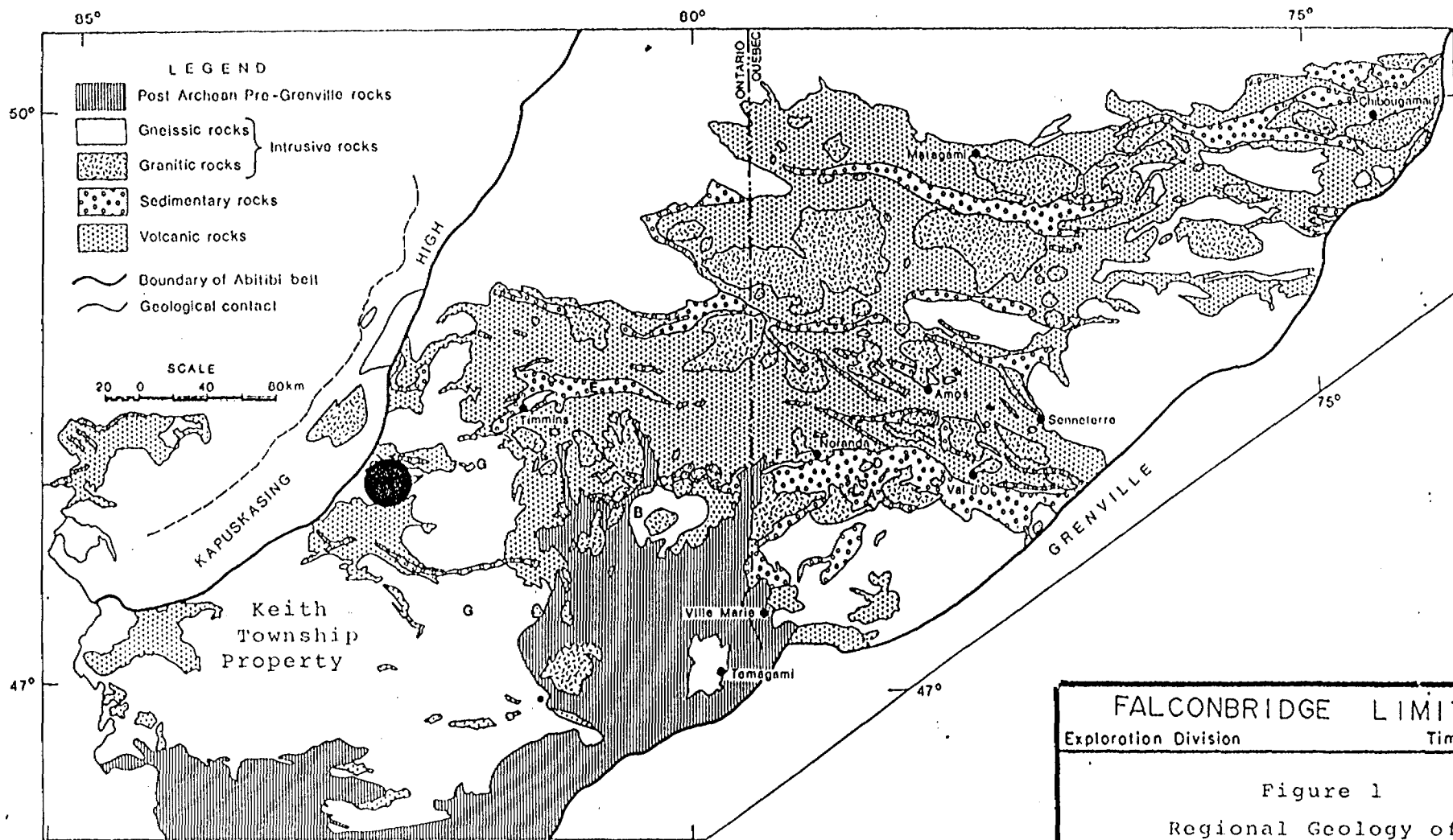

FALCONBRIDGE LIMITED	
Exploration Division	Timmins, ONTARIO
<p>Figure 1</p> <p>Regional Geology of The Abitibi Belt</p>	
SCALE :	Date :
Drawn :	Project N ^o :
	Date :

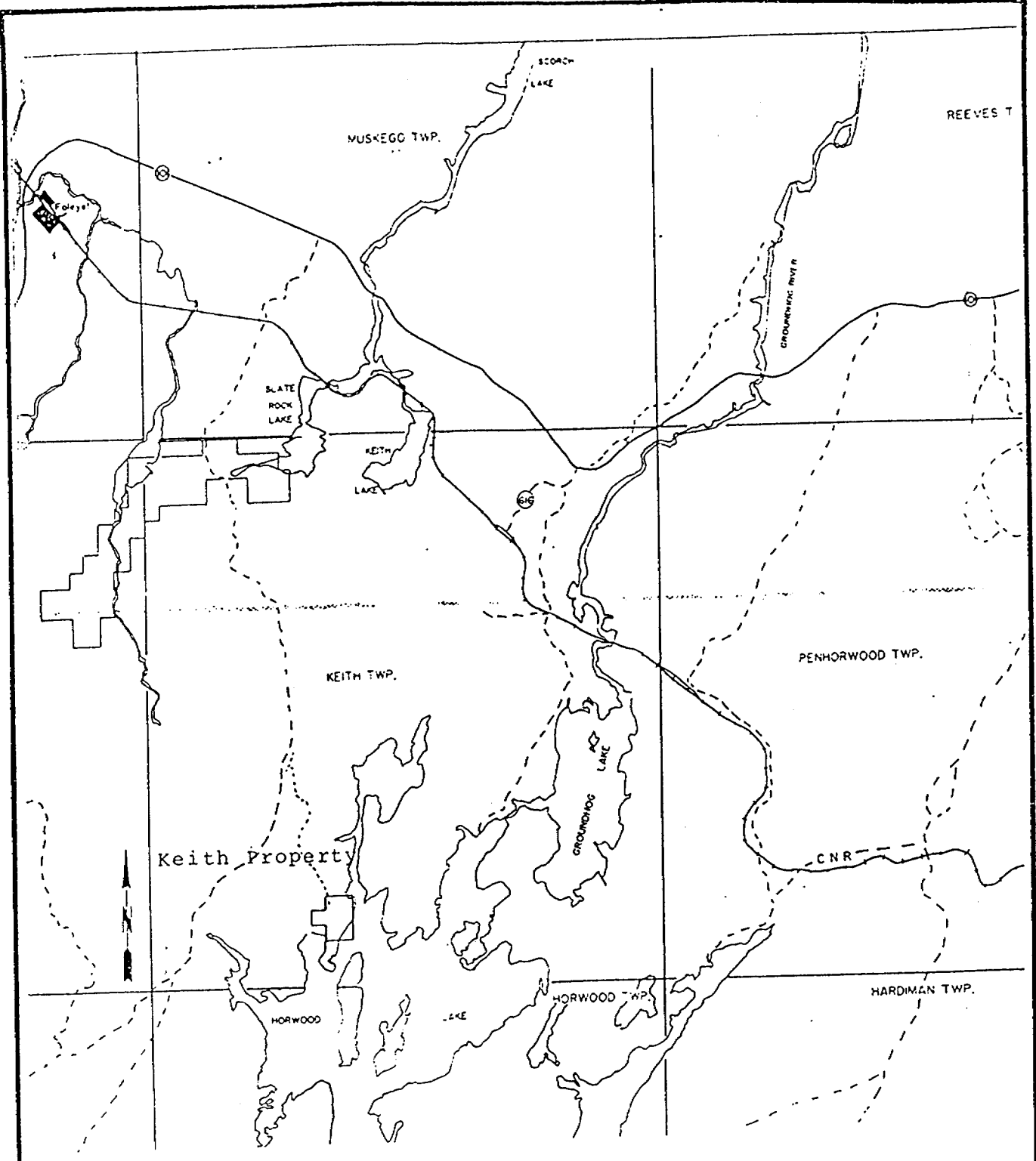

FALCONBRIDGE LIMITED
 Exploration Division Timmins, ONTARIO

Figure 2
 Claim Location Map
 1:157,345

SCALE :	Date :
Drawn :	Project N ^o :
	Date :

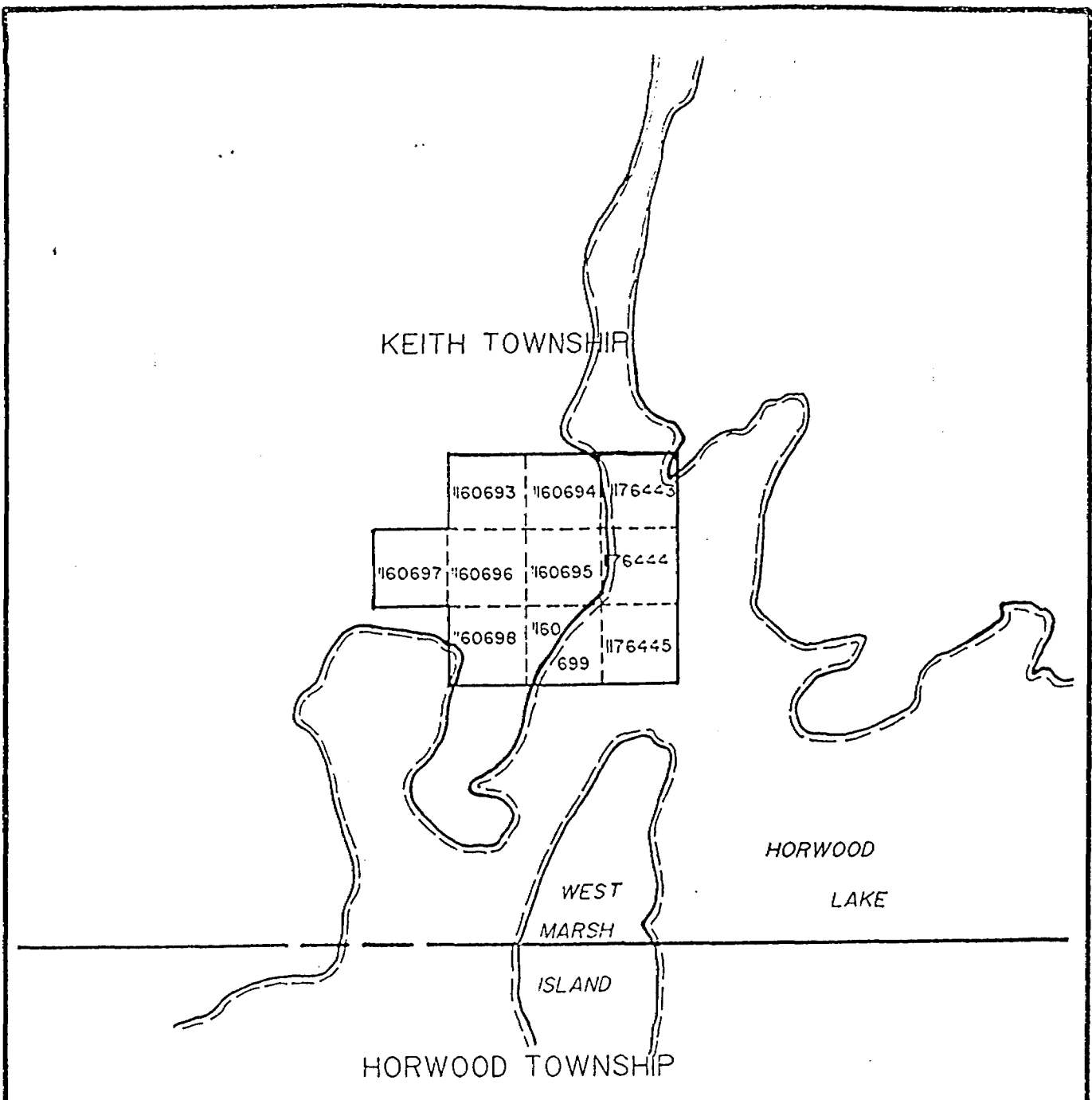

FALCONBRIDGE LIMITED		
Exploration Division		Timmins, ONTARIO
<p>Figure 3</p> <p>Keith Township Claim Map</p> <p>1" = 1 1/2 Mile (1:31,680)</p>		
SCALE :		Date :
Drawn :	Project N ^o :	Date :

HOLE NUMBER	NORTHING	EASTING	AZI	DIP	CASING (m)	HOLE (m)	START	END	COST	
									Invoiced	\$/m
KTH13-01	98+50N	104+70E	165	-50	18.5	197	03/19/92	03/21/92	\$ 9,737	\$49.42
						Totals	197		\$ 9,737	\$49.42

Table 1: 1992 Diamond Drilling Summary for the Keith Township Claims (PN 8200).

Drill hole **KTH13-01** was designed to test HLEM conductor "A". This east-west striking conductor is 1.1km long and has a moderate conductivity (3-12 mhos). The hole intersected mafic volcanics with interflow sediment/tuffaceous units that were intercalated with graphitic argillite beds. The graphitic argillite beds were identified as the cause of the HLEM anomaly. Slightly anomalous (>1000ppm), but sub-economic, base metal values were intersected in the graphitic argillites. These assay results were not considered significant. Table 2 contains a summary of the anomalous assay results from hole KTH13-01. Lithochemical samples taken from the drill core did not identify any areas of alkali depletion.

HOLE NO.	FROM (m)	TO (m)	WIDTH (m)	Cu ppm	Zn ppm	Ag ppm	Au ppb	REMARKS
	87.15	87.50	0.35	1190	601	0.7	7	Sediment/Tuffaceous unit
	87.50	87.80	0.30	1850	8760	2.9	51	Graphitic Argillite unit
	87.80	88.25	0.45	997	1540	1.6	24	Graphitic Argillite unit
	90.25	90.90	0.65	444	6260	1.0	24	Graphitic Argillite unit
	92.40	92.90	0.50	92	1250	0.2	<5	Sediment/Tuffaceous unit
	92.90	93.35	0.45	496	3700	1.0	<5	Graphitic Argillite unit
	93.35	94.80	1.45	695	3780	1.4	<5	Sediment/Tuffaceous unit
	94.80	96.30	1.50	281	3140	0.8	7	Sediment/Tuffaceous unit
	99.25	99.83	0.58	209	1500	0.4	10	Graphitic Argillite unit
	108.72	110.20	1.48	195	1290	0.4	10	Graphitic Argillite unit

Table 2: Significant assay results from hole KTH13-01.

ENVIRONMENTAL CONCERNS

Normal diamond drilling procedures were followed and all precautions were taken by the contractor to comply with the provisions set forth in the "Environmental Rider" in the Falconbridge Limited Diamond Drilling Contract. Drill casings were capped and left in the ground. All sites were cleaned up and were inspected during and after drilling to ensure that they met Falconbridge standards. Site inspection sheets for the 1992 drilling program are on file in the Timmins Exploration office.



RECOMMENDATIONS

Based upon the disappointing results obtained during the 1991 mapping program and 1992 drilling program, the potential for the property to contain an economic base metal deposit is limited. Mineralization intersected to date has been low grade and no hydrothermal activity has been noted on the property. No further work is planned for the property.

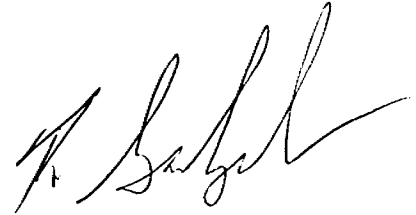

J.T. Aultman
Field Geologist



APPENDIX A

1:5000 Surface Plan
and
1:1000 Vertical Drill Section



APPENDIX B

1992 Diamond Drill Hole Log, Assay and Lithogeochemistry Results



HOLE NUMBER: KTH13-01

FALCONBRIDGE LIMITED
DRILL HOLE RECORD

DATE: 02/12/1993
IMPERIAL UNITS: METRIC UNITS: X

PROJECT NAME: 8200
PROJECT NUMBER: 8200
CLAIM NUMBER: 1160695
LOCATION: S. KEITH 1WP

PLOTTING COORDS GRID: UTM
NORTH: 5325360.00N
EAST: 400565.00E
ELEV: 343.00

ALTERNATE COORDS GRID: LINE
NORTH: 98+50N
EAST: 104+70E
ELEV: 343.00

COLLAR DIP: -50° 0' 0"
LENGTH OF THE HOLE: 197.00M
START DEPTH: 0.00M
FINAL DEPTH: 197.00M

COLLAR ASTRONOMIC AZIMUTH: 165° 0' 0"

GRID ASTRONOMIC AZIMUTH: 180° 0' 0"

DATE STARTED: 03/19/1992
DATE COMPLETED: 03/21/1992
DATE LOGGED: 04/08/1992

COLLAR SURVEY: NO
ROD LOG: NO
HOLE MAKES WATER: NO

PULSE EM SURVEY: NO
PLUGGED: NO
HOLE SIZE: BQ

CONTRACTOR: NOREX DRILLING
CASING: 16m BW
CORE STORAGE: KIDD MINESITE
UTM COORD.:

COMMENTS : To test HLEM "A".
WEDGES AT:

DIRECTIONAL DATA:

Depth (M)	Astronomic Azimuth	Dip degrees	Type of Test	FLAG	Comments	Depth (M)	Astronomic Azimuth	Dip degrees	Type of Test	FLAG	Comments
20.00	165° 0' 0"	-51° 0' 0"	S	OK							
80.00	166° 0' 0"	-49° 0' 0"	S	OK							
140.00	168° 0' 0"	-47° 0' 0"	S	OK							
191.00	172° 0' 0"	-46° 0' 0"	S	OK							
.	
.	
.	
.	
.	
.	
.	
.	
.	
.	
.	
.	
.	
.	
.	
.	

HOLE NUMBER: KTH13-01

DRILL HOLE RECORD

LOGGED BY: J. AULTMAN

PAGE: 1

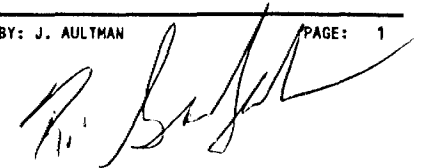

HOLE NUMBER: KTH13-01

DRILL HOLE RECORD

DATE: 02/12/1993

FROM TO	ROCK TYPE	TEXTURE AND STRUCTURE	ANGLE TO CA	ALTERATION	MINERALIZATION	REMARKS
0.00 TO 18.50	OVERBURDEN «{ob}»					
18.50 TO 22.25	MAFIC TUFF «2t(ChCb)»	-medium grey-green. -medium grained. -unit is slightly magnetic and soft. -massive unit, faint bedding at 40°/CA. -unit becomes finer uphole (towards the north). -sharp lower contact at 25°/CA.		-moderate chloritization and carbonatization (reacts to HCl).		
22.25 TO 87.15	PILLOWED MAFICS «2pew(Ch)»	-dark green. -fine grained. -moderate hardness (slightly marked by a scribe). -unit is slightly magnetic. -selvages are 1-2cm wide and contain chlorite, pillow fragments, pyrrhotite, carbonate and pyrite. -pillows contain quartz filled amygdules (<1-2mm in diameter). -unit is weakly foliated at 50-60°/CA. -gradational lower contact.		-moderate chloritization. -weak patchy silicification.	-trace pyrite and pyrrhotite.	
87.15 TO 99.83	SEDIMENTS «5,5g»	-fine grained. -medium grey to black. -bedded unit at 70°/CA. -unit appears to fine uphole (tops to the north). -unit is moderately foliated parallel to bedding. -sharp irregular lower contact. -unit has 65-70% argillite beds and 30-35% greywacke beds.		-weak carbonatization (present in the greywacke beds).	-unit contains 1-3% pyrite present in beds, fractures and nodules. -possible trace chalcopyrite.	-argillite beds consist of 95% graphitic argillite. -these beds are moderately to strongly conductive. -graphitic argillite between 87.50-87.77m, 87.85-88.15m, 90.20-90.75m, 92.92-93.35m, 93.63-94.45m, 94.62-94.80m, 95.00-96.15m, 99.28-99.83m.
99.83 TO 102.55	QUARTZ FELDSPAR PORPHYRY «9d»	-grey. -fine grained with phenocrysts. -phenocrysts are up to 3mm in diameter and		-weak sericitization.		

HOLE NUMBER: KTH13-01

DRILL HOLE RECORD

LOGGED BY: J. AULTMAN

PAGE: 2

HOLE NUMBER: KTH13-01

DRILL HOLE RECORD

DATE: 02/12/1993

FROM TO	ROCK TYPE	TEXTURE AND STRUCTURE	ANGLE TO CA	ALTERATION	MINERALIZATION	REMARKS
102.55 TO 103.60	GRAPHITIC ARGILLITE «5g»	<ul style="list-style-type: none"> consist of 50% of the unit. -phenocrysts are 60% feldspar and 40% quartz. -hard (lightly marked by a scribe). -sharp upper and lower contacts. 				
103.60 TO 105.72	QUARTZ FELDSPAR PORPHYRY «9d»	<ul style="list-style-type: none"> -black. -fine grained. -unit is weakly bedded at 65-70°/CA and is weakly conductive. -sharp irregular contacts. -similar to unit between 99.83-102.55m. -sharp irregular lower contact. 			-1% pyrite found in fractures and beds.	
105.72 TO 110.20	GRAPHITIC ARGILLITE «5g»	<ul style="list-style-type: none"> -black. -fine grained. -weakly bedded at 65-70°/CA. -unit contains 95-98% argillite beds and 2-5% greywacke beds. -gradational lower contact. 		-weak carbonatization (carbonate present in small fractures parallel to bedding).	-1-2% pyrite present in beds (1-3mm wide) and in fractures.	-moderate to strong conductivity.
110.20 TO 118.75	SEDIMENTS/ MAFIC TUFF «5,2t(g)»	<ul style="list-style-type: none"> -fine grained. -grey-black becoming grey-green at end of unit. -unit is weakly bedded at 70°/CA. -unit has 90% fine grained greywacke beds and 10% argillite beds. -unit becomes more mafic in composition towards the bottom of the unit. -graphitic argillite between 113.00-113.25m, that is weakly conductive. -gradational lower contact. 		-weak to moderate carbonatization.	-moderate carbonaceous alteration between 110.20-114.00m.	-trace to 1% pyrite in the first 4m of the unit.
118.75 TO 197.00	MAFIC VOLCANICS «2p(m)ueCh»	<ul style="list-style-type: none"> -medium to dark grey-green. -fine grained. -unit is moderately hard (easily marked by a scribe). -unit is weakly pillowed with massive intervals. -selvages are 1 to 1.5cm wide and are chlorite rich. -pillows contain quartz filled amygdules. 		-weak to moderate chloritization.	-trace pyrite.	

HOLE NUMBER: KTH13-01

DRILL HOLE RECORD

LOGGED BY: J. AULTMAN

PAGE: 3

HOLE NUMBER: KTH13-01

DRILL HOLE RECORD

DATE: 02/12/1993

FROM TO	ROCK TYPE	TEXTURE AND STRUCTURE	ANGLE TO CA	ALTERATION	MINERALIZATION	REMARKS
197.00 TO 197.00	E.O.H.	-unit is slightly fractured. -fractures have an irregular pattern and are filled with carbonate. -unit is weakly foliated at 60-70°/CA.				

HOLE NUMBER: KTH13-01

DRILL HOLE RECORD

LOGGED BY: J. AULTMAN

PAGE: 4

HOLE NUMBER : KTH13-01

ASSAYS SHEET

DATE: 12/02/1993

Sample	From (M)	To (M)	Leng. (M)	Cu ppm	Zn ppm	Au ppb	Ag ppm	Pb ppm	Co ppm	Ni ppm	Pt ppb	Pd ppb
AN00342	85.65	87.15	1.50	108	136	0	0.1	1		57		
AN00343	87.15	87.50	0.35	1190	601	7	0.7	12		98		
AN00344	87.50	87.80	0.30	1850	8760	51	2.9	83		227		
AN00345	87.80	88.25	0.45	997	1540	24	1.6	51		115		
AN00346	88.25	89.25	1.00	67	100	0	0.1	1		49		
AN00347	89.75	90.25	0.50	65	68	0	0.1	1		81		
AN00348	90.25	90.90	0.65	444	6260	24	1.0	67		193		
AN00349	90.90	92.40	1.50	91	422	0	0.2	7		58		
AN00350	92.40	92.90	0.50	92	1250	0	0.2	19		40		
AN00351	92.90	93.35	0.45	496	3700	0	1.0	55		159		
AN00352	93.35	94.80	1.45	695	3780	0	1.4	113		216		
AN00353	94.80	96.30	1.50	281	3140	7	0.8	37		154		
AN00354	96.30	97.80	1.50	91	579	7	0.2	1		50		
AN00355	97.80	99.25	1.45	51	138	0	0.1	1		65		
AN00356	99.25	99.83	0.58	209	1500	10	0.4	28		96		
AN00357	99.83	101.83	2.00	26	68	0	0.1	1		18		
AN00358	101.83	102.55	0.72	24	66	0	0.1	1		27		
AN00359	102.55	103.60	1.05	85	421	0	0.2	8		98		
AN00360	103.60	104.60	1.00	21	50	0	0.1	1		19		
AN00362	104.60	105.72	1.12	26	73	0	0.1	1		20		
AN00363	105.72	107.22	1.50	190	960	0	0.4	19		135		
AN00364	107.22	108.72	1.50	106	934	7	0.2	15		75		
AN00365	108.72	110.20	1.48	195	1290	10	0.4	17		162		
AN00366	110.20	111.70	1.50	62	361	0	0.1	9		71		
AN00367	111.70	113.20	1.50	75	709	0	0.2	40		42		
AN00368	113.20	114.60	1.40	103	388	7	0.2	20		58		

HOLE NUMBER: KTH13-01

ASSAYS SHEET

PAGE: 5

HOLE NUMBER : KTH13-01

GEOCHEMICAL ASSAY

DATE: 12/02/1993

Sample	From (M)	To (M)	Leng. (M)	SI02 %	AL2O3 %	CAO %	MGO %	NA2O %	K2O %	FE2O3 %	TIO2 %	P2O5 %	MNO %	CR2O3 %	LOI %	SUM %	Y PPM	ZR PPM	BA PPM	RB PPM	SR PPM	CO2 %	CU PPM	ZN PPM	NI PPM	CR PPM	FIELD NAME	CHEM ID	ALUM
AN00218	32.00	35.00	3.00	55.27	14.23	7.17	4.31	4.37	0.22	11.63	1.93	0.16	0.21	0.05	0.11	99.63	40	112					90	140	20		2w	121	
AN00219	47.00	50.00	3.00	53.36	14.81	7.11	3.95	2.79	0.98	12.77	1.91	0.20	0.22	0.05	1.16	99.32	36	114					95	130	20		2w	136	
AN00220	80.00	83.00	3.00	53.19	14.62	6.25	6.08	2.81	0.30	12.01	1.61	0.26	0.18	0.07	1.67	99.04	44	114					60	205	60		2v	156	
AN00221	103.60	105.72	2.12	66.61	16.88	3.34	1.42	5.17	1.24	3.26	0.47	0.14	0.05	0.05	1.17	99.79	8	120					20	55	20		3?	173	
AN00222	134.00	137.00	3.00	52.74	14.55	9.60	6.30	2.85	0.20	11.55	0.94	0.06	0.25	0.04	0.63	99.71	20	46					95	80	80		2u	115	
AN00223	158.00	161.00	3.00	52.09	14.88	9.83	7.02	2.77	0.24	11.40	0.93	0.14	0.24	0.05	0.53	100.15	16	50					100	95	60		2u	116	
AN00224	191.00	194.00	3.00	51.19	14.92	9.51	6.77	2.76	0.32	10.91	0.95	0.08	0.19	0.05	0.43	98.09	20	44					85	100	60		2u	119	

HOLE NUMBER: KTH13-01

GEOCHEMICAL ASSAY

PAGE: 6

HOLE NUMBER : KTH13-01

GEOCHEMICAL ASSAYS

DATE: 12/02/1993

Sample	From (M)	To (M)	Leng. (M)	AG PPM	AU PPB	CO PPM	PB PPM	S PPM	V PPM	AS PPM	SN PPM	CD PPM	SB PPM	BI PPM	SE PPM	HF PPM	TA PPM	W PPM	MO PPM	TH PPM	U PPM	B PPM	CS PPM	LA PPM	CE PPM	ND PPM	SM PPM	EU PPM	GD PPM	
AN00218	32.00	35.00	3.00			40																								
AN00219	47.00	50.00	3.00			40																								
AN00220	80.00	83.00	3.00			35																								
AN00221	103.60	105.72	2.12			10																								
AN00222	134.00	137.00	3.00			40																								
AN00223	158.00	161.00	3.00			45																								
AN00224	191.00	194.00	3.00			45																								

HOLE NUMBER: KTH13-01

GEOCHEMICAL ASSAYS

PAGE: 7

HOLE NUMBER : KTH13-01

GEOCHEMICAL ASSAYS

DATE: 12/02/1993

Sample	From (M)	To (M)	Leng. (M)	DY PPM	ER PPM	LU PPM	OS PPB	IR PPB	RU PPB	RH PPB	PT PPB	PD PPB	LI PPM	BE PPH	MN PPH	GA PPM	GE PPM	IN PPM	TL PPM	SC PPM	BR PPM	YB PPM	NB PPM	
AN00218	32.00	35.00	3.00																					
AN00219	47.00	50.00	3.00																					
AN00220	80.00	83.00	3.00																					
AN00221	103.60	105.72	2.12																					
AN00222	134.00	137.00	3.00																					
AN00223	158.00	161.00	3.00																					
AN00224	191.00	194.00	3.00																					

HOLE NUMBER: KTH13-01

GEOCHEMICAL ASSAYS

PAGE: 8

Report of Work Conducted After Recording Claim
Mining Act

ASSM'T FILES
Transaction Number
W9360.00035

Personal information collected on this form is obtained under the authority of the Mining Act. This information will be used for correspondence. Questions about this collection should be directed to the Provincial Manager, Mining Lands, Ministry of Northern Development and Mines, Fourth Floor, 159 Cedar Street, Sudbury, Ontario, P3E 6A5, telephone (705) 670-7264.

- Instructions:**
- Please type or print and submit in duplicate.
 - Refer to the Mining Act and Regulations for requirements of filing assessment work or consult the Mining Recorder.
 - A separate copy of this form must be completed for each Work Group.
 - Technical reports and maps must accompany this form in duplicate.
 - A sketch, showing the claims the work is assigned to, must accompany this form.

Recorded Holder(s) Falconbridge Limited		Client No. 130679
Address P.O. Box 1140, 571 Moneta Avenue, Timmins, ON, P4N 7H9		Telephone No. (705)267-1188
Mining Division Porcupine	Township/Area Keith	M or G Plan No. G-3238
Dates Work Performed From: March 19, 1992		To: March 21, 1992

Work Performed (Check One Work Group Only)

Work Group	Type
<input type="checkbox"/> Geotechnical Survey	
<input checked="" type="checkbox"/> Physical Work, Including Drilling	Diamond Drilling
<input type="checkbox"/> Rehabilitation	
<input type="checkbox"/> Other Authorized Work	
<input type="checkbox"/> Assays	
<input type="checkbox"/> Assignment from Reserve	

**ONTARIO GEOLOGICAL SURVEY
GIS - ASSESSMENT FILES
MAY 25 1993
RECEIVED**

**RECORDED
FEB 26 1993
Receipt**

Total Assessment Work Claimed on the Attached Statement of Costs \$ 10,870

Note: The Minister may reject for assessment work credit all or part of the assessment work submitted if the recorded holder cannot verify expenditures claimed in the statement of costs within 30 days of a request for verification.

Persons and Survey Company Who Performed the Work (Give Name and Address of Author of Report)

Name	Address
Norex Drilling Ltd.	P.O. Box 88 Hwy 101 E., Porcupine, ON, P0N 1C0
Jim T. Aultman (Author) Falconbridge Limited	P.O. Box 1140, 571 Moneta Avenue, Timmins, ON, P4N 7H9

(attach a schedule if necessary)

Certification of Beneficial Interest * See Note No. 1 on reverse side

I certify that at the time the work was performed, the claims covered in this work report were recorded in the current holder's name or held under a beneficial interest by the current recorded holder.	Date	Recorded Holder or Agent (Signature)

Certification of Work Report

I certify that I have a personal knowledge of the facts set forth in this Work report, having performed the work or witnessed same during and/or after its completion and annexed report is true.		
Name and Address of Person Certifying R.E. Gadzala c/o Falconbridge Limited, P.O. Box 1140, 571 Moneta Avenue, Timmins, ON, P4N 7H9		
Telephone No. (705)267-1188	Date Feb 26/93	Certified By (Signature) <i>R. E. Gadzala</i>

For Office Use Only

Total Value Cr. Recorded 10,870.⁰⁰	Date Recorded FEB. 26/93	Mining Recorder <i>[Signature]</i>	
	Deemed Approval Date MAY 27/93	Date Approved	
Date Notice for Amendments Sent			

Work Report Number for Applying Reserve	Claim Number (see Note 2)	Number of Claim Units
	P-1160693	1
	P-1160694	1
	P-1160695	1
	P-1160696	1
	P-1160697	1
	P-1160698	1
	P-1160699	1
	P-1176443	1
	P-1176444	1
	P-1176445	1
10		
Total Number of Claims		

Value of Assessment Work Done on this Claim	Value Applied to this Claim
\$10,870	Ø
\$10,870.00	Ø
Total Value Work Done	Total Value Work Applied

Value Assigned from this Claim	Reserve: Work to be Claimed at a Future Date
Ø	\$10,870
Ø	\$10,870.00
Total Assigned From	Total Reserve

Credits you are claiming in this report may be cut back. In order to minimize the adverse effects of such deletions, please indicate from which claims you wish to prioritize the deletion of credits. Please mark (✓) one of the following:

1. Credits are to be cut back starting with the claim listed last, working backwards.
2. Credits are to be cut back equally over all claims contained in this report of work.
3. Credits are to be cut back as prioritized on the attached appendix.

In the event that you have not specified your choice of priority, option one will be implemented.

Note 1: Examples of beneficial interest are unrecorded transfers, option agreements, memorandum of agreements, etc., with respect to the mining claims.

Note 2: If work has been performed on patented or leased land, please complete the following:

I certify that the recorded holder had a beneficial interest in the patented or leased land at the time the work was performed.

Signature _____ Date _____



Statement of Costs
for Assessment Credit

État des coûts aux fins
du crédit d'évaluation

Transaction No./N° de transaction
W19360.00035

Mining Act/Loi sur les mines

Personal information collected on this form is obtained under the authority of the Mining Act. This information will be used to maintain a record and ongoing status of the mining claim(s). Questions about this collection should be directed to the Provincial Manager, Minings Lands, Ministry of Northern Development and Mines, 4th Floor, 159 Cedar Street, Sudbury, Ontario P3E 6A5, telephone (705) 670-7264.

Les renseignements personnels contenus dans la présente formule sont recueillis en vertu de la Loi sur les mines et serviront à tenir à jour un registre des concessions minières. Adresser toute question sur la collecte de ces renseignements au chef provincial des terrains miniers, ministère du Développement du Nord et des Mines, 159, rue Cedar, 4^e étage, Sudbury (Ontario) P3E 6A5, téléphone (705) 670-7264.

1. Direct Costs/Coûts directs

Type	Description	Amount Montant	Totals Total global
Wages Salaires	Labour Main-d'oeuvre		
	Field Supervision Supervision sur le terrain	\$500	
Contractor's and Consultant's Fees Droits de l'entrepreneur et de l'expert- conseil	Type Drilling	\$9,737	
	Report Preparation	\$500	
			\$10,737
Supplies Used Fournitures utilisées	Type		
Equipment Rental Location de matériel	Type		
		Receipt	
Total Direct Costs Total des coûts directs			\$10,737

2. Indirect Costs/Coûts indirects

** Note: When claiming Rehabilitation work Indirect costs are not allowable as assessment work.
Pour le remboursement des travaux de réhabilitation, les coûts indirects ne sont pas admissibles en tant que travaux d'évaluation.

Type	Description	Amount Montant	Totals Total global
Transportation Transport	Type Truck Rental	\$100	
	Gas	\$33	
			\$133
Food and Lodging Nourriture et hébergement			
Mobilization and Demobilization Mobilisation et démobilisation			
Sub Total of Indirect Costs Total partiel des coûts indirects			\$133
Amount Allowable (not greater than 20% of Direct Costs) Montant admissible (n'excédant pas 20 % des coûts directs)			\$133
Total Value of Assessment Credit (Total of Direct and Allowable indirect costs)			\$10,870
Valeur totale du crédit d'évaluation (Total des coûts directs et indirects admissibles)			\$10,870

PROVINCIAL MINING DIVISION
RECEIVED
FEB 26 1993

Note: The recorded holder will be required to verify expenditures claimed in this statement of costs within 30 days of a request for verification. If verification is not made, the Minister may reject for assessment work all or part of the assessment work submitted.

Note : Le titulaire enregistré sera tenu de vérifier les dépenses demandées dans le présent état des coûts dans les 30 jours suivant une demande à cet effet. Si la vérification n'est pas effectuée, le ministre peut rejeter tout ou une partie des travaux d'évaluation présentés.

Filing Discounts

1. Work filed within two years of completion is claimed at 100% of the above Total Value of Assessment Credit.
2. Work filed three, four or five years after completion is claimed at 50% of the above Total Value of Assessment Credit. See calculations below:

Total Value of Assessment Credit	Total Assessment Claimed
	x 0.50 =

Remises pour dépôt

1. Les travaux déposés dans les deux ans suivant leur achèvement sont remboursés à 100 % de la valeur totale susmentionnée du crédit d'évaluation.
2. Les travaux déposés trois, quatre ou cinq ans après leur achèvement sont remboursés à 50 % de la valeur totale du crédit d'évaluation susmentionné. Voir les calculs ci-dessous.

Valeur totale du crédit d'évaluation	Evaluation totale demandée
	x 0,50 =

Certification Verifying Statement of Costs

I hereby certify:
that the amounts shown are as accurate as possible and these costs were incurred while conducting assessment work on the lands shown on the accompanying Report of Work form.

that as R.E. Gadzala (Senior Field Geologist) I am authorized
(Recorded Holder, Agent, Position in Company)

to make this certification

Attestation de l'état des coûts

J'atteste par la présente :
que les montants indiqués sont le plus exact possible et que ces dépenses ont été engagées pour effectuer les travaux d'évaluation sur les terrains indiqués dans la formule de rapport de travail ci-joint.

Et qu'à titre de _____ je suis autorisé
(titulaire enregistré, représentant, poste occupé dans la compagnie)

à faire cette attestation.

Signature R. E. Gadzala Date FEB 26/93

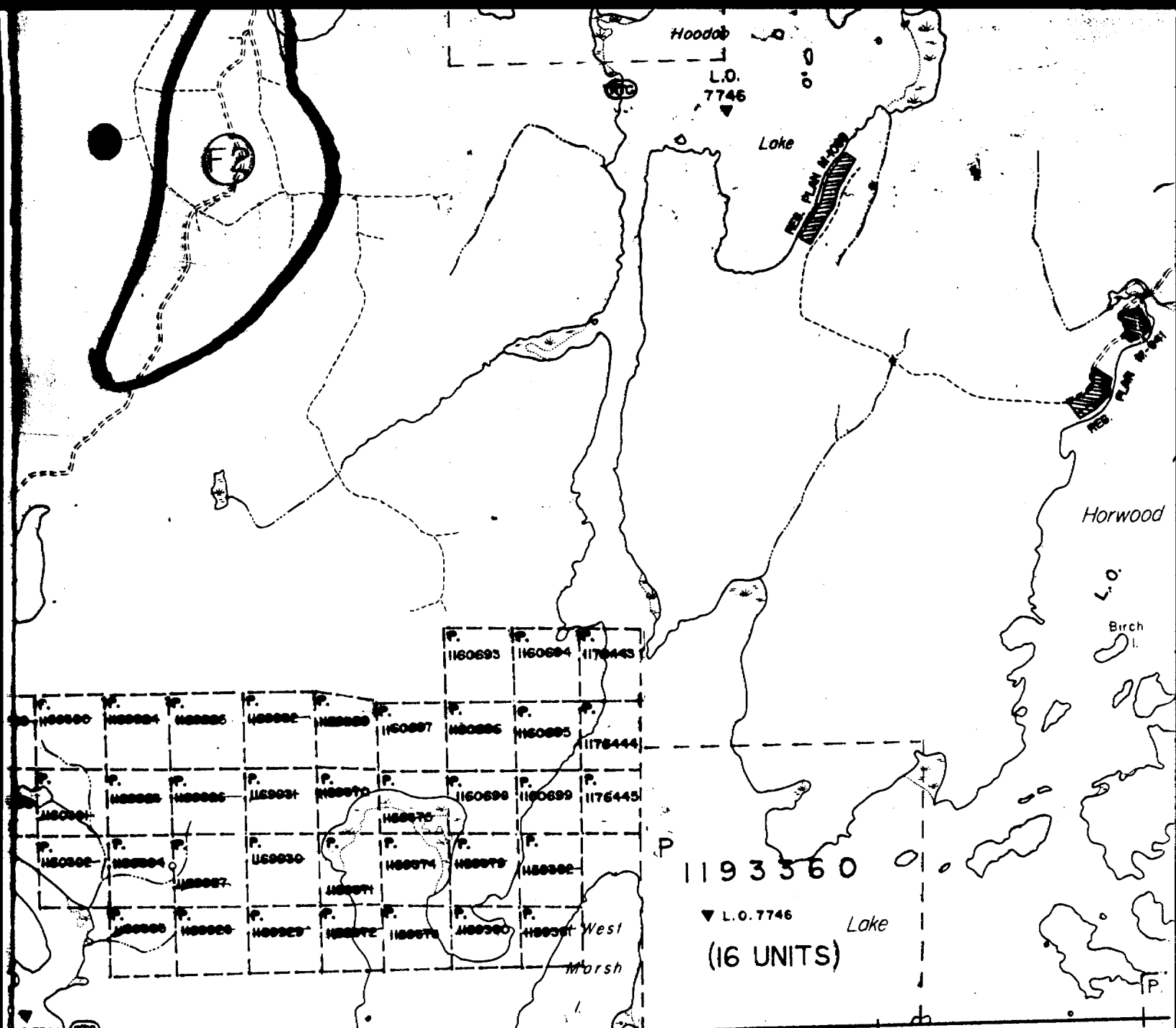

HORWOOD TWP.

C-3238

KEITH JMB

C-3238

REFERENCE

AREAS WITHDRAWN FROM DISPOSITION

M.R.O. MINING RIGHTS ONLY
 S.R.O. SURFACE RIGHTS ONLY
 M.S. - MINING AND SURFACE RIGHTS

Description	Order No.	Date	Disposition	File
(S)			S.R.O.	15263
(MNR)	RES.		S.R.O.	2247
(S)	SEC. 16/80	7/2/80	S.R.O.	18543

SAND AND GRAVEL

(M.T.C.) PIT
 (M.T.C.) PIT 3A-15
 (M.T.C.) PIT 3A-16
 (M.T.C.) PIT 1085
 (G) GRAVEL FILE 177587
 (M.N.R.) PIT 3A-1 (M.O.E. WASTE DISP. SITE)

SURVEY LINES SHOWN THUS ARE FOR CONTROL ONLY. CLAIMS CLASSIFIED AS BEING IN UNSUBDIVIDED TERRITORY - March 7, 1947. Surveyor General

FLOODING
 Flooded areas on Hoodoo & Horwood Lakes and Groundhog R. to contour elev. 1117' L.O. 7746 File: 75166

THE INFORMATION THAT APPEARS ON THIS MAP HAS BEEN COMPILED FROM VARIOUS SOURCES, AND ACCURACY IS NOT GUARANTEED. THOSE WISHING TO STAKE MINING CLAIMS SHOULD CONSULT WITH THE MINING RECORDER, MINISTRY OF NORTHERN DEVELOPMENT AND MINES, FOR ADDITIONAL INFORMATION ON THE STATUS OF THE LANDS SHOWN HEREON.

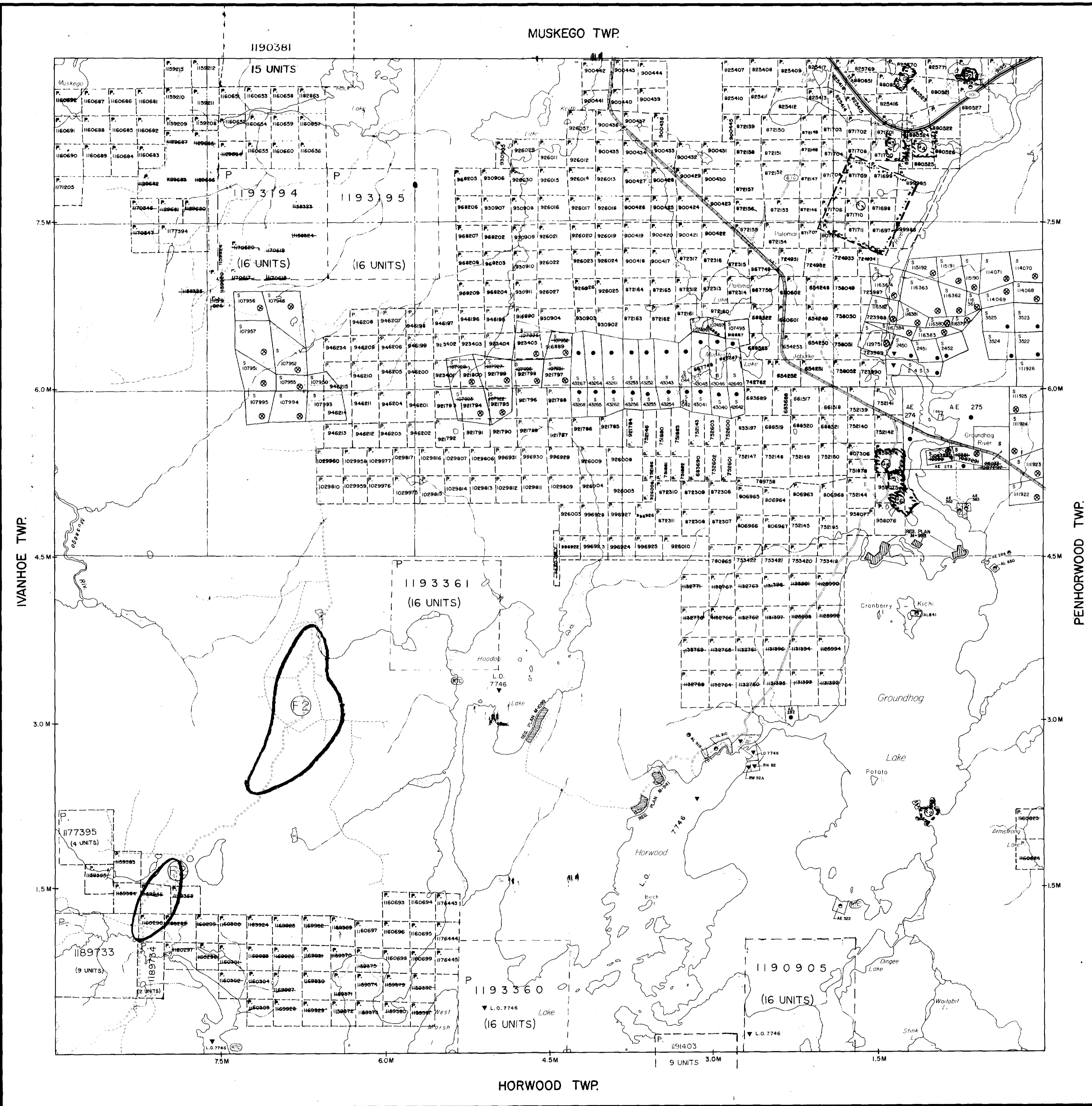

LEGEND

HIGHWAY AND ROUTE No.

OTHER ROADS

TRAILS

SURVEYED LINES: TOWNSHIPS, BASE LINES, ETC.

LOTS, MINING CLAIMS, PARCELS, ETC.

UNSURVEYED LINES: LOT LINES

PARCEL BOUNDARY

MINING CLAIMS ETC.

RAILWAY AND RIGHT OF WAY

UTILITY LINES

NON-PERENNIAL STREAM

FLOODING OR FLOODING RIGHTS

SUBDIVISION OR COMPOSITE PLAN RESERVATIONS

ORIGINAL SHORELINE

MARSH OR MUSKEG

MINES

TRAVERSE MONUMENT

DISPOSITION OF CROWN LANDS

TYPE OF DOCUMENT	SYMBOL
PATENT, SURFACE & MINING RIGHTS	(P)
" SURFACE RIGHTS ONLY	(S)
" MINING RIGHTS ONLY	(M)
LEASE, SURFACE & MINING RIGHTS	(L)
" SURFACE RIGHTS ONLY	(LS)
" MINING RIGHTS ONLY	(LM)
LICENCE OF OCCUPATION	(O)
ORDER-IN-COUNCIL	(OC)
RESERVATION	(R)
CANCELLED	(C)
SAND & GRAVEL	(G)

NOTE: MINING RIGHTS IN PARCELS PATENTED PRIOR TO MAY 6, 1913, VESTED IN ORIGINAL PATENTEE BY THE PUBLIC LANDS ACT, R.S.O. 1970, CHAP. 380, SEC. 63, SUBSEC. 1

SCALE: 1 INCH = 40 CHAINS

FEET 0 1000 2000 4000 6000 8000

METRES 0 200 400 600 800 1000 1200

(T) REMOTE TOURIST CAMPS

(F) THIS TWP. IS SUBJECT TO FOREST ACTIVITY IN 1993/94. FURTHER INFORMATION ON FILE.

RECEIVED
MAY 6 1993

TOWNSHIP
KEITH
 M.N.R. ADMINISTRATIVE DISTRICT
 CHAPLEAU MINING DIVISION
 PORCUPINE LAND TITLES / REGISTRY DIVISION
 SUDBURY

Ministry of Natural Resources
 Land Management Branch
 Ontario

Date: APRIL 1985
 Number: G-3238
 CORRECTED JUNE 30, 1992 BY D.C.

C-3238

KEITH HJTB

C-3238



34000050

5322000N



Geology
 MOUNT ROCK DIVISIONS
 10 DIABASE
 9 FELSIC INTRUSIVE ROCKS
 8 INTERMEDIATE INTRUSIVE ROCKS
 7 MAFIC INTRUSIVE ROCKS
 6 ULTRAMAFIC INTRUSIVE ROCKS
 5 SEDEXITE ROCKS
 4 FELSIC VOLCANIC ROCKS
 3 INTERMEDIATE VOLCANIC ROCKS
 2 MAFIC VOLCANIC ROCKS
 1 ULTRAMAFIC VOLCANIC ROCKS

LEGEND
TEXTURAL/GEOCHEMICAL MODIFIERS
 A Fine Grained
 B Medium Grained
 C Coarse Grained
 D Porphyritic
 E Glassy
 F Glassy
 G Pyroclastic
 H Microporous
 I Radiolarite
 J Olivine
 K Olivine
 L Olivine
 M Olivine
 N Olivine
 O Olivine
 P Olivine
 Q Olivine
 R Olivine
 S Olivine
 T Olivine
 U Olivine
 V Olivine
 W Olivine
 X Olivine
 Y Olivine
 Z Olivine

Symbols
CONTACTS
 1. Dashed line
 2. Solid line
 3. Dotted line
 4. Dotted line
 5. Dotted line
 6. Dotted line
 7. Dotted line
 8. Dotted line
 9. Dotted line
 10. Dotted line
 11. Dotted line
 12. Dotted line
 13. Dotted line
 14. Dotted line
 15. Dotted line
 16. Dotted line
 17. Dotted line
 18. Dotted line
 19. Dotted line
 20. Dotted line

PHYSICAL WORK
 X-1
 X-2
 X-3
 X-4
 X-5
 X-6
 X-7
 X-8
 X-9
 X-10
 X-11
 X-12
 X-13
 X-14
 X-15
 X-16
 X-17
 X-18
 X-19
 X-20
 X-21
 X-22
 X-23
 X-24
 X-25
 X-26
 X-27
 X-28
 X-29
 X-30
 X-31
 X-32
 X-33
 X-34
 X-35
 X-36
 X-37
 X-38
 X-39
 X-40

KEY	EASTING		INDEX MAP
	0	5	
1	390526	410526	410526 420526
2	390527	410527	410527 420527
3	390528	410528	410528 420528
4	390529	410529	410529 420529
5	390530	410530	410530 420530
6	390531	410531	410531 420531
7	390532	410532	410532 420532
8	390533	410533	410533 420533
9	390534	410534	410534 420534
10	390535	410535	410535 420535
11	390536	410536	410536 420536
12	390537	410537	410537 420537
13	390538	410538	410538 420538
14	390539	410539	410539 420539
15	390540	410540	410540 420540
16	390541	410541	410541 420541
17	390542	410542	410542 420542
18	390543	410543	410543 420543
19	390544	410544	410544 420544
20	390545	410545	410545 420545
21	390546	410546	410546 420546
22	390547	410547	410547 420547
23	390548	410548	410548 420548
24	390549	410549	410549 420549
25	390550	410550	410550 420550

CULTURAL AND PHYSIOGRAPHIC FEATURES		ASTRONOMIC	
1	1:10000	1	1
2	2:10000	2	2
3	3:10000	3	3
4	4:10000	4	4
5	5:10000	5	5
6	6:10000	6	6
7	7:10000	7	7
8	8:10000	8	8
9	9:10000	9	9
10	10:10000	10	10
11	11:10000	11	11
12	12:10000	12	12
13	13:10000	13	13
14	14:10000	14	14
15	15:10000	15	15
16	16:10000	16	16
17	17:10000	17	17
18	18:10000	18	18
19	19:10000	19	19
20	20:10000	20	20
21	21:10000	21	21
22	22:10000	22	22
23	23:10000	23	23
24	24:10000	24	24
25	25:10000	25	25

INDEX MAP

390526 410526 420526
 390527 410527 420527
 390528 410528 420528
 390529 410529 420529
 390530 410530 420530
 390531 410531 420531
 390532 410532 420532
 390533 410533 420533
 390534 410534 420534
 390535 410535 420535
 390536 410536 420536
 390537 410537 420537
 390538 410538 420538
 390539 410539 420539
 390540 410540 420540
 390541 410541 420541
 390542 410542 420542
 390543 410543 420543
 390544 410544 420544
 390545 410545 420545
 390546 410546 420546
 390547 410547 420547
 390548 410548 420548
 390549 410549 420549
 390550 410550 420550

34000050
 5322000N
 34000050
 5322000N

390526 410526 420526
 390527 410527 420527
 390528 410528 420528
 390529 410529 420529
 390530 410530 420530
 390531 410531 420531
 390532 410532 420532
 390533 410533 420533
 390534 410534 420534
 390535 410535 420535
 390536 410536 420536
 390537 410537 420537
 390538 410538 420538
 390539 410539 420539
 390540 410540 420540
 390541 410541 420541
 390542 410542 420542
 390543 410543 420543
 390544 410544 420544
 390545 410545 420545
 390546 410546 420546
 390547 410547 420547
 390548 410548 420548
 390549 410549 420549
 390550 410550 420550

PA CONCORDE LIMITED
 Exploration Division
 Keith & Horwood Twp.
DIAMOND DRILL PLAN
 (ASSAYS & GEOLOGY)

PROJ: 100057
 DATE: 10/20/2011
 TIME: 10:57:43
 DRAWN: J. M. M. / J. M. M.
 CHECKED: J. M. M. / J. M. M.
 SCALE: 1:5000
 SHEET: 100057-001
 TOTAL SHEETS: 100057-010

03 71000 21 21 11000 A4 11000 920 14 11000 920

34000050
 5322000N

5322000N
 34000050

34000050
 5322000N

400514E 400514E 400514E

DRILL PLAN 400514E

MAGNETIC RESULTS (gamma)

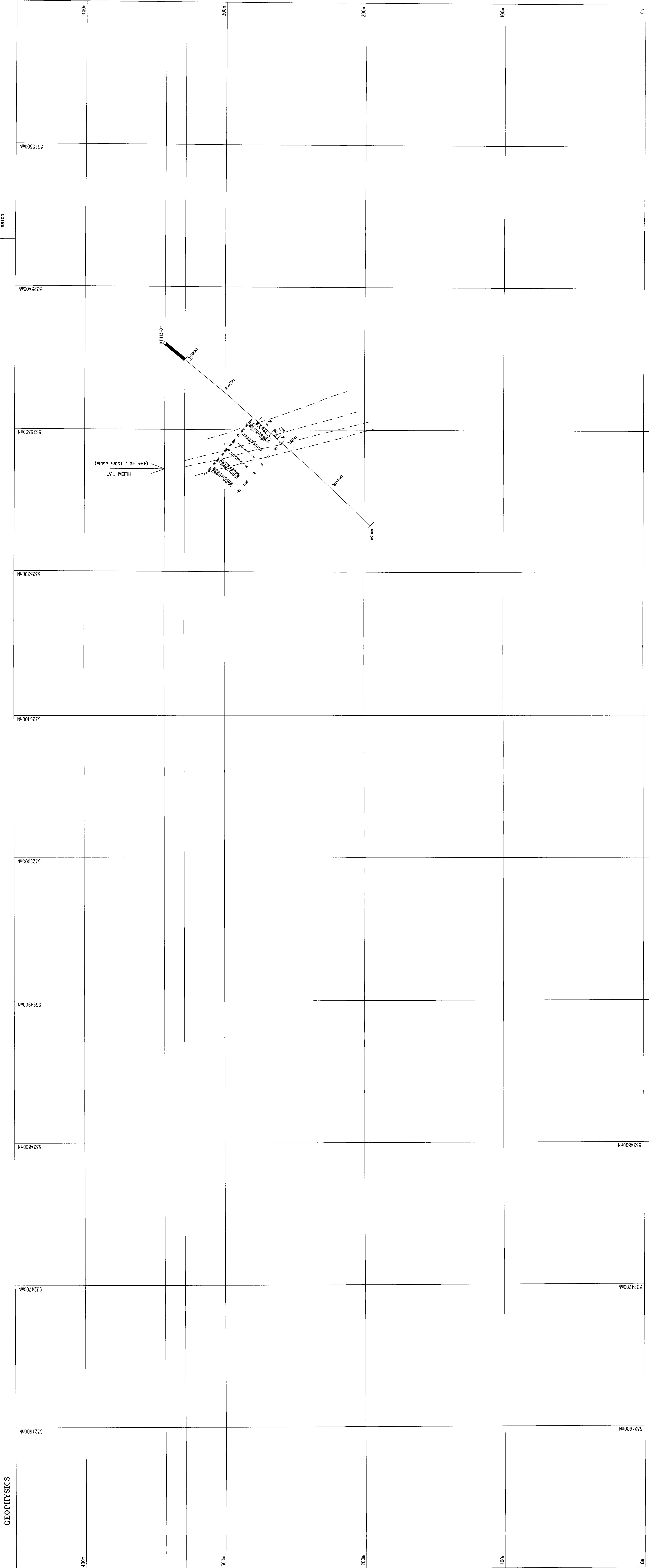
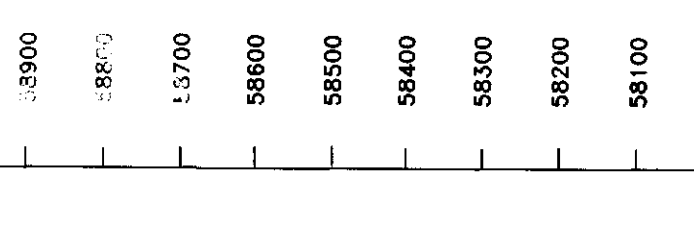

LEGEND

Geology

- MAJOR ROCK DIVISIONS
- 10 BASALT
- 9 FELSIC INTRUSIVE ROCKS
- 8 INTERMEDIATE INTRUSIVE ROCKS
- 7 MAFIC INTRUSIVE ROCKS
- 6 ULTRAMAFIC INTRUSIVE ROCKS
- 5 SEMI-METAMORPHIC ROCKS
- 4 FELSIC VOLCANIC ROCKS
- 3 INTERMEDIATE VOLCANIC ROCKS
- 2 MAFIC VOLCANIC ROCKS
- 1 ULTRAMAFIC VOLCANIC ROCKS
- TEXTURAL/GEOCHEMICAL MODIFIERS
- A Homogeneous
- B Columnar (100m)
- C Honeycombed
- D Fragmental
- E Glassy
- F Vesicular
- G Porphyritic
- H Crystalline
- I Crystalline
- J Crystalline
- K Crystalline
- L Crystalline
- M Crystalline
- N Crystalline
- O Crystalline
- P Crystalline
- ALTERATION MODIFIERS
- 1 Sericite
- 2 Chlorite
- 3 Epidote
- 4 Calcite
- 5 Dolomite
- 6 Magnetite
- 7 Hematite
- 8 Pyrite
- 9 Sphalerite
- 10 Barite
- 11石膏
- 12 重晶石
- 13 黄铁矿
- 14 方铅矿
- 15 白云石
- 16 萤石
- 17 石膏
- 18 重晶石
- 19 黄铁矿
- 20 方铅矿
- 21 白云石
- 22 萤石
- 23 石膏
- 24 重晶石
- 25 黄铁矿
- 26 方铅矿
- 27 白云石
- 28 萤石
- 29 石膏
- 30 重晶石

No.	8200		KH11-01		No.	8200		KH11-01	
	100	200	100	200		100	200	100	200
1	8300	8400	8300	8400	101	8300	8400	8300	8400
2	8300	8400	8300	8400	102	8300	8400	8300	8400
3	8300	8400	8300	8400	103	8300	8400	8300	8400
4	8300	8400	8300	8400	104	8300	8400	8300	8400
5	8300	8400	8300	8400	105	8300	8400	8300	8400
6	8300	8400	8300	8400	106	8300	8400	8300	8400
7	8300	8400	8300	8400	107	8300	8400	8300	8400
8	8300	8400	8300	8400	108	8300	8400	8300	8400
9	8300	8400	8300	8400	109	8300	8400	8300	8400
10	8300	8400	8300	8400	110	8300	8400	8300	8400
11	8300	8400	8300	8400	111	8300	8400	8300	8400
12	8300	8400	8300	8400	112	8300	8400	8300	8400
13	8300	8400	8300	8400	113	8300	8400	8300	8400
14	8300	8400	8300	8400	114	8300	8400	8300	8400
15	8300	8400	8300	8400	115	8300	8400	8300	8400
16	8300	8400	8300	8400	116	8300	8400	8300	8400
17	8300	8400	8300	8400	117	8300	8400	8300	8400
18	8300	8400	8300	8400	118	8300	8400	8300	8400
19	8300	8400	8300	8400	119	8300	8400	8300	8400
20	8300	8400	8300	8400	120	8300	8400	8300	8400
21	8300	8400	8300	8400	121	8300	8400	8300	8400
22	8300	8400	8300	8400	122	8300	8400	8300	8400
23	8300	8400	8300	8400	123	8300	8400	8300	8400
24	8300	8400	8300	8400	124	8300	8400	8300	8400
25	8300	8400	8300	8400	125	8300	8400	8300	8400
26	8300	8400	8300	8400	126	8300	8400	8300	8400
27	8300	8400	8300	8400	127	8300	8400	8300	8400
28	8300	8400	8300	8400	128	8300	8400	8300	8400
29	8300	8400	8300	8400	129	8300	8400	8300	8400
30	8300	8400	8300	8400	130	8300	8400	8300	8400

Sections pages 1-15
 1) Initial the magnetic field
 2) Initial the magnetic field
 3) Initial the magnetic field

FULL-BRIDGE LIMITED
 EXPLORATION DIVISION
 THERMANS, ONTARIO
 DIAMOND DRILL SECTION 400514E (+/-50m)
 KEITH & HERWOOD CLAIMS (LTH 13)
 LORING, ONT.
 PROJECT NO. 4005
 DRAWN BY: J.P.P. / DATE: 11/02/97 / REV. 4/02/97
 SCALE: 1:1000
 SHEET NO. 1 OF 1

Report of Work Conducted After Recording Claim

Mining Act

ASSMIT FILES
Transaction Number
W9360.00035

Personal information collected on this form is obtained under the authority of the MI this collection should be directed to the Provincial Manager, Mining Lands, Mink Sudbury, Ontario, P3E 6A5, telephone (705) 670-7264.



- Instructions:**
- Please type or print and submit in duplicate.
 - Refer to the Mining Act and Regulations for requirements of mining assessment work or contact the Mining Recorder.
 - A separate copy of this form must be completed for each Work Group.
 - Technical reports and maps must accompany this form in duplicate.
 - A sketch, showing the claims the work is assigned to, must accompany this form.

Recorded Holder(s) Falconbridge Limited		Client No. 130679
Address P.O. Box 1140, 571 Moneta Avenue, Timmins, ON, P4N 7H9		Telephone No. (705)267-1188
Mining Division Porcupine	Township/Area Keith	M or G Plan No. G-3238
Dates Work Performed From: March 19, 1992		To: March 21, 1992

Work Performed (Check One Work Group Only)

Work Group	Type
Geotechnical Survey	
Physical Work, Including Drilling	Diamond Drilling
Rehabilitation	
Other Authorized Work	
Assays	
Assignment from Reserve	

ONTARIO GEOLOGICAL SURVEY
GIS - ASSESSMENT FILES
MAY 25 1993
RECEIVED

RECORDED
FEB 26 1993
Receipt _____

Total Assessment Work Claimed on the Attached Statement of Costs \$ 10,870

Note: The Minister may reject for assessment work credit all or part of the assessment work submitted if the recorded holder cannot verify expenditures claimed in the statement of costs within 30 days of a request for verification.

Persons and Survey Company Who Performed the Work (Give Name and Address of Author of Report)

Name	Address
Norex Drilling Ltd.	P.O. Box 88 Hwy 101 E., Porcupine, ON, P0N 1C0
Jim T. Aultman (Author) Falconbridge Limited	P.O. Box 1140, 571 Moneta Avenue, Timmins, ON, P4N 7H9

(attach a schedule if necessary)

Certification of Beneficial Interest * See Note No. 1 on reverse side

I certify that at the time the work was performed, the claims covered in this work report were recorded in the current holder's name or held under a beneficial interest by the current recorded holder.	Date	Recorded Holder or Agent (Signature)
--	------	--------------------------------------

Certification of Work Report

I certify that I have a personal knowledge of the facts set forth in this Work report, having performed the work or witnessed same during and/or after its completion and annexed report is true.		
Name and Address of Person Certifying R.E. Gadzala c/o Falconbridge Limited, P.O. Box 1140, 571 Moneta Avenue, Timmins, ON, P4N 7H9		
Telephone No. (705)267-1188	Date Feb 26/93	Certified By (Signature) <i>R. Gadzala</i>

For Office Use Only

Total Value Cr. Recorded 10,870.00	Date Recorded FEB. 26/93	Mining Recorder <i>B. White</i>	
	Deemed Approval Date MAY 27/93	Date Approved	
	Date Notice for Amendments Sent		

Work Report Number for Applying Reserve	Claim Number (see Note 2)	Number of Claim Units
---	---------------------------	-----------------------

Value of Assessment Work Done on this Claim	Value Applied to this Claim
---	-----------------------------

Value Assigned from this Claim	Reserve: Work to be Claimed at a Future Date
--------------------------------	--

	P-1160693	1
--	-----------	---

	P-1160694	1
--	-----------	---

	P-1160695	1
--	-----------	---

	P-1160696	1
--	-----------	---

	P-1160697	1
--	-----------	---

	P-1160698	1
--	-----------	---

	P-1160699	1
--	-----------	---

	P-1176443	1
--	-----------	---

	P-1176444	1
--	-----------	---

	P-1176445	1
--	-----------	---

--	--	--

--	--	--

--	--	--

--	--	--

--	--	--

--	--	--

--	--	--

Total Number of Claims

10

Total Value Work Done

\$10,870.00

Total Value Work Applied

0

Total Assigned From

0

Total Reserve

\$10,870.00

Credits you are claiming in this report may be cut back. In order to minimize the adverse effects of such deletions, please indicate from which claims you wish to prioritize the deletion of credits. Please mark (✓) one of the following:

- 1. Credits are to be cut back starting with the claim listed last, working backwards.
- 2. Credits are to be cut back equally over all claims contained in this report of work.
- 3. Credits are to be cut back as prioritized on the attached appendix.

In the event that you have not specified your choice of priority, option one will be implemented.

Note 1: Examples of beneficial interest are unrecorded transfers, option agreements, memorandum of agreements, etc., with respect to the mining claims.

Note 2: If work has been performed on patented or leased land, please complete the following:

I certify that the recorded holder had a beneficial interest in the patented or leased land at the time the work was performed.

Signature

Date



Statement of Costs for Assessment Credit

État des coûts aux fins du crédit d'évaluation

Mining Act/Loi sur les mines

Transaction No./N° de transaction
W9360.00035

Personal information collected on this form is obtained under the authority of the Mining Act. This information will be used to maintain a record and ongoing status of the mining claim(s). Questions about this collection should be directed to the Provincial Manager, Minings Lands, Ministry of Northern Development and Mines, 4th Floor, 159 Cedar Street, Sudbury, Ontario P3E 6A5, telephone (705) 870-7264.

Les renseignements personnels contenus dans la présente formule sont recueillis en vertu de la Loi sur les mines et serviront à tenir à jour un registre des concessions minières. Adresser toute question sur la collecte de ces renseignements au chef provincial des terrains miniers, ministère du Développement du Nord et des Mines, 159, rue Cedar, 4^e étage, Sudbury (Ontario) P3E 6A5, téléphone (705) 870-7264.

1. Direct Costs/Coûts directs

Type	Description	Amount Montant	Totals Total global
Wages Salaires	Labour Main-d'oeuvre		
	Field Supervision Supervision sur le terrain	\$500	
Contractor's and Consultant's Fees Droits de l'entrepreneur et de l'expert-conseil	Type		
	Drilling	\$9,737	
	Report Preparation	\$500	
			\$10,737
Supplies Used Fournitures utilisées	Type		
Equipment Rental Location de matériel	Type		
Total Direct Costs Total des coûts directs			\$10,737

2. Indirect Costs/Coûts indirects

** Note: When claiming Rehabilitation work indirect costs are not allowable as assessment work. Pour le remboursement des travaux de réhabilitation, les coûts indirects ne sont pas admissibles en tant que travaux d'évaluation.

Type	Description	Amount Montant	Totals Total global
Transportation Transport	Type		
	Truck Rental	\$100	
	Gas	\$33	
			\$133
Food and Lodging Nourriture et hébergement			
Mobilization and Demobilization Mobilisation et démoblisation			
Sub Total of Indirect Costs Total partiel des coûts indirects			\$133
Amount Allowable (not greater than 20% of Direct Costs) Montant admissible (n'excédant pas 20 % des coûts directs)			\$133
Total Value of Assessment Credit (Total of Direct and Allowable indirect costs) Valeur totale du crédit d'évaluation (Total des coûts directs et indirects admissibles)			\$10,870

Note: The recorded holder will be required to verify expenditures claimed in this statement of costs within 30 days of a request for verification. If verification is not made, the Minister may reject for assessment work all or part of the assessment work submitted.

Note : Le titulaire enregistré sera tenu de vérifier les dépenses demandées dans le présent état des coûts dans les 30 jours suivant une demande à cet effet. Si la vérification n'est pas effectuée, le ministre peut rejeter tout ou une partie des travaux d'évaluation présentés.

Filing Discounts

- Work filed within two years of completion is claimed at 100% of the above Total Value of Assessment Credit.
- Work filed three, four or five years after completion is claimed at 50% of the above Total Value of Assessment Credit. See calculations below:

Total Value of Assessment Credit	Total Assessment Claimed
	× 0.50 =

Remises pour dépôt

- Les travaux déposés dans les deux ans suivant leur achèvement sont remboursés à 100 % de la valeur totale susmentionnée du crédit d'évaluation.
- Les travaux déposés trois, quatre ou cinq ans après leur achèvement sont remboursés à 50 % de la valeur totale du crédit d'évaluation susmentionné. Voir les calculs ci-dessous.

Valeur totale du crédit d'évaluation	Evaluation totale demandée
	× 0,50 =

Certification Verifying Statement of Costs

I hereby certify: that the amounts shown are as accurate as possible and these costs were incurred while conducting assessment work on the lands shown on the accompanying Report of Work form.

that as R.E. Gadzala (Senior Field Geologist) I am authorized (Recorded Holder, Agent, Position in Company)

to make this certification

Attestation de l'état des coûts

J'atteste par la présente : que les montants indiqués sont le plus exact possible et que ces dépenses ont été engagées pour effectuer les travaux d'évaluation sur les terrains indiqués dans la formule de rapport de travail ci-joint.

Et qu'à titre de _____ je suis autorisé (titulaire enregistré, représentant, poste occupé dans la compagnie)

à faire cette attestation.

Signature R. Gadzala Date Feb 26/93

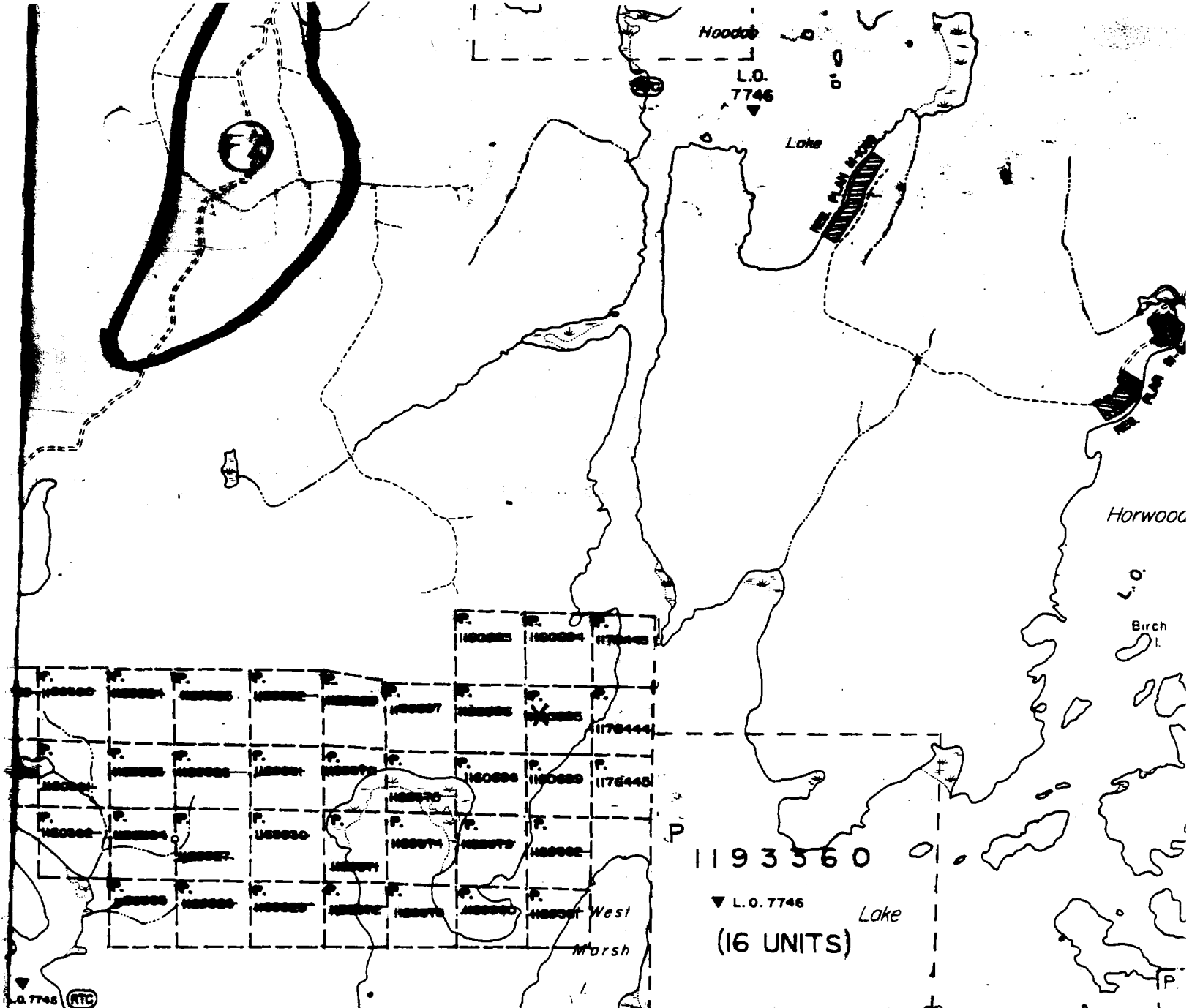

HORWOOD TWP.