



42B06SW0003 11 LLOYD

010

Diamond Drilling

Township OF LLOYD

Report NO: 11

Work performed by: H. D. CARLSON

Claim NO	Hole NO	Footage	Date	Note
P. 256332	1	64	July-Aug/70	(1)
	3	53	July-Aug/70	(1)
		<u>117</u>		

Notes: (1) 21/72

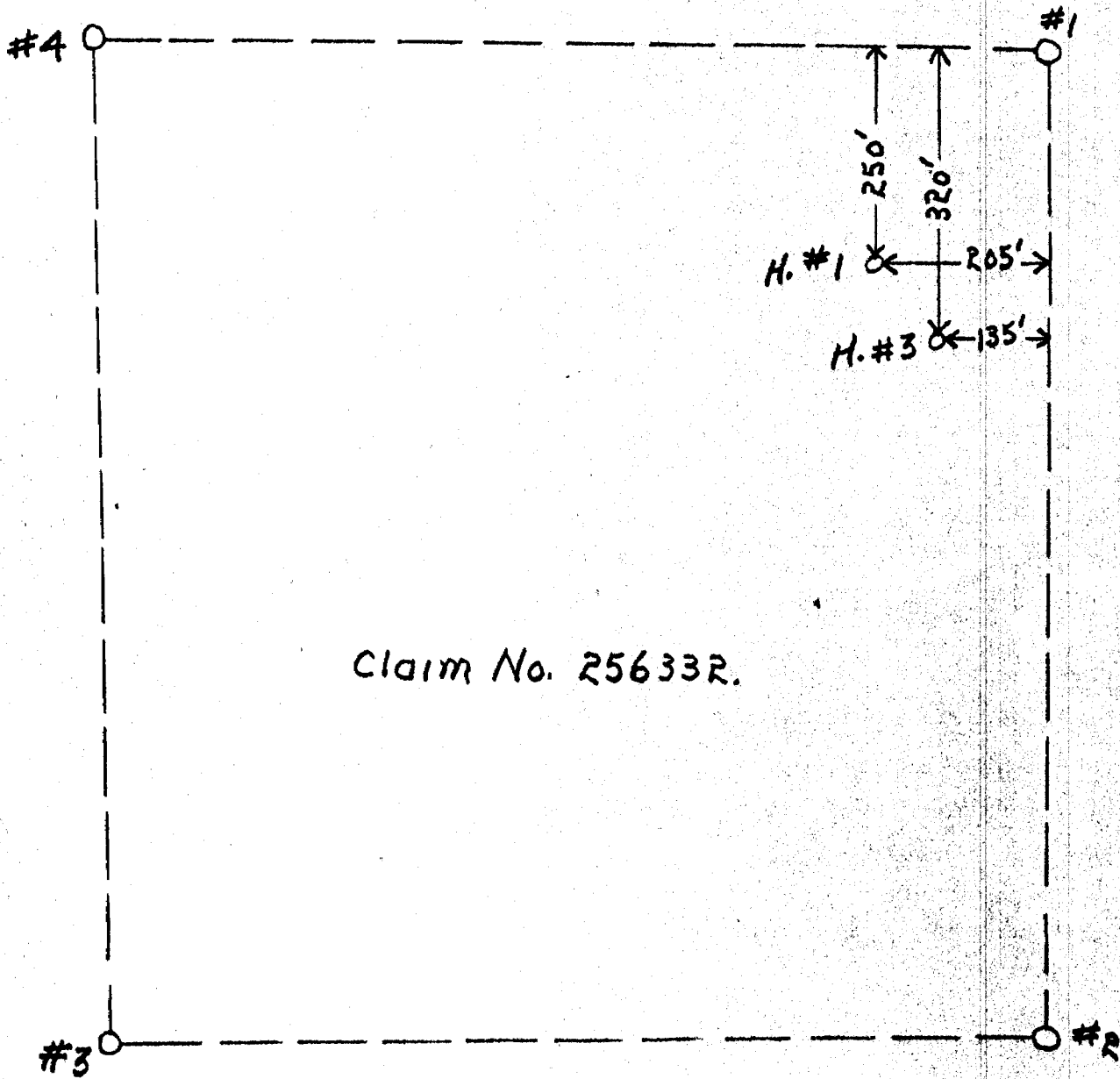

SKetch showing locations of
D.D.H. #1 and #3 on MARTEL
Property, Lloyd twp., Ontario.

Scale: 1 inch = 200 feet.

Claim No. R56332 Lloyd twp., Ontario.

Inclination: - 90°.

Date drilled: July-August, 1970.

Drilled by: Groleau Drilling Ltd.

Logged by: H. Carlson.

MARTEL: HOLE NO. 1

- 0.0 collar
- 2.3 start of core
- 5.6 mineralized very weakly: hornblende granite; biotite and garnet rich, coarse grain, black and white, sheared, slightly foliated at 70°, banded and disseminated pyrrhotite 5%-8%
sample number 14
- 5.9 granite, coarse grain, grey, large crystals of hornblende and feldspar
- 8.0 biotite hornblende gneiss; medium to coarse grain, grey to black, foliated at 70° - 80°, sheared and altered
sample number 15
- 10.1 lost core
- 29.6 hornblende granite; coarse grain, grey to black, very siliceous, occasional bands of hornblende schist, locally sheared at 80°, trace of mineralization at shears
- 33.8 hornblende quartz gneiss; coarse grain, black, foliated at 70°
- 48.1 hornblende granite, medium grain, black to white, occasional quartz bands
- 56.1 hornblende quartz gneiss; medium to coarse grain, white to black, foliated and banded at 70°, altered biotite
- 61.1 ditto
sample number 16
- 61.6 mineralized weakly: same as above; bands of pyrrhotite, 20%-25% sulphide
sample number 17
- 64.0 same as above; no mineralization
sample number 18
- 64.0 foot of hole

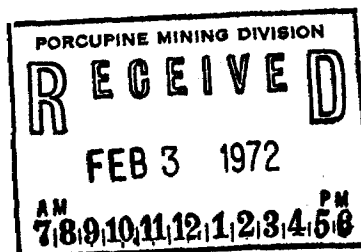

21172 Lloyd Twp
H. Carlson

HOLE NO. 1

<u>Sample No.</u>	<u>Copper</u>	<u>Nickel</u>	<u>Cobalt</u>	<u>Zinc</u>	<u>Precious Metals</u>
14	.01	.02	.003	4.05	nil
15	.01	.02	.002	4.05	nil
16	.02	.01	.002	4.05	nil
17	.03	.02	.003	4.05	nil
18	.03	.03	.003	4.05	nil

Claim No. 256332 Lloyd twp., Ontario.

Inclination: -90°

Date drilled: July-August, 1970.

MARTEL: HOLE NO. 3

Drilled by: Groleau Drilling Ltd.

Logged by: H. Carlson.

- 0.0 collar
- 6.0 start of core, overburden, sand, gravel, boulders
- 9.8 granite; grey to black, medium grain, slightly foliated, very siliceous
sample number 8
- 12.7 mineralized very very weakly: granite; coarse grain, grey, very siliceous, garnet crystals and inclusions, traces of disseminated pyrrhotite and pyrite
sample number 9
- 17.7 hornblende granite; grey to black, medium grain, large crystals and bands of hornblende, locally large crystals of feldspar
sample number 10
- 32.2 same as above
- 36.5 granite; coarse grain, black to white, massive feldspar, biotite, quartz, hornblende, sheared at 70°
- 40.8 metasediment; grey, fine to medium grain, foliated and banded at 65° - 70°, high feldspar, hornblende and quartz
- 53.0 granite, grey, medium grain, high feldspar, quartz, minor hornblende
- 53.0 foot of hole

HOLE NO. 3

<u>Sample No.</u>	<u>Copper</u>	<u>Nickel</u>	<u>Cobalt</u>	<u>Zinc</u>	<u>Precious Metals</u>
8	∠.05	∠.05	.003	∠.05	nil
9	∠.05	∠.05	.003	∠.05	nil
10	∠.05	∠.05	.003	∠.05	nil