



DIAMOND DRILLING 1994
MONTCALM NI-CU PROPERTY

DRILL HOLES: M-55
M-61
M-62
M-67

March 1995
I. Haga



TABLE OF CONTENTS

1. Introduction.
2. Location and Access.
3. Topography.
4. Property.
5. Geology.
6. Results of Drilling.

LIST OF FIGURES

1. Location and Access.

APPENDICES

- | | | |
|------------|---|----------------------|
| Appendix A | - | Diamond Drill Logs. |
| Appendix B | - | Drilling Plan Map. |
| Appendix C | - | Drill Hole Sections. |
| Appendix D | - | Expense Detail. |



1. **INTRODUCTION**

This is a report on diamond drilling carried out by Outokumpu Mines Ltd. on the Montcalm nickel-copper property. Drill holes reported on here, M-55, -61, -62 and -67 are part of a major drilling program undertaken on the property in 1994. The drilling program investigated the potential for nickel-copper mineralization below known sulphide lenses.

2. **LOCATION AND ACCESS**

The Montcalm nickel-copper property is located in Montcalm Township approximately 60 (air) kms) northwest of Timmins, Ontario. The property can be reached from Timmins by a 91 kilometre combination of paved highway and all-weather forestry road (Fig. 1).

3. **TOPOGRAPHY**

The Montcalm property area lies within the Abitibi Clay Belt, a feature which was formed when a large Wisconsin-age glacial lake covered the region. The irregular bedrock surface is covered by tills, sands and gravels and varved clays to a depth of 40m.

Due to the flatness of the area and the underlying impermeable clays, drainage is poor and the area is characterized by boggy muskeg conditions. Montcalm Creek, a narrow meandering stream generally less than 0.60 m deep, drains the property area.



4. **PROPERTY**

In September 1993, Outokumpu Mines Ltd. entered into an option agreement with the owners of the Montcalm property (Teck Corp. Metall Mining Corp., Domik Exploration and CS Resources) to acquire 100% interest in certain claims in Montcalm Twp. These claims are registered in the name of Teck Corporation.

5. **GEOLOGY**

The Montcalm property is located near the west end of the Abitibi Greenstone Belt. The greenstone belt consists largely of metavolcanic rocks, predominantly andesite, with interbedded metasediments including graphitic argillite.

In the Montcalm area, the metavolcanics are intruded by an arcuate intrusion of mafic and ultramafic rocks called the Montcalm Gabbroic Complex. The Montcalm claims are almost entirely underlain by this mafic-ultramafic complex.

Detailed mapping (based on diamond drilling) indicate that the rocks exhibit a wide variation from drill hole to drill hole. Variations occur in texture from fine grained to pegmatitic, equigranular to brecciated and in composition from relatively felsic to ultramafic and anorthositic. Due to scarcity of outcrop in the area, structured information can only be inferred. Faulting and fracturing is observed in the drill core but there is no evidence for large scale displacement.



The Montcalm deposit consists of three steeply dipping, irregularly shaped sulphide-rich lenses which are separated by granitic or grandioritic dykes. The sulphide lenses are hosted by medium-to-coarse grained gabbro.

6. **RESULTS OF DRILLING**

Holes M-55, -61, -62 and -67 were all drilled to explore potential extensions (at depth or along strike) for previously outlined sulphide mineralization. Detailed logs are presented in Appendix A and projections of drill holes in Appendix B.

Drilling has indicated overburden thickness varying from 17 m to 34 m. From bedrock to surface, four distinct layers were encountered: from bottom to top, these are: sand or sandy till, gravel and boulder-bearing gravel, varved and silty clays, muskeg/humus.

None of the holes intersected any nickel sulphide mineralization. All three holes, however, contain narrow intersections at 2-3% disseminated pyrrhotite and/or pyrite in gabbro and occasionally pyrite/pyrrhotite veinlets in mafic dykes. Assaying returned base metal values which are of no economic interest.

Drilling.407

MONTCALM PROI

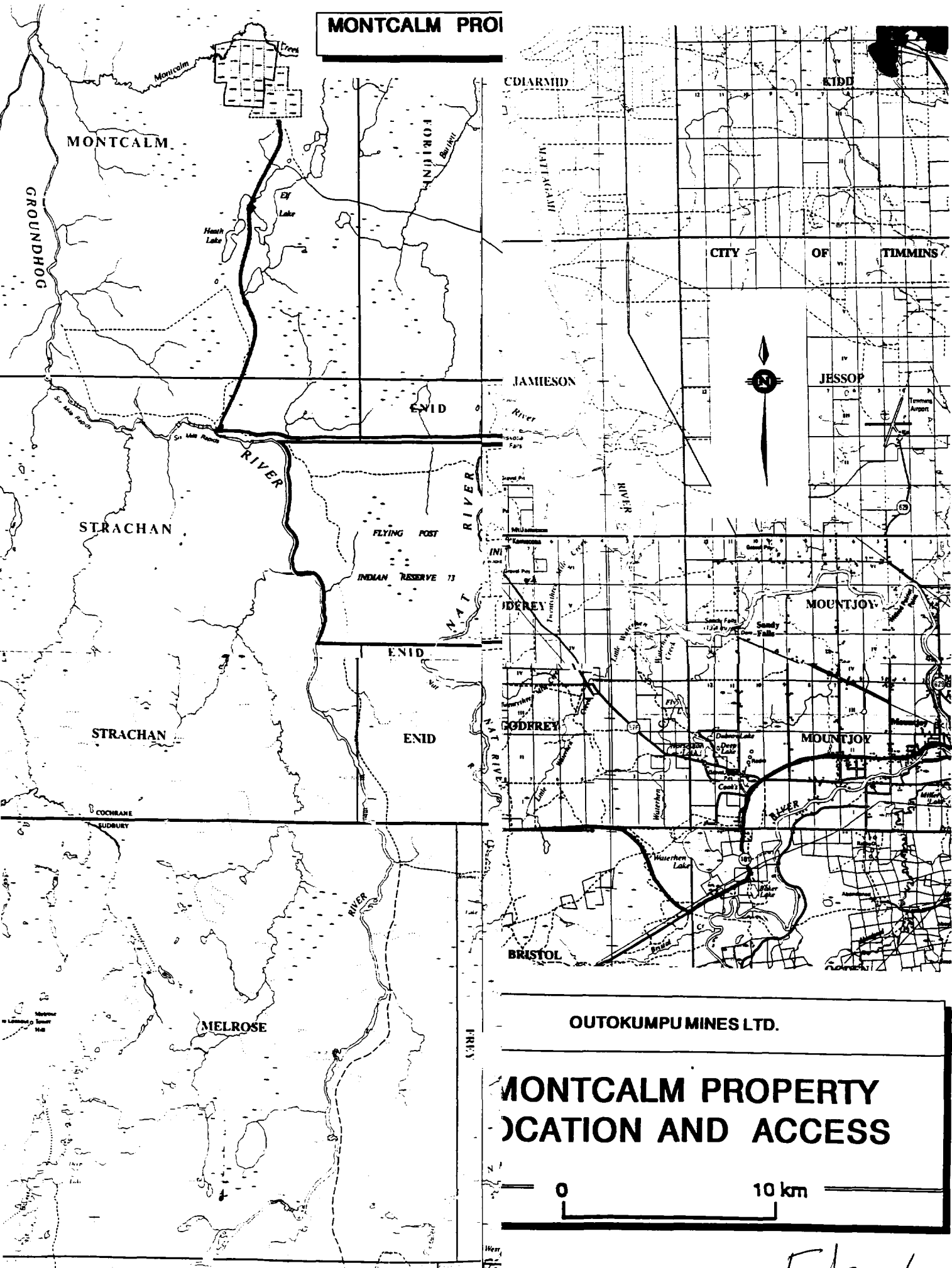

OUTOKUMPU MINES LTD.

**MONTCALM PROPERTY
LOCATION AND ACCESS**

0 10 km

Fig. 1



APPENDIX A



MONTCALM

Drill Section, E-W, Outokumpu Grid

Scale 1:1,000

Drill Hole Parameters,

Assays Ni%
Bar Scale 6% = 1 cm

gb = gabbro
py - pxd = pyroxenite - pyroxenitic dyke
um = ultramafic
mad = mafic dyke
acd = actinolite dyke
fed = feldspar dyke
fpd = feldsparporphyry
qfpd = quartzfeldsparporphyry
gr = granite
grdr = granodiorite
myl = mylonitic
m = meta
ms = massive sulphide
pyr = pyrite
po = pyrrhotite
pn = pentlandite

--	--

Area/Township	N.T.S.	Claim Map	Claim No.	Year	Project
Montcalm	42 B/NE	G-1182	437993	1994	Montcalm

Symbol	Hole No	Bearing Survey Grid °/Grad	Bearing N.T.S. Grid °/Grad
M	55	90	90

Co-ordinates: X/M	m	cm	Co-ordinates: Y/L	m	cm	Co-ordinates: Z	m	cm
7024.98 N / 191.49 N			1024.90 E / 62.86 W			5000		

Logged By	Date	Drilled By	Core Size	Started	Finished	Hole Length
P. Davis	July 13, 1994	Bradley	BQ	June 1, 1994	June 6, 1994	377.0 m
Remarks: Core stored at Hollinger Building, Timmins, Ontario.						

Paul

Depth m	Dip	Azimuth	Depth m	Dip	Azimuth	Depth m	Dip	Azimuth	Depth	Dip	Azimuth
0	-48.56	090.00	228.6	-47.42	090.40						
15.2	-49.99	091.11	243.8	-47.34	090.57						
30.5	-49.75	091.00	259.1	-47.36	090.50						
45.7	-49.43	090.89	274.3	-47.42	090.57						
61.0	-49.19	091.31	289.6	-47.35	090.86						
76.2	-49.13	091.53	304.8	-47.21	090.50						
91.4	-48.86	091.38	320.0	-47.03	090.82						
106.7	-48.72	091.27									
121.9	-48.57	090.89									
137.2	-48.21	091.04									
152.4	-47.99	090.91									
167.6	-47.87	091.11									
182.9	-47.62	091.05									
198.1	-47.57	090.78									
213.4	-47.64	090.50									

Depth	Assay No.	Rock Type	Description	Rock Types	Core Angle	RQD	Assay Type
31.0		casing					
39.5	GB 90440 90441 90442	GB + PO	4-7% vein assoc. PO,CP,PY,PN?, slightly weathered and sheared 31.0-34.0 90440 34.0-37.0 90441 37.0-39.5 90442 38.8-38.9 Fault Gouge	4	50		
41.4		FED	massive-wkly fol., aphan., light grey, minor crenulation fold, GB inclusions, minor rusty weathering	10	60		
62.0	90443	GB	wkly fol., 10-40% plag. (1-3mm), chlorite and weak epidote alt. 42.75-43.5 FED 46.25-47.0 " " 59.0-62.0 <1% veined PO,PY,PN 56.0-62.0 strong chlorite alt.	2, 3b	65		
84.75		GR	massive, m.g., light pink 10-60% blue qtz	10			
287.1		GB	wkly. fol., 5-70% plag. (1-5mm), chloritized matrix, some zones are almost anorthositic in comp., qtz-plag. veining 91.0-91.9 GR dike; m.g. 96.9-97.3 +PO; 5% vein assoc. PO,PY 97.3-104.0 <1% diss. PO,PY 104.0-104.6 +PO, 2-5% vein assoc. PY,PO,CP		60		

Handwritten signature

Depth	Assay No.	Rock Type	Description	Rock Types	Core Angle	RQD	Assay Type
	90450		104.6-115.3 <1% diss. PO,PY				
	90451		115.3-116.3 +PO, 2-3% vein assoc. PY,PO,CP				
	90452		124.7-128.1 <1% diss. + veinlet PO,PY				
	90453		107.3-110.3 90450				
	90454		110.3-113.0 90451				
	90455		113.0-115.3 90452				
	90456		115.3-116.3 90453				
			124.7-126.2 90454				
			126.2-128.1 90455				
			157.8-159.4 90456; <1% PY,PO - veinlet assoc.				
			177.6-178.25 MAD				
			200.3-202.1 CR dike				
			203.1-205.3 FED				
			206.05-206.6 CR dike				
			207.0-207.2 " " "				
			207.6-208.3 " " "				
			208.5-208.65 " " "				
			214.0-229.0 Fault Zone; rubbly core				
			229.0-230.75 FED				
			231.0-252.2 25-70% feldspar, 2-8mm, mostly altered to salmon coloured (iron stained)				
			252.2-263.64 Fault Zone?; rubbly core with fault gouge patches at 263.5-263.4				
			258.0-261.8 MAD <0.1% diss. PY				
			264.7-268.0 MAD <0.5% PY blebs in veins				
			275.0-279.9 MAD; 1-2% PO,PY diss.				
	90457		275.0-278.0 90457				
	90458		278.0-279.9 90458				

Paul

Depth	Assay No.	Rock Type	Description	Rock Types	Core Angle	RQD	Assay Type
339.4		GR		10	50		
355.1		MAD	f.g., dark grey to black. 344.3-345.3 sericitized zones (rock is greenish grey) <0.1% PY 349.2-350.0 " " " " "	8			
368.1		GR	massive, m.g. feldspars (30-70%, 1-7mm), vary from pink to white; blue qtz (10-30%) often stretched 30-60 deg. to C.A.	10	50		
377.0		MAD	f.g., dark grey, tr. diss. PY 377.0 end of hole	8			

Paul

--	--

Area/Township	N.T.S.	Claim Map	Claim No.	Year	Project
Montcalm	42 B/NE	G-118a	Y37992	1994	Montcalm

Symbol	Hole No	Bearing Survey Grid °/Grad	Bearing N.T.S. Grid °/Grad
M	61	90?	111

Co-ordinates: X/M	m	cm	Co-ordinates: Y/L	m	cm	Co-ordinates: Z	m	cm
25.00 S	/	7000 N	175.00 W	/	847.50 E	5000		

Logged By	Date	Drilled By	Core Size	Started	Finished	Hole Length
P.Davis	Aug 9, 1994	Bradley	NQ	July 21, 1994	July 28, 1994	461.0 m

Remarks: Core stored at Hollinger Building, Timmins, Ontario.

Paul

Depth m	Dip	Azimuth	Depth m	Dip	Azimuth	Depth	Dip	Azimuth	Depth	Dip	Azimuth
0	-66.5	111.30	320	-62.6	110.55						
15	-65.7	110.87	366	-62.9	108.25						
30	-65.8	111.48	381	-62.2	110.17						
46	-65.5	109.87									
61	-65.9	108.82									
76	-65.4	111.04									
91	-65.6	110.53									
107	-64.9	110.57									
137	-64.6	109.49									
168	-64.1	106.82									
183	-64.0	105.74									
229	-63.8	106.54									
259	-63.2	109.38									
274	-63.6	109.98									
305	-62.9	109.49									

Depth	Assay No.	Rock Type	Description	Rock Types	Core Angle	RQD	Assay Type
37.0		casing					
44.5		GB	mass.-mod. fol., med.-dark grey, f.g.-m.g., 10-30% anhedral plag.	3	50		
58.95		FP Mylonitized	mod.-strongly fol., 5-10% blue qtz eyes, 10-20% relict plag., <1.0% diss. cubic PY, core mod. rubbled, possible Fault Zone.	7	45		
96.8		GB	as from 37.0-44.5; numerous FEDs	3	45		
117.10		Mylonite	strong penetrative cleavage, aphan., brown-pink, GB inclusions	12	60		
129.5		GB	as from 37.0-44.5; numerous x-cutting FEDs and MADs	3	55		
137.4		MAD	mass., dark grey, f.g.-m.g., 10-20% dark phenocr., 1-2% cubic PY diss. throughout	8			
192.5		GB	wkly fol., m.g., med. grey, 15-30% anhedral plag., chloritized matrix 138.5-139.2 FPD 181.25-181.7 FEDs 182.45-185.8 " " 188.0-189.15 " "	3	65		
210.8		GR	mass.-wkly fol., f.g.-m.g., red-pink, 1-5% qtz eyes, GB inclusions, x-cutting felsic dikes, <1.0% cubic PY 203.4-204.05 MAD with 2-3% diss. PO.PY	10	55		
263.65		GB	as from 137.4-192.5	3	60		

Depth	Assay No.	Rock Type	Description	Rock Types	Core Angle	RQD	Assay Type
266.75	0101	+PO	252.65-253.1 Fault Gouge 253.1-256.5 rubbly core	4			
270.5		GB	10-15% mass., diss., net-textured PO,PY,PN?,CP	3	60		
272.8	0102	+PO	as from 137.4-192.5	8			
273.85		GB	2-3% diss. PO,PY	3	60		
274.9	0103	+PO	as from 137.4-192.5	8			
363.3		GB	2-3% diss. PO,PY	3			
			as from 137.4-192.5				
			274.9-281.5 Fault Zone?, rubbly core numerous barren MADs				
			321.0-332.4 1-2% diss. PO,PY				
			321-324 0113				
			324-327.4 0114				
			327.4-330.4 0115				
			330.4-332.4 0116				
			341-344 0117				
			344-345.5 0118				
			341.0-345.5 1-2% diss. PO,PY				
			359.0-363.3 1-2% diss. PO,PY				
			359-361 0104				
			361-363.3 0105				
366.3	0106	+PO	2-3% diss. and net-textured PO,PY,PN?	4			
371.0	0119 0107	GB	as from 137.4-192.5; <1.0% diss. PO,PY 366.3-368 0119 368-371 0107	3, 2	50		

Paul

Depth	Assay No.	Rock Type	Description	Rock Types	Core Angle	RQD	Assay Type
379.8		+PO	2-7% diss. and vein assoc. PO,PY,PN?; possibly relict clasts of siliceous iron Formation with fold features and brittle faulting 371-374 0108 374-377 0109 377-379.8 0110	4			
382.15	0111	+MS	25-30% mass., net-textured and diss. PO,PY,PN? 380-380.2 Fault Zone?, rubbly core	4			
385.0	0112	+PO	2-3% diss. and vein-assoc. PO,PY,CP,PN?	3, 2	55		
441.7		GB	wkly fol., m.g., med. grey, 10-20% anhedral plag., chloritized matrix 385-378.0 <1.0% diss. PO,PY 432-433.3 MAD 434.6-436.8 " "	3	60		
461.0		FED mylonitized	strong penetrative cleavage, pink, aphanitic, GR inclusions 445.45-446.5 MAD 441.7-442.7 Fault Zone; rubbly core	12	45		
			461.0 end of hole				

--	--

Area/Township	N.T.S.	Claim Number	Year	Project
Montcalm	42 B/NE	479951	1994	Montcalm

Symbol	Hole No	Bearing Survey Grid °/Grad	Bearing N.T.S. Grid °/Grad
M	62	90	90

Co-ordinates: X/M	m	cm	Co-ordinates: Y/L	m	cm	Co-ordinates: Z	m	cm
7100.00 N / -			1800.00 E / -			5000		

Logged By	Date	Drilled By	Core Size	Started	Finished	Hole Length
P.Davis	Aug 10, 1994	Bradley	BQ	June 28, 1994	July 16, 1994	653.0 m

Remarks: Core stored at Hollinger Building, 637 Algonquin Blvd. E., Timmins, Ont.

I

Depth	Assay No.	Rock Type	Description	Rock Types	Core Angle	RQD	Assay Type
14.0		casing					
497.1		GR	mass.-wkly fol., mg.-f.g., light speckled grey or slightly pink, 20-30% anhedral plag., 10-20% Qtz, 20-30% mafic minerals, variable chlorite alt., numerous x-cutting FEDs and MADs 14.0-25.0 rubbly core 295.1-295.7 Fault Zone; fault gouge 295.7-299.0 " " " " 296.15-497.1 strong hematite alt. 301.4-301.45 Fault Gouge 319.4-319.6 Fault Gouge 335.2-362.0 rubbly core 373.0-393.0 blocky core 381.85-383.8 Fault Gouge 393.0-397.5 rubbly core 397.5-404.0 blocky core 429.5-432.0 rubbly core	10	60		
533.2		GB	wkly-mod. fol., f.g-m.g., dark green grey, 2-5% anhedral plag., blocky core, <0.1% diss. PO	2, 4	50		
653.0		GR	massive, m.g., grey to pink, 5-10% Qtz eyes (3-6mm), few x-cutting MADs 643.55-646.0 Fault Zone?, rubbly core, fault gouge	10			
			653.0 end of hole				

Paul

--	--

Area/Township	N.T.S.	Clash Map	Clash No.	Year	Project
Montcalm	42 B/NE	G-1182	437995	1994	Montcalm

Symbol	Hole No	Bearing Survey Grid °/Grad	Bearing N.T.S. Grid °/Grad
M	67	90	90

Co-ordinates: X/M	m	cm	Co-ordinates: Y/L	m	cm	Co-ordinates: Z	m	cm
6600.00 N			984.00 E			5000		

Logged By	Date	Drilled By	Core Size	Started	Finished	Hole Length
P. Davis	Aug 3, 1994	Bradley	BQ	July 25, 1994	July 28, 1994	269.0 m

Remarks: Core stored at Hollinger Building, Timmins, Ontario.

Paul

Depth	Assay No.	Rock Type	Description	Rock Types	Core Angle	RQD	Assay Type
42.0		casing					
54.5		GR	m.g., 20-35% blue qtz, 2-7mm; 25-40% white-salmon pink feldspar (3-8mm); f.g. 50cm up from downhole contact; weak fol.	10	50		
102.2		GB	m.g.-f.g. feldspar porphyritic; M.g. zone contains 30-40% white feldspars (2-8mm) in a f.g. chloritized matrix. F.g. zone contains 5-15% white feldspars (2-4mm) in a f.g. plag. and chloritic matrix 54.5-57.3 m.g. zone; blocky core 57.3-66.2 f.g. zone 57.3-61.7 <0.5-1.0% PY; diss. 57.4-57.6 Fault Gouge; rubble 61.7-66.2 silicified 61.7-63.0 MAD; <1-2% PY,PO veinlet 63.0-66.2 <0.5-2.0% PY,PO veinlet in the sil. GB 66.2-102.2 m.g. zone, with local (0.5-1.0m) silicified zones with <0.1% diss. PY throughout interval, wkly fol 70.7 tr. PY in fracture 77.5-86.5 <1.0-5.0% PY,PO 61.7-63.0 90486 63.0-66.2 90487 77.5-80.5 90488 80.5-83.5 90489 83.5-86.5 90490	2,2b, 3b	50		

Paul

Depth	Assay No.	Rock Type	Description	Rock Types	Core Angle	RQD	Assay Type
122.2		FED	brownish-pink, aphanitic, qtz-phyrlic (5-15%, 1-3mm), silicified, sericitized, wkly fol., blocky		50		
269.0		GB	m.g., plag. porphyritic; plag. occupies 30-45%, 1-6mm, mostly white to locally pink near GR dikes. 122.2-146.0 <0.5% PY 124.6-125.0 1-2% veinlet assoc. PY; weak fol. throughout 168.0-174.8 GR dike with blue qtz (15-25%); salmon-pink, sharp contact 174.8-175.2 Rubble Zone 183.7-191.2 <0.1% PY 201.2-209.0 aphanitic FED; locally rubbly 203.0-204.0 rubble with Fault Gouge 241.0-269.0 5 m.g. blue qtz GR dikes intrude GB	2.2b, 3b	50-55 45 55 40-45		
			269.0 end of hole				

Paul



APPENDIX B



APPENDIX C



MONTCALM

Drill Section, E-W, Outokumpu Grid

Scale 1:1,000

Drill Hole Parameters,

Assays Ni%
Bar Scale 6% = 1 cm

gb = gabbro
py - pxd = pyroxenite - pyroxenitic dyke
um = ultramafic
mad = mafic dyke
acd = actinolite dyke
fed = feldspar dyke
fpd = feldsparporphyry
qfpd = quartzfeldsparporphyry
gr = granite
grdr = granodiorite
myl = mylonitic
m = meta
ms = massive sulphide
pyr = pyrite
po = pyrrhotite
pn = pentlandite

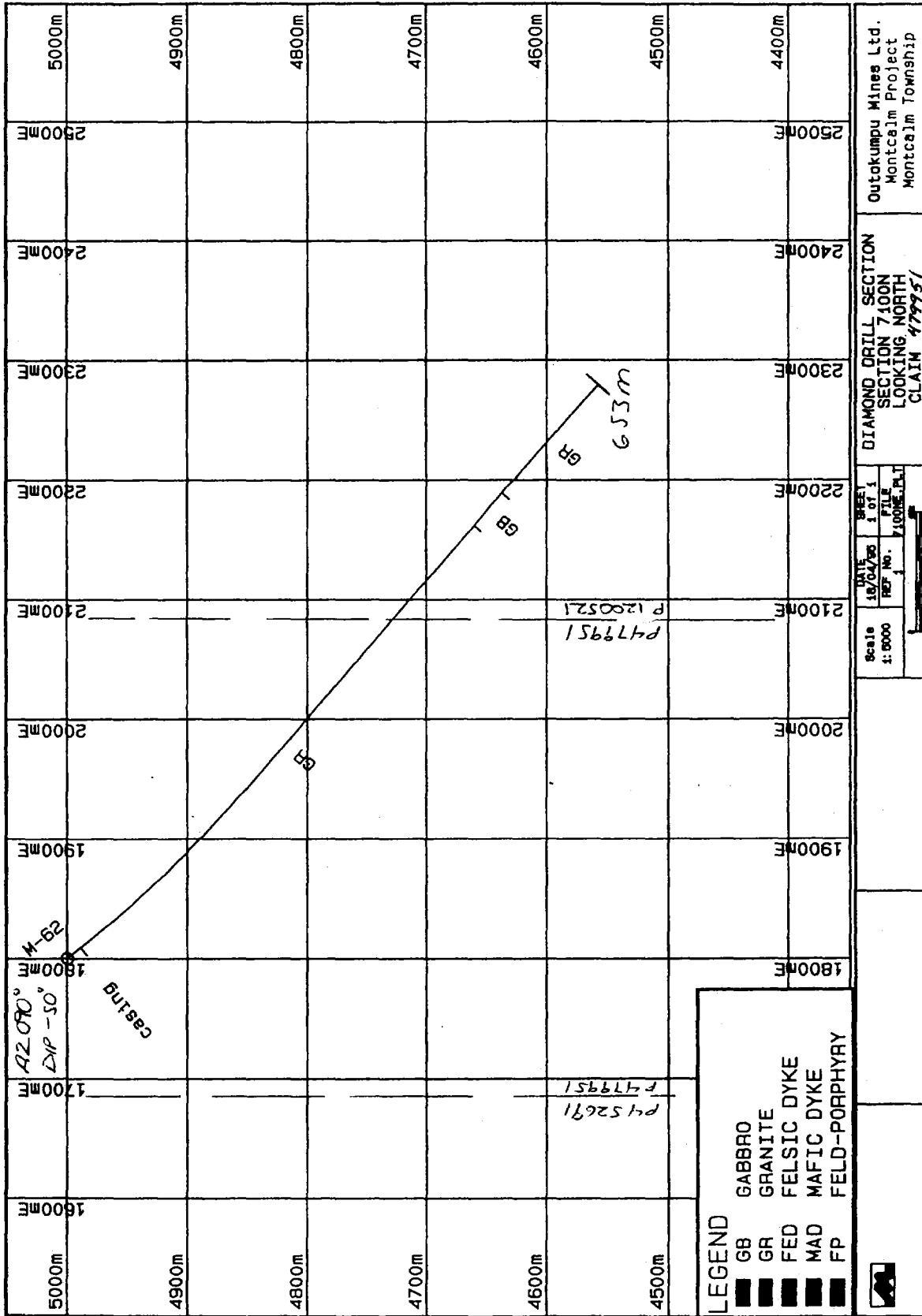

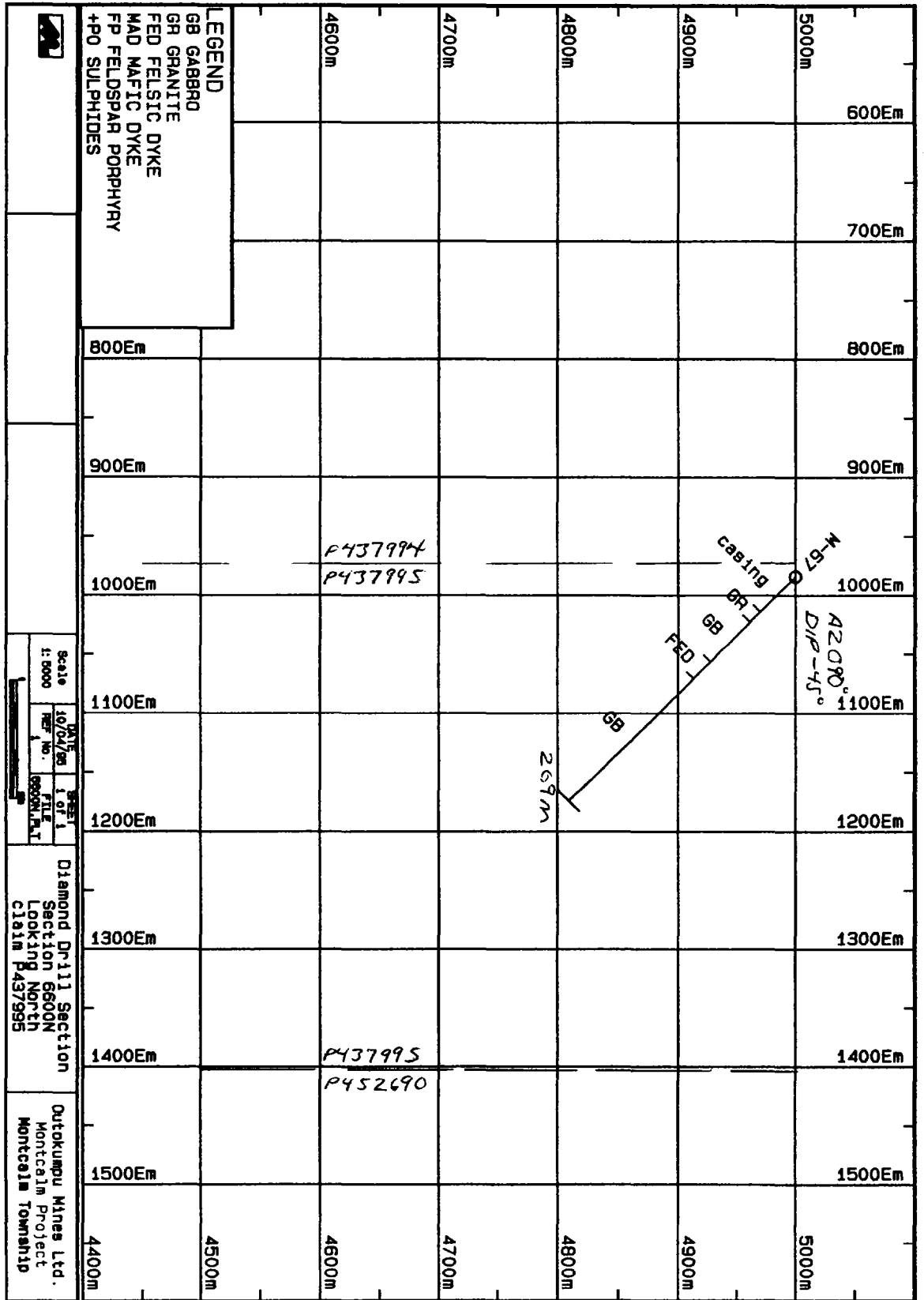



APPENDIX D

MONTCALM EXPENSE DETAIL

DRILL HOLE :

M-55	\$16,575.50
M-61	\$23,247.50
M-62	\$26,262.50
M-67	<u>\$13,092.50</u>
Total	<u>\$79,178.00</u>

BRADLEY BROS. LIMITED

June 15, 1994

CONTRACT DIAMOND DRILLING

Outokumpu Mines Ltd.
Suite 4650 - 1 First Canadian Place
P.O. Box 360,
Toronto, Ontario M5K 1E1

1699-23

Invoice No. _____

G.S.T./T.P.S. #: R100616788

Q.S.T./T.V.Q. #: 1000681845

Hole No.	June 1 to 15, 1994		
	Montcalm Township		
	June 6 - 1 muskeg hour		\$ 50.00
	June 8 - Pull NW Casing hole 55 - 3 man hours 1 machine hour	\$30.00	90.00 25.00
	Gyro test 2 1/2 hours	85.00	212.50
	Clear line for engineer 1 man hour 1 tractor hour		30.00 55.00
	Move Gyro - 3 man hours 3 muskeg hours	30.00 50.00	90.00 150.00
	June 10 - 1 man hour 1 muskeg hour		30.00 50.00
			782.50
			54.78
			<u>\$ 827.28</u>

Explor. Montcalm 70307R
Gst Recoverable 20155R
G.S.T. 7%
[Signature]
5369
July 7/94

BRADLEY BROS. LIMITED

June 15, 1994

CONTRACT DIAMOND DRILLING

Outokumpu Mines Ltd.
Suite 4650 - 1 First Canadian Place
P.O. Box 360,
Toronto, Ontario M5K 1E1

1699-24

Invoice No. _____

G.S.T./T.P.S. #: R100616788

Q.S.T./T.V.Q. #: 1000681845

Hole No.

June 1 to 15, 1994

Montcalm Township

Mud:

M55 -

15 l. OBC Polydrill

\$ 7.50

\$ 112.50

15 l. 133X Polydrill

7.50

112.50

M54 -

10 l. OBC Polydrill

7.50

75.00

10 l. 133X Polydrill

7.50

75.00

Sperry sun tests:

M55 -

43-95-143-193-

243 m.

2 1/2 hours

85.00

212.50

M54 -

62-112 m.

1 hours

85.00

M57 - 34 m.

1/2 hour

85.00

42.50

Gyro tests

M54-

2 1/2 hours

85.00

212.50

Haul core -

13 man hours

30.00

390.00

13 muskeg hours

50.00

650.00

Geologist used muskeg

June 2 -

2 hours

50.00

100.00

Explor. Montcalm 70307R

53,870.50

G.S.T. 7%

3,770.94

ASSIGNED TO

5369

GST Recoverable

20155R

\$57,641.44

July 7/94

BRADLEY BROS. LIMITED

June 15, 1994

CONTRACT DIAMOND DRILLING

Outokumpu Mines Ltd.
Suite 4650 - 1 First Canadian Place
P.O. Box 360,
Toronto, Ontario M5K 1E1

1699-24

Invoice No. _____

G.S.T./T.P.S. #: R100616788

Q.S.T./T.V.Q. #: 1000681845

Hole No.	June 1 to 15, 1994				
	Montcalm Township				
	B core				
M55	0	15	15 meters piping	\$39.00	\$ 585.00
	15	30	15 meters piping	44.00	660.00
	30	31	1 meters piping	49.00	49.00
	31	200	169 meters	39.00	6,591.00
	200	377	177 meters	40.00	7,080.00
	N core				
M54	0	15	15 meters piping	44.00	660.00
	15	30	15 meters piping	49.00	735.00
	30	45	15 meters piping	54.00	810.00
	45	49	4 meters piping	64.00	256.00
	49	200	151 meters	44.00	6,644.00
	200	400	200 meters	45.00	9,000.00
	400	440	40 meters	46.50	1,860.00
	N core				
M57	0	15	15 meters piping	44.00	660.00
	15	22	7 meters piping	49.00	343.00
	22	200	178 meters	44.00	7,832.00
	200	305	105 meters	45.00	4,725.00
	Casing left in holes:				
	M55 -				
			31 m. BW Casing	33.00	1,023.00
			1 BW Casing shoe		150.00
	M54 -				
			49 m. NW Casing	40.00	1,960.00
			1 NW Casing shoe		180.00

Forward...

BRADLEY BROS. LIMITED

August 2, 1994

CONTRACT DIAMOND DRILLING

Outokumpu Mines Ltd.
Suite 4650 - 1 First Canadian Place
P.O. Box 360,
Toronto, Ontario M5K 1E1

Invoice No. 1699-33

G.S.T./T.P.S. #: R100616788

G.S.T./T.V.Q. #: 1000681845

Hole No.	July 16 to 28, 1994		
	Gyro tests:		
	M-63	3 1/2 hours	\$85.00
			\$ 297.50
	M-61	3 hours	85.00
			255.00
	Mud:		
	M-61		
	20 l. 133X Polydrill		7.50
			150.00
	20 l. OBC Polydrill		7.50
			150.00
	Muskeg to haul core		
	July 16-17-18-27		
	4 man hours		30.00
			120.00
	4 muskeg hours		50.00
			200.00
	Muskeg for Gyro		
	July 26		
	1 men hour		30.00
	1 muskeg hour		50.00
			<u>30.00</u>
			<u>50.00</u>
			\$34,199.50
			<u>2,393.97</u>
			<u>\$36,593.47</u>
	<p>Explor. Montcalm 70307R GST Recoverable 20155 R Plus G.S.T. 7%</p>		
	<p>APPROVED <i>[Signature]</i> CHEQUE # <u>5488</u> DATE PAID <u>Aug 23/94</u></p>		

**BRADLEY
BROS.
LIMITED**

August 2, 1994

CONTRACT DIAMOND DRILLING

Outokumpu Mines Ltd.
Suite 4650 - 1 First Canadian Place
P.O. Box 360,
Toronto, Ontario M5K 1E1

Invoice No. 1699-33

G.S.T./T.P.S. #: R100616788

Q.S.T./T.V.Q. #: 1000681845

Hole No.	July 16 to 28, 1994				
	NQ core				
M-63	416	500	84 meters	\$46.50	\$ 3,906.00
	500	600	100 meters	46.50	4,650.00
	600	608	8 meters	49.50	396.00
M-61	0	15	15 meters piping	44.00	660.00
	15	30	15 meters piping	49.00	735.00
	30	37	7 meters piping	54.00	378.00
	37	100	63 meters	44.00	2,772.00
	100	200	100 meters	44.00	4,400.00
	200	300	100 meters	45.00	4,500.00
	300	400	100 meters	45.00	4,500.00
	400	460	60 meters	46.50	2,790.00
	Casings left in holes				
	M-63				
	27 m. NW Casing			40.00	1,080.00
	1 NW Casing shoe				180.00
	M-61				
	37 m. NW Casing			40.00	1,480.00
	1 NW Casing shoe				180.00
	Sperry Sun tests:				
	M-63				
	419 m.		1/2 hour	85.00	42.50
	M-61				
	44-118-169-248-				
	307-460 m.		3 1/2 hours	85.00	297.50
	Forward...				

**BRADLEY
BROS.
LIMITED**

July 31, 1994

CONTRACT DIAMOND DRILLING

Outokumpu Mines Ltd.
Suite 4650 - 1 First Canadian Place
P.O. Box 360,
Toronto, Ontario M5K 1E1

Invoice No. 1699-34

G.S.T./T.P.S. #: R100616788

Q.S.T./T.V.Q. #: 1000681845

Hole No.	July 16 to 28, 1994		
	Gyro tests: M-64	4 hrs	\$ 85.00
			\$ 340.00
	Muskeg for Gyro crew July 18		
	1 man hour		30.00
	1 muskeg hour		50.00
	Muskeg for Engineer July 24		
	1 1/2 man hour	30.00	45.00
	1 1/2 muskeg hour	50.00	75.00
	Muskeg for Geophysics July 26		
	1 man hour		30.00
	1 muskeg hour		50.00
	<i>Explor. Montcalm 70307R</i>		
	<i>G.S.T. Recoverable 20155 R</i>		\$36,313.00
	<i>G.S.T. 7%</i>		<u>2,541.91</u>
			<u>\$38,854.91</u>

APPROVED 
 CHEQUE # 5488
 DATE PAID Aug 23/94

BRADLEY BROS. LIMITED

July 31, 1994

CONTRACT DIAMOND DRILLING

Outokumpu Mines Ltd.
Suite 4650 - 1 First Canadian Place
P.O. Box 360,
Toronto, Ontario M5K 1E1

Invoice No. 1699-34

G.S.T./T.P.S. #: R100616788

Q.S.T./T.V.Q. #: 1000681845

Hole No.	July 16 to 28, 1994		
	Cost to pull casing		
	M-65		
	4 man hours	\$30.00	\$ 120.00
	2 machine hours	25.00	50.00
	M-67		
	4 man hours	30.00	120.00
	2 machine hours	25.00	50.00
	Cost to ream casing		
	M-67 from 45 to 47 m.		
	2 man hours	30.00	60.00
	1 machine hour		25.00
	Mud:		
	M-65		
	10 l. OBC Polydrill	7.50	75.00
	10 l. 133X Polydrill	7.50	75.00
	M-67		
	10 l. OBC Polydrill	7.50	75.00
	10 l. 133X Polydrill	7.50	75.00
	Sperry Sun tests:		
	M-64		
	608 m.	1 hr	
	M-65		
	59-236 m.	1 1/2 hr	
	M-67		
	53-269 m.	<u>1</u> hr	
		3 1/2 hrs	
		85.00	297.50
	Forward...		

**BRADLEY
BROS.
LIMITED**

July 31, 1994

CONTRACT DIAMOND DRILLING

Outokumpu Mines Ltd.
Suite 4650 - 1 First Canadian Place
P.O. Box 360,
Toronto, Ontario M5K 1E1

Invoice No. 1699-34

G.S.T./T.P.S. #: R100616788

Q.S.T./T.V.Q. #: 1000681845

Hole No.	July 16 to 29, 1994						
			NQ core				
M-64	506	600	94 meters	\$46.50	\$	4,371.00	
	600	700	100 meters	49.50		4,950.00	
	700	707	7 meters	53.50		374.50	
M-65	0	15	15 meters piping	44.00		660.00	
	15	30	15 meters piping	49.00		735.00	
	30	45	15 meters piping	54.00		810.00	
	45	47	2 meters piping	64.00		128.00	
	47	100	53 meters	44.00		2,332.00	
	100	200	100 meters	44.00		4,400.00	
	200	236	36 meters	45.00		1,620.00	
			BQ core				
M-67	0	15	15 meters piping	39.00		585.00	
	15	30	15 meters piping	44.00		660.00	
	30	42	12 meters piping	49.00		588.00	
	42	100	58 meters	39.00		2,262.00	
	100	200	100 meters	39.00		3,900.00	
	200	269	69 meters	40.00		2,760.00	
	Casings left in holes						
	M-64						
	43 m. NW Casing			40.00		1,720.00	
	1 NW Casing shoe					180.00	
	M-67						
	45 m. BW Casing			33.00		1,485.00	
	1 BW Casing shoe					150.00	

Forward...



Report of Work Conducted After Recording Claim

Mining Act

Transaction Number
W9560.00185

Personal information collected on this form is obtained under the authority of the Ministry. This collection should be directed to the Provincial Manager, Mining Lands, Ministry of Northern Development and Mines, Sudbury, Ontario, P3E 6A5, telephone (705) 670-7264.



42B09NE0008 W9560.00185 MONTCALM

900

- Instructions:**
- Please type or print and submit in duplicate.
 - Refer to the Mining Act and Regulations for requirements of filing assessment work or consult the Mining Recorder.
 - A separate copy of this form must be completed for each Work Group.
 - Technical reports and maps must accompany this form in duplicate.
 - A sketch, showing the claims the work is assigned to, must accompany this form.

Recorded Holder(s) Teck Exploration Ltd.		Client No. 200415
Address 19 Legault Street, North Bay, Ontario, P1B 8Z4		Telephone No. 705-474-5500
Mining Division Porcupine	Township/Area Montcalm	M or G Plan No. G-1182
Dates Work Performed From: June 01, 1994		To: July 28, 1994

Work Performed (Check One Work Group Only)

Work Group	Type
<input type="checkbox"/> Geotechnical Survey	
<input checked="" type="checkbox"/> Physical Work, Including Drilling	Diamond Drilling
<input type="checkbox"/> Rehabilitation	
<input type="checkbox"/> Other Authorized Work	
<input type="checkbox"/> Assays	
<input type="checkbox"/> Assignment from Reserve	

RECORDED

APR 20 1995

Receipt _____

Total Assessment Work Claimed on the Attached Statement of Costs \$ 79,178

Note: The Minister may reject for assessment work credit all or part of the assessment work submitted if the recorded holder cannot verify expenditures claimed in the statement of costs within 30 days of a request for verification.

Persons and Survey Company Who Performed the Work (Give Name and Address of Author of Report)

Name	Address
Bradley Bros. Limited	Box 485, Hwy. 101W, Timmins, Ontario, P4N 7E7

(attach a schedule if necessary)

Certification of Beneficial Interest * See Note No. 1 on reverse side

I certify that at the time the work was performed, the claims covered in this work report were recorded in the current holder's name or held under a beneficial interest by the current recorded holder.	Date Apr 19, 95	Recorded Holder or Agent (Signature) <i>[Signature]</i>
--	---------------------------	--

Certification of Work Report

I certify that I have a personal knowledge of the facts set forth in this Work report, having performed the work or witnessed same during and/or after its completion and annexed report is true.		
Name and Address of Person Certifying Paul Davis, Outokumpu Mines Ltd. P.O. Box 1123, Timmins, Ontario, P4N 7H9		
Telephone No. 705-264-5024	Date Apr 20, 95	Certified By (Signature) <i>[Signature]</i>

For Office Use Only

\$79,178	Total Value Cr. Recorded	Date Recorded	Mining Recorder <i>[Signature]</i>	Received Stamp APR 20 1995 1:45 PORCUPINE MINING DIVISION
	Deemed Approval Date July 19/95	Date Approved July 24, 1995		
	Date Notice for Amendments Sent July 17, 1995			



**Statement of Costs
for Assessment Credit**

**État des coûts aux fins
du crédit d'évaluation**

Transaction No./N° de transaction
W9560.00185

Mining Act/Loi sur les mines

Personal information collected on this form is obtained under the authority of the Mining Act. This information will be used to maintain a record and ongoing status of the mining claim(s). Questions about this collection should be directed to the Provincial Manager, Minings Lands, Ministry of Northern Development and Mines, 4th Floor, 159 Cedar Street, Sudbury, Ontario P3E 6A5, telephone (705) 670-7264.

Les renseignements personnels contenus dans la présente formule sont recueillis en vertu de la Loi sur les mines et serviront à tenir à jour un registre des concessions minières. Adresser toute question sur la collecte de ces renseignements au chef provincial des terrains miniers, ministère du Développement du Nord et des Mines, 159, rue Cedar, 4^e étage, Sudbury (Ontario) P3E 6A5, téléphone (705) 670-7264.

1. Direct Costs/Coûts directs

Type	Description	Amount Montant	Totals Total global
Wages Salaires	Labour Main-d'oeuvre		
	Field Supervision Supervision sur le terrain		
Contractor's and Consultant's Fees Droits de l'entrepreneur et de l'expert- conseil	Type Diamond Drilling	79,178	
			79,178
Supplies Used Fournitures utilisées	Type		
Equipment Rental Location de matériel	Type		
Total Direct Costs Total des coûts directs			79,178

2. Indirect Costs/Coûts indirects

**** Note:** When claiming Rehabilitation work Indirect costs are not allowable as assessment work.
Pour le remboursement des travaux de réhabilitation, les coûts indirects ne sont pas admissibles en tant que travaux d'évaluation.

Type	Description	Amount Montant	Totals Total global
Transportation Transport	Type		
Food and Lodging Nourriture et hébergement			
Mobilization and Demobilization Mobilisation et démobilisation			
Sub Total of Indirect Costs Total partiel des coûts indirects			
Amount Allowable (not greater than 20% of Direct Costs) Montant admissible (n'excédant pas 20 % des coûts directs)			
Total Value of Assessment Credit (Total of Direct and Allowable Indirect costs)		Valeur totale du crédit d'évaluation (Total des coûts directs et indirects admissibles)	79,178

Note: The recorded holder will be required to verify expenditures claimed in this statement of costs within 30 days of a request for verification. If verification is not made, the Minister may reject for assessment work all or part of the assessment work submitted.

Note : Le titulaire enregistré sera tenu de vérifier les dépenses demandées dans le présent état des coûts dans les 30 jours suivant une demande à cet effet. Si la vérification n'est pas effectuée, le ministre peut rejeter tout ou une partie des travaux d'évaluation présentés.

Filing Discounts

1. Work filed within two years of completion is claimed at 100% of the above Total Value of Assessment Credit.
2. Work filed three, four or five years after completion is claimed at 50% of the above Total Value of Assessment Credit. See calculations below:

Total Value of Assessment Credit	Total Assessment Claimed
	× 0.50 =

Remises pour dépôt

1. Les travaux déposés dans les deux ans suivant leur achèvement sont remboursés à 100 % de la valeur totale susmentionnée du crédit d'évaluation.
2. Les travaux déposés trois, quatre ou cinq ans après leur achèvement sont remboursés à 50 % de la valeur totale du crédit d'évaluation susmentionné. Voir les calculs ci-dessous.

Valeur totale du crédit d'évaluation	Évaluation totale demandée
	× 0,50 =

Certification Verifying Statement of Costs

I hereby certify:
that the amounts shown are as accurate as possible and these costs were incurred while conducting assessment work on the lands shown on the accompanying Report of Work form.

that as PROVINCIAL GEOLOGIST I am authorized
(Recorded Holder, Agent, Position in Company)

to make this certification

Attestation de l'état des coûts

J'atteste par la présente :
que les montants indiqués sont le plus exact possible et que ces dépenses ont été engagées pour effectuer les travaux d'évaluation sur les terrains indiqués dans la formule de rapport de travail ci-joint.

Et qu'à titre de _____ je suis autorisé
(titulaire enregistré, représentant, poste occupé dans la compagnie)

à faire cette attestation.

Signature 	Date APRIL 19/95
---------------	---------------------

Work Report Number for Applying Reserve	Claim Number (see Note 2)	Number of Claim Units
	P1113775	1
	P1113776	1
	P1113777	1
	P1113778	1
	P1113779	1
	P1113780	1
	P1113781	1
	P1113782	1
	P1113783	1
	P1113784	1
	P1113785	1
	P1113786	1
	P1113787	1
	P1113788	1
	P1113789	1
	P1113790	1
	P1113791	1
Total Number of Claims		

Value of Assessment Work Done on this Claim	Value Applied to this Claim
	650
	650
	650
	650
	650
	650
	650
	650
	650
	650
	650
	650
	650
	650
	650
	650
	650
Total Value Work Done	
Total Value Work Applied	

Value Assigned from this Claim	Reserve: Work to be Claimed at a Future Date
Total Assigned From	
Total Reserve	

Credits you are claiming in this report may be cut back. In order to minimize the adverse effects of such deletions, please indicate from which claims you wish to prioritize the deletion of credits. Please mark (✓) one of the following:

- Credits are to be cut back starting with the claim listed last, working backwards.
- Credits are to be cut back equally over all claims contained in this report of work.
- Credits are to be cut back as prioritized on the attached appendix.

In the event that you have not specified your choice of priority, option one will be implemented.

Note 1: Examples of beneficial interest are unrecorded transfers, option agreements, memorandum of agreements, etc., with respect to the mining claims.

Note 2: If work has been performed on patented or leased land, please complete the following:

I certify that the recorded holder had a beneficial interest in the patented or leased land at the time the work was performed.	Signature <i>JFC</i>	Date <i>Apr 19 95</i>
---	-------------------------	--------------------------

Work Report Number for Applying Reserve	Claim Number (see Note 2)	Number of Claim Units
	P1113792	1
	P1113793	1
	P1113796	1
	P1113797	1
	P1113798	1
	P1113799	1
	P1113800	1
	P1113801	1
	P1113802	1
	P1113803	1
	P1113804	1
	P1113813	1
	P1113814	1
	P1113815	1
	P1113816	1
	P1113817	1
	P1113818	1
Total Number of Claims		

Value of Assessment Work Done on this Claim	Value Applied to this Claim
	650
	650
	650
	650
	650
	650
	650
	650
	650
	650
	650
	650
	650
	650
	650
	650
	650
Total Value Work Done	Total Value Work Applied
	650

Value Assigned from this Claim	Reserve: Work to be Claimed at a Future Date
Total Assigned From	Total Reserve

Credits you are claiming in this report may be cut back. In order to minimize the adverse effects of such deletions, please indicate from which claims you wish to prioritize the deletion of credits. Please mark (✓) one of the following:

- Credits are to be cut back starting with the claim listed last, working backwards.
- Credits are to be cut back equally over all claims contained in this report of work.
- Credits are to be cut back as prioritized on the attached appendix.

In the event that you have not specified your choice of priority, option one will be implemented.

Note 1: Examples of beneficial interest are unrecorded transfers, option agreements, memorandum of agreements, etc., with respect to the mining claims.

Note 2: If work has been performed on patented or leased land, please complete the following:

I certify that the recorded holder had a beneficial interest in the patented or leased land at the time the work was performed.	Signature <i>[Signature]</i>	Date 09/19/95
---	---------------------------------	------------------

Work Report Number for Applying Reserve	Claim Number (see Note 2)	Number of Claim Units
	P1128182	1
	P1128183	1
	P1128184	1
	P1128185	1
	P1128186	1
	P1128187	1
	P1128188	1
	P1128190	1
	P1128191	1
	P1128192	1
	P1128195	1
	P1128196	1
	P1128197	1
	P1128198	1
	P1128199	1
	P1128200	1
	P1128201	1
Total Number of Claims		

Value of Assessment Work Done on this Claim	Value Applied to this Claim
	650
	650
	650
	650
	650
	650
	650
	650
	650
	650
	650
	650
	650
	650
	650
	650
	650
Total Value Work Done	Total Value Work Applied
	650

Value Assigned from this Claim	Reserve: Work to be Claimed at a Future Date
Total Assigned From	Total Reserve

Credits you are claiming in this report may be cut back. In order to minimize the adverse effects of such deletions, please indicate from which claims you wish to prioritize the deletion of credits. Please mark (✓) one of the following:

- Credits are to be cut back starting with the claim listed last, working backwards.
- Credits are to be cut back equally over all claims contained in this report of work.
- Credits are to be cut back as prioritized on the attached appendix.

In the event that you have not specified your choice of priority, option one will be implemented.

Note 1: Examples of beneficial interest are unrecorded transfers, option agreements, memorandum of agreements, etc., with respect to the mining claims.

Note 2: If work has been performed on patented or leased land, please complete the following:

I certify that the recorded holder had a beneficial interest in the patented or leased land at the time the work was performed.	Signature <i>T.P.G. Co. [Signature]</i>	Date 09/11/95
---	--	------------------

Page 5 of 7

Work Report Number for Applying Reserve	Claim Number (see Note 2)	Number of Claim Units
	P1128202	1
	P1128203	1
	P1128204	1
	P1128205	1
	P1128206	1
	P1128207	1
	P1128208	1
	P1128209	1
	P1128210	1
	P1128211	1
	P1128212	1
	P1128213	1
	P1128214	1
	P1128215	1
	P1128216	1
	P1128217	1
Total Number of Claims 117 + ML		

Value of Assessment Work Done on this Claim	Value Applied to this Claim
	650
	650
	650
	650
	650
	650
	650
	650
	650
	650
	650
	650
	650
	650
	650
	650
Total Value Work Done 79,178	Total Value Work Applied 79,112

Value Assigned from this Claim	Reserve: Work to be Claimed at a Future Date
Total Assigned From 75,400	Total Reserve

Credits you are claiming in this report may be cut back. In order to minimize the adverse effects of such deletions, please indicate from which claims you wish to prioritize the deletion of credits. Please mark (✓) one of the following:

- Credits are to be cut back starting with the claim listed last, working backwards.
- Credits are to be cut back equally over all claims contained in this report of work.
- Credits are to be cut back as prioritized on the attached appendix.

In the event that you have not specified your choice of priority, option one will be implemented.

Note 1: Examples of beneficial interest are unrecorded transfers, option agreements, memorandum of agreements, etc., with respect to the mining claims.

Note 2: If work has been performed on patented or leased land, please complete the following:

I certify that the recorded holder had a beneficial interest in the patented or leased land at the time the work was performed.	Signature <i>J.P. Carter</i>	Date April 19 95.
---	---------------------------------	----------------------

Page 6 of 7

Work Report Number for Applying Reserve	Claim Number (see Note 2)	Number of Claim Units
	P1113821	1
	P1113822	1
	P1113823	1
	P1113824	1
	P1113825	1
	P1113826	1
	P1113827	1
	P1113828	1
	P1113829	1
	P1113830	1
	P1113831	1
	P1113832	1
	P1113833	1
	P1113834	1
	P1113835	1
	P1113836	1
	P1113837	1
Total Number of Claims		

Value of Assessment Work Done on this Claim	Value Applied to this Claim
	650
	650
	650
	650
	650
	650
	650
	650
	650
	650
	650
	650
	650
	650
	650
	650
Total Value Work Done	Total Value Work Applied
	650

Value Assigned from this Claim	Reserve: Work to be Claimed at a Future Date
Total Assigned From	Total Reserve

Credits you are claiming in this report may be cut back. In order to minimize the adverse effects of such deletions, please indicate from which claims you wish to prioritize the deletion of credits. Please mark (✓) one of the following:

- Credits are to be cut back starting with the claim listed last, working backwards.
- Credits are to be cut back equally over all claims contained in this report of work.
- Credits are to be cut back as prioritized on the attached appendix.

In the event that you have not specified your choice of priority, option one will be implemented.

Note 1: Examples of beneficial interest are unrecorded transfers, option agreements, memorandum of agreements, etc., with respect to the mining claims.

Note 2: If work has been performed on patented or leased land, please complete the following:

I certify that the recorded holder had a beneficial interest in the patented or leased land at the time the work was performed.	Signature <i>J.P. Co...</i>	Date April 19 '95
---	--------------------------------	----------------------

Page 7 of 7

Work Report Number for Applying Reserve	Claim Number (see Note 2)	Number of Claim Units
	P1113838	1
	P1113839	1
	P1113840	1
	P1128009	1
	P1128010	1
	P1128011	1
	P1128012	1
	P1128013	1
	P1128014	1
	P1128015	1
	P1128016	1
	P1128017	1
	P1128177	1
	P1128178	1
	P1128179	1
	P1128180	1
	P1128080	1
	P1128181	1
	P1128081	1
Total Number of Claims		

Value of Assessment Work Done on this Claim	Value Applied to this Claim
	650
	650
	650
	650
	650
	650
	650
	650
	650
	650
	650
	650
	650
	650
	650
	650
	650
	650
Total Value Work Done	Total Value Work Applied

Value Assigned from this Claim	Reserve: Work to be Claimed at a Future Date
Total Assigned From	Total Reserve

Credits you are claiming in this report may be cut back. In order to minimize the adverse effects of such deletions, please indicate from which claims you wish to prioritize the deletion of credits. Please mark (✓) one of the following:

- Credits are to be cut back starting with the claim listed last, working backwards.
- Credits are to be cut back equally over all claims contained in this report of work.
- Credits are to be cut back as prioritized on the attached appendix.

In the event that you have not specified your choice of priority, option one will be implemented.

Note 1: Examples of beneficial interest are unrecorded transfers, option agreements, memorandum of agreements, etc., with respect to the mining claims.

Note 2: If work has been performed on patented or leased land, please complete the following:

I certify that the recorded holder had a beneficial interest in the patented or leased land at the time the work was performed.	Signature <i>[Signature]</i>	Date April 19 '95
---	---------------------------------	----------------------

POULETT Tp. M.1063

F₁ - SUBJECT TO FORESTAL ACTIVITY IN 1993-94 Gordon-Creech F.O.A.

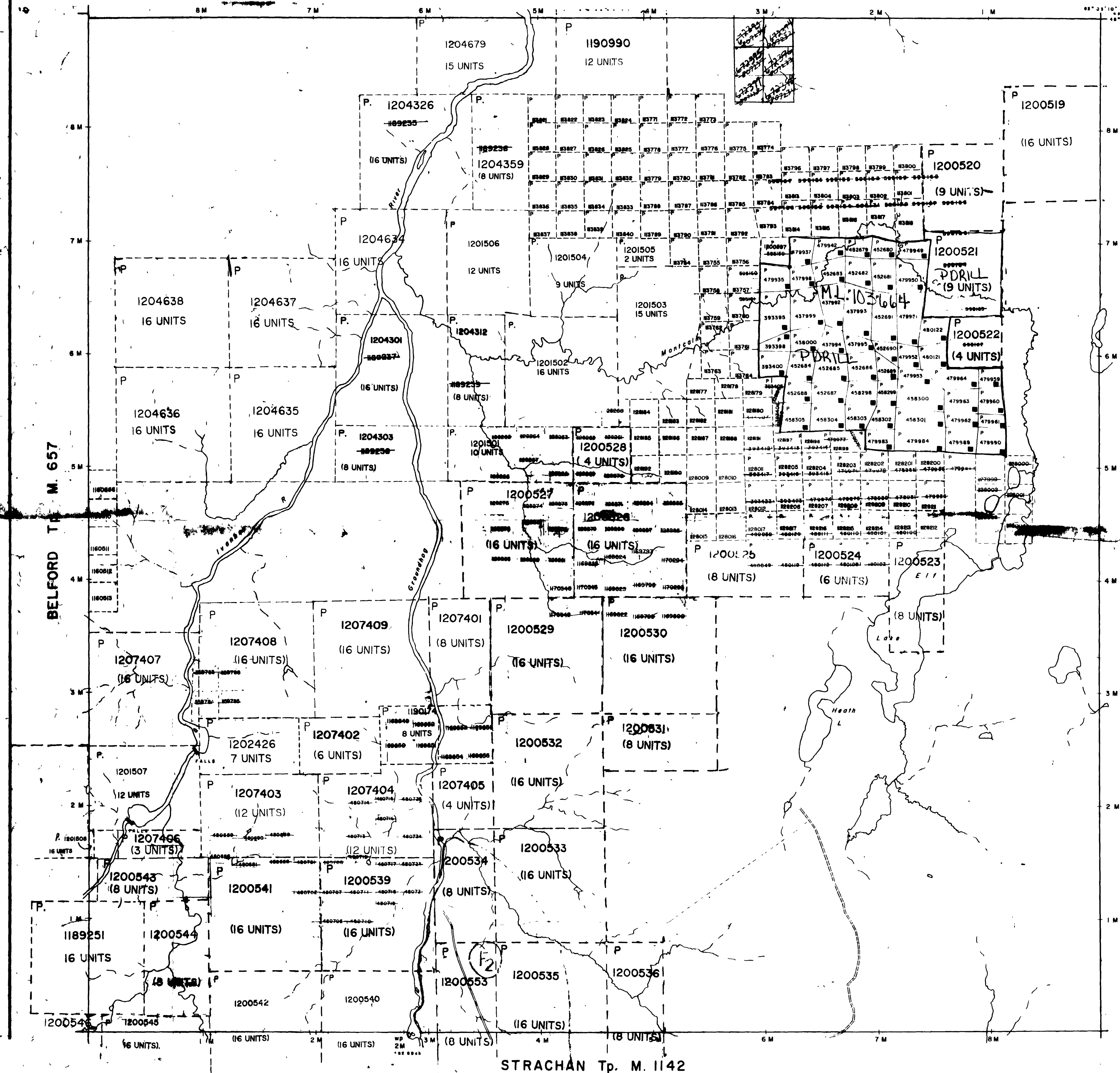

LEGEND

- HIGHWAY AND ROUTE No
- OTHER ROADS
- TRAILS
- SURVEYED LINES
- TOWNSHIPS, BASE LINES, ETC
- LOTS, MINING CLAIMS, PARCELS, ETC
- UNSURVEYED LINES
- LOT LINES
- PARCEL BOUNDARY
- MINING CLAIMS ETC
- RAILWAY AND RIGHT OF WAY
- UTILITY LINES
- NON-PERENNIAL STREAM
- FLOODING OR FLOODING RIGHTS
- SUBDIVISION
- ORIGINAL SHORELINE
- MARSH OR MUSKEG
- MINES

DISPOSITION OF CROWN LANDS

TYPE OF DOCUMENT	SYMBOL
PATENT, SURFACE & MINING RIGHTS	●
SURFACE RIGHTS ONLY	○
MINING RIGHTS ONLY	◐
LEASE, SURFACE & MINING RIGHTS	◑
SURFACE RIGHTS ONLY	◒
MINING RIGHTS ONLY	◓
LICENCE OF OCCUPATION	◔
CROWN LAND SALE	CS
ORDER-IN-COUNCIL	OC
RESERVATION	⊙
CANCELLED	⊘
SAND & GRAVEL	⊚

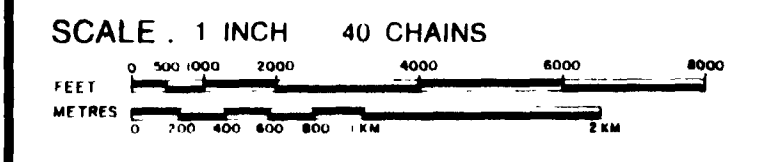

ACRES HECTARES

40 16

Received Nov 5/02

TOWNSHIP

MONTCALM

DISTRICT

COCHRANE

MINING DIVISION

PORCUPINE

Ministry of Natural Resources

Ontario Surveys and Mapping Branch

Date: 12 74 Plan No: G-1182

Whitney Black Queen's Park Toronto

INFORMATION THAT APPEARS ON THIS MAP WAS COMPILED FROM AERIAL PHOTOGRAPHS TAKEN IN 1974. THE MAP IS NOT GUARANTEED TO BE ACCURATE TO THE DEGREE OF 1:50,000. THE CROWN IS NOT RESPONSIBLE FOR ANY LOSS OR DAMAGE TO PROPERTY OR PERSONS ARISING FROM THE USE OF THIS MAP.



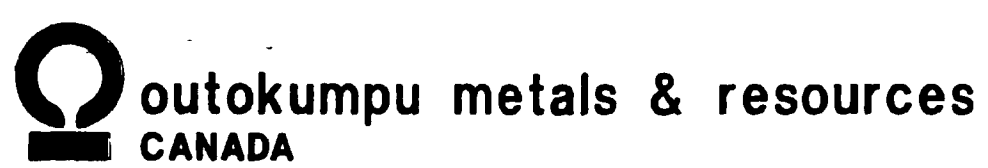
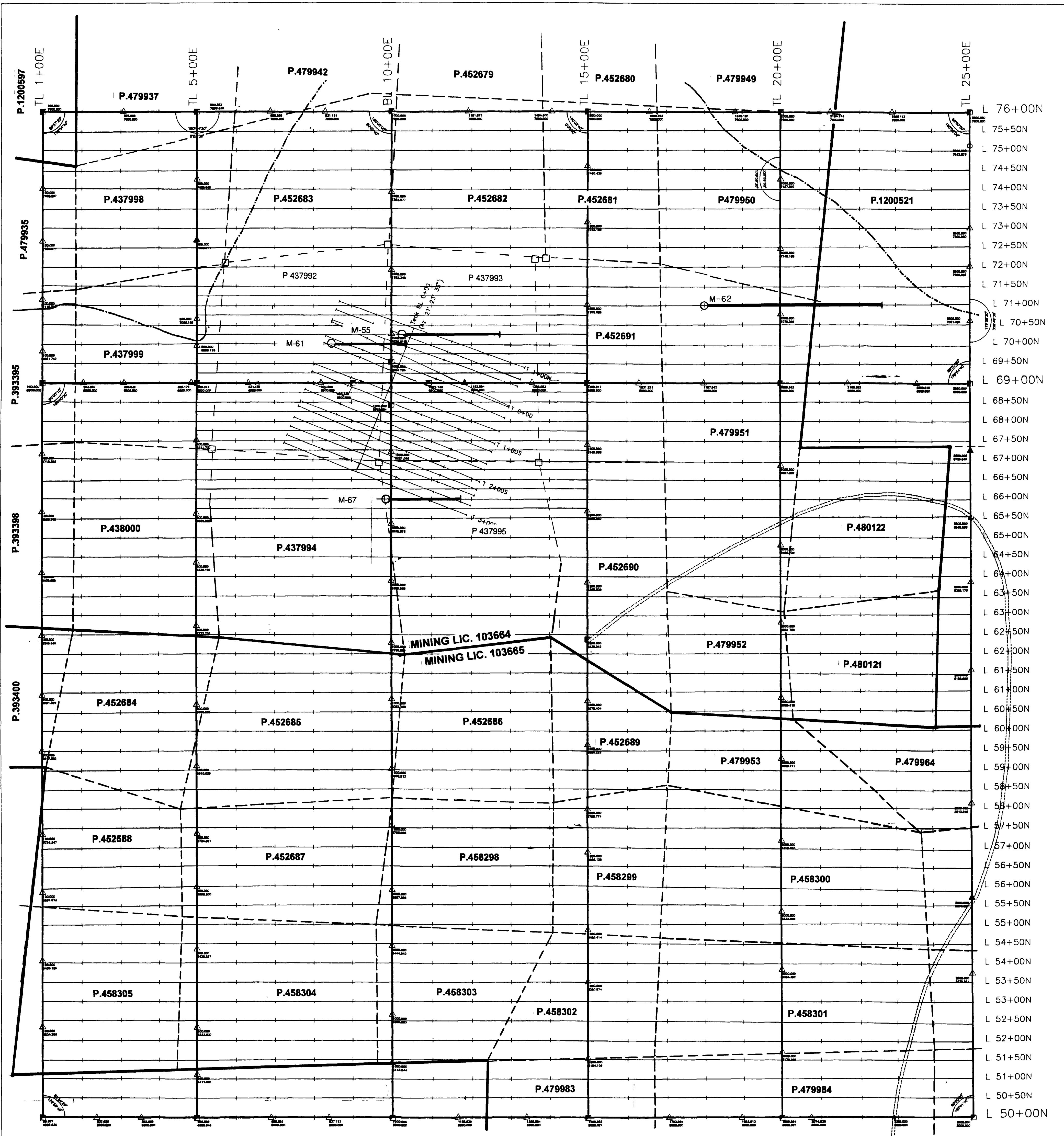

MONTCALM PROPERTY GRID

- LEGEND
- △ NAIL IN STUMP
 - RE-BAR
 - ▲ NAIL IN LOG
 - ⊕ NAIL IN GROUND
 - NAIL IN HUB
 - ==== ROAD
 - ~ CREEK
 - DRILL HOLE
 - CLAIM LINE AND POST

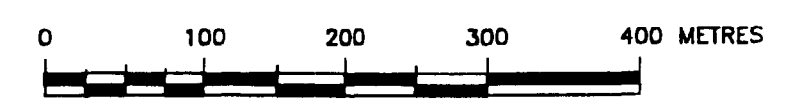
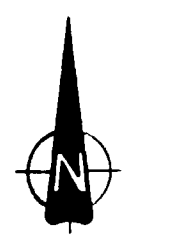

1:5000

