

DIAMOND DRILLING



42C03NW0030 15 ABBIE LAKE

010

Area: Abbie Lake

Report No: 15

WORK PERFORMED FOR: Granges Exploration Ltd.

RECORDED HOLDER: SAME AS ABOVE []

; OTHER [x] MacMillan Energy Corp. Ltd.

<u>CLAIM NO:</u>	<u>HOLE NO:</u>	<u>FOOTAGE</u>	<u>DATE</u>	<u>NOTE</u>
SSM 629242	M-91	63.09m	Oct/86	(1)
SSM 629238	M-92	63.09m	Oct-Nov/86	(1)
SSM 601899	M-93	63.09m	Nov/86	(1)
SSM 601820	M-94	66.14m	Nov/86	(1)
		<u>255.41m</u>		

NOTES: (1) #168-86 (filed in June/87)

GRANGES EXPLORATION LTD.
DIAMOND DRILL LOG

Property MISHI OPTION Project No. 227 Depth 63.04 m (207') Date Began Oct 29/86
 Hole No. M-91 Co ord. L 3500 W Horizontal Length 36m Date Completed Oct 30/86
 Claim No. SSM 629242 1296 N Core Size A_g Drilled By Morissette
 Grid No. M-1 Angle & Direction -55°S Elevation _____ Logged By W. BATES

INTERVAL FEET / METRES	DESCRIPTION	SAMPLE RECORD								
		FROM	TO	WIDTH	SAMPLE	Au.	Ag.	Cu.	Zn.	
		0	6.09	6.09	CASING					
0-6.09	<u>Casing</u>	6.09	25.60	19.51	WASTE					
6.09-25.72	<u>Gabbro</u> - Dark green - Coarse grained actinolite to .6 cm - massive; non-foliated	25.60	26.51	.91	4540	.02	.5			
		26.51	27.43	.92	41	.02	.5			
		27.43	28.34	.91	42	.02	.5			
		28.34	29.26	.92	43	.02	.5			
		29.26	30.17	.91	44	.02	.5			
25.72-26.21	<u>Mafic Schist</u> - Dark green to grey - f. grained - schistose	30.17	31.08	.91	45	.02	.5			
		31.08	32.00	.92	46	.02	.5			
		32.00	32.91	.91	47	.02	.5			
		32.91	33.83	.92	48	.02	.5			
		33.83	34.74	.91	49	.02	.5			
		34.74	35.81	1.07	4550	.02	.5			
26.21-34.42	<u>Felsic Tuff w/ sulfide bands (Conductor)</u> - light grey; siliceous - fine grained * 29.56-29.87 - 60% pyrite + pyrrhotite in .1-2cm massive bands; conductive. 35.50-35.60 - quartz vein	35.81	36.70	2.89	WASTE					
		36.70	39.62	.92	4551	.02	.5			
		39.62	40.53	.91	4552	.02	.5			
		40.53	41.45	.92	53	.02	.5			
		41.45	42.36	.91	54	.02	.5			
		42.36	43.28	.92	55	.02	.5			
		43.28	44.19	.91	56	.02	.5			
		44.19	45.11	.92	57	.02	.5			
34.42-38.70	<u>Mafic Volcanic</u> - fine grained - chloritic - olive green	45.11	46.02	.91	58	.02	.5			
		46.02	46.93	.91	59	.02	.5			
		46.93	47.85	.92	60	.02	.5			
		47.85	48.76	.91	61	.02	.5			
		48.76	49.68	.92	62	.02	.5			
38.70-59.43	<u>Schistose Felsic Tuff</u> - schistose - siliceous - 5-10% feldspars; 2-3 mm, subhedral - 10-20% sericite development	49.68	50.59	.91	63	.02	.5			
		50.59	51.51	.92	64	.02	.5			
		51.51	52.42	.91	65	.02	.5			
		52.42	53.34	.92	66	.02	.5			
		53.34	54.25	.91	67	.02	.5			
		54.25	55.16	.91	68	.02	.5			
59.43-63.09	<u>Gabbro</u> - as before	55.16	56.03	.92	69	.02	.5			
		56.03	56.97	.91	70	.02	.5			
		56.97	57.91	.92	71	.02	.5			
63.04m	<u>Core Angles</u>	57.91	58.82	.91	72	.02	.5			
	28.04 m - 71°	58.82	59.43	.91	73	.02	.5			
E.O.H	74.19 m - 67°	59.43	63.09	3.66	WASTE					
	56.99 m - 60°									

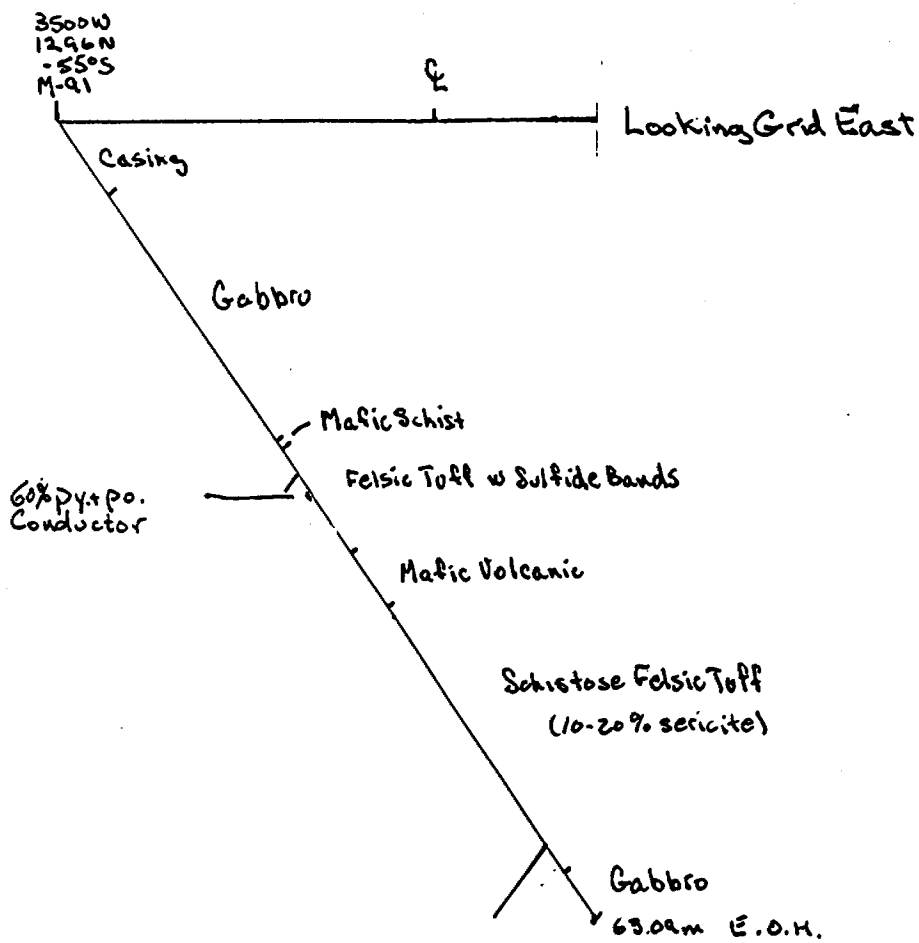

1:500
1cm = 5m

Granges Exploration
 MISHI OPTION
 D.D.H. M-91
 Grid M-1
 L3500W, 1296N, -55°S
 Claim SSM 629242

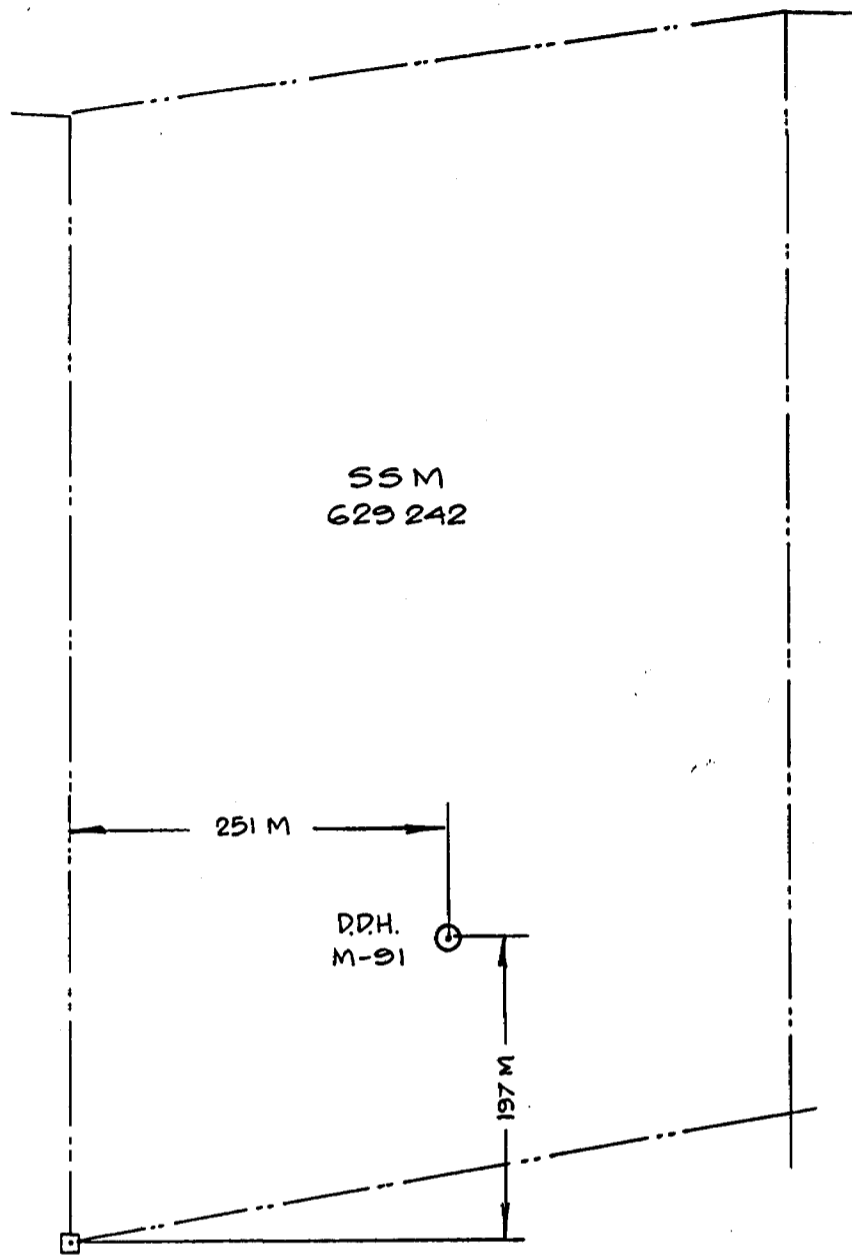
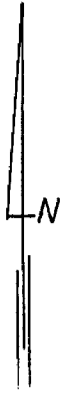

GRANGES EXPLORATION LTD.

MISHI PROJECT

DIAMOND DRILL HOLE LOCATION PLAN

SCALE 1:5000

HOLE NO: M-91

**GRANGES EXPLORATION LTD.
DIAMOND DRILL LOG**

Property MISHI OPTIUM Project No. 227 Depth 63.09 m Date Began Oct 31/86
 Hole No. M-92 Co. ord. L4200W Horizontal Length 41.00 m Date Completed Nov. 186
 Claim No. SSM 629238 / 740 N Core Size A9 Drilled By Mocissette
 Grid No. M-1 Angle & Direction -50°S Elevation _____ Logged By W. BATES

INTERVAL FEET/METRES	DESCRIPTION	SAMPLE RECORD							
		FROM	TO	WIDTH	SAMPLE	Au.	Ag.	Cu.	Zn.
0-3.65	Casing	0	3.65	3.65	CASING				
		3.65	4.57	.92	4574	.02	.5		
		4.57	5.48	.91	75	.02	.5		
3.65-14.32	Brecciated, Altered Felsic to Intermediate Tuff	5.48	6.40	.92	76	.02	.5		
	- Light to Dark grey	6.40	7.31	.91	77	.05	.5		
	- Chaotically deformed	7.31	8.22	.91	78	.02	.5		
	- trace - 5% disseminated pyrite	8.22	9.14	.92	79	.16	.5		
	3.65-5.79 broken core	9.14	10.05	.91	4580	.25	.5		
	6.70-6.85 smoky grey quartz vein; 5% pyrite	10.05	10.97	.92	81	.05	.5		
	8.22-9.75 Brecciated quartz-sericite schist	10.97	11.88	.91	87	.02	.5		
	4.52-9.98 smoky grey quartz vein	11.88	12.80	.92	83	.02	.5		
		12.80	13.70	.90	84	.02	.5		
14.32-28.95	Schistose Intermediate tuff with Pyrite Stringers	13.70	14.63	.93	85	.02	.5		
	- Lt. grey	14.63	15.54	.91	86	.02	1.0		
	- schistose	15.54	16.45	.91	87	.02	.5		
	- fine grained	16.45	17.37	.92	88	.02	.5		
	20.42-28.95 5% .2-1cm pyrite stringers (Conductive)	17.37	18.28	.91	89	.02	.5		
		18.28	19.20	.92	4590	.02	.5		
28.95-41.20	Felsic to Intermediate Tuff	19.20	20.11	.91	91	.02	.5		
	Schistose	20.11	21.03	.92	92	.02	.5		
	Granular texture on 1mm scale	21.03	21.94	.91	93	.02	.5		
	35.50-35.96 → 5%, 5-2cm pyrite + pyrrhotite stringers	21.94	22.86	.92	94	.02	.5		
		22.86	23.77	.91	95	.02	.5		
41.20-42.67	Intermediate tuff w/ Pyrite stringers	23.77	24.68	.91	96	.02	.5		
	- as before, except	24.68	25.60	.92	97	.02	.5		
	- 35% .1-1cm pyrite stringers, Conductive	25.60	26.51	.91	98	.02	.5		
		26.51	27.43	.92	99	.04	.5		
42.67-54.10	Sericite-Chlorite Schist	27.43	28.34	.91	4600	.02	.5		
	- banded on .5cm scale; buff to dark green	28.34	29.26	.92	01	.02	.5		
		29.26	29.56	.30	02	.02	.5		
54.10-54.71	Quartz Vein	29.56	34.13	4.57	WASTE				
		34.13	35.05	.92	4603	.02	.5		
54.71-63.09	Sheared Quartz-Phyric Felsic Tuff	35.05	35.96	.91	04	.02	.5		
63.09m	- 5-10% 1-2m grey quartz eyes	35.96	36.88	.92	05	.02	.5		
E.O.H.	- 30-50% sericite, slightly (3-5%) chloritic	36.88	37.79	.91	06	.02	.5		
	55.6-56.08 → 20% Qtz. veins 3-4cm	37.79	38.70	.91	07	.02	.5		
	62.33-62.48 → Quartz Vein	38.70	39.62	.92	08	.02	.5		
		39.62	40.53	.93	09	.02	.5		
	Core Angles	40.53	41.45	.92	10	.04	.5		
	21.9m-53°, 44.80m-56°, 61.56m-58°	41.45	42.36	.91	4611	.05	.5		



GRANGES EXPLORATION LTD.
DIAMOND DRILL LOG

Property Project No. Depth Date Began

Hole No. M-92 (Cont'd) Co ord. Horizontal Length Date Completed

Claim No. Core Size Drilled By

Grid No. Angle & Direction Elevation Logged By

INTERVAL FEET / METRES	DESCRIPTION	SAMPLE RECORD							
		FROM	TO	WIDTH	SAMPLE	Au.	Ag.	Cu.	Zn.
		42.36	43.28	.92	4612	.02	1.0		
		43.28	44.19	.91	4613	.02	.5		
		44.19	45.11	.92	14	.02	.5		
		45.11	46.02	.91	15	.02	.5		
		46.02	46.93	.91	16	.02	.5		
		46.93	47.85	.92	17	.02	.5		
		47.85	48.76	.91	18	.02	.5		
		48.76	49.68	.92	19	.02	.5		
		49.68	50.59	.91	4620	.05	.5		
		50.59	51.51	.92	21	.07	.5		
		51.51	52.42	.91	22	.02	.5		
		52.42	53.34	.92	23	.05	1.0		
		53.34	54.25	.91	24	.09	1.0		
		54.25	55.16	.91	25	.16	.5		
		55.16	56.08	.92	26	.19	.5		
		56.08	56.99	.91	27	.02	.5		
		56.99	57.91	.92	28	.04	.5		
		57.91	58.82	.91	29	.02	.5		
		58.82	59.74	.92	4630	.08	.5		
		59.74	60.65	.91	31	.49	.5		
		60.65	61.56	.91	32	.02	.5		
		61.56	62.48	.92	33	.03	.5		
		62.48	63.09	.61	4634	.55	1.5		
			E.O.H.						

**GRANGES EXPLORATION LTD.
DIAMOND DRILL LOG**

Property Project No. Depth Date Began

Hole No. M-9Z Co ord. Horizontal Length Date Completed

Claim No. Core Size Drilled By

Grid No. Angle & Direction Elevation Logged By

INTERVAL FEET / METRES	DESCRIPTION	SAMPLE RECORD							
		FROM	TO	WIDTH	SAMPLE	g Au. / f	Ag.	Cu.	Zn.
	SLUDGES	0	5.18	3.05	4758	.15			
		5.18	8.22	↓	59	.03			
		8.22	11.27	↓	60	.22			
		11.27	14.32	↓	61	.02			
		14.32	17.37	↓	62	.02			
		17.37	20.42	3.05	63	.02			
		20.46	23.46	3.04	64	.02			
		23.46	26.51	3.05	65	.02			
		26.51	29.56	↓	66	.03			
		29.56	32.61	↓	67	.02			
		32.61	35.66	3.05	68	.02			
		35.66	38.70	3.04	69	.05			
		38.70	41.75	3.05	4770	.02			
		41.75	44.80	↓	71	.02			
		44.80	47.85	↓	72	.09			
		47.85	50.90	3.65	73	.02			
		50.90	53.94	3.04	74	.14			
		53.94	56.99	3.05	75	.90			
		56.99	60.04	3.05	76	.12			
		60.04	63.09	3.05	4777	.57			

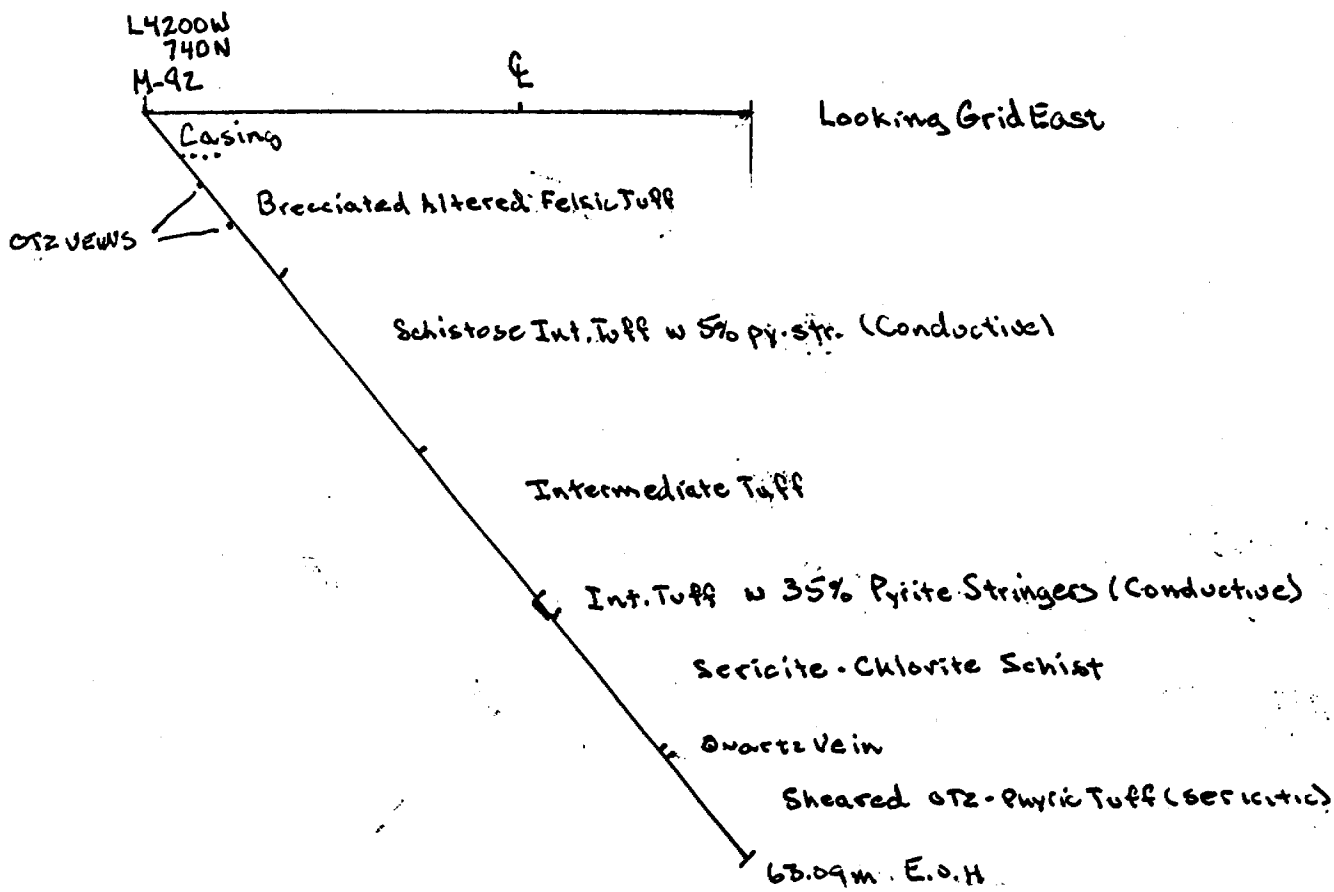

1:500
1cm = 5m

Granges Exploration
MISHI OPTION
D.O.H M-92
Grid M-1, L4200W, 740N, -50°S
CLAIM SSM 629238

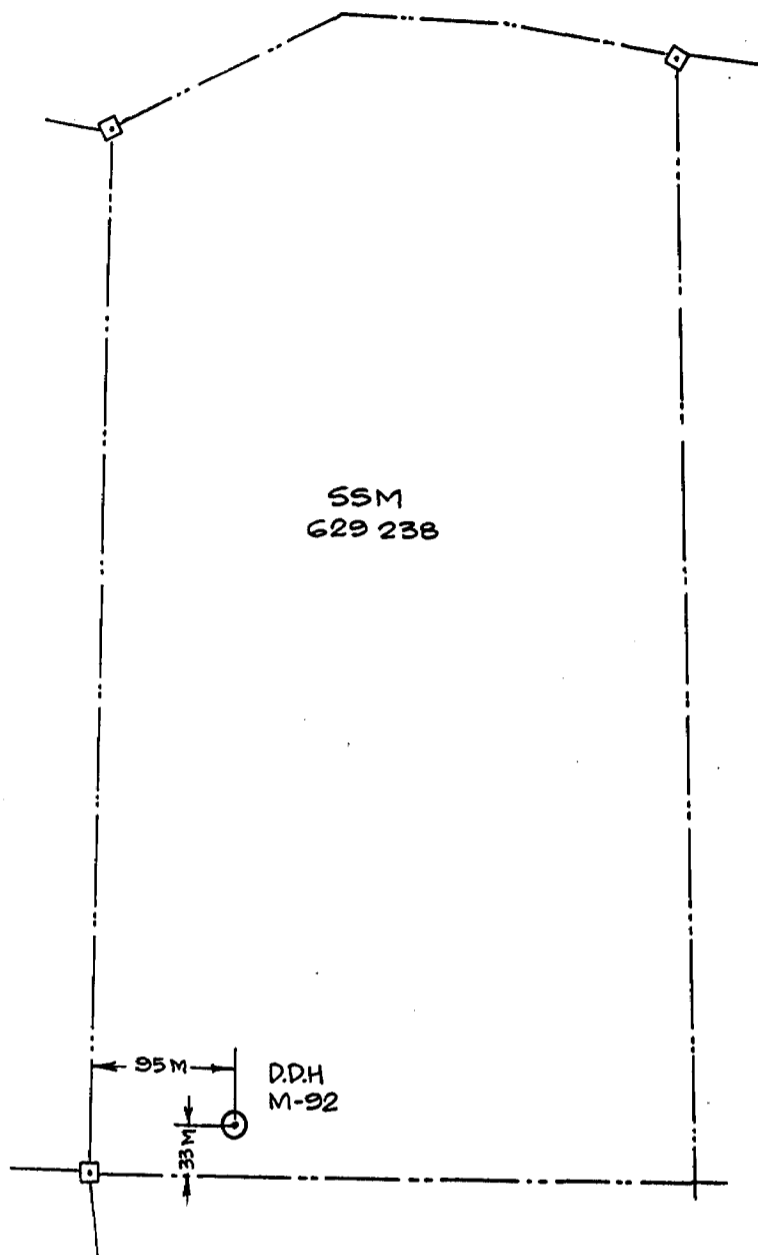

GRANGES EXPLORATION LTD.
MISHI PROJECT
DIAMOND DRILL HOLE LOCATION PLAN
SCALE 1:5000
HOLE NO: M-92

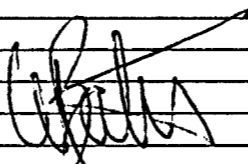

**GRANGES EXPLORATION LTD.
DIAMOND DRILL LOG**

Property MISHA OPTION Project No. 227 Depth 63.09 Date Began Nov. 2/86
 Hole No. M-93 Co ord. L5000W Horizontal Length Date Completed Nov. 3/86
 Claim No. SSM 601899 T+50N Core Size Aq Drilled By M. H. H. Bates
 Grid No. M-1 Angle & Direction 50°S Elevation Logged By W. Bates

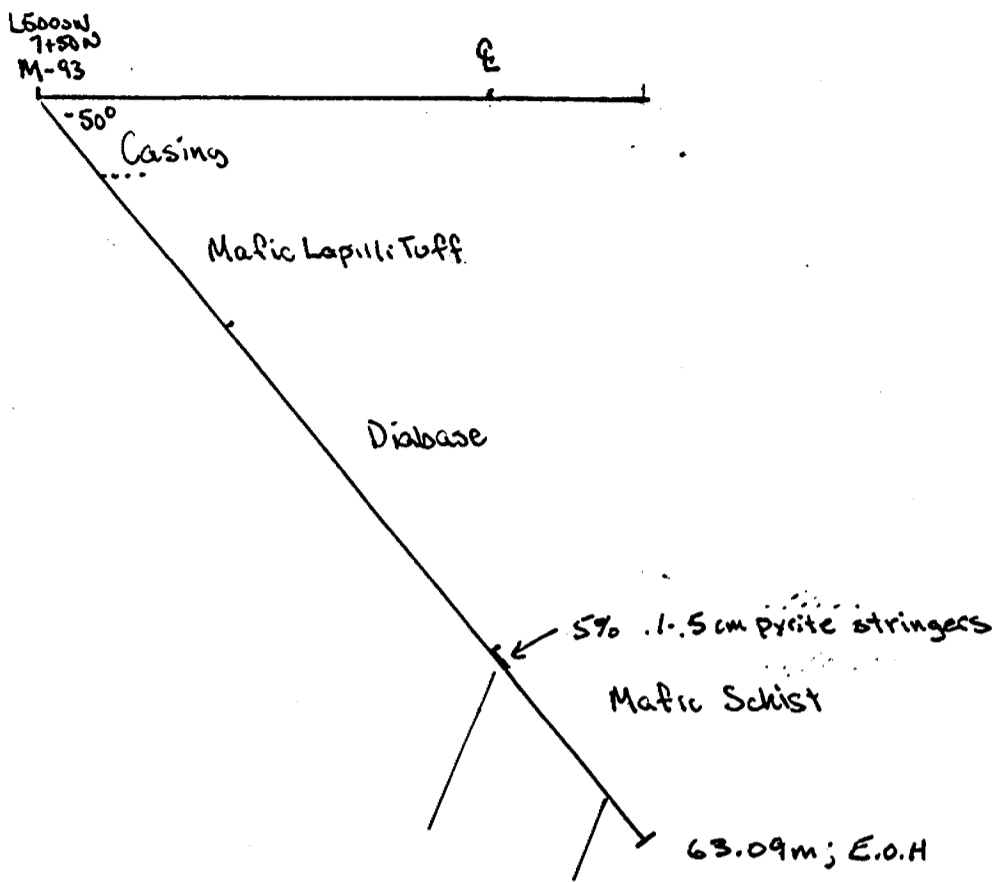
INTERVAL FEET/METRES	DESCRIPTION	SAMPLE RECORD							
		FROM	TO	WIDTH	SAMPLE	Au.	Ag.	Cu.	Zn.
0-6.70	Casing	0	6.70	6.70	CASING				
		6.70	46.75	40.05	WASTE				
6.70-19.65	<u>Mafic Lapilli Tuff</u>	46.75	47.36	.61	4635	.02	.5		
	- dark green	47.36	47.85	.49	36	.08	.5		
	- fine grained chloritic matrix	47.85	48.46	.61	37	.05	.5		
	- 10-15% 3-5mm stretched chloritic fragments	48.46	49.07	.61	38	.02	.5		
	- barren	49.07	49.68	.61	39	.09	.5		
	- massive	49.68	50.29	.61	40	.02	.5		
		50.29	50.90	.61	41	.05	.5		
19.65-47.45	<u>Diabase</u>	50.90	55.47	4.57	WASTE				
	- Black to light grey	55.47	56.08	.61	42	.08	1.0		
	- fine grained to aphanitic	56.08	56.69	.61	43	.07	.5		
	- where grain size visible (max 1mm), salt + pepper	56.69	57.30	.61	44	.07	.5		
	- diabasic texture observed	57.30	57.91	.61	45	.05	1.0		
	- massive	57.91	58.52	.61	46	.02	.5		
	- barren	58.52	63.09	4.57	WASTE				
					E.O.H				
47.45-63.09	<u>Mafic Schist</u>								
	- slightly schistose								
	- lt green								
	* 47.45-48.82 - 7.5% .1-.5cm wide; pyrite stringers; Conductive								
	56.08-56.99 -> 5% quartz veins, 3-4cm width								
	<u>Core Angles</u>								
	47.85m - 58°								
	59.43m - 60°								
									

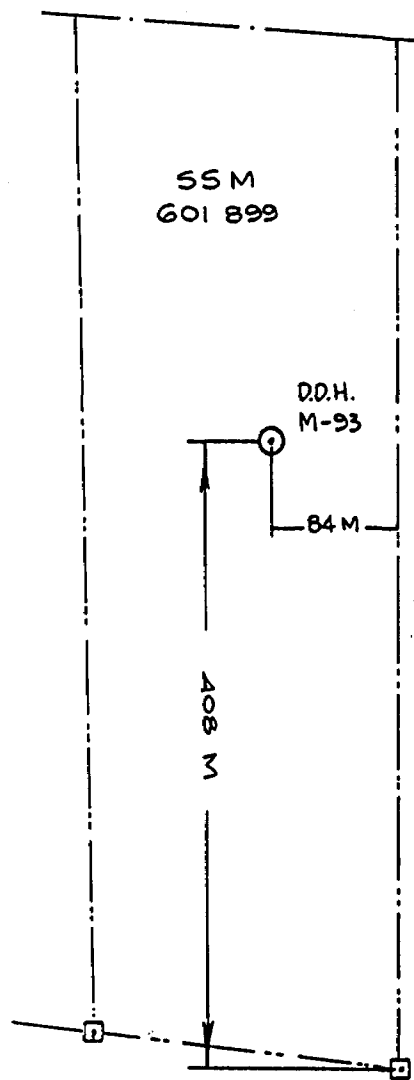
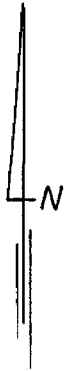

Granges Exploration
 MISHI OPTION, #227
 D.P.H M-93
 Grid M-1
 L5000W, 750N, -50°S
 63.09 m



GRANGES EXPLORATION LTD.

MISHI PROJECT

DIAMOND DRILL HOLE LOCATION PLAN
SCALE 1:5000

HOLE NO: M-93

GRANGES EXPLORATION LTD.
DIAMOND DRILL LOG

Property MISHI OPTION Project No. 221 Depth 66.14m Date Began NOV. 4/86
 Hole No. M-94 Co ord. LZ100W Horizontal Length 33.07m Date Completed NOV. 5/86
 Claim No. SSM 601820 560N Core Size Ag Drilled By Morissette
 Grid No. M-1 Angle & Direction -60°S Elevation _____ Logged By W. BATES

INTERVAL FEET / METRES	DESCRIPTION	SAMPLE RECORD							
		FROM	TO	WIDTH	SAMPLE	g Au/t	g Ag/t	Cu.	Zn.
0-3.65	<u>Casing</u>	0	3.65	3.65	CASING				
		3.65	3.96	.31	WASTE				
3.65-8.22	<u>Sheared Metaconglomerate</u> - 3.65-5.40 m qtz-sericite schist - tr. pyrite throughout - 20-80% sericitic development - trace fuchsite - 3.65-3.95 (granodiorite boulder)	3.96	4.57	.61	4404	.02	1.0		
		4.57	5.18	.61	4405	.02	.5		
		5.18	5.79	.61	4406	.07	.5		
		5.79	6.40	.61	4407	.02	.5		
		6.40	7.01	.61	4408	.02	.5		
		7.01	7.62	.61	4409	.02	.5		
		7.62	8.22	.60	4410	.02	.5		
8.22-58.82	<u>Metaconglomerate</u> - 10-15% chloritic fragments, .5 to .2cm - fragments are stretched, wispy - buff to light grey matrix, fine to medium grained - very similar to "Kanginwaki" conglomerate	8.22	8.53	.31	4411	.02	.5		
		58.53	58.52	49.99	WASTE				
		58.52	59.13	.61	4412	.02	.5		
		59.13	59.74	.61	4413	.02	.5		
58.82-60.04	<u>Brecciated Metaconglomerate (Conductor)</u> - broken and fractured rock - slightly hematitic - tr. fuchsite - 59.89-60.04 graphitic argillite, broken, in chalky matrix	59.74	60.35	.61	4414	.02	.5		
		60.35	60.96	.61	4415	.02	1.0		
		60.96	61.56	.60	4416	.02	.5		
		61.56	66.14	4.58	WASTE				
					E.O.H				
60.04-66.14	<u>Metaconglomerate</u> - 10% 1-1cm biotitic clasts - pink f.g. matrix								
	<u>Core Angles</u> 10.66 m → 55° 25.90 m → 62° 43.28 m → 60° 55.47 m → 60°								

[Handwritten signature]

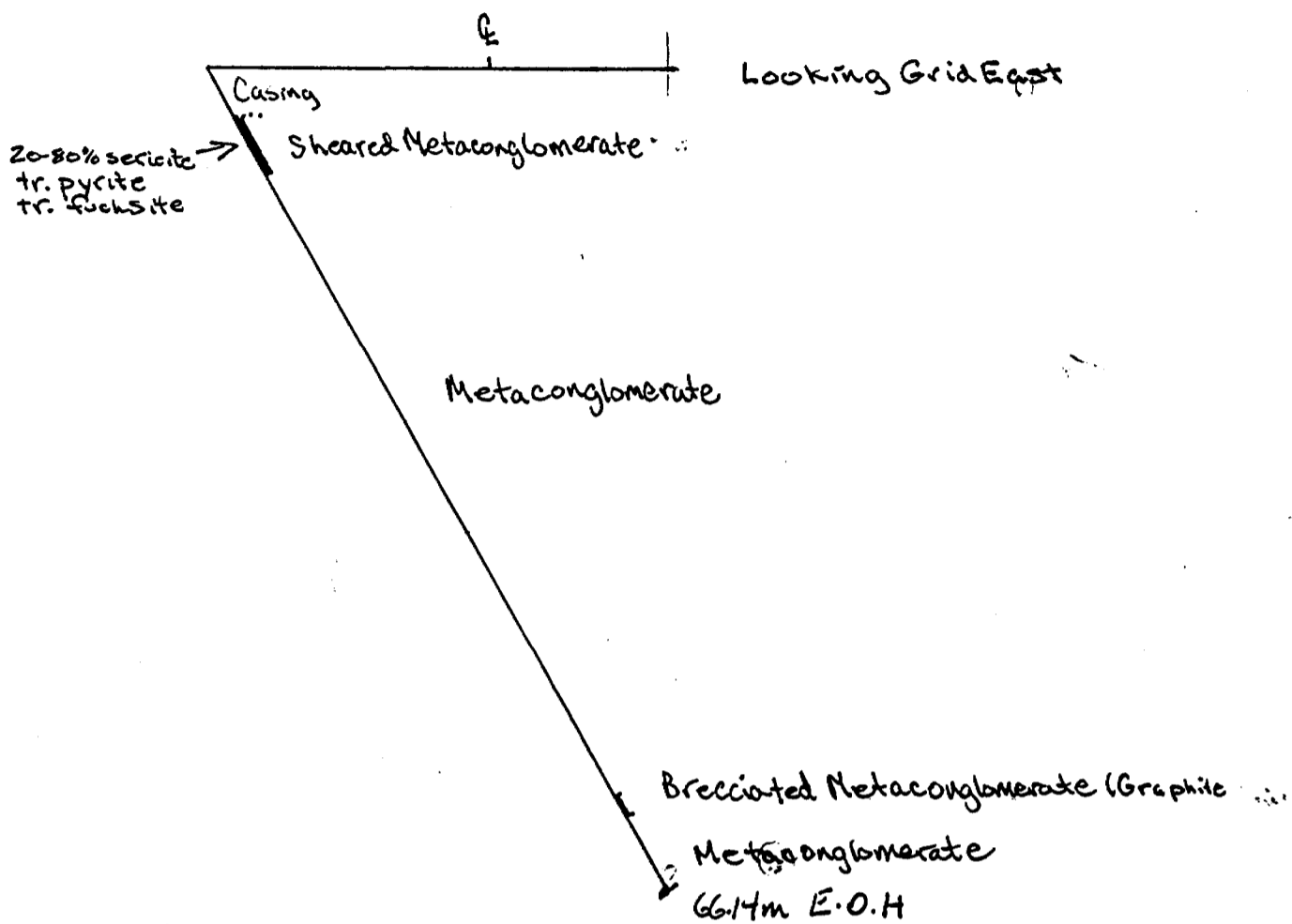

Granges Exploration
 MISHI OPTION
 D.D.H M-94
 Grid M-1
 L2100W, S60N, -60°S
 CLAIM SSM 601820

1cm = 5m

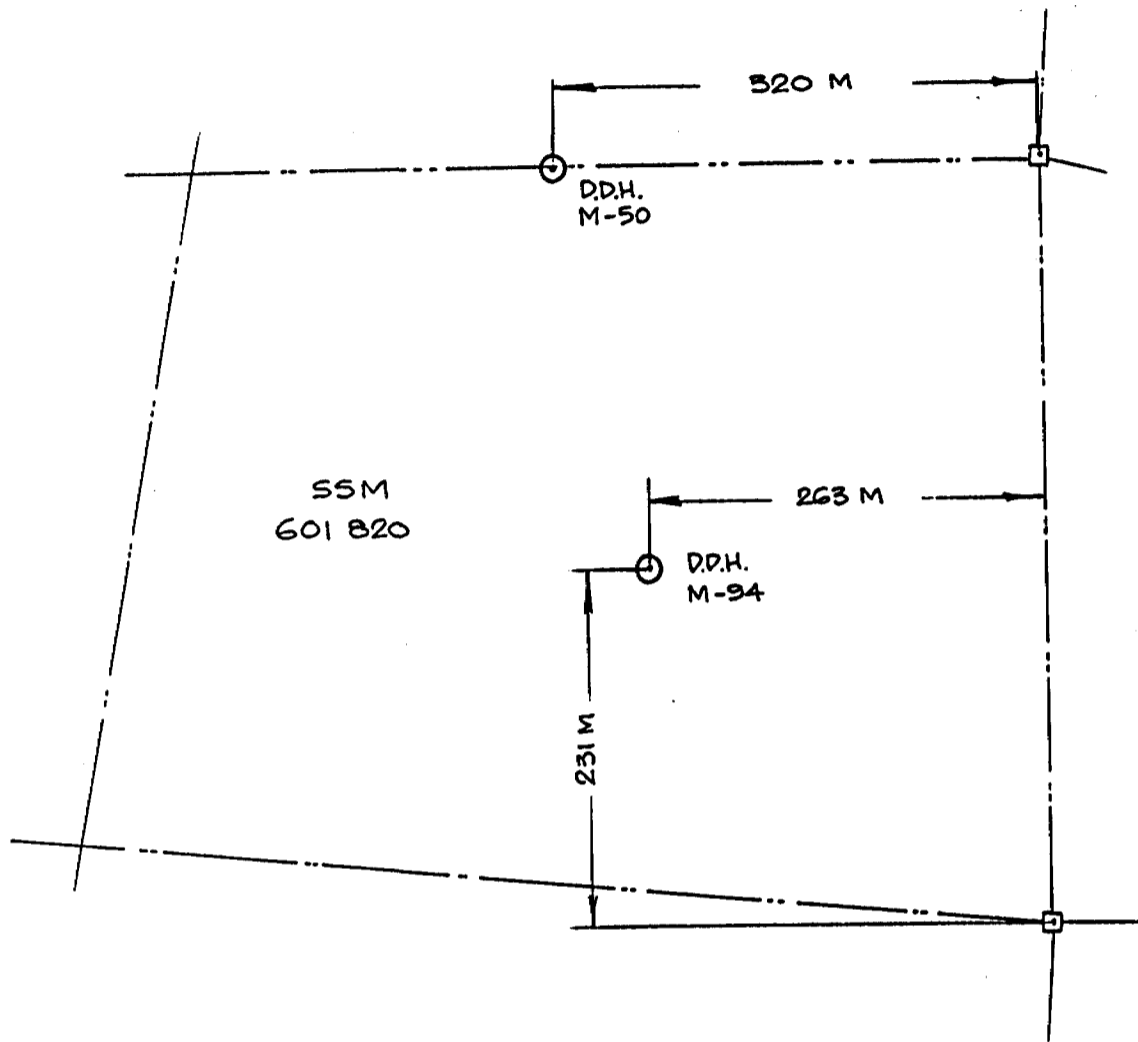
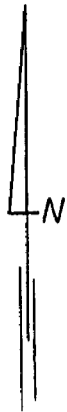

GRANGES EXPLORATION LTD.

MISHI PROJECT

DIAMOND DRILL HOLE LOCATION PLAN

SCALE 1:5000

HOLE NO: M-50 & M-94

Name and Postal Address of Recorded Holder

MACMILLAN ENERGY CORP LTD

SUITE 810 - 625 HOWE ST, VANCOUVER, B.C.



900

Summary of Work Performance and Distribution of Credits

Total Work Days Cr. claimed	Mining Claim			Mining Claim			Mining Claim		
	Prefix	Number	Work Days Cr.	Prefix	Number	Work Days Cr.	Prefix	Number	Work Days Cr.
70731	SSM	601631	40	SSM	601639	40	SSM	601647	40
for Performance of the following work. (Check one only) <input type="checkbox"/> Manual Work <input type="checkbox"/> Shaft Sinking Drifting or other Lateral Work. <input type="checkbox"/> Compressed Air, other Power driven or mechanical equip. <input type="checkbox"/> Power Stripping <input checked="" type="checkbox"/> Diamond or other Core drilling <input type="checkbox"/> Land Survey		601632	40		601640	40		601648	40
		601633*	56		601641	40		601649	40
		601634	40		601642	40		601650	40
		601635	40		601643	40		601658	40
		601636	40		601644	40		601659	40
		601637	40		601645	40		601660	40
		601638	40		601646	40		601661	40

All the work was performed on Mining Claim(s): **PLEASE SEE ATTACHED LIST MISHIBISHU LAKE.**

Required Information eg: type of equipment, Names, Addresses, etc. (See Table Below) **ST. GERMAIN G. 2291**

DRILLING WAS CARRIED OUT BY:

N. MORISSETTE CANADA INC
BOX 789
HAILEYBURY, ONTARIO
PO BOX 1KO

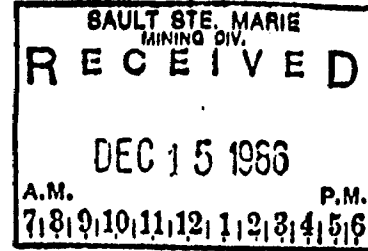

DURING THE PERIOD OF **OCTOBER 1st 1986** TO **NOVEMBER 9th 1986**

* mailed Dec. 4/86

194.

Date of Report: **Dec 4th 1986** Recorded Holder or Agent (Signature): *[Signature]*

Certification Verifying Report of Work

I hereby certify that I have a personal and intimate knowledge of the facts set forth in the Report of Work annexed hereto, having performed the work or witnessed same during and/or after its completion and the annexed report is true.

Name and Postal Address of Person Certifying

GEORGE W. ZBITNOFF

900 - 625 HOWE ST, VANCOUVER, B.C. V6K 2T6

Date Certified: **Dec 4th 1986**

Certified by (Signature): *[Signature]*

Table of Information/Attachments Required by the Mining Recorder

Type of Work	Specific Information per type	Other Information (Common to 2 or more types)	Attachments
Manual Work	Nil	Names and addresses of men who performed manual work/operated equipment, together with dates and hours of employment.	Work Sketch: these are required to show the location and extent of work in relation to the nearest claim post.
Shaft Sinking, Drifting or other Lateral Work			
Compressed air, other power driven or mechanical equip.	Type of equipment	Names and addresses of owner or operator together with dates when drilling/stripping done.	
Power Stripping	Type of equipment and amount expended. Note: Proof of actual cost must be submitted within 30 days of recording.		
Diamond or other core drilling	Signed core log showing: footage, diameter of core, number and angles of holes.		Work Sketch (as above) in duplicate



Name and Postal Address of Recorded Holder MACMILLAN ENERGY CORP. LTD	Prospector's Licence No. T 1706
---	---

Summary of Work Performance and Distribution of Credits

Total Work Days Cr. claimed	Mining Claim			Work Days Cr.	Mining Claim			Work Days Cr.	Mining Claim		
	Prefix	Number	Work Days Cr.		Prefix	Number	Work Days Cr.		Prefix	Number	Work Days Cr.
for Performance of the following work. (Check one only) <input type="checkbox"/> Manual Work <input type="checkbox"/> Shaft Sinking Drifting or other Lateral Work. <input type="checkbox"/> Compressed Air, other Power driven or mechanical equip. <input type="checkbox"/> Power Stripping <input type="checkbox"/> Diamond or other Core drilling <input type="checkbox"/> Land Survey	SSM	601662	40	SSM	601670	40	SSM	601681	40		
		601663	40		601671	40		601682	40		
		601664	40		601672	40		601683	40		
		601665	40		601673	40		601684	40		
		601666	40		601677	40		601685	40		
		601667	40		601678	40		601687	40		
		601668	40		601679	40		601688	40		
		601669	40		601680	40		601689	40		

All the work was performed on Mining Claim(s):

Required Information eg: type of equipment, Names, Addresses, etc. (See Table Below)



Name and Postal Address of Recorded Holder MACMILLAN ENERGY CORP. LTD	Prospector's Licence No. T 1706
---	---

Summary of Work Performance and Distribution of Credits

Total Work Days Cr. claimed	Mining Claim			Work Days Cr.	Mining Claim			Work Days Cr.	Mining Claim		
	Prefix	Number	Work Days Cr.		Prefix	Number	Work Days Cr.		Prefix	Number	Work Days Cr.
for Performance of the following work. (Check one only) <input type="checkbox"/> Manual Work <input type="checkbox"/> Shaft Sinking Drifting or other Lateral Work. <input type="checkbox"/> Compressed Air, other Power driven or mechanical equip. <input type="checkbox"/> Power Stripping <input type="checkbox"/> Diamond or other Core drilling <input type="checkbox"/> Land Survey	SSM	601690	40	SSM	601698	40	SSM	601709	40		
		601691	40		601699	40		601710	40		
		601692	40		601700	40		601711	40		
		601693	40		601701	40		601712	40		
		601694	40		601702	40		601713	40		
		601695	40		601703	40		601714	40		
		601696	40		601707	40		601715	40		
		601697	40		601708	40		601716	40		

All the work was performed on Mining Claim(s):

Required Information eg: type of equipment, Names, Addresses, etc. (See Table Below)



Name and Postal Address of Recorded Holder MACMILLAN ENERGY CORP. LTD	Prospector's Licence No. T 1706
---	---

Summary of Work Performance and Distribution of Credits

Total Work Days Cr. claimed	Mining Claim			Work Days Cr.	Mining Claim			Work Days Cr.	Mining Claim		
	Prefix	Number	Work Days Cr.		Prefix	Number	Work Days Cr.		Prefix	Number	Work Days Cr.
for Performance of the following work. (Check one only) <input type="checkbox"/> Manual Work <input type="checkbox"/> Shaft Sinking Drifting or other Lateral Work. <input type="checkbox"/> Compressed Air, other Power driven or mechanical equip. <input type="checkbox"/> Power Stripping <input type="checkbox"/> Diamond or other Core drilling <input type="checkbox"/> Land Survey	SSM	601717	40	SSM	601731	40	SSM	601739	40		
		601718	40		601732	40		601740	40		
		601719	40		601733	40		601741	40		
		601720	40		601734	40		601742	40		
		601721	40		601735	40		601750	40		
		601728	40		601736	40		601751	40		
		601729	40		601737	40		601752	40		
		601730	40		601738	40		601753	40		

All the work was performed on Mining Claim(s):

Required Information eg: type of equipment, Names, Addresses, etc. (See Table Below)

Name and Postal Address of Recorded Holder MACMILLAN ENERGY CORP. LTD	Prospector's Licence No. T 1706
---	---

Summary of Work Performance and Distribution of Credits

Total Work Days Cr. claimed	Mining Claim			Mining Claim			Mining Claim			
	Prefix	Number	Work Days Cr.	Prefix	Number	Work Days Cr.	Prefix	Number	Work Days Cr.	
for Performance of the following work. (Check one only) <input type="checkbox"/> Manual Work <input type="checkbox"/> Shaft Sinking Drifting or other Lateral Work. <input type="checkbox"/> Compressed Air, other Power driven or mechanical equip. <input type="checkbox"/> Power Stripping <input type="checkbox"/> Diamond or other Core drilling <input type="checkbox"/> Land Survey	SSM	601754	40	SSM	601771	80	SSM	601780	110	
		601755	40		601772	80		601781	40	
		601756	40		601773	80		601782	40	
		601757	40		601774	80		601791	40	
		601758	40		601776	80		601792	40	
		601759	40		601777	73		601793	40	
		601760	40		601778	62		601794	33	
		601761	54		601779	62		601795	33	
All the work was performed on Mining Claim(s):			384	601775			40	627		

Required Information eg: type of equipment, Names, Addresses, etc. (See Table Below)

Name and Postal Address of Recorded Holder MACMILLAN ENERGY CORP. LTD	Prospector's Licence No. T 1706
---	---

Summary of Work Performance and Distribution of Credits

Total Work Days Cr. claimed	Mining Claim			Mining Claim			Mining Claim			
	Prefix	Number	Work Days Cr.	Prefix	Number	Work Days Cr.	Prefix	Number	Work Days Cr.	
for Performance of the following work. (Check one only) <input type="checkbox"/> Manual Work <input type="checkbox"/> Shaft Sinking Drifting or other Lateral Work. <input type="checkbox"/> Compressed Air, other Power driven or mechanical equip. <input type="checkbox"/> Power Stripping <input type="checkbox"/> Diamond or other Core drilling <input type="checkbox"/> Land Survey	SSM	601796	33	SSM	601814	40	SSM	601822	22	
		601797	33		601815	33		601823	22	
		601798	22		601816	1		601824	22	
		601799	22		601817	1		601837	40	
		601800	22		601818	1		601838	40	
		601801	22		601819	1		601839	0	
		601802	22		601820	0		601840	1	
		601813	40		601821	22		601841	1	
All the work was performed on Mining Claim(s):			216				94			

Required Information eg: type of equipment, Names, Addresses, etc. (See Table Below)

Name and Postal Address of Recorded Holder MACMILLAN ENERGY CORP. LTD	Prospector's Licence No. T 1706
---	---

Summary of Work Performance and Distribution of Credits

Total Work Days Cr. claimed	Mining Claim			Mining Claim			Mining Claim			
	Prefix	Number	Work Days Cr.	Prefix	Number	Work Days Cr.	Prefix	Number	Work Days Cr.	
for Performance of the following work. (Check one only) <input type="checkbox"/> Manual Work <input type="checkbox"/> Shaft Sinking Drifting or other Lateral Work. <input type="checkbox"/> Compressed Air, other Power driven or mechanical equip. <input type="checkbox"/> Power Stripping <input type="checkbox"/> Diamond or other Core drilling <input type="checkbox"/> Land Survey	SSM	601842	1	SSM	601860	40	SSM	601868	33	
		601843	1		601861	33		601869	33	
		601844	1		601862	33		601870	33	
		601845	40		601863	33		601880	40	
		601846	33		601864	33		601881	40	
		601847	33		601865	33		601882	33	
		601848	40		601866	33		601883	0	
		601859	40		601867	33		601884	0	
All the work was performed on Mining Claim(s):			159				211	212		

Required Information eg: type of equipment, Names, Addresses, etc. (See Table Below)



Name and Postal Address of Recorded Holder MACMILLAN ENERGY CORP. LTD	Prospector's Licence No. T 1706
---	---

Summary of Work Performance and Distribution of Credits

Total Work Days Cr. claimed	Mining Claim			Mining Claim			Mining Claim		
	Prefix	Number	Work Days Cr.	Prefix	Number	Work Days Cr.	Prefix	Number	Work Days Cr.
or Performance of the following work. (Check one only) <input type="checkbox"/> Manual Work <input type="checkbox"/> Shaft Sinking Drifting or other Lateral Work. <input type="checkbox"/> Compressed Air, other Power driven or mechanical equip. <input type="checkbox"/> Power Stripping <input type="checkbox"/> Diamond or other Core drilling <input type="checkbox"/> Land Survey	SSM	601885	33	SSM	601899	40	SSM	601827	40
		601886	24		601900	31		644672	40
		601887	0		629238	0		722575	40
		601888	31		629239	24		722576	40
		601889	31		629242	0		722577	40
		601890	40		629243	40		722578	40
		601891	40		629245	31		722579	40
		601898	40		601825	40		722589	40
All the work was performed on Mining Claim(s):			239				200	722590	40

Required information eg: type of equipment, Names, Addresses, etc. (See Table Below)

BREAKDOWN OF DRILLING

SSM 601820	M-94	66.14M ✓
SSM 601844	M-68	56.99M ✓
SSM 601843	M-69/M-90	63.09M ✓
SSM 629242	M-91	63.09M ✓
SSM 629238	M-92	63.09M ✓
SSM 601899	M-93	63.09M ✓
SSM 601742	M-57	124.05M ✓
SSM 601701	M-58	60.05M ✓
SSM 601662	M-62	63.09M ✓
	M-63	136.24M ✓
SSM 601681	M-64	60.04M ✓
	M-65	63.09M ✓
SSM 601657	M-66	60.06M ✓
SSM 601659	M-67	61.87M ✓
SSM 601664	M-59	63.09M ✓
SSM 601609	M-60	63.09M ✓
	M-61	60.04M ✓
SSM 644659	M-72	63.09M ✓
SSM 644658	M-73	50.90M ✓
SSM 644616	M-74	57.91M ✓
SSM 644665	M-75	66.14M ✓
	M-76	124.05M ✓
SSM 644604	M-77	66.14M ✓
SSM 644673	M-78	78.33M ✓
SSM 644675	M-79	96.01M ✓
SSM 644680	M-100	76.20M ✓
SSM 661003	M-101	84.43M ✓
SSM 644678	M-102	202.39M ✓
TOTAL		2155.79M (7072.8 ft.) or 7073 days ✓

8.M

8.M

TRIM LINE

AREA OF
ABBIE LAKE
 DISTRICT OF
 THUNDER BAY - ALGOMA
 SAULT STE. MARIE
 MINING DIVISION
 SCALE: 1-INCH = 40 CHAINS

LEGEND

PATENTED LAND	⊙
CROWN LAND SALE	⊙
LEASES	⊙
LOCATED LAND	⊙
LICENSE OF OCCUPATION	⊙
MINING RIGHTS ONLY	M.R.O.
SURFACE RIGHTS ONLY	S.R.O.
ROADS	—
IMPROVED ROADS	—
KING'S HIGHWAYS	—
RAILWAYS	—
POWER LINES	—
MARSH OR MUSKOG	—
MINES	—

NOTES

For status of Twp 33 R 26 please consult
 the A.C.S. & R. Ry. Sault Ste. Marie Ont.

400' Surface Rights Reservation around all lakes
 & rivers.

For status of mining rights
 see also the Mining Division
 files.

SAULT STE. MARIE
 MINING DIVISION
RECEIVED
 MAY 20 1983
 A.M. 11:19 P.M. 11:19

NATIONAL TOPOGRAPHIC SERIES 42C3
PLAN NO. M-8
 ONTARIO
 MINISTRY OF NATURAL RESOURCES
 SURVEYS AND MAPPING BRANCH

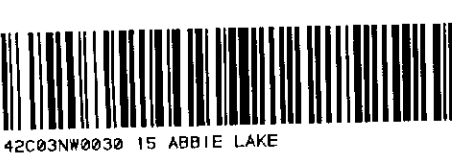
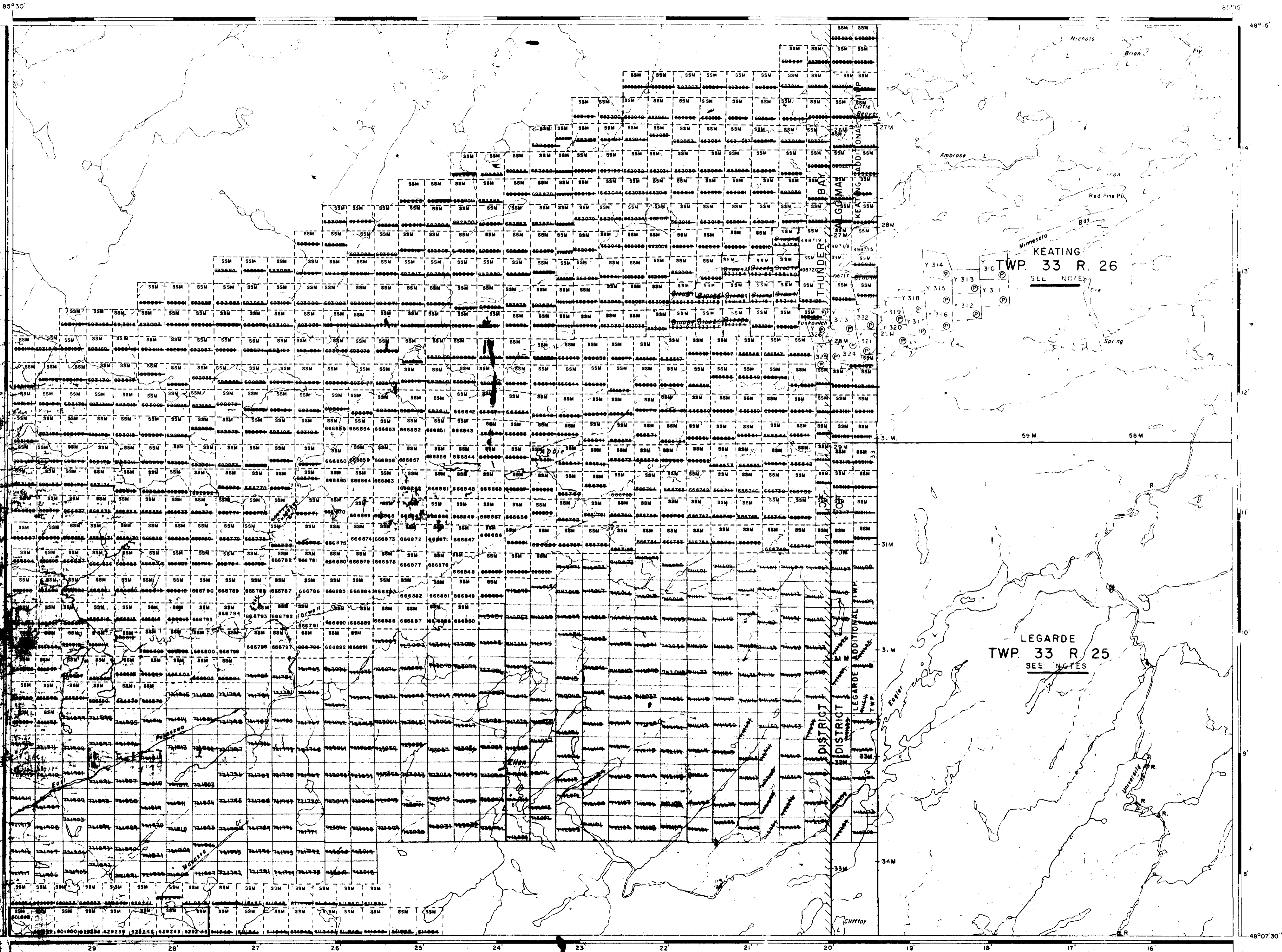

200

TRIM LINE

8.M