



REPORT ON MICHAEL (GODIN LAKE) CLAIMS

PROPERTY * TITLE

This property consists of a group of four contiguous claims numbers 2469 - 2470 - 2474 - 2475. They were staked in November 1920 by Mr. J. Webb, and are now held as follows:- A.H.Chitty one quarter; J.J.McPadden one quarter; G.L.Michael one quarter; T.J. Wilcox one eighth, and J. Webb one eighth. G.L.Michael has authority from all the owners to deal with this property.

The work has been completed on all of these claims and the contract let to have them surveyed. An application for the patent will be made as soon as the survey is completed.

Location.

The claims are located about one and three quarter miles due south of Localsh Station on the C.P.R. and are on Crown Lands. They are situated just north and east of Godin Lake, the west claim lying in the east central part of township 48, range XXVIII, and the remaining three claims in line with and immediately east of this claim and in township 47, range XXVIII. The plan which accompanies this report shows the relative position of these claims.

They are easily accessible from Localsh by a canoe route with three short portages. A road from this point on the CPR. to the property could be made with little difficulty and would be about two and one half miles in length.

TOPOGRAPHY

The topography on these claims is the same as on a large part of the country from Dog Lake westward. It consists mainly of a series of low ridges with swamps in between. The general strike of the ridges is east and west. On the south west part of the claims the land slopes down to a swamp which borders on Godin Lake. The ridges are mostly bare but between the ridges there is a heavy covering of glacial drift so that prospecting in this district has largely been confined to the ridges. No point on the claims is over 75 feet above the level of Godin Lake.

TIMBER

Except in the swamps there is very little timber of any kind on this property. The ridges are all burned

over and only a scrubby second growth is found there. There would be sufficient timber, however, in the immediate vicinity of the claims for mining operations. There is sufficient wood for drilling operations on the claims themselves. The timber in the swamps consists chiefly of spruce and a little birch.

WATER

Most of the swamps contain a small amount of water but the supply is uncertain even for drilling purposes. Generally, this water supply could only be relied upon if rains were frequent. Water supply for all purposes however, can be obtained from Godin Lake which is about 440 yards from the ore body.

CONCLUSIONS

As stated in the body of this report there is a well defined shear zone, striking almost east and west through this property. This zone has been trenched and partly stripped over a length of 800 feet. Its width varies from about one hundred feet at the west end to about one hundred and seventyfive feet at the east. There are lenses of quartz (veins) throughout this zone, which fill the open spaces along the planes of shearing. These lenses are almost negligible in width and value on the northern part of this zone but on the southern part, near the south wall they are larger and carry fair values. The most important vein has an average width of seven feet and has been traced for about 100 feet in length. The average values over this distance are over \$8.00. On the west end of this vein it splits up into small stringers and cannot be definitely traced. On the east end at its greatest width it is covered by swampy ground. Attempts were made to trench across this swamp but owing to the water they had to be discontinued. This swamp extends for a distance of one hundred and thirty feet. The sheared zone continues on east from this swamp and quartz veins can be seen at several points in it. I am not certain that the veins at this point are continuations of the ones on the west side. They vary in width from a few inches to over 5 feet and carry about \$1.50 in gold. At one point a sample from three parallel veins each about six inches in width assayed \$13.00.

While the veins already exposed are not great enough in extent to warrant extensive mining operations, at the same time it must be kept in mind that their limits are not yet defined on surface and much less underground. The zone over which shearing action has taken place is of considerable size and offers an excellent opportunity for the deposition of the gold bearing quartz. It is definitely

proven that the gold bearing quartz has found its way into this zone and it is well within the range of possibility that at places in the zone, lenses of quartz large enough and rich enough in gold may be found which can be profitably mined. It is generally conceded by government geologists who have examined this district that the quartz and gold have come from the granite masses which underlie and at many points intrude the Keewatin formation. The vein on the property of the Goudreau Gold Mines is believed to have originated from a small granite intrusion near it. There are no known granite intrusions near the zone above mentioned, and it is possible that the veins in it have come from the granite which underlies it. This being the case it would be reasonable to expect more quartz with depth and as the gold values are associated with the quartz, more gold should also be encountered. As the zone can be traced over a very long distance it is reasonable to expect that it will continue to great depth.

RECOMMENDATIONS

Owing to the width of the zone the only logical method of exploring it is by diamond drilling. I would therefore, recommend that an initial drilling program consisting of a row of six shallow holes to cut the zone at a depth of between 100 feet and 150 feet. These holes to be spaced about 125 feet apart commencing at a point near the boundary between claims 2469 and 2470 and working east. Also that two holes about 200 feet apart be drilled to cut the zone at a depth of 400 feet. These holes to cut under the central part of the shallow holes. The cost of this work would be about \$11,000. Future work would be dependent on the results of this drilling.

GEOLOGY.

The rocks of this area are almost entirely basic volcanics of Keewatin age. On the boundary between claims 2469 and 2470 there is a narrow band of quartz porphyry. This band strikes a few degrees south of east and its southern boundary is about 400 feet from the south boundary of the property. The formation on the south is a dense basic greenstone. To the north there is about 50 feet of very silicious Keewatin schist which is so altered as to make it impossible to state definitely what it is. Immediately north of this there is a basic, ellipsoidal greenstone, the ellipsoidal or pillow structure being very apparent. In the vicinity of the contact of the porphyry with the greenstone on the south there is a well defined shear zone extending from this contact northward and including the porphyry and much of the silicious schist above mentioned. The strike of this zone is identical with that of the formation i.e., a little south of east. Many small quartz veins have intruded this shear zone especially near its southern contact.

These veins are very irregular in width and are often found to be split up into several small stringers for some distance and then come together again. In between these veins is schisted porphyry and in the case of the veins some distance from the south contact, they are divided by silicious greenstone schist.

Practically the whole of the constituent rocks of this shear zone have been subjected to the action of carbonate solutions. This is especially noticeable along the southern boundary. Much of the porphyry has been entirely replaced by carbonated and in places is now either siderite or another mixture of iron and carbonates. The weathering is characteristic of an iron carbonate being a distinctive yellowish brown. The schist for some distance north is stained this color. There is also evidence of a considerable amount of decomposed pyrite. The characteristic gossan of weathered pyrite is to be seen in several places along the zone. This was to be expected as a large amount of pyrite is contained in the quartz veins, porphyry and schist. This weathering action has taken place to a depth of from a few inches to several feet. At one point a pit about ten feet deep failed to reach the bottom of the decomposed material. All the schisted rocks are tilted on edge dipping at about 85 degrees to the north. In addition to the quartz veins above mentioned, there are several cross veins striking almost north and south. These veins are younger than the first set as they cut them. This zone is also fractured horizontally, these fractures being from three inches to three feet apart. Along these flat fractures narrow quartz veins were seen. Unlike the first two sets of veins, they show no evidence of metallic mineralization, nor do they appear to have been acted upon by the carbonate solutions. The sheared zone varies in width from about 100 feet on the west end to 175 feet on the east. The schisting is most pronounced on the south side and becomes less noticeable towards the northern boundary. It has been traced over a distance of 800 feet and probably extends further than this in both directions.

A diabase dike cuts through the hanging wall about 40 feet north of the schisted zone. It is about 25 feet wide and runs almost parallel with the zone. Its contacts are clean and sharp. Several other diabase dikes were noticed on the eastern end of the property.

Owing to the intense schisting action and altered condition of the rocks it was difficult to determine just where the gold values were located. Over 100 samples were taken at various points along and across the zone and the enriched portion fairly well located.

As stated in the body of this report, in the intensely sheared part of the zone which is close to the south contact there are quartz veins. The main gold values are confined to these veins. The veins vary in width from a few inches to several feet. Close to the boundary between claims 2469 and 2470 there are several parallel quartz veins each about six inches in width and about one foot apart. Samples taken from these veins gave from \$1.50 to \$4.00 in gold. One narrow vein, 6 inches in width assayed \$9.00. At a point 120 feet east of the above mentioned boundary one of these narrow veins widened out to one and one half feet and assayed \$9.00. Thirteen feet east of the same vein widens to 3 feet and assayed \$4.50. Eleven feet east from here it narrowed to 1.8 feet and assayed \$6.00. From this point the vein widens rapidly and the following table gives the width of the vein, the gold content, and the distance between samples measuring east from the last mentioned sample.

<u>Width of channel sample</u>	<u>Gold Value</u>	<u>Distance of sample E. of preceding one.</u>
7 feet	\$7.00	10 feet
4.2 "	7. 00	5 "
5.5 "	8. 00	5 "
10.7 "	8. 50	5. 5 "
16.5 "	12. 00	24 "
8.5 "	6. 50	5. "
X 10 "	9. 00	8 "

X This last sample could not be taken over the entire width of the vein as the trench from the south end of this sample on south was filled with water so it was possible that the enrichment would extend over more than 10 feet.

From the point where these samples stop, the ground is low and swampy for a distance of 130 feet. Three attempts were made to trench across this swamp but they had to be discontinued owing to water.

On the east side of this swamp practically the same conditions exist on the west side. The sheared zone continues and the quartz veins are found. I cannot state definitely that the quartz veins found here are the direct continuation of those on the west side of the swamp. Samples taken from several points on these quartz veins assayed \$1.50 to \$3.00. One sample taken from three parallel quartz veins each about six inches in width assayed \$13.00.

It was very difficult to determine the width of the quartz vein on the west end of the swamp. This was due to the decomposed and altered state of all the rocks including the quartz itself which gave them a very similar appearance on the surface. In some instances the quartz veins were

not exposed at all being covered with a decomposed schistlike material to a depth of from a few inches to several feet. This rendered systematic sampling over any considerable distance very difficult owing to the amount of work necessary to expose the solid vein material. Another difficulty encountered in determining the width of the vein was the fact that the porphyry on one or sometimes both sides of it was so silicious as to be almost pure quartz and it was hard to tell where the contact between the vein and the porphyry was located. The quartz porphyry itself is schisted and carries about \$1.50 in gold at all points samples. The schisted Keewatin rock immediately north of the vein carries many very narrow quartz veinlets along the schist planes. This schist for a distance of over 50 feet north from the vein carries about \$1.50 in gold.

All samples were taken under my supervision and all assays were made by D. Johns Assayer and Metallurgist of Haileybury.

GEORGE W. MACLEOD.

Sault Ste. Marie. Ont.
August 12, 1922.

A. W. Cannon

Temp. 48

3M

4M

5M

3559

3173A

... ..
... ..
... ..

C.H.

August 30th, 1926

The following is a description of the Cline property giving all the information I have been able to collect.

This property consists of a group of six claims numbers 334 2185, 2186, 2188, 2189, 2190 and 2271, all of which have been patented. The property is located in the central part of Township 48, eleven miles Northeast of Goudreau Station on the Algona Central Railway. The Provincial Government has constructed a road suitable for motor traffic from Goudreau station to this property. This road is in a good state of repair at the present time.

The work on this property has largely been confined to claims 2185 and 2186 which form the north-western part of the group. A large amount of surface trenching has been done and several narrow but high grade veins have been uncovered. No. 1 shaft was sunk to a depth of one hundred and thirty feet on one of these high grade veins. This vein was not continuous all the way down the shaft, and varied in width from a few inches to three feet. I have not seen the assay plan of the shaft, but considerable free gold was visible in a greater part of the vein material. A level was established at the eighty foot level and about seventy-five feet of drifting done from this point. It appeared to be from the limited observations I was allowed to make, that better and more consistent material was encountered in this lower work, than from the surface down to this point. I would judge that the vein, which in reality is a series of lenses, was visible in the shaft for about two-thirds of the distance. The remaining one third forming the dead ground between the various lenses. As I mentioned above, I do not know what the values were, but Mr. Webb told me on several occasions that a considerable amount of the development work at this point was in commercial ore. There are several small veins in the vicinity of the one just referred to, but these were not explored from this shaft. Work was being continued in this shaft up until the time the option was dropped.

During the winter of 1924-25 a drilling campaign was carried on by the Cline Canadian Company, consisting of seven holes at various points on the property. Mr. Webb reported that one of these holes had cut a vein carrying commercial ore over a width of twelve feet, and a few shaft was planned to open up this vein which apparently did not outcrop at surface. At the point where this shaft was started free gold was visible on surface in a quartz lense from a few inches to two feet in

width, and the shaft followed this vein to a depth of forty-five feet where it apparently swung into the foot wall of the shaft. Mr. Webb stated that he considered this vein to be of commercial value as far as they explored it. From a depth of forty-five feet to eighty feet no values were encountered in the shaft. At eighty feet a series of small rich stringers were encountered which continued to the one hundred foot level where they swung into the hanging wall of the shaft. At the one hundred level a crosscut was run both north and south from the shaft for about twenty feet each way, and in this cross-cutting three veins were encountered, but I do not know the values contained in any of them. From the one-hundred foot to one hundred and sixty foot level nothing was encountered in the shaft. At one hundred and sixty feet a vein about five feet in width came in angling across the shaft, and going out at a depth of one hundred and eighty feet on the opposite side. The shaft was then continued to a depth of two hundred feet, at which point another vein was reported by the miners, but at this round was not mucked out, nothing is known about it. The vein which came into the shaft at one hundred and sixty and one hundred and eighty feet, according to Mr. Webb was the one which the drill hole had encountered, and it had been the original intention to carry on development work on this vein from the point the shaft entered it. Mr. Webb was in England at this time, and his assay department was turning in very incorrect values of the material encountered in the shaft. From a point immediately above the one hundred and sixty foot mark in this shaft the assayer was reporting commercial ore at all points sampled. The results continued so uniformly that the programme was altered, and instead of developing the vein when encountered, the shaft was continued on down to the two hundred foot level. When Mr. Webb returned from England, he checked this sampling, sending his samples to us for analysis. With the exception of a group of five samples, which averaged about \$12.00 and which Mr. Webb stated came from the vein mentioned, we obtained no results. I went to Goudreau with Mr. Webb to find out what was wrong with their assay office, and found that the assayer, who was apparently very inexperienced was using a balance which was extremely inaccurate, and which, in part, accounted for erroneous results obtained. The method of assaying used by the assayer in itself was far enough away from the standard practices to account for any discrepancies in the results. The net result was that with a years operation, and the expenditure of \$75.00 the Company had practically no more information on the vein they were attempting to develop than they already knew from the drill hole. There is no doubt that the Directors of the Company were expecting a report from Mr. Webb verifying the fine results obtained from the shaft, which if true, showed that they were in a very important ore body. I imagine that when the truth was made known to them, coupled with the fact that within a few days there was a large cash payment due on the purchase price of the property, they were very much disgusted.

The work at this property, I think, holds the record for high cost, and length of time consumed.

At this time the Mines Inspector visited the property and suspended operations, due to dangerous working conditions in the shaft. The health authorities had been threatening for sometime to close down the operation, due to unsanitary conditions.

I am of the opinion that all these factors combined were responsible for the decision to drop the option rather than the merits of the property itself.

On the property there are a set of camps which with some minor changes suggested by the health authorities, are suitable for any preliminary operations. There is a two-hundred foot gasoline driven Holman portable compressor, a small Holman hoist, together with drills, blacksmith equipment etc, on the property. There is also a pump at the shafts.

I do not consider that it would be a very expensive undertaking to make a thorough examination of the development work at this property.

Racicot Copper Prospect - Strobos Lake area, Goudreau.

Introduction. Dave Racicot, tourist operator at Localsh, showed E. Rendell and myself a copper showing on his claims south of Edwards Consolidated Mine, Goudreau, on November 3rd, 1958.

Location. Twp.48; at or near northeast corner of claim 3773A. From east end Strobos Lake, southeast along new lumber road for 4000 feet to picket line, bearing N. 53° E. 2000 feet along picket line directly to showing.

Description. - Mineralized zone:- exposed length - 65 feet; width - up to 8 feet; strike - N. 15° E., dip - 65° south. Exposed by trenching and old pit 10 feet long, 8 feet wide, about 6 feet deep.

A zone of sulphides is present in sheared rhyolite and sugary chert; it may be part of an iron formation. Massive pyrite is most common. Chalcopyrite, sphalerite and pyrrhotite disseminations occur across a width of 1 to 3 feet in the mineralized zone. The Cu-Zn mineralization is irregular and spotty in distribution; most occurs as narrow veinlets and splashes up to 1 inch wide within pyrite.

There is evidence of recent drilling (within 5 years) southeast of the showing. At least 5 drill set-ups are present, spaced at 50-foot intervals on a line 50 feet southeast of the showing and parallel to it. Wooden stakes in the collars of some holes suggest 45° and 60° holes were drilled towards the showing from each set up. Some holes are labelled "J.B.-1", suggesting drilling by "Joburke" Company, 3 or 4 years ago. Their drilling reportedly gave them no encouragement.

Sampling

1. Sample # - chip sample across 3 feet width at North end of showing.
2. Sample # - 25 feet southwest of sample # along strike of zone; chip sample across 6 feet mineralized zone.
3. Sample # - same location as sample # ; chip sample across 2 foot zone lying adjacent to sample # to the southeast.

Appraisal.

- The Cu-Zn mineralization as exposed in pit and trenches is too small and irregular in dimensions and distribution to offer any real encouragement. The large amount of reportedly negative drilling seems to rule out any reasonable chance. No further work is recommended.

A.M. Goodwin.

Jamestown, November 6th, 1958.

COPY.

CF

March 18th, 1960.

**The President & Directors.
Pick Mines Limited.
Suite 8009
80, King Street West,
Toronto, Ontario.**

Gentlemen:

I am submitting herewith my report on the western veins of the Pick Mines property at Lochalsh, Ontario, and an estimate of the ore that can be mined above the old mine workings without dewatering the mine.

A cross cut and drifts were driven a distance of 2,250 feet from the main shaft to the western part of the property. The No.2 vein system was intersected and partially opened up by way of drifts, raises and sub levels.

There are three parallel veins in an area 60 feet in width. On two of these stoping operations were started and a small tonnage delivered to the mill prior to the closing of the mine caused by the lack of labour and materials brought on by the war.

All ore delivered to the mill from the above veins was hand trammed to the main shaft in one ton cars. It was therefore, necessary that this ore be of a much higher grade than the average mine ore delivered to the mill from the main shaft area.

There is an estimated 20,000 tons of Ore between the 405 drift and the 472-22 sub drift yet to be mined, and the veins have not yet been delimited. This ore will have to remain in the mine until such time as the main mine is dewatered,

There is a large tonnage of ore above this area that can be mined from the No.3 shaft when it is deepened and a cross cut driven south 370 feet to this area.

My estimate of the Ore lying above the 472, 322, 430 and No.2 parallel vein which can be mined is as follows:

14,787 tons	@ \$24.59 per ton	Gold	-	\$363,632.00
7,687 "	@ 13.75 "	" "	-	105,693.00
7,500 "	@ 17.95 "	" "	-	134,625.00
<u>29,974 tons</u>	<u>@ \$20.14 per ton</u>	<u>Gold</u>	<u>-</u>	<u>\$603,930.00</u>

S SM 1710 G

2.
In addition to the above there is an estimated 33,074 tons of probable ore that should grade \$16.38 per ton with a value of \$341,801.00. The above is enough ore to supply a 50 ton mill for three and a half years.

The above veins are along the strike of the No. 2 shaft vein system which was only partially developed. Several hundred feet of lateral work will be required to reach the No. 2 shaft area.

The No. 1 shaft was sunk to a depth of 115 feet on a vein showing considerable native Gold. The dump from this shaft was taken and milled in the Cline Lake Gold Mines mill. A sample of this taken by the writer assayed 25.64 oz. Gold per ton. 430 feet directly below this shaft visible Gold was reported in Diamond Drill Hole No. 300.

Two test pits about 400 feet east of this shaft on the strike of the vein assayed 2.23 oz. Gold and 1.45 oz Gold per ton, both samples were cut by the writer and were 14 and 18 inches in width respectively. These pits are on the side of a hill from which point an adit would be driven on the vein.

In addition to the above veins No. 2 and 3, the No. 1 vein lies further north. Diamond drill Hole No. 311 from the drift in this area cut 1.4 feet averaging .38 oz Gold per ton, which is probably the downward extension of the No. 1 Vein. A shaft was sunk on this vein. It is 1,250 feet east of the No. 3 shaft. Then one hundred and fifty feet east of this main No. 1 vein shaft is another 65 foot shaft, this was dewatered in 1936. Native Gold was seen in the vein at various places down the shaft.

On the No. 3 vein visible Gold was encountered down the shaft and on the levels and good grade ore is found on surface on the strike of the vein. Diamond Drill Hole No. 300 cut the vein 430 feet below the shaft showing visible Gold. It therefore seems logical that a good tonnage of ore will be developed on the No. 3 vein as on the No. 2 vein system. The No. 1 vein system will possibly prove up considerably more ore.

It is, therefore, quite probable that the life of the mine would be extended many years by opening up and developing all three vein systems. This could be done by making the No. 3 shaft the main shaft on the property and by developing all the veins from this one shaft.

Respectfully submitted,

M.C. Halstead. P. Eng.

MCH/cc.

48

Township 49.

A visit was made to Pick Mines located 12 miles east of Goudreau, on the Goudreau-Localsh road. M.C. Halstead is the consulting geologist. Known formerly as Clino Lake Mines, the property has been adequately described geologically (ODM Vol. 44. part 3. 1940).

Pick Mines was formed approximately two years ago and financed by Toronto interests. Mine and Mill equipment, purchased from Jardin Mines had been installed at the time of the visit.

Mining activity had been centered on an east-west trending vein and an adit was driven for approximately 400' into the side of a hill, 300' east of the No. 3 shaft. A sketch of the surface plan is shown below:-

The auriferous vein is 8" to 36" in width and is associated with quartz porphyry. Several other veins have been discovered on the hill, to the north of the vein.

Visible gold may be seen in the adit walls and in the rubble lying on the adit floor. Three holes, drilled from the 100' level of the No. 3 shaft have indicated a tonnage of 129,000 tons at a value of \$25 per ton over a 3' width.

The mill had commenced operations when an adit cave-in occurred 100' inside the portal. A bypass drift had to be driven 150' around the caved area. The mill flow sheet is similar to that of other cyanide mills at other Ontario gold camps, with one exception. Three thickeners and a wash replace the filter set-up. It is capable of handling 50 tons per day, as a straight cyanide mill, or 200 tons per day as a cyanide/floatation mill.

An unsuccessful attempt was made at puring gold brick. Apparently the operators had no idea of the correct fuel injection pressure to use, and consequently the furnace was below the correct temperature. It is reported that the best part of the brick remains inside the furnace.

Hydro electric power was supplied by the Great Lakes Power Company.

The work force during mill construction numbered 35 men.

48
township 49 cont.

- 4 -

At the time of the visit (June 7, 1961) the mine was closed. Amc; the few remaining on the property, there was a spirit of optimism that the mine would operate shortly. Recent information indicates that the mine is still closed and that, at the present time, is hardly worthwhile venture.

C.R.Kustra.
July 1961.

CA
July 30, 1961.

Don:

We just arrived from Old Cabin Lake and, unfortunately, the results are not encouraging. We found only one indication of pyrite - about 10% to 15% streaked and in irregular patches in intermediate volc. This was in loose fragments on a hill slope not far from Bruce's indication of iron formation (O.D.M. vol. 49, 1940, geol. map). We did not find his iron formation. The swamp along the south shore of the lake is walkable, but, in places quite shaky. There is no visible indication of pyrite along the shore, or in the water. The rocks are mainly acid and basic. Locally, in the very basic rocks (some of which may be dikes) there is a small amount of magnetite. Several old trenches were seen in the area. Gledhill reports some qtz. veins and the trenches probably were dug to examine the veins. We sounded the bottom along the south shore and found bedrock to occur within 2' of the water surface and covered by about 18" of muck. The whole lake is rather shallow.

The lake is accessible by canoe via the Tehoama River to Godin Lake, thence via creek from Godin to Old Cabin. The creek is quite tortuous and averages 10' in width.

Since our rummaging failed to uncover anything, it may be wise to run some E.M., although part may have to be done over water.

You will find a sketch map of the vicinity of Old Cabin and Godin Lake and some comments. There has been some recent staking, to include Old Cabin Lake. These are all cancelled according to Mining Recorder's office, August 10, 1961 - D.E.S.)

The total time to travel from Goudreau to Old Cabin was about 5½ hours. It took 4½ hours to come back. Of that time, about 2½ - 3 hours were spent canoeing and portaging. There are 3 portages; 2 are short, the third is a bit dirty. Current velocity of the creek is low.

Another way to get to the lake, which may be quicker is to take Cappellani's road from Strobos Lake. Cawdron, paddle to the east tip of Cawdron, then set off cross country for about 1.5 miles. Again, there is supposed to be a trail to the lake, but it is probably in bad repair.

We are visiting prospects and rechecking A.G.P. anomalies. Haven't run into Jonsmith prospectors yet.

Regards,

Clarence Kustra.

CH

CROWN TOWNSHIP L8 (CH)

An investigation was made of the south shore of Old Cabin Lake in the southeast corner of the township over ground reported to carry pyrite. Some rubble of pyrite bearing chlorite schist was found on a hill slope, but the source could not be traced. Rocks in the vicinity include acid and basic volcanics and pyroclastics. Locally, the basic volcanics exhibit weak magnetism.

(ii) A brief visit was made to Pick Mines. Several of the buildings are being readied for a "re-opening" scheduled in two to three weeks.

(iii) Gledhill (O.D.M. Vol. 36, 1927) reports a shear zone with quartz on the east side of Laughlin (Indian) lake. The zone occurs in acid volcanics and consists of sericite schist with thin discontinuous, barren quartz veins scattered over a large width. The rocks strike at 110° and dip steeply north. No sampling was attempted.

(iv) The Markes' property ties on to the east boundary of Pick Mines. To the east and west of the number one post of claim 7263 (map 49g, 1940, O.D.M.) several long trenches, now partially filled, have uncovered a shear zone in basic volcanics. The zone appears to be 4' to 5' in width, strikes at 100° and dips vertically. It is conformable with the enclosing rocks and is mineralized with pyrite in amounts up to 10%. Sugary quartz occurs with the schist.

On the line between claims 7263 and 7648 a 125' trench occurs across a quartz porphyry/greenstone contact. The trench has a considerable amount of water. Burwash (O.D.M., 1935) reports that this trench exposed a mineralized contact between the greenstone and quartz porphyry.

A core shack containing approximately 1500' of core was found. Core consists of acid and basic volcanics and quartz porphyry.

C. Kustra.

Coudreau, Ontario,
August 4, 1961.

NOT TO BE REPRODUCED FROM
THE OFFICE OF THE ASSISTANT
GEOLOGIST IN CHIEF OF MINES
Sault Ste. Marie, Ont.

CROWN TOWNSHIP, L8 (CH)

1. The Edwards' Consolidated property lies adjacent to the west boundary of Pick Mines, in the central part of the township, approximately nine miles northeast of Goudreau (Map 49g). The main showing lies in claim 3559 and consists of sheared Keewatin volcanics intruded by quartz porphyry. The vein matter consists of quartz associated with pyrite and tourmaline. A sample SA-127 was taken from a vein 500' north of the shaft, termed the No. 2 vein (O.D.M. Vol. 44, 1935).

2. The Racicot copper prospect is located near the northeast corner of claim A (Map 49g), one mile southwest of Pick Mines. The prospect is accessible from the St. Louis Lake-Cawdron Lake Road via a picket line running for 2000' at North 53 east from a point on the road 4000' south of Strobos Lake.

The showing consists of a shear/breccia zone, in excess of a 10' width, in grey rhyolite and trends North 50 east and dips 50° south. A trench has exposed the zone for a length of approximately 50', and a pit has been sunk at the northeast end of the trench. To the southwest, the zone disappears under drift.

A sulphide zone consists of an iron formation (interbedded quartz and pyrite) smeared with bands and streaks of chalcopyrite, pyrrhotite and sphalerite. Pyrite is the most abundant mineral and is followed by chalcopyrite, pyrrhotite and sphalerite, in descending abundance. The sulphides are irregularly distributed and spotty, and occupy a 2' to 3' width. Locally, the iron formation is brecciated and cemented by secondary quartz, chalcopyrite and pyrrhotite (specimen KRA-1). The pyrrhotite is not nickeliferous. The property is reported to have been drilled by Joburke. Several setups were seen.

A grab sample of chalcopyrite bearing rock, SA-161, was taken. *CU 5.50%
AU TR.*

3. The ~~Michael-Sudicate~~ group of claims is located in the extreme west central portion of the township, 1/2 mile southeast of Mile post 3. The showing is accessible by a good walking trail from the Goudreau-Lochalsh road. (Ref: Gledhill, Map 366).

The main showing is located in the southeast corner of claim 4200, and consists of a 15' breccia-shear zone impregnated with quartz and pyrite, and trending N30W. Some chalcopyrite is present and, according to Gledhill, some native gold.

The west side of the zone is occupied by a diabase dyke.

A 20' shaft has been sunk into the zone, and the A-type headframe continued to stand. A sample SA-133, representing a 9' width, was taken. *C.02 01.400' Av.
Other elements, no assays.*

4. A.C.P. Anomaly O, aerosheet 3, consists of a tightly folded band of good quality pyrite approximately 50' wide and exposed by trenches and pits (Map 49g). It is located in the southeast corner of claim 1614 in the west central portion of the township, north of Strobos Lake.

The southern pyrite is bounded to the south by pyritized chlorite schist, and to the north by banded silica, which passes, northerly, into basic volcanics. The schist south of the limb strikes N80E and dips steeply south.

5. In addition, the geology along the Strobos Lake-Cawdron Lake road was complete. Rock types encountered were basic to intermediate volcanics, pillow lava tuffs and agglomerates, cut by diabase dykes. The pyroclastics were the predominant rock type. Structurally, the rocks represent a northeasterly trending and northerly dipping thrusting structure.

RECEIVED

OCT 21 1961

C. R. Kustra,

September 1961.

RECEIVED FROM
ALGOMA CENTRAL RAILWAY

RESIDENT GEOLOGIST
SAULT STE. MARIE

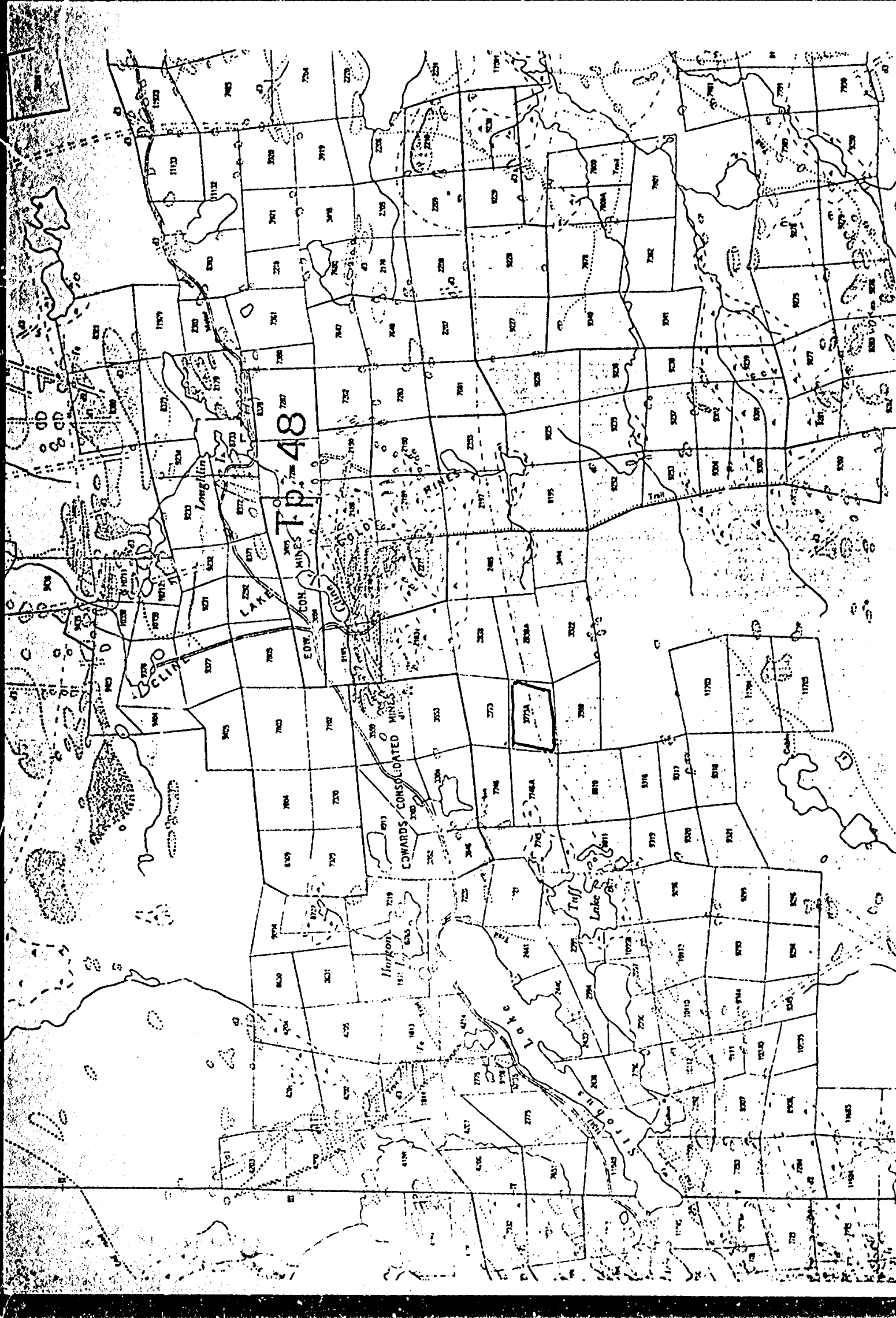

TOWNS

TERRACE PROP

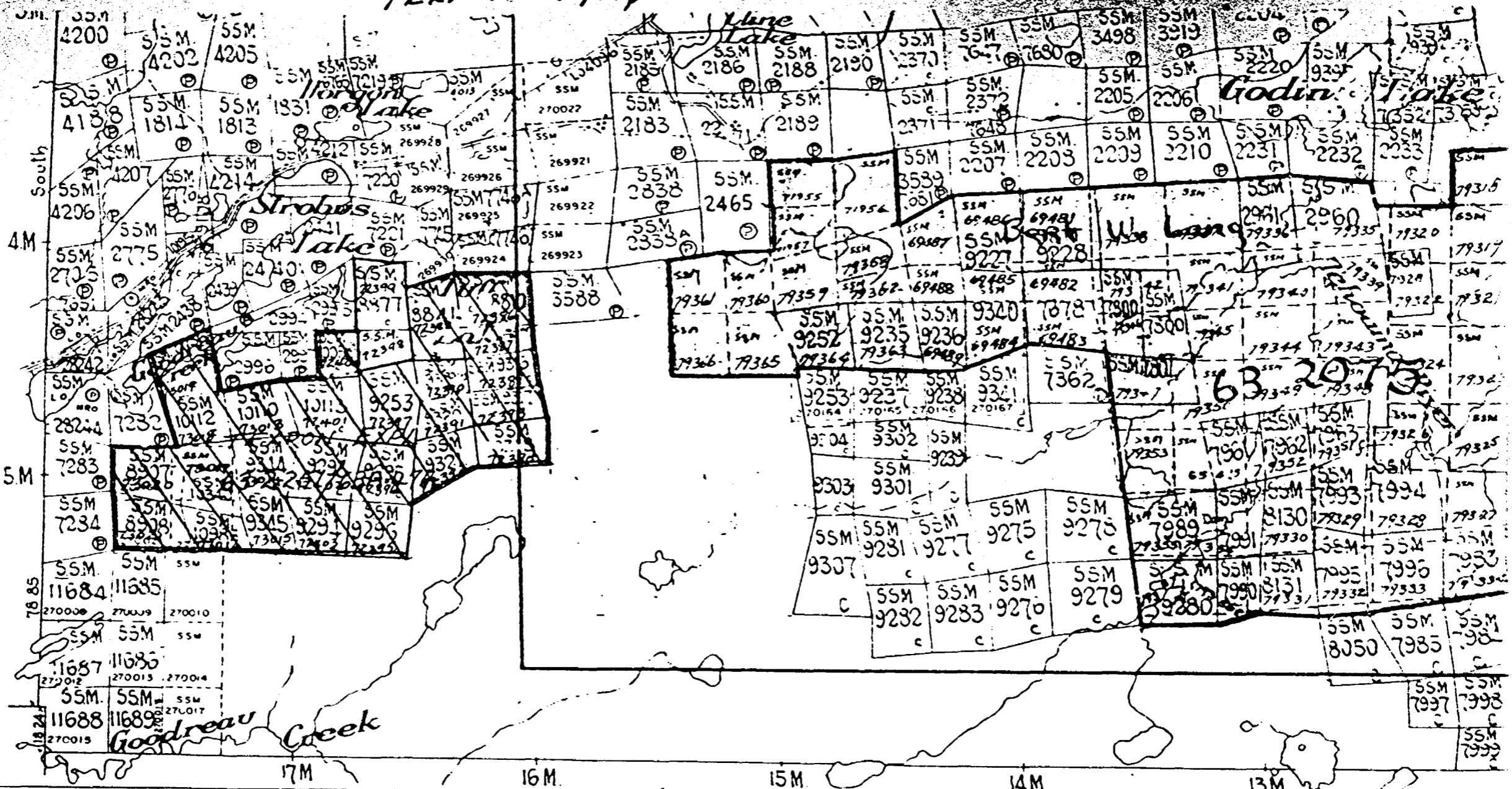

VEYS
 North boundary surveyed by E Stewart
 1893. Field note book no. 2543
 South, East and West bdrys. by G.B. Abrey
 O.L.S. 1902. Field note book no. 227'

TRANSMISSION LINES
 LO 6892, Great Lakes Power Co from
 mining claim S.S.M. 2642 easterly, 60' R/W.
 Plan no L21-8' File no. 142133

BIRD TWP.
TOWNSHIP 26.
 100 Reserve to the
 Dept of Lands & Forests

TELEPHONE LINES
 LO 4096 Algoma Central Telephone Co
 located within the limits of a constructed road
 from Goodreau to Lochalsh. File. 107828.

Paved Road
 Gravel Road
 Other Roads
 Trail or Path

NOTE

LA George held
• Suburban showing

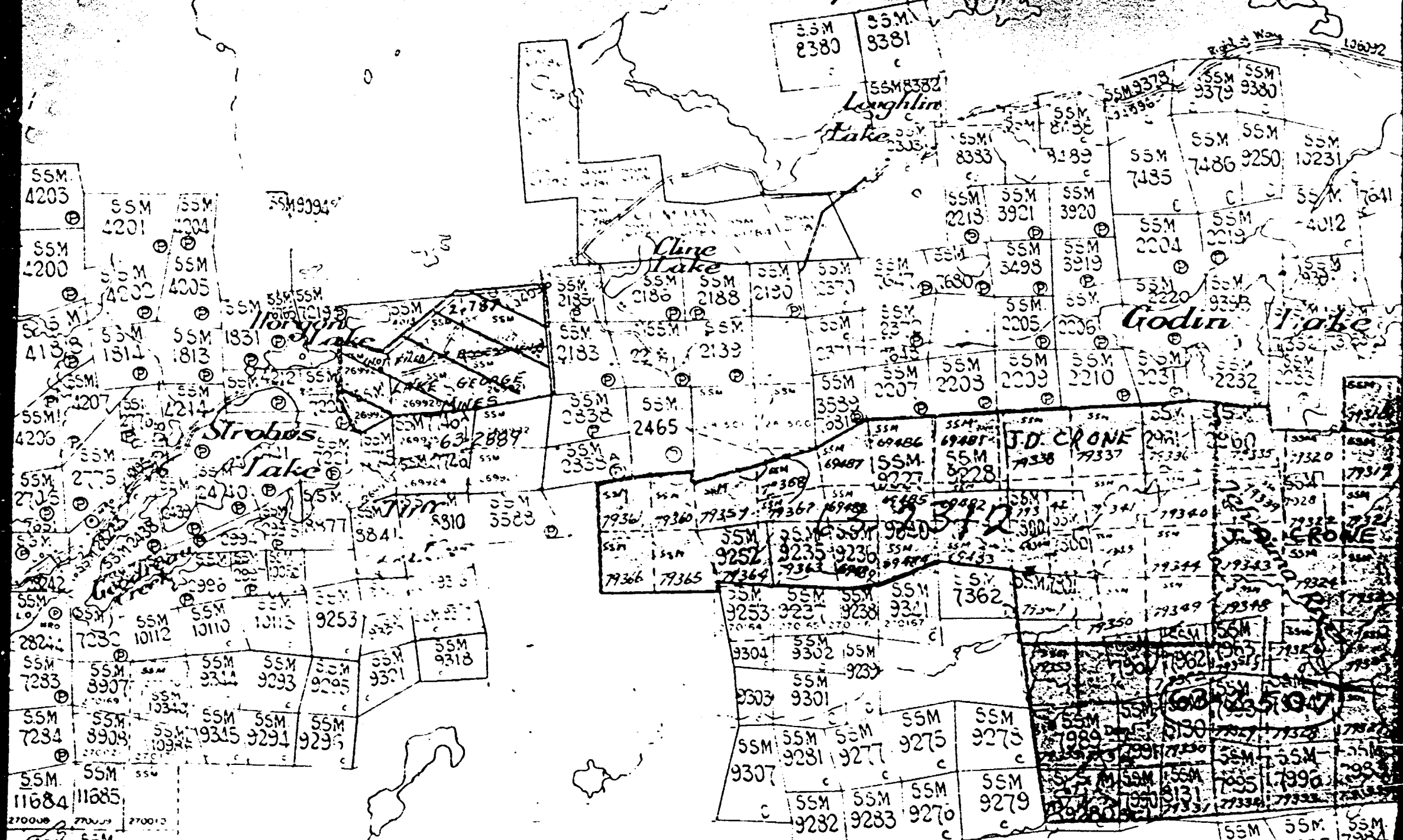

270008 270009 270010

SSM 7984

SEE GENERAL
FILE

(NON-FILMABLE
MATERIAL)

FOR:

JACOBSON - 0022-A1

TITLE:

CANADIAN - HANDBOOK - 1958
J - N

SEE ACCOMPANYING
MAP(S) IDENTIFIED AS

JACOBSON 0022-A1 #1

LOCATED IN THE MAP
CHANNEL IN THE FOLLOWING
SEQUENCE (X)

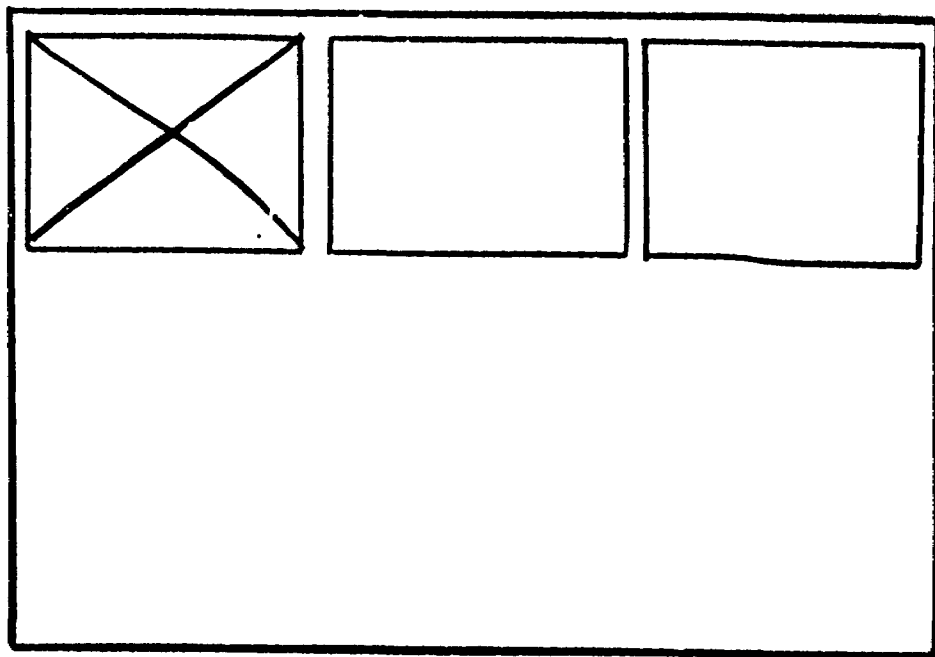

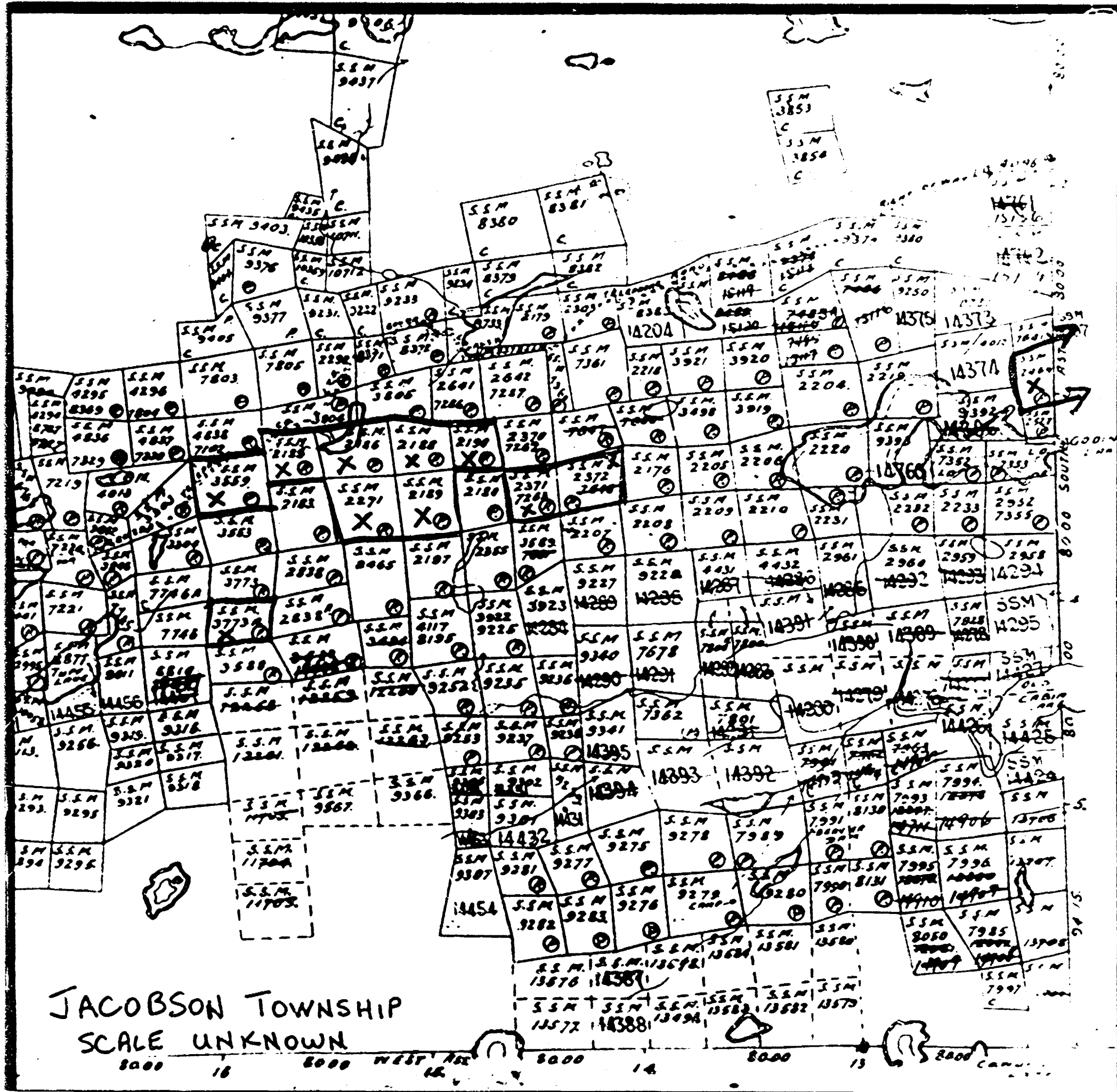

JACOBSON TOWNSHIP
SCALE UNKNOWN

8000 16 8000 WEST 14 8000 15 8000

index, to 6.236 & 856 respectively, based on net 40,000,000 lb content of orebody, basic payment of \$2,400,000 payable in 4 equal annual instalments, the 1st \$600,000 pd on signing lease Mar 1974, 1st cash payment \$280,000 (incr Feb 78, 1977, to \$364,000, result of lease indexing), with copper price at record levels 1974, no rec'd added royalties; to Mar 6, 1977, synd had rec'd \$3,690,000, of which cash \$1,411,161. Also holds 1/6 of 2% net smelter return from prod. In 1974, explor program on balance of prop not incl in Noranda lease, incl 12,087 ft d in 13 holes, 1975, geol mapping, 1976, contract with Noranda for 10 survey, 1977, further dev suspended due to low copper prices.

(1) Copper-zinc-silver prop, approx 1,350 ac, bounded by 10 mi W of Noranda, NW Ont, optioned from West Macanda Res 1, incl former prod Algonquin mine, 1976, 25,000 ft d in West Wab, 1976, explor on Macanda ground, early 1977, West Wab area 100% of Macanda & 50% of West Macanda Remain on 1, option agreement with the 2 former cos (combined).

(2) Uranium prop, inc 1975: (a) Prairie Lake prop, 30 ch, N of Lake Superior, no current work by prev int, 1977, 76, 5,000 ft d of indic radioactivity over 1,050 ft strike length, part of zone 300 ft long, ave. base width 22 ft & grade 1.3 lb U₃O₈ & 5 lb Nb₂O₅, est over 200,000 tons ore to 275-ft elevation; (b) 1975, purch int in 37 chs formerly optioned from Intl Minerals & Chemical Corp (Canada) L for 50,000 shs; (5) Base metals pros, Sturgeon Lake area, sold to Seagull Resources L.

(6) Holds 488,077 shs Horne Fau' ML (7) Holds 287,587 shs W Macanda Res.

Finances: Dec 31, 1978, curr assets \$1,120, curr liab \$31,488.

NEW JERICHO DEVELOPMENT CORP L - 711, 475 Howe St, Vancouver V6C 2B3 R. McLean, pres, H. Kenward, sec. Inc. 1956, BC chart. Cap 5,000,000 shs, npv, iss 1,733,866 Tr Ag. Guaranty Tr, Vancouver, April 1973, name changed from Jericho ML, one new sh for 5 old. (1) Copper pros, 8 chs (73 units), Highland Valley, BC, optioned 1971 to Highmont M'g Corp & Teck Corp L, which can earn 70% int by expend & if prop brought to prod. Dev by adit & underground explor, 1972, geochem, geophys survey, perc & d d (2) 12 1/2% int in 3 gas wells, Greenan Field, Sask. No recent report.

NEW JOBURKE EXPLORS L - Name changed Aug 1977, to Genex L, sh for sh.

NEW JONSMITH EXPLOR L - Name changed April 1977, to Chal-Bert Drilling (Western) L, with all shs purch by Chal-Bert Drilling Co L at 16¢ per sh.

NEW KELORE MINES LTD (TSE)

EX O 1402, 390 Bay St, Toronto M5H 2Y2. DIR & OFF: H. I. Miller, pres, J. A. Murphy, v.p., J. Geddes, treas, H. R. Heard, H. V. White, dirs. H. S. Doison, sec. INC. 1945, Ont chart. CAP. Auth. 7,500,000 shs, npv, iss 6,516,622 TR AG: Canada Permanent Trust, Toronto. Auth cap incr from 6,000,000 shs Oct 1973, from 5,000,000 shs 1964 & from 4,000,000 shs, 1955. Name changed 1953, from Kelore ML, 1 new sh for 5 old shs. Major Shareholders: Kam-Kolta ML holds 427,717 shs (6.5%), Dickenson ML holds 200,000 shs (3.1%).

Properties & Development: (1) Gold pros, 18 chs, Hislop & Gubbord twps, Ramore area, N Ont, ad. Pamour's Ross mine in prev opers, shaft sunk to 450 ft, 4 levels, extensive lateral dev; idle 1950-72, 1973, leased to Hollinger ML to Dec 31, 1984, Kelore rec \$5,000 annual rental & entitled to 25% of net profits from any prod.

Ore Reserves: 1974, indic res 320,000 tons aver 0.17 oz gold per ton above 500-ft level, based on underground sampling & d d.

(2) Gold-nickel-copper-zinc-platinum pros, 24 chs, Argyle twp, 15 mi NW of Matachewan, N Ont, (b) 90% int, 18 chs, Argyle twp, surveys & d d on both props, to continue on one group (3) Uranium pros, 93% int, 17 chs, Burleigh twp, Ban-

croft area, Ont, surveys (4) Oil & gas leases, Orford twp, SW Ont. (5) Holds 600,000 shs Plano ML (see).

Finances: June 30, 1978, curr assets \$39,697, incl mktbl securities at book val \$4,174 (mkt val \$11,500), curr liab \$7,297.

NEW KELVER RESOURCES L - Name changed Jan 1977, to Access Resources L.

NEW LORIE ML - 1005, 360 Bay St, Toronto M5H 2V6. C. W. Street, pres; W. E. Reardon, sec. inc. 1945, Ont chart. Cap 5,000,000 shs, \$1, iss 4,798,641. Tr Ag. Premier Tr, Toronto. (1) Copper-gold pros, 20 chs, adj Falconbridge Copper's Duland prop on E, Duland twp, Noranda area, NW Ont, optioned to Noranda, 1961 to 1970, when option dropped, sufficient d d to keep ore in good standing several yrs, 1973, 5 chs, N part of prop, optioned to Duland Contract ML, which did 3,389 ft d in 2 holes & dropped option (2) Holds 6,000 shs Yellowknife River ML, mkt val Sept 30, 1978, \$49,500.

Finances: Sept 30, 1978, curr \$724, curr liab \$971.

NEW McMANUS RED LAKE GML - 1140, 444 St Mary Ave, Winnipeg R3C 3H1. C. D. Huron, pres, I. B. Mandel, sec. inc. 1977, Ont chart. Cap 3,000,000 shs, npv, iss 368,226 Tr Ag. Crown Tr, Toronto. Name changed from McManus Red Lake GML, 1 new sh for 10 old shs; auth cap decr from 5,000,000 shs. Gold pros, 28 chs, Dome & Heyson twps, Red Lake, NW Ont, inactive since 1949, work planned 1979. Holds 1,300,000 shs Wendol Porcupine GML (dormant).

NEWMAR EXPLORS L - BC chart cancelled Aug 1977.

NEWMEX GOLD RESOURCES INC - 1014, 111 Richmond St W, Toronto M5H 2G4. I. A. Wallace, pres; A. J. Fortin, sec-treas, P. E. Price, W. A. Carter, C. B. Jarvis, dirs. inc. 1975, Ont chart. Cap 3,000,000 shs, npv, iss 1,050,005 (675,000 escrowed) Tr Ag. Metropolitan Tr, Toronto. Gold pros, 11 chs, Harker twp, Larder Lake div, N Ont; prior to 1940, limited explor & d d by prev ints, 1975, magnetic & EM surveys & d d. **NEW MINEX RESOURCES L(VSE)** - 306, 1039 Richards St, Vancouver, W. Rauball, pres; V. Busby, sec; J. Ivancoe, M. Rosa, dirs. inc. 1958, BC chart. Cap 5,000,000 shs, npv, iss 2,700,187. Tr Ag. Guaranty Tr, Vancouver, Feb 1974, name changed from Minex Dev L, 1 new sh for 5 old shs.

Properties: (1) Copper-molybdenum pros, 3 chs, Gnowed Mtn, Highland Valley area, BC, 1968-69, geophys survey & d d, extensive explor & d d 1969 by Canadian Superior Explor L under option, since dropped, 1971, co did trenching & geophys work; 1975, perc d; 1976-77, d d. (2) Copper pros, (a) 24 chs, Trojan prop, Highland Valley area, BC, (b) 24 units, same area as (a); 1976, perc d; 1977, seeks to int major co in dev props. (5) Tungsten pros, Golden Gate tungsten mine, Stibnite div, Idaho; oper by wholly owned subsid Golden Gate Corp; limited prod, 1977, m'g by open pit, 75 ton per day mill capacity, oper at 50 lpd.

Finances: July 30, 1978, working cap deficit \$191,000.

NEWMONT EXPLORATION OF CANADA LTD

H.O. & W EXPLOR OFF: 1400, 750 W Pender St, Vancouver V6C 1K3. E EXPLOR OFF: 2840 Commerce Bldg W, Toronto M5L 1E3. Field off at Timmins, NW Ont, R. D. Elliott, New York, chm; R. F. Sheldon, pres; P. G. Rook-Green, sec-treas, both Vancouver; J. A. Coope, v.p. & E explr mgr; R. W. Stevens, both Toronto; P. Malozemoff, J. C. Keenan, both New York; dirs T. N. Macaulay, W. explr mgr, Vancouver.

Name changed 1977, from Newmont M'g Corp of Canada L. Wholly owned subsid of Newmont M'g Corp. Active in explor & dev in Canada. Holds 23.75% in Icon Sullivan Jt Vent; 53% in Sourdough Bay ML.

NEWMONT MINES LIMITED

EX.O.: 1400, 750 W Pender St, Vancouver V6C 1K3. M.O.: Granduc Operating Div, P.O. Box 69, Stewart, BC V0T 1W0; Similkameen Div, P.O. Box 520, Princeton, BC V0X 1W6. DIR & OFF: P. Malozemoff, chm, New York; J. H. Parliament, pres; R. F. Sheldon, both Vancouver; W. H. Burt, D. J. Christie, J. C. Keenan, R. B. Leather, J. E. Thompson, H. Van Benschoten, W. A. Humphry, dirs, all New York; R. S. Mattson, v.p. & gen

mgr; P. G. Rook-Green, controller, W. L. Vorley, purch agt. INC. 1965, Delaware, US chart.

History: Formerly Granduc Operating Co & Similkameen Mining Co, both wholly-owned subsidiaries of Newmont Mining Corp (US co), ones combined to form Newmont Mines L. Major Shareholder: Wholly-owned subsid of Newmont Mining Corp.

Granduc Operating Div: Opers: Oct 1, 1965, leased from Granduc ML, jty with Asarco Inc, 253 chs between Leduc & Uluk Rivers, 20 mi N of Stewart; co is operator. M'g opers suspended mid-1978.

Development: Prev opers, adits at 3,100 & 3,600 ft, shaft sunk 676 ft below 3,100 ft level opening at 2,375, 1969, now access by 11 mi main haulage tunnel from Leduc camp at 2,750 ft.

Production: Started Mar 1, 1971, plant capacity 10,000 tons per day on holding basis for economic reasons. In yr to June 30, 1978, milled 817,000 tons aver 1.43% copper, in yr to Dec 31, 1977, milled 1,469,000 tons aver 1.31% copper. Metals prod in conc, 1978, 11,162 tons copper, 3,368 oz gold, 196,000 oz silver; in 1977, prod 18,200 tons copper, 5,100 oz gold, 341,000 oz silver.

Ore Reserves: June 30, 1978, 15,054,000 tons aver 1.64% copper.

Similkameen Div: Properties & Development: Copper-silver-gold prod, over 100 chs, 10 mi S of Princeton, BC, incl former prod Copper Mountain mine & adj Ingerbelle prop. Prod currently from Ingerbelle open pit. Preparations for dev of Copper Mtn orebodies in progress, with crushed ore to be conveyed via suspension bridge across canyon to existing concentrator in 1981.

Production: Started Sept 1972 at 15,000 tons per day, expanded 1975 to 22,000 tons to handle low grade ore stockpiled. In yr to Dec 31, 1978, milled 7,473,000 tons aver 0.41% copper, in 1977 milled 7,866,000 tons aver 0.37% copper. Metals prod in conc 1978, 27,300 tons copper, 37,100 oz gold, 139,800 oz silver; in 1977 prod 25,300 tons copper, 35,200 oz gold, 140,000 oz silver.

Ore Reserves: Dec 31, 1978, after re-evaluation of orebodies & open pit designs, 149,077,000 tons aver 0.41% copper, 1977, 49,892,000 tons aver 0.54% copper.

NEW MOUNT COSTIGAN ML - 1010, 85 Richmond St W, Toronto M5H 2G1. J. C. Lamcraft, pres; J. A. Patterson, sec-treas, J. S. Adams, asst sec-treas, M. Zurowski, H. G. Forrest, dirs. inc. 1962, Ont chart. Cap: 133,896 shs 5% non-cum pref, \$1, & 5,000,000 shs com, npv, iss 61,775 pref, & 3,117,481 com (328,870 escrowed). Tr Ag: Guaranty Tr, Toronto. Name changed 1967 from Mount Costigan ML, 3 new shs for 5 old shs.

Major Shareholder: Intl Mogul ML holds 10,600 pref (17%), & 1,054,520 com shs (33.8%).

Properties: (1) Lead-zinc-fluorite-barite pros, Lake Ainslie, Inverness city, Cape Breton Isl, NS; (a) 32 chs; (b) part of adj 36 chs of Mogul, optioned under agreement giving Costigan right to metallic minerals on both, Mogul right to fluorite & barite on both, with reciprocal royalties on any prod. (2) 10% carried int in Comstaff Pty L holding m'g concession, base metals & tin pros, N Tasmania; explic tm by Preussag Australia Pty L & Anglo American Corp (Australia) L with expands over \$A4,850,000 to end of 1978; in 1978, expend \$A739,000.

Finances: Dec 31, 1978, curr assets \$21, curr liab \$2,669; 6% deb (held by Mogul) \$50,000.

NEW NADINA EXPLORS L(VSE) - 617, 789 W Pender St, Vancouver V6C 1H2. W. F. McGowan, pres; E. D. H. Wilkinson, G. Blore, v.p. dirs. inc. 1964, BC chart. Cap: 5,000,000 shs, npv, iss 595,001. Tr Ag: Guaranty Tr, Vancouver. Name changed Dec 1977, from Nadina Explors L, 1 new sh for 4 old shs, & auth cap incr from 3,000,000 shs.

Property & Development: (1) Copper-lead-zinc-silver prop, former prod, 25 chs (17 leased from Placer Div), Owen Lake,

28 mi S of Houston, BC. Surf explor by prev ints; underground dev, drifting, slope preparation, geochem & geophys surveys; 1967 to early 1971, under options since dropped to Kennecott & Northgate Explor L. Dev by 2 adits, main, bottom level at 2,600 ft. June 1971, it went "Dreadna" to bring prop to prod with Bralorne Resources & Pacific Petroleum L. Latter 2 provided funds repayable from cash flow, then Nadina 50%, Bralorne & Pacific each 25%. Managed by Bralorne, cost to prod approx \$7,000,000, much of Bralorne's portion supplied by equip & supplies from its shutdown Bralorne mine & mill. 500-ton mill started June up Feb 1972, full prod May 1972, prod ceased Aug 31, 1973.

Ore Reserves: Dec 31, 1977, 430,300 tons proven & probable aver 0.09 oz gold per ton, 7.96 oz silver per ton, 0.59% copper, 1.47% lead, 6.30% zinc.

On 17 leased chs, co can earn 100% int by dev & prod decision by Dec 31, 1986.

NEWNORTH GOLD ML (LSE) - 2500, 44 King St W, Toronto M5L 1G9. P. G. Emley, pres, A. Adken, sec-treas, J. R. Luby, L. D. Fisher, all Toronto, H. T. MacAlpine, Lindsay, Ont, dirs. inc. 1945, Ont chart. Cap 5,000,000 shs, \$1, iss 4,400,000. Tr Ag: Crown Tr, Toronto. May 1973, no props held, seeking new pros.

Finances: Dec 31, 1978, curr assets \$26,403, curr liab \$3,996.

NEW PASCALIS ML - P.O. Box 40, Commerce Ct W, Toronto M5L 1B4. W. B. G. Walker, pres, J. F. Gillies, v.p.; J. D. Krane, A. R. Pasieka, W. D. Harrison, dirs, W. R. Robertson, sec, N. H. Witherell, treas, W. F. Avery, controller. Inc. 1932, Dom chart. Cap: 3,000,000 shs, npv, iss 1,200,000 Tr Ag: Crown Tr, Toronto.

Major Shareholder: Falconbridge Nickel ML holds 735,494 shs (61.3%).

Property: Gold pros, 41 chs, Pascalis & Louvicourt twps, NW Que. Former opers, 1,563 ft shaft & dev on several levels. Idle since 1973-65 when d d done by Falconbridge Nickel ML.

Finances: Dec 31, 1978, curr assets \$87,222; curr liab \$360.

NEW PRIVATEER ML (VSE) - 306, 736 Granville St, Vancouver V6Z 1G3. E. K. Pinkerton, pres, A. S. Kerry, v.p., R. Jancowski, R. G. C. Hadaway, dirs. inc. 1937, BC chart. Cap 5,000,000 shs, npv, iss 3,258,294 Tr Ag: Royal Tr, Vancouver. Name changed 1959, from Privateer ML, 1 new sh for 5 old shs. Auth cap incr 1971 from 3,000,000 shs. Gold-copper pros, all adj; (a) former gold prod, 34 chs, Zeballos area, Vancouver Isl, BC, 1937-48, prod 168,000 ozs gold val \$6,000,000; ore res est approx 125,000 tons aver 0.24 oz gold per ton, with another zone indic to contain 200,000 tons aver 2% copper; (b) 34 chs, Zeballos, Vancouver Isl, BC.

NEW PYRAMID GM INC - Name changed Jan 1977, to International Pyramid M Inc, 1 new sh for 5 old shs.

NEW QUEBEC M'G & EXPLOR L - 916, 111 Richmond St W, Toronto M5H 2G4. N. A. Anderson, pres. inc. 1957, Que chart. Cap: 5,000,000 shs, \$1, iss 2,505,035 Tr Ag: Guaranty Tr, Montreal. Spooner Mines & Oils has approx 35% int (1) Through its Canadian subsid, Fernico ML, 5 Danish subsid, Nordkalotten Spooner M, Fernico A/S, Carbolino, Nicol & Eisaspanguaq, has conducted extensive exp. or of concessions in Greenland. (2) New Quebec has 20% int in Green-arctic Consortium of Canadian cos, which through Danish co, Ponderary Polar, held 3 concessions for minerals, & pros licence for oil & natural gas.

NEW QUEBEC RAGLAN MINES LTD (TSE MSE)

EX.O. P.O. Box 40, Commerce Court West, Toronto M5L 1B4. DIR & OFF: L. C. Kiburn, pres, T. F. Pugliese, v.p., J. Desanti, G. P. Mitchell, all Toronto, P. E. Auger, J. H. Gagne, both Quebec, dirs, W. R. Robertson, sec, N. H. Witherell, treas, J. O. Kachmar, controller. INC. 1956, Ont chart. CAP. Auth. 8,000,000 shs, \$1, iss 7,763,871 TR AG: Crown

(810,000 pooled). Tr Ag: Crown Tr, Toronto. 25 cls. Joan twp, Temagami area, N Ont. Idle since surface explor & limited d d in 1957.

JOBERT KEEFER GOLD MINES LTD — Dormant.

JOBURKE GOLD MINES LTD (TSE)
EX.O.: 936, 257 Bay St, Toronto. OFF & DIR: E. C. MacLeod, pres; W. M. Macintosh, sec-treas; H. F. Kimber, asst sec; R. L. McDonnell, asst treas; M. C. Mosher, M. A. McLeod, dirs; all Toronto. INC: 1946, Ont chart. CAP: Auth, 5,000,000 shs, \$1 par; iss (June, 1958) 4,200,000, of which 29,995 shs pooled. Auth cap incr from 3,500,000 shs in 1953. TR AG: Chartered Trust Co, Toronto. Prop: (1) Gold prospect, 20 claims; (2) Copper prospect, 3 claims; both Keith twp, Grounding River area, Sudbury min div, N Ont. (3) Base metal prospect, 30 claims, Rathurst area, N.O. (4) Iron prospect, 551 claims, Nashitapoka Islands Cape Smith Wakeham Bay area, Ungava Prov, NW.T. (5) June, 1958, held 51,125 free shs & 45,000 pooled shs Glenburke ML, 1,000 Geo, 193,600 Bracemac, 14,500 Jonsmith ML, 300,000 Mirador ML, 10,500 free & 4,500 pooled Prntfield, 500 Shunsby, 15,000 Tashleck, 5,000 free & 45,000 pooled Worthington Mines Ltd. (6) Uranium prospect, 20 claims, Xipawa area, Que. approx 60 miles NE of North Bay, Ont.

JODELO GOLD MINES LTD — Succeeded by Mintrock G.M.L.

JOE INDIAN MOUNTAIN METAL MINES LTD — Mar, 1953, renamed Indian Mountain Metal ML, share-for-share.

JOHANNESBURG GOLD MINING CO LTD — Property sold to Cons Nicola Goldfields Ltd for 250,000 shares.

JOHNSON'S ASBESTOS CO
EX.O.: Thetford Mines, Que. M.O. & RLY STA: Black Lake, Que. OFF & DIR: A. S. Johnson, Thetford Mines, pres; J. H. Mooney, Quebec City, Que, v p; Geo. Robinson, sec-treas; W. J. Johnson, dir & gen mgr; both Thetford Mines; E. A. Mackenzie, Montreal, T. H. Best, Toronto, dirs. CONS ENG: L. W. Bladon. OPERS: Asbestos producer with mine at Black Lake, where 4,000-ton mill in oper since late 1953. Private Co; (see also Johnson's Co. an associated co.).

JOHNSON'S CO LTD
EX.O., M.O. & RLY STA: Thetford Mines, Que. OFF & DIR: A. S. Johnson, Thetford Mines, pres; J. H. Mooney, Quebec City, Que, v p; Geo. Robinson, sec-treas; W. J. Johnson, dir & gen mgr; both Thetford Mines; E. A. Mackenzie, Montreal, T. H. Best, Toronto, dirs. CONS ENG: L. W. Bladon. OPERS: Asbestos producer, private co founded 1875, with mine at Thetford Mines, in prod many yrs. (See also Johnson's Asbestos Co. an associated co.).

JOHNSTON KNEE LAKE MINES LTD — Wound up; assets distributed.

JO JAY MINING CO LTD — Ont charter cancelled, 1952.

JOLIET-QUEBEC MINES LTD (TSE: CSE)
EX.O.: 2810, 25 King St W, Toronto. OFF & DIR: J. P. Millenbach, pres; A. G. Fulton, sec; J. T. McWhirter, asst sec; A. J. Anderson, C. C. Calvin, J. P. Manley, dirs; all Toronto; R. Robertson, Montreal, dir. INC: 1935, Ont chart. CAP: Auth, 6,000,000 shs, \$1 par; iss 5,122,351, none pooled. Auth cap incr from 3,000,000 to 5,000,000 shs 1954 & to above 1956. TR AG: Prudential Trust Co, Toronto & Montreal. FISC YR: Dec 31. AN MTG: At Toronto, June 12, 1958. Hist: 1939, name changed from Brownlee Mines (1936) Ltd, sh-for-sh. Brownlee Mines (1936) Ltd had succ Brownlee Mines, basis 1 new for 5 old shs; latter in 1931 had succ Brownlee Gold Mines, basis 3 new for 5 old shs. 1946, acq assets of Dunford Reyvn Mines, basis 1 new for 9 old shs. Frobisher Ltd holds 1,031,800 shares. Prop: Gold-copper prop, 1,069 ac, Rouyn twp, Que, adj Noranda & Queumont. Dev: 3-compart shaft to 628 ft with levels at 150, 300 & 500-ft levels. Lateral work stopped in 1947. Limited d d in 1957 with further work planned June, 1958. Agreement with Noranda: Noranda holds mining rights until 1974 on block of ground 1,000 ft square & 1,200 ft deep in shaft area, where work indicated est 1,667,074 tons of ore aver 0.95% copper,

valuable to Noranda as smelter flux. Joliet receives royalties for ore mined. Noranda put out drive 3,200 ft long, mostly in Joliet-Quebec ground, on 1,200-ft level from its workings to open leased section. To Mar 31, 1958, total of 480,718 tons ore shipped to Noranda smelter. Fini At Dec 31, 1957, had \$7,354 cash, \$24,707 notes rec; current liabilities \$191.

JOLIN DOURLAMAQUE G.M.L. — 325 St. James St W, Montreal. Cap: 3,000,000 shs, \$1; iss 1,300,000. Tr Ag: Chartered Tr, Montreal. 5 cls, Bourlamaque twp, NW Que. Idle many years.

JONSMITH GOLD MINES LTD — Renamed Jonsmith Mines Ltd, share-for-share.

JONSMITH MINES LTD (TSE)

EX.O.: 996, 357 Bay St, Toronto. OFF & DIR: E. C. MacLeod, pres; J. M. Macintosh, v p; A. B. Whitelaw, sec-treas; R. L. McDonnell, asst sec-treas; C. S. Darrach, Geo. Scott, J. A. Hackett, J. R. Stratton, F. G. MacLeod, dirs. INC: 1947, Ont chart. CAP: Auth, 5,000,000 shs, \$1; iss (June, 1958) 4,160,431, none pooled. Auth cap incr from 3,500,000 shs, Feb, 1955. TR AG: Guaranty Trust Co, Toronto. Hist: Name changed, 1952, from Jonsmith Gold Mines. Prop & Ints: (1) Nickel-copper prospect, 10 pat claims & 7 leasehold claims in one block, Parkin twp, Sudbury min div; (2) Copper prospect, 54 claims & 5 optioned claims, Sewell twp; (3) Base metals prospect: (a) 19 claims, Twp 48; (b) 18 claims, SE & SF twps; both Sault Ste Marie div; (4) 26 claims, Creelman twp; all N Ont; (5) Uranium prospect, 30 claims, Kipawa area, Que, approx 50 miles NE of North Bay, Ont. June, 1958 held 92,000 shs Dunvegan ML, 500 Hoyle, Mg (59% preferred), 102,000 Joburke, 6,400 MacLeod-Cockshuff, 1,148,600 free & 166,000 pooled New Dominion Nickel, 20,000 Shunsby, 100,000 Sporan & \$4,000 government bonds. Dev: On Parkin prop 477-ft shaft with 3 levels; opers suspended & plant & equipment sold in 1956. Surface work & d d on Sewell prop in 1956. Fin: At June, 1958 had approx \$77,000 cash, & \$150,000 Industrial Acceptance Corp note; curr liabs nil.

JORDAN MINES LTD — BC charter cancelled, 1943.

JORITA MINES LTD — Dissolved; no equity.

JOWATY MINES LTD — No equity.

JOWSEY DENTON G.M.L. — 1405, 302 Bay St, Toronto. Robt. J. Jowsey, pres; D. W. Lang, sec. Cap: 3,000,000 shs, \$1; iss 1,810,409 (200,000 pooled). Tr Ag: Crown Tr, Toronto, 13 pat cls, Denton twp, 32 pat cls, Carscallen twp, both Perc, N Ont. Idle since 1947.

JOWSEY ISLAND GOLD MINES LTD — Shares worthless.

JOWSEY MINING CO LTD, R. J. (TSE: CSE)

EX.O.: 1405, 302 Bay St, Toronto. OFF & DIR: Robt. J. Jowsey, chairman; F. H. Jowsey, pres; Eric Cradock, v p; H. T. Hurley, sec-treas; C. C. Huston, W. B. Maxwell, J. J. Rankin, dirs; all Toronto. INC: 1928, Ont chart. CAP: Auth, 7,500,000 shs, \$1 par; iss (June, 1958) 3,587,013, none pooled. TR AG: Crown Trust Co, Toronto; Toronto General Trusts Corp, Winnipeg. Hist: Mar, 1956, name changed from Bobjo Mines, basis 1 new for 3 old shs. Co then absorbed God's Lake Gold Mines, basis 4 new for 9 old shs; latter co continues as wholly-owned subsid. Prop & Int: (1) 9 pat claims, original Bobjo prop, Eargroy twp, Clearwater Lake, Patricia dist, NW Ont. Shaft to 270-ft depth with 2 levels; inactive. (2) 18 pat claims, McNeill twp Porcupine area; (3) 7 pat claims, Calvin twp, E of North Bay; (4) 75% Int, 28 claims, Falconbridge & Street twps, Sudbury area; all N Ont. (5) 147 claims, adj Sherritt Gordon prop, Lynn Lake area; (6) 54 claims, optioned, Herb Lake min div; (7) 30 claims, leased, Athapapuskow & Herb Lake area; (8) 15 claims, leased, Rice Lake area; (9) 2/7th int in spread of potential oil & gas lands, SW Man. (10) Reservation on large acreage of potential oil-gas lands, S of Mocin Mtn Forest Reserve, Sask, near Manitoba boundary. Retained 2 1/2% gross royalty on 30,000 acres sold to Ajax Petroleum & 12 1/2% royalty on 640 ac, leased to Sun Oil Co. in

1953, Williston Oil & Gas Co drilled 800-ac tract, Forget area, Sask. R. J. Jowsey Mining Co has 44.75% int in 2 prod wells. In 1956, leased 640-ac, to California Standard Co, retaining 12% royalty int. (11) 20% int, 84 claims, Montville twp, near Lake Waswanipi, NW Que. (12) Dec 31, 1957, held: 1,449,403 Atlin-Ruffner Mines, 53,550 Consolidated Denison, 80,000 Dominion Magnesium, 393,750 free & 85,000 pooled shs Lyndhurst Mine Co, 180,200 Radiore Uranium Mines, 602,855 free & 90,000 pooled shs Sand River Gold Mining Co, 8,000 Sherritt Gordon Mines, 4,000 Winchester Larder Mines, plus shs in other less active cos, & various participations, sundry units, Ints & royalties. Dev: Surface explor on all groups incl limited d d on some; June, 1958, explor of Lake Waswanipi prop in progress. Fin: Dec 31, 1957, had cash \$63,185, govt bonds \$14,500, invests with mkt val \$1,780,718, & other curr assets \$932; current liabilities \$1,343.

JOYDOR GOLD MINES LTD — Name changed to Adnaron Copper Corp Ltd.

JOY M. ZEBALLOS LTD — BC charter cancelled, 1946.

JUBILEE COP & GALENA MINES LTD — Chart cancl, 1941.

JUBILEE IRON CORP — Subsid of Canadian Javelin Ltd.

JUBILEE LONG LAC GOLD MINES LTD — Chart cancl, 1955.

JUDELLA URANIUM ML — Address unknown. Cap:

3,000,000 shs, \$1; iss 1,384,477. Tr Ag: Prudential Tr, Regina. (1) 6 cls; (2) 9 cls; both St. Joseph Point; (3) 8 cls; all Black Bay sector, Beaverlodge area, N Sask. No recent report.

JUDSON GOLD MINES LTD — Ont charter cancelled, 1955.

JULIAN IRON CORP — Subsid of Canadian Javelin L (see).

JUMA MINING & EXPLORATION LTD

EX.O.: 102 Victoria St N, Sarnia, Ont. OFF & DIR: E. C. Levesque, pres; A. Sauve, v p; H. A. Crawford, sec-treas & dir; all Sarnia, R. G. Stevenson, Byron, Ont, C. Godbout, Grand Falls, NB; both dirs. INC: Mar, 1957, Ont chart. CAP: Auth, 5,000,000 shs, \$1 par; iss (Apr, 1958) 1,042,905 of which 810,000 shs pooled. TR AG: Crown Trust Co, Toronto. Prop: (1) Uranium prospect, 16 claims, Willard Lake, MacNicol twp; (2) Magnetite-iron prospect, 108 claims in the Helder Lake district; both Kenora dist, 40 miles E of Kenora, N Ont. Dev: Limited surface explor on both groups with some sampling on (2); April, 1958, further work planned.

JUNIOR FROOD ML — 1202, 50 King St W, Toronto.

D. R. Michener, pres; D. A. Lang, sec-treas. Cap: 200,000 shs, \$1; iss 155,984 (none pooled). Tr Ag: Co. Holds 12 cls, Biezard twp, Sudbury dist, N Ont. Prop under working option to Feb 1, 1959, by Falconbridge Nickel ML, which in recent yrs has done extensive d d & explor work.

JUNO GOLD MINES LTD — Man charter cancelled, 1952.

JUNO METALS CORP — 2005 Belanger St, Montreal.

T. Nadeau, pres; A. Cole, sec. Cap: 3,500,000 shs, \$1; iss 3,018,987 (1,165,000 pooled). Tr Ag: Chartered Tr, Montreal. (1) Claim group, Coleman twp, Cobalt, N Ont. (2) 1,540 ac, Privat twp, NW Que. Surface explor on both props; Ont prop, shaft to 250 ft & limited amount lateral dev, d d in 1956. Mar, 1957, reported to have leased & subleased Cobalt area props of Silver Crater ML on royalty basis; no further report.

JUPITER MINES LTD — Tr Ag: Crown Trust Co, Toronto; shs exchangeable 1 McIntyre Porc Mines Ltd present stock for 30 Jupiter shares.

JURY G.M.L. — Dormant; no report for years.

KABOUR MINES LTD — Ont charter cancelled, 1957.

KAISER DEVELOPMENT CORP LTD — C/o V. S. Hardie, 800 Arnyle St, Regina, Sask. Cap: 5,000,000 shs, \$1; iss 1,870,000 (675,000 pooled). Tr Ag: Prudential Tr, Regina. Held: (1) prop at Sonora, Mexico, through wholly-owned subsid, Atlas M'g Co. (2) 105 leased cls, Skagit Co, Washington. (3) 27 cls, Leland Lake area; (4) 16 cls, Pipestone Bay; (5) 7 cls, Waden Bay; all Lk La Ronde dist, N Sask. Surface explor on most props, d d on some; no recent report.

KAISER HOLDINGS LTD — BC charter cancelled, 1956.

KALADAR G.M.L. — No report for years.

KALADAR IRON ML — C/o J. Mahon, 292 Bay St, Toronto.

Cap: 5,000,000 shs, \$1; iss 930,005 (810,000 pooled). Tr Ag: Toronto General Tr, Toronto. Held 10 cls & option on 1,487 ac, Kaladar twp, Lennox & Addington cos, SE Ont.

KALAMALKA G.M.L. — Wound up; 1st & final distribution, 33c share.

KALBROOK M'G CO LTD — 2810, 25 King St W, Toronto.

J. M. Cunningham-Dunlop, pres; F. C. Sullivan, sec.

Cap: 3,500,000 shs, \$1; iss 1,700,092 (1,080,000 pooled).

Tr Ag: Crown Tr, Toronto. (1) 1,718 pat ac & 11 unpat

cls, Cowper & Foley twps, Parry Sound div, N Ont. (2)

Mineral rights on 75 pat ac, Kaladar twp, & 107 pat ac,

Angletown twp, both SE Ont. (3) Holds 1,300 shs United

Keno Hill ML & 226,960 Peako G.M.L. Idle since 1951.

KALGOLD MINES LTD — Ont charter cancelled, 1955.

KALGOORLIE KIRKLAND G.M.L. — Liquidated, 1920.

KALIBAX G.M.L. — Tr Ag: Crown Trust Co, Toronto. Cap:

3,000,000 shs, \$1; iss 1,504,487 (945,000 pooled). Held

26 pat & 25 unpat cls, Lizar twp, Sault Ste. Marie div,

N Ont; idle since 1948.

KALUM LAKE MINES LTD — BC charter cancelled, 1937.

KAMCON ML — Trail, BC. W. G. Jewitt, pres; E. G.

Randall, sec. Cap: 1,000,000 shs, \$1; iss 800,000

(none pooled). Tr Ag: Co. 74 cls, 2 groups, Yk div,

N.W.T. Idle since 1951. Apr 30, 1957, had \$10,740 cash;

curr liabs \$82,040. 407,737 shs held by Cons Smelters,

393,192 shs held by Kamlac G.M.L.

KAMIS COPPER MINES LTD — 1955, renamed Kamis

Uranium Mines Ltd, share-for-share.

KAMISKO MINES LTD — Dormant.

KAMISKOTIA BASIN MINES LTD — Dormant.

KAMISKOTIA DEV CO LTD — Ont charter cancelled, 1956.

KAMISKOTIA M'G CO L — 1302, 320 Bay St, Toronto.

A. B. Linhart, California, Ferns, pres. Cap: 2,000,000

shs, \$1; iss 1,990,300. Tr Ag: Co. 2 cls, Robb twp,

Porc, N Ont. Idle many years.

KAMIS URANIUM ML — 419, 62 Richmond St W, Toronto.

P. T. Drutz, pres. Cap: 3,500,000 shs, \$1; iss 2,671,130

(843,750 pooled). Tr Ag: Guaranty Tr, Toronto. (1) 16

cls, Twp 149, Elliot L, N Ont. (2) 18 cls, Vassan twp;

(3) 25 cls, Levy twp, Chibougamau; both NW Que. (4)

Held 400,000 shs Cavalier M'g Corp & 200,000 Concor-

Chibougamau. Surface explor on all groups plus d d

on (1); June 1958, idle.

KAM KOTIA PORC ML — 2402, 44 King St W, Toronto.

Hollinger Consol subsid with 8 cls, Jamieson twp,

Kamkotia area, N Ont. Idle since 1945.

KAMLAC G.M.L. — 1202, 50 King St W, Toronto. R. A.

Cranston, sec. Cap: 3,000,000 shs, \$1; iss 1,472,005,

none pooled. Tr Ag: Sterling Tr, Toronto. Holds

393,192 shs Kamcon Mines Ltd.

KAMLOOPS COPPER CO LTD — Royal Bank Bldg, Kam-

loops, BC. R. W. Kennedy, sec. Cap: 3,000,000 shs,

npv; iss 1,247,000 (800,000 pooled). Tr Ag: Canada Tr,

Vancouver. 35 cls, Iron Mask Group, 5 miles SW of

Kamloops. No recent report.

KAMLOOPS HOMESTAKE ML — Charter cancelled, 1940.

KAMLOOPS MERCURY MINES LTD — BC charter cancl, 1946.

KANASUTA GOLD MINES LTD — Property lapsed.

KANDAHAR CONS G.M.L. — BC charter cancelled, 1942.

KAPKICHI NICKEL MINES LTD

EX.O.: 6th floor, 360 Bay St, Toronto. M.O.: 405, 67

Yonge St, Toronto. OFF & DIR: F. W. Thompson, pres;

F. C. Sullivan, sec-treas; A. Hoffman, R. D. Hoffman, G.

McLaughlin, dirs; all Toronto. CAP: Auth, 5,000,000 shs,

npv; iss (June, 1958) 900,000, of which 853,000 pooled.

TR AG: Crown Trust Co, Toronto. Opers: Formed to acq

nickel-copper prospect, 59 claims, at Kaskichi Lake, 7

miles W of Pickle Crow, N.Y. Ont. Controlled jointly by

Thompson-Lundmark ML & Quebec Cobalt & Exploration

Ltd. In 1957, electromagnetic survey & sample d d;

June, 1958 further d d planned.

Canico, Cleveland Cliffs Iron Co, Eldorado Nuclear Ltee, Falconbridge Nickel ML, Imperial Oil L, Kenneco Explors L, Lynx-Canada Explors L, Cominco L, Mexico Resources L, Muscocho Explors L, Noranda Explor Co L, Pancontinental M'g (Canada) L, Progomines Ltee, Sequem, Seico M'g Corp L, Serru Nuclearo (Canada) Ltee, Sullivan M'g Group, Union Miniere Explors & M'g Corp L (Umax), & Uranex Explor & M'g L. Major int est dev program for the large iron ore dep of Lake Abitibi area, NW Que. has optioned iron ore of Kaino area ML, exercised to Jan 1976; also optioned in 1974 for purchase of 50% of Algonquin Minerals L, & in promotion of "Local" project for the area which controls iron ore deposit of own 1 billion tons over 31 km. Also engaged in major explor for uranium in joint vent with Eldorado Nuclear & Serru Nuclear, in 1976 in 1976 of a \$3,000,000 program covering general area of La Grande River, numerous anomalies & other info obtained, & explor continuing 1977, also has 33.5% int (into balance) in deposit of Lake Sakami containing 9,000,000 lbs U₃O₈. & other int from 11% to 51% in other programs, 1978, with Cominco (20%) & Pancontinental M'g (40%), explor for uranium in Ohio Mtn area, N Que (James Bay 40%), relay & int. geochem surveys indic significant uranium discovery.

JAMES RIVER ML — Reported defunct 1976

JAMESTOWN EXPLORS INC (MSE) — 500, 65 Queen St W, Toronto MSH 2M5 C. D. Cameron, pres, H. G. Harper, I. A. Wallace, dirs. R. Brown, sec-treas, Inc. 1949, Ont chart, Cap. 250,000 shs, now 1,874,754 (541,289 escrowed). Tr Ag: Premier Tr, Toronto, June 1972, name changed from Argentinum ML, 1 new sh for 8 old. Gold pros, 38 cls, Clency & LaPouse twps, NW Que. airborne & ground geophys surveys & limited d d by prev ints, 1976, d d Dec 31, 1977, curr assets \$45,855, curr liab \$600. Fin: 1978, optioned to Long Lac Mineral Explor L which can earn 80% int by expend.

JAMEX EXPLORATIONS L (MSE) — 412, 8 King St E, Toronto MSC 1B5 H. M. Stanley, Loughrea, Ireland, pres, W. W. Cummins, Toronto, v p; H. J. Stanley, Rockwood, Ont, sec-treas, H. Rapp, Toronto, dirs, Inc. 1970, Dom chart, Cap. 10,000,000 shs, npv, iss 1,365,005. Tr Ag: Canada Permanent Trust, Montreal.

Prop & Dev: (1) Option from Denison ML & Argosy M'g to earn 51% int in 8 props, 2 groups, in Ireland, by expend \$84,000 total on both, copper-silver pros, Aherlow group, extensive d d by prev ints, \$200,000 explor commitment, d d, 1973, 1976, d d where prev work indic possible 6 million tons over 0.9% copper & 1.31 ozs silver per ton, (2) Through affil Mexican co copper-molybdenum pros in Mex optioned to Noranda Mex affil, which can acq for cash, (3) (a) 36% int in 355 cls, Bathurst, NB, optioned to Metallgesellschaft Canada L & Aquitaine Co of Canada L for prop payments aver \$375,000 & 15% net cash royalty, (b) 36% int in 7½% net profit royalty on 231 cls, Ont & (b) 1976-77, geol mapping, geochem & geophys surveys, 1978, further work incl d d, Fin: Sept 30, 1977, working cap deficit \$63,842.

JAN-KEN ML — Address & status unknown

JANUS EXPLORS L — Address & status unknown.

JARAD RESOURCES L — BC chart cancelled Aug 1977

JARIDGE EXPLORS INC — 806 88 University Ave, Toronto M5J 1T6 R. S. Nelson, pres, I. Dobbs, C. A. Hart, dirs, J. T. Tokarsky, sec-treas, Inc. 1978, by amalg of Fairview M'g L, 1 new sh for 4 old shs, Hivew GML, 1 new sh for 4 old shs, Jacomo ML, 1 new sh for 4 old shs, Ridgeman Explors & Dev L, 1 new sh for 2 old shs, Ont chart, Cap. 3,000,000 shs, npv, 1,200,000 pref shs, 1/10 of 1c, iss 1,350,005 com (843,750 escrowed). Tr Ag: Metropolitan Tr, Toronto. **Prop:** (1) Uranium pros, 14 cls, Cardiff twp, 8 mi S of Bancroft, E Ont, 1976, radio-metric survey, d d, line cutting, trenching, 1977, 2,182 ft d d. (2) Gold-copper pros, 3 cls, Frechette twp, Larder Lake div, N Ont, 1974, mag & EM surveys, 1,268 ft d d. (3) Gold pros, (a) 10 cls, Frechette twp, 1974-75, mag & EM surveys,

geol mapping, 1,670 ft d d, (b) 8 cls, Thornhill twp, Porcupine div, N Ont, 1974, mag & EM surveys, d d.

JASON EXPLORS L — 775, 555 Burrard St, Vancouver, J. D. Mason, pres, A. E. Hale, sec-treas, Inc. 1967, BC chart, Cap. 5,000,000 shs 50¢; iss 2,443,802 (379,500 escrowed). Tr Ag: Guaranty Tr, Vancouver. Held: (1) Uranium pros, 6 cls, Alton Lake area, BC; 1968-70, surf explor, trenching & geochem survey. (2) Molybdenum tungsten pros, 16 cls, Stormy Mtn, Watson Lake dist, Y.T., held by subed, Napco Explors L, 1968, surf explor. (3) Copper-silver pros, 27 cls, Campbell River area, NWI, 1968-69, surf explor, 1971, trenching, 1973, further trenching. (4) Held 650,000 shs (75%) Napco Explors (now defunct).

JATICA MINES L — BC chart cancelled Oct 1977.

JAYBEE LANDRY EXPLOR & M'G CO L — Address & status unknown

JAYE EXPLORATIONS L — Ont chart cancelled Mar 1976.

JAYROX M'G CORP L — BC chart cancelled June 1977

JCAN LAKE LITHIUM ML — 2400, 44 King St W, Toronto M5H 1E2 K. A. Roberts, pres, P. C. Finlay, v p, Inc. 1955, Ont chart, Cap. 3,000,000 shs, \$1; iss 1,875,005 (787,500 escrowed). Tr Ag: Crown Tr, Toronto. Held: (1) Lithium pros, 18 pat cls, Cosgrove-Jean Lakes dist, Beardmore area, NW Ont. Extensive surf d d 1955-56 indic 1,689,000 tons over 1.30% lithium oxide, geophys survey 1957, idle since. (2) 710,000 shs (controlling int) in Lithijean ML (dormant).

JEBCO EXPLORATIONS L — Alta chart cancelled Sept 1977.

JELEX ML — Name changed June 1978, to Key Lake Explors L, 1 new sh for 5 old shs.

JENNIFER ML — Box 40, Toronto-Dominion Centre, Toronto M5K 1B7. W. A. Robinson, pres, E. R. Ryan, sec-treas, Inc. 1972, Ont chart, Cap. 3,000,000 shs, npv; iss 950,000. Tr Ag: Co. Base metal pros, 21 cls, adj-Santa Maria prop, E. Sturgeon Lake area, NW Ont; 1973, 1,803 ft d d. Co owned 66.7% by Newconex-Goldfields, 33.3% by Canadore Mines & Resources L.

JEROME EXPLORS L — 402, 45 Richmond St W, Toronto M5H 1Z3 D. F. Collingwood, pres, Inc. 1971, Ont chart, Cap. 3,000,000 shs, npv; iss 1,330,005 (650,000 escrowed). Tr Ag: Sterling Tr, Toronto. Held: Copper-zinc pros, 25 cls, Duparquet twp, Rouyn div, NW Que; 1973, magnetic & EM surveys, mapping & d d; 1976, surf explor, EM survey. No recent report.

JERSEY CONS ML — Name changed July 1976, to Holofilo Technology Inc, sh for sh.

JETEX RESOURCES L (ASE) — 1710, 1177 W Hastings St, Vancouver V6E 2L3. C. M. Scott, pres; A. Macdougall, v p; C. R. Johnson, sec, Inc. 1969, BC chart, Cap. 4,000,000 shs, npv; iss 1,405,000 (750,000 escrowed). Tr Ag: Crown Tr, Calgary. Controlled (77%) by Intl Precious Metals Inc. (1) Copper pros, 4 cls, Sayward area, Nanaimo div, Vancouver Isl, BC. (2) Gold pros: (a) 19,000 ac, 80% int, optioned, Guysborough cty, NS; 1975-76, surf explor, EM & geochem surveys, trenching & d d; (b) optioned 247 ac, Tipuan River valley, Bolivia; 1975-76, surf explor; (c) 855 ac, optioned, Miramar dist, Costa Rica; 1975-76 explor. (3) Int in oil pros, German North Sea. No recent report.

JILBIE MINING CO L — Ont chart, cancelled Mar 1976.

J.M.D. CANADIAN EXPLORS L — 204, 215 Portage Ave, Winnipeg R3B 1Z9. M. O. 56 Terrace Ave, Flin Flon, Man. J. M. Brain, Flin Flon, pres, M. Skwark, sec; W. Dubowec, treas; T. Konyk, v p; dirs, Inc. 1970, Dom chart, Cap. 500,000 shs, npv; iss 123,004. Private co. (1) Copper-zinc-gold pros, both Reddeer dist, Sask (a) 1,038 ac; 1972, aerial survey, 1973-74, geophys survey & d d. 1976-77, d d. (b) 1,200 ac; 1974, geophys survey, 1977, geophys survey. (2) Copper-zinc-molybdenum pros, 620 ac, Amisk Lake area, Sask, optioned to Hud-

son Bay Explor & Dev Co L; d d 1972, geophys survey; 1973, aeromagnetic survey; 1974, d d.

JO EXPLORS L — BC chart cancelled Oct 1977.

JOGRAN ML — Ont chart cancelled Mar 1976.

JOHNSBY ML — 1011, 2200 Yonge St, Toronto M4S 2G6. J. C. Byrne, pres, W. Steuerman, sec-treas, Inc. 1962, Ont chart, Cap. 3,500,000 shs, \$1; iss 3,000,007. Owned jointly by Discovery ML & Hydro Explors L. Holds gold pros, 71 cls, Indian Lake area, 125 mi N of Yellowknife, NWI. Optioned Apr 1974, to Cominco L, 1974, expend \$250,000 on d d 20 holes & investigate 2,000 ft section of a 20,000 ft long gold bearing dyke, work indic 20,000,000 tons to 1,000 ft over 0.05% int by open pit m'g, no work since, option dropped 1977.

JOINED M'G CO L — 800, 88 University Ave, Toronto M5J 1T0. Inc. 1967, Ont chart. Formed 1967 to take over 10 cl molybdenum pros, Cardiff twp, SL Ont. Cardiff Uranium ML holds 375,000 shs. Inactive since inc. No props.

JOLIET-QUEDEC MINES L — 506, 199 Bay St, Toronto M5J 1E5 V. Thornborough, Vancouver, Ont, pres, W. I. Hogarth, v p, B. Kraft, sec-treas, W. R. Packman, J. S. Grant, dirs, Inc. 1936, Ont chart, Cap. 1,000,000 shs, npv, iss 5,072,351. Auth cap incr from 3,000,000 to 5,000,000 shs 1944 to 6,000,000 in 1946 & to 7,000,000 in 1975. Tr Ag: Canada Permanent Trust, Toronto & Montreal. Present int acq control 1972 by purchase of 1,128,800 shs held by Falconbridge Nickel ML. **Prop & Dev:** (1) Gold-copper prop, approx 535 ac, Rouyn twp, Que, adj Noranda & Quemont, 3-compart shaft to 628 ft with levels at 150, 300 & 600 ft. Intermittent surf work incl d d since lateral work stopped in 1947. In 1967, completed limited d d from adj workings. Noranda held mining rights (paid royalties on ore mined, used as a smelter fuel) until Dec 31, 1973 on underground block in shaft area; indic est res 1,239,234 tons over 0.95% copper. To Dec 31, 1973, total of 2,482,016 tons mined by Noranda incl: 1973, 45,000 tons; 1972, 128,000 tons; 1971, 118,000 tons; 1970, 61,018 tons. (2) Acq 1972-74 for \$395,000, 17% int in Kanichee M'g Inc (see) & to be repd invest from prod which started early 1974 & conc subsequently sold to Falconbridge Nickel ML, Feb 1976. Falconbridge terminated agreement & ops suspended. (3) Jt vent with Osisko Lake ML in option to earn 50% int in 37 cls, Shelby Lake platinum-palladium area, Lac des lacs, NW Ont, 1975, EM & magnetic survey & d d.

JOLIN DOURLAMAQUE ML — Amalg June 1976, with 7 other cos of "Brossard Group" to form Brossard Inc, 1 new sh for 5,000 old shs.

JOLLOCO EXPLORATIONS L — Ont chart cancelled Mar 1976.

JOMAR M'G CO L — BC chart cancelled Apr 1977.

JONSMITH ML — Name changed May 1976, to New Jonsmith Explor L, 1 new sh for 200 old shs, & shareholders voted to transfer chart from Ont to Alta.

JORDAN RIVER ML — Formed 1971 by Pechiney Dev L (60%) & Dixon Dev L (40%) to oper former Sunro copper prod, 60 cls, 20 mi N of Sooko, Vancouver Isl, BC; prod started Jan 1973 at 1,000 tons per day, later incr to 1,500 tons. Aug 1974, Pechiney sold its int to Dixon which oper until Dec 1974 when mine closed & co placed in receivership by Pechiney to protect its holding of 2,000,000 lbs. Recoverer: J. Mason, Dunwoody & Co, 505 Burrard St, Vancouver.

JORDESCO RESOURCES L — Ont chart cancelled Aug 1976.

JOREX LTD (TSE)

EX.O.: 600, 85 Richmond St W, Toronto M5H 2E8. DIR & OFF: J. Rankin, pres; D. T. Rankin, v p; J. S. Grant, sec; J. C. Byrne, S. A. J. Azzareto, N. H. C. Fraser, H. J. Richardson; dirs. M. Osborne, treas, INC. 1968, Ont chart, CAP: Auth, 6,000,000 shs, npv; iss 2,811,507. TR AG: Guaranty Trust, Toronto, Montreal & Vancouver, July 1978, auth cap incr from 4,000,000 shs.

Oper: Active explor programs across Canada on own behalf & with others. (1) Fluorite pros, jly with Conwest, discovery late 1971, approx 800 cls staked, 1 mi from Liard Crossing, 200 mi W of Fort Nelson, BC, now co formed, Liard Fluorspar ML, to hold prop, co's int 42.5%, Conwest 47.5%. Late May 1974, 50% int (acq Apr 1974) in option to purchase from Northfield Mines Inc 1,000,000 shs (36%) of Silver Eureka Corp L (see) sold to Pamminx L for \$50,000 cash & \$100,000 10% conv debt. Half of debt paid to 2 creditors in discharge of debt of \$150,000 prev incurred re Eureka option. Holds 19,100 lbs Silver Eureka Corp (est val \$7,000). & \$25,500 Pamminx debt (after \$30,000 pd Jan 1977). (2) Uranium pros, over 1,500 ac, Second prog, N Ont, 1978, agreement with F. A. H. Explors L which can earn 50% int by expend \$1,250,000, initial phase incl surveys, geo mapping, d d & evaluation, for expens \$100,000.

Fin: Dec 31, 1977, curr assets \$19,561, curr liab \$42,131.

JOUBI M'G CORP L — Ont chart cancelled Feb 1977

JOUEL COPPER MINES LTD (TSE) — P.O. Box 91, Commerce Court W, Toronto M5L 1G7 W. James, pres, M. D. Rowswell, exec v p, D. W. Falconer, J. O. Hinds, W. S. Row, dirs, Inc. 1961, Ont chart, J. B. Sage, sec, I. D. Bayer, treas. Cap. 5,000,000 shs, 55¢, iss 4,050,073. Tr Ag: Royal Tr, Toronto. Kerr Addison controls with 3,057,091 shs (60%). Par val reduced Aug 1975 from \$1 by cap distribution of 2½¢ per sh, being total pymt of \$977,815; reduced July 1976, from 80¢ by cap distribution of 25¢ per sh for total \$1,222,268. Divs: Initial 10¢ plus 15¢ extra pd Dec 18, 1969, 1970, 50¢, 1971, 40¢, 1972, 10¢. None until July 28, 1977, 12¢, 1978, 4¢. Total to June 21, 1978, \$9,093,924.

Prop & Dev: Former zinc-copper shipper, 35 cls, Jouel twp, 60 mi N of Amos, NW Que, 3-compart shaft to 1,228 ft, oper levels at 575 & 1,025 ft. Prod from zinc zone started Aug 1972, 1966, advanced \$650,000 to Mines de Pointe which expanded its mill, 3 mi from Jouel prop, to treat 700 tons daily of Jouel ore; copper shipments started Feb 8, 1967, to late Aug 1972 when mill circuit converted to treat zinc ore. Prod 1973 alternated between copper & zinc. Ops ceased June 30, 1975, after closing of Pointe mill; co winding up affairs.

Fin: Mar 31, 1978, working cap \$238,756.

JOUSEY DENTON GML — Box 339, Toronto Dominion Centre, Toronto M5K 1K7. F. H. Jowsey, pres, D. Horncastle, sec-treas, Inc. 1935, Ont chart, Cap. 3,000,000 shs, \$1, iss 1,815,409 (995,000 escrowed). Tr Ag: Crown Tr, Toronto. No prop.

JULCO IRON CORP L — 2900, 1115 Sherbrooke St W, Montreal H3A 1A8. EXPL MGR. W. Blakeman, Inc. 1963, Dom chart. Wholly-owned subsid of Cdn Javein L, holding iron pros, part of concession, Juliette Lake area, Labrador. Since 1969 carried on marketing studies with view to iron pellet oper. Engineering studies in 1971 on simultaneous dev of Julian iron ore deposit in the area & nearby Star-O'Keef concession. Legislation June-July 1975 by Nfld govt expropriated Julian concession.

JUMBO ML — BC chart cancelled April 1977.

JUNEX RESOURCES L — Name changed Mar 1976, to C.T. Exploranda, 1 new sh for 4 old shs.



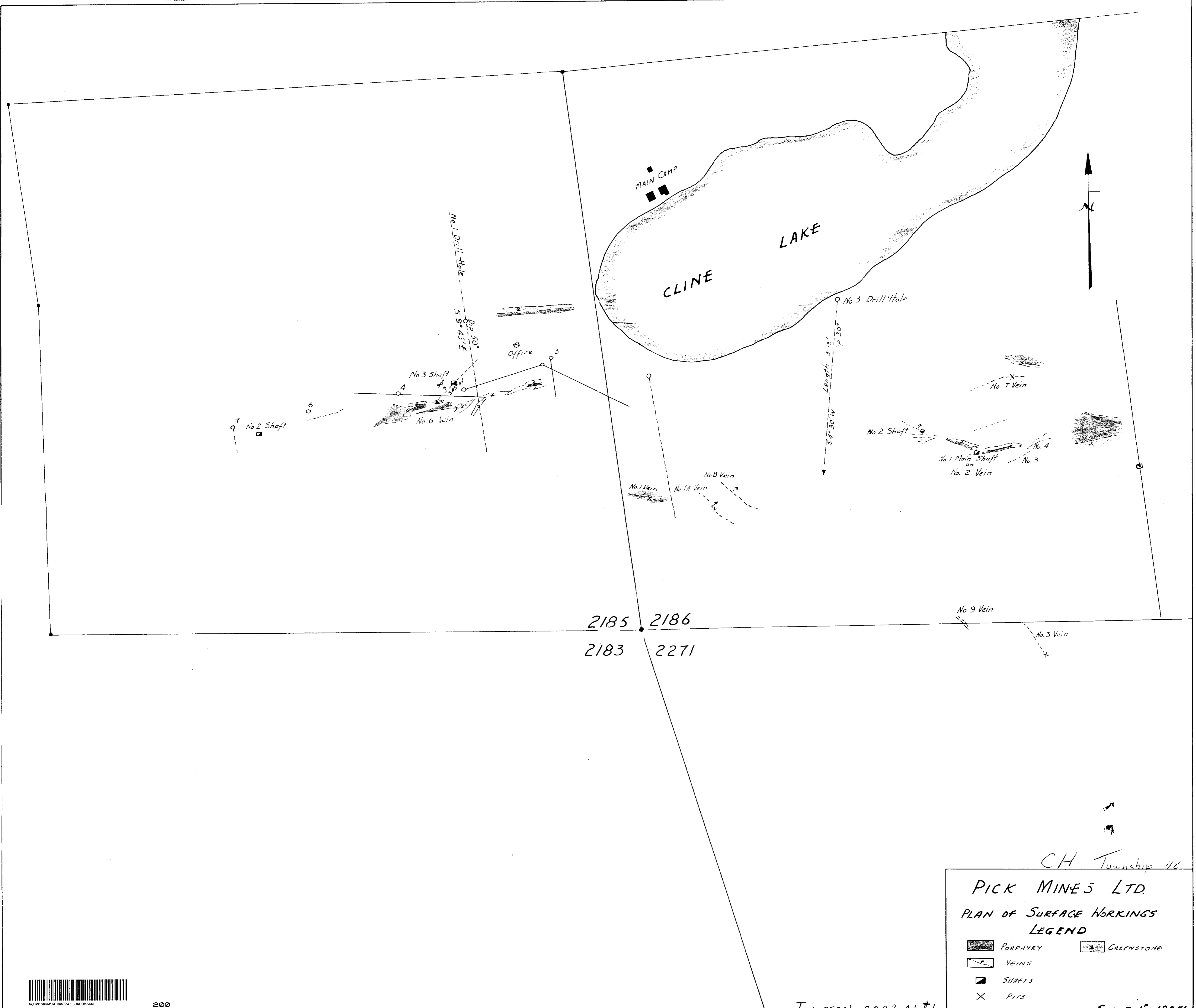

JUNIPER ML (VC) — 101, 325 Howe St, Vancouver V6C 1Z7 R. Philip, Nicaragua, pres, R. McKay, R. Hughes, dirs, Inc. 1966, BC chart, Cap. 3,000,000 shs, npv, iss 1,953,708 (700,000 escrowed). Tr Ag: Guaranty Tr, Vancouver. Base metal pros, 12½%-20% profit-sharing int, 5 cls, Port Hardy area, Nanaimo div, Vancouver Isl, 1972, surf explor, geochem survey.

JUPIER DEV CORP L (ASE) — 404, 360 Bay St, Toronto M5H 2V6 S. J. Randall, chm, G. de Duxey, pres, J. A. Murphy, sec-treas, S. Fairfield, dirs, Inc. 1971, Alta chart, Cap. 4,000,000 shs, npv; iss 2,122,002 (660,000 escrowed). Tr Ag: Guaranty Tr, Calgary & Toronto. **Prop & Ints:** (1) 10% int in

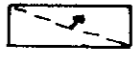

CH Township 48

PICK MINES LTD.
PLAN OF SURFACE WORKINGS
LEGEND

	PORPHYRY		GREENSTONE
	VEINS		SHAFTS
	PITS		

JACOBSON 0022-A1 #1

SCALE 1" = 100 FT.

