



42C12NE0027 2 16755 BRYANT

010

REPORT ON
GEOLOGICAL MAPPING AND PROSPECTING
PATIO LAKE PROPERTY
AREA OF WHITE LAKE (SOUTH PART)
THUNDER BY MINING DIVISION
ONTARIO
FOR
WINSLOW GOLD CORPORATION

2.16755

July 31, 1996
Thunder Bay, Ontario

D.B. McKay, M.Sc
Clark-Eveleigh Consulting



42C12NE0027 2 16755 BRYANT

010C

Table of Contents

	Page
Introduction	1
Property Description	1
Location and Access	2
Topography and Vegetation	2
Previous Exploration	5
Regional and Local Geology	6
Exploration Procedures	6
Property Geology	8
Conclusions	9
Recommendations	9
References	10
Statement of Qualifications	11

List of Figures

Figure 1.	Property location (regional scale)	3
2.	Property location and general geology (local scale)	4
3.	Traverse Lines	7

List of Tables

Table 1.	Status and ownership of claims	2
----------	--------------------------------------	---

List of Maps

Map 1.	Claim Map G-623, White Lake (south part)
Map 2.	Geology of the Patio Lake property

2 . 1 6 7 5 5

List of Appendices

Appendix I	Sample Descriptions
Appendix II	Assay Certificates

INTRODUCTION

At the request of Winslow Gold Corporation of Calgary, Alberta, Clark-Eveleigh Consulting of Thunder Bay, Ontario conducted a geological mapping and prospecting survey on Winslow's Patio Lake property located in the White Lake area of Ontario. The survey was conducted by D.B. McKay and M. Veltri during the period from July 15 to July 21, 1996.

The Patio Lake property consists of 1 claim block comprising 4 claim units. The property is situated in the Thunder Bay Mining Division within the Schreiber-Hemlo Resident Geologist's District. The property is underlain primarily by Archean supracrustal rocks comprising a portion of the eastern end of the north limb of the Schreiber-Hemlo greenstone belt. The property contains 2 molybdenite occurrences and grab samples collected from the property are reported to have returned assay values of up to 14970 ppb gold. The property is currently being assessed to determine its potential for hosting both base and precious metal mineralization.

This report provides details regarding the present survey and discusses the results obtained. It also provides a synopsis of previous exploration and gives recommendations for future exploration.

PROPERTY DESCRIPTION

The Patio Lake property consists of 1 unpatented, unsurveyed claim block comprising 4, 16 hectare claim units (Map 1, back pocket; Figure 2). The claim is situated in the Thunder Bay Mining Division and is currently recorded in good standing at the Thunder Bay Mining Recorder's Office located in Thunder Bay, Ontario. The status and ownership of the claim is given in Table 1.

Table 1. Status and ownership of the claim comprising the Patio Lake property (N.B.: the work described in this report will be applied to the claim for assessment credit, thereby advancing the expiration date by 1 year).

Claim Number	Size	Registered Owner	Expiration Date
TB 1209466	4 units	Winslow Gold Corp.	03/08/96

LOCATION AND ACCESS

The Patio Lake property is located approximately 47 km southeast of Manitouwadge, 58 km east of Marathon, and 28 km northwest of White River, Ontario (Figure 1). The Hemlo gold deposit is located approximately 27.5 km to the southwest. The property is located between Patio and Finger Lakes, approximately 2.75 km east of The Narrows of White Lake (Figure 2). The property is covered by N.T.S. map sheet 42C/12 and by claim map G-623, White Lake (south part) (Map 1, back pocket).

The property is accessible via motor vehicle followed by travel on foot.

From the intersection of highways 614 and 17, proceed easterly along Highway 17 for approximately 22.25 km to the North Regan Road. Proceed easterly and then northeasterly along the North Regan Road for approximately 1.9 km to an unnamed gravel logging road that leads northwesterly to an abandoned gravel pit. Proceed northwesterly along this road, through the gravel pit, for approximately 2.5 km to a point overlooking Patio Lake. Proceed westerly on foot through the bush along the south side of Patio Lake for approximately 750 m to the vicinity of the property. Alternatively, the property may be accessed by following a trail leading northwestwards from the junction of the North Regan Road and Highway 17. Proceed northwesterly along this trail, which, in part, follows a power transmission line, for approximately 1.8 km to the south end of a long, narrow lake, locally known as Finger Lake. Proceed north along the east side of this lake for approximately 1.5 km to the vicinity of the property.

TOPOGRAPHY AND VEGETATION

The property is bounded to the east by Patio Lake, and to the west by Finger Lake. A 45m high, flat-topped, northwesterly-trending ridge is located between these lakes and bisects the property. Rock outcrop generally constitutes less than 5% of the surface area and is concentrated along the ridge. No outcrop occurs along the shorelines of either lake. The northeast corner of the property, especially near the shore of Patio Lake, is relatively low and swampy. Large, rounded granitic boulders are common in this area.

Vegetation consists of sparsely-distributed, over-mature spruce, poplar and birch intergrown with a thick, pervasive, ground-covering mantle of second-generation poplar, alder and maple. Dead-fallen trees are numerous and severely impede travel on foot locally.

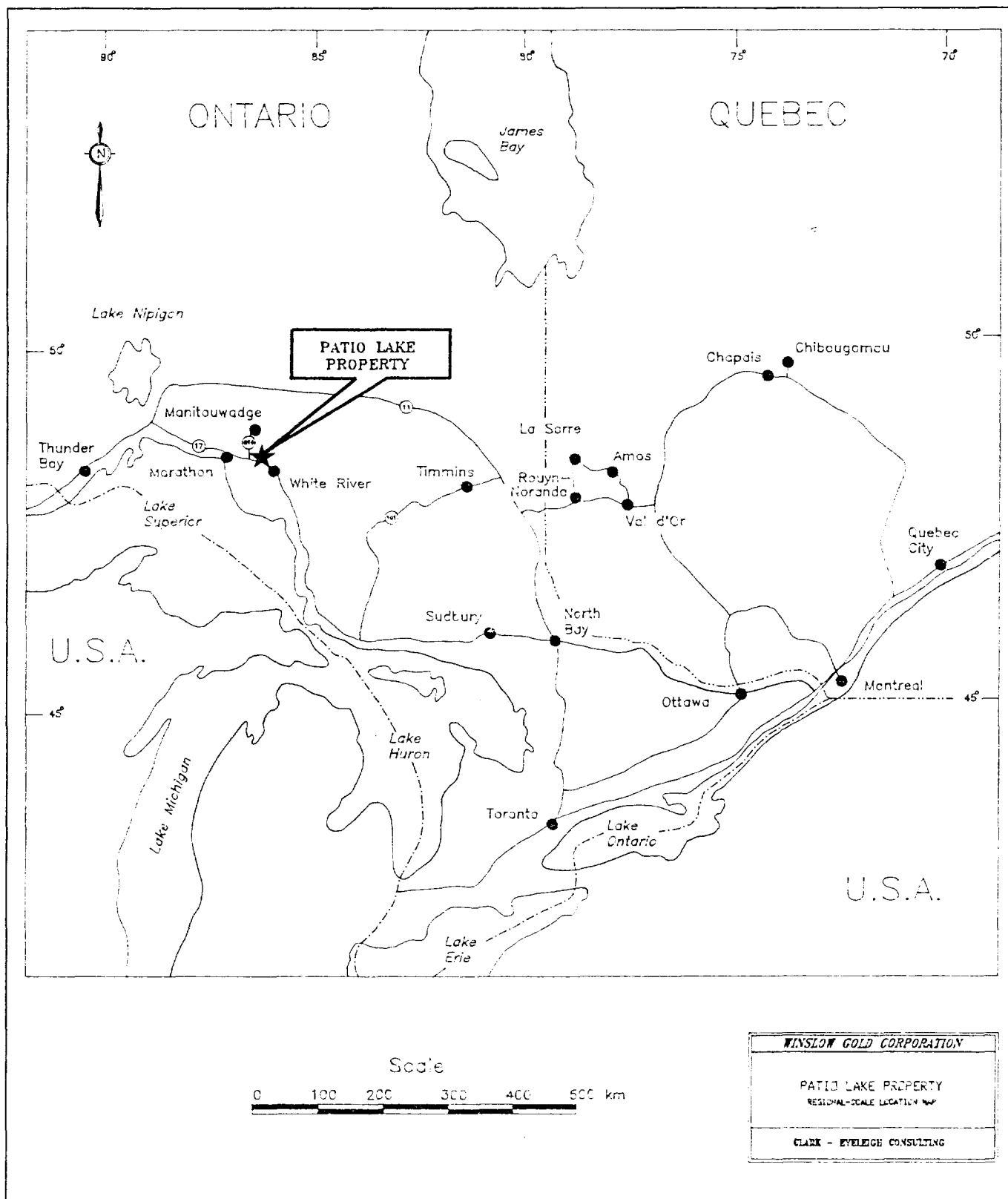

Figure 1. Regional-scale map showing the location of the Patio Lake property.

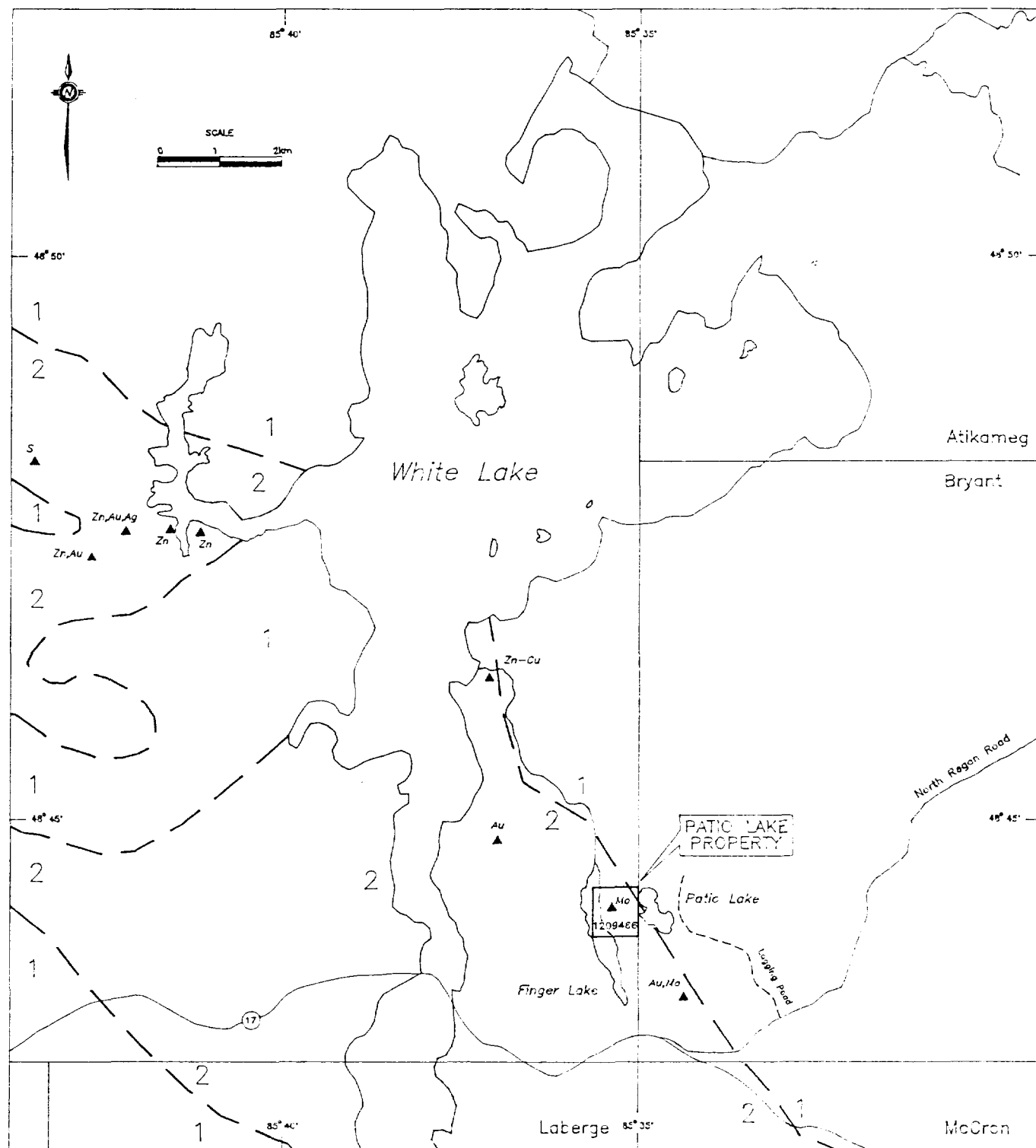

Figure 2. Local scale map showing the location of the Fatic Lake property and the general geology of the surrounding area (geology modified from Milne et al. (1972) and McKay (1994); reported mineral occurrences are shown as solid triangles; geological contacts are shown as dashed lines; 1: felsic intrusive rocks, 2: mafic metavolcanic and metasedimentary rocks, S: sulphides, Au: gold, Ag: silver, Cu: copper, Zn: zinc, Mo: molybdenum).

PREVIOUS EXPLORATION

The area comprising the Patio Lake property has been staked intermittently since at least the early 1970's. Although molybdenum-bearing pegmatites have been known to exist in the Patio Lake area for many years, relatively little mineral exploration has been conducted in the area (Lohman 1983). Grab samples collected from the area are reported to have returned assay values of up to 14970 ppb gold (Lohman 1983). Subsequent exploration has failed to reproduce these values (Lohman 1983, Cavey and Raven 1986, Gallo 1990). To the author's knowledge, no diamond drilling has been conducted on the property.

A synopsis of previous work performed on the property and filed for assessment credit with the Ontario Ministry of Northern Development and Mines and/or compiled by ministry staff is given, in chronological order, below:

1982: D. Carroll staked 4 claims that covered the known molybdenite occurrences in the Patio Lake area. These claims were optioned to G. Hawley, who staked an additional 67 claims in the surrounding area. All of these claims were then optioned to Windarra Minerals Ltd.

1983-1984: Oso Explorations Ltd. and Agilis Engineering Ltd., working on behalf of Windarra Minerals Ltd., conducted linecutting, geological mapping, soil geochemical sampling and lithochemical sampling on the Patio Lake claims (Lohman 1983). Rock Samples collected during this work failed to return any significant gold or base metal assay values (Lohman 1983). The soil sampling program did, however, identify 2 gold targets on the property (Lohman 1983). These targets were explored by Orequest Consultants Ltd. in 1985 (see below).

In 1983, Aerodat Limited conducted an airborne geophysical survey (HLEM, VLF-EM, MAG) of approximately 1570 km² in the Hemlo area. This survey included the area comprising the Patio Lake property.

1985: Orequest Consultants Ltd., working on behalf of Windarra Minerals Ltd., conducted further linecutting, geological mapping, prospecting, lithochemical sampling and trenching on the Patio Lake claims. No new areas of interest were discovered. The best gold assay obtained was 140 ppb gold from a grab sample of vein quartz. No further work was recommended for the property (Cavey and Raven 1986).

1990: Prospectors D. Carroll and G. Carroll conducted a program of basic prospecting, overburden stripping, rock trenching and lithochemical sampling on 4 claims covering the area which now comprises the Patio Lake property (Gallo 1990). Grab samples collected from a molybdenite-bearing pegmatite on the property returned assay values of up to 0.002 ounces of gold per ton, and 3840 ppm molybdenum (Gallo 1990).

REGIONAL AND LOCAL GEOLOGY

The property is located in the Wawa subprovince and is underlain primarily by a northwesterly-trending sequence of mafic metavolcanic and clastic metasedimentary rocks which comprise a portion of the eastern end of the north limb of the Schreiber-Hemlo greenstone belt (Milne et al. 1972; Ontario Geological Survey 1991a-g). These rocks are locally strongly foliated and mineral assemblages indicate they have experienced lower amphibolite facies-grade regional metamorphism (Milne 1968b; Milne et al. 1972).

In the vicinity of the property, the supracrustal sequence is approximately 4 km wide, and is bounded to the northeast by granodioritic rocks of the Dotted Lake Batholith, and to the southwest by the Cedar Lake Pluton (Milne et al. 1972; Figure 2). The property is located along the northern margin of the belt within a 1 km wide sequence of amphibolitic mafic metavolcanic rocks (Milne et al. 1972). Minor amounts of clastic metasedimentary rocks are reported to occur within the volcanic sequence (Lohman 1983, Cavey and Raven 1986, Gallo 1990).

Several molybdenum occurrences are reported to exist on the Patio Lake property and several gold and base metal occurrences are reported to occur elsewhere within the north limb of the Schreiber-Hemlo greenstone belt in the area surrounding the property (Lohman 1983; Cavey and Raven 1986; Gallo 1990; McKay 1994; Figure 2). To date, none of these occurrences have been shown to contain economic amounts of gold, base metals or molybdenum.

EXPLORATION PROCEDURES

A geological mapping and prospecting survey was conducted on the Patio Lake property by D.B. McKay and M. Veltri during the period from July 15 to July 21, 1996. Two days were spent on the property performing the survey.

The survey was conducted along the shores of Patio and Finger Lakes, and along claim lines where possible. Approximately 1 km of shoreline and 2.5 km of claimline were mapped, prospected and sampled (Figure 3). The mapping was conducted at a scale of 1:2500. Six grab samples were collected and assayed to determine their gold, silver, copper and zinc content (Appendices I and II; Map 2). The molybdenum content of one sample was also determined. Spatial control was maintained by utilizing a hip chain and a compass.

During the survey, accommodations were procured at White Lake Lodge, which is located adjacent to Highway 17, approximately 30 km west of the town of White River.

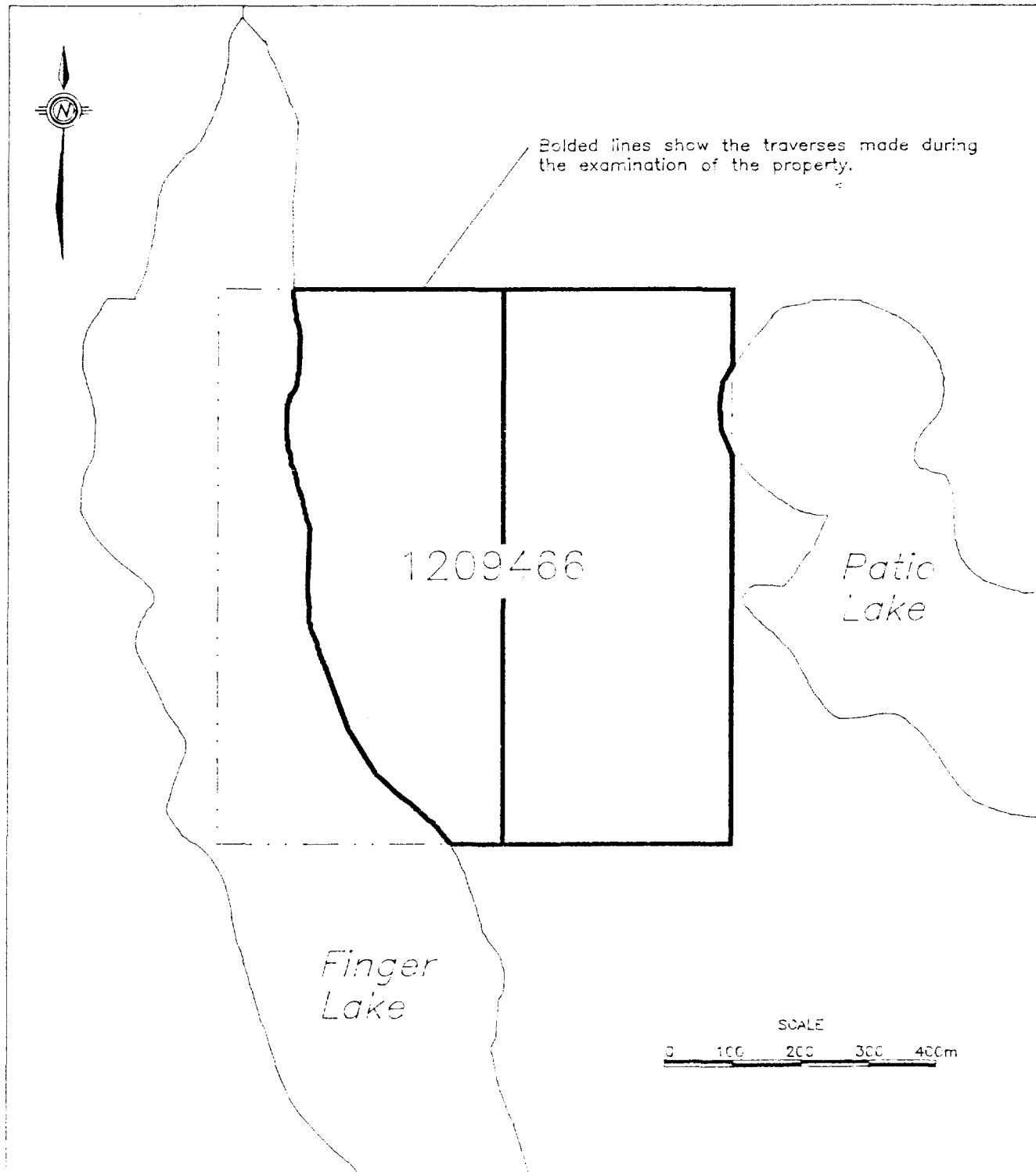

Figure 3. Traverse lines followed during the examination of the Patric Lake property.

PROPERTY GEOLOGY

The geology of the property is described in detail by Lohman (1983), Cavey and Raven (1986) and Gallo (1990). The geological mapping conducted during the present survey confirmed, generally, the findings of these workers. In summary, the property was found to be underlain primarily by a northwesterly-trending sequence of amphibolitic mafic metavolcanic rocks intercalated locally with minor amounts of clastic, quartzo-feldspathic metasedimentary rocks. Narrow, foliation-parallel and foliation-crosscutting, locally pegmatitic, sills and dikes of granitic composition occur locally within the mafic metavolcanic rocks. Numerous large, rounded, boulders of granitic composition occur on the northeast portion of the property, suggesting that area may be underlain by rocks of granitic composition (Map 2).

The mafic metavolcanic rocks are typically locally rusty-weathering, dark green to black, moderately foliated, medium-grained, non-magnetic, non-calcareous amphibolitic schists. The foliation in these rocks varies in strike to 320 to 344 degrees, and in dip from 65 east to 85 degrees west. Trace amounts of pyrite occur locally within these rocks as fine-grained disseminated grains.

The clastic metasedimentary rocks are poorly exposed on the property. Where present, they occur as thin (generally less than 1 m wide) units within the mafic metavolcanic sequence. These rocks are typically thinly banded (on a cm scale), moderately foliated, medium-grained quartzo-feldspathic schists. No sulphide mineralization or alteration was found to be associated with the metasedimentary rocks.

Pegmatitic granite occurs as locally rusty-weathering, pinkish-white, massive to weakly foliated, coarse- to very coarse-grained sills up to 1 m wide within the mafic metavolcanic sequence. One sill was traced in outcrop for 10 m along strike. Fractures within these sills are locally mineralized with variable amounts of coarse-grained pyrite and molybdenite.

During the present examination of the property, one blast pit approximately 2 m long by 1 m wide by 0.5 m deep was located and sampled (Map 2). This pit exposes pyrite and molybdenite mineralization within a very coarse-grained granitic pegmatite. The pegmatite is hosted within amphibolitic mafic metavolcanic rocks, is approximately 1 m wide, and can be traced along the side of the low-lying ridge for approximately 10 m along strike. The sulphides are localized within a 2 to 3 cm wide zone centered along a fracture within the pegmatite. The fracture strikes northerly and dips 60 degrees to the east. Pyrite occurs as coarse-grained euhedra and constitutes 2 - 3% of the mineralized zone. Molybdenite occurs as coarse-grained anhedral blebs and flakes, and constitutes, locally, up to 25% of the mineralized zone. Yellow ferrimolybdenite commonly coats the weathered portions of the mineralized zone.

Six grab samples were collected from the property and assayed to determine their gold, silver, copper and zinc content. One of these samples was also assayed for molybdenum. These samples are described in Appendix I, their locations are given on Map 2, and the assay results are given in Appendix II. The highest assay values obtained from these samples were <5 ppb gold, 3 ppm silver, 80 ppm copper, 33 ppm zinc and 8800 ppm molybdenum.

CONCLUSIONS

1. The geological mapping conducted during the present survey confirmed, generally, the findings of previous workers.
2. The Patio Lake property is underlain primarily by a northwesterly-trending sequence of amphibolitic mafic metavolcanic schists intercalated with minor amounts of clastic, quartzo-feldspathic metasedimentary rocks. The mafic metavolcanic rocks have been intruded locally by foliation-parallel and foliation-crosscutting, locally pegmatitic, granitic sills and dikes. Pyrite and molybdenite occur locally within the pegmatitic sills in amounts varying up to 3% and 25% respectively. Grab samples collected from the property returned assay values of less than 5 ppb gold, and up to 3 ppm silver, 80 ppm copper, 33 ppm zinc and 8800 ppm molybdenum. Where exposed in a blast pit, the pegmatite-hosted sulphide mineralization is confined to a 2 to 3 cm wide zone which can be traced along strike for approximately 2 m.
3. The economic potential of the molybdenite showing examined during the present survey is restricted by the narrow width of the mineralized zone, by its low molybdenum content and by the small size of the pegmatite hosting the mineralization.
4. No new gold, molybdenum nor base metal occurrences were discovered during the present examination of the property.

RECOMMENDATIONS

Although the exploration conducted on the property to date (Lohman 1983, Cavey and Raven 1986, Gallo 1990) has failed to discover economical amounts of gold, molybdenum or base metals, the recent discovery of gold-bearing quartz veins by prospectors D. Carroll (now deceased) and D. MacDougall on claims located approximately 2 km to the northwest of the Patio Lake property (McKay 1994) is encouraging, and suggests prospecting on the Patio Lake property for gold-bearing quartz veins may be warranted.

The molybdenite-bearing pegmatites present on the property do not warrant further work.

REFERENCES

- Cavey, G., Raven, W 1986. Report on the property of Windarra Minerals Ltd., Bryant Township, White Lake area south, Sault Ste. Marie Mining Division, Ontario; assessment files (Hawley, G.), Thunder Bay Resident Geologist's Office, Schreiber-Hemlo District, Thunder Bay, 8p.
- Gallo, E.A. 1990. Report on 1990 prospecting program of Daniel and Gerrard Carroll; assessment files (Carroll, Daniel, file #63.5872), Thunder Bay Resident Geologist's Office, Schreiber-Hemlo District, Thunder Bay, 12p.
- Lohman, G. 1983. Geotechnical assessment report on the Patio Lake claims, Bryant Township, White Lake area south, Ontario, Sault Ste. Marie Mining Division, N.T.S. 42-C-12; assessment files (Hawley, G.), Thunder Bay Resident Geologist's Office, Schreiber-Hemlo District, Thunder Bay, 22p.
- McKay, D.B. 1994. Mineral occurrences of the Manitouwadge area, Volumes 1-3; Ontario Geological Survey, Open File Report 5906, 566 p.
- Milne, V.G., Giblin, P.E., Bennett, G., Thurston, P., Wolfe, W.J., Giguere, J.F., Leahy, E.J., Rupert, R.J. 1972. Manitouwadge-Wawa sheet, Algoma, Cochrane, Sudbury and Thunder Bay districts; Ontario Division of Mines, Geological Compilation Series Map 2220, scale 1:253440.
- Ontario Geological Survey, 1991a. Bedrock geology of Ontario, east-central sheet; Ontario Geological Survey, Map 2543, scale 1:1000000.
- Ontario Geological Survey, 1991b. Quaternary geology of Ontario, east-central sheet; Ontario Geological Survey, Map 2555, scale 1:1000000.
- Ontario Geological Survey, 1991c. Shaded image of total magnetic field of Ontario, east-central sheet; Ontario Geological Survey, Map 2586, scale 1:1000000.
- Ontario Geological Survey, 1991d. Vertical magnetic gradient of Ontario, east-central sheet; Ontario Geological Survey, Map 2590, scale 1:1000000.
- Ontario Geological Survey, 1991e. Bouger gravity of Ontario, east-central sheet; Ontario Geological Survey, Map 2594, scale 1:1000000.
- Ontario Geological Survey, 1991f. Shaded image of vertical gravity gradient of Ontario, east-central sheet; Ontario Geological Survey, Map 2598, scale 1:1000000.
- Ontario Geological Survey, 1991g. Tectonic assemblages of Ontario, east-central sheet; Ontario Geological Survey, Map 2598, scale 1:1000000.

STATEMENT OF QUALIFICATIONS

I, Douglas Bruce McKay do hereby certify that:

- a) I currently reside at RR #14, Gorevale Road, Thunder Bay, Ontario, P7B 5E5; and that I am currently an employee of Clark-Eveleigh Consulting of 1000 Alloy Drive, Thunder Bay, Ontario P7B 6A5.
- b) I am a graduate of Lakehead University, Thunder Bay, Ontario where I received an H.B.Sc. degree in Geology in 1984 and a M.Sc. degree in Geology in 1987.
- c) I have been engaged in base and precious metal exploration as a geologist since 1984.
- d) I have not received, directly or indirectly, nor do I expect to receive, any interest in Winslow Gold Corporation or any of its properties.

Respectfully Submitted,

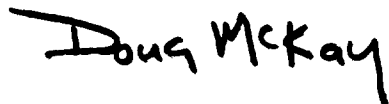

D.B. McKay
July 31, 1996

APPENDIX I
SAMPLE DESCRIPTIONS
PATIO LAKE PROPERTY

SAMPLE NUMBERDESCRIPTION

- 18486: locally rusty-weathering, dark green, moderately foliated, medium-grained amphibolitic schist intruded by several coarse-grained, foliation-parallel, pink granitoid sills of variable width, non-magnetic, non-calcareous, no visible sulphides, (grab)
- 18487: locally rusty-weathering, dark green, moderately foliated, medium-grained amphibolitic schist intruded by numerous medium- to coarse-grained, foliation-parallel, pinkish granitoid sills, non-magnetic, non-calcareous, trace amounts of fine-grained pyrite as disseminated grains, (grab)
- 18488: dark green, moderately foliated, fine- to medium-grained amphibole-quartz-feldspar schist, non-magnetic, non-calcareous, no visible sulphides, (grab)
- 18489: gray- to tan-weathering, medium to dark green, weakly foliated, fine-grained schist, weakly to moderately magnetic, moderately calcareous, no visible sulphides, (grab)
- 18490: locally rusty-weathering, dark gray/green, moderately foliated, medium-grained, amphibolitic schist, non-magnetic, non-calcareous, intruded by a pyrite- and molybdenite-bearing pegmatite, trace amounts of pyrite as fine-grained disseminated grains, (grab)
- 18491: locally rusty-weathering (along fractures), pinkish-white, massive, pegmatitic granite containing 2 to 3% coarse-grained, euhedral pyrite and up to 25% coarse-grained molybdenite localized along a narrow (2 to 3 cm wide) fracture, non-magnetic, non-calcareous, abundant yellow staining (ferrimolybdite) associated with the mineralized fracture, (grab)

APPENDIX II
ASSAY DATA
PATIO LAKE PROPERTY



ACCURASSAY LABORATORIES

A DIVISION OF ASSAY LABORATORY SERVICES INC.

1070 LITHIUM DRIVE, UNIT 2
THUNDER BAY, ONTARIO P7B 6G3
PHONE (807) 623-6448
FAX (807) 623-6820

Page 2

CLARK-EVELEIGH CONSULTING
1000 ALLOY DRIVE
THUNDER BAY, ONTARIO
P7B 6A5

July 22, 1996

Job# 964961

Ref: Doug Parker

Accurassay	SAMPLE # Customer	Gold ppb	Gold Oz/t
------------	----------------------	-------------	--------------

39	18486	<5	<0.001
40	18487	<5	<0.001
41 Check	18487	<5	<0.001
42	18488	<5	<0.001
43	18489	<5	<0.001
44	18490	<5	<0.001
45	18491	<5	<0.001

Certified By: _____



ACCURASSAY LABORATORIES

A DIVISION OF ASSAY LABORATORY SERVICES INC.

1070 LITHIUM DRIVE, UNIT 2
THUNDER BAY, ONTARIO P7B 6G3
PHONE (807) 623-6448
FAX (807) 623-6820

Page 2

CLARK-EVELEIGH CONSULTING
1000 ALLOY DRIVE
THUNDER BAY, ONTARIO
P7B 6A5

July 22, 1996

Job# 964961

Ref: Doug Parker

SAMPLE #		Copper	Silver	Zinc
Accurassay	Customer	ppm	ppm	ppm
36	18486	48	<1	8
37	18487	38	<1	16
38	18488	80	<1	5
39	18489	39	2	24
40	18490	14	3	33
41	18491	26	1	5

Certified By: 



ACCURASSAY LABORATORIES

A DIVISION OF ASSAY LABORATORY SERVICES INC.

1070 LITHIUM DRIVE, UNIT 2
THUNDER BAY, ONTARIO P7B 6G3
PHONE (807) 623-6448
FAX (807) 623-6820

Page 2

C ARK-EVELEIGH CONSULTING
1000 ALLOY DRIVE
THUNDER BAY, ONTARIO
E B 6A5

July 22, 1996

Job# 964961

Ref: Doug Parker

Accurassay	SAMPLE # Customer	Molybdenum ppm	Copper ppm	Silver ppm	Zinc ppm
	36	18486		<1	8
	37	18487		<1	16
	38	18488		<1	5
	39	18489		2	24
	40	18490	8800	3	33
	41	18491		1	5

Certified By: _____



Ministère du Développement du Nord et des Mines

Ontario

Rapport sur les travaux exécutés après l'enregistrement d'un claim

Loi sur les mines

MINING LANDS

N° de transaction

W 9640-472

Les renseignements personnels contenus dans la présente formule sont recueillis en vertu de la Loi sur les mines et serviront à la correspondance. Adresser toute question sur la collecte de ces renseignements au chef provincial des terrains miniers, ministère du Développement du Nord et des Mines, 159, rue Cedar, 4^e étage, Sudbury (Ontario) P3E 6A5; téléphone : (705) 670-7264.

2.1673

Directives : - Dactylographier ou écrire en lettres moulées.

- Se reporter à la Loi sur les mines et à l'évaluation ou consulter le registrateur
- Remplir une formule pour chaque group
- Joindre à la présente formule deux exe
- Joindre à la présente formule une esqu

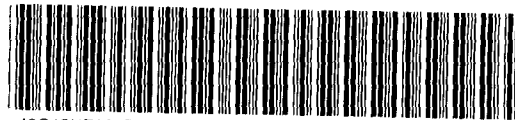

42C12NE0027 2 16755 BRYANT

900

Titulaire(s) enregistré(s) Winslow Gold Corp.		N° de client 300299
Adresse 1000 A. Hwy Dr. Thunder Bay P7B 6A5.		N° de téléphone 807-625-9291
Division des mines Thunder Bay	Canton/secteur White Lake (South Part)	N° de plan M ou G 6-623.
Dates d'exécution des travaux du : July 15		au : July 31 st 1996

Travaux exécutés (cocher un seul groupe de travaux)

<input checked="" type="checkbox"/> Groupe de travaux	(U10) (GEO) (PROSP) Prospecting and Geological Mapping and Sampling.	Genre
<input type="checkbox"/> Levé géotechnique		
<input type="checkbox"/> Travaux physiques, y compris forage		Thunder Bay Mining Division
<input type="checkbox"/> Réhabilitation		AUG 02 1996
<input type="checkbox"/> Autres travaux autorisés		RECEIVED
<input type="checkbox"/> Essais		
<input type="checkbox"/> Valeur transférée de la réserve		

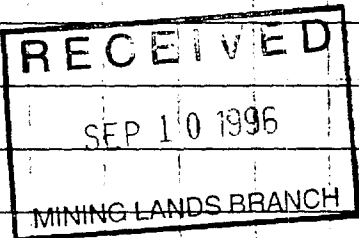

Total des travaux d'évaluation réclamé sur le relevé des frais ci-annexé 2503. \$

Nota : - Le ministre peut rejeter une partie ou la totalité des travaux d'évaluation présentés pour obtenir des crédits d'évaluation si le titulaire enregistré ne peut vérifier les dépenses réclamées sur le relevé des frais dans les trente jours suivant une demande de vérification.

Les personnes et la compagnie d'arpentage qui ont exécuté les travaux (donner le nom et l'adresse de l'auteur du rapport)

Nom	Adresse
Doug McKay	As Above

(Joindre une annexe au besoin)

Certification d'intérêt bénéficiaire * Voir la note n° 1 au verso

Je certifie qu'au moment où les travaux ont été exécutés, les claims dont il est question dans le présent rapport étaient enregistrés au nom de leur titulaire actuel ou détenus à titre bénéficiaire par l'actuel titulaire enregistré.	Date	Titulaire enregistré ou représentant (Signature)
		<i>[Signature]</i>

Certification du rapport sur les travaux exécutés

Je certifie que j'ai une connaissance directe des faits exposés dans le présent rapport, pour avoir exécuté les travaux ou en avoir constaté l'exécution avant ou après leur achèvement. Je certifie aussi que le rapport ci-annexé est exact.		
Nom et adresse du certificateur J. G. Clark - As Above		
N° de téléphone 807-625-9291	Date 02/03/96	Certifié par (signature) <i>[Signature]</i>

Réservé au ministère

Valeur totale des crédits enregistrés \$2503	Date d'enregistrement OCT. 30, 1996	Registrateur de claims <i>[Signature]</i>	Cachet reçu Thunder Bay Mining Division AUG 02 1996 RECEIVED
	Date de l'approbation prévue	Date d'approbation	
	Date d'envoi de l'avis de modification		

Numéro de rapport sur les travaux exécutés pour l'affectation de la réserve	Numéro de claim	Nombre d'unités
	1209466	4
Nombre total de claims		1

Travaux d'évaluation exécutés sur ce claim	Valeur affectée à ce claim
2503	2400
Valeur totale des travaux exécutés	
2503	
Valeur totale des travaux qui a été affectée	
2400	

Valeur transférée de ce claim	Réserve : travaux à réclamer à une date ultérieure
	103
Total transféré	
103	
Réserve totale	
103	

Les crédits que vous réclamez dans le présent rapport peuvent être réduits. Afin de diminuer les conséquences défavorables de telles réductions, veuillez indiquer l'ordre dans lequel vous désirez qu'elles soient appliquées à vos claims. Veuillez cocher (✓) l'une des options suivantes :

- Les crédits doivent être réduits en commençant par le dernier claim sur la liste.
- Les crédits doivent être réduits également entre tous les claims figurant dans le présent rapport.
- Les crédits doivent être réduits selon l'ordre donné en annexe.

Si vous n'avez pas choisi d'option, la première sera appliquée.

Note 1 : Exemples d'intérêts bénéficiaires : cessions non enregistrées, ententes sur des options, protocoles d'entente, etc. relatifs aux claims.

Note 2 : Si des travaux ont été exécutés sur un terrain faisant l'objet de lettres patentes ou d'un bail, veuillez remplir ce qui suit:

Je certifie que le titulaire enregistré possédait un intérêt bénéficiaire sur le terrain faisant l'objet de lettres patentes ou d'un bail, au moment où les travaux ont été exécutés.	Signature	Date
---	-----------	------

Personal information collected on this form is obtained under the authority of subsection 8(1) of the Assessment Work Regulation 6/96. Under section 8 of the Mining Act, the information is a public record. This information will be used to review the assessment work and correspond with the mining land holder. Questions about this collection should be directed to the Chief Mining Recorder, Ministry of Northern Development and Mines, 8th Floor, 933 Ramsey Lake Road, Sudbury, Ontario, P3E 6B5.

Work Type	Units of Work <small>Depending on the type of work, list the number of hours/days worked, metres of drilling, kilometres of grid line, number of samples, etc.</small>	Cost Per Unit	Total Cost
Mapping + Sampling	2 men - 2.0 days	525/day	1050.-
Report + Drafting	1 man - 2 days	300/day	600.-
Word Processing	1 day	200/day	200.-
Associated Costs (e.g. supplies, mobilization and demobilization).			
	Assays 6 samples	25/sample	150.-
		MINISTRY OF NORTHERN DEVELOPMENT AND MINES	
		AUG 02 1996	
Transportation Costs		RECEIVED	
Food and Lodging Costs			503.05
Total Value of Assessment Work			2503.05

Calculations of Filing Discounts:

1. Work filed within two years of performance is claimed at 100% of the above Total Value of Assessment Work.
2. If work is filed after two years and up to five years after performance, it can only be claimed at 50% of the Total Value of Assessment Work. If this situation applies to your claims, use the calculation below:

TOTAL VALUE OF ASSESSMENT WORK x 0.50 = Total \$ value of worked claimed.

Note:

- Work older than 5 years is not eligible for credit.
- A recorded holder may be required to verify expenditures claimed in this statement of costs within 45 days of a request for verification and/or correction/clarification. If verification and/or correction/clarification is not made, the Minister may reject all or part of the assessment work submitted.

Certification verifying costs:

I, James G. Clark, do hereby certify, that the amounts shown are as accurate as may reasonably be determined and the costs were incurred while conducting assessment work on the lands indicated on the accompanying Declaration of Work form as Agent I am authorized to make this certification.
(recorded holder, agent, or state company position with signing authority)

Signature 	Date 02/08/96
---------------	------------------

Ministry of
Northern Development
and Mines

Ministère du
Développement du Nord
et des Mines



October 22, 1996

Geoscience Assessment Office
933 Ramsey Lake Road
6th Floor
Sudbury, Ontario
P3E 6B5

Michael Weirmeir
Mining Recorder
435 James Street South
Suite B003
Thunder Bay, ON
P7E 6E3

Telephone: (705) 670-5853
Fax: (705) 670-5863

Dear Sir or Madam:

Submission Number: 2.16755

Subject: Transaction Number(s): W9640.00472

After reviewing the Work Report(s) we have prepared this letter and the attached summary, which lists the results of our review. Requirements of the Assessment Work Regulation may not have been fully met. Please examine the summary to determine the next course of action concerning the identified Work Report(s).

NOTE: The 90 day deemed approval provision, subsection 6(7) of the Assessment Work Regulation, is no longer in effect for this submission.

PLEASE NOTE ANY REQUESTED REVISIONS MUST BE SUBMITTED IN DUPLICATE.

If the anniversary dates for the mining claims affected by this correspondence have not passed, a number of options are available. Please contact the Mining Recorder to discuss these options.

If you have any questions regarding this correspondence, please contact Lucille Jerome at (705)670-5858.

Yours sincerely,

A handwritten signature in black ink, appearing to read "Ron C. Gashinski".

ORIGINAL SIGNED BY
Ron C. Gashinski
Senior Manager, Mining Lands Section
Mines and Minerals Division

Work Report Assessment Results

Submission Number: 2.16755

Date Correspondence Sent: October 22, 1996

Assessor: Lucille Jerome

Transaction Number	First Claim Number	Township(s) / Area(s)	Status	Approval Date
W9640.00472	1209466	WHITE LAKE (SOUTH)	Approval	October 18, 1996

Section:

12 Geological GEOL

Correspondence to:

Mining Recorder
Thunder Bay, ON

Resident Geologist
Thunder Bay, ON

Assessment Files Library
Sudbury, ON

Recorded Holder(s) and/or Agent(s):

J.Garry Clark
THUNDER BAY, ONTARIO

WINSLOW GOLD CORP.
CALGARY, ALBERTA

NEW FILE SUBMISSIONS

File Number **2.16755**

OMIP

OPAP

Claim Holder **BOILY, BERNARD / METALL MINING
CORPORATION**

Township **PRICE / THORNELOE**

Mining Division **PORCUPINE**

Report of Work # **W9660.00461**

Survey **MAG**

Shelved **13-2**

Date Recorded

Date Approved **10/15/96**

Date Filed **10/24/96**

INFO Client Number **CLIENT #169899**

Date Shipped

invoice #

Date Returned

Notes

NOTES

AREAS WITHDRAWN FROM DISPOSITION

M.R.O. - MINING RIGHTS ONLY	S.R.O. - SURFACE RIGHTS ONLY	M. & S. - MINING AND SURFACE RIGHTS		
Description	Order No.	Date	Disposition	File
1 CROWN RESERVE			S.R.O.	1630064
2 SEC. 36/80 W. 2/81 1/4/81			S.R.O.	188546
3 SEC. 36/80 W. 2/81 1/4/81			S.R.O.	188546
4 SEC. 36/80 W. 7/82 5/4/82			S.R.O.	188546
5 SEC. 36/80 W. 10/82 7/4/82			S.R.O.	1630064
6 SEC. 36/80 W. 12/81 11/07/81 M&S				
7 Pending application for surface rights P.L.B. May 20, 1991				

WHITE LAKE AREA (NORTH PART) G-622

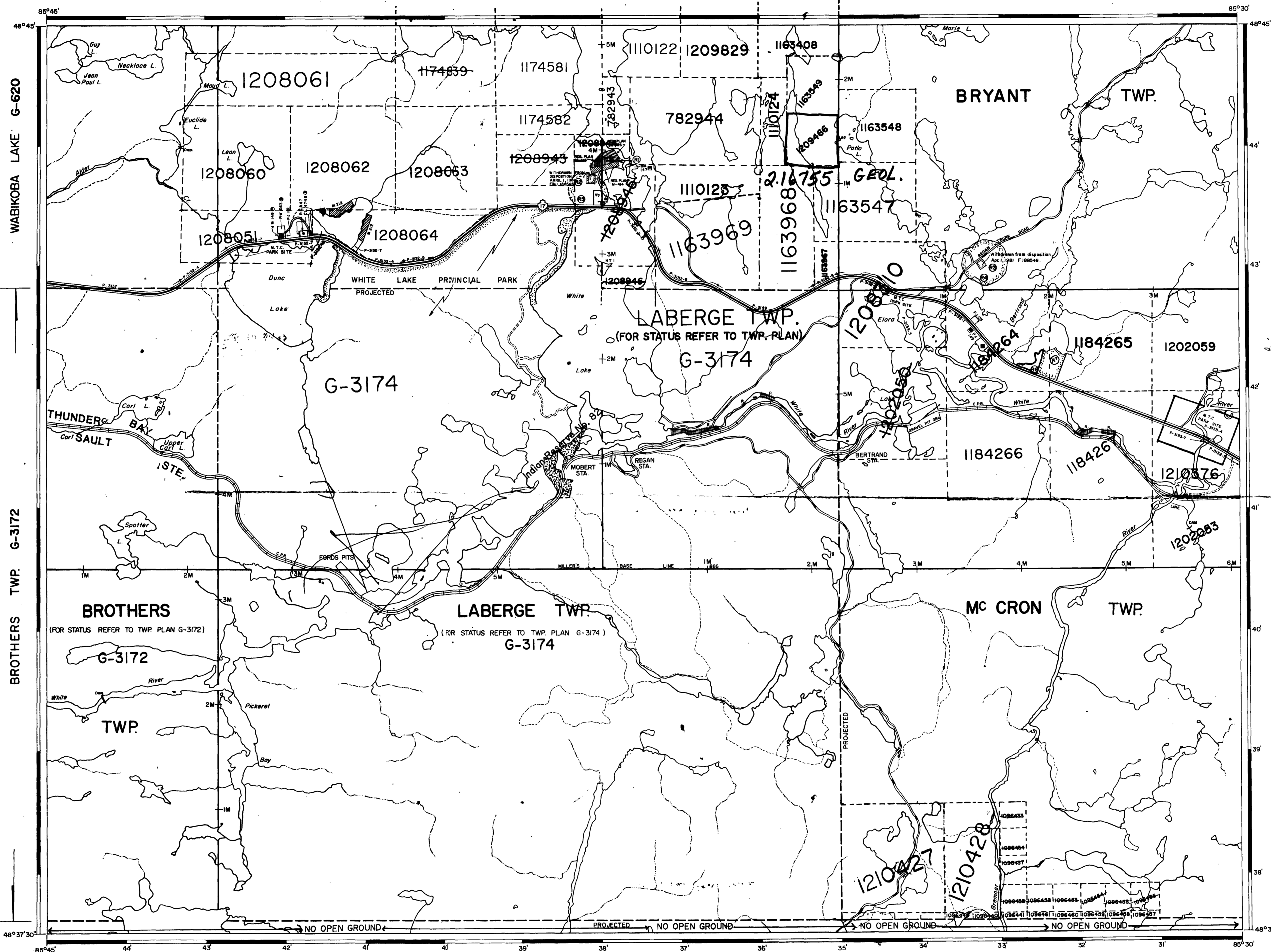

LEGEND

HIGHWAY AND ROUTE No.	
OTHER ROADS	
TRAILS	
SURVEYED LINES:	
TOWNSHIPS, BASE LINES, ETC.	
LOTS, MINING CLAIMS, PARCELS, ETC.	
UNSURVEYED LINES:	
LOT LINES	
PARCEL BOUNDARY	
MINING CLAIMS ETC.	
RAILWAY AND RIGHT OF WAY	
UTILITY LINES	
NON-PERENNIAL STREAM	
FLOODING OR FLOODING RIGHTS	
SUBDIVISION OR COMPOSITE PLAN	
RESERVATIONS	
ORIGINAL SHORELINE	
MARSH OR MUSKOG	
MINES	
TRAVERSE MONUMENT	

DISPOSITION OF CROWN LANDS

TYPE OF DOCUMENT	SYMBOL
PATENT, SURFACE & MINING RIGHTS	
" SURFACE RIGHTS ONLY	
" MINING RIGHTS ONLY	
LEASE, SURFACE & MINING RIGHTS	
" SURFACE RIGHTS ONLY	
" MINING RIGHTS ONLY	
LICENCE OF OCCUPATION	
ORDER-IN-COUNCIL	
RESERVATION	
CANCELLED	
SAND & GRAVEL	
LAND USE PERMITS FOR COMMERCIAL TOURISM, OUTPOST CAMPS	

SCALE: 1 INCH = 40 CHAINS

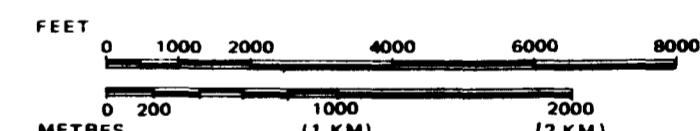

AREA WHITE LAKE

(SOUTH PART)

M.N.R. ADMINISTRATIVE DISTRICT

TERRACE BAY/WAWA

MINING DIVISION

THUNDER BAY/

SAULT STE. MARIE

LAND TITLES / REGISTRY DIVISION

THUNDER BAY



Date: AUGUST 1984 10 Number: G-623
In service Nov. 04/94.



NOTES

AREAS WITHDRAWN FROM DISPOSITION

M.R.O. - MINING RIGHTS ONLY
 S.R.O. - SURFACE RIGHTS ONLY
 M.S. - MINING AND SURFACE RIGHTS

Description	Order No.	Date	Disposition	File
(R) CROWN RESERVE	S.R.O.	163006v1		
(12) SEC. 36/80 W.3/81 1/4/81	S.R.O.	188546		
(13) SEC. 36/80 W.8/81 1/4/81	S.R.O.	188546		
(14) SEC. 36/80 W.7/82 5/1/82	S.R.O.	188546		
(15) SEC. 36/80 W.10/82 7/1/82	S.R.O.	163006v1		
(16) SEC. 36/80 W.12/81 11/07/81	M.S.			
(17) Pending application for Surface Rights P.A. #4301991				

MINING RIGHTS ON WHITE RIVER AND WHITE LAKE
 SUBJECT TO SEC. 41 OF THE MINING ACT
 (M.T.O.)

MINING CLAIMS AROUND WHITE RIVER AND CUSHNETT
 SUBJECT TO SEC. 41 OF THE MINING ACT
 (M.T.O.)

The information on this map has been compiled from various sources and its accuracy is not guaranteed. Those wishing to verify the accuracy of the information should consult with the Mining Division and the Land Management Branch for additional information on the status of the lands shown hereon.



210

WHITE LAKE AREA (NORTH PART) G-622

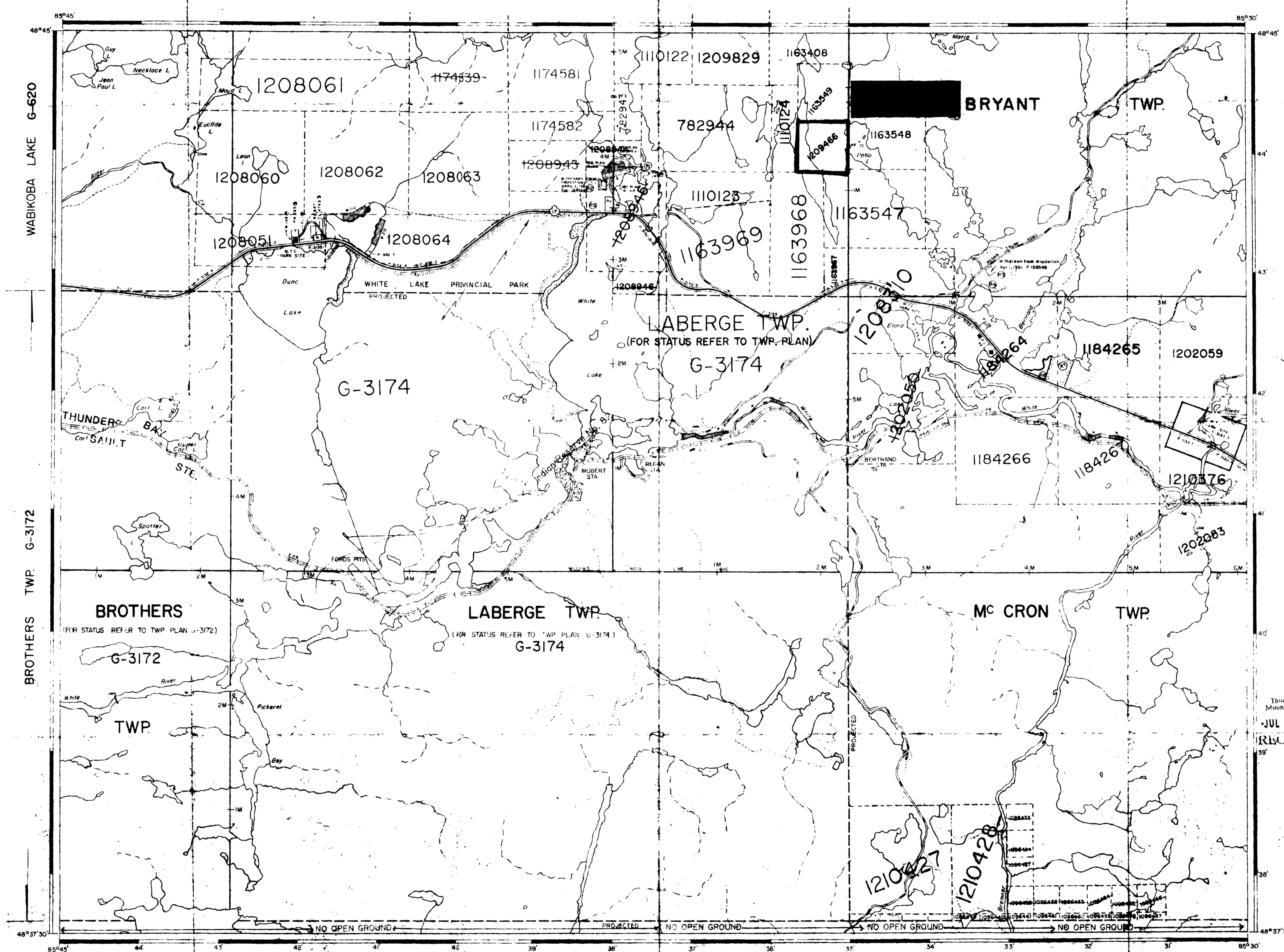

LEGEND

- HIGHWAY AND ROUTE NO.
- OTHER ROADS
- TRAILS
- SURVEYED LINES
- TOWNSHIPS, BASE LINES, ETC.
- LOTS, MINING CLAIMS, PARCELS, ETC.
- UNSURVEYED LINES
- LOT LINES
- PARCEL BOUNDARY
- MINING CLAIMS, ETC.
- RAILWAY AND RIGHT OF WAY
- UTILITY LINES
- NON-PERMANENT STREAM
- FLOODING OR FLOODING RIGHTS
- SUBDIVISION OR COMPENSATION PLAN
- RESERVATIONS
- ORIGINAL SHORELINE
- MARSH OR MUSKIEG
- MINES
- TRAVERSE MONUMENT

DISPOSITION OF CROWN LANDS

TYPE OF DOCUMENT	SYMBOL
PATENT SURFACE & MINING RIGHTS	
SURFACE RIGHTS ONLY	
MINING RIGHTS ONLY	
LEASE SURFACE & MINING RIGHTS	
SURFACE RIGHTS ONLY	
MINING RIGHTS ONLY	
LICENCE OF OCCUPATION	
ORDER IN COUNCIL	
RESERVATION	
CANCELLED	
SAND & GRAVEL	
AND USE PERMITS FOR COMMERCIAL TOURISM, OUTPOST CAMPS	

SCALE 1 INCH = 40 CHAINS

JUL - 8 1996
 RECEIVED

AREA WHITE LAKE (SOUTH PART)
 M.N.R. ADMINISTRATIVE DISTRICT TERRACE BAY/WAWA
 MINING DIVISION THUNDER BAY / SAULT STE. MARIE
 LAND TITLES / REGISTRY DIVISION THUNDER BAY

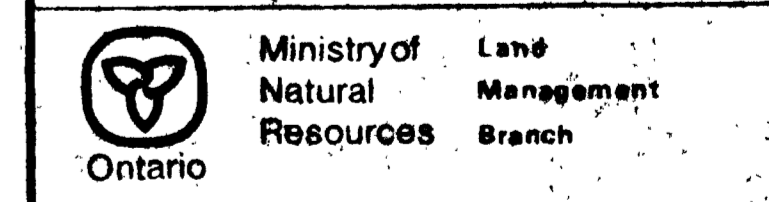

Date AUGUST 1994 10
 In service Nov. 04/94. **G-623**

OSKABUKUTA LAKE AREA G-3775



Finger Lake

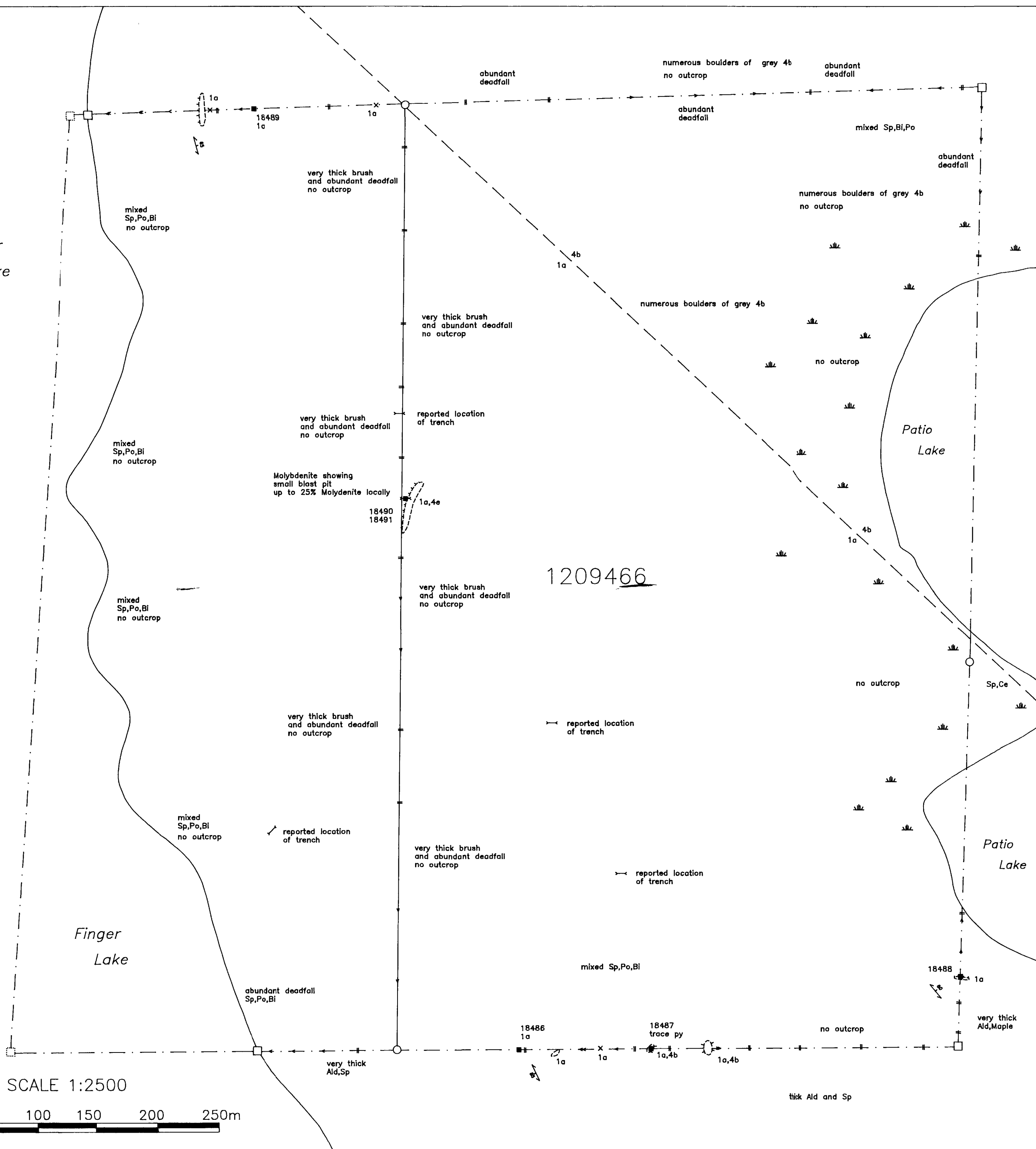

SCALE 1:2500



LEGEND

- PROTEROZOIC
- 5 MAFIC
- ARCHEAN
- 4 FELSIC
- 3 CLAS
- 1 MAFIC

SYMBOLS

- Claim
- Claim
- Line
- Claim
- Swamp
- Bour
- Tren
- Area
- Small
- Geol
- Sam
- Trail
- Follet
- Follet
- Ridge
- Trove
- Level
- Slight
- Mode
- Stron

ABBREVIATIONS

- py: pyrite
- po: pyrrhotite
- pp: chalcopyrite
- eph: sphalerite
- gnt: garnet
- qtz: quartz vein
- S: sulphide mineral
- fl: fluorite
- Sp: spruce
- Po: poplar
- Bi: birch
- Ce: cedar
- Ald: alder

WINSLOW

PATIO GEOLOGY

Geology: D.B. Mc
Digital cartography

CLARK-E

