

ASSESSMENT FILING
2003 DIAMOND DRILL HOLES WR03-01 to -03
ON THE WHITE RIVER PROPERTY
BOMBY, BROTHERS AND LABERGE TOWNSHIPS
ONTARIO

2.28160

NTS 42 C/12

07-22-04

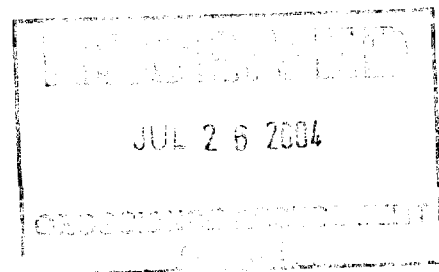

TECKCOMINCO EXPLORATION LTD.
DIAMOND DRILL LOG

Hole Number WR03-01

Page 1 of 1 Drill Log Summary

<i>Project Number</i>	241400	<i>Objective</i>	check IP anomaly	<i>Tests</i>		
<i>NTS</i>	42C12			<i>Depth (m)</i>	<i>Azimuth (d)</i>	<i>Dip (d)</i>
<i>Project Name</i>	White River	<i>Drilling Company</i>	Heath and Sherwood	0	177	-65
<i>Township/Area</i>	Brothers	<i>Start Date (m/d/y)</i>	17/03/03	33	194	-63
<i>Claim Number</i>	607746	<i>Finish Date (m/d/y)</i>	21/03/03	101	195	-62
<i>UTM Zone</i>	16	<i>Date Logged (m/d/y)</i>	21/03/03	152	197	-61
<i>UTM Easting (m)</i>	589032	<i>Geologist</i>	J. Lehtinen	203	197	-60
<i>UTM Northing (m)</i>	5392505	<i>Hole Length</i>	293	253	196	-58.5
<i>Grid Identifier</i>		<i>Core Location</i>	David Bell Mine Exploration Core Shack	293	196	-57
<i>Easting (+E,-W)</i>	2200	<i>Distance to Water</i>	0			
<i>Northing (+N,-S)</i>	152	<i>Core Size</i>	NQ			
<i>Elevation:</i>	0	<i>Casing Lost</i>	0			

Drill Log Summary:

J. Lehtinen for J. Lehtinen

TECKCOMINCO EXPLORATION LTD.

DIAMOND DRILL LOG

Project Number

241400

Hole Number

WR03-01

<i>From</i>	<i>To</i>	<i>Rock Type Rock Code</i>	<i>Geology</i>	<i>Sample No.</i>	<i>From</i>	<i>To</i>	<i>Length</i>	<i>Au (ppb)</i>	<i>Au (g/t)</i>
0	27.8	Overburden	CASING- BOULDERS AND SILT(TILL)						
27.8	106.1	Granodiorite 10a	Light grey white, med.-course grained. Plag. Xtals to 5mm. Chloritized hbl(?) + biotite = 15-20%. Milky white plag, commonly zoned. Qz commonly as matrix, 20%. Weak foliation from 45 to 50 degrees TCA. Weak epidote (saussuritization) throughout. Kspar alteration to pink, v weak from 55.5 to 88.8m, increase intensity from 88.8 to 98.8m, decreasing 98.8 to 104.5m. Minor qz +/- kspar or hematite veins between 29.2 and 87.0m. All less than 20 cm and 30 to 45 degrees TCA. Weakly magnetic throughout and calcareous in microfractures. Minor 30 cm dyke @ 58.5m.						
106.1	106.5	qv	Quartz vein @ contact. HW contact 35, FW 53. Wall rock fragment inclusions, trace py.	9001	106.1	106.5	0.40	-10	
106.5	112.1	Biotite wacke 6d	Med.-dk brown-green to light grey metasediments. Thinly bedded to laminated. Brown biotite rich bands alternating with light green sericite bands and siliceous grit. Bedding and foliation parallel @ 47 TCA. Chlorite along fol'n planes. Rare garnets, pale pink.						
112.1	116.3	Granodiorite 10a	Same as 27.8 to 106.1m interval.						

TECKCOMINCO EXPLORATION LTD.

DIAMOND DRILL LOG

Project Number

241400

Hole Number

WR03-01

<i>From</i>	<i>To</i>	<i>Rock Type</i> <i>Rock Code</i>	<i>Geology</i>	<i>Sample No.</i>	<i>From</i>	<i>To</i>	<i>Length</i>	<i>Au (ppb)</i>	<i>Au (g/t)</i>
116.3	179.9	Biotitic wacke	Meta sediments. Similar to sediments above with the addition of light to med green, chloritic, tuffaceous(?) sediments + quartz-sericite bands. Minor lath shaped crystals @117.5m = kyanite? Minor garnet rich bands @117.4 - 122.5 and 129.0 - 134.3m. Foliation increasing from 38 TCA @117.0m to 53 TCA @152.4m. Gradational change to lighter coloured, increasing sericite and muscovite content from 147.0 - 153.0m and 155.0 - 157.0m. Foliation average 57 TCA from 152.0 - 175.9m. 167.1 to 169.6 = Silicified seds + 3% Po and Py in bleached weakly bed/foliated seds with trace arsenopyrite. 171.2 - 171.7m qz stringers with trace Po, 53 TCA. Contorted seds at end of interval.	9003	167.1	169.6	2.50	-10	
6d									
179.9	199.1	Silicified sediments - mineralized zone	Light grey with minor darker zones of chlorite and quartz. Bed/fol'n weak to mod. With intervals of contorted bedding. Variable silica and sericite. 179.9-180.7 - trace Po,Py 180.7-184.9 - 3-5% Py, tr Po, tr As all as disseminations. Mod - strong silica. 184.9-186.3 - 5-7% SX. Po>Py, tr As + Cp. Mod. Weak silica. 186.3-186.6 - 3-5% SX. Po>Py, tr As, weak silica. 186.6-187.8 - tr Py + As, weak silica. 187.8-192.5 - 3% Po+Py, tr As, weak silica 192.5-194.9 - 5-7% Po +/- Py, +/-As. Variably silicified, dominantly weak. Strongly contorted bedding @ base of interval. 194.9-199.1 - Weak Si banding and stringers. Trace Po + Py. Bedding/fol'n avg. 53 TCA @ 183 to 189m.	9004	179.9	180.7	0.80	-10	
				9005	180.7	182	1.30	-10	
				9006	182	183.5	1.50	-10	
				9007	183.5	184.9	1.40	-10	
				9008	184.9	186.6	1.70	-10	
				9009	186.6	187.8	1.20	-10	
				9010	187.8	189.4	1.60	-10	
				9011	189.4	191	1.60	-10	
				9012	191	192.5	1.50	-10	
				9013	192.5	194	1.50	-10	
				9014	194	194.9	0.90	-10	
				9015	194.9	197	2.10	-10	
				9016	197	199.1	2.10	-10	
6d									

TECKCOMINCO EXPLORATION LTD.

DIAMOND DRILL LOG

Project Number

241400

Hole Number

WR03-01

		<i>Rock Type</i>	<i>Geology</i>			<i>Sample No.</i>	<i>From</i>	<i>To</i>	<i>Length</i>	<i>Au (ppb)</i>	<i>Au (g/t)</i>
<i>From</i>	<i>To</i>	<i>Rock Code</i>									
199.1	230.4	Biotitic wacke	Metasediments as per intervals 106.6 - 112.1m and 116.3 - 179.9m. 202.3-203.0m = foliated feldspar porphyry dyke. Large plagioclase phenos.- up to 7mm. Contact subparallel to fol'n. Metasediments garnetiferous throughout. Strongly chloritic/biotitic 199.1-210m. Foliation avg. 63 TCA.								
		6d									
230.4	288.7	Chloritic sediment	Metasediment. Dark green, medium grained wacke with variable chlorite and biotite content. Fol'n 66 TCA @ 240.4m. Minor Qz stringers with tr Py parallel to fol'n throughout interval. Bed/fol'n avg 60 TCA from 255-288m. Increasing wacke, decreasing chlorite at bottom of interval.								
		6d									
288.7	293	Biotitic wacke	Metasediments. Chloritic and biotitic rich beds producing weak bed/fol'n. Predominantly wacke with minor silty biotite rich beds. Minor sericite. < 5mm Qz stringers, rare talc veinlets near bottom of interval. (alteration of dolomite?). Bed/ fol'n 70 TCA @ 290.6m								
		6d									
288.7	293	Biotitic/chloritic wacke	Metasediments. Chloritic and biotitic rich beds, producing weak bed/fol'n. Predominantly wacke with minor silty biotite rich beds. Minor sericite. < 5mm Qz stringers, rare talc veinlets near bottom of interval. (alteration of dolomite?) Fol'n @ 70 TCA.								
		6d									

TECKCOMINCO EXPLORATION LTD.

Hole Number WR03-02

DIAMOND DRILL LOG

Page 1 of 2 Drill Log Summary

<i>Project Number</i>	241400	<i>Objective</i>	IP target	<i>Tests</i>		
<i>NTS</i>	42C12			<i>Depth (m)</i>	<i>Azimuth (d)</i>	<i>Dip (d)</i>
<i>Project Name</i>	WHITE RIVER	<i>Drilling Company</i>	Heath and Sherwood	0	180	-89
<i>Township/Area</i>	Brothers	<i>Start Date (m/d/y)</i>	21/03/03	35	90	-89
<i>Claim Number</i>	607746	<i>Finish Date (m/d/y)</i>	04/07/03	83	155	-89
<i>UTM Zone</i>	16	<i>Date Logged (m/d/y)</i>	04/07/03	131	165	-88
<i>UTM Easting (m)</i>	589032	<i>Geologist</i>	J. LEHTINEN	191	180	-88
<i>UTM Northing (m)</i>	5392505	<i>Hole Length</i>	698	250	187	-87
<i>Grid Identifier</i>		<i>Core Location</i>	David Bell Mine Exploration Core Shack	305	181	-86
<i>Easting (+E,-W)</i>	2200	<i>Distance to Water</i>	30	359	188	-84
<i>Northing (+N,-S)</i>	152	<i>Core Size</i>	NQ	425	191	-83
<i>Elevation:</i>		<i>Casing Lost</i>		488	190	-81
				548	190	-81
				611	192	-75
				698	197	-73

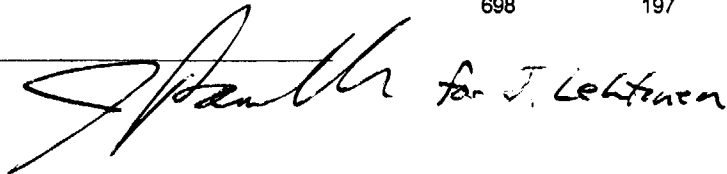
Drill Log Summary:

J. Lehtinen

TECKCOMINCO EXPLORATION LTD.
DIAMOND DRILL LOG

Project Number 241400
Hole Number WR03-02

<i>From</i>	<i>To</i>	<i>Rock Type</i> <i>Rock Code</i>	<i>Geology</i>	<i>Sample No.</i>	<i>From</i>	<i>To</i>	<i>Length</i>	<i>Au (ppb)</i>	<i>Au (g/t)</i>
0	25	Overburden, silt/boulders-Till OVB	Casing						
25	207.9	Granodiorite	Light to med. grey-white to med. grey. Med. - coarse grained. Chloritized mafics-20 - 30%. Plag as crystals to 5mm. Zoned. Quartz dominantly as matrix, 20%. Kspar weak pink-orange crystals approx 5%. Fine grained epidote. Moderately magnetic. 62.4 m = intermediate fine grained dyke., med. - dark green-grey. Weak fol'n. averaging 38 TCA between 34.0-110.2m. Increased mafic content downsection. Kspar altered zones-intense from 152.6-154.4m, moderate from 154.4- 158.3m, weak from 158.3-166.0m. Minor Qz and kspar veins all less than 10cm. @ 140m-40 TCA, 158.2m-40 TCA, 167.9m-20 TCA. Contact sharp at 207.9 @ 22 TCA.						
		10a							
207.9	208.8	Pegmatite vein	Pegmatite vein, 35 cm true width. Top and bottom contact 22 TCA. Large pink kspar crystals and muscovite books.						
		vein							
208.8	316.6	Metasediments - biotite wacke	Metasediments. Med to dark green-brown to pale green-grey. Biotite rich beds and lighter sericite rich beds. Variably garnetiferous(pale pink). Locally fibrous to lath shaped, pale green xtals= sillimanite? In upper section near garnet rich sections. Minor chloritic bands to 10cm. Foliations/beds avg.21 TCA between 211- 246m. Protoliths = pelitic to clastic sediments, +/- chloritic volcanoclastics. 245.6-247.4m = feldspar pophyry dyke @ 28 TCA. 252.0-315.0m=strong muscovite altered bands. Bed/fol'n from 251.4-308.5m = 29 TCA. 278.6-280.45m = silicified zone or qz rich arenite. 286.4-306.5m = quartz stringered zone with < 1cm qz stringers. Qz veins +/- muscovite @ 50 TCA. Qz stringers 305.0-306.5m with trace Po,Py with fine blue-grey sx (not moly).	9018	315	316.6	1.60	-10	
		6d							

TECKCOMINCO EXPLORATION LTD.

DIAMOND DRILL LOG

Project Number

241400

Hole Number

WR03-02

From	To	Rock Type Rock Code	Geology	Sample No.	From	To	Length	Au (ppb)	Au (g/t)
316.6	339	Mineralized zone - silicified sediments	Metasediments. Variably silicified/stringered. Colour varying from dark brown-grey to pastel green. Moderate to weakly foliated. Sx throughout as disseminated, bedding parallel to narrow intervals of clotty sx. Sx = Po,Py and As. Silica and sulphide appear to be directly related.	9019	316.6	318.1	1.50	-10	
			316.6-319.3 - W-m Si, tr-15 Po, Py, tr Cp	9020	318.1	319.3	1.20	-10	
			319.3-321.3 - M Si, 1-3% Py, Po, tr Cp	9021	319.3	320.3	1.00	20	
			321.3-321.4 - Intense Si, 15-20% Po, tr Py	9022	320.3	321.3	1.00	-10	
			321.4-322.6 - St Si, 5-7% Po, tr Py	9023	321.3	322.6	1.30	-10	
			322.6-326.0 - variable mod.-wk Si, variable 1-2% Po,Py, tr Cp,As. Mottled colour due to Si + tremolite.	9024	322.6	324.1	1.50	-10	
			326.0-327.5 - mod.-strong Si + Se. 3-5% Sx. Pale green, Qz + minor Sx stringers.	9025	324.1	325.1	1.00	-10	
			327.5-329.7 - w Si. 3-5% Po.	9026	325.1	326	0.90	-10	
			329.7-330.3 - chloritic band. Tr sx.	9027	326	327.5	1.50	-10	
			330.3-332.0 - Mod.Si. 3-5% Po,+/-Py. Tr Cp,As.	9028	327.5	328.5	1.00	-10	
			332.0-334.1 - Mod.-st Si. 5-7% Sx, Po. Tr As.	9029	328.5	329.7	1.20	-10	
			334.1-337.0 - Mod Si. 3-5% Sx. Po,Py, tr As	9030	329.7	330.3	0.60	-10	
			337.0-339.0 - W Si. 1-3% Sx. Po,Py. Minor garnets.	9031	330.3	332	1.70	-10	
			339.0-339.8 - Tr Sx. Py, garnets.	9032	332	333	1.00	-10	
				9033	333	334.1	1.10	-10	
				9034	334.1	335.6	1.50	-10	
				9035	335.6	337	1.40	10	
				9036	337	338	1.00	50	
				9037	338	339	1.00	24	

6d

TECKCOMINCO EXPLORATION LTD.

DIAMOND DRILL LOG

Project Number

241400

Hole Number

WR03-02

<i>From</i>	<i>To</i>	<i>Rock Type</i> <i>Rock Code</i>	<i>Geology</i>	<i>Sample No.</i>	<i>From</i>	<i>To</i>	<i>Length</i>	<i>Au (ppb)</i>	<i>Au (g/t)</i>
339	377.6	Biotitic wacke 6d	Metasediments. Dark brown-grey in upper interval from 339.0-350.9m. Well bedded/foliated 356.0-373.3m. Wacke mod. bedded, 373.3-377.6m. Strong biotite-garnet rich in upper interval. Bed/fol'n weak to mod. @ 31 TCA @ 340.0-345.0m. Qz feldspar and pegmatite veins at approx. 17 TCA @ 350.9-356.0m. Minor silicified zones between 356.0 to 369.4m.	9038	339	339.8	0.80	60	
377.6	400.1	Chloritic sediment 6g	Chloritic fine grained volcanoclastics with minor lapilli tuff zones interbedded with brown biotite rich bands(seds). Zones of mottled light green/dark green due to calcite and sericite alteration. Bedding strongly folded over short intervals. Minor calcite veining and alteration between 390.8 to 398.0m. Bed/fol'n. avg 47 TCA.						
400.1	445.1	Biotite wacke 6d	Metasediments. 400.1-403.2 biotite wacke. 403.2-434.0 well bedded, thin 1-3cm beds of light and dark beds. Grading from qz-biotite to sericite rich from 411.0-416.0m. Increasing garnet rich zones primarily with Bi. Bed/fol'n. @58 TCA. Increased Bi-garnet rich beds 437-445m, minor qz strgrs with increasing sx. 442.6-445.0. As parallel to stringers in wall rock. Strgrs with Po, Py. Minor chloritic zones.	9039 9040	442.6 444.4	444.4 445.1	1.80 0.70	-10 -10	

TECKCOMINCO EXPLORATION LTD.

DIAMOND DRILL LOG

Project Number

241400

Hole Number

WR03-02

<i>From</i>	<i>To</i>	<i>Rock Type</i> <i>Rock Code</i>	<i>Geology</i>	<i>Sample No.</i>	<i>From</i>	<i>To</i>	<i>Length</i>	<i>Au (ppb)</i>	<i>Au (g/t)</i>
445.1	457.4	Silica-muscovite-pyrite Mineralized zone	Felsic. Qz-muscovite(to sericite) altered. Whole interval variable from med to light grey. Darker and patchy zones + weakly bedded and banded zones. Coarse muscovite to fine sericite. Sx along discrete bands and disseminated, generally fine to coarse grained from 1 to 40%. 445.1-446.2 Med grey, strong Si alt'd. 1% combined Po,Py, Tr As. 446.2-447.8 Mod-st Si, st Se, 3% Py+Po, med. Grey. 447.8-452.0 V st muscovite, mod-st Si, Py +minor Po up to 40% following banding @58 TCA. Tr As. 452.0-457.4 St Se, mod. Si. Bedding/fol'n increasing downsection. 452.0-456.0 Py 10%. 456.0-457.4 Py3-5%. Py commonly concentrated in discrete beds with Py up to 30% over 5-15 cm widths.	9041	445.1	446.2	1.10	-10	
				9042	446.2	447.8	1.60	420	
				9043	447.8	449.3	1.50	-10	
				9044	449.3	450.8	1.50	-10	
				9045	450.8	452	1.20	-10	
				9046	452	453.5	1.50	-10	
				9047	453.5	455	1.50	-10	
				9048	455	456.5	1.50	-10	
				9049	456.5	457.4	0.90	-10	
		6h							
457.4	465.9	Silicified sediments	Pale green-grey, poor to well bedded. Quartz veined and stringered. 1-3% Py+/-Po. 459.5-459.85 Qz-Fs vein with 3% Py-Po + tr Cp, As. Py,Po in discrete beds.	9050	457.4	458.9	1.50	-10	
				9051	458.9	460.4	1.50	-10	
				9052	460.4	461.9	1.50	-10	
				9053	461.9	463.4	1.50	-10	
				9054	463.4	464.9	1.50	-10	
				9055	464.9	465.9	1.00	-10	
		6d							
465.9	469.6	Biotite/sericite sediments	Thinly bedded biotite and sericite rich sediments. Minor qz +/- Po & Py stringers						
		6d							

TECKCOMINCO EXPLORATION LTD.

DIAMOND DRILL LOG

Project Number

241400

Hole Number

WR03-02

<i>From</i>	<i>To</i>	<i>Rock Type Rock Code</i>	<i>Geology</i>	<i>Sample No.</i>	<i>From</i>	<i>To</i>	<i>Length</i>	<i>Au (ppb)</i>	<i>Au (g/t)</i>
469.6	474	Silica altered sediments 6d	Silica alteration marginal to QV @ 471.1-471.65m. Minor Py, Po. Bleached white zones with green radiating to fibrous crystals=actinolite?	9056	471.1	471.65	0.55	-10	
474	478.4	Biotite wacke 6d	Metasediments. Mod to well bedded. Alternating biotite and sericite rich beds. Bed @ 51 TCA.						
478.4	480.9	Chloritic volcaniclastics 6g	Coarse grained, med. To dark green, light and dark fragments, all less than 2mm. Bed/fol'n 50 TCA.						
480.9	487.6	Meta sediments 6d	Light o dark grey, variable Se and Si altered. Weak chlorite alteration. Wacke intervals. Minor feldspar xtal tuff? Bed/fol'n 59 TCA.						
487.6	496.5	Biotite wacke 6d	Metasediments. Med-dark grey, fine to coarse grained, dominantly wacke. Weakbed/fol'n. Minor Se altered intervals commonly wi diss Py. Lighter coloured downsection, and increase Bi. Bed avg 75 TCA. Minor interbed folding.						
496.5	523.2	Metasediments 6d	Variably coloured- light grey to med. Brown-green-grey. Minor dark brown-grey. Bed/fol'n variable, thin..avg 64 TCA. Sericite alt imparts light green colour. Minor garnet rich zones in vfg dark brown-grey bands. Green, patchy, non-bedded zones = fragmental? or slump?						

TECKCOMINCO EXPLORATION LTD.

DIAMOND DRILL LOG

Project Number

241400

Hole Number

WR03-02

<i>From</i>	<i>To</i>	<i>Rock Type</i> <i>Rock Code</i>	<i>Geology</i>	<i>Sample No.</i>	<i>From</i>	<i>To</i>	<i>Length</i>	<i>Au (ppb)</i>	<i>Au (g/t)</i>
523.2	553	Biotite-quartz-sericite metasediment 6d	Med-dark green-grey. Generally non-bedded. Minor weakly foliated zones. Patchy green sericite as irregular lenticular to irregular shapes = fragments? Minor well bedded chloritic bands up to 10cm. Minor garnet rich biotitic bands. 541.9-543.15m pegmatitic qz, fs muscovite vein. Weak fol'n avg = 57 TCA.						
553	578.9	Biotite-Sericite quartz-sillimanite 6h	Similar to interval above with the addition of sillimanite, increasing downsection. Strong sillimanite from 560.0-578.9m with increased garnet. Minor zones of wacke. Mod-poor fol'n avg. 57 TCA. Tr Moly @ 555.5m on fracture. Sillimanite= fibrous white to clear fibrous to prismatic aggregates.						
578.9	629.2	Biotite-sericite-quartz-sillimanite-garnet 6i	Dark brown-grey, mod. Bed/fol'n avg 56 TCA. Garnet confined to discrete bands, increasing downsection. Minor qz stringers. Al silicates = kyanite + sillimanite.						
629.2	630.2	Garnet-sericite-biotite metasediment 6i	60% garnet as dull pink porphyroblasts in sericite and biotite.	9057	629.2	630.2	1.00	-10	
630.2	632.3	"Banded iron formation" 5b	Silica/magnetite/garnet/chlorite/sericite metased. Dark green-grey with pink-grey porphyroblasts of garnet. Magnetite-silica banding throughout, < 1cm width, with chlorite banding. Minor Po at top contact. Bed 70 TCA	9058 9059	630.2 631.2	631.2 632.2	1.00 1.00	-10 -10	

TECKCOMINCO EXPLORATION LTD.

DIAMOND DRILL LOG

Project Number 241400

Hole Number WR03-02

<i>From</i>	<i>To</i>	<i>Rock Type</i> <i>Rock Code</i>	<i>Geology</i>	<i>Sample</i> <i>No.</i>	<i>From</i>	<i>To</i>	<i>Length</i>	<i>Au (ppb)</i>	<i>Au (g/t)</i>
632.3	647.7	Biotite-garnet-quartz-sericite metasediment 6i	Dark brown with pink garnet porphyroblasts up to 5mm. Biotite rich, strongly foliated with greatly increased garnet content. Sericite as bands with grainy quartz. Bed/fo'l'n avg 57 TCA. Minor qz stingers x-cutting fol'n.						
647.7	698	Biotite-quartz-sericite metasediment 6h	Dark brown-grey, fine grained with lighter qz-Se and aluminosilicate porphyroblast-rich sections. Minor garnet. Strong bed/fo'l'n avg 66 TCA. 655.4-657.3 = pegmatitic Feldspar-muscovite garnet vein. Thinner beds with finer grain size. Pegmatite veins from 666.6-692.9m. Bed/fo'l'n 64 TCA at bottom of hole. 698.0 - EOH						

TECKCOMINCO EXPLORATION LTD.

Hole Number WR03-03

DIAMOND DRILL LOG

Page 1 of 1 Drill Log Summary

Project Number	241400	Objective	IP anomaly	Tests		
NTS	42C12			Depth (m)	Azimuth (d)	Dip (d)
Project Name	White River	Drilling Company	Heath and Sherwood	0	180	-50
Township/Area	Brothers	Start Date (m/d/y)	04/11/03	20	191	-46
Claim Number	607972	Finish Date (m/d/y)	14/04/03	71	182	-39
UTM Zone	16	Date Logged (m/d/y)	14/04/03	122	195	-35
UTM Easting (m)	590035	Geologist	J. LEHTINEN	170	195	-33
UTM Northing (m)	5392025	Hole Length	257	200	192	-33
Grid Identifier		Core Location	NQ	245	198	-32
Easting (+E,-W)	3200	Distance to Water	150			
Northing (+N,-S)	-300	Core Size	NQ			
Elevation:		Casing Lost	6.0M			

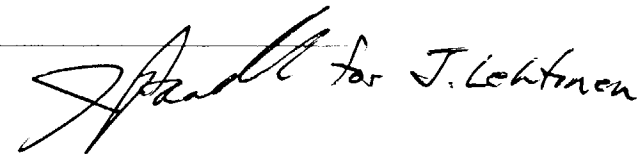
Drill Log Summary:A handwritten signature in black ink, appearing to read "J. Lehtinen", is written over the signature line. The signature is stylized and cursive.

TECKCOMINCO EXPLORATION LTD.

DIAMOND DRILL LOG

Project Number

241400

Hole Number

WR03-03

<i>From</i>	<i>To</i>	<i>Rock Type</i> <i>Rock Code</i>	<i>Geology</i>	<i>Sample</i> <i>No.</i>	<i>From</i>	<i>To</i>	<i>Length</i>	<i>Au (ppb)</i>	<i>Au (g/t)</i>
0	6	Till OVB	Casing						
6	17.9	Biotite-quartz-sericite-sillimanite 6i	Med-dark brown-green-grey. Weak to mod. Fol'n @ 75 TCA. Minor irregular Qz stringers. Minor garnet. Variable sillimanite and Se. Sillimanite = long fibrous xtals commonly aligned with banding.						
17.9	19	Biotite-quartz-sericite-sillimanite 6i	Similar to above with increased garnet content, up to 35%. Basal contact with Qz stringers + chlorite.						
19	25.5	"Banded garnetiferous iron 5b	Biotite, garnet, sillimanite, silica, magnetite, chlorite. Garnet porphyroblasts up to and commonly 2mm. Mod. To strong sillimanite. Banded Si and magnetite + minor chlorite bands. Beds @ 75 TCA.						
25.5	32	Biotite-garnet-chlorite-silica metasediment 6i	Strongly garnetiferous(similar to above). Tr Py. Bed @ 73 TCA. Minor fault slips, chloritic 58 TCA.						
32	35	"Iron formation" 5b	Banded garnet-silica-magnetite-biotite. Pink garnet porphyroblasts up to 2mm. Bed @ 64 TCA. Variably magnetite rich.						

TECKCOMINCO EXPLORATION LTD.

DIAMOND DRILL LOG

Project Number

241400

Hole Number

WR03-03

<i>From</i>	<i>To</i>	<i>Rock Type</i> <i>Rock Code</i>	<i>Geology</i>	<i>Sample No.</i>	<i>From</i>	<i>To</i>	<i>Length</i>	<i>Au (ppb)</i>	<i>Au (g/t)</i>
35	61.1	Biotite-sericite-quartz wacke 6d	Minor zones of garnet, minor sillimanite. Thinly bedded @ 76 TCA. Minor chloritic/garnet zones.						
61.1	63.8	"Iron Formation" 5b	Black with minor med.-dark grey bedding. Strongly garnetiferous at top and at contacts. Bedding thin and contorted @ 68 TCA. Tr Py.						
63.8	176.2	Biotite-quartz-wacke 6d	Med. Brown-grey. Med.-coarse grained. Variably bedded. .poor-63.8-83.0m. Well bedded-83.0-120.0m. Minor zone of tr sx. 87.5m = tr As,Py. Bed/fol'n avg. = 69 TCA. Minor sillimanite, garnet. Minor mm scale Qz stringers +/- calcite+/- Py,Po. Weak Chlorite near bottom of interval.						
176.2	184.7	Chlorite altered wacke 6d	Mod.-strongly chlorite altered metasediment. Med. To dark green. Strongly quartz stringered. Dark green actinolite + chlorite. Weakly pyritic in wallrock and marginal to quartz stringers. Minor Po. Strongest Sx samples 9063-9065.	9060 9061 9062 9063 9064 9065	176.2 177.7 179.2 180.7 182.2 183.7 184.7	177.7 179.2 180.7 182.2 183.7 184.7	1.50 1.50 1.50 1.50 1.50 1.00	-10 -10 -10 -10 -10 -10	
184.7	197.2	Biotite wacke 6d	Brown-grey. Quartz-biotite wacke. Weak to mod. Bedded @70 TCA. Becoming chlorite-actinolite rich from 193.5-197.2m Minor garnet. Strong chlorite and fol'n over 196.0-197.2m @90 TCA.						

TECKCOMINCO EXPLORATION LTD.
DIAMOND DRILL LOG

Project Number 241400
Hole Number WR03-03

<i>From</i>	<i>To</i>	<i>Rock Type</i> <i>Rock Code</i>	<i>Geology</i>	<i>Sample</i> <i>No.</i>	<i>From</i>	<i>To</i>	<i>Length</i>	<i>Au (ppb)</i>	<i>Au (g/t)</i>
197.2	198.8	Iron formation 5b	Dark green-black. Variably magnetic at base of interval. Numerous garnet porphyroblasts at base of interval.						
198.8	221.8	Quartz biotite wacke 6d	Variably brown to green owing to patchy chlorite alteration. Erratic foliation with small scale folds. Minor fold nose with quartz and qz stringers. Weak Py as disseminations near stringers. Weak bed @72 TCA. Increased garnet from 215.8-221.8m.						
221.8	257	Biotite sillimanite quartz wacke 6i	Metasediment. Med. grey and light grey mottled. Poorly foliated. Garnet rich from 221.8-225.8m. Strong fibrous clear sillimanite from 225.8-257.0m. Weak qz stringers with minor Po +Py. Weak fol'n avg 68 TCA. Tr Py, Po. 230.4-230.9m = healed fault breccia.						

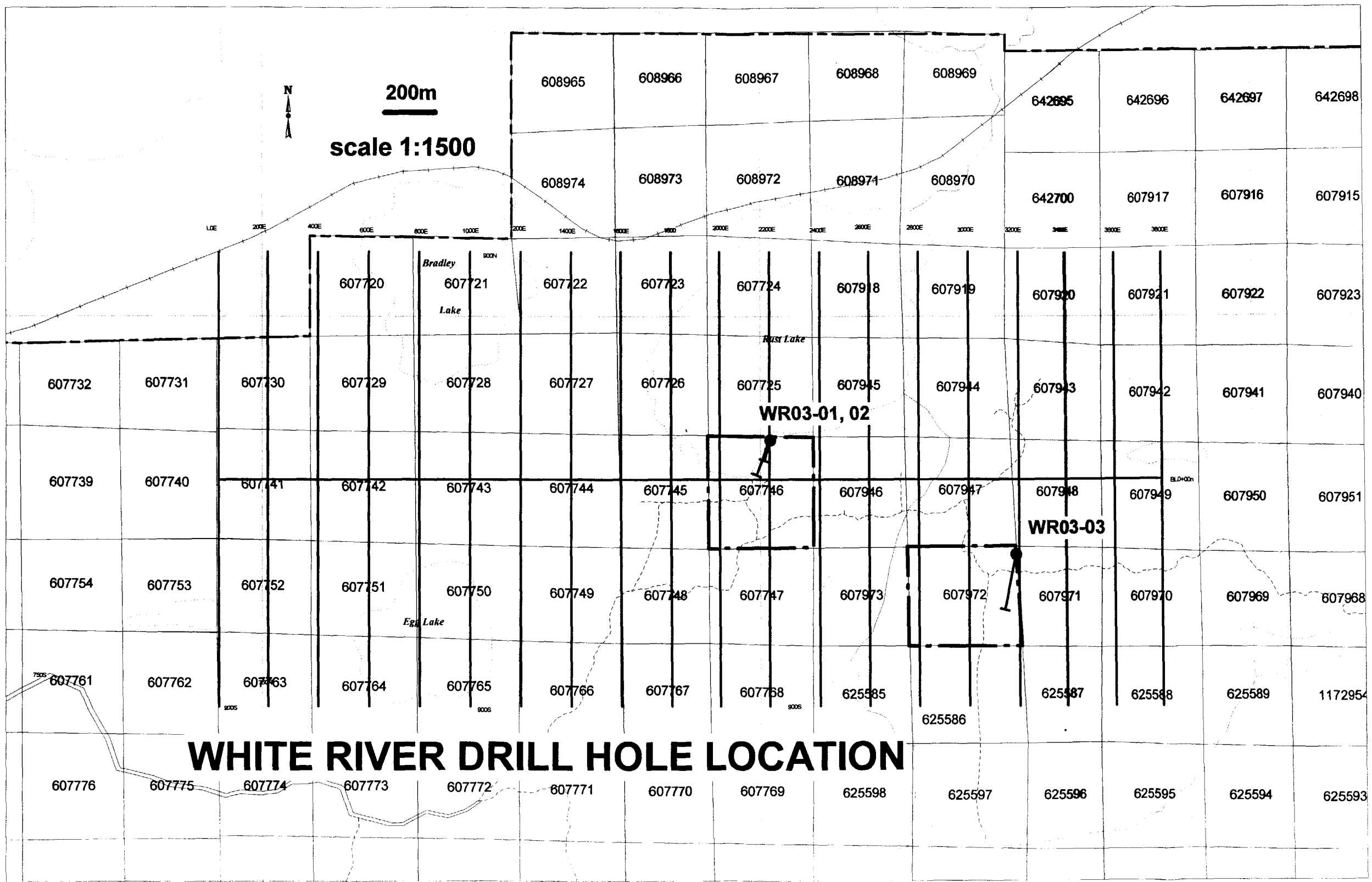

WHITE RIVER DRILL HOLE LOCATION

				608965	608966	608967	608968	608969		642695	642696	642697	642698	
				608974	608973	608972	608971	608970		642700	607917	607916	607915	
				607720	607721	607722	607723	607724	607918	607919	607920	607921	607922	607923
607732	607731	607730	607729	607728	607727	607726	607725	607945	607944	607943	607942	607941	607940	
607739	607740	607741	607742	607743	607744	607745	607746	607946	607947	607948	607949	607950	607951	
607754	607753	607752	607751	607750	607749	607748	607747	607973	607972	607971	607970	607969	607968	
607761	607762	607763	607764	607765	607766	607767	607768	625585	625586	625587	625588	625589	1172954	
607776	607775	607774	607773	607772	607771	607770	607769	625598	625597	625596	625595	625594	625593	

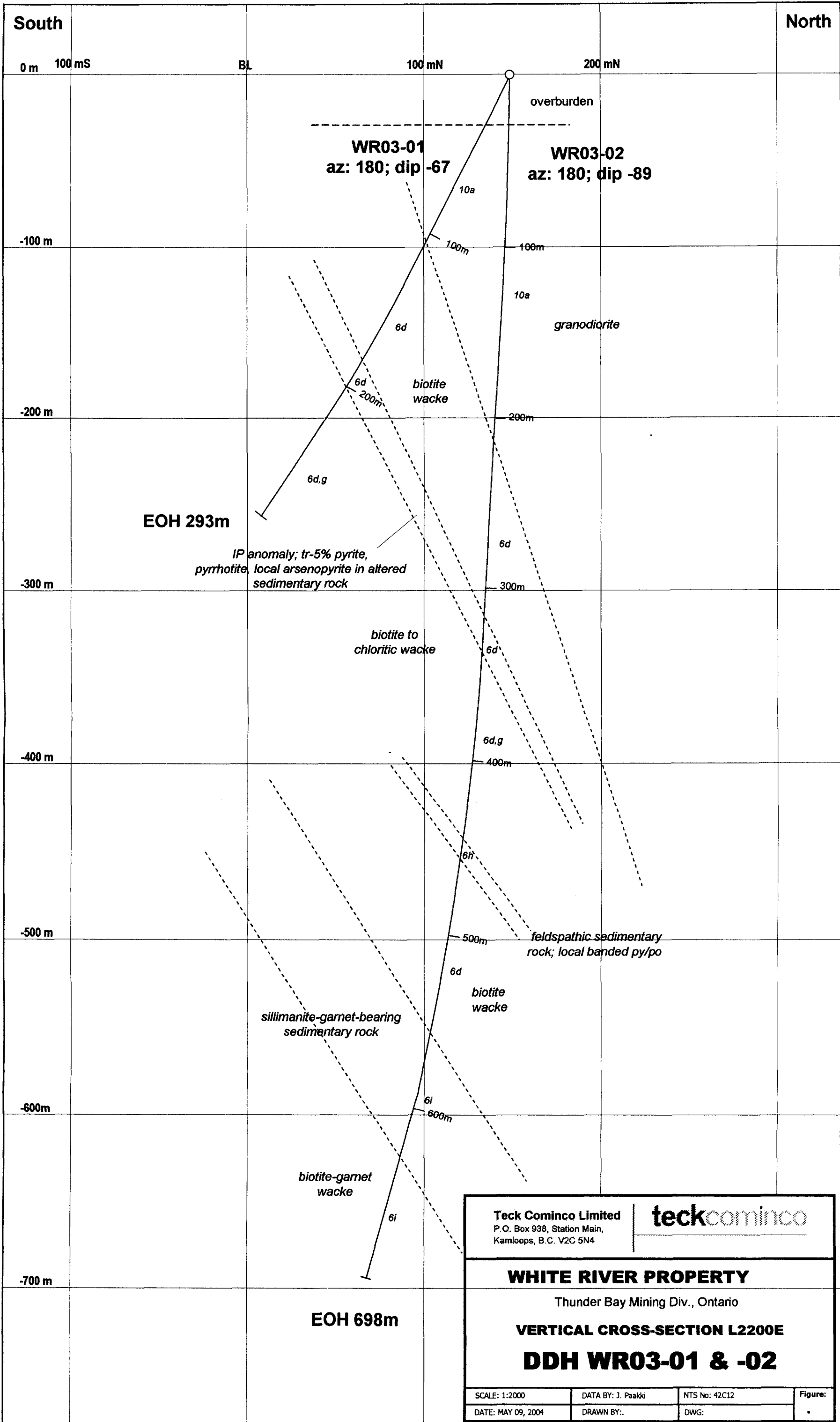

EOH 293m

IP anomaly; tr-5% pyrite, pyrrhotite, local arsenopyrite in altered sedimentary rock

EOH 698m

Teck Cominco Limited P.O. Box 938, Station Main, Kamloops, B.C. V2C 5N4			
WHITE RIVER PROPERTY Thunder Bay Mining Div., Ontario VERTICAL CROSS-SECTION L2200E DDH WR03-01 & -02			
SCALE: 1:2000	DATA BY: J. Paakki	NTS No: 42C12	Figure:
DATE: MAY 09, 2004	DRAWN BY: .	DWG:	.

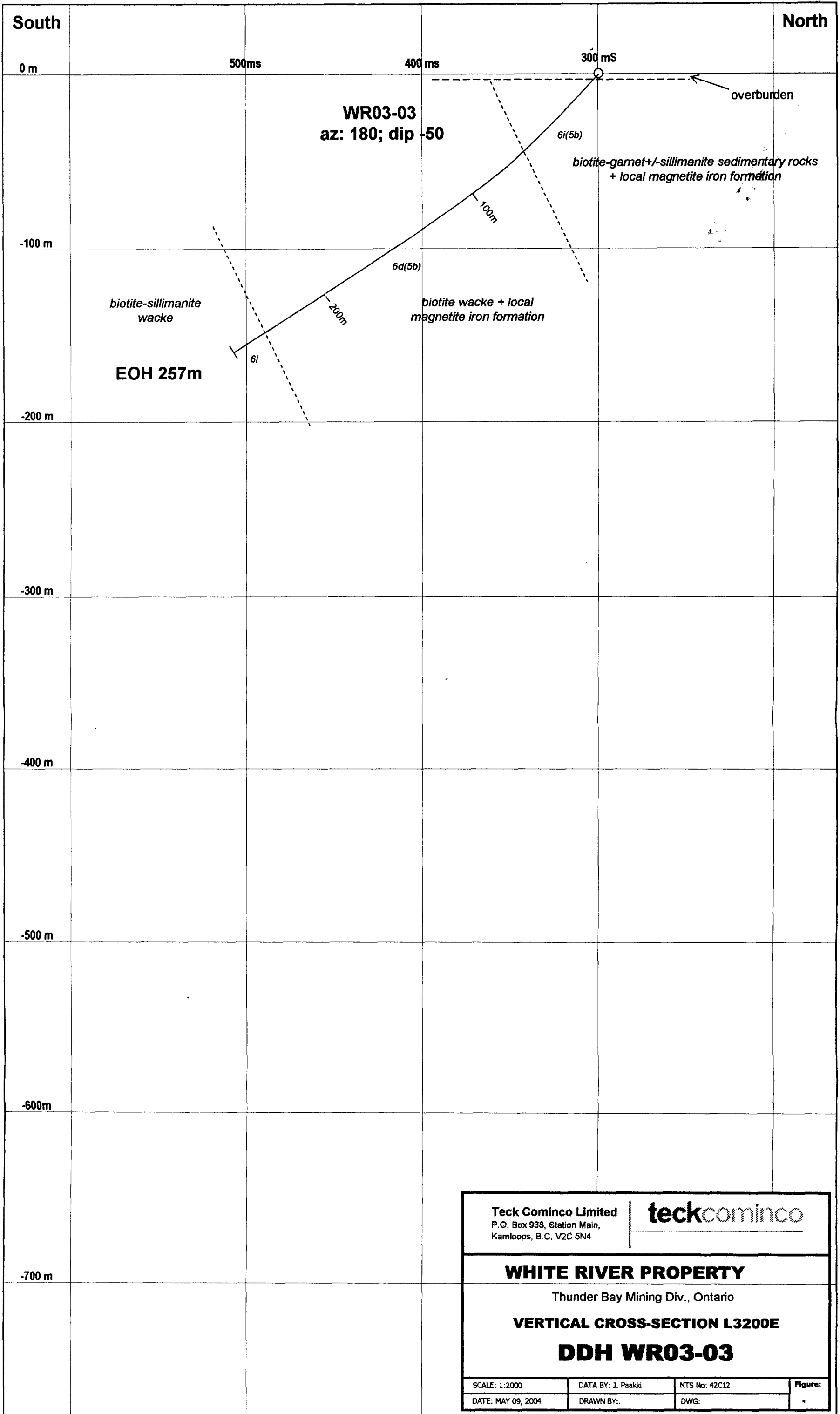

Teck Cominco Limited P.O. Box 938, Station Main, Kamloops, B.C. V2C 5N4			
WHITE RIVER PROPERTY Thunder Bay Mining Div., Ontario VERTICAL CROSS-SECTION L3200E DDH WR03-03			
SCALE: 1:2000	DATA BY: J. Paakki	NTS No: 42C12	Figure: •
DATE: MAY 09, 2004	DRAWN BY: .	DWG:	

Work Report Summary

Transaction No:	W0440.01175	Status: APPROVED
Recording Date:	2004-JUL-23	Work Done from: 2003-MAR-17
Approval Date:	2004-JUL-30	to: 2003-APR-14

Client(s):
 301000 LAC EXPLORATION INC.

Survey Type(s):
 ASSAY PDRILL

Work Report Details:

Claim#	Perform	Perform Approve	Applied	Applied Approve	Assign	Assign Approve	Reserve	Reserve Approve	Due Date
TB 607746	\$77,689	\$77,689	\$0	\$0	\$0	0	\$77,689	\$77,689	2005-JUN-12
TB 607972	\$20,652	\$20,652	\$0	\$0	\$0	0	\$20,652	\$20,652	2005-JUN-12
	\$98,341	\$98,341	\$0	\$0	\$0	\$0	\$98,341	\$98,341	

External Credits: \$0

Reserve:

	\$98,341	Reserve of Work Report#: W0440.01175
	\$98,341	Total Remaining

Status of claim is based on information currently on record.



42C12NW2010 2.28160 BROTHERS

900

Date: 2004-JUL-30

GEOSCIENCE ASSESSMENT OFFICE
933 RAMSEY LAKE ROAD, 6th FLOOR
SUDBURY, ONTARIO
P3E 6B5

LAC EXPLORATION INC.
BCE PLACE, TD CANADA TRUST TOWER
SUITE 3700, 161 BAY STREET, PO BOX 212
TORONTO, ONTARIO
M5J 2S1 CANADA

Tel: (888) 415-9845
Fax: (877) 670-1555

Submission Number: 2.28160
Transaction Number(s): W0440.01175

Dear Sir or Madam

Subject: Approval of Assessment Work

We have approved your Assessment Work Submission with the above noted Transaction Number(s). The attached Work Report Summary indicates the results of the approval.

At the discretion of the Ministry, the assessment work performed on the mining lands noted in this work report may be subject to inspection and/or investigation at any time.

If you have any question regarding this correspondence, please contact BRUCE GATES by email at bruce.gates@ndm.gov.on.ca or by phone at (705) 670-5856.

Yours Sincerely,



Ron.C. Gashinski
Senior Manager, Mining Lands Section

Cc: Resident Geologist

Jari J. Paakki
(Agent)

Lac Exploration Inc.
(Assessment Office)

Assessment File Library

Lac Exploration Inc.
(Claim Holder)

