

pierre c. labrèque

ingénieur géologue - geological engineer

245, rue des Chrysanthèmes, La Prairie, P. Québec, Canada J5R 4G4 Tél. (514) 659-1889



42C13SE0063 2.8794 WABIKOBA LAKE

010

KILEMBE RESOURCES INC.

HEMLO PROJECT

CASSEX OPTION

**RECEIVED**

JAN 13 1986

**MINING LANDS SECTION**

DECEMBER 2, 1985

*Send this file.*



42C13SE0063 2.8794 WABIKOBA LAKE

010C

## CONTENTS

Introduction.....1

Property.....1

Location, Access and Infrastructure.....2

Geology.....2

Geochemistry.....3

Geophysics.....4

Conclusions and recommendations.....6

Exploration programme.....7

Certificate.....8

Maps:

- VLF-EM survey
- Geochemistry
- Magnetometer survey

KILEMBE RESOURCES INC.

HEMLO PROJECT

Cassex Option

---

Introduction

In August, September and November 1985, exploration work was done on the property in order to: 1) verify the previous surveys, 2) extend further west the geophysical survey (VLF-EM), and 3) find suitable targets for stripping, trenching and drilling.

Property

The claims covered are the following:

606733	658750
675066	701957
675063	701957
675059	701955
675065	701948
675068	709541
686212	701945
674043	
674042	
686218	
686219	
674037	
675067	

### Location, Access and Infrastructure

The property is situated north of Lake Superior some 1100 km northwest of Toronto, 1200 km west of Ottawa and about 30 km southeast of Manitowadge. The Theresa Lake property is about 15 km from the main gold deposits of Hemlo and about 10 km north of the Trans-Canada Highway.

Theresa Lake covers the eastern and southeastern parts of the property. Dotted Lake touches the northwestern corner of the claim block.

The property can be reached from the Trans-Canada highway by highway 614, and then, by taking gravel roads leading to Theresa Lake and Dead Otter Lake.

### Geology

#### a) Regional

The property is located in the Archean Abitibi-Wawa-Shebandowan subprovince of the Superior Province of the Canadian Precambrian Shield. That subprovince forms the southernmost lithological group that hosts the gold deposits of Timmins, Val d'Or and Kirkland Lake and has several volcanic belts.

The Heron Bay meta-volcanic belt is one out of several greenstone belts that occurs in the Shield and that comprises the gold occurrences and mines of Hemlo district. The Heron belt is thought to be a syncline whose dimensions are 8 to 20 km in a N-S direction and striking east-west for 40 km. This belt is chiefly made up of steeply dipping volcanic-sedimentary series. That synclinal structure is flanked on all sides by granitoid plutons with some gneisses.

The Heron Bay metavolcanic belt has been metamorphosed and most rocks have reached the upper amphibolite facies.

In the Hemlo area, the gold ore zone is hosted within mafic and felsic volcanic sequences that are overlain by felsic volcanoclastites and calcareous sediments.

Within the Hemlo synclinal structure, two phases of felsic plutonism are known. The first and the earliest is represented by concordant porphyry sills intruding the felsic volcanic rocks. The second phase is constituted by late tectonic granitic stock intruding the core of the syncline.

#### b) Local

The property is situated on the northern limb of the syncline and is mostly underlain by metavolcanics and meta-sedimentaries which are metamorphosed to the upper amphibolite facies. The northern half of the property is underlain by the Dotted Lake granodiorite complex. Ultramafics (peridotite) are also present and form a lens-like body 2000' by 700' and is located near the western shore of Theresa Lake and appears to be responsible for the magnetic anomaly shown on the airborne magnetic survey.

#### Geochemistry

During August and September '85, 95 soil samples have been taken and assayed for gold. Most of them have been taken in the A horizon and mainly consisted of semi-organic material.

The analyses showed no real gold anomaly in the area where we carried out the sampling. Because of the small number of samples taken, this geochemical survey that covers only a small part of the property is considered inconclusive.

## Geophysics

During August, September and November '85, several verifications have been done on the already reported VLF anomalies. New VLF readings have been taken on the main VLF conductors and confirmed their existence.

Conductor F-F' is the most conspicuous conductor occurring in the South Central part of the property. At one place, between lines 52W and 48W south of the base line, the conductor is disrupted and appears to have been displaced by a cross-fault with a general N-S direction. This conductor is also the closest to the known sulphide mineralization (L-36W at 0+75S) occurring on the property.

Conductors H and I-I' are moderately strong and persistent enough to deserve more attention while continuing the exploration of the property.

Conductors F-F' , H and I-I' are all located within the mafic volcanics of the Hemlo synform and are situated about 500 to 1000 feet of the granodiorite batholith.

A number of other VLF conductors are present but are not considered to be of prime importance for the time being.

A VLF conductor arises from the presence of conductive massive sulphides, graphite, fractures like faults and shears, geological contacts and other conductive substances. Metallic objects are also detectable by VLF-EM and may cause a conductive effect.

While working on the property, I noticed several electrical wires lying on the ground that once have been used for electricity/communications. In some instances, these wires may cause a conductive effect and give rise to a VLF conductor. Before conducting any drilling, proper care should be given to look around for these wires in order not to make a hole for nothing.....!

The NAA (Cutler, Me, U.S.A.) transmitting station was used for most of the survey.

The NSS (Annapolis) transmitting station was used for all the lines north and west of line 60 W.

A very small magnetometer survey has been carried out on a few lines. The high magnetic readings in some places reflect the presence of ultramafic rocks along with magnetite. The magnetometer survey should definitely be extended to cover the South Central part of the property which of interest to us at this moment.

### Conclusions and recommendations

In 1983 and 1984, several field surveys and other studies have been done on the property. The geological mapping along with the VLF electromagnetic surveys yielded useful results concerning the geology of the property and its exploration potential.

In 1985, additional field studies have been carried out in order to verify the results previously obtained. The main VLF conductors have been surveyed again and a small geochemical survey has been completed. The VLF-EM check up proved the existence of conductive axes as previously reported, but the geochemical sampling yielded no positive mineralized trend and is thus considered as inconclusive.

Following the examination of the work done on the property up to this time, it stands out that a few surveys and related work should have been carried out on the field before this time but have not been. So, it is recommended to Kilembe to complete the line cutting on the property west of the actual grid of cut lines. For this reason, the line cutters will have to cut the tie lines around your property and will further define its boundaries. The VLF-EM survey already done on most of the property should be extended to cover the western portion of it.

It is also highly recommended to run a magnetometer survey over the south-central and western parts of the property in order to detect any magnetic mineral association with the mineralization and to decipher the local tectonics. Conventional prospecting by stripping and trenching involving some geological mapping should also be undertaken as it constitutes an excellent means for visualizing the rock formations and taking fresh rock samples.

If the mineralization consists of disseminated sulphides, induced polarization will have to be used to locate appropriate targets for drilling. Additional geochemistry, in places, could be a useful tool to show the presence of gold mineralization.

Diamond drilling should be used to test the best targets defined by previous surveys. If good results are obtained, further drilling will be recommended.



## EXPLORATION PROGRAMME

### Phase Ia - General Exploration and Outlining the Targets

Linecutting	\$8,000
Geophysics: Magnetometer survey	
VLF electromagnetic survey	5,000
Conventional Prospecting: stripping, trenching some geological mapping, road building, etc...	15,000
Consulting and Supervision	8,000
Accommodations & Transportation/associated expenses	10,000
	\$46,000
Contingency	5,000
	\$51,000

### Phase Ib - if necessary only

Induced polarization	\$30,000
Geochemistry	10,000
	\$40,000

### Phase II - Diamond drilling

600 - 1000 metres @ \$100/m	\$60,000 - 100,000
Contingency	10,000
	\$70,000 - 110,000

Respectfully submitted,

December 2, 1985

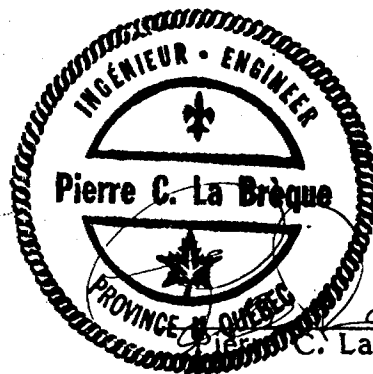

*P. LaBrègue*  
C. LaBrègue, P.Eng.

pierre c. labrèque

Ingénieur géologue · geological engineer

8.

C E R T I F I C A T E

I, Pierre C. LaBrèque, hereby declare that I reside at 245, rue des Chrysanthèmes, La Prairie, P.Qué. J5R 4G4, and that:

- 1- I am a graduate in Geological Engineering from Ecole Polytechnique, University of Montréal, 1971:
- 2- I am a member in good standing of the Order of Engineers Of Quebec:
- 3- I have been practicing my profession since 1971:
- 4- I have no direct or indirect interest in the said property of Kilembe Resources Inc. (Cassex option); nor do I expect to receive any such consideration:
- 5- The foregoing report is based on work carried out on the property under my supervision during August/September 1985 , and after in November 1985.

DATED, SIGNED AND SEALED,



December 2, 1985,

La Prairie,  
Province of Quebec.

Pierre C. LaBrèque, P.Eng.



**Report of Work**  
(Geophysical, Geological,  
Geochemical and Expenditures)

W 8509 453



42C13SE0063 2.8794 WABIKOBA LAKE

900

File: 658750

#:

Type of Survey(s) Geophysical surveys		Township or Area Wabikoba Lake (8-620)	
Claim Holder(s) Cassex Resources Ltd.		Prospector's Licence No. T1514	
Address 9B Caesar Avenue, Nepean, Ont. K2G 0A8			
Survey Company Maisonneuve Energy Materials Inc.		Date of Survey (from & to) 20 <sup>th</sup>   08 <sup>th</sup>   85 <sup>th</sup>   06 <sup>th</sup>   09 <sup>th</sup>   85 <sup>th</sup>	Total Miles of line Cut 12
Name and Address of Author of Geo-Technical report Pierre Labreque, P. Eng., 245 rue des Chrysanthemes, La Prairie, PQ J5R 4G4 and Terry Johnston, B.Sc., 245D Echo Drive, Ottawa, Ont. K1S 1N3			

Credits Requested per Each Claim in Columns at right Mining Claims Traversed (List in numerical sequence)

Special Provisions	Geophysical	Days per Claim	Mining Claims Traversed		
			Prefix	Mining Claim Number	Expend. Days Cr.
For first survey: Enter 40 days. (This includes line cutting)  For each additional survey: using the same grid: Enter 20 days (for each)	- Electromagnetic	40	TB	658750	
	- Magnetometer			675059	
	- Radiometric			675060	
	- Other			675061	
Man Days  Complete reverse side and enter total(s) here  RECEIVED 1985  RECEIVED	Geological			675062	
	Geochemical			675063	
	- Electromagnetic			675064	
	- Magnetometer			675065	
	- Radiometric			675066	
	- Other			675067	
	Geological			686233	
	Geochemical			701944	
				701945	
				701946	
Airborne Credits  Note: Special provisions credits do not apply to Airborne Surveys.	Electromagnetic			701947	
	Magnetometer			701948	
	Radiometric			701949	
				701950	
				701951	
				701952	
				701953	
				701954	
			701955		

Expenditures (excludes power stripping)

Type of Work Performed

Performed on Claim(s)

Calculation of Expenditure Days Credits

Total Expenditures \$  + 15 =  Total Days Credits

Instructions

Total Days Credits may be apportioned at the claim holder's choice. Enter number of days credits per claim selected in columns at right.

Date  
Sept. 23, 1985

CASSEX RESOURCES LTD. per  
Recorded Holder or Agent (Signature)  
Audrey M. Denis

**For Office Use Only**

Total Days Cr. Recorded: 1120

Date Recorded: Oct. 1/85

Mining Recorder: Audrey M. Denis

Certification Verifying Report of Work

I hereby certify that I have a personal and intimate knowledge of the facts set forth in the Report of Work annexed hereto, having performed the work or witnessed same during and/or after its completion and the annexed report is true.

Name and Postal Address of Person Certifying  
Terry Johnston, 245D Echo Drive, Ottawa, Ont. K1S 1N3

Date Certified: Sept. 23, 1985

Certified by (Signature): Johnston

Total number of mining claims covered by this report of work. 28



**Report of Work**  
(Geophysical, Geological,  
Geochemical and Expenditures)

W 85 09 454  
#454

*Land Management*

Nov 20

Instructions: - Please type or print.  
- If number of mining claims traversed exceeds space on this form, attach a list.  
Note: - Only days credits calculated in the "Expenditures" section may be entered in the "Expend. Days Cr." columns.  
- Do not use shaded areas below.

28794

File: 659749

**Mining Act**

Type of Survey(s) <b>Geological surveys</b>		Township or Area <b>Wabikoba Lake (S-620)</b> <b>White Lake (north part) (S-422)</b>	
Claim Holder(s) <b>Cassex Resources Ltd.</b>		Prospector's Licence No. <b>T1514</b>	
Address <b>9B Caesar Avenue, Nepean, Ont. K2G 0A8</b>			
Survey Company <b>Maisonneuve Energy Materials Inc.</b>		Date of Survey (from & to) 20 08 85   06 09 85 Day   Mo.   Yr.   Day   Mo.   Yr.	Total Miles of line Cut
Name and Address of Author (of Geo-Technical report) <b>Pierre Labreque, 245 rue des Chrysanthemes, La Prairie, PQ J5R 4G4 and Terry Johnston, 245 D Echo Drive, Ottawa, Ont. K1S 1N3</b>			

**Credits Requested per Each Claim in Columns at right**

Special Provisions	Geophysical	Days per Claim
For first survey: Enter 40 days. (This includes line cutting)	- Electromagnetic	
	- Magnetometer	
	- Radiometric	
	- Other	
For each additional survey: using the same grid: Enter 20 days (for each)	Geological	22
	Geochemical	
Man Days	Geophysical	Days per Claim
Complete reverse side and enter total(s) here	- Electromagnetic	
	- Magnetometer	
	- Radiometric	
	- Other	
	Geological	
	Geochemical	
Airborne Credits	Electromagnetic	Days per Claim
Note: Special provisions credits do not apply to Airborne Surveys.	Magnetometer	
	Radiometric	

**Mining Claims Traversed (List in numerical sequence)**

Mining Claim		Expend. Days Cr.	Mining Claim		Expend. Days Cr.
Prefix	Number		Prefix	Number	
TB	658749		TB	701950	
	658750			701951	
	675059			701952	
	675060			701953	
	675061			701954	
	675062			701955	
	675063			701956	
	675064			701957	
	675065			701958	
	675066			701959	
	675067			701960	
	675068				
	686215				
	686216				
	686226				
	686233				
	701922				
	701944				
	701945				
	701946				
	701947				
	701948				
	701949				

**Expenditures (excludes power stripping)**

Type of Work Performed
Performed on Claim(s)
Calculation of Expenditure Days Credits
Total Expenditures \$ <input type="text"/> ÷ 15 = Total Days Credits <input type="text"/>
Instructions Total Days Credits may be apportioned at the claim holder's choice. Enter number of days credits per claim selected in columns at right.

Total number of mining claims covered by this report of work. **34**

CASSEX RESOURCES LTD. per  
Date **Sept. 23, 1985**  
Recorded Holder or Agent (Signature) *Audrey M. Denis*

**For Office Use Only**  
Total Days Cr. Recorded **748**  
Date Recorded **October 1/85**  
Mining Recorder *Audrey M. Denis*  
Date Approved as Recorded **10/1/85**  
Branch Director

**Certification Verifying Report of Work**  
I hereby certify that I have a personal and intimate knowledge of the facts set forth in the Report of Work annexed hereto, having performed the work or witnessed same during and/or after its completion and the annexed report is true.

Name and Postal Address of Person Certifying  
**Terry Johnston, 245D Echo Drive, Ottawa, Ont. K1S 1N3**  
Date Certified **Sept. 23, 1985**  
Certified by (Signature) *T Johnston*



**Report of Work**  
(Geophysical, Geological,  
Geochemical and Expenditures)

W 85 09 455

#455

Land Management

Nov. 20<sup>th</sup>

- Instructions: - Please type or print:  
- If number of mining claims traversed exceeds space on this form, attach a list.  
Note: - Only days credits calculated in the "Expenditures" section may be entered in the "Expend. Days Cr." columns.  
- Do not use shaded areas below. (6-620)

File: 658749

Mining Act

Type of Survey(s) Geochemical surveys		Township or Area Wabikoba Lake and White Lake (north part) (6-622)	
Claim Holder(s) Cassex Resources Ltd.		Prospector's Licence No. T1514	
Address 9B Caesar Avenue, Nepean, Ont. K2G 0A8			
Survey Company Maisonneuve Energy Materials Inc.		Date of Survey (from & to) 20 08 85   06 09 85 Day   Mo.   Yr.   Day   Mo.   Yr.	Total Miles of line Cut
Name and Address of Author (of Geo-Technical report) Sudesh K. Singh, Ph.D., 42 Oval Drive, Aylmer, Que. J9H 1V2			

Credits Requested per Each Claim in Columns at right

Mining Claims Traversed (List in numerical sequence)

Special Provisions	Geophysical	Days per Claim
For first survey: Enter 40 days. (This includes line cutting)	- Electromagnetic	
	- Magnetometer	
For each additional survey: using the same grid: Enter 20 days (for each)	- Radiometric	
	- Other	
	Geological	
	Geochemical	40

Man Days	Geophysical	Days per Claim
Complete reverse side and enter total(s) here	- Electromagnetic	
	- Magnetometer	
	- Radiometric	
	- Other	
	Geological	
	Geochemical	

Airborne Credits	Geophysical	Days per Claim
Note: Special provisions credits do not apply to Airborne Surveys.	Electromagnetic	
	Magnetometer	
	Radiometric	

Mining Claim		Expend. Days Cr.	Mining Claim		Expend. Days Cr.
Prefix	Number		Prefix	Number	
TB	658749		TB	686208	
	658750			686209	
	674017			686210	
	674037			686211	
	674038			686212	
	674039			686213	
	674040			686214	
	674041			686215	
	674042			686216	
	674043			686217	
	674044			686218	
	674045			686219	
	674046			686220	
	675059			686222	
	675060			686223	
	675061			686224	
	675062			686225	
	675063			686226	
	675064			686227	
	675065			686228	
	675066			686229	
	675067			686230	
	675068			686231	

Expenditures (excludes power stripping)

Type of Work Performed

Performed on Claim(s)

Calculation of Expenditure Days Credits

Total Expenditures \$  ÷ 15 = Total Days Credits

Instructions  
Total Days Credits may be apportioned at the claim holder's choice. Enter number of days credits per claim selected in columns at right.

Total number of mining claims covered by this report of work. **46**

For Office Use Only

Total Days Cr. Recorded: 1840

Date Recorded: *185*

Mining Recorder: *Sudesh K. Singh*

Date Approved as Recorded: *185*

Date: Sept. 23, 1985

Recorded Holder or Agent (Signature): *Audrey M. Denis*

Certification Verifying Report of Work

I hereby certify that I have a personal and intimate knowledge of the facts set forth in the Report of Work annexed hereto, having performed the work or witnessed same during and/or after its completion and the annexed report is true.

Name and Postal Address of Person Certifying  
Sudesh K. Singh, 42 Oval Drive, Aylmer, Que. J9H 1V2

Date Certified: Sept. 23, 1985

Certified by (Signature): *S. K. Singh*



**Report of Work**  
(Geophysical, Geological,  
Geochemical and Expenditures)

WAS 04 456 *Land Management* *Nov 20*

#456 2.8794

- Instructions: - Please type or print.  
- If number of mining claims traversed exceeds space on this form, attach a list.  
Note: - Only days credits calculated in the "Expenditures" section may be entered in the "Expend. Days Cr." columns.  
- Do not use shaded areas below.

File: 686232

Mining Act

Type of Survey(s) Geochemical surveys	Township or Area Wabikoba Lake and White Lake (north part) (G-622)
Claim Holder(s) Cassex Resources Ltd.	Prospector's Licence No. T1514
Address 9B Caesar Avenue, Nepean, Ont. K2G 0A8	
Survey Company Maisonneuve Energy Materials Inc.	Date of Survey (from & to) 20 08 85   06 09 85 Day   Mo.   Yr.   Day   Mo.   Yr.
Total Miles of line Cut	
Name and Address of Author (of Geo-Technical report) Sudesh K. Singh, Ph.D., 42 Oval Drive, Aylmer, Que. J9H 1V2	

Credits Requested per Each Claim in Columns at right

Special Provisions	Geophysical	Days per Claim
For first survey: Enter 40 days. (This includes line cutting)	- Electromagnetic	
	- Magnetometer	
	- Radiometric	
	- Other	
For each additional survey: using the same grid: Enter 20 days (for each)	Geological	
	Geochemical	40
Man Days Complete reverse side and enter total(s) here	Geophysical	Days per Claim
	- Electromagnetic	
	- Magnetometer	
	- Radiometric	
	- Other	
	Geological	
Airborne Credits Note: Special provisions credits do not apply to Airborne Surveys.	Electromagnetic	
	Magnetometer	
	Radiometric	

Mining Claims Traversed (List in numerical sequence)

Mining Claim		Expend. Days Cr.	Mining Claim		Expend. Days Cr.
Prefix	Number		Prefix	Number	
TB	686232		TB	701949	
	686233			701950	
	686234			701951	
	686235			701952	
	686236			701953	
	686237			701954	
	686238			701955	
	686239			701956	
	686240			701957	
	686241			701958	
	686242			701959	
	686243			701960	
	686244				
	686245				
	686246				
	686247				
	686256				
	701922				
	701944				
	701945				
	701946				
	701947				
	701948				

Expenditures (excludes power stripping)

Type of Work Performed	
Performed on Claim(s)	
Calculation of Expenditure Days Credits	
Total Expenditures	Total Days Credits
\$	÷ 15 =
Instructions Total Days Credits may be apportioned at the claim holder's choice. Enter number of days credits per claim selected in columns at right.	

Total number of mining claims covered by this report of work. **35**

For Office Use Only	
Total Days Cr. Recorded 1400	Date Recorded October 1/85 Audrey M. Denis
Mining Recorder Audrey M. Denis	Date Approved as Recorded

Date  
Sept. 23, 1985  
Cassex Resources Ltd.  
Audrey M. Denis

Certification Verifying Report of Work

I hereby certify that I have a personal and intimate knowledge of the facts set forth in the Report of Work annexed hereto, having performed the work or witnessed same during and/or after its completion and the annexed report is true.

Name and Postal Address of Person Certifying  
Sudesh K. Singh, 42 Oval Drive, Aylmer, Que. J9H 1V2

Date Certified Sept. 23, 1985	Certified by (Signature) S.K. Singh
----------------------------------	--



Recorded Holder  
**CASSEX RESOURCES LTD**

Township or Area  
**AREA OF WABIKOBA LAKE**

Type of survey and number of Assessment days credit per claim	Mining Claims Assessed
Geophysical <span style="float: right;">28</span>	
Electromagnetic _____ days	TB 658750
	675059
	675063
Magnetometer _____ days	675065 to 67 incl
	686233
Radiometric _____ days	701948
	701955 to 57 incl
Induced polarization _____ days	
Other _____ days	
Section 77 (19) See "Mining Claims Assessed" column	
Geological _____ days	
Geochemical _____ days	
Man days <input type="checkbox"/> Airborne <input type="checkbox"/>	
Special provision <input checked="" type="checkbox"/> Ground <input checked="" type="checkbox"/>	
<input checked="" type="checkbox"/> Credits have been reduced because of partial coverage of claims.	
<input type="checkbox"/> Credits have been reduced because of corrections to work dates and figures of applicant.	

Special credits under section 77 (16) for the following mining claims

\_\_\_\_\_

No credits have been allowed for the following mining claims

not sufficiently covered by the survey  insufficient technical data filed

TB 675060 to 62 incl  
675064  
701944 to 47 incl  
701949 to 54 incl  
701958 to 60 incl

The Mining Recorder may reduce the above credits if necessary in order that the total number of approved assessment days recorded on each claim does not exceed the maximum allowed as follows: Geophysical - 80; Geological - 40; Geochemical - 40; Section 77(19) - 60.



Recorded Holder  
**CASSEX RESOURCES LTD**

Township or Area  
**AREA OF WABIKOBA LAKE AND WHITE LAKE (NORTH PART)**

Type of survey and number of Assessment days credit per claim	Mining Claims Assessed
<b>Geophysical</b>	
Electromagnetic _____ days	
Magnetometer _____ days	
Radiometric _____ days	TB 658749-50 675059 to 68 incl 686215-16 686226 686233
Induced polarization _____ days	701922
Other _____ days	701944 to 60 incl
Section 77 (19) See "Mining Claims Assessed" column	
Geological _____ 0 _____ days	
Geochemical _____ days	
Man days <input type="checkbox"/>	Airborne <input type="checkbox"/>
Special provision <input type="checkbox"/>	Ground <input type="checkbox"/>
<input type="checkbox"/> Credits have been reduced because of partial coverage of claims.	
<input type="checkbox"/> Credits have been reduced because of corrections to work dates and figures of applicant.	

**Special credits under section 77 (16) for the following mining claims**

**No credits have been allowed for the following mining claims**

not sufficiently covered by the survey       insufficient technical data filed

- No geological assessment credit as reports and maps not submitted.

The Mining Recorder may reduce the above credits if necessary in order that the total number of approved assessment days recorded on each claim does not exceed the maximum allowed as follows: Geophysical - 80; Geological - 40; Geochemical - 40; Section 77(19) - 60.





Recorded Holder  
**CASSEX RESOURCES LTD**

Township or Area  
**WABIKOBA LAKE AND WHITE LAKE (NORTH PART)**

Type of survey and number of Assessment days credit per claim	Mining Claims Assessed
<b>Geophysical</b>	
Electromagnetic _____ days	
Magnetometer _____ days	TB 674037
Radiometric _____ days	674042-43
Induced polarization _____ days	675065
Other _____ days	675068
	686212
	686218-19
Section 77 (19) See "Mining Claims Assessed" column	
Geological _____ days	
Geochemical <u>12</u> days	
Man days <input type="checkbox"/> Airborne <input type="checkbox"/>	
Special provision <input checked="" type="checkbox"/> Ground <input checked="" type="checkbox"/>	
<input checked="" type="checkbox"/> Credits have been reduced because of partial coverage of claims.	
<input type="checkbox"/> Credits have been reduced because of corrections to work dates and figures of applicant.	

Special credits under section 77 (16) for the following mining claims

No credits have been allowed for the following mining claims

<input checked="" type="checkbox"/> not sufficiently covered by the survey	<input type="checkbox"/> insufficient technical data filed
TB 658749-50	686208 to 11 incl
674017	686213 to 17 incl
674938 to 41 incl	686220
674044 to 46 incl	686222 to 47 incl
675059 to 64 incl	686256
675066-67	701922
	701944 to 60 incl

The Mining Recorder may reduce the above credits if necessary in order that the total number of approved assessment days recorded on each claim does not exceed the maximum allowed as follows: Geophysical - 80; Geological - 40; Geochemical - 40; Section 77(19) - 60.



Ministry of  
Natural  
Resources

Order of  
the Minister

AMENDED

The Mining Act

Jan 10  
Room 6643, Whitney Block  
Queen's Park  
Toronto, Ontario  
M7A 1W3  
416/965-4888

In the matter of mining claims:

TB 658750, et al,  
in the Area of Wabikoba Lake  
as listed on Report of Work  
453 to 456 inclusive.

On consideration of an application from the recorded holder, Cassex Resources Ltd  
under Section 77 Subsection 22 of The Mining Act, I hereby order that the time for filing reports and plans in support of  
Geophysical (Electromagnetic) assessment work recorded on October 1, 1985  
be extended until and including January 10, 1986.

1985.11.27

Date

Signature of Director, Land Management Branch

Copies:  
Cassex Resources Ltd  
9B Caesar Avenue  
Nepean, Ontario  
K2G 0A8

Pierre Labreque, P.Eng.,  
245 rue des Chryanthemes  
La Prairie, Quebec  
J5R 4G4

Mining Recorder  
Thunder Bay, Ontario



Ministry of  
Natural  
Resources

Order of  
the Minister

Amended

Jan 10

Room 6643, Whitney Block  
Queen's Park  
Toronto, Ontario  
M7A 1W3  
416/965-4888

The Mining Act

In the matter of mining claims:

TB 658750, et al,  
in the Area of Wabikoba Lake  
as listed on Report of Work  
#453. to 456 incl.

On consideration of an application from the recorded holder, Cassex Resources Ltd  
under Section 77 Subsection 22 of The Mining Act, I hereby order that the time for filing reports and plans in support of  
Geophysical (Electromagnetic) assessment work recorded on October 1, 1985  
be extended until and including January 10, 1986.

1985. 11. 27.

Date

Stendt

Signature of Director, Land Management Branch

Copies: Cassex Resources Ltd  
9B Caesar Avenue  
Nepean, Ontario  
K2G 0A8

Pierre Labreque, P.Eng.,  
245 rue des Chrysanthemes  
La Prairie, Quebec  
J5R 4G4

Mining Recorder  
Thunder Bay, Ontario

Mining Lands Section

File No 28794

Control Sheet

TYPE OF SURVEY  GEOPHYSICAL  
 GEOLOGICAL  
 GEOCHEMICAL  
 EXPENDITURE

MINING LANDS COMMENTS:

---

---

---

---

---

---

---

---

---

---

---

---

---

---

---

---

---

---

---

---

---

---

---

---

---

---

↳ Wabiko bakk. 3, White LK. (North part) ↘

Lgd.  
L. ①

Dennis K.

Signature of Assessor

Jan. 21/88

Date

March 12, 1986

Your File: 453 & 454  
Our File: 2.8794

Mining Recorder  
Ministry of Northern Development and Mines  
435 James Street South  
P.O. Box 5000  
Thunder Bay, Ontario  
P7C 5G6

Dear Madam:

RE: Notice of Intent dated February 18, 1986  
Geophysical (Electromagnetic) and Geological  
Surveys on Mining Claims TB 658749, et al,  
in the Area of Wabikoba Lake and White Lake  
(North Part)

---

The assessment work credits, as listed with the  
above-mentioned Notice of Intent, have been approved  
as of the above date.

Please inform the recorded holder of these mining  
claims and so indicate on your records.

Yours sincerely,

J.C. Smith, Supervisor  
Mining Lands Section

Whitney Block, 6th Floor  
Queen's Park  
Toronto, Ontario  
M7A 1W3

Telephone: (416) 965-4888

DK/mc

cc: Cassex Resources Ltd  
9B Caesar Avenue  
Nepean, Ontario  
K2G 0A8

Pierre Labreque, P.Eng.,  
245 rue des Chrysanthes  
La Prairie, Quebec  
J4R 4G4

Mr. G.H. Ferguson  
Mining & Lands Commissioner  
Toronto, Ontario

K. Sethuraman  
Suite 400  
111 Richmond Street West  
Toronto, Ontario  
M5H 2G4

Encl.

Resident Geologist  
Thunder Bay, Ontario

March 21, 1986

Your Files: 455 & 456  
Our File: 2.8794

Mining Recorder  
Ministry of Northern Development and Mines  
435 James Street South  
P.O. Box 5000  
Thunder Bay, Ontario  
P7C 5G6

Dear Madam:

RE: Notice of Intent dated February 18, 1986  
Geochemical Survey on Mining Claims TB 658749,  
et al, in the Area of Wabikoba Lake and  
White Lake (North Part)

---

The assessment work credits, as listed with the  
above-mentioned Notice of Intent, have been approved  
as of the above date.

Please inform the recorded holder of these mining  
claims and so indicate on your records.

Yours sincerely,

J.C. Smith, Supervisor  
Mining Lands Section

Whitney Block, 6th Floor  
Queen's Park  
Toronto, Ontario  
M7A 1W3

Telephone: (416) 965-4888

DK/mc

cc: Cassex Resources Ltd  
9B Caesar Avenue  
Nepean, Ontario  
K2G 0A8

Pierre Labreque, P.Eng.,  
24 rue des Chrysanthes  
La Prairie, Quebec  
J4R 4G4

K. Sethuraman  
Suite 400  
111 Richmond Street West  
Toronto, Ontario  
M5H 2G4

Mr. G.H. Ferguson  
Mining & Lands Comm.  
Toronto, Ontario

Resident Geologist  
Thunder Bay, Ont.

Encl.

*Extended to  
Jan. 10th.*

November 20, 1985

Reports of Work 453  
454  
455  
456

REGISTERED

Cassex Resources Ltd.  
9B Caesar Avenue  
Nepean, Ontario  
K2G 0A8

Dear Sirs:

RE: Mining Claims TB 658749 et al in the Areas of Wabikoba  
Lake and White Lake North.

---

I have not received the reports and maps (in duplicate) for  
the Geochemical, Geological and Electromagnetic Surveys on  
the above-mentioned claims.

As the assessment "Report of Work" was recorded by the Mining  
Recorder on October 1, 1985 the 60 day period allowed by  
Section 77 of the Mining Act for the submission of the  
technical reports and maps to this office will expire on  
November 30, 1985.

If the material is not submitted to this office by  
November 30, 1985 I will have no alternative but to instruct  
the Mining Recorder to delete the work credits from the claim  
record sheets.

For further information, please contact Mr. A. Barr at  
416/965-4888.

Yours sincerely

S.E. Yundt  
Director  
Land Management Branch

Whitney Block, Room 6643  
Queen's Park, Toronto  
M7A 1W3  
Telephone: 416/965-4888

AB:sc

cc: Mining Recorder  
Thunder Bay, Ontario

111, Richmond St. West  
Suite 400  
Toronto, Ontario.  
M5H 2G4  
January 10, 1986.

Ms. S. Yundt  
Director  
Land Management Branch  
Ontario Ministry of Natural Resources  
Queen's Park,  
Toronto, Ontario.

Re: Mining claims TB 658749 et.al., Thunder Bay Division.  
Reports of work 453,454,455,456.

I have been authorized by Cassex Resources of Ottawa and Kilembe Resources of Vancouver to act as their geological consultant effective January 10, 1986.

Based on a review of files made available to me by Cassex, I understand that as per telephone conversation between Audry M. Denis of Cassex and A. Barr of your Branch on November 25, 1985, Cassex was granted extension to submit the report by January 10, 1986. Accordingly, I am forwarding a recent report dated December 2, 1985 prepared by Pierre C. Labreque.

Last year, Cassex signed an agreement with Kilembe Resources whereby Kilembe is committed to doing further exploration on the above property subject to further financing. Kilembe advised me that the financing has been completed today and the Company intends to initiate an exploration program as soon as possible subject to snow conditions on the property.

I hope the documents are in order. If you need further information, please do not hesitate to contact me.

Y,  
ES LTD.

*K. Sethuraman.*

*111 Richmond St. W.  
Suite 400  
Toronto Ont.  
M5H 2G4.*

*Wam*  
Ph.D.,

*366-5201. or. Mr Swain*



# CASSEX RESOURCES LTD.

9B CAESAR AVENUE, NEPEAN, ONT. K2G 0A8 613 226 7598 / 7699

<b>RECEIVED</b>	
LAND MANAGEMENT BRANCH	
DEC 2 - '85	
PREPARE REPLY	<input type="checkbox"/>
COMMENTS PLEASE	<input type="checkbox"/>
BY	
S. E. YUNDT	
J. R. MORTON	
J. C. SMITH	<i>[initials]</i>
W. P. BROOK	
M. J. HOGAN	
D. W. SCOTT	
S. KEEN	
Return To: R.6649	

November 26, 1985

Ms. S. Yundt  
Director  
Land Management Branch  
Ont. Ministry of Natural Resources  
Whitney Block, Room 6643  
Queen's Park  
Toronto, Ont. M7A 1W3

Dear Ms. Yundt:

Re: Mining claims TB 658749 et al in the Areas of Wabikoba Lake and White Lake North; Reports of work 453, 454, 455, 456

We acknowledge and appreciate receiving your letter of November 20/85 reminding us of our obligation to submit the reports and maps for the geo-chemical, geological, and electromagnetic surveys on the above-mentioned claims by Nov. 30/85.

I would like to inform you of my telephone discussion of Nov. 25/85 with Mr. A Barr of the Land Management Branch. As I told Mr. Barr, the three geologists responsible for writing these reports went out to the property to do additional work and Dr. S. Singh, President of Cassex Resources, went missing on Nov. 16th. The other two geologists were assisting the O.P.P. in their search for Dr. Singh for eight days. Obviously, no work was done on the reports during this period and I expressed the need for additional time in which to complete the report preparation. Mr. Barr agreed to such an extension until Jan. 10/86.

I hope that this information brings you up to date and will be included in your files.

Yours sincerely,

CASSEX RESOURCES LTD.

*Audrey M. Denis*  
Audrey M. Denis  
Secretary-Treasurer

cc: Mining Recorder  
Thunder Bay, Ont.

**RECEIVED**  
DEC 02 1985  
MINING LANDS SECTION





Ontario

Mar. 5/86

Ministry of  
Northern Development  
and Mines

February 18, 1986

Your Files: 453,454,455 & 456  
Our File: 2.8794

Mining Recorder  
Ministry of Northern Development and Mines  
435 James Street South  
P.O. Box 5000  
Thunder Bay, Ontario  
P7C 5G6

Dear Madam:

Enclosed are two copies of a Notice of Intent with statements listing a reduced rate of assessment work credits to be allowed for a technical survey. Please forward one copy to the recorded holder of the claims and retain the other. In approximately fifteen days from the above date, a final letter of approval of these credits will be sent to you. On receipt of the approval letter, you may then change the work entries on the claim record sheets.

For further information, if required, please contact Mr. R.J. Pichette at (416) 965-4888.

Yours sincerely,

  
T.S.E. Yurdt, Director  
Land Management Branch

Mining Lands Section  
Whitney Block, 6th Floor  
Queen's Park  
Toronto, Ontario  
M7A 1W3

*DK* DK/mc  
Encls.

cc: Cassex Resources Ltd  
9B Caesar Avenue  
Nepean, Ontario  
K2G 0A8

Mr. G.H. Ferguson  
Mining & Lands Commissioner  
Toronto, Ontario

Pierre Labreque, P.Eng.,  
245 rue des Chryanthemes  
La Prairie, Quebec  
J5R 4G4

K. Sethuraman  
Suite 400  
111 Richmond Street West  
Toronto, Ontario  
M5H 2G4



Ontario

Ministry of  
Northern Development  
and Mines

Notice of Intent  
for Technical Reports

February 18, 1986

2.8794/453,454,455 & 456

An examination of your survey report indicates that the requirements of The Ontario Mining Act have not been fully met to warrant maximum assessment work credits. This notice is merely a warning that you will not be allowed the number of assessment work days credits that you expected and also that in approximately 15 days from the above date, the mining recorder will be authorized to change the entries on the record sheets to agree with the enclosed statement. Please note that until such time as the recorder actually changes the entry on the record sheet, the status of the claim remains unchanged.

If you are of the opinion that these changes by the mining recorder will jeopardize your claims, you may during the next fifteen days apply to the Mining and Lands Commissioner for an extension of time. Abstracts should be sent with your application.

If the reduced rate of credits does not jeopardize the status of the claims then you need not seek relief from the Mining and Lands Commissioner and this Notice of Intent may be disregarded.

If your survey was submitted and assessed under the "Special Provision-Performance and Coverage" method and you are of the opinion that a re-appraisal under the "Man-days" method would result in the approval of a greater number of days credit per claim, you may, within the said fifteen day period, submit assessment work breakdowns listing the employees names, addresses and the dates and hours they worked. The new work breakdowns should be submitted directly to the Land Management Branch, Toronto. The report will be re-assessed and a new statement of credits based on actual days worked will be issued.



**S.I.O. - SURFACE RIGHTS ONLY**

Description	Order No.	Date	Disposition	F/R
100' x 150'	2-10-83	10/10/83	100' x 150'	100'
200' x 200'	2-10-83	10/10/83	200' x 200'	200'
300' x 300'	2-10-83	10/10/83	300' x 300'	300'
400' x 400'	2-10-83	10/10/83	400' x 400'	400'

**DISPOSITION OF CROWN LANDS**

SYMBOL

- PATENT SURFACE & MINING RIGHTS
- SURFACE RIGHTS ONLY
- MINING RIGHTS ONLY
- LEASE SURFACE & MINING RIGHTS
- SURFACE RIGHTS ONLY
- MINING RIGHTS ONLY
- LICENCE OF OCCUPATION
- RESERVATION
- CANCELLED
- SAND & GRAVEL

NOTE: MINING RIGHTS IN ORIGINAL PATENTED SURFACE & MINING RIGHTS LANDS ACT, R.S.O. 1970, CHAP. 360, SEC. 43, SUBSEC. 1.

**TYPE OF DOCUMENT**

- DEED
- ASSIGNMENT
- RESERVATION
- ORDER IN COUNCIL
- RESERVATION
- CANCELLED
- SAND & GRAVEL

**SCALE 1 INCH = 40 CHAINS**

FEET: 0, 1000, 2000, 4000, 8000

METRES: 0, 200, 400, 800, 1600

THUNDER BAY RECEIVED FEB 24 1986

759101112123456

FILE 469360

SOLEING LAKE SUBJECT TO FLOODING TO SOLEING LAKE SUBJECT TO FLOODING TO WINDING LAKE CONVEYANCE JUNE 7, 1985.

AREA: **WABIKOBA LAKE**

M.N.R. ADMINISTRATIVE DISTRICT: **TERRACE BAY**

MINING DIVISION: **THUNDER BAY**

LAND TITLES / REGISTRY DIVISION: **THUNDER BAY**

Ministry of Land Management Resources Branch Ontario

7-1-15-1984

011 AUGUST 1984

G-623

WHITE LAKE (S. PT.)

G-622

WHITE LAKE (N. PT.)

BOMBY TWP. G-3173

BROTHERS TWP. G-3172

ROUS LAKE G-611

LORNA LAKE G-598

48°43'00"

48°43'00"

48°43'00"

48°43'00"

48°43'00"

48°43'00"

48°43'00"

48°43'00"

48°43'00"

48°43'00"

48°43'00"

48°43'00"

48°43'00"

48°43'00"

48°43'00"

48°43'00"

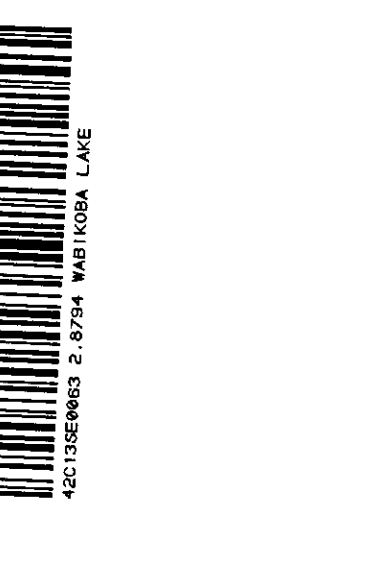
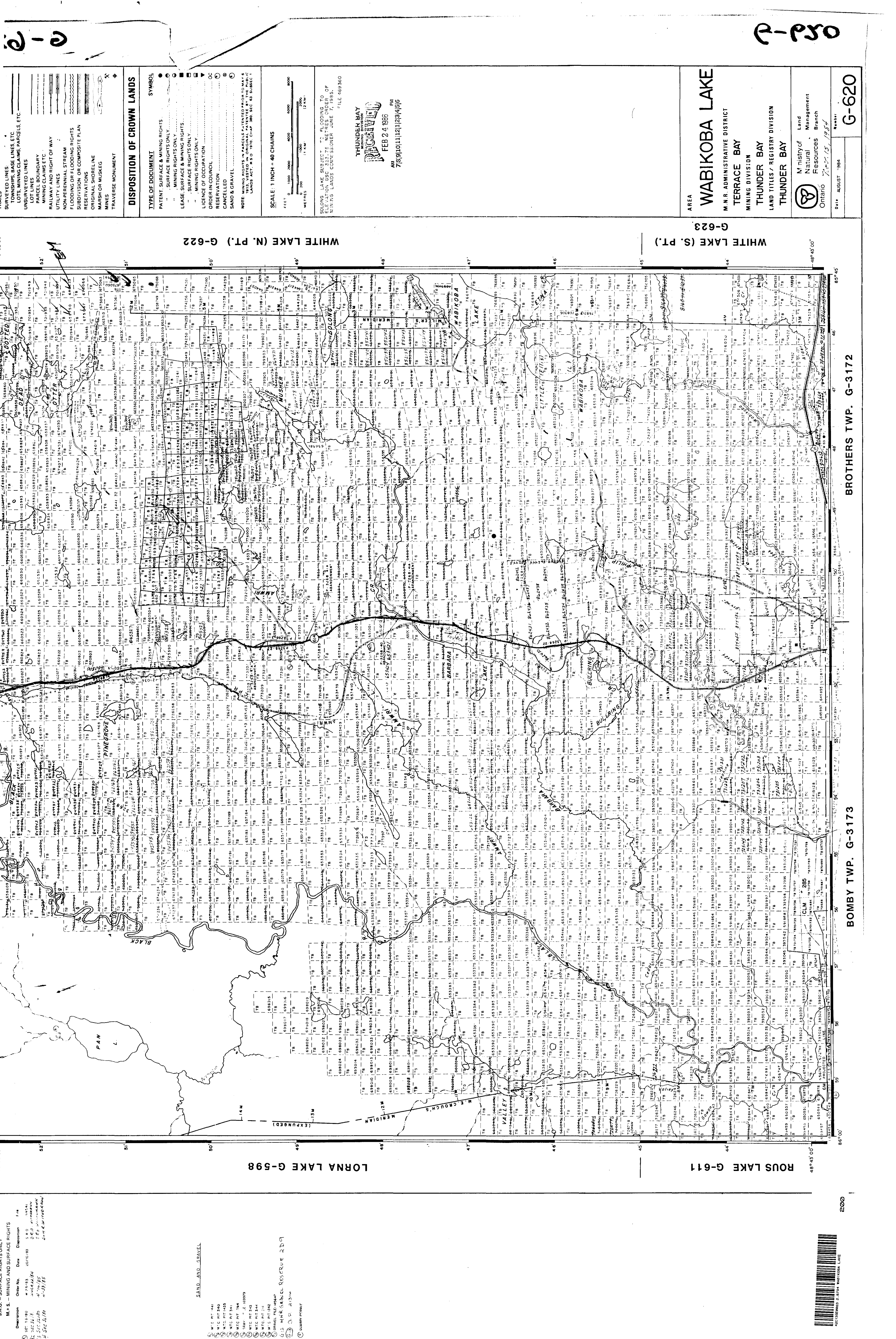



REFERENCES

AREAS WITHDRAWN FROM DISPOSITION

S.R. - SURFACE RIGHTS M.R. - MINING RIGHTS

Description	Order No.	Date	Disposition	File

FLOODING RIGHTS ON WHITE LAKE AND RAVINE LAKE TO  
CONTOUR ELEVATION 1000'  
M.L.P.C. OF ONTARIO, 28th FEB. 1952. File: H3980.

SAULT STE MARIE  
RECEIVED  
OCT 11 1983  
A.M. 11:10 11:12 P.M. 1:21 1:41 1:50

OLGA LAKE G-604

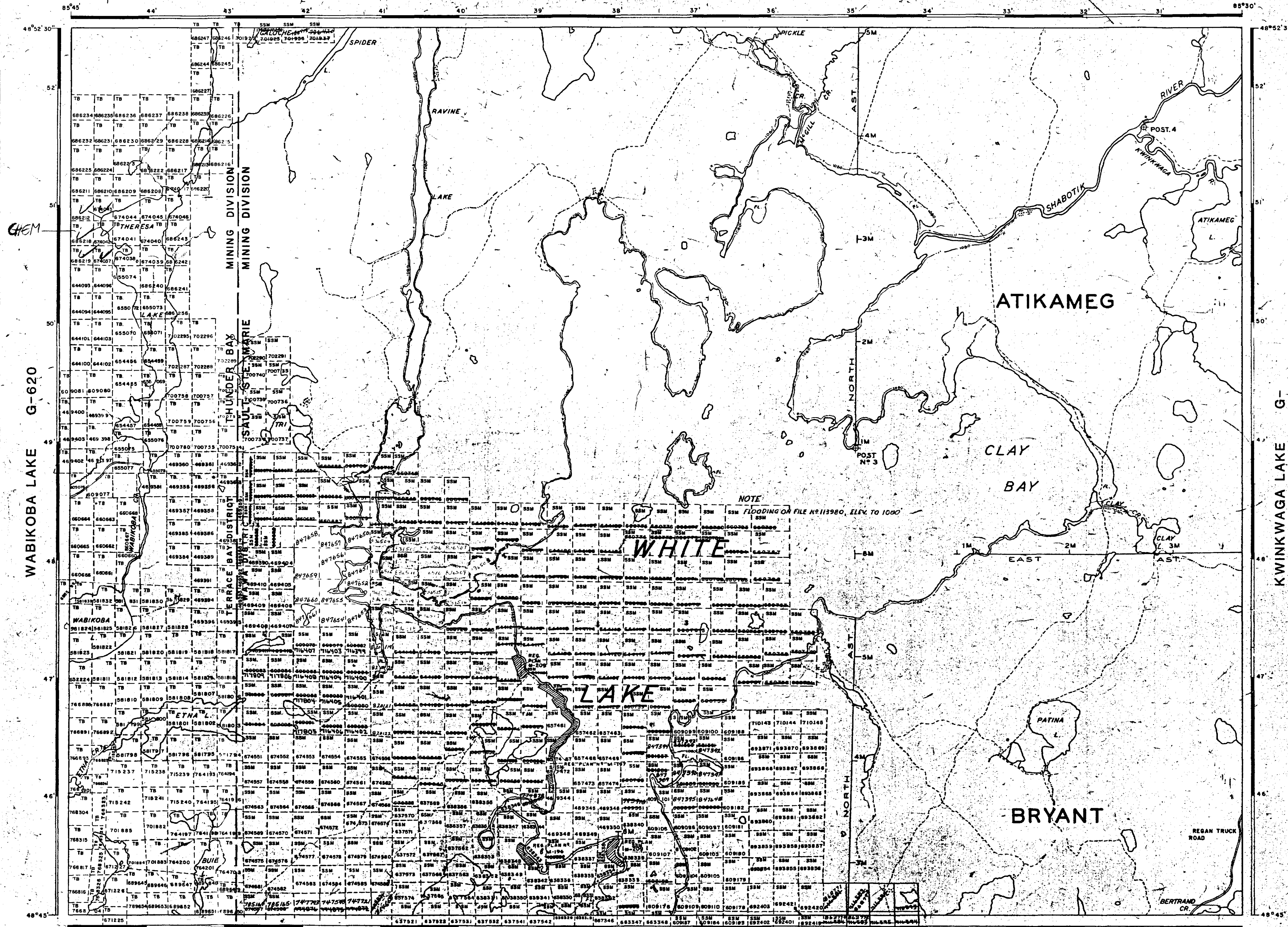

WHITE RIVER (south part) G-623

REFERENCES

TOPOGRAPHY  
LAKES, RIVERS, ETC., FROM FOREST  
RESOURCES INVENTORY SHEET No. 487853

DATE OF ISSUE  
MAY 7 1985  
SAULT STE MARIE  
MINING RECORDER'S OFFICE

LEGEND

- HIGHWAY AND ROUTE No.
- OTHER ROADS
- TRAILS
- SURVEYED LINES: TOWNSHIPS, BASE LINES, ETC.
- LOTS, MINING CLAIMS, PARCELS, ETC.
- UNSURVEYED LINES: LOT LINES
- PARCEL BOUNDARY MINING CLAIMS ETC.
- RAILWAY AND RIGHT-OF-WAY
- UTILITY LINES
- NON-PERMANENT STREAM
- FLOODING OR FLOODING RIGHTS
- SUBDIVISION OR COMPOSITE PLAN
- RESERVATIONS
- ORIGINAL SHORELINE
- MARSH OR MUSKIE
- MINES
- TRAVERSE MONUMENT

DISPOSITION OF CROWN LANDS

TYPE OF DOCUMENT	SYMBOL
PATENT, SURFACE & MINING RIGHTS	
SURFACE RIGHTS ONLY	
MINING RIGHTS ONLY	
LEASE, SURFACE & MINING RIGHTS	
SURFACE RIGHTS ONLY	
MINING RIGHTS ONLY	
LICENCE OF OCCUPATION	
ORDER-IN-COUNCIL	
RESERVATION	
CANCELLED	
SAND & GRAVEL	

NOTE: MINING RIGHTS IN PARCELS PATENTED PRIOR TO MAY 1913, VESTED IN ORIGINAL PATENTEES BY THE PUBLIC LANDS ACT, R.S.O. 1914, CHAP. 206, SEC. 63, SUBSEC. 4.

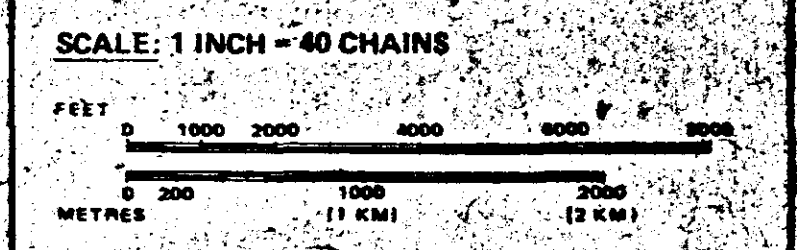

AREA  
**WHITE LAKE**  
(north part)  
M.N.R. ADMINISTRATIVE DISTRICT  
**TERRACE BAY/WAWA**  
MINING DIVISION  
**THUNDER BAY/SAULT STE.MARIE**  
LAND TITLES / REGISTRY DIVISION  
**THUNDER BAY**

Ministry of Natural Resources  
Land Management Branch  
Ontario

Date: FEBRUARY, 1985  
Number: **G-622**

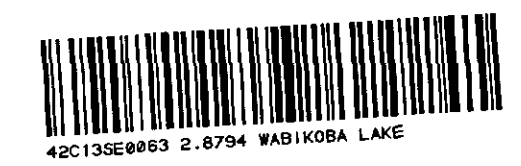



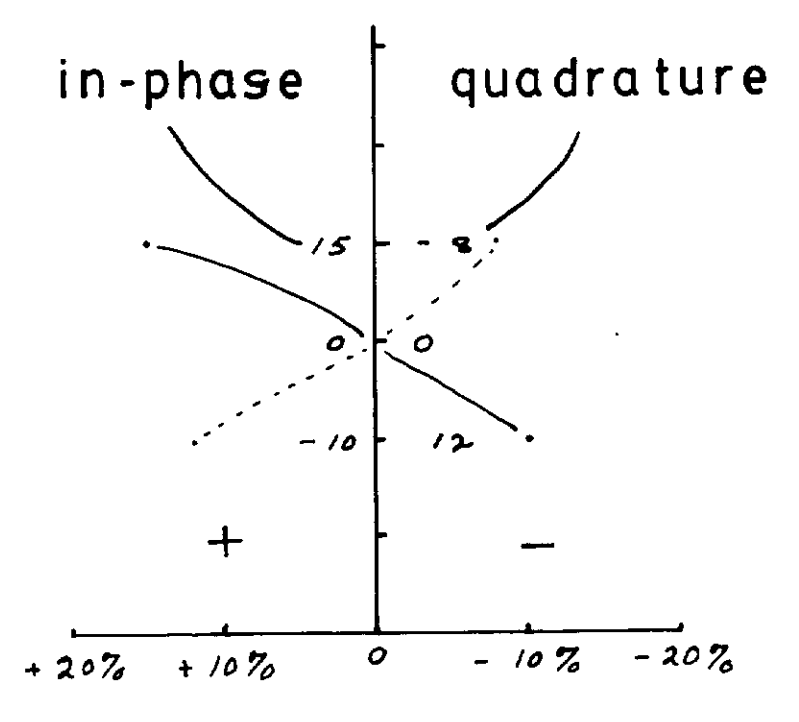
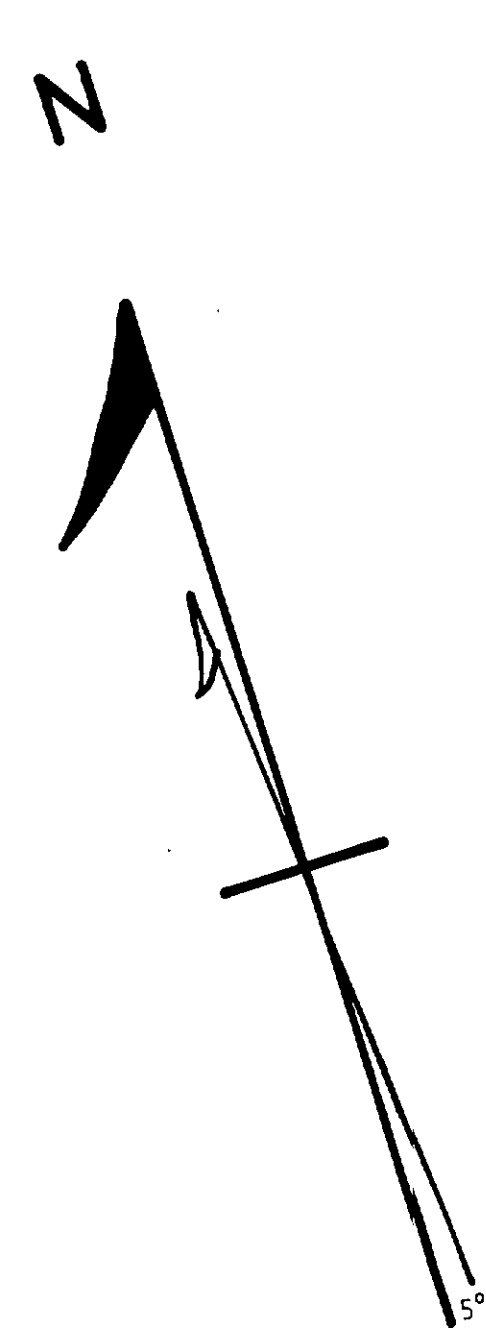
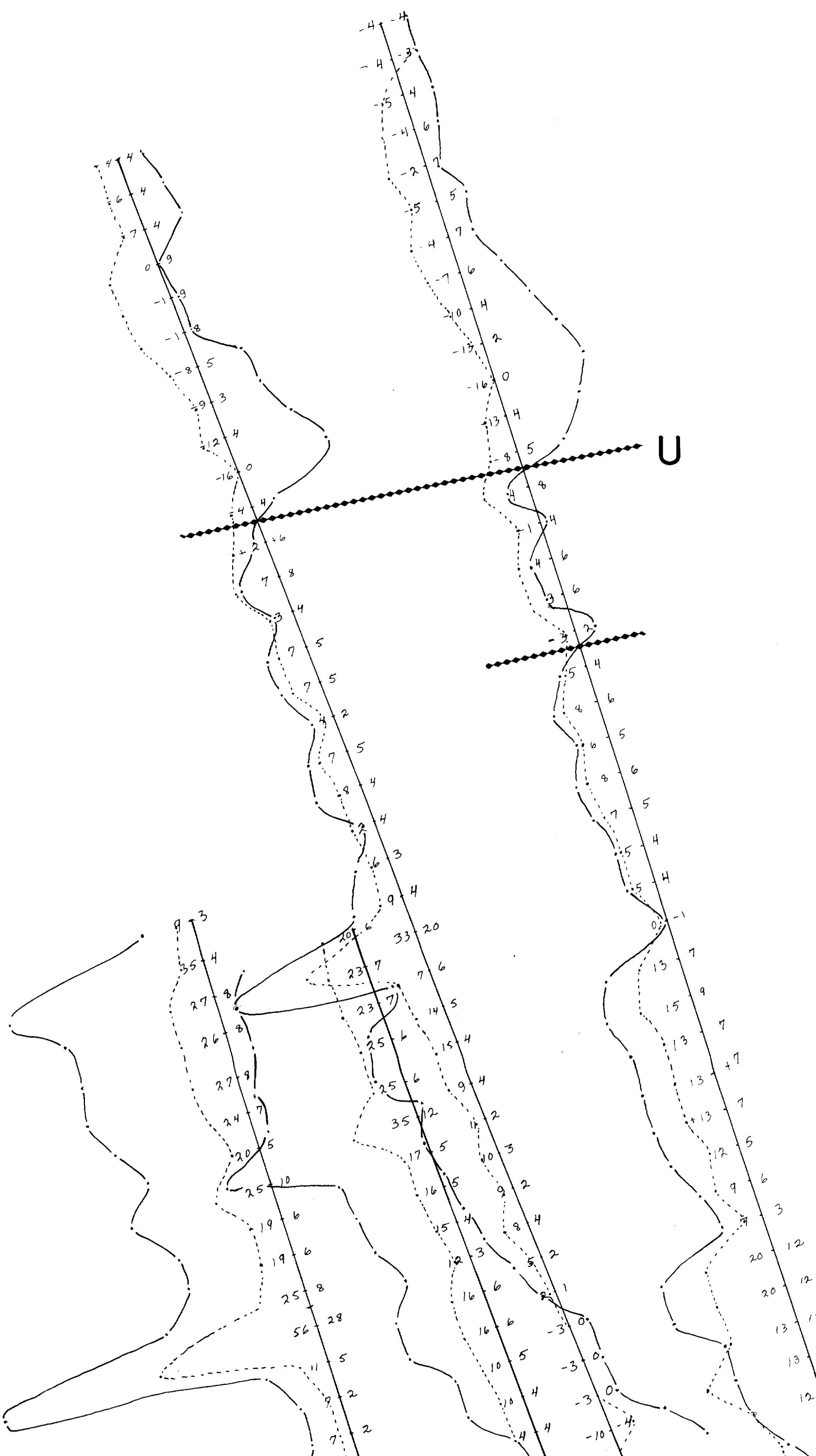

..... VLF CONDUCTIVE AXIS  
 // // // // // FRASER HIGH

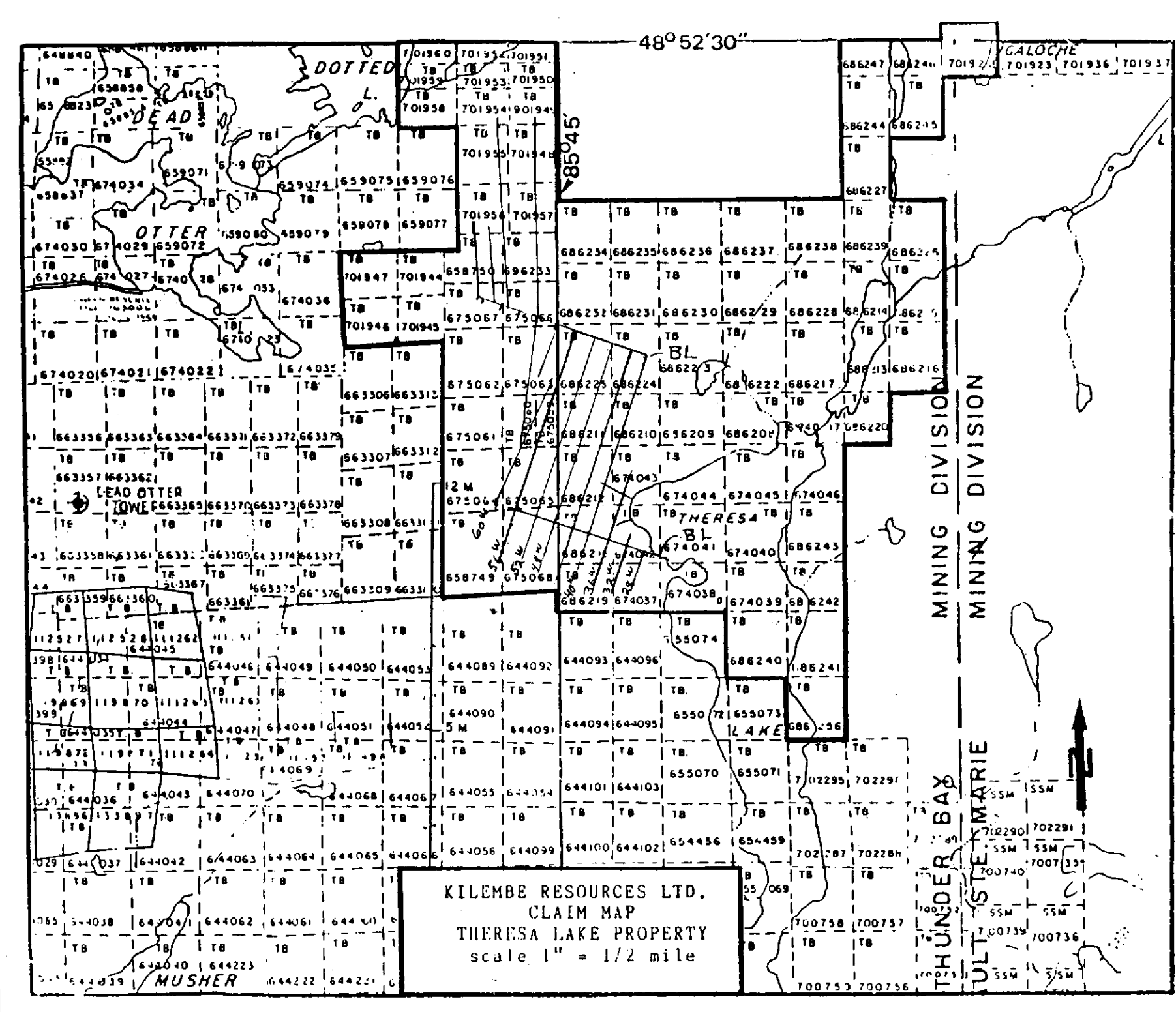

KILIMBE RESOURCES LTD	
CASSEY OPTION - HEMLO AREA Theresa Lake Project	
pierre c. labrègue ingénieur géologue - geological engineer	
VLF - ELECTROMAGNETIC SURVEY Transmitting Stations: NSS and NAA	
PROFILES	
PROFICION Terry Johnson, D.Sc. Pierre Labrègue, P.Eng.	DATE Aug-Sept '85
INTERPRETATION Pierre Labrègue, P.Eng.	Instrument: EM-16 (Geonics)
REVISION P.L.	28794
SCALE 1" = 200'	0 200 400 feet
LATITUDES	LONGITUDES

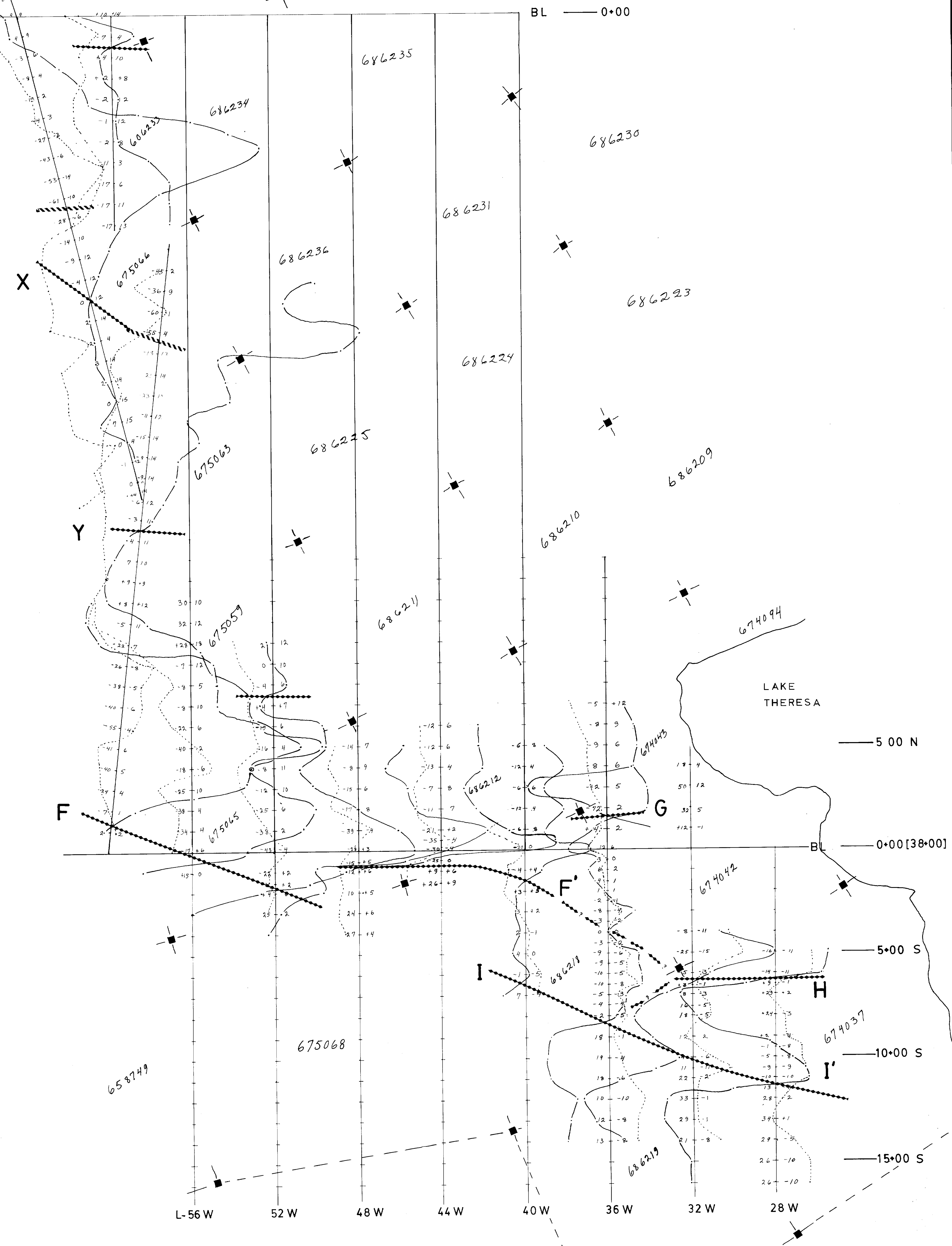

..... VLF CONDUCTIVE AXIS

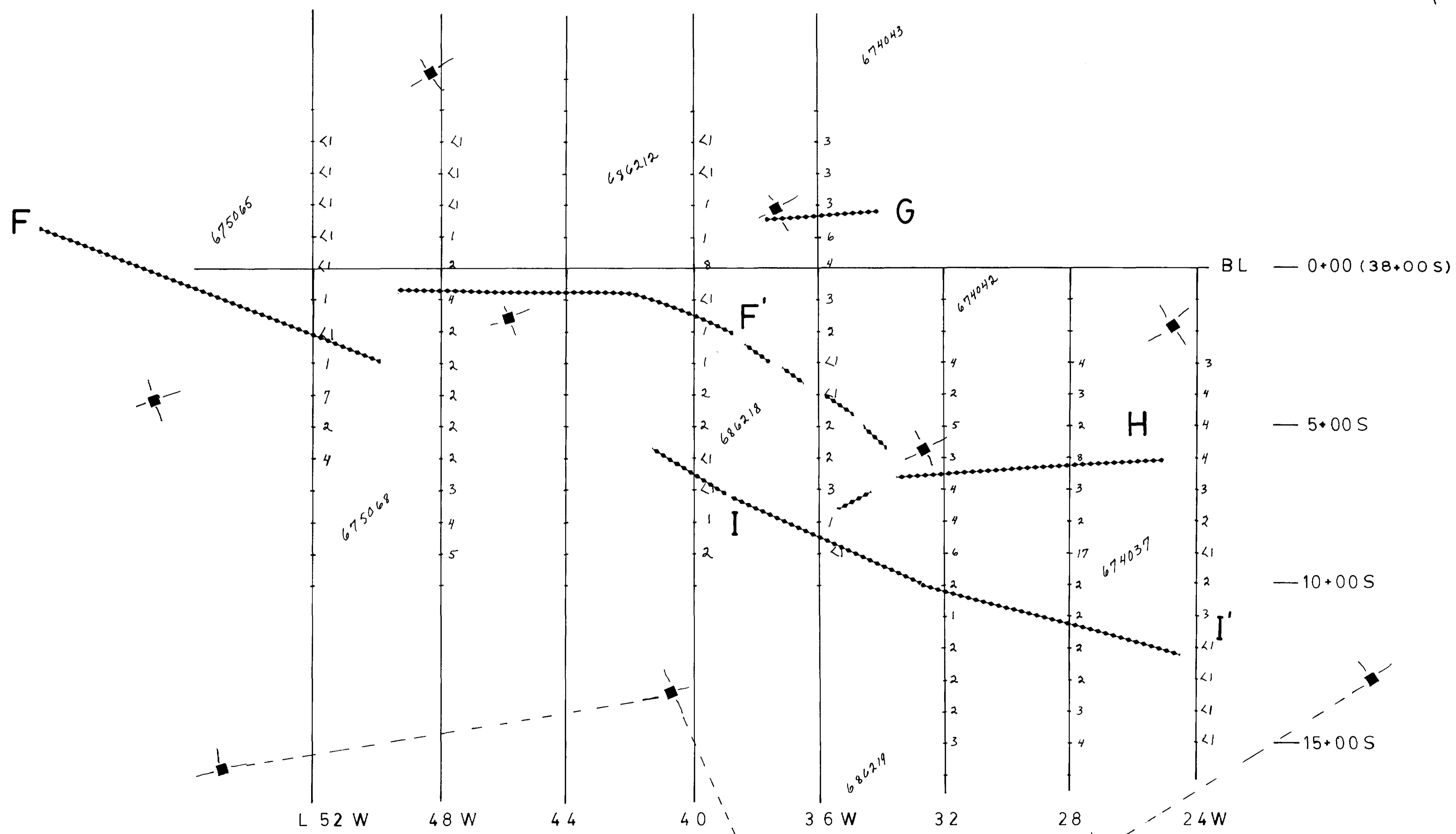
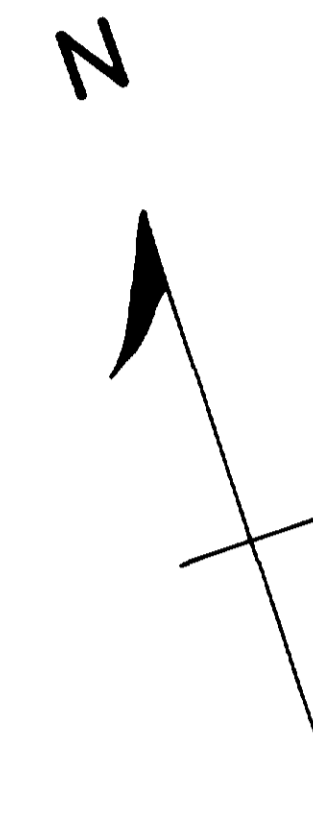

KILEMBE RESOURCES LTD

CASSEX OPTION - HEMLO AREA  
Theresa Lake Project

**pierre c. labrèque**  
ingénieur géologue - geological engineer

SOIL GEOCHEMISTRY  
G O L D  
(expressed in parts per billion-ppb)

EXECUTION Pierre LaBrèque, P.Eng. Terry Johnston, B.Sc.	DATE Sept. '85
---	-------------------

28794

INTERPRETATION Pierre LaBrèque, P.Eng.	
---	--

DESSIN P.L.	Oct. '85
----------------	----------

ECHELLE  
1" = 200' 0' 200' 400' 600' 800'

LATITUDES	LONGITUDES	NTS
-----------	------------	-----



