



42C15SW0007 OP92-428 ODLUM

010

**OPAP FINAL SUBMISSION
SUMMER 1992
DAYOHESSARAH LAKE AREA**

January 1993

Clark Geological Consulting



42C15SW0007 OP92-426 ODLUM

010C

TABLE OF CONTENTS

Location and Access 1

Regional Geology 4

Property Geology and Mineralization 5

Results 6

1992 OPAP Work 7

Conclusions and Recommendations 8

References 9

FIGURES:

- Figure 1 - Location Map
- Figure 2 - Property Outline

APPENDIXES:

- Appendix A - Assay Results
- Appendix B - Trench Data
- Appendix C - Daily Log

LOCATION AND ACCESS

The project area is located in the Wawa Area of the Sault Ste Marie Mining Division approximately 20 km northeast of White River, Ontario within the townships of Johns, Odlum and Cooper. NTS 42 C/11 with approximate latitude 49°00' and longitude 85°00'.

Access is via Domtar logging road north from the town of White River.

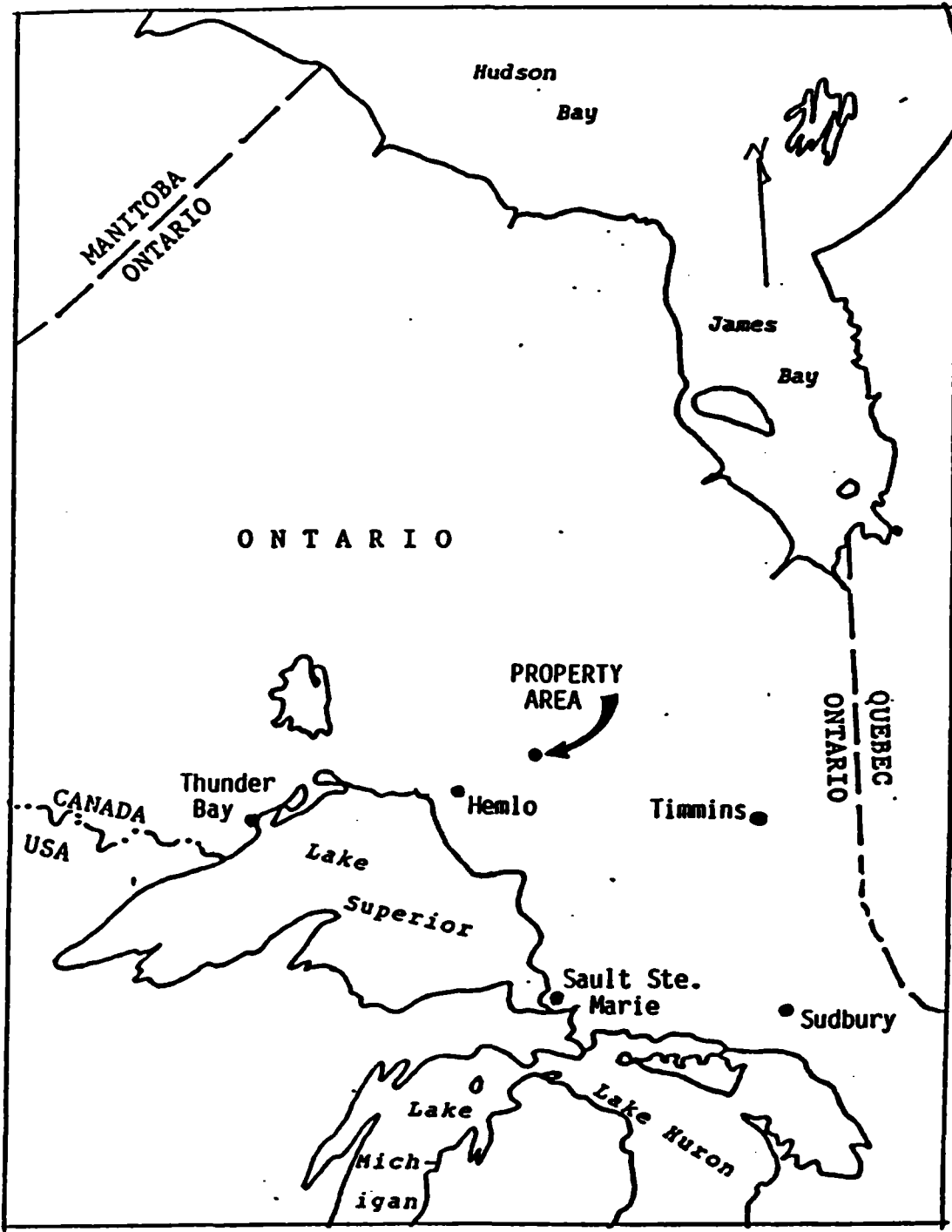
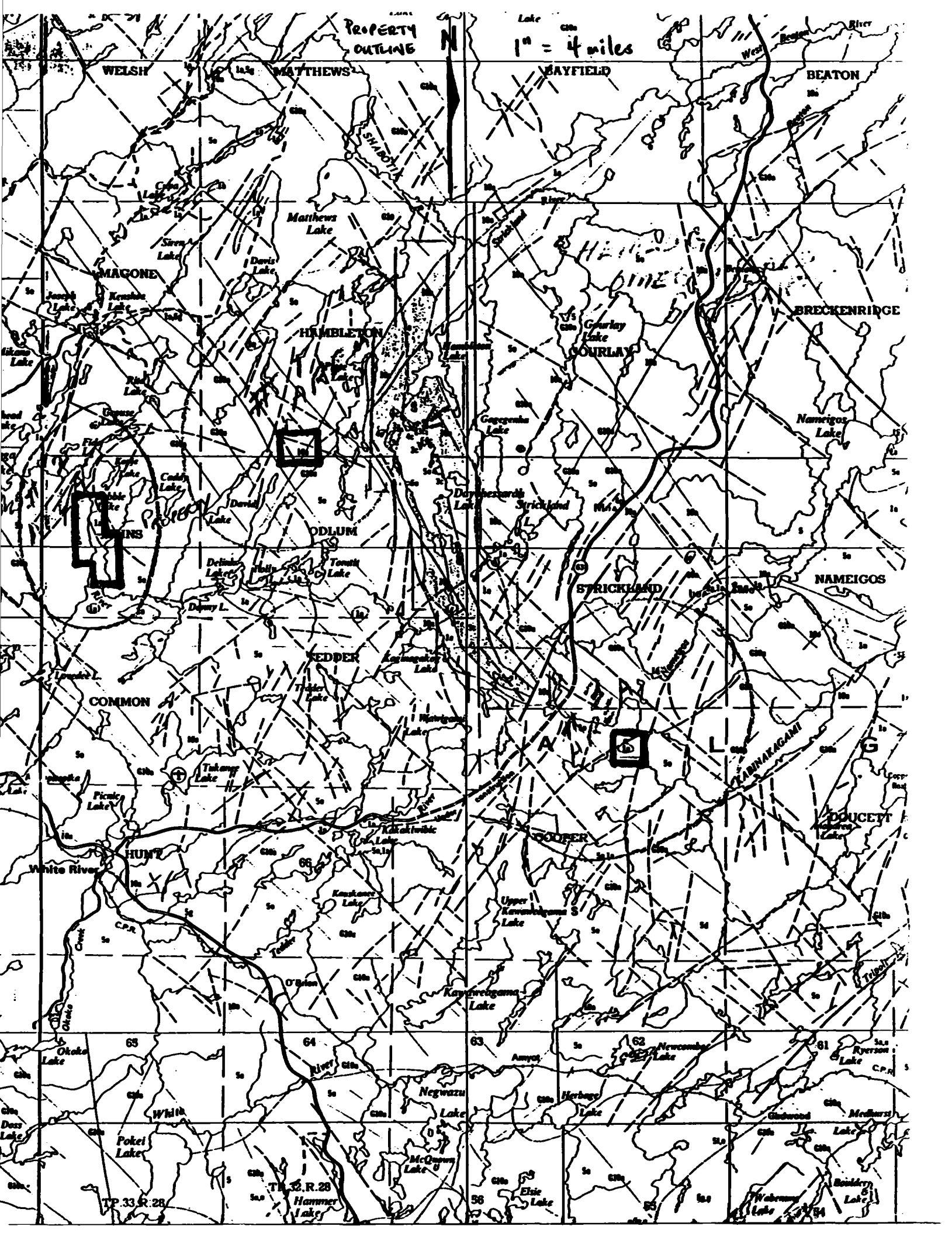

Figure 1: Location of the Property Area in Northwestern Ontario

FIG.1. LOCATION MAP



PROPERTY OUTLINE

1" = 4 miles



WELSH MATTHEWS HAYFIELD BEATON

MAGONE HAMBLETON COURLAY BRECKENRIDGE

ODLUM STRICKLAND NAMEIGOS

COMMON FEDDER STRICKLAND NAMEIGOS

HUNT COOPER

65 64 63 62 61

TP 33 R 28 TP 32 R 28 Hammer Lake

REGIONAL GEOLOGY

The area is located within the Wawa Sub-province and is comprised of massive to gneissic and locally migmatitic felsic intrusive rocks enclosing isolated packages of greenstone terrain. The isolated greenstone terrain around Dayohessarah Lake is underlain by metavolcanics and metasediments that form a narrow belt approximately 4 km wide and 35 km long.

PROPERTY GEOLOGY AND MINERALIZATION

- Johns Township:** The property is underlain by an isolated package of greenstone rocks comprising of basic to intermediate metavolcanic composition. Within these metavolcanic rocks are massive sulphides (pyrite, magnetite) which were trenced under the 1992 OPAP program.
- Cooper Township:** This property is also underlain by an isolated package of greenstone rocks. The rocks are of amphibolite or amphibolite schist in composition with sulphides associated.
- Hambelton Township:** This property is predomiantly underlain by blotite granite gneiss. Minor massive sulphides are observed in local areas along lineaments.

RESULTS

The best results of this summers work came from the Johns Township property where a rock sample of pyritic, green mica-bearing sericite schist assayed 0.181 oz Au/ton and .61% molybdenum. Doug McKay of the Ministry of Northern Development and Mines (Thunder Bay), who had this sample assayed for Peter, believed the mineralization to be very similar to that found in the ore bodies at Hemlo. Upon Doug McKay's suggestion that he do a field observation of this showing, Peter showed him around his properties. A possible location for which this sample would have been derived was not found.

Results of other sampling returned low results in gold, silver, coper, zinc, lead, molybdenum and nickel.

1992 OPAP WORK

This past summer all three areas received prospecting, trenching, blasting and sampling. A number of areas of interest were uncovered. These areas were later blasted, trenched and sampled to better expose and determine the economic significance of them. The mineralization was usually in the form of pyrite, chalcopyrite and sphalerite within rafted greenstone terrains. The sulphide showings proved to be very interesting and will need further work in the future.

CONCLUSION AND RECOMMENDATIONS

Although a considerable amount of time was spent uncovering the showing discovered this past summer, more trenching will be needed in the coming year to better expose them. Also more sampling will be needed to fully evaluate the potential of these sulphide zones. Because of this, another OPAP grant will be applied for to financially assist in further exploration work of these areas.

REFERENCES

Fenwick, K.G.; Geology of the Dayohessarah Lake Area, Ontario Department of Mines, Geological Report 49, 1967

APPENDIX A
ASSAY RESULTS



Ministry of
Northern Development
and Mines

Temiskaming
Testing
Laboratories

P.O. Box 799
Presley St.
Cobalt, Ontario
P0J 1C0
(705) 679-8313

Report Number

CB 12199

Laboratory Report

Date Sept. 8, 1992.

Issued To: Doug McKay, MINDM, P.O. Box 5000, Thunder Bay, Ont. P7C 5G6

Sample Number	Gold Oz. Per Ton	Silver Oz. Per Ton	Cu Ppm	Pb Ppm	Zn Ppm	Ni Ppm	Pd Ppb
92-DDM-01	Trace		187		1560		
92-DMS-01	Trace	Nil	567	111	1880		
92-DMS-02	Nil	Nil	411	24	4040		
92-DGR-02	Trace		129		49		
92-DGR-03	Trace		811		27	592	124
2-finger Lake { 92-DBM-92	Nil		26		105		
92-DBM-95	Nil		93		37		
92-DBM-96	Nil		173		42		
4ber { 92-DBM-97	Nil	Nil	(315)	<10	28		
92-DBM-99	Nil		106				
92-DBM-101	Nil		132				
Russel's Lakes { 92-DBM-103	Nil		270				
6er { 92-DBM-106	Nil		56				

315 ppm = 0.0315 %

RECEIVED
SEP 15 1992
REGISTRY

Charged to Cost Code 05-3536

D. McKay
for Manager

Except by special permission, reproduction of these results must include any
qualifying remarks made by this ministry with reference to any sample.



WAWA ASSAYING INC.

P.O. Box 1998 - Wawa, Ontario POS 1K0 - 705-856-4443
127 Mission Road Fax - 705-856-2902

CERTIFICATE OF ANALYSIS

NO. 100

CLIENT: Ann Wilson

DATE: October 8, 1992

PROJECT: COPPER TWP

Ref: 921008-1051

TYPE OF ANALYSIS: Au - fire assay, A.A. finish

Elements - A.A.

SAMPLE NO.	Au ppb	Ag ppm	Cu ppm	Zn ppm	Pb ppm	Ni ppm
920901 SAMPLE 1A	8	1.0	141	51	105	69
920902 SAMPLE 2A	162	2.4	52	395	302	39

Certified By: 



WAWA ASSAYING INC.

P.O. Box 1998 - Wawa, Ontario P0S 1K0 - 705-856-4443
127 Mission Road Fax - 705-856-2902

CERTIFICATE OF ANALYSIS

NO. 1027

CLIENT: Mr. Alfred Nabigon

DATE: October 9, 1994

PROJECT: *COOPER TWP.*

Ref: 921009-1

TYPE OF ANALYSIS: Au - fire assay, A.A. finish

Elements - A.A.

SAMPLE NO.	Au ppb	Ag ppm	Cu ppm	Zn ppm
1A	5	1.1	213	58
2A	6	1.4	57	68

Certified By: 



ACCURASSAY LABS
A DIVISION OF ASSAY LABORATORY SERVICES INC.
1070 LITHIUM DRIVE, UNIT 2
THUNDER BAY, ONTARIO P7B 6G3
(807) 623-6448 FAX 623-6820

Mr. John Nabigon
96 South Algoma St, Apt. #1
Thunder Bay, ON
P7B 3B5

14-Oct-92

Page: 1
Status: Final

Attn: Mr. Nabigon
Job: 924729T

Received: 8-Oct-92

Rock Samples

Sample	Au FA/AA3 ppb	Cu AA ppm	Ni AA ppm	Zn AA ppm
FR1	44	200	51	43
46R	200	81	40	60



ACCURASSAY LABS

A DIVISION OF ASSAY LABORATORIES SERVICES INC.

1070 LITHIUM DRIVE, UNIT 2
THUNDER BAY, ONTARIO P7B 6G3
(807) 623-6448 FAX 623-6820

16-Sep-92

John Nabigon
96 South Algoma Street Apt. #1
Thunder Bay, ON

Page: 1
Copy: 2 of 2
Set: 1

Attn: Mr. John Nabigon
Project: *46R*

Received: 31-Aug-92 15:01

PU #:

Job: 9245521

Status: Final

Rock Samples

Sample	Au FA/AA3 ppb	Ag AA ppm	Cu AA ppm	Mo ICAP ppm
PNW#1	5	0.8	226	2



Ministry of
Northern Development
and Mines

Temiskaming
Testing
Laboratories

P.O. Box 799
Presley St.
Cobalt, Ontario
P0J 1C0
(705) 679-8313

Report Number
CB 12085

Laboratory Report

Date June 30, 1992.

Issued To: Doug McKay, Resident Geologist Office, MNDM, P.O. Box 5000, Thunder Bay, Ont. P7C 5G6

Sample Number	Gold Oz. Per Ton	Silver Oz. Per Ton	Cu Ppm	Zn Ppm	Pb Ppm	Mo Ppm	Na2O Ppm	Pd Ppm
92-DPN-01	0.181		23	450		6100		
92-DBM-02	0.007							
92-DBM-06	0.003		158	128				
92-DAT-07	Trace	0.36	3560	63	<10		4826	<10
92-DBM-07	N11	Trace	3160	54	<10			<10
92-DBM-08	Trace		114	27				
92-DBM-09	Trace		69	30				
92-DBM-10	0.003		148	78				
92-DGG-02	0.005		13	132				
92-DGG-04	N11		53	640				
92-DGG-06	Trace		13	204				
92-DBM-11	0.002		13	36				
92-DBM-12	Trace		21	35				
92-DBM-13	0.012		14	24				
92-DBM-14	Trace		10	18				
92-DBM-15	0.002		106	46				
92-DBM-16	Trace		13	41				
92-DBM-17	N11		14	26				
92-DBM-18	N11		19	37				
92-DBM-19	0.016		644	64	<10			
92-DBM-20	N11		278	184				
92-DBM-21	0.004		620	93				
92-DBM-23	Trace		224	92				
92-DBM-24	N11	N11	273	103	<10			
92-DBM-25	N11	Trace	265	122	<10			
92-DAT-08	Trace		57	66				
92-DAT-09	Trace		367	1180				
92-DAT-10			152					
92-DGR-01	Trace		13	42				<10

46R
C10011

RECEIVED
JUL 07 1992

J. Ireland
A/ Manager

Except by special permission, reproduction of these results must include any qualifying remarks made by this ministry with reference to any sample.



Ontario

Ministry of
Northern Development
and Mines

Ministère du
Développement du Nord
et des Mines

August 17, 1992

Mr. Peter Nabigon
96 S. Algoma Street
Thunder Bay, Ontario
P7B 3B5

Dear Peter:

The attached assay results are for the sample of pyritic, green mica-bearing sericite schist you collected from the Dayohessarah Lake area and submitted to me for analysis earlier this summer (92-DPN-01). The analysis indicated the presence of significant gold (0.181 oz Au/ton) and molybdenum (0.61%).

The mineralization in your sample is very similar to that found in the ore bodies at Hemlo.

If possible, I would like to visit the area from which you collected this sample to help you determine the size and nature of the mineralization on your property. Please let me know, as soon as possible, if you would be willing to accompany me on such a visit. All costs would be paid by the Ministry of Northern Development and Mines.

Sincerely,

Doug McKay
Manitouwadge Mineral Resource Geologist
Schreiber-Hemlo District
Mines and Minerals Division
Ministry of Northern Development and Mines
P. O. Box 5000
Thunder Bay, Ontario
P7C 5G6
Tel. (807)475-1331
Fax (807)475-1112

DM/sew

Attach.

APPENDIX B
TRENCH DATA

AREA # 1
HAMBLETON TWP.
ODLUM TWP.

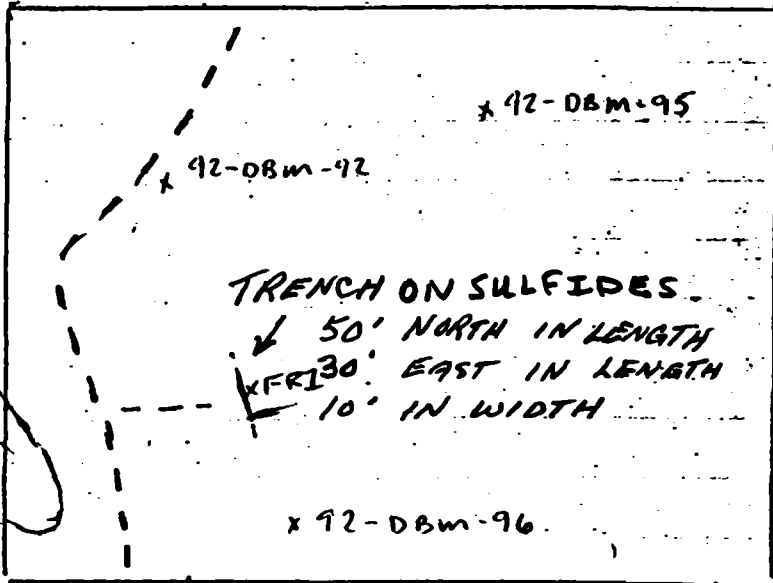

TRENCH ON SULFIDES.
↓ 50' NORTH IN LENGTH
← 30' EAST IN LENGTH
↓ 10' IN WIDTH

HAMBLETON TWP.
ODLUM TWP.

1" = 1/4 mile

DOMTAR
ROAD

AREA # 2
JOHNS TWP.
(46R)

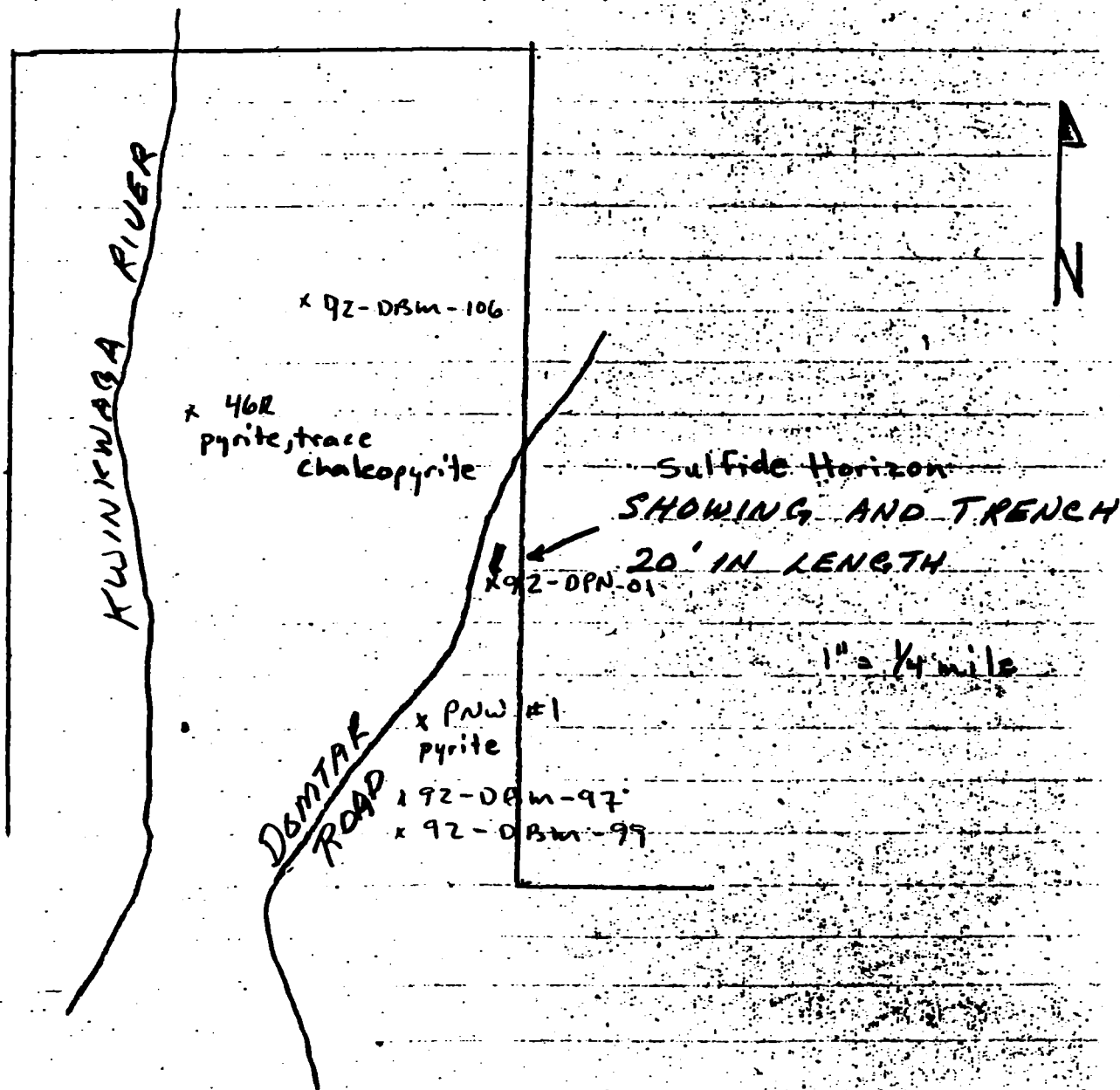

AREA # 3
COOPER TWP.

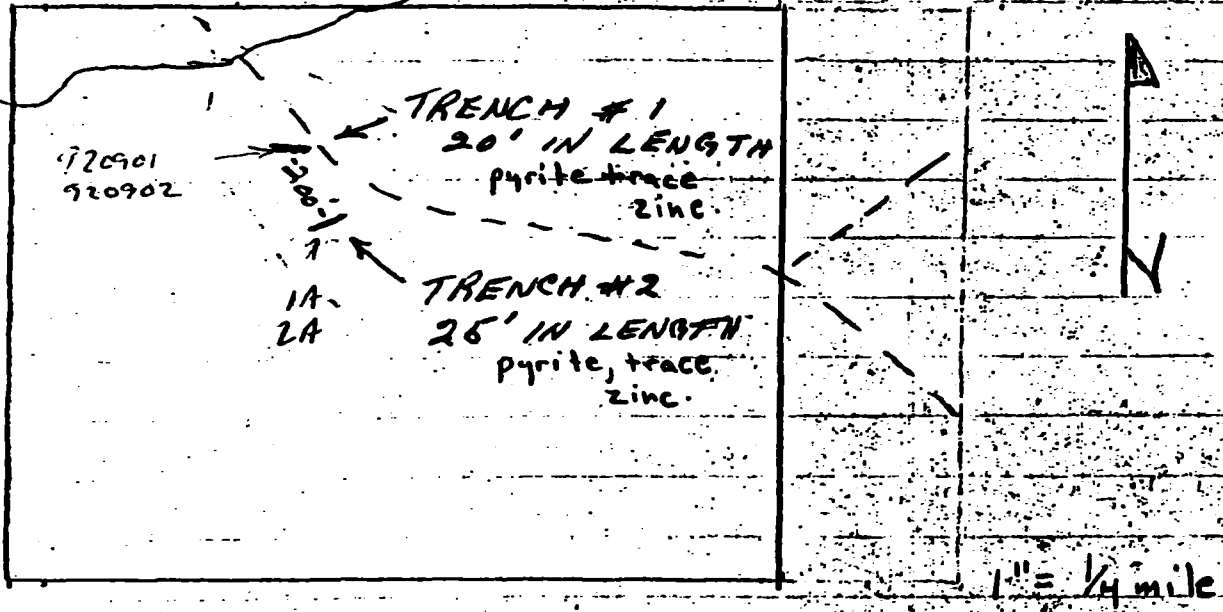

APPENDIX C
DAILY LOG

AREAS WITHDRAWN FROM DISPOSITION

M.R.O. - MINING RIGHTS ONLY
 S.R.O. - SURFACE RIGHTS ONLY
 M.+S. - MINING AND SURFACE RIGHTS

Description Order No. Date Disposition File

F.O. FILED ONLY

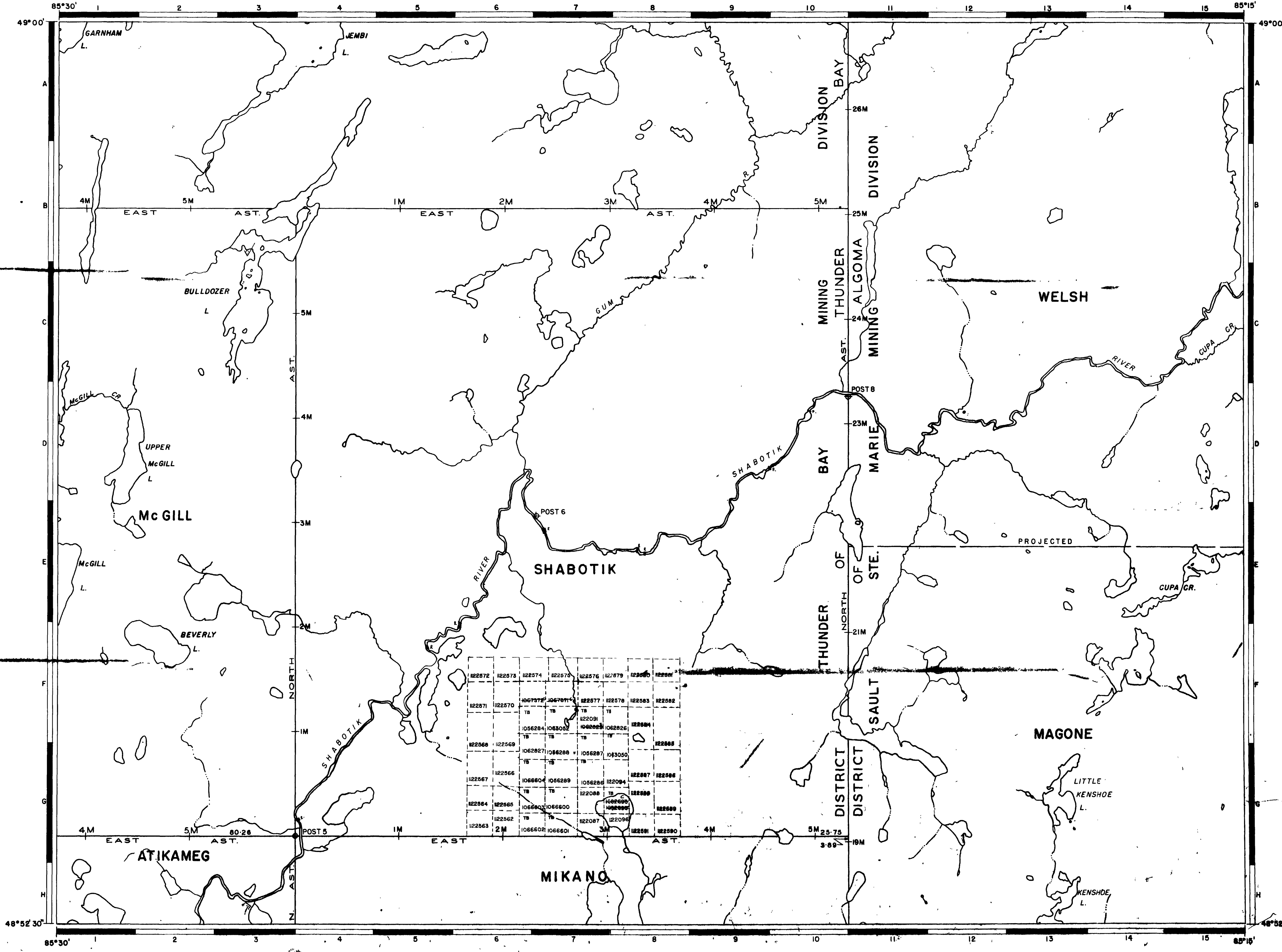

- HIGHWAY AND ROUTE
- OTHER ROADS
- TRAILS
- SURVEYED LINES
- TOWNSHIPS, EASE LINES
- LOTS, MINING
- UNSURVEYED LINES
- LOT LINES
- PARCEL BOUNDARY
- MINING CLAIMS ETC.
- RAILWAY AND RIGHT OF WAY
- UTILITY LINES
- NON-PERENNIAL STREAM
- FLOODING OR FLOODING
- SUBDIVISION OR COMBINATION
- RESERVATIONS
- ORIGINAL SHORELINE
- MARSH OR MUSKELINE
- MINES
- TRAVERSE MONUMENT

DISPOSITION OF CROWN LANDS

TYPE OF DOCUMENT	SYMBOL
PATENT, SURFACE & MINING RIGHTS	●
SURFACE RIGHTS ONLY	○
MINING RIGHTS ONLY	◐
LEASE SURFACE & MINING RIGHTS	◑
SURFACE RIGHTS ONLY	◒
MINING RIGHTS ONLY	◓
LICENCE OF OCCUPATION	◔
ORDER-IN-COUNCIL	◕
RESERVATION	◖
CANCELLED	◗
SAND & GRAVEL	◘
LAND USE PERMITS FOR COMMERCIAL TOURISM OUTPOST CAMPS	◙

NOTE: MINING RIGHTS IN PARCELS PATENTED PRIOR TO MAY 1913 VESTED IN ORIGINAL PATENTEES BY THE MINING LANDS ACT, R.S.O. 1970, CHAP. 280, SEC. 89, SUBSECTION 1.

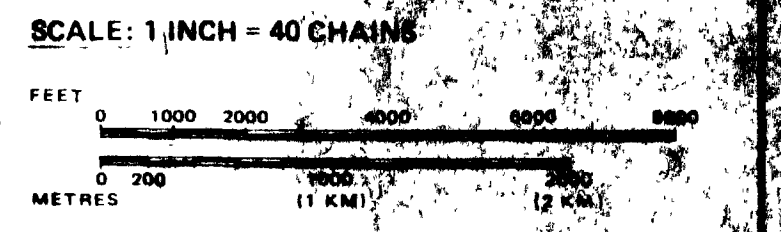

OP92-426

1982 FEB 15 AM 1 04
 MINING DIVISION

THE INFORMATION THAT APPEARS ON THIS MAP HAS BEEN COMPILED FROM VARIOUS SOURCES AND ACCURACY IS NOT GUARANTEED. THOSE WISHING TO MAKE MINING CLAIMS SHOULD CONSULT WITH THE MINING RECORDER, MINISTRY OF NORTHERN DEVELOPMENT AND MINES.

AREA
SHABOTIK RIVER
 M.N.R. ADMINISTRATIVE DISTRICT
WAWA
 MINING DIVISION
 THUNDER BAY/SAULT STEPHEN
 LAND TITLES / REGISTRY DIVISION
 THUNDER BAY/ALGOMA

Ministry of Natural Resources
 Ministry of Northern Development and Mines

Date: FEBRUARY, 1987



REFERENCES

AREAS WITHDRAWN FROM DISPOSITION

- M.R.O. - MINING RIGHTS ONLY
- S.R.O. - SURFACE RIGHTS ONLY
- M + S. - MINING AND SURFACE RIGHTS

Description Order No Date Disposition File

CHOLLETTE TWP G-2298

WELSH TWP G-2830

BAYFIELD TWP G-1835

HAMBLETON TWP G-2768

LEGEND

- HIGHWAY AND ROUTE No
- OTHER ROADS
- TRAILS
- SURVEYED LINES
- TOWNSHIPS, BASE LINES, ETC
- LOTS, MINING CLAIMS, PARCELS, ETC
- UNSURVEYED LINES
- LOT LINES
- PARCEL BOUNDARY
- MINING CLAIMS ETC
- RAILWAY AND RIGHT OF WAY
- UTILITY LINES
- NON PERENNIAL STREAM
- FLOODING OR FLOODING RIGHTS
- SUBDIVISION OR COMPOSITE PLAN
- RESERVATIONS
- ORIGINAL SHORELINE
- MARSH OR MUSKEG
- MINES
- TRAVERSE MONUMENT

DISPOSITION OF CROWN LANDS

TYPE OF DOCUMENT	SYMBOL
PATENT SURFACE & MINING RIGHTS	○
SURFACE RIGHTS ONLY	○
MINING RIGHTS ONLY	○
LEASE, SURFACE & MINING RIGHTS	■
SURFACE RIGHTS ONLY	■
MINING RIGHTS ONLY	■
LICENCE OF OCCUPATION	▽
ORDER IN COUNCIL	OC
RESERVATION	○
ANCELLED	○
SAND & GRAVEL	○

NOTE: MINING RIGHTS IN PARCELS PATENTED PRIOR TO MARCH 1873 VESTED IN ORIGINAL PATENTEE BY THE PUBLIC LANDS ACT R.S.O. 1970 CHAP. 380 SEC. 63 & 64.

SCALE 1 INCH = 40 CHAINS

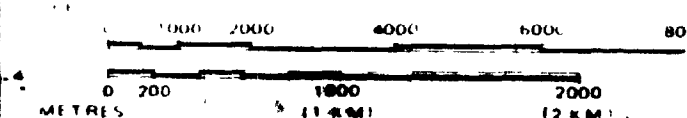

MINING RIGHTS REGISTER

JUL 1 1988

DATE OF ISSUE
JUL 6 1988
SAULT STE. MARIE
MINING REGISTRAR'S OFFICE

RECEIVED
JUL 10 1988

TOWNSHIP
MATTHEWS
M.N.R. ADMINISTRATIVE DISTRICT
WAWA
MINING DIVISION
SAULT STE. MARIE
LAND TITLES / REGISTRY DIVISION
ALGOMA

Ministry of Natural Resources
Land Management Branch
Ontario

DATED FEBRUARY, 1984

Number
G-2790

