



42C16NE8215 63.5303 HAWKINS

010

TRENCHING REPORT
ON THE
HAWKINS TOWNSHIP PROPERTY
FOR
AURLOT EXPLORATIONS LTD.

H. R. LAHTI
MATTAWA, ONTARIO

JULY 1989

INTRODUCTION

From June 12th to July 12th thirteen trenches were excavated within the grid. The trenches were cleaned, mapped and sampled. The trenching was done to evaluate geophysical and/or geochemical targets for Au mineralization.

A D-8 Caterpillar Bulldozer was rented from J. Raymond Poulin Ltd. rather than a back hoe because of difficult access to some of the trenches. However, in areas of wet clay and deep overburden the bulldozer could not excavate as deep as a back hoe.

Overall, the trenching verified the IP chargeability anomalies to be related to sulphides. Occasionally, diabase dykes were found to be coincident with parts of the IP anomaly. No large sulphide zones were discovered but small parallel sulphide shear zones gave a chargeability response over 30 millisecc's. In many of the trenches the rugged relief along the trench meant that not all of the bedrock could be exposed by the D-8 bulldozer.

Although trenching is a quick and relatively cheap method of evaluating IP and geochemical soil sample anomalies it is of limited use in areas of thick overburden or swamps.

TABLE 1

RESULTS OF TRENCHING

<u>TRENCH NO.</u>	<u>LOCATION</u>	<u>TARGET</u>	<u>RESULTS</u>
1	L8W/30N to 100N	Geochem Au Soil Anomaly	-Several small shear zones in mafic volcanic exposed; channel sampling gave negative results for Au.
2	L17W/350S to 425S	Very strong IP; mag, weak Au in rock samples high Cu +py-po	-Areas with highest IP could not be exposed. Rest of trench; silicified shears with low level Au conc., anomalous Cu, py-po. Sulphide zones narrow.

TABLE 9 continued

<u>TRENCH NO.</u>	<u>LOCATION</u>	<u>TARGET</u>	<u>RESULTS</u>
3	L16+90W-L16+60W 3+95S -4+25 S	IP Chargeability Anomaly	-only weak shear in mafic volcanics exposed; weakly silicified-parts of trench not exposed due to deep overburden minor sulphides.
4	L16+50W-L16+30W 420S to 440S	IP Chargeability Anomaly	- narrow sulphide rich silicified shear zone exposed, main part of IP anomaly not exposed due to overburden
5	Tieline 1500 S 9+85E-10+25E	IP+ Anomalous Geochem Grab Sample (45 ppb Au) and 820 ppm Cu)	- no significant rich shear zone found. mainly massive amphib. with po and py; east part of trench did not reach bedrock
6	L9E/1500 S to 1445 S	Moderate IP visible rusty zones in OTC	- no wide sulphide zones were exposed, no signif. Au. mineralization was found
7	L7E/13855 to 1450 S	Weak IP, Rusty zones found during mapping	- narrow weakly pyritized zones; no significant Au.
8	L7E/1225 S to 1250 S	On point Au soil Anomaly, rock grab sample with 6 ppb Au. 560 ppm Cu.	- no major sulphide shear zone uncovered narrow zones with py cpy & mica, only part of trench exposed OTC.
9	L17W/0+00 to 0+35N	Strong IP anomaly weak Au soil anom.	- background levels of Au found; geochem analysis in Cu (70-346 ppm) and Zn (180-920 ppm) in narrow, folded sulphide zones.

TABLE 9 continued

<u>TRENCH NO.</u>	<u>LOCATION</u>	<u>TARGET</u>	<u>RESULTS</u>
10	L16W/265N to 325 N	Anomalous Au in rock samples (17-49 ppb) Au soil anomaly good IP anomaly	-minor narrow sulphide shear zones uncovered felsic-sericite schist unit with Au. very limited extent - above units anomalous in Cu. and Zn
11	L19W/235N to 300 N	IP Anomaly on strike from Au soil anomalies	-poorly exposed Ep. rich breccia zone with tr. cpy; minor sulphide zones; areas with highest sulphide possibly hidden under deep overburden
12	L57W/125 S to 300 S, (old grid) Between L0+50W/ L1+00W about 100M S of B.L.	Very strong IP anomaly Au-Cu anomaly in soil	-wide spread sulph. py, po, cpy erratic distrib. Ep + cpy float dug up sample gave weak geochem. anomalous Au (3ppb)
13	L3E/240 S to 300 S	Good Au Soil Anomaly 5-25 ppb high background IP anomaly	-no major alteration or shear zone uncovered. weak sulphide mineralization

100N

75N

50N

25N

L8W

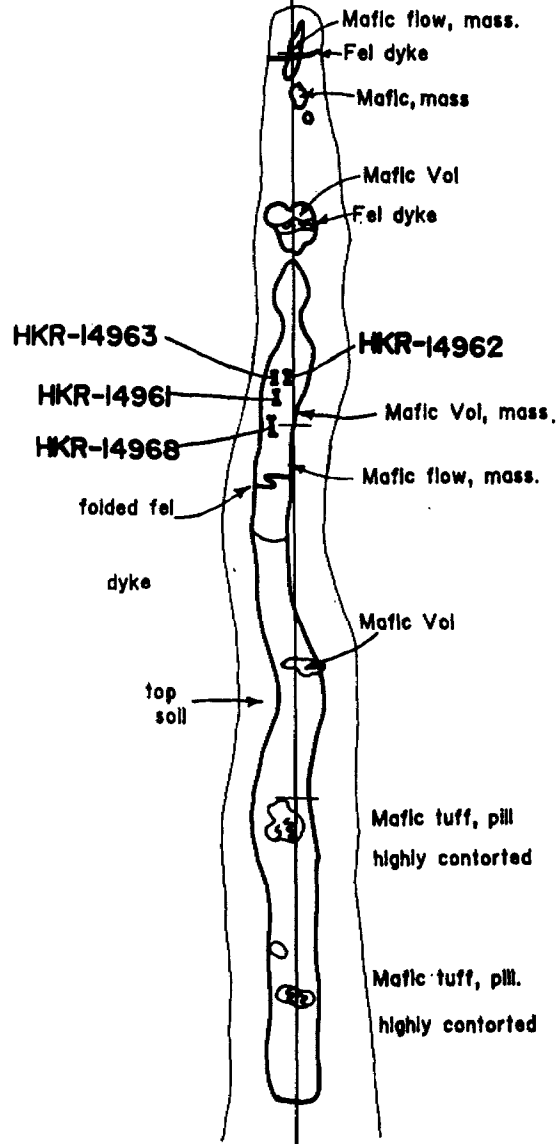

CHANNEL SAMPLES

- HKR-61
- HKR-62
- HKR-63

GRAB SAMPLE

- HKR-68

DURHAM GEOLOGICAL SERVICES INC.		
For: AURLOT EXPLORATION LTD.		
Title: TRENCH-89-1 L8W (25N-100N)		
Date: SEPT 89	Drawn: C.G.	Scale: 1:500
NTS: 42C,42F	Approved:	Fig.:

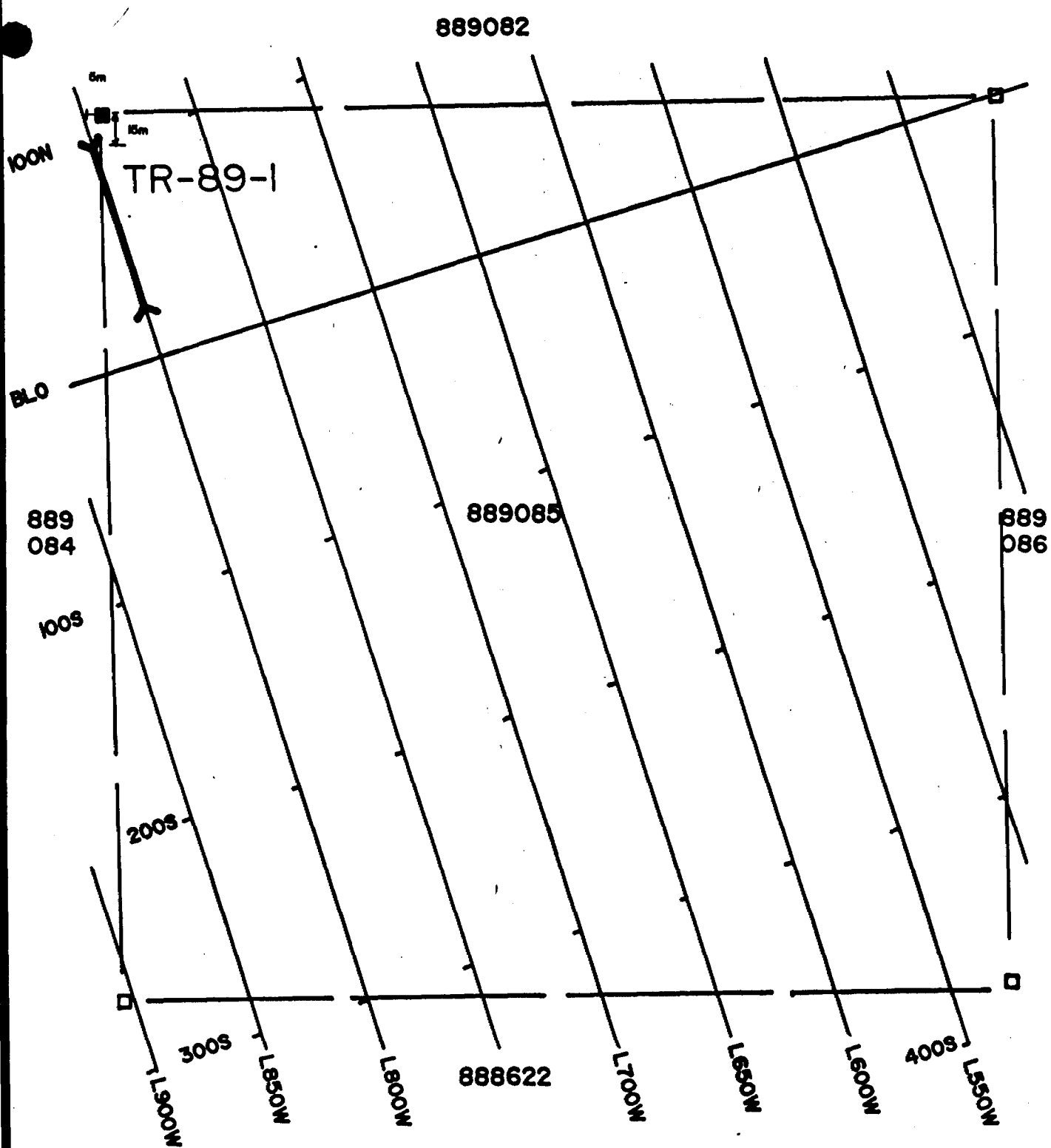

REVISIONS	DURHAM GEOLOGICAL SERVICES INC.		
	For:	AURLOT EXPLORATIONS LTD.	
	Title:	TRENCH LOCATION MAP	
		TR-89-1	
	Date: Sept 1989	Drawn: C.G.	Scale: 1 : 2500
	Job No.:	Approved:	Flt.:

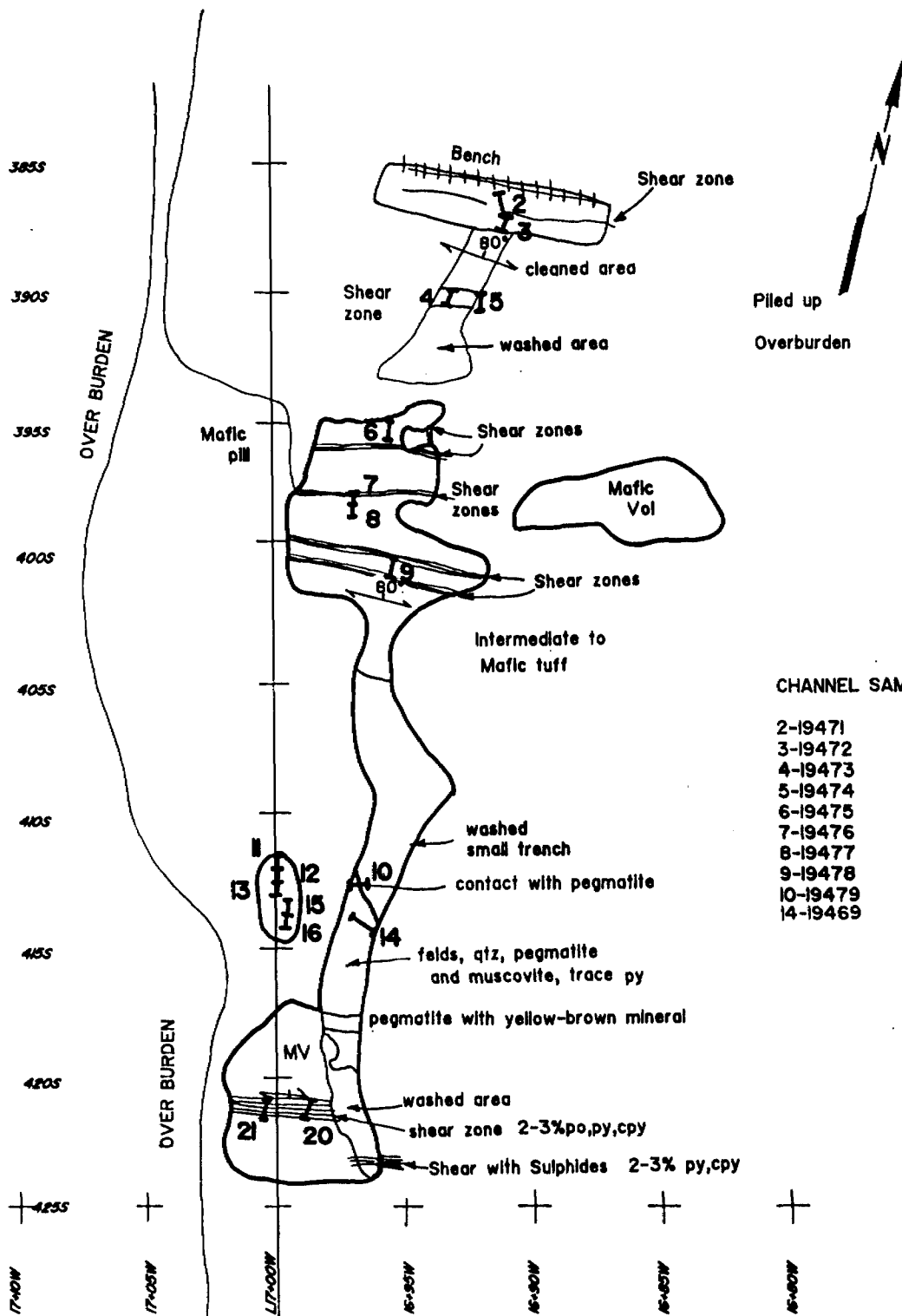

CHANNEL SAMPLES

2-19471	11-15502
3-19472	12-15503
4-19473	13-15504
5-19474	15-15505
6-19475	16-15506
7-19476	20-15507
8-19477	21-15508
9-19478	
10-19479	
14-19469	

DURHAM GEOLOGICAL SERVICES INC.		
For: AURLOT EXPLORATION LTD.		
Title: TRENCH-89-2(d) LI7W (385S-425S)		
Date: SEPT 89	Drawn: C.G.	Scale: 1:250
NTS: 42C,42F	Approved	Fig:

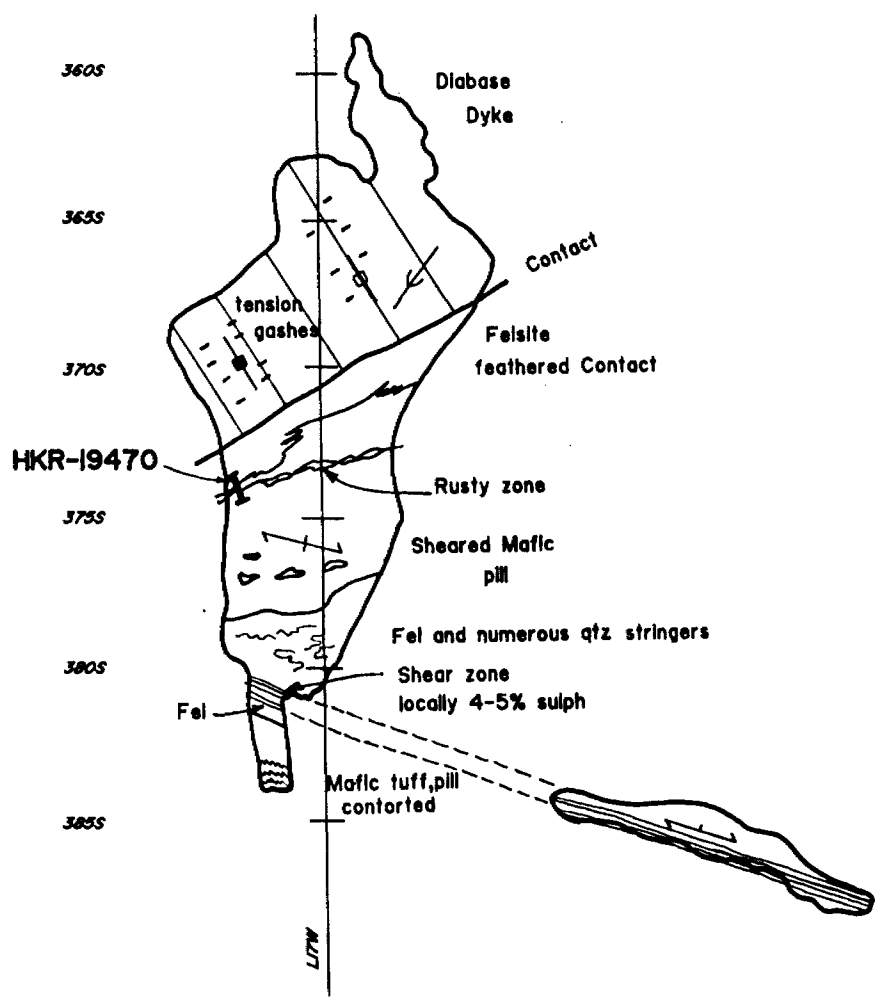

DURHAM GEOLOGICAL SERVICES INC.		
For:	AURLOT EXPLORATION LTD.	
Title:	TRENCH-89-2(b) LI7W (390S-360S)	
Date:	SEPT 89	Drawn: C.G.
NTS:	42C,42F	Scale: 1:250
	Approved:	Fig:

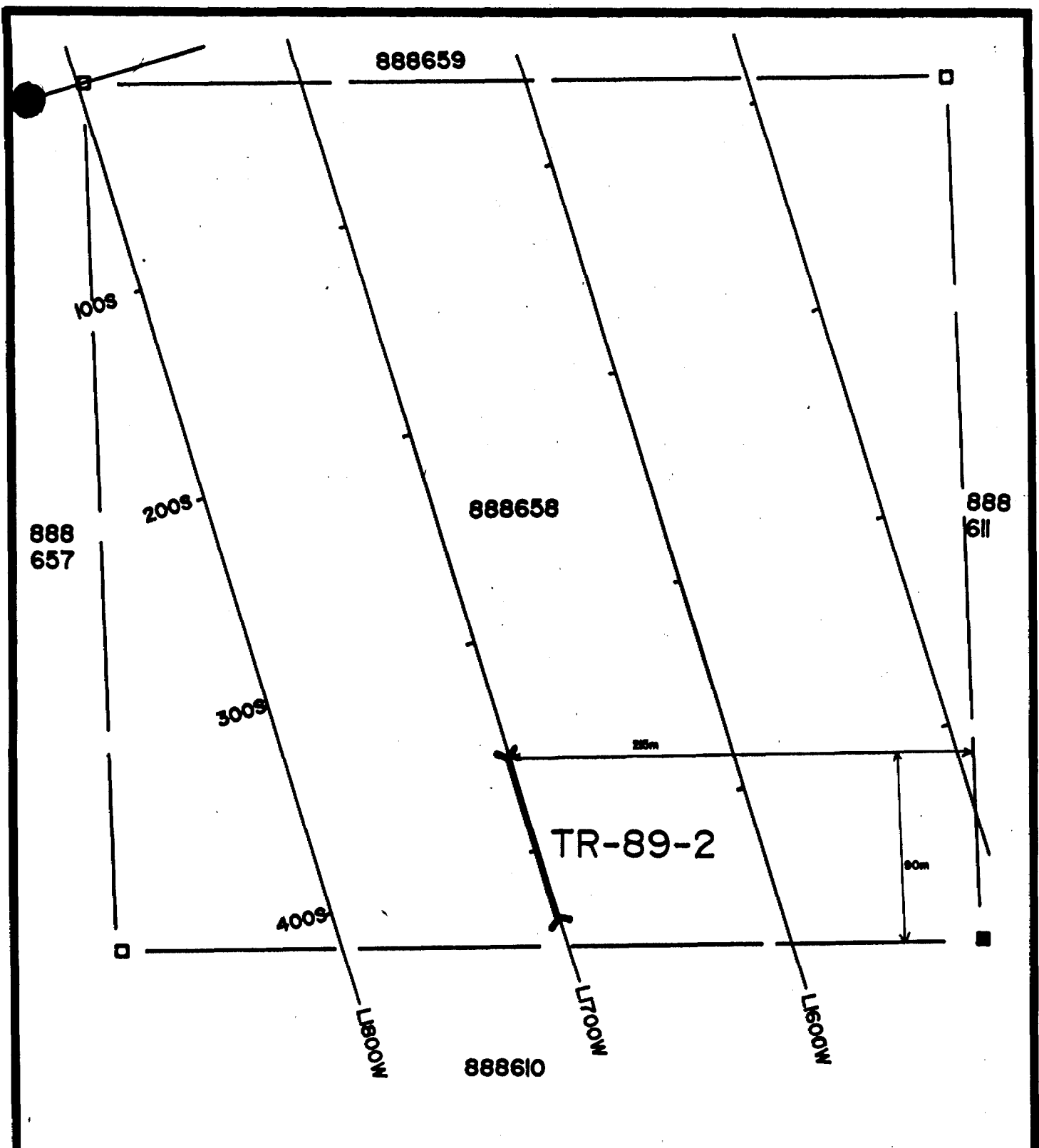

REVISIONS	DURHAM GEOLOGICAL SERVICES INC.		
	<i>For:</i> AURLOT EXPLORATIONS LTD.		
	<i>Title:</i> TRENCH LOCATION MAP		
	TR-89-2		
	<i>Date:</i> Sept 1989	<i>Drawn:</i> C.G.	<i>Scale:</i> 1 : 2500
	<i>Job No.:</i>	<i>Approved:</i>	<i>Fig.:</i>

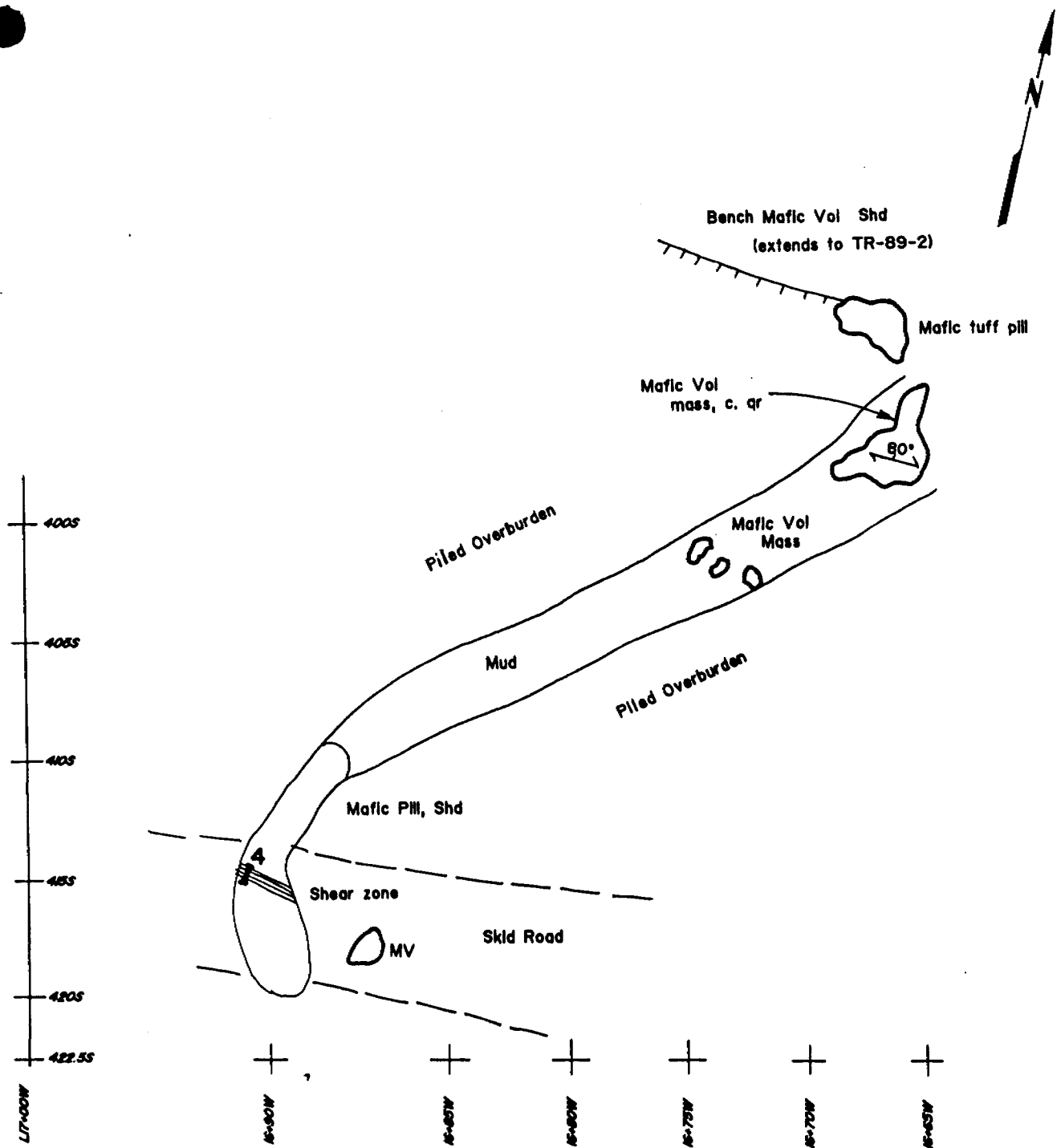

CHANNEL SAMPLE
4-15522

DURHAM GEOLOGICAL SERVICES INC.		
For: AURLOT EXPLORATION LTD.		
Title: TRENCH-89-3		
Date: SEPT 89	Drawn: C.G.	Scale: 1:250
NTS: 42C,42F	Approved	Fig:

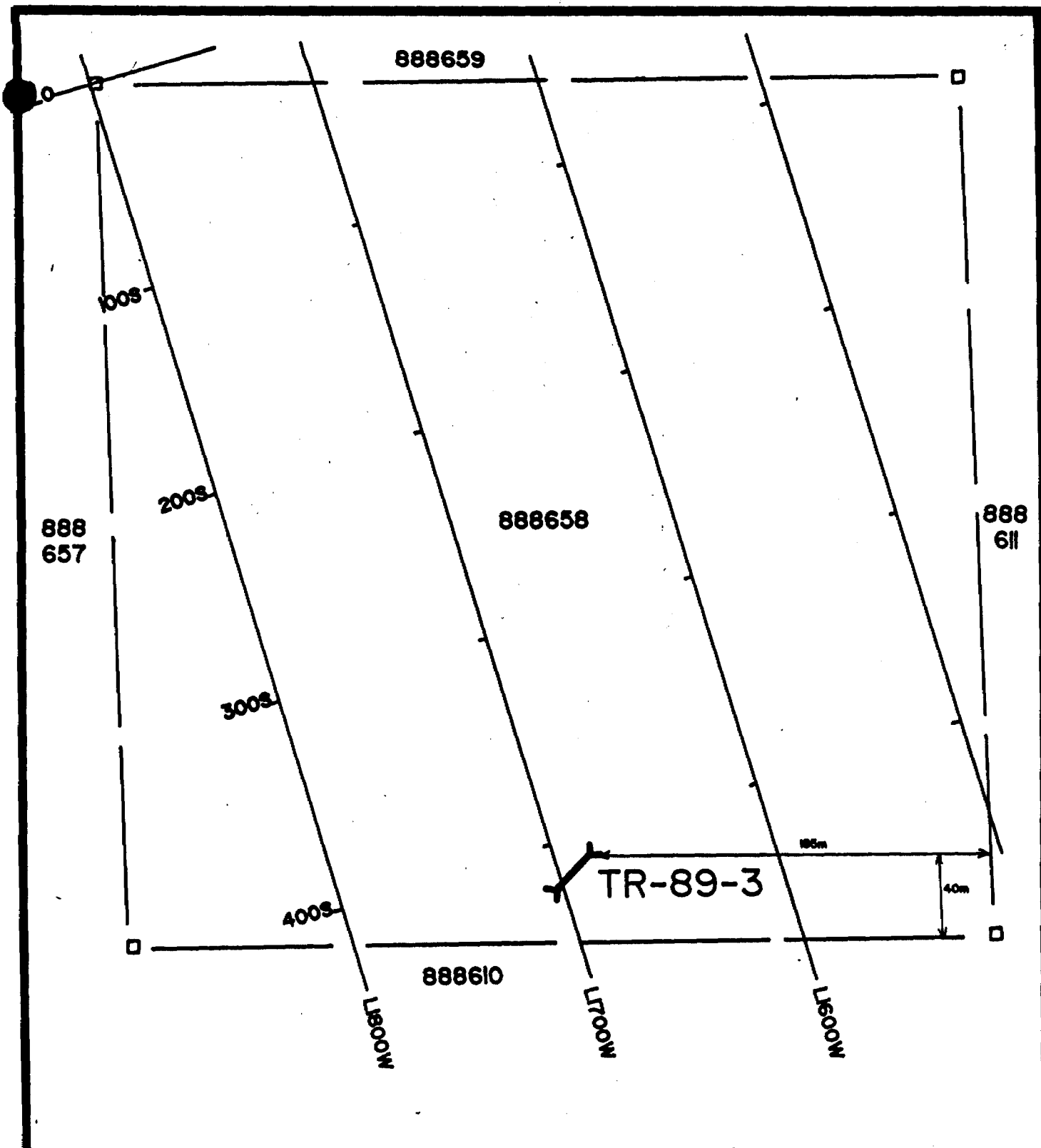

REVISIONS	DURHAM GEOLOGICAL SERVICES INC.		
	For:	AURLOT EXPLORATIONS LTD.	
	Title:	TRENCH LOCATION MAP	
		TR-89-3	
	Date:	Sept 1989	Drawn: C.G.
	Job No.:		Scale: 1 : 2500
		Approved:	Fig:

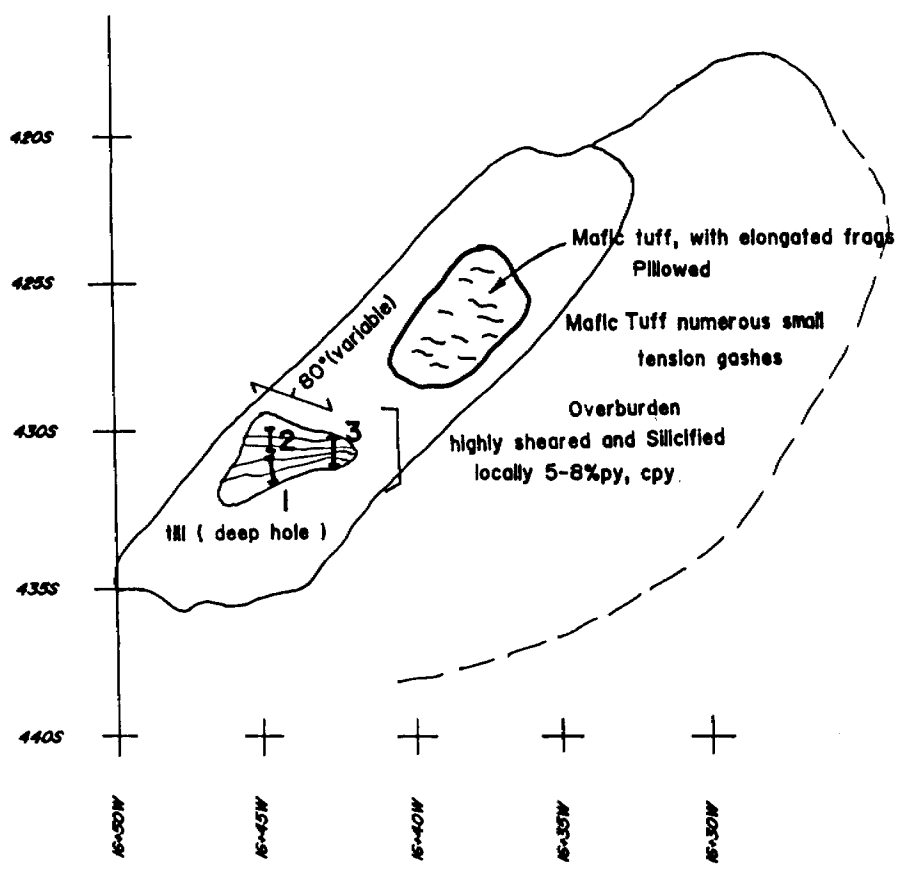

CHANNEL SAMPLES

- 1-15519
- 2-15520
- 3-15521

DURHAM GEOLOGICAL SERVICES INC.		
For:	AURLQT EXPLORATION LTD.	
Title:	TRENCH-89-4	
Date:	SEPT 89	Drawn: C.G.
Scale:	1:250	
NTS:	42C,42F	Approved:
		Fig.:

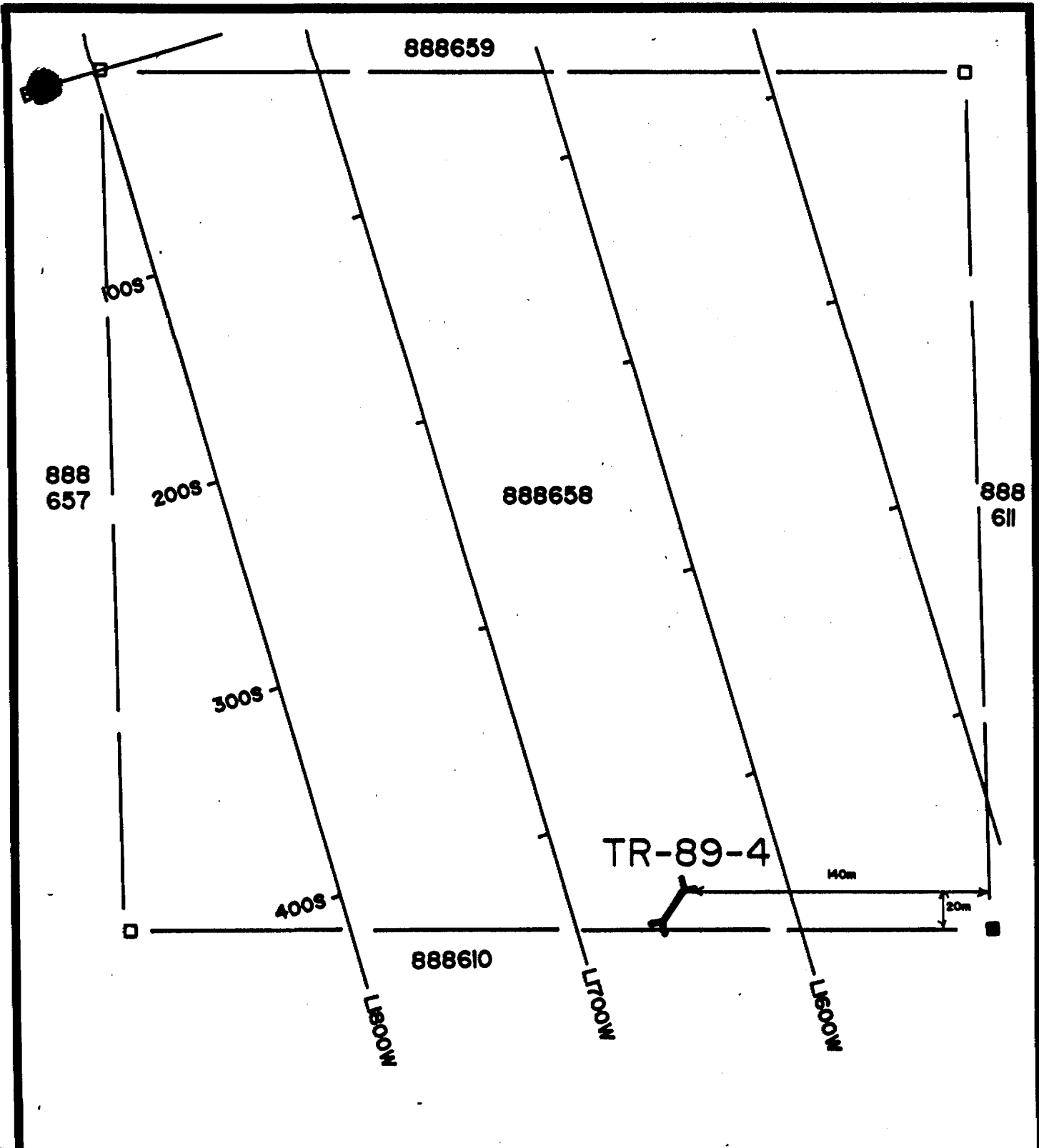

REVISIONS	DURHAM GEOLOGICAL SERVICES INC.		
	For:	AURLOT EXPLORATIONS LTD.	
	Title:	TRENCH LOCATION MAP	
		TR-89-4	
	Date:	Sept 1989	Drawn: C.G.
			Scale: 1 : 2500
	Job No.:	Approved:	Fig.:

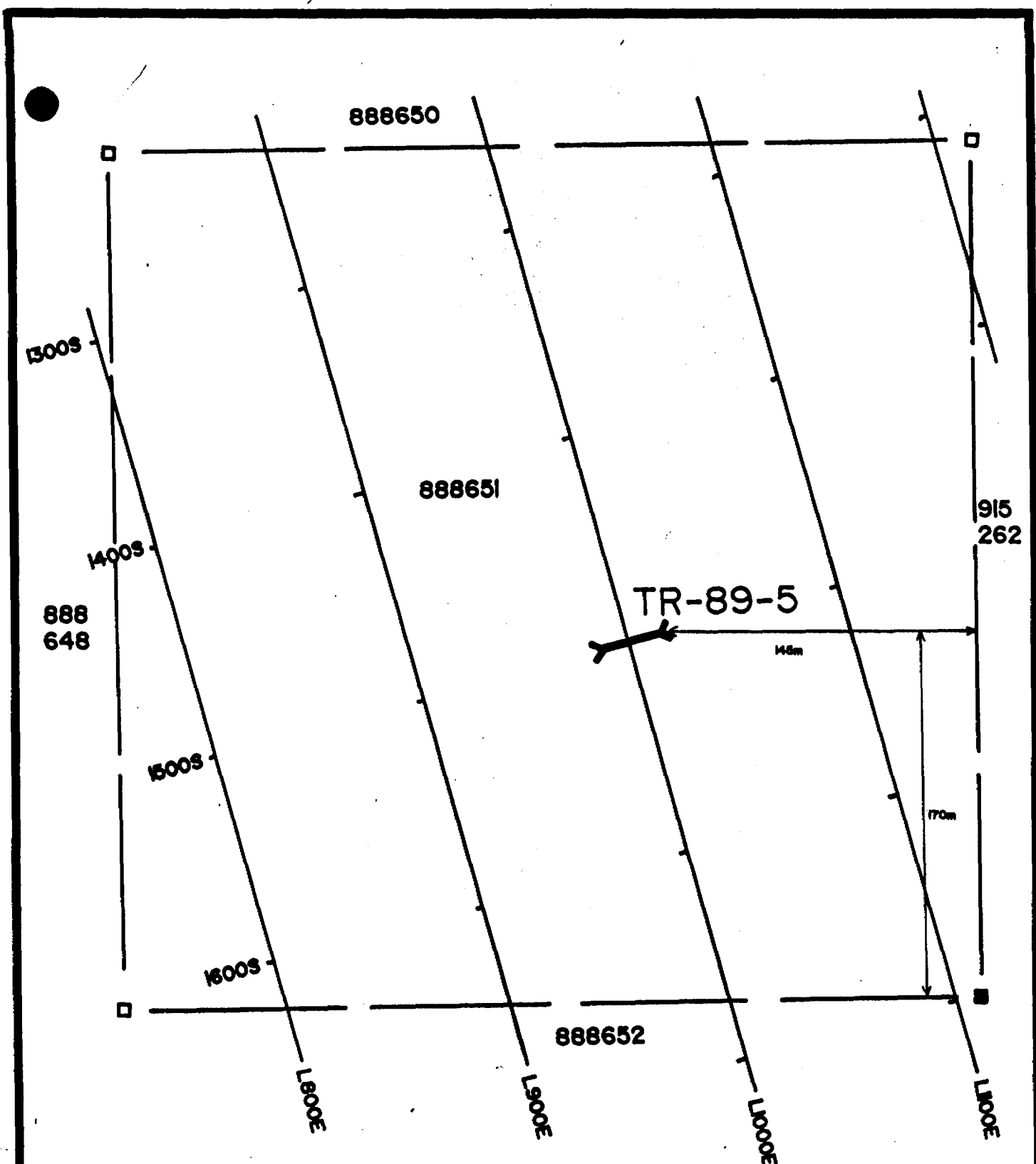

REVISIONS	DURHAM GEOLOGICAL SERVICES INC.		
	For:	AURLOT EXPLORATIONS LTD.	
	Title:	TRENCH LOCATION MAP	
		TR-89-5	
	Date: Sept 1989	Drawn: C.G.	Scale: 1 : 2500
	Job No.:	Approved:	Fig.:

M400S

M405S

M410S

M415S

M420S

M425S

M430S

M435S

M440S

M445S

M450S

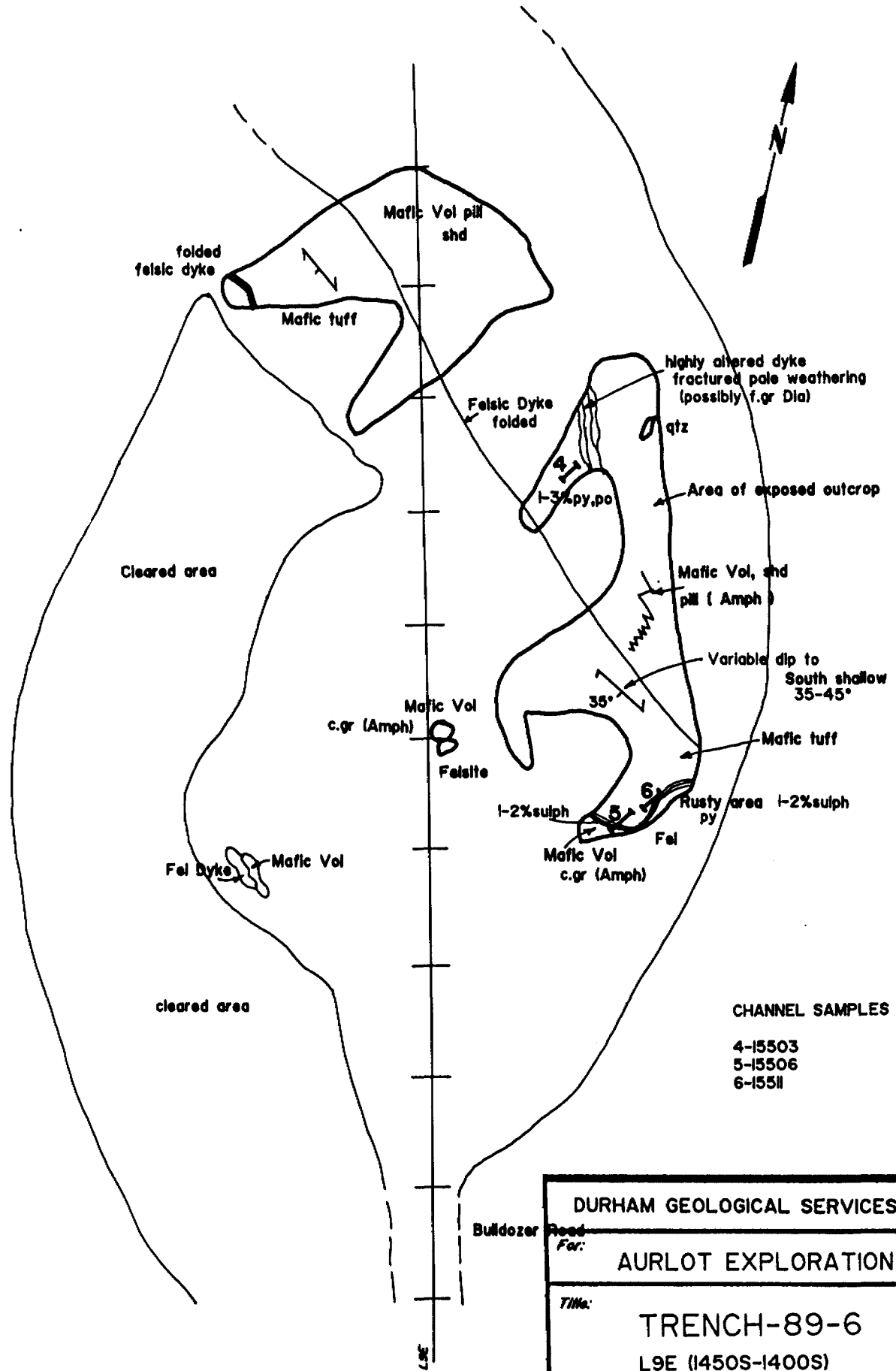

CHANNEL SAMPLES

- 4-15503
- 5-15506
- 6-15511

DURHAM GEOLOGICAL SERVICES INC.		
Road For:		
AURLOT EXPLORATION LTD.		
Title:		
TRENCH-89-6		
L9E (I450S-I400S)		
Date: SEPT 89	Drawn: C.G.	Scale: 1:250
NTS: 42C,42F	Approved:	Fig:

1390S

1385S

1400S

1405S

1410S

1415S

1420S

1425S

1430S

1435S

1440S

L7E

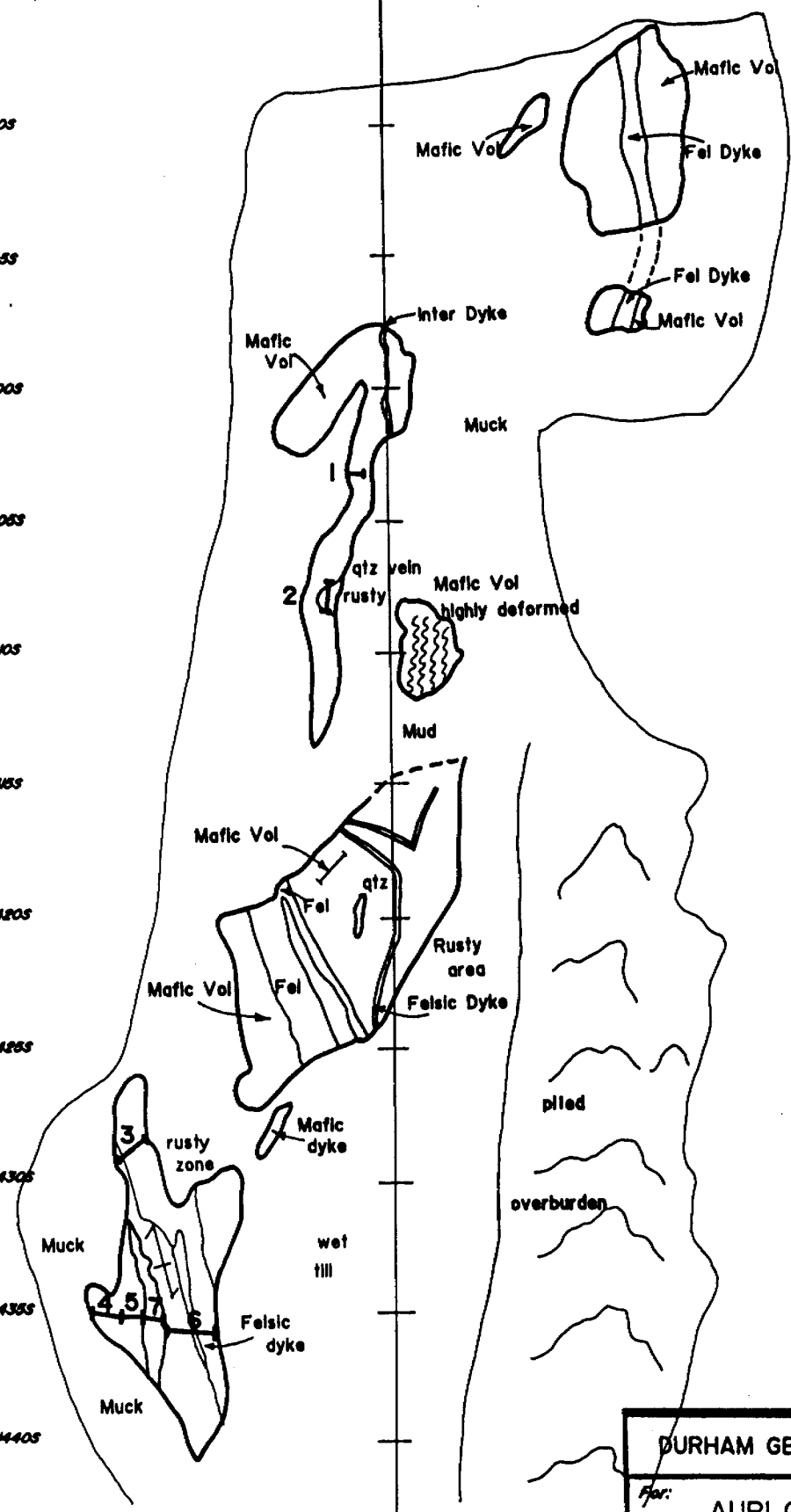

PROPOSED CHANNEL SAMPLES 1 TO 8

DURHAM GEOLOGICAL SERVICES INC.		
For: AURLOT EXPLORATION LTD.		
Title: TRENCH-89-7 L7E (1440S-1390S)		
Date: SEPT 89	Drawn: C.G.	Scale: 1:250
NTS: 42C,42F	Approved:	Fig:

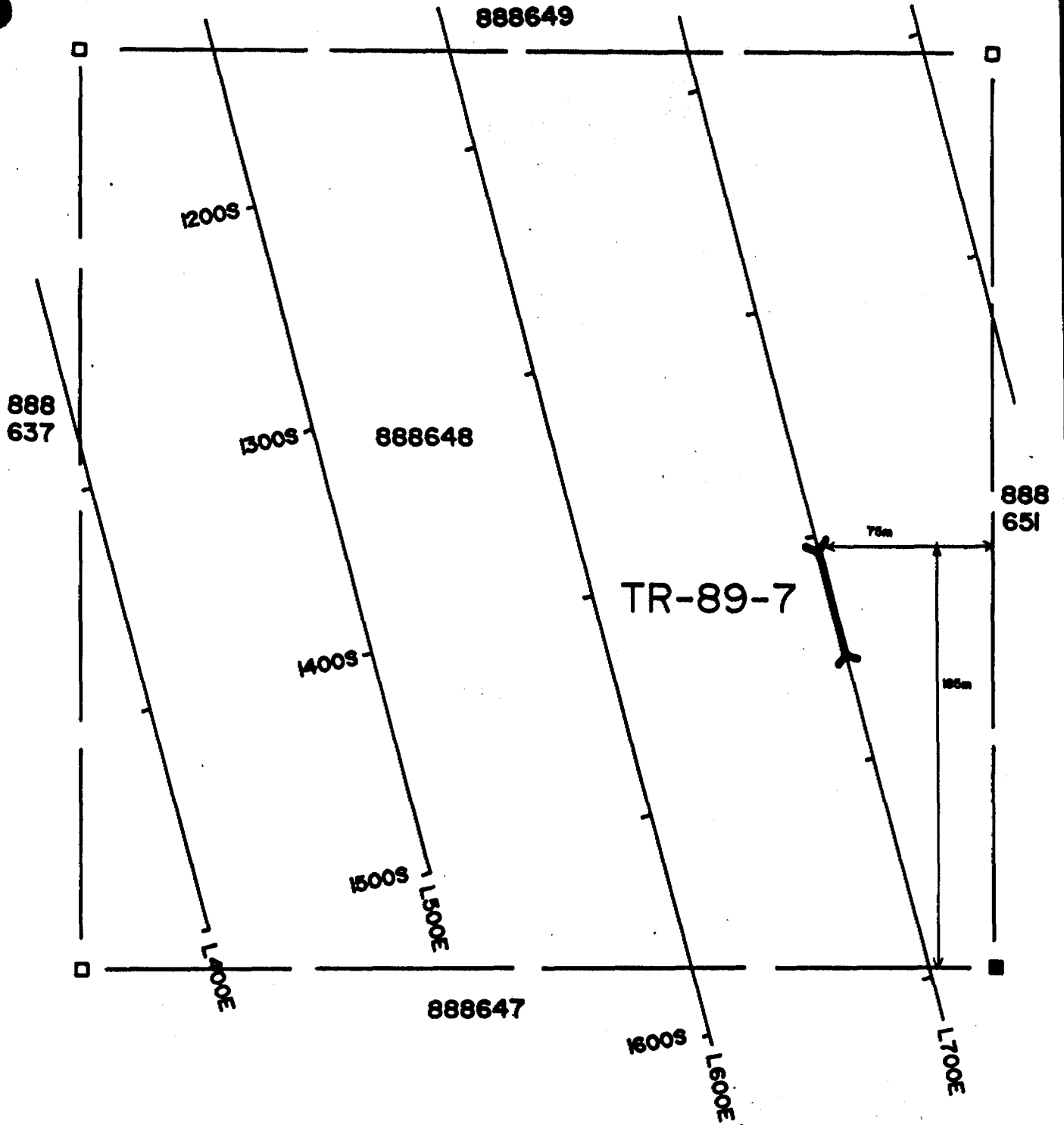

REVISIONS	DURHAM GEOLOGICAL SERVICES INC.		
	For:	AURLOT EXPLORATIONS LTD.	
	Title:	TRENCH LOCATION MAP	
		TR-89-7	
	Date:	Sept 1989	Drawn: C.G.
			Scale: 1 : 2500
	Job No.:	Approved:	Fig.:

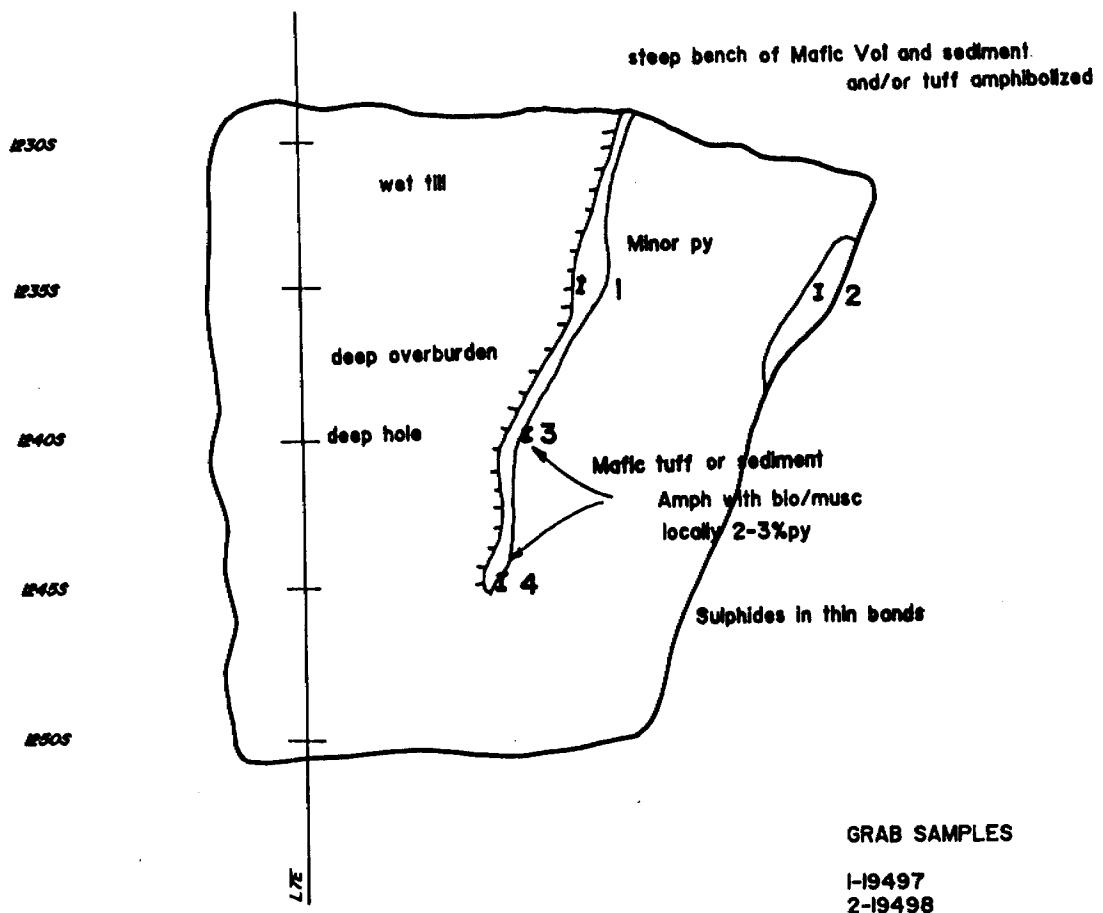

GRAB SAMPLES

- 1-19497
- 2-19498
- 3-19499
- 4-19500

DURHAM GEOLOGICAL SERVICES INC.		
<i>For:</i> AURLOT EXPLORATION LTD.		
<i>Title:</i> TRENCH-89-8 L7E (1230S-1250S)		
<i>Date:</i> SEPT 89	<i>Drawn:</i> C.G.	<i>Scale:</i> 1:250
<i>NTS:</i> 42C,42F	<i>Approved:</i>	<i>Fig.:</i>

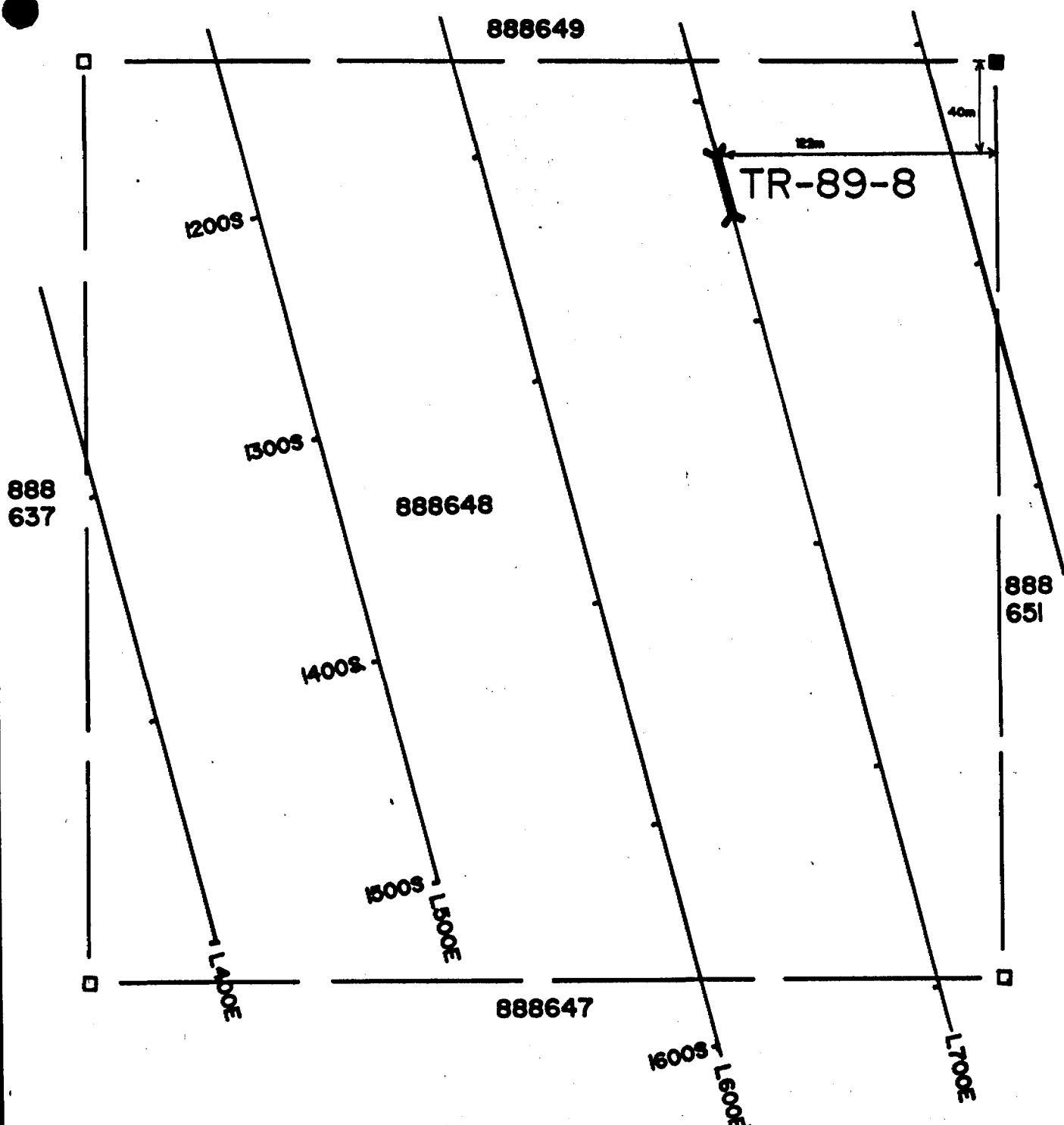

REVISIONS	DURHAM GEOLOGICAL SERVICES INC.		
	For: AURLOT EXPLORATIONS LTD.		
	Title: TRENCH LOCATION MAP		
	TR-89-8		
	Date: Sept 1989	Drawn: C.G.	Scale: 1 : 2500
	Job No.:	Approved:	Fig.:

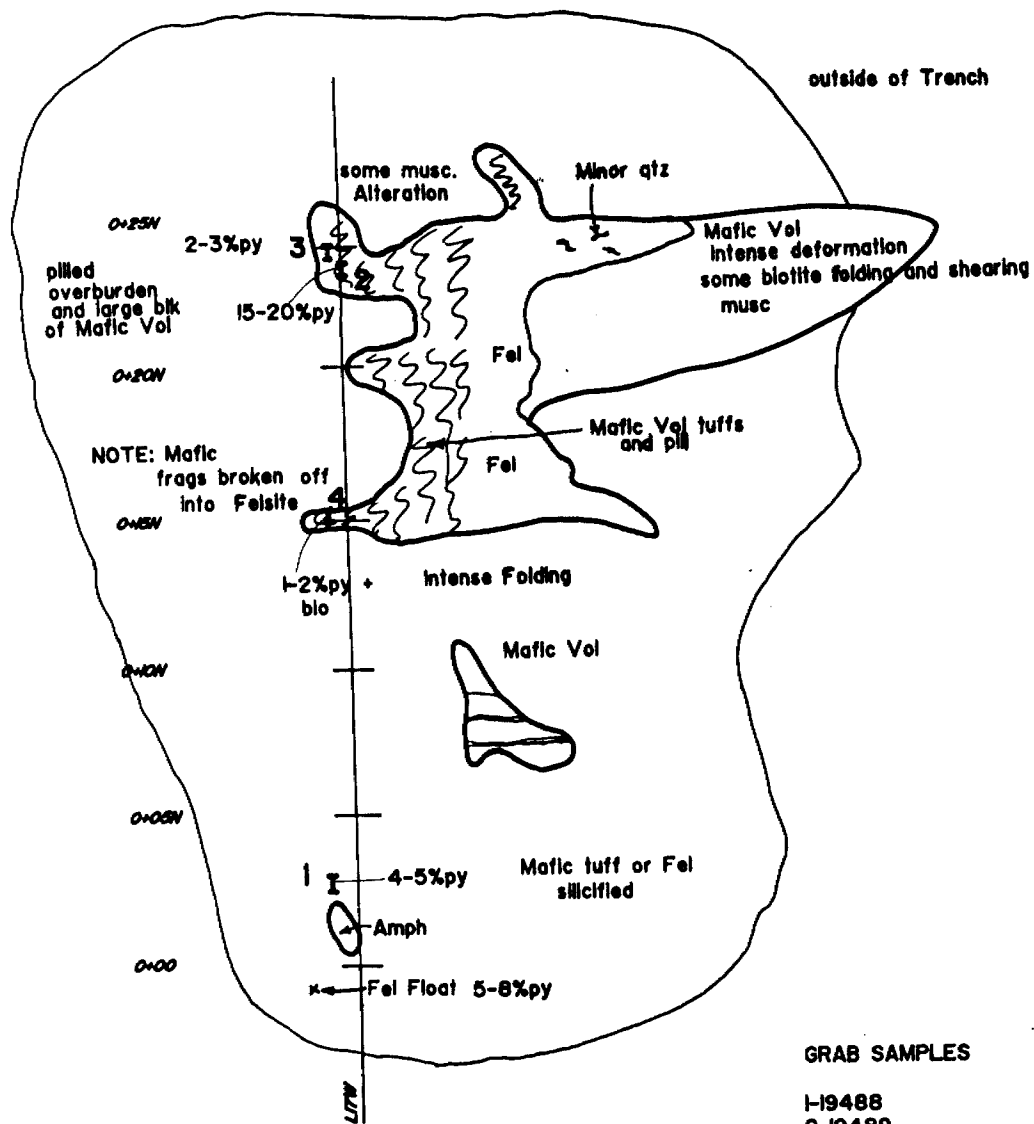

GRAB SAMPLES

- 1-19488
- 2-19489
- 3-19490
- 4-19491

DURHAM GEOLOGICAL SERVICES INC.		
For: AURLOT EXPLORATION LTD.		
Title: TRENCH-89-9 L17W (25N-00)		
Date: SEPT 89	Drawn: C.G.	Scale: 1:250
NTS: 42C,42F	Approved:	Fig:

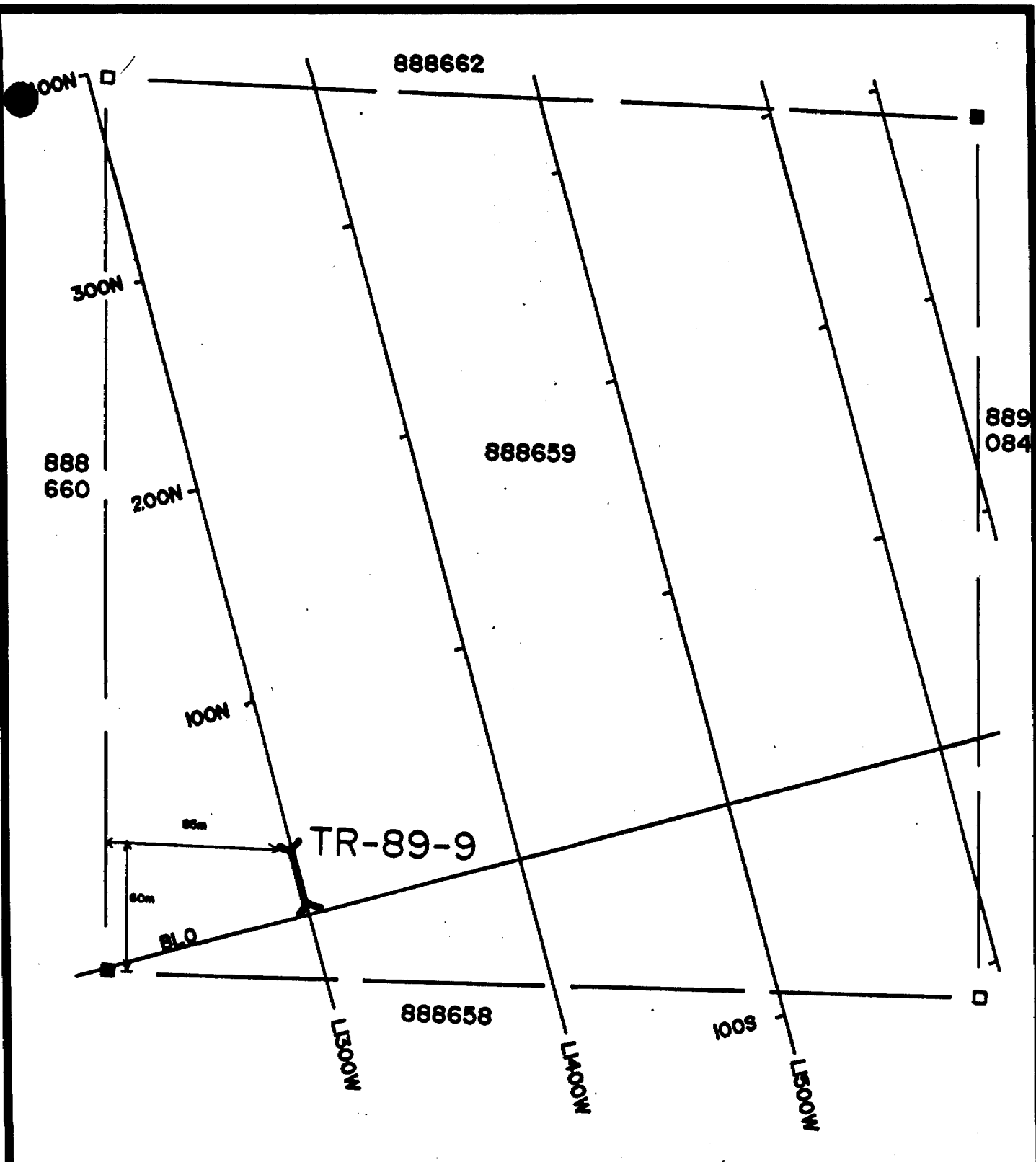

REVISIONS	DURHAM GEOLOGICAL SERVICES INC.		
	For: AURLOT EXPLORATIONS LTD.		
	Title: TRENCH LOCATION MAP		
	TR-89-9		
	Date: Sept 1989	Drawn: C.G.	Scale: 1 : 2500
	Job No.:	Approved:	Fig.:

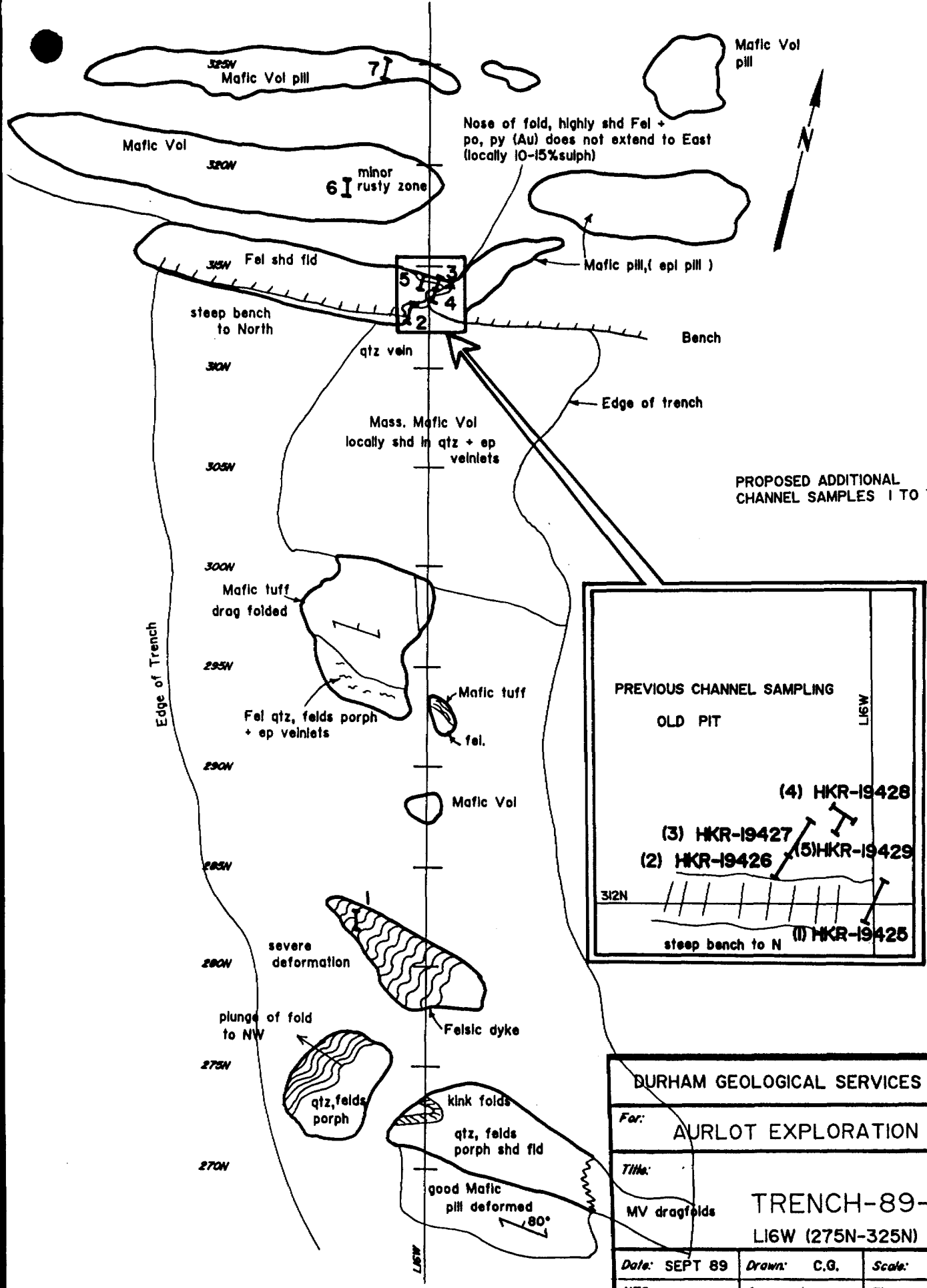

DURHAM GEOLOGICAL SERVICES INC.		
For:	AURLOT EXPLORATION LTD.	
Title:	MV dragfolds	
	TRENCH-89-10 L16W (275N-325N)	
Date:	SEPT 89	Drawn: C.G.
NTS:	42C, 42F	Scale: 1:250
	Approved:	Fig:

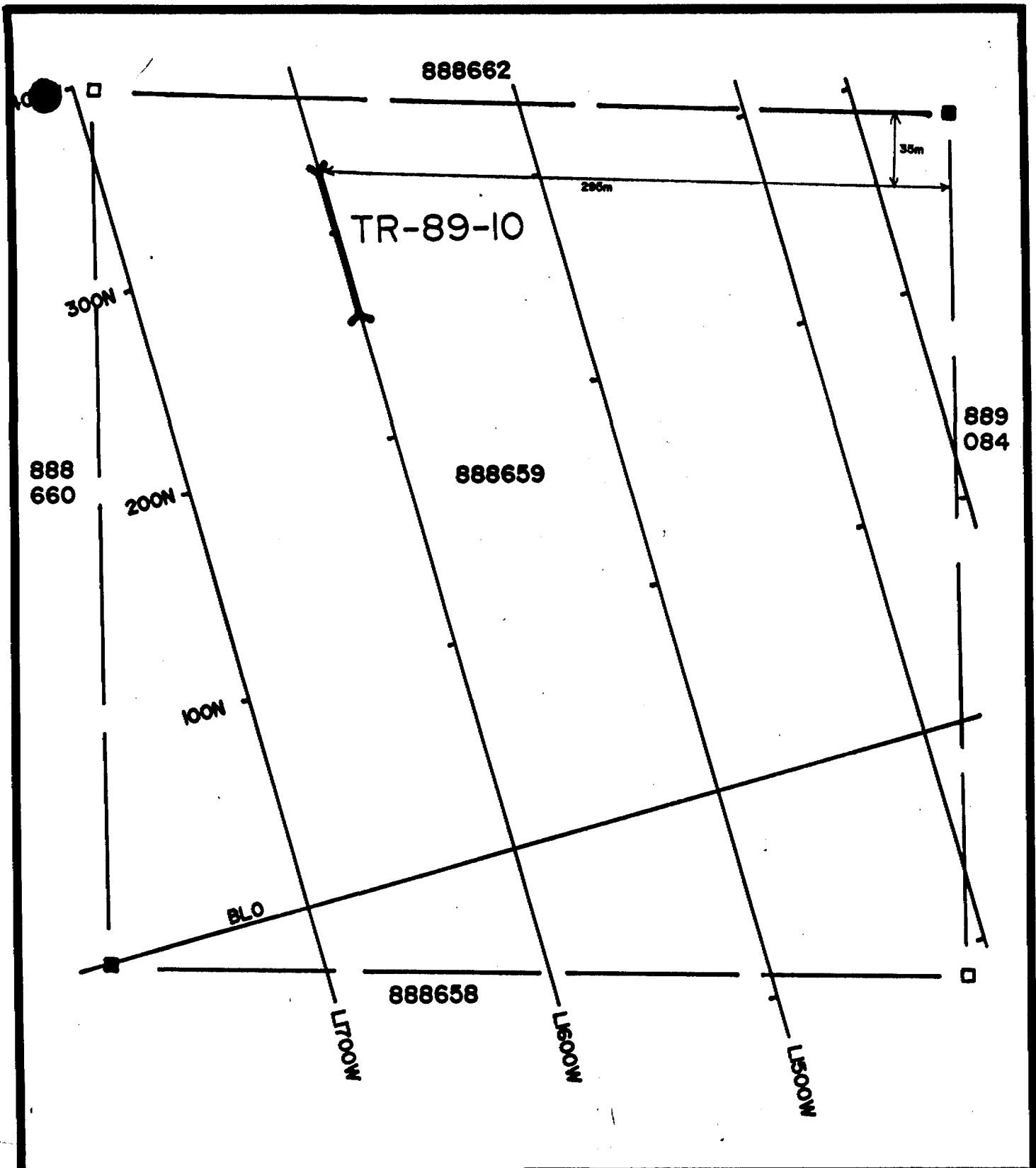

REVISIONS	DURHAM GEOLOGICAL SERVICES INC.		
	For:	AURLOT EXPLORATIONS LTD.	
	Title:	TRENCH LOCATION MAP	
		TR-89-10	
	Date:	Sept 1989	Drawn: C.G. Scale: 1 : 2500
	Job No.:	Approved	Fig.:

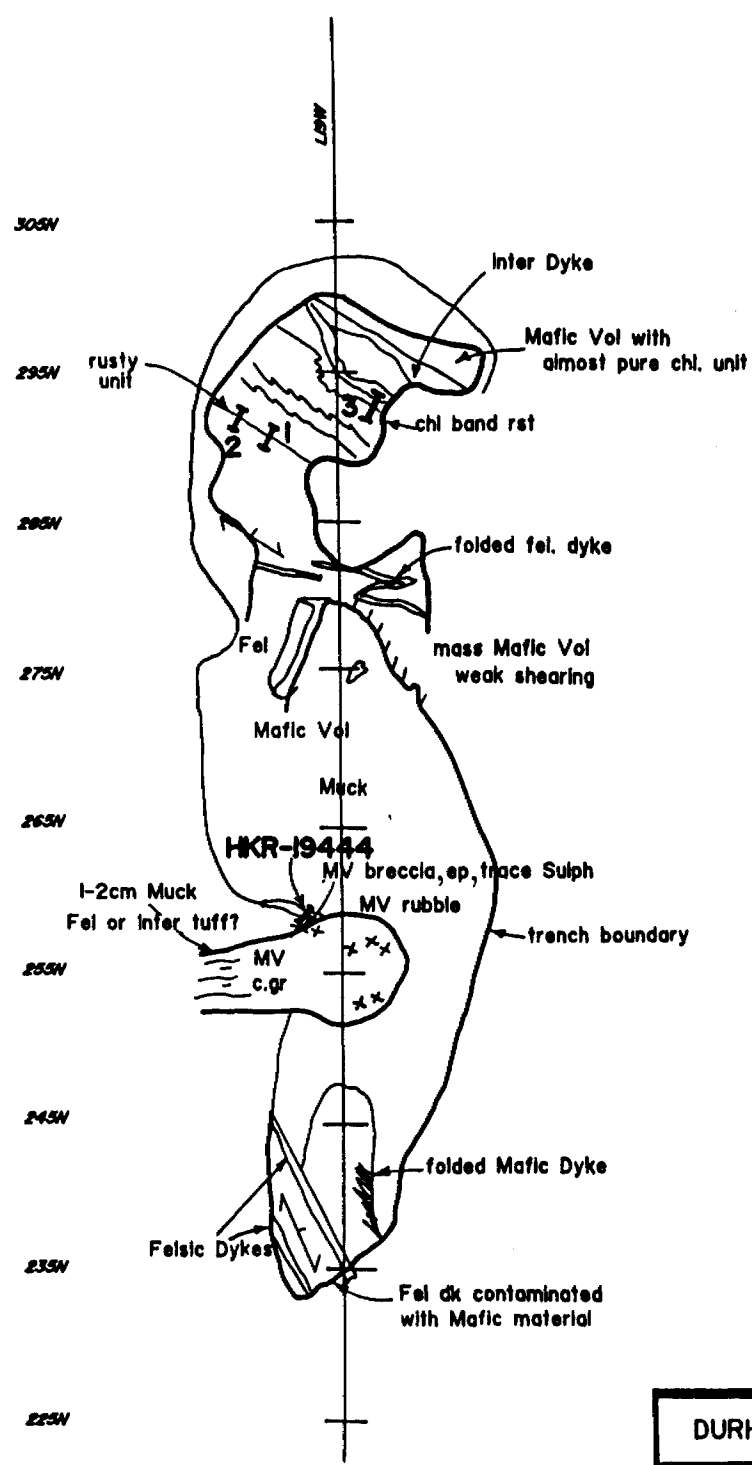

PROPOSED CHANNEL SAMPLES
1 TO 3

DURHAM GEOLOGICAL SERVICES INC.		
For: AURLOT EXPLORATION LTD.		
Title: TRENCH-89-II LI9W (225N-300N)		
Date: SEPT 89	Drawn: C.G.	Scale: 1:500
NTS: 42C,42F	Approved:	Fig:

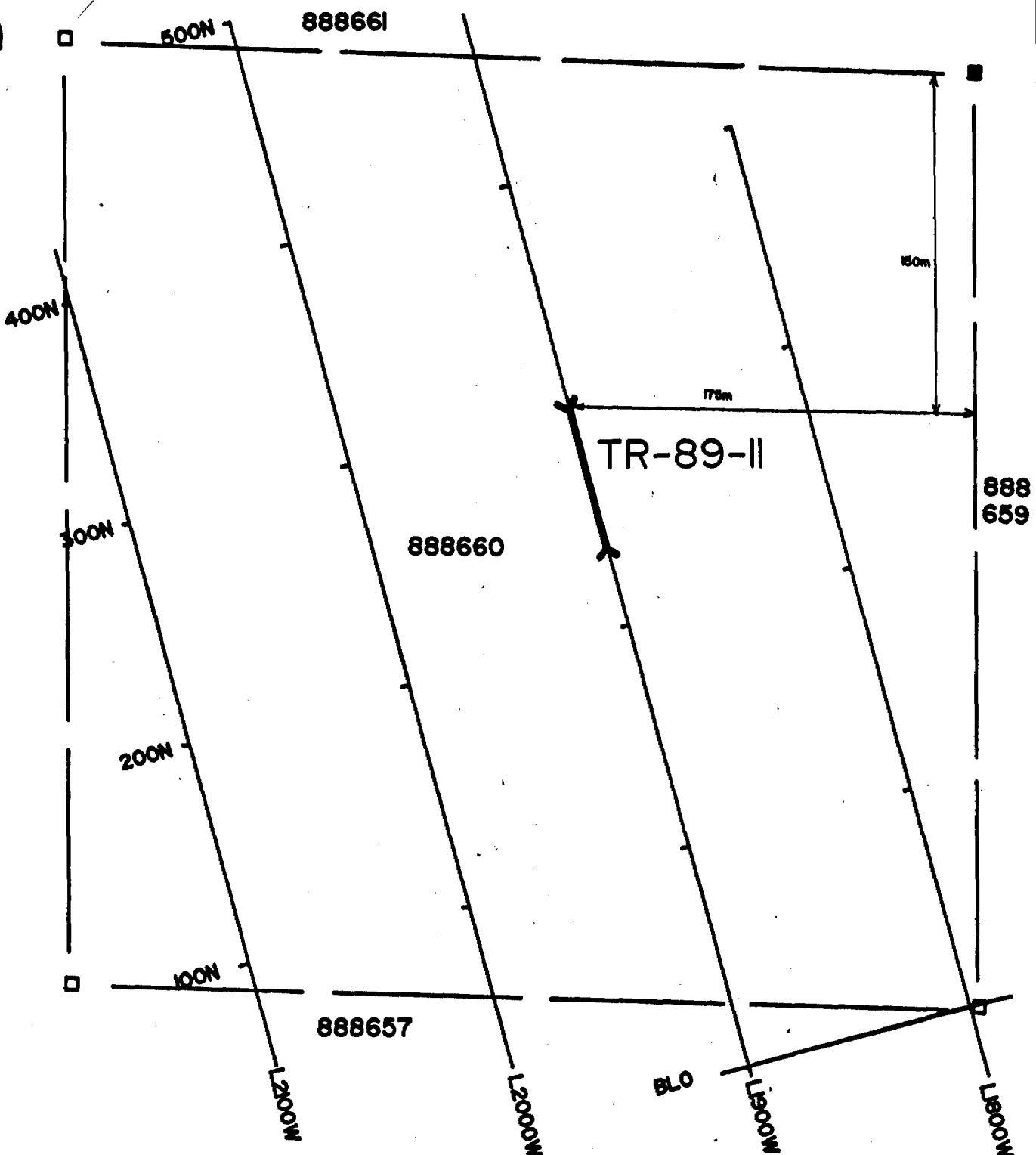

REVISIONS	DURHAM GEOLOGICAL SERVICES INC.		
	For:	AURLOT EXPLORATIONS LTD.	
	Title:	TRENCH LOCATION MAP	
		TR-89-II	
	Date:	Sept 1989	Drawn: C.G.
			Scale: 1 : 2500
	Job No.:	Approved	Fig.:

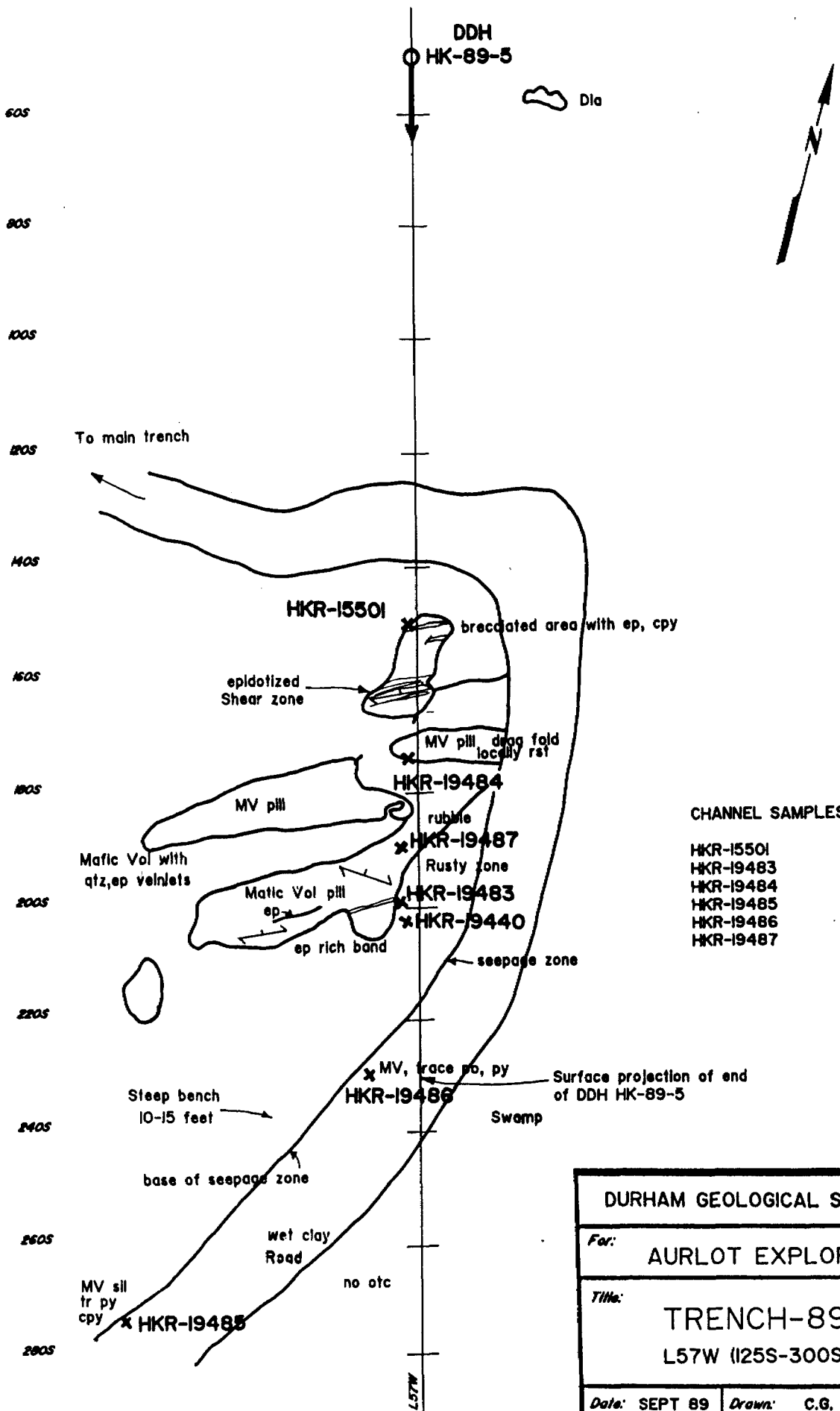

CHANNEL SAMPLES

- HKR-15501
- HKR-19483
- HKR-19484
- HKR-19485
- HKR-19486
- HKR-19487

DURHAM GEOLOGICAL SERVICES INC.		
For: AURLOT EXPLORATION LTD.		
Title: TRENCH-89-12 L57W (I25S-300S)		
Date: SEPT 89	Drawn: C.G.	Scale:
NTS: 42C,42F	Approved:	Fig.:

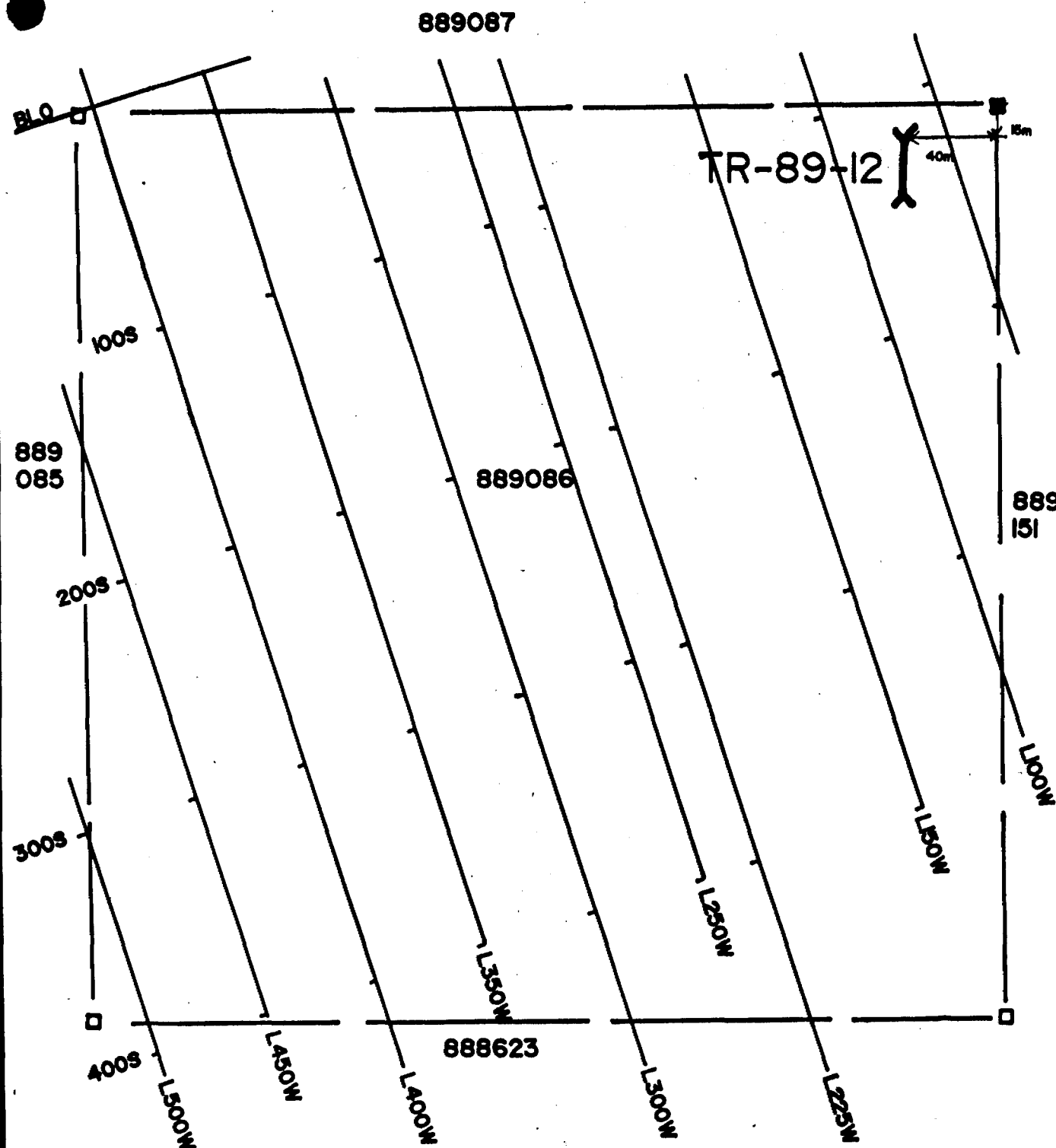

REVISIONS	DURHAM GEOLOGICAL SERVICES INC.		
	For: AURLOT EXPLORATIONS LTD.		
	Title: TRENCH LOCATION MAP		
	TR-89-12		
	Date: Sept 1989	Drawn: C.G.	Scale: 1 : 2500
	Job No.:	Approved:	Fig.:

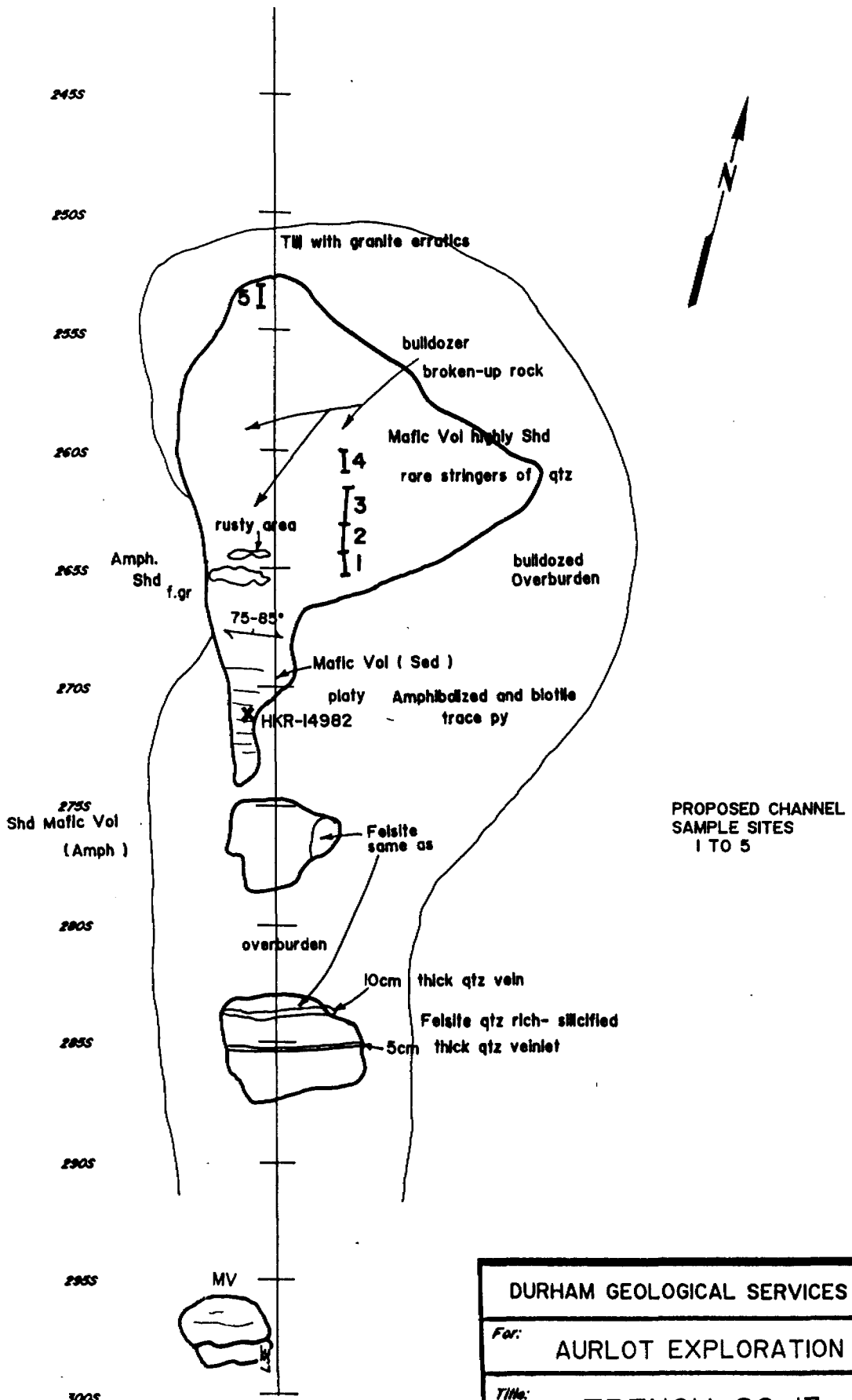

DURHAM GEOLOGICAL SERVICES INC.		
For:	AURLOT EXPLORATION LTD.	
Title:	TRENCH-89-13 L3E (350S-390S)	
Date:	SEPT 89	Drawn: C.G.
NTS:	42C,42F	Scale: 1:250
	Approved:	Fig:

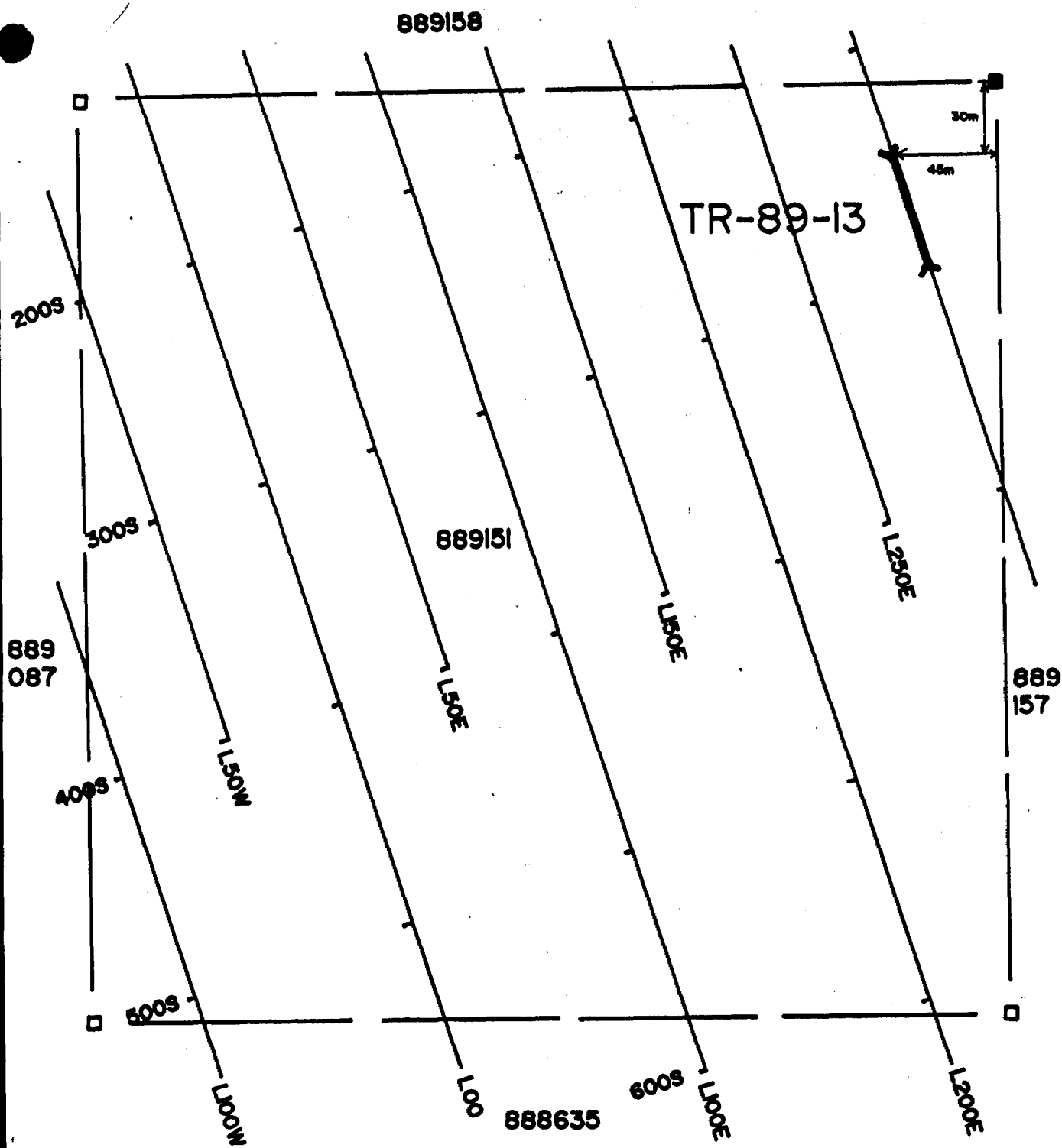

REVISIONS	DURHAM GEOLOGICAL SERVICES INC.		
	For: AURLOT EXPLORATIONS LTD.		
	Title: TRENCH LOCATION MAP		
	TR-89-13		
	Date: Sept 1989	Drawn: C.G.	Scale: 1 : 2500
	Job No.:	Approved:	Fig.:

DOCUMENT No.
W8905-176



900

Mining Act

Report of Work

Name and Address of Recorded Holder Goldfields Canadian Mining Ltd.	Prospector's Licence No. T-1195
467 Preston Lane, Timmins, Ontario	Telephone No. 268-6060

Mining Division Sault Ste. Marie	Mining Claim		Work Days Cr.	Mining Claim		Work Days Cr.	Mining Claim		Work Days Cr.
	Prefix	Number		Prefix	Number		Prefix	Number	
Township or Area Hawkins									
Total Assessment Credits Claimed 1238 1228.2	Please see attached claim list								
Type of Work Performed (Check one only)									
<input type="checkbox"/> Manual Work									
<input type="checkbox"/> Shaft Sinking Drifting or other Lateral Work									
<input type="checkbox"/> Mechanical equipment									
<input checked="" type="checkbox"/> Power Stripping other than Manual (maximum credit allowed - 100 days per claim)									
<input type="checkbox"/> Diamond or other Core drilling									
<input type="checkbox"/> Core Specimens									

Dates when work was performed From: June 14	To: July 1, 1989 June 30, 1989	Total No. of Days Performed 1238	Total No. of Days Claimed 1238 1228.2	Total No. of Days to be Claimed at a Future Date 9.8 days
---	---	--	---	---

All the work was performed on Mining Claim(s): Indicate no. of days performed on each claim. * (See note No. 1 on reverse side)		Mining Claim	No. of Days	Mining Claim	No. of Days	Mining Claim	No. of Days	Mining Claim	No. of Days
		888659	137.4	889085	137.6	888658	137.6	889086	137.6
Mining Claim	No. of Days	Mining Claim	No. of Days	Mining Claim	No. of Days	Mining Claim	No. of Days	Mining Claim	No. of Days
889151	137.6	888649	137.6	888651	137.6	888660	137.6	889084	137.6

Required information eg. type of equipment, Names, Addresses, etc. (See Table on reverse side)
If space below is insufficient, attach schedules with required information and location sketches

J. R. Poulin
Oba, Ontario

Equipment

CAT D-8

Total Amount of Expenditures = \$ 2,580.00

\$2,580.00/10 = 258 days

Exsics Exploration
Box 1880
Timmins, Ontario
P4N 7X1

Equipment

Wajax Pump
3000' High Pressure Fire Hose

Total Amount of Expenditures = \$9,800.00

\$9,800.00/10 - 980 days

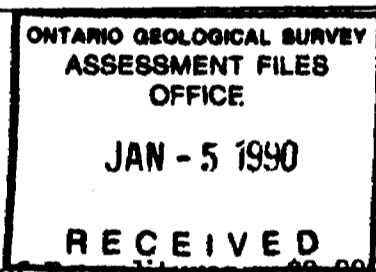

Certification of Beneficial Interest * (See Note No. 2 on reverse side)

I hereby certify that, at the time the work was performed, the claims covered in this report of work were recorded in the current recorded holder's name or held under a beneficial interest by the current recorded holder.

Date Sept. 20, 1989	Recorded Holder or Agent (Signature) <i>Randy Maass</i>
-------------------------------	--

Certification Verifying Report of Work

I hereby certify that I have a personal and intimate knowledge of the facts set forth in the Report of Work annexed hereto, having performed the work or witnessed same during and/or after its completion and the annexed report is true.

Name and Address of Person Certifying
Randy Maass c/o Durham Geological Services Inc., Box 1330 Timmins, Ontario P4N 7J8

Telephone No. 268-6644	Date Sept. 20, 1989	Certified By (Signature) <i>Randy Maass</i>
----------------------------------	-------------------------------	--

For Office Use Only

Work Assignments

RECORDED

SEP 25 1989

Receipt No. _____

Received Stamp

SULT STE MARIE
MINE DIV.

SEP 25 1989

A.M.

CLAIM NUMBER

WORK DAYS CREDIT

P 860501	6.9
P 860502	"
P 860503	"
P 860504	"
P 860505	"
P 860509	"
P 860510	"
P 860511	"
P 860512	"
P 860513	"
P 860514	"
P 860515	"
P 860516	"
P 860522	"
P 860523	"
P 860524	"
P 860525	"
P 860526	"
P 860527	"
P 860534	"
P 860535	"
P 860536	"
P 860537	"
P 860538	"
P 860539	"
P 888601	"
P 888602	"
P 888603	"
P 888604	"
P 888605	"
P 888606	"
P 888607	"
P 888608	"
P 888609	"
P 888610	"
P 888612	"
P 888613	"
P 888614	"
P 888615	"
P 888616	"
P 888617	"
P 888618	"
P 888619	"
P 888620	"
P 888621	"
P 888624	"

cont'd (page 2)

CLAIM NUMBER	WORK DAYS CREDIT
P 888625	6.9
P 888626	"
P 888627	"
P 888628	"
P 888629	"
P 888630	"
P 888631	"
P 888632	"
P 888633	"
P 888639	"
P 888640	"
P 888641	"
P 888642	"
P 888643	"
P 888644	"
P 888645	"
P 888646	"
P 888652	"
P 888653	"
P 888654	"
P 888655	"
P 888656	"
P 888663	"
P 888664	"
P 888665	"
P 888666	"
P 888667	"
P 888668	"
P 888669	"
P 888670	"
P 888671	"
P 888672	"
P 888673	"
P 888674	"
P 888675	"
P 888676	"
P 888677	"
P 888678	"
P 888679	"
P 888680	"
P 888681	"
P 888682	"
P 888683	"
P 888684	"
P 888685	"
P 888686	"
P 888687	"

cont'd (page 3)

CLAIM NUMBER	WORK DAYS CREDIT
P 888688	6.9
P 888689	"
P 888690	"
P 888691	"
P 888692	"
P 888693	"
P 888694	"
P 889080	"
P 889081	"
P 890160	"
P 890161	"
P 890162	"
P 890163	"
P 890164	"
P 890165	"
P 890166	"
P 890167	"
P 890168	"
P 890169	"
P 890170	"
P 890171	"
P 890172	"
P 890173	"
P 890174	"
P 890175	"
P 890176	"
P 890177	"
P 890178	"
P 890179	"
P 890180	"
P 890181	"
P 890182	"
P 890183	"
P 890184	"
P 890258	"
P 890259	"
P 890260	"
P 890261	"
P 890262	"
P 890263	"
P 890264	"
P 890265	"
P 890266	"
P 890267	"
P 890268	"
P 890269	"
P 890270	"
P 890271	"

cont'd (page 4)

CLAIM NUMBER	WORK DAYS CREDIT
P 890272	6.9
P 890273	"
P 890274	"
P 890275	"
P 890276	"
P 890277	"
P 890278	"
P 890279	"
P 890280	"
P 890281	"
P 899715	"
P 899716	"
P 899717	"
P 899718	"
P 899719	"
P 899720	"
P 899721	"
P 899722	"
P 899723	"
P 915254	"
P 915255	"
P 915259	"
P 915260	"
P 915263	"
P 915264	"
P 915265	"
P 915266	"
P 915268	"
P 915269	"
P 915270	"
P 915271	"
P 915272	"
P 915273	"
P 915274	"
P 915275	"
P 915276	"
P 915277	"

Total claims = 178

AURLOT EXPLORATIONS LTD.

DOCUMENT No.
W8905-176

Ontario Ministry of Natural Resources
Division of Mines,
SAULT STE. MARIE, Ontario
P6A 2B3

TO WHOM IT MAY CONCERN:

This letter is to advise that Aurlot Explorations Ltd. has incurred the following expenditures on its property located in Hawkins Township, Ontario:

- (a) \$2580 - J.R. Poulin -D-8 and operator for trenching
- (b) \$9800 - Exsics Exploration - 2 men crew hydro stripping²²
- (c) \$17,952 - Barringer Labs - assaying soils, rock and core.

Yours sincerely,

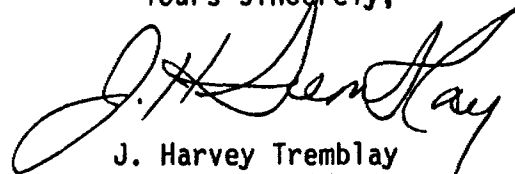
J. Harvey Tremblay
President.

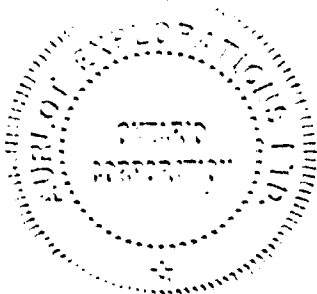

June 19, 1989

M. AURLOT RESOURCES LTD.
HARVEY TREMLAY

(9)

For
Signature

141 ADELAIDE ST. W., SUITE 1404,
TORONTO, ONT. M5H 3L5

In account with J. Raymond Soulin Ltd.
Box 1000, OBA, Ont. P0M 2P0.

Terms

June 12, 13 + 14:	Rental of D-8 Cat. Tractor & operator - 2 1/2 hrs. @ \$120.00/hr.						\$2,580.00
Paid June 28/89 R. Soulin							



EXSICS EXPLORATION LIMITED
CONTRACTING & CONSULTING GEOPHYSICS

Tel. (705) 267-4151

P.O. Box 1880
Timmins, Ontario P4N 7X1

INVOICE #: 608R
PROJECT #: E-261A

ON ACCOUNT WITH: Aurlot Exploration Limited
Suite 1404 - 141 Adelaide St. West
TORONTO, ONTARIO.
M5H 3M7

RE: Hydro Stripping - OBA

IN CONSIDERATION FOR: 2 Man Crew, Gear, Truck, Camp Set-up,
Equipment

AT A RATE OF: \$700.00/day All Inclusive
June 14 to June 24 Incl.
June 29, 30, July 1, 1989

June 14 - 24, 1989 - 11 days @ \$700.00/day.....\$7,700.00
June 29 - July 1, 1989 - 3 Days @ \$700.00/day.....\$2,100.00

TOTAL OF THIS INVOICE: \$9,800.00

DATE: July 4, 1989

SIGNED: _____

~~Signature~~ AURLOT

Payment due upon receipt of invoice. No statements issued.
Terms: Net 30, 2% interest per month on overdue accounts.

FRANZ TWP

IRVING TWP

REFERENCES

AREAS WITHDRAWN FROM DISPOSITION

- M.R.O - MINING RIGHTS ONLY
- S.R.O - SURFACE RIGHTS ONLY
- M + S - MINING AND SURFACE RIGHTS

Description	Order No.	Date	Disposition	File
(1)		4/10/73		64585 L.P.L.

Prop'd Forestry Work in Township
 available for
 disposal upon request

LEGEND

- HIGHWAY AND POLICE No.
- OTHER ROADS
- TRAILS
- SURVEYED LINES:
 - TOWNSHIPS, PARCELS, ETC.
 - MINING AND SURFACE RIGHTS
 - PARCELS, ETC.
- RAILWAY
- MINING
- MINORIAL STREAM
- FLOOD CONTROL
- SUBDIVISION
- RESERVATIONS
- ORIGINAL SHORELINE
- MARSH OR MUSKIEG
- MINES
- TRAILERS

DISPOSITION OF CROWN LAND

TYPE OF DOCUMENT	SYMBOL
PATENT SURFACE AND MINING RIGHTS	□
SURFACE RIGHTS ONLY	□
MINING RIGHTS ONLY	□
LEASE SURFACE & MINING RIGHTS	□
SURFACE RIGHTS ONLY	□
MINING RIGHTS ONLY	□

SCALE 1 INCH = 40 CHAINS

TOWNSHIP

HAWKINS

M.N.R. ADMINISTRATIVE DISTRICT
 HEARST
 MINING DIVISION
 SAULT STE. MARIE
 LAND TITLES / REGISTRY DIVISION

ALGOMA

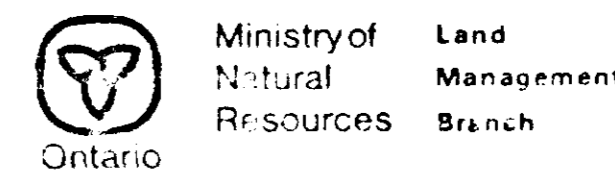

Date: MARCH 3, 1983

Checked by: LP

Number: G-2316

W8905-176 63-5303

DOCUMENT No. W8905-176



4251 (ENERG) 03-5303 HAWKINS