



42A09NW0101 63.5916 WILKIE

3.5916

010

Elwood Fournier Gold Prospect

WILKIE TWP

Matheron, Ont

by

R. D. Burns, P. Eng.

Sept. 1988



OP90-356  
OP90-357  
OP90-358

## Fournier Gold Prospect

Mr Elwood Fournier of Kearns, Ont holds a group of 14 claims, which are in good standing; which have gold showings on them in andesitic volcanics. The property adjoins, on strike, with the Maude Lake gold mine, NE of Matheson, Ont.

### Property, Location and Access.

The property consists of 14 contiguous claims, in lots 2, 3, 4, and 5 of Con II Wilkie Twp, District of Cochrane; Larder Lake Mining Division, Ontario. The south boundary of the township is about 6 miles north of Matheson, Ontario. The property is accessible by road (last part 4 wheel drive) and is about 10 miles distant from the Town of Matheson.

The Shallow River is just north of the Fournier property and the Maude Lake Mine underground workings (Northern Miner of April 12, 88) are about one mile southeast of it. (see sketch map, herewith).

The Maude Lake Company, ——— holds the ground East, southeast, and southwest of the Fournier Property, while Kidd Creek holds the ground NE, N, and west as well as south of it. This latter ground was previously held by Hollinger.

General Geology

Regional geologic structures trend WNW. The Fournier Property, The Maude Lake Mine and most of the Kidd Creek ground are on the same belt of Archaean, Blake Type andesitic to basaltic volcanics.

Except for in Con I, Wilkie Twp; outcrop is generally poor with apparently deep overburden and bush cover.

The Pipestone Fault, a part of the Timmins to Cadillac Break complex is a major carbonated talc chlorite schist zone about 1 mile south. This fault strikes about N70°W, and is in turn cut by smaller NE striking faults.

South of the fault the rocks are clastic metasediments while north of the fault they are mostly intermediate to basic metavolcanics.

Just north of the Pipestone fault and about half a mile south of the Fournier property there is a granite stock about 2,000ft wide and two miles long that parallels the fault. Much of the mineralization in the area is north of this granitic stock.

A swarm of NS striking Metachewan type diabase dikes cuts all other rocks south of the property while a large NE trending Keeweenawan type diabase dike is exposed SW of the property. The regional aeromagnetic survey indicates that this latter dike crosses the property from SW to NE.

3/

Along the shallow river north of the property are numerous outcrops of serpentized peridotite and one of feldspar porphyry.  
see sketch map here with  
als ODM Geolmap P 156.

### Detail Geology

The regional aeromagnetic map shows a NE trending magnetic anomaly associated with a large diabase dike crossing the property. There are no <sup>known</sup> outcrops on this structure on the property.

Almost all the outcrops on the property are on or near claim no 935210 at the east end of the group. Here there are abundant andesitic to basaltic, often pillowed volcanic flow outcrops with WNW striking pyritic, quartz-carbonate zones and quartz veins. Some of these carry gold. They appear to be the NW extension of the Maude Lake ore zone.

Mr. Fournier, an old time prospector who does not speak french, has drilled 5 EX holes of about 130 to 280 feet length, all inclined to the south from near the north side of claim no. 935210. see drilling sketch map. These holes cut andesite-basalt contacts, and they indicate the presence of two gold bearing pyritic quartz-carbonate

zones in andesite. One zone is just north of the contact and the other zone is about 100 feet north of the contact, and also in andesite. Fourniers holes were logged by A C Bath of the Ontario Ministry of Natural Resources. Only about 7-10% of each hole has been sampled. The core is now stored at Fourniers house in Kearns, Ont.

There are no other known drill holes and no significant trenches or pits on the property.

DDH Assays to date Include

Hole No	Loc in hole	width	oz Au
#2	58 ft	6 in.	0.08
	0.002 over 18" nearby on both sides,		
#3	172-175 ft	36 in	0.016
	164-200 ft much cloric, QC material w to 10% Py + Po - almost all not sampled		
#4	115-117.5	30 in	0.06
	127.5-130	30 in	0.17/0.19
	no other samples between 90 and 137.5 ft.		
#5	194-195	12 in	0.02

#1 No signif assays, where sampled.

The other 13 claims have almost no outcrops and have never been drilled.

Previous Work

In 1977 Hollinger drilled a copper gold showing north of the granite and 1/4 mile south of the Fournier block. Their geophysical survey covered the SW 3 of the present Fournier claims and picked up both HEM and VLF anomalies there. There have never been checked. see Maps. Hollinger also did some drilling to the north along the shallow river.

No other geophysical work has been done on the property.

General

The claims are in good standing until early 1989.

Mr. Fournier is not after initial cash but rather wants serious work done on the property.

If you are interested in this property please contact me:

R. D. Burns, P. Eng.  
1434 Peoples Road  
Sault Ste Marie, Ont.  
P6C 3W8

(705) 254-7983



Thank you  
Bob Burns

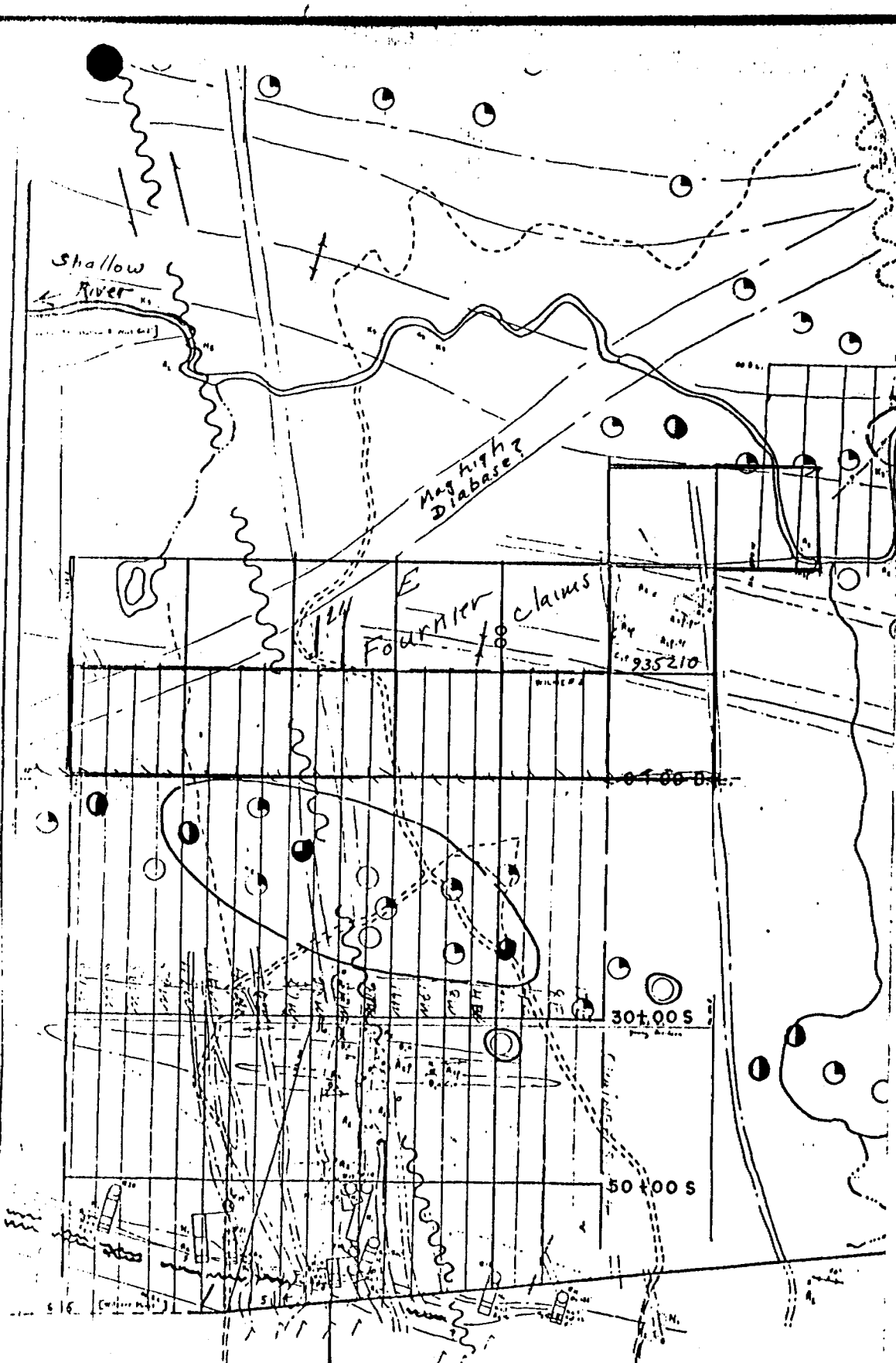

↓ To Matheson ↓

Hollinger Drilling? Wilkie  
 1977 ~~Water~~ Twp.  
 Matheson, Ont.

DIAMOND DRILLING LOG

1

HOLE NO. 5

Drilling Company Elwood Fournier

Core Size  $1\frac{5}{16}$  ~~3/8~~ in.

Claim No. TB 843374

Date Started 90/04/27

Date Finished 90/05/07

Date Logged 90/07/16

Logged By D. R. Boucher

Township Yesno

Property \_\_\_\_\_

Location UTM Coordinate \_\_\_\_\_  
Grid Coordinate \_\_\_\_\_

Collar Elevation \_\_\_\_\_

Bearing 180°

Dip of Hole -50°

Depth collar \_\_\_\_\_

Length 420.05 ft. \_\_\_\_\_

PURPOSE

To test total field magnetic high and fluorite occurrence

DIAMOND DRILLING LOG SUMMARY

The drill hole intersected a complex intrusive consisting predominantly of granite to syenodioritic rocks with two late gabbroic units. Two brecciated zones with intense silica flooding were also intersected in the granite. The quartz is translucent white with no mineralization. A strg epidote alteration zone within the granite contains approximately 1% fluorite in late fractures up to 1/4 inch wide.



DIAMOND DRILLING LOG

FROM	TO	
0	60.00 ft	CASING
60	77.76 ft	GRANITE BRECCIA
		Orange pink, mg., brecciated granite with intense silica flooding. Mod. dull grey green epidote alteration. Fragments up to 2 inch., strg. silicification Overall 50% white qtz.
		@ 62.22 ft - 1 inch qtz V with 1% cpy
		@ 74.30 ft - 1/8 inch py V along fract.
		@ 75.78 ft - 1/16 inch py V along fract.
		Contact with lower unit is sharp defined by 2 inch brecciated zone with calcite.
77.76	153.05 ft	GABBRO
		Dark grey to black, mg., ms., speckled with orange feldspar, non to wk. mt., 60% Plag., 15% Alk Feld., wk fractured with minor thin shear zones.
		@ 81.61 ft - 1/2 inch Shear with Calcite V. @ 30°TCA
		@ 95.03 ft - 1 1/2 inch red orange Granite dyke
		@ 96.37 ft - 1 inch " " " "
		@ 99.97 ft - 1 inch Shear with calcite & py @ 35°TCA
		@ 110.79 ft - 1 inch Shear with calcite V.
		@ 116.97 ft - 8 inch Shear with white calcite V. and black fine graine chlorite along contacts and fragments @ 15°TCA
		@ 123.09 ft - 1 inch Shear with calcite V. @ 30°TCA
		From 125.15 to 153.05 ft wk pervasive carbonatization with loss of orange feldspar, wk seritization of mfc.. The alterations decreases towards lower contact.
		Overall 1% calcite V. along fractures and narrow shear zones from 1/16 to 1/2 inch wide. Trace fg disseminated py throughout.
153.05	166.46 ft	GRANITE
		Orange pink mg, ms to wk fol., 18% qtz, 40% plag, 40% ortho, <1% mfc

DIAMOND DRILLING LOG

3

- 166.46      172.61 ft      SYENODIORITE  
Light grey white, cg, ms-wk fol, 10% chloritized hbl
- 172.61      179.51 ft      GRANITE  
Orange pink mg, ms, 50-50% feld, <1% mfc
- 179.51      180.41 ft      SYENODIORITE  
Light grey white, cg, ms-wk fol, 10% chloritized hbl
- 180.41      215.70 ft      GABBRO  
Dark grey to black, mg., ms., speckled with orange feldspar, non to wk. mt., 60% Plag., 15% Alk Feld., wk fractured with minor thin shear zones.  
@ 188.99 ft - 1 inch Shear with calcite V. @ 25°TCA  
@ 190.25 ft - 1/2 inch Shear with calcite V. @ 40°TCA  
@ 204.53 ft - 2 inch Shear with calcite V. @ 10°TCA  
@ 206.67 ft - 1/2 inch Shear with calcite V. @ 20°TCA  
Overall <1% calcite veining along fractures and narrow shear zones from 1/8 to 2 inch wide.
- 215.70      240.44 ft      GRANITE  
Orange pink, mg, up to 80% feldspar, 7% qtz, <3% mfc  
@ 216.2 ft - 6 inch dark green hornblendite dyke or segregation  
@ 218.33 ft SyenoDiorite 50% hornblend 50% feldspar  
@ 222.63 ft Shear zone @ 60°TCA  
@ 224.10 ft - 2 inch core split  
from 223.68 to 225.15 ft greenish grey zone, vmt, 5% diss po, 1% diss py,
- 240.44      254.93 ft      SYENODIORITE  
Greyish green with pinkish hues, m-cg, ms, 60% feldspar, 40% mfc mod chloritized hbl & biot, trace to 1% diss fg py  
from 246.11 to 247.9 ft orange pink Granite  
from 247.9 to 249.26 med grey green SyenoDiorite 1% diss fg py.

DIAMOND DRILLING LOG

6

CORE RECOVERY

BOX NUMBER	CORE LENGTH ON FROM	BOX TO	MEASURED CORE FROM	CORE TO
1	60 ft	95 ft	60.00 ft	83.67 ft
2	95 ft	120 ft	83.67 ft	108.00 ft
3	120 ft	145 ft	108.00 ft	132.33 ft
4	145 ft	185 ft	132.33 ft	154.50 ft
5	185 ft	215 ft	154.50 ft	178.33 ft
6	215 ft	240 ft	178.33 ft	202.08 ft
7	240 ft	265 ft	202.08 ft	226.00 ft
8	265 ft	290 ft	226.00 ft	250.00 ft
9	290 ft	320 ft	250.00 ft	272.33 ft
10	320 ft	345 ft	272.33 ft	295.83 ft
11	345 ft	370 ft	295.83 ft	319.50 ft
12	370 ft	395 ft	319.50 ft	342.50 ft
13	395 ft	420 ft	342.50 ft	364.67 ft

TOTAL RECOVERY = 87%

DIAMOND DRILLING LOG

5

- 315.46      345.18 ft    GRANITE
- from 315.46 to 345.18 ft Granite  
              Pink to med grey, mg, mfc from <1% to 10% biot,  
              mod fractured with silica flooding, 20% qtz V trace py  
              in fractures @ 329.50 & 339.90 ft, locally mod epidote  
              alt ie. 341.50 to 342.5 ft
- 345.18      366.38 ft    GRANITE BRECCIA
- from 345.18 to 366.38 ft Granite Breccia strg silic.  
              of granitic clasts and intense silica flooding (V) 70%  
              qtz V, 5% epidote alt, significant veins include  
              from 351.01 to 351.96 ft qtz V  
              from 352.60 to 353.16 ft qtz V  
              from 354.19 to 358.01 ft qtz V  
              Nil mineralization
- 366.38      384.93 ft    GRANITE
- same as above (315.46 to 345.18 ft)
- 384.93      389.51 ft    ALTERED ZONE
- strg silicification and epidotization (cherty) nil  
              mineralization
- 389.51      416.70 ft    SYENODIORITE
- Pinkish grey, cg, ms to wk fol, 40% orthoclase, 30% plag  
              25% mfc (chloritized), <5% qtz  
              @ 345 ft wk fol @ 50°TCA  
              split core from 397.49 to 400.20 ft Tr py  
                          from 400.65 to 403.25 1/2% py  
                          from 408.79 to 410.93 Tr py  
                          from 415.57 to 416.70 ft 1/2 to 1% py  
              @ 413.76 ft - 2 inch micro breccia with 1% diss py
- 416.7      420.05 ft    GRANITE
- Orange pink, cg, ms, 50% orange feldspar, 25% plag., 15%  
              qtz, <1% mfc.
- 420.05 ft    END OF HOLE

DIAMOND DRILLING LOG

4

From 249.26 to 249.89 ft Granite  
From 249.89 to 254.93 ft Mfc SyenoDiorite  
med grey green, mg, with biot rich sections (Lamp.).  
From 250.42 to 250.94 ft 3 % py  
@ 251.05 ft - 2 inch pink granite dyke.  
From 253 to 254.60 ft mod fol. @ 65°TCA

254.93 280.50 ft GRANITE

Orange pink, mg, ms, 5-10 % qtz, <5% mfc  
@ 265.62 ft grey fol. zone @ 65°TCA  
@ 268.12 ft grey fol. zone @ 75°TCA

280.5 284.24 ft SYENODIORITE

Med to light grey, mg, near contacts grading to cg, in  
core of unit, 80% med grey green feld, 20% biotite, up  
to 1-2% diss fg py locally, wk fol.

284.24 289.96 ft GRANITE

Redish pink, mg, ms, 50% white plag, 40% ortho, 3% mfc

289.96 305.54 ft GRANITE BRECCIA

Orange pink angular granite clasts up to 3 inch strg  
silicified and intense silica flooding 60% qtz V, 40%  
granite, mod epidote alt.

305.54 263.40 ft SYENODIORITE

Med to light grey, mg, near contacts grading to cg, in  
core of unit, 80% med grey green feld, 20% biotite,  
nil py, wk fol.

307.96 310.37 ft GRANITE  
mod Fractured with silica flooding (V)

310.37 315.46 ft ALTERED ZONE

intense epidote alteration silicification with 1% purple  
fluorite along late fractures 1/16 to 1/4 inch wide, @  
314.79 ft cubic crystals of purple fluorite.

YESNO, TWP  
HOLE. 5.

N  
↓

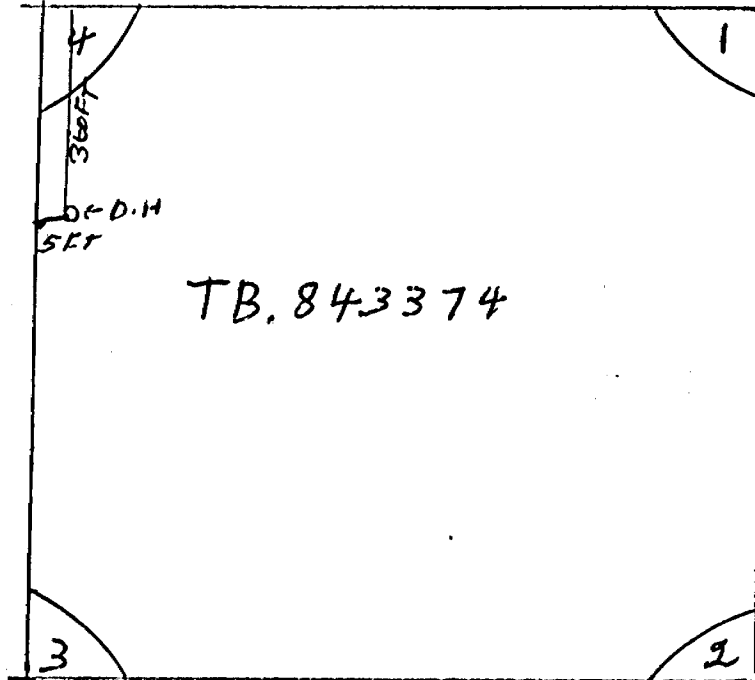

HOLE, 5, YES No. TWP. T. B

BEARING OF HOLE  
FROM NORTH. 180°  
DIP OF HOLE. 50°

060065

CASING  
SAMPLE 60 FT  
60763

SAMPLE  
NO

060055

SAMPLE FROM 397.49 TO 400.20

060056

400.65 TO 403.25

060057

408.79 TO 410.93

060058

415.57 TO 416.70

420.5

END. HOLE





Jan 28/91

This is a brief summary of our no. 8 hole in Wilkie T.W.P. Matheson.

We are now awaiting results from assays, which will be forwarded to you as soon as we receive them. (five assays for Base metals)

We are now at a depth of 403 ft. We are approximately 40 to 60 ft from proposed target which should consist of brusha zone and carbonites.

We are hoping to continue to a depth of approximately 750 to 800 ft we had to stop due to cold weather, hopefully we'll be able to continue in the spring.

(We are drilling on a maylow)

From the depth of 125 to 403 ft, we are hitting fair amounts of mineralization throughout the core, which does not seem to show up in the drill log results.

1) PROPERTY NAME AND NUMBER: Sunset Vein( ) DATE(S) VISITED:

2) ALTERNATE NAME(S): Asarco Exploration Co. of Canada Ltd.

3) COMMODITY: MAIN: Fl, ba SECONDARY: anyethyst

4) DEVELOPMENT, HISTORY AND OWNERSHIP:

PAST: 1973 Geological reconnaissance mapping, silt and water sampling by Asarco Explorations.

CURRENT:

5) LOCATION AND ACCESS:

N.T.S. 42 D 13/NE  
Latitude: 48° 54'  
Longitude: 87° 38'

The occurrence is not staked, although its apparent eastern extension is held by L. A. Halonen who has completed a substantial amount of surface mechanical work from 1984 to 1985.

GENERAL LOCATION:

Approximately 4 km (2.5 miles) west of the Pays Plat Indian Reserve on Trans-Canada Highway 17.

ACCESS:

Access is available via Highway 17, about 4 km west of the Pays Plat Indian Reserve. The vein system crosses the highway and further access is provided by a communication tower access road branching off from the main highway.

REFERENCES:

Resident Geologist's Files, Ontario Ministry of Northern Affairs and Mines, Thunder Bay. *Development*

MAP REFERENCES:

Map 2232, Nipigon-Schreiber, *Sheet* (M.W. Carter, et al, ~~1970-71~~ 1973).

6) GENERAL GEOLOGY AND STRUCTURE:

The area is underlain by an igneous complex of two major rock types, granite and pegmatite. This complex is cut by two major structures. The earlier structure is represented by a quartz-epidote veining system and the later structure represents a system of mafic dikes.

The granitic rock is fine to medium grained and pink in colour, and ranges in composition from a high silica-potassium granite to a granodiorite.

Many portions of the granite contain inclusions or xenoliths of mafic material that have been altered by the intruding granite. Inclusions vary in size from 5 cm up to many meters (a few inches to tens of feet) in diameter. Some inclusions show sharp contacts whereas others show gradational contacts. *whereas*

GENERAL GEOLOGY AND STRUCTURE: (continued)

The granite is cut by numerous narrow pegmatite veins composed of quartz and coarse-grained feldspar. The veins vary in width from 5 cm to 0.6 or 1 meter ( a few inches to 2 or 3 feet) and strike N 70° E.

There are numerous fluorite veins in the vicinity. The majority of these are found in the surfaces of the joint planes, as seams of purple fluorite cubes. (Reference) (Also: See Sunrise Vein).

*(Resident Geologist's Files, Ontario Ministry of Northern Development and Mines, Thunder Bay)*

7) MINERALOGY:

Mapping by Asarco Exploration Co. indicated a continuous mineralized fluorite zone extending for more than 915 m (3000 feet). The zone varies in width from 1.2 m to 13.5 m (4 to 44 feet). It is made up of a milky quartz vein which dips vertically and strikes northeast-southwest. The vein is flanked on the northwest by a breccia, the matrix of which is made up of fluorite, milky-white quartz, amethyst, and barite. Breccia fragments are derived from the surrounding granites and have been altered by silicification and epidotization. Fluorite mineralization is erratic throughout the vein (Reference).

*(Resident Geologist's Files, Ontario Ministry of Northern Development and Mines, Thunder Bay)*

Three major fluorite bearing veins, and a few minor ones have been located. They contain large granitic fragments cemented together by quartz, barite, and fluorite. The quartz is usually a white milky colour although some cavities are lined with amethyst crystals. The breccia fragments contain epidote, giving the breccia zones a greenish-yellow colouration on fresh surfaces.

8) ECONOMIC FEATURES:

TONNAGE AND GRADE ESTIMATES:

PAST PRODUCTION:

9) CHEMICAL ANALYSES:

The following assay values were obtained by Asarco on the Sunset Vein:

<u>Sample No.</u>	<u>Assay Width</u>	<u>%CaF<sub>2</sub></u>
7157	7.6 m (25')	5.48
7158	1.8 m ( 6')	11.13
7159	0.5 m (1.7')	1.25
7160	2.1 m (7')	3.94
7161	3 m (10')	0.72
7162	2.7 m (9')	0.54
7163	1.2 m (4')	0.60
7164	character sample	0.43
7165	1.2 m (4')	0.35
7142	character sample	20.48



THE MINING ACT - MINISTRY OF NATURAL RESOURCES  
DIAMOND DRILLING LOG

Start a new page for every new hole, but fill in top portion of form only on first page for each hole.

FILL IN ON EVERY PAGE

HOLE NO. 6 PAGE NO. 1

DRILLING COMPANY Elwood Fournier		COLLAR ELEVATION	BEARING OF HOLE FROM TRUE NORTH 060°	TOTAL FOOTAGE	DIP OF HOLE AT collar   -52	LOCATION OF HOLE IN RELATION TO A FIXED POINT ON THE CLAIM 
DATE HOLE STARTED November 1, 1990	DATE COMPLETED Nov. 5, 1990	DATE LOGGED 1991.01.18	LOGGED BY Douglas Robinson			
EXPLORATION CO., OWNER OR OPTIONEE Elwood Fournier		DATE SUBMITTED	SUBMITTED BY (Signature)			

MAP REFERENCE NO.

CLAIM NO. TB843374

LOCATION (Tp., Lot, Con. OR Lat. and Long.)  
Yesno Township

PROPERTY NAME  
Asarco Exploration Co. (1973)

FOOTAGE		ROCK TYPE	DESCRIPTION Colour, grain size, texture, minerals, alteration, etc.	PLANAR FEATURE ANGLE *	CORE SPECIMEN FOOTAGE †	YOUR SAMPLE NUMBER	SAMPLE FOOTAGE		SAMPLE LENGTH	ASSAYS †	
FROM	TO						FROM	TO			
0	56	Casing									
56	239	Granite	Alternating sections of massive granite and coarse grained pegmatite as logged below. Slips are spaced at 1-12". Light to heavy dark green chlorite is common on slips.			060065	213	215	2 ft		
	56-60		Pegmatite: 2-5mm xline dominantly 2-5mm xline approx. 90% pale red feldspar. approx. 10% quartz.								
	60-78		Massive Granite: Uniform 0.5-2mm xline, red coloured due to red feldspar which is the dominant mineral. Approximately 10% of rock is quartz. Mafic minerals hornblende and/or biotite constitute less than 10% of rock. Distinct foliation 40-45° to C.A.								

\* For features such as foliation, bedding, schistosity, measured from the long axis of the core.





Ontario

THE MINING ACT - MINISTRY OF NATURAL RESOURCES  
DIAMOND DRILLING LOG

Start a new page for every new hole, but fill in top portion of form only on first page for each hole.

FILL IN ON EVERY PAGE

HOLE NO. 6 PAGE NO. 3

DRILLING COMPANY		COLLAR ELEVATION	BEARING OF HOLE FROM TRUE NORTH	TOTAL FOOTAGE	DIP OF HOLE AT collar	LOCATION OF HOLE IN RELATION TO A FIXED POINT ON THE CLAIM	MAP REFERENCE NO.	CLAIM
DATE HOLE STARTED	DATE COMPLETED	DATE LOGGED	LOGGED BY		ft			TB843374
EXPLORATION CO., OWNER OR OPTIONEE		DATE SUBMITTED	SUBMITTED BY (Signature)		ft			LOCATION (Tp., Lot, Con. OR Lot. and Long.)
Elwood Fournier					ft			Yesno Township
							PROPERTY NAME	

FOOTAGE FROM TO		ROCK TYPE	DESCRIPTION Colour, grain size, texture, minerals, alteration, etc.	PLANAR FEATURE ANGLE *	CORE SPECIMEN FOOTAGE †	YOUR SAMPLE NUMBER	SAMPLE FOOTAGE FROM TO		SAMPLE LENGTH	ASSAYS †		
			215.1 - 216.9 1-4mm xline, approximately 10-15 hornblende, no quartz noted									
			216.9-218.0 1mm xline, dark green greater than 15% hornblende and biotite. (as 215.1-216.9)									
			218.0-218.5 (as 218.1-219.9)									
			214.8-220.0 trace fine anhedral pyrite interstitial to feldspar and hornblende.									
		219.5-234	Pegmatite (as 90-155)									
		234-237	Massive granite (as 60-78)									
			237 End of hole.									

\* For features such as foliation, bedding, schistosity, measured from the long axis of the core.

† Additional credit available. See Assessment Work Regulations

HOLE. 6.

BEARING. OF. HOLE  
FROM. NORTH.  $060^{\circ}$

DIP OF HOLE  $-52^{\circ}$

CASING 56 FT

FROM 213.215 FT

237 FT END OF HOLE

SAMPL  
NO  
060065

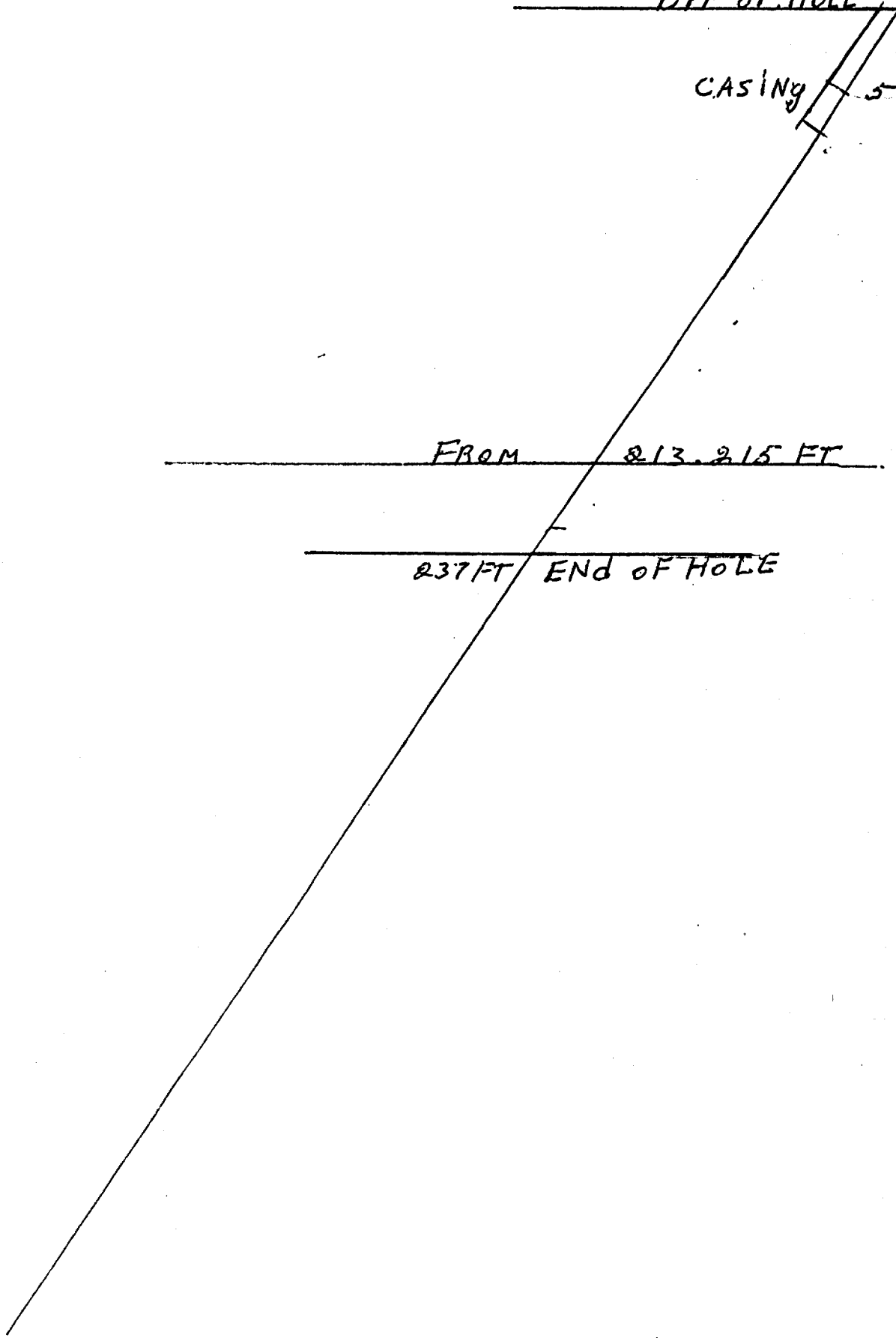

YESNO. TWP  
HOLE. 6

22

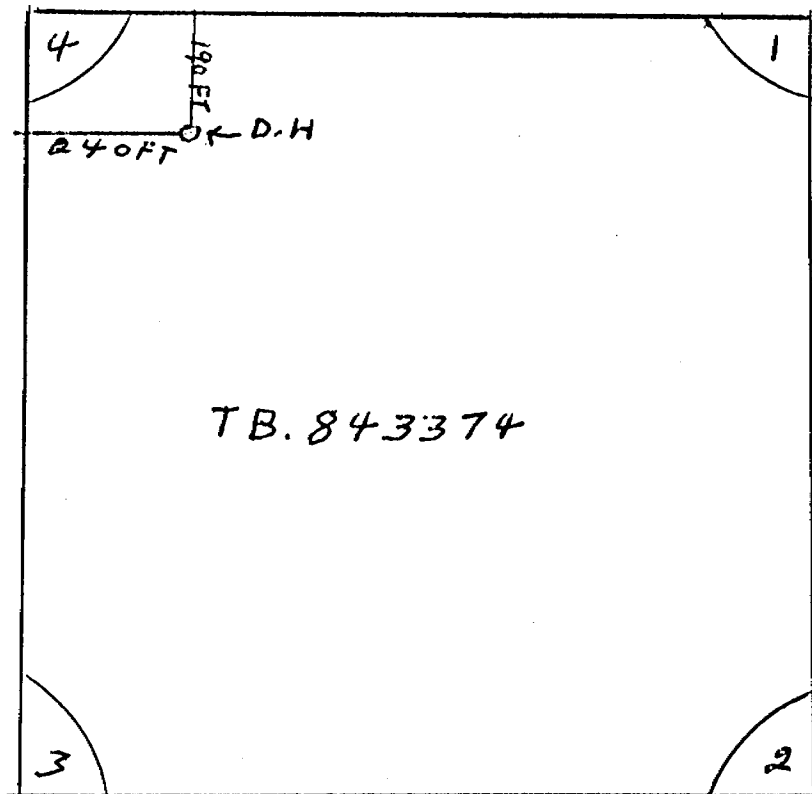





HOLE. 8 WILK. TWP

BEARING OF HOLE  
FROM NORTH. 180°

Dip of HOLE 55°

SAMPL  
NO.

CASING 93 FT

060059

SAMPL 118 To 121

060060

SAMPL 136 To 138

060061

SAMPL 168 To 171

060062

SAMPL 239 To 241

060063

SAMPL 255 To 257

403 FT

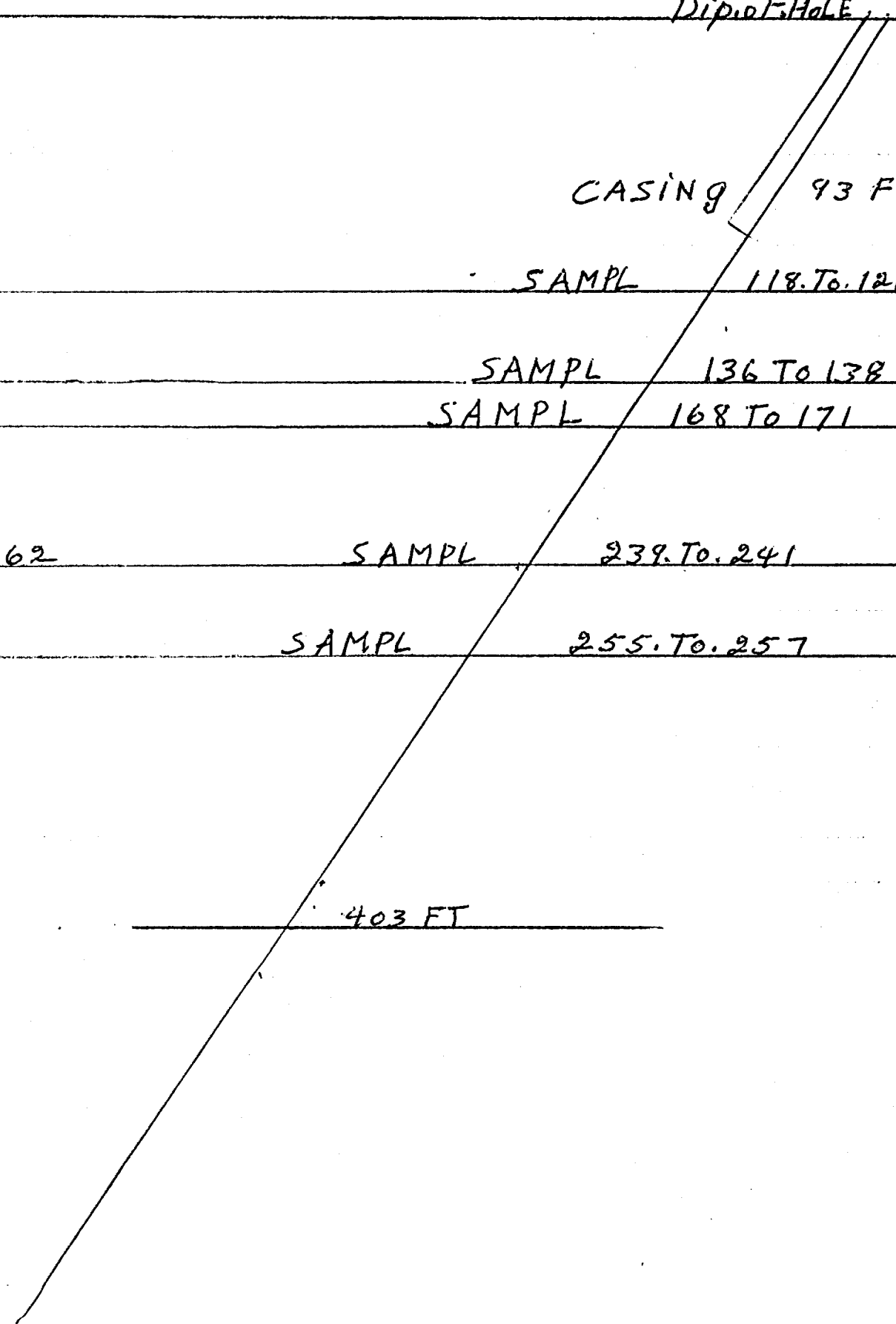

ALL.

HOLE, 8

WILK. TWP

TRENCHING  
SAMPLING

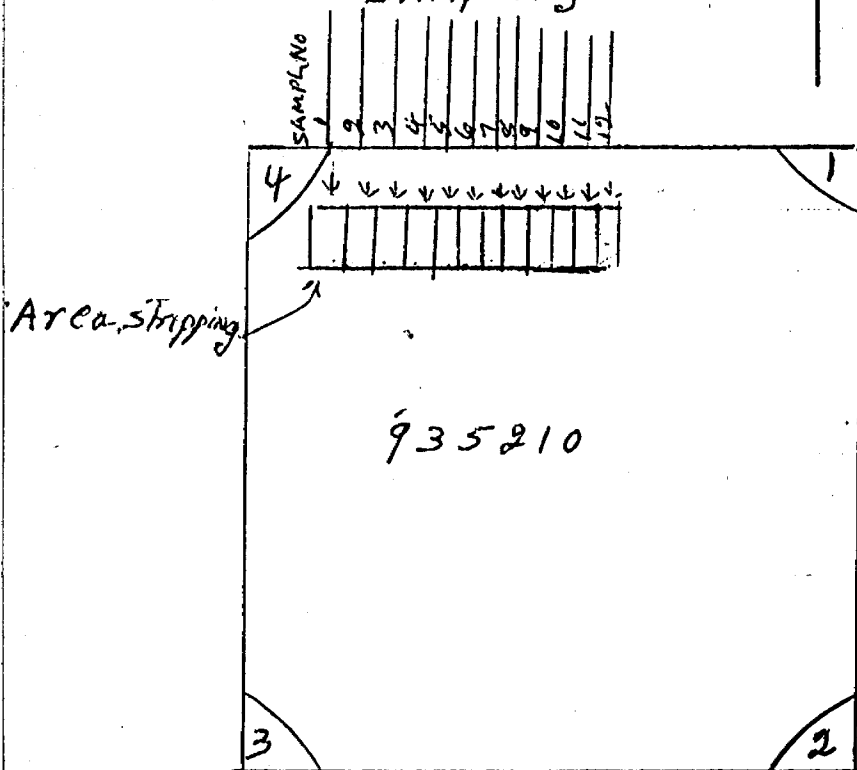

ALL SAMPLES PICKED.  
WERE IN THE SIZE  
O.F. BETWEEN 7cm.  
10cm.

SAMPL. NO.	ASSAY	Rock Type
21/05/90	1 60049	ANDESIT
21/05/90	2 60050	ANDESIT
21/05/90	3 060051	ANDESIT
21/05/90	4 060052	BASAIT.
21/05/90	5 060053	breccia-BASAIT
21/05/90	6 060054	breccia-BASAIT
3/06/90	7 W4088	breccia-BASAIT
3/06/90	8 W4-028	BASAIT, ALTERED
3/06/90	9 W4105	BASAIT, ALTERED
9/06/90	10 W4054	BASAIT, ALTERED
9/06/90	11 W4754	BASAIT, ALTERED

MINOR sulphides  
chalcopyrite  
pyrrhotite  
thru out //  
Trench.

1990. EXPENSES.

GAS - OIL - Propane.

WILKIE. Tw P.	MATHESON.	
20.00	14.04	12.78
21.00	28.04	27.27
20.00	20.00	40.05
24.00	20.00	
20.00	21.90	
16.00	21.00	
<u>121.00</u>	<u>124.98</u>	
		Total. 286.03

15.11	34.00	155.00	18.01	49.00	19.00
9.18	50.00	24.00	17.00	30.00	41.47
33.82	32.00	12.00	51.00	72.45	80.18
345.00	35.00	20.00	33.15	32.00	<u>8.83</u>
46.54	19.03	14.90	36.00	34.00	149.48
8.30	20.00	38.00	8.62	19.00	
37.03	20.00	42.00	36.00	36.00	TOTAL
<u>28.00</u>	<u>19.02</u>	<u>33.34</u>	<u>113.75</u>	<u>41.00</u>	1,867.72
522.98	229.05	339.24	313.52	313.45	

~~37.1~~ SEE REVERSE

FINAL TOTAL

2,192.39  
 1,867.72  
286.03  
 4,346.14

1990. EXPENSES.

YES. no. Twp. THUNGER BAY.  
FOOD. & MOTELS.

77.70	16.50	69.45	20.00
15.00	6.45	18.75	60.03
19.22	21.87	32.40	8.75
26.84	21.91	31.00	28.40
8.91	114.64	35.32	14.25
<u>17.87</u>	<u>9.46</u>	<u>6.43</u>	<u>19.42</u>
165.54	190.83	188.35	150.55

9.70	27.25	232.16
28.30	10.85	<u>215.89</u>
83.18	55.50	448.05
62.07	15.22	
<u>183.25</u>	21.98	
	10.00	
	<u>6.05</u>	
	164.85	448.05
		878.52
		<u>164.85</u>
TOTAL.		1491.52

1990. EXPENSES.  
PARTS. & EQUIPMENT.

YES.	NO - TWP.	THUNDER.	Bay.
54.54	61.51	10.02	
4.06	68.02	28.94	
9.98	73.38	36.94	
33.94	<u>202.91</u>	5.05	10.80
26.91		30.19	<u>35.77</u>
31.03		35.39	
<u>160.46</u>		17.26	46.57
		15.50	
		<u>179.29</u>	

160.46	179.29
<u>202.91</u>	<u>46.57</u>
363.37	225.86

363.37
<u>225.86</u>
589.23

TOTAL. 589.23

MISCELLANEOUS.

688.50	BITS.
689.80	BITS.
257.00	ASSAYS.
81.00	CASING BIT
57.00	CUTTING OIL
83.00	TRANSMISSION OIL
25.00	ROD GREASE
178.00	INSURANCE.

2,059.30	TOTAL.
<u>600.00</u>	
2659.30	CAMPER RENTAL

1990 - EXPENSES.

YES - NO. TOWNSHIP. THUNDER BAY  
GAS & OIL & PROPANE.

40.16	62.00	23.00	55.00
68.86	38.00	2.47	25.00
32.00	145.00	40.30	33.15
151.00	24.70	40.00	30.00
<u>215.00</u>	<u>31.02</u>	17.40	53.00
507.02	300.72	20.00	31.00
		30.00	52.00
113.28		<u>51.01</u>	<u>29.18</u>
		224.18	308.33

180.00  
183.00  
680.00  

---

1043.00

807.74  
645.79  

---

1,043.00

Total. 2,496.53

1990 - EXPENSES.

YES. NO. TWP.	THUNDER Bay.
GAS & OIL.	— 2,496.53
FOOD & MOTELS.	— 1,491.52
PARTS & EQUIPMENT.	— 589.23
MISCELLANEOUS & ASSAYS.	— 2,659.20
RENTAL.	<u>7286.48</u>

WILKIE.. TWP EXPENSES.

GAS & OIL	4,346.14
PARTS & EQUIPMENT.	2,140.44
FOOD & ROOMS.	1,427.01
MISCELLANEOUS.	1,768.66
	<u>9,682.25</u>

9,682.25

7,236.48

16,918.73

ALL EXPENSES DIVIDED IN  $33\frac{1}{3}\%$  EACH

ELWOOD, FOURNIER.	OP 90356
JAMES ALLOIRE.	OP 90357
JULIEN McLEAN.	OP 90358

# 1990 EXPENSES FOOD + ROOMS

WILKIE TWP.

MATHESON

28.33	104.32	22.00	22.45	
23.78	14.06	11.39	6.10	TOTAL
22.95	51.65	15.00	18.09	717.69
10.37	15.28	26.35	36.75	
10.04	109.06	14.17	<u>103.82</u>	
6.37	<u>21.33</u>	<u>24.63</u>	187.21	
<u>101.24</u>	315.70	113.54		

10.32	18.00	10.00	13.44	10.00	
18.20	18.09	16.19	22.00	8.33	
15.00	6.55	12.64	11.00	50.02	TOTAL
20.00	10.04	15.80	12.52	36.11	
6.30	12.50	20.77	16.07	8.92	564.88
8.26	14.91	6.97	15.28	15.04	
<u>9.65</u>	12.00	15.94	14.97	7.58	
<del>102.50</del>	<u>10.50</u>	<u>11.00</u>	<u>5.05</u>	<u>8.42</u>	
100.23	102.59	107.31	110.33	144.42	

15.67	107.69
17.00	<u>36.75</u>
7.78	144.44
25.06	
7.78	
16.80	
<u>17.60</u>	
107.69	

TOTAL 144.44

FINAL TOTAL

717.69  
 564.88  
144.44  
 \$1,427.01



1990. EXPENSES.

YES. NO. MISCELLANEOUS. THUNDERBAY  
 WILKIE. T.W.P. MATHESON.

6.45 ministry  
 15.00 ministry  
 5.57 Purikator.  
7.56  
 27.02 TOTAL.

193.04 POWDER.  
 14.95 Lab.  
 16.10 Lab.  
 14.95 Lab.  
 29.90 Lab.  
 13.54 Lab.  
232.48 TOTAL.

175.00 PLATES.  
~~16.15~~ MINING OFFICE.  
 274.10 BITS.  
 452.61 ASSAYS.  
 76.00 "  
 127.00 "  
 181.00 "  
 120.00 "  
 95.00 PLATES.  
1509.16 TOTAL.

27.02  
 232.48  
 1,509.16  

---

 1,768.66

FINAL TOTAL.

1990. EXPENSES.

PARTS & EQUIPMENT.

WILKIE TWP.

MATHESON.

19.00

4.31

32.39

14.79

4.09

10.79

6.43

91.80

10.79

91.80

7.56

110.14 TOTAL.

28.26

4.42

.87

21.59

9.71

9.93

192.24

17.14

284.16

60.91

25.58

19.35

17.82

7.24

24.18

16.41

2.76

174.25

36.13

13.55

57.00

106.68

TOTAL. 565.09

25.96

10.00

10.45

25.80

41.22

45.93

19.78

23.35

11.86

5.00

14.52

12.62

44.24

26.38

33.66

22.68

7.34

10.77

8.52

4.67

40.00

26.89

7.34

48.30

8.57

6.16

21.00

17.17

31.92

59.45

33.47

44.26

27.00

25.00

46.22

140.40

43.19

38.76

56.56

42.71

34.54

219.35

189.93

153.58

230.53

171.25

183.10

536.82

110.14 + 565.09 + 1465.21 =

TOTAL. 2,140.44

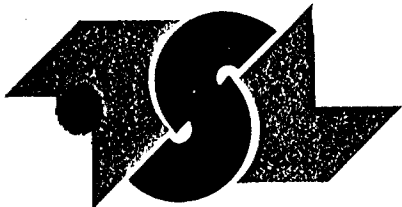

# T S L LABORATORIES

DIVISION OF BURGENER TECHNICAL ENTERPRISES LIMITED

2031 RIVERSIDE DRIVE, UNJT #2

TIMMINS, ONTARIO

P4N 7C3

☎ (705) 268-4441 FAX: (705) 268-4420

## CERTIFICATE OF ANALYSIS

SAMPLE(S) FROM Sunset Exploration  
448 Tonelli  
Timmins, Ontario

REPORT No.  
W4054

SAMPLE(S) OF Rock

INVOICE #: 3975  
P. O. :

J. McLean

	Au ppb	Ag ppm	Zn ppm
- A -	<5	<.2	107

COPIES TO: Timmins  
INVOICE TO: Timmins

Jun 13/90

SIGNED \_\_\_\_\_



For enquiries on this report, please contact Customer Service Department.  
Samples, Pulps and Rejects discarded two months from the date of this report.

Page 1 of 1

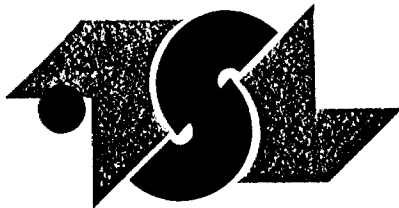

# T S L LABORATORIES

DIVISION OF BURGENER TECHNICAL ENTERPRISES LIMITED

2031 RIVERSIDE DRIVE, UNIT #2

TIMMINS, ONTARIO

P4N 7C3

☎ (705) 268-4441 FAX: (705) 268-4420

## CERTIFICATE OF ANALYSIS

SAMPLE(S) FROM Sunset Exploration  
44R Tonelli  
Timmins, Ontario  
264-3348

REPORT No. W5067
---------------------

SAMPLE(S) OF core

INVOICE #: 5059  
P. O. :

	Au
	ppb
1	<5

COPIES TO: Julien McLean  
INVOICE TO: Julien McLean

Jan 02/91

SIGNED \_\_\_\_\_ 

For enquiries on this report, please contact Customer Service Department.  
Samples, Pulps and Rejects discarded two months from the date of this report.





# Swastika Laboratories

A Division of Assayers Corporation Ltd.

Assaying - Consulting - Representation

## Assay Certificate

0W-0791-RA1

Company: **MR. E. FOURNIER**

Project:

Attn: **MR. E. FOURNIER**

Date: JUN-14-90

Copy 1. P.O. BOX 256, SWASTIKA, ONT. P0K 1T0

We hereby certify the following Assay of 4 ROCK samples submitted JUN-12-90 by .

Sample Number	Au oz/ton	Au check oz/ton	Ag oz/ton
060051	0.006		Nil
060052	0.008		Nil
060053	0.006	0.004	Nil
060054	Nil		Nil

Multi-Element results to follow

Certified by

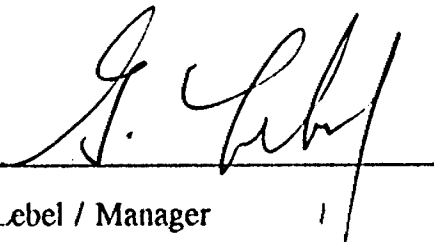
  
G. Lebel / Manager

P.O. Box 10, Swastika, Ontario P0K 1T0  
Telephone (705) 642-3244 FAX (705) 642-3300



# T S L LABORATORIES

DIVISION OF BURGNER TECHNICAL ENTERPRISES LIMITED

2031 RIVERSIDE DRIVE, UNIT #2  
TIMMINS, ONTARIO  
P4N 7C3

☎ (705) 268-4441 FAX: (705) 268-4420

## CERTIFICATE OF ANALYSIS

SAMPLE(S) FROM Sunset Exploration  
448 Tonelli  
Timmins, Ontario  
264-3348

REPORT No:  
W4028

SAMPLE(S) OF rock

INVOICE #: 3949  
P. O. :

J. McLean

	Au ppb	Ag ppm
A	<5	<.2
B	<5	<.2

COPIES TO: J. McLean  
INVOICE TO: J. McLean

Jun 06/90

SIGNED \_\_\_\_\_



For enquiries on this report, please contact Customer Service Department.  
Samples, Pulps and Rejects discarded two months from the date of this report.

Page 1 of 1



# Swastika Laboratories

A Division of Assayers Corporation Ltd.

Assaying - Consulting - Representation

Rock

## Assay Certificate

OW-0765-RA1

Company: **E. FOURNIER**

Date: JUN-12-90

Project:

Copy 1. Box 256, Swastika, Ont POK ITO

Attn:

We hereby certify the following Assay of 2 ROCK samples submitted JUN-08-90 by E. FOURNIER.

Sample Number	Au oz ton
60049	Nil
60050	Nil

Results for multi element scan to follow

Certified by

  
G. Lebel / Manager

P.O. Box 10, Swastika, Ontario POK ITO  
Telephone (705) 642-3244 FAX (705) 642-3300

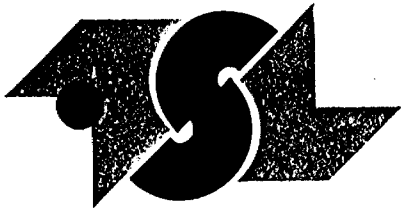

# T S L LABORATORIES

DIVISION OF BURGENER TECHNICAL ENTERPRISES LIMITED

2031 RIVERSIDE DRIVE, UNIT #2

TIMMINS, ONTARIO

P4N 7C3

☎ (705) 268-4441 FAX: (705) 268-4420

## CERTIFICATE OF ANALYSIS

SAMPLE(S) FROM Sunset Exploration  
448 Tonelli  
Timmins, Ontario

REPORT No.  
W4105

INVOICE #: 4030  
P.O.:

SAMPLE(S) OF rock

J. McLean

	Au ppb	Ag ppm
- A -	10	<.2

COPIES TO: Timmins  
INVOICE TO: Timmins

Jun 20/90

SIGNED \_\_\_\_\_



For enquiries on this report, please contact Customer Service Department.  
Samples, Pulps and Rejects discarded two months from the date of this report.





# Swastika Laboratories

A Division of Assayers Corporation Ltd.

Assaying - Consulting - Representation

## Assay Certificate

1W-2129-RA1

Company: E. FOURNIER

Date: JAN-25-91

Project:

Copy 1. SWASTIKA

Attn:

We hereby certify the following Assay of 8 SPLIT CORE samples submitted JAN-23-91 by .

Sample Number	Au oz/ton	Au check oz/ton	Ag oz/ton	Ba ppm	Multi Element	Fluorine PPM
060059	0.002	0.002	Nil			
060060	0.002		Nil			
060061	Nil		Nil			
060062	Nil		Nil			
060063	Nil		Nil			
060064	0.002		Nil			
060065	Nil		Nil			
060066	Nil		Nil			

WILKIE  
8  
THUNDER BAY

Certified by Donna Gardner

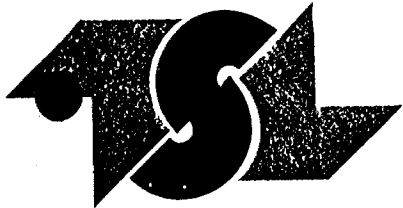

# T S L LABORATORIES

DIVISION OF BURGNER TECHNICAL ENTERPRISES LIMITED

2031 RIVERSIDE DRIVE, UNIT #2

TIMMINS, ONTARIO

P4N 7C3

☎ (705) 268-4441 FAX: (705) 268-4420

## CERTIFICATE OF ANALYSIS

SAMPLE(S) FROM Sunset Exploration  
448 Tonelli  
Timmins, Ontario

REPORT No.  
W4754

SAMPLE(S) OF rock

INVOICE #: 4726  
P. O. :

	Au ppb	Ag ppm
- A -	30	<.2

COPIES TO: Julien McLean  
INVOICE TO: Julien McLean

Oct 03/90

SIGNED \_\_\_\_\_

Page 1 of 1

For enquiries on this report, please contact Customer Service Department.  
Samples, Pulps and Rejects discarded two months from the date of this report.





# Swastika Laboratories

A Division of Assayers Corporation Ltd.

Assaying - Consulting - Representation

## Assay Certificate

0W-0919-RA1

Company: **E. FOURNIER**  
Project:  
Attn:

Date: JUL-05-90  
Copy 1. BOX 256, SWASTIKA, ONT POK ITO

We hereby certify the following Assay of 4 split core samples submitted JUL-03-90 by .

Sample Number	Au oz/ton	Ag oz/ton	Pt oz/ton	Pd oz/ton
60055	Nil	0.01	<0.005	<0.001
60056	Nil	0.01	<0.005	<0.001
60057	Nil	0.02	<0.005	<0.001
60058	Nil	0.01	<0.005	<0.001

*Thunderbay  
hole 5*

Certified by

G. Lebel / Manager

P.O. Box 10, Swastika, Ontario P0K 1T0  
Telephone (705) 642-3244 FAX (705) 642-3300



# Swastika Laboratories

A Division of Assayers Corporation Ltd.

Assaying - Consulting - Representation

## Certificate of Analysis

Certificate No. OW-0919-RA1

Date July 17, 1990

Received July 3, 1990 4 split core samples

Submitted by Mr. E. Fournier, Swastika, Ontario

### "Semi-Quantitative Multi-Element Analysis"

SAMPLE NO:	60055	60056	SAMPLE NO:	60055	60056
Silver	PPM <0.1	<0.1	Thorium	PPM <10	<10
Arsenic	PPM <10	<10	Uranium	PPM <10	<10
Boron	% 0.01	0.01	Vanadium	PPM 70	77
Barium	PPM 1160	1567	Tungsten	PPM <10	<10
Berillium	PPM <10	<10	Yttrium	PPM <10	<10
Bismuth	PPM <10	<10	Zinc	PPM 52	57
Cadmium	PPM <10	<10	Zirconium	PPM 163	159
Cerium	PPM <10	<10	Al <sub>2</sub> O <sub>3</sub>	% 4.7	5.8
Cobalt	PPM 21	29	Fe <sub>2</sub> O <sub>3</sub>	% 3.1	3.8
Chromium	PPM 792	1085	CaO	% 1.1	1.1
Copper	PPM <10	14	MgO	% 1.2	1.5
Lanthanum	PPM 16	21	Na <sub>2</sub> O	% 4.5	3.2
Molybdenum	PPM <10	<10	K <sub>2</sub> O	% 2.2	2.7
Niobium	PPM <10	<10	TiO <sub>2</sub>	% 0.3	0.2
Nickel	PPM 109	208	MnO	% 0.06	0.05
Lead	PPM 47	63	P <sub>2</sub> O <sub>5</sub>	% 0.1	0.1
Sulphur	% 0.4	0.9	LOI	% 3.58	2.49
Antimony	PPM <10	<10			
Selenium	PPM 10	12			
Tin	PPM <10	<10			
Strontium	PPM 46	50			
Tellurium	PPM <10	<10			

*Handwritten signature: E. Fournier*

NOTE: Slight chromium contamination due to use of hard chrome steel pulverizer plates.

Per *G. Lebel*

G. Lebel, Manager/dg

P.O. Box 10, Swastika, Ontario P0K 1T0

Telephone (705) 642-3244.

FAX (705) 642-3300





# Swastika Laboratories

A Division of Assayers Corporation Ltd.

Assaying - Consulting - Representation

## Certificate of Analysis

Certificate No. OW-0765-RA1 Date June 15, 1990  
 Received June 8, 1990 2 rock samples  
 Submitted by Mr. E. Fournier, Swastika, Ontario

### "Semi-Quantitative Multi-Element Analysis"

SAMPLE NO:	60049	60050	SAMPLE NO:	60049	60050
Silver	PPM <0.1	<.01	Thorium	PPM <10	<10
Arsenic	PPM <10	<10	Uranium	PPM <10	<10
Boron	% 0.1	0.06	Vanadium	PPM 308	279
Barium	PPM 51	22	Tungsten	PPM 30	22
Berillium	PPM <10	<10	Yttrium	PPM 23	24
Bismuth	PPM 22	<10	Zinc	PPM 183	309
Cadmium	PPM 115	22	Zirconium	PPM 98	83
Cerium	PPM <10	<10	Al <sub>2</sub> O <sub>3</sub>	% 9.1	8.8
Cobalt	PPM 135	80	Fe <sub>2</sub> O <sub>3</sub>	% 14.8	14.5
Chromium	PPM 228	237	CaO	% 8.4	10.5
Copper	PPM 116	129	MgO	% 4.9	5.1
Lanthanum	PPM <10	<10	Na <sub>2</sub> O	% 0.8	0.4
Molybdenum	PPM 13	<10	K <sub>2</sub> O	% 0.1	0.03
Niobium	PPM <10	<10	TiO <sub>2</sub>	% 1.0	0.8
Nickel	PPM 66	59	MnO	% 0.2	0.2
Lead	PPM 231	137	P <sub>2</sub> O <sub>5</sub>	% 0.2	0.1
Sulphur	% 0.5	0.8	LOI	% 5.44	6.85
Antimony	PPM <10	<10			
Selenium	PPM <10	<10			
Tin	PPM <10	<10			
Strontium	PPM 149	159			
Tellurium	PPM 35	15			

NOTE: Slight chromium contamination due to use of hard chrome steel pulverizer plates.

Per   
 G. Lebel, Manager/dg



P.O. Box 10, Swastika, Ontario P0K 1T0  
 Telephone (705) 642-3244 FAX (705) 642-3300



# Swastika Laboratories

A Division of Assayers Corporation Ltd.

Assaying - Consulting - Representation

## Certificate of Analysis

Certificate No. OW-0919-RA1

Date July 17, 1990

Received July 3, 1990 4 split core samples

Submitted by Mr. E. Fournier, Swastika, Ontario

"Semi-Quantitative Multi-Element Analysis"

SAMPLE NO:	60055	60056	SAMPLE NO:	60055	60056
Silver	PPM <0.1	<0.1	Thorium	PPM <10	<10
Arsenic	PPM <10	<10	Uranium	PPM <10	<10
Boron	% 0.01	0.01	Vanadium	PPM 70	77
Barium	PPM 1160	1567	Tungsten	PPM <10	<10
Berillium	PPM <10	<10	Yttrium	PPM <10	<10
Bismuth	PPM <10	<10	Zinc	PPM 52	57
Cadmium	PPM <10	<10	Zirconium	PPM 163	159
Cerium	PPM <10	<10	Al <sub>2</sub> O <sub>3</sub>	% 4.7	5.8
Cobalt	PPM 21	29	Fe <sub>2</sub> O <sub>3</sub>	% 3.1	3.8
Chromium	PPM 792	1085	CaO	% 1.1	1.1
Copper	PPM <10	14	MgO	% 1.2	1.5
Lanthanum	PPM 16	21	Na <sub>2</sub> O	% 4.5	3.2
Molybdenum	PPM <10	<10	K <sub>2</sub> O	% 2.2	2.7
Niobium	PPM <10	<10	TiO <sub>2</sub>	% 0.3	0.2
Nickel	PPM 109	208	MnO	% 0.06	0.05
Lead	PPM 47	63	P <sub>2</sub> O <sub>5</sub>	% 0.1	0.1
Sulphur	% 0.4	0.9	LOI	% 3.58	2.49
Total Irony	PPM <10	<10			
Strontium	PPM 10	12			
Tin	PPM <10	<10			
Tantalum	PPM 46	50			
Tellurium	PPM <10	<10			

NOTE: Slight chromium contamination due to use of hard chrome steel pulverizer plates.

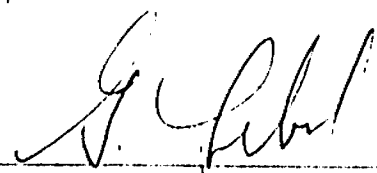
Per 

G. Lebel, Manager/dg

P.O. Box 10, Swastika, Ontario P0K 1T0

Telephone (705) 642-3244

FAX (705) 642-3300

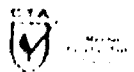



# Swastika Laboratories

A Division of Assayers Corporation Ltd.

Assaying - Consulting - Representation

## Certificate of Analysis

R<sup>o</sup>R

*Matheson*

Certificate No. OW-0791-RA1

Date June 20, 1990

Received June 12, 1990 4 rock samples

Submitted by Mr. E. Fournier, Swastika, Ontario

### "Semi-Quantitative Multi-Element Analysis"

SAMPLE NO:	060051	060052	SAMPLE NO:	060051	060052
Silver	PPM 2	<0.1	Thorium	PPM <10	<10
Arsenic	PPM <10	<10	Uranium	PPM <10	<10
Boron	% 0.04	0.04	Vanadium	PPM 290	277
Barium	PPM 182	88	Tungsten	PPM <10	<10
Berillium	PPM <10	<10	Yttrium	PPM 28	29
Bismuth	PPM <10	<10	Zinc	PPM 157	163
Cadmium	PPM 18	15	Zirconium	PPM 96	99
Cerium	PPM <10	<10	Al <sub>2</sub> O <sub>3</sub>	% 10.2	9.8
Cobalt	PPM 89	79	Fe <sub>2</sub> O <sub>3</sub>	% 11.6	11.2
Chromium	PPM 166	201	CaO	% 7.0	7.4
Copper	PPM 128	112	MgO	% 5.1	4.8
Lanthanum	PPM <10	<10	Na <sub>2</sub> O	% 2.6	1.8
Molybdenum	PPM <10	<10	K <sub>2</sub> O	% 0.5	0.3
Niobium	PPM <10	<10	TiO <sub>2</sub>	% 1.1	1.0
Nickel	PPM 68	64	MnO	% 0.1	0.1
Lead	PPM 163	164	P <sub>2</sub> O <sub>5</sub>	% 0.1	0.1
Sulphur	% 0.5	0.4	LOI	% 4.69	5.62
Antimony	PPM <10	<10			
Selenium	PPM <10	<10			
Tin	PPM <10	<10			
Strontium	PPM 185	197			
Tellurium	PPM 13	13			

NOTE: Slight chromium contamination due to use of hard chrome steel pulverizer plates.

Per *G. Lebel*  
G. Lebel, Manager/dg



P.O. Box 10, Swastika, Ontario P0K 1T0  
Telephone (705) 642-3244 FAX (705) 642-3300



Rock

"Semi-Quantitative Multi-Element Analysis"

SAMPLE NO:	060053	060054	SAMPLE NO:	060053	060054		
Silver	PPM	<0.1	6	Thorium	PPM	<10	<10
Arsenic	PPM	<10	14	Uranium	PPM	<10	<10
Boron	%	0.04	0.06	Vanadium	PPM	286	348
Barium	PPM	47	23	Tungsten	PPM	<10	<10
Berillium	PPM	<10	<10	Yttrium	PPM	26	29
Bismuth	PPM	<10	<10	Zinc	PPM	158	188
Cadmium	PPM	18	25	Zirconium	PPM	94	101
Cerium	PPM	<10	12	Al <sub>2</sub> O <sub>3</sub>	%	10.0	9.7
Cobalt	PPM	87	102	Fe <sub>2</sub> O <sub>3</sub>	%	11.7	15.9
Chromium	PPM	189	248	CaO	%	8.5	10.2
Copper	PPM	123	111	MgO	%	5.3	5.6
Lanthanum	PPM	<10	<10	Na <sub>2</sub> O	%	1.4	0.7
Molybdenum	PPM	<10	19	K <sub>2</sub> O	%	0.1	0.06
Niobium	PPM	<10	<10	TiO <sub>2</sub>	%	1.0	1.1
Nickel	PPM	68	77	MnO	%	0.2	0.3
Lead	PPM	143	178	P <sub>2</sub> O <sub>5</sub>	%	0.1	0.1
Sulphur	%	0.4	0.6	LOI	%	6.50	6.51
Antimony	PPM	<10	<10				
Selenium	PPM	<10	<10				
Tin	PPM	<10	<10				
Strontium	PPM	230	302				
Tellurium	PPM	13	16				

NOTE: Slight chromium contamination due to use of hard chrome steel pulverizer plates.

Per G. Lebel

G. Lebel, Manager/dg





**REFERENCES**

**AREAS WITHDRAWN FROM DISPOSITION**

- M.R.O. - MINING RIGHTS ONLY
- S.R.O. - SURFACE RIGHTS ONLY
- M.+S. - MINING AND SURFACE RIGHTS

Description	Order No.	Date	Disposition	File
SEC. 36/80	W. 66/83	18/11/83	M. & S.	171506

**NOTES**

NOTICE OF FORESTRY  
 THIS TOWNSHIP/AREA FALL WITHIN THE WATABEAG MANAGEMENT UNIT AND MAY BE SUBJECT TO FORESTRY OPERATIONS.  
 MNR UNIT FORESTER FOR THIS AREA CAN BE CONTACTED AT:  
 P.O. BOX 129  
 SWASTIKA, ONT.  
 POK - 10T  
 705-642-3222

THE INFORMATION THAT APPEARS ON THIS MAP HAS BEEN COMPILED FROM VARIOUS SOURCES, AND ACCURACY IS NOT GUARANTEED. THOSE WISHING TO STAKE MINING CLAIMS SHOULD CONSULT WITH THE MINING RECORDER, MINISTRY OF NORTHERN DEVELOPMENT AND MINES, FOR ADDITIONAL INFORMATION ON THE STATUS OF THE LANDS SHOWN HEREON.

**RICKARD TOWNSHIP**

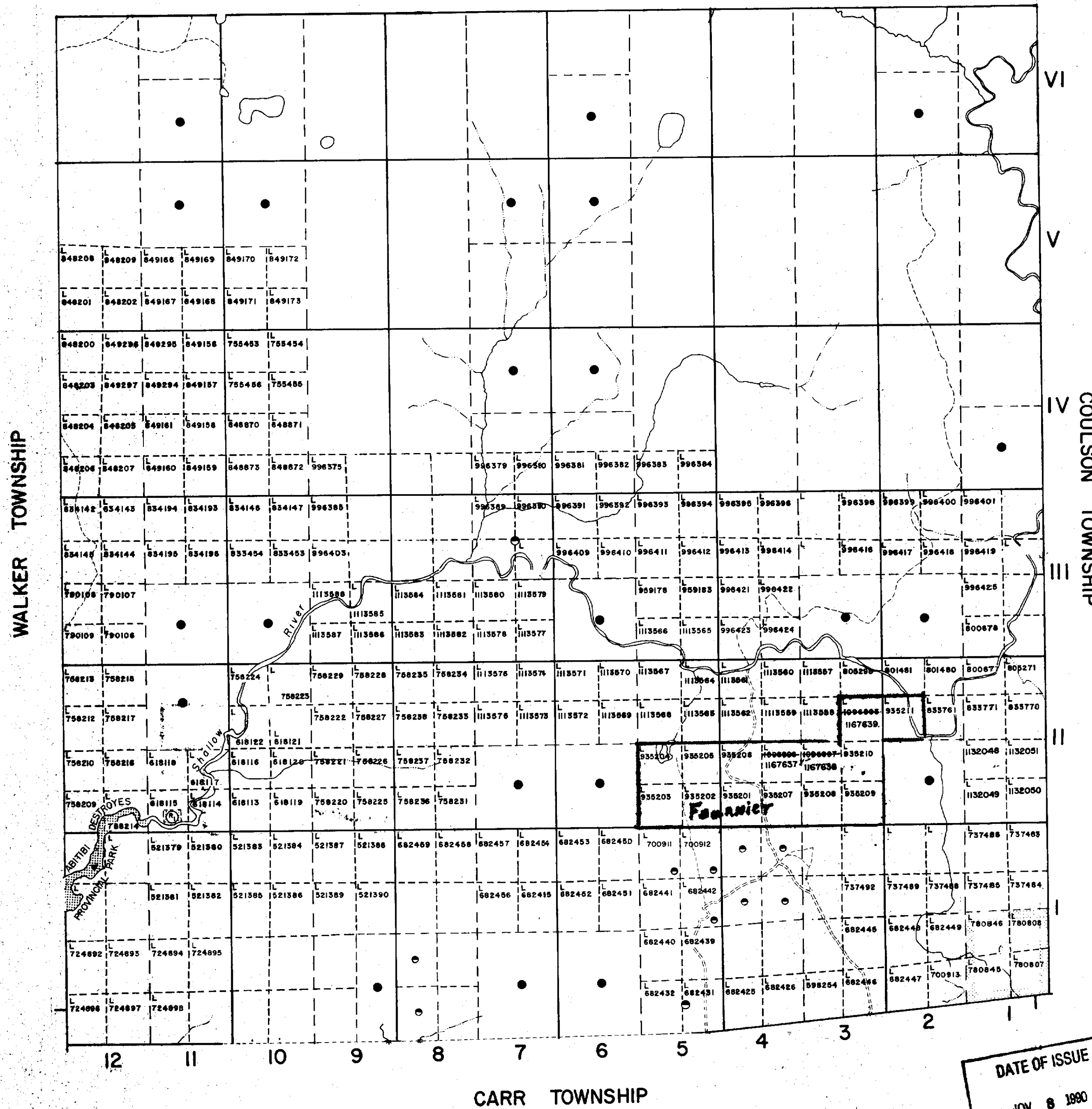

**LEGEND**

- HIGHWAY AND ROUTE No.
- OTHER ROADS
- TRAILS
- SURVEYED LINES:  
 TOWNSHIPS, BASE LINES, ETC.
- LOTS, MINING CLAIMS, PARCELS, ETC.
- UNSURVEYED LINES:  
 LOT LINES
- PARCEL BOUNDARY
- MINING CLAIMS ETC.
- RAILWAY AND RIGHT OF WAY
- UTILITY LINES
- NON-PERENNIAL STREAM
- FLOODING OR FLOODING RIGHTS
- SUBDIVISION OR COMPOSITE PLAN
- RESERVATIONS
- ORIGINAL SHORELINE
- MARSH OR MUSKEG
- MINES
- TRAVERSE MONUMENT

**DISPOSITION OF CROWN LANDS**

TYPE OF DOCUMENT	SYMBOL
PATENT, SURFACE & MINING RIGHTS	●
" SURFACE RIGHTS ONLY	○
" MINING RIGHTS ONLY	○
LEASE, SURFACE & MINING RIGHTS	■
" SURFACE RIGHTS ONLY	□
" MINING RIGHTS ONLY	□
LICENCE OF OCCUPATION	▲
ORDER-IN-COUNCIL	OC
RESERVATION	○
CANCELLED	○
SAND & GRAVEL	○

SCALE: 1 INCH = 40 CHAINS

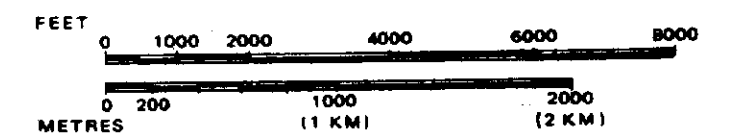

TOWNSHIP  
**WILKIE**  
 M.N.R. ADMINISTRATIVE DISTRICT  
 COCHRANE  
 MINING DIVISION  
 LARDER LAKE  
 LAND TITLES / REGISTRY DIVISION  
 COCHRANE

Ontario Ministry of Natural Resources  
 Ministry of Northern Development and Mines

DATE OF ISSUE  
 NOV 8 1980  
 LARDER LAKE  
 MINING RECORDERS OFFICE

Date MARCH 1990  
 Number G-3587  
 CIRCULATED JULY 20, 1990



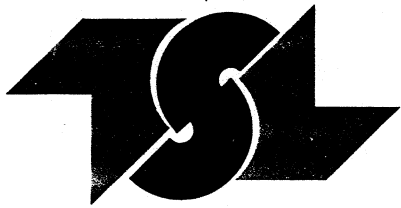

# TECHNICAL SERVICE LABORATORIES

DIVISION OF BURGNER TECHNICAL ENTERPRISES LIMITED

1301 FEWSTER DRIVE  
MISSISSAUGA, ONTARIO  
L4W 1A2

☎ (416) 625-1544 FAX: (416) 625-8368

## CERTIFICATE OF ANALYSIS

SAMPLE(S) FROM

Swastika Laboratories (E. Fournier)  
P.O. Box 10  
Swastika, Ontario  
POK 1T0

REPORT No.

M8710

SAMPLE(S) OF

Pulp

INVOICE #:

P.O.:

Re: 1W-2129-RG1

	Ag ppm	Ba ppm	Be ppm	Bi ppm	Cu ppm	Mn ppm	Ni ppm	Pb ppm	Sn ppm
060060	2	7	<1	<5	120	1300	40	24	<10
060061	<1	<1	<1	<5	100	1200	30	13	<10
060062	<1	<1	<1	<5	120	650	36	3	<10
060063	<1	<1	<1	<5	110	790	43	<1	<10
060064	<1	1	<1	<5	110	680	35	4	<10
060065	<1	110	<1	<5	110	630	28	7	<10
060066	<1	93000	<1	<5	76	220	15	6	<10

	Sr ppm	V ppm	Y ppm	Zn ppm	Zr ppm	Sc ppm	Al ppm	Ca ppm	Fe ppm
060060	42	130	8	69	17	7	28000	17000	61000
060061	10	170	9	76	14	6	27000	25000	55000
060062	10	79	8	50	11	3	22000	13000	44000
060063	16	110	11	65	11	4	28000	7100	54000
060064	11	85	9	72	12	2	24000	6200	49000
060065	27	71	15	65	8	7	16000	13000	33000
060066	160	44	13	23	27	5	15000	38000	17000

	K ppm	Mg ppm	Na ppm	P ppm	Ti ppm	B ppm	As ppm	Au ppb	Br ppm
060060	70	6700	150	260	2900	<10	<5	7	<1
060061	110	6300	430	260	3400	<10	<5	<5	<1
060062	70	6100	210	250	1800	<10	<5	16	<1
060063	70	6800	260	290	2700	<10	<5	<5	<1
060064	80	6300	340	290	2100	<10	<5	9	<1
060065	3500	6300	810	1600	1700	<10	<5	<5	<1
060066	5600	5100	3300	160	1100	<10	<5	<5	<1

INVOICE TO: Swastika

Feb 25/91

SIGNED



For enquiries on this report, please contact Customer Service Department.  
Samples, Pulps and Rejects discarded two months from the date of this report.

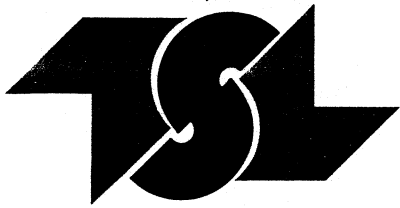

# TECHNICAL SERVICE LABORATORY

DIVISION OF BURGNER TECHNICAL ENTERPRISE

1301 FEWSTE  
MISSISSAUGA, ONT.

(416) 625-1544 FAX: (416) 625-8368

L4W 1A2

## CERTIFICATE OF ANALYSIS

SAMPLE(S) FROM

Swastika Laboratories  
P.O. Box 10  
Swastika, Ontario  
POK 1T0

REPORT No.

M8710

SAMPLE(S) OF

Pulp

INVOICE #:

P.O.:

Re: 1W-2129-RG1

	Cd ppm	Co ppm	Cr ppm	Cs ppm	Hf ppm	Ir ppb	Mo ppm	Rb ppm	Se ppm
060060	<1	46	77	<2	3	<5	<5	<30	<5
060061	2	41	46	<2	2	<5	<5	<30	<5
060062	<1	36	77	<2	2	<5	<5	<30	<5
060063	<1	43	93	<2	2	<5	<5	34	<5
060064	<1	41	78	<2	2	<5	<5	<30	<5
060065	<1	22	40	4	4	<5	58	120	<5
060066	<1	8	29	<2	5	<5	<5	64	<5

	Ta ppm	W ppm	La ppm	Ce ppm	Nd ppm	Sm ppm	Eu ppm	Yb ppm
060060	<1	<4	6	15	<5	3.1	1.7	4.50
060061	<1	<4	4	13	<5	2.6	1.0	3.75
060062	<1	<4	4	11	9	2.2	0.9	3.19
060063	<1	<4	4	10	<5	2.7	1.1	3.76
060064	<1	<4	4	12	8	2.5	1.1	3.40
060065	<1	<4	37	92	47	8.7	2.1	2.45
060066	<1	10	10	19	<5	1.3	0.7	1.20

	Lu ppm	U ppm	Th ppm	F %
060060	0.45	<0.5	0.8	
060061	0.34	<0.5	<0.5	
060062	0.25	<0.5	<0.5	
060063	0.33	<0.5	<0.5	
060064	0.29	<0.5	<0.5	
060065	0.19	3.7	7.6	
060066	0.10	<0.5	5.4	5.75

INVOICE TO: Swastika

Feb 25/91

SIGNED



For enquiries on this report, please contact Customer Service Department.  
Samples, Pulps and Rejects discarded two months from the date of this report.



42D13NE0001 14 MIDDLE FOX LAKE

010

DIAMOND DRILLING

TOWNSHIP: MIDDLE FOX LAKE

REPORT NO: # 14

WORK PERFORMED FOR: ELWOOD FOURNIER

RECORDED HOLDER: SAME AS ABOVE

: OTHER

<u>CLAIM NO.</u>	<u>HOLE NO.</u>	<u>FOOTAGE</u>	<u>DATE</u>	<u>NOTE</u>
843373- 843374	5	420.05 '	APRIL-MAY/90	(1)

NOTES: (1) W9004.311, (FILED NOVEMBER 8, 1990)

## DIAMOND DRILLING LOG

1

HOLE NO. 5

Drilling Company Elwood Fournier

Core Size *15/16* ~~3/4~~ in.

Claim No.

1B 843374

Date Started 90/04/27

Date Finished 90/05/07

Date Logged 90/07/16

Logged By D. R. Boucher

Township Yesno

Property .....

Location UTM Coordinate .....

Grid Coordinate .....

Collar Elevation .....

Bearing 180°

Dip of Hole -50°

Depth collar .....

Length 420.05 ft

## PURPOSE

To test total field magnetic high and fluorite occurrence

## DIAMOND DRILLING LOG SUMMARY

The drill hole intersected an intrusive complex consisting predominantly of granite and syenodioritic rocks with two late gabbroic units. Two brecciated zones with intense silica flooding were also intersected in the granite. The quartz is translucent white with no mineralization. A strg epidote alteration zone within the granite contains approximately 1% fluorite in late fractures up to 1/4 inch wide.

## DIAMOND DRILLING LOG

2

FROM	TO	
0	60.00 ft	CASING
60	77.76 ft	GRANITE BRECCIA
		Orange pink, mg., brecciated granite with intense silica flooding. Mod. dull grey green epidote alteration. Fragments up to 2 inch., strg. silicification Overall 50% white qtz.
		@ 62.22 ft - 1 inch qtz V with 1% cpy
		@ 74.30 ft - 1/8 inch py V along fract.
		@ 75.78 ft - 1/16 inch py V along fract.
		Contact with lower unit is sharp defined by 2 inch brecciated zone with calcite.
77.76	153.05 ft	GABBRO
		Dark grey to black, mg., ms., speckled with orange feldspar, non to wk. mt., 60% Plag., 15% Alk feld., wk fractured with minor thin shear zones.
		@ 81.61 ft - 1/2 inch Shear with Calcite V. @ 30°ICA
		@ 95.03 ft - 1 1/2 inch red orange Granite dyke
		@ 96.37 ft - 1 inch " " " "
		@ 99.97 ft - 1 inch Shear with calcite & py @ 35°ICA
		@ 110.79 ft - 1 inch Shear with calcite V.
		@ 116.97 ft - 8 inch Shear with white calcite V. and black fine grained chlorite along contacts and fragments @ 15°ICA
		@ 123.09 ft - 1 inch Shear with calcite V. @ 30°ICA
		From 125.15 to 153.05 ft wk pervasive carbonatization with loss of orange feldspar, wk seritization of mfc.. The alterations decreases towards lower contact.
		Overall 1% calcite V. along fractures and narrow shear zones from 1/16 to 1/2 inch wide. trace fg disseminated py throughout.
153.05	166.46 ft	GRANITE
		Orange pink mg, ms to wk fol., 18% qtz, 40% plag, 40% ortho, <1% mfc

## DIAMOND DRILLING LOG

3

- 166.46 172.61 ft SYENODIORITE  
Light grey white, cg, ms-wk fol, 10% chloritized hbl
- 172.61 179.51 ft GRANITE  
Orange pink mg, ms, 50-50% feld, <1% mfc
- 179.51 180.41 ft SYENODIORITE  
Light grey white, cg, ms-wk fol, 10% chloritized hbl
- 180.41 215.70 ft GABBRO  
Dark grey to black, mg., ms., speckled with orange feldspar, non to wk. mt., 60% Plag., 15% Alk Feld., wk fractured with minor thin shear zones.  
  
@ 188.99 ft - 1 inch Shear with calcite V. @ 25°ICA  
@ 190.25 ft - 1/2 inch Shear with calcite V. @ 40°ICA  
@ 204.53 ft - 2 inch Shear with calcite V. @ 10°ICA  
@ 206.67 ft - 1/2 inch Shear with calcite V. @ 20°ICA  
  
Overall <1% calcite veining along fractures and narrow shear zones from 1/8 to 2 inch wide.
- 215.70 240.44 ft GRANITE  
Orange pink, mg, up to 80% feldspar, 7% qtz, <3% mfc  
@ 216.2 ft - 6 inch dark green hornblendite dyke or segregation  
  
@ 218.33 ft SyenoDiorite 50% hornblend 50% feldspar  
@ 222.63 ft Shear zone @ 60°ICA  
@ 224.10 ft - 2 inch core split  
  
from 223.68 to 225.15 ft greenish grey zone, vmt, 5% diss po, 1% diss py,
- 240.44 254.93 ft SYENODIORITE  
Greyish green with pinkish hues, m-cg, ms, 60% feldspar, 40% mfc mod chloritized hbl & biot, trace to 1% diss fg py  
from 246.11 to 247.9 ft orange pink Granite  
from 247.9 to 249.26 med grey green SyenoDiorite 1% diss fg py.

## DIAMOND DRILLING LOG

4

From 249.26 to 249.89 ft Granite  
 From 249.89 to 254.93 ft Mfc Syenodiorite  
 mod grey green, mg, with biot rich sections (lamp.).  
 From 250.42 to 250.94 ft 3 % py  
 @ 251.05 ft - 2 inch pink granite dyke.  
 From 253 to 254.60 ft mod fol. @ 65°C

254.93 280.50 ft GRANITE

Orange pink, mg, ms, 5-10 % qtz, <5% mfc  
 @ 265.62 ft grey fol. zone @ 65°C  
 @ 268.12 ft grey fol. zone @ 75°C

280.5 284.24 ft SYENODIORITE

Med to light grey, mg, near contacts grading to cg, in  
 core of unit, 80% med grey green feld, 20% biotite, up  
 to 1-2% diss fg py locally, wk fol.

284.24 289.96 ft GRANITE

Redish pink, mg, ms, 50% white plag, 40% ortho, 3% mfc

289.96 305.54 ft GRANITE BRECCIA

Orange pink angular granite clasts up to 3 inch strg  
 silicified and intense silica flooding 60% qtz V, 40%  
 granite, mod epidote alt.

305.54 263.40 ft SYENODIORITE

Med to light grey, mg, near contacts grading to cg, in  
 core of unit, 80% med grey green feld, 20% biotite,  
 nil py, wk fol.

307.96 310.37 ft GRANITE  
 mod fractured with silica flooding (V)

310.37 315.46 ft ALTERED ZONE

intense epidote alteration silicification with 1% purple  
 fluorite along late fractures 1/16 to 1/4 inch wide, @  
 314.79 ft cubic crystals of purple fluorite.



## DIAMOND DRILLING LOG

5

- 315.46      345.18 ft    GRANITE
- from 315.46 to 345.18 ft Granite  
Pink to med grey, mg, mfc from <1% to 10% biot,  
mod fractured with silica flooding, 20% qtz V trace py  
in fractures @ 329.50 & 339.90 ft, locally mod epidote  
alt ie. 341.50 to 342.5 ft
- 345.18      366.38 ft    GRANITE BRECCIA
- from 345.18 to 366.38 ft Granite Breccia strg silic.  
of granitic clasts and intense silica flooding (V) 70%  
qtz V, 5% epidote alt, significant veins include  
from 351.01 to 351.96 ft qtz V  
from 352.60 to 353.16 ft qtz V  
from 354.19 to 358.01 ft qtz V  
Nil mineralization
- 366.38      384.93 ft    GRANITE
- same as above (315.46 to 345.18 ft)
- 384.93      389.51 ft    ALTERED ZONE
- strg silicification and epidotization (cherty) nil  
mineralization
- 389.51      416.70 ft    SYENODIORITE
- Pinkish grey, cg, ms to wk fol, 40% orthoclase, 30% plag  
25% mfc (chloritized), <5% qtz  
@ 345 ft wk fol @ 50%ICA  
split core from 397.49 to 400.20 ft Tr py  
                  from 400.65 to 403.25 1/2% py  
                  from 408.79 to 410.93 Tr py  
                  from 415.57 to 416.70 ft 1/2 to 1% py  
@ 413.76 ft - 2 inch micro breccia with 1% diss py
- 416.7      420.05 ft    GRANITE
- Orange pink, cg, ms, 50% orange feldspar, 25% plag., 15%  
qtz, <1% mfc.
- 420.05 ft    END OF HOLE

## DIAMOND DRILLING LOG

6

## CORE RECOVERY

BOX NUMBER	CORE LENGTH ON FROM	BOX TO	MEASURED CORE FROM	CORE TO
1	60 ft.	95 ft.	60.00 ft	83.67 ft.
2	95 ft.	120 ft.	83.67 ft	108.00 ft.
3	120 ft.	145 ft.	108.00 ft	132.33 ft.
4	145 ft.	185 ft.	132.33 ft	154.50 ft.
5	185 ft.	215 ft.	154.50 ft	178.33 ft.
6	215 ft.	240 ft.	178.33 ft	202.08 ft.
7	240 ft.	265 ft.	202.08 ft	226.00 ft.
8	265 ft.	290 ft.	226.00 ft	250.00 ft.
9	290 ft.	320 ft.	250.00 ft	272.33 ft.
10	320 ft.	345 ft.	272.33 ft	295.83 ft.
11	345 ft.	370 ft.	295.83 ft	319.50 ft.
12	370 ft.	395 ft.	319.50 ft	342.50 ft.
13	395 ft.	420 ft.	342.50 ft	364.67 ft.

TOTAL RECOVERY = 87%

DIAMOND DRILL HOLE

LOCATION SKETCH

YES NO TP. CLAIM MAP G-85

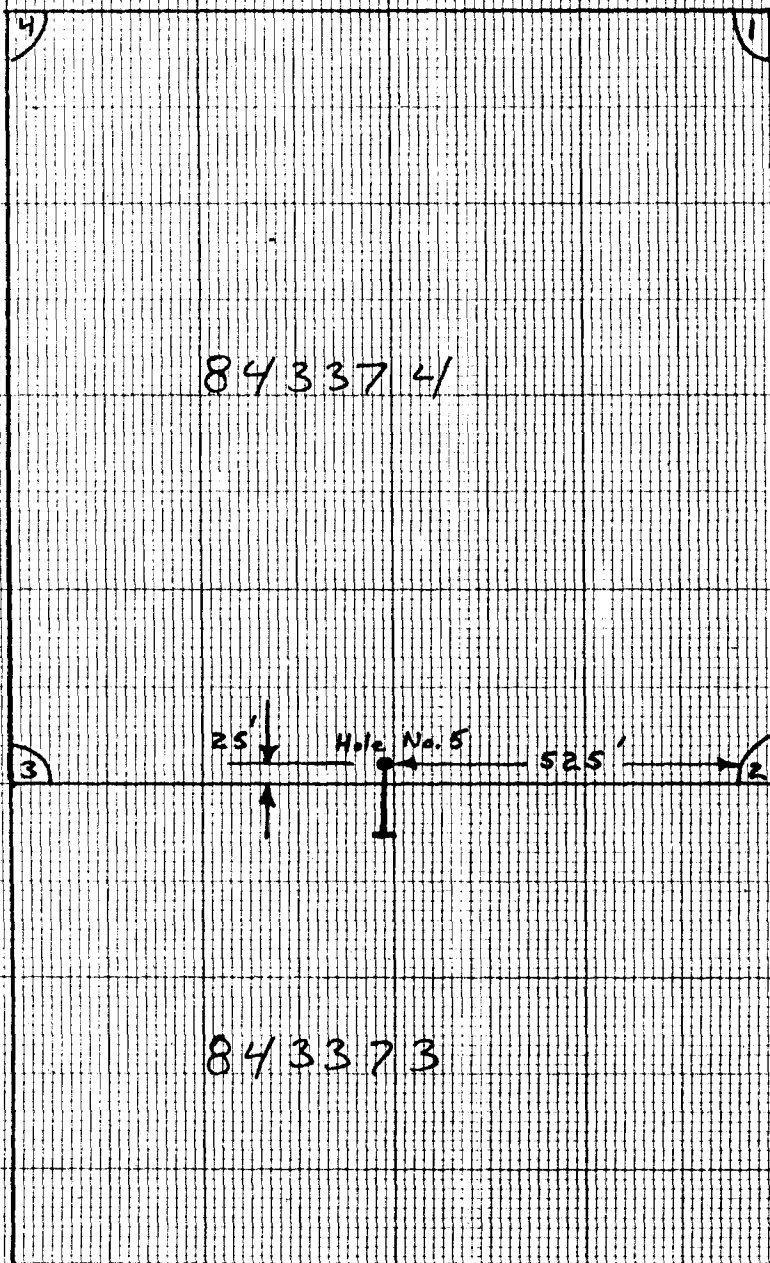

Scale 1 inch = 1/16 mi

DOCUMENT N  
W9004.311



42D13NE0001 14 MIDDLE FOX LAKE

900

Refer to sections 70 and 71 of the Mining Act for assessment requirements and the reverse side of this form for table of information.

Mining Act **MR. OWEN** Report of Work

Name and Address of Recorded Holder <b>ELWOOD FOURNIER</b>	Prospector's Licence No. <b>K 28090</b>
<b>P.O. Box 256 SWASTIKA ONT</b>	Telephone No. <b>705.634.2532</b>

Summary of Distribution of Credits and Work Performance

Mining Division <b>THUNDER BAY</b>	Mining Claim			Mining Claim			Mining Claim		
	Prefix	Number	Work Days Cr.	Prefix	Number	Work Days Cr.	Prefix	Number	Work Days Cr.
Township or Area <b>MIDDLE FOX LAKE</b> <del>YESNO-G-85</del>									
Total Assessment Credits Claimed <b>420</b>		<b>843372</b>	<b>53</b>						
Type of Work Performed (Check one only)		<b>843373</b>	<b>3</b>						
	<input type="checkbox"/> Manual Work		<b>893406</b>	<b>100</b>					
	<input type="checkbox"/> Shaft Sinking Drifting or other Lateral Work		<b>893407</b>	<b>98</b>					
	<input type="checkbox"/> Mechanical equipment		<b>1097078</b>	<b>83</b>					
	<input type="checkbox"/> Power Stripping other than Manual (maximum credit allowed - 100 days per claim)		<b>1097079</b>	<b>83</b>					
<input checked="" type="checkbox"/> Diamond or other Core drilling									
<input type="checkbox"/> Core Specimens									

Dates when work was performed From: <b>90/04/27</b> To: <b>90/05/07</b>	Total No. of Days Performed <b>420</b>	Total No. of Days Claimed <b>420</b>	Total No. of Days to be Claimed at a Future Date
--	---	---	--

All the work was performed on Mining Claim(s): Indicate no. of days performed on each claim. (See note No. 1 on reverse side)	Mining Claim	No. of Days	Mining Claim	No. of Days	Mining Claim	No. of Days	Mining Claim	No. of Days
	<b>843374</b>	<b>420</b>						

Required Information eg. type of equipment, Names, Addresses, etc. (See Table on reverse side)

If space below is insufficient, attach schedules with required information and location sketches

WORK DONE BY  
DIAMOND DRILL  
Type of Equipment : SULLIVAN, 12. 15/16 GORE  
PARTNERS. JAMES, ALLAIRE  
HELPERS 127. COLUMBUS AVE TIMMINS ONT  
Name + Address : JULIAN, MCLEAN, TONELLY ST  
MY SELF ELWOOD Fournier. TIMMINS. ONT

RECEIVED  
THUNDER BAY  
MINING DIVISION  
30 JUL 90 PM 12 06

Certification of Beneficial Interest \* (See Note No. 2 on reverse side)

I hereby certify that, at the time the work was performed, the claims covered in this report of work were recorded in the current recorded holder's name or held under a beneficial interest by the current recorded holder.

Date: **July 23/90** Recorded Holder or Agent (Signature): **Elwood Fournier**

Certification Verifying Report of Work

I hereby certify that I have a personal and intimate knowledge of the facts set forth in the Report of Work annexed hereto, having performed the work or witnessed same during and/or after its completion and the annexed report is true.

Name and Address of Person Certifying  
**D. R. Boucher Box 814 Kirkland Lake, Ont. P2N3K1**

Telephone No. **567-6662** Date **90/07/16** Certified By (Signature) **Donald R. Boucher**

or Office Use Only

Work Assignments <b>TB 843374 420 (BAL) 3242</b>	Received Stamp <b>AUG 08 1990</b>
---	--------------------------------------

DIAMOND DRILL HOLE

LOCATION SKETCH

YES NO TP. CLAIM MAP G-85

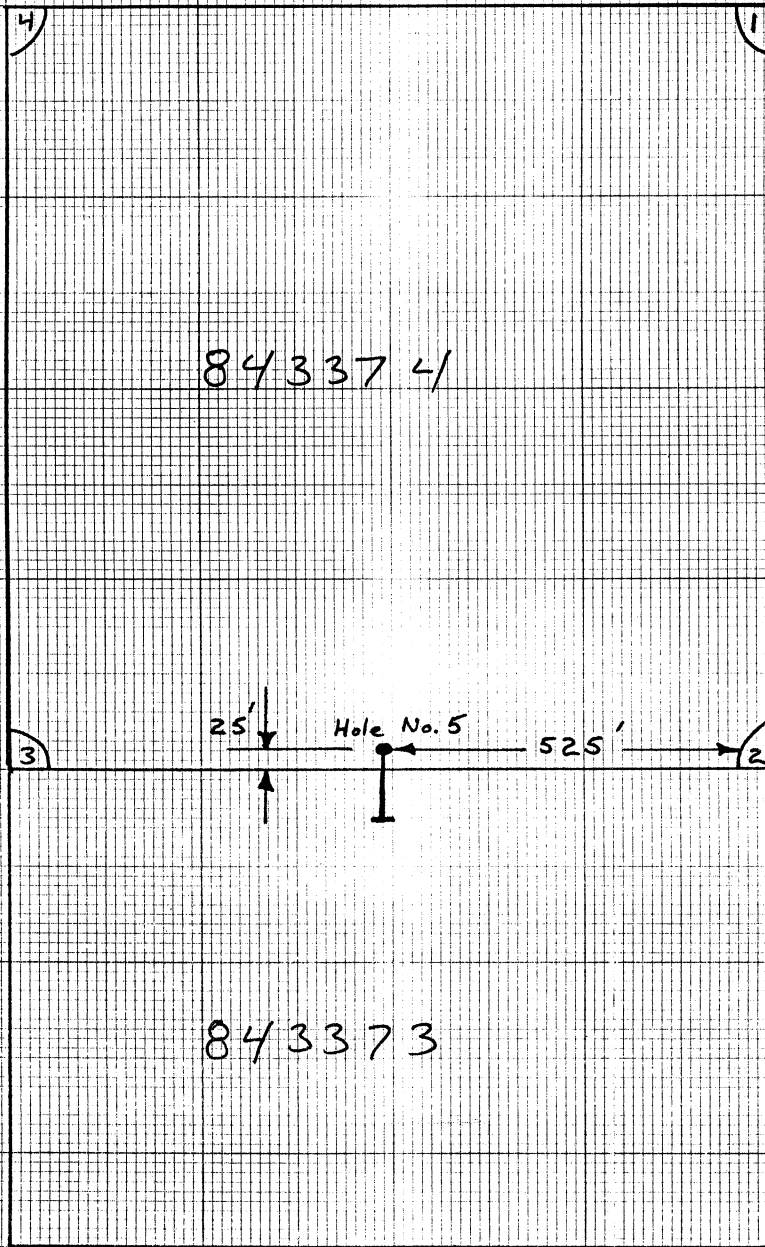

Scale 1 inch = 1/16 mi



42D13NE0003 12 MIDDLE FOX LAKE

010

DIAMOND DRILLING

Area: MIDDLE FOX LAKE

Report No: 12

WORK PERFORMED FOR: Elwood Fournier

RECORDED HOLDER: SAME AS ABOVE [x]

: OTHER [ ]

<u>CLAIM NO.</u>	<u>HOLE NO.</u>	<u>FOOTAGE</u>	<u>DATE</u>	<u>NOTE</u>
TB 843374	3	55'	Apr/87	(1)

NOTES: (1) #192-87, filed in Jan/88.

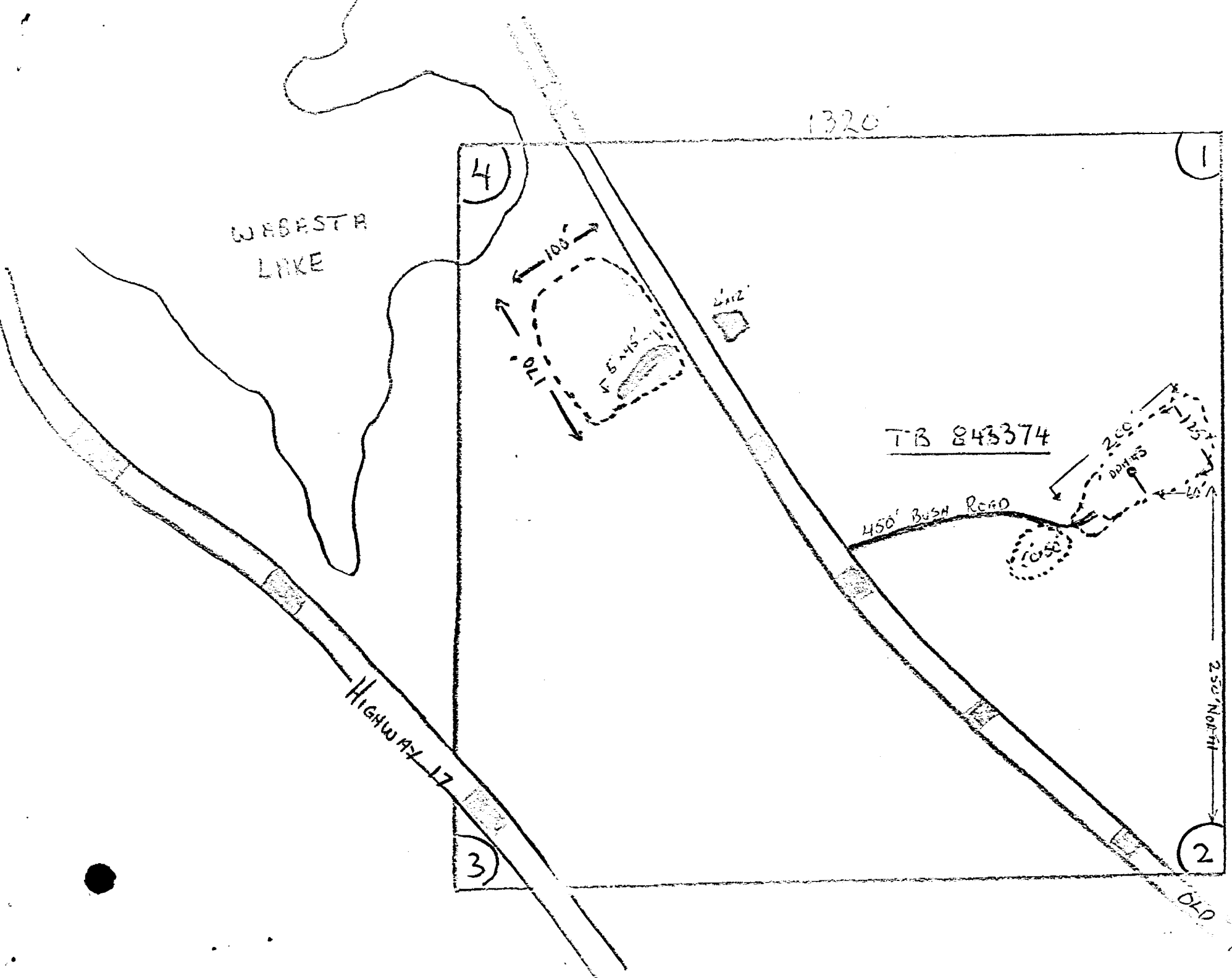

DDH #3  
and  
STRIPPING  
ON  
CLAIM  
843374  
YESNO TWP



----- AREA STRIPPED  
 BLASTED TRENCH







#192

M. Owen - Supply required data on a separate form for each type of work.

Ontario

Dist: 843372

Minin

Name and Postal Address of Recorded Holder: Elwood Fournier, P.O. Box 256, Swastika.



42D13NE0003 12 MIDDLE FOX LAKE

900

Summary of Work Performance and Distribution of Credits

Table with columns for Mining Claim Prefix, Number, and Work Days Cr. Includes checkboxes for Manual Work, Shaft Sinking, Compressed Air, Power Stripping, Diamond or other Core drilling, and Land Survey.

All the work was performed on Mining Claim(s): T6843374 Work Assignment: 13.3 days - Balance 986.7

Required Information eg: type of equipment, Names, Addresses, etc. (See Table Below)

Diamond Drill - Sullivan #12, 1" core diameter, Depth 55' DDH. #3, Operator Elwood Fournier, some address above.

THUNDER BAY MINING DIVISION

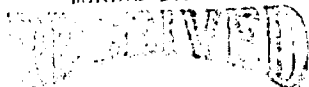

MAY 17 1987

MAY 10 11 12 13 14 15 16

ONTARIO GEOLOGICAL SURVEY ASSESSMENT FILES RESEARCH OFFICE

JUN 17 1987

Date of Report: May 7/87, Recorded Holder or Agent (Signature): Elwood Fournier

Certification Verifying Report of Work

RECEIVED

I hereby certify that I have a personal and intimate knowledge of the facts set forth in the Report of Work annexed hereto, having performed the work or witnessed same during and/or after its completion and the annexed report is true.

Name and Postal Address of Person Certifying

Elwood Fournier

P.O. Box 256 Swastika, Ont.

Date Certified: May 7/87, Certified by (Signature): Elwood Fournier

Table of Information/Attachments Required by the Mining Recorder

Table with 4 columns: Type of Work, Specific information per type, Other information (Common to 2 or more types), Attachments. Rows include Manual Work, Shaft Sinking, Compressed air, Power Stripping, Diamond or other core drilling, and Land Survey.

GRAVEL RIVER-G-45

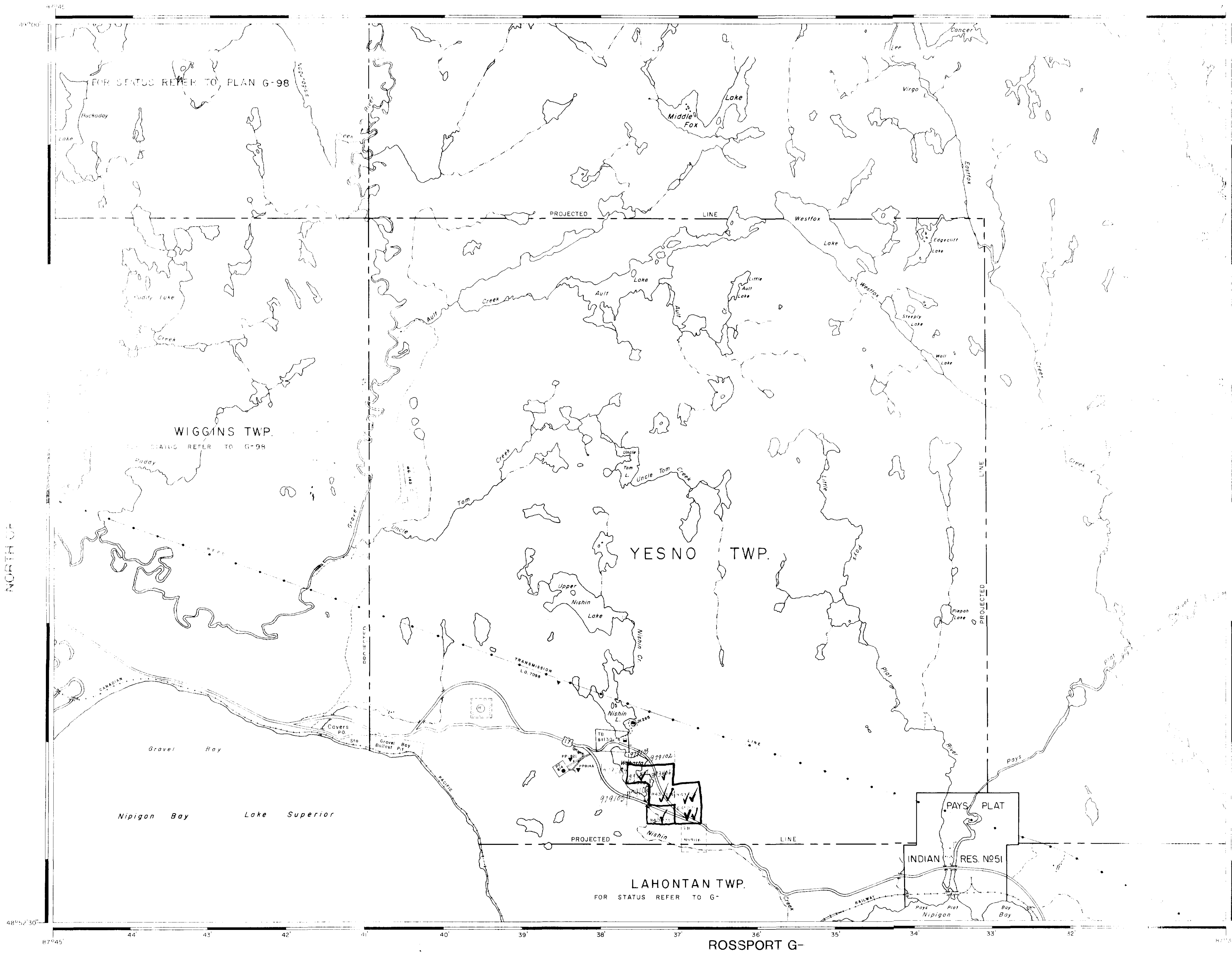

*M. Owen*

LEGEND

[Symbol]	RAILWAY
[Symbol]	ROAD
[Symbol]	IMPROVED ROAD
[Symbol]	KING'S HIGHWAY
[Symbol]	RAILWAYS
[Symbol]	POWER LINE
[Symbol]	WATER
[Symbol]	MINES
[Symbol]	CANALS

MIDDLE FOX LAKE

TERRACE BAY & NIPIGON

THUNDER BAY

THUNDER BAY



DIAMO



010

AREA: MIDDLE FOX LAKE

REPORT NO: 13

WORK PERFORMED FOR: Elwood Fournier

RECORDED HOLDER: SAME AS ABOVE (xx)

: OTHER

<u>CLAIM NO.</u>	<u>HOLE NO.</u>	<u>FOOTAGE</u>	<u>DATE</u>	<u>NOTE</u>
843374	4	197'	July/89	(1)

NOTES: (1) W8904.517, filed Feb/90



THE MINING ACT - MINISTRY OF NATURAL RESOURCES  
DIAMOND DRILLING LOG

Start a new page for every new hole, but fill in top portion of form only on first page for each hole.

FILL IN ON EVERY PAGE

HOLE NO. 84 PAGE NO. 1

DRILLING COMPANY ELWOOD FOURNIER		COLLAR ELEVATION	BEARING OF HOLE FROM TRUE NORTH 180	TOTAL FOOTAGE 200 ft.	DIP OF HOLE AT COLLAR 50°	LOCATION OF HOLE IN RELATION TO A FIXED POINT ON THE CLAIM 160 feet east and 180 feet south of the No. 4 post of claim 843374	MAP REFERENCE NO. G-85	CLAIM NO. 843374
DATE HOLE STARTED July 23/89	DATE COMPLETED July 30/89	DATE LOGGED Nov. 1, 1989	LOGGED BY A.C. BATH (MNDM)				LOCATION (Tp., Lot, Con. OR Lot. and Long.) claim 843374, YesnoTwp.	
EXPLORATION CO., OWNER OR OPTIONEE ELWOOD FOURNIER		DATE SUBMITTED Nov. 18/89	SUBMITTED BY (Signature) Elwood Fournier				PROPERTY NAME FOURNIER	

FOOTAGE FROM (feet) TO	ROCK TYPE	DESCRIPTION Colour, grain size, texture, minerals, alteration, etc.	PLANAR FEATURE ANGLE	CORE SPECIMEN FOOTAGE †	YOUR SAMPLE NUMBER	SAMPLE FOOTAGE		SAMPLE LENGTH	ASSAYS †	
						FROM	TO			
		Note: There are no footage markers provided with the core. E. Fournier reported that 52 feet of casing was used prior to drilling bedrock. Core description provided in this log are in a box by box basis with footage noted with reference to the upper left hand corner of each box. Thus in box 1, footage 0 presumably corresponds to drill hole depth 52 feet, etc.								
Box 1										
0	Hornblende Granite	100% recovery. 3-10mm grained pink hornblende granite. Variably weakly foliated, in steep downhole contact with (foliated) quartz - feldspar - hornblende schist.								
1	10' 3" Metasediments(?)	100% recovery. Variably foliated (at 80° to C.A.) fine to medium grained quartz - white feldspar - hornblende rock which locally contains 5-15% of foliation controlled splashes and disseminations of pyrrhotite.								

ONTARIO GEOLOGICAL SURVEY  
ASSESSMENT FILES  
OFFICE  
JAN - 9 1990  
RECEIVED

† Additional credit available. See Assessment Work Regulations.







THE MINING ACT - MINISTRY OF NATURAL RESOURCES  
DIAMOND DRILLING LOG

Start a new page for every new hole, but fill in top portion of form only on first page for each hole.

FILL IN ON EVERY PAGE

HOLE NO.	PAGE NO.
84	4

DRILLING COMPANY		COLLAR ELEVATION	BEARING OF HOLE FROM TRUE NORTH	TOTAL FOOTAGE	DIP OF HOLE AT COLLAR	LOCATION OF HOLE IN RELATION TO A FIXED POINT ON THE CLAIM	MAP REFERENCE NO.	CLAIM NO.
DATE HOLE STARTED	DATE COMPLETED	DATE LOGGED	LOGGED BY		ft		LOCATION (Twp., Lot, Con, OR Lat, and Long.)	PROPERTY NAME
EXPLORATION CO., OWNER OR OPTIONEE		DATE SUBMITTED	SUBMITTED BY (Signature)		ft			
					ft			

FOOTAGE FROM	TO	ROCK TYPE	DESCRIPTION Colour, grain size, texture, minerals, alteration, etc.	PLANAR FEATURE ANGLE	CORE SPECIMEN FOOTAGE	YOUR SAMPLE NUMBER	SAMPLE FOOTAGE		SAMPLE LENGTH	ASSAYS	
							FROM	TO			
49'	25'00"	hornblende granite / Metasediment Complex	90% recovery with evidence of ground core. As above. Well foliated dark (metasedimentary section) may contain 2-3% of disseminated pyrochloite.								
Box 4	0	25'00"	hornblende granite / Metasediment Complex	100% recovery. As above. Non granitic sections are generally not foliated, are 2-4mm grained, and typically contain 2-10% of disseminated recrystallized pyrochloite. The lower hole part of the complex contains incipiently recrystallized and "granitized" metasedimentary material with a moderately well developed foliation at 70° to the C.A. which is defined by pink felsic leucocratic horizons of feldspathization.							
Box 6	0	25'00"	hornblende granite / Metasedimentary Complex	80% recovery with evidence of core grinding. Mostly pink granitic like material - non foliated and fine grained, where							



THE MINING ACT - MINISTRY OF NATURAL RESOURCES  
DIAMOND DRILLING LOG

Start a new page for every new hole, but fill in top portion of form only on first page for each hole.

FILL IN ON EVERY PAGE

HOLE NO. **84** PAGE NO. **5**  
CLAIM NO.

DRILLING COMPANY		COLLAR ELEVATION	BEARING OF HOLE FROM TRUE NORTH	TOTAL FOOTAGE	DIP OF HOLE AT collar	LOCATION OF HOLE IN RELATION TO A FIXED POINT ON THE CLAIM	MAP REFERENCE NO.	CLAIM NO.	
DATE HOLE STARTED	DATE COMPLETED	DATE LOGGED	LOGGED BY		ft		LOCATION (Tp., Lot, Con. OR Lat. and Long.)		
EXPLORATION CO., OWNER OR OPTIONEE		DATE SUBMITTED	SUBMITTED BY (Signature)		ft				
					ft			PROPERTY NAME	

FOOTAGE		ROCK TYPE	DESCRIPTION <small>Colour, grain size, texture, minerals, alteration, etc.</small>	PLANAR FEATURE ANGLE	CORE SPECIMEN FOOTAGE	YOUR SAMPLE NUMBER	SAMPLE FOOTAGE		SAMPLE LENGTH	ASSAYS		
FROM	TO						FROM	TO				
		<b>E.O.H</b>	present, mafic portions are believed to represent recrystallized material as above and probably occur as xenoliths within granitic intrusions. The core is fragmented and it is difficult to characterize the relationship between the felsic (gneiss) and mafic (sedimentary?) domains. Coarse grained quartz-epidote hydrothermal material occurs locally.									
		<b>197 ft.</b>										



SKETCH

YESNO-Twp

LAKE  
WABASTA  
893407

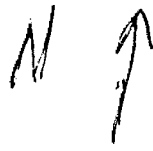

893406

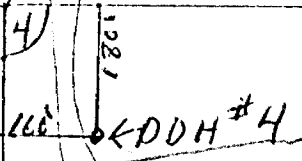

843374

843372

E

OLD HiWAY

HiWAY 17

843373

SCALE 1" = 330 FT.



DRILLED  
July 23/89

DOCUMENT No.  
W8904-517



42D13NE0004 13 MIDDLE FOX LAKE

900

requirements and the reverse side of this form for table of information.

Mining Act

Report of Work

Name and Address of Recorded Holder <b>ELWOOD FOURNIER</b> <b>P.O. Box 256 SWASTIKA ONTARIO POKITO</b>	Prospector's Licence No. <b>E 28090</b>
	Telephone No. <b>705-634-2532</b>

Summary of Distribution of Credits and Work Performance

Mining Division	Mining Claim			Mining Claim			Mining Claim		
	Prefix	Number	Work Days Cr.	Prefix	Number	Work Days Cr.	Prefix	Number	Work Days Cr.
<b>THUNDER BAY ONT.</b>									
<del>MIDDLE FOX C-185</del>	<b>TB</b>	<b>843373</b>	<b>60</b>						
<b>YES NO TWP.</b>									
Total Assessment Credits Claimed	<b>TB</b>	<b>843374</b>	<b>43</b>						
<b>197 200 DAYS</b>	<b>TB</b>	<b>893407</b>	<b>29</b>						
Type of Work Performed (Check one only)	<b>TB</b>	<b>893406</b>	<b>25</b>						
<input type="checkbox"/> Manual Work	<del><b>FB</b></del>	<del><b>1097078</b></del>	<del><b>20</b></del>						
<input type="checkbox"/> Shaft Sinking Drifting or other Lateral Work	<del><b>TB</b></del>	<del><b>1097179</b></del>	<del><b>20</b></del>						
<input type="checkbox"/> Mechanical equipment									
<input type="checkbox"/> Power Stripping other than Manual (maximum credit allowed - 100 days per claim)									
<input checked="" type="checkbox"/> Diamond or other Core drilling									
<input type="checkbox"/> Core Specimens									

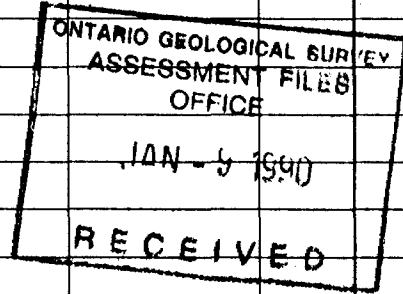

Dates when work was performed From: <b>July 21/89</b> To: <b>August 1/89</b>	Total No. of Days Performed <b>200197</b>	Total No. of Days Claimed <b>200157</b>	Total No. of Days to be Claimed at a Future Date <b>40</b>
---	--	--	---

All the work was performed on Mining Claim(s): Indicate no. of days performed on each claim. * (See note No. 1 on reverse side)		Mining Claim	No. of Days	Mining Claim	No. of Days	Mining Claim	No. of Days	Mining Claim	No. of Days
		<b>843374</b>	<b>197</b>						
Mining Claim	No. of Days	Mining Claim	No. of Days	Mining Claim	No. of Days	Mining Claim	No. of Days	Mining Claim	No. of Days

Required Information eg. type of equipment, Names, Addresses, etc. (See Table on reverse side)  
If space below is insufficient, attach schedules with required information and location sketches

**i- DIAMOND DRILL SULLIVAN 12 - CJS Swamp Buggy.**  
**ELWOOD FOURNIER P.O. Box 256 SWASTIKA ONTARIO**  
**JIM ALLAIRE 57 COLUMBUS AVE TIMMINS ONTARIO**  
**ALLEN ALLAIRE 57 COLUMBUS AVE TIMMINS ONTARIO**  
**JULES McLEAN 36 MIDDLETON AVE TIMMINS ONTARIO**

Certification of Beneficial Interest \* (See Note No. 2 on reverse side)

I hereby certify that, at the time the work was performed, the claims covered in this report of work were recorded in the current recorded holder's name or held under a beneficial interest by the current recorded holder.

Date: **NOV 18/89** Recorded Holder or Agent (Signature): **Elwood Fournier**

Certification Verifying Report of Work

I hereby certify that I have a personal and intimate knowledge of the facts set forth in the Report of Work annexed hereto, having performed the work or witnessed same during and/or after its completion and the annexed report is true.

Name and Address of Person Certifying: **ELWOOD FOURNIER**

Telephone No.: **705-634-2532** Date: **NOV 18/89** Certified By (Signature): **Elwood Fournier**

For Office Use Only

Work Assignments

Received Stamp: **NOV 22 11 59 AM '89**  
**MINING DIVISION**  
**THUNDER BAY**  
**RECEIVED**

GRAVEL RIVER-G-45

AREAS WITHDRAWN FROM DISPOSITION

S.R. - SURFACE RIGHTS M.R. - MINING RIGHTS

Description	Order No.	Date	Disposition	File
Sec 36/70	W 92/86 NCR	06/11/74	SRD	7598 v19

R2 Sec 36 W 92/86 NCR 06/11/74 at 5:30 PM. see the Hamilton

LEGEND

- PATENT, SURFACE AND MINING RIGHTS ----- ●
- " SURFACE RIGHTS ONLY ----- ○
- " MINING RIGHTS ONLY ----- □
- LEASE, SURFACE AND MINING RIGHTS ----- ■
- " SURFACE RIGHTS ONLY ----- ▨
- " MINING RIGHTS ONLY ----- ▩
- LICENCE OF OCCUPATION ----- ▽
- ROADS -----
- IMPROVED ROADS -----
- KING'S HIGHWAYS -----
- RAILWAYS -----
- POWER LINES -----
- MARSH OR MUSKEG -----
- MINES -----
- CANCELLED ----- C.

NOTES

Land under water in Lake Superior withdrawn from staking by Order in Council dated April 30, 1912.

All lands within the Indian Reserve are controlled by the Dept. of Indian Affairs in Ottawa.

SCALE: 1 INCH = 40 CHAINS

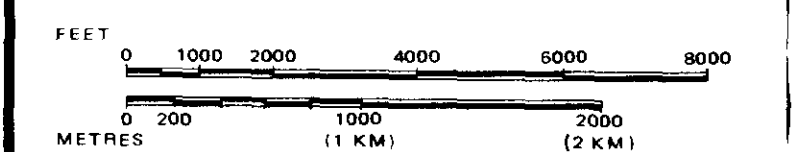

AREA  
MIDDLE FOX LAKE

M.N.R. ADMINISTRATIVE DISTRICT  
TERRACE BAY & NIPIGON  
MINING DIVISION  
THUNDER BAY  
LAND TITLES / REGISTRY DIVISION  
THUNDER BAY

Ministry of Land Management  
Ontario Natural Resources Branch

Date March 1981

Number G-85  
G-8!

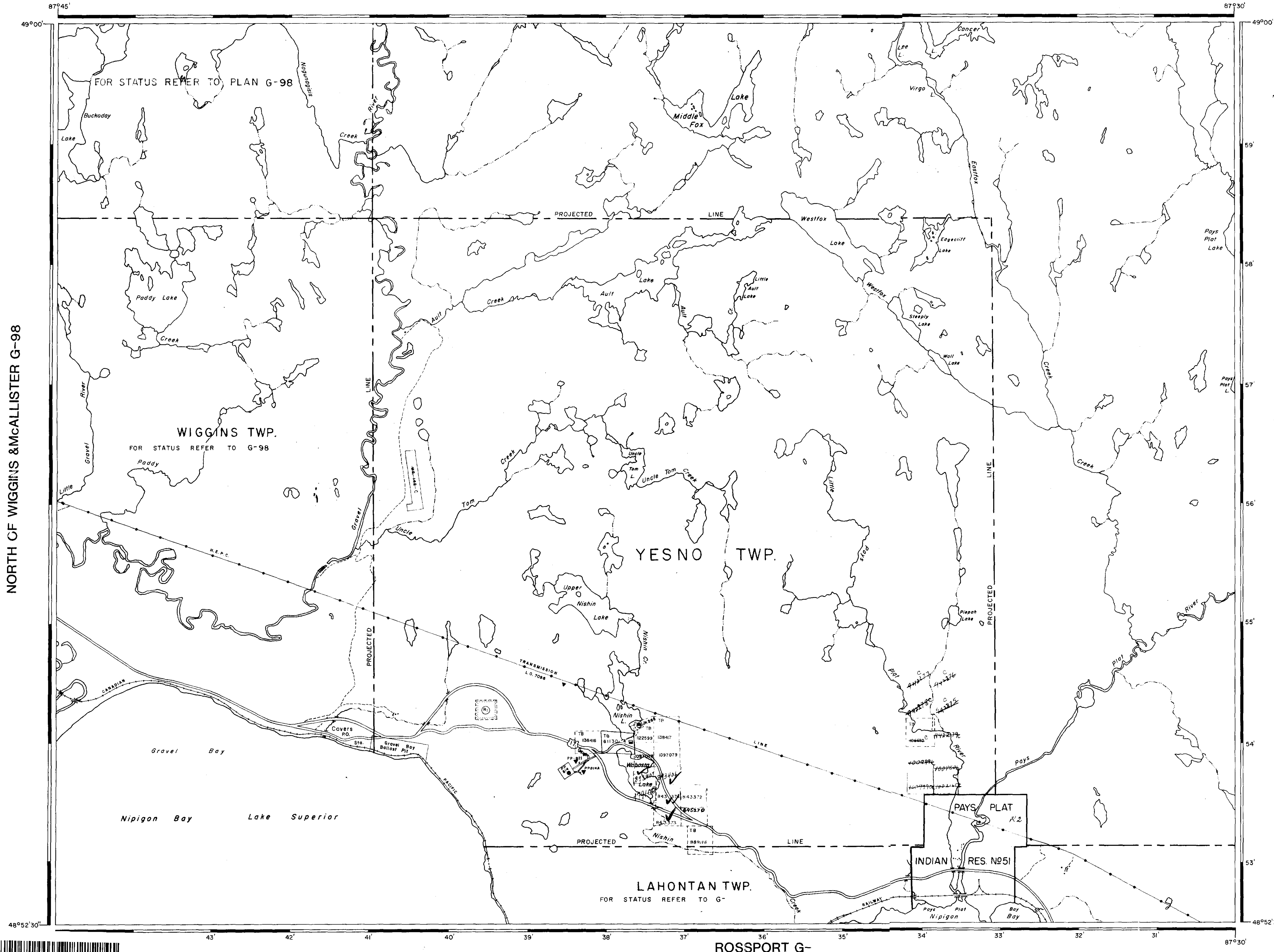



42013NE 0005 11 MIDDLE FOX LAKE

010

# DIAMOND DRILLING

Area: MIDDLE FOX LAKE

Report No: 11

WORK PERFORMED FOR: Elwood Fournier

RECORDED HOLDER: SAME AS ABOVE

: OTHER

<u>CLAIM No.</u>	<u>HOLE No.</u>	<u>FOOTAGE</u>	<u>DATE</u>	<u>NOTE</u>
TB 645270	2	185'	Apr/87	(1)

NOTES: (1) #191-87, filed Jan/88.



THE MINING ACT - MINISTRY OF NATURAL RESOURCES  
DIAMOND DRILLING LOG

Start a new page for every new hole, but fill in top portion of form only on first page for each hole.

FILL IN ON EVERY PAGE

1 HOLE NO. 2 PAGE NO.

DRILLING COMPANY E. FOURNIER		COLLAR ELEVATION 180'		DIP OF HOLE AT 185'		DIP OF HOLE AT collar 55°		LOCATION OF HOLE IN RELATION TO A FIXED POINT ON THE CLAIM 200' East, 50' South of the No. 4 post, claim No: 645270		MAP REFERENCE NO.		CLAIM NO. 645270	
DATE HOLE STARTED April 4, 1987	DATE COMPLETED April 9, 1987	DATE LOGGED April 14, 1987	LOGGED BY A.C. Bath						LOCATION (Twp., Lot, Csw. OR Lat. and Long.)		YES/NO TOWNSHIP on claim map G-85 "Middle Fox Lake Area"		PROPERTY NAME
EXPLORATION CO., OWNER OR OPTIONEE E. FOURNIER		DATE SUBMITTED April 14, 1987	SUBMITTED BY (Signature) <i>A.C. Bath</i>										

FOOTAGE		ROCK TYPE	DESCRIPTION Colour, grain size, texture, minerals, alteration, etc.	PLANAR FEATURE ANGLE *	CORE SPECIMEN FOOTAGE †	YOUR SAMPLE NUMBER	SAMPLE FOOTAGE		SAMPLE LENGTH	ASSAYS ‡
FROM	TO						FROM	TO		
0	4'13"	Casing								
4'13"	70'8"	Hornblende (?) Diorite	Grey, f.-m.g., with diabase to locally ophitic texture. Non magnetic to weakly-magnetic locally. Variable development of leucoxene and salmon pink feldspar (K-spar?). Vatics are non chloritic. 4'13"-63'8": f.g. with weak and spotty development of leucoxene. 15-20% salmon pink feldspar. 42'9": 2" pink granite vein. Contacts are ground, no alteration, no sulfides. 48'10"-49'11": chlorite seam with white calcite-filled fractures and coarse grained by at 22° to C.A. 57'3": white calcite-chlorite veinlet over 1" with 5% m.g. py cubes at 42° to C.A. 60'0": sheeted white calcite seam over 1/2" at 42° to C.A. 63'8"-64'3": chloritic with white calcite-filled fractures. Marginal altered diorite is leucoxene-bearing. 64'3"-67'5": leucoxene-bearing with gradational down-hole contact. 67'5"-70'8": diorite becoming finer-grained down hole.							
70'8"	88'6"	Monzonite	M.-c.g. monzonite to quartz monzonite. Where not potassium metasomatized, 15-35% pink feldspar (K-spar), 25-60% white feldspar (Na plagioclase?), 10-15% chlorite after mafic minerals. Where potassium metasomatized, rocks tends towards syenitic compositions with 80% of Feldspar pink (K-spar) and the remainder variably altered (to pink) white feldspar. Quartz generally 10%; locally in c.g. area to 25%. 70'8": irregular, gradational up hole contact with f.g. (chilled?) diorite 70'8"-71'5": syenitic domains are essentially coalescing but appear to be fracture-controlled. 71'5"-73'11": incipiently foliated M.-f.g. quartz syenite with 5-10% Qtz., 80+ % pink Feldspar, 5% chlorite after mafic minerals. Locally M.-c.g. and Na plagioclase-bearing at 72'9".							

\* For features such as foliation, bedding, schistosity, etc., give the dip angle of the core.



Start a new page for every new hole, but fill in top portion of form only on first page for each hole.

DRILLING COMPANY E. FOURNIER		COLLAR ELEVATION	BEARING OF HOLE FROM TRUE NORTH 180°	TOTAL FOOTAGE 185'	DIP OF HOLE AT COLLAR 55°	LOCATION OF HOLE IN RELATION TO A FIXED POINT ON THE CLAIM 200' East, 50' South of the No. 4 post, claim No. 645270	CLAIM REFERENCE NO.	CLAIM NO. 645270
DATE HOLE STARTED April 4, 1987	DATE COMPLETED April 9, 1987	DATE LOGGED April 14, 1987	LOGGED BY A.C. Bath				LOCATION (Twp., Lat., Cor. OR Lat. and Long.) YESNO TOWNSHIP on claim map G-85 "Middle Fox Lake Area"	
EXPLORATION CO., OWNER OR OPTIONEE E. FOURNIER		DATE SUBMITTED April 14, 1987	SUBMITTED BY (Signature) <i>E. Fournier</i>				PROPERTY NAME	

FOOTAGE FROM	TO	ROCK TYPE	DESCRIPTION Colour, grain size, texture, minerals, alteration, etc.	PLANAR FEATURE ANGLE	CORE SPECIMEN FOOTAGE	YOUR SAMPLE NUMBER	SAMPLE FOOTAGE		ASSAYS
							FROM	TO	
			73'11"-74'10": c.g., pegmatitic Qtz, monzonite. Non-foliated, with incidentally potassium metasomatized white Na plagioclase and c.g. pink potassium-feldspar porphyroblasts.						
			74'10"-76'8": f.-m.g. foliated at 42° to C.A. Qtz, syenite metasomatite with 102mm K Feldspar porphyroblasts. Locally may be medium grained and not foliated.						
			76'8"-78'2": m.g. quartz monzonite fining down hole.						
			78'2"-83'8": m.g. non foliated and locally intensity K metasomatized quartz diorite to quartz monzonite. Pink feldspar domains generally local at 78'8", 81'2", 81'10", 83'6".						
			83'6"-88'6": generally m.g. quartz syenitic metasomatite with rare local Qtz diorite domains. The down hole contact with underlying fine grained diorite is sharp - this may be a dike of Qtz syenitic composition at the base of this felsic horizon.						
88'6"	185'	Diorite	As above. Locally may be leucoxenitic and contain orbicular pink feldspars.						
			88'6"-91'0": contact with upper, foliated f.g. quartz syenitic (vein?) appears to be at 42°, parallel to foliation developed in felsic rock. Diorite is aphanitic at contact and becomes medium grained down hole. Non-leucoxenitic.						
			91'0"-93'4": m.g. without leucoxene. Occasional white calcite veinlets at various orientations. Those at 42° to C.A. may have local leucoxene development in marginal diorite.						
			93'4"-128'0": leucoxene diorite.						
			96'0": white carbonate vein with 30+ % py over 1".						
			96'0"-119'3": Slightly pink with scattered porphyroblastic (?) pink feldspar and orbicular pink feldspar masses (2-4mm). Scattered narrow white calcite and white calcite/chlorite veinlets and seams at various orientations to C.A. with scattered veinlets with preferred orientation of 42° to C.A. Veinlets rarely with 2% py cubes.						
			119'3"-128'3": rare silicic/white calcite/chlorite syngenetic (?) shears over 2cm.						



THE MINING ACT - MINISTRY OF NATURAL RESOURCES  
DIAMOND DRILLING LOG

Start a new page for every new hole, but fill in top portion of form only on first page for each hole.

FILL IN ON EVERY PAGE

HOLE NO. 2  
PAGE NO. 3

DRILLING COMPANY E. FOURNIER	COLLAR ELEVATION	BEARING OF HOLE FROM TRUE NORTH 180°	TOTAL FOOTAGE 185'	DIP OF HOLE AT COLLAR 55°	LOCATION OF HOLE IN RELATION TO A FIXED POINT ON THE CLAIM 200' East, 50' South of the No. 4 post, claim No. 645270	MAP REFERENCE NO.	CLAIM NO. 645270
DATE HOLE STARTED April 4, 1987	DATE COMPLETED April 9, 1987	DATE LOGGED April 14, 1987	LOGGED BY A.C. Bath				LOCATION (Twp., Lot, Con. OR Lat. and Long.)
EXPLORATION CO., OWNER OR OPTIONEE E. FOURNIER	DATE SUBMITTED April 14, 1987	SUBMITTED BY (Signature) <i>A.C. Bath</i>					YES/NO TOWNSHIP on claim map G-85 "Middle Fox Lake Area"
						PROPERTY NAME	

FOOTAGE FROM TO	ROCK TYPE	DESCRIPTION Colour, grain size, texture, minerals, alteration, etc.	PLANAR FEATURE ANGLE	CORE SPECIMEN FOOTAGE	YOUR SAMPLE NUMBER	SAMPLE FOOTAGE		SAMPLE LENGTH	ASSAYS
						FROM	TO		
		128'3"-166'0": medium grained, leucoxene-bearing with v.f.g. leucoxene visible with hard lens and usually not with naked eye except in narrow (2-4mm) alteration halos around & sheeted white calcite/quartz/chlorite veinlets. Blebs to 1mm of py in the diorite 1%.							
		166'0"-185': n.g. with or without macroscopic leucoxene. Blebs (1mm) of py constitute 1%. Scattered white calcite/chlorite/ctz veinlets at various orientation to C.A. are rare.							
		185': End of Hole.							
<p>Note: Blue/white fluorescent masses under short wave U.V. lamp (scheelite) occur sporadically throughout the core, generally they are 2cm in max dimension, rarely occurring in veins.</p>									





Ontario

File: 645270

Mini



42013NE 0005 11 MIDDLE FOX LAKE

900

Name and Postal Address of Recorded Holder

Elwood Fournier  
P.O. Box 256 Swastik, Ont.

Summary of Work Performance and Distribution of Credits

Total Work Days Cr. claimed 185	Mining Claim			Work Days Cr.	Mining Claim			Work Days Cr.
	Prefix	Number	Work Days Cr.		Prefix	Number	Work Days Cr.	
for Performance of the following work. (Check one only)		843372	10					
	<input type="checkbox"/> Manual Work	843374	40					
	<input type="checkbox"/> Shaft Sinking Drifting or other Lateral Work.	893407	60					
	<input type="checkbox"/> Compressed Air, other Power driven or mechanical equip.	893406	75					
<input type="checkbox"/> Power Stripping								
<input checked="" type="checkbox"/> Diamond or other Core drilling								
<input type="checkbox"/> Land Survey								

All the work was performed on Mining Claim(s): TB 645270 WORK ASSIGNMENT: 185 days

Required Information eg: type of equipment, Names, Addresses, etc. (See Table Below)

Balance = 900

REGIONAL DRILL  
GROUND GEOLOGICAL SURVEY  
ASSESSMENT OF  
RESEARCH OF ICE  
JUN 17 1987

SULLIVAN #12  
1" core diameter  
Depth 185' DOH #2  
OPERATOR: Elwood Fournier  
same address as above.

all info attached on drill log.

Date of Report: May 7/87  
Recorded Holder or Agent (Signature): Elwood Fournier

Certification Verifying Report of Work

I hereby certify that I have a personal and intimate knowledge of the facts set forth in the Report of Work annexed hereto, having performed the work or witnessed same during and/or after its completion and the annexed report is true.

Name and Postal Address of Person Certifying

same as above

Date Certified: May 7/87  
Certified by (Signature): Elwood Fournier

Table of Information/Attachments Required by the Mining Recorder

Type of Work	Specific information per type	Other information (Common to 2 or more types)	Attachments
Manual Work	Nil		
Shaft Sinking, Drifting or other Lateral Work		Names and addresses of men who performed manual work/operated equipment, together with dates and hours of employment.	Work Sketch: these are required to show the location and extent of work in relation to the nearest claim post.
Compressed air, other power driven or mechanical equip.	Type of equipment		
Power Stripping	Type of equipment and amount expended. Note: Proof of actual cost must be submitted within 30 days of recording	Names and addresses of owner or operator together with dates when drilling/stripping done.	
Diamond or other core drilling	Signed core log showing; footage, diameter of core, number and angles of holes.		Work Sketch (as above) in duplicate
Land Survey	Name and address of Ontario land surveyor.	Nil	Nil



42013NE 0000 10 MIDDLE FOX LAKE

010

## Diamond Drilling

Area Middle Fox lake Report NO 10

Work performed by: Elwood Fournier

Claim NO	Hole NO	Footage	Date	Note
TR 645270	1	125.0	May/82	(1)

Notes: (1) #101-83

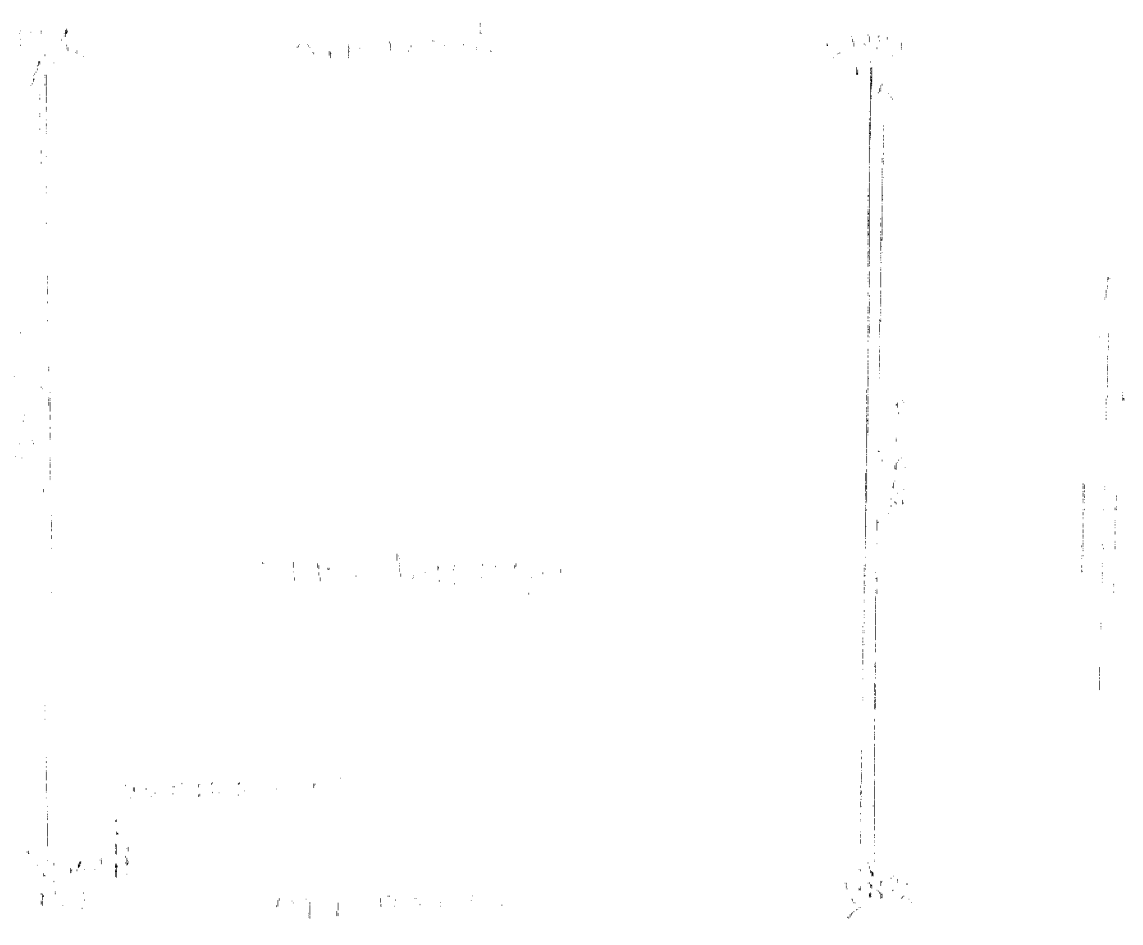

Vertical dimension  
 Horizontal dimension  
 Vertical dimension  
 Horizontal dimension

# DIAMOND DRILL RECORD

Hole No. D-115 Sheet No. 1

Property Location: Elwood Fournier Claim TB 645270  
Yesno Twp. (South Central Part) Wabasta L.  
Middle Fox Lake Area

Latitude: Thunder Bay Mining Div. Ont.

Departure Bearing: 270° (west)

Dip: 0DE  
-50°

Total Footage: 175 FEET @ -50°

Elev. Collar: 2000

Datum: 2000

Date Started: 10/17/1952

Date Completed: 10/23/1952

Drilled by: W. J. VAN DER WERF

Logged by: FRANK C. ...

Footage		Formation	Sample Number	Sample Footage	Sample Weight	Gold Sample	Gold Sludge	Remarks
From	To							
0	10'	Casing in overburden						
10'	35'	Gabbroic, Dk. to Med XL's, weakly magnetic, minor Carb. Calcic stringers and blebs occasional stgs 1/8 to 1/2" occasional sulph. blebs (pyt) where finely crystalline appears trend to diabase Core recovery 0 -good.						
35'	60'	Gabbroic somewhat coarser XL, occasional blebs carbonate (calcite) minor pyrite scattered						
60'	85'	As above, carbonate slightly more abundant at 64-65', minor pyt only, at 80' very fine grained aphanic phase - good recovery						Character sample 82'
85'	90'	As above, slightly more sulphides scattered						
90'	95'	As above very fine grained dark, with pyrite in fine fracturing						
95'	100'	Very fine dark formation contact with aplite pinkish fine grained dike?						
100'	108'	aplite dike pinkish aplitic, some coarse feldspar XL's in places						
108'	110'	core badly broken, short 1-2" section, knobs and pieces some short 1-2" carbonate and quartz only fair recovery						Character sample 109
110'	125'	fine aplitic, grading to coarser reddish feldspar, some pyrite in slip face. recovery 70% approx.						

Date of Examination: 27/1/53

*[Handwritten Signature]*