

DIAMOND DRILLING



42D15SW0117 12 SYINE

010

TOWNSHIP: SYINE

REPORT No.: 12

WORK PERFORMED BY: MICHAM EXPLORATION CO. LTD.

<u>CLAIM No.</u>	<u>HOLE No.</u>	<u>FOOTAGE</u>	<u>DATE</u>	<u>NOTE</u>
TB 603912	441-84-5	449.9'	Mar/84	(1)
	441-84-6	434'	Mar/84	(1)
	441-84-7	399.4'	Mar/84	(1)
	441-84-8	300.9'	Mar/84	(1)

NOTES: (1) #149-85

Company: Micham Exploration Inc.

Project No: 441

Diamond Drill Hole Number	Location	Azimuth	Dip	Total Footage	Anomaly Description		Anomaly Intersection		Comments
					Geophysical	Geochemical	Proposed	Actual	
441-84-5	L12W 8+00S	0°	-50	449.9'			106	157	pyrite in carb.-sericitic shear 5%
441-84-6	L12W 6+20S	0°	-50	434			40	70	same as above
441-84-7	L9W 6+00S	0°	-50	399.4'			40	51	20% py locally in chloritic tuff
441-84-8	L9W 6+00S	0°	-80	300.9'				51	2-5% py in mafic tuff

David R. Bell Geological Services Inc.

DIAMOND DRILL HOLE RECORD

Project 441

Company MICHAM EXPLORATION INC.

Hole No. 441-84-5

LOCATION		DIP TEST		LEVEL	HORIZONTAL COMPONENT	DATE STARTED
AREA or TWP. SYINE TWP.	CLAIM NO. TB603912	FOOTAGE 0' 200' 450'	ANGLE		ELEVATION	305
			RECORDING	CORRECTED		VERTICAL COMPONENT
						385
NTS 42D/14 UTM				LATITUDE L12 + 00W	BEARING 0°	DATE FINISHED March 22/84
				DEPARTURE 8 + 00S	LENGTH 449.9'	LOGGED BY M. Simunovic
					CORE LOCATION TB603912	PURPOSE I.P. Anomaly
						TOT. RECOVERY

DIAMOND DRILL HOLE LOCATION SKETCHES
CLAIM MAP Scale: 1 inch to 1/2 mile

DIAMOND DRILL HOLE LOCATION
WITH RESPECT TO CLAIM BOUNDARIES
Scale: 1 inch to 400 feet

Signature *Mike Simunovic*

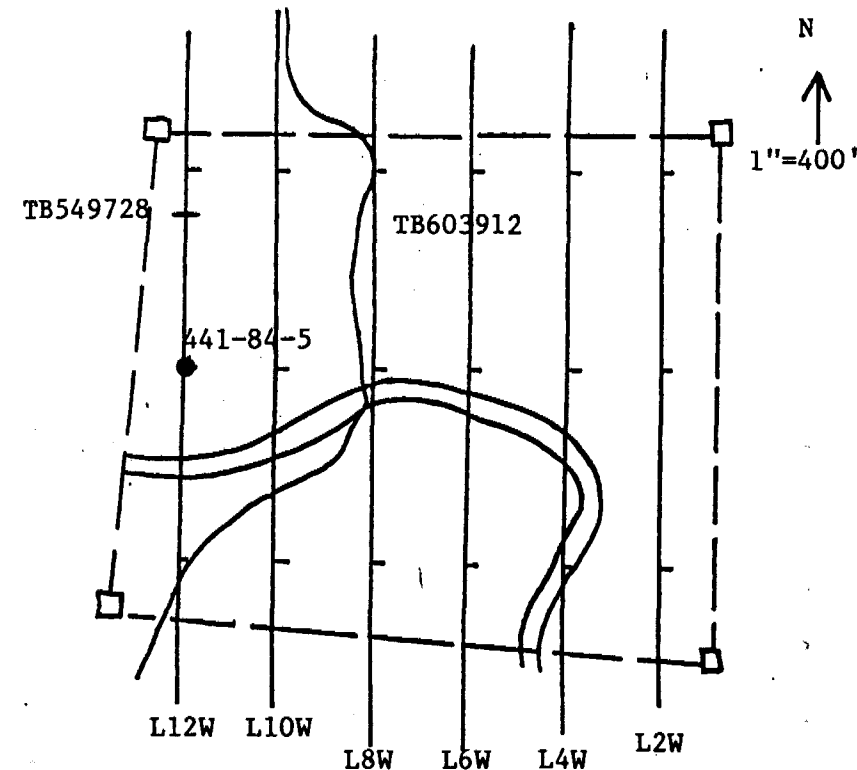
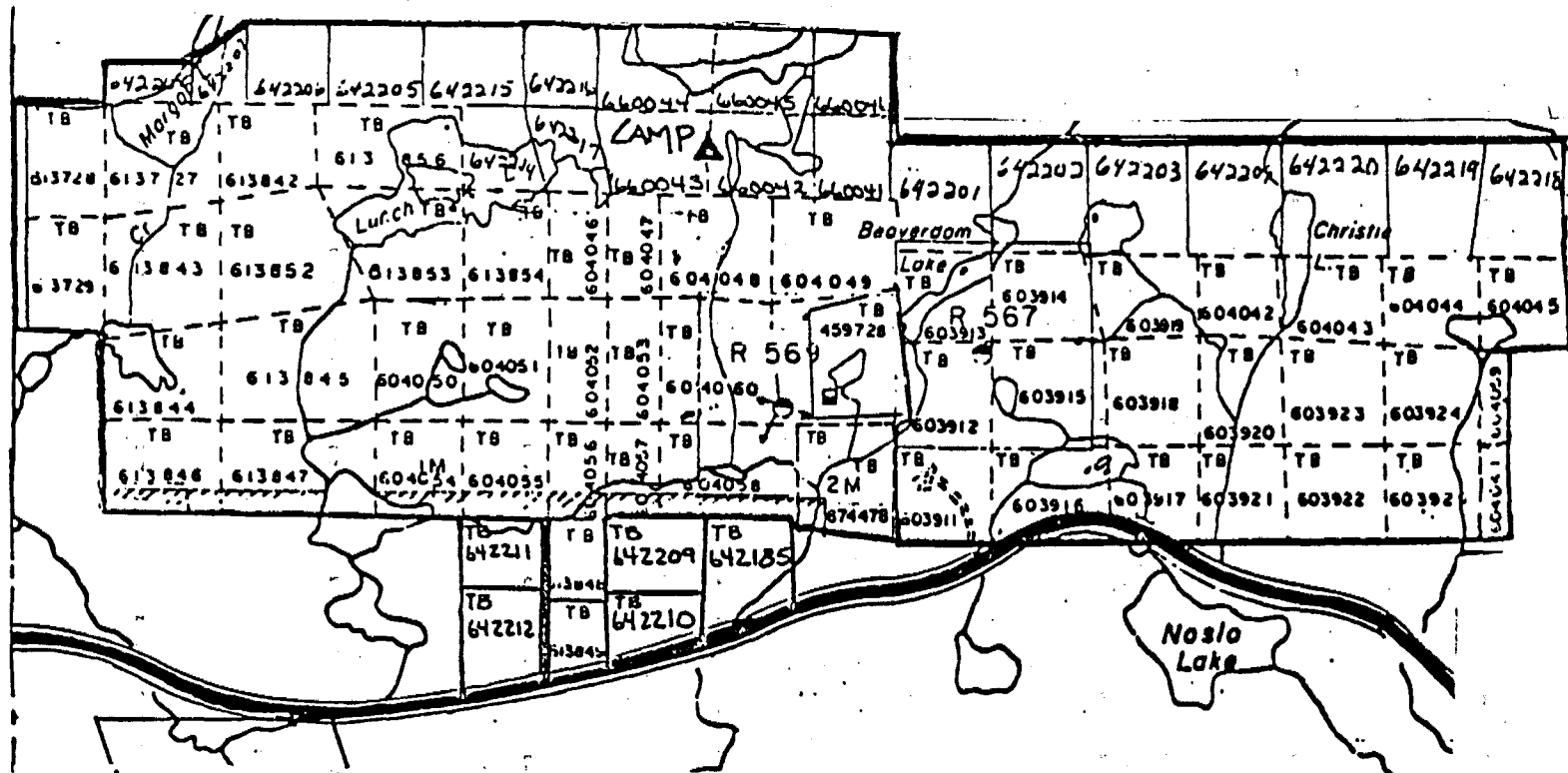

David R. Bell Geological Services Inc.

DIAMOND DRILL HOLE LOG

PROJECT 441

Company MICHAM EXPLORATION INC.

HOLE No. 441-84-5 Page 3 of 8

FOOTAGE		ROCK TYPE AND DESCRIPTION (alteration, structure, mineralization)	CORE ANGLES TO AXIS	% SULPHIDES	SAMPLE				ANALYTICAL RESULTS																										
FROM	TO				NUMBER	FROM	TO	LENGTH	Au ppb	Ag oz	Ag ppm																								
157'	222'	SAMPLE	71°	5%	441-000																														
		- 136' - possible spherulites coming in minor felsic bands			-1074														131'	134'	3'	2													
		- some mafic fragments																																	
		- py. picks up 1% in places, sometimes more																																	
		SAMPLE			441-000																														
					-1075														138'	140'	2'	2													
		SAMPLE			441-000																														
					-1076														142'	144'	2'	4													
		<u>Carbonatized-Sericitic Shear</u>																																	
		- carbonatized sericitic shear zone																																	
		- minor silicification																																	
		- varying degrees of sericitization and carbonatization																																	
		- average approx. 5% sulphide																																	
		- locally 15-20% py. minor cpy.																																	
		- many qz. and qz.-carb. veins																																	
- some felsic alteration as well																																			
- appear to be bedded volcanic mud																																			
- 3 inch qz. vein 160.3 feet approx. 90° to core axis																																			
- bedding 71° to core axis																																			
- 164' - 165.2' - felsic alteration with qz.																																			
- 167.5' - felsic alteration with qz. as well to 168.4'																																			
- some sections slightly chloritic wisps as well																																			
- 171.5' - gets argillaceous but not graphitic																																			
- 172' - irregular qz.-carb. vein parallel to core axis																																			
SAMPLE	441-000																																		
	-1077	157'	162'	5'	1166	.045	1.8																												
SAMPLE	441-000																																		
	-1078	162'	167'	5'	477		1.4																												
SAMPLE	441-000																																		
	-1079	167'	172'	5'	304		1.4																												
- 175' - end of argillites																																			
- 175'-179' - sericitic mud zone																																			
- carb. alteration, slumping																																			
- some silicification, beds 70°																																			
- minor hematite alteration																																			

WR 147'

WR 158.1

WR 163

441-000

-1498

441-000

-1499

David R. Bell Geological Services Inc.

DIAMOND DRILL HOLE LOG

PROJECT 441

Company Micham Exploration Inc.

HOLE No. 441-84-5 Page 8 of 8

FOOTAGE		ROCK TYPE AND DESCRIPTION (alteration, structure, mineralization)	CORE ANGLES TO AXIS	% SULPHIDES	SAMPLE				ANALYTICAL RESULTS							
FROM	TO				NUMBER	FROM	TO	LENGTH	Au ppb							
		-py and po trace		tr												
		<u>Sample</u>			441-000 -1099	407	409	2	4							
		-412 gets very chloritic and broken	55°													
		-foliation 412 feet														
		-413-414														
		-irregular qz-carb vein trace py	10°													
		-419.5 irregular qz-carb vein with po and chlorite, brown biotite														
		<u>Sample</u>			441-000 -1100	419	420	1	2							
		-421 chloritic														
		-421.2-435.3 lamprophyre dike														
		-upper contact brecciated														
		-rich in hornblende and biotite														
		-chloritic														
		-chill margins approx. 2 feet														
		-lower contact approx. 71°, brown sandy mineral, garnets														
		-chloritic now														
		-439 py pick up, some siliceous sections														
		-438-440														
		<u>Sample</u> END 449.9			441-000 -1101	438	440	2	2							

David R. Bell Geological Services Inc.

DIAMOND DRILL HOLE LOG

PROJECT 441

Company Micham Exploration Inc.

HOLE No. 441-84-5 Page 1 of 2

FOOTAGE		ROCK TYPE AND DESCRIPTION (alteration, structure, mineralization)	CORE ANGLES TO AXIS	% SULPHIDES	SAMPLE				ANALYTICAL RESULTS							
FROM	TO				NUMBER	FROM	TO	LENGTH	Au ppb	Au oz						
		<u>SLUDGE</u>			441-000	16	26	10	2							
					-1103											
					-1104	26	36	10	2							
					-1105	36	46	10	10							
					-1106	46	56	10	3							
					-1107	56	66	10	5							
					-1108	66	76	10	4							
					-1109	76	86	10	7							
					-1110	86	96	10	4							
					-1111	102	115	13	2							
					-1112	115	125	10	5							
					-1113	125	134	9	5							
					-1114	134	144	10	3							
					-1115	144	155	11	5							
					-1116	155	165	10		.057						
					-1117	165	175	10	595							
					-1118	175	185	10	214							
					-1119	185	196	10		.04						
					-1120	196	206	10	174							
					-1121	206	216	10	119							
					-1122	216	226	10	75							
					-1123	226	236	10	34							
					-1124	236	246	10	16							
					-1125	246	256	10	8							
					-1126	256	266	10	15]		[2, one is					
					-1127	256	166	10	55]		[266-276					
					-1128	276	286	10	15							
					-1129	286	296	10		.002						
					-1130	296	306	10		tr						
					-1131	306	316	10		.002						
					-1132	316	326	10		.002						
					-1133	326	334	8		.002						
					-1134	336	346	10		tr						
					-1135	346	356	10		.002						
					-1136	356	366	10		.002						
					-1137	366	376	10		.002						

David R. Bell Geological Services Inc.

DIAMOND DRILL HOLE RECORD

Project 441

Company MICHAM EXPLORATION INC.

Hole No. 441-84-6

LOCATION		DIP TEST		LEVEL	HORIZONTAL COMPONENT	DATE STARTED
AREA or TWP.	SYINE TWP.	FOOTAGE	ANGLE		285'	March 23/84
			RECORDING	CORRECTED	VERTICAL COMPONENT	DATE FINISHED
CLAIM NO.	TB603912	0'	50	50	383	March 25/84
		200'		47	ELEVATION	LOGGED BY
		400'		51	LATITUDE	M. Simunovic
NTS	42D/14 UTM				L12 + 00W	PURPOSE
					DEPARTURE	I. P. Anomaly
					6 + 20S	TOT. RECOVERY
					CORE LOCATION	98%
					TB603912	

DIAMOND DRILL HOLE LOCATION SKETCHES
CLAIM MAP Scale: 1 inch to 1/2 mile

DIAMOND DRILL HOLE LOCATION
WITH RESPECT TO CLAIM BOUNDARIES
Scale: 1 inch to 400 feet

Signature *Mike Simunovic*

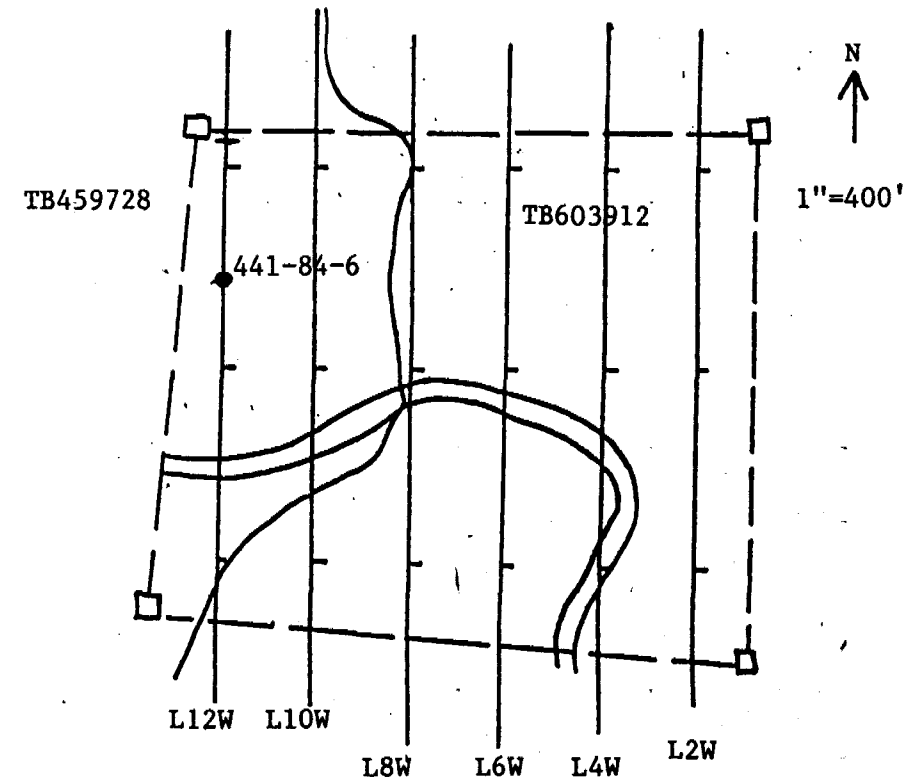
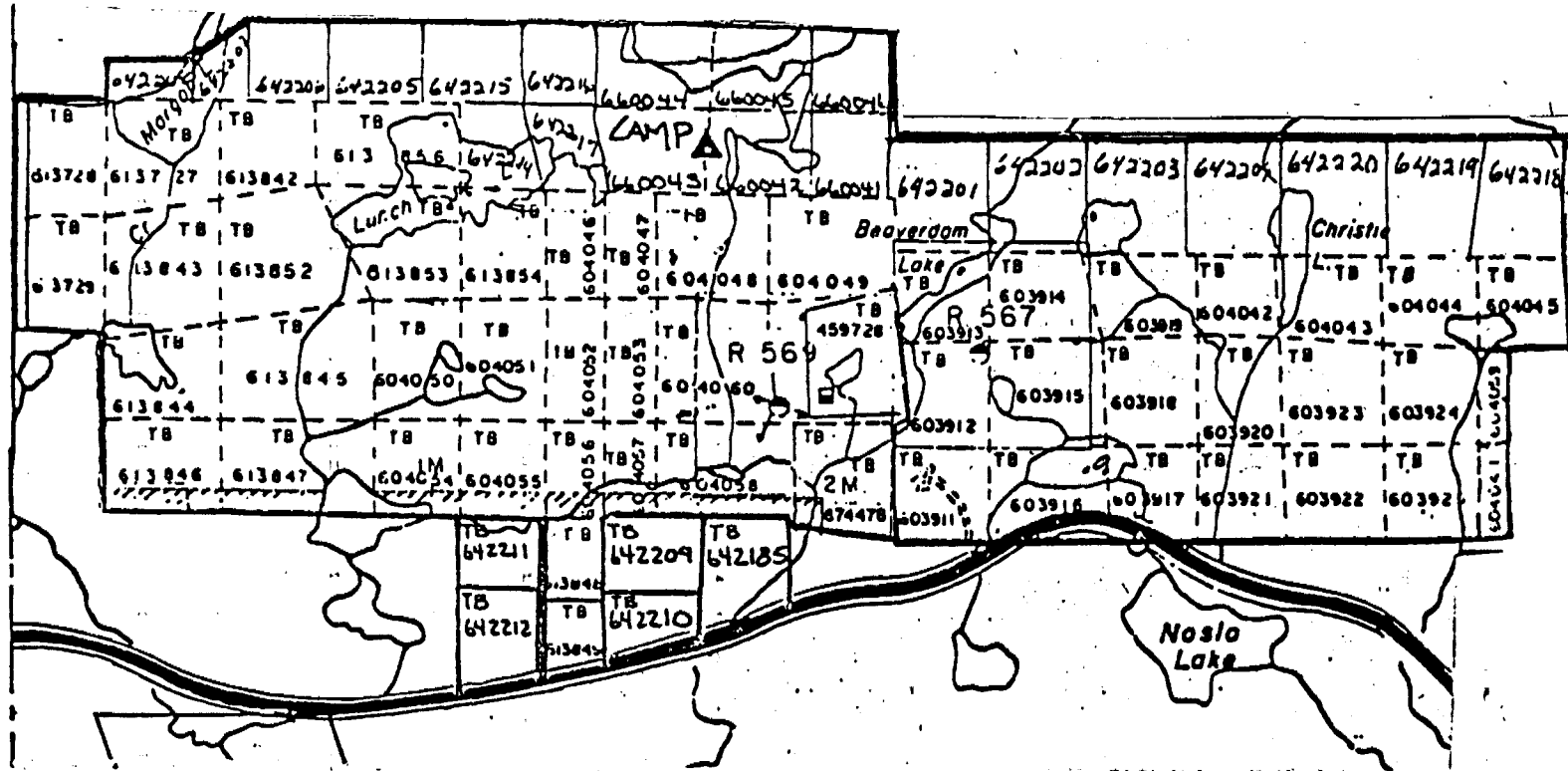

David R. Bell Geological Services Inc.

DIAMOND DRILL HOLE LOG

PROJECT 441
 HOLE No. 441-84-6 Page 3 of 6

Company MICHAM EXPLORATION INC.

FOOTAGE		ROCK TYPE AND DESCRIPTION (alteration, structure, mineralization)	CORE ANGLES TO AXIS	% SULPHIDES	SAMPLE				ANALYTICAL RESULTS							
FROM	TO				NUMBER	FROM	TO	LENGTH	Au ppb							
		- at 116 feet sericite begins to die out - still a lot of carbonate alteration - 116' - 118' - many irregular carb. stringers - 117' - 1 inch carb. vein, clots of py. - very chloritic here, as well - py. less than 1% - 118' - get a carbonatized tuff, goes to about 122' - carb. then dies out, only bands and stringers SAMPLE SAMPLE		< 1%												
122'	434.4'	<u>Mafic Tuff (Lapilli)</u> - chlorite rich with minor biotite - some qz.-carb. veining - brown biotite banding - some mafic fragments - chlorite, bands as well - 125.5' - irregular qz.-carb. veining over 2 inches, 126' - .5 inch, 50° to core axis - py. 5% SAMPLE *probably 75-80% po. - Analyse for Ni, Ag, Zn. - some felsic fragments as well - qz.-carb. veining 143.3' - irregular carb. with traces of po. SAMPLE														
		- 146'-147' - qz.-carb. vein parallel to core axis - foliation 150 feet 62° to core axis - 151.3' - felsic fragments up to 1 inch long - 162' - .5 inch qz.-carb. vein 42° to core axis, barren chlorite on contacts	62°													
					441-000 -1154	113'	116'	3'	38							
					441-000 -1155	116'	121'	5'	14							
					441-000 -1156	125'	126'	1'	8							
					441-000 -1157	142'	144'	2'	4							

David R. Bell Geological Services Inc.

DIAMOND DRILL HOLE LOG

PROJECT 441

Company Micham Exploration Inc.

HOLE No. 441-84-6 Page 2 of 2

FOOTAGE		ROCK TYPE AND DESCRIPTION (alteration, structure, mineralization)	CORE ANGLES TO AXIS	% SULPHIDES	SAMPLE				ANALYTICAL RESULTS							
FROM	TO				NUMBER	FROM	TO	LENGTH	Au oz							
		<u>SLUDGE</u>			441-000	356	366	10	tr							
					-1205											
					-1206	366	376	10	tr							
					-1207	376	386	10	tr							
					-1208	286	396	10	tr							
					-1209	396	406	10	tr							
					-1210	406	425	19	tr							
					-1211	425	435	10	tr							

David R. Bell Geological Services Inc.

DIAMOND DRILL HOLE RECORD

Project 441

Company MICHAM EXPLORATION INC.

Hole No. 441-84-7

LOCATION		DIP TEST		LEVEL	HORIZONTAL COMPONENT	DATE STARTED
AREA or TWP.	SYINE TWP.	FOOTAGE	ANGLE		ELEVATION	DATE FINISHED
			RECORDING	CORRECTED		
CLAIM NO.	TB603912	0'	50	50	BEARING	LOGGED BY M. Simunovic
		200'		42		
		400'		38		
NTS	42D/14 UTM			LATITUDE	LENGTH	PURPOSE
				L9+00W		
				DEPARTURE	CORE LOCATION	TOT. RECOVERY
				6+00S	TB603912	90%

DIAMOND DRILL HOLE LOCATION SKETCHES
CLAIM MAP Scale: 1 inch to 1/2 mile

DIAMOND DRILL HOLE LOCATION
WITH RESPECT TO CLAIM BOUNDARIES
Scale: 1 inch to 400 feet

Signature *Mike Simunovic*

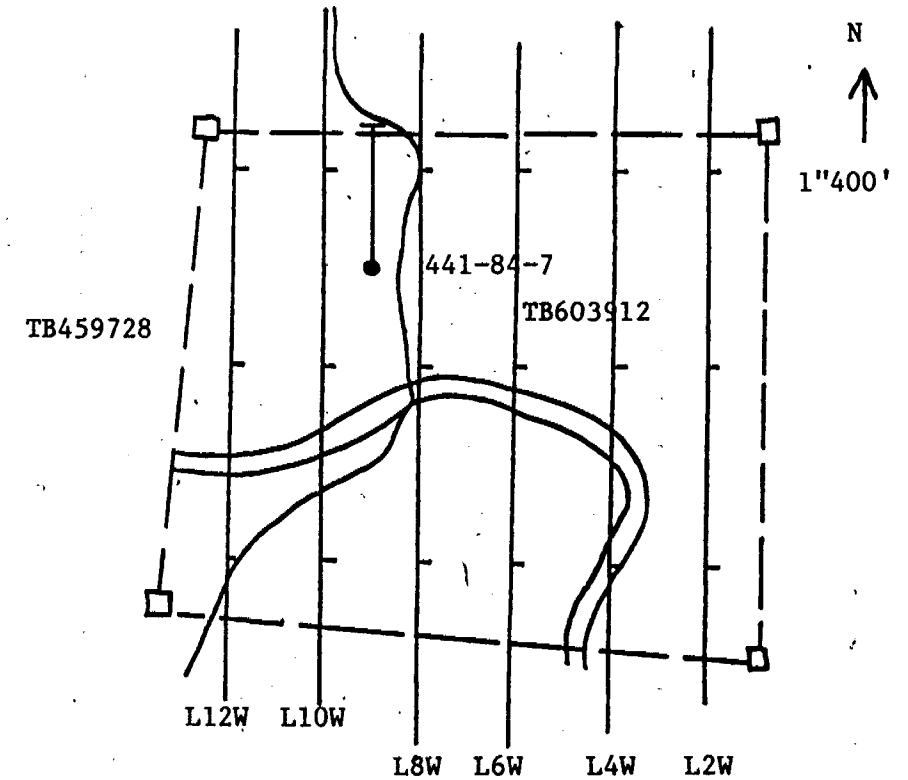
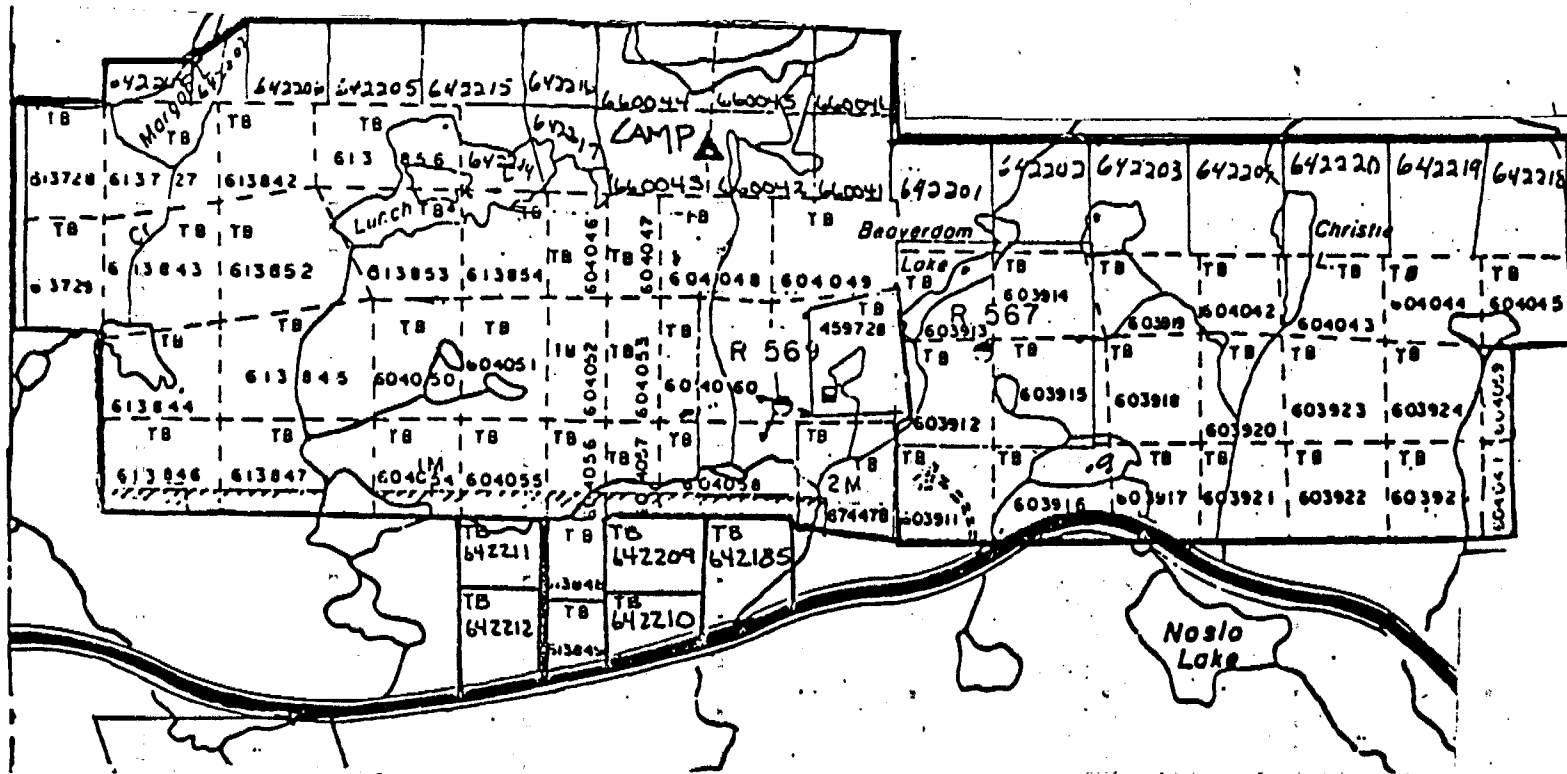

David R. Bell Geological Services Inc.

DIAMOND DRILL HOLE LOG

PROJECT 441

Company MICHAM EXPLORATION INC.

HOLE No. 441-84-7 Page 4 of 11

FOOTAGE		ROCK TYPE AND DESCRIPTION (alteration, structure, mineralization)	CORE ANGLES TO AXIS	% SULPHIDES	SAMPLE				ANALYTICAL RESULTS					
FROM	TO				NUMBER	FROM	TO	LENGTH	Au ppb	Au oz	Ag ppm	Cu ppm		
		SAMPLE - 92' - carbonatized sericitic shear - some qz.-carb. stringers - massive mud - some chloritic sections - some qz. pods - 2-5% py. trace cpy. - 106'-107' - chloritic section - 97'- py. drops off 2-3% locally 5% - 109'- gets bedded 86° - possible slumping - sulphides very fine grained	86°		441-000 -1223	90'	92'	2'	8		1.4	WR 90.6'	441-000 -1512	
		SAMPLE			441-000 -1224	92'	97'	5'	155		.6	WR 93'	441-000 -1515	
		SAMPLE			441-000 -1225	97'	102'	5'	123		.8	WR 104'	441-000 -1516	
		SAMPLE			441-000 -1226	102'	107'	5'	62		.8	WR 106'	441-000 -1517	
		SAMPLE			441-000 -1227	107'	112'	5'	22		.6			
		SAMPLE			441-000 -1228	112'	117'	5'	10		.6	WR 113'	441-000 -1518	
		- approx. 117'- cpy. picks up - now get 2-5% py. & cpy. - locally more sulphide												
		SAMPLE - 122'-124'- 1 foot of grind - slightly siliceous section			2-5%	441-000 -1229	117'	122'	5'		.062	2.6	850 WR 117.6'	441-000 1519

David R. Bell Geological Services Inc.

DIAMOND DRILL HOLE LOG

PROJECT 441

Company MICHAM EXPLORATION INC.

HOLE No. 441-84-7 Page 5 of 11

	FOOTAGE		ROCK TYPE AND DESCRIPTION (alteration, structure, mineralization)	CORE ANGLES TO AXIS	% SULPHIDES	SAMPLE				ANALYTICAL RESULTS						
	FROM	TO				NUMBER	FROM	TO	LENGTH	Au ppb	Au .oz	Ag ppm	Zn ppm	Cu ppm		
			<p>SAMPLE</p> <p>- 126.7'-127.5' qz.-vein - contains cpy., py., sph., & gelena - traces, upper contact 77°, lower approx. 90°</p>			441-000-1230	122'	126.7'	4.7'	301		.8		1.2	WR 125'	441-000-1520
			<p>SAMPLE</p> <p>- 127.5'-129' - sericite-heavily carbonate section (mud) somewhat bedded 72° - py. & cpy. & sph. 10%</p>	72°	10%	441-000-1231	126.7'	127.5'	.8'	130		1.0		560		
			<p>SAMPLE</p> <p>- 129'-130.4'- some chlorite - 90% qz. with cpy. 5% trace py. - upper contact 90°, lower 90°</p>		5%	441-000-1232	127.5'	129'	1.5'	201		2.4	2925	990		
			<p>SAMPLE</p> <p>- 130.4'- sericitic section - first foot sericitic - then core is broken, but is very chloritic & less sericitic possible <u>fault</u> - now approx. 50% qz. - 5% py. & cpy. - 134'-get vuggy - 134.4'- massive cpy.</p>		5%	441-000-1233	129'	130.4'	1.4'	269		3.0		2100		
			<p>SAMPLE</p> <p>- 135'-142'</p>			441-000-1234	130.4'	135'	4.6'		.134	6:7		4500	WR 132.1'	441-000-1526

David R. Bell Geological Services Inc.

DIAMOND DRILL HOLE LOG

PROJECT 441

Company MICHAM EXPLORATION INC.

HOLE No. 441-84-7 Page 7 of 11

FOOTAGE		ROCK TYPE AND DESCRIPTION (alteration, structure, mineralization)	CORE ANGLES TO AXIS	SULPHIDES %	SAMPLE				ANALYTICAL RESULTS						
FROM	TO				NUMBER	FROM	TO	LENGTH	Au ppm	Ag ppm					
		<ul style="list-style-type: none"> - 152'- possible <u>fault</u>, brecciated - trace py. - 155.3'- grind 													
		SAMPLE			441-000	149'	154'	5'	7	1.8					
		SAMPLE grind at 155.3'			441-000	154'	156'	2'	5	1.0	<u>WR 154.6</u>		441-000		
					-1239								-1528		
		<ul style="list-style-type: none"> - 156'-164.4' - sericitic-carbonatized section (mud) - hematite in fractures at 161' - 2-3% py. - qz.-pods, some silicification - chlorite wisps & veins - some biotite banding possible slump 													
		SAMPLE			441-000	156'	161'	5'	20	.6					
		SAMPLE			441-000	161'	164.4'	3.4'	22	.8	<u>WR 162.2</u>		441-000		
					-1241								-1529		
					-1242										
		<ul style="list-style-type: none"> - 164.4'-184.1' - mafic tuff with felsic fragments and some minor 1-2 foot sericitic sections - trace of py. in the tuff, & sericitic muds, locally up to 2% - tuff has felsic beds and mafic fragments - some chloritic bands & sections - bedding in tuffs beds 85° - minor hematite in fractures - tuffs have minor carbonate alt. - 180'-183'- sericitic sections 	85°												
		SAMPLE			441-000	164.4'	169.4'	5'	4	.4					
		SAMPLE			441-000	169.4'	174.4'	5'	7	.8	<u>WR 170.2</u>		441-000		
					-1243								-1530		
					-1244										
											<u>WR 171.7</u>		441-000		
													-1531		

David R. Bell Geological Services Inc.

DIAMOND DRILL HOLE LOG

PROJECT 441

Company MICHAM EXPLORATION INC.

HOLE No. 441-84-7 Page 10 of 11

	FOOTAGE		ROCK TYPE AND DESCRIPTION (alteration, structure, mineralization)	CORE ANGLES TO AXIS	% SULPHIDES	SAMPLE				ANALYTICAL RESULTS								
	FROM	TO				NUMBER	FROM	TO	LENGTH	Au ppb	Ag ppm							
			<ul style="list-style-type: none"> - qz.-veining - qz.-carb. veining and pods - chloritic wisps & bands - brown biotite banding - trace py. & po. <p>SAMPLE</p>															
			<ul style="list-style-type: none"> - 297.8'- stringer of cpy. & po., minor carb. alt. <p>SAMPLE</p>															
			<ul style="list-style-type: none"> - 321'-6 inch felsic band - 320 foliation 65° - possible flow bed from 331'-340' - no contacts amphibolitized - may have altered fragments at 336' - veining drops off (not as much) - 340.4'- irregular qz.-carb. veining - trace py. & po. - foliation 336 feet approx. 50° - 341' mafic fragments - 345.8'-347.7' - felsic section in core - slightly silicified - intensely carb. altered - some chlorite & biotite - po. & cpy 2-3% 	65°	trace													
			<p>SAMPLE</p> <ul style="list-style-type: none"> - 373'-376 - felsic fragments in mafic tuff - carb. altered locally - qz.-carb. veins & qz. veins assoc. with po. - trace po. in remainder - 374.6'-qz.-carb. vein .5 inches wide 30% po. 45° to core axis 	50°	30%													
						441-000 -1252	290.7'	295.4'	4.7'	4	.8							
						441-000 -1253	297'	298'	1'	4	.6							
						441-000 -1254	345.8'	347.7'	1.9'	4	.6							

David R. Bell Geological Services Inc.

DIAMOND DRILL HOLE RECORD

Project 441

Company MICHAM EXPLORATION INC.

Hole No. 441-84-8

LOCATION	DIP TEST		LEVEL	HORIZONTAL COMPONENT	DATE STARTED
AREA or TWP. SYINE TWP.	FOOTAGE	ANGLE		VERTICAL COMPONENT	DATE FINISHED
		RECORDING	CORRECTED		
	0'	80	80		
CLAIM NO. TB603912	150'		76	BEARING	LOGGED BY M. Simunovic
	300'		70		
NTS 42D/14 UTM				LENGTH	PURPOSE I. P. Anomaly
			ELEVATION	CORE LOCATION	TOT. RECOVERY 95%
			LATITUDE L9+00W		
			DEPARTURE 6+00S		

DIAMOND DRILL HOLE LOCATION SKETCHES
CLAIM MAP Scale: 1 inch to 1/2 mile

DIAMOND DRILL HOLE LOCATION WITH RESPECT TO CLAIM BOUNDARIES
Scale: 1 inch to 400 feet

Signature *Mike Simunovic*

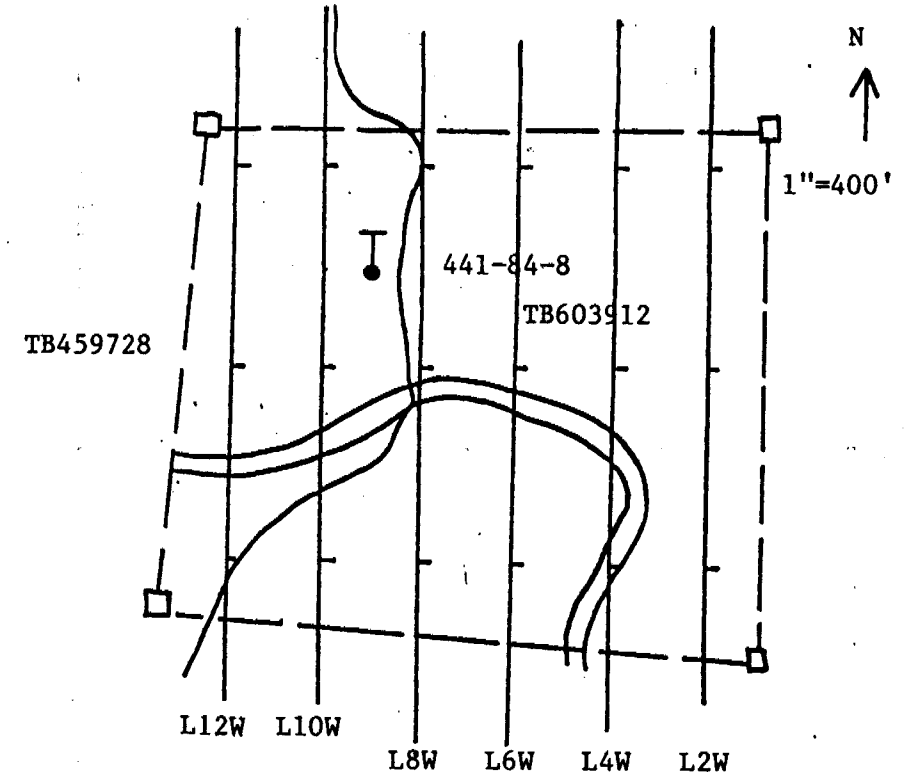
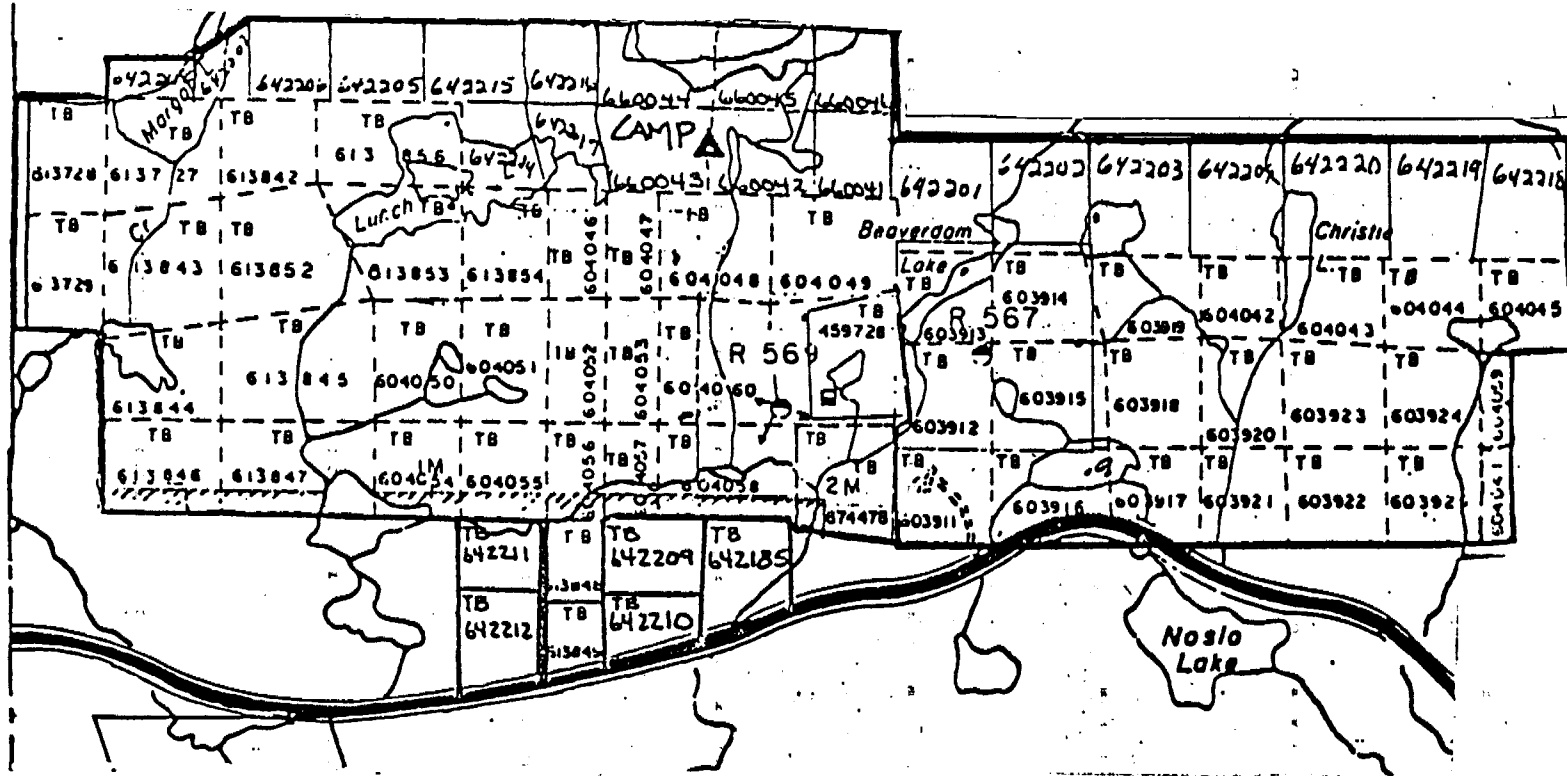

David R. Bell Geological Services Inc.

DIAMOND DRILL HOLE LOG

 PROJECT 441

 HOLE No. 441-84-8

 Page 1 of 10

 Company MICHAM EXPLORATION INC.

FOOTAGE		ROCK TYPE AND DESCRIPTION (alteration, structure, mineralization)	CORE ANGLES TO AXIS	% SULPHIDES	SAMPLE				ANALYTICAL RESULTS							
FROM	TO				NUMBER	FROM	TO	LENGTH	Au ppb	Ag ppm						
0'	51'	<u>Basalt Flow (Fine Grained)</u> - chloritic, slightly siliceous, massive - possible minor amphibolitization - slightly felsic - trace py. - iron staining on fractures 0'-12' - 12'-15' - carbonatized section - very chloritic - 1% py. - gets more felsic at 18 feet SAMPLE - 29.5' - qz.-carb. vein 1" wide, trace py. 55° to core axis - 30'-33 feet - felsic stringer parallel to core axis, minor carb., alkali feldspar in narrow carb. stringer associated		1%	441-000-1256	12'	15'	3'	5	1.6						
51'	203'	<u>Carbonated - Sericitic Shear</u> - first 51 feet is a slightly carbonatized mafic tuff with small units of minor sericitic alteration - sericitic units appear bedded possible mud - py. picks up as well - felsic units present up to 1 foot in length in places - 52.5' - siliceous stringers in core, minor hematite - alkali feldspar - minor carb., trace py. SAMPLE - 54'-64' - mafic tuff - mafic fragments - felsic bands			441-000-1257	52'	54'	2'	4	.4						

David R. Bell Geological Services Inc.

DIAMOND DRILL HOLE LOG

PROJECT 441
 HOLE No. 441-84-8 Page 10 of 10

Company MICHAM EXPLORATION INC.

FOOTAGE		ROCK TYPE AND DESCRIPTION (alteration, structure, mineralization)	CORE ANGLES TO AXIS	% SULPHIDES	SAMPLE				ANALYTICAL RESULTS			
FROM	TO				NUMBER	FROM	TO	LENGTH	Au ppb	Ag ppm	Ni ppm	Zn ppm
		- felsic bands + fragments - foliation 230 feet 45° - 229' - 233' - brown biotite banding - chlorite bands, 232 - 1 foot 20% po. f.g. - irregular qz. + qz.-carb. veining - py. + po. present 1% po., 20% locally SAMPLE - 233' - 238' - same as that described 229'-233', 236' - 1 foot 20% po. f.g. SAMPLE - 251' - brown biotite bands increase - foliation 264 feet 26° - 259' - 3 inch section with po. SAMPLE - 296' - 298' - qz.-carb. veining - minor silicification - brown biotite, chlorite - trace po. + py., hematite in fractures SAMPLE - end 300.9' END OF HOLE 300.9'	45°	1%	441-000 -1300	229'	233'	4'	18	1.4	72	255
			26°		441-000 -1301	233'	238'	5'	45	1.6	66	600
					441-000 -1302	259'	260'	1'	4	.8	96	
					441-000 -1303	296'	298'	2'	7	.8		



Ministry of
Natural
Resources
Ontario

Report
of Work

149

File 6

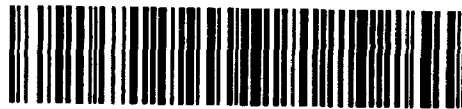

42D155W0117 12 SYINE

900

4410 P. 1 of 3 SHANTON LK. (G-612) The Miner

Name and Postal Address of Recorded Holder

PROSPECTOR'S LICENSE NO.

MICHAM EXPLORATION INC.

T-1185

1030-609 Granville St., Vancouver, B.C. V7Y 1C6

Summary of Work Performance and Distribution of Credits

Total Work Days Cr. claimed	Mining Claim			Mining Claim			Mining Claim		
	Prefix	Number	Work Days Cr.	Prefix	Number	Work Days Cr.	Prefix	Number	Work Days Cr.
1590	TB	603911	20	TB	603919	20	TB	604042	20
		603912	20		603920	30		604043	30
		603913	20		603921	25		604044	30
		603914	20		603922	25		604045	35
		603915	30		603923	30		604046	30
		603916	20		603924	30		604047	30
		603917	30		603925	30		604048	35
		603918	25		604041	40		604049	35

All the work was performed on Mining Claim(s): TB 603912; TB 614674; TB 614676 660

Required Information eg: type of equipment, Names, Addresses, etc. (See Table Below) WORK ASSIGNMENTS PG. 2

BQ CORE DRILLING PERFORMED BY NOREX DRILLING LTD. THUNDER BAY
P.O. BOX 88, PORCUPINE, ONTARIO - OWNER ALEXIS PERINIS

IDH No.	FOOTAGE	DIP ANGLE	AZIMUTH	DATES
441-84-5	450	-50°	0°	March 20-22/84
441-84-6	434'	-50°	0°	March 23-25/84
441-84-7	399'	-50°	0°	March 26-28/84
441-84-8	301'	-80°	0°	March 28-29/84
441-84-9	406'	-49°	0°	Apr. 2-4/84
441-84-10	394'	-49°	0°	Apr. 6-8/84
441-84-11	395'	-50°	0°	Apr. 9-12/84
441-84-12	401'	-50°	0°	Apr. 13-15/84

TOTAL 3180 feet.

CREDIT BALANCE 1590' Date of Report: Apr. 2, 1985 Recorded Holder or Agent (Signature): R.A. Bell

Certification Verifying Report of Work

I hereby certify that I have a personal and intimate knowledge of the facts set forth in the Report of Work annexed hereto, having performed the work or witnessed same during and/or after its completion and the annexed report is true.

Name and Postal Address of Person Certifying: R.A. Bell c/o David R. Bell Geological Services Inc., P.O. Box 1250, Timmins, Ontario

Date Certified: April 2, 1985 Certified by (Signature): R.A. Bell

Table of Information/Attachments Required by the Mining Record Survey

Type of Work	Specific information per type	Other information (Common to 2 or more types)	Attachments
Manual Work			
Shaft Sinking, Drifting or other Lateral Work	Nil	Names and addresses of men who performed manual work/operated equipment, together with dates and hours of employment.	Work Sketch: these are required to show the location and extent of work in relation to the nearest claim post.
Compressed air, other power driven or mechanical equip.	Type of equipment		
Power Stripping	Type of equipment and amount expended. Note: Proof of actual cost must be submitted within 30 days of recording.	Names and addresses of owner or operator together with dates when drilling/stripping done.	
Diamond or other core drilling	Signed core log showing; footage, diameter of core, number and angles of holes.		Work Sketch (as above) in duplicate
Land Survey	Name and address of Ontario land surveyor.	Nil	Nil



Ministry of
Natural
Resources

Report
of Work

Instructions - Supply required data on a separate form for each type of work to be recorded (see table below).
- For Geo-technical work use form no. 1362 "Report of Work (Geological, Geophysical, Geochemical and Expenditures)".

The Mining Act

4410 p52 of 3

Name and Postal Address of Recorded Holder MICRAM EXPLORATION INC.	Inspector's Licence No. T-1185
1030-609 Granville St., Vancouver, B.C. V7Y 1C6	

Summary of Work Performance and Distribution of Credits

Total Work Days Cr. claimed	Mining Claim			Mining Claim			Mining Claim		
	Prefix	Number	Work Days Cr.	Prefix	Number	Work Days Cr.	Prefix	Number	Work Days Cr.
for Performance of the following work. (Check one only) <input type="checkbox"/> Manual Work <input type="checkbox"/> Shaft Sinking Drifting or other Lateral Work. <input type="checkbox"/> Compressed Air, other Power driven or mechanical equip. <input type="checkbox"/> Power Stripping <input checked="" type="checkbox"/> Diamond or other Core drilling <input type="checkbox"/> Land Survey	TB	604050	40	TB	604058	25	TB	613844	35
		604051	30		604059	30		613845	35
		604052	25		604060	20		613846	40
		604053	20		613727	30		613847	40
		604054	40		613728	40		613848	35
		604055	30		613729	35		613849	40
		604056	25		613842	30		613852	20
		604057	20		613843	20		613853	30

All the work was performed on Mining Claim(s): 735

Required Information eg: type of equipment, Names, Addresses, etc. (See Table Below)

refer to pg 1

WORK ASSIGNMENTS

TB 603912 - 1564 days. Balance - 2436 days.

TB 614676 - 780 days. Balance - 3220 days.

TB 614674 - 771 days. Balance - 3229 days.

THUNDER BAY
MINING DIVISION
RECEIVED
APR 4 1985

AM 7/8/9/10/11/12/1/2/3/4/5/6 PM

A

Date of Report Apr. 2, 1985	Recorded Holder or Agent (Signature) R.A. Bell
---------------------------------------	--

Certification Verifying Report of Work

I hereby certify that I have a personal and intimate knowledge of the facts set forth in the Report of Work annexed hereto, having performed the work or witnessed same during and/or after its completion and the annexed report is true.

Name and Postal Address of Person Certifying R. A. Bell c/o David R. Bell Geological Services Inc., P.O. Box 1250, Timmins, Ont. P4N 7J5.	
Date Certified Apr. 2, 1985	Certified by (Signature) R.A. Bell

Table of Information/Attachments Required by the Mining Recorder

Type of Work	Specific information per type	Other information (Common to 2 or more types)	Attachments
Manual Work	Nil	Names and addresses of men who performed manual work/operated equipment, together with dates and hours of employment.	Work Sketch: these are required to show the location and extent of work in relation to the nearest claim post.
Shaft Sinking, Drifting or other Lateral Work			
Compressed air, other power driven or mechanical equip.	Type of equipment	Names and addresses of owner or operator together with dates when drilling/stripping done.	Work Sketch (as above) in duplicate
Power Stripping	Type of equipment and amount expended. Note: Proof of actual cost must be submitted within 30 days of recording.		
Diamond or other core drilling	Signed core log showing; footage, diameter of core, number and angles of holes.	Nil	Nil
Land Survey	Name and address of Ontario land surveyor.		



Report of Work

Instructions - Supply required data on a separate form for each type of work to be recorded (see table below). - For Geo-technical work use form no. 1362 "Report of Work (Geological, Geophysical, Geochemical and Expenditures)".

The Mining Act

Name and Postal Address of Recorded Holder: MICHAM EXPLORATIONS INC. 1030-609 Granville St., Vancouver, B.C. V7Y 1C6. Prospector's Licence No. T-1185

Summary of Work Performance and Distribution of Credits

Table with columns: Total Work Days Cr. claimed, Mining Claim Prefix/Number, Work Days Cr. Includes checkboxes for Manual Work, Shaft Sinking, Compressed Air, Power Stripping, Diamond or other Core drilling, Land Survey.

All the work was performed on Mining Claim(s): 195

Required Information eg: type of equipment, Names, Addresses, etc. (See Table Below)

Large empty box for required information. Includes handwritten note 'refer to pg 1' and a 'THUNDER BAY MINING DIVISION RECEIVED APR 4 1985' stamp.

Date of Report: Apr. 2, 1985. Recorded Holder or Agent (Signature): R. A. Bell

Certification Verifying Report of Work

I hereby certify that I have a personal and intimate knowledge of the facts set forth in the Report of Work annexed hereto, having performed the work or witnessed same during and/or after its completion and the annexed report is true.

Name and Postal Address of Person Certifying: R. A. Bell c/o David R. Bell Geological Services Inc., P.O. Box 1250, Timmins, Ontario, P4N 7J5. Date Certified: Apr. 2, 1985. Certified by (Signature): R. A. Bell

Table of Information/Attachments Required by the Mining Recorder

Table with columns: Type of Work, Specific Information per type, Other Information (Common to 2 or more types), Attachments. Rows include Manual Work, Shaft Sinking, Compressed air, Power Stripping, Diamond or other core drilling, Land Survey.

Lower Aquasabon Lake Area
G-599

Santoy Lake Area G-612

STREY TP G-633

TUURI TP

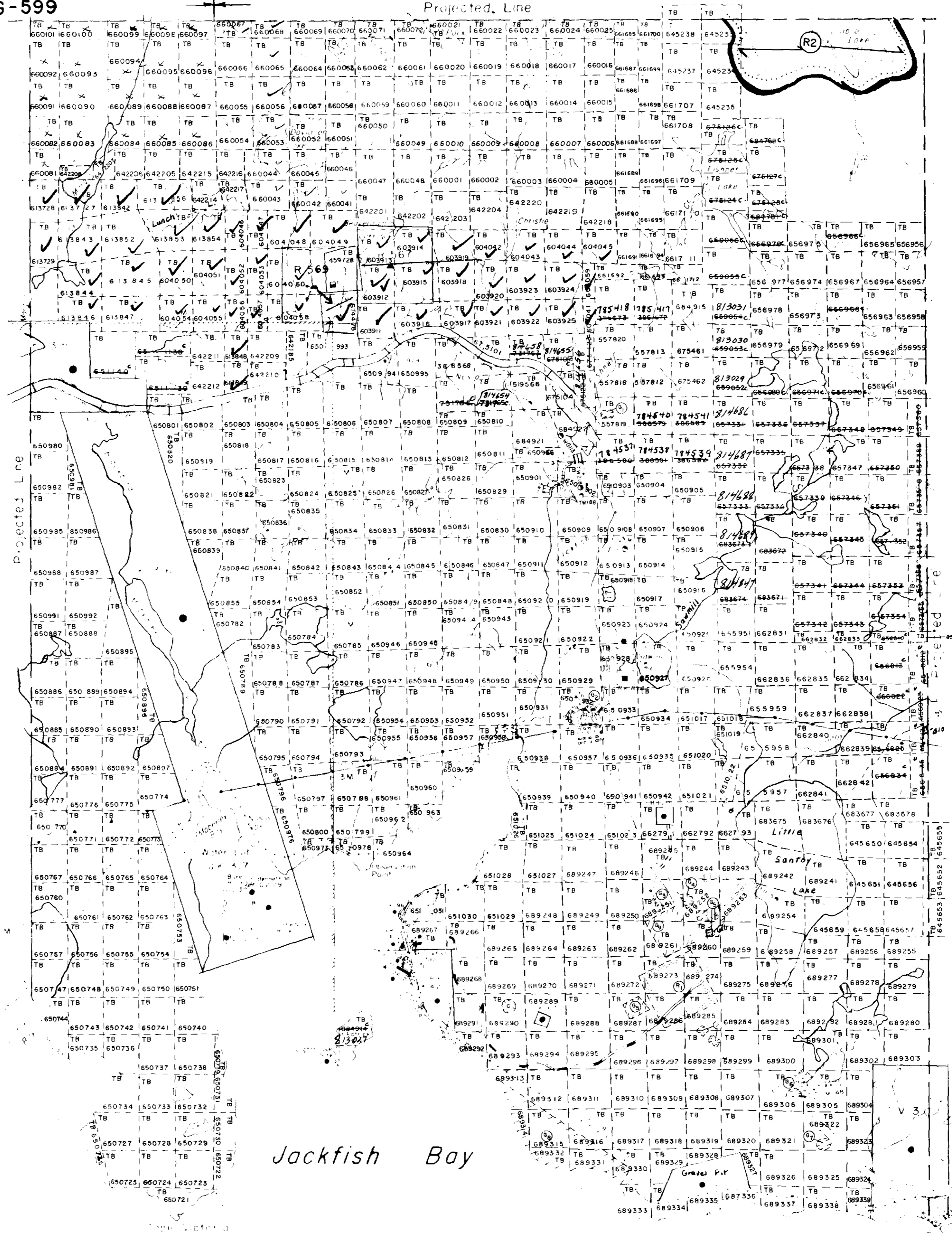

REFERENCES

AREAS WITHDRAWN FROM DISPOSITION

MINING RIGHTS M.R. MINING RIGHTS

Disposition	Order No.	Date	Disposition	File
Ⓜ	NCR	W 40/81	137/4/81	S.R. 153452
Ⓜ	PARK RESERVE	W 61/83	6/9/83	M.S. 188318
Ⓜ	DISPOSITION BY EXPLORATORY LICENCE OF OCCUPATION ONLY - APPLY TO MINING RECORDER.			

SAND & GRAVEL

- Ⓜ M.T.C. Pit 37
- Ⓜ M.T.C. Pit 38
- Ⓜ M.T.C. Pit 39
- Ⓜ M.T.C. Pit 40
- Ⓜ Gravel File 153452
- Ⓜ M.T.C. Pit 42
- Ⓜ M.T.C. Pit 43
- Ⓜ Gravel Reserve, File 65008
- Ⓜ M.T.C. Pit 41, Gravel File 153452
- Ⓜ Quarry Permit
- Ⓜ M.R. - Gravel Reserve
- Ⓜ M.R. - Sand Reserve

IMPROVED DISTRICT OF TERRACE BAY SHOWN
THUS

LAND UNDER LAKE SUPERIOR WITHDRAWN FROM
STAKING BY O.C. APRIL 30, 1912

LEGEND

DISPOSITION OF CROWN LANDS

TYPE OF ENCUMBRANCE	SYMBOL
RESERVED RIGHTS	●
MINING RIGHTS	○
MINING RIGHTS - GRANT	○
LEASE SURFACE & MINING RIGHTS	○
SURFACE RIGHTS ONLY	○
MINING RIGHTS ONLY	○
RIGHT OF OCCUPATION	○
CHRONIC OFFENSE	○
RESERVATION	○
PARK RESERVE	○
QUARRY PERMIT	○

NOTE: MINING RIGHTS IN PART OF PATENT ARE SUBJECT TO A
SPECIAL CONDITIONAL PATENT BY THE PUBLIC
AND ARE SUBJECT TO THE PUBLIC

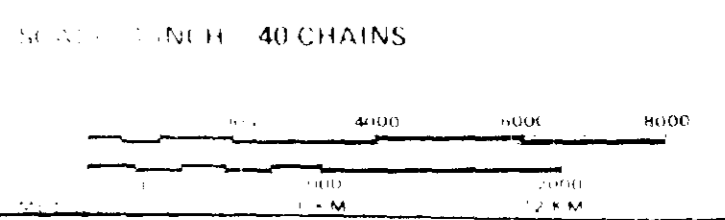

TOWNSHIP

SYINE

M.N.R. ADMINISTRATIVE DISTRICT

TERRACE BAY

MINING DIVISION

THUNDER BAY

LAND TITLES / REGISTRY DIVISION

THUNDER BAY

Ministry of Natural Resources
Land Management Branch
August 22, 1984

Number

G-634

