



Summary Report
Mel Swereda OPAP # OP92-457
Croll Twp Property

Location:

The Mel Swereda Croll Twp. property, which straddles the Ashmore - Croll Twp. boundary, lies immediately south of Highway 11 about 10 km east of Geraldton, Ontario.

Access:

The property is reachable by gravel road which cuts south through the claim group immediately south of Highway 11.

Geology:

The property is underlain by mafic flows and interflow diorite - gabbro intrusives (possibly massive coarse grain flow centres) which have been altered by low grade regional metamorphism, local silicification and chlorite, chlorite-sericite along minor faulting such as on the No 1 zone. Pyrite, quartz and quartz-carbonate, locally chalcopyrite and trace amounts of galena are associated with these deformation-alteration systems. Sampling results also indicate substantial gold enrichment (several samples 1000 ppb to 2500 ppb Au) along the fault related deformation system along the #1 Zone.

Work Completed;

The work was directed primarily at prospecting for old trenches (apparently many exist in the area), mechanically stripping, trenching, blasting, mapping, sampling to determine gold enrichment possibilities in these old workings. One drill hole was completed to test the gold-bearing No. 1 zone at depth.

Results;

Zone #1 proved to be a gold-bearing zone while the other zones (#2, #3 and #4) returned very low to nil values in gold. The #1 zone is a well defined fault shear system, variably carbonitized, quartz veined, chloritized and locally sericitic. It is about 5 feet to 10 feet wide, exposed along strike for about 350 feet and apparently continues its strike length extension well beyond the trenched-stripped location. Pyrite occurs variably along its length. Chalcopyrite is "spotty" and appears to be concentrated most heavily with the thicker quartz veined locations. The best gold values were obtained from locations containing a quartz-chalcopyrite association.

Recommendations:

1) An attempt should be made to define the eastward extension of the No 1 zone by prospecting on strike to the east boundary of the claim group followed by bulldozer stripping at suitable locations.

2) The property area, as a whole, should be prospected in detail for old trenches, where found these should be sampled for assay. Locations returning ^{assay} indications of gold enrichment should be bulldozer stripped for a better mineralization evaluation.

3) ^{Gold in the} ~~The~~ area of the old Roche prospect was discovered in 1939. Where it is possible, bulldozer stripping should be conducted eastward from the ^{old} discoveries to determine if there is any eastward extensions of this gold-bearing zone.

4) VLF-EM survey results show several VLF EM conductive zones on the property. An attempt should be made to trace these conductors to see if they continue into shallow overburden or outcrop areas where they can be exposed by

mechanical stripping or trenching.

Budget:

If funds are prudently utilized, a fairly thorough prospecting oriented examination of much of the property area should be possible for the cost of \$12000 to \$15000.

P. Lassila
Geologist

P. Lassila
Sept. 21, 1992

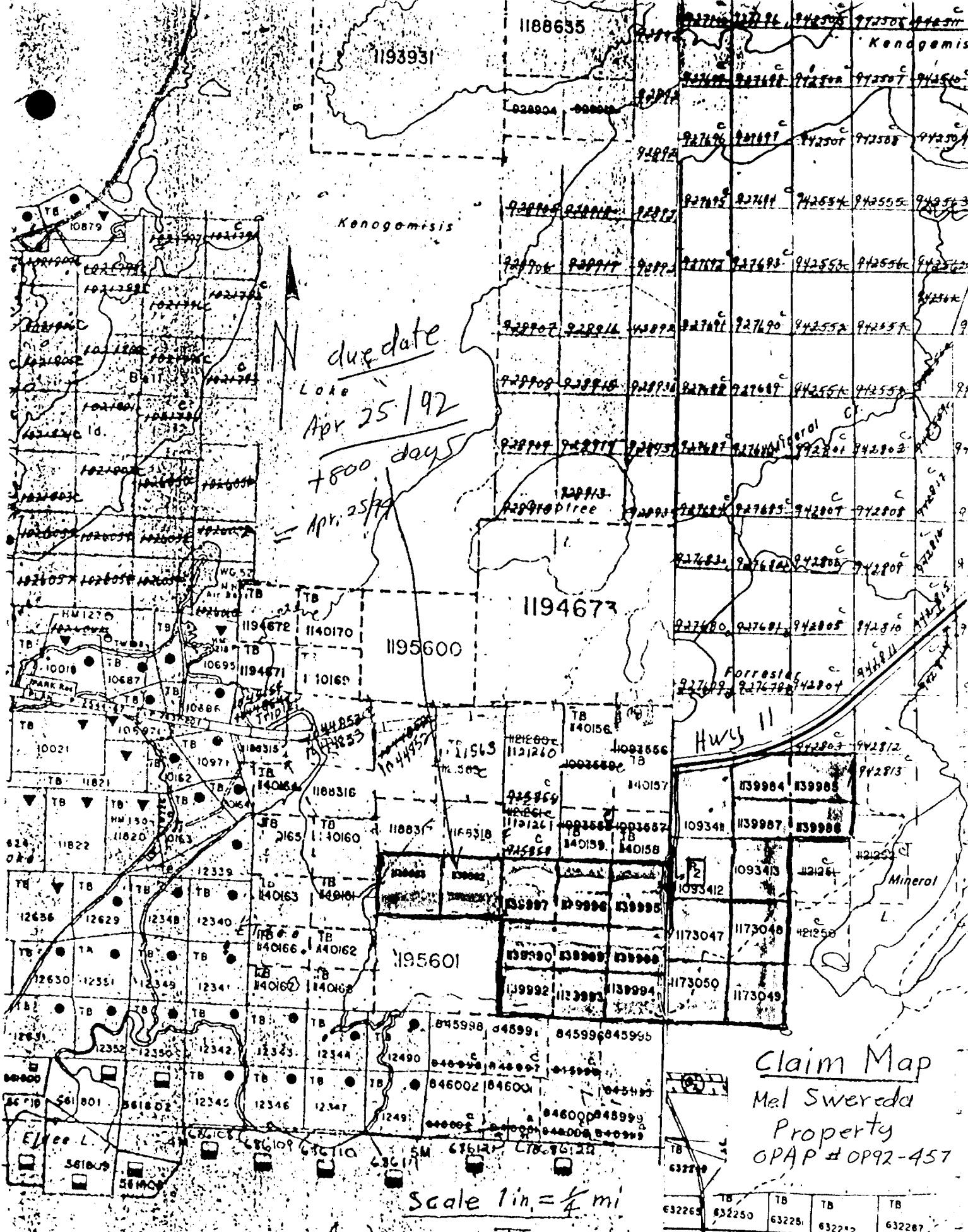

due date
 Apr 25/92
 + 800 days
 = Apr. 25/99

Claim Map
 Mel Swereda
 Property
 OPAP # 0P92-457

Scale 1 in. = 1/4 mi

Ashmore Twp

Eroll Twp

TB 632265	TB 632250	TB 632251	TB 632252	TB 632287
--------------	--------------	--------------	--------------	--------------

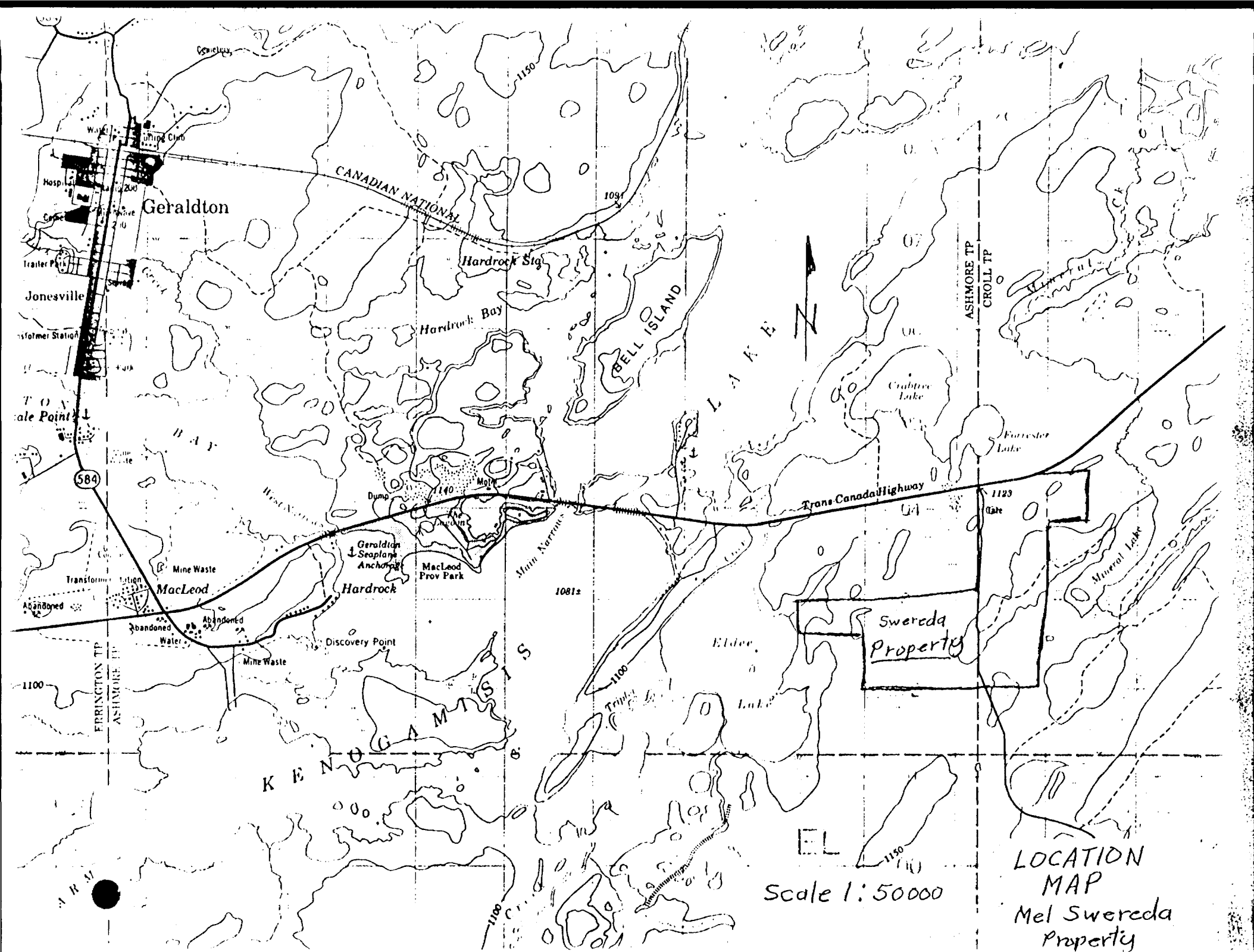

LOCATION
MAP
Mel Swereda
Property

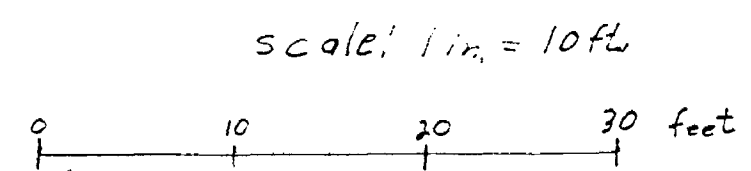
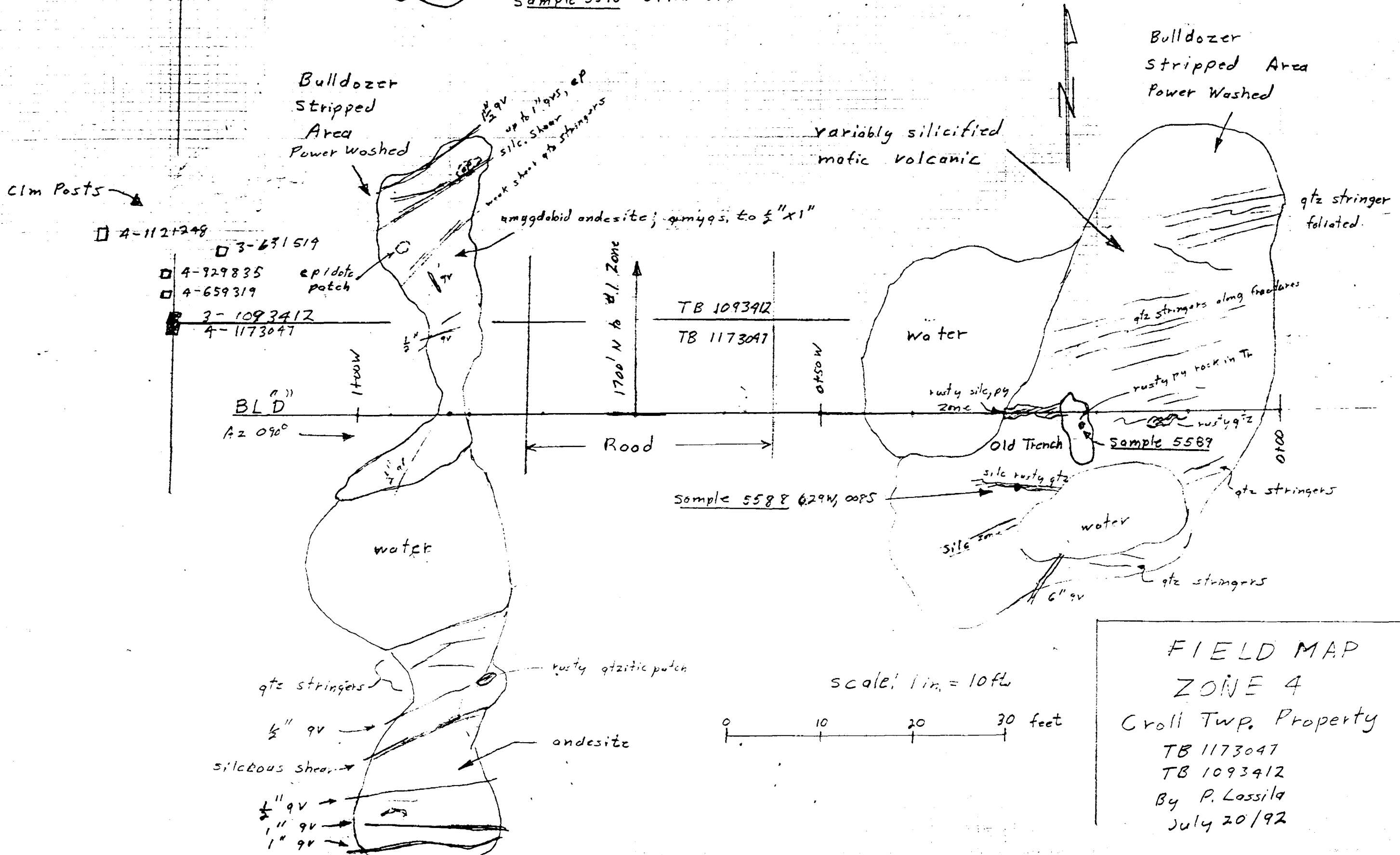
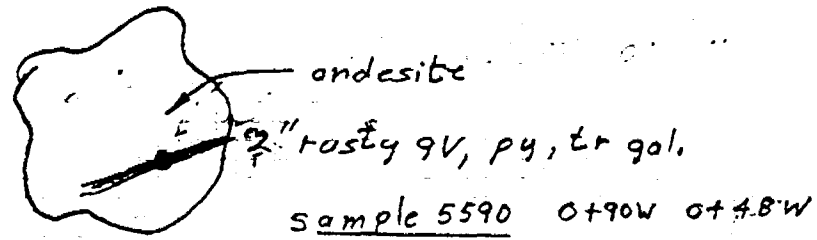

FIELD MAP
 ZONE 4
 Croll Twp. Property
 TB 1173047
 TB 1093412
 By P. Lassila
 July 20/92

Sample #5585 0+18 W 0+34 N

strongly silicified and sericitized
volc with many rusty (sulfide)
patches; heavy epidote flooding
with silica.

mafic volc altered to subvolcanic
composition, weakly to mod. foliated
localized rusty patches

weakly foliated fragment
slightly silic

rusty pitted surface
contains py, some po, occas epy,
total of 3% to 7% sulfides
subvolcanic composition, appears
to be weakly silicified and
sulfide injected mafic volc.

Andesite lapilli with frags to 6" long
and 2" thick - all andesitic material
up to 5% feldspathic elongated amygdules
to 4" long and 1" wide

Shear (small fault)
rusty weakly
silicic zone

Trachyandesitic
lapilli

Sample 5586 5% py, 4% po
Sample 5587 7% py, 10% po
brecciated andesitic lapilli

area of silicification
and weak sericitization
due to silica flooding
thru fractures
much original
texture obliterated

Bulldozer stripped
Backhoe Trenched
Power washed
EXPOSURES

TB1093412

335 ft. to #1 zone

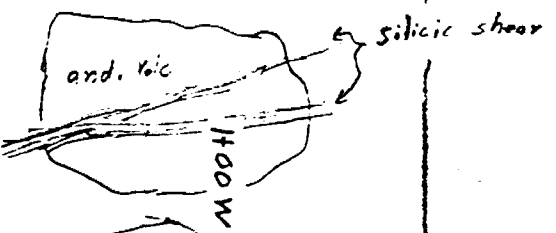

massive fn grain
dark grey andesitic volc
very weakly silicified

calc veins (minor Qtz) N-S
with numerous E-W tension fractures
filled with calcite; N-S tension moment
andesitic flow locally brecciated

6' deep backhoe Trench

mud

To 0+75 N

Scale

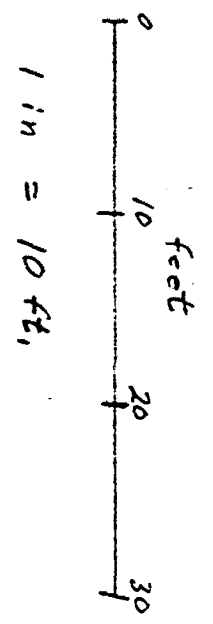

BL C

Az 090°

P Lassoila

1450W

FIELD MAP
ZONE 3

Croll TWP, Property

TB 1093412

By: P Lassoila

July 20 1992

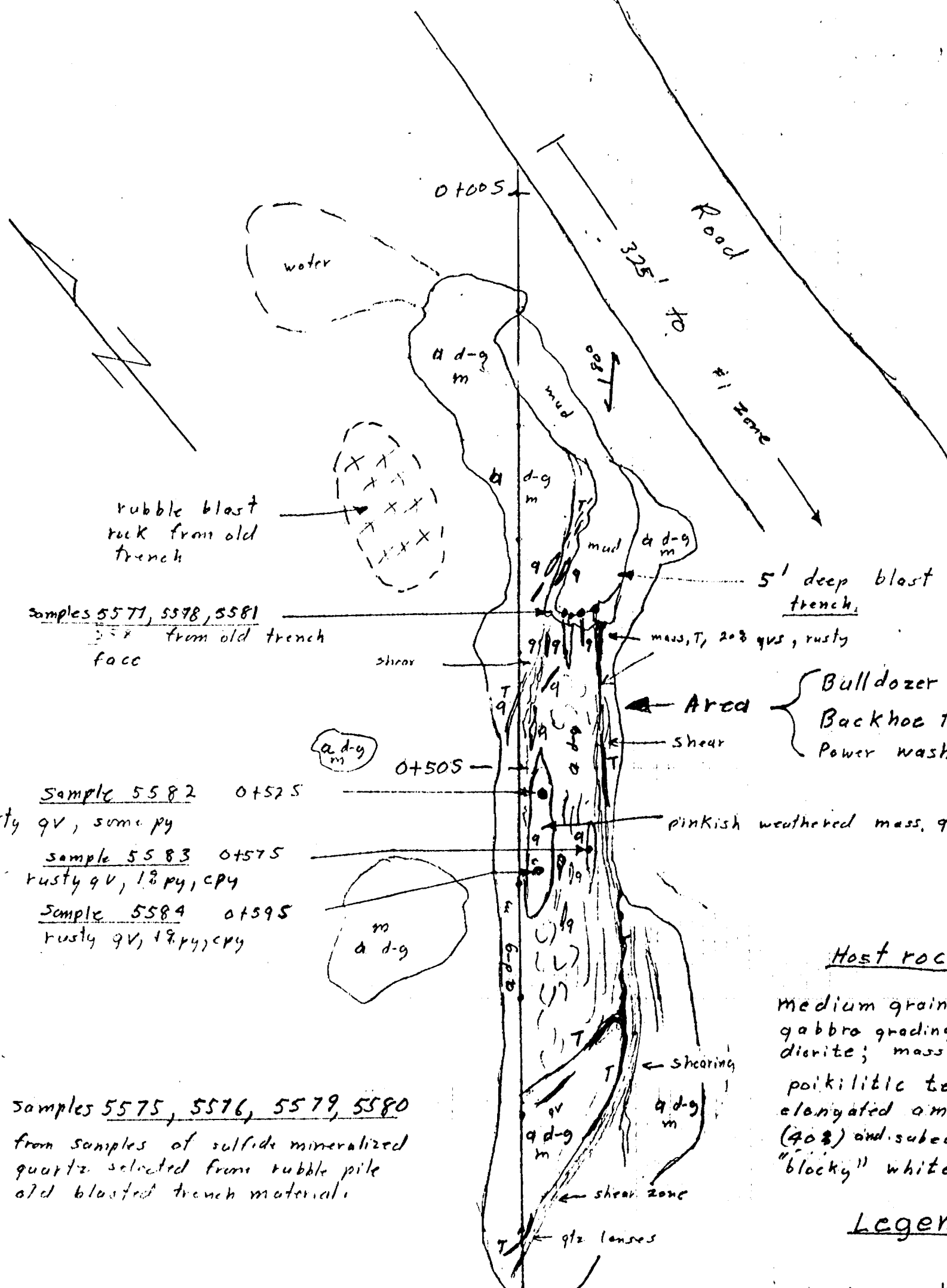

samples 5577, 5578, 5581
from old trench
face

Sample 5582 0+52.5
rusty qv, some py

sample 5583 0+57.5
rusty qv, 12 py, cpv

Sample 5584 0+59.5
rusty qv, 18 py, cpv

samples 5575, 5576, 5579, 5580
from samples of sulfide mineralized
quartz selected from rubble pile
old blasted trench materials

Area { Bulldozer Stripped
Backhoe trenched
Power washed

Host rock

medium grained
gabbro grading towards
diorite; massive.
poikilitic textured
elongated amphiboles
(40%) and subhedral
"blocky" white feldspar,

Legend

- a d-g amphibole
diorite - gabbro
- q quartz vein
- T tourmaline seam
- m massive
- shear
- irreg. foliation
- sample locations

TB 1093411 1+00.5

BL B
AZ 040°

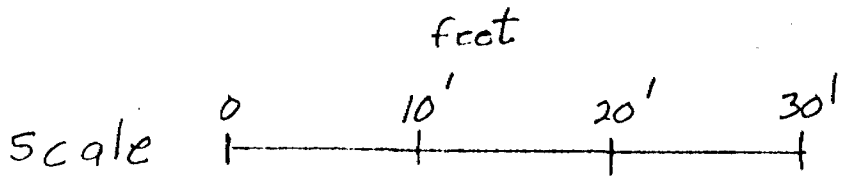

1 in. = 10 ft

P Lassila

FIELD MAP
#2 ZONE
Croll Twp. Property
Croll Twp, Ont.
By: P Lassila July 20 1992

P Lassila
Copy

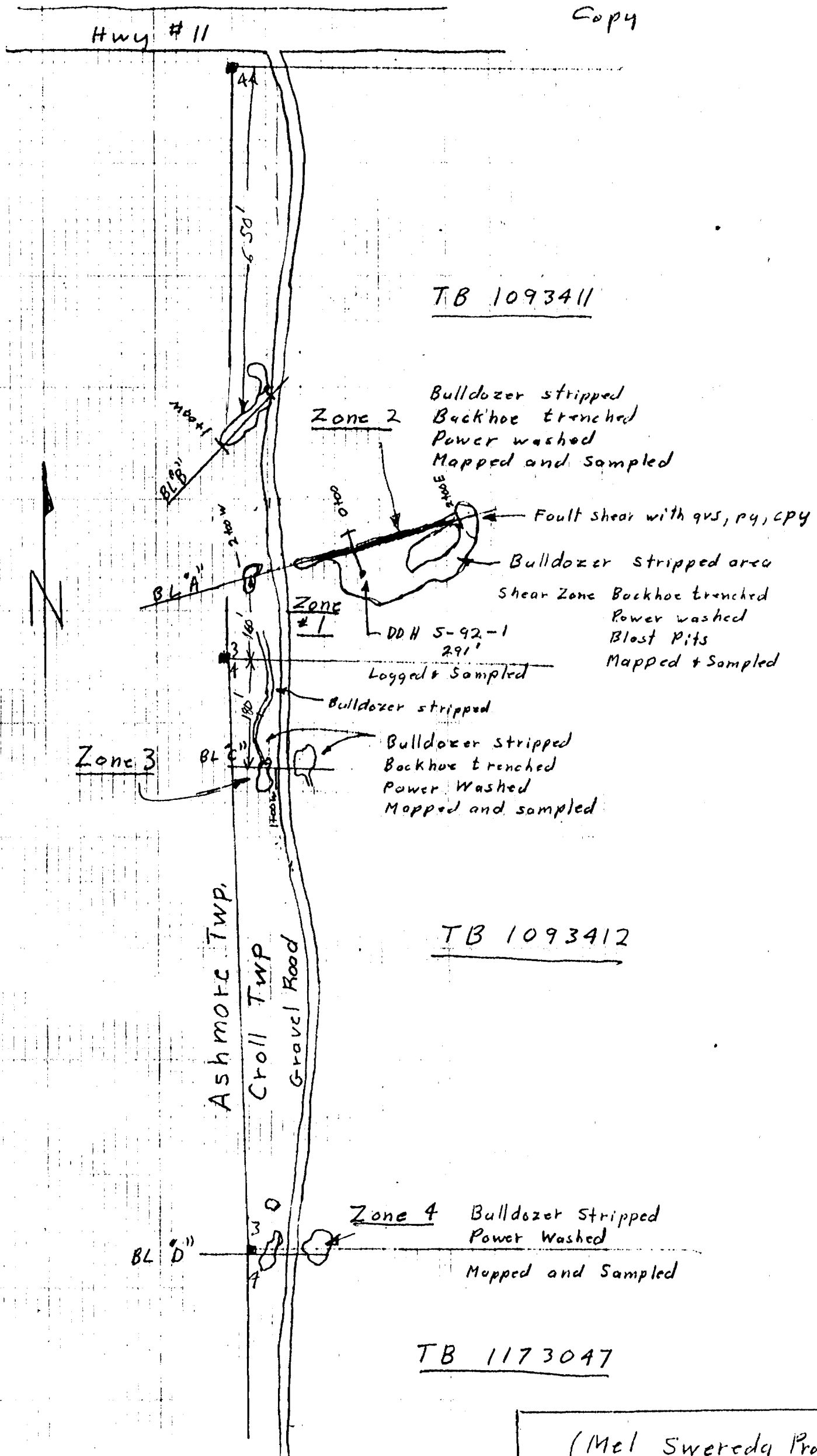

TB 1093411

Bulldozer stripped
Backhoe trenched
Power washed
Mapped and Sampled

Fault shear with qvs, py, cpy

Bulldozer stripped area

Shear Zone Backhoe trenched
Power washed
Blast Pits
Mapped + Sampled

DDH 5-92-1
291'

Logged + Sampled

Bulldozer stripped

Bulldozer stripped
Backhoe trenched
Power Washed
Mapped and sampled

TB 1093412

Zone 4 Bulldozer Stripped
Power Washed
Mapped and Sampled

TB 1173047

(Mel Swereda Property)

WORK LOCATION
SKETCH

Croll Twp. Property

By P. Lassila
July 21, 1992

Scale: 1 in = 200 ft

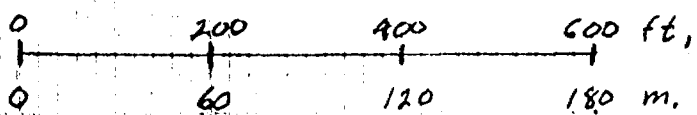

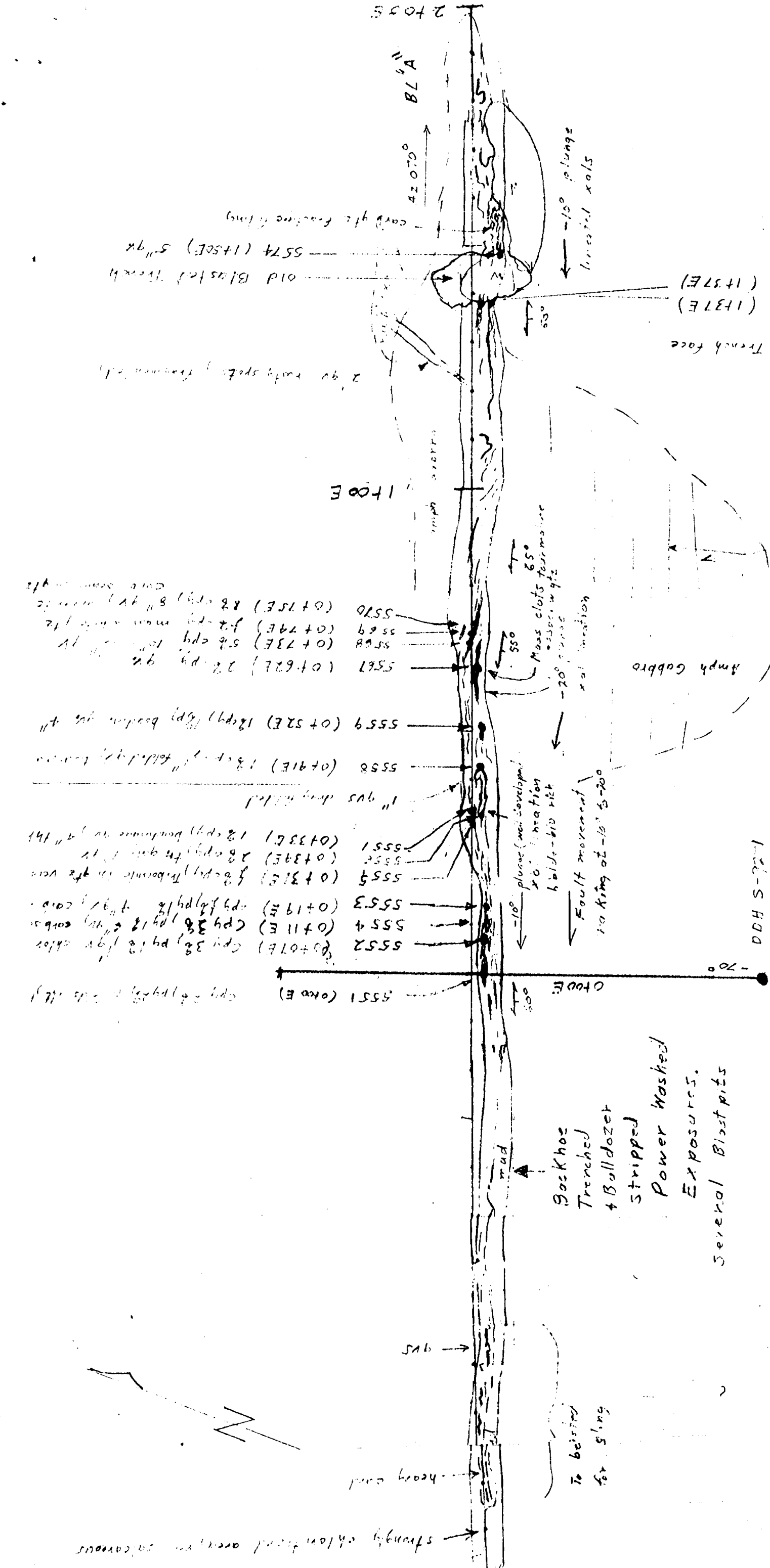

Symbols

- quartz veins
- rock sample location (selective grab)

#1 Zone consists of a sill on flood, fault shear zone dipping -55° to 85° to the south. Rock components include alteration of mafic rock into lined to foliated fine grained hornblende, biotite, muscovite, enstatite and quartzite. Quartz veining up to 12" thick as lensy veins and stringers commonly with variable amounts of apophyllite occurs mainly in the mafic rock in close proximity to the quartzite. Calcite is a minor constituent but increases towards the east where chloritization is also most prominent. Carbonatization (ankerite) occurs variably along with quartz and in places acts as a matrix filler within the quartzite. The western part of the zone (near the road) is extremely barren and also strongly calcareous with less quartz.

- Backhoe Trenched + Bulldozer Stripped
- Power Washed Exposures.
- Several Blast pits

strongly chloritized area, calcareous

heavy sand
to be used for sling

L-26-S HQD

Amph Gabbro

plunge (well developed) 65°
x 60° interaction
hills - big rift
Fault movement
to king at -10° to 200

Mass clots tourmaline
2500 wt%
-20° plunge
xal transition

many v's
1" to 2" thick

- S551 (0 to 6 E)
- S552 (0 to 7 E) cpy 38, py 12, fgr 10%
- S554 (0 to 11 E) cpy 38, py 12, fgr 10%
- S553 (0 to 19 E) py 18, fgr 10%
- S555 (0 to 31 E) fgr 38, py 12, fgr 10%
- S556 (0 to 39 E) 28 cpy, fgr 10%
- S557 (0 to 33 E) 18 cpy, fgr 10%
- S558 (0 to 41 E) 18 cpy, fgr 10%
- S559 (0 to 52 E) 18 cpy, fgr 10%
- S567 (0 to 62 E) 28 py, 9%
- S568 (0 to 73 E) 58 cpy, 10%
- S569 (0 to 74 E) fgr 20, 10%
- S570 (0 to 75 E) 88 cpy, 8" py, 10%

2' to 9' rusty spots, fragments

Off Trench face

- S572 (1437E) 18 cpy, 1/2 py, 2" py
- S573 (1437E) 38 cpy, 1/2 py, 1" py, 28 py in matrix

-10° plunge
lateral xals

420750
BL 6 A
2 to 5 E

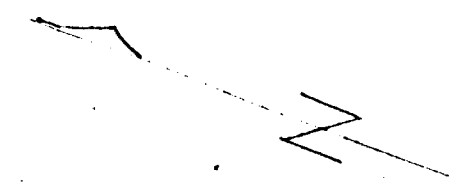

strongly chlorinated area, very siliceous

heavy sand

sub

road

Road

quartz - disc

200 ft

Az 0 to 5

BL - A

Rusty weathered chlor-corb fault shear. Many angular boulders of some material dug up. Only minor qtz knots visible.

To be used for siling

Backhoe Trenched + Bulldozer Stripped

Power Washed Exposures. Several Blast pits

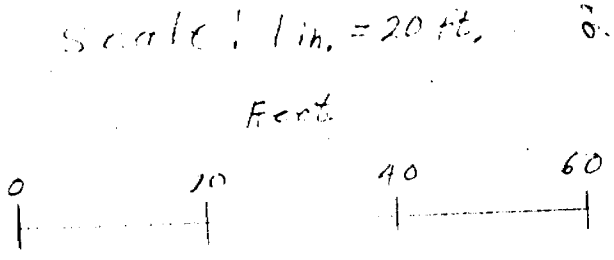

Symbols

quartz veins
rock sample location (selective grab)

P Lassila

FIELD MAP
ZONE 1
Croll Twp Property
TB 1093411
By: P Lassila
July 19, 1992

63.6093

P Lassila

#1 Zone - mostly of -55° to 65° to the south. It is lined to foliated and mostly sericite. Quartz veinlets and stringers occur mainly in the matrix is a minor constituent but is also most prominent. Carb quartz and in places are part of the zone (near the road)

Swevedo
~~OTAV~~ Capri

Assay Results: #1 Zone: TB 1093411

Sample	Values		Location (ft)	Remarks
	Au, ppb	Cu, %		
5551	2170	0.30	BL A 0+00W	1' qv, py 2%, cpy 2%
5552	1234	0.76	BL A 0+07W	1' qv, cpy 3%, tr bornite
5553	1190	-	BL A 0+19E	4" qv, py 1%, cpy 1/2%
5554	603	0.30	BL A 0+11E	6" qv, py 1%, cpy 2%
5555	202	0.21	BL A 0+31E	qv lenses, cpy 1%, trace bornite, carb
5556	199	0.19	BL A 0+34E	1" qtz vs, cpy 2%, gal tr
5557	027	0.05	BL A 0+33E	Boudin qv, cpy 1%
5558	165	-	BL A 0+41E	1" folded qv, cpy 1% tourmaline
5559	1851	-	BL A 0+52E	4" boudin qv, py 1%, cpy 1%
5567	480	0.30	BL A 0+63E	qv, cpy 2%
5568	2434	1.54	BL A 0+73E	10" qv, cpy 5%
5569	024	-	BL A 0+74E	mass qtz, cpy 1/2%
5570	158	-	BL A 0+75E	8" qv, cpy 1% carb seams
5571	285	-	BL A 0+90E	4" qv, py tr, ankerite seams
5572	305	-	BL A 1+37E	2" qv, cpy 1% old tr face
5573	1118	1.15	BL A 1+37E	2" qv, cpy 3%, py 1% old tr face
5574	926	-	BL A 1+50E	6" qv, py 1%, cpy 1%

Total samples: 17

July 21, 1992
P. Losada

Assay Results

DDH 5-92-1, No. 1 Zone, TB 1093411

<u>Sample</u>	<u>Value Au ppb</u>	<u>Cu%</u>	<u>Location in ft.</u>	<u>Remarks</u>
5560	189	-	28.7'	3" qv, py 2%
5561	014	-	{ 38.7 42.8	4" qv, tr mo 3" qv
5562	089	0.03	64.4' to 66.4'	sericite, qvs to 2", few blebs cpy shear zone
5563	384	-	67.8' to 68.9'	3% py, alt. mafic volc.
5564	017	-	69.7' to 71.0'	3% py, alt. mafic volc.
5565	Nil	-	142.0' to 143.0'	white qv
5566	007	0.04	222.0' to 225.0'	3% po blebs, tr cpy

55 Total samples: 7

No. 4 Zone; TB # 1173047

5588	034	-	0+08S, 0+29W	3" qv, py 1%
5589	120	-	0+25W, old Tr	py, po 5%, silc. tr
5590	Nil	-	0+48N, 0+90W	3" qv, po 1%, col tr

Total samples 3

July 21/92

P. Lassila

P. Lassila

Assay Results

No. 2 Zone: TB 1093411

<u>Sample</u>	<u>Values</u> Au ppb, Cu %	<u>Location (ft)</u>	<u>Remarks</u>
5575	010 -	Old Tr. material	qv., py 1%
5576	014 -	Old Tr. material	qtz, py, po 1%
5577	007 -	Old Tr. face	qv., py tr
5578	Nil -	Old Tr. material	qv., po 2%
5579	010 -	Old Tr. material	smoky qv, po 2%
5580	Nil -	Old Tr. material	qtz., py 1%
5581	051 -	Old Tr. face	qv., po 3%
5582	Nil -	0+02E, 0+52S	rusty qv, py
5583	082 0.31	0+06E, 0+57S	rusty qv, cpy
5584	Nil -	0+02E, 0+59S	2' rusty qv., py 1% few blobs cpy

Total Samples 10

No. 3 Zone: TB 1093412

5585	017 -	0+18W 0+34N	Qtzitic rk, epidote ½ v. fn. py
5586	007 -	0+34W 0+00	alt mafic volc. 5% py, 4% po
5587	007 -	0+33W 0+00	alt mafic volc 7% py, po

Total Samples 3

P. Lossila
July 21, 1992

P. Lossila

B-6

Swastika Laboratories
P.O. Box 10
Swastika, Ontario
P0K 1T0

INVOICE

NO: 27534

DATE: 08-07-92

PAGE: 1 of 1

SOLD TO:

SHIP TO:

F. Lassila
General Delivery
Beardmore, Ontario
P0T1G0

Same

ST Number: R132862640

ITEM NO.	QUANTITY	UNIT	DESCRIPTION	G	P	UNIT PRICE	AMOUNT
40		Code 1	Au Assays			8.750	350.00
12		Code 1	Cu %			7.250	87.00
5		Code 1	Ni %			6.000	30.00
40		Code A	Sample Handling			3.000	120.00
			Cert#2W-0758-R01				
			3-0ST @ 7 %				41.09
<i>Ord by Mel Sworecky (OPAP # 0P92-457)</i> <i>F. Lassila</i>							
TERMS:							
at 30 Days						TOTAL	528.09



Established 1928

Swastika Laboratories

A Division of Assayers Corporation Ltd.

Assaying - Consulting - Representation

Page 1 of 2

Geochemical Analysis Certificate

2W-0758-RG1

Company: **P. LASSILA**

Date: **AUG-04-92**

Project:

Copy 1. GENERAL DEL. BEARDMORE, ONT. POT 1GO

Attn:

2. PHONE # (807) 875-2604

We hereby certify the following Geochemical Analysis of 40 rock samples submitted JUL-24-92 by .

Sample Number	Au PPB	Au oz/ton	Au Check oz/ton	Cu %	Ni %
5551	2170	0.063	0.055	0.30	
5552	1234	0.036		0.76	
5553	1190	0.035			
5554	603	0.018		0.30	
5555	202	0.006		0.21	
5556	199	0.006		0.19	0.01
5557	27			0.05	
5558	165	0.005			
5559	1851	0.054			
5560	189	0.006			
5561	14				
5562	89			0.03	0.01
5563	384	0.011			
5564	17				
5565	Nil				
5566	7			0.04	0.01
5567	480	0.014		0.30	
5568	2434	0.071	0.090	1.54	
5569	24				
5570	158	0.005			
5571	285	0.008			
5572	305	0.009			
5573	1118	0.033		1.15	
5574	926	0.027			
5575	10				
5576	14				
5577	7				
5578	Nil				
5579	10				
5580	Nil				

Certified by 

P.O. Box 10, Swastika, Ontario P0K 1T0

Telephone (705) 642-3244

FAX (705) 642-3300



Swastika Laboratories

A Division of Assayers Corporation Ltd.

Assaying - Consulting - Representation

Page 2 of 2

2W-0758-RG1

Company: **P. LASSILA**

Date: **AUG-04-92**

Project:

Copy 1. GENERAL DEL. BEARDMORE, ONT. POT IGO

Attn:

2. PHONE # (807) 875-2604

We hereby certify the following Geochemical Analysis of 40 rock samples submitted JUL-24-92 by .

Sample Number	Au PPB	Au oz/ton	Au Check oz/ton	Cu %	Ni %
5581	51				
5582	Nil				
5583	82			0.31	
5584	Nil				
5585	17				
5586	7				0.03
5587	7				0.01
5588	34				
5589	120				
5590	Nil				

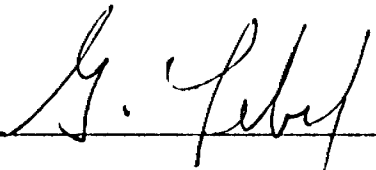
Certified by 

P.O. Box 10, Swastika, Ontario P0K 1T0
Telephone (705) 642-3244. FAX (705) 642-3300

Report of Work Cost After Recording Claims
Mining Act



42E10NW0101 63.6093 CROLL

900

Personal information collected on this form is obtained under the authority of the Ministry of Northern Development and Mines. For more information, contact the Provincial Manager, Mining Lands, Ministry of Northern Development and Mines, Fourth Floor, 159 Cedar Street, Toronto, Ontario, P3E 6A5, telephone (705) 670-7264.

63.6093

- Instructions:**
- Please type or print and submit in duplicate.
 - Refer to the Mining Act and Regulations for requirements of filing assessment work or consult the Mining Recorder.
 - A separate copy of this form must be completed for each Work Group.
 - Technical reports and maps must accompany this form in duplicate.
 - A sketch, showing the claims the work is assigned to, must accompany this form.

Recorded Holder(s) <i>Mel. Swereda</i>	Client No. <i>199458</i>
Address <i>P.O. Box 936 Geraldton, Ontario POT 1M0</i>	Telephone No. <i>(807) 859-0535</i>
Mining Division <i>Thunder Bay</i>	Township/Area <i>Croll Twp. Ont.</i>
Work Group From: <i>July 8, 1992</i>	M or G Plan No. <i>G 491 + G 472</i>
Work Group To: <i>July 21, 1992</i>	

Work Performed (Check One Work Group Only)

Work Group	Type
Geotechnical Survey	
Physical Work, Including Drilling	<i>Backhoe, trench, geological survey, rock stripping, Rock washing</i>
Rehabilitation	
Other Authorized Work	
Assays	
Assignment from Reserve	

Total Assessment Work Claimed on the Attached Statement of Costs \$ 7790

Note: The Minister may reject for assessment work credit all or part of the assessment work submitted if the recorded holder cannot verify expenditures claimed in the statement of costs within 30 days of a request for verification.

Persons and Survey Company Who Performed the Work (Give Name and Address of Author of Report)

Name	Address
<i>Olenik Associates</i>	<i>302 Holm Ave. Geraldton Ontario POT 1M0</i>
<i>Stans Drilling</i>	<i>P O Box 166 Geraldton Ontario POT 1M0</i>
<i>K. Kivian, J. Gaden</i>	<i>General Delivery, Geraldton, Ont, POT 1M0</i>
<i>Mel Swereda</i>	<i>P O Box 926 Geraldton Ont, POT 1M0</i>

Attach a schedule if necessary)

Declaration of Beneficial Interest * See Note No. 1 on reverse side

I certify that at the time the work was performed, the claims covered in this work report were recorded in the current holder's name or held under a beneficial interest in the current recorded holder.	Date	Recorded Holder or Agent (Signature)
	<i>Sept 21/92</i>	<i>M. Swereda</i>

Declaration of Work Report

I certify that I have a personal knowledge of the facts set forth in this Work report, having performed the work or witnessed same during and/or after completion and annexed report is true.		
Name and Address of Person Certifying <i>P. Lassila, General Delivery, Beardmore, Ontario POT 1M0</i>		
Telephone No. <i>(807) 875-2604</i>	Date <i>Sept 21/92</i>	Certified By (Signature) <i>P Lassila</i>

Office Use Only

Total Value Cr. Recorded <i>7790</i>	Date Recorded <i>Oct 19/92</i>	Mining Recorder <i>M. A. Weirman</i>	Received Stamp <i>SEP 21 1992</i> MINING DIVISION THUNDER BAY RECEIVED
	Deemed Approval Date	Date Approved <i>NOV 20/92</i>	
	Date Notice for Amendments Sent		

work report Number for Applying Reserve	Claim Number (see Note 2)	Number of Claim Units
	TB 1093411	1
	TB 1093412	1
	TB 1093413	1
	TB 1139984	1
	TB 1139985	1
	TB 1139986	1
	TB 1139987	1
Croft Twp	TB 1173047	1
	TB 1173048	1
	TB 1173049	1
	TB 1173050	1
	TB 1139989	1
	TB 1139990	1
	TB 1139992	1
Ashmeir Twp		
	14	

Total Number of Claims

value of Assessment Work Done on this Claim	value Applied to this Claim
46.74 ^{PR}	530
3116	530
	530
	400
	400
	400
	400
	598
	685
	685
	685
	685
	685
	557 ^{PR}
7790	7790

Total Value Work Done

Total Value Work Applied

value Assigned from this Claim	Reserve: Work to be Claimed at a Future Date
4144 ^{PR}	
2586	
6730 ^{PR}	0

Total Assigned From

Total Reserve

Credits you are claiming in this report may be cut back. In order to minimize the adverse effects of such deletions, please indicate from which claims you wish to prioritize the deletion of credits. Please mark (✓) one of the following:

1. Credits are to be cut back starting with the claim listed last, working backwards.
2. Credits are to be cut back equally over all claims contained in this report of work.
3. Credits are to be cut back as prioritized on the attached appendix.

In the event that you have not specified your choice of priority, option one will be implemented.

Note 1: Examples of beneficial interest are unrecorded transfers, option agreements, memorandum of agreements, etc., with respect to the mining claims.

Note 2: If work has been performed on patented or leased land, please complete the following:

I certify that the recorded holder had a beneficial interest in the patented or leased land at the time the work was performed.

Signature

Date

Nov 31 92

To Whom it may Concern;

The information you requested is as follows:

1' International backhoe.
\$65.00 per hour

2' D6 - Bulldozer
\$65.00 per hour

I hope this information is satisfactory. Please find a copy of the assay results enclosed as well. If you require more information, please feel free to contact us.

Thank You

M.F. Swereda.

92 NOV 17 AM 11 30

RECEIVED
LABORER PAY
TRAINING DIVISION

NOTES

of the Corporation of the town of
 this subject to Section 37(b)
 (1970)

AS DRAWN FROM DISPOSITION

S.R. - SURFACE RIGHTS M.R. - MINING RIGHTS

Date	Disposition	File
1970	R & M R	14797
1970	S.R.O.	100204

1619 87 212

McQUESTON TWP. 189

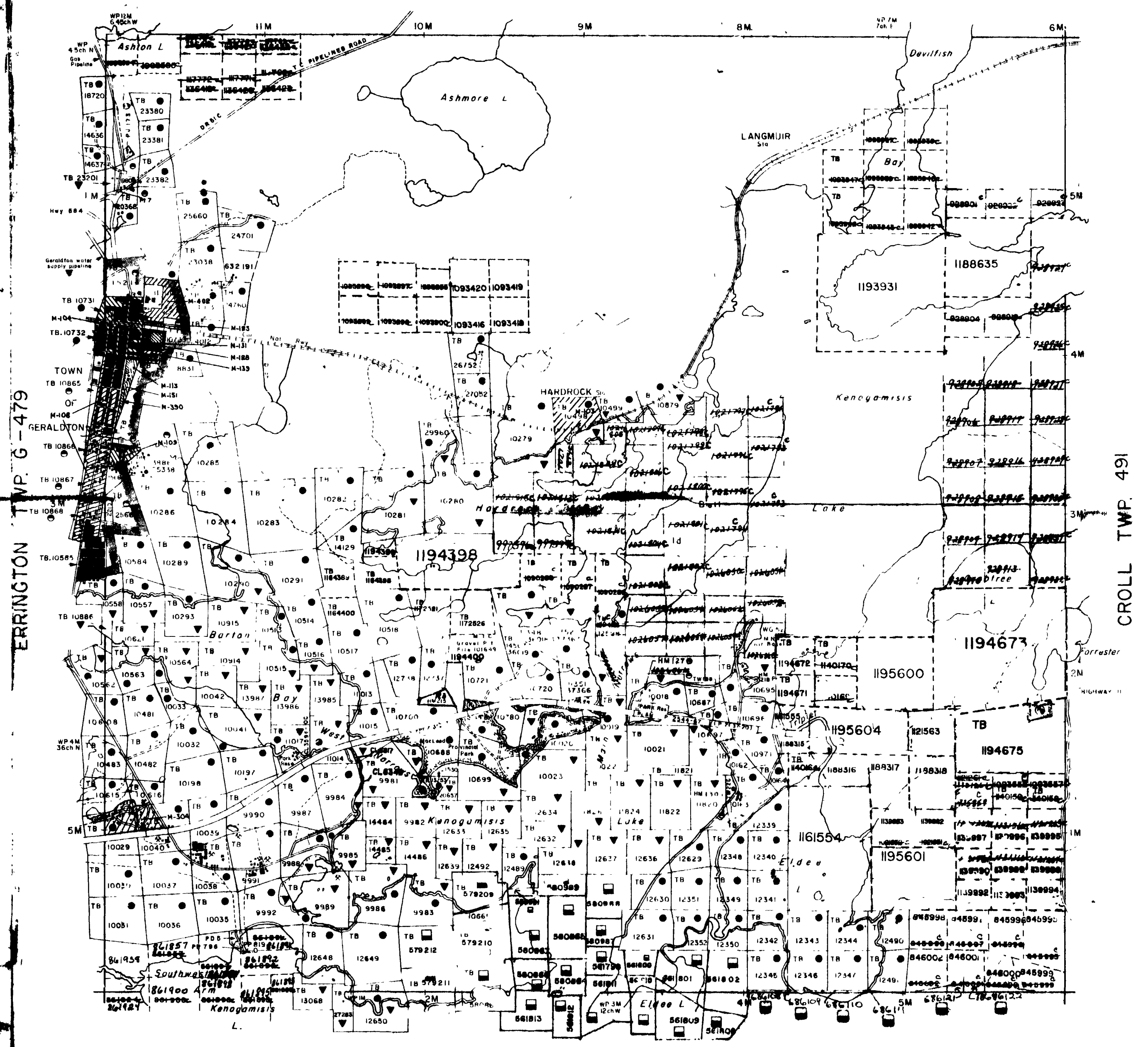

THE INFORMATION THAT APPEARS ON THIS MAP HAS BEEN COMPILED FROM VARIOUS SOURCES, AND ACCURACY IS NOT GUARANTEED. THOSE WISHING TO STAKE MINING CLAIMS SHOULD CONSULT WITH THE MINING RECORDER, MINISTRY OF NORTHERN DEVELOPMENT AND MINES FOR ADDITIONAL INFORMATION ON THE STATUS OF THE LANDS SHOWN HEREON.

LEGEND

- HIGHWAY AND ROUTE
- OTHER ROADS
- TRAILS
- SURVEYED LINES
- TOWNSHIPS, BASE LINES, ETC.
- LOTS, MINING CLAIMS, PARCELS, ETC.
- UNSURVEYED LINES
- LOT LINES
- PARCEL BOUNDARY
- MINING CLAIMS ETC.
- RAILWAY AND RIGHT OF WAY
- UTILITY LINES
- NON PERENNIAL STREAM
- FLOODING OR FLOODING RIGHTS
- SUBDIVISION OR COMPOSITE PLAN
- RESERVATIONS
- ORIGINAL SHORELINE
- MARSH OR MUSKEG
- MINES
- TRAVERSE MONUMENT

DISPOSITION OF CROWN LANDS

TYPE OF DOCUMENT	SYMBOL
PATENT, SURFACE & MINING RIGHTS	●
" SURFACE RIGHTS ONLY	○
" MINING RIGHTS ONLY	◐
LEASE SURFACE & MINING RIGHTS	■
" SURFACE RIGHTS ONLY	◼
" MINING RIGHTS ONLY	◻
LICENCE OF OCCUPATION	▽
ORDER IN COUNCIL	OC
RESERVATION	⊙
CANCELLED	⊘
SAND & GRAVEL	⊙

LAND USE LIMITED FOR COMMERCIAL TOURISM/OUTPOST CAMPS
 NOTE: MINING RIGHTS IN PARCELS PATENTED PRIOR TO MAY 1, 1913, VESTED IN ORIGINAL PATENTEE BY THE PUBLIC LANDS ACT R.S.O. 1970, CHAP. 390, SEC. 63, SUBSEC. 1

SCALE - 1 INCH = 40 CHAINS

TOWNSHIP **63.6093**

ASHMORE

M.N.R. ADMINISTRATIVE DISTRICT

GERALDTON

MINING DIVISION

THUNDER BAY

LAND TITLES / REGISTRY DIVISION

THUNDER BAY

Ontario Ministry of Natural Resources Land Management Branch

Date *January 24, 1986*

SEPTEMBER 1981

Number **G-472**



NOTES

AREAS WITHDRAWN FROM DISPOSITION

S.R. - SURFACE RIGHTS M.R. - MINING RIGHTS

Registration	Order No.	Date	Disposition	File
(R1) Sec. 36/80	W 53/88	28/11/83	S.R.	188.516
McLEOD LAKE LAND ROLL				
R2 EQUIPMENT STORAGE	W-TB-31/91	NOV/91	S.R.O	CROLL LAND ROLL

SAND AND GRAVEL

- (G1) M.T.C Gravel Pit N° 1568
- (G2) " " " " 4A-51

THE INFORMATION THAT APPEARS ON THIS MAP HAS BEEN COMPILED FROM VARIOUS SOURCES, AND ACCURACY IS NOT GUARANTEED. THOSE WISHING TO STAKE MINING CLAIMS SHOULD CONSULT WITH THE MINING RECORDER, MINISTRY OF NORTHERN DEVELOPMENT AND MINES, FOR ADDITIONAL INFORMATION ON THE STATUS OF THE LANDS SHOWN HEREON

ALFRED LAKE G-189 LONGLAC & OAKES TWP, G-307

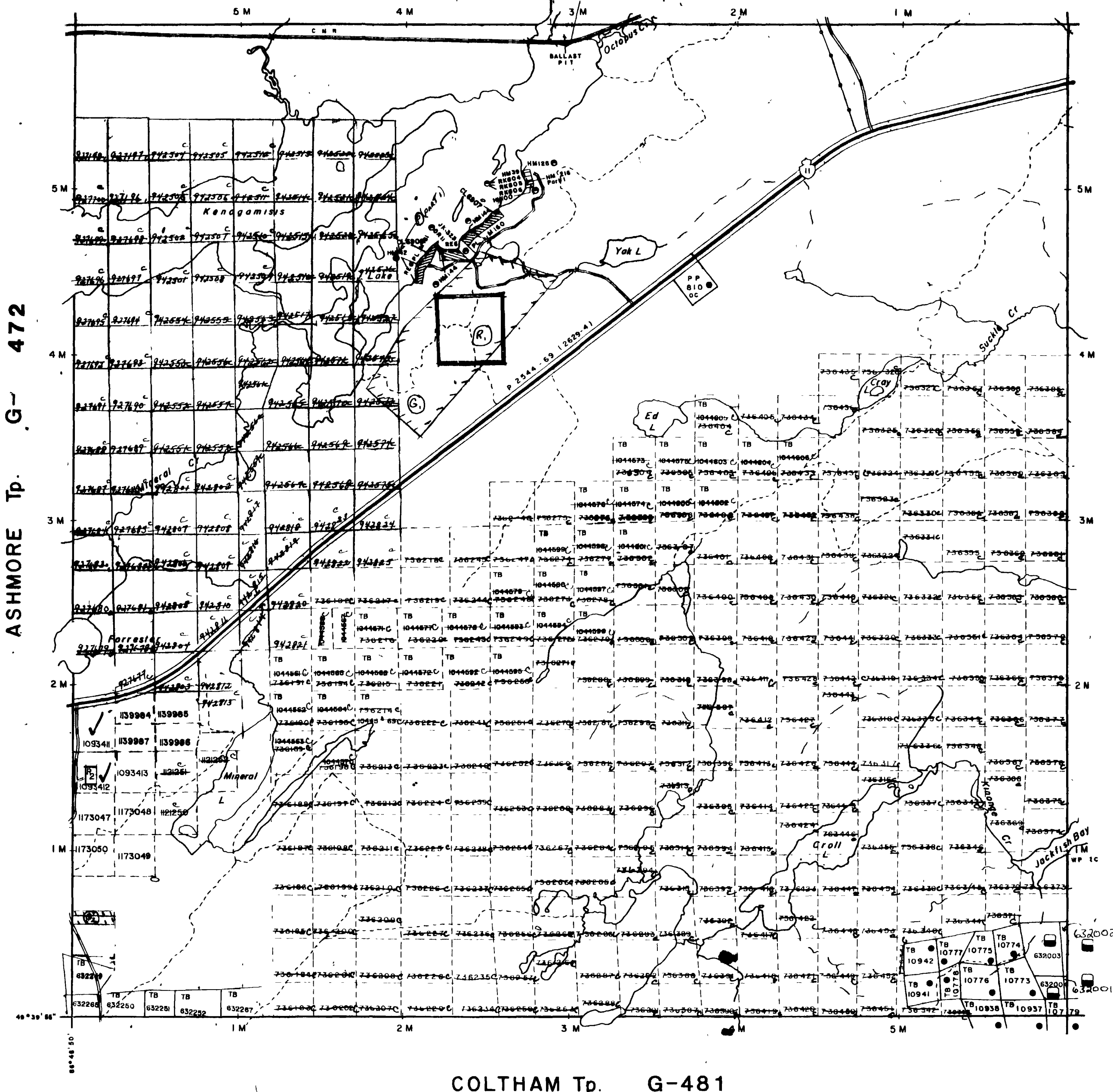

ASHMORE Tp. G-472

ABREY G-321

COLTHAM Tp. G-481

LEGEND

- HIGHWAY AND ROUTE No.
- OTHER ROADS
- TRAILS
- SURVEYED LINES:
 - TOWNSHIPS, BASE LINES, ETC.
 - LOTS, MINING CLAIMS, PARCELS, ETC.
- UNSURVEYED LINES
 - LOT LINES
 - PARCEL BOUNDARY
 - MINING CLAIMS ETC
- RAILWAY AND RIGHT OF WAY
- UTILITY LINES
- NON-PERENNIAL STREAM
- FLOODING OR FLOODING RIGHTS
- SUBDIVISION
- ORIGINAL SHORELINE
- MARSH OR MUSKEG
- MINES
- TRAVERSE MONUMENT

DISPOSITION OF CROWN LANDS

TYPE OF DOCUMENT	SYMBOL
PATENT, SURFACE & MINING RIGHTS	
" SURFACE RIGHTS ONLY	
" MINING RIGHTS ONLY	
LEASE, SURFACE & MINING RIGHTS	
" SURFACE RIGHTS ONLY	
" MINING RIGHTS ONLY	
LICENCE OF OCCUPATION	
CROWN LAND SALE	
ORDER-IN-COUNCIL	
RESERVATION	
CANCELLED	
SAND & GRAVEL	
LAND USE PERMITS FOR COMMERCIAL TOURISM OUTPOST CAMPS	

NOTE: MINING RIGHTS IN PARCELS PATENTED PRIOR TO FEBRUARY 1, 1913, VESTED IN ORIGINAL PATENTEE BY THE PUBLIC LANDS ACT, R.S.O. 1970, CHAP. 280, SEC. 61, SUBSEC. 11.

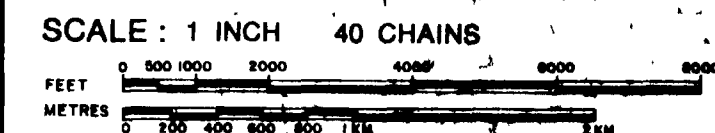

TOWNSHIP **63.6092**
CROLL
 M.N.R. ADMINISTRATIVE DISTRICT
GERALDTON
 MINING DIVISION
THUNDER BAY
 LAND TITLES / REGISTRY DIVISION
THUNDER BAY



Date **OCTOBER, 1985** Number **G-491**
 AUGUST 6, 1985

