

DIAMC



42E10NW0104 13 CROLL

010

TOWNSHIP: CROLL TWP

REPORT NO: 13

WORK PERFORMED FOR: MELVIN SWEREDA

RECORDED HOLDER: SAME AS ABOVE

: OTHER

| <u>CLAIM NO.</u> | <u>HOLE NO.</u> | <u>FOOTAGE</u> | <u>DATE</u> | <u>NOTE</u> |
|------------------|-----------------|----------------|-------------|-------------|
| 1093411          | S-92-1          | 291 FT         | JUNE 25 92  | (1)         |

NOTES: (1) W9240 000156

FILED NOVEMBER 20TH 1992

# Drill Log

OPAP #  
0992-457

Page # 1

Drill Hole: 5-92-1

Location: #1 Zone; TB 1093411  
0100 W, 0160 S

Collar 100' N  
and 200' E  
of #8 post  
TB 1093411

Attitude: -70°, Az. 330°

Date Collected: June 8, 1992

Date Finished: June 25, 1992

Date Logged: July 16, 1992

Logged By: P Lassila

Core Size: BQ Length: 291 ft.

*P Lassila*

| Footage    | Description  |
|------------|--|
| 0' to 05'  | Overburden   |
| 05' to 63' | Andesite Flow; massive, fine grain, locally<br>amgdaloidal with 1mm to 3mm white felds,<br>amgdules; nonmagnetic noncalcareous sections<br>34.5' 1 1/2 in clat, massive po (60%) py (40%)<br>Quartz veins.<br>16.2' 1 in, qv 55° to core axis<br>28.2' 3 in qv ... <u>Sample 5560</u><br>38.7' 4 in, qv 40° to core axis } <u>Sample 5561</u><br>42.8' 3 in, qv 80° to core axis }<br>Trace po, mo?<br>38.7' to 48.0' pyritic zone 28 to 38<br>fine to 3mm blobs dissem. py<br>Section contains several narrow 1/4 in. to 3/4 in.<br>qtz. veins at 45° to 80° to core axis |

63.0' to 64.5' Fragmented mafic volcanic with sericitic fracture filling.

64.5' to 66.6' Sericitic quartz veined zone. Well foliated at 60° to 80° to core axis. 20% sericite, 15% qtz to 2 in thick, 15% chloritic mafic volc, Trace py.

64.5' to 66.4' sample 5562

66.6' to 72.00' Altered mafic volcanic; foliated 60° to 70° to core axis, weakly to moderately sericitic, biotitic, moderately calcareous, many fine qtz-calc seams to  $\frac{1}{8}$ " thick mainly parallel to foliation, 1% to 3% fine grain bright pyrite as dissem. crystals elongated along foliation.

67.6' to 68.9' sample 5563

69.7' to 71.0' sample 5564

72' to 85' Andesitic volcanic; exhibits lacy mottled network of weakly saussuritized feldspar infilling. Locally up to 1% fine dissem py.

85' to 126' Andesitic volc. pseudobreccia; fine grained mafic subground fragments of mafic volcanic up to 3 inches in saussuritic feldspathic volcanic matrix, Well developed brecciation between 103 ft, and 106 ft. Occasional thin (less than  $\frac{1}{4}$  in.) qtz-calc seams.

126' to 135' Foliated mafic volcanic; biotitic-chloritic - weakly sericitic fine grained; moderately calcareous, foliation 25° to 30° to core axis, 129' to 130' 30% mottled calc infilling.

135' to 242' Altered andesitic flow rock; locally brecciated, exhibits mosaic textured feldspathic, weakly saussuritized alteration. Contains occasional thin qtz and qtz-calc veinlets to 2 in. thick and many thin (less than 1 in.) seams oriented at 45° to 90° to core axis.

Occasional clots, up to 1/2 in. long, of po and very minor cpy in some parts of section.

142' to 143' qtz vein subparallel to core axis; Sample # 5565

222.0' to 225.0' 2% to 3% po (minor cpy) as clots to 1/2 in long  
Sample # 5566

242' to 291'

Massive unaltered andesite,

Qtz. veins with reddish hematitic contact rims

245.5' 1 in. qv at 70° to core axis

245.7' 1 1/2 in qv at 50° to core axis

274.5' white qv 2" thick (no hematite) at 70° to core axis

291'

End Hole

Core at Mel Swereda's  
Comp at Geraldton, Ontario

DRILL CORE SECTION  
 DDH S-92-1  
 TB 1093411, Croll Twp  
 No 1 ZONE  
 July 21, 1992 By: P. Lossib

*P. Lossib*

Note: Present andesitic composition probably was basalt before pervasive alteration occurred.

1 in. = 20 ft.

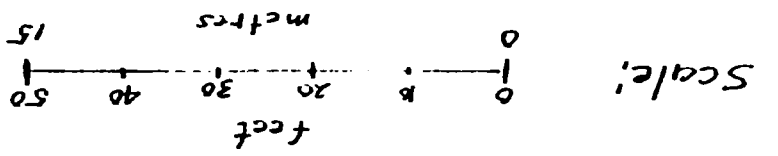

Looking West

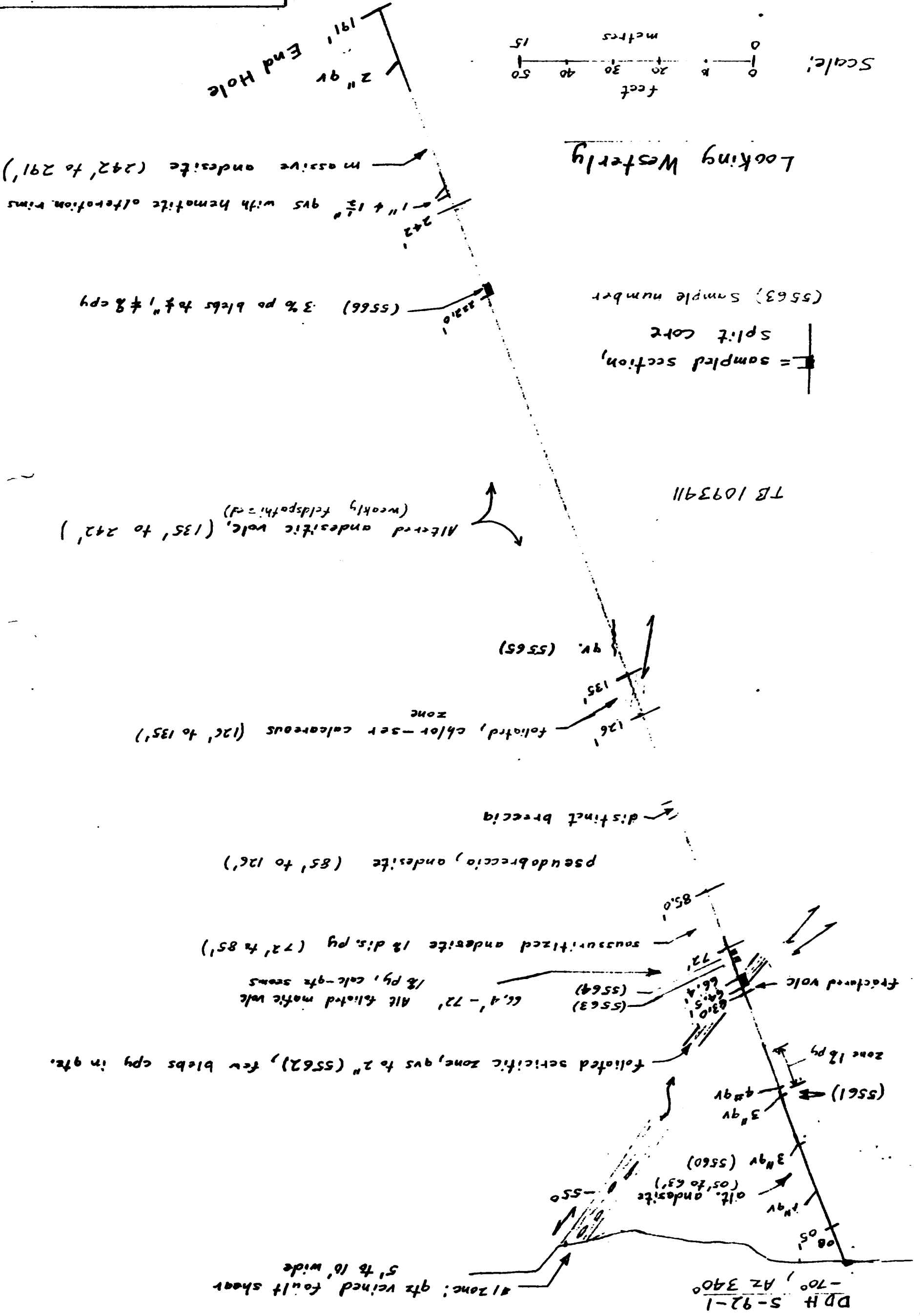

TB 1093411

DDH S-92-1  
 AZ 340  
 -70°



Ontario

240 156 Mining Act

Information collected on this form is obtained under the authority of the Mining Act. For more information should be directed to the Provincial Manager, Mining Lands, Ministry of Northern Development and Mines, Fourth Floor, 150 Cedar Street, Sudbury, Ontario, P3E 6A5 telephone (705) 670-7284.

Instructions: Please type or print and submit in duplicate. Refer to the Mining Act and Regulations for requirements of filing assessment work or consult the Mining Recorder. A separate copy of this form must be completed for each Work Group. Technical reports and maps must accompany this form in duplicate. A sketch, showing the claims the work is assigned to, must accompany this form.

Recorded Holder: Mel Sveredg Client No. 199458
Address: PO Box 936, Geraldton Ont, POT 1M0 Telephone No. (807) 850 0535
Mining Division: Thunder Bay Township/Area: Croll Twp Ont M or G Plan No.
Date Work Performed: From June 8 1992 To June 25, 1992 (Drilling)

Work Performed (Check One Work Group Only) Core Logged on July 16/1992
Table with columns: Work Group, Type
- Geotechnical Survey
- Physical Work, including Drilling: Drilling 297 ft
- Rehabilitation
- Other Authorized Work: Loggal and sampled drill core
- Assays
- Assignment from Reserve

Total Assessment Work Claimed on the Attached Statement of Costs \$ 6119.00

Note: The Minister may reject for assessment work credit all or part of the assessment work submitted if the recorded holder cannot verify expenditures claimed in the statement of costs within 30 days of a request for verification.

Persons and Survey Company Who Performed the Work (Give Name and Address of Author of Report)
Table with columns: Name, Address
- Mel Sveredg (Drilling) PO Box 936, Geraldton, Ont, POT 1M0
- P Lassila (Logged core) General Delivery Beardmore Ont, POT 1M0

attach a schedule if necessary)
Certification of Beneficial Interest \* See Note No. 1 on reverse side
I certify that at the time the work was performed, the claims covered in this work report were recorded in the current holder's name or held under a beneficial interest by the current recorded holder.
Date: July 23, 1992
Recorded Holder or Agent (Signature): P Lassila

Certification of Work Report
I certify that I have a personal knowledge of the facts set forth in this Work report, having performed the work or witnessed same during and/or after its completion and annexed report is true.
Name and Address of Person Certifying: P Lassila, General Delivery, Beardmore, Ont, POT 1G0
Telephone No. (807) 875-2604 Date: July 23/93 Certified By (Signature): P Lassila

For Office Use Only
Total Value Cr. Recorded: 6119
Date Recorded: July 24/92
Mining Recorder: M.A. Weisman
Date Approved: Aug. 11/92
Received Stamp

RECEIVED
RECORDS DIVISION
JUL 24 PM 3:08



**Statement of Costs  
for Assessment Credit**

**État des coûts aux fins  
du crédit d'évaluation**

**Mining Act/Loi sur les mines**

Transaction No./N° de transaction

Personal information collected on this form is obtained under the authority of the Mining Act. This information will be used to maintain a record and ongoing status of the mining claim(s). Questions about this collection should be directed to the Provincial Manager, Mining Lands, Ministry of Northern Development and Mines, 4th Floor, 159 Cedar Street, Sudbury, Ontario P3E 6A5, telephone (705) 670-7284.

Les renseignements personnels contenus dans la présente formule sont recueillis en vertu de la Loi sur les mines et serviront à tenir à jour un registre des concessions minières. Adresser toute question sur la collecte de ces renseignements au chef provincial des terrains miniers, ministère du Développement du Nord et des Mines, 159, rue Cedar, 4<sup>e</sup> étage, Sudbury (Ontario) P3E 6A5, téléphone (705) 670-7284.

**1. Direct Costs/Coûts directs**

| Type  | Description                                     | Amount<br>Montant | Totals<br>Total global |
|---|---|-------------------|------------------------|
| Wages<br>Salaires   | Labour<br>Main-d'oeuvre                         |                   |                        |
|   | Field Supervision<br>Supervision sur le terrain |                   |                        |
| Contractor's<br>and Consultant's<br>Fees<br>Droits de<br>l'entrepreneur<br>et de l'expert-<br>conseil | Type<br>Logging & Sampling<br>core<br>By Lesila | 200               |                        |
|   | Drilling with<br>own drill                      | 5820              | 6020                   |
| Supplies Used<br>Fournitures<br>utilisées   | Value at \$20/ft<br>= 291 x 20                  |                   |                        |
|   |   |                   |                        |
| Equipment<br>Rental<br>Location de<br>matériel  | Type  |                   |                        |
|   |   |                   |                        |
| <b>Total Direct Costs<br/>Total des coûts directs</b>   |   |                   | <b>6020</b>            |

**2. Indirect Costs/Coûts indirects**

\*\* Note: When claiming Rehabilitation work Indirect costs are not allowable as assessment work.  
Pour le remboursement des travaux de réhabilitation, les coûts indirects ne sont pas admissibles en tant que travaux d'évaluation.

| Type  | Description        | Amount<br>Montant | Totals<br>Total global |
|---|--------------------|-------------------|------------------------|
| Transportation<br>Transport   | Type<br>Truck      |                   |                        |
|   | 330km at<br>30¢/km | 99.00             |                        |
|   |                    |                   | 99.00                  |
| Food and<br>Lodging<br>Nourriture et<br>hébergement   |                    |                   |                        |
| Mobilization and<br>Demobilization<br>Mobilisation et<br>démobilisation   |                    |                   |                        |
| <b>Sub Total of Indirect Costs<br/>Total partiel des coûts indirects</b>  |                    |                   | <b>99.00</b>           |
| <b>Amount Allowable (not greater than 20% of Direct Costs)<br/>Montant admissible (n'excedant pas 20 % des coûts directs)</b> |                    |                   | <b>6020.00</b>         |
| <b>Total Value of Assessment Credit<br/>(Total of Direct and Allowable<br/>Indirect costs)</b>                                |                    |                   | <b>6119.00</b>         |
| <b>Value totale du crédit<br/>d'évaluation<br/>(Total des coûts directs<br/>et indirects admissibles)</b>                     |                    |                   |                        |

Note: The recorded holder will be required to verify expenditures claimed in this statement of costs within 30 days of a request for verification. If verification is not made, the Minister may reject for assessment work all or part of the assessment work submitted.

Note : Le titulaire enregistré sera tenu de vérifier les dépenses demandées dans le présent état des coûts dans les 30 jours suivant une demande à cet effet. Si la vérification n'est pas effectuée, le ministre peut rejeter tout ou une partie des travaux d'évaluation présentés.

**Filing Discounts**

- Work filed within two years of completion is claimed at 100% of the above Total Value of Assessment Credit.
- Work filed three, four or five years after completion is claimed at 50% of the above Total Value of Assessment Credit. See calculations below:

|                                  |                          |
|----------------------------------|--------------------------|
| Total Value of Assessment Credit | Total Assessment Claimed |
|                                  | x 0.50 =                 |

**Remises pour dépôt**

- Les travaux déposés dans les deux ans suivant leur achèvement sont remboursés à 100 % de la valeur totale susmentionnée du crédit d'évaluation.
- Les travaux déposés trois, quatre ou cinq ans après leur achèvement sont remboursés à 50 % de la valeur totale du crédit d'évaluation susmentionné. Voir les calculs ci-dessous.

|                                      |                            |
|--------------------------------------|----------------------------|
| Valeur totale du crédit d'évaluation | Évaluation totale demandée |
|                                      | x 0,50 =                   |

**Certification Verifying Statement of Costs**

I hereby certify:  
that the amounts shown are as accurate as possible and these costs were incurred while conducting assessment work on the lands shown in the accompanying Report of Work form.

I am authorized as Consulting Geologist (Recorded Holder, Agent, Position in Company) I am authorized

to make this certification

**Attestation de l'état des coûts**

J'atteste par la présente :  
que les montants indiqués sont le plus exact possible et que ces dépenses ont été engagées pour effectuer les travaux d'évaluation sur les terrains indiqués dans la formule de rapport de travail ci-joint.

Et qu'à titre de \_\_\_\_\_ je suis autorisé (titulaire enregistré, représentant, poste occupé dans la compagnie)

à faire cette attestation.

Signature P. Lesila Date July 23/92

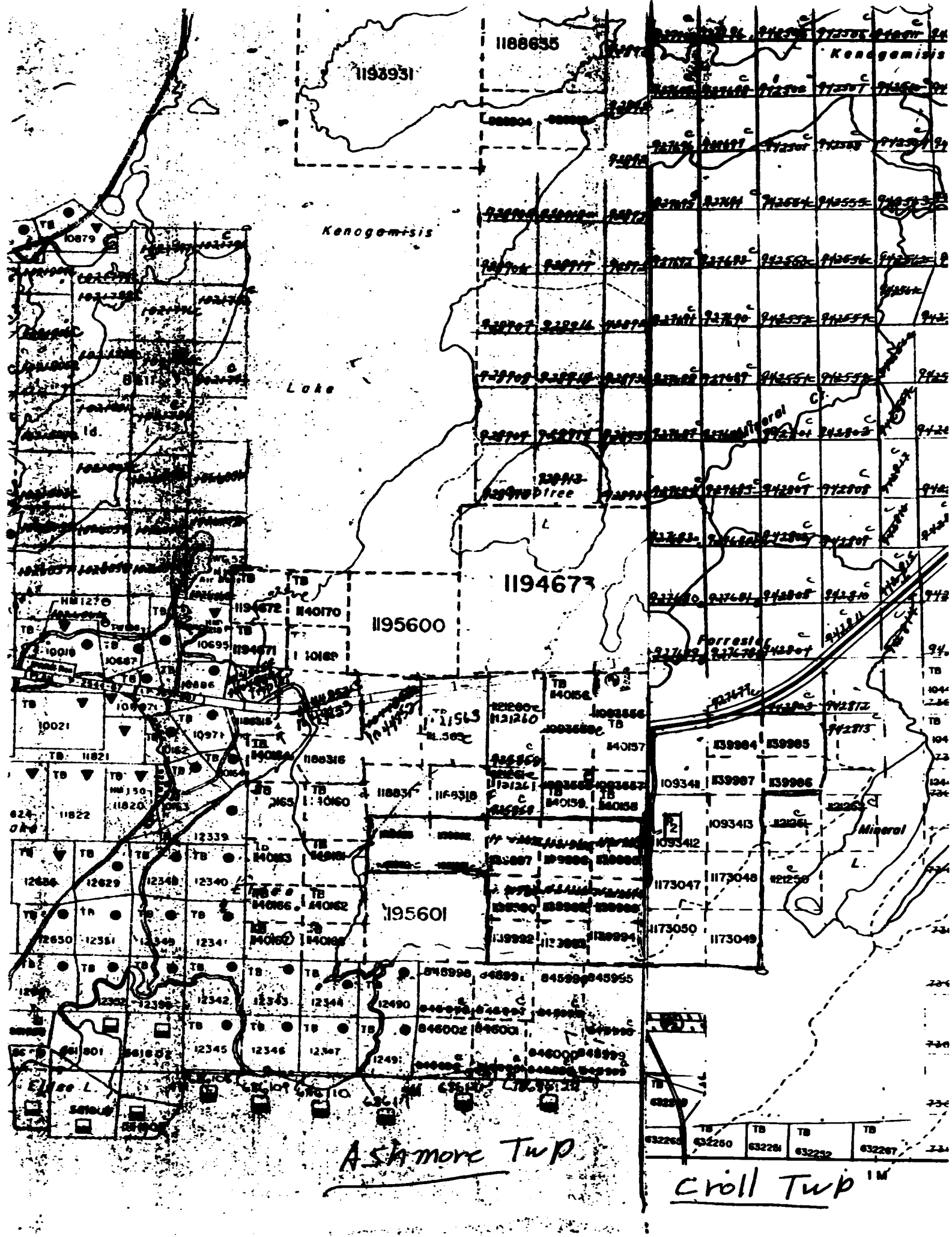



NOTES

AREAS WITHDRAWN FROM DISPOSITION

S.R. - SURFACE RIGHTS M.R. - MINING RIGHTS

| Description           | Order No.  | Date     | Disposition | File            |
|-----------------------|------------|----------|-------------|-----------------|
| (R) Sec. 34/80        | W 33/83    | 28/11/83 | S.R.        | 188316          |
| McLEOD LAKE LAND ROLL |            |          |             |                 |
| R2 EQUIPMENT STORAGE  | W-TB-31/91 | NOV19/91 | S.R.O.      | CROLL LAND ROLL |

SAND AND GRAVEL

|      |                          |
|------|--------------------------|
| (G1) | M.T.C Gravel Pt. N° 156B |
| (G2) | " " " " 4A-51            |

THE INFORMATION THAT APPEARS ON THIS MAP HAS BEEN COMPILED FROM VARIOUS SOURCES, AND ACCURACY IS NOT GUARANTEED. THOSE WISHING TO STAKE MINING CLAIMS SHOULD CONSULT WITH THE MINING RECORDER, MINISTRY OF NORTHERN DEVELOPMENT AND MINES, FOR ADDITIONAL INFORMATION ON THE STATUS OF THE LANDS SHOWN HEREON

ASHMORE Tp. G-472

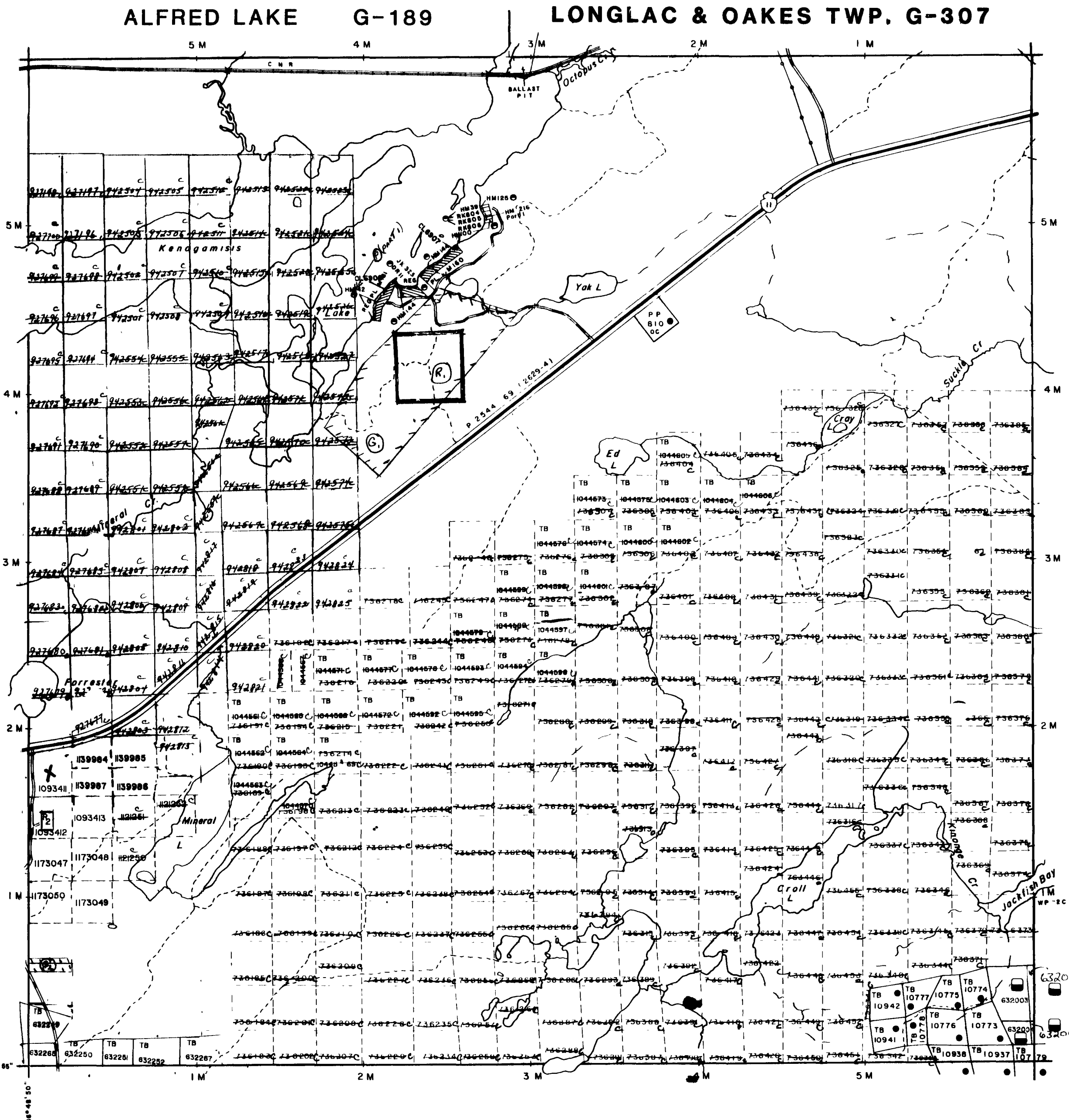

COLTHAM Tp. G-481

LEGEND

|                                   |  |
|-----------------------------------|--|
| HIGHWAY AND ROUTE No              |  |
| OTHER ROADS                       |  |
| TRAILS                            |  |
| SURVEYED LINES                    |  |
| TOWNSHIPS, BASE LINES, ETC        |  |
| LOTS, MINING CLAIMS, PARCELS, ETC |  |
| UNSURVEYED LINES                  |  |
| LOT LINES                         |  |
| PARCEL BOUNDARY                   |  |
| MINING CLAIMS ETC                 |  |
| RAILWAY AND RIGHT OF WAY          |  |
| UTILITY LINES                     |  |
| NON-PERENNIAL STREAM              |  |
| FLOODING OR FLOODING RIGHTS       |  |
| SUBDIVISION                       |  |
| ORIGINAL SHORELINE                |  |
| MARSH OR MUSKEG                   |  |
| MINES                             |  |
| TRAVERSE MONUMENT                 |  |

DISPOSITION OF CROWN LANDS

| TYPE OF DOCUMENT                                      | SYMBOL |
|---|--------|
| PATENT, SURFACE & MINING RIGHTS                       |        |
| " SURFACE RIGHTS ONLY                                 |        |
| " MINING RIGHTS ONLY                                  |        |
| LEASE, SURFACE & MINING RIGHTS                        |        |
| " SURFACE RIGHTS ONLY                                 |        |
| " MINING RIGHTS ONLY                                  |        |
| LICENCE OF OCCUPATION                                 |        |
| CROWN LAND SALE                                       |        |
| ORDER-IN-COUNCIL                                      |        |
| RESERVATION   |        |
| CANCELLED   |        |
| SAND & GRAVEL   |        |
| LAND USE PERMITS FOR COMMERCIAL TOURISM OUTPOST CAMPS |        |

NOTE: MINING RIGHTS IN PARCELS PATENTED PRIOR TO MAY 8, 1913, VESTED IN ORIGINAL PATENTEE BY THE PUBLIC LANDS ACT, R.S.O. 1970, CHAP 380, SEC 63, SUBSEC 1

SCALE: 1 INCH = 40 CHAINS



TOWNSHIP  
**CROLL**  
M.N.R. ADMINISTRATIVE DISTRICT  
**GERALDTON**  
MINING DIVISION  
**THUNDER BAY**  
LAND TITLES / REGISTRY DIVISION  
**THUNDER BAY**

Ministry of Natural Resources  
Ontario  
Land Management Branch

Date OCTOBER, 1981

Number  
**G-491**

AUGUST 6, 1985



42E10N0104 13 CROLL

N

200

**NOTES**

... of the ... of ...  
 ... show the ... of ...  
 ... within the ... of ...  
 ... of the Mining ...  
 ... 34

AREAS WITHDRAWN FROM DISPOSITION

S.R. - SURFACE RIGHTS M.R. - MINING RIGHTS

Description U-4# No Date Disposition File

W50/73 5/1/73 S.R. & M.R. 9474

Sec 42 of Min Act S.R.O. 160/04

W19 87 3 C S.R.O. see ...

**McQUESTON TWP. 189**

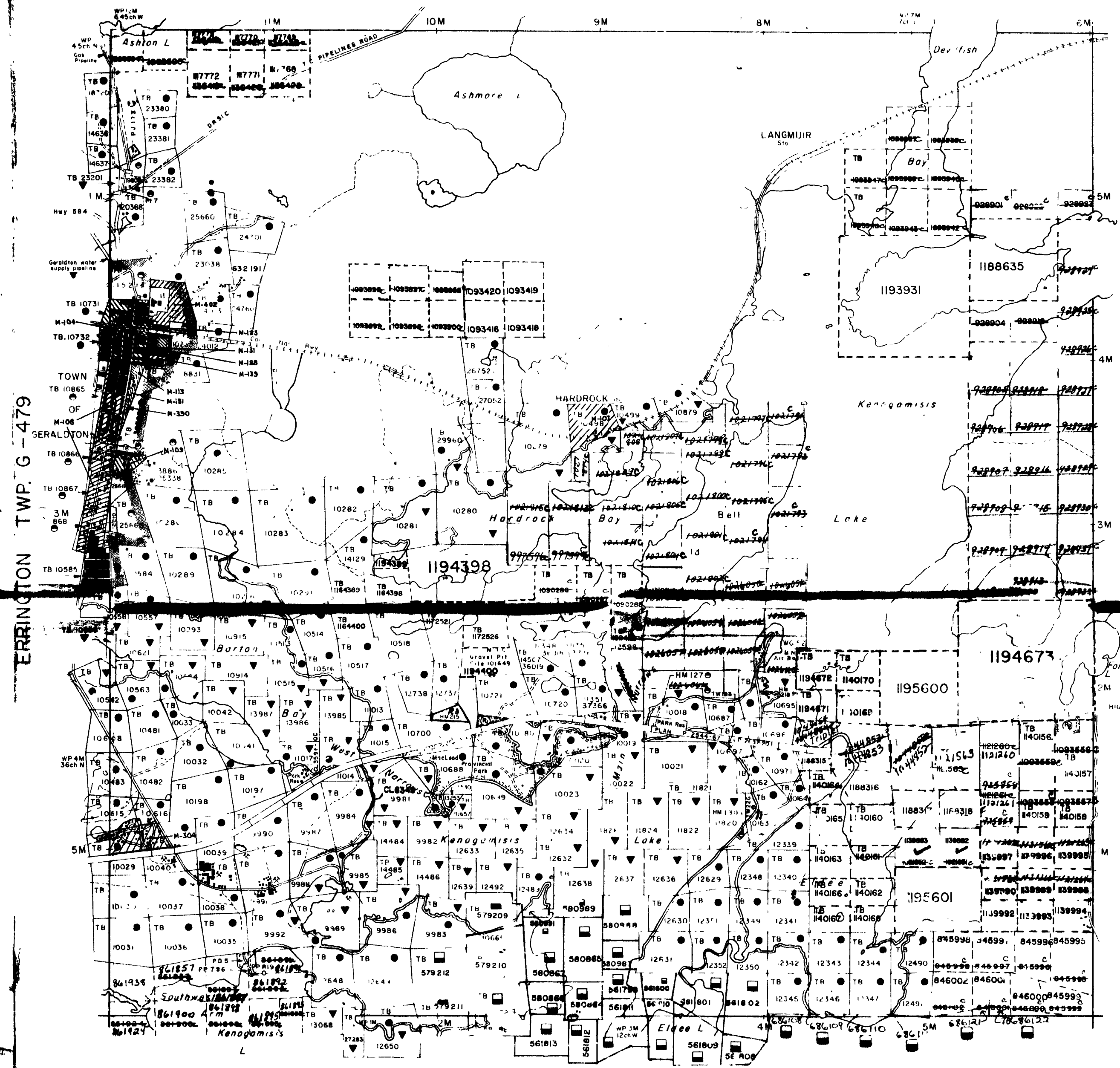

**LEGEND**

- ROAD
- OTHER ROAD
- TRAILS
- SURVEYED LINES
  - TOWNSHIP, RANGE LINES ETC
  - LOTS, MINING CLAIMS PAPERS ETC
- UNSURVEYED LINES
  - LOT LINES
  - PARCEL BOUNDARY
  - MINING CLAIMS ETC
- RAILWAY AND RIGHT OF WAY
- UTILITY LINES
- NON PERENNIAL STREAM
- FLOODING OR FLOODING RIGHTS
- SUBDIVISION OR COMPOSITE PLAN
- RESERVATIONS
- ORIGINAL SHORFLINE
- MARSH OR MUSKEG
- MINES
- TRAVERSE MONUMENT

**DISPOSITION OF CROWN LANDS**

- | TYPE OF DOCUMENT                | SYMBOL |
|---------------------------------|--------|
| PATENT, SURFACE & MINING RIGHTS | ●      |
| " SURFACE RIGHTS ONLY           | ○      |
| " MINING RIGHTS ONLY            | ◐      |
| LEASE SURFACE & MINING RIGHTS   | ■      |
| " SURFACE RIGHTS ONLY           | □      |
| " MINING RIGHTS ONLY            | ◻      |
| LICENCE OF OCCUPATION           | ▽      |
| ORDER IN COUNCIL                | OC     |
| RESERVATION                     | ⊙      |
| CANCELLED                       | ⊗      |
| SAND & GRAVEL                   | ⊕      |
- LAND USE PERMITS FOR COMMERCIAL TOURISM/OUTPOST CAMPS  
 NOTE MINING RIGHTS IN PARCELS PATENTED PRIOR TO MAY 1 1913, VESTED IN ORIGINAL PATENTEE BY THE PUBLIC LANDS ACT R.S.O. 1970 C.I.P. 380 SEC 63 SUBSEC 1

THE INFORMATION THAT APPEARS ON THIS MAP HAS BEEN COMPILED FROM VARIOUS SOURCES, AND ACCURACY IS NOT GUARANTEED THOSE WISHING TO STAKE MINING CLAIMS SHOULD CONSULT WITH THE MINING RECORDER, MINISTRY OF NORTHERN DEVELOPMENT AND MINES, FOR ADDITIONAL INFORMATION ON THE STATUS OF THE LANDS SHOWN HEREON

TOWNSHIP  
**ASHMORE**  
 M.N.R. ADMINISTRATIVE DISTRICT  
**GERALDTON**  
 MINING DIVISION  
**THUNDER BAY**  
 LAND TITLES / REGISTRY DIVISION  
**THUNDER BAY**

Ministry of Natural Resources  
 Land Management Branch  
 Ontario

Date *January 24, 1986*  
**SEPTEMBER 1981** Number  
**G-472**