

42E10NW0150 13 ASHMORE

010

Diamond Drilling

Township of ASHMORE

Report No: 13

Work performed by: Bidlamaque Gold Mines

Claim No	Hole No	Footage	Date	Note
TB 100195	NBW-1	140.0'	July/62	
	NBW-2	198.0'	July/62	
	NBW-3	50.7'	July/62	
	NBW-4	53.0'	July/62	
	NBW-5	56.5'	July/62	
	NBW-6	210.8'	July/62	
	NBW-7	158.0'	July/62	
	NBW-8	108.0'	July/62	
	NBW-9	235.0'	July/62	

Notes:

FINAL REPORT
ON
DIAMOND DRILLING
WODIAN OPTION
ASHMORE TOWNSHIP
FOR
NEW BIDLAMAQUE GOLD MINES LIMITED

FINAL REPORT
ON
DIAMOND DRILLING
WODIAN OPTION
ASHMORE TOWNSHIP
FOR
NEW BIDLAMAQUE GOLD MINES LIMITED

Summary

An exploratory drill programme of nine holes totalling 1,247 feet was carried out in two areas on claim TB100195. The work under the main trench located two zones of copper mineralization in porphyries. The values were only one-quarter of one percent. The work on the second area under a magnetic anomaly located a zone in two drill holes with a maximum drill hole width 1.7 feet of 1.78% copper. This zone was located in two additional holes but they lacked width and interesting values.

No further work is recommended in connection with this area of copper mineralization.

PINAL REPORT
ON
DIAMOND DRILLING
WODIAN OPTION
ASHMORE TOWNSHIP
FOR
NEW BIDLAMAQUE GOLD MINES LIMITED

I Introduction

Surface trenching and stripping was carried out by John Wodian on this group of twenty claims in Ashmore and Croll Townships. This work was in two pits, on claim TB100195, just 300 feet south of Highway 11.

Surface sampling in May of 1962 by H. Parliment produced channel samples along the strike that contained interesting values in copper and one narrow sample had an appreciable gold assay.

New Bidlamaque optioned a group of twenty claims, shown on the accompanying claim sketch and in mid-June started a programme to survey and drill the area surrounding the showing.

II Access

The showing is accessible from a point 1,000 feet along the highway west of the gravel pit at the south end of Forrester Lake. A tractor road leads from Highway 11, 300 feet south to the pits.

III General Geology

The rocks in the area of the drilling are diorite, feldspar porphyry and quartz - feldspar porphyry. These rocks form an intrusive series of narrow vertical dipping dykes striking approximately N30°E. This series is cut by a narrow north - south striking quartz diabase dyke.

IV Chalcopyrite - Pyrrhotite Mineralization

Three of these bands of feldspar porphyry appear to be altered and bleached and portions of them are replaced in part by chalcopyrite and pyrrhotite mineralization.

V Magnetic Survey

A small picket line grid 700 feet by 500 feet was cut around the pit showing and a magnetic survey was run over this portion of the property (see map 1 inch = 40 feet). The magnetic survey outlined the diabase and two of the zones where the copper sulphide mineralization occurs.

VI Diamond Drilling Programme

Five holes were drilled under the showing in the main pit. This drilling located two copper mineralized zones and the widths varied from 2 to 10 feet but the best assay was in hole 2; 0.18% Cu. over 5.0 feet.

The last four holes were drilled on the second magnetic anomaly centered at 1 + 30S, line 1 + 00W. All four holes located the zone of alteration and mineralization but only holes 6 and 7 located some copper mineralization. Hole 6 intersected 1.1 feet of 1.00% Cu. and hole 7 under six intersected 1.7 feet of 1.78% Cu.

Following this hole 8 was drilled 71 feet to the west and located the altered porphyry and sulphide but without significant values or widths.

Next, hole 9 was drilled under holes 6 and 7 and the copper values and widths were discouraging.

VII Conclusions and Recommendations

The copper zone in holes 6 and 7 did not have sufficient width nor vertical depth to warrant any further attention.

The copper zones under the main pit were too low in values and discontinuous to warrant further exploration. The gold assays associated with a 0.8 foot quartz - calcite vein on surface were located in drilling but gave only trace assays.

No further work is recommended in connection with this area of copper mineralization.

None of the information obtained concerning the Roche - LongLac workings in the southwest portion of the claim group indicated that any exploration for gold should be carried out in this area.

Respectfully submitted,

SCOPE MINING AND EXPLORATION CONSULTANTS
LIMITED

Tom Gledhill

Tom Gledhill, B.A., P. Eng.

Toronto, Ontario

August 15, 1962.

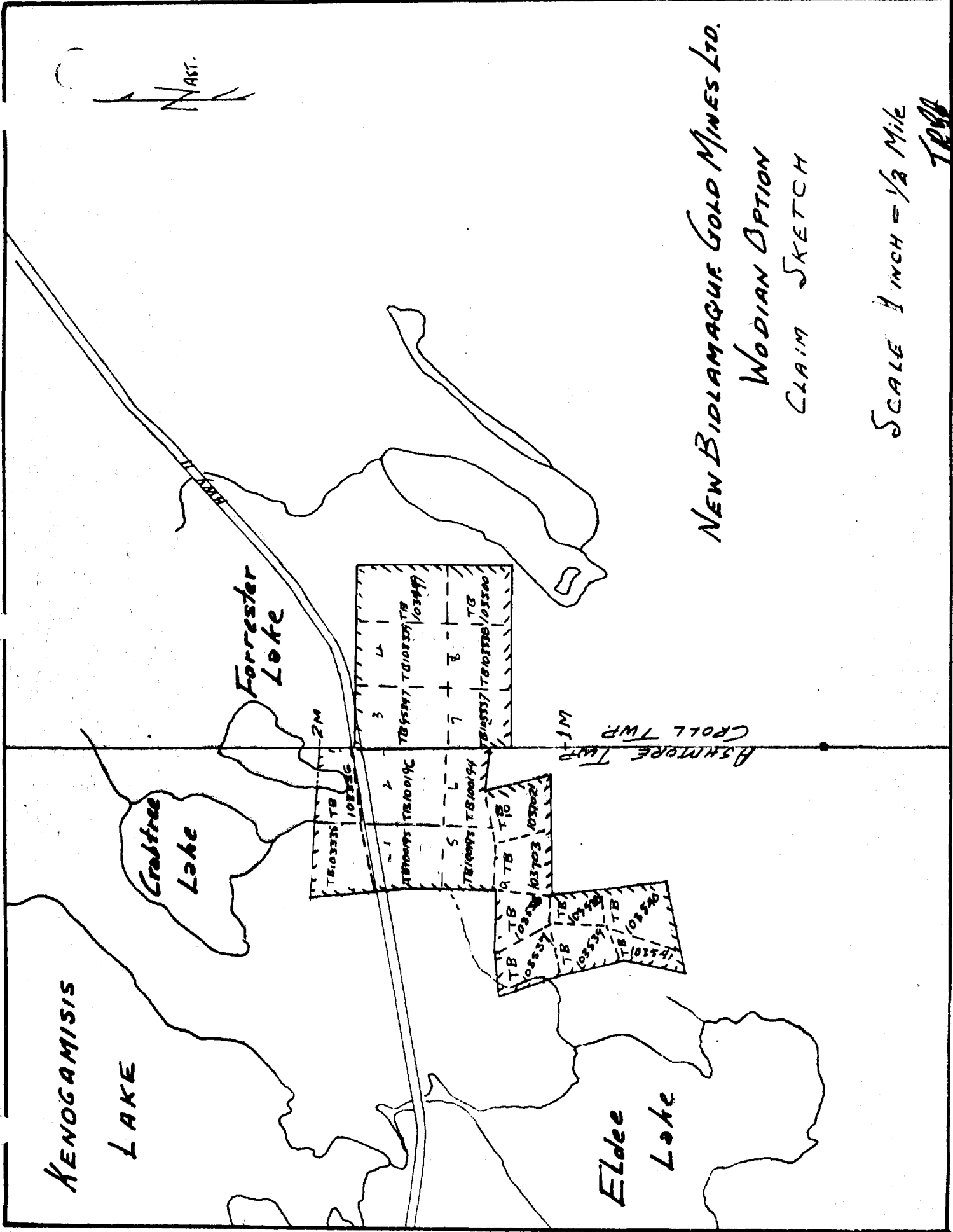

NEW BIDLAMAGUE GOLD MINES LTD.

WODIAN OPTION

CLAIM SKETCH

SCALE 1 INCH = 1/2 MILE

T.B.

1	2	3	4
TB 10335	TB 10349	TB 10357	TB 10365
5	6	7	8
TB 10373	TB 10381	TB 10389	TB 10397

ASHMORE TWP
CROLL TWP



KENOGAMIS LAKE

Crabtree Lake

Forrester Lake

Eldee Lake

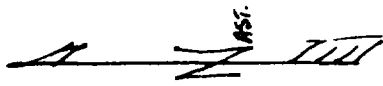

KING'S HIGHWAY 31

POST 1

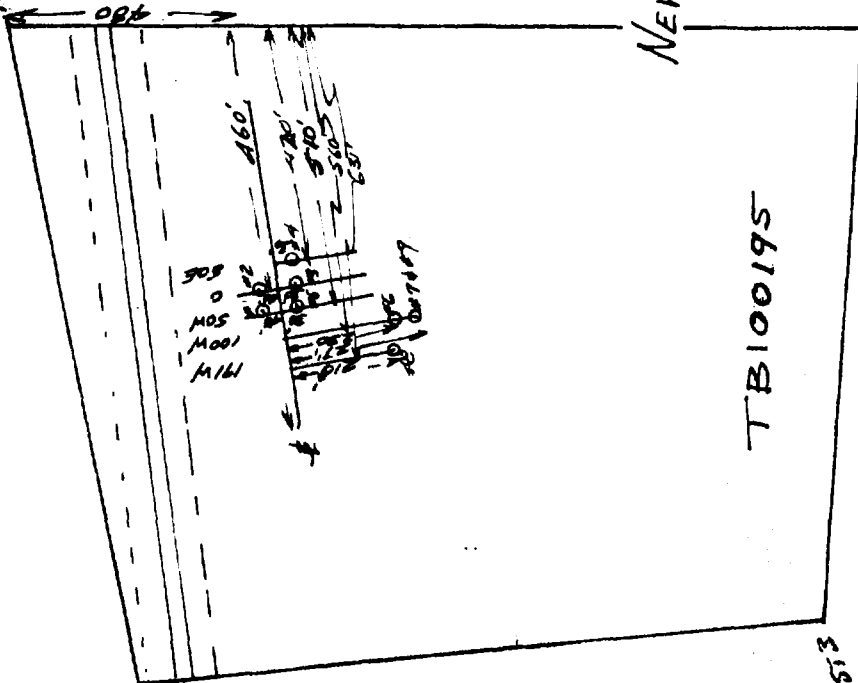

PLAN OF DRILL HOLES

NEW BIDLAMARQUE GOLD MINES LTD.

WOBIAN OPTION

ASHMORE TOWNSHIP

DISTRICT OF THUNDER BAY
POST 2

SCALE 1 inch = 400 feet

SCOPE AUG/62

TRG

SCOPE MINING & EXPLORATION CONSULTANTS
LIMITED

Property New Edinburg Gold Mines Limited
Median Option

Hole No. NBW-1

Latitude 0 + 20N

Bearing 117° Grid

Page 1

Departure 0 + 40W

Dip - 45° SE

Location TB103335 TB 100195

Length 140.0

Core Size AIT

Elevation + 6.0 ft.

Started July 10/62

Completed July 12/62

FROM	TO	FORMATION	SAMPLE NO.	LENGTH FT.	% Cu.	Au oz./ton			
0	5.0	<u>Overburden</u>							
5.0	140.0	<u>Diorite Porphyry</u>							
16.0	16.2	<u>Quartz Vein</u>							
22.0	25.0	<u>Quartz - Carbonate Vein</u>							
31.0	32.5	<u>Quartz - Carbonate Vein</u>							
59.0	61.0	<u>Quartz - Carbonate Vein</u>							
63.0	63.6	<u>Quartz Vein</u>							
67.0	68.5	<u>Calcite Vein</u>							
138.4	138.6	<u>Quartz Vein</u>							
16.0	16.5	<u>Quartz Vein - pyrrhotite, chalcopyrite</u>	W-1	0.5	0.65	N11			
22.0	25.0	<u>Quartz - Carbonate Vein</u>	W-2	3.0		N11			
25.0	27.0	<u>Diorite Porphyry - minor pyrite and pyrrhotite</u>	W-3	2.0		N11			
27.8	28.3	<u>Quartz Vein - pyrrhotite and chalcopyrite</u>	W-4	0.5		N11			
29.0	30.5	<u>Diorite Porphyry - minor pyrrhotite and chalcopyrite</u>	W-5	1.5	0.05	N11			
31.0	32.5	<u>Quartz - Carbonate Vein</u>	W-6	1.5		N11			
38.0	41.0	<u>Diorite Porphyry - minor pyrrhotite</u>	W-7	3.0		N11			
							% CORE RECOVERY		

Drilled by Cameron Drilling Company Limited

Logged by Tom Gledhill

SCOPE MINING & EXPLORATION CONSULTANTS
LIMITED

Property New Bidloquoque Gold Mines Limited

Hole No. NDW-1

Latitude 0 + 20N

Bearing 117° Grid

Page - 2 -

Departure 0 + 40W

Dip -45° SE

Location TB103335 TB 100195

Length 140.0' Core Size AT

Elevation +6.0 ft.

Started July 10/62 Completed July 12/62

FROM	TO	FORMATION	SAMPLE NO.	LENGTH FT.	% Cu	Au. gm / ton	
42.2	45.2	<u>Diorite Porphyry, 2% sulphides pyrrhotite and chalcopyrite</u>	W-8	3.0	0.13	Nil	
47.0	52.0	<u>Diorite Porphyry, minor quartz carbonate, 1% sulphides, pyrrhotite and chalcopyrite</u>	W-9	5.0		Nil	
55.0	58.2	<u>Diorite Porphyry, 1% pyrrhotite and chalcopyrite</u>	W-10	3.2		Nil	
59.0	61.0	<u>Quartz Carbonate Vein, 1% pyrrhotite and chalcopyrite</u>	W-11	2.0	0.31	Tr.	
63.0	63.6	<u>Quartz Vein, 1% sulphides, pyrrhotite and chalcopyrite</u>	W-12	0.6		Nil	
67.0	68.5	<u>Calcite Vein</u>	W-13	1.5		Nil	
83.0	88.0	<u>Diorite Porphyry, 1% sulphides pyrrhotite and chalcopyrite</u>	W-14	5.0		Nil	
89.2	91.2	<u>Sheared Diorite Porphyry, 1% sulphides, pyrrhotite and chalcopyrite</u>	W-15	2.0	0.23	Nil	
103.0	105.0	<u>Sheared Diorite, 45° to core axis</u>	W-16	2.0		Nil	
118.0	118.5	<u>Diorite Porphyry, 5% sulphides pyrrhotite and chalcopyrite</u>	W-17	0.5		Nil	
122.0	122.7	<u>Diorite Porphyry, 2% pyrrhotite</u>	W-18	0.7		Nil	
126.0	129.0	<u>Sheared Diorite Porphyry less than 1% pyrrhotite</u>	W-19	3.0		Nil	
138.0	139.0	<u>Quartz Vein 0.2 feet wide, 5% pyrrhotite</u>	W-20	1.0		Nil	
140.0		<u>- END OF HOLE -</u>					% CORE RECOVERY

Drilled by _____

Logged by Tom Gladhill

SECTION
ALONG 117°

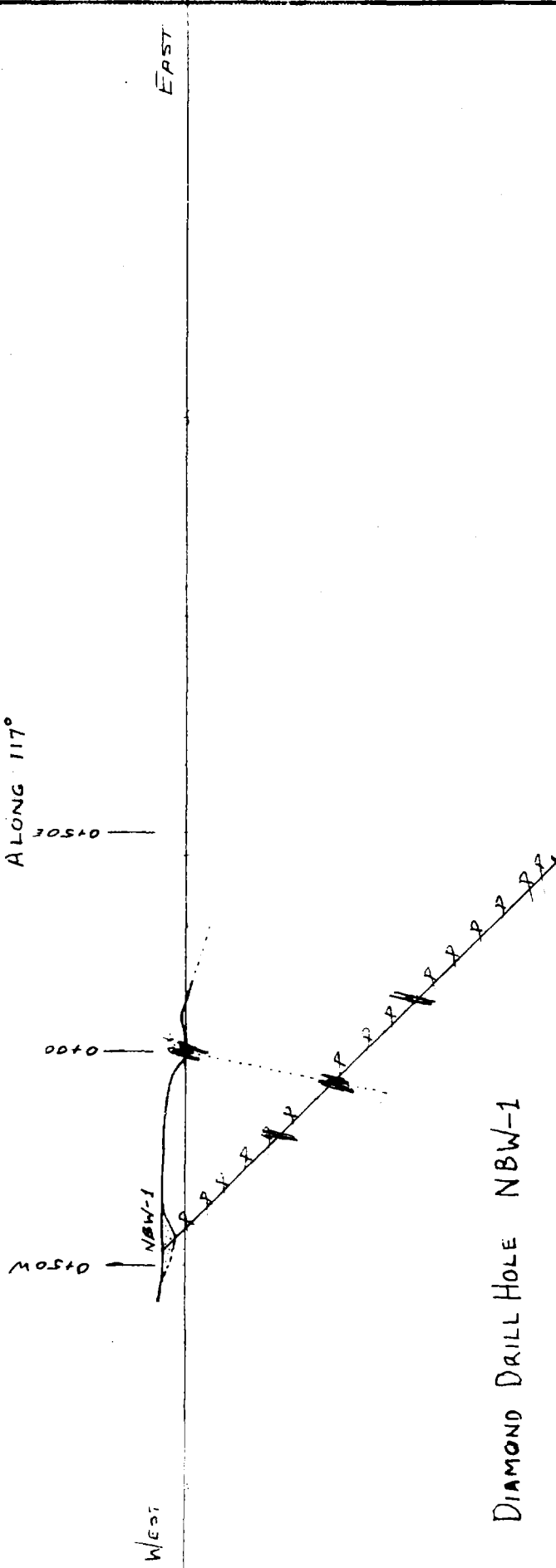

DIAMOND DRILL HOLE NBW-1

NEW BIDLAMAQUE GOLD MINES LIMITED

NODIAN OPTION
ASHMORE TOWNSHIP
DISTRICT OF THUNDER BAY
ONTARIO

GEOLOGICAL LEGEND

- V V Diorite, Quartz Diorite
- P P Diorite Porphyry
- 0 0 0 Feldspar Porphyry
- 0 X 0
Y 0 X Quartz-Feldspar Porphyry
- Sulphide Zone
- QV Quartz Vein

SCALE 1 INCH = 40 feet

SCOPE AUG/62

[Handwritten signature]

SCOPE MINING & EXPLORATION CONSULTANTS
LIMITED

Property New Bidiasaque Gold Mines Limited
Wodian Option

Hole No. NBW-2

Latitude 0 + 40N

Bearing Grid South

Page 1

Departure 0 + 10E

Dip -45° S

Location TB100195

Length 198.0 ft.

Core Size AXT

Elevation +9.0 ft.

Started July 13/62

Completed July 14/62

FROM	TO	FORMATION	SAMPLE NO.	LENGTH FT.	% Cu	AN OR/ ton
0	5.0	Casing				
5.0	27.0	<u>Diorite Porphyry</u>				
27.0	37.0	<u>Quartz Diorite</u>				
37.0	47.0	<u>Diorite Porphyry</u>				
41.0	42.0	<u>Fine Grained Diorite, 1% sulphides in band of 0.2' pyrrhotite and chalcopyrite</u>	W-21	1.0		Nil
42.0	44.0	<u>Diorite Porphyry, 1% pyrrhotite and chalcopyrite</u>	W-22	2.0	0.15	Nil
44.0	47.0	<u>Diorite Porphyry, 1% sulphides pyrrhotite and chalcopyrite</u>	W-23	3.0	0.17	Nil
47.0	62.0	<u>Quartz Diorite</u>				
62.0	77.0	<u>Diorite Porphyry</u>				
77.0	79.5	<u>Quartz Vein, high chlorite</u>	W-24	2.5		Nil
79.5	161.5	<u>Diorite Porphyry</u>				
112.0	113.0	<u>0.2 wide vein of sulphides At 112.5 pyrrhotite and chalcopyrite</u>	W-25	1.0		Nil
114.8	115.8	<u>Sheared diorite porphyry minor pyrrhotite</u>	W-26	1.0		Nil
119.0	120.0	<u>Sheared Diorite Porphyry 0.05' band of sulphide</u>	W-27	1.0		Nil
137.0	140.5	<u>Sheared Diorite Porphyry minor pyrrhotite</u>	W-28	3.5		Nil
						% CORE RECOVERY

Drilled by _____

Logged by Tom Elshult

SCOPE MINING & EXPLORATION CONSULTANTS
LIMITED

Property New Bidlamague Gold Mines Limited

Hole No. NDV-2

Latitude 0 + 40N

Bearing Grid South

Page 2

Departure 0 + 126

Dip -45° S

Location TB 103935 TB100195

Length 198.0 ft.

Core Size AKT

Elevation + 9.0 ft.

Started July 13/62

Completed July 14/62

FROM	TO	FORMATION	SAMPLE NO.	LENGTH FT.	% Cu	Au CS / Ton			
157.5	158.5	<u>Quartz Vain with chlorite</u> <u>0.2 wide</u>	<u>W-29</u>	<u>1.0</u>		<u>Nil</u>			
161.5	170.5	<u>Diorite, fine grained</u>							
170.5	198.0	<u>Diorite Porphyry</u>							
177.0	178.5	<u>Diorite Porphyry, minor sul-</u> <u>phide</u>	<u>W-30</u>	<u>1.5</u>		<u>Nil</u>			
196.6	197.6	<u>Band of Sulphides 0.1' wide</u> <u>pyrrhotite and chalcopyrite</u>	<u>W-31</u>	<u>1.0</u>		<u>Nil</u>			
174.5	175.5	<u>Quartz Vain in sheared</u> <u>diorite porphyry</u>	<u>W-32</u>	<u>1.0</u>		<u>Nil</u>			
		<u>- End of Hole - 198.0 feet</u>							
							% CORE RECOVERY		

Canadian Drilling Company Limited

Form NDV-2

Drilled by _____

Logged by Tom Eldhill

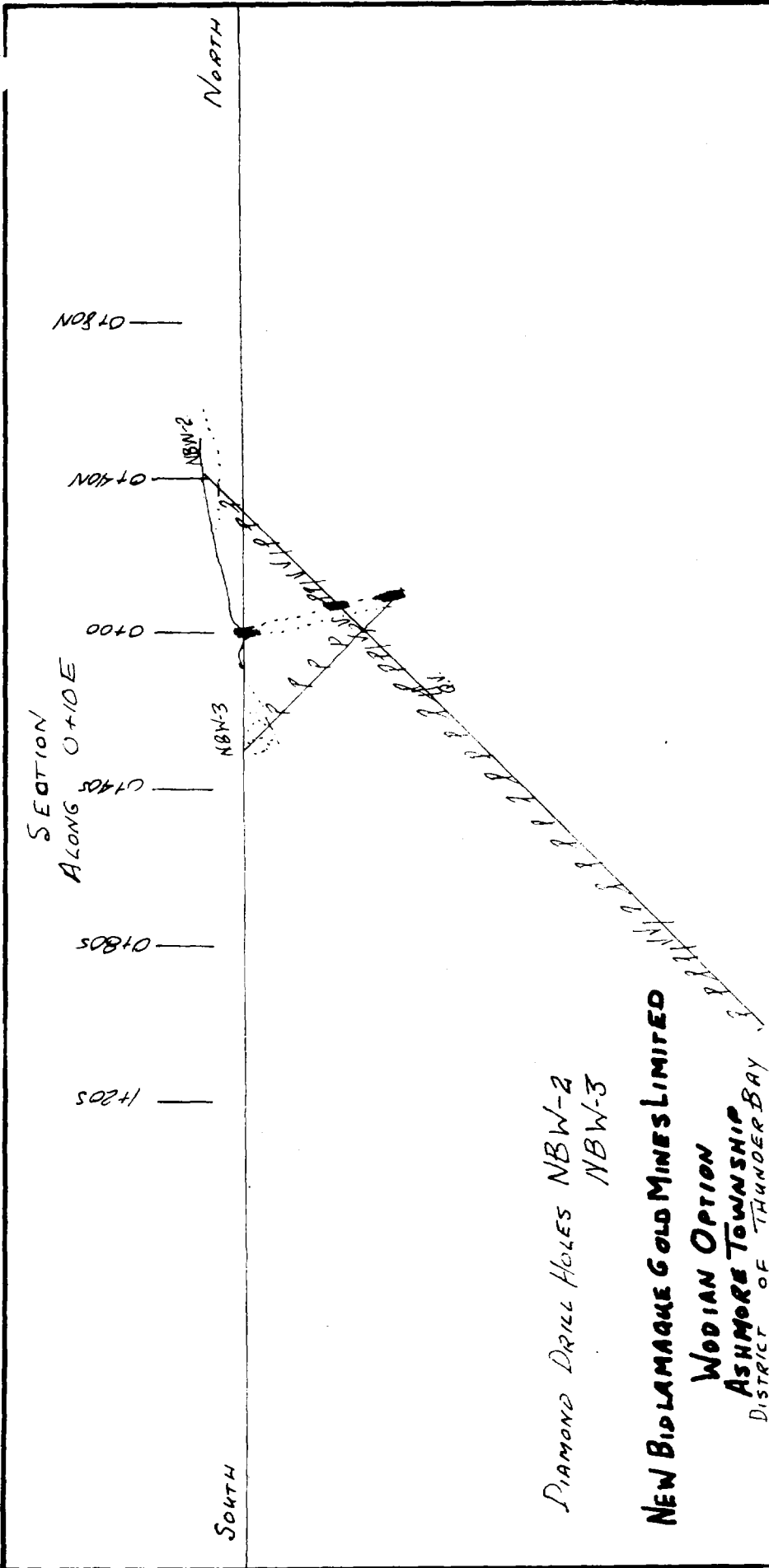

DIAMOND DRILL HOLES NBW-2
NBW-3

NEW BIDLAMAQUE GOLD MINES LIMITED

WOODIAN OPTION
ASHMORE TOWNSHIP
DISTRICT OF THUNDER BAY
ONTARIO

GEOLOGICAL LEGEND

- V V DIORITE, QUARTZ DIORITE
- X P DIORITE PORPHYRY
- OOO FELDSPAR PORPHYRY
- Q F O QUARTZ-FELDSPAR PORPHYRY
- [Shaded Box] SULPHIDE ZONE
- [Horizontal Line Box] QUARTZ VEIN

SCALE 1 INCH = 40 FEET

SCOPE AUG/62

TAE

SCOPE MINING & EXPLORATION CONSULTANTS
LIMITED

Property New Bidlamague Gold Mines Limited
Wodian Option

Hole No. HW-3

Latitude 0 + 30.58

Bearing Grid North

Page 1

Departure 0 + 10E

Dip -45° N

Location 75-103335 TB 100195

Length 50.7 feet

Core Size AXT

Elevation 0.0 ft.

Started July 15/62

Completed July 16/62

FROM	TO	FORMATION	SAMPLE NO.	LENGTH FT.	% Cu	AN OS / ton
0	9.0	<u>Quartz</u>				
9.0	12.5	<u>Feldspar Porphyry - sheared at 45° to core axis.</u>				
12.5	13.4	<u>Quartz Vein - high chlorite content</u>				
13.4	14.3	<u>Sheared Porphyry - chloritic</u>				
14.3	20.9	<u>Feldspar Porphyry - biotite alteration</u>				
20.9	27.7	<u>Quartz Diorite - cut by numerous narrow (2 mm) quartz veins</u>				
27.7	28.3	<u>Feldspar Porphyry</u>				
28.3	45.0	<u>Quartz Diorite cut by numerous narrow (2mm) quartz veins</u>				
45.0	46.2	<u>Quartz - Chlorite Vein</u>				
46.2	50.7	<u>Feldspar Porphyry - minor sulphides, less than 1% pyrrhotite and chalcopyrite</u>				
50.7	51.2	<u>Quartz Diorite</u>				
9.9	12.5	<u>Sheared Feldspar Porphyry</u>	W-33	2.6		N11
12.5	13.5	<u>Quartz Vein - chloritic</u>	W-34	1.0		N11
21.0	23.0	<u>Quartz Diorite - minor quartz veins</u>	W-35	2.0		N11
24.2	26.2	<u>Quartz Diorite - minor quartz veins</u>	W-36	2.0		N11
						% CORE RECOVERY

Drilled by

Logged by

Tom Shidhill

SCOPE MINING & EXPLORATION CONSULTANTS
LIMITED

Property New Middlesex Gold Mines Limited
Wodian Option

Hole No. NOW-3

Latitude 0 + 30.58 Bearing Grid North Page 2

Departure 0 + 10E Dip 45° N

Location ~~TS 102335~~ TB 100195 Length 50.7 feet Core Size AT

Elevation 0.0 ft. Started July 15/62 Completed July 16/62

FROM	TO	FORMATION	SAMPLE NO.	LENGTH FT.	% Cu	Au/oz /ton	
31.5	33.9	<u>Quartz Diorite - several quartz - carbonate veins</u>	W-37	2.0		Nil	
36.0	37.9	<u>Quartz Diorite, narrow quartz veins</u>	W-38	1.5		Nil	
45.0	47.0	<u>Quartz Chlorite Vein - minor sulphides</u>	W-39	2.0		Nil	
47.0	50.7	<u>Raldenar Porphyry, 1% pyrrhotite and chalcopyrite</u>	W-40	3.7	0.08	Nil	
- End of Hole - 50.7 feet							
							% CORE RECOVERY

Cameron Drilling Company Limited

Tom Gledhill

Drilled by _____

Logged by Tom Gledhill

SCOPE MINING & EXPLORATION CONSULTANTS
LIMITED

Property NEW HIBLAMAQUE GOLD MINES LIMITED
Median Option

Hole No. NEW-4

Latitude 0 + 283

Bearing Grid North

Page 1

Departure 0 + 502

Dip -45° N

Location TS 103335 T1100195

Length 53.0' Core Size AST

Elevation 0.0 Ft.

Started July 16/62 Completed July 17/62

FROM	TO	FORMATION	SAMPLE NO.	LENGTH FT.	% Cu	Au oz/ton
0	16.0	<u>Gneiss</u>				
16.0	27.0	<u>Quartz Porphyry</u>				
27.0	31.0	<u>Sheared Porphyry - chloritized</u>				
28.0	29.0	<u>Quartz Vein</u>				
31.0	51.5	<u>Feldspar Porphyry - numerous small quartz - carbonate veins</u>				
51.5	53.0	<u>Quartz - Chlorite Breccia</u>				
22.0	23.5	<u>Quartz Porphyry - broken core minor sulphides</u>	<u>M-41</u>	<u>1.5</u>		<u>Nil</u>
27.0	31.0	<u>Sheared Porphyry - quartz - chlorite alteration</u>	<u>M-42</u>	<u>4.0</u>		<u>Nil</u>
39.0	40.5	<u>Feldspar Porphyry - minor quartz veins</u>	<u>M-43</u>	<u>1.5</u>		<u>Nil</u>
51.5	53.0	<u>Quartz - Chlorite Breccia</u>	<u>M-44</u>	<u>1.5</u>		<u>Nil</u>
<u>- END OF HOLE - 53.0'</u>						
						<u>% CORE RECOVERY</u>

Cameron Drilling Co. Ltd.

Tom Gledhill

Drilled by

Logged by Tom Gledhill

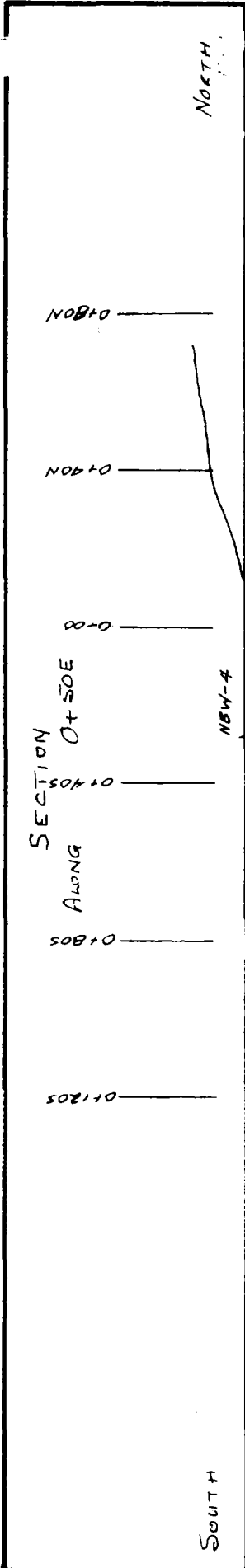



DIAMOND DRILL HOLE NBW-4

NEW BIDLAMAQUE GOLD MINES LIMITED

WODIAN OPTION
ASHMORE TOWNSHIP
 DISTRICT OF THUNDER BAY
 ONTARIO

GEOLOGICAL LEGEND

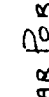
- V V Diorite, Quartz Diorite  Sulphide Zone
- PP Diorite Porphyry  Quartz Vein
- Feldspar Porphyry 
- x○○y Quartz-Feldspar Porphyry 

SCALE 1 INCH = 40 feet

SCOPE Aug/62

TRG.

SCOPE MINING & EXPLORATION CONSULTANTS
LIMITED

Property NEW BIDLAMAQUE GOLD MINES LIMITED
Wodian Option

Hole No. NBM-5

Latitude 0 + 34.53

Bearing Grid North

Page 1

Departure 0 + 504

Dip -45° N

Location TD 103335 TB100195

Length 56.5' Core Size AIT

Elevation 0.0 ft.

Started July 17/62 Completed July 18/62

FROM	TO	FORMATION	SAMPLE NO.	LENGTH FT.	% Cu	Au oz/ton
0	12.0	<u>Casing</u>				
12.0	19.8	<u>Sheared Feldspar Porphyry</u>				
19.8	32.2	<u>Feldspar Porphyry</u>				
32.2	46.5	<u>Quartz Diorite</u>				
39.8	40.2	<u>Quartz Vein</u>				
46.5	56.5	<u>Feldspar Porphyry</u>				
12.0	15.0	<u>Sheared Porphyry</u>	W-45	3.0		N11
15.0	20.0	<u>Sheared Porphyry</u>	W-46	5.0		N11
24.0	25.5	<u>Feldspar Porphyry - minor sulphides</u>	W-47	1.5		N11
35.2	36.5	<u>Quartz Diorite - minor quartz carbonate veins</u>	W-48	1.3		N11
43.7	46.3	<u>Quartz Vein (0-3 ft.) in quartz diorite</u>	W-49	0.6		N11
42.4	43.6	<u>Feldspar Porphyry - several small quartz veins</u>	W-50	1.2		N11
43.6	45.3	<u>Feldspar Porphyry - chlorite and minor sulphides</u>	W-51	1.7		N11
46.5	47.5	<u>Feldspar Porphyry</u>	W-52			
47.5	49.5	<u>Feldspar Porphyry - chloritised</u>	W-53	2.0	0.02	N11
49.5	51.5	<u>Feldspar Porphyry</u>	W-54	2.0	0.02	N11
51.5	53.5	<u>Feldspar Porphyry</u>	W-55	2.0	0.03	N11

% CORE RECOVERY

Cameron Drilling Co. Ltd.

Tom Oledhill

Drilled by

Logged by Tom Oledhill

SCOPE MINING & EXPLORATION CONSULTANTS
LIMITED

Property NEW BIDLARAGUE GOLD MINES LIMITED

Hole No. NEW-5

Latitude 0 + 34.58

Bearing Grid North

Page 2

Departure 0 + 50W

Dip -45°N

Location TB-103335 TB100195

Length 56.5'

Core Size AKT

Elevation 0.0 ft.

Started July 17/62

Completed July 18/62

FROM	TO	FORMATION	SAMPLE NO.	LENGTH FT.	% Cu	Au, OMS. /ton	
53.5	56.5	<u>Felegnar Porphyry</u>	W-56	3.0	0.06	N11	
		- END OF HOLE - 56.5'					
							% CORE RECOVERY

Cameron Drilling Co. Ltd.

Tom Gladhill

Drilled by _____

Logged by Tom Gladhill

SECTION
ALONG LINE 0+50W

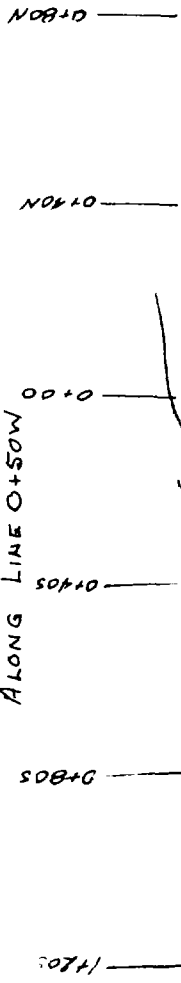

NORTH

SOUTH

DIAMOND DRILL HOLE NBW-5

NEW BIDLAMAQUE GOLD MINES LIMITED

WODIAN OPTION
ASHMORE TOWNSHIP
DISTRICT OF THUNDER BAY
ONTARIO

GEOLOGICAL LEGEND

- V V Diorite, Quartz Diorite
- P P Diorite Porphyry
- O O O Feldspar Porphyry
- O X O X Quartz-Feldspar Porphyry
- ▬ Sulfide Zone
- Quartz Vein

SCALE 1 INCH = 40 FEET

SCOPE AUG/62

TRB.

SCOPE MINING & EXPLORATION CONSULTANTS
LIMITED

Property NEW BIDLANSQUE GOLD MINES LIMITED

Hole No. NBW-6

Latitude 2 + 303

Bearing Grid North

Page 1

Departure 1 + 003

Dip -45°

Location 78 100195

Length 210.8

Core Size AXT

Elevation 0.0 Ft.

Started July 20/62

Completed July 22/62

FROM	TO	FORMATION	SAMPLE NO.	LENGTH FT.				
0	19.0	<u>Basins</u>						
19.0	33.0	<u>Feldspar Porphyry</u>						
33.0	37.0	<u>Sheared Porphyry 45° to core axis, small quartz veins, chloritization.</u>						
37.0	46.0	<u>Feldspar Porphyry. Minor sulphides at 45.2.</u>						
46.0	78.0	<u>Quartz Diorite. 0.1 ft. quartz vein at 47.0</u>						
56.0	57.5	<u>Two quartz - carbonate veins</u>						
72.0	73.5	<u>Quartz vein</u>						
78.0	155.0	<u>Feldspar Porphyry</u>						
90.7	92.2	<u>10% sulphides - chalcopyrite and pyrrhotite</u>						
105.5	106.5	<u>3% sulphides - chalcopyrite and pyrrhotite</u>						
106.0	108.0	<u>Quartz Breccia</u>						
114.7	115.7	<u>Sheared Porphyry - less than 1% sulphides</u>						
141.5	143.5	<u>Minor sulphides in sheared porphyry</u>						
155.0	198.9	<u>Quartz - Feldspar Porphyry</u>						
198.9	207.5	<u>Quartz Diorite</u>						
207.5	222.0	<u>Quartz - Feldspar Porphyry</u>						
								% CORE RECOVERY

Remmond Drilling Co. Ltd.

Tom Gladhill

Drilled by _____

Logged by Tom Gladhill

SCOPE MINING & EXPLORATION CONSULTANTS
LIMITED

Property NEW BIDLAMAQUE GOLD MINES LIMITED

NBW-6

Latitude 2 + 30S Grid North _____ Hole No. 2
 Bearing _____ Page _____
 Departure 1 + 00W Dip -45°
 Location TB 100195 Length 210.8 Core Size AIT
 Elevation 0.0 Ft. Started July 20/62 Completed July 22/62

FROM	TO	FORMATION	SAMPLE NO.	LENGTH FT.	CU.	AN OR/TON	
209.8	210.8	Quartz Vein					
90.5	91.6	Feldspar Porphyry - 10% sulphides. Chalcopyrite and pyrrhotite.	W59	1.1	1.00	N11	
91.6	92.2	Feldspar Porphyry minor sulphides. Chalcopyrite and pyrrhotite	W60	0.6	0.23	N11	
33.0	34.0	Sheared Porphyry - chloritized and talcous.	W61	1.0		N11	
34.0	36.0	Sheared Porphyry - chloritized and talcous.	W62	2.0		N11	
36.0	37.5	Feldspar Porphyry - chloritized and quartz veins.	W63	1.5		N11	
45.0	46.5	Contact Zone - Feldspar Porphyry and quartz diorite. Minor sulphide.	W64	1.5		N11	
46.8	47.3	0.1 ft. quartz veins	W65	0.5		N11	
56.0	57.5	Two small quartz veins in quartz diorite.	W66	1.5		N11	
72.0	73.5	Quartz vein in quartz diorite	W67	1.5		N11	
105.5	106.0	Sheared Porphyry - 3% sulphides pyrrhotite and chalcopyrite.	W68	0.5	0.23	N11	
106.0	108.0	Feldspar Porphyry - quartz veins.	W69	2.0		N11	
							% CORE RECOVERY

Drilled by _____

Logged by Tom Glidhill

SCOPE MINING & EXPLORATION CONSULTANTS
LIMITED

Property NEW BIDLAMAQUE GOLD MINES LIMITED

Hole No. NEW-6

Latitude 2 + 309 Bearing Grid North Page 3

Departure 1 + 00W Dip -45°

Location TR 100195 Length 210.8 Core Size AYT

Elevation 0.0 Ft. Started July 20/62 Completed July 22/62

FROM	TO	FORMATION	SAMPLE NO.	LENGTH FT.	% Cu.	Au. oz/TON	
114.7	115.7	Sheared <u>Ferdyxy</u> - minor sulphides	W70	1.0		N11	
141.5	143.5	Sheared <u>Feldspar Ferdyxy</u> - minor sulphides	W71	2.0	0.03	N11	
207.8	209.8	<u>Feldspar Ferdyxy</u> with quartz veins	W72	2.0		N11	
209.8	210.8	<u>Quartz Vein</u>					
- END OF HOLE - 210.8'							
							% CORE RECOVERY

Drilled by

Logged by Tom Glidhill

SCOPE MINING & EXPLORATION CONSULTANTS
LIMITED

Property NEW BIDLAKQUE GOLD MINES LIMITED
Wodian Option

Hole No. NEW-7

Latitude 2 + 71S Bearing Grid North Page 1
 Departure 1 + 00W Dip -45°
 Location TS 100195 Length 154.0' Core Size AIT
 Elevation 0.0 Ft. Started July 26/62 Completed July 27/62

FROM	TO	FORMATION	SAMPLE NO.	LENGTH FT.				
0	34.0	<u>EMING</u>						
34.0	79.4	<u>Feldspar Porphyry</u>						
79.4	83.3	<u>Sheared Porphyry</u>						
83.3	97.8	<u>Feldspar Porphyry</u>						
97.8	103.2	<u>Quartz Diorite</u>						
103.2	104.0	<u>Feldspar Porphyry</u>						
104.0	130.1	<u>Quartz Diorite - some porphyry inclusions at 104 contact. At 108 minor chalcopyrite - disseminated and fractures. At 133 minor chalcopyrite - disseminated and fractures.</u>						
136.1	145.0	<u>Feldspar Porphyry</u>						
145.0	147.7	<u>Bleached Porphyry</u>						
145.0	145.5	<u>8% sulphides - chalcopyrite and pyrrhotite</u>						
145.5	147.2	<u>15% sulphides - chalcopyrite and pyrrhotite</u>						
147.2	147.7	<u>10% sulphides - chalcopyrite and pyrrhotite</u>						
147.7	156.8	<u>Feldspar Porphyry - minor sulphides. Disseminated blebs.</u>						
156.8	158.7	<u>Bleached Feldspar Porphyry 5% sulphides - chalcopyrite and pyrrhotite.</u>						
								% CORE RECOVERY

Cameron Drilling Company Limited

Tom Blodhill

Drilled by

Logged by Tom Blodhill

SCOPE MINING & EXPLORATION CONSULTANTS
LIMITEDProperty NEW BIDLAMAQUE GOLD MINES LIMITEDHole No. NBW-7Latitude 2 + 713Bearing Grid NorthPage 2Departure 1 + 00VDip -45°Location TB 100195Length 158.0'Core Size AXTElevation 0.0 Ft.Started July 26/62Completed July 27/62

FROM	TO	FORMATION	SAMPLE NO.	LENGTH FT.	% Cu	lbs. Cu / ton		
158.7	152.0	<u>Feldspar Porphyry</u>						
152.0	154.0	<u>Quartz - Feldspar Porphyry</u>						
145.0	145.5	<u>Bleached Feldspar Porphyry</u> 8% sulphides - chalcopyrite and pyrrhotite	W74	0.5	0.87	Tr.		
145.5	147.2	<u>Bleached Feldspar Porphyry</u> 15% sulphides - chalcopyrite and pyrrhotite	W75	1.7	1.76	Tr.		
147.2	147.7	<u>Bleached Feldspar Porphyry</u> 10% sulphides - chalcopyrite and pyrrhotite	W76	0.5	0.43	Tr.		
157.8	158.0	<u>Bleached Feldspar Porphyry</u> 5% sulphides - chalcopyrite and pyrrhotite	W77	1.0	0.88	Tr.		
		- END OF HOLE - 158.0						
							% CORE RECOVERY	

Drilled by

Logged by Tom Eldred

SCOPE MINING & EXPLORATION CONSULTANTS
LIMITED

Property NEW BIDLAWAQUE GOLD MINES LIMITED
Wodian Option

Hole No. NBW-8

Latitude 2 + 123

Bearing Grid North

Page 1

Departure 1 + 71.3W

Dip -45°

Location TB 100195

Length 103.0

Core Size AXT

Elevation 0.0 Ft.

Started July 27/62

Completed July 28/62

FROM	TO	FORMATION	SAMPLE NO.	LENGTH FT.				
0	21.0	<u>Gneiss</u>						
21.0	44.1	<u>Feldspar Porphyry - minor chalcopyrite and pyrrhotite blebs.</u>						
44.1	52.6	<u>Quartz Diorite</u>						
52.6	54.6	<u>Bleached Porphyry - 2% sulphides.</u>						
54.2	55.9	<u>Quartz Diorite</u>						
55.9	62.1	<u>Feldspar Porphyry - many small quartz-carbonate veins</u>						
62.1	62.4	<u>Bleached Porphyry - 1% sulphides.</u>						
62.4	75.0	<u>Feldspar Porphyry Quartz-</u>						
75.0	105.1	<u>Feldspar Porphyry</u>						
105.1	105.8	<u>Bleached Porphyry - 1% sulphide - pyrrhotite and chalcopyrite.</u>						
105.8	108.0	<u>Quartz Feldspar Porphyry</u>						
		<u>-----End of Hole----- 103.0'</u>						
								% CORE RECOVERY

Common Definition No. 1-4

Drilled by _____

Logged by Tom Blidhill

SCOPE MINING & EXPLORATION CONSULTANTS
LIMITEDProperty NEW BIDLAMAQUE GOLD MINES LIMITED
Wodian OptionHole No. NBW-9Latitude 2 + 718 Bearing Grid North Page 1
Departure 1 + 008 Dip - 60°
Location TB 100195 Length 235.0' Core Size AKT
Elevation 0.0 Ft. Started July 30/62 Completed July 31/62

FROM	TO	FORMATION	SAMPLE NO.	LENGTH FT.				
0.0	25.5	<u>Leaning</u>						
25.5	71.0	<u>Feldspar Porphyry</u>						
71.0	85.0	<u>Quartz Diorite</u>						
85.0	100.0	<u>Feldspar Porphyry</u>						
100.0	103.5	<u>Sheared Quartz - Chlorite - minor sulphides</u>						
103.5	112.5	<u>Feldspar Porphyry</u>						
112.5	121.8	<u>Quartz - Feldspar Porphyry</u>						
121.8	126.5	<u>Feldspar Porphyry - minor blebs of chalcopyrite less than 1%</u>						
126.5	148.4	<u>Quartz - Feldspar Porphyry</u>						
148.4	190.5	<u>Quartz Diorite</u>						
190.5	196.3	<u>Feldspar Porphyry - light shearing at 60° to core axis.</u>						
196.3	196.8	<u>Bleached Porphyry</u>						
196.8	212.0	<u>Feldspar Porphyry - minor blebs of chalcopyrite.</u>						
212.0	213.3	<u>Bleached Feldspar Porphyry 0.05 Quartz Vein at 214.0 minor chalcopyrite.</u>						
230.8	232.3	<u>Bleached Feldspar Porphyry</u>						
232.3	235.0	<u>Feldspar Porphyry</u>						
								% CORE RECOVERY

Cameron Drilling Co. Ltd.

Tom Gladhill

Drilled by _____

Logged by Tom Gladhill

Drill Core Log

SCOPE MINING & EXPLORATION CONSULTANTS
LIMITED

Property NEW BIDLAMAQUE GOLD MINES LIMITED
Wodian Option

Hole No. NEW-9

Latitude 2 + 713 Bearing Grid North Page 2

Departure 1 + 00W Dip -60°

Location TB 100195 Length 235.0' Core Size AIT

Elevation 0.0 Ft. Started July 30/62 Completed July 31/62

FROM	TO	FORMATION	SAMPLE NO.	LENGTH FT.	% Cu	AU GR./ton	
100.0	103.5	<u>Sheared Quartz - Chlorite - minor sulphides</u>	W-79	3.5		Tr.	
127.9	128.9	<u>Feldspar - Quartz Feldspar</u>	W-80	1.0	0.28	Tr.	
230.0	231.0	<u>Feldspar Porphyry - minor pyrrhotite and chalcopyrite blebs.</u>	W-81	1.0		Tr.	
233.0	235.0	<u>Feldspar Porphyry, 2% pyrrhotite</u>	W-82	2.0		Tr.	
- END OF HOLE - 235.0'							
							% CORE RECOVERY

Cameron Drilling Co. Ltd.

Tom Gladhill

Drilled by

Logged by Tom Gladhill

SECTION
ALONG LINE 100 W.

3+205 ———
2+805 ———
2+405 ———
2+005 ———
1+605 ———
1+205 ———

NORTH

SOUTH

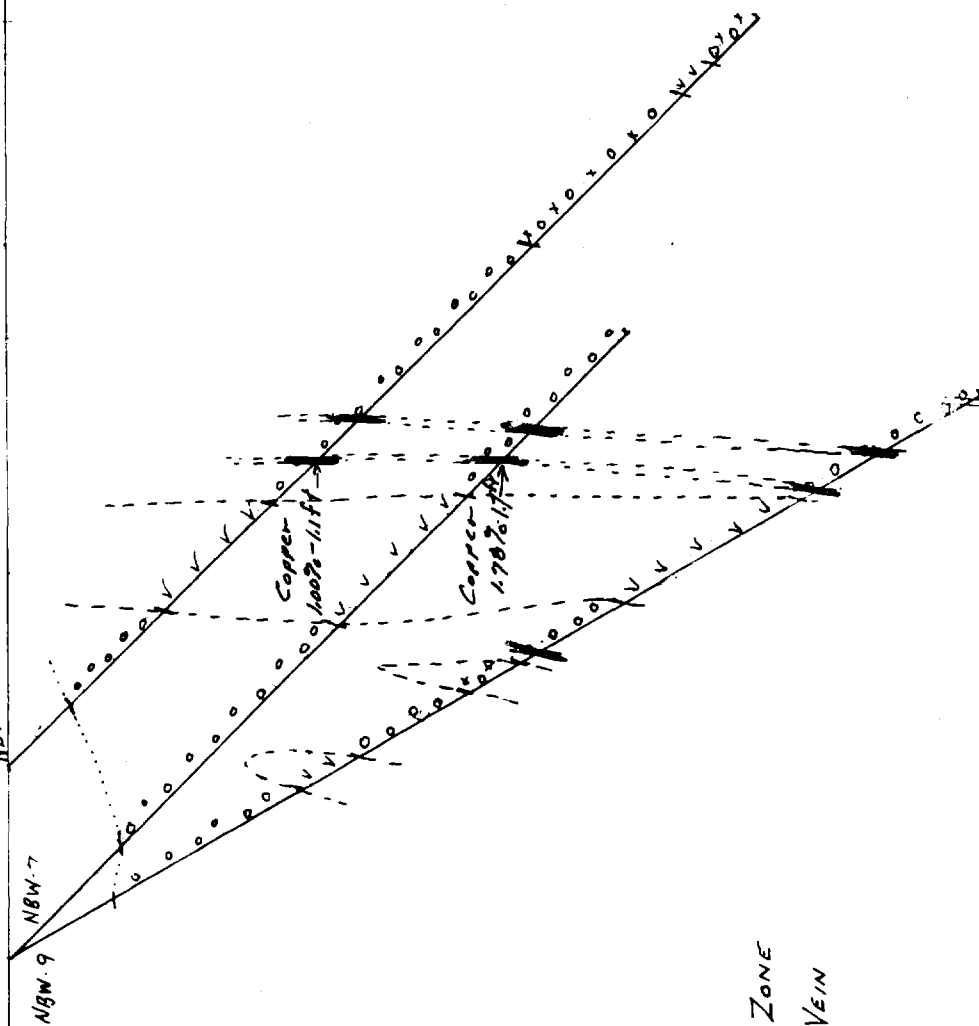

DIAMOND DRILL HOLES NBW-6
NBW-7
NBW-9

NEW BIDLAMAGUE GOLD MINES LIMITED

WODIAN OPTION
ASHMORE TOWNSHIP
DISTRICT OF THUNDER BAY
ONTARIO

GEOLOGICAL LEGEND

- v v Diorite, Quartz Diorite
- p p Diorite Porphyry
- o o o o Feldspar Porphyry
- o o x x Quartz-Feldspar Porphyry
- ▬ Sulphide Zone
- Quartz Vein

SCALE 1 INCH = 40 feet

SCOPE Aug/62

T.R.

SECTION
ALONG 1+71.3W

3+205

2+805

2+405

2+005

1+605

1+205

NORTH

SOUTH

NBW-8

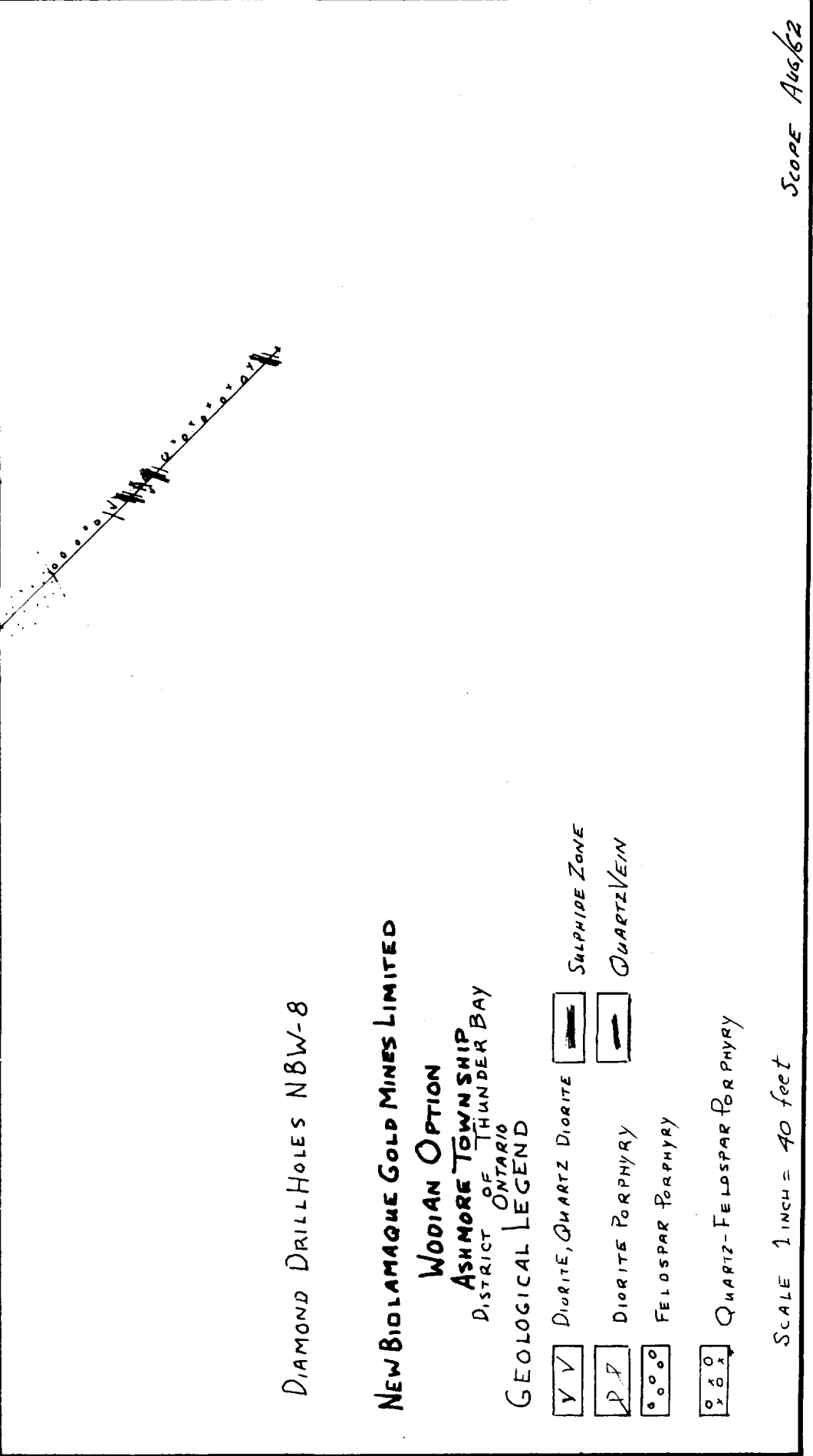

DIAMOND DRILLHOLES NBW-8

NEW BIOLAMAQUE GOLD MINES LIMITED

WOJIAN OPTION

ASHMORE TOWNSHIP
DISTRICT OF THUNDER BAY

ONTARIO

- GEOLOGICAL LEGEND
- Y V DIORITE, QUARTZ DIORITE
 - P P DIORITE PORPHYRY
 - ° ° ° FELDSPAR PORPHYRY
 - Q F Q QUARTZ-FELDSPAR PORPHYRY
 - SULPHIDE ZONE
 - QUARTZ VEIN

SCALE 1 INCH = 40 FEET

SCOPE AUG. 62

T.B.S.

L3+00W

L2+00W

L1+00W

L0+00

L1+00E

L2+00E

L3+00E

L4+00E

2+00N

BASE LINE

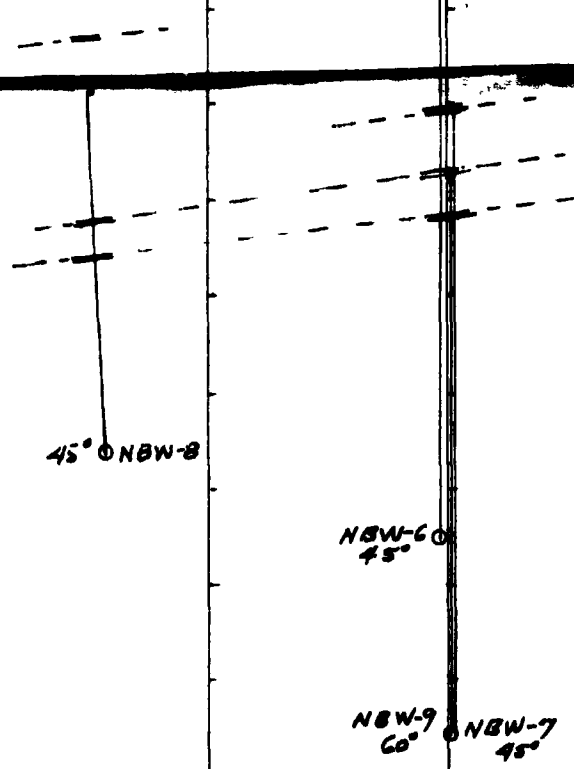
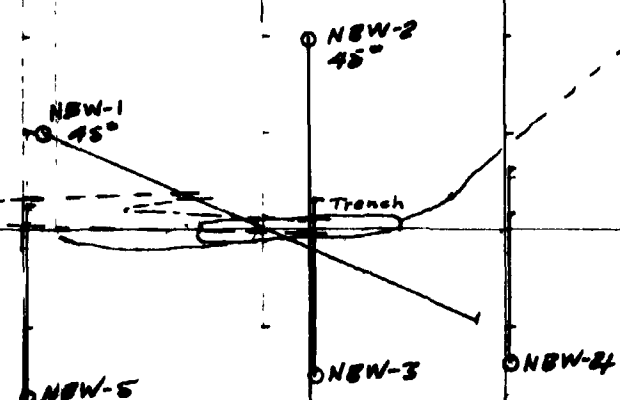

DIAMOND DRILL PLAN
 NEW BIDLAMAQUE GOLD MINES LTD.
 WODIAN OPTION
 ASHMORE TOWNSHIP
 DISTRICT OF THUNDER BAY
 ONTARIO

HOLES NBW -1
 -2
 -3
 -4
 -5
 -6
 -7
 -8
 -9
 -10
 3+00S



42E10W0150 13 ASHMORE

200

SCOPE AUG/68
 TRG.

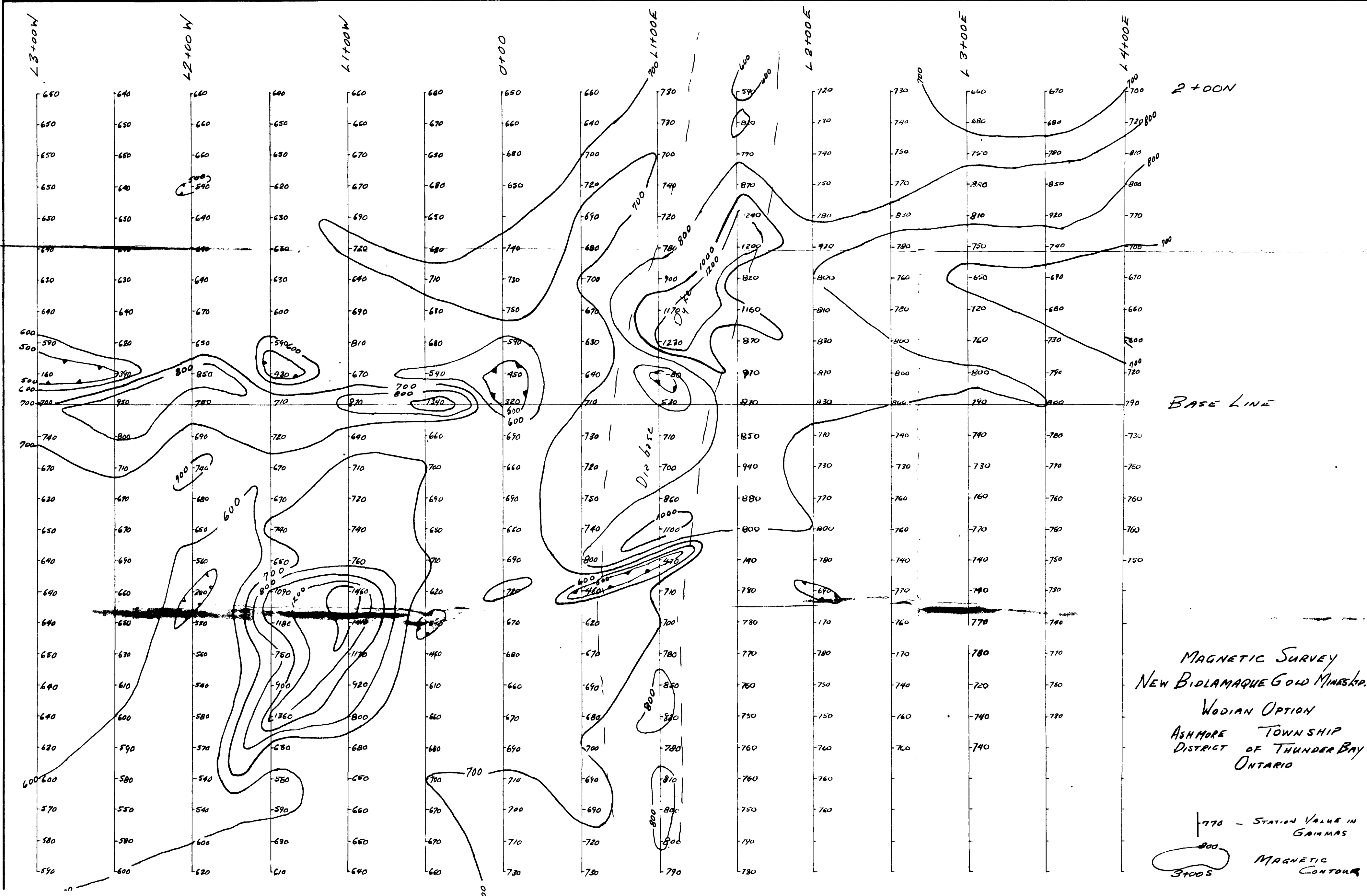

MAGNETIC SURVEY
 NEW BIDLAMAQUE GOLD MINES LTD.
 WODIAN OPTION
 ASHMORE TOWNSHIP
 DISTRICT OF THUNDER BAY
 ONTARIO

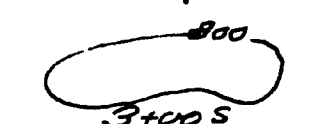
770 - STATION VALUE IN
 GAMMAS

 MAGNETIC
 CONTOUR

