

DIA



42E10NW0111 32 ASHMORE

010

TOWNSHIP: Ashmore

REPORT NO: 32

WORK PERFORMED FOR: A.Wilson

RECORDED HOLDER: SAME AS ABOVE

: OTHER

<u>CLAIM NO.</u>	<u>HOLE NO.</u>	<u>FOOTAGE</u>	<u>DATE</u>	<u>NOTE</u>
TB1195604	SW 92-1	302.5 ft	Sept 24-92	(1)

NOTES:

(1) ROW 9240 0 0231

Filed December 09 92

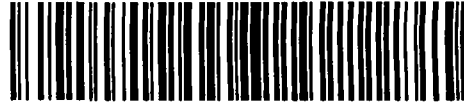

42E10NW0151 12 ASHMORE

010

Diamond Drilling

Township of ASHMORE

Report NO: 12

Work performed by: Hard Rock Gold

Claim NO	Hole NO	Footage	Date	Note
TB 38471	HG-1	444.0'	Mar/50	

Notes:

Ashmore Twp.
M 1636

Hard Rock Gold Mines, Limited
(No Personal Liability)
DIAMOND DRILL LOG

HOLE NUMBER H.G. #1
SHEET NO. 1
BEARING South
CO-ORDINATES
ELEV. of COLLAR
DIP AT Collar -45°
Etch test at 502' -47°36'

TOTAL DEPTH 502 feet
DATE BEGUN March 11, 1950
DATE FINISHED March 21, 1950

Core Sample No.	FOOTAGE	Feet	Assay Gold Data	FORMATION	REMARKS	SLUDGE	
						Feet	Value
	0.0-6.0			Casing			
	66-90	24.0		Diorite, slightly fractured, first 2.0 feet has a trace of pyrite			
	90-115	25.0		Andesite, " " , 1 quartz carb. vein at 98.5' trace of pyrite			
	115-127	12.0		Diorite, dark green, porphyritic texture.			
	127-152	25.0		Andesite, fine to medium grained, 1 quartz stringer at 142.0'			
	152-177	25.0		Volcanics, " " , light to dark green, disseminated pyrite crystals			
	177-202	25.0		" " , dark green, disseminated pyrite			
	202-227	25.0		Andesite, 3 narrow quartz carb. veins in first 10 feet trace of pyrite			
	227-252	25.0		" " , trace of pyrite and pyrrhotite			
Samples:							
4959K	241.0-241.4	0.4	0.2	Irregular, narrow, quartz veinlet, trace pyrrhotite, chalcopyrite and pyrite			
4970K	246.2247.9	1.7	Tr	1.1' quartz vein - trace pyrrhotite			
4971K	248.6-249.8	1.2	Tr	2 narrow quartz veinlets nearly parallel to core axis trace pyrite			
4972K	259.0-260.0	1.0	Tr	Andesite, disseminated pyrite, pyrrhotite and chalcopyrite			
4973K	260.0-261.8	1.8	Tr	" " " " " "			
	252.0-277.0	25.0		Andesite, fine to medium grained, few narrow quartz veinlets, trace of pyrite			
	277.0-302.0	25.0		Andesite, " " " " " " and chalcopyrite			
	302.0-352.0	50.0		Volcanics, " " " " , light to dark green, disseminated pyrite and pyrrhotite			
	352.0-402.0	50.0		Andesite, massive, uniform, green, coarse to fine grained.			
	402.0-452.0	50.0		Andesite, fine grained, light green, slightly fractured trace of pyrite			
	452-502.0	50.0		Volcanics, fine to medium grained, in places porphyritic, massive, dark green.			
Samples							
4974K	326.3-328.0	1.7	Tr	50% quartz, disseminated coarse pyrite, trace of pyrrhotite in andesite			
4975K	442.0-444.0	2.0	0.2	Quartz, carbonate veinlet almost parallel to core axis, disseminated pyrite and chalcopyrite			

HARD ROCK GOLD MINES LTD.
(NO PERSONAL LIABILITY)
MAY 11 1950
MANAGER

David F. Monrow
GEOLOGIST

4-1-95

ASHMORE

TOWNSHIP OF THUNDER BAY

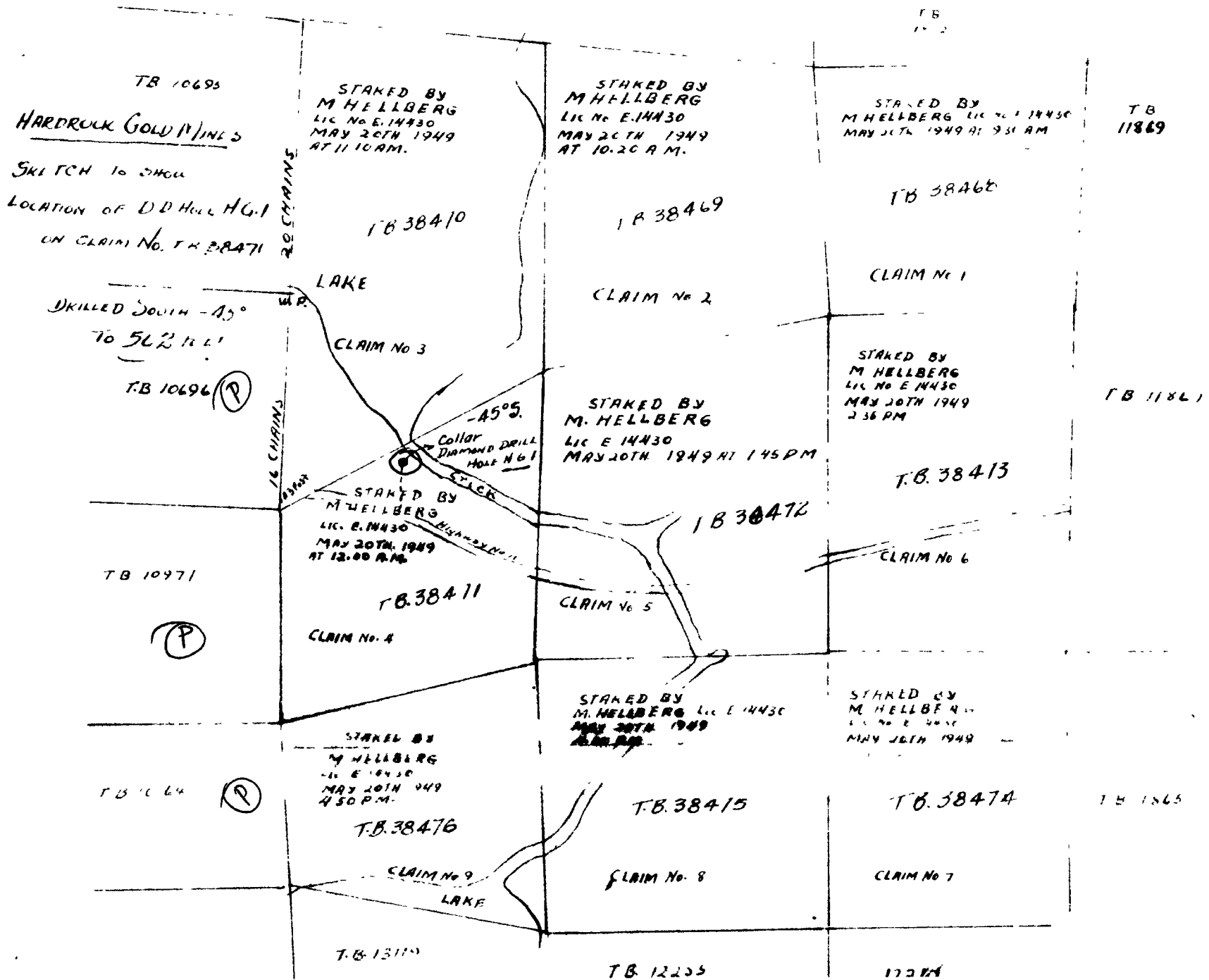

HARD ROCK GOLD MINES LTD.
SHOULD BE PERSONAL LIABILITY

M. J. Stevens

MAY 17 1950

MANAGER

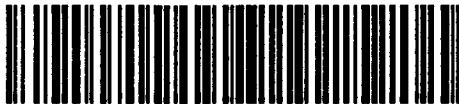

42E10W0151 12 ASHMORE

200