



42E11NW0027 10 COLTER

010

Diamond Drilling

Township of COLTER

Report No: 10

Work performed by: L. JEFFERSON ON KINGHORNE CLAIMS

Claim No	Hole No	Footage	Date	Note
TB 91721	1	20'	Aug/59	
	2	58'	Aug/59	
	3	104'	Aug/60	
	4	11.2'	Aug/60	
	5	101'	Aug/60	
	6	100.6'	Aug/60	
	7	101'	Aug/60	
	8	56'	Aug/60	
TB 91722	9	105'	Aug/60	
	10	103'	Aug/60	

Notes:

Colter Twp
M1679

LOG OF HOLES DRILLED IN 1959, CLAIMS - KINGHORNE,
TOWNSHIP OF COLTER, D.D.H. 1.

LOCATION: On mining claim T.B. 91721

780' south 7° east Line A B,
thence west mag 127' Line BCD,
thence south westerly on Line
CE 314', thence north westerly
on Line H I 11'.

AZIMUTH N. mag.

DIP 80° - Commenced August 22nd 9 a.m.
Suspended due to cave and gravel.

DEPTH 20'

0 - 20' Mostly carbonated greenstone. Very
chippy and sandy cover mud. Suspended
drilling hole pending cement or casing.

No credit given (less than 25')

~~P. H. H.~~

Jefferson

LOG OF HOLES DRILLED IN 1939, CLAIMS - KINGDOM, TOWNSHIP OF COLTIE, D.R.N. 2.

LOCATION: On mining claim C. 22290- TB 91721
19' north westerly of No. 1.

AZIMUTH N. 10° E. mag.
DIP 70° Commenced August 22nd, 4 p.m.
0 - 2'10" Carbonated greenstone
2'10"-3'2" Quartz vein
3'2"-9'4" Carbonated greenstone
9'4"-12' Broken quartz, little or no mineral
12'-13' Carbonated greenstone
13'-13'6" Ground core
13'6"-14'1" Quartz. No mineral
14'1"-19'6" Carb. greenstone
19'6"-20' Quartz
20' -20'6" Carb. greenstone
20'6" - 20'10" Quartz
20'10"-25' Carb. greenstone, ground core 33'-33'
25' - 38' Carb. greenstone 4" quartz at 27'
(Taken for sample by L. Tofferson)

Suspended drilling due to sickness and other circumstances.

Core stored. 100' N. north of
holes 5, 6, 7

L. Tofferson

**LOG OF HOLES DRILLED IN 1960, CLAIMS - KINGROSE,
TOWNSHIP OF COLTIC, P.D.M. 3.**

LOCATION: On mining claim T.B. 91721
20' n. westerly of No. 2

AZIMUTH Dip vertical
Commenced August 12, 3:30 p.m.

0 - 7'4" Carbonated greenstone
7'4" - 9'7" Cave
9'7" - 11' Carbonated greenstone, Blocky
11' - 13'9" Convy. Chips of greenstone and quartz
mixed.
13'9" - 14'1" Quartz. Little or no mineral
14'1" - 16'8" Carbonated greenstone with quartz stringers
16'8" - 17' Quartz vein
17' - 25' Carbonated greenstone, carbonate and quartz
stringers through 24'-4", Specks of chalcite
pyrite also 24' - 25'
25' - 33'9" Carbonated greenstone, more rusty carbonates
at 25' - 26'. 2" quartz at 28', some specks
mineral, 8" quartz at 33'.
33'9" - 50' Carbonated greenstone.
50' - 104' Carbonated greenstone altered and schisted.
Schisting about 70° to core.

2020 started 100' - 110' depth 4/10/60, 5/6/74

L. Jefferson

LOG OF HOLES DRILLED IN 1960, CLAIMS - KIRKWOOD,
TOWNSHIP OF COLTIER, D.P.M. 4

LOCATION: On mining claim T.B. 91721
7' s. easterly of No. 1.

AZIMUTH N. 10° W.

Commenced August 16th, 10 a.m.
Stopped August 17th, 9 a.m.

DIP 45°

0 - 6'10" Carbonated greenstone scattered showings
of iron pyrite. Some rusty carbonate cement

6'10" - 8' Cave gravel - no core

8' - 11'2" Carbonated greenstone 3", rusty carbonates
at 8'. Stringers of quartz throughout.

Holes suspended pending cement or casing.

No metal given - (less than 25')

L. Jefferson

LOG OF HOLES DRILLED IN 1960, CLAIMS - KINGHOUSE,
TOWNSHIP OF COLTER, D.D.N. 5

LOCATION: On mining claim T.B. 91721
110' S. Easterly from intersection of
Line C E F with Line H I and 29' south
westerly

AXISUTH Commenced August 17th, 9 a.m.

DIP Vertical

DEPTH 101'

0 - 16'8" Quartz and feldspar. Rough, very fine
mineral, most likely pyrites.

16'8" - 24'8" Gradual merging of porphyry into
greenstone. 4" sample of porphyry taken
at 6'4".

24'8" - 25'4" Quartz has cherty appearance.

25'4" - 30'6" Carbonated greenstone

30'6" - 37' Dark rock, black spots and blotches,
probably altered greenstone chlorite.

37' - 39' A merging into greenstone massive

39' - 61'6" Carbonated greenstone

61'6" - 62'3" 30% quartz. Little or no mineral.

62'3" - 97'6" Carbonated greenstone merges into schist
greenstone or andesite. Then feldspar quartz-quartz
porphyry somewhat carbonated. Spots of fine
mineralization.

97'6" - 97'10" Quartz

97'10" - 101' Coarser material, probably andesite. End of hole.

Core stored 100' - 101' of holes 5, 6 & 7

L. Jefferson

**LOG OF HOLES DRILLED IN 1960, CLAIMS - KINGHOUSE
TOWNSHIP OF COLTAR, D.B.R. 6**

LOCATION: On mining claim T.B. 91721
6" n. westerly of No. 3 hole

AZIMUTH N. 5° E. mag.
Commenced August 22
Finished August 24

DIP 45°

DEPTH 106'6"

0 - 25' Quartz feldspar porphyry altered, carbonated and sheared with fine disseminated sulphides throughout, shearing is 45° to core, average at 21' inclusion of what looks like small particles of red jaspilite or very red feldspar with specks of sulphides in center.

25' - 30' Altered quartz feldspar porphyry section 30'-4" - 32' more altered than the preceding core. Olivine noted in several places, then merges back to same as preceding core. Section 49'-50' has very small patches of massive fine sulphides, the section more or less mineralized with fine sulphides.

30' - 32' Same as preceding. At 32' the core merges into carbonated greenstone.

32' - 106'6" Carbonated greenstone.
End of hole.

Core stored 100' - north of Holes 5, 6 & 7

P. Jefferson

LOG OF HOLES DRILLED IN 1960, CLAIMS - KINGHORNE,
TOWNSHIP OF COLTAR, D.D.H 7

LOCATION: 2' north of Hole Number 5

AXIMUM Commenced August 24, 10:30 a.m.
Finished August 26th.

DIP 45°

DEPTH 101'

0 - 25' Quartz feldspar porphyry. 2" quartz
at 3'5" and about 3" of feldspar and
quartz at 3'3".

Note: 6'8" - 10' altered, fractured
and sheared with more than normal amount.
of iron sulphides very fine. 8'8" - 13'7"
core much more acid.

25' - 50' Alternating bands of porphyry and carbonated
greenstone. A small showing of massive
pyrite at 26'8".

50' - 55' Feldspar porphyry

55' - 56'3" Carbonated greenstone.

56'3" - 58'6" Ground core

58'6" - 96'6" Carbonated greenstone

96'6" - 99' Altered, more acid in places. Some carbonation
and brecciation, fragmental. Specks of chalcocite
pyrite noted and iron sulphides.

99' - 101' Carbonated greenstone.

Core stored 100' - North of Holes 5, 6, 7

L. Jefferson

LOG OF HOLES DRILLED IN 1960, CLAIMS - KINGHORNE,
TOWNSHIP OF COLTAR, D.D.H. 8

LOCATION: 780' south of and 170' west of the
number 1 post of T. B. 91721.

AZIMUTH Dip vertical - Depth 56'

Commenced August 28th, suspended due to
lack of water. Tried again September
5th and went to 56' when pump gave out.
Hole suspended again.

0 - 14' Carbonated greenstone very soft.
1'4" - 2'4" ground core.

15' - 56' Carbonated greenstone, sheared and wedgy
with showings of iron sulphides in the
shearings. There is a section at 9'6" of
brecciation for 5".

Hole suspended pending water.

3579 started 100^{ft} - 270^{ft} of Holes 5, 6 & 7

Jefferson

LOG OF HOLES DRILLED IN 1969, CLAIMS - KINGHORSE,
TOWNSHIP OF COLTER, D.D.N 9

LOCATION: On mining claim T.B. 91722

780' south 7° east, thence west mag
127', thence south westerly 260' to
Line E G, thence south 35° east 290'.

Commenced August 29, 9 a.m.
Finished August 31st.

DIP Vertical

DEPTH 103'

0 - 31'

Altered and highly carbonated feldspar
porphyry bands 2 - 5" of brecciation
with elongated dark materials. Small
sections 3" and 4" show iron sulphides,
small showing of chalcocite pyrite noticed
in places. 19'6" small quartz seen
showing iron sulphide and a little chalcocite
pyrite.

31' - 103'

37'6" - 40' scattered sulphides. Altered
rock merges into a more basic rock, possibly
quartz diorite or andesite.

End of hole.

Core stored 12th - East of Hole 10

L. Jefferson

**LOG OF HOLES DRILLED IN 1960; CLAIMS - KINGHOUSE,
TOWNSHIP OF COLTAR, P.E.I. 10**

LOCATION: On mining claim T.B. 91722
26' north westerly on 18' south
westerly of No. 9

AZIMUTH Commenced August 31
Finished September 4th, 3 p.m.
North 35° west.

DIP 55°

DEPTH 103'

0 - 5'3" Altered quartz and feldspar porphyry.
Small sections fragmental or brecciated
with rusty seams.

5'3" - 6'3" Ground core. Rusty and partially
decomposed at each end.

6'3" - 25' Margas more to a carbonated greenstone,
still with sections fragmental or
brecciated. 3" quartz at 10'2".
Section 12' - 13' better than normal.
Mineralization mostly iron sulphides,
specks chalcite pyrite.

25' - 30' Same as preceding though more quartz
seams. There is a 2" seam at 32'6" and at
33' with chalcite and iron sulphides visible.

30' - 82'5" Carbonated greenstone, some brecciated
sections - Less quartz seams, more massive
becomes coarser. 74'6" to 82'6" looks
more like quartz diorite or grand diorite.

82'6" - 103' Has become fine grained, massive.
103' end of hole.

NOTE: The core from all the holes drilled can be
considered for the most part as showing that
the formation is of volcanic origin, is highly
altered, schistose and sheared. It is very
difficult to define or differentiate. There
are sections one would call more fragmental
rather than brecciated, also various phases
that grade from acid to less acid, probably
andesite.

Core stored 12th - East of Hole 10

L. Jeffers 5/10/70

**SAMPLES TAKEN FOR ASSAY,
MINING CLAIMS T B 91721
and T B 91722, KINGHORN,
TOWNSHIP OF COLTIER, ONT.**

- NO. 1 From Hole 7 - from 43' to 50' *mill.*
NO. 2 " " 9 - from 31' to 33'4" *Trace.*

ROCK SPECIMENS FOR IDENTIFICATION

- | | | |
|----|---------|-----------|
| 1. | Hole 5 | At 26' |
| 2. | Hole 9 | At 13'10" |
| 3. | Hole 9 | At 34'6" |
| 4. | Hole 9 | At 40' |
| 5. | Hole 10 | At 12'10" |
| 6. | Hole 10 | At 72'10" |
| 7. | Hole 10 | At 103' |

L. Jefferson



42E11N0027 10 COLTER

900

LEGACHT TWP.

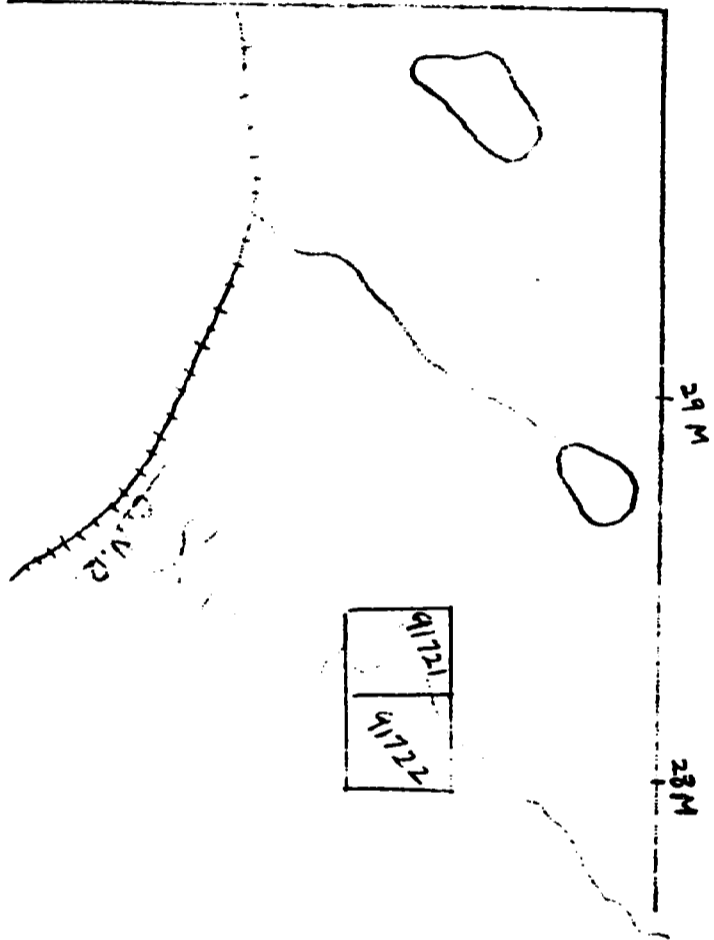

COLTER TWP
M1679

Q.V.P.

91721
91722

PLAN of PART of MINING CLAIMS T.B.91721-T.B.91722

Showing Location of Diamond Drill holes nos 1-10
Scale - 800' = 1"

Tag No. T.B.91721 Tag No. T.B.91722

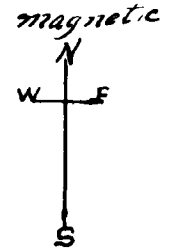

GROUP PLAN of CLAIMS

T.B.	T.B.	T.B.	T.B.
91720	91721	91722	91723
T.B.	T.B.	T.B.	T.B.
91727	91728	91729	91730
T.B.	T.B.	T.B.	T.B.
91731	91732	91733	91734
T.B.	T.B.	T.B.	T.B.
91735	91736	91737	91738

on which diamond drilling has been done to apply in assessment work
Drilling claims T.B.91721 and T.B.91722

C.N.R.
yard
Kingston 1911 20

Line of Drilling

PICKET LINE S70°E

T.B. 91721

T.B. 91722

NOTE: picket line bearings measured also distances to drill holes with surveyor's tape. All bearings made with hand compass and readings are magnetic day.

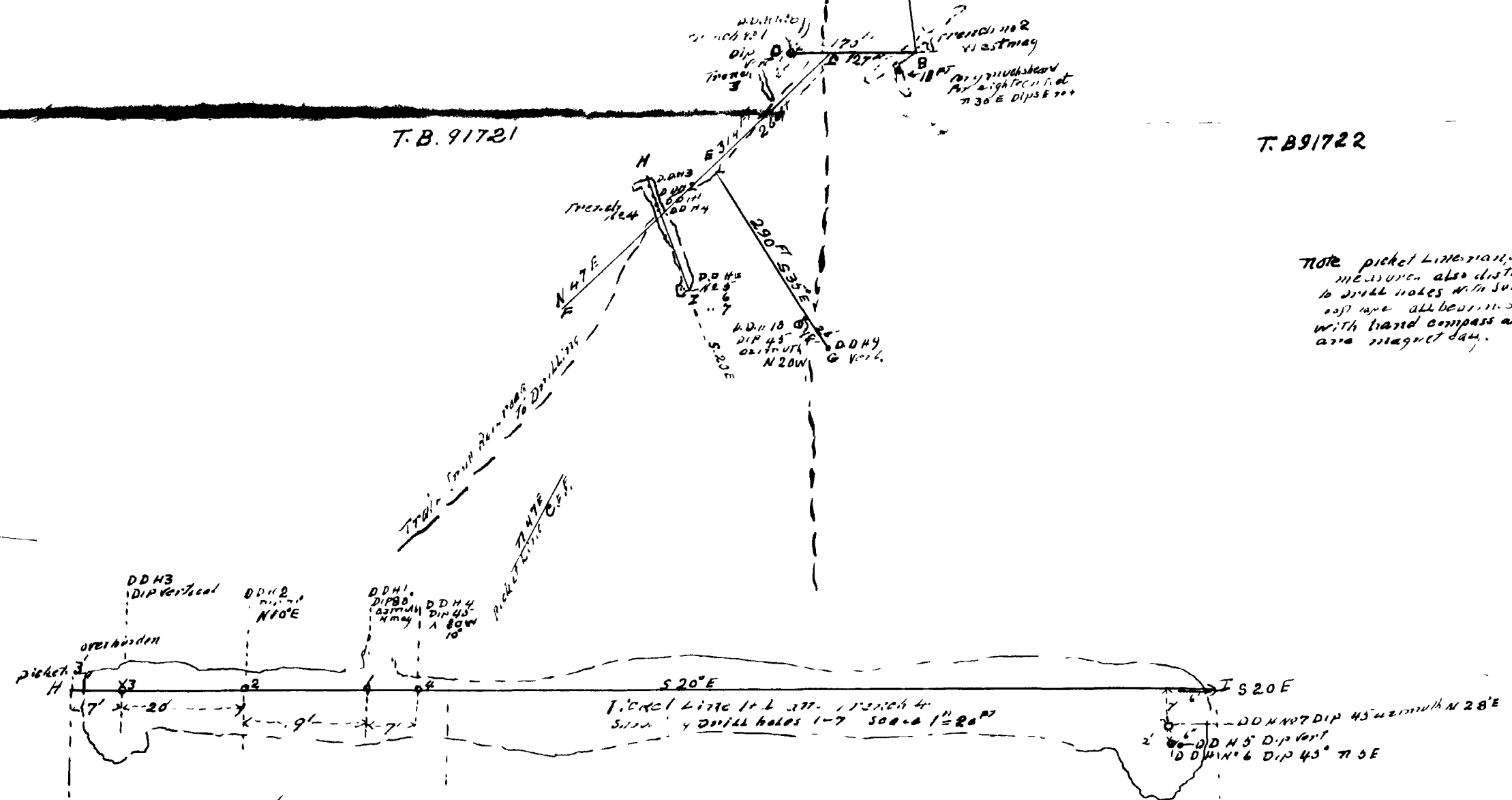

116
PLAN of TRENCH A
Scale 1" = 20'

by J. J. J. J.
Sept. 15/40

